

SUNDORO SOUTH PARK

City of Albuquerque

Department of Municipal Development – Managing Department
Park Design and Construction Division

Parks and Recreation Department – Owner

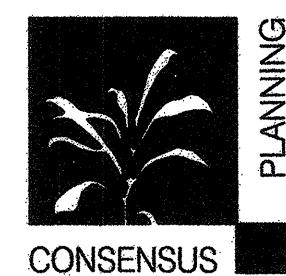

CONSENSUS PLANNING, INC.

PLANNING / LANDSCAPE ARCHITECTURE
302 EIGHTH STREET NW

ALBUQUERQUE, NM 87102

(505) 764-9801

Property Information

Legal Description: Lots A and P,

Sundoro South Unit 1

Meter Address: Ashfall Place NW – 9499 Endee Rd. NW

Zoning: SU-2 / R-LT

Total Site Area: 3.31 acres (144,330 SF)

Total Landscape Area: 0.95 acres (41,182 SF)

Total Turf Area: 1.33 acres (57,861 SF)

Parking Provided: 12

Consultants

Civil Engineering

D. Mark Goodwin & Associates

P.O. Box 90606

Albuquerque, New Mexico 87199

(505) 828-2200

Index of Drawings

- 1 Cover Sheet
- 2 General Notes
- 3 Site Plan
- 4 Grading and Drainage Plan
- 5 Enlarged Play Area
- 6 Site Details
- 7 Irrigation Plan (East)
- 8 Irrigation Plan (West)
- 9 Planting Plan
- 10 Acceptance Forms

SITE VICINITY

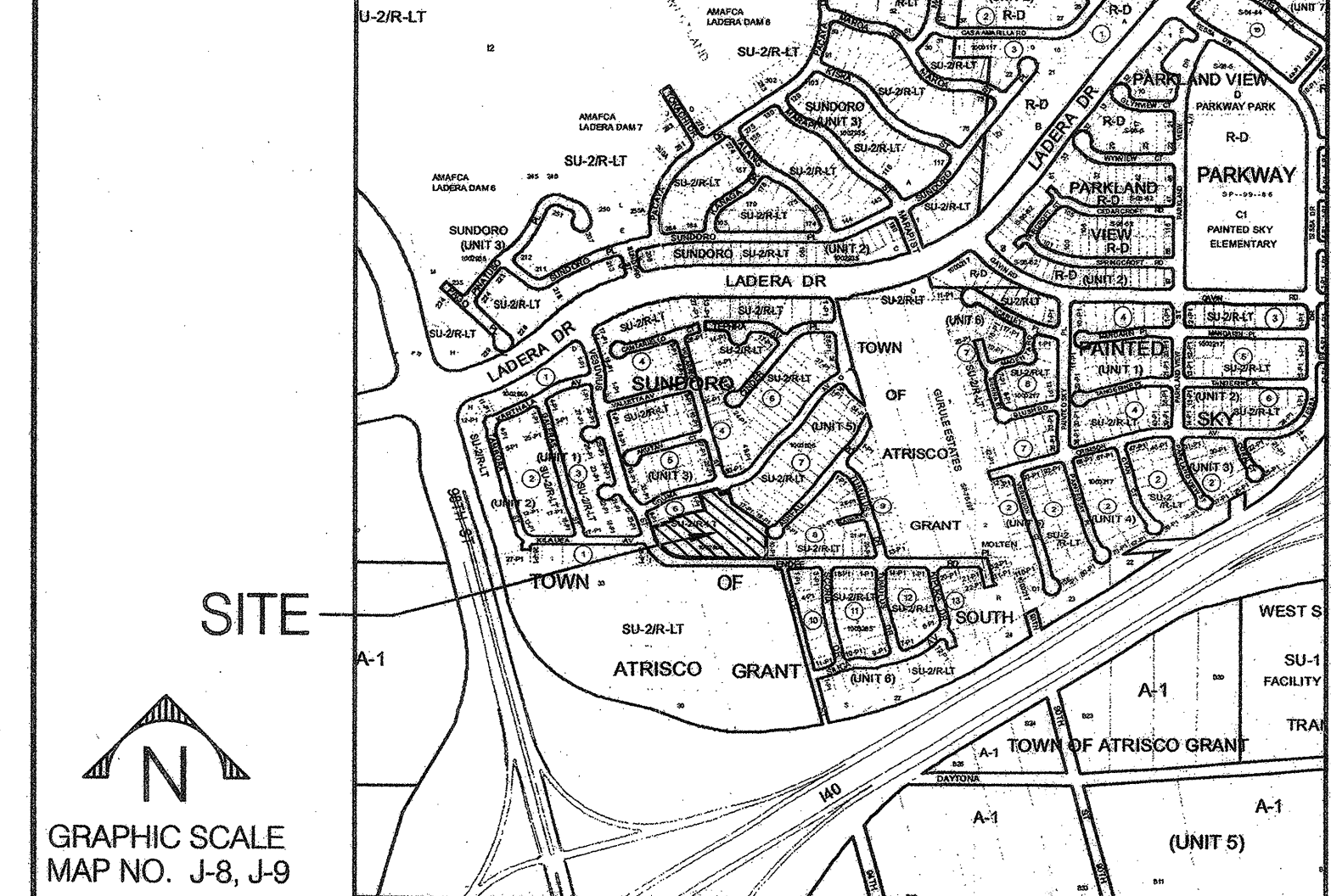

UTILITY COMPANY CONTACTS

CITY OF ALBUQUERQUE (WATER & SEWER)

NANCY MUSINSKI
Engineer/Utility Development
P.O. Box 1293
Albuquerque, New Mexico 87103
(505) 768-2729

PNM-ELECTRIC

JIM HILL
Engineering Representative
4201 Edith Boulevard NE
Albuquerque, New Mexico 87107
(505) 241-3581

PNM-GAS CO.

JOE DUNLAP
Project Engineer
4625 Edith Boulevard NE
Albuquerque, New Mexico 87107
(505) 241-7771

QUEST/US WEST

DAVID MULLER
Capacity Provisioning Specialist
400 Tijeras Ave. NW, Suite 710
Albuquerque, New Mexico 87102
(505) 245-8706

QUEST LONG DISTANCE

LARRY KELLY
Senior Operations Tech
400 Tijeras Ave. NW, Suite 710
Albuquerque, New Mexico 87102
(505) 246-0501

AT&T

DAVID CROWEL
Albuquerque, New Mexico 87103
P.O. Box 1293
Albuquerque, New Mexico 87103
(505) 842-2911

MCI WORLDWIDE

ANDY DARNELL
Operation Manager
6001 Midway Park NE
Albuquerque, New Mexico 87109
(505) 346-4470

COMCAST CABLE

RITA ERICKSON
Planning and Design Supervisor
4611 Montbel Pl. NE
Albuquerque, New Mexico 87107
(505) 761-6235

UNIVERSE ACCESS

JAMIE MARTINEZ
Resource Supervisor
505 Marquette Ave. NW, #119A
Albuquerque, New Mexico 87102
(505) 328-2675

B-SPIRE (ACSI)

JOHN MARES
505 Marquette Ave. NW, Suite 1605
Albuquerque, New Mexico 87102
(505) 998-2274

McLEOD USA

RICK MUELLER
Supervisor of Outside Techs.
505 Marquette Ave. NW, Suite 1600
Albuquerque, New Mexico 87102
(505) 244-3161

CityNet TELECOMMUNICATIONS

JOSH NELSON
Field Representative
13500 Coronado freeway
Albuquerque, New Mexico 87121
(505) 991-2120

TIME WARNER TELECOM

ROY HARRISON
Plant Manager
3830 Singer Blvd. NE, Suite 1000
Albuquerque, New Mexico 87109
(505) 938-7339

LEVEL 3 COMMUNICATIONS, LLC

STEVE GILMAN
Resource Supervisor
1025 Eldorado Blvd.
Broomfield, Colorado 80021
(720) 888-5920

EXPEDIUS MANAGEMENT CO.

STEVE BENJAMIN
Operations Support Manager
505 Marquette Ave. NW, Suite 1605
Albuquerque, New Mexico 87102
(505) 345-6555

OSO GRANDE TECHNOLOGIES

BUD LENSING
Resource Supervisor
505 Marquette Ave. NW, #119A
Albuquerque, New Mexico 87102
(505) 328-2675



REV.	SHEETS	CITY ENGINEER	DATE	USER DEPARTMENT	DATE	USER DEPARTMENT	DATE
ENGINEERS STAMP & SIGNATURE		APPROVED	ENGINEER	DATE	APPROVED FOR CONSTRUCTION		
 CHRISTOPHER J. GREEN #234 REGISTERED LANDSCAPE ARCHITECT 9.15.06		DRC Chairman	<i>[Signature]</i>	11-10-06	<i>[Signature]</i> CITY ENGINEER DATE		
		Transportation	<i>[Signature]</i>	10/19/06			
		Water/Wastewater	<i>[Signature]</i>	9/20/06			
		Hydrology	<i>[Signature]</i>	10-18-06			
		CIP	<i>[Signature]</i>				
		Constr. Mngmt.					
		Constr. Coord.					
		PROJECT NUMBER			777591		
		SHEET			1 OF 10		

- 1 FIVE (5) WORKING DAYS PRIOR TO BEGINNING CONSTRUCTION, THE CONTRACTOR WILL SUBMIT A DETAILED CONSTRUCTION SCHEDULE TO THE CITY CONSTRUCTION COORDINATION DIVISION. TWO (2) DAYS PRIOR TO CONSTRUCTION, THE CONTRACTOR WILL OBTAIN A BARRICADING PERMIT FROM THE CONSTRUCTION COORDINATION DIVISION. CONTRACTOR SHALL NOTIFY BARRICADE ENGINEER (924-3400) PRIOR TO OCCUPYING AN INTERSECTION. REFER TO SECTION 19 OF SPECIFICATIONS.
- 2 THE CONTRACTOR WILL NOTIFY THE FIELD ENGINEER NOT LESS THAN SEVEN (7) DAYS PRIOR TO STARTING WORK, IN ORDER THAT THE CITY SURVEY SECTION MAY TAKE NECESSARY MEASURES TO INSURE THE PRESERVATION OF SURVEY MONUMENTS. THE CONTRACTOR WILL NOTIFY THE ENGINEER IF A MONUMENT IS DISTURBED. REPLACEMENT WILL BE DONE ONLY BY THE CITY OF ALBUQUERQUE SURVEY SECTION AT THE CONTRACTOR'S EXPENSE. WHEN A CHANGE IS MADE IN THE FINISHED ELEV. OF THE PAVEMENT OF ANY ROADWAY IN WHICH A PERMANENT SURVEY MONUMENT IS LOCATED, CONTRACTOR WILL, AT HIS OWN EXPENSE, HAVE THE CITY SURVEY SECTION ADJUST THE MONUMENT COVER TO THE NEW GRADE UNLESS OTHERWISE SPECIFIED. REFER TO SECTION 4 OF SPECIFICATIONS.
- 3 THE SPECIFICATIONS USED FOR THIS PROJECT ARE THE CITY OF ALBUQUERQUE STANDARD SPECIFICATIONS FOR PUBLIC WORKS CONSTRUCTION, 1986 EDITION, UPDATE NO. 7, INCLUDING AMENMENT #1.
- 4 ALL NEW MANHOLES SHALL BE TYPE "E" (COA DWG. 2102) UNLESS OTHERWISE NOTED ON THE PLANS.
- 5 THE CONTRACTOR WILL BE RESPONSIBLE FOR DISPOSING OF ALL DEBRIS, INCLUDING, BUT NOT LIMITED TO HAZARDOUS WASTE AT DISPOSAL SITES APPROVED BY GOVERNMENTAL AGENCIES REGULATING THE DISPOSAL OF SUCH MATERIALS.
- 6 ALL WATER VALVE BOXES AND MANHOLES IN THE STREET CONSTRUCTION ARE TO BE ADJUSTED TO FINISH GRADE AND WILL BE MEASURED AND PAID PER EACH.
- 7 SUBGRADE PREPARATION UNDER SIDEWALKS AND DRIVE PADS, AND SUBGRADE AND SUBBASE PREPARATION UNDER CURB AND GUTTER IS CONSIDERED INCIDENTAL TO THE CONSTRUCTION OF SUCH, AND NO DIRECT PAYMENT SHALL BE MADE FOR THOSE ITEMS OF WORK.
- 8 THE CONTRACTOR WILL REPLACE ANY STRIPPING THAT HAS BEEN RUINED OR REMOVED IN THE COURSE OF CONSTRUCTION.
- 9 ALL EXCAVATION WILL BE GOVERNED BY FEDERAL, STATE AND LOCAL LAWS, RULES, AND REGULATIONS CONCERNING CONSTRUCTION SAFETY AND HEALTH.
- 10 ALL SIGNS AND CODING WILL BE IN ACCORDANCE WITH THE "MANUAL OF UNIFORM TRAFFIC CONTROL DEVICES FOR STREETS AND HIGHWAYS" CURRENT EDITION PUBLISHED BY THE U.S. DEPARTMENT OF TRANSPORTATION.
- 11 THE CONTRACTOR IS TO EXERCISE CARE TO AVOID DISTURBING ANY EXISTING UNDERGROUND UTILITIES. IT WILL BE HIS RESPONSIBILITY TO COORDINATE WITH THE UTILITY COMPANIES IN ORDER TO PREVENT ANY SERVICE DISRUPTION. SEE SECTION 18 "UTILITIES", CITY OF ALBUQUERQUE, STANDARD SPECIFICATIONS FOR CONTRACTOR REQUIREMENTS.
- 12 WHEN ABUTTING NEW PAVEMENT TO EXISTING INTERSECTING STREETS, SAW CUT EXISTING PAVEMENT TO A STRAIGHT LINE AND AT RIGHT ANGLES AND REMOVE ANY BROKEN OR CRACKED PAVEMENT. NO DIRECT PAYMENT WILL BE MADE FOR SAW CUTTING.
- 13 ALL GAS VALVES, GAS MANHOLES, ELECTRICAL MANHOLES, TELEPHONE MANHOLES, AND UTILITY POLES WILL BE ADJUSTED TO GRADE BY EACH UTILITY COMPANY. CONTRACTOR WILL COORDINATE THROUGH CITY UTILITY COORDINATOR.
- 14 WHEN REMOVAL OF EXISTING CURB AND GUTTER OR SIDEWALK IS REQUIRED, REMOVE BACK TO NEAREST SUITABLE JOINT UNLESS OTHERWISE DIRECTED BY THE CITY FIELD ENGINEER.
- 15 THE CONTRACTOR WILL NOTIFY THE NEW MEXICO ONE CALL SYSTEM 260-1990 TWO (2) WORKING DAYS PRIOR TO COMMENCING WORK IN NEW AREAS.
- 16 CONTRACTOR WILL MAKE ALL WATER VALVES AND MANHOLES ACCESSIBLE TO THE CITY AT ALL TIMES.
- 17 CONTRACTOR WILL PLACE BITUMINOUS MATERIAL WITH THE USE OF A LAYDOWN MACHINE WHERE PAVEMENT IS 8 FEET IN WIDTH OR WIDER.
- 18 ALL SUBGRADE AND SUBBASE MATERIAL ENCOUNTERED IN PAVEMENT REMOVAL AND REPLACEMENT THAT IS DETERMINED BY THE FIELD ENGINEER TO MEET THE SPECIFICATIONS, CAN BE REUSED. HOWEVER, THE MATERIAL WILL BE PROCESSED AND COMPACTED TO MEET MOISTURE CONTENT AND PERCENT COMPACTION REQUIRED BY THE SPECIFICATIONS.
- 19 CONTRACTOR WILL NOT PAVE OVER ANY SURFACE FEATURE, I.E., GAS VALVE, MANHOLE COVER, ETC. WITHOUT PRIOR APPROVAL FROM THE CITY FIELD ENGINEER.
- 20 CONTRACTOR WILL CONFINE HIS WORK WITHIN THE CONSTRUCTION EASEMENT LIMITS AND/OR RIGHT-OF-WAY, OR PROVIDE COPIES OF AGREEMENTS WITH ADJACENT LANDOWNERS TO THE CITY OF ALBUQUERQUE.
- 21 ALL WATER VALVES AND FIRE HYDRANTS REMOVED TO BE SALVAGED AND RETURNED TO THE C.O.A.
- 22 MINIMUM BOTTOM WIDTH OF TRENCHES FOR RIGID PIPE SHALL BE EQUAL TO THE OUTSIDE DIAMETER PLUS 16 INCHES. BEDDING MATERIAL SHALL BE CLASS II, III, OR IV UNLESS OTHERWISE SPECIFICALLY NOTED ON THE PLANS.
- 23 MINIMUM BOTTOM WIDTH OF TRENCHES FOR NON-RIGID PIPE SHALL BE EQUAL TO THE OUTSIDE DIAMETER PLUS 12 INCHES. BEDDING MATERIAL SHALL BE CLASS I, II, OR III.
- 24 THE CONTRACTOR AGREES TO TAKE NECESSARY SAFETY PRECAUTIONS AS REQUIRED BY FEDERAL, STATE AND LOCAL AUTHORITIES TO PROTECT PEDESTRIAN AND VEHICULAR TRAFFIC IN THE CONSTRUCTION AREA, WHICH INCLUDE BUT ARE NOT LIMITED TO: MAINTAINING ADEQUATE WARNING SIGNS, BARRICADES, LIGHTS, GUARD FENCES, WALKS AND BRIDGES.
- 25 ALL STRUCTURAL CONCRETE WILL BE 3000 PSI UNLESS OTHERWISE NOTED ON PLANS.
- 26 ALL REINFORCING STEEL WILL BE GRADE 60.
- 27 ALL EXPOSED EDGES ON CAST-IN-PLACE CONCRETE STRUCTURES WILL HAVE A 1" CHAMFER UNLESS OTHERWISE NOTED.
- 28 ALL SPLICES IN REINFORCING STEEL TO BE 2-FOOT 6-INCH MINIMUM UNLESS OTHERWISE NOTED.

- 29 PRIOR TO CONSTRUCTION, THE CONTRACTOR WILL EXCAVATE AND VERIFY THE HORIZONTAL AND VERTICAL LOCATIONS OF ALL POTENTIAL CONFLICTING UTILITIES. SHOULD A CONFLICT EXIST BETWEEN THE FIELD INFORMATION AND THE PLANS, THE CONTRACTOR WILL NOTIFY THE FIELD ENGINEER SO THE CONFLICT CAN BE RESOLVED WITH MINIMUM AMOUNT OF DELAY.
- 30 THE REPLACEMENT OF THE EXISTING UTILITIES AND THE INSTALLATION OF NEW UTILITY LINES WILL BE COMPLETED IN ADVANCE OF STARTING THE PAVEMENT WORK. TEMPORARY PAVEMENT WILL BE PLACED IN ALL TRENCHES REQUIRED FOR THE UTILITY REPLACEMENTS IN THOSE AREAS THAT MUST MAINTAIN TRAFFIC UNTIL THE FINAL PAVEMENT WORK STARTS IN EACH AREA. TEMPORARY STRIPING SHALL BE THE CONTRACTOR'S RESPONSIBILITY. MAINTENANCE OF THE TEMPORARY PAVING AND STRIPING WILL BE AT THE CONTRACTOR'S EXPENSE.
- 31 TACK COAT FOR SURFACE COURSE REQUIREMENTS WILL BE DETERMINED BY THE ENGINEER.
- 32 THE CONTRACTOR WILL CONTACT THE CITY OF ALBUQUERQUE TRAFFIC DIVISION 857-8004, ONE (1) WEEK IN ADVANCE OF ANY CHANGES REQUIRED IN THE TRAFFIC SIGNALIZATION OF THIS PROJECT. ALL WORK ASSOCIATED WITH NEW TRAFFIC SIGNALIZATION SHALL BE THE RESPONSIBILITY OF THE CONTRACTOR.
- 33 ALL NEW STREET PAVING, DRIVEWAYS, SIDEWALKS, AND CURB AND GUTTERS, ABUTTING EXISTING AREAS SHALL MATCH THE ELEVATION OF THOSE AREAS.
- 34 PERMANENT PAVEMENT STRIPING AND MARKINGS WILL BE PLACED BY THE CONTRACTOR. ROAD SHALL NOT BE OPENED TO TRAFFIC UNTIL IT IS STRIPED. ALL STRIPING, PAVEMENT MARKINGS INCLUDING CROSSWALKS, ARROWS AND LINE MARKINGS ARE TO BE CONSTRUCTED OF HOT PLASTIC OR COLD PLASTIC IN ACCORDANCE WITH THE MANUAL OF UNIFORM TRAFFIC CONTROL DEVICES.
- 35 ALL EXCAVATED MATERIAL THAT IS NOT REQUIRED TO BE REUSED MUST BE REMOVED FROM THE PROJECT AREA WITHIN FOUR DAYS OF EXCAVATION. SPOIL PILES WILL BE ALLOWED ONLY AS DIRECTED BY THE CITY FIELD ENGINEER.
- 36 THE CONTRACTOR WILL COORDINATE THE CONSTRUCTION ACTIVITIES WITH ALL OTHER CONTRACTORS AND UTILITY COMPANIES WORKING IN THE SAME AREA. THE CONTRACTOR MAY BE REQUIRED TO RESCHEDULE THEIR ACTIVITIES TO ALLOW UTILITY CREWS TO PERFORM THEIR REQUIRED WORK. NO ADDITIONAL COMPENSATION WILL BE ALLOWED FOR DELAYS OR INCONVENIENCE CAUSED BY UTILITY COMPANY WORK CREWS. A CONTRACT EXTENSION MAY BE ALLOWED AS DELINEATED IN CITY OF ALBUQUERQUE STANDARD SPECIFICATIONS.
- 37 ALL CONSTRUCTION EASEMENTS ON PRIVATE PROPERTY WILL BE OBTAINED BY THE CITY OF ALBUQUERQUE PRIOR TO THE BEGINNING OF CONSTRUCTION.
- 38 EXISTING MEDIAN CURB AND GUTTER AND STANDARD CURB AND GUTTER, NOT DISTURBED BY CONTRACTOR, BUT OUT OF ALIGNMENT, DISPLACED VERTICALLY, BADLY BROKEN AND/OR DETERIORATED, WILL BE REPLACED AS DIRECTED BY THE FIELD ENGINEER AND PAID FOR AT CONTRACT UNIT PRICES.
- 39 ALL TRAFFIC CONTROL DEVICES REQUIRED FOR DRIVEWAY CLOSURES, UTILITY CONSTRUCTION OR FOR OTHER REASONS AND NOT SHOWN ON THE SIGNING PLANS WILL BE FURNISHED BY THE CONTRACTOR AND WILL BE PAID AS SPECIFIED IN THE TECHNICAL SPECIFICATIONS AND BID PROPOSAL. PRIOR TO PLACING THE TRAFFIC CONTROL DEVICES, THE CONTRACTOR WILL NOTIFY THE AFFECTED OWNERS IN ACCORDANCE WITH THE SPECIFICATIONS. CONTRACTOR MUST MAKE PROVISIONS TO PROVIDE ACCESS TO PROPERTIES. REFER TO SECTION 19 OF THE SPECIFICATIONS.
- 40 ALL UTILITY LINES WHICH ARE NOT SPECIFICALLY DESIGNATED TO BE REMOVED AND REPLACED ON THE PLANS, WILL BE MAINTAINED IN SERVICE. SHORING, SHEETING AND OTHER MEANS OF SUPPORT SHALL BE EMPLOYED BY THE CONTRACTOR TO PREVENT DAMAGE OR LOSS OF THESE EXISTING UTILITIES AND THESE SHORING, SHEETING, AND SUPPORTS ARE CONSIDERED INCIDENTAL TO THIS PROJECT. BEAM AND CABLE OR OTHER ADEQUATE SUPPORTS WILL BE USED FOR TEMPORARY SUPPORT OF ALL UTILITY LINES WHICH CROSS THE TRENCH. ANY DAMAGE TO EXISTING UTILITIES WILL PROMPTLY BE REPAIRED AT THE CONTRACTOR'S EXPENSE. THE CONTRACTOR WILL NOTIFY THE ENGINEER IMMEDIATELY OF ANY SIGNIFICANT DEVIATION OF EXPOSED UTILITIES FROM THE LOCATIONS SHOWN ON THE PLANS SO THAT CONFLICTS CAN BE RESOLVED IN A TIMELY MANNER.
- 41 THE CONTRACTOR WILL ASSUME RESPONSIBILITY FOR ANY DAMAGE TO EXISTING COA INFRASTRUCTURE (C & G, PAVING, ETC.) DURING CONSTRUCTION, APART FROM THOSE SECTIONS INDICATED FOR REMOVAL ON THE PLANS, AND WILL REPAIR OR REPLACE SAME AT HIS OWN EXPENSE. HE WILL SUITABLY PROTECT THE CURB AND GUTTER FROM INCIDENTAL SPLASHING DURING THE TACK COAT APPLICATION AND WILL BE RESPONSIBLE FOR CLEANING SAME AT HIS OWN COST SHOULD SPLASHING OCCUR.
- 42 ALL INTERFERING PORTIONS OF ABANDONED UTILITY LINES WHICH ARE EXPOSED AS A RESULT OF CONSTRUCTION WILL BE REMOVED AND DISPOSED OF BY THE CONTRACTOR.
- 43 STATIONS OF STORM DRAIN INLETS ARE TO THE CENTER OF GRATE. ALL STORM DRAIN INLETS WILL BE TYPE "A" UNLESS OTHERWISE NOTED ON THE PLANS.
- 44 SHORING COSTS WILL BE CONSIDERED INCIDENTAL TO THE TRENCH AND BACKFILL COSTS.
- 45 THE CONTRACTOR WILL BE RESPONSIBLE FOR SECURING NPDES PERMITS REQUIRED BY APPLICABLE CITY, STATE, AND FEDERAL REGULATIONS.
- 46 ALL STORM DRAIN AND CONNECTOR PIPE WILL BE CLASS IV REINFORCED CONCRETE PIPE UNLESS OTHERWISE NOTED ON THE PLANS.
- 47 THE TERM REMOVE USED IN THIS PLAN SET INCLUDES THE DISPOSAL OF SAID MATERIAL IN ACCORDANCE WITH CITY OF ALBUQUERQUE SPECIFICATIONS, LATEST EDITION.
- 48 CONTRACTOR WILL SURVEY AND LOG EXISTING ELEVATIONS OF CURB-AND-GUTTER, SIDEWALK, AND PAVEMENT WHICH WILL BE REMOVED FOR CONSTRUCTION OF IMPROVEMENTS. CONTRACTOR WILL REPLACE REMOVED CURB-AND-GUTTER, SIDEWALK, DRIVE PADS, AND PAVEMENT TO ELEVATIONS PRIOR TO REMOVAL UNLESS OTHERWISE INDICATED ON THE PLANS.
- 49 CONTRACTOR WILL CONSTRUCT TEMPORARY ASPHALT PAVEMENT AS DIRECTED BY THE FIELD ENGINEER TO PROVIDE ACCESS TO LOCAL BUSINESS, ETC. TEMPORARY PAVEMENT SHALL BE REMOVED AND DISPOSED OF PRIOR TO PLACEMENT OF FULL WIDTH PAVEMENT SECTION. TEMPORARY PAVING SHALL BE PER COA STD. DWG. 2415B AND PAID FOR PER COA STD. SPECIFICATIONS.

- 50 ALL CLASSES OF SEEDING SHALL BE DRY LAND MIX PLACED AT 1.5 LBS/1000 S.F. WITH FERTILIZER 21-12-12 PLACED AT 5 LBS/1000 S.F.
- 51 ANY WORK OCCURRING WITHIN AN ARTERIAL ROADWAY REQUIRES TWENTY-FOUR (24) HOUR CONSTRUCTION.
- 52 ALL EXCAVATION, TRENCHING AND SHORING ACTIVITIES MUST BE CARRIED-OUT IN ACCORDANCE WITH OSHA 29 CFR 1926.650 SUBPART P.
- 53 THE CONTRACTOR SHALL BE RESPONSIBLE FOR TIMING AND COORDINATION OF WATER SHUTOFF AT LEAST SEVEN (7) WORKING DAYS PRIOR TO CONSTRUCTION. CONTRACTOR SHALL CONTACT THE WATER SYSTEMS DIVISION, 857-8200, TO INITIATE IMPLEMENTATION OF THE NON-PRESSURIZED CONNECTION PLAN.
- 54 FOR STORM DRAIN CONSTRUCTION, RCP PIPE JOINTS SHALL NOT BE GROUTED PRIOR TO FINAL INSPECTION. FINAL INSPECTION WILL DETERMINE JOINTS TO BE GROUTED FOR FINAL ACCEPTANCE OF THE CONSTRUCTION.
- 55 CONTRACTOR SHALL MAINTAIN A GRAFFITI-FREE WORK SITE. CONTRACTOR SHALL PROMPTLY REMOVE ANY AND ALL GRAFFITI FROM EQUIPMENT, WHETHER PERMANENT OR TEMPORARY.
- 56 CONTRACTOR SHALL ERECT TEMPORARY CHAIN LINK CONSTRUCTION FENCE. SUCH FENCE SHALL BE MAINTAINED THROUGHOUT THE DURATION OF THE CONSTRUCTION PERIOD AND REMOVED ONLY UPON FINAL ACCEPTANCE OF THE PROJECT BY THE CITY.
- 57 CONTRACTOR SHALL BE RESPONSIBLE FOR PROVIDING AND MAINTAINING ALL CONSTRUCTION SIGNAGE UNTIL PROJECT HAS BEEN ACCEPTED BY THE CITY.
- 58 QUANTITIES PROVIDED ON THE PLANS ARE FOR THE CONTRACTOR'S CONVENIENCE ONLY. PLANS SHALL TAKE PRECEDENCE IN ALL CASES.

EXISTING FEATURES LEGEND:

- o----- EXISTING WOOD POST FENCE
- x----- EXISTING CHAIN-LINK FENCE
- 2" HPG EXISTING GAS LINE W/ VALVE
- 6" W EXISTING WATERLINE W/ VALVE
- EXISTING WATERLINE METER
- EXISTING FIRE HYDRANT
- 6" SAS EXISTING SANITARY SEWER LINE W/ MANHOLE
- 30" RCP EXISTING STORM DRAIN
- OHE--- EXISTING OVERHEAD ELECTRIC W/POLE
- UE--- EXISTING UNDERGROUND ELECTRIC
- 44----- EXISTING 1' CONTOUR
- 4945----- EXISTING 5' CONTOUR
- ===== EXISTING CURB & GUTTER
- ===== EXISTING CONCRETE
- EXISTING BUILDING LINE
- S----- EXISTING EASEMENT LINE
- EXISTING SPRINKLER HEAD

NEW FEATURES LEGEND:

- CONSTRUCTION CENTERLINE
- x----- NEW CHAIN-LINK FENCE
- 2" HPG NEW GAS LINE W/ VALVE
- 6" W NEW WATERLINE W/ VALVE
- NEW WATERLINE METER
- NEW FIRE HYDRANT
- 6" SAS NEW SANITARY SEWER LINE W/ MANHOLE
- NEW STORM DRAIN W/ MH
- * NEW UTILITY POLE
- 4945----- NEW 5' CONTOUR
- ===== NEW CURB & GUTTER
- ===== NEW CONCRETE
- NEW EASEMENT LINE
- POT HOLE LOCATION W/ NO.
- ////// NEW EDGE OF PAVEMENT

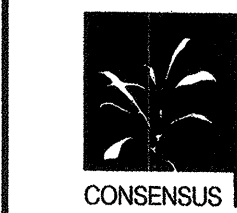

CONSENSUS PLANNING, INC.
Planning / Landscape Architecture
302 Eighth Street NW
Albuquerque, NM 87102
(505) 764-9801 Fax 842-5495
e-mail: cp@consensusplanning.com

CITY OF ALBUQUERQUE
DEPARTMENT OF MUNICIPAL DEVELOPMENT
PARK DESIGN AND CONSTRUCTION DIVISION

TITLE: SUNDORO SOUTH PARK
GENERAL NOTES

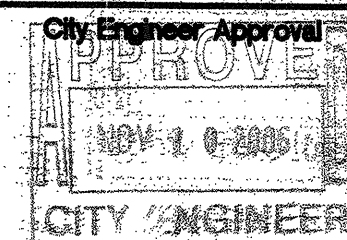
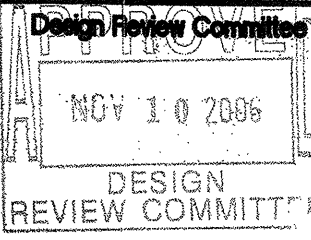

No. / Day / Yr.	No. / Day / Yr.

City Project No.

777591

Zone Map No.
J-8/J-9

Sheet 2 of 10

AS-BUILT INFORMATION		BENCH MARKS		SURVEY INFORMATION		ENGINEER'S SEAL	
CONTRACTOR	DATE	CONTRACTOR	DATE	NO.	BY	NO.	BY
INSPECTED BY	DATE	INSPECTED BY	DATE	NO.	BY	NO.	BY
FIELD ENGINEER	DATE	FIELD ENGINEER	DATE	NO.	BY	NO.	BY
VERIFIED BY	DATE	VERIFIED BY	DATE	NO.	BY	NO.	BY
CHECKED BY	DATE	CHECKED BY	DATE	NO.	BY	NO.	BY
RECORDED BY	DATE	RECORDED BY	DATE	NO.	BY	NO.	BY
NO.	DATE	NO.	DATE	NO.	BY	NO.	BY

9-15-06

REMARKS	BY
REVISIONS	
DESIGN	
DESIGNED BY JR	DATE 9/15/06
DRAWN BY JR	DATE 9/15/06
CHECKED BY CS	DATE 9/15/06

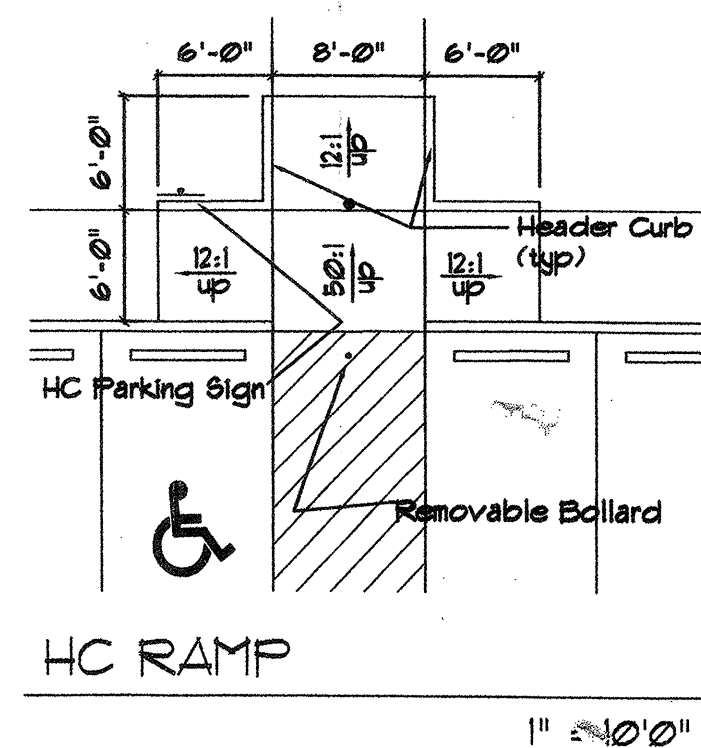

*Truncated domes shall be designed per ADA guidelines. Contractor shall submit specifications to City Construction Engineer prior to construction for evaluation.

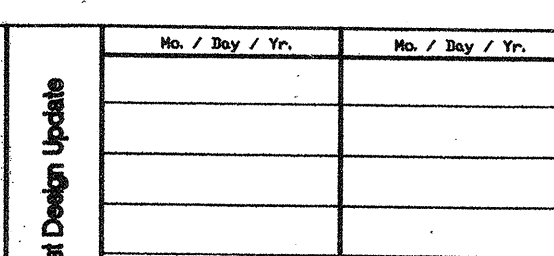
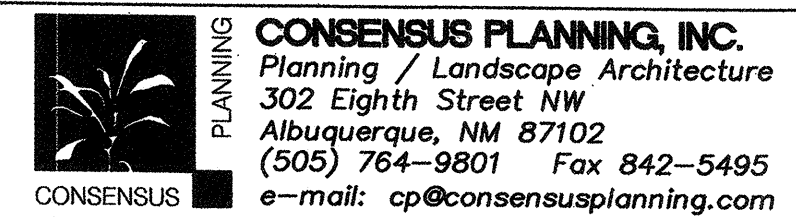
[illegible]

NOTICE TO CONTRACTOR

1. An excavation/construction permit will be required before beginning any work within City right of way.
2. All work detailed on these plans to be performed, except as otherwise stated or provided hereon, shall be constructed in accordance with "City of Albuquerque Standard Specifications for Public Works Construction" (1985 Edition).
3. Two working days prior to any excavation, Contractor must contact the Line Locating Service, 765-1234, for location of existing utilities.
4. Prior to construction, the Contractor shall excavate and verify the horizontal and vertical locations of all obstructions. Should a conflict exist, the Contractor shall notify the Engineer so that the conflict can be resolved with a minimum amount of delay.
5. Backfill compaction shall be according to traffic/street use.
6. Maintenance of these facilities shall be the responsibility of the Owner of the property served.
7. Work on arterial streets shall be performed on a 24 hour basis.

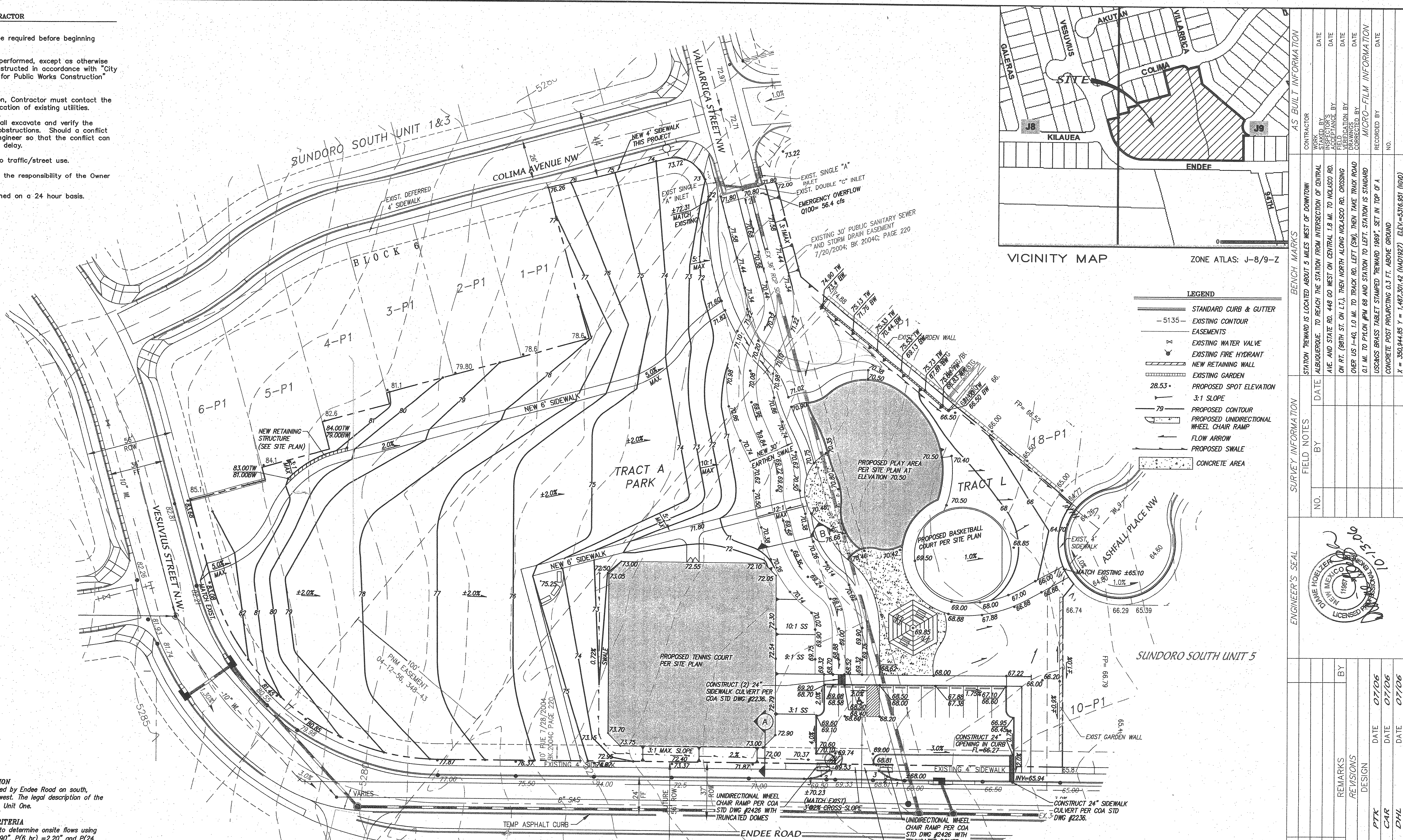

PROJECT DESCRIPTION
As shown by the Vicinity Map, the site is bounded by Endee Road on south, Colima Street on north and Vesuvius Street on west. The legal description of the property is Tract "A", Sundoro South Subdivision Unit One.

DRAINAGE DESIGN CRITERIA
The 100-year, 6-hour storm event was utilized to determine onsite flows using the AHYMO Hydrology program with $P(1 \text{ hr}) = 1.90"$, $P(6 \text{ hr}) = 2.20"$ and $P(24 \text{ hr}) = 2.67"$. The onsite land treatment values are type A= 45%, B=5%, type C= 50% for existing conditions and type B= 30%, C=25% and D=45% for developed conditions.

EXISTING DRAINAGE CONDITION
An Emergency Overflow Spillway through the Park site is for the Sump Inlets at the end of Vallarica Street. ($Q_{max} = 56.4 \text{ cfs}$)

A Drainage Report for Sundoro South Units 1 & 3, which included the Park Site was approved in 2003. According to that report, free discharge from this Park Site flows to Endee Road. The majority of the runoff from this site is being directed to Endee Road, however, there is a small area north & east of the basketball courts that will discharge to Ashfall Place. The estimated Q for this area is 1.0 cfs. The existing grades in this area prohibited drainage to Endee Road.

DEVELOPED CONDITIONS
The 100 year discharge from this site was calculated to be 11.0 cfs. The 100 year design discharge from the 2003 Drainage Report was 14.15 cfs. The Emergency Overflow Spillway through the park will intercept flows from the west and direct the runoff south to the parking lot and ultimately to Endee Road.

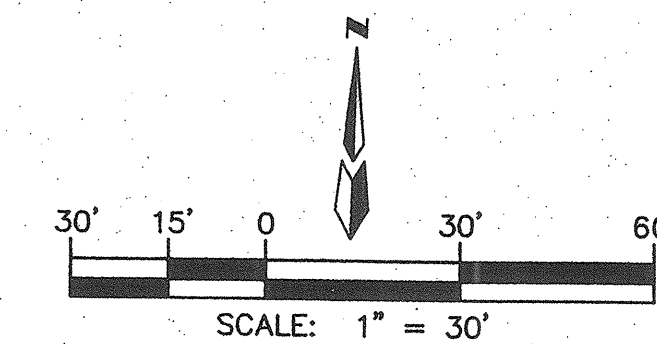
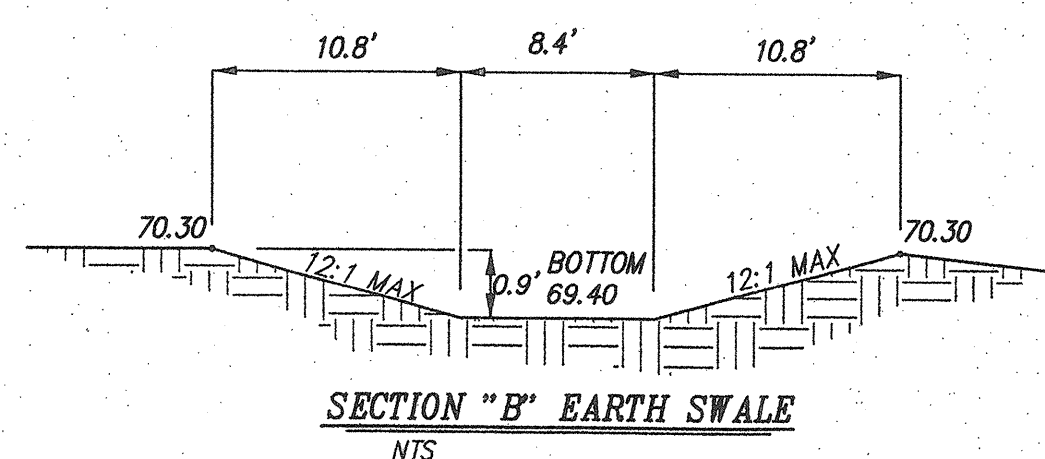
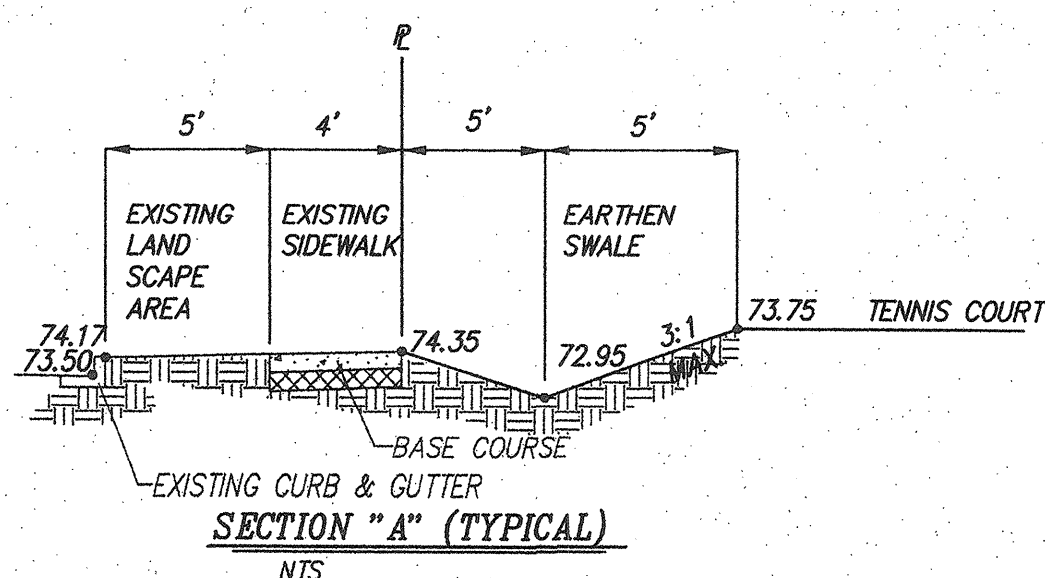

VICINITY MAP

ZONE ATLAS: J-8/9-Z

LEGEND

- STANDARD CURB & GUTTER
- 51.35- EXISTING CONTOUR
- EASEMENTS
- EXISTING WATER VALVE
- EXISTING FIRE HYDRANT
- NEW RETAINING WALL
- EXISTING GARDEN
- 28.53- PROPOSED SPOT ELEVATION
- 3:1 SLOPE
- 79- PROPOSED CONTOUR
- PROPOSED UNIDIRECTIONAL WHEEL CHAIR RAMP
- FLOW ARROW
- PROPOSED SWALE
- CONCRETE AREA

AS BUILT INFORMATION			
CONTRACTOR	DATE	DATE	DATE
INSPECTOR	DATE	DATE	DATE
FIELD ENGINEER	DATE	DATE	DATE
RECORDING	DATE	DATE	DATE
MICRO-FILM INFORMATION			
RECORDED BY	DATE	DATE	DATE
NO.			

SURVEY INFORMATION

FIELD NOTES	DATE	BY
NO.		

ENGINEER'S SEAL

NO.	DATE	REMARKS	BY
		DESIGN	
		REVISIONS	
		DESIGN	
		DATE	07/06
		DATE	07/06
		DATE	07/06

dmg

MARK GOODWIN & ASSOCIATES, P.A.
CONSULTING ENGINEERS
P.O. BOX 90606
ALBUQUERQUE, NEW MEXICO 87199
(505) 828-2200, FAX (505) 797-9539



CITY OF ALBUQUERQUE
PUBLIC WORKS DEPARTMENT

TITLE: **SUNDORO PARK
GRADING & DRAINAGE PLAN**

DESIGN REVIEW COMMITTEE
NOV 14 2006
DESIGN REVIEW COMMITTEE

CITY ENGINEER APPROVAL
NOV 14 2006
CITY ENGINEER

MO./DAY/YR. MO./DAY/YR.
LAST DESIGN UPDATE

CITY PROJECT NO. **7775 91** ZONE MAP NO. **J-8/9** SHEET **4** OF **10**

PLAY EQUIPMENT LIST (EXERPLAY)

Qty	Item#	Description
1	120891A	Arch Tire Swing
1	120251J	4 Seat Swings
2	120255A	Bucket Seat
1	148631B	4 Seat Seesaw

Playbooster

Roofs		
2	129816	Square Peak Tile Roof

Permalene Panels

1	121439	Navigator Panel
2	117951	Periscope Panel
1	119514	Pilot Panel
1	115222	Slant Panel
1	115254	Store Front Panel
1	117946	Wire Barrier
1	115221	Zoo Panel

Slides

1	123336	Double Wave Poly Slide
1	122033	Spyroslide

Climbers

1	126212	Circus Ladder
1	135345	Pod Climbers
1	128608	Summit Climber
2	116249	Vertical Ladder

Overhead Events

1	119430	Overhead Parallel Bar
---	--------	-----------------------

Attachments/Connectors

1	111351	Chinning Bar
1	120902	Hand Hold/Leg Lift
2	111363	Talk Tube (No Post)
1	111362	Talk Tube
1	148426	Firepole

Playshaper

Roofs		
1	130102	Super SG Shingle Roof

Permalene Panels

1	111284	Hole Panel
1	111292	Table Panel
2	111293	House Panel
1	116120	2 Bench with End Panels
1	118429	Periscope Panel
1	144984	Store Panel
1	117946	Wire Barrier with Wheel
2	117946	Wire Barrier

Slides

1	130798	Double Swirl Poly Slide
1	132117	Slidewinder 2

Attachments/Connectors

1	131956	Belt Bridge
1	135541	Block Climb
1	143200	Conical Climber
1	132023	Cozy Climber
1	138521	Deck Link
1	119981	Step Deck
1	129961	Horizontal Ladder
1	129968	Horizontal Ladder Support

Stickers to denote age appropriateness for all playground equipment shall be provided and applied by equipment manufacturer.

SITE AMENITIES LIST

Shelters

1	80489M	Litchfield All-Steel Duo-Top 36' Hexagonal Shelter Color: Roman Blue
---	--------	---

Benches

22	58-60	DuMor 6' Steel Bench with Backrest Color: Black
----	-------	--

Picnic Tables

3	100-60-PL	DuMor Recycled Plastic Picnic Tables, Color: Cedar slats w/Black frame. S-1 Embedment.
1	100-68-PL	DuMor Recycled Plastic Picnic Table (ADA), Color: Cedar slats w/Black frame. S-1 Embedment.

Bike Racks

1	130-30	DuMor Steel Bike Rack (1 Slot), Color: Black
---	--------	---

Trash Receptacles

1	84-32	DuMor 32 Gallon All-Steel Receptacle Color: Black
---	-------	--

Basketball Post

1	1536-11-38	PW Athletic Galvanized 5 9/16" O.D. Post
---	------------	--

Basketball Backboards

2	11	PW Athletic 3/16th" Steel Fan Backboards Color: White
---	----	--

Basketball Net

2	37	PW Athletic Double Rim Goals with Chain Nets
---	----	--

Tennis Nets

2	8353	PW Athletic Champion Tennis Nets
---	------	----------------------------------

Tennis Posts

2	2205	PW Athletic Square Posts (pair)
---	------	---------------------------------

GENERAL NOTES

- Contractor to review and coordinate all contract documents.
- Contractor to notify Landscape Architect of any discrepancies in Contract Documents.
- Contractor to notify Landscape Architect of any discrepancies between Contract Documents and Field Conditions.
- Contractor to refer to annotated dimensions only. Contractor not to scale off drawings.
- Larger scale drawings take precedence over smaller scale, typ.

KEYED NOTES

- Concrete plaza-8'x8' score pattern w/broom finish-alternating direction.
- HC Access Ramp.
- Concrete play area access ramp.
- Turndown slab at play area, C.O.A. Standard Dwg. 2728.
- EPDM surfacing, 1/2" depth, tan color, over 2 1/2" depth cushion layer, over 4" depth concrete slab.
- 36' Shade Structure, see Site Amenities List, this sheet.
- Litter receptacle, see Site Amenities List, this sheet.
- Bench, see Site Amenities List, this sheet.
- Picnic table, see Site Amenities List, this sheet.
- Bicycle loops, see Site Amenities List, this sheet.
- Concrete sidewalk, C.O.A. Standard Dwg. No. 2430.
- Control joint.
- Expansion joint.
- HC Parking - Van Accessible Sign.
- Safety zone. - Typ.
- Play structures, see Play Equipment List, this sheet.
- Age appropriate signage.
- Basketball court - see detail 3, sheet 6.
- Play area header per COA detail 2729.
- Removable bollard per COA detail 2250.
- Painted striping per plan.
- Sawcut joint.
- Specialty paving - see detail 2, sheet 6.

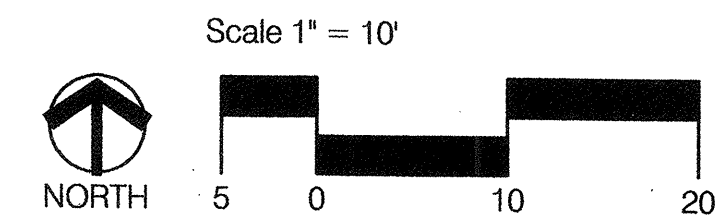
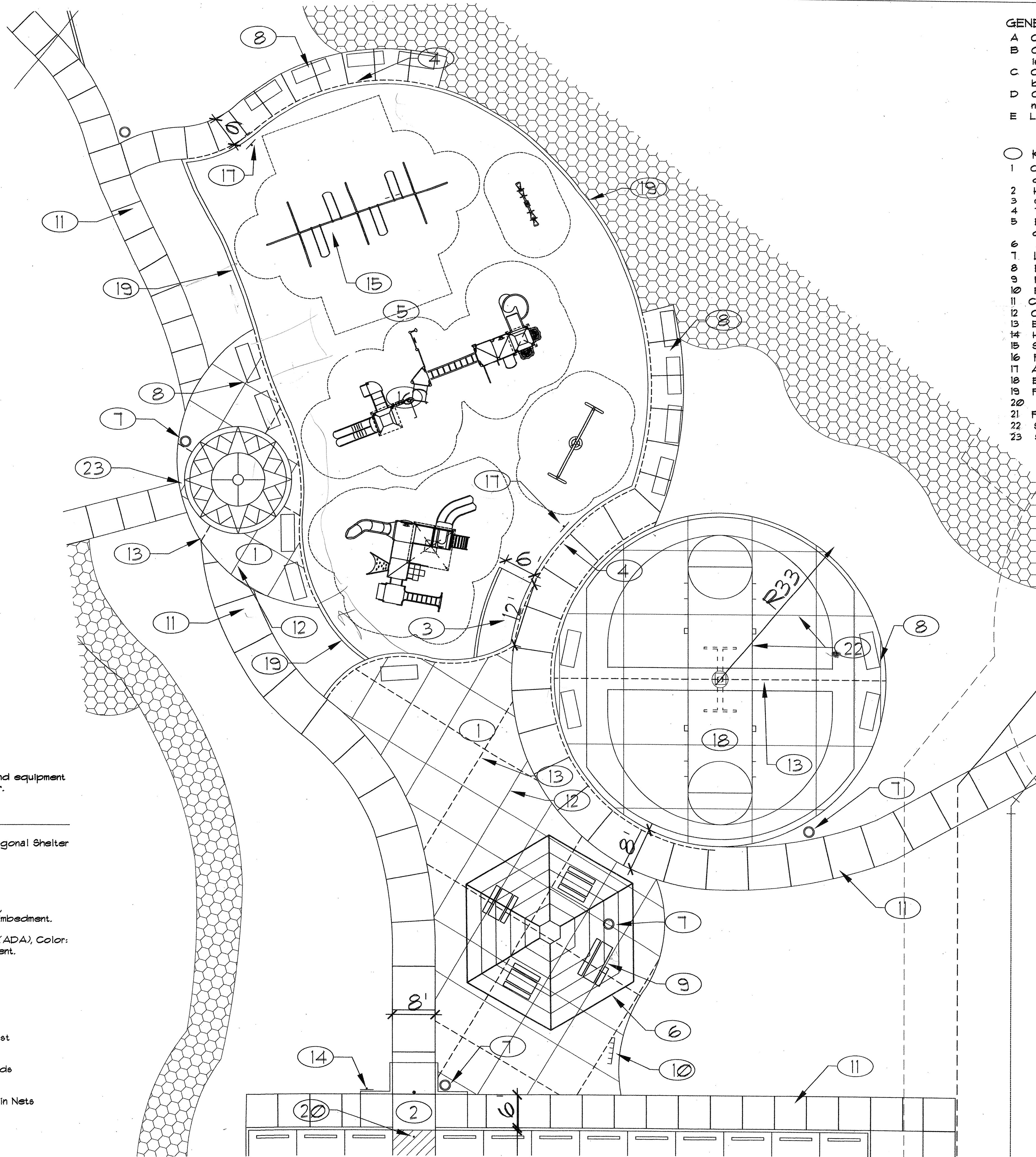

CONSensus PLANNING, INC.
Planning / Landscape Architecture
302 Eighth Street NW
Albuquerque, NM 87102
(505) 764-9801 Fax 842-5495
e-mail: cp@consensusplanning.com

CITY OF ALBUQUERQUE
DEPARTMENT OF MUNICIPAL DEVELOPMENT
PARK DESIGN AND CONSTRUCTION DIVISION

TITLE: SUNDORO SOUTH PARK
ENLARGED PLAY AREA

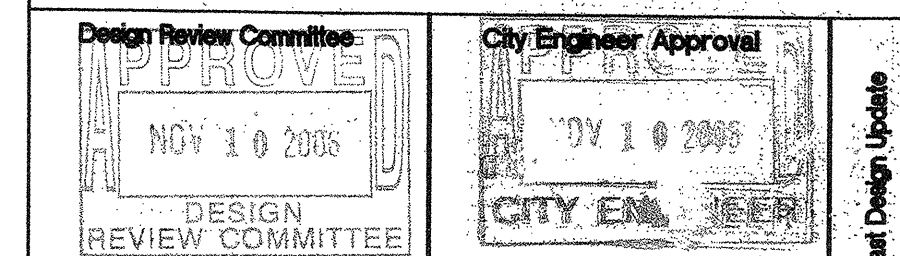

City Project No. 777591
Zone Map No. J-8/J-9
Sheet 5 of 10

AS BUILT INFORMATION		BENCH MARKS		SURVEY INFORMATION		ENGINEERS SEAL	
CONTRACTOR				FIELD NOTES		REMARKS	
STAMPED BY	DATE	NO.	BY	DATE	NO.	DATE	BY
ACCEPTANCE BY	DATE					DESIGN	
FIELD BY	DATE						
DRAWINGS BY	DATE						
CHECKED BY	DATE						
RECORDED BY	DATE						
NO.							

10.17.06

CONSensus PLANNING, INC.

NOV 10 2005

NOV 10 2005

DESIGN REVIEW COMMITTEE

CITY ENGINEER

Note: Tennis court finish to be TP8 5000 acrylic surface.
Colors:
Playing Area - Forest Green
Perimeter - Brick Red
Striping - White

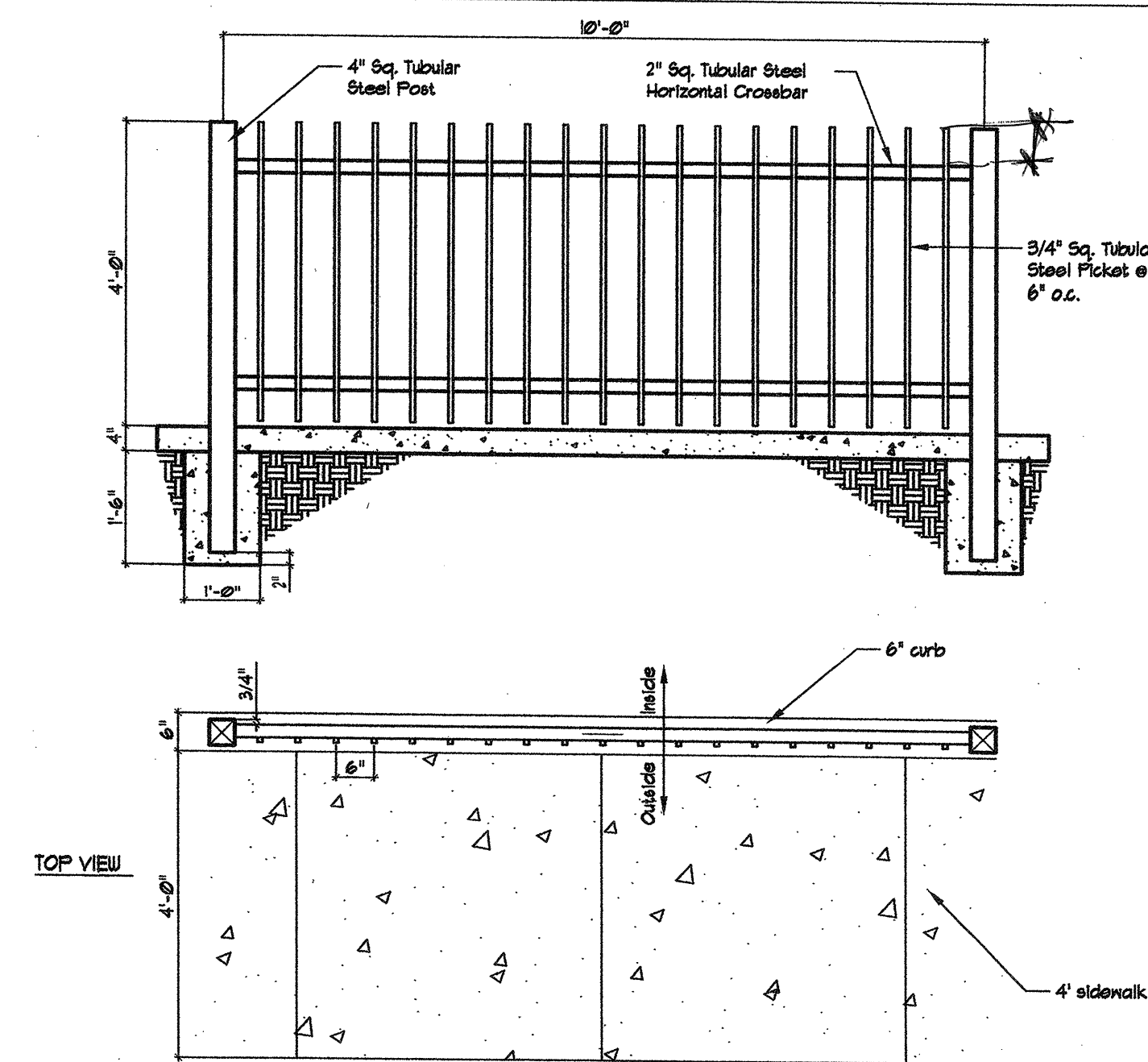
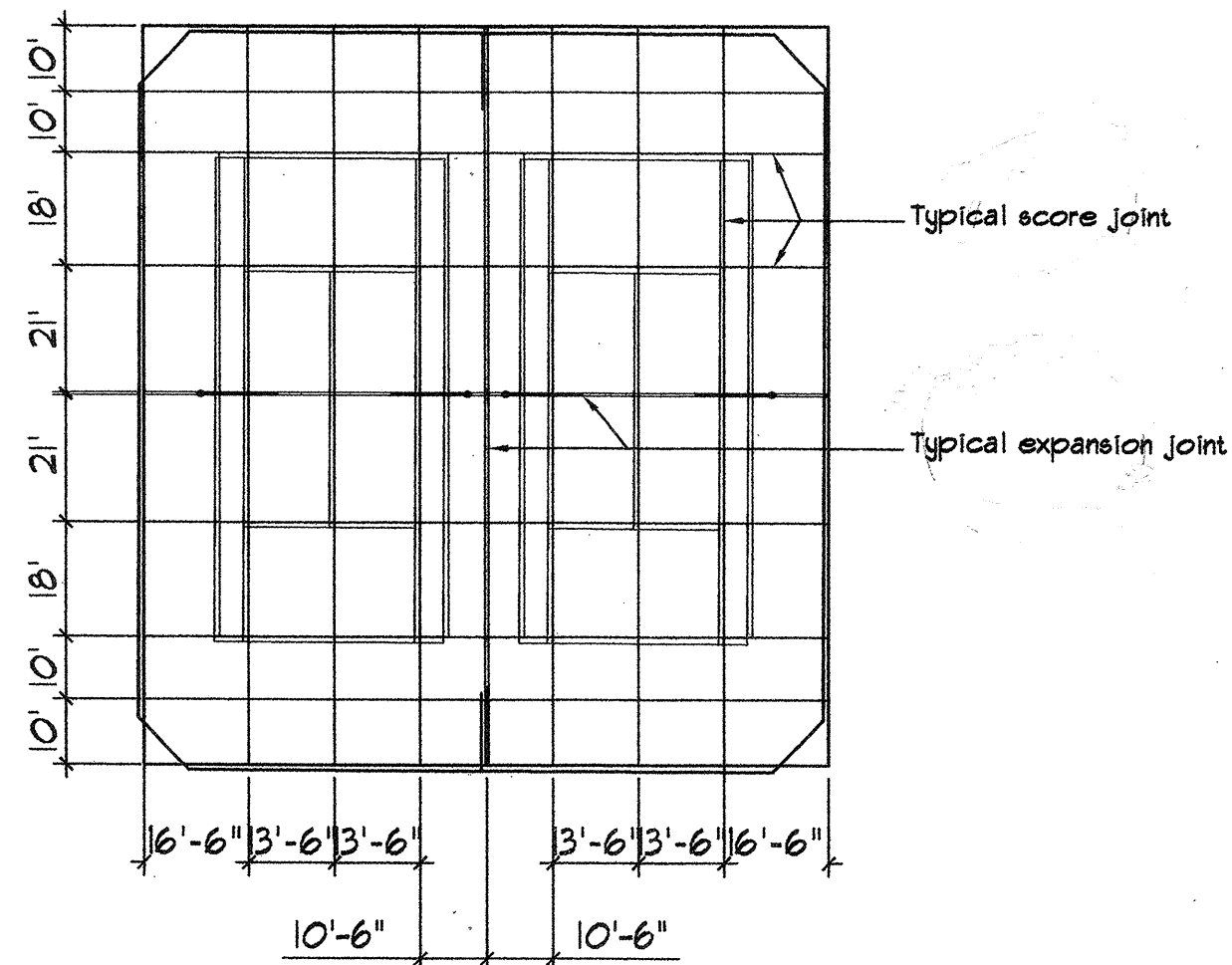
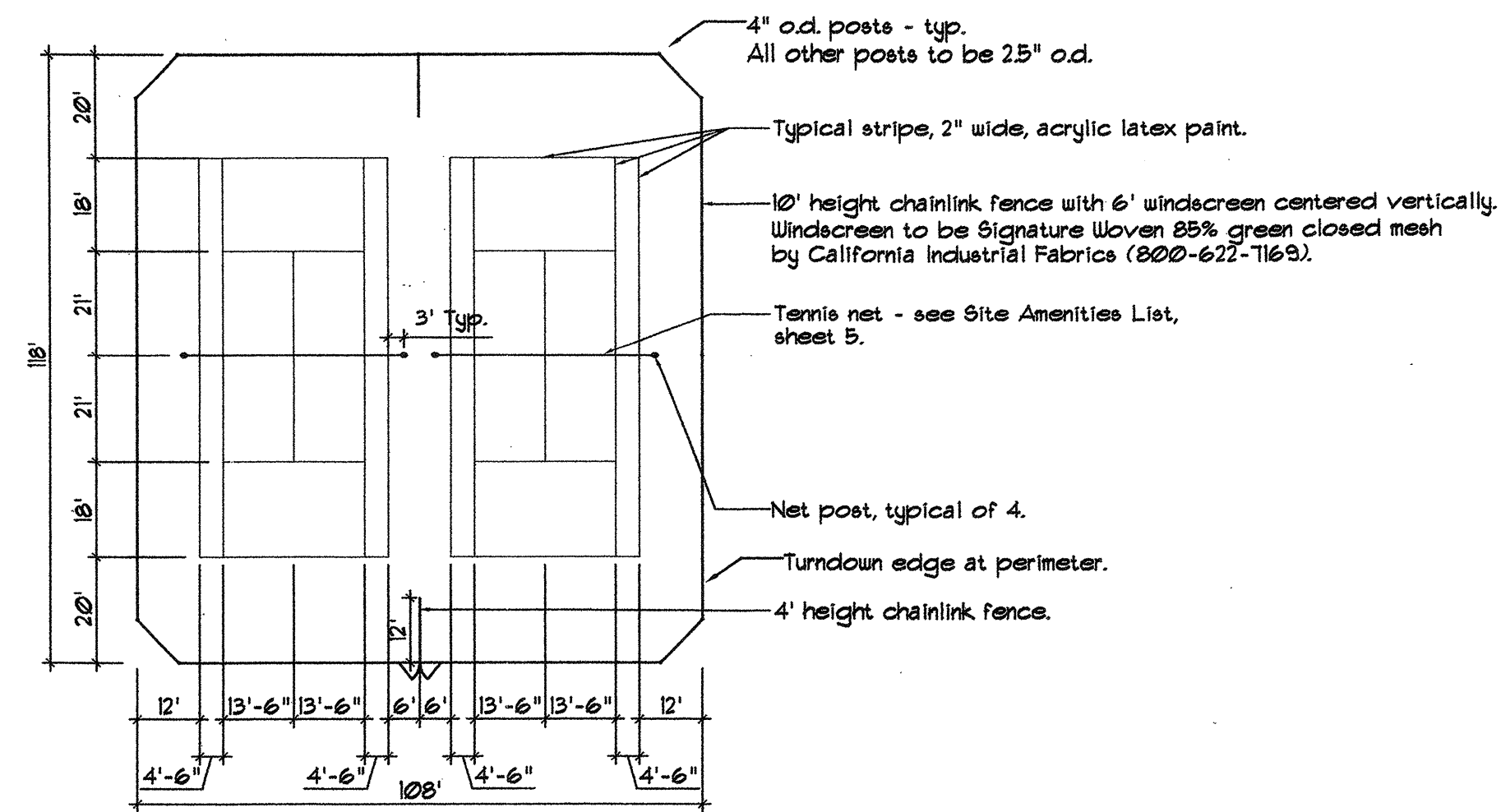

1 TENNIS COURT LAYOUT & SCORING PLAN

1" = 30'0"

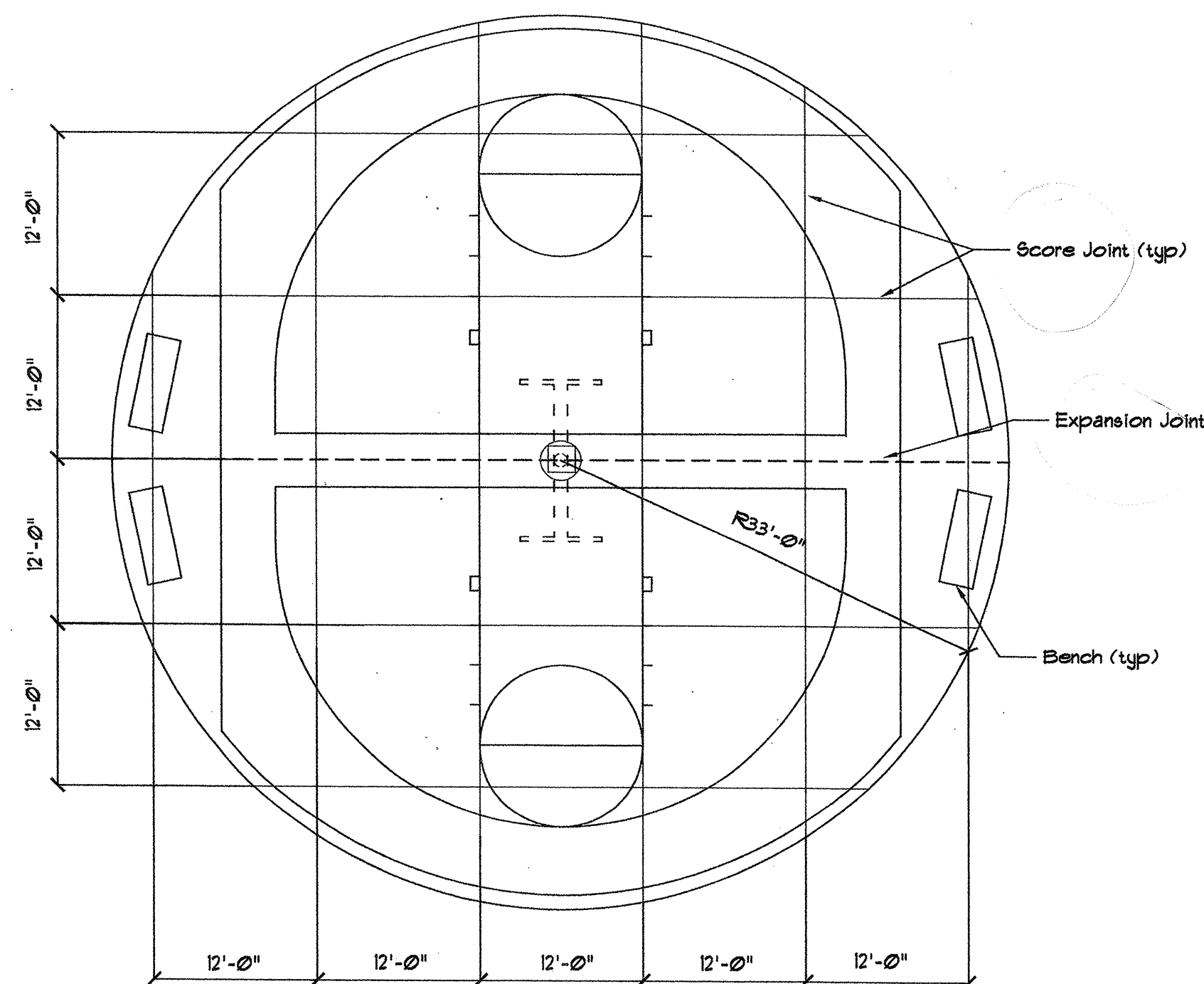
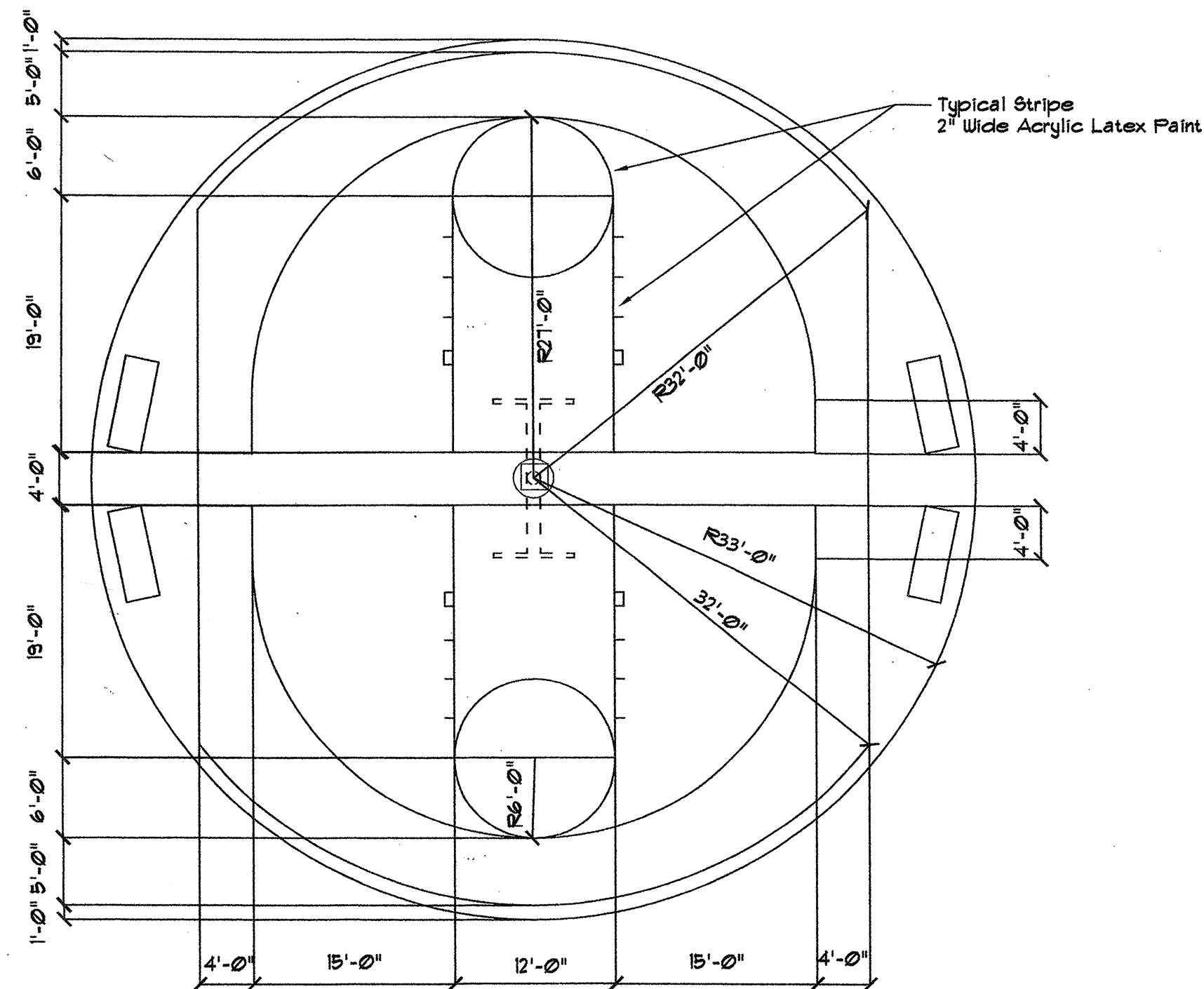

2 4' TUBULAR STEEL FENCING

1" = 2'0"

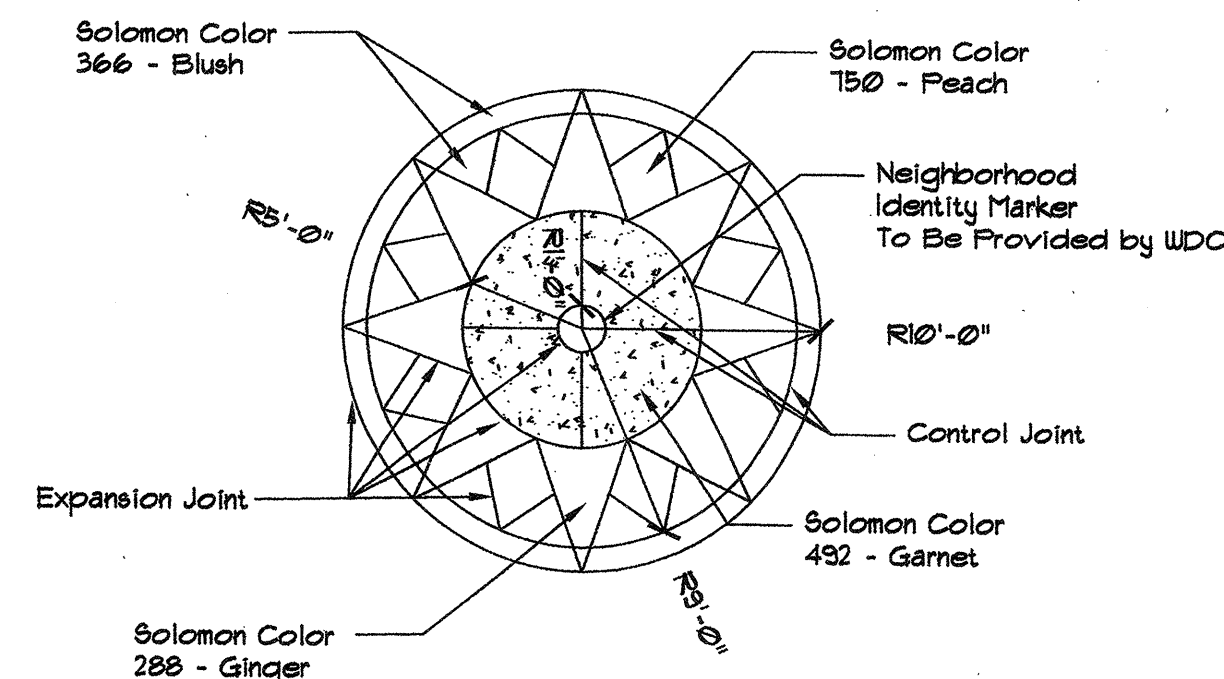

4 SPECIALTY PAVING FOR PLAZA

1" = 8'0"

3 BASKETBALL COURT LAYOUT & SCORING PLAN

1" = 10'0"

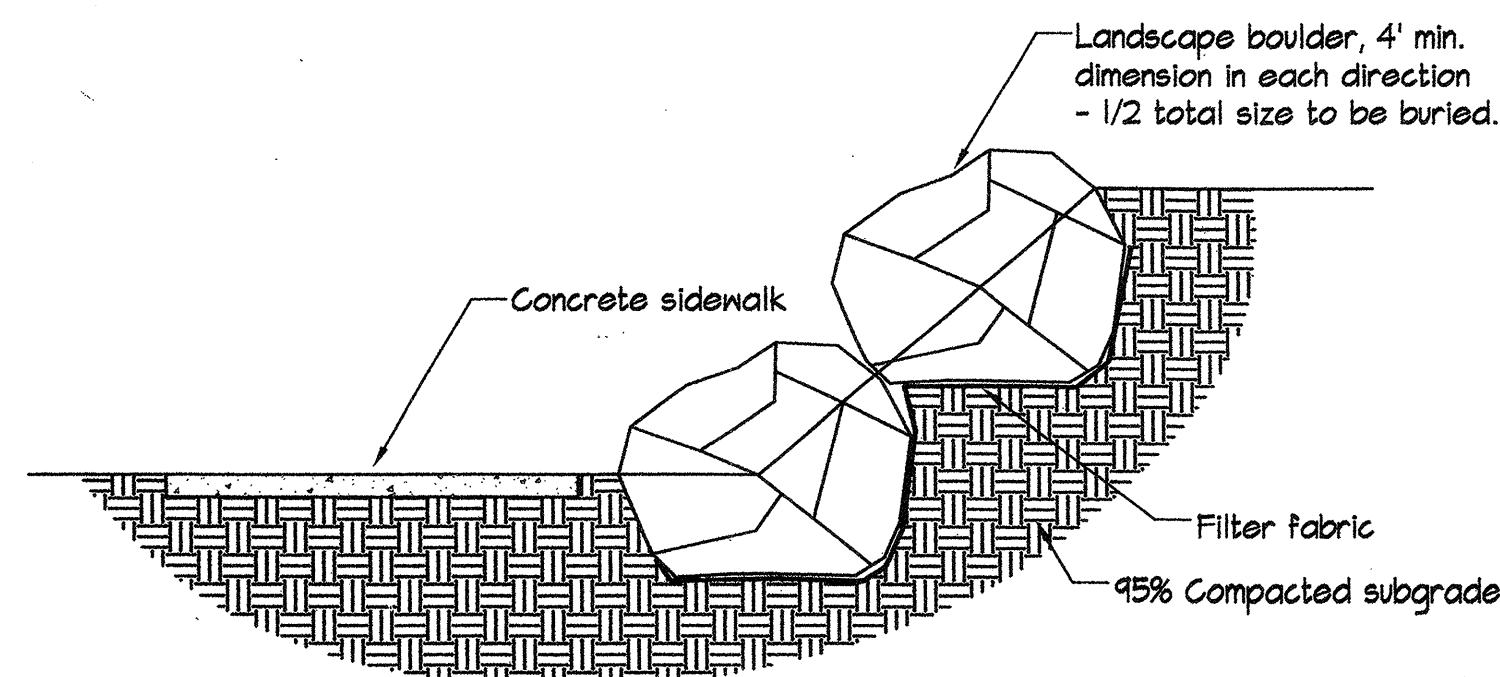

5 BOULDER RETAINING WALL

nts

AS BUILT INFORMATION				BENCH MARKS				SURVEY INFORMATION				ENGINEERS SEAL				REVISIONS			
CONTRACTOR	WORK	DATE	NO.	BY	DATE	NO.	BY	NO.	BY	DATE	NO.	BY	DATE	NO.	BY	DATE	NO.	BY	DATE
	STAKED BY	DATE																	
	ACCEPTANCE BY	DATE																	
	FIELD CATION BY	DATE																	
	DRAWINGS	DATE																	
	CORRECTED BY	DATE																	
	MICRO-FILM INFORMATION	DATE																	
	RECORDED BY	DATE																	
	NO.																		

CONSENSUS PLANNING, INC.
Planning / Landscape Architecture
302 Eighth Street NW
Albuquerque, NM 87102
(505) 764-9801 Fax 842-5495
e-mail: cp@consensusplanning.com

CITY OF ALBUQUERQUE
DEPARTMENT OF MUNICIPAL DEVELOPMENT
PARK DESIGN AND CONSTRUCTION DIVISION

TITLE:
SUNDORO SOUTH PARK
SITE DETAILS

Design Review Committee
NOV 19 2005
DESIGN REVIEW COMMITTEE

City Engineer Approval
NOV 19 2005
CITY ENGINEER

No. / Day / Yr.
No. / Day / Yr.

Last Design Update

City Project No. 777591

Zone Map No. J-8/J-9

Sheet 6 of 10

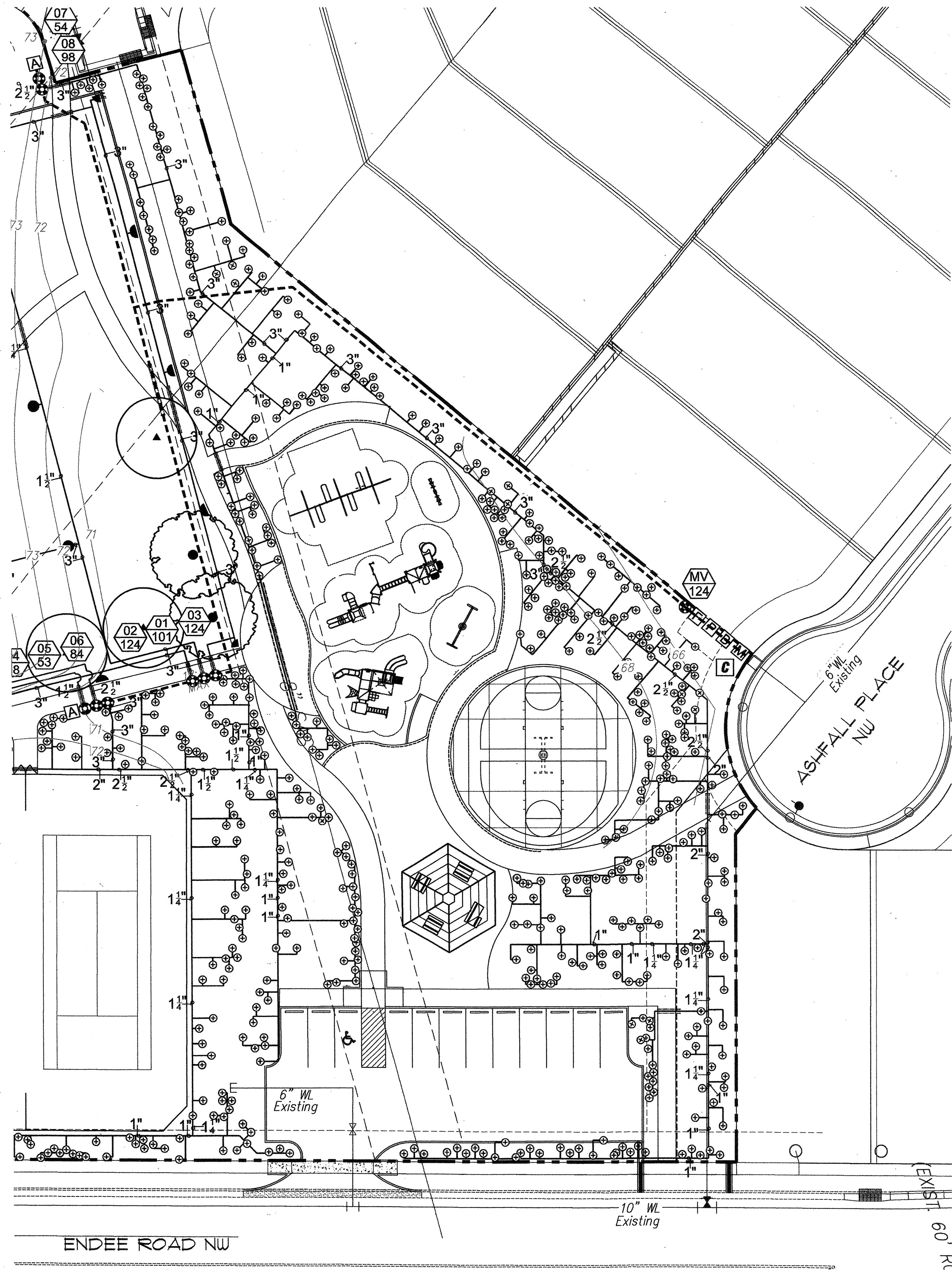

IRRIGATION LEGEND

- HUNTER #25-36S-13 FULL CIRCLE ROTARY SPRINKLER WITH CHECK VALVE, STAINLESS STEEL RISER AND #13 NOZZLE (3\"/>
 - HUNTER #25-ADS-13 PART CIRCLE ROTARY SPRINKLER WITH CHECK VALVE, STAINLESS STEEL RISER AND #13 NOZZLE (3\"/>
 - HUNTER #25-ADS-15 PART CIRCLE ROTARY SPRINKLER WITH CHECK VALVE, STAINLESS STEEL RISER AND #15 NOZZLE (3\"/>
 - HUNTER #25-ADS-7 PART CIRCLE ROTARY SPRINKLER WITH CHECK VALVE, STAINLESS STEEL RISER AND #7 NOZZLE (1\"/>
 - HUNTER #20-36S-4.5LA FULL CIRCLE ROTARY SPRINKLER WITH CHECK VALVE, STAINLESS STEEL RISER AND #4.5LA LOW ANGLE NOZZLE (3\"/>
 - HUNTER #20-ADS-4.5LA PART CIRCLE ROTARY SPRINKLER WITH CHECK VALVE, STAINLESS STEEL RISER AND #4.5LA LOW ANGLE NOZZLE (3\"/>
 - HUNTER #20-ADS-2.5LA PART CIRCLE ROTARY SPRINKLER WITH CHECK VALVE, STAINLESS STEEL RISER AND #2.5LA LOW ANGLE NOZZLE (3\"/>
 - RAINBIRD #1401 FULL CIRCLE, PRESSURE COMPENSATING, TRICKLE PATTERN BUBBLER (25 GPM @ 30 PSI)
 - RAINBIRD #100-PEB 1\"/>
 - RAINBIRD #200-PEB 2\"/>
 - FEBCO #825V 2\"/>
 - FLOW METER ASSEMBLY: MASTER METER WT SERIES 2\"/>
 - CRISPEN JUL10.1 1\"/>
 - 2\"/>
 - BOOSTER PUMP: 50 PSI BOOST AT 125 GPM (SEE IRRIGATION NOTES). CONTRACTOR TO PROVIDE ALL NECESSARY ELECTRICAL POWER TO PUMP STATION
 - MOTOROLA IRRINET IRRIGATION CONTROLLER TO BE INSTALLED IN INTERSPEC ENCLOSURE WITH VOLT SURGE PROTECTION, STATION SWITCHES AND REMOTE READY WITH C.O.A. COMMUNICATION RADIO (16 STATION OUTPUT)
- MAINLINE PIPE - 4\"/>
- LATERAL PIPE - SCH 40 PVC PIPE (PIPE SIZE INDICATED ON PLAN)
- UNSIZED PIPE: 1\"/>
- UNSIZED PIPE: 1\"/>
- UNSIZED PIPE: 1\"/>
- SLEEVE PIPE - SCH 40 PVC (TWO SIZES LARGER THAN PIPE TO BE SLEEVED)

IRRIGATION NOTES

WATER PRESSURE: THE WATER PRESSURE AT THIS SITE WAS REPORTED TO BE 50 PSI. THE CONTRACTOR SHALL VERIFY THE DESIGN CRITERIA OF THIS SYSTEM BY COMPLETING A FLOW PRESSURE TEST PRIOR TO THE INSTALLATION OF ANY IRRIGATION COMPONENTS. THE CONTRACTOR SHALL INSTALL A FLOW METER AND WATER PRESSURE GAUGE ON THE DOWNSTREAM SIDE OF THE WATER METER. THE CONTRACTOR SHALL MEASURE THE DYNAMIC WATER PRESSURE AT THE FLOW NOTED BELOW, AND REPORT HIS FINDINGS IN WRITING TO THE IRRIGATION CONSULTANT. THE CONTRACTOR SHALL RECEIVE A NOTICE CHANGES AND/OR ADDITIONAL WORK IF HE DOES NOT POSSESS A NOTICE TO PROCEED FROM THE CONSULTANT.

DESIGN FLOW / PRESSURE CRITERIA: 45 PSI (DYNAMIC) @ 125 GPM

WATER METER: THE WATER PRESSURE AT THIS SITE IS REPORTED TO BE 50 PSI. THE CONTRACTOR SHALL INSTALL A 2\"/>

BOOSTER PUMP: THIS SYSTEM WILL REQUIRE A BOOSTER PUMP IN ORDER TO FUNCTION PROPERLY. THE CONTRACTOR SHALL PROVIDE A UNITIZED PUMP STATION CAPABLE OF PROVIDING A 50 PSI BOOST AT 125 GPM. THE PUMP STATION SHALL DISCHARGE AT A MAXIMUM PRESSURE OF 95 PSI AT 125 GPM. THE PUMP STATION SHALL BE ENCLOSED IN A HEATED AND VENTED OUTDOOR ENCLOSURE WITH HIGH TEMPERATURE AND NO FLOW SHUTDOWN CAPABILITY. THE CONTRACTOR SHALL CONSULT WITH THE CITY OF ALBUQUERQUE'S PARK MANAGEMENT DEPARTMENT FOR ACCEPTABLE PUMP STATION MANUFACTURERS.

SPRINKLER STAKING: THE SPRINKLER LOCATIONS SHALL BE PRECISELY LOCATED BY THE USE OF SURVEY GRADE GPS EQUIPMENT OR CONVENTIONAL SURVEY METHODS. THE FINAL STAKED SPRINKLER LOCATIONS SHALL BE BASED ON AS-BUILT SURVEY DATA OF THE HARDSCAPE SURROUNDING THE TURF AREAS. THE IRRIGATION CONSULTANT SHALL GPS SURVEY AND STAKE THE LOCATIONS OF THE ROTARY SPRINKLERS. THE COSTS OF THESE SERVICES SHALL BE THE RESPONSIBILITY OF THE CONTRACTOR.

CERTIFIED LANDSCAPE IRRIGATION AUDIT: PRIOR TO THE INSTALLATION OF SOD, SEED, TREES OR OTHER PLANT MATERIAL, THE CONTRACTOR SHALL BE RESPONSIBLE FOR PROVIDING A CERTIFIED LANDSCAPE WATER AUDIT TO DETERMINE THE DISTRIBUTION UNIFORMITY FOR ALL TURFGRASS AREAS. NO PLANT MATERIALS SHALL BE INSTALLED IN TURFGRASS AREAS UNTIL DISTRIBUTION UNIFORMITY RESULTS HAVE BEEN ACCEPTED BY THE CITY.

AUDIT PREPARATION: THE CONTRACTOR SHALL BE RESPONSIBLE FOR INSURING THAT THE SPRINKLER IRRIGATION SYSTEM IS IN FULL WORKING ORDER PRIOR TO AUDIT. THERE SHALL BE NO CLOGGED OR MISSING NOZZLES. NON-ROTATING SPRINKLERS MUST BE REPLACED OR REPAIRED. ALL DEBRIS OR DIRT PILES MUST BE REMOVED OR LEVELED AND EACH SPRINKLER MUST BE PROPERLY SET AND LEVELED. THE CONTRACTOR SHALL ALSO SET ALL PRESSURE REGULATION DEVICES OR VALVE FLOW CONTROLS (IF APPLICABLE) TO THE DISCHARGE PRESSURE INDICATED IN THE LEGEND.

SPECIFICATIONS AND DETAIL DRAWINGS: SPECIFICATIONS AND DETAIL DRAWINGS FOR IRRIGATION CONSTRUCTION. IN THE EVENT OF A CONFLICT BETWEEN SPECIFICATIONS AND IRRIGATION DESIGN, THE CONTRACTOR SHALL NOTIFY THE IRRIGATION CONSULTANT IN WRITING. THE CONTRACTOR SHALL NOT PROCEED WITH INSTALLATION OF CONFLICTING IRRIGATION COMPONENTS UNTIL HE RECEIVES CLARIFICATION IN WRITING FROM THE CONSULTANT.

TREE / SHRUB LOCATIONS: THE PIPE ROUTING SHOWN ON THESE PLANS IS SCHEMATIC. THE CONTRACTOR SHALL INSTALL ALL PIPING OUTSIDE OF THE ROOT ZONE OF TREES OR SHRUBS. THE SPRINKLER LOCATIONS SHOWN ON THESE PLANS ARE FIXED AND MUST BE FIELD LOCATED AS CLOSELY AS POSSIBLE TO LOCATIONS SHOWN ON PLANS TO MEET THE INTENDED DISTRIBUTION UNIFORMITY. THE CONTRACTOR SHALL FIELD ADJUST ANY TREE LOCATIONS THAT ARE SHOWN TO BE CLOSER THAN 12\"/>

SPRINKLER NOZZLES: THE CONTRACTOR SHALL ADJUST THE THROWING RADIUS OF ALL PERTINENT SPRINKLER NOZZLES SO AS TO MINIMIZE THE OVERSPRAY ONTO HARDSCAPE OR OTHER UNINTENDED AREAS. THE CONTRACTOR SHALL ALSO INCLUDE IN HIS BID OR PRICING AN ALLOWANCE FOR ANY SPRINKLER NOZZLE CHANGES THAT ARE DEEMED NECESSARY BY THE LANDSCAPE ARCHITECT OR IRRIGATION CONSULTANT TO CORRECT ISSUES OF OVERSPRAY, UNDERSPRAY OR DISTRIBUTION UNIFORMITY.

MAINLINE FITTINGS: THE CONTRACTOR SHALL USE TWO (2) 45 DEGREE ELBOWS FOR EACH 90 DEGREE MAINLINE BEND AS PER CITY OF ALBUQUERQUE'S REQUEST.

IRRIGATION SCHEDULE

VALVE ID	CTRL STA.	SPK TYPE	FLOW	PRECIP RATE	RUNTIME
01	01	I-25 FC	100.8 GPM	.45\"/>hr	88 MIN
02	02	I-25 PC	124.0 GPM	.89\"/>hr	44 MIN
03	03	I-25 PC	124.0 GPM	.89\"/>hr	44 MIN
04	04	I-20 FC	17.6 GPM	.40\"/>hr	99 MIN
05	05	I-20 PC	52.4 GPM	.80\"/>hr	50 MIN
06	06	BUBBLER	87.0 GPM	25.75 GPM	12 MIN
07	07	BUBBLER	53.8 GPM	25.75 GPM	12 MIN
08	08	BUBBLER	100.0 GPM	25.75 GPM	12 MIN
MV	16	N/A	124.0 GPM	N/A	N/A
				TOTAL RUNTIME: 6.2 hrs	

TOTAL RUNTIME: 6.2 hrs

STATION RUNTIMES ARE CALCULATED TO APPLY .66\"/>

IRRIGATION FRICTION LOSSES

IRRIGATION COMPONENT @ 125 GPM		PRESSURE LOSS
2\"/>		6.2 PSI
2\"/>		13.0 PSI
2\"/>		1.4 PSI
2\"/>		6.8 PSI
2\"/>		6.8 PSI
LATERAL PIPE (ESTIMATE)		5.0 PSI
4\"/>		1.6 PSI
ELEVATION		XX.X PSI
TOTAL PRESSURE LOSSES:		-40.8
EXPECTED WATER PRESSURE:		+45.0
BOOSTER PUMP BOOST:		+50.0
SPRINKLER OPERATING PSI:		54.2

THE EXPECTED WATER PRESSURE AT THIS SITE WAS REPORTED TO BE 50 PSI (STATIC). THERE IS NO ESTIMATE FOR THE PRESSURE LOSSES THROUGH THE CITY WATER MAINLINE FEEDING THE WATER METER. THE CONTRACTOR SHALL THOROUGHLY TEST THE CONDITIONS OF THE WATER AVAILABILITY PRIOR TO THE INSTALLATION OF THE IRRIGATION SYSTEM.

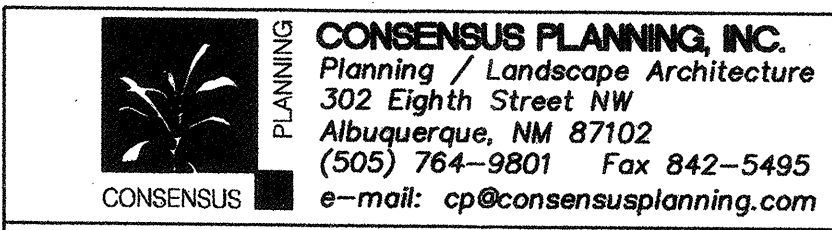

CITY OF ALBUQUERQUE
DEPARTMENT OF MUNICIPAL DEVELOPMENT
PARK DESIGN AND CONSTRUCTION DIVISION

TITLE: SUNDORO SOUTH PARK
IRRIGATION PLAN (EAST)

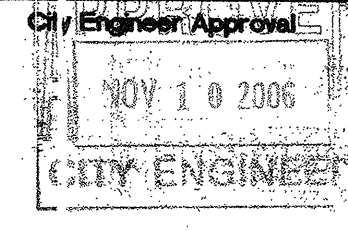

City Project No. 777:591
Zone Map No. J-8/J-9
Sheet 7 Of 10



IRRIGATION LEGEND

- HUNTER #125-38S-13 FULL CIRCLE ROTARY SPRINKLER WITH CHECK VALVE, STAINLESS STEEL RISER AND #13 NOZZLE (63' RADIUS, 11.2 GPM, 45' H₂O @ 50 PSI) (IF NOTED, THE CONTRACTOR SHALL ADJUST THE THROWING RADIUS OF THE SPRINKLER TO THE SPECIFIED DISTANCE)
 - ▲ HUNTER #125-ADS-13 PART CIRCLE ROTARY SPRINKLER WITH CHECK VALVE, STAINLESS STEEL RISER AND #13 NOZZLE (63' RADIUS, 11.2 GPM, 45' H₂O @ 50 PSI) (IF NOTED, THE CONTRACTOR SHALL ADJUST THE THROWING RADIUS OF THE SPRINKLER TO THE SPECIFIED DISTANCE)
 - HUNTER #125-ADS-7 PART CIRCLE ROTARY SPRINKLER WITH CHECK VALVE, STAINLESS STEEL RISER AND #7 NOZZLE (47' RADIUS, 7.0 GPM, 70' H₂O @ 50 PSI) (IF NOTED, THE CONTRACTOR SHALL ADJUST THE THROWING RADIUS OF THE SPRINKLER TO THE SPECIFIED DISTANCE)
 - HUNTER #125-ADS-4.5LA PART CIRCLE ROTARY SPRINKLER WITH CHECK VALVE, STAINLESS STEEL RISER AND #4.5LA LOW ANGLE NOZZLE (35' RADIUS, 4.4 GPM, 80' H₂O @ 30 PSI) (IF NOTED, THE CONTRACTOR SHALL ADJUST THE THROWING RADIUS OF THE SPRINKLER TO THE SPECIFIED DISTANCE)
 - HUNTER #125-ADS-2.5LA PART CIRCLE ROTARY SPRINKLER WITH CHECK VALVE, STAINLESS STEEL RISER AND #2.5LA LOW ANGLE NOZZLE (33' RADIUS, 2.5 GPM, 87' H₂O @ 30 PSI) (IF NOTED, THE CONTRACTOR SHALL ADJUST THE THROWING RADIUS OF THE SPRINKLER TO THE SPECIFIED DISTANCE)
 - RAINBIRD #1401 FULL CIRCLE, PRESSURE COMPENSATING, TRICKLE PATTERN BUBBLER (2.5 GPM @ 30 PSI)
 - RAINBIRD #100-PEB 1" PLASTIC ELECTRIC VALVE WITH FLOW CONTROL (2.9 PSI LOSS @ 20 GPM)
 - RAINBIRD #200-PEB 2" PLASTIC ELECTRIC VALVE WITH FLOW CONTROL (6.8 PSI LOSS @ 124 GPM) THE CONTRACTOR SHALL INSTALL A PRESSURE REGULATION MODULE ON THE MASTER VALVE AND ADJUST TO A DISCHARGE PRESSURE OF 80 PSI
 - FEBCO #25V 2" REDUCED PRESSURE BACKFLOW PREVENTER ENCLOSED IN HOT BOX, PRE-INSULATED ENCLOSURE (CONTRACTOR TO PROVIDE POSITIVE HEAT SOURCE TO BACKFLOW PREVENTER)
 - FLOW METER ASSEMBLY: MASTER METER WT SERIES 2" TURBINE METER WITH ELECTRICAL OUTPUT REGISTER (1 PULSE = 1 GALLON)
 - CRISPEN #UL10.1 1" UNIVERSAL AIR RELEASE VALVE ASSEMBLY
 - 2" CITY WATER METER: EXISTING. CONTRACTOR TO VERIFY 45 PSI DISCHARGE PRESSURE AT 125 GPM
 - BOOSTER PUMP: 50 PSI BOOST AT 125 GPM (SEE IRRIGATION NOTE)
 - MOTOROLA IRRINET IRRIGATION CONTROLLER TO BE INSTALLED IN INTERSPEC ENCLOSURE WITH 24 VOLT SURGE PROTECTION, STATION SWITCHES AND REMOTE READY WITH C.O.A. COMMUNICATION RADIO (16 STATION OUTPUT)
- MAINLINE PIPE - 4" CLASS 200 PVC GASKETED PIPE
--- LATERAL PIPE - SCH 40 PVC PIPE (PIPE SIZE INDICATED ON PLAN)
--- UNSIZED PIPE - 1/2" SPRINKLERS - 1/4"
--- UNSIZED PIPE - 1/2" SPRINKLERS - 1/4"
--- UNSIZED PIPE - BUBBLERS - 3/4"
--- SLEEVE PIPE - SCH 40 PVC (TWO SIZES LARGER THAN PIPE TO BE SLEEVED)

IRRIGATION NOTES

SPRINKLER STAKING:
THE SPRINKLER LOCATIONS SHALL BE PRECISELY LOCATED BY THE USE OF SURVEY GRADE GPS EQUIPMENT OR CONVENTIONAL SURVEY METHODS. THE FINAL STAKED SPRINKLER LOCATIONS SHALL BE BASED ON AS-BUILT SURVEY DATA OF THE HARDSCAPE SURROUNDING THE TURF AREAS. THE IRRIGATION CONSULTANT SHALL GPS SURVEY AND STAKE THE LOCATIONS OF THE ROTARY SPRINKLERS. THE COSTS OF THESE SERVICES SHALL BE THE RESPONSIBILITY OF THE CONTRACTOR.

OR
THE CONTRACTOR SHALL HIRE HIS OWN SURVEY FIRM TO PROVIDE AS-BUILT SURVEY DATA OF THE HARDSCAPE AREAS SURROUNDING THE TURF AREAS IN DIGITAL AUTOCAD FORMAT. THE DATA SHALL THEN BE FORWARDED TO THE IRRIGATION CONSULTANT, WHO WILL ADJUST SPRINKLER LOCATIONS ACCORDINGLY BASED ON THE DIGITAL DATA. THE IRRIGATION CONSULTANT SHALL PROVIDE THE COORDINATE DATA OF EACH SPRINKLER LOCATION TO THE CONTRACTOR'S SURVEY FIRM TO FIELD LOCATE. THE COSTS OF THESE SERVICES SHALL BE THE RESPONSIBILITY OF THE CONTRACTOR.

CERTIFIED LANDSCAPE IRRIGATION AUDIT:
PRIOR TO THE INSTALLATION OF SOIL, SEED, TREES OR OTHER PLANT MATERIAL, THE CONTRACTOR SHALL BE RESPONSIBLE FOR PROVIDING A CERTIFIED LANDSCAPE WATER AUDIT TO DETERMINE THE DISTRIBUTION UNIFORMITY FOR ALL TURFGRASS AREAS. NO PLANT MATERIALS SHALL BE INSTALLED IN TURFGRASS AREAS UNTIL DISTRIBUTION AUDIT PREPARATION. THE CONTRACTOR SHALL BE RESPONSIBLE FOR INSURING THAT THE SPRINKLER IRRIGATION SYSTEM IS IN FULL WORKING ORDER PRIOR TO AUDIT. THERE SHALL BE NO CLOSED OR MISSING NOZZLES. NON-ROTATING SPRINKLERS MUST BE REPLACED OR REPAIRED. ALL DEBRIS OR DIRT PILES MUST BE REMOVED OR LEVELED. AND EACH SPRINKLER MUST BE PROPERLY SET. THE CONTRACTOR SHALL HAVE HIS PROPOSED LOCATIONS APPROVED BY THE LANDSCAPE ARCHITECT PRIOR TO PLANTING.

SPECIFICATIONS AND DETAIL DRAWINGS:
THE CONTRACTOR SHALL REFER TO THE CITY OF ALBUQUERQUE'S STANDARD SPECIFICATIONS AND DETAIL DRAWINGS FOR IRRIGATION CONSTRUCTION. IN THE EVENT OF A CONFLICT BETWEEN SPECIFICATIONS AND IRRIGATION DESIGN, THE CONTRACTOR SHALL NOTIFY THE IRRIGATION CONSULTANT IN WRITING. THE CONTRACTOR SHALL NOT PROCEED WITH INSTALLATION OF CONFLICTING IRRIGATION COMPONENTS UNTIL HE RECEIVES CLARIFICATION IN WRITING FROM THE CONSULTANT.

TREE / SHRUB LOCATIONS:
THE PIPE ROUTING SHOWN ON THESE PLANS IS SCHEMATIC. THE CONTRACTOR SHALL INSTALL ALL PIPING OUTSIDE OF THE ROOT ZONE OF TREES OR SHRUBS. THE SPRINKLER LOCATIONS SHOWN ON THESE PLANS ARE FIXED AND MUST BE ADJUSTED TO MEET THE INTENDED DISTRIBUTION UNIFORMITY. THE CONTRACTOR SHALL FIELD ADJUST ANY SPRINKLER HEAD LOCATIONS THAT ARE SHOWN TO BE CLOSER THAN 12" FROM ANY SPRINKLER HEAD. IF SUBSTANTIAL TREE OR SHRUB REMOVALS ARE REQUIRED, THE CONTRACTOR SHALL HAVE HIS PROPOSED LOCATIONS APPROVED BY THE LANDSCAPE ARCHITECT PRIOR TO PLANTING.

SPRINKLER NOZZLES:
THE CONTRACTOR SHALL ADJUST THE THROWING RADIUS OF ALL PERTINENT SPRINKLER NOZZLES SO AS TO MINIMIZE OVERSPRAY ONTO HARDSCAPE OR OTHER UNINTENDED AREAS. THE CONTRACTOR SHALL ALSO INCLUDE IN HIS BID OR PRICING AN ALLOWANCE FOR ANY SPRINKLER NOZZLE CHANGES THAT ARE DEEMED NECESSARY BY THE LANDSCAPE ARCHITECT OR IRRIGATION CONSULTANT TO CORRECT ISSUES OF OVERSPRAY, UNDERSPRAY OR DISTRIBUTION UNIFORMITY.

MAINLINE FITTINGS:
THE CONTRACTOR SHALL USE TWO (2) 45 DEGREE ELBOWS FOR EACH 90 DEGREE MAINLINE BEND AS PER CITY OF ALBUQUERQUE'S REQUEST.

CONSENSUS PLANNING, INC.
Planning / Landscape Architecture
302 Eighth Street NW
Albuquerque, NM 87102
(505) 764-9801 Fax 842-5495
e-mail: c@consensusplanning.com

CITY OF ALBUQUERQUE
DEPARTMENT OF MUNICIPAL DEVELOPMENT
PARK DESIGN AND CONSTRUCTION DIVISION

TITLE: SUNDORO SOUTH PARK
IRRIGATION PLAN (WEST)

Design Review Committee
NOV 10 2006
DESIGN REVIEW COMMITTEE

City Engineer Approval
NOV 10 2006
CITY ENGINEER

City Project No. 777591
Zone Map No. J-8/J-9
Sheet 8 of 10

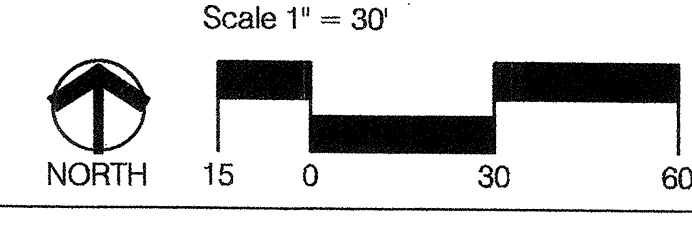

AS-BUILT INFORMATION		BENCH MARKS		SURVEY INFORMATION		ENGINEERS SEAL		REVISIONS		DESIGN	
CONTRACTOR	DATE	BY	DATE	NO.	BY	DATE	NO.	DATE	DESIGNED BY	CHECKED BY	DATE
									JR	CG	9/15/06
											9/15/06

10.17.06



GENERAL LANDSCAPE NOTES

1. Prior to beginning work on the project, the Landscape Contractor shall review the project in the field with the Owner's Representative.
2. If discrepancies occur between the drawings and the site, the Landscape Contractor shall notify the Owner's Representative for clarification prior to proceeding on that portion of work.
3. All planting areas are to have weeds and competitive vegetation removed prior to preparation for planting.
4. All existing plant materials shall be protected during construction. Damaged materials shall be replaced in kind at the Contractor's expense.
5. Plant quantities are provided for Contractor's convenience only, plans shall take precedence.
6. The Owner's Representative shall approve all plant material prior to planting. In addition, the Owner's Representative reserves the right to refuse any plant material deemed unacceptable. The Owner's Representative is to approve any and all substitutions.
7. It is the Landscape Contractor's responsibility to locate all underground utilities prior to commencement of planting operations.
8. All shrub planting areas shall be top dressed with 4" depth of 1/8" Santa Fe Brown gravel.

PLANT LEGEND

Qty.	Symbol	Scientific Name Common Name	Size	Installed Size Mature Size	Water Use
14		Chilopsis Linearis 'Lucretia Hamilton' 2" B4B Desert Willow	2" B4B	8' ft. x 6' spr. 20' ft. x 25' spr.	Low
6		Malus 'Spring Snow' Spring Snow Crabapple	2" B4B	8' ft. x 6' spr. 25' ft. x 25' spr.	Medium +
18		Pistachia chinensis Chinese Pistache	2.5" B4B	16' ft. x 6' spr. 60' ft. x 60' spr.	Medium +
11		Platanus acerifolia 'Bloodgood' Bloodgood London Plane Tree	2" B4B	16' ft. x 6' spr. 10' ft. x 60' spr.	Medium +
9		Quercus buckleyi Texas Red Oak	2" B4B	14' ft. x 6' spr. 40' ft. x 40' spr.	Medium
8		Fyrus calleryana 'Cleveland' Cleveland Pear	2" B4B	8' ft. x 6' spr. 25' ft. x 15' spr.	Medium
10		Fraxinus velutina 'Modesto' Modesto Ash	2" B4B	14' ft. x 6' spr. 40' ft. x 35' spr.	Medium +
4		Catalpa speciosa Western Catalpa	2" B4B	14' ft. x 6' spr. 40' ft. x 35' spr.	Medium +
8		Pinus nigra Austrian Pine	B4B	6' min. ht. 35' ft. x 25' spr.	Medium
10		Robinia ambigua 'Purple Robe' Purple Robe Locust	2" B4B	16' ft. x 6' spr. 30' ft. x 30' spr.	Medium
Shrubs/Grasscovers					
48		Agastache cana Hummingbird Mint	1-Gal.	3' o.c. 4' ht. x 2' spr.	Medium
10		Artemisia 'Powis Castle' Powis Castle Sage	1-Gal.	5' o.c. 3' ht. x 3' spr.	Medium
22		Baccharis 'Stam Thompson' Dwarf Coyotebush	5-Gal.	3' o.c. 3' ht. x 3' spr.	Medium
99		Caryopteris clandonensis Blue Mist	5-Gal.	3' o.c. 3' ht. x 3' spr.	Medium
63		Chrysanthemum nauseosus Chamisa	1-Gal.	5' o.c. 4' ht. x 4' spr.	Low
65		Ericameria laricifolia Dwarf Turpentine Bush	1-Gal.	4' o.c. 4' ht. x 4' spr.	Low +
63		Fallugia paradoxa Apache Plume	5-Gal.	4' o.c. 4' ht. x 6' spr.	Low +
33		Mirabilis multiflora Desert Four O'Clock	1-Gal.	3' o.c. 3' ht. x 3' spr.	Low
18		Atriplex canescens Fourwing saltbush	5-Gal.	6' o.c. 3' ht. x 4' spr.	Low
89		Rhus trilobata Threeleaf sumac	1-Gal.	4' o.c. 3' ht. x 3' spr.	Low
28		Rosmarinus officinalis 'Prostratus' Rosemary	1-Gal.	5' o.c. 2' ht. x 6' spr.	Low +
10		Sedum telephium Autumn Joy Sedum	5-Gal.	2' o.c. 2' ht. x 2' spr.	Low+
Ornamental Grasses					
42		Calamagrostis acutifolia Feather Reed Grass	1-Gal.	3' o.c. 3' ht. x 3' spr.	Medium
35		Helictitrichon sempervirens Blue Avena Grass	5-Gal.	4' o.c. 4' ht. x 4' spr.	Medium
49		Muhlenbergia cap. 'Regal Mist' Muhly Grass	5-Gal.	3' o.c. 3' ht. x 3' spr.	Medium
13		Nassella tenuissima Threadgrass	1-Gal.	3' o.c. 3' ht. x 3' spr.	Low +
36		Moss rock boulders 3'x3' (min)			
10582 SF		2" - 4" Ironstone Cobble			
51861 SF		Park Blend Turfgrass Sod (Tall Fescue, Kentucky Bluegrass, Rye)			

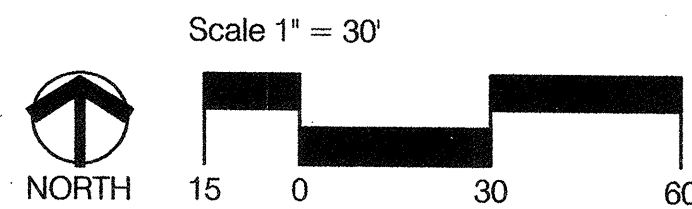

CONSENSUS PLANNING, INC.
Planning / Landscape Architecture
302 Eighth Street NW
Albuquerque, NM 87102
(505) 764-9801 Fax 842-5495
e-mail: cp@consensusplanning.com

CITY OF ALBUQUERQUE
DEPARTMENT OF MUNICIPAL DEVELOPMENT
PARK DESIGN AND CONSTRUCTION DIVISION

TITLE: SUNDORO SOUTH PARK
PLANTING PLAN

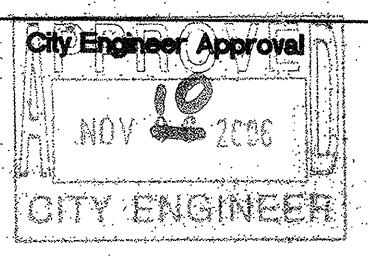

No. / Day / Yr.	No. / Day / Yr.

City Project No. 777591 Zone Map No. J-8/J-9 Sheet 9 of 10

AS BUILT INFORMATION			
CONTRACTOR	DATE	DATE	DATE
WORK STARTED BY	DATE	INSPECTED BY	DATE
FIELD	DATE	DESIGNATION BY	DATE
CORRECTED BY	DATE	RECORDED BY	DATE

BENCH MARKS			

SURVEY INFORMATION			
FIELD NOTES	BY	DATE	
NO.			

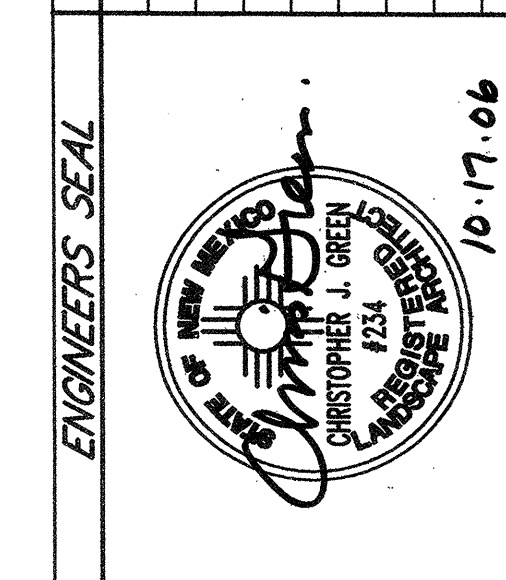

ENGINEERS SEAL			
REMARKS	BY	DATE	
REVISIONS			
DESIGN			
DESIGNED BY JR	DATE 9/15/06		
DRAWN BY JR	DATE 9/15/06		
CHECKED BY CG	DATE 9/15/06		

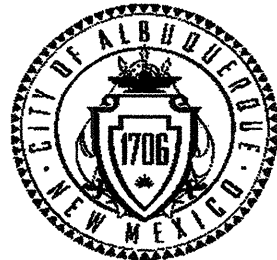

City of Albuquerque
Martin J. Chavez, Mayor

Department of Municipal Development
John Castillo, Director

Final Acceptance Form

Date: 8-30-06
To: Dale Sokkary, Superintendent, Park Management, Parks & Recreation Department (PRD)
From: John Casados, Construction Manager, Park Design and Construction, DMD
Subject: -PRD, Park Management Division Accepts Maintenance Responsibility

As of (date):
Project ID#: Sundoro South Park - Phase 1
Name of Facility: Sundoro South Park - Phase 1
Address: 700 88th Street SW
Park Zoning: RD/R-1

... is officially assigned to the Park Management Division, Parks & Recreation Department, City of Albuquerque for maintenance. Outlined below is a description of work completed:

☐ Developed ☐ Renovation

Detailed Park Summary Information:

Total Park Acreage: 3.31

Acres Developed or Renovated: 46.25 SF / 1.06 Acres

Acres of Irrigated Turf: Cool Season: 1.27

Warm Season:

Description of Project

Construction of children's play area, basketball court, plaza area, shade structure, including picnic tables, benches, bike racks, and litter receptacles.

Effective date:

NO MORE CHARGES for new water, electric and gas

...will be accepted by the contractor:

...are to occur against activity numbers:

Water Meter Reading:	Electric Meter Reading:	Gas Meter Reading:
Water Meter Number:	Electric Meter Number:	Gas Meter Number:

Project Name Sundoro South Park

Amenities	Total Existing	# Removed	#Added	Current Total
Backstops				
Baseball Fields (Lit)				
Basketball Courts (Full)				
Basketball Courts (Half)	0		2	2
BBQ Grills				
Benches	0		22	22
Bike Racks	0		1	1
Bleachers				
Concrete Sidewalks	0		9153 sf	9153 sf
Crusher Fines/Trail/Distance				
Drinking Fountains				
Exercise Stations				
Fencing(LF/Height)	0		183 LF of 4'	183 LF of 4'
Horseshoe Courts				
Modular Skate Facility				
Mutt Mitt Box				
Parking Spaces	0		11	11
Parking Spaces (ADA)	0		1	1
Pedestrian Bridge				
Picnic Tables	0		4	4
Play Areas	0		1	1
Play Structures (2 to 5 yrs)	0		2	2
Play Structures (5 to 12 yrs)	0		3	3
Pools (Indoor)				
Pools (Outdoor)				
Recreation Fields				
Shade Structures	0		1	1
Skate Facilities				
Softball Fields (Lit)				
Softball Fields (Unlit)				
Tennis Courts (Lit)				
Tennis Courts (Unlit)	0		2	2
Trash Receptacles	0		7	7
Turf Acres	0		1.27	1.27
Visitors Center				
Volleyball Courts				
Walking Paths(LF)				
Youth Baseball Fields				

Warranty and Vendor Information:

The following is a listing of all labor, vendors and product warranties pertaining to project: Tower Park - Phase 3 SWQ Modular Skate Area and Play Area
During the first year all calls regarding warranty information will go to the contractor. After one year calls regarding warranty go directly to the vendor.

Contractor:
Contact Name:
Phone:
Warranty:
One (1) year labor and installation
One (1) year growing season plant material
One (1) year irrigation/material

Vendor: DuMor, Inc.
Phone:
Application:
Product: 6" Recycled Plastic Bench w/Armrests
Model#: 58-60PL
For a period of (time frame):
commencing on (starting date):
and ending on (ending date):

Vendor: DuMor, Inc.
Phone:
Application:
Product: Recycled Plastic Picnic Tables
Model#: 100-68PL / 100-60PL
For a period of (time frame):
commencing on (starting date):
and ending on (ending date):

Vendor: McClintock
Phone:
Application:
Product: Trash Receptacle (surface mount)
Model#: RSO-25
For a period of (time frame):
commencing on (starting date):
and ending on (ending date):

Vendor: Litchfield
Phone:
Application:
Product: Metal Shade Structure
Model#: 8048SM 36' Hexagonal
For a period of (time frame):
commencing on (starting date):
and ending on (ending date):

Vendor: DuMor, Inc.
Phone:
Application:
Product: Multi-Loop Bike Rack
Model#: 130-30
For a period of (time frame):
commencing on (starting date):
and ending on (ending date):

Other amenities added and/or removed (Please describe, note the number, and specify whether added or removed):

The DMD, Project Manager from Park Design and Construction Division for this Capital Project

Sundoro South Park
(project name)

☐ John Casados
☒ David Flores
☐ Colleen Frenz
☐ Clay Gatewood
☐ Jose Martinez-Marino
☐ Dorothy Vinson

Email copies to:

javhar@caba.gov, szuschlag@caba.gov, svouna@caba.gov, afrenz@caba.gov, rlostrom@caba.gov,
jefinhart@caba.gov, stevesierra@caba.gov, rickpatya@caba.gov, DJFlores@caba.gov, smasandoval@caba.gov

AS BUILT INFORMATION		BENCH MARKS		SURVEY INFORMATION		ENGINEERS SEAL	
CONTRACTOR	DATE	NO.	BY	DATE	NO.	BY	DATE
WORK STARTED BY	DATE						
ACCEPTANCE BY	DATE						
FIELD NOTES BY	DATE						
DRAWINGS BY	DATE						
CORRECTIONS BY	DATE						
MICRO-FILM INFORMATION		REVISIONS		DESIGN		CHECKED BY	
RECORDED BY	DATE						
NO.							

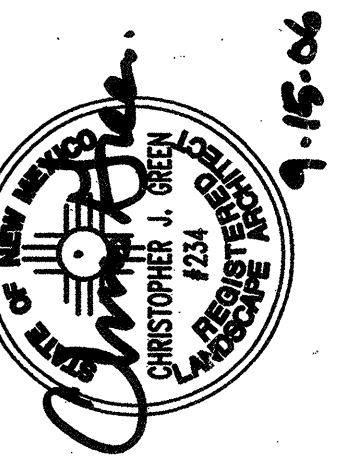

		CONSensus PLANNING, INC. Planning / Landscape Architecture 302 Eighth Street NW Albuquerque, NM 87102 (505) 764-9801 Fax 842-5495 e-mail: cp@consensusplanning.com	
CITY OF ALBUQUERQUE DEPARTMENT OF MUNICIPAL DEVELOPMENT PARK DESIGN AND CONSTRUCTION DIVISION			
TITLE: SUNDORO SOUTH PARK ACCEPTANCE FORMS			
Design Review Committee	City Engineer Approval	No. / Day / Yr.	No. / Day / Yr.
Last Design Update		DATE	DATE
		9/15/06	9/15/06
City Project No.	Zone Map No.	Sheet	Of
777591	J-8/J-9	10	10