

## IRRIGATION LEGEND

## IRRIGATION NOTES

- RAINBIRD #1401 .25 GPM FULL CIRCLE TRICKLE PATTERN BUBBLER (SEE COA STANDARD DETAIL DRAWINGS: 2710, 2711, 2711-A & 2712)
- ZONE VALVE: RAINBIRD #150-PEB 1 1/2" PLASTIC ELECTRIC VALVE WITH FLOW CONTROL (SEE COA STANDARD DETAIL DRAWING: 2703)
- ZONE VALVE: RAINBIRD #200-PEB 2" PLASTIC ELECTRIC VALVE WITH FLOW CONTROL (SEE COA STANDARD DETAIL DRAWING: 2703)
- MOTOROLA SCORPIO-AC CONTROLLER WITH INTERSPEC ENCLOSURE, KEYPAD AND DOMED ANTENNA. UNIT SHALL COMMUNICATE ON COA RADIO FREQUENCY (WIDE BAND). (SEE DETAIL DRAWING: B/4 & D/4) (8 STATION OUTPUT)
- ISOLATION VALVE ASSEMBLY - LINE SIZE (SEE COA STANDARD DETAIL #2707)
- FEBCO #825YA 2" REDUCED PRESSURE BACKFLOW PREVENTER WITH 2" MASTER VALVE ASSEMBLY INSTALLED IN "CLAY" COLORED HOTBOX "HOT ROK" HEATED AND INSULATED BACKFLOW DEVICE ENCLOSURE. (SEE DETAIL DRAWING: C/4)
- MASTER METER INTERMEDIATE MULTIJET SERIES 2" FLOW METER WITH ELECTRICAL OUTPUT REGISTER - 1 PULSE = 1 GALLON (SEE DETAIL DRAWING: C/4)
- CITY WATER METER - 2" SENSUS SR SERIES (SEE COA STANDARD DETAIL DRAWING: 2362 OR 2363) WATER METER ADDRESS IS UNKNOWN AT THIS TIME
- CRISPEN #UL10.1 1" UNIVERSAL AIR RELEASE VALVE ASSEMBLY
- ELECTRIC METER PEDESTAL (SEE DETAIL DRAWING: A/4)
- MAINLINE PIPING - 2.5" CLASS 200 PVC
- LATERAL PIPING - SCH.40 PVC SOLVENT WELD (SIZE INDICATED ON PLAN - UNSIZED PIPE IS 3/4")
- SLEEVE PIPING - CLASS 200 PVC (TWO SIZES LARGER THAN PIPE TO BE SLEEVED)
- WATER METER SERVICE LINE - (SAME SIZE AS WATER METER)
- 120 VOLT ELECTRICAL POWER WIRE ROUTE
- VALVE ID NUMBER
- FLOW IN GALLONS PER MINUTE

**WATER PRESSURE:**  
THE WATER PRESSURE AT THIS SITE HAS BEEN REPORTED AND NOTED ON DRAWING BY THE LANDSCAPE ARCHITECT. THE CONTRACTOR SHALL VERIFY WATER PRESSURE AT THE NEAREST AVAILABLE FIRE HYDRANT PRIOR TO BEGINNING INSTALLATION OF IRRIGATION SYSTEM.

**SPECIFICATIONS AND DETAIL DRAWINGS:**  
THE CONTRACTOR SHALL REFER TO THE CITY OF ALBUQUERQUE'S STANDARD SPECIFICATIONS AND DETAIL DRAWINGS FOR IRRIGATION CONSTRUCTION. IN THE EVENT OF A CONFLICT BETWEEN SPECIFICATIONS AND IRRIGATION DESIGN, THE CONTRACTOR SHALL NOTIFY THE PROJECT MANAGER IN WRITING. THE CONTRACTOR SHALL NOT PROCEED WITH INSTALLATION OF CONFLICTING IRRIGATION COMPONENTS UNTIL HE RECEIVES CLARIFICATION IN WRITING FROM THE PROJECT MANAGER.

**PROXIMITY OF PIPING TO SHRUBS AND TREES:**  
THE PIPE ROUTING SHOWN ON THESE PLANS IS SCHEMATIC AND MAY REQUIRE FIELD ADJUSTMENTS BY THE CONTRACTOR. WHEN POSSIBLE THE CONTRACTOR SHALL INSTALL PIPING OUTSIDE OF ROOTZONE OF SHRUBS AND TREES.

**IRRIGATION SATELLITE:**  
FOR SCORPIO SATELLITES, THE CONTRACTOR SHALL HAVE A RADIO SIGNAL STRENGTH SURVEY PERFORMED TO VERIFY PROPER RADIO COMMUNICATION FROM IRRINET CONTROLLER LOCATION TO PROPOSED SCORPIO CONTROLLER LOCATION. PRIOR TO THE INSTALLATION OF THE SCORPIO CONTROLLER, THE CONTRACTOR SHALL CONTACT: WATER RESOURCES, INC., (MARK MATHES) (505) 888-1388 FOR THIS SERVICE. THE CONTRACTOR SHALL BE RESPONSIBLE FOR ALL COSTS ASSOCIATED WITH THE RADIO SIGNAL STRENGTH SURVEY.

**BUBBLER CHECK VALVES:**  
IT IS EXPECTED THAT THERE MAY BE LOW-HEAD DRAINAGE AT SOME OF THE BUBBLERS AT THE LOWER ELEVATIONS. IF PROBLEMATIC CONDITIONS APPEAR, THE CONTRACTOR SHALL INSTALL A RAINBIRD #ACV-050 CHECK VALVE ON ALL EFFECTED BUBBLERS. FOR BID OR PRICING PURPOSES THE CONTRACTOR SHALL ASSUME THE INSTALLATION OF CHECK VALVES ON ALL BUBBLERS AND INCLUDE THESE COSTS IN HIS BID.

**ROAD CROSSINGS:**  
THE CONTRACTOR SHALL BORE ALL SLEEVE PIPE WHEN CROSSING PAVED SURFACES.

**HIGH VOLTAGE ELECTRICAL WIRING:**  
THE CONTRACTOR SHALL INSTALL THE ENTIRE LENGTH OF HIGH VOLTAGE ELECTRICAL WIRING INSIDE OF PVC ELECTRICAL CONDUIT AND SHALL PROVIDE ELECTRICAL PULL BOXES IN APPROXIMATELY 185' INTERVALS. THE CONTRACTOR SHALL INSURE THAT THE ELECTRICAL WIRING IS PROPERLY SIZED FOR THE AMPERAGE AND DISTANCE.

**PROXIMITY OF PIPING AND WIRING TO LANDSCAPE PODS:**  
THE CONTRACTOR SHALL INSTALL ALL PIPING (LATERAL AND MAINLINE) AND WIRING (HIGH VOLTAGE AND LOW VOLTAGE) AS CLOSE TO THE LANDSCAPE POD AS POSSIBLE IN ORDER TO PROVIDE ROOM FOR FUTURE ROADWAY EXPANSION.

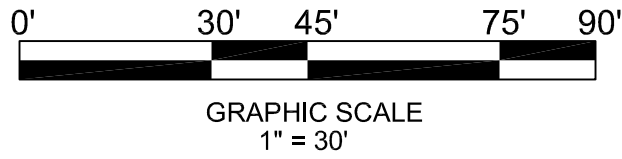

**MORROW REARDON WILKINSON, LTD., LANDSCAPE ARCHITECTS**  
210 La Veta NE, Albuquerque, NM 87108  
505.268.2268 FAX 505.265.9637  
mrw@mrwnm.com

AS-BUILTS  
9-9-08

**Irrigation Services**  
IRRIGATION DESIGNERS & CONSULTANTS  
44 GOOD DRIVE BELLEVILLE, NM 87002  
PHONE: (505) 861-1536  
FAX: (505) 864-3212  
EMAIL: irrserv@csdnet.com

CITY OF ALBUQUERQUE CAPITAL IMPLEMENTATION PROGRAM DEPARTMENT OF MUNICIPAL DEVELOPEMENT			
TITLE: PROTOTYPE MEDIAN & INTERSTATE LANDSCAPES FY06-B COORS BLVD: CENTRAL TO BRIDGE			
IRRIGATION SYSTEM DESIGN			
Design Review Committee	City Engineer Approval	MO/ JAW/ ZTR	05/15/08
		05/05/08	
		05/07/08	
		05/15/08	
City Project No. 777902		Zone Map No. K-10 / L-10	Sheet 1 Of 3

SURVEY INFORMATION		BENCHMARK		AS BUILT INFORMATION	
FIELD NOTES					
NO.	BY	DATE	CONTRACTOR: SEQUOIA LANDSCAPE	WORK STAKED BY: X	DATE: X
			INSPECTOR'S APPROVAL: X	DATE: X	
			FIELD VERIFICATION BY: C.G.	DATE: X	
			DRAWING CORRECTED BY: X	DATE: X	
MICRO-FILM INFORMATION			RECORDED BY	DATE:	
			NO.		

DESIGNED BY: JG  
DRAWN BY: JG / JW  
CHECKED BY: JG  
DATE: 05/08  
DATE: 05/08  
DATE: 05/08

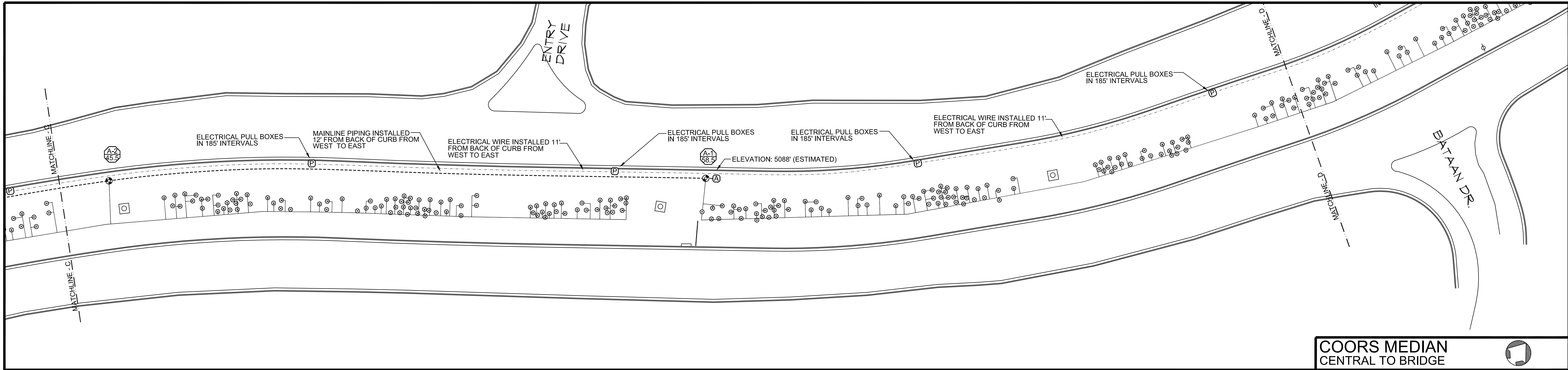



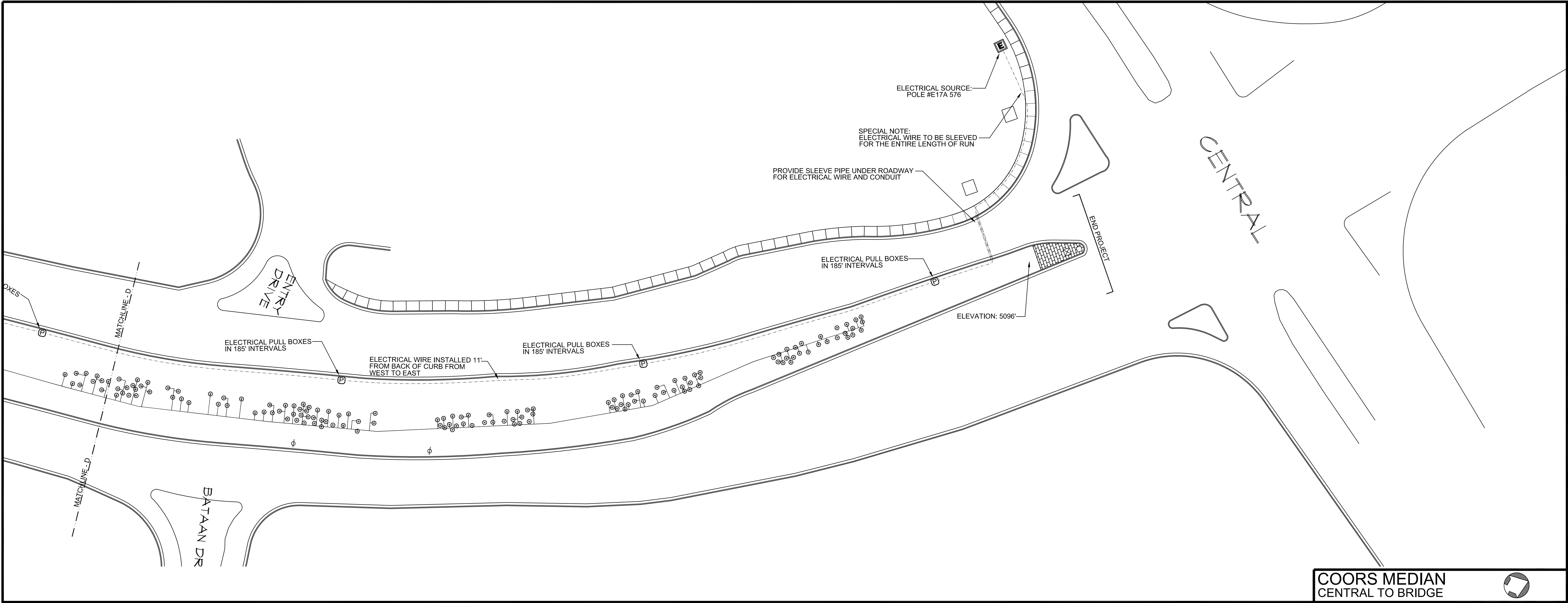

## IRRIGATION LEGEND

- RAINBIRD #1401 .25 GPM FULL CIRCLE TRICKLE PATTERN BUBBLER (SEE COA STANDARD DETAIL DRAWINGS: 2710, 2711, 2711-A & 2712)
- ZONE VALVE: RAINBIRD #150-PEB 1 1/2" PLASTIC ELECTRIC VALVE WITH FLOW CONTROL (SEE COA STANDARD DETAIL DRAWING: 2703)
- ZONE VALVE: RAINBIRD #200-PEB 2" PLASTIC ELECTRIC VALVE WITH FLOW CONTROL (SEE COA STANDARD DETAIL DRAWING: 2703)
- MOTOROLA SCORPIO-AC CONTROLLER WITH INTERSPEC ENCLOSURE, KEYPAD AND DOMED ANTENNA. UNIT SHALL COMMUNICATE ON COA RADIO FREQUENCY (WIDE BAND). (SEE DETAIL DRAWING: B/4 & D/4) (8 STATION OUTPUT)
- ISOLATION VALVE ASSEMBLY - LINE SIZE (SEE COA STANDARD DETAIL #2707)
- FEBCO #825YA 2" REDUCED PRESSURE BACKFLOW PREVENTER WITH 2" MASTER VALVE ASSEMBLY INSTALLED IN "CLAY" COLORED HOTBOX "HOT ROK" HEATED AND INSULATED BACKFLOW DEVICE ENCLOSURE. (SEE DETAIL DRAWING: C/4)
- MASTER METER INTERMEDIATE MULTIJET SERIES 2" FLOW METER WITH ELECTRICAL OUTPUT REGISTER - 1 PULSE = 1 GALLON (SEE DETAIL DRAWING: C/4)
- CITY WATER METER - 2" SENSUS SR SERIES (SEE COA STANDARD DETAIL DRAWING: 2362 OR 2363) WATER METER ADDRESS IS UNKNOWN AT THIS TIME
- CRISPEN #UL10.1 1" UNIVERSAL AIR RELEASE VALVE ASSEMBLY
- ELECTRIC METER PEDESTAL (SEE DETAIL DRAWING: A/4)
- MAINLINE PIPING - 2.5" CLASS 200 PVC
- LATERAL PIPING - SCH.40 PVC SOLVENT WELD (SIZE INDICATED ON PLAN - UNSIZED PIPE IS 3/4")
- SLEEVE PIPING - CLASS 200 PVC (TWO SIZES LARGER THAN PIPE TO BE SLEEVED)
- WATER METER SERVICE LINE - (SAME SIZE AS WATER METER)
- 120 VOLT ELECTRICAL POWER WIRE ROUTE
- VALVE ID NUMBER
- FLOW IN GALLONS PER MINUTE

## IRRIGATION NOTES

- WATER PRESSURE:**  
THE WATER PRESSURE AT THIS SITE HAS BEEN REPORTED AND NOTED ON DRAWING BY THE LANDSCAPE ARCHITECT. THE CONTRACTOR SHALL VERIFY WATER PRESSURE AT THE NEAREST AVAILABLE FIRE HYDRANT PRIOR TO BEGINNING INSTALLATION OF IRRIGATION SYSTEM.
- SPECIFICATIONS AND DETAIL DRAWINGS:**  
THE CONTRACTOR SHALL REFER TO THE CITY OF ALBUQUERQUE'S STANDARD SPECIFICATIONS AND DETAIL DRAWINGS FOR IRRIGATION CONSTRUCTION. IN THE EVENT OF A CONFLICT BETWEEN SPECIFICATIONS AND IRRIGATION DESIGN, THE CONTRACTOR SHALL NOTIFY THE PROJECT MANAGER IN WRITING. THE CONTRACTOR SHALL NOT PROCEED WITH INSTALLATION OF CONFLICTING IRRIGATION COMPONENTS UNTIL HE RECEIVES CLARIFICATION IN WRITING FROM THE PROJECT MANAGER.
- PROXIMITY OF PIPING TO SHRUBS AND TREES:**  
THE PIPE ROUTING SHOWN ON THESE PLANS IS SCHEMATIC AND MAY REQUIRE FIELD ADJUSTMENTS BY THE CONTRACTOR. WHEN POSSIBLE THE CONTRACTOR SHALL INSTALL PIPING OUTSIDE OF ROOTZONE OF SHRUBS AND TREES.
- IRRIGATION SATELLITE:**  
FOR SCORPIO SATELLITES, THE CONTRACTOR SHALL HAVE A RADIO SIGNAL STRENGTH SURVEY PERFORMED TO VERIFY PROPER RADIO COMMUNICATION FROM IRRINET CONTROLLER LOCATION TO PROPOSED SCORPIO CONTROLLER LOCATION. PRIOR TO THE INSTALLATION OF THE SCORPIO CONTROLLER, THE CONTRACTOR SHALL CONTACT: WATER RESOURCES, INC., (MARK MATHES) (505) 888-1388 FOR THIS SERVICE. THE CONTRACTOR SHALL BE RESPONSIBLE FOR ALL COSTS ASSOCIATED WITH THE RADIO SIGNAL STRENGTH SURVEY.
- BUBBLER CHECK VALVES:**  
IT IS EXPECTED THAT THERE MAY BE LOW-HEAD DRAINAGE AT SOME OF THE BUBBLERS AT THE LOWER ELEVATIONS. IF PROBLEMATIC CONDITIONS APPEAR, THE CONTRACTOR SHALL INSTALL A RAINBIRD RACV-050 CHECK VALVE ON ALL EFFECTED BUBBLERS. FOR BID OR PRICING PURPOSES THE CONTRACTOR SHALL ASSUME THE INSTALLATION OF CHECK VALVES ON ALL BUBBLERS AND INCLUDE THESE COSTS IN HIS BID.
- ROAD CROSSINGS:**  
THE CONTRACTOR SHALL BORE ALL SLEEVE PIPE WHEN CROSSING PAVED SURFACES.
- HIGH VOLTAGE ELECTRICAL WIRING:**  
THE CONTRACTOR SHALL INSTALL THE ENTIRE LENGTH OF HIGH VOLTAGE ELECTRICAL WIRING INSIDE OF PVC ELECTRICAL CONDUIT AND SHALL PROVIDE ELECTRICAL PULL BOXES IN APPROXIMATELY 185' INTERVALS. THE CONTRACTOR SHALL INSURE THAT THE ELECTRICAL WIRING IS PROPERLY SIZED FOR THE AMPERAGE AND DISTANCE.
- PROXIMITY OF PIPING AND WIRING TO LANDSCAPE PODS:**  
THE CONTRACTOR SHALL INSTALL ALL PIPING (LATERAL AND MAINLINE) AND WIRING (HIGH VOLTAGE AND LOW VOLTAGE) AS CLOSE TO THE LANDSCAPE POD AS POSSIBLE IN ORDER TO PROVIDE ROOM FOR FUTURE ROADWAY EXPANSION.

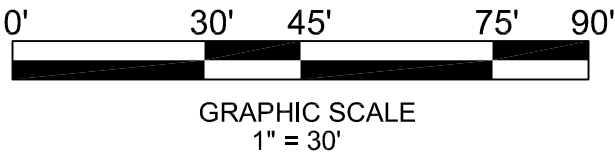

**MORROW REARDON WILKINSON, LTD., LANDSCAPE ARCHITECTS**  
210 La Veta NE, Albuquerque, NM 87108  
505.268.2268 FAX 505.265.9637  
mrw@mrwnm.com

AS-BUILTS  
9-9-08

**Irrigation Services**  
IRRIGATION DESIGNERS & CONSULTANTS  
44 GOOD DRIVE BELLEVILLE, NM 87002  
PHONE: (505) 861-1538  
FAX: (505) 864-3212  
EMAIL: irrservices@aol.com

CITY OF ALBUQUERQUE CAPITAL IMPLEMENTATION PROGRAM DEPARTMENT OF MUNICIPAL DEVELOPEMENT			
TITLE: PROTOTYPE MEDIAN & INTERSTATE LANDSCAPES FY06-B COORS BLVD: CENTRAL TO BRIDGE		05/15/08	
Design Review Committee	City Engineer Approval	MO/7/04/2/08	MO/7/04/2/08
		05/07/08	
		05/15/08	
City Project No. 777902	Zone Map No. K-10 / L-10	Sheet 3	Of 3