

1 2 3 4 5 6 7 8 9 10 11 12 13 14 15  
26-778787-181-2009

SCANNED BY  
PLANNING

**PUBLIC IMPROVEMENT PLANS**  
**FOR**  
**STORM WATER IMPROVEMENTS**  
**ELITE DRY WALL**  
**ALBUQUERQUE, BERNALILLO COUNTY, NEW MEXICO**  
**JANUARY 2006**

PREPARED FOR:  
ELITE DRY WALL  
370 HIGHWAY 333 E- ST  
TIJERAS, NM 87059

PREPARED BY:  
TGC ENGINEERING INC.  
330 LOUISIANA BLVD. NE  
ALBUQUERQUE, NM 87108

**INDEX TO DRAWINGS**

SHEET NO.	TITLE
1 OF 6	COVER SHEET
2 OF 6	PLAT
3 OF 6	APPROVED/AS BUILT SITE GRADING AND DRAINAGE PLAN
4 OF 6	PLAN AND PROFILE - SAN MATEO BLVD.
5 OF 6	PLAN AND PROFILE - EAGLE ROCK AVE.
6 OF 6	STRIPING - SAN MATEO BLVD. PAVEMENT SECTION, RAMP DETAILS

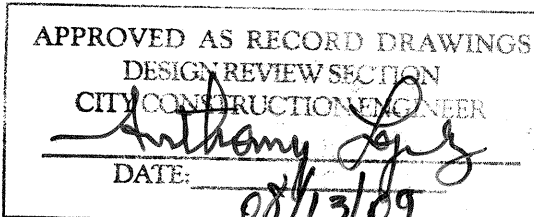

The subject property is located near a former landfill. Due to the subject property being near a former landfill, certain precautionary measures may need to be taken to ensure the health and safety of the public. Recommendations made by a professional engineer with expertise in landfills and landfill gas issues (as required by the most current version of the Interim Guidelines for Development within City Designated Landfill Buffer Zones shall be consulted prior to development of the site.

*Richard Mathis* 2/26/07  
Environmental Health

I, THOMAS D. JOHNSTON, OF THE FIRM TGC ENGINEERING INC. DO HEREBY CERTIFY TO THE BEST OF MY KNOWLEDGE AND BELIEF THAT THE INFRASTRUCTURE INSTALLED AS PART OF THIS PROJECT HAS BEEN INSPECTED BY ME AND HAS BEEN CONSTRUCTED IN ACCORDANCE WITH THE PLANS & SPECIFICATIONS APPROVED BY THE CITY ENGINEER AND THAT THE ORIGINAL DESIGN INTENT OF THE APPROVED PLANS HAS BEEN MET. THIS CERTIFICATION IS BASED ON SITE INSPECTIONS AND SURVEY DATA PROVIDED BY ME AND EDITED ONTO THIS PLANSET.

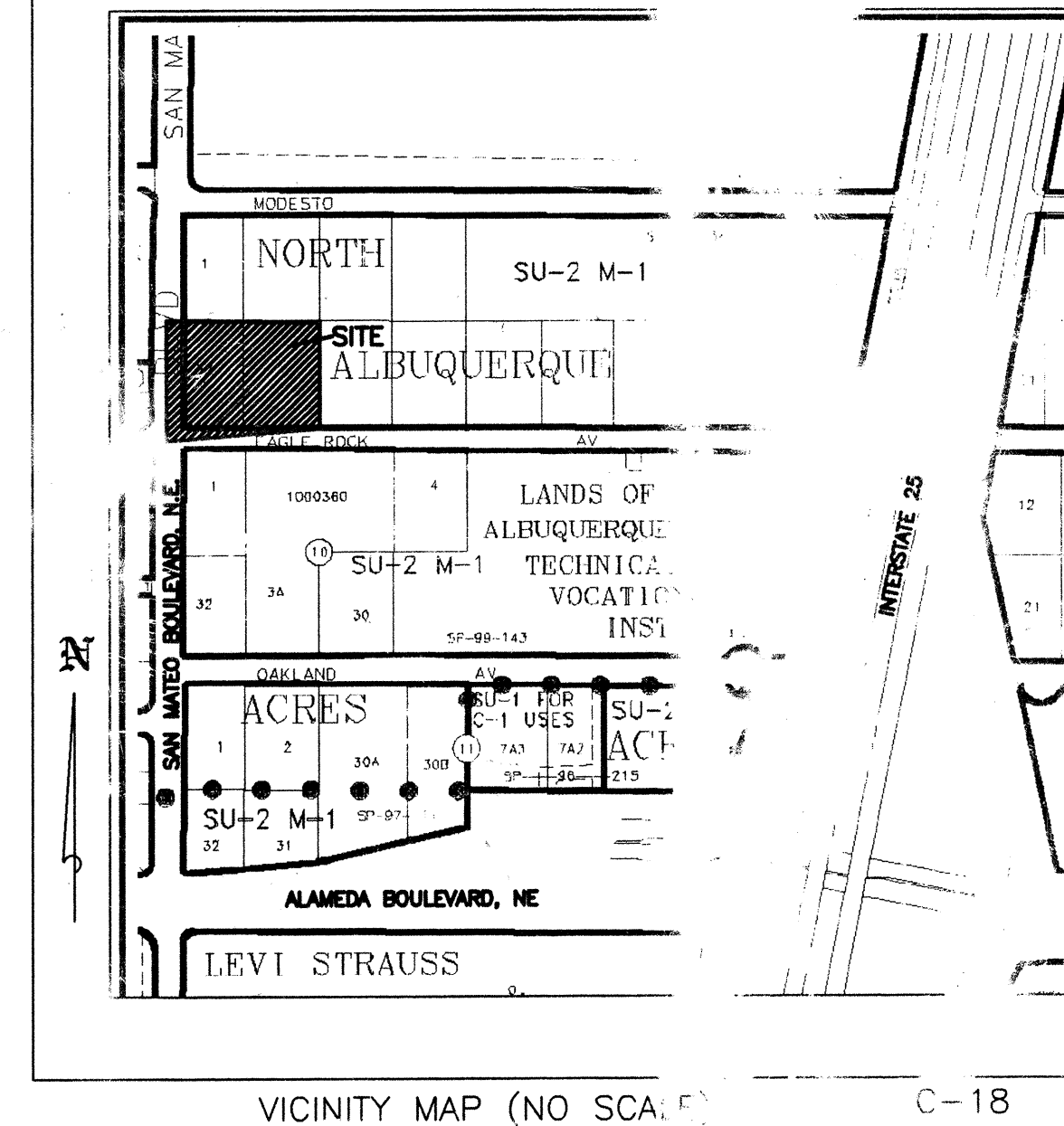
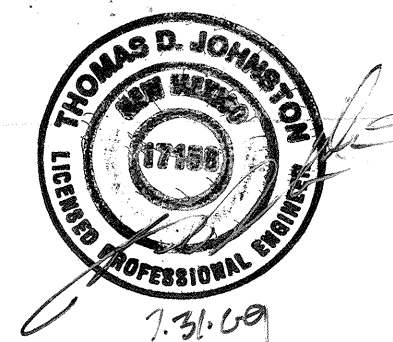

**GENERAL NOTES**

1. ALL WORK DETAILED ON THESE PLANS TO BE PERFORMED UNDER CONTRACT SHALL, EXCEPT AS OTHERWISE STATED OR PROVIDED FOR HEREON, BE CONSTRUCTED IN ACCORDANCE WITH THE CITY OF ALBUQUERQUE STANDARD SPECIFICATIONS FOR PUBLIC WORKS CONSTRUCTION 1986 EDITION AS AMENDED THROUGH UPDATE NO. 7 INCLUDING AMENDMENT NO. 1.
2. ALL WORK ON THIS PROJECT SHALL BE PERFORMED IN ACCORDANCE WITH APPLICABLE FEDERAL, STATE, AND LOCAL LAWS, RULES AND REGULATIONS CONCERNING CONSTRUCTION SAFETY AND HEALTH.
3. PRIOR TO CONSTRUCTION, THE CONTRACTOR SHALL EXCAVATE AND VERIFY THE HORIZONTAL AND VERTICAL LOCATIONS OF ALL OBSTRUCTIONS. SHOULD A CONFLICT EXIST, THE CONTRACTOR SHALL NOTIFY THE ENGINEER SO THAT THE CONFLICT CAN BE RESOLVED WITH MINIMUM DELAY.
4. TWO (2) WORKING DAYS PRIOR TO ANY EXCAVATION, CONTRACTOR MUST CONTACT THE LINE LOCATION SERVICE, NM ONE CALL AT 260-1990 FOR LOCATION OF EXISTING UTILITIES.
5. CONTRACTOR SHALL CONDUCT HIS OPERATIONS IN A MANNER WHICH WILL MINIMIZE INTERFERENCE WITH LOCAL TRAFFIC. CONTRACTOR SHALL COMPLY WITH ALL APPLICABLE LAWS, ORDINANCES, RULES, REGULATIONS, AND ORDERS OF ANY PUBLIC BODY HAVING JURISDICTION FOR THE SAFETY OF PERSONS OR PROPERTY, AND TO PROTECT THEM FROM DAMAGE, INJURY OR LOSS. CONTRACTOR SHALL ERECT AND MAINTAIN, AS REQUIRED BY THE CONDITIONS AND PROGRESS OF THE WORK, ALL NECESSARY SAFEGUARDS FOR SAFETY CONTINUOUSLY AND NOT LIMIT TO NORMAL WORKING HOURS, THROUGHOUT THE DURATION OF THE PROJECT. CONTRACTOR SHALL ADHERE TO SECTION 19 OF THE GENERAL CONDITIONS OF THE CITY OF ALBUQUERQUE STANDARD SPECIFICATIONS FOR PUBLIC WORKS CONSTRUCTION, 1986, AS AMENDED WITH UPDATE NO. 7.
6. CONTRACTOR AGREES THAT HE SHALL ASSUME THE SOLE AND COMPLETE RESPONSIBILITY FOR THE JOB SITE CONDITIONS DURING THE COURSE OF CONSTRUCTION OF THE PROJECT, INCLUDING SAFETY OF ALL PERSONS AND PROPERTY, THAT THIS REQUIREMENT SHALL APPLY CONTINUOUSLY AND NOT BE LIMITED TO NORMAL WORKING HOURS, AND THAT THE CONTRACTOR SHALL DEFEND, INDEMNIFY AND HOLD THE OWNER, ENGINEER, AND CITY HARMLESS FROM ANY AND ALL LIABILITY, REAL OR ALLEGED, IN CONNECTION WITH THE PERFORMANCE OF WORK ON THIS PROJECT, EXCEPTING FOR LIABILITY ARISING FROM THE SOLE NEGLIGENCE OF THE OWNER, ENGINEER, OR CITY.
7. TRAFFIC CONTROL: FIVE (5) WORKING DAYS PRIOR TO BEGINNING CONSTRUCTION, THE CONTRACTOR SHALL SUBMIT TO THE CITY A DETAILED CONSTRUCTION SCHEDULE. TWO (2) WORKING DAYS PRIOR TO CONSTRUCTION, THE CONTRACTOR SHALL OBTAIN A BARRICADING PERMIT FROM THE CONSTRUCTION COORDINATION DIVISION. CONTRACTOR SHALL NOTIFY BARRICADE ENGINEER (924-3400) PRIOR TO OCCUPYING AN INTERSECTION. SEE SECTION 19 OF THE SPECIFICATIONS. ALL STREET STRIPING ALTERED OR DESTROYED SHALL BE REPLACED WITH PLASTIC REFLECTORIZED PAVEMENT MARKINGS BY CONTRACTOR TO LOCATION AND IN KIND AS EXISTING OR AS INDICATED BY THIS PLAN SET.
8. WHEN ABUTTING EXISTING PAVEMENT TO NEW, SAWCUT EXISTING PAVEMENT TO A STRAIGHT EDGE AND AT A RIGHT ANGLE, OR AS APPROVED BY THE FIELD ENGINEER. REMOVAL OF BROKEN OR CRACKED PAVEMENT WILL ALSO BE REQUIRED.
9. EXISTING CURB AND GUTTER NOT TO BE REMOVED UNDER THE CONTRACT WHICH IS DAMAGED OR DISPLACED BY THE CONTRACTOR SHALL BE REMOVED AND REPLACED BY THE CONTRACTOR AT HIS/HER EXPENSE.
10. ALL FINAL BACKFILL FOR TRENCHES SHALL BE COMPACTED TO A MINIMUM 95 % MAXIMUM DENSITY PER ASTM D-1557 AND AS DIRECTED BY SECTION 701.14.2 AND STANDARD DRAWING NO. 2465.
11. THE CONTRACTOR SHALL PROMPTLY CLEAN UP ANY MATERIAL EXCAVATED WITHIN THE PUBLIC RIGHT-OF-WAY OR PRIVATE ROADWAY EASEMENTS SO THAT THE EXCAVATED MATERIAL IS NOT SUSCEPTIBLE TO BEING WASHED DOWN THE STREET OR INTO ANY PUBLIC DRAINAGE FACILITY.
12. TACK COAT FOR SURFACE COURSE REQUIREMENTS WILL BE DETERMINED BY THE ENGINEER.
13. PERMANENT PAVEMENT STRIPING AND MARKINGS WILL BE PLACED BY THE CONTRACTOR. THE ROAD SHALL NOT BE OPENED TO THE TRAFFIC UNTIL IT IS STRIPED. ALL STRIPING, PAVEMENT MARKINGS INCLUDING CROSSWALKS, ARROWS AND LINE MARKINGS ARE TO BE CONSTRUCTED OF HOT PLASTIC OR COLD PLASTIC IN ACCORDANCE WITH THE MANUAL OF UNIFORM TRAFFIC CONTROL DEVICES.
14. CONTRACTOR SHALL SUPPORT ALL EXISTING, UNDERGROUND UTILITY LINES WHICH BECOME EXPOSED DURING CONSTRUCTION. PAYMENT FOR SUPPORTING WORK SHALL BE INCIDENTAL TO WATERLINE AND/OR SEWERLINE COSTS.
15. ALL WATER VALVE BOXES, MANHOLES IN THE STREET CONSTRUCTION ARE TO BE ADJUSTED TO FINISH GRADE AND WILL BE MEASURED AND PAID PER EACH.
16. CONTRACTOR SHALL ASSIST THE ENGINEER/INSPECTOR IN THE RECORDING OF DATA ON ALL UTILITY LINES AND ACCESSORIES AS REQUIRED BY THE CITY OF ALBUQUERQUE FOR THE PREPARATION OF RECORD DRAWINGS. CONTRACTOR SHALL NOT COVER UTILITY LINES AND ACCESSORIES UNTIL ALL DATA HAS BEEN RECORDED.
17. CONTRACTOR SHALL NOTIFY THE ENGINEER NOT LESS THAN 7 DAYS PRIOR TO STARTING WORK IN ORDER THAT THE ENGINEER MAY TAKE NECESSARY MEASURES TO PRESERVE SURVEY MONUMENTS. CONTRACTOR SHALL NOT DISTURB SURVEY MONUMENTS WITHOUT THE CONSENT OF THE ENGINEER AND BEAR THE EXPENSE OF REPLACING ANY THAT MAY BE DISTURBED WITHOUT PERMISSION. REPLACEMENT SHALL BE DONE ONLY BY THE CITY SURVEYOR. WHEN A CHANGE IS MADE IN THE FINISHED ELEVATIONS OF THE PAVEMENT OF ANY ROADWAY IN WHICH A PERMANENT SURVEY MONUMENT IS LOCATED, CONTRACTOR SHALL, AT HIS OWN EXPENSE, ADJUST THE MONUMENT COVER TO THE NEW GRADE UNLESS OTHERWISE SPECIFIED. REFER TO SECTION 4.4 OF THE GENERAL CONDITIONS OF THE STANDARD SPECIFICATIONS.
18. CONTRACTOR WILL BE RESPONSIBLE FOR PROVIDING AND MAINTAINING ALL SIGNING UNTIL PROJECT HAS BEEN ACCEPTED BY THE CITY.
19. PNM WILL PROVIDE AT NO COST TO THE CITY OR THE CONTRACTOR THE REQUIRED PERSONNEL FOR INSPECTION OR OBSERVATION DEEMED NECESSARY BY PNM WHILE THE CONTRACTOR IS EXPOSING PNM'S CABLES. HOWEVER, THE CONTRACTOR SHALL BE CHARGED THE TOTAL COST ASSOCIATED WITH REPAIRS TO ANY DAMAGED CABLES OR FOR ANY COST ASSOCIATED WITH SUPPORTING OR RELOCATING THE POLES AND CABLES DURING CONSTRUCTION.
20. WARNING - EXISTING UTILITY LINE LOCATIONS ARE SHOWN IN AN APPROXIMATE MANNER ONLY, AND SUCH LINES MAY EXIST WHERE NONE ARE SHOWN. THE LOCATION OF ANY SUCH EXISTING LINES IS BASED UPON INFORMATION PROVIDED BY THE UTILITY COMPANY, THE OWNER, OR BY OTHERS, AND THE INFORMATION MAY BE INCOMPLETE OR MAY BE OBSOLETE BY THE TIME CONSTRUCTION COMMENCES.
21. THE ENGINEER HAS UNDERTAKEN NO FIELD VERIFICATION OF THE LOCATION, DEPTH, SIZE OR TYPE OF EXISTING UNDERGROUND UTILITY LINES, MAKES NO REPRESENTATION PERTAINING THERETO, AND ASSUMES NO RESPONSIBILITY OR LIABILITY THEREFOR. THE CONTRACTOR SHALL INFORM ITSELF OF THE LOCATION OF ANY UTILITY LINE IN OR NEAR THE AREA OF THE WORK IN ADVANCE OF AND DURING EXCAVATION WORK. THE CONTRACTOR IS FULLY RESPONSIBLE FOR ANY AND ALL DAMAGE CAUSED BY ITS FAILURE TO LOCATE, IDENTIFY, AND PRESERVE ANY AND ALL EXISTING UTILITIES. THE CONTRACTOR SHALL COMPLY WITH STATE STATUTES, MUNICIPAL AND LOCAL ORDINANCES, RULES AND REGULATIONS PERTAINING TO THE LOCATION OF THESE LINES AND FACILITIES, IN PLANNING AND CONDUCTING EXCAVATION, WHETHER BY CALLING OR NOTIFYING THE UTILITIES, COMPLYING WITH "BLUE STAKES" PROCEDURES, OR OTHERWISE.
22. ANY WORK OCCURRING WITHIN AN ARTERIAL ROADWAY REQUIRES 24 HR. CONSTRUCTION.
23. ALL EXCAVATION, TRENCHING AND SHORING ACTIVITIES MUST BE ACCOMPLISHED IN ACCORDANCE WITH OSHA 29CFR 1926.650 SUBPART P.
24. CONTRACTOR SHALL MAINTAIN A GRAFFITI-FREE WORK SITE. CONTRACTOR SHALL PROMPTLY REMOVE ANY AND ALL GRAFFITI FROM EQUIPMENT, WHETHER PERMANENT OR TEMPORARY.
25. FOR STORM DRAIN CONSTRUCTION, RCP PIPE JOINTS SHALL NOT BE GROUTED PRIOR TO FINAL INSPECTION. FINAL INSPECTION WILL DETERMINE JOINTS TO BE GROUTED FOR FINAL ACCEPTANCE OF THE CONSTRUCTION.

**RECORD DRAWING**

REV.	SHEETS	CITY ENGINEER	DATE	USER DEPARTMENT	DATE	USER DEPARTMENT	DATE
ENGINEERS' STAMP & SIGNATURE		APPROVALS		ENGINEER		APPROVED FOR CONSTRUCTION	
		DRC Chairman		<i>Stephen Woodell</i>		5/2/07	
		Transportation		<i>Tom Johnston</i>		3/2/07	
		Water/Wastewater		<i>William D. Dales</i>		3/2/07	
		Hydrology		<i>Tom Johnston</i>		3/2/07	
		AMAFCA		<i>Tom Johnston</i>		3/2/07	
Construction Mgmt.							
Construction Coord.							
City Project No.				778781			
				SHEET 1 OF 6			

DRB PROJECT NO. 1004300

**TGC ENGINEERING, INC.** (505)266-7256  
330 LOUISIANA BLVD. NE Fax: (505) 255-2887  
ALBUQUERQUE, NM 87108







# VICINITY MAP (C-18-Z) AND OFFSITE BASIN

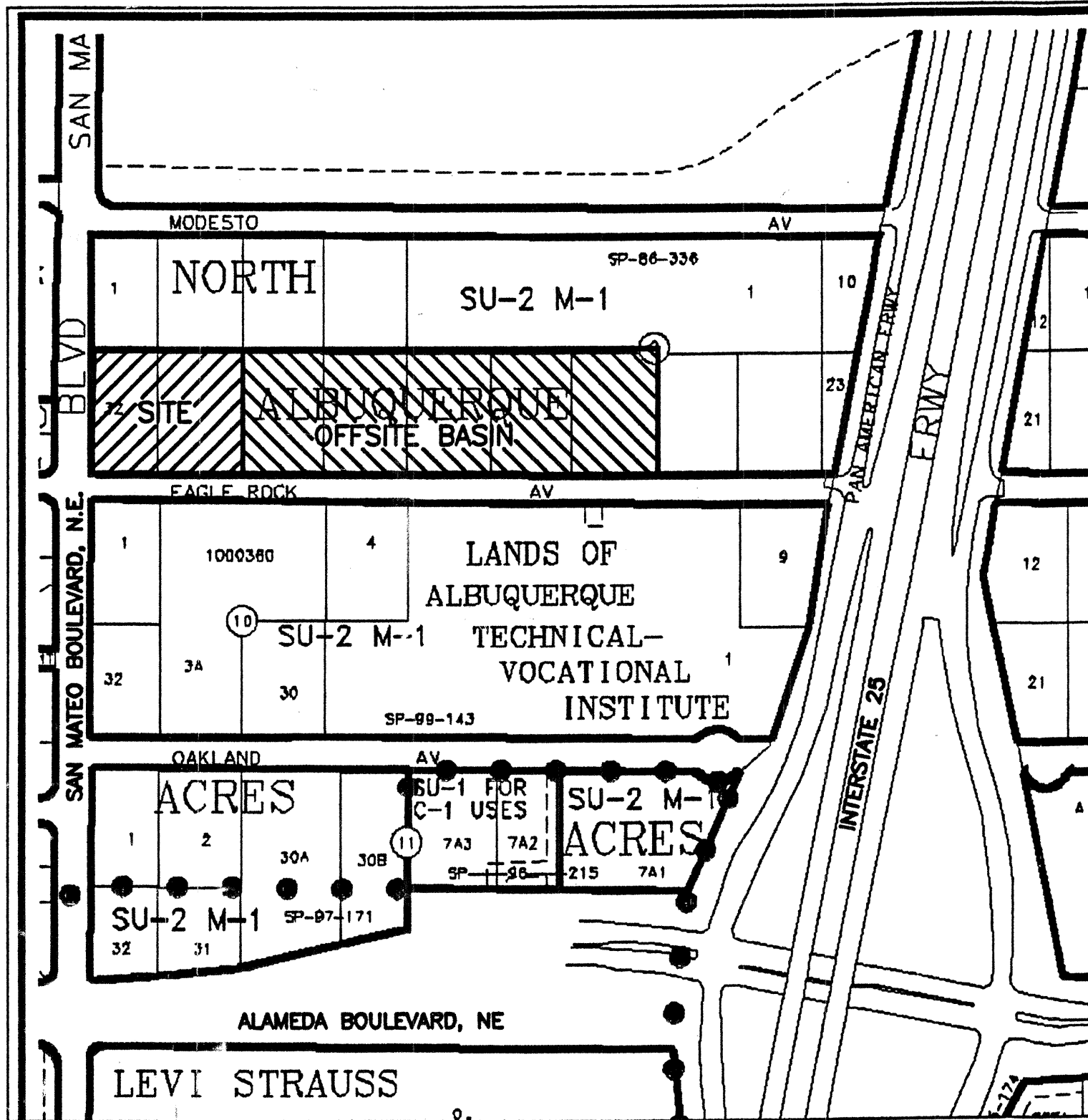

## LEGEND

- WV WATER VALVE
- WM WATER METER
- SMH SANITARY SEWER MANHOLE
- SAS SANITARY SEWER DROP
- W WATER TAP
- IRR IRRIGATION CONTROL VALVE
- TS TRAFFIC SIGNAL / BOX
- PP POWER POLE
- ANCH ANCHOR
- LP LIGHT POLE
- THREE CALIPER NOTED
- SPOT ELEVATION UNLESS OTHERWISE INDICATED, SPOT ELEVATIONS ARE TO ASPHALT SURFACE
- PH FIRE HYDRANT
- EA EDGE OF ASPHALT
- TC TOP OF CURB / CONCRETE
- FL FLOWLINE
- BSW BACK OF SIDEWALK
- CHAIN LINK FENCE
- CONCRETE BLOCK WALL
- RR TIE LANDSC. RETAINER
- OVERHEAD POWER LINE
- EXISTING INDEX CONTOURS @ 5 FT. INTERVALS
- EXISTING CONTOURS @ 1 FT. INTERVALS
- PROPOSED CONTOURS @ 1.0' INTERVALS
- PROPOSED SPOT ELEVATION
- FLOW LINE
- PROPOSED RETAINER
- TC TOP OF CONCRETE
- FL FLOW LINE
- TSW TOP OF SIDEWALK
- RIM RIM OF MANHOLE
- BURIED TELEPHONE LINE

## NOTICE TO CONTRACTOR

PROPOSED CONTOURS AND SPOT ELEVATIONS SHOWN ARE TO FINISH SURFACES AND ARE PROVIDED FOR THE PURPOSE OF SHOWING FLOW ROUTING.

CONTRACTOR IS RESPONSIBLE FOR THE ABATEMENT OF SEDIMENT ONTO ADJOINING PUBLIC RIGHTS-OF-WAY DURING CONSTRUCTION AND FOR THE REMOVAL OF ANY SEDIMENT DEPOSITED IN PUBLIC RIGHT-OF-WAY.

CONTRACTOR SHALL OBTAIN ALL REQUIRED PERMITS PRIOR TO ANY GRADING OR CONSTRUCTION.

SITE IS SUBJECT TO NPDES SWPPP REQUIREMENTS. CONTRACTOR WILL BE RESPONSIBLE FOR ACQUIRING THE NECESSARY PERMITS FROM THE EPA.

ALL IMPROVEMENTS WITHIN CITY OF ALBUQUERQUE RIGHT OF WAY MUST BE CONSTRUCTED BY CITY OF ALBUQUERQUE WORK ORDER.

## BENCH MARK

BENCH MARK IS ACS STA. "10-C17" ACS Aluminum disk epoxied to top of drop inlet, ENE quadrant of Alameda Blvd. & Jefferson Street, NE ELEV. 5179.24 (NAVD 88)

TBM P-K Nail & disk "8686" set in asphalt curbing at SE corner of site ELEV. 5157.89

## DRAINAGE NOTES:

- ROOF DRAINAGE CONVEYED TO NORTH AND SOUTH PARKING LOTS VIA GUTTER AND DOWNSPOUT. SEE ROOF PLAN FOR LOCATIONS.
- ALL ELEVATIONS GIVEN ARE TO TOP OF PROPOSED GRADE
- ALL IMPROVEMENTS IN SAN MATEO BOULEVARD, NE MUST BE CONSTRUCTED BY CITY OF ALBUQUERQUE WORK ORDER.

CONCRETE CENTER CHANNEL  
SEE DETAIL "A"

REMOVE EXISTING CONCRETE ABUTMENT  
INSTALL STANDARD TYPE A GRATE (INLET SIZE 725 sq. in) (DWG. 2201) AND ROUTE OUTFALL PIPE TO EXISTING 42" PIPE VIA 18" REINFORCED CONCRETE PIPE (BY BLDG. PERMIT)  
TRANSITION 18" PIPES TO 42" PIPE AT END OF EXISTING PIPE

## LEGAL DESCRIPTION / FLOOD NOTE

Lots numbered Thirty-one (31) and Thirty-two (32), in Block numbered Nine (9), Tract A, Unit B, NORTH ALBUQUERQUE ACRES, Albuquerque, Bernalillo County, New Mexico, as the same are shown and designated on said plat, filed in the office of the County Clerk of Bernalillo County, New Mexico, on April 24, 1936.

The above described property is located within Zone X, Community Panel No. 350002 0129 E, dated November 19, 2003, and is located within a Special Flood Hazard Boundary indicated by FEMA Flood Insurance Rate Maps. Determination of Flood Hazard is by graphic plotting only.

## DRAINAGE CONCEPT:

THIS SITE CURRENTLY FREE DISCHARGES TO THE CULVERT THAT DRAINS INTO THE SOUTH LA CUEVA CHANNEL. THE PROPOSED DRAINAGE CONCEPT IS TO CONTINUE TO FREE DISCHARGE DRAIN TO THE SOUTH LA CUEVA CHANNEL VIA EXISTING STORM DRAINS LOCATED WITHIN SAN MATEO BOULEVARD, NE. OFFSITE FLOWS WILL BE ACCOMMODATED VIA A SWALE THROUGH THE PARKING LOT. THE ULTIMATE BUILDOUT ON THE OFFSITE CONTRIBUTORY FLOWS WILL CONTRIBUTE A TOTAL OF 27.9 CFS TO THE SUBJECT SITE. THESE FLOWS WILL BE CONTAINED IN A TRIANGULAR CHANNEL WITH 6:1 SIDE SLOPES. DEPTH OF THE CHANNEL WILL BE 0.5 FEET AND TOP WIDTH OF THE CHANNEL AT 100 YEAR FLOOD CONDITIONS WILL BE 10.3 FEET. BOTH THE ONSITE AND OFFSITE FLOWS WILL BE DIRECTED INTO TYPE A INLETS LOCATED AT THE NW CORNER OF THE PROPERTY THAT WILL DRAIN INTO THE EXISTING 42" PIPE IN PLACE.

ORIFICE EQUATION FOR ON-SITE TYPE A INLETS:  $Q = A(C_d)\sqrt{2gh}$   
 $Q = 13.95 \text{ cfs/INLET}$ ;  $A = 725 \text{ sq.in.}$  (5.03 sq.ft.);  $C_d = 0.5$  FOR SILT  
DEPTH OF WATER IN INLET FOR 100-YEAR STORM: 0.47 FEET  
DEPTH OF 18" PIPE AT 100-YEAR STORM CONDITIONS: 0.85 FEET;  
NO BACKWATER CONDITION

WIDTH OF SWALE FLOW AT ONSITE/  
OFFSITE Q100 (35.4 cfs), FULLY  
DEVELOPED CONDITIONS

1:1 SLOPES SHALL BE ARMORED WITH  
4" DIA COBBLES W/UNDERLYING  
GEOTEXTILE FABRIC

## OFFSITE FLOW INFORMATION

OFFSITE CONTRIBUTORY FLOW TO THE PROPERTY IS A BASIN OF APPROXIMATELY 6 ACRES. OFFSITE FLOWS ARE BASED UPON FULLY DEVELOPED CONDITIONS WITH A MAXIMUM 85% IMPERMEABLE SURFACE AND 15% LANDSCAPING. A FLOW INCREASE OF 12.3 CFS IS EXPECTED AT FULLY DEVELOPED CONDITIONS. DRAINAGE SWALE AND DROP INLETS ARE DESIGNED TO FULLY DEVELOPED CONDITIONS OF 27.9 CFS. PER MASTER DRAINAGE PLAN BY JEAN BORDENAVE, APPROVED 2/24/1997, ALLOWABLE DISCHARGE INCREASE IS 1.76 CFS/ACRE. FLOWRATES FALL WITHIN DESIGN PARAMETERS FOR MASTER DRAINAGE PLAN.

DRAINAGE DATA - Offsite flows, Elite Dri-Wall							
THIS SITE LIES WITHIN PRECIPITATION ZONE 3							
Condition	Storm Return Period, Table 4 (Years)	Treatment Type	Treatment Area (sq. ft.)	Excess Precip. Table A-8 (in.)	Peak Runoff Table A-9 (cfs/acre)	Runoff Volume (cu. ft.)	Runoff Rate (cfs)
EXISTING	100	A	0	0.66	1.87	0.0	0.00
		B	261,360	0.92	2.60	20,037.6	15.60
		C	0	1.29	3.45	0.0	0.00
		D	0	2.36	5.02	0.0	0.00
EXISTING	10	A	0	0.19	0.58	0.0	0.00
		B	261,360	0.36	1.19	7,840.8	7.14
		C	0	0.62	2.00	0.0	0.00
		D	0	1.50	3.39	0.0	0.00
DEVELOPED	100	A	0	0.66	1.87	0.0	0.00
		B	39,204	0.92	2.60	3,005.8	2.34
		C	0	1.29	3.45	0.0	0.00
		D	222,156	2.36	5.02	43,690.7	25.60
DEVELOPED	10	A	0	0.19	0.58	0.0	0.00
		B	39,204	0.36	1.19	1,176.1	1.07
		C	0	0.62	2.00	0.0	0.00
		D	222,156	1.50	3.39	27,789.5	17.29
TOTAL (EXT)	100					20,037.6	15.6
	10					7,840.8	7.1
TOTAL (DEV)	100					46,696.3	27.9
	10					28,945.6	18.4

FLOW RATE WILL INCREASE BY 12.3 CFS AND 11.3 CFS FOR THE 100-YEAR AND 10 YEAR STORMS MAY BE EXPECTED. THE 6-HOUR RUNOFF VOLUMES WILL INCREASE BY 26559 CUBIC FEET FOR THE 100-YEAR STORM & 21105 CUBIC FEET FOR THE 10-YEAR STORM.

## DRAINAGE CERTIFICATE

I, Thomas D. Johnston, NMPE 17158, of the firm of TDC ENGINEERING INC. hereby certify that this project has been graded and will drain in substantial compliance with and in accordance with the design intent of the approved plan dated 12-02-05. The record information edited onto the original design document has been obtained by further certify that I have personally visited the project site on November 9, 2005 and have determined by visual inspection that the survey data provided is representative of actual site conditions and is true and correct to the best of my knowledge and belief. This certification is submitted in support of a request for temporary Certificate of Occupancy. The record information presented herein is not necessarily complete and intended only to verify substantial compliance of the grading and drainage aspects of this project. Those relying on this record document are advised to obtain independent verification of its accuracy before using it for any other purpose.

Thomas D. Johnston, NMPE 17158

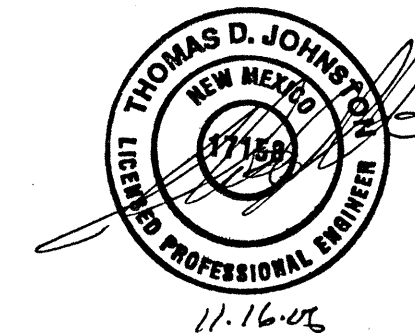

I, THOMAS D. JOHNSTON, NEW MEXICO REGISTERED PROFESSIONAL ENGINEER NO. 17158, DO HEREBY CERTIFY THAT I INSPECTED THIS SITE ON MAY 15, 2005, AND THAT, AS OF THAT DATE, THERE HAD BEEN NO RECENT ALTERATION OF GRADE OR EVIDENCE OF GRADING OPERATIONS ON THIS SITE.

THOMAS D. JOHNSTON, NMPE NO. 17158

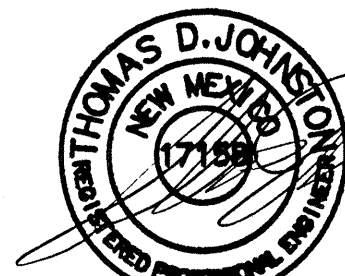

## DRAINAGE AND GRADING PLAN ELITE DRI-WALL

TDC ENGINEERING INC.  
330 LOUISIANA BLVD. NE  
ALBUQUERQUE, NM 87108

(505)266-7256  
Fax: (505) 255-2887

RECORD DRAWING

SHEET 3 OF 6

DETAIL "A"  
CONCRETE CENTER CHANNEL  
NO SCALE

SCALE: 1 INCH = 30 FEET



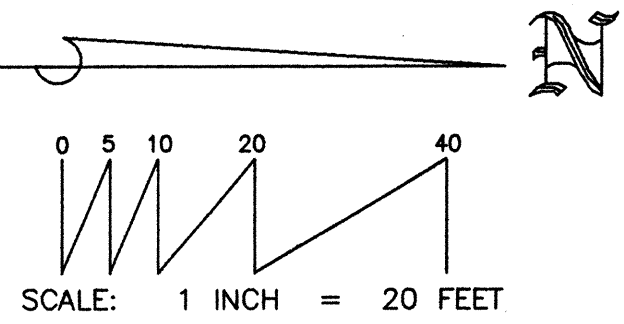
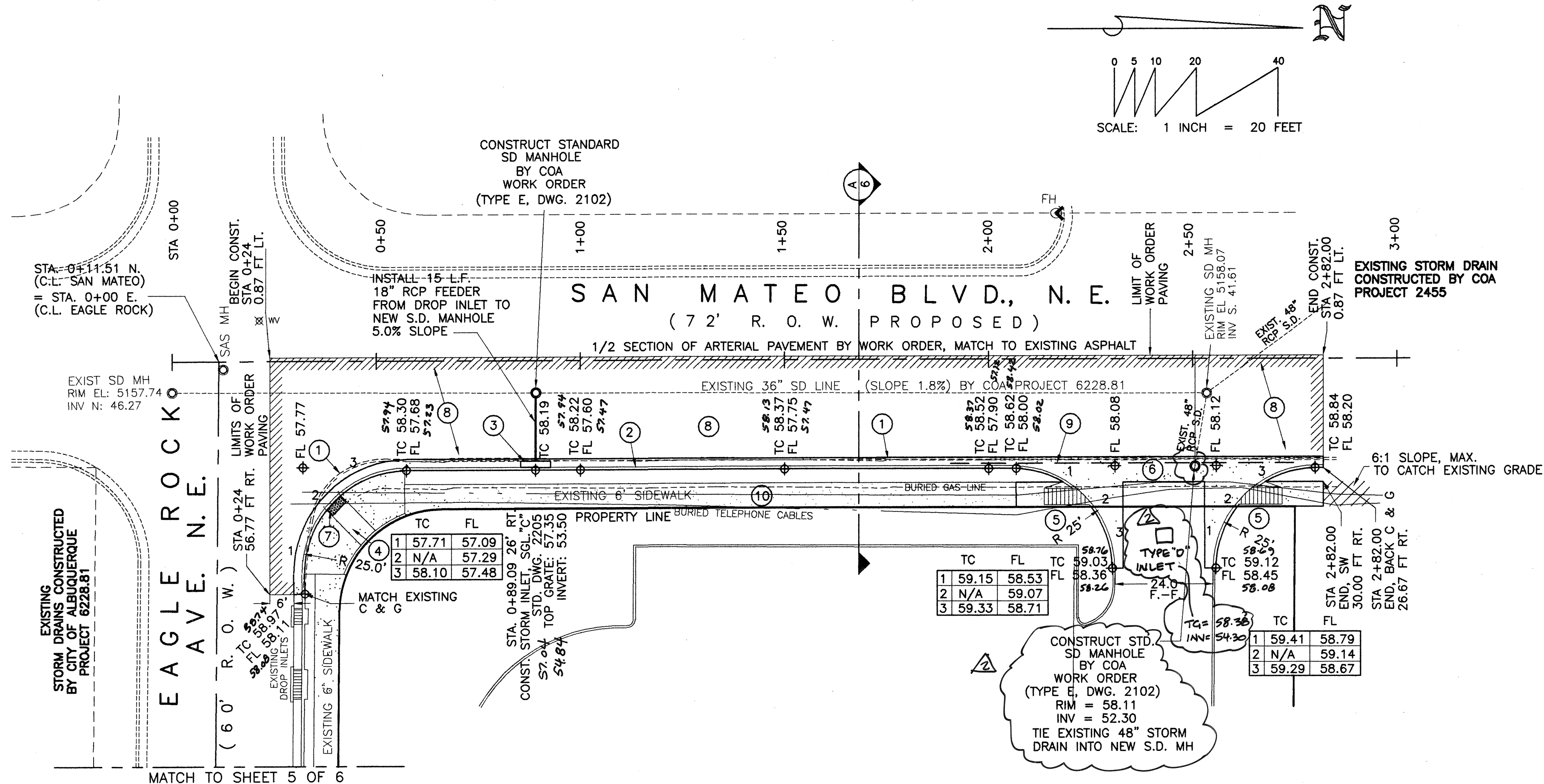

- KEYED NOTES:
- 1 REMOVE EXISTING ASPHALT CURB FROM STA. 0+32.06, 56.65' RT. TO STA. 2+82.00, 24.3' RT
  - 2 PROPOSED LOCATION FOR NEW CURB AND GUTTER SHALL BE CONSTRUCTED PER COA STD DWG 2415A
  - 3 INSTALL STANDARD DROP INLET TYPE "A" BY COA WORK ORDER (DWG. 2201)
  - 4 EXISTING WHEELCHAIR ACCESS RAMP CONSTRUCTED PER COA STD DWG 2441, CASE II ALL HANDICAPPED RAMPS SHALL BE EQUIPPED WITH TRUNCATED DOMES.
  - 5 CONSTRUCT UNIDIRECTIONAL WHEELCHAIR RAMP PER COA STD. DWG. 2426. A MINIMUM 3' WIDE PEDESTRIAN ROUTE MUST BE MAINTAINED ACROSS DRIVEPAD. CROSS SLOPE LIMITED TO 1:50.
  - 6 CONSTRUCT 6' VALLEY GUTTER PER COA STD. DWG. 2420
  - 7 INSTALL 60" X 24" TRUNCATED DOMES DESIGN PER ADA GUIDELINES SUBMIT SPECIFICATIONS TO COA CONSTRUCTION ENGINEER FOR EVALUATION PRIOR TO CONSTRUCTION.
  - 8 CONSTRUCT 1/2 CROWN PAVEMENT SECTION PER COA DWG 2401. SECTION APPEARS ON SHEET 6 OF 6
  - 9 REMOVE & DISPOSE, 84 L.F. STEEL GUARD RAIL
  - 10 EXISTING 6' CONC. SIDEWALK

EXISTING 6' CONCRETE SIDEWALKS AND WHEELCHAIR RAMP CONSTRUCTED UNDER CONCRETE PERMIT APPLICATION NO. 2119870, DATED OCT. 16, 2006.

WHEELCHAIR RAMP TO BE CONSTRUCTED BY WORK ORDER 777 4/24/07

MANHOLE ELIMINATED FROM WORK ORDER AND INFRASTRUCTURE LIST. REPLACED BY TYPE "D" DROP INLET AS SHOWN. TID 7.17.08

I, THOMAS D. JOHNSTON, OF THE FIRM OF TGC ENGINEERING, INC. DO HEREBY CERTIFY TO THE BEST OF MY KNOWLEDGE AND BELIEF, THAT THE INFRASTRUCTURE INSTALLED AS PART OF THIS PROJECT HAS BEEN INSPECTED BY ME AND HAS BEEN CONSTRUCTED IN ACCORDANCE WITH THE PLANS AND SPECIFICATIONS APPROVED BY THE CITY ENGINEER AND THAT THE ORIGINAL DESIGN INTENT OF THE APPROVED PLANS HAS BEEN MET. THIS CERTIFICATION IS BASED ON SITE INSPECTIONS BY ME AND BY SURVEY INFORMATION PROVIDED BY THOMAS D. JOHNSTON, NMP# 14269, AND EDITED ON PAGES 4, 5 AND 6 OF THIS PLANSET.

THOMAS D. JOHNSTON  
REGISTERED PROFESSIONAL ENGINEER  
NEW MEXICO  
17199

RECORD  
DRAWING

TGC ENGINEERING, INC.  
330 LOUISIANA BLVD. NE  
266-7256 FAX 255-2887

CITY OF ALBUQUERQUE  
PUBLIC WORKS DEPARTMENT  
ENGINEERING GROUP

TITLE: ELITE DRY WALL - SAN MATEO BLVD.  
PLAN AND PROFILE

Design Review Committee	City Engineer Approval	Mo./Day/Yr.	Mo./Day/Yr.
APPROVED MAY 02 2007 DESIGN REVIEW COMMITTEE	APPROVED CITY ENGINEER		

City Project No. 778781 Zone Map C-18 Sheet 4 of 6

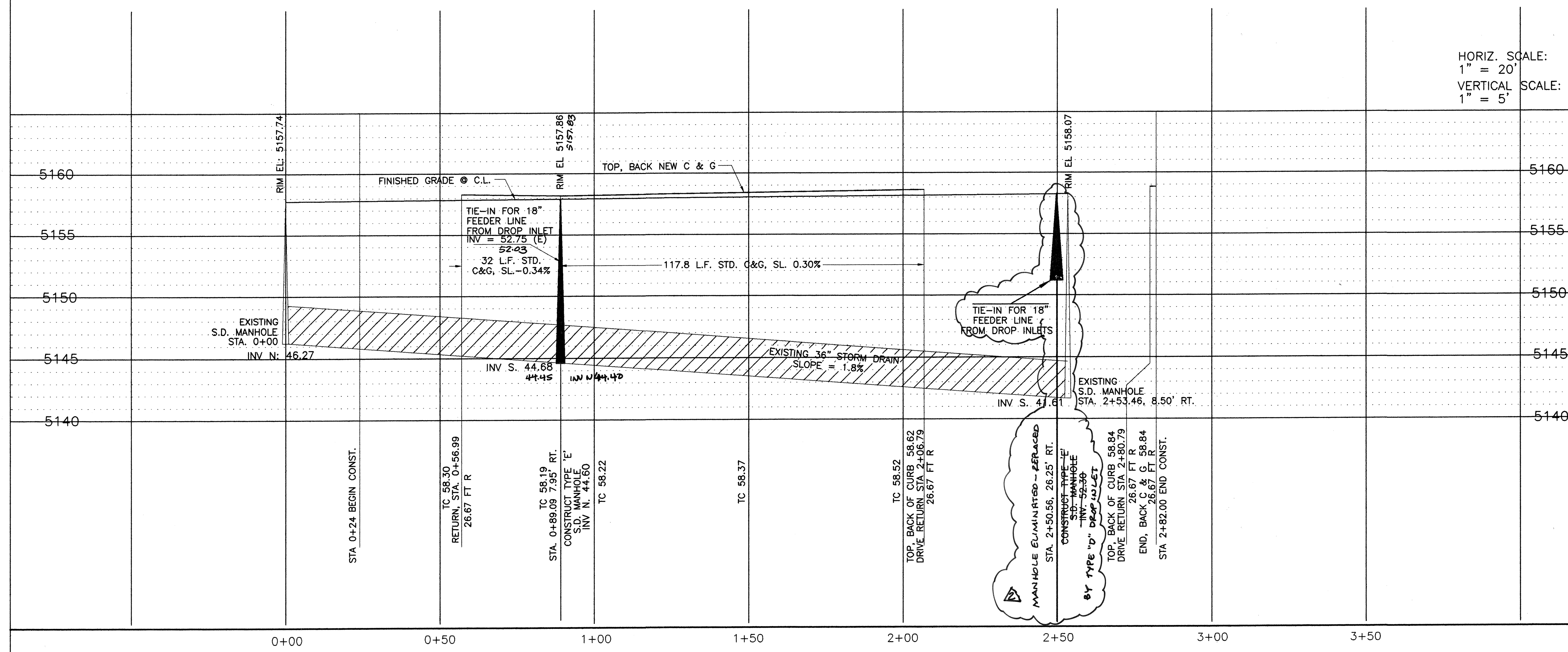



SCANNED BY  
PLANNING

SAN MATEO BLVD. NE

MATCH TO SHEET 4 OF 6

STA. 0+00 E.  
(C.L. EAGLE ROCK)  
= STA. 0+11.51 N  
(C.L. SAN MATEO)

SD MH  
RIM EL: 5157.74  
INV N: 46.27

SD MH

SD MH

EAGLE ROCK AVENUE NE  
(6' R. O. W.)

-REMOVAL AND REPLACEMENT OF  
VALLEY GUTTER AND WHEELCHAIR  
RAMP BY THIS WORK ORDER-

	TC	FL		TC	FL		
62.60	1	62.65	62.00	63.37	1	63.39	62.74
63.08	2	63.10	62.45	63.67	2	63.70	63.05
62.23	3	62.30	61.65	63.07	3	63.10	62.45

SCALE: 1 INCH = 20 FEET

- KEYED NOTES:
- NOT USED THIS SHEET
  - NOT USED THIS SHEET
  - NOT USED THIS SHEET

- EXISTING UNIDIRECTIONAL WHEELCHAIR RAMP PER COA STD. DWG. 2426. A MINIMUM 3' WIDE PEDESTRIAN ROUTE MUST BE MAINTAINED ACROSS DRIVEPAD. CROSS SLOPE LIMITED TO 1:50.
- REMOVE AND REPLACE UNIDIRECTIONAL WHEELCHAIR RAMP TO COMPLY W/ ADA STDS. PER COA STD. DWG. 2426.
- REMOVE AND REPLACE 6' VALLEY GUTTER PER COA STD. DWG. 2420 & FILLETS
- INSTALL TRUNCATED DOMES DESIGN PER ADA GUIDELINES. SUBMIT SPECIFICATIONS TO COA CONSTRUCTION ENGINEER FOR EVALUATION PRIOR TO CONSTRUCTION.
- EXISTING 6' SIDEWALK

EXISTING 6' CONCRETE SIDEWALK, WHEELCHAIR RAMP AND 24" DRIVEPAD CONSTRUCTED UNDER CONCRETE PERMIT APPLICATION NO. 2119870, DATED OCT. 16, 2006.  
WHEELCHAIR RAMP AND DRIVEPAD VALLEY GUTTER TO BE CONSTRUCTED BY WORK ORDER 1430107

HORIZ. SCALE:  
1" = 20'  
VERTICAL SCALE:  
1" = 5'

PROFILE, CENTERLINE NEW SIDEWALK  
PROFILE, BACK OF EXIST. C & G

BEGINNING OF S/W  
CENTERLINE  
STA. 0+44.91  
31.79 FT L

CHANGE DIRECTIONS  
AT CENTERLINE  
STA. 1+55.25  
27.00 FT L  
RETURN TO  
CENTERLINE  
STA. 1+69.84  
27.00 FT L

TOP, BACK OF CURB 61.50  
DRIVE RETURN STA 2+42.90  
21.67 FT L

TOP, BACK OF CURB 61.28  
DRIVE RETURN STA 3+16.90  
21.67 FT L  
STA 3+27.64  
END, SIDEWALK / C & G

RECORD DRAWING

TCO ENGINEERING, INC.

CITY OF ALBUQUERQUE  
PUBLIC WORKS DEPARTMENT  
ENGINEERING GROUP

TITLE: ELITE DRY WALL - EAGLE ROCK AVE  
PLAN AND PROFILE

Design Review Committee  
APPROVE  
MAY 03 2007  
DESIGN REVIEW COMMITTEE

City Engineer Approval  
APPROVE  
MAY 14 2008  
CITY ENGINEER

Last Design Update

City Project No. 778781 Zone Map C-18 Sheet 5 of 6

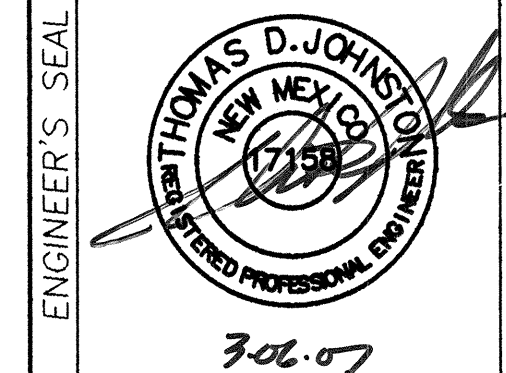

REVISIONS		REMARKS	BY	DATE
NO.	DATE			
1	03-01-07	DESIGN	TJ	03-01-07
2	03-05-07		EWK	03-05-07
3	03-08-07		TJ	03-08-07

AS-BUILT INFORMATION		CONTRACTOR	DATE
WORK ORDER NO.	DATE		
INSPECTOR'S ACCEPTANCE BY:	DATE		
VERIFICATION BY:	DATE		
DRAWINGS CHECKED BY:	DATE		
MICRO-FILM INFORMATION		RECORDED BY:	DATE
RECORDED BY:	DATE		

## CANNED BY PLANNING

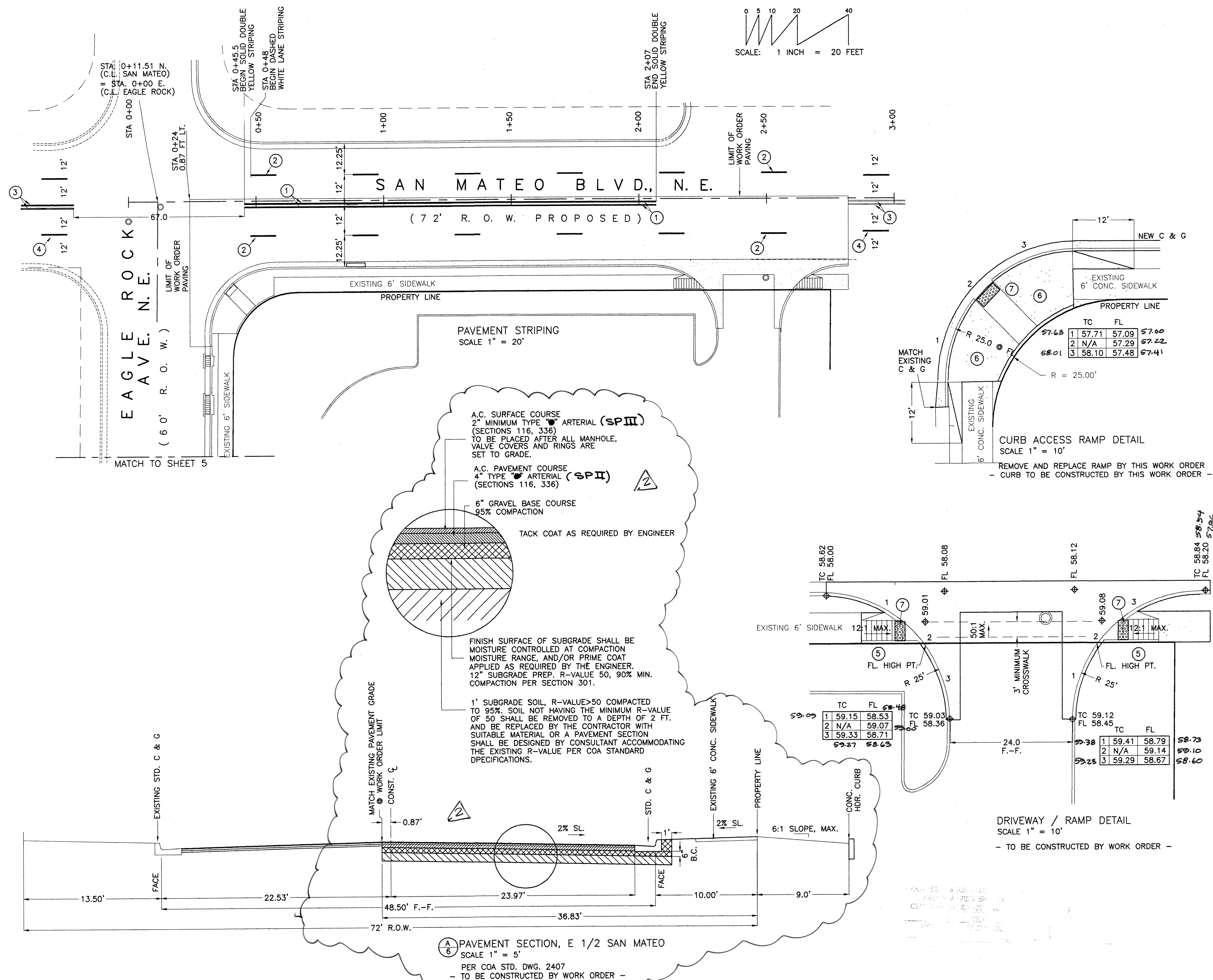

KEYED NOTES:

- ① 161.5 L.F. DOUBLE 4" YELLOW CENTER STRIPING
- ② 4" WHITE LANE STRIPING, 10' STRIPE, 30' SPACING
- ③ EXISTING DOUBLE YELLOW CENTER STRIPING
- ④ EXISTING 4" WHITE LANE STRIPING
- ⑤ CONSTRUCT UNIDIRECTIONAL WHEELCHAIR RAMP PER COA STD. DWG. 2426.  
A MINIMUM 3' WIDE PEDESTRIAN ROUTE MUST BE MAINTAINED ACROSS DRIVEPAD. CROSS SLOPE LIMITED TO 1:50.
- ⑥ REMOVE AND REPLACE WHEELCHAIR ACCESS RAMP PER COA STD DWG 2441, CASE II  
ALL HANDICAPPED RAMPS SHALL BE EQUIPPED WITH TRUNCATED DOMES.
- ⑦ INSTALL TRUNCATED DOMES  
DESIGN PER ADA GUIDELINES  
SUBMIT SPECIFICATIONS TO COA CONSTRUCTION ENGINEER FOR EVALUATION PRIOR TO CONSTRUCTION

EXISTING 6' CONCRETE SIDEWALKS ~~AND~~  
WHEELCHAIR RAMP CONSTRUCTED UNDER CONCRETE  
PERMIT APPLICATION NO. 2119870, DATED OCT. 16,  
2006.

⚠️ WHEELCHAIR RAMP TO BE CONSTRUCTED  
BY WORK ORDER TD 4/30/57

2 REMOVE AND REPLACE ASPHALT  
SECTION HAS BEEN ELIMINATED.  
2" MILL AND OVERLAY OVER  
EXISTING HAS BEEN SUBSTITUTED  
AND APPROVED. TID-7.17.8

ENGINEER'S SEAL		SURVEY INFORMATION		BENCH MARK		AS-BUILT INFORMATION	
		FIELD NOTES					
		NO.	BY	DATE			
						NO. OF MOTOR WORK	
						STAKED BY	
						ACCEPTANCE BY	
						VERIFICATION BY	
						DRAWINGS BY	
						DATE	
						MICRO-FILM INFORMATION	
						RECORDED BY:	
						DATE	

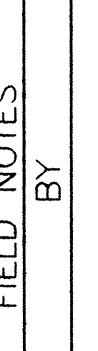

306-7

### REVISIONS

NO.	DATE	REMARKS	BY

### DESIGN

DESIGNED BY:	DATE
<b>TDJ</b>	<b>03-01-07</b>



DRAWN BY:	DATE
<b>EWK</b>	<b>03-05-07</b>

RECORD DRAWING

**TCC ENGINEERING, INC.**  
330 LOUISIANA BLVD. NE  
266-7256 FAX 255-2887

CITY OF ALBUQUERQUE  
PUBLIC WORKS DEPARTMENT  
ENGINEERING GROUP

**TITLE:** ELITE DRY WALL - STRIPING-SAN MATEO BLVD.  
PAVEMENT SECTION, RAMP DETAILS

Design Review Committee		City Engineer Approval			Mo./Day/Yr.	Mo./Day/Yr.
			Last Design Update			

City Project No.	778781	Zone Map	C-18	Sheet	6	Of	6
------------------	--------	----------	------	-------	---	----	---