



ANDALUCIA PARK

City of Albuquerque

Department of Municipal Development - Managing Department

Park Design and Construction Division

Albuquerque, New Mexico

Parks and Recreation Department - Owner

SITE

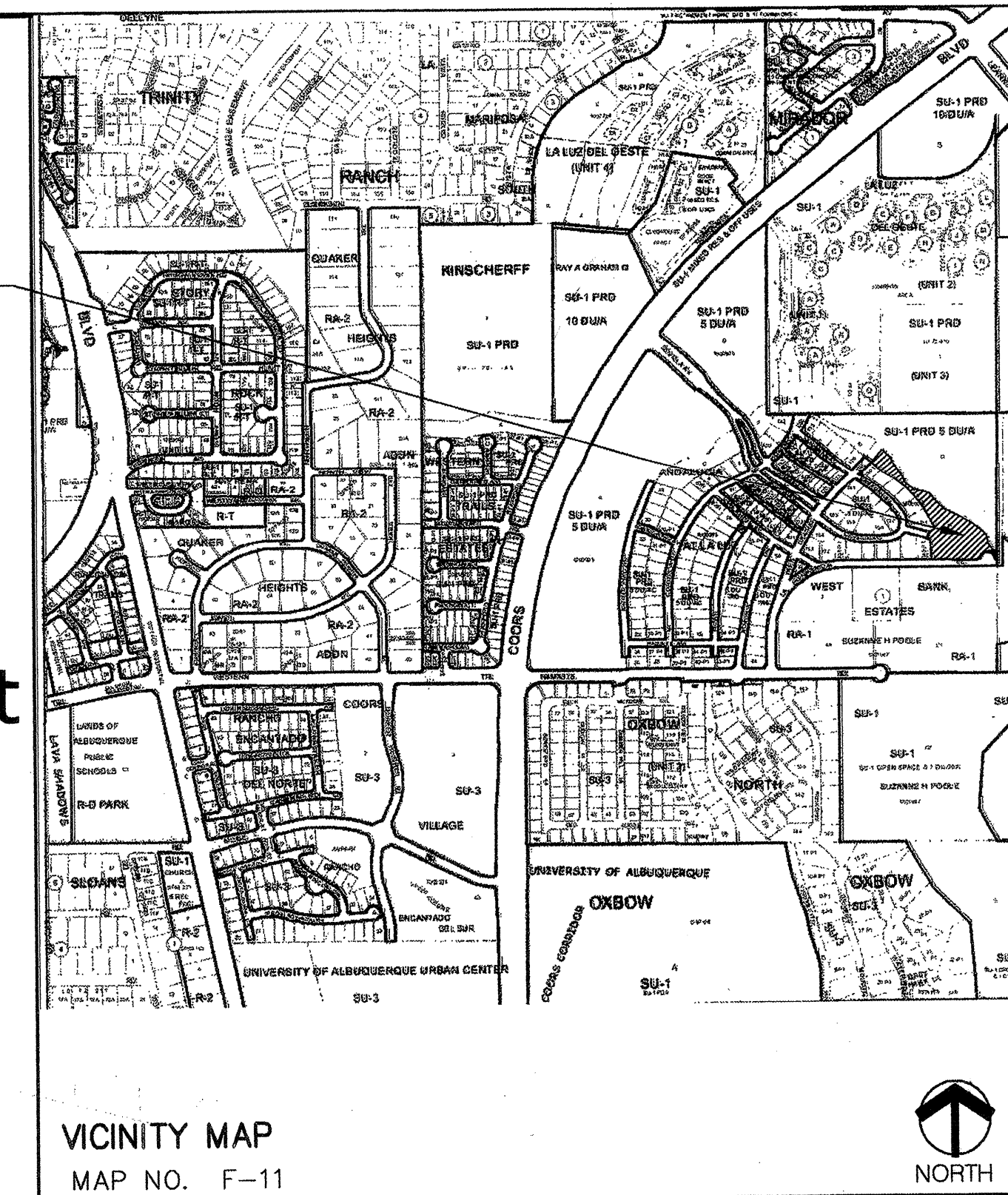

VICINITY MAP
MAP NO. F-11



PROJECT # 779891 / ANDALUCIA PARK / FINAL FOR CONSTRUCTION / DECEMBER 2006

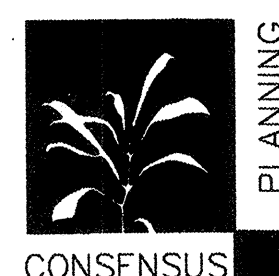

CONSENSUS PLANNING, INC.

PLANNING / LANDSCAPE ARCHITECTURE

302 EIGHTH STREET NW

ALBUQUERQUE, NM 87102

(505) 764-9801

Property Information

Legal Description: Tract H, Lands of Andalucia at La Luz

Meter Address: 5001 $\frac{1}{2}$ Sevilla Avenue

Zoning: SU-1/PRD (5 du/ac)

Total Site Area: 2.6 acres

Total Landscape Area: 87,720 SF (2.01 acres)

Total Native Area: 32,382 SF (0.74 acres)

Total Turf Area: 25,367 SF (0.58 acres)

Parking Provided: 4 Standard, 1 HC space

Consultants

Civil Engineering

Bohannon Huston, Inc.

7500 Jefferson NE, Courtyard 1

Albuquerque, New Mexico 87109

(505) 823-1000

Irrigation

Irrigation Services

2190 Highway 304

Belen, New Mexico 87002

(505) 861-1536

Index of Drawings

- 1 Cover Sheet
- 2 General Notes
- 3 Site Plan
- 4 Grading & Drainage Plan
- 5 Horizontal Control Plan
- 6 Enlarged Plaza/Play Area Plan
- 7 Irrigation Plan
- 8 Planting Plan
- 9 Site Details
- 10 Site Details
- 11 Acceptance Forms

UTILITY COMPANY CONTACTS

PNM-ELECTRIC

4201 Edith Boulevard NE
Albuquerque, New Mexico 87107
(505) 241-0525

PNM-GAS

4625 Edith Boulevard NE
Albuquerque, New Mexico 87107
(505) 241-7745

QWEST

201 Third Street NW, Suite 700
Albuquerque, New Mexico 87103
(505) 245-8706



COMCAST

4611 Montbel Place NE
Albuquerque, NM 87107
(505) 761-6235

CITY OF ALBUQUERQUE UTILITY DEVELOPMENT

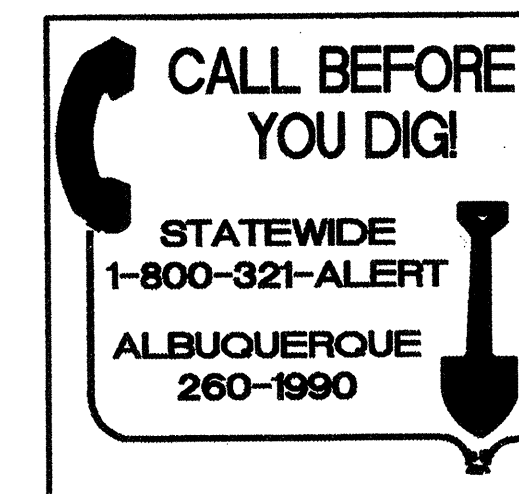
P.O. Box 1293
Albuquerque, New Mexico 87103
(505) 768-2719



REV.	SHEETS	CITY ENGINEER	DATE	USER DEPARTMENT	DATE	USER DEPARTMENT	DATE
ENGINEERS STAMP & SIGNATURE			APPROVED	ENGINEER	DATE		
			DRC Chairman	<i>L. Woodall</i>	9/7/07		
			Transportation	<i>MD</i>	9/3/07		
			Water/Wastewater	<i>William G. Pappas</i>	2/2/07		
			Hydrology	<i>Bradley A. Pappas</i>	1/10/07		
			C I P				
			Constr. Mngmt.			CITY ENGINEER DATE	
			Constr. Coord.				
1-9-07			PROJECT NUMBER		779891		
					SHEET 1 OF 11		

- 1 FIVE (5) WORKING DAYS PRIOR TO BEGINNING CONSTRUCTION, THE CONTRACTOR WILL SUBMIT A DETAILED CONSTRUCTION SCHEDULE TO THE CITY CONSTRUCTION COORDINATION DIVISION. TWO (2) DAYS PRIOR TO CONSTRUCTION, THE CONTRACTOR WILL OBTAIN A BARRICADING PERMIT FROM THE CONSTRUCTION COORDINATION DIVISION. CONTRACTOR SHALL NOTIFY BARRICADE ENGINEER (924-3400) PRIOR TO OCCUPYING AN INTERSECTION. REFER TO SECTION 19 OF SPECIFICATIONS.
- 2 THE CONTRACTOR WILL NOTIFY THE FIELD ENGINEER NOT LESS THAN SEVEN (7) DAYS PRIOR TO STARTING WORK, IN ORDER THAT THE CITY SURVEY SECTION MAY TAKE NECESSARY MEASURES TO INSURE THE PRESERVATION OF SURVEY MONUMENTS. THE CONTRACTOR WILL NOTIFY THE ENGINEER IF A MONUMENT IS DISTURBED. REPLACEMENT WILL BE DONE ONLY BY THE CITY OF ALBUQUERQUE SURVEY SECTION AT THE CONTRACTOR'S EXPENSE. WHEN A CHANGE IS MADE IN THE FINISHED ELEV. OF THE PAVEMENT OF ANY ROADWAY IN WHICH A PERMANENT SURVEY MONUMENT IS LOCATED, CONTRACTOR WILL, AT HIS OWN EXPENSE, HAVE THE CITY SURVEY SECTION ADJUST THE MONUMENT COVER TO THE NEW GRADE UNLESS OTHERWISE SPECIFIED. REFER TO SECTION 4 OF SPECIFICATIONS.
- 3 THE SPECIFICATIONS USED FOR THIS PROJECT ARE THE CITY OF ALBUQUERQUE STANDARD SPECIFICATIONS FOR PUBLIC WORKS CONSTRUCTION, 1994 EDITION, UPDATE NO.7, INCLUDING AMENDMENT #1.
- 4 ALL NEW MANHOLES SHALL BE TYPE "E" (COA DWG. 2102) UNLESS OTHERWISE NOTED ON THE PLANS.
- 5 THE CONTRACTOR WILL BE RESPONSIBLE FOR DISPOSING OF ALL DEBRIS, INCLUDING, BUT NOT LIMITED TO HAZARDOUS WASTE, AT DISPOSAL SITES APPROVED BY GOVERNMENTAL AGENCIES REGULATING THE DISPOSAL OF SUCH MATERIALS.
- 6 ALL WATER VALVE BOXES AND MANHOLES IN THE STREET CONSTRUCTION ARE TO BE ADJUSTED TO FINISH GRADE AND WILL BE MEASURED AND PAID PER EACH.
- 7 SUBGRADE PREPARATION UNDER SIDEWALKS AND DRIVE PADS, AND SUBGRADE AND SUBBASE PREPARATION UNDER CURB AND GUTTER IS CONSIDERED INCIDENTAL TO THE CONSTRUCTION OF SUCH, AND NO DIRECT PAYMENT SHALL BE MADE FOR THOSE ITEMS OF WORK.
- 8 THE CONTRACTOR WILL REPLACE ANY STRIPPING THAT HAS BEEN RUINED OR REMOVED IN THE COURSE OF CONSTRUCTION.
- 9 ALL EXCAVATION WILL BE GOVERNED BY FEDERAL, STATE AND LOCAL LAWS, RULES, AND REGULATIONS CONCERNING CONSTRUCTION SAFETY AND HEALTH.
- 10 ALL SIGNS AND CODING WILL BE IN ACCORDANCE WITH THE "MANUAL OF UNIFORM TRAFFIC CONTROL DEVICES FOR STREETS AND HIGHWAYS" CURRENT EDITION PUBLISHED BY THE U.S. DEPARTMENT OF TRANSPORTATION.
- 11 THE CONTRACTOR IS TO EXERCISE CARE TO AVOID DISTURBING ANY EXISTING UNDERGROUND UTILITIES. IT WILL BE HIS RESPONSIBILITY TO COORDINATE WITH THE UTILITY COMPANIES IN ORDER TO PREVENT ANY SERVICE DISRUPTION. SEE SECTION 18 "UTILITIES", CITY OF ALBUQUERQUE, STANDARD SPECIFICATIONS FOR CONTRACTOR REQUIREMENTS.
- 12 WHEN ABUTTING NEW PAVEMENT TO EXISTING INTERSECTING STREETS, SAW CUT EXISTING PAVEMENT TO A STRAIGHT LINE AND AT RIGHT ANGLES AND REMOVE ANY BROKEN OR CRACKED PAVEMENT. NO DIRECT PAYMENT WILL BE MADE FOR SAW CUTTING.
- 13 ALL GAS VALVES, GAS MANHOLES, ELECTRICAL MANHOLES, TELEPHONE MANHOLES, AND UTILITY POLES WILL BE ADJUSTED TO GRADE BY EACH UTILITY COMPANY. CONTRACTOR WILL COORDINATE THROUGH CITY UTILITY COORDINATOR.
- 14 WHEN REMOVAL OF EXISTING CURB AND GUTTER OR SIDEWALK IS REQUIRED, REMOVE BACK TO NEAREST SUITABLE JOINT UNLESS OTHERWISE DIRECTED BY THE CITY FIELD ENGINEER.
- 15 THE CONTRACTOR WILL NOTIFY THE NEW MEXICO ONE CALL SYSTEM 260-1990 TWO (2) WORKING DAYS PRIOR TO COMMENCING WORK IN NEW AREAS.
- 16 CONTRACTOR WILL MAKE ALL WATER VALVES AND MANHOLES ACCESSIBLE TO THE CITY AT ALL TIMES.
- 17 CONTRACTOR WILL PLACE BITUMINOUS MATERIAL WITH THE USE OF A LAYDOWN MACHINE WHERE PAVEMENT IS 8 FEET IN WIDTH OR WIDER.
- 18 ALL SUBGRADE AND SUBBASE MATERIAL ENCOUNTERED IN PAVEMENT REMOVAL AND REPLACEMENT THAT IS DETERMINED BY THE FIELD ENGINEER TO MEET THE SPECIFICATIONS, CAN BE REUSED. HOWEVER, THE MATERIAL WILL BE PROCESSED AND COMPACTED TO MEET MOISTURE CONTENT AND PERCENT COMPACTION REQUIRED BY THE SPECIFICATIONS.
- 19 CONTRACTOR WILL NOT PAVE OVER ANY SURFACE FEATURE, I.E., GAS VALVE, MANHOLE COVER, ETC. WITHOUT PRIOR APPROVAL FROM THE CITY FIELD ENGINEER.
- 20 CONTRACTOR WILL CONFINE HIS WORK WITHIN THE CONSTRUCTION EASEMENT LIMITS AND/OR RIGHT-OF-WAY, OR PROVIDE COPIES OF AGREEMENTS WITH ADJACENT LANDOWNERS TO THE CITY OF ALBUQUERQUE.
- 21 ALL WATER VALVES AND FIRE HYDRANTS REMOVED TO BE SALVAGED AND RETURNED TO THE C.O.A.
- 22 MINIMUM BOTTOM WIDTH OF TRENCHES FOR RIGID PIPE SHALL BE EQUAL TO THE OUTSIDE DIAMETER PLUS 16 INCHES. BEDDING MATERIAL SHALL BE CLASS II, III, OR IV UNLESS OTHERWISE SPECIFICALLY NOTED ON THE PLANS.
- 23 MINIMUM BOTTOM WIDTH OF TRENCHES FOR NON-RIGID PIPE SHALL BE EQUAL TO THE OUTSIDE DIAMETER PLUS 12 INCHES. BEDDING MATERIAL SHALL BE CLASS I, II, OR III.
- 24 THE CONTRACTOR AGREES TO TAKE NECESSARY SAFETY PRECAUTIONS AS REQUIRED BY FEDERAL, STATE AND LOCAL AUTHORITIES TO PROTECT PEDESTRIAN AND VEHICULAR TRAFFIC IN THE CONSTRUCTION AREA, WHICH INCLUDE BUT ARE NOT LIMITED TO: MAINTAINING ADEQUATE WARNING SIGNS, BARRICADES, LIGHTS, GUARD FENCES, WALKS AND BRIDGES.
- 25 ALL STRUCTURAL CONCRETE WILL BE 3000 PSI UNLESS OTHERWISE NOTED ON PLANS.
- 26 ALL REINFORCING STEEL WILL BE GRADE 60.
- 27 ALL EXPOSED EDGES ON CAST-IN-PLACE CONCRETE STRUCTURES WILL HAVE A 1" CHAMFER UNLESS OTHERWISE NOTED.
- 28 ALL SPLICES IN REINFORCING STEEL TO BE 2-FOOT 6-INCH MINIMUM UNLESS OTHERWISE NOTED.

- 29 PRIOR TO CONSTRUCTION, THE CONTRACTOR WILL EXCAVATE AND VERIFY THE HORIZONTAL AND VERTICAL LOCATIONS OF ALL POTENTIAL CONFLICTING UTILITIES. SHOULD A CONFLICT EXIST BETWEEN THE FIELD INFORMATION AND THE PLANS, THE CONTRACTOR WILL NOTIFY THE FIELD ENGINEER SO THE CONFLICT CAN BE RESOLVED WITH MINIMUM AMOUNT OF DELAY.
- 30 THE REPLACEMENT OF THE EXISTING UTILITIES AND THE INSTALLATION OF NEW UTILITY LINES WILL BE COMPLETED IN ADVANCE OF STARTING THE PAVEMENT WORK. TEMPORARY PAVEMENT WILL BE PLACED IN ALL TRENCHES REQUIRED FOR THE UTILITY REPLACEMENTS IN THOSE AREAS THAT MUST MAINTAIN TRAFFIC UNTIL THE FINAL PAVEMENT WORK STARTS IN EACH AREA. TEMPORARY STRIPING SHALL BE THE CONTRACTOR'S RESPONSIBILITY. MAINTENANCE OF THE TEMPORARY PAVING AND STRIPING WILL BE AT THE CONTRACTOR'S EXPENSE.
- 31 TACK COAT FOR SURFACE COURSE REQUIREMENTS WILL BE DETERMINED BY THE FIELD ENGINEER.
- 32 THE CONTRACTOR WILL CONTACT THE CITY OF ALBUQUERQUE TRAFFIC DIVISION 857-8025, ONE (1) WEEK IN ADVANCE OF ANY CHANGES REQUIRED IN THE TRAFFIC SIGNALIZATION OF THIS PROJECT. ALL WORK ASSOCIATED WITH NEW TRAFFIC SIGNALIZATION SHALL BE THE RESPONSIBILITY OF THE CONTRACTOR.
- 33 ALL NEW STREET PAVING, DRIVEWAYS, SIDEWALKS, AND CURB AND GUTTERS, ABUTTING EXISTING AREAS SHALL MATCH THE ELEVATION OF THOSE AREAS.
- 34 PERMANENT PAVEMENT STRIPING AND MARKINGS WILL BE PLACED BY THE CONTRACTOR. ROAD SHALL NOT BE OPENED TO TRAFFIC UNTIL IT IS STRIPED. ALL STRIPING, PAVEMENT MARKINGS INCLUDING CROSSWALKS, ARROWS AND LINE MARKINGS ARE TO BE CONSTRUCTED OF HOT PLASTIC OR COLD PLASTIC IN ACCORDANCE WITH THE MANUAL OF UNIFORM TRAFFIC CONTROL DEVICES.
- 35 ALL EXCAVATED MATERIAL THAT IS NOT REQUIRED TO BE REUSED MUST BE REMOVED FROM THE PROJECT AREA WITHIN FOUR DAYS OF EXCAVATION. SPOIL PILES WILL BE ALLOWED ONLY AS DIRECTED BY THE CITY FIELD ENGINEER.
- 36 THE CONTRACTOR WILL COORDINATE THE CONSTRUCTION ACTIVITIES WITH ALL OTHER CONTRACTORS AND UTILITY COMPANIES WORKING IN THE SAME AREA. THE CONTRACTOR MAY BE REQUIRED TO RESCHEDULE THEIR ACTIVITIES TO ALLOW UTILITY CREWS TO PERFORM THEIR REQUIRED WORK. NO ADDITIONAL COMPENSATION WILL BE ALLOWED FOR DELAYS OR INCONVENIENCE CAUSED BY UTILITY COMPANY WORK CREWS. A CONTRACT EXTENSION MAY BE ALLOWED AS DELINEATED IN CITY OF ALBUQUERQUE STANDARD SPECIFICATIONS.
- 37 ALL CONSTRUCTION EASEMENTS ON PRIVATE PROPERTY WILL BE OBTAINED BY THE CITY OF ALBUQUERQUE PRIOR TO THE BEGINNING OF CONSTRUCTION.
- 38 EXISTING MEDIAN CURB AND GUTTER AND STANDARD CURB AND GUTTER, NOT DISTURBED BY CONTRACTOR, BUT OUT OF ALIGNMENT, DISPLACED VERTICALLY, BADLY BROKEN AND/OR DETERIORATED, WILL BE REPLACED AS DIRECTED BY THE FIELD ENGINEER AND PAID FOR AT CONTRACT UNIT PRICES.
- 39 ALL TRAFFIC CONTROL DEVICES REQUIRED FOR DRIVEWAY CLOSURES, UTILITY CONSTRUCTIONS OR FOR OTHER REASONS AND NOT SHOWN ON THE SIGNING PLANS WILL BE FURNISHED BY THE CONTRACTOR AND WILL BE PAID AS SPECIFIED IN THE TECHNICAL SPECIFICATIONS AND BID PROPOSAL. PRIOR TO PLACING THE TRAFFIC CONTROL DEVICES, THE CONTRACTOR WILL NOTIFY THE AFFECTED OWNERS IN ACCORDANCE WITH THE SPECIFICATIONS. CONTRACTOR MUST MAKE PROVISIONS TO PROVIDE ACCESS TO PROPERTIES. REFER TO SECTION 19 OF THE SPECIFICATIONS.
- 40 ALL UTILITY LINES WHICH ARE NOT SPECIFICALLY DESIGNATED TO BE REMOVED AND REPLACED ON THE PLANS, WILL BE MAINTAINED IN SERVICE. SHORING, SHEETING AND OTHER MEANS OF SUPPORT SHALL BE EMPLOYED BY THE CONTRACTOR TO PREVENT DAMAGE OR LOSS OF THESE EXISTING UTILITIES AND THESE SHORING, SHEETING, AND SUPPORTS ARE CONSIDERED INCIDENTAL TO THIS PROJECT. BEAM AND CABLE OR OTHER ADEQUATE SUPPORTS WILL BE USED FOR TEMPORARY SUPPORT OF ALL UTILITY LINES WHICH CROSS THE TRENCH. ANY DAMAGE TO EXISTING UTILITIES WILL PROMPTLY BE REPAIRED AT THE CONTRACTOR'S EXPENSE. THE CONTRACTOR WILL NOTIFY THE ENGINEER IMMEDIATELY OF ANY SIGNIFICANT DEVIATION OF EXPOSED UTILITIES FROM THE LOCATIONS SHOWN ON THE PLANS SO THAT CONFLICTS CAN BE RESOLVED IN A TIMELY MANNER.
- 41 THE CONTRACTOR WILL ASSUME RESPONSIBILITY FOR ANY DAMAGE TO EXISTING COA INFRASTRUCTURE (C & G, PAVING, ETC.) DURING CONSTRUCTION, APART FROM THOSE SECTIONS INDICATED FOR REMOVAL ON THE PLANS, AND WILL REPAIR OR REPLACE SAME AT HIS OWN EXPENSE. HE WILL SUITABLY PROTECT THE CURB AND GUTTER FROM INCIDENTAL SPLASHING DURING THE TACK COAT APPLICATION AND WILL BE RESPONSIBLE FOR CLEANING SAME AT HIS OWN COST SHOULD SPLASHING OCCUR.
- 42 ALL INTERFERING PORTIONS OF ABANDONED UTILITY LINES WHICH ARE EXPOSED AS A RESULT OF CONSTRUCTION WILL BE REMOVED AND DISPOSED OF BY THE CONTRACTOR.
- 43 STATIONS OF STORM DRAIN INLETS ARE TO THE CENTER OF GRATE. ALL STORM DRAIN INLETS WILL BE TYPE "A" UNLESS OTHERWISE NOTED ON THE PLANS.
- 44 SHORING COSTS WILL BE CONSIDERED INCIDENTAL TO THE TRENCH AND BACKFILL COSTS.
- 45 THE CONTRACTOR WILL BE RESPONSIBLE FOR SECURING NPDES PERMITS REQUIRED BY APPLICABLE CITY, STATE, AND FEDERAL REGULATIONS.
- 46 ALL STORM DRAIN AND CONNECTOR PIPE WILL BE CLASS IV REINFORCED CONCRETE PIPE UNLESS OTHERWISE NOTED ON THE PLANS.
- 47 THE TERM REMOVE USED IN THIS PLAN SET INCLUDES THE DISPOSAL OF SAID MATERIAL IN ACCORDANCE WITH CITY OF ALBUQUERQUE SPECIFICATIONS, LATEST EDITION.
- 48 CONTRACTOR WILL SURVEY AND LOG EXISTING ELEVATIONS OF CURB-AND-GUTTER, SIDEWALK, AND PAVEMENT WHICH WILL BE REMOVED FOR CONSTRUCTION OF IMPROVEMENTS. CONTRACTOR WILL REPLACE REMOVED CURB-AND-GUTTER, SIDEWALK, DRIVE PADS, AND PAVEMENT TO ELEVATIONS PRIOR TO REMOVAL UNLESS OTHERWISE INDICATED ON THE PLANS.
- 49 CONTRACTOR WILL CONSTRUCT TEMPORARY ASPHALT PAVEMENT AS DIRECTED BY THE FIELD ENGINEER TO PROVIDE ACCESS TO LOCAL BUSINESS, ETC. TEMPORARY PAVEMENT SHALL BE REMOVED AND DISPOSED OF PRIOR TO PLACEMENT OF FULL WIDTH PAVEMENT SECTION. TEMPORARY PAVING SHALL BE PER COA STD. DWG. 2415B AND PAID FOR PER COA STD. SPECIFICATIONS.

- 50 ALL CLASSES OF SEEDING SHALL BE DRY LAND MIX PLACED AT 1.5 LBS/1000 S.F. WITH FERTILIZER 21-12-12 PLACED AT 5 LBS/1000 S.F.
- 51 ALL ASPHALTIC CONCRETE PAVING SHALL CONFORM TO COA STANDARD SPECIFICATIONS.
- 52 ANY WORK OCCURRING WITHIN AN ARTERIAL ROADWAY REQUIRES TWENTY-FOUR (24) HOUR CONSTRUCTION.
- 53 ALL EXCAVATION, TRENCHING AND SHORING ACTIVITIES MUST BE CARRIED-OUT IN ACCORDANCE WITH OSHA 29 CFR 1926.650 SUBPART P.
- 54 THE CONTRACTOR SHALL BE RESPONSIBLE FOR TIMING AND COORDINATION OF WATER SHUTOFF AT LEAST SEVEN (7) WORKING DAYS PRIOR TO CONSTRUCTION. CONTRACTOR SHALL CONTACT THE WATER SYSTEMS DIVISION, 857-8200, TO INITIATE IMPLEMENTATION OF THE NON-PRESSURIZED CONNECTION PLAN.
- 55 FOR STORM DRAIN CONSTRUCTION, RCP PIPE JOINTS SHALL NOT BE GROUTED PRIOR TO FINAL INSPECTION. FINAL INSPECTION WILL DETERMINE JOINTS TO BE GROUTED FOR FINAL ACCEPTANCE OF THE CONSTRUCTION.
- 56 CONTRACTOR SHALL MAINTAIN A GRAFFITI-FREE WORK SITE. CONTRACTOR SHALL PROMPTLY REMOVE ANY AND ALL GRAFFITI FROM EQUIPMENT, WHETHER PERMANENT OR TEMPORARY.
- 57 CONTRACTOR SHALL ERECT TEMPORARY CHAIN LINK CONSTRUCTION FENCE. SUCH FENCE SHALL BE MAINTAINED THROUGHOUT THE DURATION OF THE CONSTRUCTION PERIOD AND REMOVED ONLY UPON FINAL ACCEPTANCE OF THE PROJECT BY THE CITY.
- 58 QUANTITIES PROVIDED ON THE PLANS ARE FOR THE CONTRACTOR'S CONVENIENCE ONLY. PLANS SHALL TAKE PRECEDENCE IN ALL CASES.

EXISTING FEATURES LEGEND:

	EXISTING WOOD POST FENCE
	EXISTING CHAIN-LINK FENCE
	EXISTING GAS LINE W/ VALVE
	EXISTING WATERLINE W/ VALVE
	EXISTING WATERLINE METER
	EXISTING FIRE HYDRANT
	EXISTING SANITARY SEWER LINE W/ MANHOLE
	EXISTING STORM DRAIN
	EXISTING OVERHEAD ELECTRIC W/POLE
	EXISTING UNDERGROUND ELECTRIC
	EXISTING 1' CONTOUR
	EXISTING 5' CONTOUR
	EXISTING CURB & GUTTER
	EXISTING CONCRETE
	EXISTING BUILDING LINE
	EXISTING EASEMENT LINE
	EXISTING SPRINKLER HEAD

NEW FEATURES LEGEND:

	CONSTRUCTION CENTERLINE
	NEW CHAIN-LINK FENCE
	NEW GAS LINE W/ VALVE
	NEW WATERLINE W/ VALVE
	NEW WATERLINE METER
	NEW FIRE HYDRANT
	NEW SANITARY SEWER LINE W/ MANHOLE
	NEW STORM DRAIN W/ MH
	NEW UTILITY POLE
	NEW 1' CONTOUR
	NEW 5' CONTOUR
	NEW CURB & GUTTER
	NEW CONCRETE
	NEW EASEMENT LINE
	POT HOLE LOCATION W/ NO.
	NEW EDGE OF PAVEMENT



CONSENSUS PLANNING, INC.
Planning / Landscape Architecture
302 Eighth Street NW
Albuquerque, NM 87102
(505) 764-9801 Fax 842-5495
e-mail: cp@consensusplanning.com

CITY OF ALBUQUERQUE
DEPARTMENT OF MUNICIPAL DEVELOPMENT
PARK DESIGN AND CONSTRUCTION DIVISION

TITLE: **ANDALUCIA PARK
GENERAL NOTES**

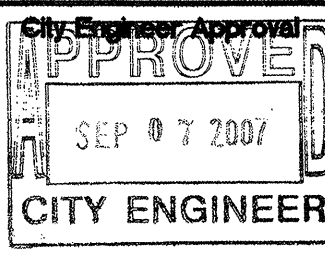

No. / Day / Yr.	No. / Day / Yr.

City Project No.

779891

Zone Map No.
F-11

Sheet

2

Of
11

POINT TABLE			CURVE TABLE				
PNT#	NORTHING	EASTING	CRV#	RADIUS	LENGTH	TANGENT	DELTA
1	1505776.41	367764.54	C1	89.93'	48.22'	24.70'	30°43'08"
2	1505808.44	367729.27	C2	111.07'	85.54'	45.02'	44°07'48"
3	1505890.54	367714.32	C3	111.07'	75.70'	39.38'	39°02'58"
4	1505954.00	367752.85	C4	111.07'	38.88'	19.64'	20°03'25"
5	1505962.77	367765.24	C5	142.22'	185.87'	108.90'	74°52'51"
6	1505976.85	367801.26	C6	101.79'	8.19'	4.10'	04°36'43"
7	1505903.95	367958.07	C7	135.18'	89.81'	46.63'	38°03'56"
8	1505896.37	367961.17	C8	122.13'	47.93'	24.28'	22°29'07"
9	1505881.81	367853.70	C9	92.57'	30.88'	15.59'	19°06'52"
10	1505890.01	367765.91	C10	68.89'	35.88'	18.36'	29°50'28"
11	1505889.71	367718.29	C11	172.71'	63.78'	32.26'	21°09'29"
12	1505891.78	367709.47	C12	143.92'	34.74'	17.45'	13°49'48"
13	1505895.05	367678.90	C13	143.89'	83.85'	43.15'	33°23'12"
14	1505903.09	367644.35	C14	143.89'	83.85'	43.15'	33°23'12"
15	1505950.06	367748.28	C15	264.05'	110.43'	56.04'	23°57'46"
16	1506010.85	367730.22	C16	347.38'	69.51'	34.87'	11°27'54"
17	1506044.84	367723.46	C17	136.18'	78.87'	40.58'	33°11'04"
18	1506060.83	367717.13	C18	88.36'	89.60'	49.08'	58°05'59"
19	1506122.54	367662.12	C19	221.47'	71.39'	36.01'	18°28'01"
20	1506187.41	367573.74	C20	58.83'	80.43'	47.92'	78°19'57"
21	1506232.90	367521.33	C21	26.59'	70.93'	110.11'	152°51'04"
22	1506296.97	367477.24	C22	69.22'	83.46'	47.65'	69°05'03"
23	1506354.59	367413.65	C23	112.19'	65.72'	33.83'	33°33'54"
24	1506390.61	367352.37	C24	68.48'	79.10'	44.63'	66°10'48"
25	1506404.93	367334.08	C25	107.70'	211.81'	161.74'	112°40'56"
26	1505777.56	367829.31	C26	112.33'	79.86'	41.70'	40°44'04"
27	1505851.28	367855.29					
28	1505891.53	367887.72					
29	1505843.43	367949.75					
30	1505795.99	367905.64					
31	1505908.61	367960.11					
32	1505760.35	367859.30					
33	1505803.71	367825.07					
34	1505877.27	367851.61					
35	1505885.78	367857.03					
36	1505935.67	367919.67					

SITE CONTROL NOTES:

1. ALL COORDINATE POINTS & CURVE DATA ARE TO CL OF WALK AND/OR BACK OF CURB UNLESS OTHERWISE NOTED.
2. CONTRACTOR TO CONTACT ENGINEER IMMEDIATELY IF ANY DISCREPANCIES ARE FOUND.

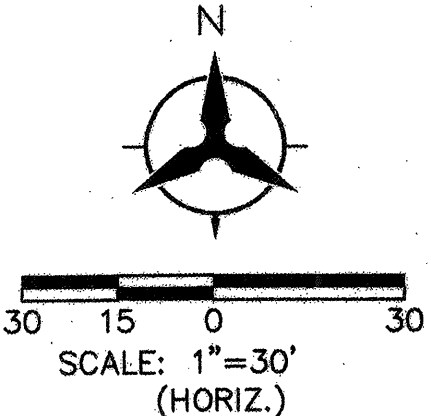

Bohannon & Huston

Courtyard | 7800 Jefferson St. NE Albuquerque, NM 87108-4395
ENGINEERING • SPATIAL DATA • ADVANCED TECHNOLOGIES



CITY OF ALBUQUERQUE
PUBLIC WORKS DEPARTMENT
ENGINEERING DEVELOPMENT GROUP

ANDALUCIA PARK
HORIZONTAL CONTROL PLAN

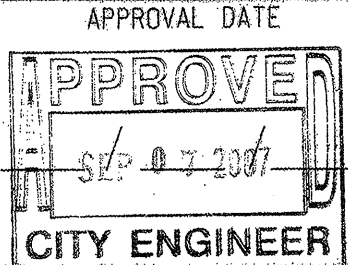

LAST DESIGN UPDATE

CITY PROJECT NO.

779891

ZONE MAP NO.

F-11/F-12

SHEET

OF

5

11

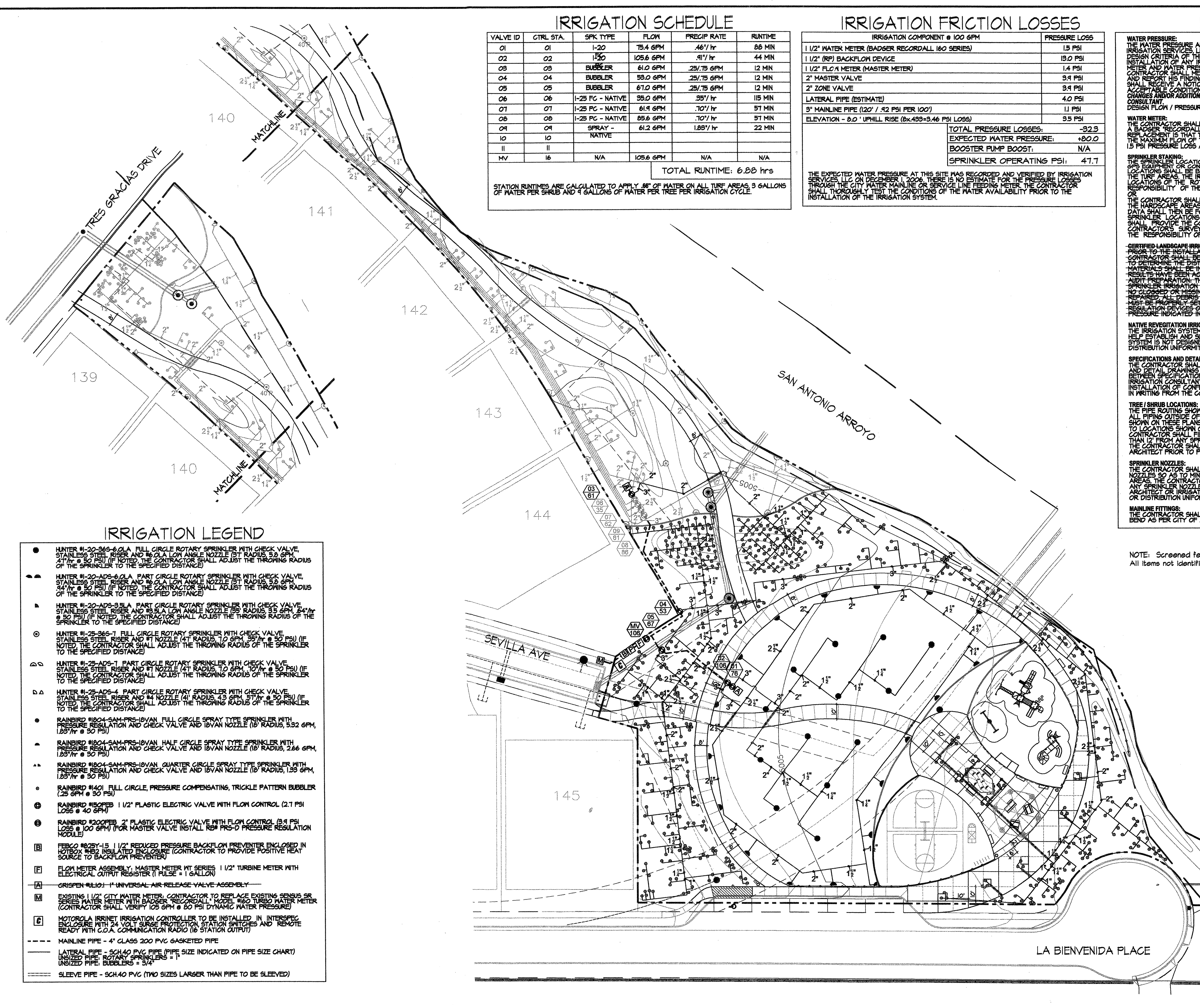

IRRIGATION SCHEDULE

VALVE ID	CTRL STA.	SPK TYPE	FLOW	PRECIP RATE	RUNTIME
01	01	I-20	75.4 GPM	.46"/hr	88 MIN
02	02	I-20	105.6 GPM	.91"/hr	44 MIN
03	03	BUBBLER	61.0 GPM	.25"/75 GPM	12 MIN
04	04	BUBBLER	53.0 GPM	.25"/75 GPM	12 MIN
05	05	BUBBLER	61.0 GPM	.25"/75 GPM	12 MIN
06	06	I-25 FC - NATIVE	35.0 GPM	.35"/hr	115 MIN
07	07	I-25 FC - NATIVE	61.9 GPM	.70"/hr	57 MIN
08	08	I-25 FC - NATIVE	85.6 GPM	.70"/hr	57 MIN
09	09	I-25 FC - NATIVE	85.6 GPM	.70"/hr	57 MIN
10	10	SPRAY - NATIVE	61.2 GPM	1.89"/hr	22 MIN
11	11				
12	12				
13	13				
14	14				
15	15				
16	16				
17	17				
18	18				
19	19				
20	20				
21	21				
22	22				
23	23				
24	24				
25	25				
26	26				
27	27				
28	28				
29	29				
30	30				
31	31				
32	32				
33	33				
34	34				
35	35				
36	36				
37	37				
38	38				
39	39				
40	40				
41	41				
42	42				
43	43				
44	44				
45	45				
46	46				
47	47				
48	48				
49	49				
50	50				
51	51				
52	52				
53	53				
54	54				
55	55				
56	56				
57	57				
58	58				
59	59				
60	60				
61	61				
62	62				
63	63				
64	64				
65	65				
66	66				
67	67				
68	68				
69	69				
70	70				
71	71				
72	72				
73	73				
74	74				
75	75				
76	76				
77	77				
78	78				
79	79				
80	80				
81	81				
82	82				
83	83				
84	84				
85	85				
86	86				
87	87				
88	88				
89	89				
90	90				
91	91				
92	92				
93	93				
94	94				
95	95				
96	96				
97	97				
98	98				
99	99				
100	100				

TOTAL RUNTIME: 6.88 hrs

STATION RUNTIMES ARE CALCULATED TO APPLY .86" OF WATER ON ALL TURF AREAS, 3 GALLONS OF WATER PER SHRUB AND 4 GALLONS OF WATER PER TREE PER IRRIGATION CYCLE.

IRRIGATION FRICTION LOSSES

IRRIGATION COMPONENT @ 100 GPM	PRESSURE LOSS
1 1/2" WATER METER (BADGER RECORDALL 160 SERIES)	1.5 PSI
1 1/2" (RP) BACKFLOW DEVICE	13.0 PSI
1 1/2" FLOW METER (MASTER METER)	1.4 PSI
2" MASTER VALVE	3.9 PSI
2" ZONE VALVE	3.9 PSI
LATERAL PIPE (ESTIMATE)	4.0 PSI
9" MAINLINE PIPE (120' / .92 PSI PER 100')	1.1 PSI
ELEVATION - 8.0' UPHILL RISE (8x.433=3.46 PSI LOSS)	3.5 PSI
TOTAL PRESSURE LOSSES:	-32.3
EXPECTED WATER PRESSURE:	+80.0
BOOSTER PUMP BOOST:	N/A
SPRINKLER OPERATING PSI:	47.7

THE EXPECTED WATER PRESSURE AT THIS SITE WAS RECORDED AND VERIFIED BY IRRIGATION SERVICES, LLC ON DECEMBER 1, 2006. THERE IS NO ESTIMATE FOR THE PRESSURE LOSSES THROUGH THE CITY WATER MAINLINE OR SERVICE LINE FEEDING METER. THE CONTRACTOR SHALL THOROUGHLY TEST THE CONDITIONS OF THE WATER AVAILABILITY PRIOR TO THE INSTALLATION OF THE IRRIGATION SYSTEM.

IRRIGATION NOTES

WATER PRESSURE: THE WATER PRESSURE AT THIS SITE WAS RECORDED AND VERIFIED TO BE 80 PSI BY IRRIGATION SERVICES, LLC ON DECEMBER 1, 2006. THE CONTRACTOR SHALL VERIFY THE DESIGN CRITERIA OF THIS SYSTEM BY COMPLETING A FLOW / PRESSURE TEST PRIOR TO THE INSTALLATION OF ANY IRRIGATION COMPONENTS. THE CONTRACTOR SHALL INSTALL A FLOW METER AND WATER PRESSURE GAUGE ON THE DOWNSTREAM SIDE OF THE WATER METER. THE CONTRACTOR SHALL MEASURE THE DYNAMIC WATER PRESSURE AT THE FLOW METER, AND REPORT HIS FINDINGS IN WRITING TO THE IRRIGATION CONSULTANT. THE CONTRACTOR SHALL RECEIVE A NOTICE TO PROCEED IN WRITING FROM THE IRRIGATION CONSULTANT UPON ACCEPTABLE CONDITIONS. THE CONTRACTOR SHALL ASSUME FULL RESPONSIBILITY FOR ANY DESIGN CHANGES AND/OR ADDITIONAL WORK IF HE DOES NOT POSSESS A NOTICE TO PROCEED FROM THE CONSULTANT.

DESIGN FLOW / PRESSURE CRITERIA: 80 PSI (DYNAMIC) @ 105 GPM

WATER METER: THE CONTRACTOR SHALL REPLACE THE EXISTING 1 1/2" SERIES OR SERIES WATER METER WITH A BADGER RECORDALL 160 SERIES WATER METER. THE CONTRACTOR SHALL VERIFY THE METER REPLACEMENT IS THAT THE EXISTING SERIES WATER METER HAS A 1/4" PRESSURE LOSS AT THE MAXIMUM FLOW OF THE SYSTEM WHILE THE BADGER WATER METER ONLY EXPERIENCES A 1/8" PRESSURE LOSS AT THE SAME FLOW.

SPRINKLER STANDING: THE SPRINKLER LOCATIONS SHALL BE PRECISELY LOCATED BY THE USE OF SURVEY GRADE OR CONVENTIONAL SURVEY SURVEY DATA OF THE HARDSCAPE SURROUNDING THE TURF AREAS. THE IRRIGATION CONSULTANT SHALL GPS SURVEY AND STAKE THE LOCATION OF EACH SPRINKLER. THE CONTRACTOR SHALL BE RESPONSIBLE FOR THE RESPONSIBILITY OF THE CONTRACTOR.

CERTIFIED LANDSCAPE IRRIGATION AUDIT (TURFGRASS): THE CONTRACTOR SHALL HIRE HIS OWN SURVEY FIRM TO PROVIDE AS-BUILT SURVEY DATA OF THE HARDSCAPE AREAS SURROUNDING THE TURF AREAS IN DIGITAL, AUTOCAD FORMAT. THE DATA SHALL THEN BE FORWARDED TO THE IRRIGATION CONSULTANT, WHO WILL ADJUST SPRINKLER LOCATIONS ACCORDINGLY BASED ON THIS DATA. THE IRRIGATION CONSULTANT SHALL PROVIDE THE COORDINATE DATA OF EACH SPRINKLER TO THE CONTRACTOR. THE CONTRACTOR'S SURVEY FIRM TO FIELD LOCATE THE COSTS OF THESE SERVICES SHALL BE THE RESPONSIBILITY OF THE CONTRACTOR.

NATIVE REVEGETATION IRRIGATION: THE IRRIGATION SYSTEM FOR THE NATIVE OR REVEGETATION PLANT MATERIAL IS DESIGNED TO HELP ESTABLISH AND SUPPORT THE PRECIPITATION REQUIREMENTS OF THE PLANTINGS. THIS SYSTEM IS NOT DESIGNED FOR TURFGRASS APPLICATION AND MAY NOT MEET THE MINIMUM DISTRIBUTION UNIFORMITY REQUIREMENTS AS REQUIRED FOR ROTARY SPRINKLER SYSTEMS.

SPECIFICATIONS AND DETAIL DRAWINGS: THE CONTRACTOR SHALL REFER TO THE CITY OF ALBUQUERQUE'S STANDARD SPECIFICATIONS AND DETAIL DRAWINGS FOR IRRIGATION CONSTRUCTION. IN THE EVENT OF A CONFLICT BETWEEN SPECIFICATIONS AND IRRIGATION DESIGN, THE CONTRACTOR SHALL NOTIFY THE IRRIGATION CONSULTANT IN WRITING. THE CONTRACTOR SHALL NOT PROCEED WITH THE INSTALLATION OF CONFLICTING IRRIGATION COMPONENTS UNTIL HE RECEIVES CLARIFICATION IN WRITING FROM THE CONSULTANT.

TREE / SHRUB LOCATIONS: THE PIPE ROUTING SHOWN ON THESE PLANS IS SCHEMATIC. THE CONTRACTOR SHALL INSTALL ALL PIPING OUTSIDE OF THE ROOT ZONE OF TREES OR SHRUBS. THE SPRINKLER LOCATIONS SHOWN ON THESE PLANS ARE FIXED AND MUST BE FIELD LOCATED AS CLOSELY AS POSSIBLE TO LOCATIONS SHOWN ON PLANS TO MEET THE INTENDED DISTRIBUTION UNIFORMITY. THE CONTRACTOR SHALL FIELD ADJUST ANY TREE LOCATIONS THAT ARE SHOWN TO BE CLOSER THAN 12" FROM ANY SPRINKLER HEAD. IF SUBSTANTIAL TREE REARRANGEMENT IS REQUIRED, THE CONTRACTOR SHALL HAVE HIS PROPOSED LOCATIONS APPROVED BY THE LANDSCAPE ARCHITECT PRIOR TO PLANTING.

SPRINKLER NOZZLES: THE CONTRACTOR SHALL ADJUST THE THROWING RADIUS OF ALL PERTINENT SPRINKLER NOZZLES SO AS TO MINIMIZE THE OVERSPRAY ONTO HARDSCAPE OR OTHER UNINTENDED AREAS. THE CONTRACTOR SHALL ALSO INCLUDE IN HIS BID OR PRICING AN ALLOWANCE FOR ANY SPRINKLER NOZZLE CHANGES THAT ARE DEEMED NECESSARY BY THE LANDSCAPE ARCHITECT OR IRRIGATION CONSULTANT TO CORRECT ISSUES OF OVERSPRAY, UNDERSPRAY OR DISTRIBUTION UNIFORMITY.

MAINLINE FITTINGS: THE CONTRACTOR SHALL USE TWO (2) 45 DEGREE ELBOWS FOR EACH 90 DEGREE MAINLINE BEND AS PER CITY OF ALBUQUERQUE'S REQUEST.

NOTE: Screened features are considered to be included in PHASE 2. All items not identified as PHASE 2 are assumed to be constructed in PHASE 1.

IRRIGATION LEGEND

- HUNTER H-20-365-6-OLA FULL CIRCLE ROTARY SPRINKLER WITH CHECK VALVE, STAINLESS STEEL RISER AND 1/2" LOW ANGLE NOZZLE (BT RADIUS 5.0 GPM, 24"/hr @ 50 PSI) (IF NOTED, THE CONTRACTOR SHALL ADJUST THE THROWING RADIUS OF THE SPRINKLER TO THE SPECIFIED DISTANCE)
- HUNTER H-20-AD5-6-OLA PART CIRCLE ROTARY SPRINKLER WITH CHECK VALVE, STAINLESS STEEL RISER AND 1/2" LOW ANGLE NOZZLE (BT RADIUS 5.0 GPM, 24"/hr @ 50 PSI) (IF NOTED, THE CONTRACTOR SHALL ADJUST THE THROWING RADIUS OF THE SPRINKLER TO THE SPECIFIED DISTANCE)
- HUNTER H-20-AD5-3-OLA PART CIRCLE ROTARY SPRINKLER WITH CHECK VALVE, STAINLESS STEEL RISER AND 1/2" LOW ANGLE NOZZLE (BT RADIUS 5.0 GPM, 24"/hr @ 50 PSI) (IF NOTED, THE CONTRACTOR SHALL ADJUST THE THROWING RADIUS OF THE SPRINKLER TO THE SPECIFIED DISTANCE)
- HUNTER H-25-365-7 FULL CIRCLE ROTARY SPRINKLER WITH CHECK VALVE, STAINLESS STEEL RISER AND 1" NOZZLE (4" RADIUS 7.0 GPM, 35"/hr @ 50 PSI) (IF NOTED, THE CONTRACTOR SHALL ADJUST THE THROWING RADIUS OF THE SPRINKLER TO THE SPECIFIED DISTANCE)
- HUNTER H-25-AD5-7 PART CIRCLE ROTARY SPRINKLER WITH CHECK VALVE, STAINLESS STEEL RISER AND 1" NOZZLE (4" RADIUS 7.0 GPM, 35"/hr @ 50 PSI) (IF NOTED, THE CONTRACTOR SHALL ADJUST THE THROWING RADIUS OF THE SPRINKLER TO THE SPECIFIED DISTANCE)
- HUNTER H-25-AD5-4 PART CIRCLE ROTARY SPRINKLER WITH CHECK VALVE, STAINLESS STEEL RISER AND 1" NOZZLE (4" RADIUS 7.0 GPM, 35"/hr @ 50 PSI) (IF NOTED, THE CONTRACTOR SHALL ADJUST THE THROWING RADIUS OF THE SPRINKLER TO THE SPECIFIED DISTANCE)
- RAINBIRD H1804-SAM-PRS-18VAN FULL CIRCLE SPRAY TYPE SPRINKLER WITH PRESSURE REGULATION AND CHECK VALVE AND 18VAN NOZZLE (BT RADIUS 5.32 GPM, 1.89"/hr @ 50 PSI)
- RAINBIRD H1804-SAM-PRS-18VAN HALF CIRCLE SPRAY TYPE SPRINKLER WITH PRESSURE REGULATION AND CHECK VALVE AND 18VAN NOZZLE (BT RADIUS 2.66 GPM, 1.89"/hr @ 50 PSI)
- RAINBIRD H1804-SAM-PRS-18VAN QUARTER CIRCLE SPRAY TYPE SPRINKLER WITH PRESSURE REGULATION AND CHECK VALVE AND 18VAN NOZZLE (BT RADIUS 1.33 GPM, 1.89"/hr @ 50 PSI)
- RAINBIRD H1401 FULL CIRCLE, PRESSURE COMPENSATING, TRICKLE PATTERN BUBBLER (25 GPM @ 50 PSI)
- RAINBIRD H150PEB 1 1/2" PLASTIC ELECTRIC VALVE WITH FLOW CONTROL (2.1 PSI LOSS @ 40 GPM)
- RAINBIRD H200PEB 2" PLASTIC ELECTRIC VALVE WITH FLOW CONTROL (3.9 PSI LOSS @ 100 GPM) (FOR MASTER VALVE INSTALL RB-PRS-D PRESSURE REGULATION MODULE)
- FERRIS H225Y-15 1 1/2" REDUCED PRESSURE BACKFLOW PREVENTER ENCLOSED IN HOTBOX H225 INSULATED ENCLOSURE (CONTRACTOR TO PROVIDE POSITIVE HEAT SOURCE TO BACKFLOW PREVENTER)
- FLOW METER ASSEMBLY: MASTER METER WT SERIES 1 1/2" TURBINE METER WITH ELECTRICAL OUTPUT REGISTER (1 PULSE = 1 GALLON)
- CRISPEX H10101 1" UNIVERSAL AIR RELEASE VALVE ASSEMBLY
- EXISTING 1 1/2" CITY WATER METER. CONTRACTOR TO REPLACE EXISTING SENSUS SR SERIES WATER METER WITH BADGER RECORDALL MODEL #60 TURBO WATER METER (CONTRACTOR SHALL VERIFY 105 GPM @ 80 PSI DYNAMIC WATER PRESSURE)
- MOTOROLA IRRINET IRRIGATION CONTROLLER TO BE INSTALLED IN INTERSPEC ENCLOSURE WITH 24 VOLT SURGE PROTECTION STATION SWITCHES AND REMOTE READY WITH C.O.A. COMMUNICATION RADIO (16 STATION OUTPUT)
- MAINLINE PIPE - 4" CLASS 200 PVC GASKETED PIPE
- LATERAL PIPE - SCH 40 PVC PIPE (PIPE SIZE INDICATED ON PIPE SIZE CHART)
- UNSIZED PIPE: ROTARY SPRINKLERS = 1"
- UNSIZED PIPE: BUBBLERS = 3/4"
- SLEEVE PIPE - SCH 40 PVC (TWO SIZES LARGER THAN PIPE TO BE SLEEVED)

Irrigation Services
IRRIGATION DESIGNERS & CONSULTANTS

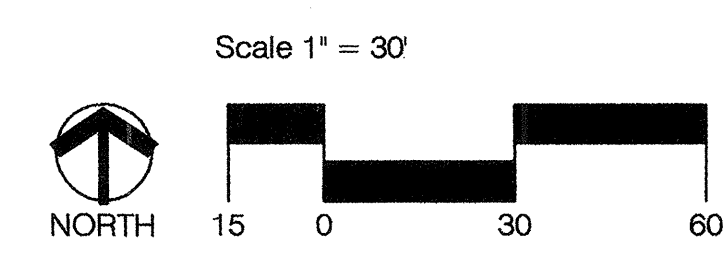

CONSENSUS PLANNING, INC.
Planning / Landscape Architecture
302 Eighth Street NW
Albuquerque, NM 87102
(505) 764-9801 Fax 842-5495
e-mail: cp@consensusplanning.com

CITY OF ALBUQUERQUE
DEPARTMENT OF MUNICIPAL DEVELOPMENT
PARK DESIGN AND CONSTRUCTION DIVISION

TITLE: **ANDALUCIA PARK**
IRRIGATION PLAN

Design Review Committee: **APPROVED**
City Engineer Approval: **APPROVED**
DESIGN REVIEW COMMITTEE: **SEP 07 2007**
CITY ENGINEER: **SEP 07 2007**

City Project No. **779891** Zone Map No. **F-11** Sheet **7** of **11**

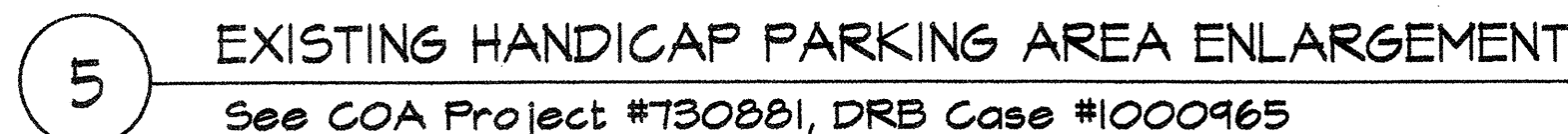
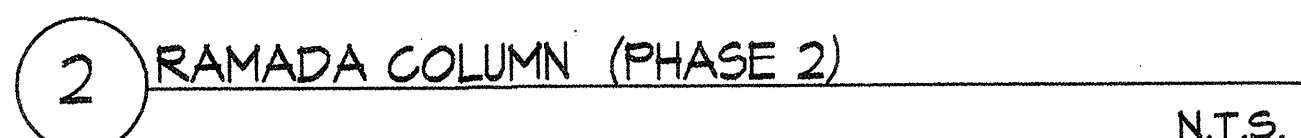
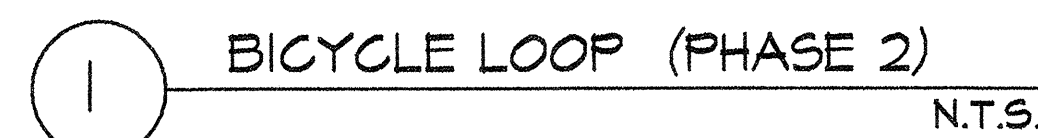

- NOTE:
FENCE SHALL BE PRIMED AND PAINTED FINISH. CONTRACTOR
SHALL PAINT ALL POSTS, RAILS, AND PICKETS WITH TWO
COATS OF SEMI GLOSS ACRYLIC LATEX PAINT. PAINT COLOR:
BLACK.

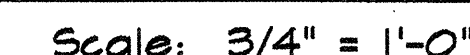
[illegible]

City Project No.	779891	Zone Map No.	E-11	Sheet	9	of	1
------------------	--------	--------------	------	-------	---	----	---

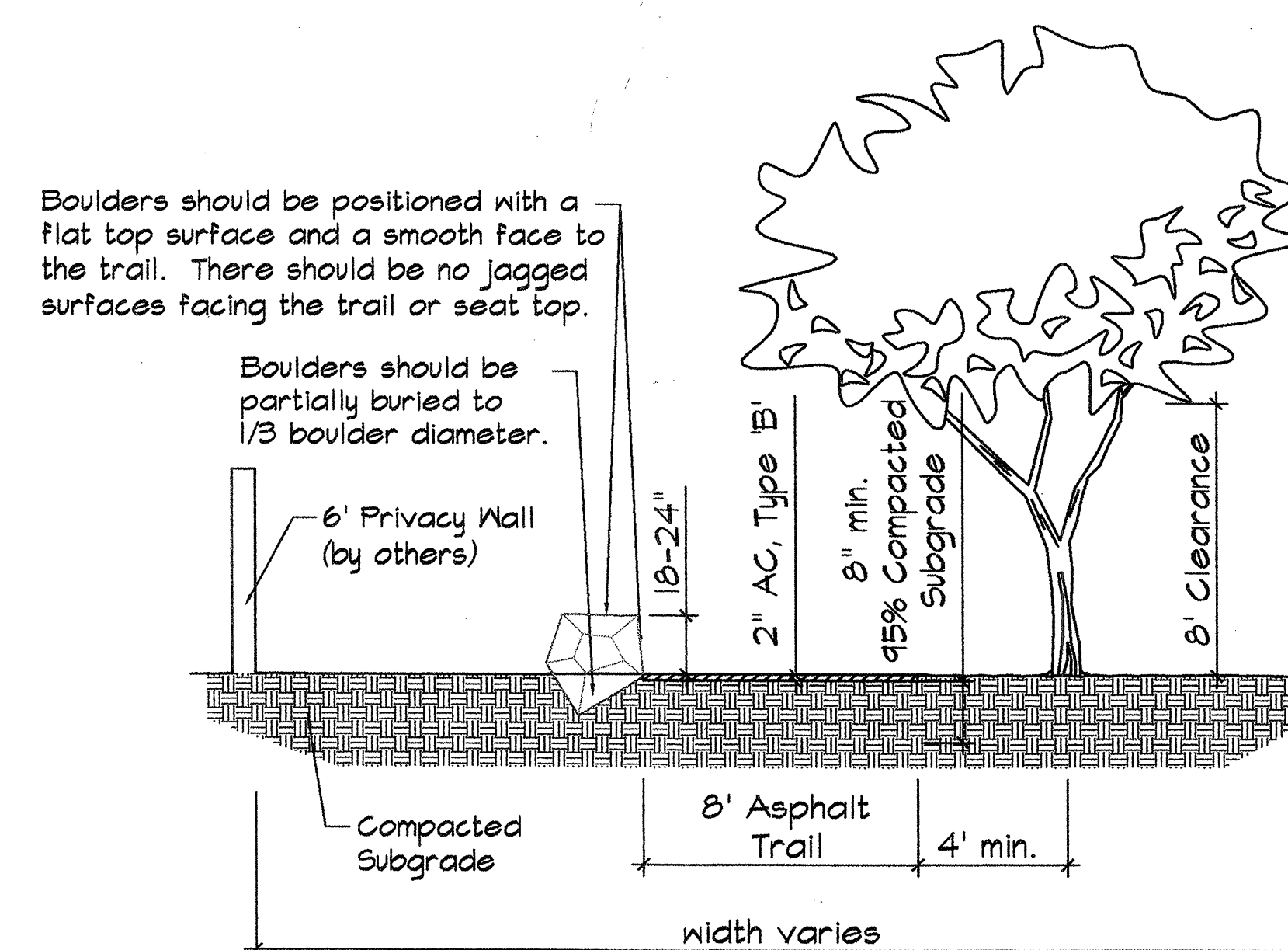
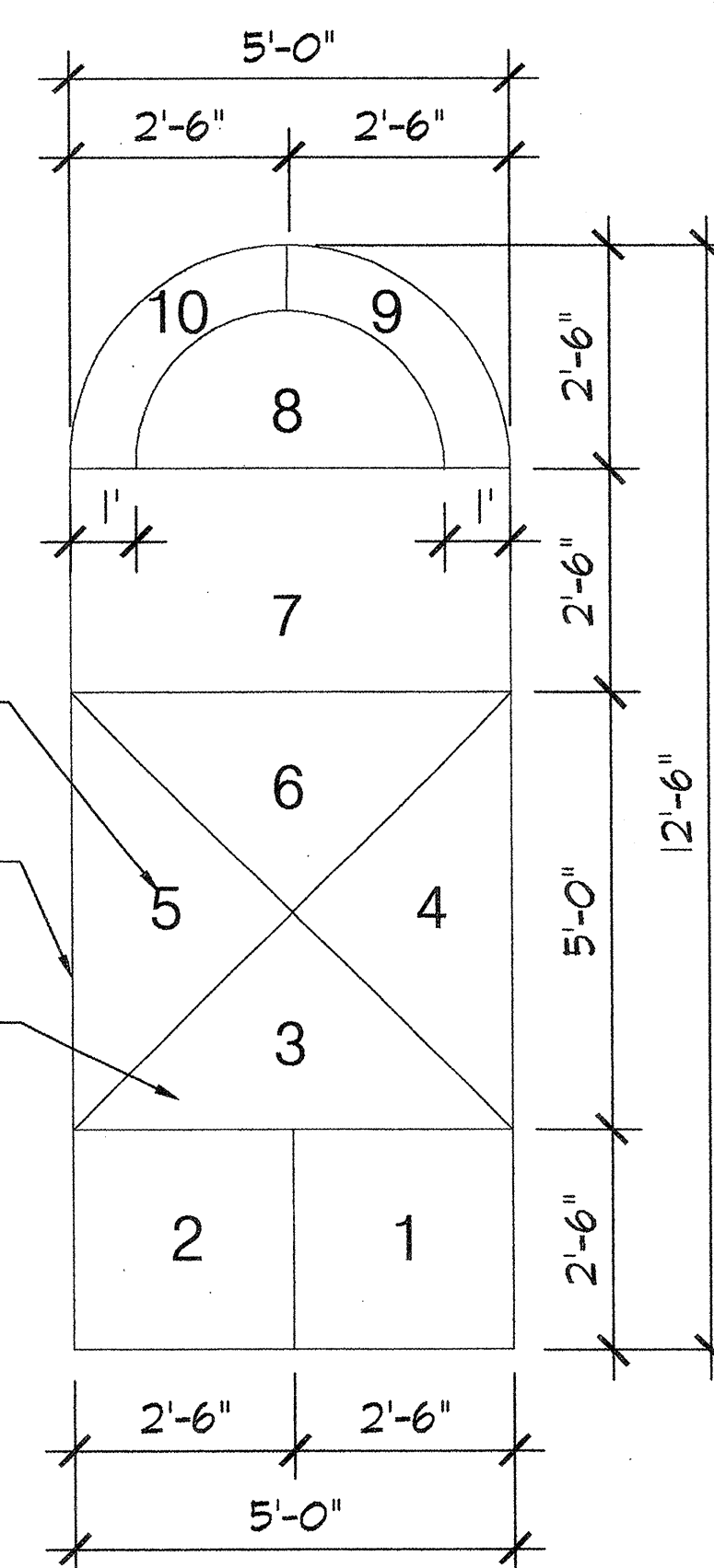
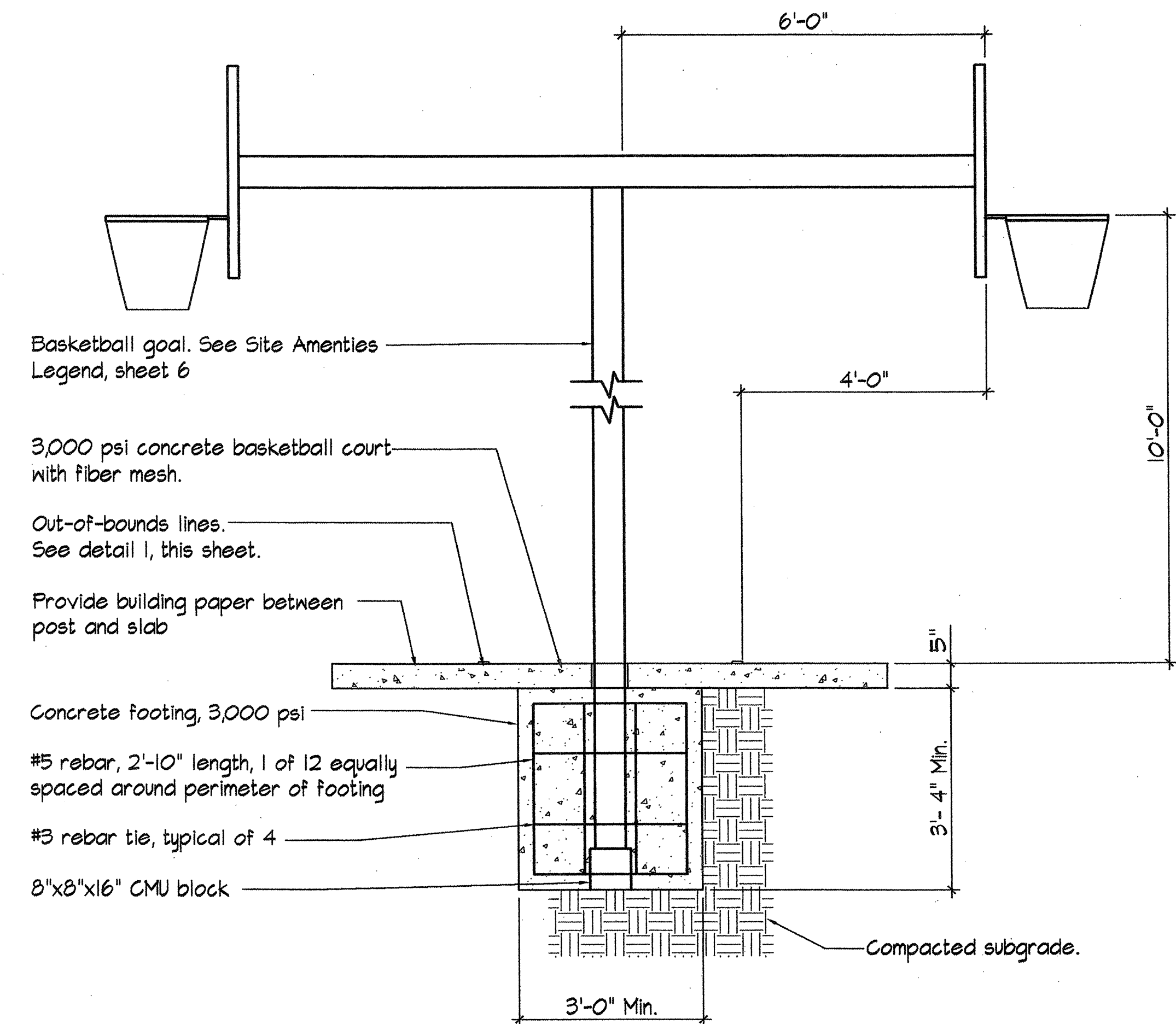
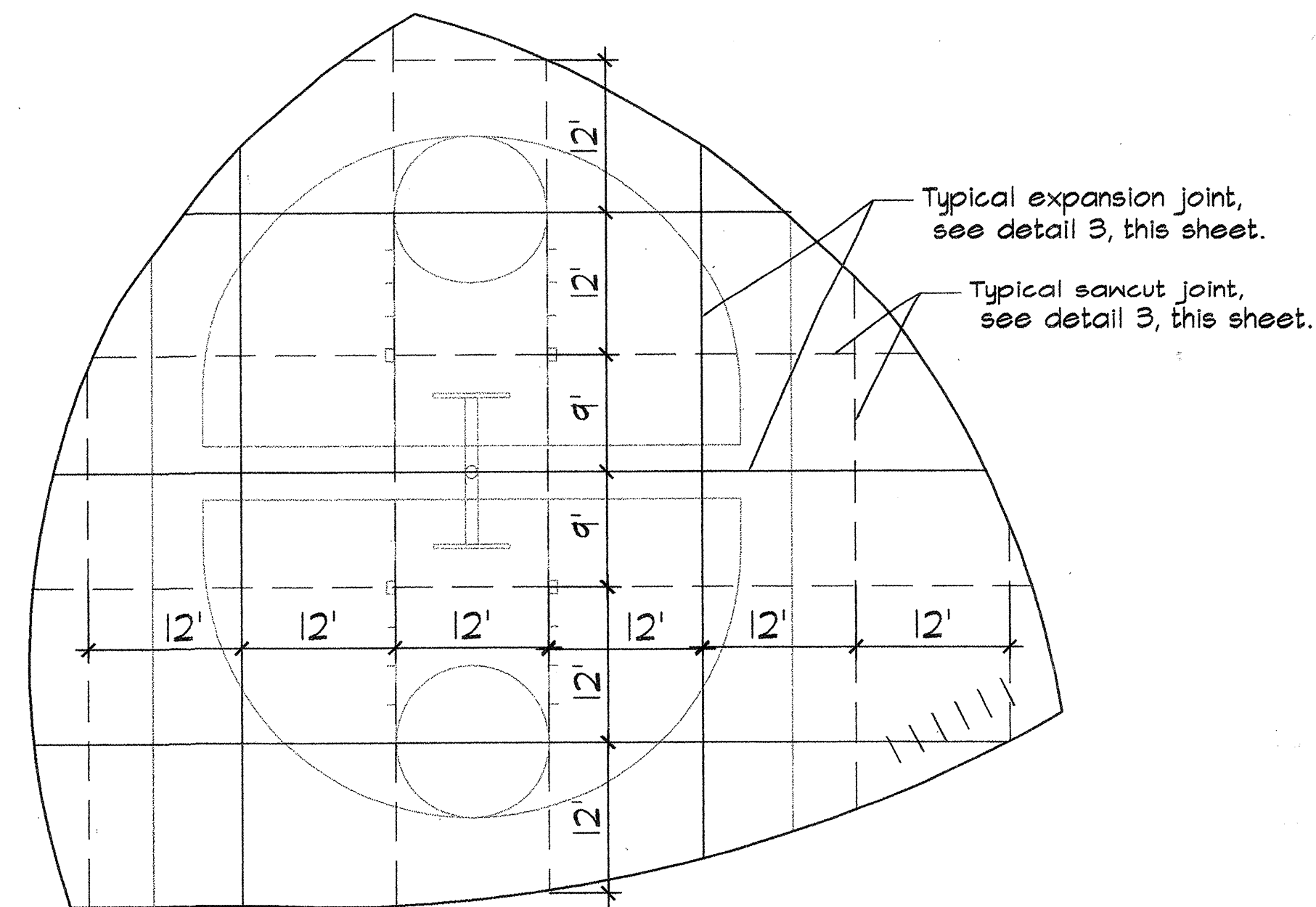
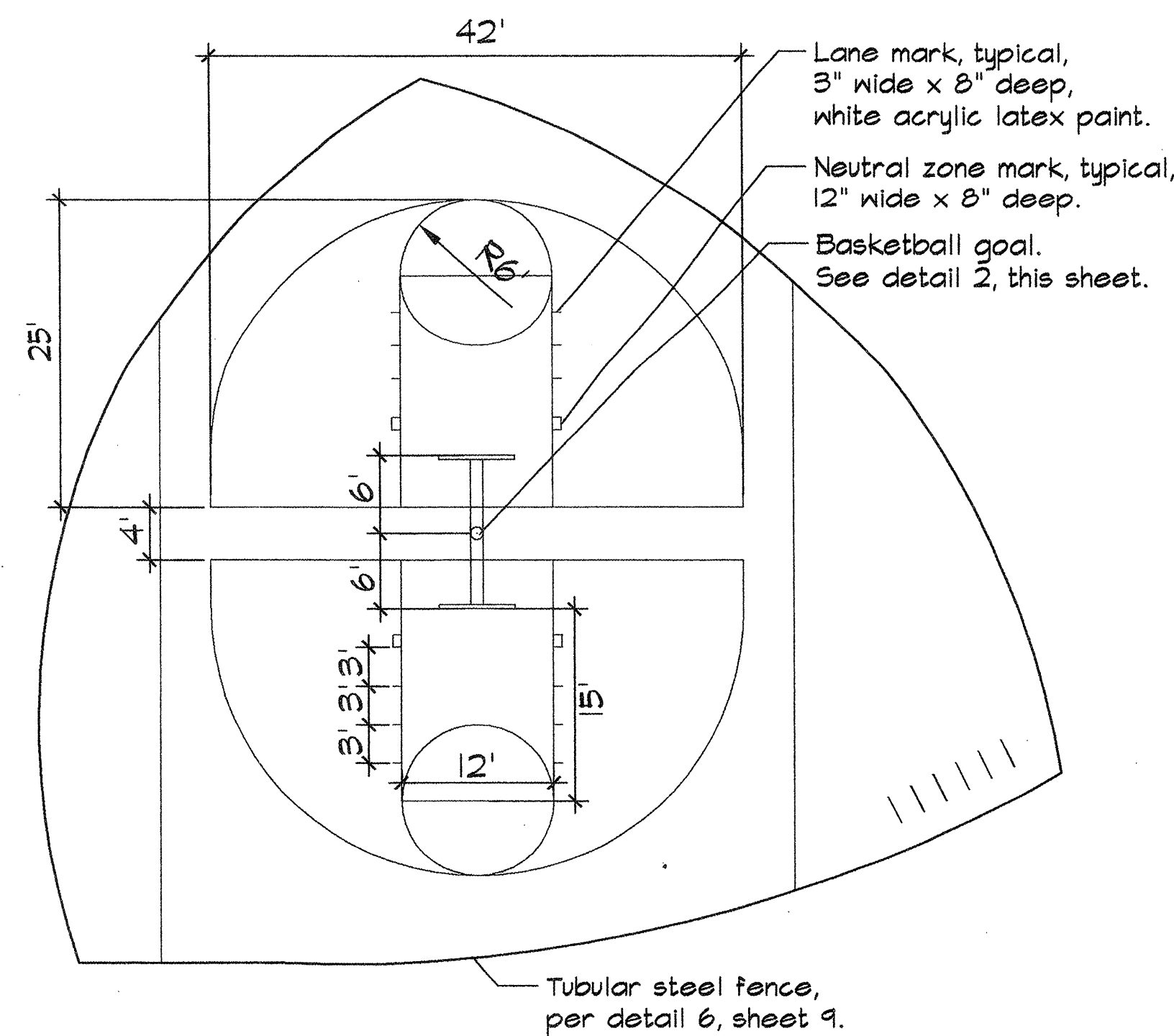

DATE OF DEVELOPMENT ON DIVISION		ENGINEERS SEAL <div style="text-align: center;">  <p>4.19.07</p> </div>		SURVEY INFORMATION FIELD NOTES NO. BY DATE		BENCH MARKS		AS-BUILT INFORMATION CONTRACTOR WORK STARTED BY DATE INSPECTORS BY DATE FIELD JUDGE BY DATE VERIFICATION BY DATE CORRECTED BY DATE MICRO-FILM INFORMATION RECORDED BY DATE NO.	
NO. DATE REMARKS REVISIONS DESIGN		DESIGNED BY CG DATE 10/06 DRAWN BY LF DATE 10/06 CHECKED BY CG DATE 10/06							
Last Design Update		No. / Day / Yr.		No. / Day / Yr.					
No.		Sheet 10 of 11							



City of Albuquerque
Martin J. Chavez, Mayor

Department of Municipal Development
John Castillo, Director

Final Acceptance Form

Date: 10/20/06
To: Dale Sokkary, Superintendent, Park Management, Parks & Recreation Department (PRD)
From: John Casados, Construction Manager, Park Design and Construction, DMD
Subject: PRD, Park Management Division Accepts Maintenance Responsibility

As of (date):
Project ID#: Andalusia Park
Name of Facility: Andalusia Park
Address: 4999 Sevilla Avenue
Albuquerque, NM 87120
Park Zoning: SU-1/PRD

... is officially assigned to the Park Management Division, Parks & Recreation Department, City of Albuquerque for maintenance. Outlined below is a description of work completed:

☐ Developed ☐ Renovation

Detailed Park Summary Information:

Total Park Acreage: 2.6 acres

Acres Developed or Renovated: 0 Acres

Acres of Irrigated Turf: Cool Season: 0.58 Acres

Warm Season:

Description of Project

Construction of children's play area, plaza area (including: shade structure, picnic tables, benches, and litter receptacles), open turf area, and native landscape.

Effective date:

NO MORE CHARGES for new water, electric and gas

...will be accepted by the contractor:

...are to occur against activity numbers:

Water Meter Reading:	Electric Meter Reading:	Gas Meter Reading:
Water Meter Number:	Electric Meter Number:	Gas Meter Number:

Project Name: Andalusia Park

Amenities	Total Existing	# Removed	# Added	Current Total
Backstops	0		0	0
Baseball Fields (Lit)	0		0	0
Basketball Courts (Full)	0		0	0
Basketball Courts (Half)	0		1	1
BBQ Grills	0		0	0
Benches	0		16	16
Bike Racks	0		6	6
Bleachers	0		0	0
Concrete Sidewalks	0 LF		683 LF	683 LF
Crusher Fines/Trail/Distance	0		0	0
Drinking Fountains	0		0	0
Exercise Stations	0		0	0
Fencing (LF/Height)	0 LF of 4'		263 LF of 4'	263 LF of 4'
Horseshoe Courts	0		0	0
Modular Skate Facility	0		0	0
Mutt Mitt Box	0		1	1
Parking Spaces	0		4	4
Parking Spaces (ADA)	0		1	1
Pedestrian Bridge	0		0	0
Picnic Tables	0		5	5
Play Areas	0		1	1
Play Structures (2 to 5 yrs)	0		1	1
Play Structures (5 to 12 yrs)	0		1	1
Pools (Indoor)	0		0	0
Pools (Outdoor)	0		0	0
Recreation Fields	0		1	1
Shade Structures	0		1	1
Skate Facilities	0		0	0
Softball Fields (Lit)	0		0	0
Softball Fields (Unlit)	0		0	0
Tennis Courts (Lit)	0		0	0
Tennis Courts (Unlit)	0		0	0
Trash Receptacles	0		3	3
Turf Acres	0		0.58 AC	0.58 AC
Visitors Center	0		0	0
Volleyball Courts	0		0	0
Walking Paths (LF)	0		638 LF	638 LF
Youth Baseball Fields	0		0	0

Warranty and Vendor Information:

The following is a listing of all labor, vendors and product warranties pertaining to project: Andalusia Park
During the first year all calls regarding warranty information will go to the contractor. After one year calls regarding warranty go directly to the vendor.

Contractor:
Contact Name:
Phone:
Warranty:
One (1) year labor and installation
One (1) year growing season plant material
One (1) year irrigation/material

Vendor: Exemplar
Phone: 505-281-0151
Application:
Product: Dumor: Picnic Tables, Benches, Bike Loops; PW: Basketball Equipment
Model#: 100-66-IPL, 100-60PL, 88-63PL, 83-00-S-1, PW14, PW125, PW41, PW35
For a period of (time frame):
commencing on (starting date):
and ending on (ending date):

Vendor: Exemplar
Phone: 505-281-0151
Application:
Product: Children's Play Equipment
Model#: see Play Equipment List, sheet 6
For a period of (time frame):
commencing on (starting date):
and ending on (ending date):

Vendor: McClintock
Phone: 1-800-350-3588
Application:
Product: Trash Receptacle (surface mount)
Model#: RSO-25
For a period of (time frame):
commencing on (starting date):
and ending on (ending date):

Vendor: Litchfield
Phone: 505-899-6892
Application:
Product: Metal Shade Structure
Model#: 30380P
For a period of (time frame):
commencing on (starting date):
and ending on (ending date):

Vendor:
Phone:
Application:
Product:
Model#:
For a period of (time frame):
commencing on (starting date):
and ending on (ending date):

Other amenities added and/or removed (Please describe, note the number, and specify whether added or removed):

The DMD, Project Manager from Park Design and Construction Division for this Capital Project

Andalusia Park
(project name)

- ☐ John Casados
☒ David Flores
☐ Colleen Frenz
☐ Clay Gatewood
☐ Josie Martinez-Marino
☐ Dorothy Vinson

Email copies to:
jayhart@caba.gov, szuschlag@caba.gov, svoune@caba.gov, sfrenz@caba.gov, rlostrom@caba.gov,
jeffhart@caba.gov, stevesierra@caba.gov, ricknyc@caba.gov, DFlores@caba.gov, emsandoval@caba.gov

		CONSENSUS PLANNING, INC. Planning / Landscape Architecture 302 Eighth Street NW Albuquerque, NM 87102 (505) 764-9801 Fax 842-5495 e-mail: cp@consensusplanning.com	
CITY OF ALBUQUERQUE DEPARTMENT OF MUNICIPAL DEVELOPMENT PARK DESIGN AND CONSTRUCTION DIVISION			
TITLE: ANDALUCIA PARK ACCEPTANCE FORMS			
Design Review Committee 	City Engineer Approval 	Last Design Update	
City Project No. 779891		Zone Map No. F-11	Sheet 11 of 11