

CONSTRUCTION PLANS
FOR
OURAY ROAD
WIDENING IMPROVEMENTS
ALBUQUERQUE, NEW MEXICO

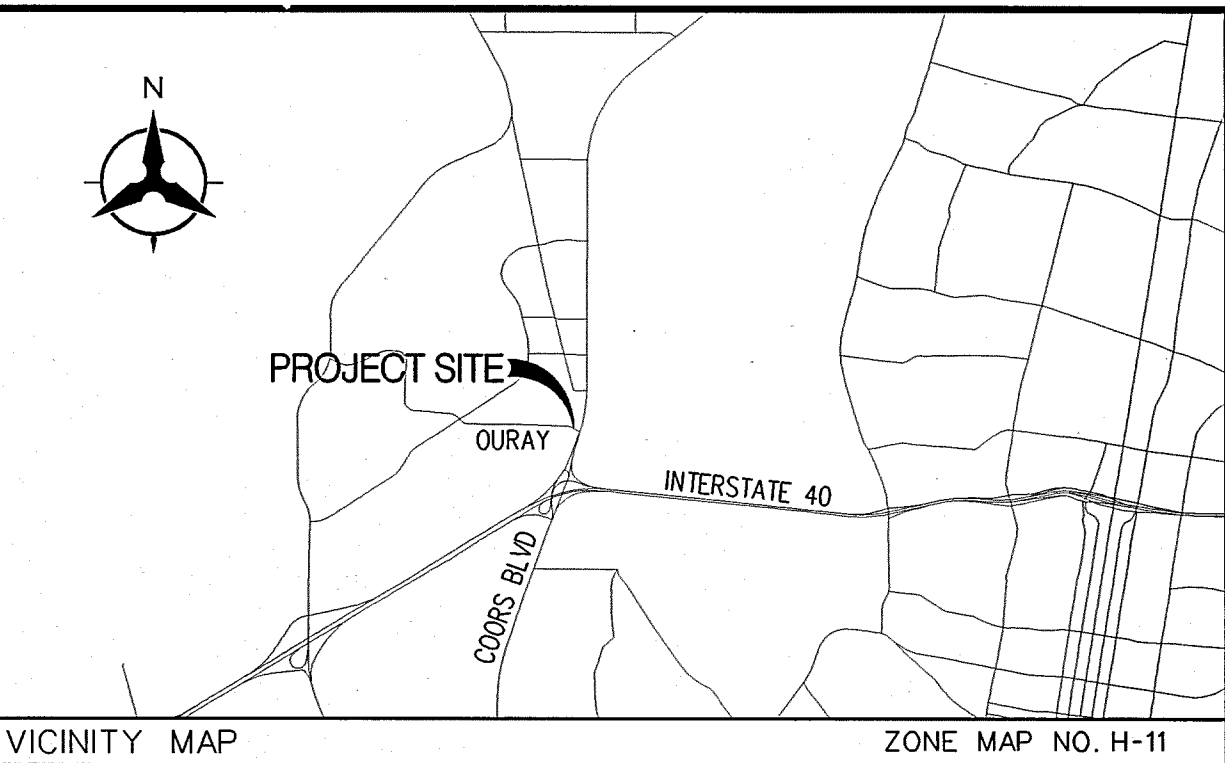

INDEX

SHEET NO.	SHEET TITLE
1	COVER SHEET AND VICINITY MAP
2	GENERAL NOTES
3	PAVING PLAN & PROFILE - BOP TO STA 12+00
4	PAVING PLAN & PROFILE - STA 12+00 TO STA 16+80
5	PAVING PLAN & PROFILE - STA 16+80 TO EOP
6	PAVING TYPICAL SECTIONS
7	PERMANENT SIGNING AND STRIPING PLAN
8	PERMANENT SIGNING AND STRIPING PLAN



NOTICE TO CONTRACTORS

1. AN EXCAVATION/CONSTRUCTION PERMIT WILL BE REQUIRED BEFORE BEGINNING ANY WORK WITHIN THE CITY RIGHT-OF-WAY.
2. ALL WORK DETAILED ON THESE PLANS TO BE PERFORMED UNDER CONTRACT SHALL, EXCEPT AS OTHERWISE STATED OR PROVIDED FOR HEREON, BE CONSTRUCTED IN ACCORDANCE WITH THE CITY OF ALBUQUERQUE STANDARD SPECIFICATIONS FOR PUBLIC WORKS CONSTRUCTION, 1986 EDITION AS REVISED THROUGH UPDATE No.7.
3. TWO WORKING DAYS PRIOR TO ANY EXCAVATION, THE CONTRACTOR MUST CONTACT NEW MEXICO ONE CALL SYSTEM (260-1990) FOR LOCATION OF EXISTING UTILITIES.
4. PRIOR TO CONSTRUCTION, THE CONTRACTOR SHALL EXCAVATE AND VERIFY THE HORIZONTAL AND VERTICAL LOCATIONS OF ALL OBSTRUCTIONS. SHOULD A CONFLICT EXIST, THE CONTRACTOR SHALL NOTIFY THE ENGINEER OR SURVEYOR IMMEDIATELY SO THAT THE CONFLICT CAN BE RESOLVED WITH A MINIMUM AMOUNT OF DELAY.
5. FIVE (5) WORKING DAYS PRIOR TO BEGINNING CONSTRUCTION, THE CONTRACTOR SHALL SUBMIT, TO THE CONSTRUCTION COORDINATION DIVISION, A DETAILED CONSTRUCTION SCHEDULE. TWO (2) WORKING DAYS PRIOR TO CONSTRUCTION, THE CONTRACTOR SHALL OBTAIN A BARRICADE PERMIT FROM THE CONST. COORDINATION DIVISION. CONTRACTOR SHALL NOTIFY CONSTRUCTION COORDINATION ENGINEER (768-2551) PRIOR TO OCCUPYING AN INTERSECTION. REFER TO SECTION 19 OF THE GENERAL CONDITIONS OF THE STANDARD SPECIFICATIONS.
6. ALL WORK AFFECTING ARTERIAL ROADWAYS REQUIRES TWENTY-FOUR HOUR CONSTRUCTION.
7. ALL STREET STRIPING ALTERED OR DESTROYED SHALL BE REPLACED W/ PLASTIC REFLECTORIZED PAVEMENT MARKING BY CONTRACTOR TO THE SAME LOCATION AS EXISTING, OR AS INDICATED BY THIS PLAN SET.
8. CONTRACTOR SHALL NOTIFY THE ENGINEER NOT LESS THAN SEVEN (7) DAYS PRIOR TO STARTING WORK IN ORDER THAT THE CITY SURVEYOR MAY TAKE NECESSARY MEASURES TO INSURE THE PRESERVATION OF SURVEY MONUMENTS. CONTRACTOR SHALL NOT DISTURB PERMANENT SURVEY MONUMENTS WITHOUT THE CONSENT OF THE CITY SURVEYOR AND SHALL NOTIFY THE CITY SURVEYOR AND BEAR THE EXPENSE OF REPLACING ANY THAT MAY BE DISTURBED WITHOUT PERMISSION. REPLACEMENT SHALL BE DONE ONLY BY THE CITY SURVEYOR. WHEN A CHANGE IS MADE IN THE FINISHED ELEVATIONS OF THE PAVEMENT OF ANY ROADWAY IN WHICH A PERMANENT SURVEY MONUMENT IS LOCATED, CONTRACTOR SHALL, AT HIS OWN EXPENSE, ADJUST THE MONUMENT COVER TO THE NEW GRADE UNLESS OTHERWISE SPECIFIED. REFER TO SECTION 4.4 OF THE GENERAL CONDITIONS OF THE STANDARD SPECIFICATIONS.
9. CONTRACTOR SHALL RECORD DATA ON ALL UTILITY LINES AND ACCESSORIES AS REQUIRED BY THE CITY OF ALBUQUERQUE FOR THE PREPARATION OF "AS CONSTRUCTED" DRAWINGS. CONTRACTOR SHALL NOT COVER UTILITY LINES AND ACCESSORIES UNTIL ALL DATA HAS BEEN RECORDED.
10. CONTRACTOR SHALL MAINTAIN A GRAFFITI-FREE WORK SITE. CONTRACTOR SHALL PROMPTLY REMOVE ANY GRAFFITI FROM ALL EQUIPMENT, WHETHER PERMANENT OR TEMPORARY.
11. CONTRACTOR SHALL COORDINATE WITH THE CITY OF ALBUQUERQUE WATER SYSTEMS DIVISION (857-8200) FIVE WORKING DAYS IN ADVANCE OF ANY WORK THAT MAY AFFECT EXISTING PUBLIC WATER OR SEWER UTILITIES. EXISTING VALVES TO BE OPERATED BY CITY PERSONNEL ONLY. CONTRACTOR SHALL CONTACT THE WATER SYSTEMS DIVISION THREE (3) DAYS PRIOR TO NEEDING VALVES TURNED ON OR OFF.

THE FOLLOWING NOTES ALSO APPLY WHEN CHECKED

- ☒ ALL UTILITIES AND UTILITY SERVICE LINES SHALL BE INSTALLED PRIOR TO PAVING.
- ☒ BACKFILL COMPACTION SHALL BE ACCORDING TO SPECIFIED STREET USE.
- ☒ TACK COAT REQUIREMENTS SHALL BE DETERMINED BY THE CITY ENGINEER.
- ☒ SIDEWALKS AND WHEELCHAIR RAMPS WITHIN THE CURB RETURNS SHALL BE CONSTRUCTED WHEREVER A NEW CURB RETURN IS CONSTRUCTED.
- ☒ IF CURB IS DEPRESSED FOR A DRIVEPAD, THE DRIVEPAD SHALL BE CONSTRUCTED PRIOR TO ACCEPTANCE OF CURB AND GUTTER.
- ☒ ALL STORM DRAINAGE FACILITIES SHALL BE COMPLETED PRIOR TO FINAL ACCEPTANCE.
- ☒ THE REQUESTOR OR DEVELOPER SHALL BE RESPONSIBLE FOR REPAIR OR REPLACEMENT OF ALL CURB AND GUTTER OR SIDEWALK DAMAGED AFTER APPROVAL BY THE CITY ENGINEER OF WORK COMPLETED BY THE CONTRACTOR.

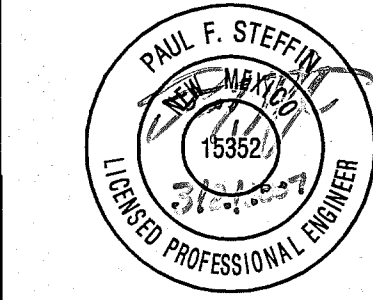

1. THE CONTRACTOR SHALL FIELD VERIFY AND LOCATE ALL EXISTING UTILITY LOCATIONS AND NOTIFY THE ENGINEER IMMEDIATELY OF ANY POTENTIAL CONFLICTS WITH PROPOSED IMPROVEMENTS. ALL ELECTRICAL, TELEPHONE, CABLE TV, GAS AND OTHER UTILITY LINES, CABLES AND APPURTENANCES ENCOUNTERED DURING CONSTRUCTION THAT REQUIRE RELOCATION SHALL BE COORDINATED WITH THAT UTILITY. THE CONTRACTOR SHALL BE RESPONSIBLE FOR COORDINATION OF ALL NECESSARY UTILITY ADJUSTMENTS. NO ADDITIONAL COMPENSATION WILL BE ALLOWED FOR DELAYS OR INCONVENIENCES CAUSED BY UTILITY COMPANY WORK CREWS. THE CONTRACTOR MAY BE REQUIRED TO RESCHEDULE HIS ACTIVITIES TO ALLOW UTILITY CREWS TO PERFORM THEIR REQUIRED WORK. THE CONTRACTOR IS RESPONSIBLE FOR PROTECTING THE EXISTING UTILITY LINES WITHIN THE CONSTRUCTION AREA. ANY DAMAGE TO EXISTING FACILITIES CAUSED BY CONSTRUCTION ACTIVITY SHALL BE REPAIRED OR REPLACED AT THE CONTRACTOR'S EXPENSE AND APPROVED BY THE CONSTRUCTION OBSERVER.
2. DISPOSAL SITE FOR ALL EXCESS EXCAVATION MATERIAL AND UNSUITABLE MATERIAL SHALL BE OBTAINED BY THE CONTRACTOR IN COMPLIANCE WITH APPLICABLE ENVIRONMENTAL REGULATIONS AND APPROVED BY THE CONSTRUCTION OBSERVER. ALL COSTS INCURRED IN OBTAINING A DISPOSAL SITE AND HAUL THERETO SHALL BE CONSIDERED INCIDENTAL TO THE PROJECT AND NO SEPARATE MEASUREMENT OR PAYMENT WILL BE MADE.
3. CONSTRUCTION ACTIVITY SHALL BE LIMITED TO THE PROPERTY AND/OR PROJECT LIMITS. ANY DAMAGE TO ADJACENT PROPERTIES RESULTING FROM THE CONSTRUCTION PROCESS IS THE RESPONSIBILITY OF THE CONTRACTOR. ANY COSTS INCURRED FOR REPAIRS SHALL BE THE COST OF THE CONTRACTOR.
4. OVERNIGHT PARKING OF CONSTRUCTION EQUIPMENT SHALL NOT OBSTRUCT DRIVEWAYS OR DESIGNATED TRAFFIC LANES. THE CONTRACTOR SHALL NOT STORE ANY EQUIPMENT OR MATERIAL WITHIN THE PUBLIC RIGHT-OF-WAY.
5. THE CONTRACTOR SHALL BE RESPONSIBLE TO REPLACE AT HIS EXPENSE ANY AND ALL PROPERTY CORNERS DESTROYED DURING CONSTRUCTION. ALL PROPERTY CORNERS MUST BE RESET BY A REGISTERED LAND SURVEYOR.
6. ALL CURVE DATA AND DIMENSIONS REFER TO FACE OF CURB UNLESS OTHERWISE SPECIFIED.
7. ALL SAW CUT PAVEMENT SHALL HAVE A UNIFORM EDGE AND BE SPRAYED WITH TACK PRIOR TO PLACEMENT OF ADJACENT PAVING.
8. THE CONTRACTOR SHALL ASSUME RESPONSIBILITY FOR ANY DAMAGE TO EXISTING PAVEMENTS, PAVEMENT MARKINGS, CURB & GUTTER, DRIVE PADS, WHEELCHAIR RAMPS, WALLS, AND SIDEWALK DURING CONSTRUCTION, APART FROM THOSE SECTIONS INDICATED FOR REMOVAL ON THE PLANS AND SHALL REPAIR OR REPLACE PER COA STANDARDS AT HIS OWN EXPENSE.
9. WHEELCHAIR RAMPS SHALL BE CONSTRUCTED PRIOR TO ACCEPTANCE OF CURB & GUTTER.
10. ANY ADDITIONAL GRADING REQUIRED TO MATCH PROPOSED STREET GRADES SHALL BE INCIDENTAL TO PAVING ITEMS.
11. WHEN ABUTTING NEW PAVEMENT TO THE EXISTING INTERSECTING STREETS THE EXISTING PAVEMENT SHALL BE SAW CUT PER CITY OF ALBUQUERQUE STANDARD DRAWING 2465 TO A STRAIGHT LINE AT RIGHT ANGLES AND ANY BROKEN OR CRACKED PAVEMENT SHALL BE REMOVED. SAW CUTTING SHALL BE CONSIDERED INCIDENTAL TO PAVING, THEREFORE, NO DIRECT PAYMENT WILL BE MADE FOR SAW CUTTING. A CITY OF ALBUQUERQUE INSPECTOR MUST VERIFY PAVEMENT THICKNESS.
12. THE CONTRACTOR SHALL PROVIDE AND INSTALL ALL REQUIRED STREET SIGNS, WHICH SHALL MEET THE COA INSPECTOR'S APPROVAL. ALL SIGNS AND CODING SHALL BE IN ACCORDANCE WITH THE "MANUAL OF UNIFORM TRAFFIC CONTROL DEVICES FOR STREETS AND HIGHWAYS" CURRENT EDITION PUBLISHED BY THE US DEPARTMENT OF TRANSPORTATION.
13. THE CONTRACTOR SHALL OBTAIN ALL THE NECESSARY PERMITS FOR THE PROJECT PRIOR TO COMMENCING CONSTRUCTION (I.E. BARRICADING, SURFACE DISTURBANCE)
14. THE CONTRACTOR SHALL PROVIDE THE CONSTRUCTION TRAFFIC CONTROL AND SIGNING PLANS. THE CONTRACTOR SHALL COORDINATE WITH THE CITY OF ALBUQUERQUE, TRAFFIC ENGINEERING DEPARTMENT, PRIOR TO BEGINNING ANY CONSTRUCTION WORK ON OR ADJACENT TO EXISTING STREETS.
15. ALL BARRICADES AND CONSTRUCTION SIGNING SHALL CONFORM TO APPLICABLE SECTIONS OF THE "MANUAL OF UNIFORM TRAFFIC CONTROL DEVICES" (MUTCD), U.S. DEPARTMENT OF TRANSPORTATION, LATEST EDITION.
16. THE CONTRACTOR SHALL MAINTAIN ALL CONSTRUCTION BARRICADES AND SIGNING AT ALL TIMES. THE CONTRACTOR SHALL VERIFY THE PROPER LOCATION OF ALL BARRICADING AT THE END AND BEGINNING OF EACH DAY.
17. THE CONTRACTOR SHALL ASSUME RESPONSIBILITY FOR ANY DAMAGE TO EXISTING PAVEMENTS, PAVEMENT MARKINGS, CURB & GUTTER, DRIVE PADS, WHEELCHAIR RAMPS, AND SIDEWALK DURING CONSTRUCTION, APART FROM THOSE SECTIONS INDICATED FOR REMOVAL ON THE PLANS AND SHALL REPAIR OR REPLACE PER COA STANDARDS, AT HIS OWN EXPENSE.
18. ALL EXCAVATION, TRENCHING, AND SHORING ACTIVITIES MUST BE CARRIED OUT IN ACCORDANCE WITH OSHA 29 CFR 1926.650 SUB-PART P.
19. CONTRACTOR SHALL PARK EQUIPMENT AND VEHICLES AS NOT TO INTERFERE WITH NORMAL ACTIVITIES OF PROPERTY OWNERS OR OTHER CONTRACTORS ON SITE.
20. THE CONTRACTOR WILL BE RESPONSIBLE FOR PROVIDING AND MAINTAINING ALL SIGNING UNTIL THE PROJECT HAS BEEN ACCEPTED BY THE CITY.
21. SECTION 2800 OF THE CITY OF ALBUQUERQUE STANDARD DRAWINGS SHALL BE USED TO DEVELOP TRAFFIC CONTROL PLANS FOR THIS PROJECT.

<p>ELECTRIC PNM ELECTRIC SERVICES (DISTRIBUTION) ALBUQUERQUE, NM PHONE: 241-3606 CONTACT: Roland Blauwkamp</p>	<p>TELEPHONE QWEST COMMUNICATIONS ALBUQUERQUE, NM PHONE: 245-8352 CONTACT: Michael Velarde</p>	<p>NATURAL GAS PNM GAS SERVICES ALBUQUERQUE, NM PHONE: 241-7752 CONTACT: Kelley Bouska</p>
<p>CABLE TV COMCAST CABLE COMMUNICATIONS ALBUQUERQUE, NM PHONE: 761-6252 CONTACT: Mike Mortus</p>	<p>AT&T ALBUQUERQUE, NM PHONE: 842-2911 CONTACT: David Crowel</p>	<p>CITY OF ALBUQUERQUE SENIOR ENGINEER ALBUQUERQUE, NM PHONE: 768-2729 CONTACT: Nancy Musinski</p>

Bohannon							Huston					
Court yard 7500 Jefferson St NE						Albuquerque, NM 87109-4335						
ENGINEERING ▲ SPATIAL DATA ▲ ADVANCED TECHNOLOGIES												
						NO.		DATE		DESIGNED BY		
										DRAWN BY		
										CHECKED BY		

CITY OF ALBUQUERQUE

DEPARTMENT OF MUNICIPAL DEVELOPMENT

OURAY ROAD WIDENING IMPROVEMENTS

GENERAL NOTES

DESIGN REVIEW COMMITTEE	CITY ENGINEER APPROVAL		MO./DAY/YR.	MO./DAY/YR.
		LAST DESIGN UPDATE		

CITY PROJECT NO.
7802.92

ZONE MAP NO.
H-11-Z

SHEET
2

OF
8

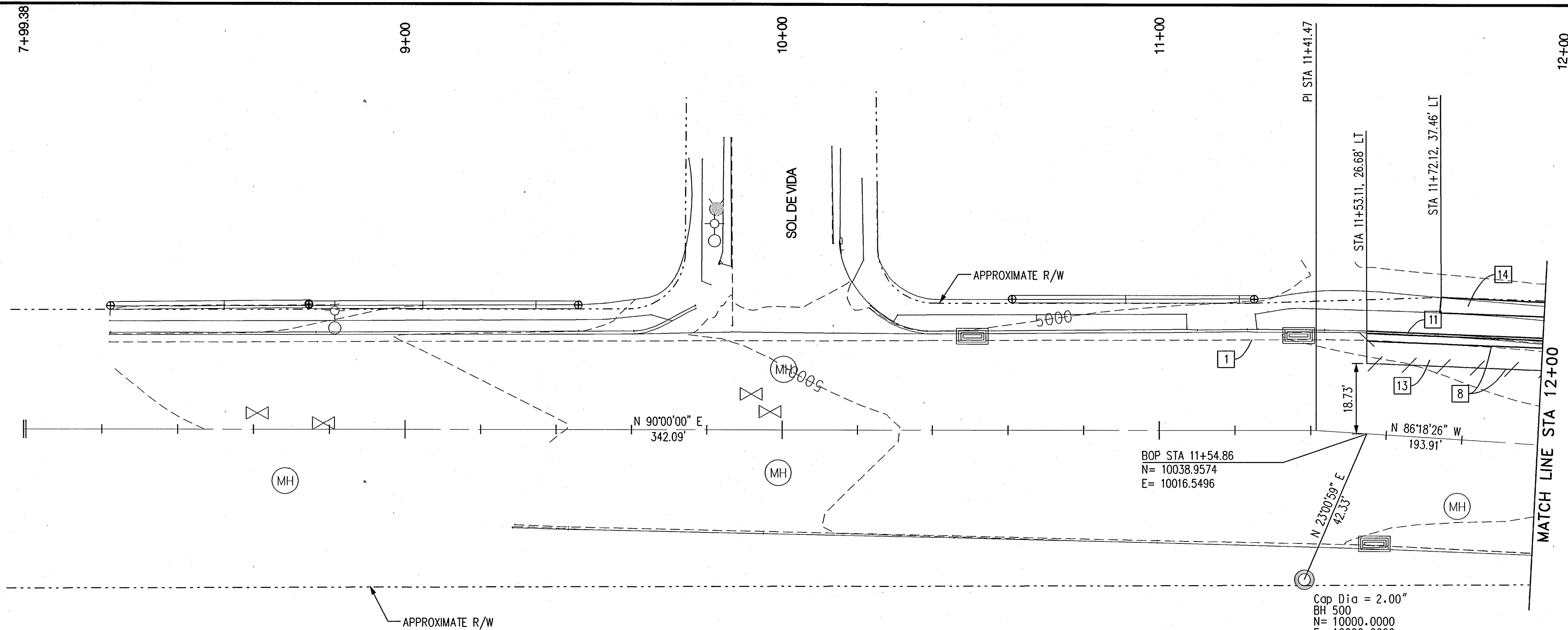

OURAY ROAD

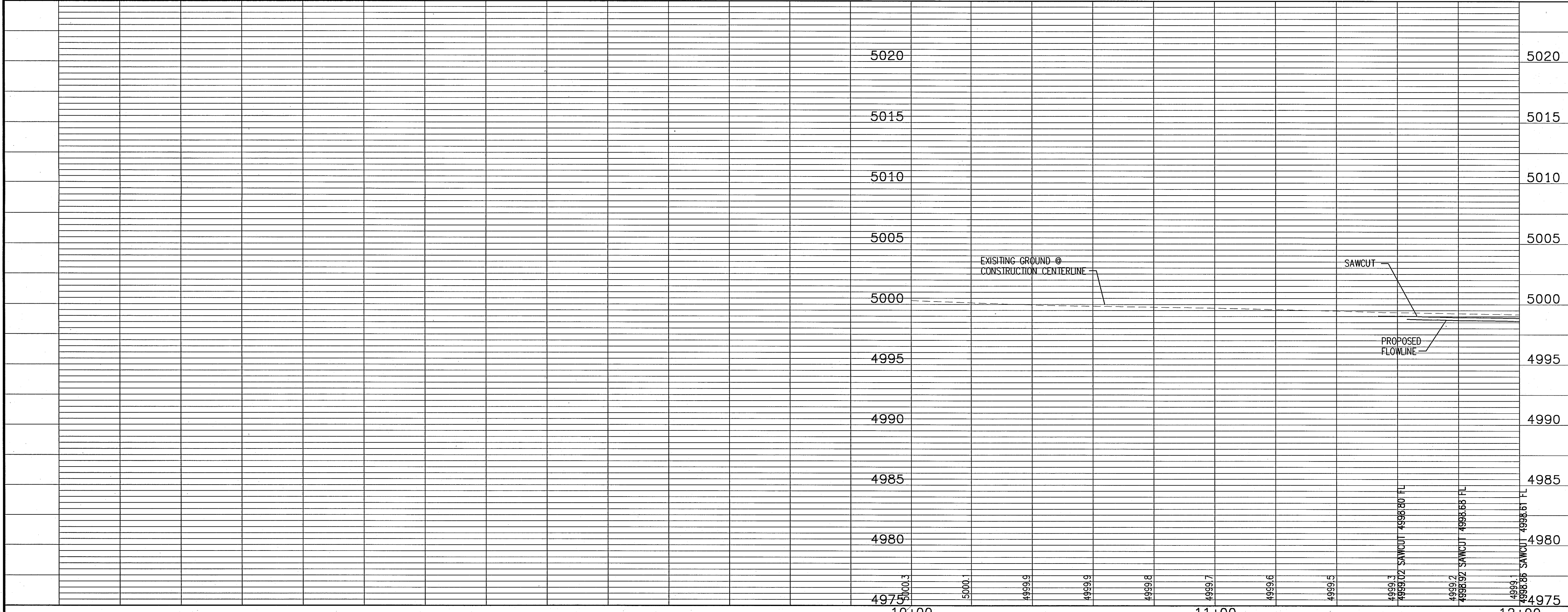

- KEYED NOTES**
- EXISTING CURB & GUTTER TO REMAIN
 - EXISTING PAVEMENT TO REMAIN
 - EXISTING POWER POLE TO BE RELOCATED BY PNM
 - EXISTING FIRE HYDRANT TO BE RELOCATED BY CONTRACTOR
 - EXISTING TELEPHONE RISER TO BE RELOCATED BY QWEST
 - EXISTING TREE TO BE REMOVED
 - REMOVE AND RELOCATE EXISTING STORM INLET TO NEW CURB LINE. EXTEND CULVERTS IN FIELD TO NEW LOCATION AS REQUIRED.
 - SAWCUT, REMOVE EXISTING ASPHALT PAVEMENT & CONCRETE CURB & GUTTER
 - REMOVE EXISTING CONCRETE SIDEWALK
 - REMOVE AND RECONSTRUCT EXISTING DRIVEWAY PAD PER COA STD DWG 2425 (MATCH EXISTING WIDTH)
 - STANDARD CURB & GUTTER PER COA STD DWG 2415A
 - STANDARD VALLEY CURB & GUTTER PER COA STD DWG 2420
 - ASPHALT PAVING, MATCH TO EXISTING PAVEMENT SECTION IN FIELD
 - CONCRETE SIDEWALK PER COA STD DWG 2430
 - PEDESTRIAN CURB RAMP PER NMDOT STD DWG PAD-001-4/10
 - INSTALL STORM INLET TYPE "A" PER COA STD DWG 2201
 - REMOVE EXISTING STORM INLET AND REPLACE WITH SEWER MANHOLE TYPE "C" PER COA STD DWG 2101. MATCH MANHOLE COVER TO GRADE. CONNECT MANHOLE TO ADJACENT STORM INLET WITH 24" CULVERT PIPE (INCIDENTAL TO MANHOLE). ALLOW CULVERT PIPE TO DRAIN FROM NEW INLET TO MANHOLE.
 - ADJUST VALVE TO GRADE

Bohannon & Huston
Court yard | 7500 Jefferson St. NE | Albuquerque, NM 87109-4335
ENGINEERING • SPATIAL DATA • ADVANCED TECHNOLOGIES

CITY OF ALBUQUERQUE
DEPARTMENT OF MUNICIPAL DEVELOPMENT

OURAY ROAD WIDENING IMPROVEMENTS
PAVING PLAN & PROFILE
BOP TO STA 12+00

DESIGN REVIEW COMMITTEE: [] CITY ENGINEER APPROVAL: []
LAST DESIGN UPDATE: []

CITY PROJECT NO. 7802.92 ZONE MAP NO. H-11-Z SHEET 3 OF 8

AS-BUILT INFORMATION		BENCH MARKS		SURVEY INFORMATION		ENGINEER'S SEAL	
CONTRACTOR	DATE	STATIONS AND ELEVATIONS BASED UPON LOCAL CONTROL ESTABLISHED BY BHI - USE BH 500 (CAP) AND BH 502 (PK NAL) AS SHOWN IN PLANS TO ESTABLISH CONTROL.	DATE	FIELD NOTES	DATE		REVISIONS DESIGN
WORKED BY	DATE		DATE	NO.	DATE		
INSPECTOR'S ACCEPTANCE BY	DATE		DATE				
VERIFICATION BY	DATE		DATE				
DRAWINGS CHECKED BY	DATE		DATE				
MICRO-FILM INFORMATION							
RECORDED BY	DATE						
NO.	DATE						

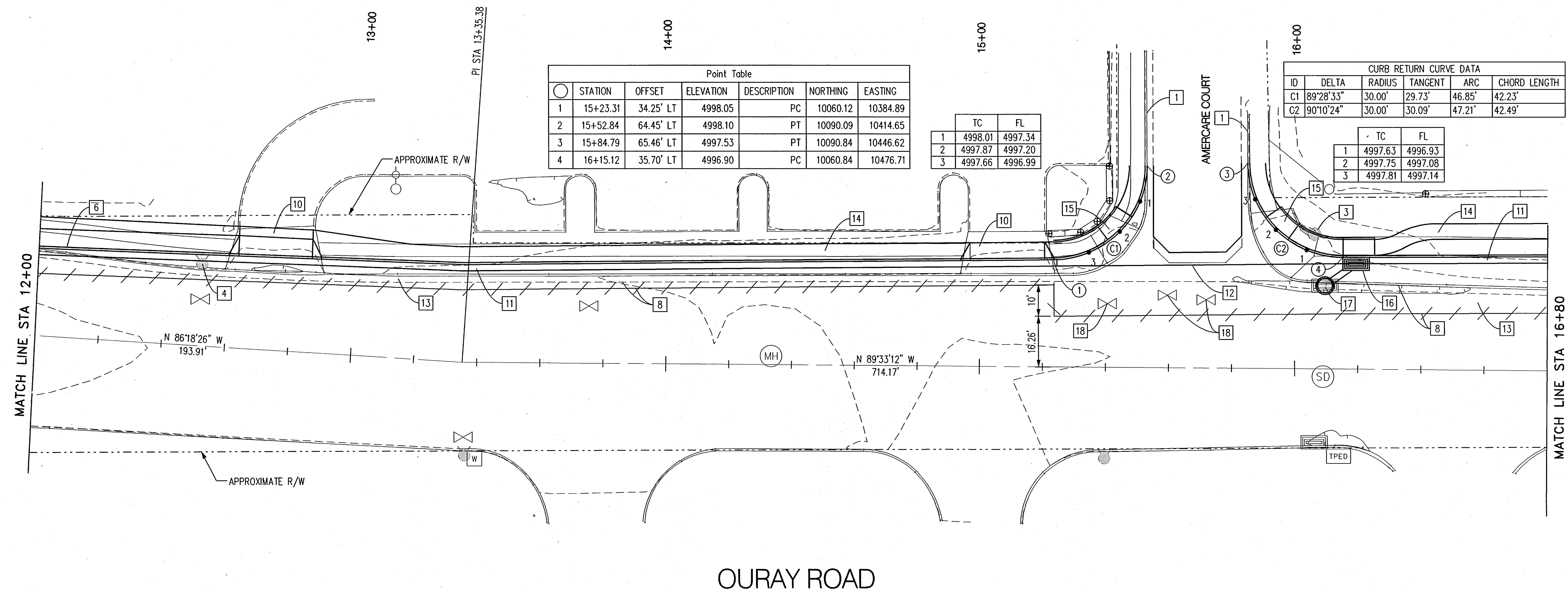

Point Table						
○	STATION	OFFSET	ELEVATION	DESCRIPTION	NORTHING	EASTING
1	15+23.31	34.25' LT	4998.05	PC	10060.12	10384.89
2	15+52.84	64.45' LT	4998.10	PT	10090.09	10414.65
3	15+84.79	65.46' LT	4997.53	PT	10090.84	10446.62
4	16+15.12	35.70' LT	4996.90	PC	10060.84	10476.71

	TC	FL
1	4998.01	4997.34
2	4997.87	4997.20
3	4997.66	4996.99

CURB RETURN CURVE DATA					
ID	DELTA	RADIUS	TANGENT	ARC	CHORD LENGTH
C1	89°28'33"	30.00'	29.73'	46.85'	42.23'
C2	90°10'24"	30.00'	30.09'	47.21'	42.49'

	TC	FL
1	4997.63	4996.93
2	4997.75	4997.08
3	4997.81	4997.14

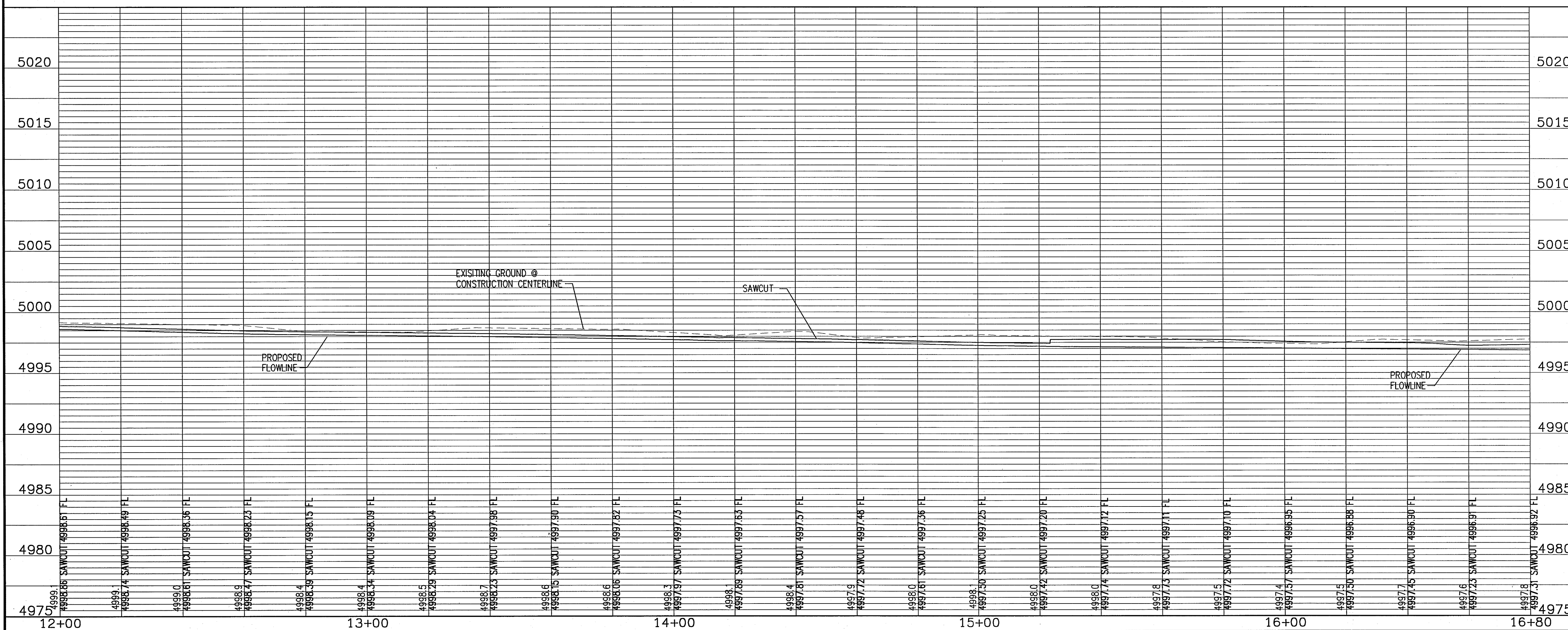

Bohannon Huston INC.

Courtyard I 7500 Jefferson St. NE Albuquerque, NM 87109-4335
ENGINEERING • SPATIAL DATA • ADVANCED TECHNOLOGIES



CITY OF ALBUQUERQUE
DEPARTMENT OF
MUNICIPAL DEVELOPMENT

OURAY ROAD WIDENING IMPROVEMENTS
PAVING PLAN & PROFILE
STA 12+00 TO STA 16+80

STA 12+00 TO STA 16+80

DESIGN REVIEW COMMITTEE	CITY ENGINEER APPROVAL	LAST DESIGN UPDATE	MO./DAY/YR.	MO./DAY/YR.

	CITY PROJECT NO.
--	------------------

7802.92

ZONE MAP NO.	
--------------	--

H-11-

SHEET

OF

4

8

P: \070141\Trans\Design\Pnp\070141pnp02.20
Fri, 02-MAR-2007 - 09:19AM, Plotted by: lahinde

Fri, 02-MAR-2007 - 09:19AM, Plotted by: lahinde

BHI JOB NO. 070141

SCALE: 1" = 20' (HORIZ.)
1" = 5' (VERT.)

$$1'' = 5' \text{ (VERT.)}$$

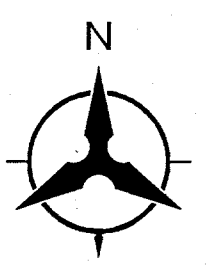
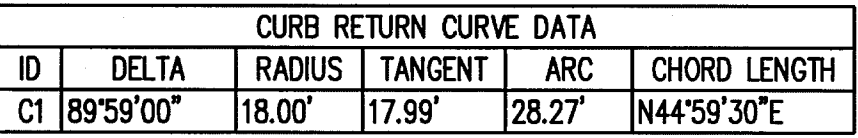

DESIGN REVIEW COMMITTEE	CITY ENGINEER APPROVAL	LAST DESIGN UPDATE	MO./DAY/YR.	MO./DAY/YR.

-

SCALE: 1" = 20' (HORIZ.)
1" = 5' (VERT.)

SHEET 5 OF 8

Bohannon		Huston							
Court yard 7500 Jefferson St. NE Albuquerque, NM 87109-4335									
ENGINEERING ▴ SPATIAL DATA ▴ ADVANCED TECHNOLOGIES									
								NO. DATE	
								DESIGNED BY	
								DRAWN BY	
								CHECKED BY	



CITY OF ALBUQUERQUE

DEPARTMENT OF MUNICIPAL DEVELOPMENT

OURAY ROAD WIDENING IMPROVEMENTS

PAVING TYPICAL SECTIONS

DESIGN REVIEW COMMITTEE	CITY ENGINEER APPROVAL		MO./DAY/YR.	MO./DAY/YR.
		LAST DESIGN UPDATE		

CITY PROJECT NO.
7802.92

ZONE MAP NO.
H-11-Z

SHEET 6 OF 8

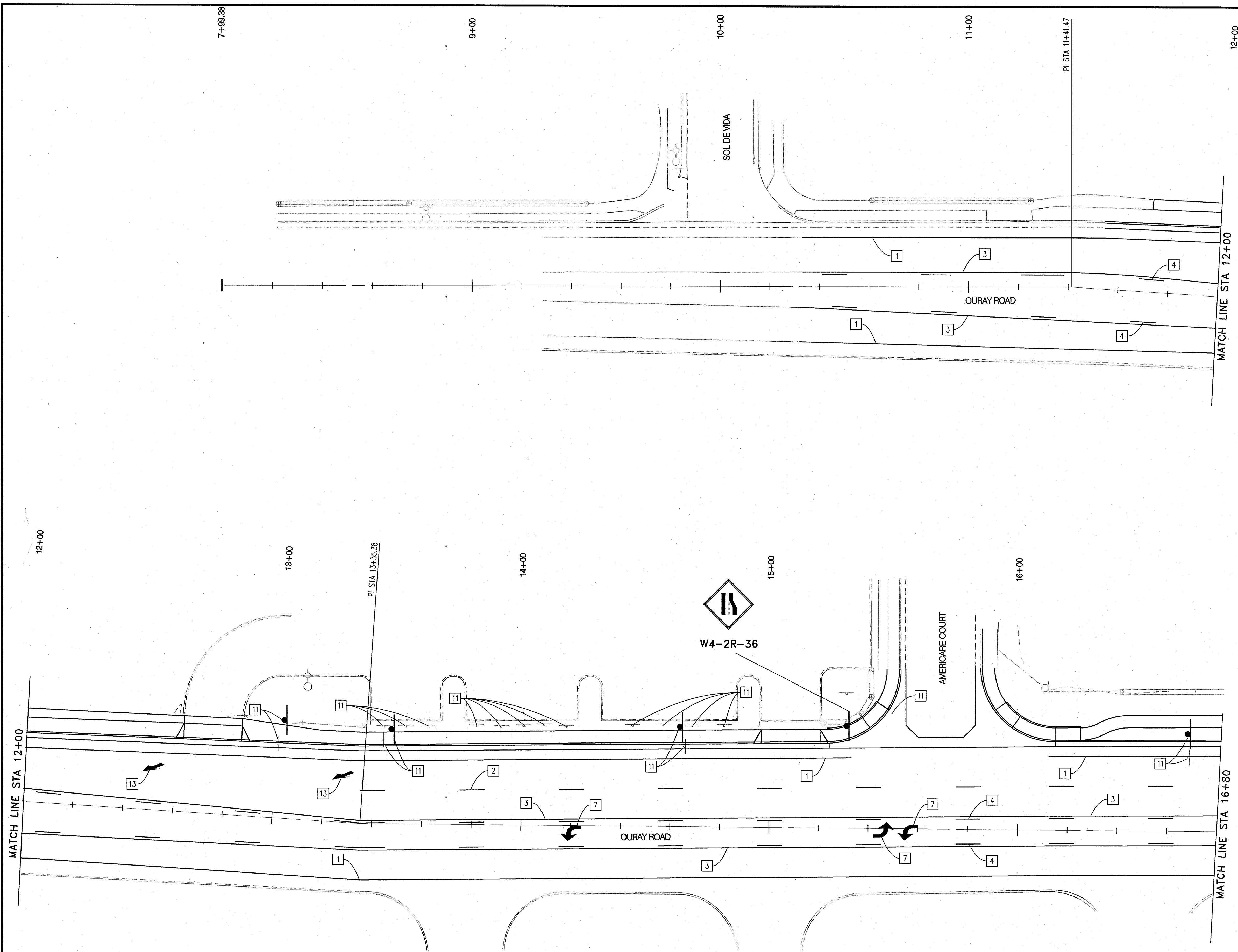

- KEYED NOTES**
- 1 INSTALL NEW 4" WHITE REFLECTORIZED PLASTIC STRIPE
 - 2 INSTALL NEW 4" DASHED WHITE REFLECTORIZED PLASTIC STRIPE (10' LINE, 30' SPACING)
 - 3 INSTALL NEW 4" YELLOW REFLECTORIZED PLASTIC STRIPE
 - 4 INSTALL NEW 4" DASHED YELLOW REFLECTORIZED PLASTIC STRIPE (10' LINE, 30' SPACING)
 - 5 INSTALL NEW 12" WHITE REFLECTORIZED PLASTIC STRIPE
 - 6 INSTALL NEW 24" WHITE REFLECTORIZED PLASTIC STRIPE
 - 7 INSTALL NEW RETROREFLECTIVE PREFORMED PATTERNED PAVEMENT MARKING, LEFT ARROW
 - 8 INSTALL NEW RETROREFLECTIVE PREFORMED PATTERNED PAVEMENT MARKING, WORD ONLY
 - 9 INSTALL NEW RETROREFLECTIVE PREFORMED PATTERNED PAVEMENT MARKING, WORD STOP
 - 10 INSTALL NEW RETROREFLECTIVE PREFORMED PATTERNED PAVEMENT MARKING, WORD AHEAD
 - 11 REMOVE AND RELOCATE EXISTING SIGN AS INDICATED
 - 12 REMOVE AND SALVAGE EXISTING SIGN TO PINO YARDS
 - 13 INSTALL NEW RETROREFLECTIVE PREFORMED PATTERNED PAVEMENT MARKING, DROP LANE ARROW
 - 14 EXISTING STRIPING TO REMAIN

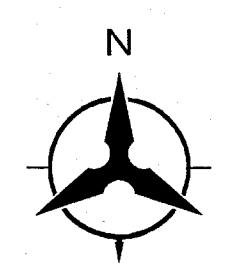

NOTE: ALL STRIPING AND PAVEMENT MARKINGS FROM BOP TO EOP TO BE OBLITERATED BY WATER BLASTING ALONG OURAY ROAD.

Bohannon & Huston
Court yard | 7500 Jefferson St. NE Albuquerque, NM 87109-4335
ENGINEERING * SPATIAL DATA * ADVANCED TECHNOLOGIES

		CITY OF ALBUQUERQUE	
		DEPARTMENT OF MUNICIPAL DEVELOPMENT	
OURAY ROAD WIDENING IMPROVEMENTS			
PERMANENT SIGNING AND STRIPING			
DESIGN REVIEW COMMITTEE	CITY ENGINEER APPROVAL	MO./DAY/YR. MO./DAY/YR.	
CITY PROJECT NO.	7802.92	ZONE MAP NO.	H-11-Z
		SHEET	7 OF 8

SURVEY INFORMATION		BENCH MARKS		AS-BUILT INFORMATION	
NO.	BY	DATE	STATIONS AND ELEVATIONS BASED UPON LOCAL CONTROL ESTABLISHED BY BHI. USE BHI 500 (CAP) AND BHI 502 (PK NAIL) AS SHOWN IN PLANS TO ESTABLISH CONTROL.	CONTRACTOR	DATE
				INSPECTOR'S ACCEPTANCE BY	DATE
				VERIFICATION BY	DATE
				DRAWINGS CHECKED BY	DATE
				MICRO-FILM INFORMATION	
				RECORDED BY	DATE
				NO.	DATE

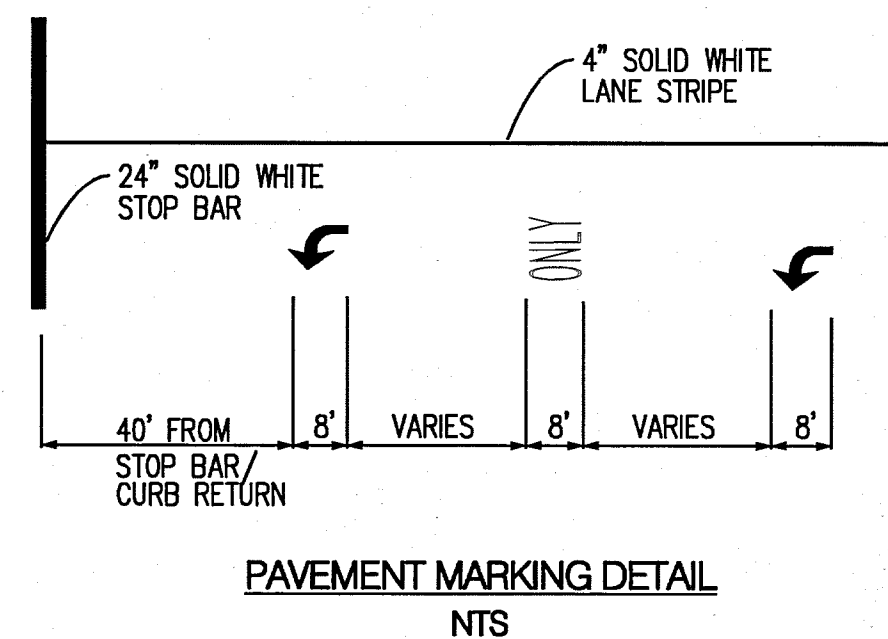
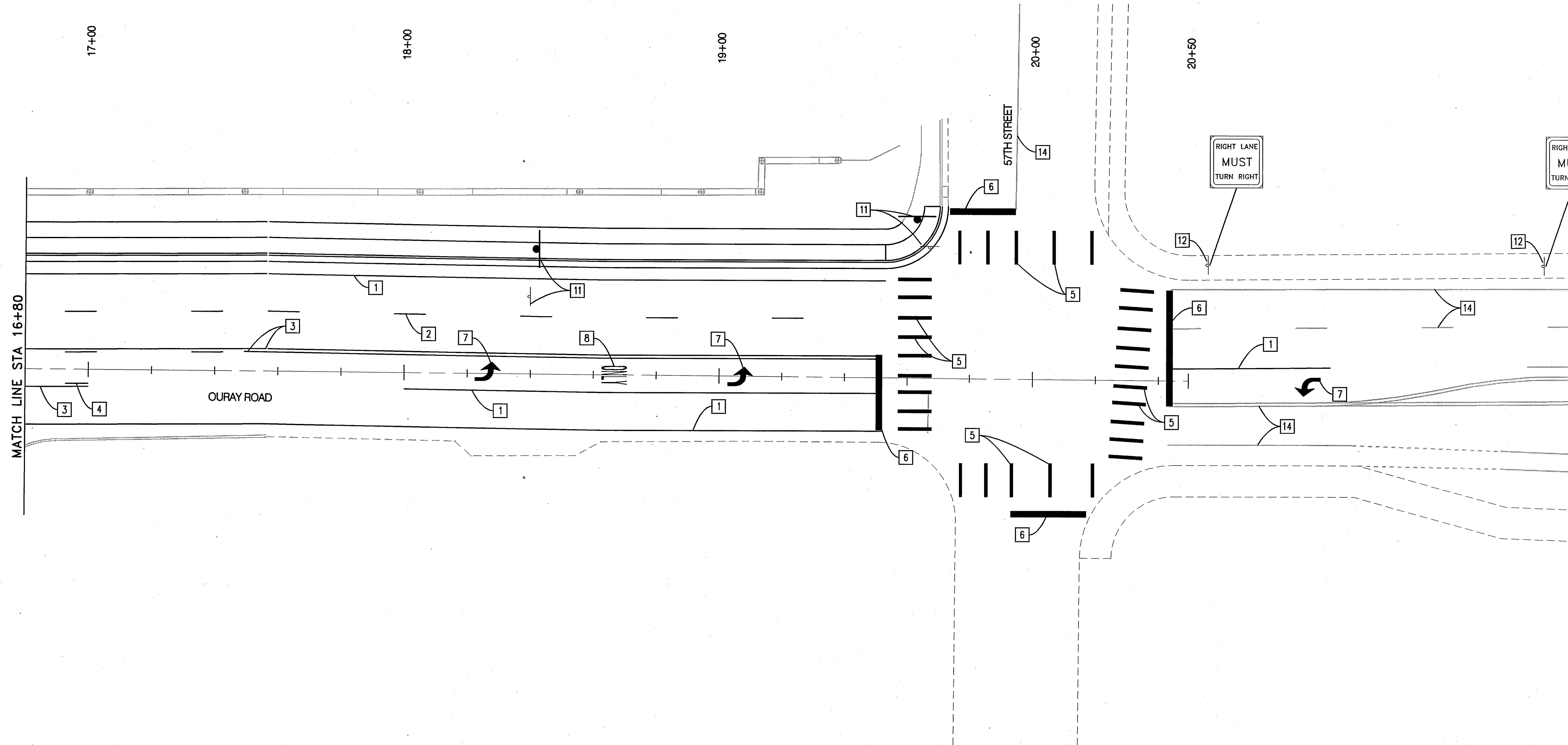

KEYED NOTES

- 1 INSTALL NEW 4" WHITE REFLECTORIZED PLASTIC STRIPE
- 2 INSTALL NEW 4" DASHED WHITE REFLECTORIZED PLASTIC STRIPE (10' LINE, 30' SPACING)
- 3 INSTALL NEW 4" YELLOW REFLECTORIZED PLASTIC STRIPE
- 4 INSTALL NEW 4" DASHED YELLOW REFLECTORIZED PLASTIC STRIPE (10' LINE, 30' SPACING)
- 5 INSTALL NEW 12" WHITE REFLECTORIZED PLASTIC STRIPE
- 6 INSTALL NEW 24" WHITE REFLECTORIZED PLASTIC STRIPE
- 7 INSTALL NEW RETROREFLECTIVE PREFORMED PATTERNED PAVEMENT MARKING, LEFT ARROW
- 8 INSTALL NEW RETROREFLECTIVE PREFORMED PATTERNED PAVEMENT MARKING, WORD ONLY
- 9 INSTALL NEW RETROREFLECTIVE PREFORMED PATTERNED PAVEMENT MARKING, WORD STOP
- 10 INSTALL NEW RETROREFLECTIVE PREFORMED PATTERNED PAVEMENT MARKING, WORD AHEAD
- 11 REMOVE AND RELOCATE EXISTING SIGN AS INDICATED
- 12 REMOVE AND SALVAGE EXISTING SIGN TO PINO YARDS
- 13 INSTALL NEW RETROREFLECTIVE PREFORMED PATTERNED PAVEMENT MARKING, DROP LANE ARROW
- 14 EXISTING STRIPING TO REMAIN

STRIPING NOTES:

1. ALL EXISTING STRIPING SHALL BE OBLITERATED THROUGH WATER BLASTING.
2. OBLITERATE ALL PREFORMED PATTERNED PAVEMENT MARKINGS AT EAST INTERSECTION APPROACH.
3. OBLITERATE STRIPING ON 57th STREET 20 FT NORTH OF THE INTERSECTION.
4. OBLITERATE CENTERLINE STRIPE ALONG OURAY ROAD 120 FEET EAST OF INTERSECTION AS SHOWN IN PLANS.
5. OBLITERATE CROSSWALK AT EAST APPROACH TO INTERSECTION.
6. CROSSWALK STRIPES SHALL BE CENTERED ON LANE LINES AND BETWEEN ADJACENT LANE STRIPES.
7. CROSSWALK SHALL BE 2 FEET BACK FROM EXISTING EXTENDED CURB LINE.

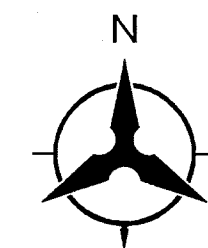

Bohannon & Huston Courtyard I 7500 Jefferson St. NE Albuquerque, NM 87109-4335 ENGINEERING • SPATIAL DATA • ADVANCED TECHNOLOGIES			
CITY OF ALBUQUERQUE DEPARTMENT OF MUNICIPAL DEVELOPMENT			
OURAY ROAD WIDENING IMPROVEMENTS PERMANENT SIGNING AND STRIPING			
DESIGN REVIEW COMMITTEE	CITY ENGINEER APPROVAL	MO./DAY/YR.	MO./DAY/YR.
CITY PROJECT NO.	ZONE MAP NO.	SHEET	OF
7802.92	H-11-Z	8	8

NOTE: ALL STRIPING AND PAVEMENT MARKINGS FROM BOP TO EOP TO BE OBLITERATED BY WATER BLASTING ALONG OURAY ROAD.

W/OUT POST-HOLE MARK