

CITY OF ALBUQUERQUE, NEW MEXICO
DEPARTMENT OF MUNICIPAL DEVELOPMENT
CONSTRUCTION PLANS
FOR
CANDELARIA ROAD
RAIL CROSSING IMPROVEMENTS
RAILROAD QUIET ZONE
STA 10+00 TO STA 15+90
COA PROJECT NO. 7839.92



VICINITY MAP
ZONE ATLAS: G-14, G-15

INDEX:

- 1 OF 9 COVER SHEET
- 2 OF 9 SYMBOL LEGEND AND UTILITY CONTACT LIST
- 3 OF 9 GENERAL NOTES
- 4 OF 9 SUMMARY OF QUANTITIES
- 5 OF 9 EXISTING & PROPOSED TYPICAL SECTIONS
- 6 OF 9 GEOMETRIC & HORIZONTAL CONTROL PLAN
- 7 OF 9 GRADING PLAN
- 8 OF 9 MEDIAN GEOMETRIC PLAN
- 9 OF 9 STRIPING & SIGNING PLAN

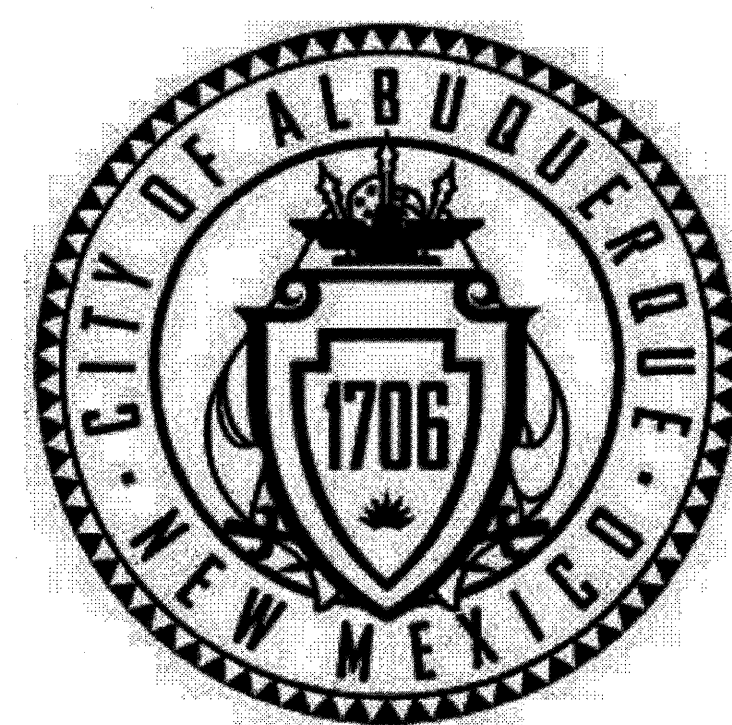

APPROVAL OF RECORD DRAWINGS
CHIEF CONSTRUCTION ENGINEER
DATE 4/24/08
JUAN CARLOS SAMUEL

WILSON & COMPANY
4900 LANG AVE., NE
SUITE 100
ALBUQUERQUE, NEW MEXICO 87109

REV	SHEETS	CITY ENGINEER	DATE	USER DEPT.	DATE	USER DEPT.	DATE
ENGINEERS STAMP & SIGNATURE		APPROVALS	ENGINEER	DATE	APPROVED FOR CONSTRUCTION		
		DRC Chairman	<i>L. Woodall</i>	10/22/07	<i>Bradley J. Bignon</i> 10/22/07 City Engineer Date		
		Transportation	<i>K. Land</i>	9/26/07			
		Water/Wastewater	<i>William J. Bignon</i>	9/25/07			
		Hydrology	<i>Bradley J. Bignon</i>	9/25/07			
		C.I.P.	N/A				
		Const. Coord.	N/A				
		NMUI	N/A				
		AMAFCA	N/A				
		City Project No.	7839.92		SHEET NO. 1 of 9		

SYMBOL LEGEND		
PROPOSED	EXISTING	DESCRIPTION
		CONCRETE
		COLORED PATTERNED CONCRETE
---		SLOPE LIMITS
----		RIGHT-OF-WAY
		BOLLARD
		CONTROL POINT
		MONITORING WELL
		CANTILEVER SIGNAL
		SIGNAL POLE w/ARM
		SINGLE POST SIGN
		DOUBLE POST SIGN
		GUY WIRE
		COMMUNICATION LINE, OVERHEAD
		CORROSION TEST POINT
		BUSH
		POWER POLE
		SPRINKLER
		LIGHT POLE
		J-BOX
		WATER VALVE
		UNKNOWN VALVE
		REFLECTOR
		ELECTRIC METER
		TRAFFIC LIGHT
		BENCH
		TRAFFIC CONNECTION BOX
		TRAFFIC CONTROL BOX
		TELEPHONE RISER
		ELECTRIC BOX
		ELECTRIC SPLICE BOX
		CABLE TV BOX
		SPRINKLER CONTROL BOX
		WATER METER
		SIGNAL LIGHT JUNCTION BOX
		FIRE HYDRANT
		DROP INLET
		GATE
● ST		STORM DRAINAGE MANHOLE
● SS		SANITARY SEWER MANHOLE
		TELEPHONE MANHOLE
		ELECTRIC MANHOLE
		CURB AND GUTTER
		SIDEWALK
		UNDERGROUND GAS LINE
		UNDERGROUND TELEPHONE LINE
		UNDERGROUND FIBER OPTICS LINE
		UNDERGROUND WATERLINE
		UNDERGROUND CABLE TELEVISION LINE
		UNDERGROUND ELECTRIC LINE
		OVERHEAD ELECTRIC LINE
		UNDERGROUND SANITARY SEWER LINE
		UNDERGROUND STORM DRAIN LINE
		WIRE FENCE
		PIPE FENCE
		WOOD FENCE
		BLOCK WALL
		UNDERGROUND CONDUIT

UTILITY OWNERS

<u>Name</u>	<u>Phones</u>	<u>Business</u>
Musinski, Nancy	Office phone: (505) 768-2729 Office fax: 768-3629 nmusinski@cabq.gov	ABCWUA Senior Engineer, Utility Engineering P.O. Box 1293 Albuquerque, NM 87103
Blauwkamp, Roland (Rol)	Office phone: 241-3606 Cell Phone: 401-7516 Office fax: (505) 241-0559 rblauwk@pnm.com	PNM Electric Co. Mail Stop ES61 4201 Edith Blvd. NW Albuquerque, NM 87107
Bates, Steve	Office phone: (505) 898-2661ext.48 Office fax: 898-6379 sbates@ecoresources.com	New Mexico Utilities 4700 Irving Blvd. NW Suite 201 Albuquerque, NM 87114
Bouska, Kelly	Office phone: (505) 241-7752 Office fax: (505) 241-7753 kbouska@pnm.com	PNM Gas Co. Mail Stop GS66 4625 Edith Blvd. NE Albuquerque, NM 87107
Brown, John	Office phone: (505) 314-0890 Office fax: (505) 314-0810 john@bcgassets.com	BCG Assets 505 Marquette Ave NW Suite LL-110A Albuquerque, NM 87102
Crowel, David	Office phone: (505) 842-2911 Office fax: 842-2890 dcrowel@att.com	AT&T Resource Supervisor 111 3 rd Street NW Albuquerque, NM 87103
Darnell, Andy	Office phone: (505) 346-4470 Office fax: 348-8666 Andy.Darnell@mci.com	MCI Worldcom Operations Manager 6001 Midway Park NE Albuquerque, NM 87109
Harrison, Royal	Office phone: (505) 938-7339 Office fax: 938-7380 Royal.Harrison@twtelecom.com	Time Warner Telecom Plant Manager 3830 Singer Blvd. NE Suite 1000 Albuquerque, NM 87109
Jaramillo, Rita	Office phone: (505) 245-8352 Office fax: (505) 245-6733 Mobile: (505) 385-4472 Pager: (505) 380-3301 rjarami@qwest.com	Qwest Manager- Engineering NM Engineering/Planning 400 Tijeras NW, Room 710 Albuquerque, NM 87102
Kelly, Larry	Office Phone: (505) 246-0501 Office Fax: (505) 246-0479 Cell: 505-270-3442 Larry.Kelly@qwest.com	Qwest Long Distance Sr. Operations Tech 400 Tijeras Ave NW Suite570 Albuquerque, NM 87102
Mortus, Mike	Office Phone: (505) 761-6235 Office Fax: (505) 761-0599 Mobile: (505) 269-4006 Mike_Mortus@cable.comcast.com	Comcast Project Manager 4611 Montbel Place NE Albuquerque, NM
Mueller, Rick	Office phone: (505) 244-3161 Office fax: 244-0094 Mobile: 228-3329 rdmueller@mcleodusa.com	McLeod USA Supervisor of Outside Techs. 505 Marquette NW (Compass Bank) Suite 1600 Albuquerque, NM 87102

RAILROAD CONTACTS

<u>Name</u>	<u>Phones</u>	<u>Business</u>
Gonzales, Henry	Office Phone: (505)827-3219	New Mexico Dept. of Transportation Railroad Division
Wiley, Matthew	Office Phone: (505)247-1750	Mid-Region Council of Governments

**WILSON
& COMPANY**



CITY OF ALBUQUERQUE DEPARTMENT OF MUNICIPAL DEVELOPMENT TRANSPORATATION DIVISION			
CANDELARIA ROAD RAIL CROSSING IMPROVEMENTS SYMBOL LEGEND AND UTILITY CONTACT LIST			
Design Review Committee OCT 2 2 2007 DESIGN REVIEW COMMITTEE	City Engineer Approval OCT 2 2 2007 CITY ENGINEER	Last Design Update	
City Project No. 7839.92	Zone Map No. G-14, G-15	Sheet 2 of 9	

1. ALL WORK DETAINED ON THESE PLANS TO BE PERFORMED UNDER THIS CONTRACT SHALL, EXCEPT AS OTHERWISE STATED OR PROVIDED HEREON, BE CONSTRUCTED IN ACCORDANCE WITH THE CITY OF ALBUQUERQUE STANDARD SPECIFICATIONS FOR PUBLIC WORKS CONSTRUCTION, 1986 EDITION, AS AMENDED THROUGH UPDATE NO. 7 AND AMENDMENT NO. 1 DATED 08/19/2005.
2. THE CONTRACTOR SHALL PROVIDE INGRESS AND EGRESS TO LOCAL BUSINESSES AND RESIDENCES FOR THE DURATION OF THE PROJECT. THE CONTRACTOR SHALL ADVISE OF AND SCHEDULE ACCESS CLOSURES, AT LEAST 24 HOURS IN ADVANCE, WITH PROPERTY OWNERS AND THE CONSTRUCTION PROJECT MANAGER.
3. FIVE (5) WORKING DAYS PRIOR TO BEGINNING CONSTRUCTION THE CONTRACTOR SHALL SUBMIT TO THE CONSTRUCTION COORDINATION DIVISION A DETAILED CONSTRUCTION SCHEDULE. TWO (2) WORKING DAYS PRIOR TO CONSTRUCTION THE CONTRACTOR SHALL OBTAIN A BARRICADING PERMIT FROM THE CONSTRUCTION COORDINATION DIVISION. CONTRACTOR SHALL NOTIFY BARRICADE ENGINEER (924-3400) PRIOR TO OCCUPYING AN INTERSECTION.
4. TWO (2) WORKING DAYS PRIOR TO ANY EXCAVATION, CONTRACTOR MUST CONTACT N.M. ONE-CALL SYSTEM, (505) 260-1990, FOR LOCATION OF EXISTING UTILITIES.
5. CONTRACTOR SHALL BE RESPONSIBLE FOR ACQUIRING, AT THEIR OWN EXPENSE, ALL PERMITS NECESSARY FOR CONSTRUCTION.
6. ALL WORK IMPACTING AN ARTERIAL ROADWAY WILL REQUIRE 24-HOUR CONSTRUCTION IN ACCORDANCE WITH THE CITY OF ALBUQUERQUE'S ORANGE BARREL POLICY, EXCEPT AS OTHERWISE STATED OR PROVIDED HEREON.
7. CRITICAL INTERSECTION WORK SHALL NOT START UNTIL THE CONTRACTOR HAS ALL MATERIAL, EQUIPMENT, AND NECESSARY PERSONNEL ON-SITE. TRAFFIC CONTROL DEVICES SHALL NOT BE PLACED PREMATURELY.
8. OVERNIGHT PARKING OF CONSTRUCTION VEHICLES ON PRIVATE PROPERTY IS THE SOLE RESPONSIBILITY OF THE CONTRACTOR.
9. THE CONSTRUCTION CLEAR ZONE FOR THIS PROJECT IS 16 FEET FROM THE EDGE OF DRIVING LANE WITH A REDUCED SPEED LIMIT (25 MPH.) THE CONTRACTOR SHALL NOT STORE EQUIPMENT OR MATERIAL WITHIN THE CONSTRUCTION CLEAR ZONE UNLESS THE EQUIPMENT OR MATERIAL IS PROPERLY SHIELDED UTILIZING CURRENT SAFETY DESIGN AND INSTALLATION METHODS. THE SAFETY DESIGN FOR SHIELDING SHALL BE PROVIDED BY THE CONTRACTOR AND MUST BE APPROVED BY THE PROJECT MANAGER BEFORE IMPLEMENTING. THIS WORK, INCLUDING DESIGN, INSTALLATION, AND REMOVAL OF THE SHIELDING, SHALL BE CONSIDERED INCIDENTAL TO THE COMPLETION OF THE PROJECT AND NO ADDITIONAL PAYMENT WILL BE MADE.
10. THE CONTRACTOR SHALL NOTIFY THE ALBUQUERQUE TRAFFIC ENGINEERING DIVISION THREE (3) WORKING DAYS IN ADVANCE OF ANY WORK REQUIRED REGARDING ALL EXISTING REGULATORY SIGNS AND SIGNALS THAT NEED TO BE REMOVED, RELOCATED, OR REINSTALLED. CALL 857-8680. REFER TO SECTION 18.4.4 OF THE SPECIFICATIONS.
11. WHEN EXISTING TRAFFIC SIGNALS ARE TURNED OFF, THE CONTRACTOR SHALL HAVE AN OFF-DUTY POLICE OFFICER DIRECT TRAFFIC. THIS WORK SHALL BE CONSIDERED INCIDENTAL TO CONSTRUCTION AND NO ADDITIONAL PAYMENT WILL BE MADE.
12. THE CONTRACTOR SHALL NOTIFY THE ENGINEER NOT LESS THAN SEVEN (7) DAYS PRIOR TO STARTING WORK IN ORDER THAT THE ENGINEER MAY TAKE NECESSARY MEASURES TO INSURE THE PRESERVATION OF SURVEY MONUMENTS. CONTRACTOR SHALL NOT DISTURB PERMANENT SURVEY MONUMENTS WITHOUT THE CONSENT OF THE ENGINEER AND SHALL NOTIFY THE ENGINEER AND BEAR THE EXPENSE OF REPLACING ANY THAT MAY BE DISTURBED WITHOUT PERMISSION. REPLACEMENT SHALL BE DONE ONLY BY THE CITY SURVEYOR. WHEN A CHANGE IS MADE IN THE FINISHED ELEVATION OF THE PAVEMENT OF ANY ROADWAY IN WHICH A PERMANENT SURVEY MONUMENT IS LOCATED, CONTRACTOR SHALL, AT THE CONTRACTOR'S EXPENSE, ADJUST THE MONUMENT COVER TO THE NEW GRADE UNLESS OTHERWISE SPECIFIED. REFER TO SECTION 4.4 OF THE GENERAL CONDITIONS OF THE STANDARD SPECIFICATIONS.
13. THE CONTRACTOR WILL BE REQUIRED TO CONFINE THEIR WORK WITHIN THE CONSTRUCTION LIMITS AND/OR RIGHT OF WAY TO PRESERVE EXISTING VEGETATION AND PRIVATE PROPERTY. OVERNIGHT PARKING OF CONSTRUCTION EQUIPMENT SHALL NOT OBSTRUCT DRIVEWAY OPENINGS OR DESIGNATED TRAFFIC LANES.
14. IT SHALL BE THE CONTRACTOR'S RESPONSIBILITY TO ENSURE THAT BUILDING STRUCTURES ADJACENT TO THE PROJECT NOT BE DAMAGED DUE TO ANY CONSTRUCTION ACTIVITIES. DAMAGE CAUSED TO ANY BUILDING STRUCTURE WILL BE THE SOLE RESPONSIBILITY OF THE CONTRACTOR, INCLUDING ALL COSTS INCURRED IN RESTORING/REPAIRING SAID DAMAGE.
15. THE CONTRACTOR SHALL SUBMIT A PROPOSED WORK PLAN FOR PEDESTRIAN IMPROVEMENTS TO THE PROJECT MANAGER FOR REVIEW AND APPROVAL PRIOR TO INITIATING ANY WORK AFFECTING PEDESTRIANS. THIS PLAN SHALL INCLUDE THE METHOD PROPOSED TO MAINTAIN PEDESTRIAN ACCESS TO BUSINESSES, SCHOOLS, HOSPITALS, BUILDINGS, ETC. THROUGHOUT THE PEDESTRIAN IMPROVEMENTS CONSTRUCTION IN PARTICULAR. THE CONTRACTOR, AT MINIMUM, SHALL MAINTAIN A 36" CLEAR PATH FOR PEDESTRIANS SO AS TO MEET ADA ACCESSIBILITY REQUIREMENTS.
16. THE CONTRACTOR SHALL MAINTAIN AN UP TO DATE SET OF AS-BUILT PLANS FOR THE PROJECT. THESE PLANS SHALL BE KEPT CURRENT, WITHIN TWO WEEKS, AT ALL TIMES AND SHALL BE SUBJECT TO REVIEW BY THE PROJECT MANAGER THROUGHOUT THE PROJECT AND WILL BE REVISED BY THE PROJECT MANAGER FOR ACCURACY AND COMPLETENESS AT LEAST ONCE EVERY 30 DAYS. THE FINAL AS-BUILT PLANS SHALL BE SUBMITTED TO THE PROJECT MANAGER PRIOR TO FINAL PAYMENT.
17. THE CONTRACTOR SHALL BE RESTRICTED TO THE USE OF A 35 TON MAXIMUM NON-VIBRATORY ROLLER TO OBTAIN THE REQUIRED COMPACTION IN PAVEMENT STRUCTURE, ROADWAY BACKFILL, EMBANKMENT, AND SUBGRADES IN URBAN AREAS WHERE THE USE OF HEAVIER EQUIPMENT COULD DAMAGE UNDERGROUND UTILITIES OR OTHER PERMANENT STRUCTURES.
18. MANHOLE RIM ELEVATIONS SHOWN ON THESE PLANS ARE APPROXIMATE AND WILL VARY WITH THE FINISHED PAVEMENT ELEVATIONS.
19. ALL RADII OF CURB RETURNS ARE SHOWN TO THE FACE OF CURB AND, UNLESS OTHERWISE NOTED, ALL OFFSETS AND DIMENSIONS ARE TO THE FACE OF CURB. MATCH FLOWLINES OF GUTTERS WHEN CONNECTING NEW CURB AND GUTTER WITH EXISTING CURB AND GUTTER.
20. EXACT LOCATION OF DRIVEPADS AND WHEELCHAIR RAMPS WILL BE DETERMINED IN THE FIELD BY THE FIELD ENGINEER. LOCATIONS SHOWN ON PLAN AND PROFILE SHEETS ARE APPROXIMATE.
21. WHERE PULL BOXES ABOUT THE BACK OF CURB OR ARE LOCATED IN A CONCRETE PAVED AREA, PROVIDE 3/4" EXPANSION MATERIAL AROUND THE PULL BOX. ALL PULL BOXES TO BE FLUSH WITH SURFACE OF CONCRETE.
22. WHEN ABUTTING NEW PAVEMENT TO EXISTING, CONTRACTOR SHALL SAW CUT, TO FULL PAVEMENT DEPTH, THE EXISTING PAVEMENT TO A NEAT VERTICAL STRAIGHT LINE AS REQUIRED TO REMOVE ANY BROKEN OR CRACKED PAVEMENT AND MATCH NEW TO EXISTING.
23. THE CONTRACTOR SHALL VERIFY ALL EXISTING FIRE HYDRANT FLANGES, PADS, VALVE BOXES, MANHOLE RIMS AND TOP OF PIPE ELEVATIONS IN THE FIELD. ELEVATIONS SHALL BE ADJUSTED TO COMPLY WITH THE REQUIREMENTS OF THE STANDARD CITY DETAILS.
24. WHEN APPEARING IN ANY PORTION OF THIS CONTRACT, THE WORDS "PLANT MIX BITUMINOUS PAVEMENT" (PMBP) WILL HAVE THE SAME MEANING AS AND MAY BE USED INTERCHANGEABLY WITH THE WORDS "ASPHALT CONCRETE".
25. THE CONTRACTOR SHALL WARP SLOPES WHERE NECESSARY TO STAY WITHIN THE RIGHT OF WAY OR CONSTRUCTION EASEMENT LIMITS. THE WORK SHALL BE AS DIRECTED BY THE PROJECT MANAGER.
26. THE SUBGRADE PREP SHALL EXTEND ONE (1) FOOT BEYOND THE FREE EDGE OF NEW SIDEWALK.
27. THE CONTRACTOR SHALL ASSUME RESPONSIBILITY FOR ANY DAMAGE TO EXISTING PAVEMENTS, PAVEMENT MARKINGS, CURB AND GUTTER, DRIVEPADS, HANDICAP RAMPS, AND SIDEWALK DURING CONSTRUCTION APART FROM THOSE SECTIONS INDICATED FOR REMOVAL ON THE PLANS, AND SHALL REMOVE AND REPLACE AS PER COA STANDARDS AT THEIR OWN EXPENSE.
28. WHEN REMOVAL OF EXISTING CURB AND GUTTER OR SIDEWALK IS REQUIRED, REMOVE TO NEAREST JOINT.
29. ALL CONSTRUCTION DEBRIS, SPOIL AND NON-SALVAGEABLE ITEMS BECOME THE PROPERTY OF THE CONTRACTOR AND PROPER DISPOSAL OF THESE ITEMS IS THE RESPONSIBILITY OF THE CONTRACTOR. ANY HAUL COSTS ASSOCIATED WITH THIS WORK IS CONSIDERED INCIDENTAL TO THE PROJECT.
30. ALL TRENCH EXCAVATION BACKFILL WITHIN THE ROADWAY PRISM SHALL BE COMPACTED TO 95% OF THE MODIFIED PROCTOR PER ASTM D-698 OR D-1557 AS APPLICABLE.
31. ANY EARTHWORK HAUL ON THIS PROJECT WILL BE CONSIDERED AS INCIDENTAL TO THE PROJECT AND NO SEPARATE PAYMENT WILL BE MADE THEREFOR.
32. A SHRINKAGE FACTOR OF 10% SHALL BE APPLIED TO COMPENSATE FOR THE CHANGE IN MATERIAL VOLUME FOR CUT TO FILL SECTIONS. EARTHWORK QUANTITIES ARE BASED ON THIS SHRINKAGE FACTOR FOR ROADWAY EMBANKMENT..

33. STRUCTURAL FILL FOR EMBANKMENTS, PAVEMENTS, AND STRUCTURES SHALL BE PLACED IN LIFTS THAT, FOLLOWING COMPACTION, DO NOT EXCEED 8". FILLS SHALL BE COMPACTED AT MOISTURE CONTENTS WITHIN +/- 2% OF OPTIMUM MOISTURE CONTENT. SELECT STRUCTURAL FILL AROUND CULVERTS AND OTHER STRUCTURES SHOULD BE COMPACTED, USING HAND OPERATED COMPACTION EQUIPMENT AND IN LIFTS NOT EXCEEDING 4", TO THE DENSITY AND MOISTURE CONTENT SPECIFIED ABOVE. THE UPPER 12" OF ROADBEDS SHALL BE COMPACTED TO 95% OF MAXIMUM DRY DENSITY (ASTM 1557).
34. ALL EXISTING UTILITIES SHOWN HEREIN WERE TAKEN FROM RECORD DRAWINGS, FIELD SURVEYS, C.O.A. SYSTEMS UTILITIES MAPS AND INFORMATION PROVIDED BY THE UTILITY OWNERS AND ARE APPROXIMATE. IT WILL BE CONTRACTORS RESPONSIBILITY TO FIELD VERIFY HORIZONTAL AND VERTICAL LOCATIONS AND TYPE OF EXISTING UTILITIES TO BE ADJUSTED OR EXTENDED AND TO PROVIDE PROTECTION FOR ALL UTILITIES WITHIN THE CONSTRUCTION AREA. THE CONTRACTOR WILL BE RESPONSIBLE FOR EXPLORATORY TRENCHING AND EXPOSING OF EXISTING UTILITIES (POTHOLING) TO CONFIRM SIZE, LOCATION, ETC. THIS WORK WILL BE CONSIDERED AS INCIDENTAL TO THE PROJECT.
35. CONTRACTOR IS TO EXERCISE DUE CARE TO AVOID DISTURBING ANY EXISTING UTILITIES. IT SHALL BE THE RESPONSIBILITY OF THE CONTRACTOR TO COORDINATE WITH THE UTILITY COMPANIES IN ORDER TO PREVENT ANY SERVICE DISRUPTION THAT MIGHT RESULT FROM PROJECT CONSTRUCTION. IT SHALL BE THE RESPONSIBILITY OF THE CONTRACTOR TO PROTECT AND PRESERVE UTILITY EQUIPMENT AFFECTED BY PROJECT CONSTRUCTION. SHOULD THE CONTRACTOR BREAK AN EXISTING UTILITY LINE DURING CONSTRUCTION ACTIVITIES THE CONTRACTOR SHALL BE RESPONSIBLE FOR UTILITY REPAIR COSTS.
36. THE CONTRACTOR SHALL NOTIFY THE LOCAL FIRE DEPARTMENT AT LEAST TWO (2) WORKING DAYS IN ADVANCE OF WHEN FIRE HYDRANTS WILL BE TAKEN OUT OF SERVICE AND RETURNED TO SERVICE.
37. THE ABCWUA (857-8200) WILL BE NOTIFIED BY THE CONTRACTOR SEVEN(7) WORKING DAYS IN ADVANCE OF ANY WORK WHICH MAY AFFECT THE EXISTING PUBLIC WATER FACILITIES. REFER TO SECTION 18 OF THE STANDARD SPECIFICATIONS.
38. THE CONTRACTOR SHALL ADJUST TO GRADE ALL WATER VALVE BOXES, SANITARY SEWER MANHOLES AND STORM DRAIN MANHOLES WHICH MAY BE AFFECTED BY THIS CONTRACT.
39. ALL EXCAVATION, TRENCHING, AND SHORING ACTIVITIES MUST BE CARRIED OUT IN ACCORDANCE WITH OSHA 29 CFR 1926.650 SUBPART P.
40. THE CONTRACTOR SHALL BE RESPONSIBLE FOR DISPOSING OF DEBRIS, INCLUDING BUT NOT LIMITED TO HAZARDOUS WASTE AT DISPOSAL SITES APPROVED BY GOVERNMENTAL AGENCIES REGULATING THE DISPOSAL OF SUCH MATERIALS.
41. THE CONTRACTOR SHALL MAINTAIN A GRAFFITI-FREE WORK SITE AND SHALL PROMPTLY REMOVE ANY AND ALL GRAFFITI FROM EQUIPMENT, WHETHER PERMANENT OR TEMPORARY.
42. THE CONTRACTOR SHALL BE RESPONSIBLE FOR PROVIDING AND MAINTAINING ALL CONSTRUCTION SIGNING UNTIL THE PROJECT HAS BEEN ACCEPTED BY THE CITY.
43. ALL CONSTRUCTION WITHIN THE NMDOT RAILROAD RIGHT OF WAY SHALL BE COORDINATED WITH HENRY GONZALES (505-837-3219) AND MATTHEW WILEY (505-247-1750) PRIOR TO COMMENCING WORK. A FLAGMAN WILL BE REQUIRED FOR ALL WORK WITHIN THE NMDOT RAILROAD RIGHT OF WAY.

ENGINEER'S SEAL		SURVEY INFORMATION		BENCH MARKS		AS-BUILT INFORMATION	
		FIELD NOTES					
		NO.	BY				
				ACS STATION BEING A BRASS TABLET STAMPED "6-G15 1979" SET IN A TRAFFIC SIGNAL BOX, 0.6' BELOW THE GROUND, FROM THE INTX. OF CANDELARIA RD. & I-25, GO WEST 0.8 mi. TO THE A' & SF R.R.. THE STATION IS ON THE EAST SIDE OF THE RR (N) OF CANDELARIA (2nd-Order)		CONTRACTOR AS HOLENER INC	
						WORK STARTED BY ALICIA HOLENER	DATE 10/07
						ACCEPTANCE BY COA CSD	DATE 11/07
						FIELD DRAWING BY COA CSD	DATE 11/07
						CORRECTED BY	DATE 12/07
REVISIONS		MICRO-FILM INFORMATION					
		RECORDED BY					
WILSON & COMPANY, ENGINEERS & ARCHITECTS							
DESIGNED BY	SGG	DATE	2007				
DRAWN BY	ELO	DATE	2007				
CHECKED BY	DDM	DATE	2007				

**WILSON
& COMPANY**

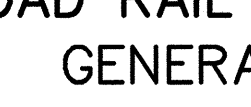
	CITY OF ALBUQUERQUE DEPARTMENT OF MUNICIPAL DEVELOPMENT TRANSPORTATION DIVISION			
CANDELARIA ROAD RAIL CROSSING IMPROVEMENTS GENERAL NOTES				
Design Review Committee 	City Engineer Approval 	Last Design Update	Mo./Day/Yr. 	Mo./Day/Yr.
City Project No. <div style="font-size: 24pt; font-weight: bold;">7839.92</div>	Zone Map No. <div style="font-size: 24pt; font-weight: bold;">G-14, G-15</div>	Sheet <div style="font-size: 24pt; font-weight: bold;">3 of 9</div>		

SUMMARY OF QUANTITIES

BID ITEM	ITEM ID NO.	ITEM DESCRIPTION	ESTIMATED QUANTITY	UNIT
		CONSTRUCTION ENGINEERING		
1.	4.010	CONSTRUCTION STAKING & SURVEYING, PROJECT AS-BUILTS, COMPLETE.	1	LS
2.	6.010	MOUNTING, INSTALLATION & MAINTENANCE OF PROJECT IDENTIFICATION SIGN, INCL. PLYWOOD, POSTS, AND FOUNDATIONS, CIP.	2	EACH
3.	6.050	CONSTRUCTION MOBILIZATION, COMPLETE.	1	LS
4.	6.060	CONSTRUCTION DEMOBILIZATION, COMPLETE.	1	LS
5.	19.010	CONSTRUCTION TRAFFIC CONTROL & BARRICADING, COMPLETE.	1	LS
		ROADWAY		
6.	116.061	MATERIAL AND PLACEMENT SUPERPAVE ASPHALT CONCRETE, 2.5" LIFT, TYPE III, CIP.	100	SY
7.	116.071	MATERIAL AND PLACEMENT SUPERPAVE ASPHALT CONCRETE, 3" LIFT, TYPE II, CIP.	100	SY
8.	202.012	EXCAVATION, PLACEMENT, AND COMPACTION OF SELECT MATERIAL, CIP.	200	CY
9.	301.020	SUBGRADE PREP. 12" @ 95% COMPACTION, CIP.	100	SY
10.	302.000	AGGREGATE BASE COURSE CRUSHED, 8" @ 95% COMPACTION, CIP.	100	SY
11.	336.010	PRIME COAT, EMULSIFIED ASPHALT, CIP.	100	SY
12.	336.120	TACK COAT, CATIONIC EMULSIFIED ASPHALT, CIP.	100	SY
13.	340.060	CURB & GUTTER, MEDIAN, PORTLAND CEMENT CONCRETE, CIP. SD 2408	440	LF
14.	346.100	TEXTURED MEDIAN PAVEMENT, 4" THICK, COLORED PC CONCRETE, INCL. SUBGRADE COMPACTION, CIP.	120	SY
		PERMANENT SIGNING & STRIPING		
15.	440.0015	REFLECTORIZED PAINTING FOR MEDIAN NOSES	50	SF
16.	441.001	REFLECTORIZED PLASTIC PAVEMENT MARKINGS, 4" WIDTH, CIP.	3300	LF
17.	441.002	REFLECTORIZED PLASTIC PAVEMENT MARKINGS, 6" WIDTH, CIP.	1000	LF
18.	441.005	REFLECTORIZED PLASTIC PAVEMENT MARKINGS, 24" WIDTH, CIP.	300	LF
19.	441.032	REFLECTORIZED PLASTIC SYMBOL, RXR, CIP.	6	EACH
20.	450.001	ALUMINUM PANEL SIGN, CIP.	100	SF
21.	450.002	OBJECT MARKER TYPE II, INCLUDING BASE POST AND MOUNTING POST, CIP.	2	EACH
22.	450.010	SQUARE TUBE STEEL POSTS & BASE POSTS FOR ALUMINUM PANEL SIGN, CIP.	120	LF
		REMOVALS		
23.	343.020	EXISTING PAVEMENT, ASPHALT CONCRETE, UP TO 4" THICK, SAWCUT, REMOVE & DISPOSE, COMPLETE.	200	SY
24.	443.101	REMOVAL OF PAVEMENT STRIPE, ANY WIDTH, PAINTED OR PLASTIC, COMPL.	4000	LF
25.	443.102	REMOVAL OF PAVEMENT ARROW, SYMBOL, OR WORD, PAINTED OR PLASTIC, COMPL.	6	EACH

[illegible]

	CITY OF ALBUQUERQUE DEPARTMENT OF MUNICIPAL DEVELOPMENT TRANSPORTATION DIVISION																
	CANDELARIA ROAD RAIL CROSSING IMPROVEMENTS SUMMARY OF QUANTITIES																
Design Review Committee <div style="border: 1px solid black; padding: 5px; text-align: center;"> APPROVED OCT 22 2007 DESIGN REVIEW COMMITTEE </div>	City Engineer Approval <div style="border: 1px solid black; padding: 5px; text-align: center;"> APPROVED OCT 22 2007 CITY ENGINEER </div>	Last Design Update	<table border="1" style="width: 100%; border-collapse: collapse;"> <thead> <tr> <th style="width: 50%;">Mo./Day/Yr.</th> <th style="width: 50%;">Mo./Day/Yr.</th> </tr> </thead> <tbody> <tr><td> </td><td> </td></tr> <tr><td> </td><td> </td></tr> <tr><td> </td><td> </td></tr> <tr><td> </td><td> </td></tr> <tr><td> </td><td> </td></tr> <tr><td> </td><td> </td></tr> </tbody> </table>	Mo./Day/Yr.	Mo./Day/Yr.												
Mo./Day/Yr.	Mo./Day/Yr.																
City Project No.	Zone Map No.		Sheet														
7839.92	G-14, G-15		4 of 9														

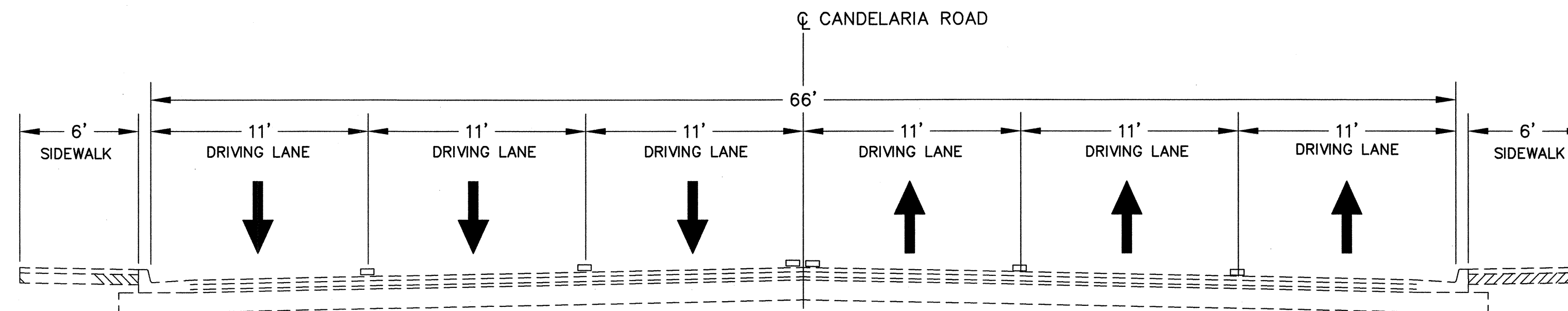

CANDELARIA ROAD EXISTING TYPICAL ROADWAY SECTION

NTS
STA 10+00.00 TO STA 15+98.98

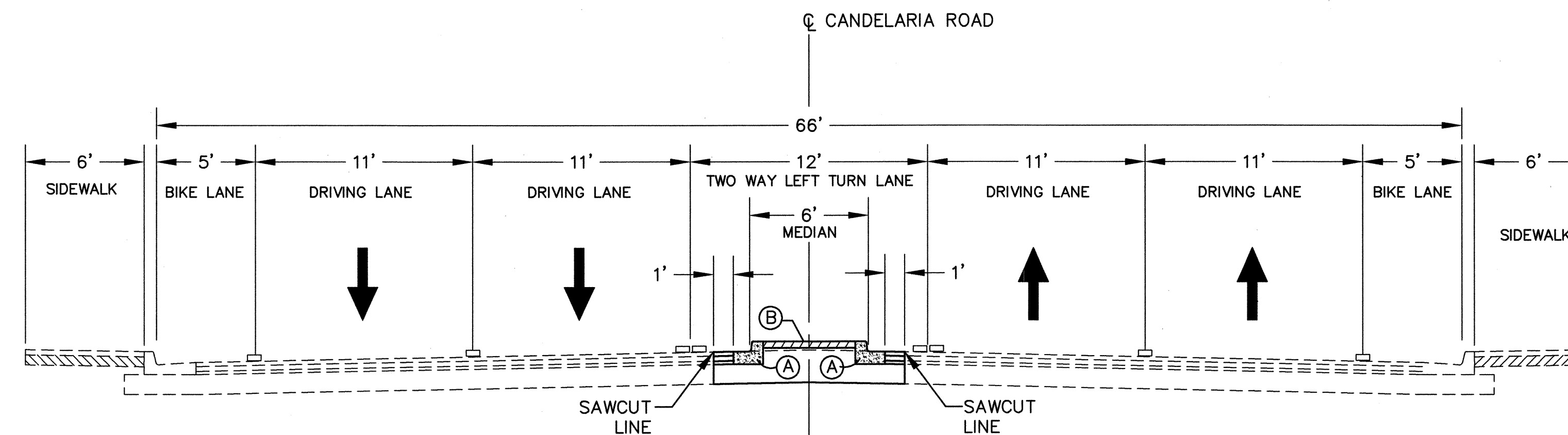

CANDELARIA ROAD PROPOSED TYPICAL ROADWAY SECTION

NTS
STA 12+26.31 TO STA 13+19.58
STA 13+53.98 TO STA 14+47.25
STRIPED 12' TWO WAY LEFT TURN LANE - 2ND STREET TO BROADWAY BLVD.

Ⓐ MEDIAN CURB & GUTTER PER
COA STD DWG 2415B

Ⓑ MEDIAN PCC PER
COA STD DWGS 2408 & 2502

**WILSON
& COMPANY**

		CITY OF ALBUQUERQUE	
		DEPARTMENT OF MUNICIPAL DEVELOPMENT	
		TRANSPORTATION DIVISION	
CANDELARIA ROAD RAIL CROSSING IMPROVEMENTS			
EXISTING & PROPOSED TYPICAL SECTIONS			
Design Review Committee	City Engineer Approval	Last Design Update	Mo./Day/Yr.
APPROVED OCT 22 2007 DESIGN REVIEW COMMITTEE	APPROVED OCT 22 2007 CITY ENGINEER		
City Project No.	Zone Map No.	Sheet	
7839.92	G-14, G-15	5 of 9	

ENGINEER'S SEAL		SURVEY INFORMATION		BENCH MARKS		AS-BUILT INFORMATION	
	NO.	DATE	BY	ACS STATION BEING A BRASS TABLET STAMPED "6-GH5 1979" SET IN A TRAFFIC SIGNAL BOX, 0.6' BELOW THE GROUND. FROM THE INTX. OF CANDELARIA RD. & I-25, GO WEST 0.8 MI. TO THE AT & SF R.R.. THE STATION IS ON THE EAST SIDE OF THE RR (N) OF CANDELARIA (2nd-Order)		CONTRACTOR AS BUILT INFORMATION	
				STAMPED "6-GH5 1979" SET IN A TRAFFIC SIGNAL BOX, 0.6' BELOW THE GROUND. FROM THE INTX. OF CANDELARIA RD. & I-25, GO WEST 0.8 MI. TO THE AT & SF R.R.. THE STATION IS ON THE EAST SIDE OF THE RR (N) OF CANDELARIA (2nd-Order)		CONTRACTOR AS BUILT INFORMATION	
				STAMPED "6-GH5 1979" SET IN A TRAFFIC SIGNAL BOX, 0.6' BELOW THE GROUND. FROM THE INTX. OF CANDELARIA RD. & I-25, GO WEST 0.8 MI. TO THE AT & SF R.R.. THE STATION IS ON THE EAST SIDE OF THE RR (N) OF CANDELARIA (2nd-Order)		CONTRACTOR AS BUILT INFORMATION	
				STAMPED "6-GH5 1979" SET IN A TRAFFIC SIGNAL BOX, 0.6' BELOW THE GROUND. FROM THE INTX. OF CANDELARIA RD. & I-25, GO WEST 0.8 MI. TO THE AT & SF R.R.. THE STATION IS ON THE EAST SIDE OF THE RR (N) OF CANDELARIA (2nd-Order)		CONTRACTOR AS BUILT INFORMATION	
REVISIONS	NO.	DATE	BY	REVISIONS		REVISIONS	
WILSON & COMPANY, ENGINEERS & ARCHITECTS				WILSON & COMPANY, ENGINEERS & ARCHITECTS		WILSON & COMPANY, ENGINEERS & ARCHITECTS	
DESIGNED BY	SGG	DATE	2007	DESIGNED BY		DESIGNED BY	
DRAWN BY	ELO	DATE	2007	DRAWN BY		DRAWN BY	
CHECKED BY	DDM	DATE	2007	CHECKED BY		CHECKED BY	

CENTERLINE OF CONSTRUCTION					PROJECT GROUND COORDINATES (FT)	
REF.	DESCRIPTION	STATION	BEARING	DISTANCE	NORTHING	EASTING
CANDELARIA ROAD						
3-2	BOP IS ALSO PC CURVE NO. 1	10+00			1499131.6532	83588.0520
3-2,3-3	COURSE FOR PC TO PI		S71°58'29"E	299.72'		
3-3	PI	12+99.72			1499038.9086	83873.0624
3-3	COURSE FOR PI TO PT		S66°27'56"E	299.72'		
3-3	EOP IS ALSO PT CURVE NO. 1	15+98.98			1498919.2303	84147.8526

CURVE TABLE CENTERLINE OF CONSTRUCTION						
CURVE	LENGTH	RADIUS	TANGENT	DELTA	EXTERNAL	MID-ORD
(C1)	598.98'	6229.52'	299.72'	05° 30'33"	7.21'	7.20'

BENCHMARK:
ACS CONTROL STATION "6-G15" STANDARD A.C.S. BRASS TABLE STAMPED "6-G15, 1979" SET IN A TRAFFIC SIGNAL BOX, 0.6' BELOW THE GROUND.
NEW MEXICO STATE PLANE COORDINATES (CENTRAL ZONE)
X=1499044.892 Y=383949.088 ELEV=4975.80 (SLD 1929)
GROUND-TO-GRID FACTOR=0.9996775 DELTA ALPHA=(-)0°13'24.5" (NAD 1927)

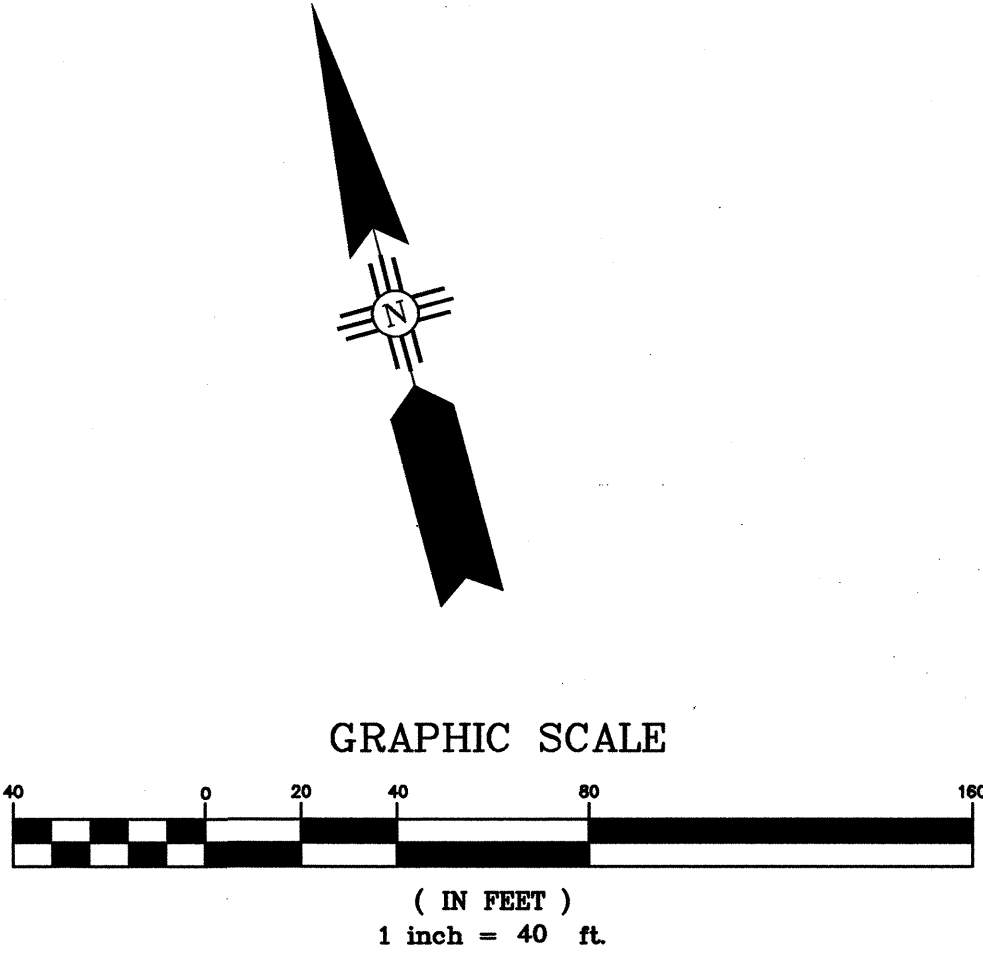
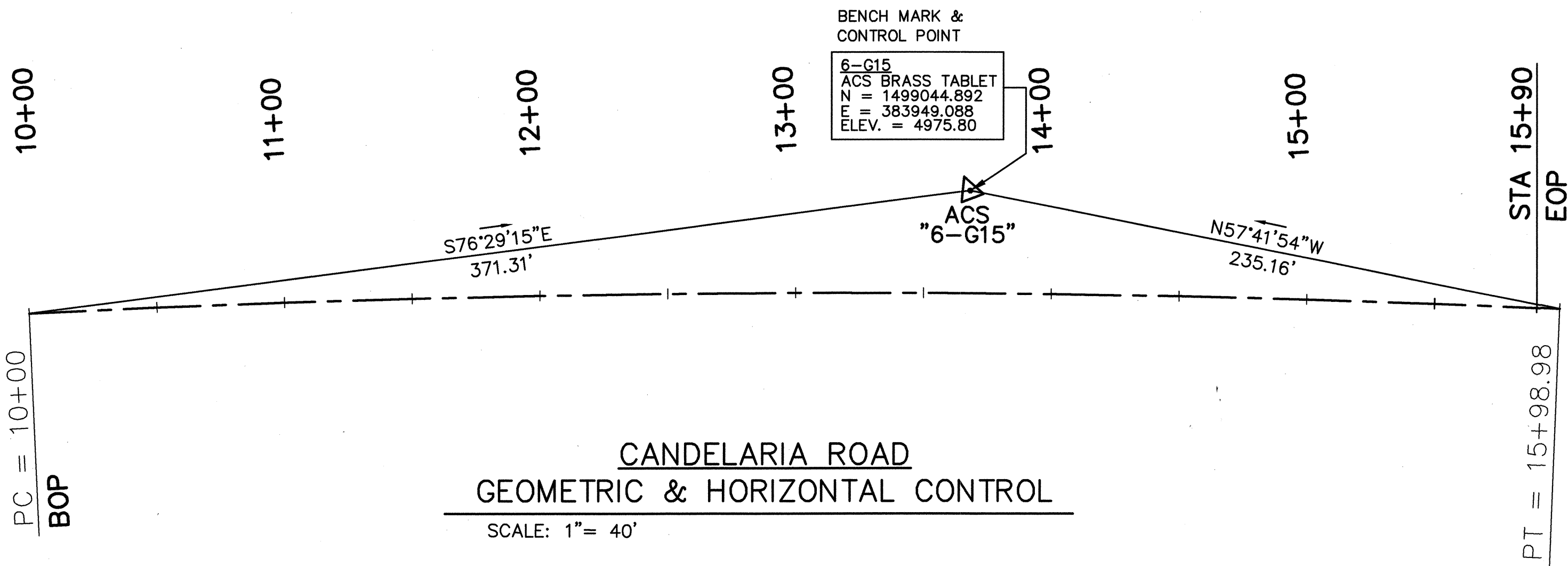

WILSON
& COMPANY

CITY OF ALBUQUERQUE DEPARTMENT OF MUNICIPAL DEVELOPMENT TRANSPORTATION DIVISION			
CANDELARIA ROAD RAIL CROSSING IMPROVEMENTS GEOMETRIC & HORIZONTAL CONTROL PLAN			
Design Review Committee APPROVED OCT 22 2007 DESIGN REVIEW COMMITTEE	City Engineer Approval APPROVED OCT 22 2007 CITY ENGINEER	Last Design Update	Mo./Day/Yr. Mo./Day/Yr.
City Project No. 7839.92	Zone Map No. G-14, G-15	Sheet 6 of 9	

ENGINEER'S SEAL		SURVEY INFORMATION		BENCH MARKS		AS-BUILT INFORMATION	
		NO.	BY	DATE	ACS STATION BEING A BRASS TABLE STAMPED "6-G15 1979" SET IN A TRAFFIC SIGNAL BOX, 0.6' BELOW THE GROUND. FROM THE INTX. OF CANDELARIA RD. & I-25, GO WEST 0.8 mi. TO THE AT & SF R.R.. THE STATION IS ON THE EAST SIDE OF THE RR (N) OF CANDELARIA (2nd-Order)	CONTRACTOR AS HURD & SONS	DATE 10/07
		REVISIONS	BY	DATE		INSPECTOR ACCURATE SURVEY	DATE 11/07
		WILSON & COMPANY, ENGINEERS & ARCHITECTS		DATE		FIELD CORP. CSD	DATE 11/07
		DESIGNED BY SGG		DATE 2007		RECORDED BY WILSON & CO	DATE 11/07
		DRAWN BY ELO		DATE 2007		MICRO-FILM INFORMATION	
		CHECKED BY DDM		DATE 2007			

CANDELARIA ROAD

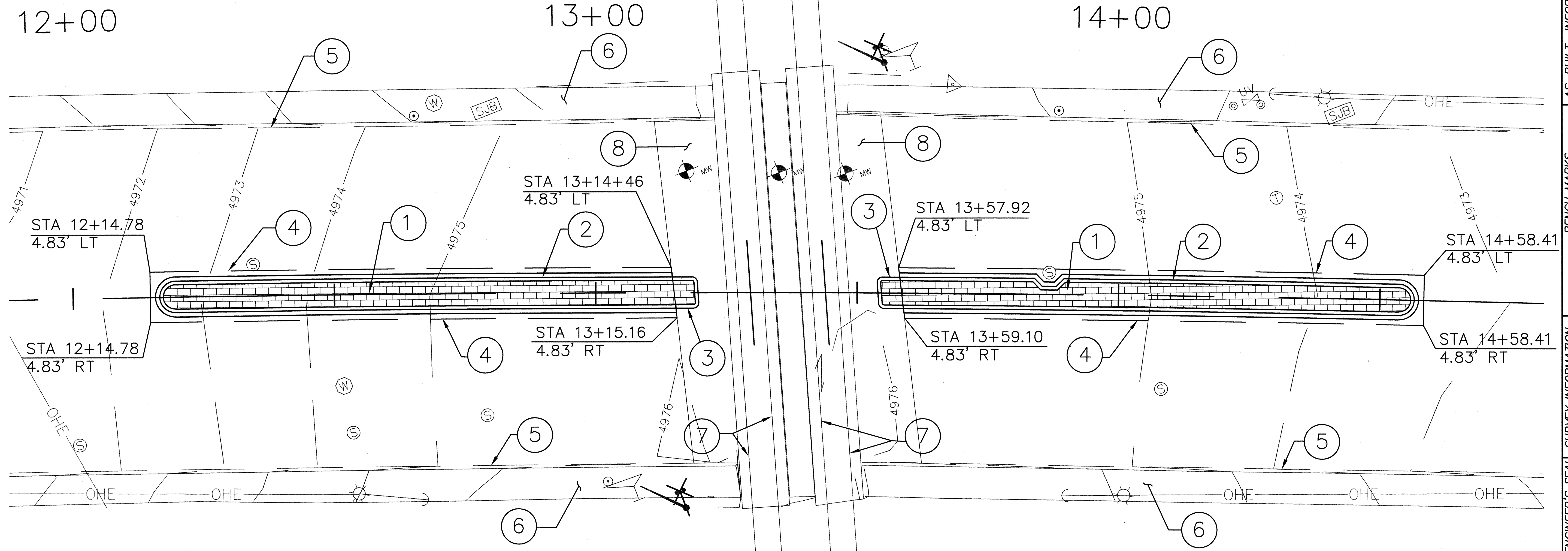

KEYED NOTES:

- 1 BUILD MEDIAN PCC AS PER COA STD DWG'S 2502 AND 2408.
- 2 BUILD MEDIAN CURB & GUTTER AS PER COA STD DWG 2415B.
- 3 BUILD TYPE II PINNED CURB AS PER COA STD DWG 2415B. SEE SHEET 8 of 9 FOR GEOMETRY AND FL ELEVATIONS.
- 4 SAWCUT LINE FOR EXISTING ASPHALT PAVEMENT REMOVAL, 1 FT. FROM THE LIP OF PROPOSED MEDIAN C&G
- 5 EXISTING CURB & GUTTER TO REMAIN.
- 6 EXISTING SIDEWALK TO REMAIN.
- 7 EXISTING RAIL TO REMAIN.
- 8 EXISTING CONCRETE APPROACH TO REMAIN.

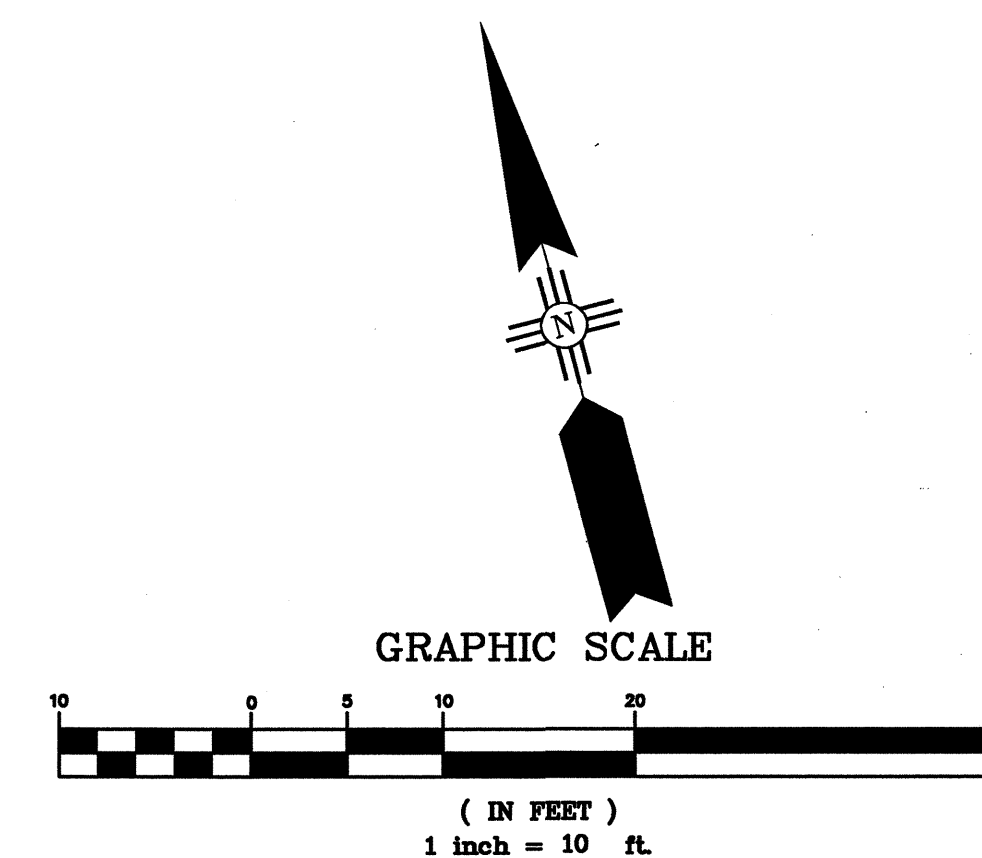

WILSON & COMPANY

CITY OF ALBUQUERQUE DEPARTMENT OF MUNICIPAL DEVELOPMENT TRANSPORTATION DIVISION	
CANDELARIA ROAD RAIL CROSSING IMPROVEMENTS GRADING PLAN	
Design Review Committee APPROVED OCT 22 2007 DESIGN REVIEW COMMITTEE	City Engineer Approval APPROVED OCT 22 2007 CITY ENGINEER
City Project No. 7839.92	Zone Map No. G-14, G-15
Sheet 7 of 9	

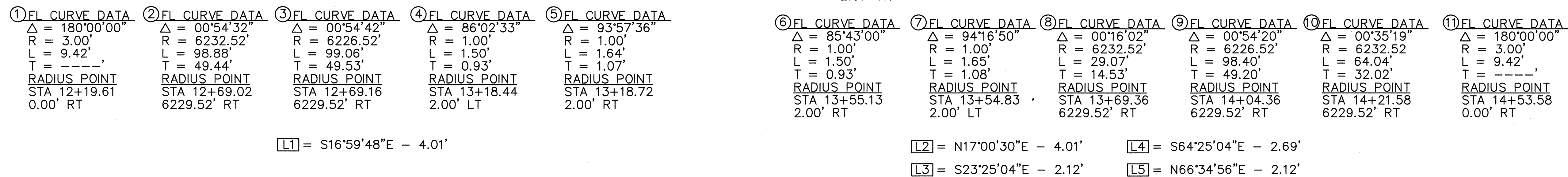

ENGINEER'S SEAL		SURVEY INFORMATION		BENCH MARKS		AS-BUILT INFORMATION	
	NO.	DATE	BY	ACS STATION BEING A BRASS TABLET STAMPED "6-G15 1979" SET IN A TRAFFIC SIGNAL BOX, 0.6' BELOW THE GROUND, FROM THE INTX. OF CANDELARIA RD. & I-25, GO WEST 0.8 MI. TO THE AT & SF R.R.. THE STATION IS ON THE EAST SIDE OF THE RR (N) OF CANDELARIA (2nd-Order)	CONTRACTOR	DATE	BY
REMARKS	DATE	DATE	DATE	DATE	DATE	DATE	DATE
DESIGNED BY	SGG	DATE	2007	DATE	2007	DATE	2007
DRAWN BY	ELO	DATE	2007	DATE	2007	DATE	2007
CHECKED BY	DDM	DATE	2007	DATE	2007	DATE	2007

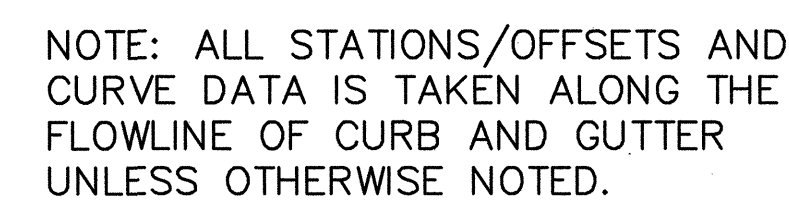

LOC	STATION	OFFSET	FL ELEV.
LT	12+19.61	3.00	4972.64
LT	12+50.00	3.00	4974.17
LT	13+00.00	3.00	4975.77
LT	13+14.67	3.00	match exist. PCC
LT	13+58.15	3.00	match exist. PCC
LT	13+83.89	3.00	4975.51
LT	13+89.57	3.00	4975.51
LT	14+00.00	3.00	4975.15
LT	14+53.58	3.00	4973.55

LOC	STATION	OFFSET	FL ELEV.
RT	12+19.61	3.00	4972.71
RT	12+50.00	3.00	4974.23
RT	13+00.00	3.00	4975.77
RT	13+15.35	3.00	match exist. PCC
RT	13+58.88	3.00	match exist. PCC
RT	14+00.00	3.00	4975.15
RT	14+53.58	3.00	4973.54

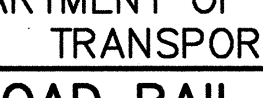

	CITY OF ALBUQUERQUE DEPARTMENT OF MUNICIPAL DEVELOPMENT TRANSPORTATION DIVISION															
CANDELARIA ROAD RAIL CROSSING IMPROVEMENTS MEDIAN GEOMETRIC PLAN																
Design Review Committee	City Engineer Approval	<table border="1" style="width: 100%; border-collapse: collapse;"> <tr> <th style="width: 50%;">Mo./Day/Yr.</th> <th style="width: 50%;">Mo./Day/Yr.</th> </tr> <tr><td> </td><td> </td></tr> <tr><td> </td><td> </td></tr> <tr><td> </td><td> </td></tr> <tr><td> </td><td> </td></tr> <tr><td> </td><td> </td></tr> <tr><td> </td><td> </td></tr> </table>	Mo./Day/Yr.	Mo./Day/Yr.												
Mo./Day/Yr.	Mo./Day/Yr.															
<div style="border: 1px solid black; padding: 10px; width: 100%;">  <p style="font-size: 0.8em;">DESIGN REVIEW COMMITTEE</p> </div>	<div style="border: 1px solid black; padding: 10px; width: 100%;">  <p style="font-size: 0.8em;">CITY ENGINEER</p> </div>	Least Update														
City Project No.	Zone Map No.	Sheet														
7839.92	G-14, G-15	8 of 9														

[illegible]

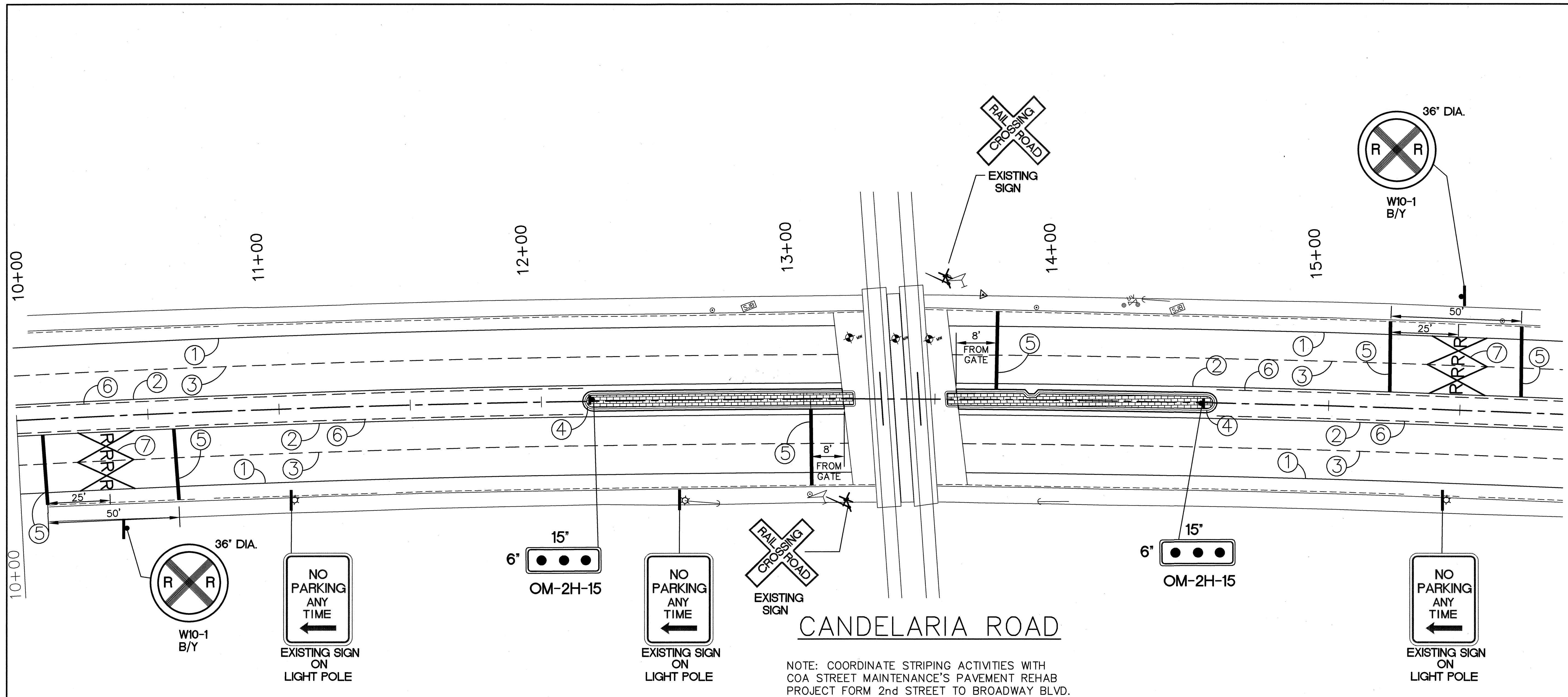

STRIPING KEY

- ① 6" SOLID WHITE REFLECTORIZED THERMOPLASTIC STRIPE
- ② 4" SOLID YELLOW REFLECTORIZED THERMOPLASTIC STRIPE
- ③ 4" BROKEN WHITE REFLECTORIZED THERMOPLASTIC STRIPE (10' STRIPE, 30' SPACE)
- ④ MEDIAN NOSE PAINTED SOLID YELLOW (PC TO PT)
- ⑤ 24" SOLID WHITE REFLECTORIZED THERMOPLASTIC STRIPE
- ⑥ 4" BROKEN YELLOW REFLECTORIZED THERMOPLASTIC STRIPE (10' STRIPE, 30' SPACE)
- ⑦ WHITE REFLECTORIZED RR CROSSING PAVEMENT MARKINGS PER MUTCD.

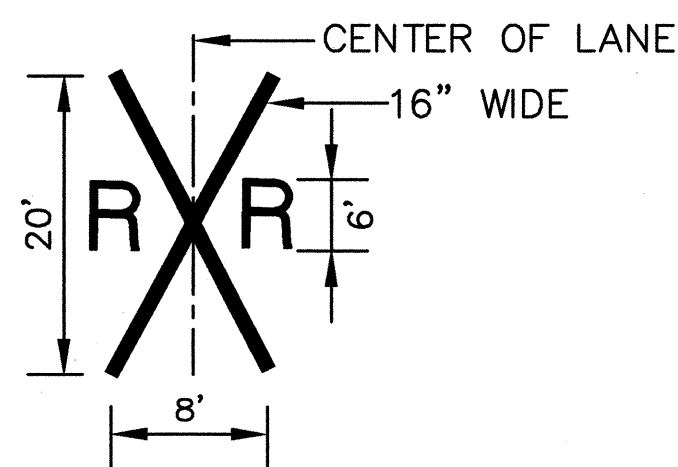

NOTE: COORDINATE STRIPING ACTIVITIES WITH COA STREET MAINTENANCE'S PAVEMENT REHAB PROJECT FROM 2nd STREET TO BROADWAY BLVD.

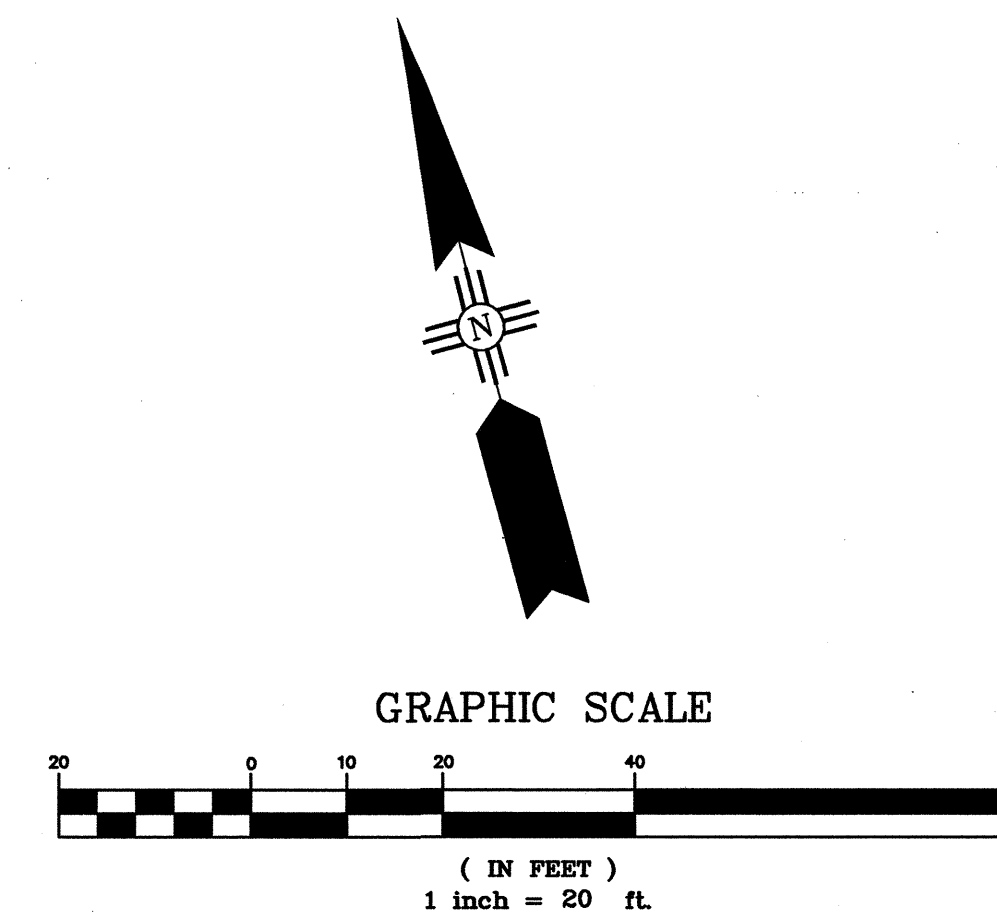

WILSON & COMPANY

CITY OF ALBUQUERQUE DEPARTMENT OF MUNICIPAL DEVELOPMENT TRANSPORTATION DIVISION			
CANDELARIA ROAD RAIL CROSSING IMPROVEMENTS STRIPING & SIGNING PLAN			
Design-Review Committee APPROVED OCT 22 2007 DESIGN REVIEW COMMITTEE	City Engineer Approval APPROVED OCT 22 2007 CITY ENGINEER	Mo./Day/Yr. Mo./Day/Yr.	Mo./Day/Yr. Mo./Day/Yr.
City Project No. 7839.92	Zone Map No. G-14, G-15	Sheet 9 of 9	

ENGINEER'S SEAL		SURVEY INFORMATION		BENCH MARKS		AS-BUILT INFORMATION	
	NO.	DATE	BY	ACS STATION BEING A BRASS TABLET STAMPED "6-GT5 1979" SET IN A TRAFFIC SIGNAL BOX, 0.6' BELOW THE GROUND, FROM THE INTX. OF CANDELARIA RD. & I-25, GO WEST 0.8 MI. TO THE AT & SF R.R.. THE STATION IS ON THE EAST SIDE OF THE RR (N) OF CANDELARIA (2nd-Order)	CONTRACTOR AS NOTED BY DDC	INSPECTOR'S DATE 10/17	DATE 11/07
REMARKS	DATE	DATE	DATE	DATE	DATE	DATE	DATE
DESIGNED BY WILSON & COMPANY, ENGINEERS & ARCHITECTS	SGG	2007	2007	2007	2007	2007	2007
DRAWN BY ELO	2007	2007	2007	2007	2007	2007	2007
CHECKED BY DDM	2007	2007	2007	2007	2007	2007	2007