

LEGEND

- EXISTING CURB & GUTTER
- EXISTING SIDEWALK
- EXISTING EASEMENT LINE
- EXISTING CONTOUR MAJOR
- EXISTING CONTOUR MINOR
- NEW BOUNDARY LINE
- NEW RIGHT OF WAY LINE
- NEW ADJOINER LINE
- NEW CENTER LINE
- NEW EASEMENT LINE
- NEW SIDEWALK
- NEW STANDARD CURB & GUTTER
- NEW ROLL CURB & GUTTER
- CROWN TO NO CROWN TRANSITION
- NEW STREET LIGHT
- DEPRESSED LANDSCAPED AREAS
- DEPRESSED EASEMENT AREAS

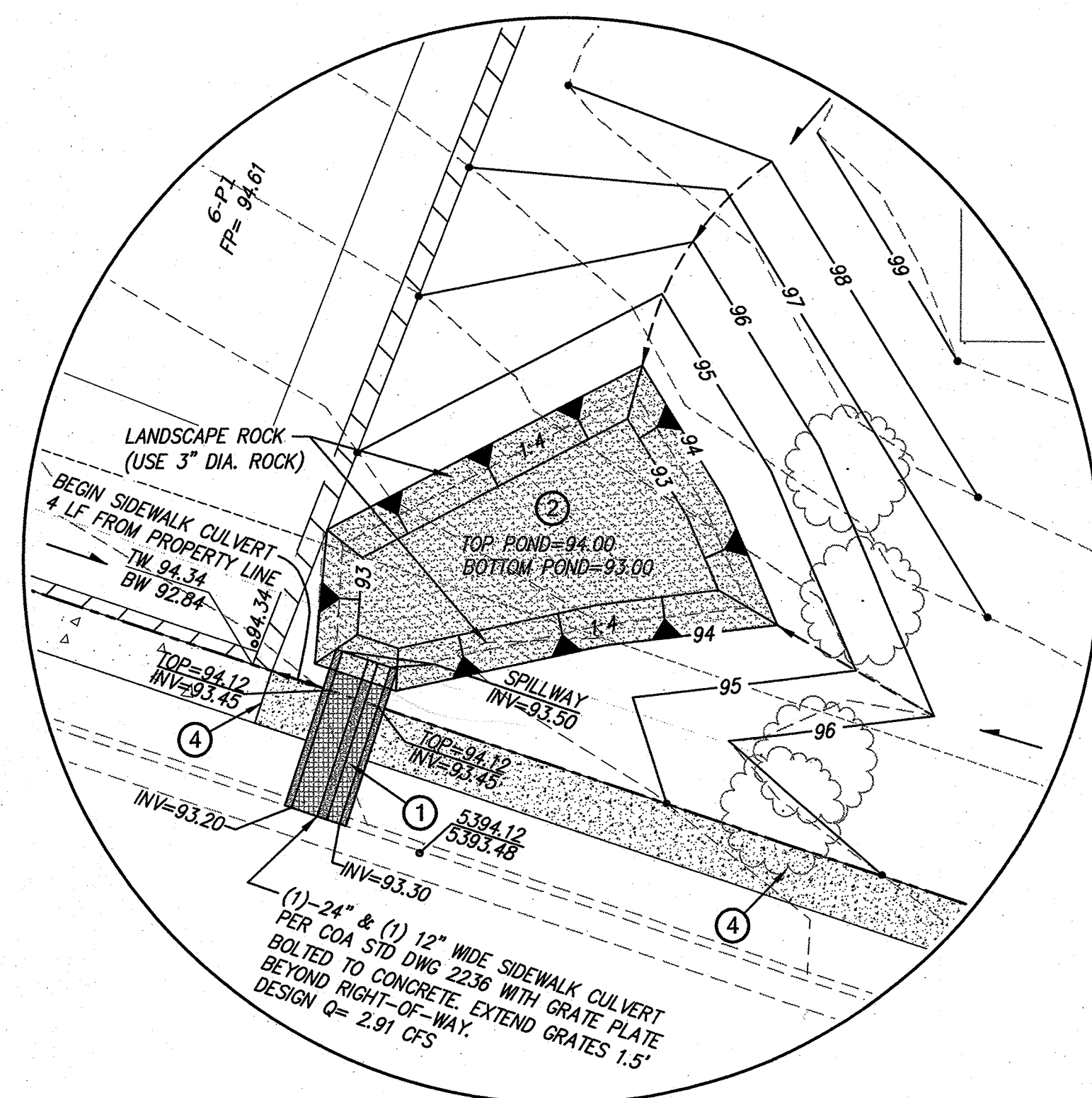
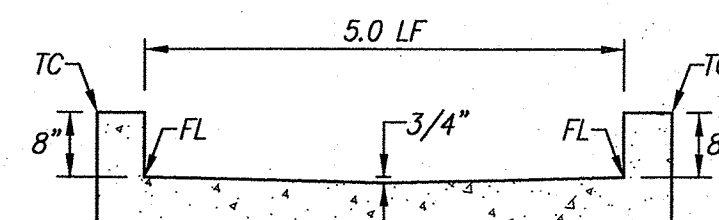
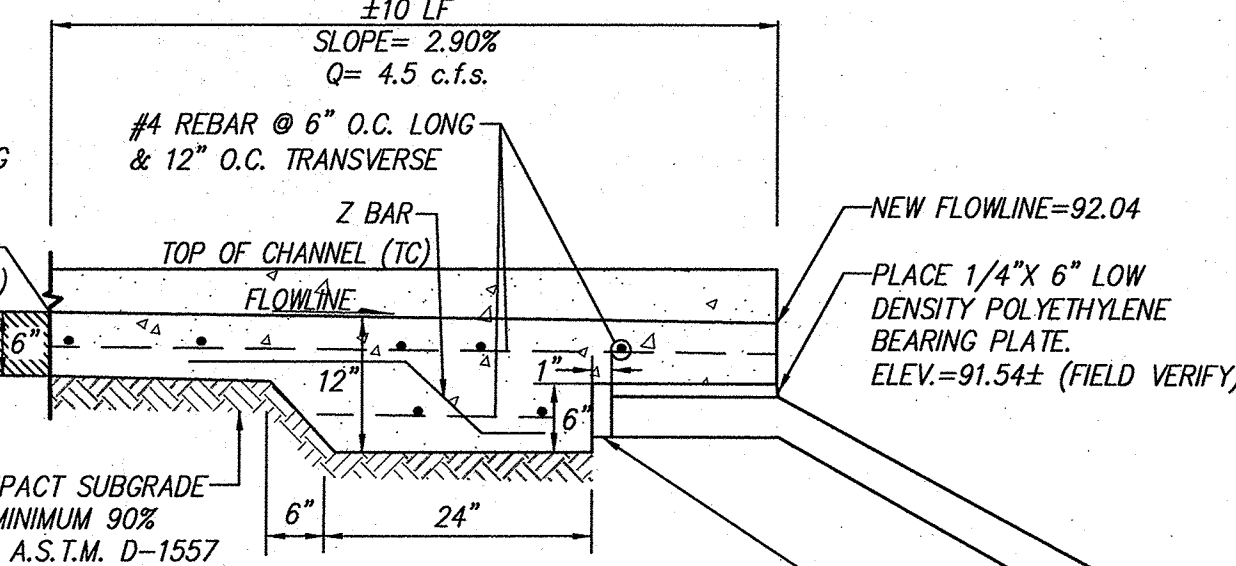

STATEMENT CERTIFICATION:

I, Jeffrey T. Wooten, P.E., of Wooten Engineering, do hereby certify to the best of my knowledge and belief, that the infrastructure designed by: **WOOTEN ENGINEERING** (Engineer of Record), with observation services performed by: **SPINELLO-DCS, LLC** (Part-time), was constructed in accordance with the plans and specifications approved by the City Engineer and that the original design intent of the approved plans has been met, except as noted on the Record Drawings. All warranties, guarantees and quality of work are the responsibility of the Contractor of record and their subcontractors. This Certification is based on the inspections conducted and the As-Built Survey performed by: _____ on _____

Signature: *[Signature]* Date: 8/13/2019
Jeffrey T. Wooten, P.E.
Wooten Engineering
(Sub-Consultant to Spinello-DCS, LLC)
NM PE 16892

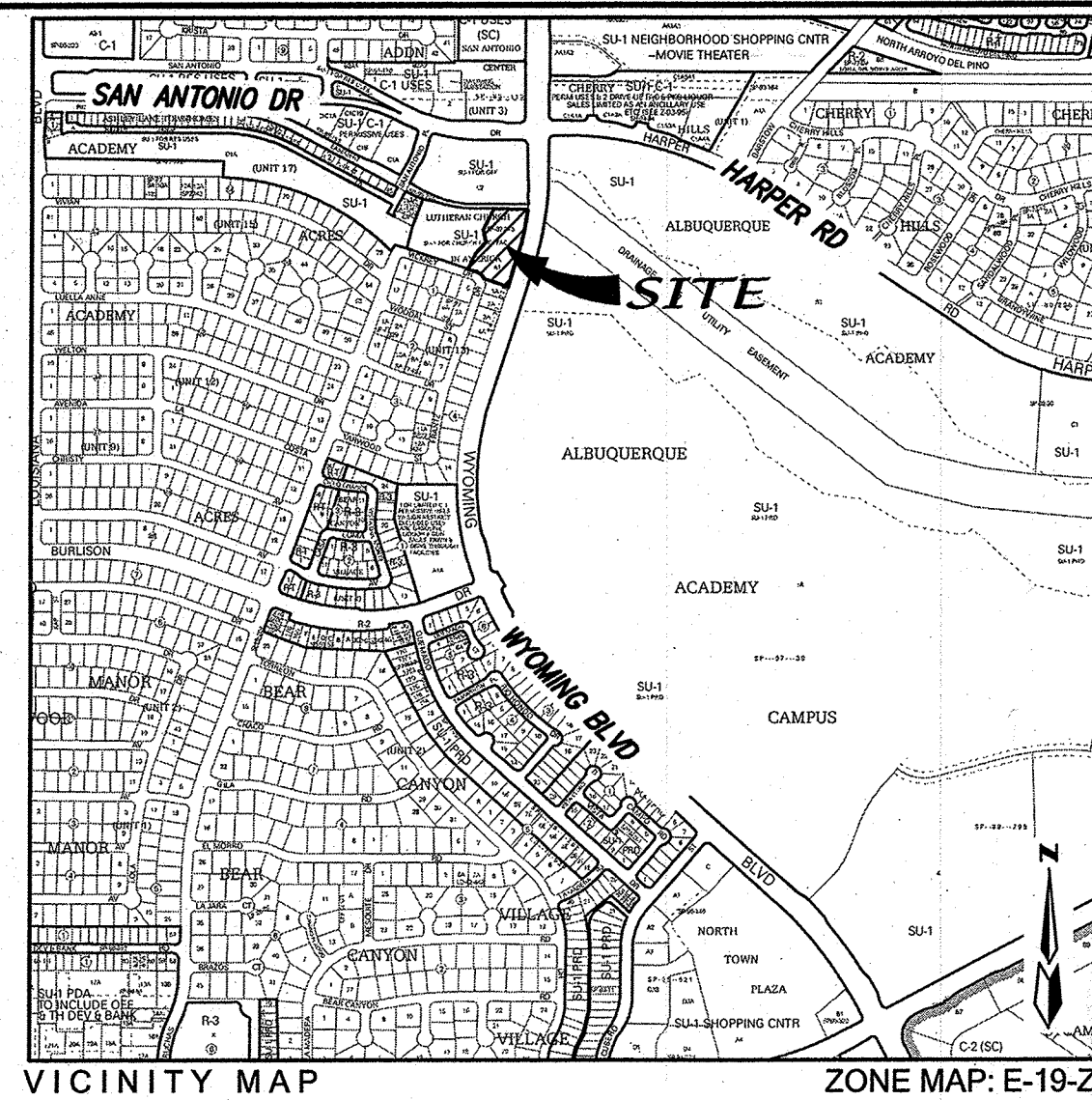

LEGAL DESCRIPTION

A TRACT OF LAND SITUATE WITHIN THE ELENA GALLEGOS GRANT, PROJECTED SECTION 30, TOWNSHIP 11 NORTH, RANGE 4 EAST, NEW MEXICO PRINCIPAL MERIDIAN, CITY OF ALBUQUERQUE, BERNALILLO COUNTY, NEW MEXICO, BEING ALL OF TRACT A-1-B, LANDS OF LUTHERAN CHURCH IN AMERICA, AS THE SAME IS SHOWN AND DESIGNATED ON SAID PLAT FILED FOR RECORD IN THE OFFICE OF THE COUNTY CLERK OF BERNALILLO COUNTY, NEW MEXICO ON 5/5/16, IN PLAT BOOK 2016C, PAGE 50, AND CONTAINING 1.9565 ACRES MORE OR LESS.

WORK ORDER CONSTRUCTION NOTES

- CONSTRUCT SIDEWALK CULVERTS PER C.O.A. STD DWG #2236, TACK WELD BOLTS TO PLATE.
- CONSTRUCT WATER HARVEST DETENTION POND PER DRAWING. POND SPILLWAY ELEVATION TRANSITIONS INTO SIDEWALK CULVERTS AT 5393.50' AS INDICATED ON THIS PLAN. POND TO BE ARMORED WITH 3" DIAMETER ROCK.
- CONSTRUCT NEW 5' WIDE RUNDOWN SPILLWAY INTO ARROYO PER DESIGN.
- CONSTRUCT NEW 4' WIDE SIDEWALK PER C.O.A. STD DWG #2430, TIE NEW SIDEWALK TO EXISTING SIDEWALK ON THE EAST NEAR LOT 1A ON FRANTZ DRIVE AND TO THE WEST OF THE NEW SIDEWALK AT LOT 6-P1 IN THE FRUITA DEL SOL SUBDIVISION. CROSS SLOPE ON SIDEWALK SHALL BE 2% AS INDICATED ON STD DWG. EXISTING BC TO SIDEWALK IS APPROXIMATELY 4.38 FEET. BEGIN SIDEWALK AT ROW/P.L. PER RECORDED FINAL PLAT.
- ALL WORK DETAILED ON THESE PLANS TO BE PERFORMED, EXCEPT AS OTHERWISE STATED OR PROVIDED HEREON, SHALL BE CONSTRUCTED IN ACCORDANCE WITH CITY OF ALBUQUERQUE STANDARD SPECIFICATIONS FOR PUBLIC WORKS CONSTRUCTION, 1986 EDITION THROUGH UPDATE #9, AND WILL BE REFERRED TO HEREIN AS "STANDARD SPECIFICATIONS".
- CURB AND GUTTER AND SIDEWALKS SHALL MATCH THE ELEVATIONS OF ADJUTING EXISTING AREAS AS SHOWN ON THE PLANS OR AS DIRECTED BY THE PROJECT ENGINEER.
- AN EXCAVATION/CONSTRUCTION PERMIT WILL BE REQUIRED BEFORE BEGINNING ANY WORK WITHIN CITY RIGHT-OF-WAY.
- AT CONTRACTORS EXPENSE, CONTRACTOR SHALL ASSUME RESPONSIBILITY FOR ANY DAMAGE TO EXISTING PAVEMENT, PAVEMENT MARKINGS, SIGNAGE, CURB AND GUTTER, HANDICAP RAMPS, AND SIDEWALK DURING CONSTRUCTION APART FROM THOSE SECTIONS INDICATED FOR REMOVAL ON THE PLANS AND SHALL REPAIR OR REPLACE PER STANDARD SPECIFICATIONS.
- TWO (2) WORKING DAYS PRIOR TO ANY EXCAVATION, CONTRACTOR MUST CONTACT NEW MEXICO ONE CALL SYSTEM (260-1990) FOR LOCATION OF EXISTING UTILITIES.

APPROVED RECORD DRAWINGS

City Inspector	Henry Blair
Contractor	Solis Brothers Construction
Construction Engineer	Muhammed Adebbe
Date	9/3/2019

MINI WORK ORDER

DRB CASE 1006844
DRAINAGE FILE: E19D021A

MARK GOODWIN & ASSOCIATES, P.A.
CONSULTING ENGINEERS
P.O. BOX 90606
ALBUQUERQUE, NEW MEXICO 87199
(505) 828-2200, FAX (505) 797-9539



CITY OF ALBUQUERQUE
PUBLIC WORKS DEPARTMENT

TITLE: **TRACT A-1-B
HOLY CROSS LUTHERAN CHURCH
DRAINAGE IMPROVEMENTS**

MINI WORK ORDER

APPROVALS	ENGINEER	DATE
DRC CHAIRMAN	<i>[Signature]</i>	5/16/19
HYDROLOGY	<i>[Signature]</i>	7/16/19

APPROVED FOR CONSTRUCTION

CITY ENGINEER

DATE: 10/26/16

DRB CASE NO: 1006844
DRAINAGE FILE: E19D021A

CITY PROJECT NO.
785372

ZONE MAP NO.
E-19

SHEET **1** OF **1**