

WATER METER ADDRESS: PENDING

CLASS 1 CONSTRUCTION (NOT FOR BID)

JUNE 2006

INDEX TO DRAWINGS

SHEET NUMBER	DESCRIPTION
1.	TITLE SHEET
2.	GRADING PLAN
3.	CONSTRUCTION AND LAYOUT PLAN
4.	PLANTING PLAN
5.	IRRIGATION PLAN

FOR INFORMATION ONLY

As-buils and Closeout package not submitted.
Construction verified by aerial imagery.

By: Jim Roeder Date: 12-31-2019

2.5 acres total
1.5 acres turf

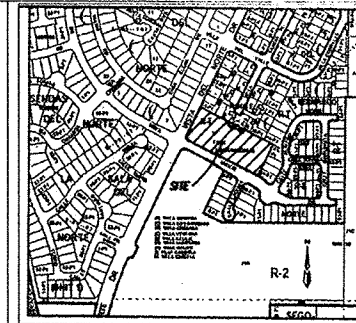

VICINITY MAP ZONE ATLAS E-16-Z

NOTICE TO CONTRACTORS

1. ALL WORK DELETED ON THESE PLANS IS TO BE PERFORMED UNDER TAB FOR HEREON, EXCEPT AS OTHERWISE STATED OR PROVIDED. FOR HEREON, SHALL BE CONSTRUCTED IN ACCORDANCE WITH THE CITY OF ALBUQUERQUE STANDARD SPECIFICATIONS FOR PUBLIC WORKS CONSTRUCTION, UPDATE 82 including Amendment #1.
2. TWO WORKING DAYS PRIOR TO ANY EXCAVATION, THE CONTRACTOR MUST CONTACT NEW MEXICO ONE CALL SYSTEM (260-1990) FOR LOCATION OF EXISTING UTILITIES.
3. PRIOR TO CONSTRUCTION, THE CONTRACTOR SHALL EXCAVATE AND VERIFY THE HORIZONTAL AND VERTICAL LOCATIONS OF ALL OBSTRUCTIONS. SHOULD A CONFLICT EXIST, THE CONTRACTOR SHALL NOTIFY THE ENGINEER OR SURVEYOR IMMEDIATELY SO THAT THE CONFLICT CAN BE RESOLVED WITH A MINIMUM AMOUNT OF DELAY.
4. FIVE (5) WORKING DAYS PRIOR TO BEGINNING CONSTRUCTION, THE CONTRACTOR SHALL SUBMIT TO CONSTRUCTION COORDINATION DIVISION A DETAILED CONSTRUCTION SCHEDULE. TWO (2) WORKING DAYS PRIOR TO CONSTRUCTION, THE CONTRACTOR SHALL OBTAIN A BARRICADING PERMIT FROM THE CONST. COORDINATION DIVISION. CONTRACTOR SHALL NOTIFY BARRIAGE ENGINEER (924-3400) PRIOR TO OCCUPYING AN INTERSECTION. REFER TO SECTION 19 OF THE GENERAL CONDITIONS OF THE STANDARD SPECIFICATIONS.
5. CONTRACTOR SHALL NOTIFY THE ENGINEER NOT LESS THAN SEVEN (7) DAYS PRIOR TO STARTING WORK IN ORDER THAT THE ENGINEER MAY TAKE NECESSARY MEASURES TO INSURE THE PRESERVATION OF SURVEY MONUMENTS. CONTRACTOR SHALL NOT DISTURB PERMANENT SURVEY MONUMENTS WITHOUT THE CONSENT OF THE ENGINEER AND SHALL NOTIFY THE ENGINEER AND BEAR THE EXPENSE OF REPLACING ANY THAT MAY BE DISTURBED WITHOUT PERMISSION. REPLACEMENT SHALL BE DONE ONLY BY THE CITY SURVEYOR. WHEN A CHANGE IS MADE IN THE FINISHED ELEVATIONS OF PAVEMENT OR ROADWAY WHICH AFFECTS A PERMANENT SURVEY MONUMENT IS LOCATED, CONTRACTOR SHALL, AT HIS OWN EXPENSE, ADJUST THE MONUMENT COVER TO THE NEW GRADE UNLESS OTHERWISE SPECIFIED. REFER TO SECTION 4.4 OF THE GENERAL CONDITIONS OF THE STANDARD SPECIFICATIONS.
6. CONTRACTOR SHALL COORDINATE WITH THE CITY OF ALBUQUERQUE WATER SYSTEMS DIVISION (857-8200) SEVEN (7) WORKING DAYS IN ADVANCE OF ANY WORK THAT MAY AFFECT EXISTING PUBLIC WATER OR SEWER UTILITIES OR VALVES. ROADWAY WORK WHICH AFFECTS WATER PERSONNEL ONLY, THE WATER SYSTEMS DIVISION (857-8200) WILL BE NOTIFIED BY THE CONTRACTOR SEVEN (7) WORKING DAYS IN ADVANCE OF ANY WORK WHICH MAY AFFECT THE EXISTING PUBLIC WATER FACILITIES. REFER TO SECTION 18 OF THE STANDARD SPECIFICATIONS.
7. ALL EXCAVATION, TRENCHING, AND SHORING ACTIVITIES MUST BE CARRIED-
ACCORDANCE WITH OSHA 29 CFR 1926.650 SUBPART P.

THE FOLLOWING NOTES ALSO APPLY WHEN CHECKED

- ☐ ALL UTILITIES AND UTILITY SERVICE LINES SHALL BE INSTALLED PRIOR TO PAVING.
- ☐ BACKFILL COMPACTION SHALL BE ACCORDING TO SPECIFIED STREET USE.
- ☐ TACK COAT REQUIREMENTS SHALL BE DETERMINED BY THE ENGINEER.
- ☐ SIDEWALKS AND WHEELCHAIR RAMPS WITHIN THE CURB RETURNS SHALL BE CONSTRUCTED WHEREVER A NEW CURB RETURN IS CONSTRUCTED.
- ☐ IF CURB IS DEPRESSED FOR A DRIVEPAD, THE DRIVEPAD SHALL BE CONSTRUCTED PRIOR TO ACCEPTANCE OF CURB AND GUTTER.
- ☐ ALL STORM DRAINAGE FACILITIES SHALL BE COMPLETED PRIOR TO FINAL ACCEPTANCE.
- ☐ THE REQUESTOR OR DEVELOPER SHALL BE RESPONSIBLE FOR REPAIR OR REPLACEMENT OF ALL CURBS AND GUTTER OR SIDEWALK DAMAGED AFTER APPROVAL BY THE CITY ENGINEER OF WORK COMPLETED BY THE CONTRACTOR.

CONTRACTOR SHALL
MAINTAIN A GRAFFITI-
FREE WORK SITE.
CONTRACTOR SHALL
PROMPTLY REMOVE
ANY AND ALL
GRAFFITI FROM SITE
EQUIPMENT,
WHETHER PERMANENT
OR TEMPORARY.

CONTRACTOR WILL BE RESPONSIBLE FOR PROVIDING AND MAINTAINING ALL CONSTRUCTION SIGNALING UNTILL PROJECT HAS BEEN ACCEPTED BY THE CITY.

THE HILLTOP
LANDSCAPE ARCHITECTS AND CONTRACTORS
7909 Edith Blvd. N.E.
ALBUQUERQUE, NEW MEXICO 87103
(505)898-9690

REV	SHEETS	CITY ENGINEER	DATE	USER DEPT.	DATE	USER DEPT.	DATE
LANDSCAPE ARCHITECTS STAMP & SIGNATURE			APPROVALS	ENGINEER	DATE	*****	
	DRC Chairman		<i>William G. Dukes</i>		<i>6/17/06</i>	APPROVED FOR CONSTRUCTION	
	Transportation		<i>WGD</i>		<i>6/30/06</i>		
	Water/Wastewater		<i>William G. Dukes</i>		<i>6/17/06</i>		
	Hydrology		<i>Bradley B. B.</i>		<i>6/27/06</i>		
	Parks						
Constr. Coord.						<i>Bill Dukes</i> City Engineer Date	
CITY PROJECT NO.					785481	SHEET 1 of 5	

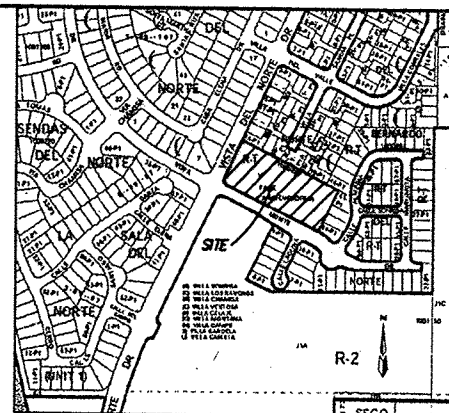
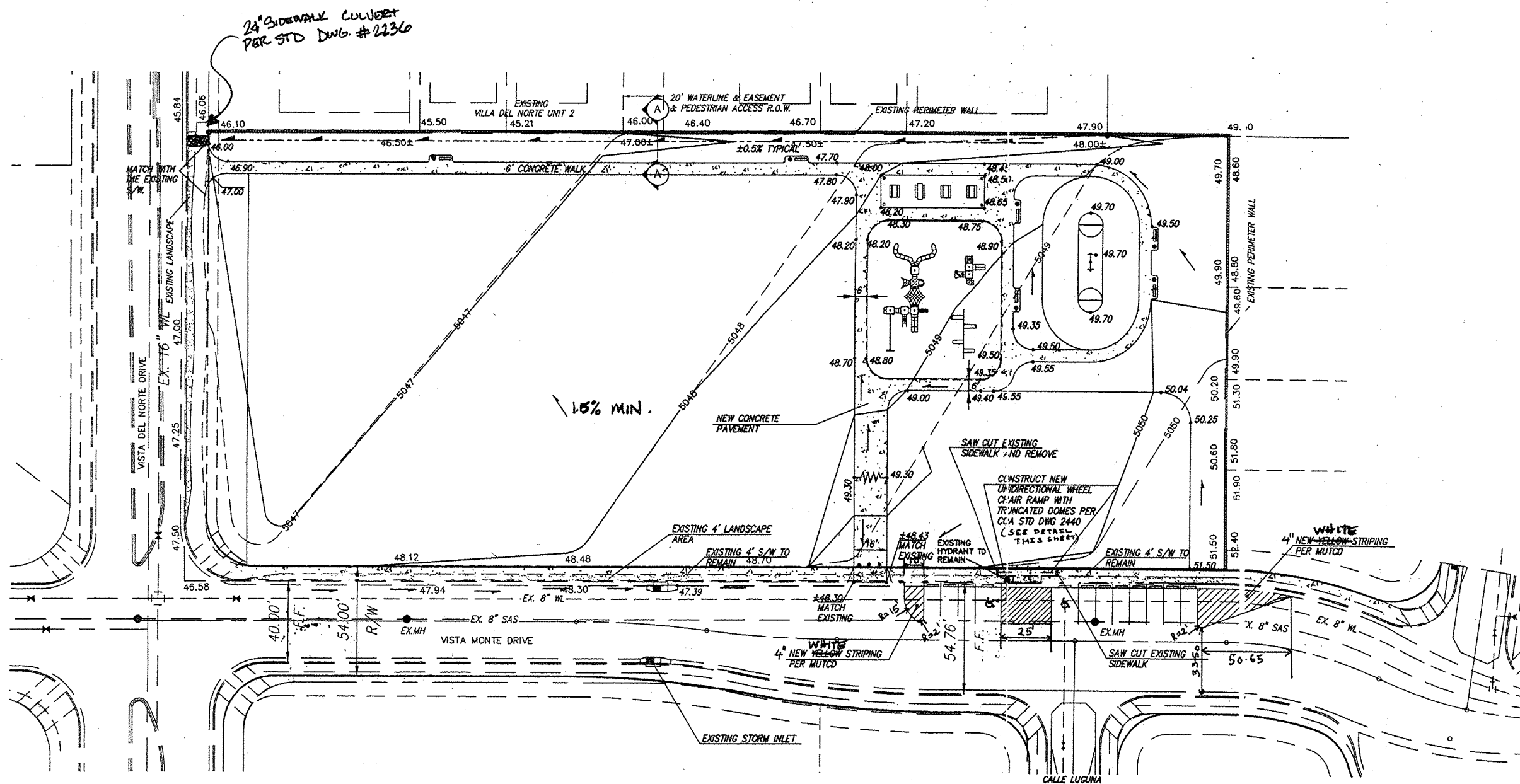

VICINITY MAP ZONE MAP: E-18

LEGAL DESCRIPTION
TRACT 'V', VILLA DEL NORTE.

NOTES
1. TRANSITION NEW PEDESTRIAN PATHS TO MATCH EXISTING AT STREET RIGHT-OF-WAYS (MAX. SLOPE=5.00%)

LEGEND

- EXISTING M. VALVE
- EXISTING SAS MH
- EXISTING WATER LINE
- EXISTING SANITARY LINE
- EXISTING SPOT ELEVATION
- EXISTING CONTOUR
- EXISTING PERIMETER WALL
- PROPOSED SPOT ELEVATION
- PROPOSED CONTOUR
- FLOW ARROW
- PROPOSED SWALE

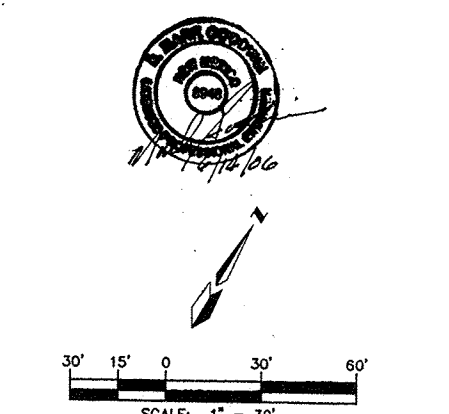

MARK GOODWIN & ASSOCIATES, P.A. CONSULTING ENGINEERS P.O. BOX 90606 ALBUQUERQUE, NEW MEXICO 87199 (505) 828-2200, FAX (505) 797-9539	
CITY OF ALBUQUERQUE PUBLIC WORKS DEPARTMENT	
TITLE: GRADING PLAN BERNARDO TRAILS CITY PARK AT VISTA DEL NORTE	
DESIGN-REVIEW COMMITTEE	CITY ENGINEER APPROVAL
DESIGNED BY DMG	DATE 8/05
DRAWN BY SV	DATE 8/05
CHECKED BY DMG	DATE 8/05
CITY PROJECT NO. 785481	ZONE MAP NO. E-16
SHEET 2 OF 5	

I. INTRODUCTION
PLANS CALL FOR THE DEVELOPMENT OF A NEW PUBLIC PARK TO BE DEVELOPED ON A CURRENTLY VACANT, APPROXIMATELY 2.5 ACRE, SITE LOCATED AT THE NE CORNER OF VISTA DEL NORTE DRIVE & VISTA MONTE DRIVE WITHIN THE VISTA DEL NORTE DEVELOPMENT - REFER TO VICINITY MAP.

II. EXISTING DRAINAGE CONDITIONS
THE PROPOSED PARK SITE HAS PREVIOUSLY BEEN ROUGH GRADED RESULTING IN AN APPROXIMATE 1.00% SLOPE WHICH FALLS FROM THE SOUTHEAST TO THE NORTHWEST. HOMES EXIST ALONG THE EASTERN AND NORTHERN BOUNDARIES OF THE SITE. TWO EXISTING, FULLY DEVELOPED CITY STREETS, VISTA DEL NORTE DRIVE AND VISTA MONTE DRIVE FRONT THE SITE ON THE WEST AND SOUTH RESPECTIVELY. NO OFF-SITE RUNOFF CURRENTLY IMPACTS THIS SITE, AND THE SITE IS NOT WITHIN A FEMA DESIGNATED FLOOD PLAIN. STORM RUNOFF GENERATED FROM THIS SITE SHEET FLOWS TO THE NORTHWEST WHERE IT ULTIMATELY ENTERS THE VISTA DEL NORTE DRIVE RIGHT OF WAY DRIVE. ONCE THE ROADWAY, FLOWS ARE ROUTED TO THE NORTH TO EXISTING DROP INLETS LOCATED ALONG VISTA DEL NORTE JUST UPSTREAM OF THE VILLA DEL VALLE INTERSECTION. CALCULATIONS INDICATE THAT IN A 100-YEAR, 6 HOUR STORM EVENT, A TOTAL OF 6.26 CFS WOULD ENTER VISTA DEL NORTE DRIVE FROM THIS SITE.

III. PROPOSED CONDITIONS
OFF THE 2.5 ACRES, APPROXIMATELY 1.3 ACRES ARE TO BE DEVELOPED INTO A PRACTICE SOCCER FIELD AND A SANDED BOTTOM CHILDREN'S PLAY AREA. A 6' WIDE CONCRETE PATHWAY IS PLANNED ALONG THE PERIMETER OF THE SOCCER FIELD AND PLAY AREA. A CRIMPED STRAW MULCH WILL BE APPLIED TO THE REMAINDER OF THE SITE, WHICH WILL OTHERWISE BE LEFT UNDEVELOPED. DEVELOPED HYDROLOGICAL CALCULATIONS SHOW THAT UPON IMPROVING THE SITE AN ANTICIPATED 5.66 CFS WILL, LIKE IN THE EXISTING STATE, SURFACE DISCHARGE TO THE VISTA DEL NORTE RIGHT OF WAY. AGAIN, AS IN THE EXISTING STATE, THE FLOW WILL TRAVEL NORTH IN THE ROADWAY AND BE INTERCEPTED BY EXISTING INLETS.

IV. SUMMARY
WITH THE DEVELOPMENT OF THIS SITE IN THE MANNER PRESENTED, THE VOLUME OF THE STORM RUNOFF FROM THE SITE ACTUALLY DECREASES, WHICH ENSURES THAT THERE WILL BE NO ADVERSE IMPACTS DOWN STREAM.

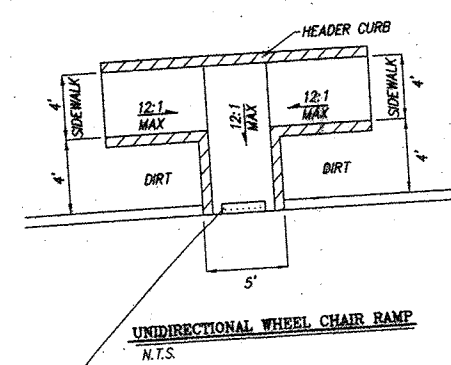
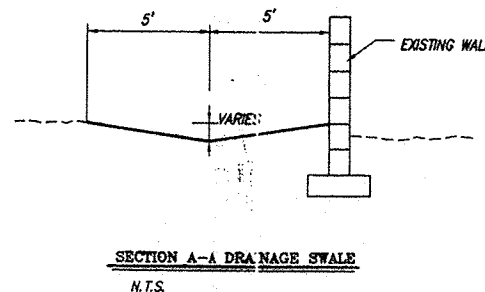

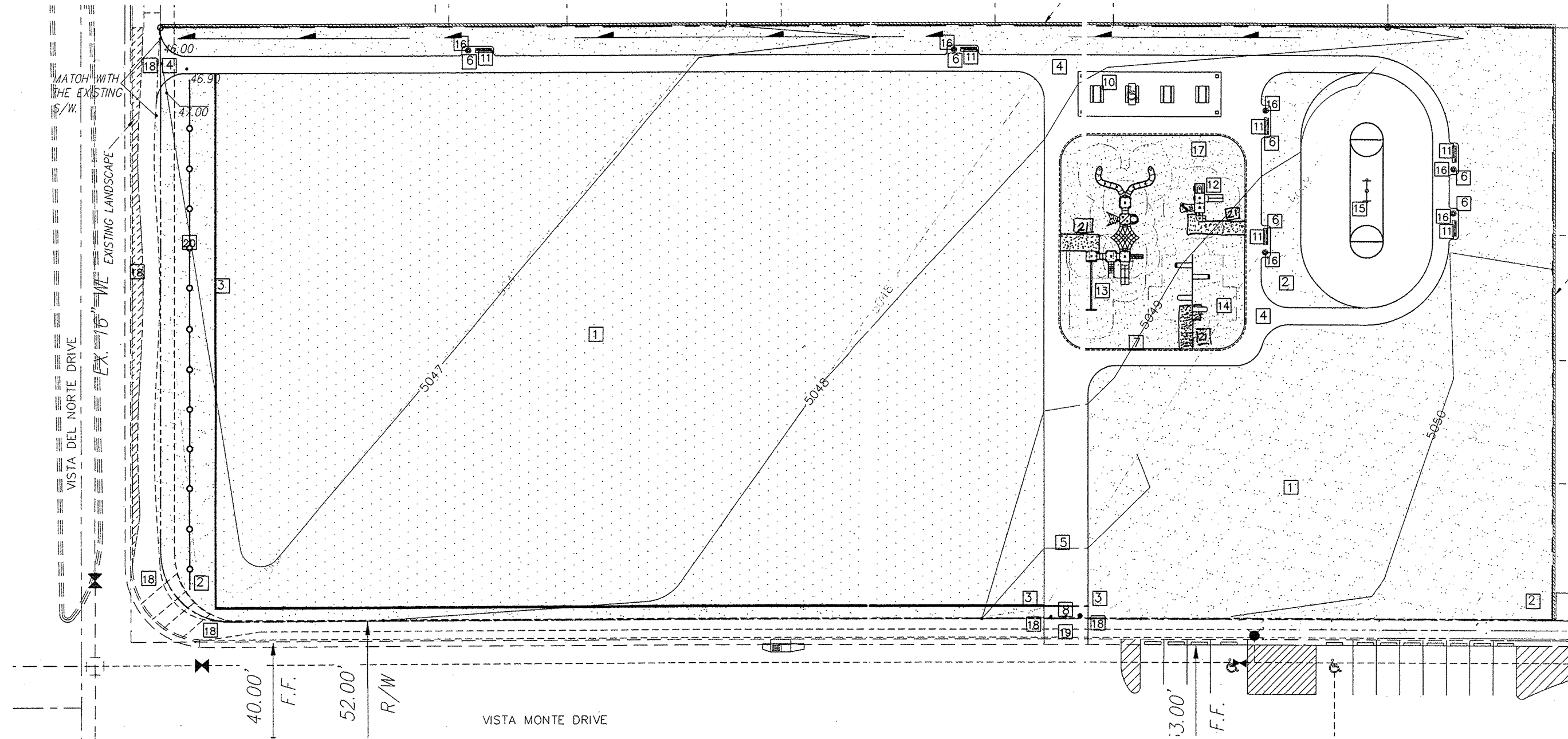

LEGEND

- | | | | |
|----|---|----|--|
| 1 | SOD LAWN (SEE SECTION 1010 OF COA SPEC.) 1.75 ACRES | 11 | BENCH-6' (4) RECYCLED PLASTIC, SURFACE MOUNT, WITH END AND CENTER ARM RESTS, (Model No.88-60) DUMOR/EXERPLAY |
| 2 | SANTA FE BROWN CRUSHERFINES 4" DEEP W/ FF | 12 | PLAY STRUCTURE -AGES: 2-5 YEARS, (Model No. 8829-1-1) LANDSCAPE STRUCTURES/EXERPLAY |
| 3 | 6" x 6" CONCRETE MONOCURBS (SEE CITY STANDARD DWG 2726) | 13 | PLAY STRUCTURE -AGES: 5-12 YEARS, (Model No. 8829-1-1) LANDSCAPE STRUCTURES/EXERPLAY |
| 4 | 5' WIDE X 4" CONCRETE (COA SPEC. # 2430) FLUSH CONNECTION TO EXISTING SIDEWALK 10' RADIUS FILLET | 14 | SWINGS, 2 BAY/1 accessible LANDSCAPE STRUCTURES/EXERPLAY |
| 5 | MIN. 12" CONCRETE FOR MOWER ACCESS | 15 | BASKETBALL EQUIPMENT, PW ATHLETICS/EXERPLAY |
| 6 | 11.5' WIDE X 3.5' X 4" CONCRETE (COA SPEC. # 2430) FOR HC ACCESS TO BENCH 1' RADIUS FILLET | 16 | TRASH RECEPTICAL, (Model No. 102-32) DUMOR/EXERPLAY |
| 7 | 18" TURNDOWN (SEE CITY STD. DWG 2728) | 17 | BIO-ENGINEERED WOODFIBER 12" DEEP |
| 8 | BOLLARD- WITH MIN. 3' ACCESS AROUND BOLLARD (SEE COA SPEC#2250) (2-stationary)(1-removable-center) MINIMUM 3' CLEARANCE | 18 | EXISTING SIDEWALK/LANDSCAPING |
| 9 | SHADE STRUCTURE- 16'x52', (1) ICON SHELTERS/PLAYWELL GROUP | 19 | EXISTING SIDEWALK TO BE REMOVED FOR HC ACCESS FROM EX. SW TO PARKING |
| 10 | TABLE (4) RECYCLED PLASTIC, SURFACE MOUNT, (Model No. 100-68-TPL & 100-60PL) DUMOR/EXERPLAY | 20 | 6' FENCE (DETAIL PENDING) |
| | | 21 | POURED IN PLACE SAFETY SURFACING |

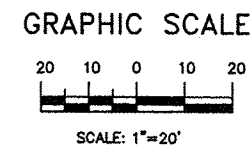

<p>THE HILLTOP LANDSCAPE ARCHITECTS AND CONTRACTORS 7909 EDITH BLVD. N.E. ALBUQUERQUE, NEW MEXICO 87109 (505)898-9690</p>			
CITY OF ALBUQUERQUE			
TITLE: VISTA DEL NORTE PARK CONSTRUCTION AND LAYOUT PLAN			
DESIGN REVIEW COMMITTEE	CITY ENGINEER APPROVAL	MO./DAY/YR.	MO./DAY/YR.
DESIGN REVIEW COMMITTEE	CITY ENGINEER		
CITY PROJECT NO. 785481		ZONE MAP NO. E-16-Z	SHEET 3 OF 5

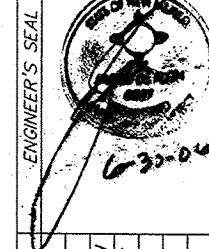

DESIGN		REVISIONS	
NO.	DATE	REMARKS	BY
1	5-16-06	Per DRC session #1-	CJ
DESIGNED BY		CJ	DATE 5/10/2006
DRAWN BY		CJ	DATE 5/10/2006
CHECKED BY		JD	DATE 5/10/2006

AS BUILT INFORMATION	
CONTRACTOR	DATE
WORK STARTED BY	DATE
ACCEPTED BY	DATE
FIELD BY	DATE
CORRECTED BY	DATE
MICRO-FILM INFORMATION	
RECORDED BY	DATE
NO.	

FIELD NOTES	
NO.	BY
	DATE

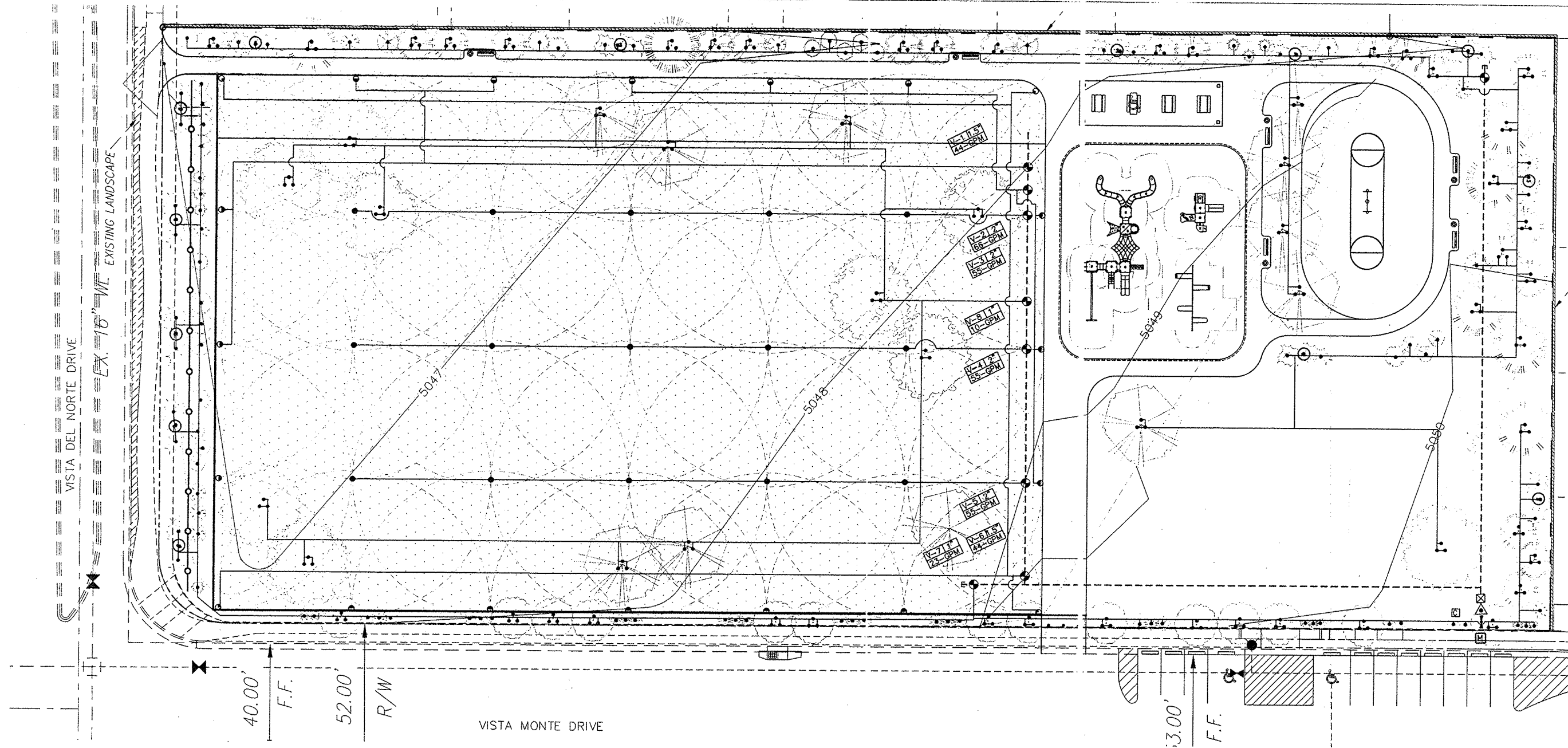

IRRIGATION SCHEDULE				
VALVE ID	SPRINKLER TYPE	FLOW	PRECIP RATE	RUN TIME
V-1	I40ADS	44-GPM	.81"/HR	49 MIN
V-2	I40ADS	66-GPM	.81"/HR	49 MIN
V-3	I4036S	55-GPM	.81"/HR	49 MIN
V-4	I4036S	55-GPM	.81"/HR	49 MIN
V-5	I4036S	55-GPM	.81"/HR	49 MIN
V-6	I40ADS	44-GPM	.81"/HR	49 MIN
V-7	BUBBLER	23-GPM	.25/.75 GPM	12 MIN
V-8	BUBBLER	10-GPM	.25/.75 GPM	12 MIN
V-9	BUBBLER	34-GPM	.25/.75 GPM	12 MIN
MV	N/A	66-GPM	N/A	N/A
TOTAL RUN TIME 5.5 HRS				
STATION RUNTIMES ARE CALCULATED TO APPLY .66" OF WATER ON ALL TURF AREAS. 3 GALLONS OF WATER PER SHRUB AND 9 GALLONS PER TREE PER IRRIGATION CYCLE.				
NOTE: IRRIGATION SYSTEM WAS DESIGNED @ 50 PSI AT THE BASE OF THE SPRINKLER. STATIC WATER PRESSURE HAS NOT BEEN DETERMINED				

IRRIGATION LEGEND				
[M]	2" WATER METER AND 2" TAP. (EXISTING)			
=====	24-VOLT WIRE SLEEVES, SIZE 2"			
---	SLEEVE PIPING FOR LATERALS AND IRRIGATION MAIN LINE, CLASS 200 SDR-21, SOLVENT WELD PVC. SLEEVE SHALL BE TWO SIZES LARGER THAN PIPE TO BE SLEEVED. SLEEVE DEPTH FOR LATERALS SHALL BE 18". SLEEVE DEPTH FOR IRRIGATION MAIN LINE SHALL BE 28".			
[I]	MANUAL VALVE ASSEMBLY SPEARS #3621-020SR 2" SCH. 80 TRUE UNION BALL VALVE			
[B]	BACKFLOW PREVENTER ASSEMBLY, FIBCO 825Y-200 2" REDUCED PRESSURE BACKFLOW PREVENTER WITH RAINBIRD #200-PEB MASTER VALVE UNIT IN HOT BOX #2			
---	IRRIGATION MAINLINE CLASS 200 "O" RING AND GASKET, PVC, SIZE 2.5", 18" DEPTH OF BURY.			
[A]	AUTOMATIC VALVE ASSEMBLY, RAINBIRD #PEB SERIES PLASTIC BODY AUTOMATIC VALVE ASSEMBLY WITH FLOW CONTROL AND MANUAL ACTIVATION, SIZE AS SHOWN ON PLAN.			
---	LATERAL PIPING SCH. 40, BELL END, SOLVENT WELD PVC, 18" DEPTH OF BURY.			
---	SOLVENT WELD CAP, SCH. 40 PVC SIZE.			
---	IRRIGATION CONTROLLER			
•	RAINBIRD #1401 FIXED BUBBLER ASSEMBLY ONE PER SHRUB AND THREE PER TREE			
•	ROTOR POP-UP SPRINKLER HUNTER #40 SERIES WITH NOZZLES AS FOLLOWS:			
NOZZLE	AREA OF COVERAGE	GPM	PSI	
#42	90° 51' RADIUS	11.0	50	
#42	180° 51' RADIUS	11.0	50	
#42	360° 51' RADIUS	11.0	50	
•	ROTOR POP-UP SPRINKLER HUNTER #PGP SERIES WITH NOZZLES AS FOLLOWS:			
NOZZLE	AREA OF COVERAGE	GPM	PSI	
#3	90° 31' RADIUS	1.2	50	
#3	180° 31' RADIUS	1.2	50	
#3	360° 31' RADIUS	1.2	50	

Booster Pump may be required based on reported water pressure

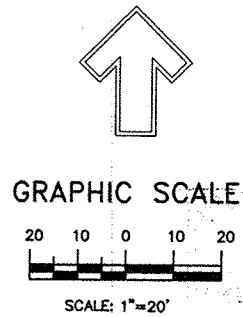

THE HILLTOP LANDSCAPE ARCHITECTS AND CONTRACTORS 7909 EDITH BLVD. N.E. ALBUQUERQUE, NEW MEXICO 87109 (505)898-9690			
CITY OF ALBUQUERQUE			
TITLE: VISTA DEL NORTE PARK IRRIGATION PLAN			
DESIGN REVIEW COMMITTEE	CITY ENGINEER APPROVAL	LAST DESIGN UPDATE	MO./DAY/YR.
APPROVED	APPROVED		
DESIGN REVIEW COMMITTEE	CITY ENGINEER		
CITY PROJECT NO. 785481	ZONE MAP NO. E-16-Z	SHEET 5	OF 5

AS BUILT INFORMATION			
CONTRACTOR	WORK	DATE	
STAMPED BY	DATE		
ACCEPTANCE BY	DATE		
FIELD	DATE		
REVISIONS	DATE		
CORRECTED BY	DATE		
MICRO-FILM INFORMATION			
RECORDED BY	DATE		
NO.			





City of Albuquerque
Martin J. Chavez, Mayor

Department of Municipal Development
John R. Castillo, Director

Final Acceptance Form

Date:
To: Dale Sokkary, Superintendent, Park Management, Parks & Recreation Department
From: John Casados, Construction Manager, Park Design and Construction, DMD
Subject: - PRD, Park Management Division Accepts Maintenance Responsibility

As of (date):
Project ID#:
Name of Facility:
Address:
Park Zoning:

... is officially assigned to the Park Management Division, Parks & Recreation Department, City of Albuquerque for maintenance. Outlined below is a description of work completed:

☐ Developed ☐ ? Renovation

Detailed Park Summary Information:

Acres of Irrigated Turf:

Description of Project

- Park property developed; property developed per blueprints and COA specifications.
1. Concrete sidewalks, mowstrips, poured and finished
 2. New irrigation system expanded to accommodate additions to park property.
 3. Installation of wrought iron fencing
 4. Installation of () stationary bollards painted yellow.
 5. Installation of () cycle of crusher fines.
 6. Installation of () of cool season sod.
 7. Planted trees and shrubs.
 8. Installation of tables and benches.

Effective date:

NO MORE CHARGES for new water, electric and gas

...will be accepted by the contractor: City of Albuquerque, Class II Crews
...are to occur against activity numbers: 7304060, 7385080

Water Meter Reading: N/A	Electric Meter Reading: N/A	Gas Meter Reading: N/A
Water Meter Number: N/A	Electric Meter Number: N/A	Gas Meter Number: N/A

Play Equipment Inspection and Audit Information:

Vendor:
Phone:
Inspector:
Inspection date:

Water Audit Information:

Requirement on 1/2 acre or more on turf.

Vendor:
Phone:
Inspector:
Inspection date:

Warranty and Vendor Information:

The following is a listing of all labor, vendors and product warranties pertaining to project:
During the first year all calls regarding warranty information will go to the contractor. After one year calls regarding warranty go directly to the vendor.

Contractor: City of Albuquerque, Class II Crews
Contact Name: John Casados
Phone: (505) 857-8664
Warranty: 1 yr.
One (1) year labor and installation
One (1) year growing season plant material
One (1) year irrigation/material

Vendor:
Phone:
Application:
Product:
Model#:
For a period of (time frame):
commencing on (starting date):
and ending on (ending date):

Vendor:
Phone:
Application:
Product:
Model#:
For a period of (time frame):
commencing on (starting date):
and ending on (ending date):

Vendor:
Phone:
Application:
Product:
Model#:
For a period of (time frame):
commencing on (starting date):
and ending on (ending date):

Vendor:
Phone:
Application:
Product:
Model#:
For a period of (time frame):
commencing on (starting date):
and ending on (ending date):

Vendor:
Phone:
Application:
Product:
Model#:
For a period of (time frame):
commencing on (starting date):
and ending on (ending date):

Vendor:
Phone:
Application:
Product:
Model#:
For a period of (time frame):
commencing on (starting date):
and ending on (ending date):

Vendor:
Phone:
Application:
Product:
Model#:
For a period of (time frame):
commencing on (starting date):
and ending on (ending date):

Vendor:
Phone:
Application:
Product:
Model#:
For a period of (time frame):
commencing on (starting date):
and ending on (ending date):

Vendor:
Phone:
Application:
Product:
Model#:
For a period of (time frame):
commencing on (starting date):
and ending on (ending date):

Other amenities added and/or removed (Please describe, note the number, and specify whether added or removed):

The DMD, Project Manager from Park Design and Construction Division for this Capital Project,

(project name)

☐
☐
☐

Email copies to:

Project Name:

Amenities	Total Existing	# Removed	# Added	Current Total
Backstops				
Baseball Fields (Lit)				
Basketball Courts (Full)				
Basketball Courts (Half)				
BBQ Grills				
Benches				
Bike Racks				
Bleachers				
Concrete Sidewalks				
Crusher Fines/Trail/Distance				
Drinking Fountains				
Exercise Stations				
Fencing/Tubular				
Chain Link Fencing				
Modular Skate Facility				
Mutt Mitt Box				
Parking Spaces				
Parking Spaces (ADA)				
Pedestrian Bridge				
Picnic Tables				
Play Areas				
Play Structures (2 to 5 yrs)				
Play Structures (5 to 12 yrs)				
Pools (Indoor)				
Pools (Outdoor)				
Recreation Fields				
Shade Structures				
Skate Facilities				
Softball Fields (Lit)				
Softball Fields (Unlit)				
Tennis Courts (Lit)				
Tennis Courts (Unlit)				
Trash Receptacles				
Turf Acres				
Visitors Center				
Volleyball Courts				
Walking Paths (LF)				
Youth Baseball Fields				

CONTRACTOR STARTED BY DATE		AS-BUILT INFORMATION	
INSPECTED BY DATE		BENCH MARKS	
FIELD ADJUSTMENT BY DATE		SURVEY INFORMATION	
CORRECTED BY DATE		FIELD NOTES	
MICRO-FILM INFORMATION		NO. BY DATE	
RECORDED BY DATE		NO. BY DATE	
NO.		NO.	

CITY OF ALBUQUERQUE PUBLIC WORKS DEPARTMENT ENGINEERING DEVELOPMENT GROUP			
PARK ACCEPTANCE			
DESIGN REVIEW COMMITTEE APPROVAL	CITY ENGINEER APPROVAL	MO./DAY/YR.	MO./DAY/YR.
DESIGN REVIEW COMMITTEE	CITY ENGINEER	LAST DESIGN UPDATE	
CITY PROJECT NO.	ZONE MAP NO.	SHEET	OF

78548