

2 3 4 5 6 7 8 9 10 11 12 13 14 15
26-7866-811-2009

△
RECORD DRAWING

CONSTRUCTION PLANS
FOR

UNM TERRACE STREET BUS ACCESS

ALBUQUERQUE, NEW MEXICO

INDEX

Sheet No.	Sheet Title
1	COVER SHEET
2	PLAN SHEET

CERTIFICATE OF SUBSTANTIAL COMPLIANCE ON PLANS

I, Matthew A. Santistevan of the firm of Bohannon Huston, Inc., a Registered Professional Engineer in the State of New Mexico, do hereby certify, to the best of my knowledge and belief, that the infrastructure installed as shown on these drawings (UNM Terrace Street Bus Access) has been inspected by me or by a qualified person under my direct supervision and has been constructed in accordance with the plans and specifications and that the original design intent of the approved plans has been met, except as noted by me on the as-built construction drawings. This Certification is based on site inspections by me or personnel under my direction and survey information provided by the contractor, Mountain States Constructors, Inc. and their surveyor, Joseph M. Solomon, Jr., NMPS 15075.

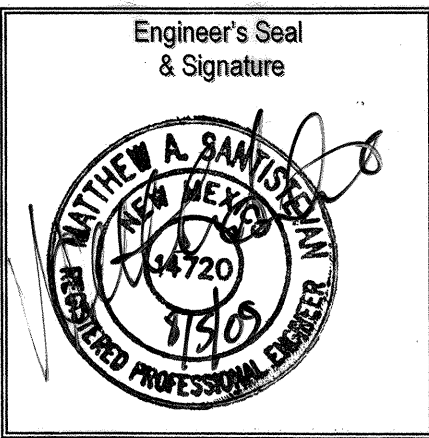

SURVEYOR'S CERTIFICATION △

I, Joseph M. Solomon, Jr., a duly qualified Licensed Professional Surveyor under the laws of the State of New Mexico, do hereby certify; that the "as-built" information shown on these drawings was obtained from field construction and "as-built" surveys performed by me or under my supervision; that the "as-built" information shown on these drawings was added by me or under my supervision; and that this "as-built" information is true and correct to the best of my knowledge and belief. I am not responsible for any of the design concepts, calculations, engineering, or intent of the record drawings.



Joseph M. Solomon, Jr. 7/21/2009
Joseph M. Solomon, Jr., NMPS 15075 Date

NOTICE TO CONTRACTORS CONTINUED

13. A CURB RAMP SHALL HAVE A DETECTABLE WARNING. THE DETECTABLE WARNING SHALL EXTEND THE FULL WIDTH OF THE CURB RAMP (EXCLUSIVE OF FLARED SIDES) AND SHALL EXTEND EITHER THE FULL DEPTH OF THE CURB RAMP OR 24 INCHES (610 MM) DEEP MINIMUM MEASURED FROM THE BACK OF THE CURB ON THE RAMP SURFACE. SUBMIT SPECIFICATIONS TO CONSTRUCTION ENGINEER FOR EVALUATION PRIOR TO INSTALLATION.

APPROVED AS RECORD DRAWINGS
DESIGN REVIEW SECTION
CITY CONSTRUCTION ENGINEER
Nathan Aguiar
DATE: 08/19/09

RECORD DRAWING

Bohannon Huston
Court yard I 7500 Jefferson St. NE Albuquerque, NM 87109-4335
ENGINEERING ▴ SPATIAL DATA ▴ ADVANCED TECHNOLOGIES

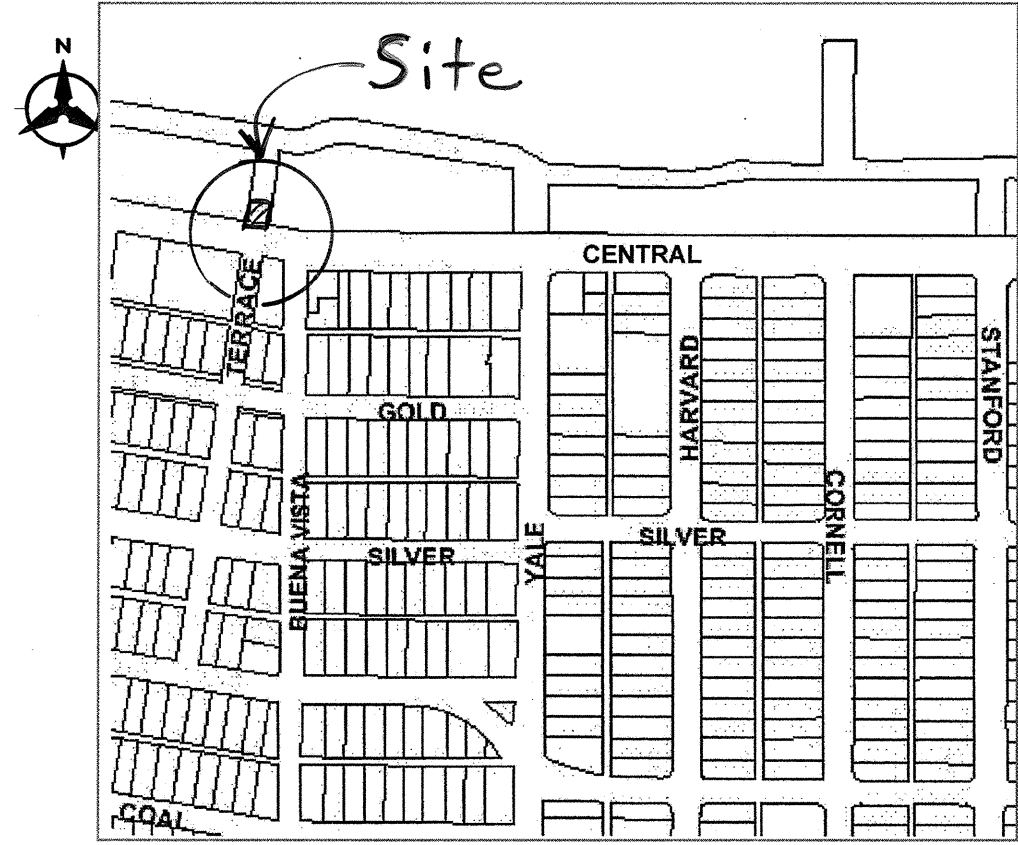

VICINITY MAP
ZONE MAP NO. K-15

NOTICE TO CONTRACTORS

1. AN EXCAVATION/CONSTRUCTION PERMIT TO BE OBTAINED BY THE CONTRACTOR AS PART OF THE CONTRACT WILL BE REQUIRED BEFORE BEGINNING ANY WORK WITHIN THE CITY RIGHT-OF-WAY.
2. ALL WORK DETAILED ON THESE PLANS TO BE PERFORMED UNDER CONTRACT SHALL, EXCEPT AS OTHERWISE STATED OR PROVIDED FOR HEREON, BE CONSTRUCTED IN ACCORDANCE WITH THE CITY OF ALBUQUERQUE STANDARD SPECIFICATIONS FOR PUBLIC WORKS CONSTRUCTION, 1986 EDITION AS REVISED THROUGH UPDATE #7 INCLUDING AMENDMENT NO. 1.
3. TWO WORKING DAYS PRIOR TO ANY EXCAVATION, THE CONTRACTOR MUST CONTACT NEW MEXICO ONE CALL SYSTEM (260-1990) FOR LOCATION OF EXISTING UTILITIES.
4. PRIOR TO CONSTRUCTION, THE CONTRACTOR SHALL EXCAVATE AND VERIFY THE HORIZONTAL AND VERTICAL LOCATIONS OF ALL OBSTRUCTIONS, SHOULD A CONFLICT EXIST. THE CONTRACTOR SHALL NOTIFY THE ENGINEER IMMEDIATELY SO THAT THE CONFLICT CAN BE RESOLVED WITH A MINIMUM AMOUNT OF DELAY.
5. WITHIN 7 WORKING DAYS OF NOTICE TO PROCEED, THE CONTRACTOR SHALL SUBMIT TO CONSTRUCTION COORDINATION DIVISION A DETAILED CONSTRUCTION SCHEDULED. TWO (2) WORKING DAYS PRIOR TO THE START OF CONSTRUCTION, THE CONTRACTOR SHALL OBTAIN A BARRICADING PERMIT FROM THE CONSTRUCTION COORDINATION DIVISION. CONTRACTOR SHALL NOTIFY THE CONSTRUCTION COORDINATION ENGINEER (924-3400) PRIOR TO OCCUPANCY AN INTERSECTION. REFER TO SECTION 19 OF THE GENERAL CONDITIONS OF THE STANDARD SPECIFICATIONS.
6. ALL WORK EFFECTING ARTERIAL ROADWAYS REQUIRES TWENTY-FOUR HOUR CONSTRUCTION.
7. CONTRACTOR SHALL NOTIFY THE ENGINEER NOT LESS THAN SEVEN (7) DAYS PRIOR TO STARTING WORK IN ORDER THAT THE CITY SURVEYOR MAY TAKE NECESSARY MEASURES TO ENSURE THE PRESERVATION OF SURVEY MONUMENTS. CONTRACTOR SHALL NOT DISTURB PERMANENT SURVEY MONUMENTS WITHOUT THE CONSENT OF THE CITY SURVEYOR AND SHALL NOTIFY THE CITY SURVEYOR AND BEAR THE EXPENSE OF REPLACING ANY THAT MAY BE DISTURBED WITHOUT PERMISSION. REPLACEMENT SHALL BE DONE ONLY BY THE CITY SURVEYOR. WHEN A CHANGE IS MADE IN THE FINISHED ELEVATIONS OF THE PAVEMENT OF ANY ROADWAY IN WHICH A PERMANENT SURVEY MONUMENT IS LOCATED, CONTRACTOR SHALL, AT HIS OWN EXPENSE, ADJUST THE MONUMENT COVER TO THE NEW GRADE UNLESS OTHERWISE SPECIFIED. REFER TO SECTION 4.4 OF THE GENERAL CONDITIONS OF THE STANDARD SPECIFICATIONS.
8. CONTRACTOR SHALL RECORD DATA ON ALL UTILITY LINES AND ACCESSORIES AS REQUIRED BY THE CITY OF ALBUQUERQUE FOR THE PREPARATION OF "AS CONSTRUCTED" DRAWINGS. CONTRACTOR SHALL NOT COVER UTILITY LINES AND ACCESSORIES UNTIL ALL DATA HAS BEEN RECORDED.
9. CONTRACTOR SHALL MAINTAIN A GRAFFITI-FREE WORK SITE. CONTRACTOR SHALL PROMPTLY REMOVE ANY GRAFFITI FROM ALL EQUIPMENT, WHETHER PERMANENT OR TEMPORARY.
10. CONTRACTOR SHALL COORDINATE WITH THE ABCWA (857-8200) SEVEN (7) WORKING DAYS IN ADVANCE OF ANY WORK THAT MAY AFFECT EXISTING PUBLIC WATER OR SEWER UTILITIES. EXISTING VALVES TO BE OPERATED BY WATER UTILITY PERSONNEL ONLY. CONTRACTOR SHALL CONTACT THE WATER SYSTEMS DIVISION SEVEN (7) WORKING DAYS PRIOR TO NEEDING VALVES TURNED ON OR OFF.
11. CONTRACTOR SHALL REPLACE ANY IMPACTED SIGNING OR STRIPING.
12. CONTRACTOR SHALL BE RESPONSIBLE TO PROVIDE AND MAINTAIN ALL TRAFFIC CONTROL DEVICES UNTIL THE PROJECT HAS BEEN EXCEPTED BY THE CITY OF ALBUQUERQUE.

THE FOLLOWING NOTES ALSO APPLY WHEN CHECKED

- ☐ ALL UTILITIES AND UTILITY SERVICE LINES SHALL BE INSTALLED PRIOR TO PAVING.
- ☒ BACKFILL COMPACTION SHALL BE ACCORDING TO SPECIFIED STREET USE.
- ☒ TACK COAT REQUIREMENTS SHALL BE DETERMINED BY THE ENGINEER.
- ☒ SIDEWALKS AND WHEELCHAIR RAMPS WITHIN THE CURB RETURNS SHALL BE CONSTRUCTED WHEREVER A NEW CURB RETURN IS CONSTRUCTED.
- ☐ IF CURB IS DEPRESSED FOR A DRIVEPAD, THE DRIVEPAD SHALL BE CONSTRUCTED PRIOR TO ACCEPTANCE OF CURB AND GUTTER.
- ☐ ALL STORM DRAINAGE FACILITIES SHALL BE COMPLETED PRIOR TO FINAL ACCEPTANCE.
- ☒ THE REQUESTOR OR DEVELOPER SHALL BE RESPONSIBLE FOR REPAIR OR REPLACEMENT OF ALL CURB AND GUTTER OR SIDEWALK DAMAGED AFTER APPROVAL BY THE CITY ENGINEER OF WORK COMPLETED BY THE CONTRACTOR.

HMCG # 2009.021.1

--	--	--	--	--	--	--	--	--	--	--	--	--	--	--	--	--	--	--	--	--	--	--	--	--	--	--	--	--	--	--	--	--	--	--	--	--	--	--	--	--	--	--	--	--	--	--	--	--	--	--	--	--	--	--	--	--	--	--	--	--	--	--	--	--	--	--	--	--	--	--	--	--	--	--	--	--	--	--	--	--	--	--	--	--	--	--	--	--	--	--	--	--	--	--	--	--	--	--	--	--	--	--	--	--	--	--	--	--	--	--	--	--	--	--	--	--	--	--	--	--	--	--	--	--	--	--	--	--	--	--	--	--	--	--	--	--	--	--	--	--	--	--	--	--	--	--	--	--	--	--	--	--	--	--	--	--	--	--	--	--	--	--	--	--	--	--	--	--	--	--	--	--	--	--	--	--	--	--	--	--	--	--	--	--	--	--	--	--	--	--	--	--	--	--	--	--	--	--	--	--	--	--	--	--	--	--	--	--	--	--	--	--	--	--	--	--	--	--	--	--	--	--	--	--	--	--	--	--	--	--	--	--	--	--	--	--	--	--	--	--	--	--	--	--	--	--	--	--	--	--	--	--	--	--	--	--	--	--	--	--	--	--	--	--	--	--	--	--	--	--	--	--	--	--	--	--	--	--	--	--	--	--	--	--	--	--	--	--	--	--	--	--	--	--	--	--	--	--	--	--	--	--	--	--	--	--	--	--	--	--	--	--	--	--	--	--	--	--	--	--	--	--	--	--	--	--	--	--	--	--	--	--	--	--	--	--	--	--	--	--	--	--	--	--	--	--	--	--	--	--	--	--	--	--	--	--	--	--	--	--	--	--	--	--	--	--	--	--	--	--	--	--	--	--	--	--	--	--	--	--	--	--	--	--	--	--	--	--	--	--	--	--	--	--	--	--	--	--	--	--	--	--	--	--	--	--	--	--	--	--	--	--	--	--	--	--	--	--	--	--	--	--	--	--	--	--	--	--	--	--	--	--	--	--	--	--	--	--	--	--	--	--	--	--	--	--	--	--	--	--	--	--	--	--	--	--	--	--	--	--	--	--	--	--	--	--	--	--	--	--	--	--	--	--	--	--	--	--	--	--	--	--	--	--	--	--	--	--	--	--	--	--	--	--	--	--	--	--	--	--	--	--	--	--	--	--	--	--	--	--	--	--	--	--	--	--	--	--	--	--	--	--	--	--	--	--	--	--	--	--	--	--	--	--	--	--	--	--	--	--	--	--	--	--	--	--	--	--	--	--	--	--	--	--	--	--	--	--	--	--	--	--	--	--	--	--	--	--	--	--	--	--	--	--	--	--	--	--	--	--	--	--	--	--	--	--	--	--	--	--	--	--	--	--	--	--	--	--	--	--	--	--	--	--	--	--	--	--	--	--	--	--	--	--	--	--	--	--	--	--	--	--	--	--	--	--	--	--	--	--	--	--	--	--	--	--	--	--	--	--	--	--	--	--	--	--	--	--	--	--	--	--	--	--	--	--	--	--	--	--	--	--	--	--	--	--	--	--	--	--	--	--	--	--	--	--	--	--	--	--	--	--	--	--	--	--	--	--	--	--	--	--	--	--	--	--	--	--	--	--	--	--	--	--	--	--	--	--	--	--	--	--	--	--	--	--	--	--	--	--	--	--	--	--	--	--	--	--	--	--	--	--	--	--	--	--	--	--	--	--	--	--	--	--	--	--	--	--	--	--	--	--	--	--	--	--	--	--	--	--	--	--	--	--	--	--	--	--	--	--	--	--	--	--	--	--	--	--	--	--	--	--	--	--	--	--	--	--	--	--	--	--	--	--	--	--	--	--	--	--	--	--	--	--	--	--	--	--	--	--	--	--	--	--	--	--	--	--	--	--	--	--	--	--	--	--	--	--	--	--	--	--	--	--	--	--	--	--	--	--	--	--	--	--	--	--	--	--	--	--	--	--	--	--	--	--	--	--	--	--	--	--	--	--	--	--	--	--	--	--	--	--	--	--	--	--	--	--	--	--	--	--	--	--	--	--	--	--	--	--	--	--	--	--	--	--	--	--	--	--	--	--	--	--	--	--	--	--	--	--	--	--	--	--	--	--	--	--	--	--	--	--	--	--	--	--	--	--	--	--	--	--	--	--	--	--	--	--	--	--	--	--	--	--	--	--	--	--	--	--	--	--	--	--	--	--	--	--	--	--	--	--	--	--	--	--	--	--	--	--	--	--	--	--	--	--	--	--	--	--	--	--	--	--	--	--	--	--	--	--	--	--	--	--	--	--	--	--	--	--	--	--	--	--	--	--	--	--	--	--	--	--	--	--	--	--	--	--	--	--	--	--	--	--	--	--	--	--	--	--	--	--	--	--	--	--	--	--	--	--	--	--	--	--	--	--	--	--	--	--	--	--	--	--	--	--	--	--	--	--	--	--	--	--	--	--	--	--	--	--	--	--	--	--	--	--	--	--	--	--	--	--	--	--	--	--	--	--	--	--	--	--	--	--	--	--	--	--	--	--	--	--	--	--	--	--	--	--	--	--	--	--	--	--	--	--	--	--	--	--	--	--	--	--	--	--	--	--	--	--	--	--	--	--	--	--	--	--	--	--	--	--	--	--	--	--	--	--	--	--	--	--	--	--	--	--	--	--	--	--	--	--	--	--	--	--	--	--	--	--	--	--	--	--	--	--	--	--	--	--	--	--	--	--	--	--	--	--	--	--	--	--	--	--	--	--	--	--	--	--	--	--	--	--	--	--	--	--	--	--	--	--	--	--	--	--	--	--	--	--	--	--	--	--	--	--	--	--	--	--	--	--	--	--	--	--	--	--	--	--	--	--	--	--	--	--	--	--	--	--	--	--	--	--	--	--	--	--	--	--	--	--	--	--	--	--	--	--	--	--	--	--	--	--	--	--	--	--	--	--	--	--	--	--	--	--	--	--	--	--	--	--	--	--	--	--	--	--	--	--	--	--	--	--	--	--	--	--	--	--	--	--	--	--	--	--	--	--	--	--	--	--	--	--	--	--	--	--	--	--	--	--	--	--	--	--	--	--	--	--	--	--	--	--	--	--	--	--	--	--	--	--	--	--	--	--	--	--	--	--	--	--	--	--	--	--	--	--	--	--	--	--	--	--	--	--	--	--	--	--	--	--	--	--	--	--	--	--	--	--	--	--	--	--	--	--	--	--	--	--	--	--	--	--	--	--	--	--	--	--	--	--	--	--	--	--

RECORD DRAWING

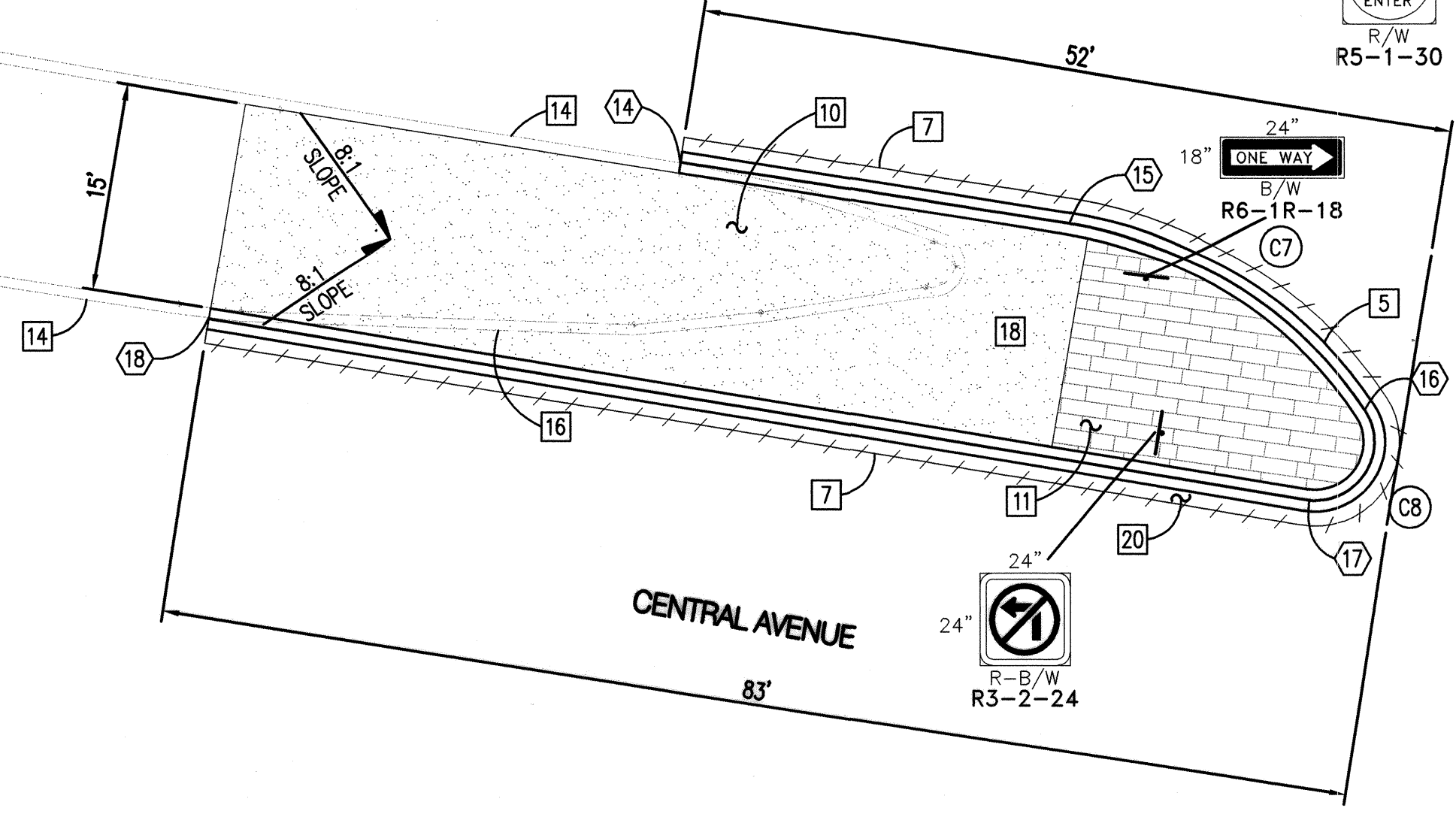
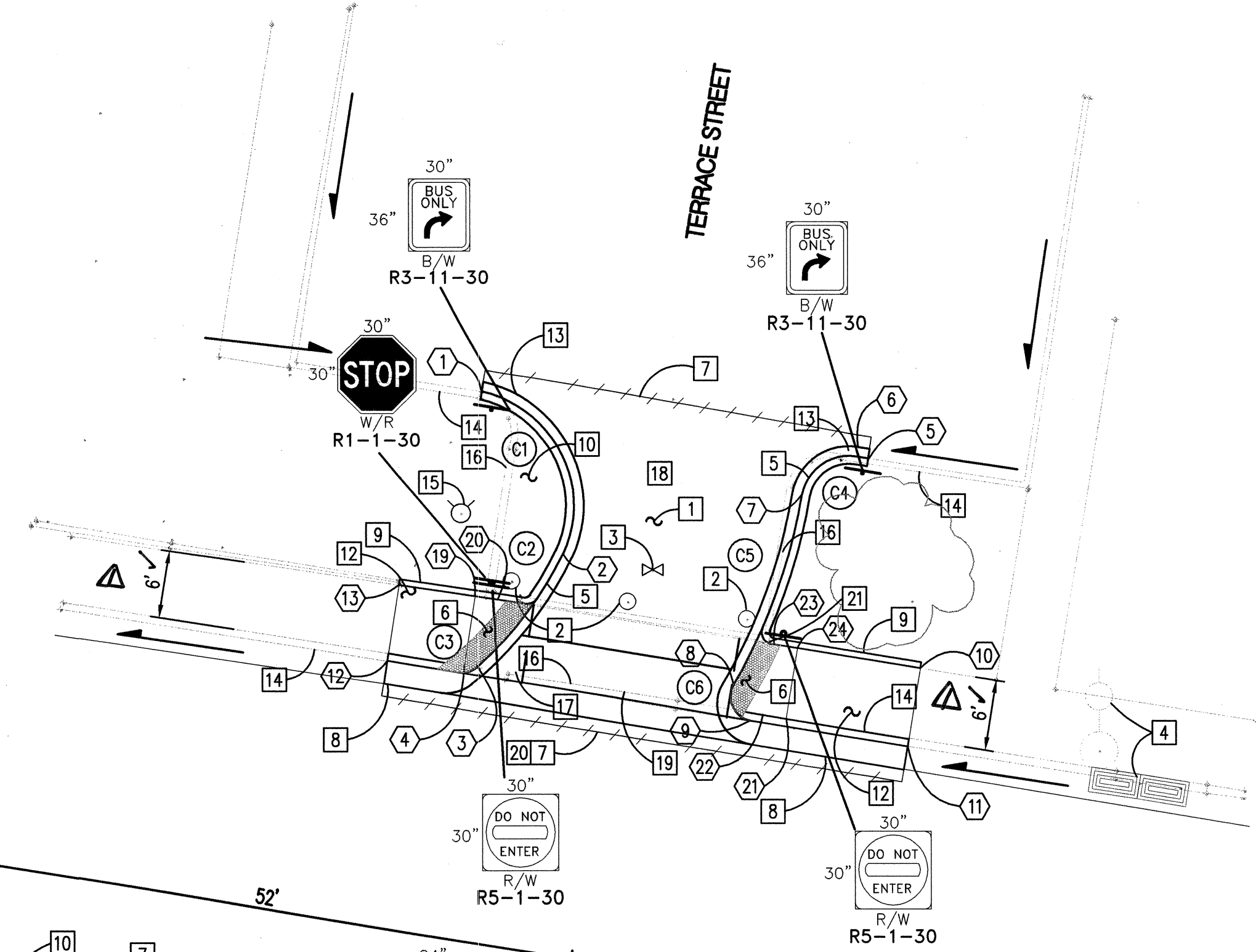
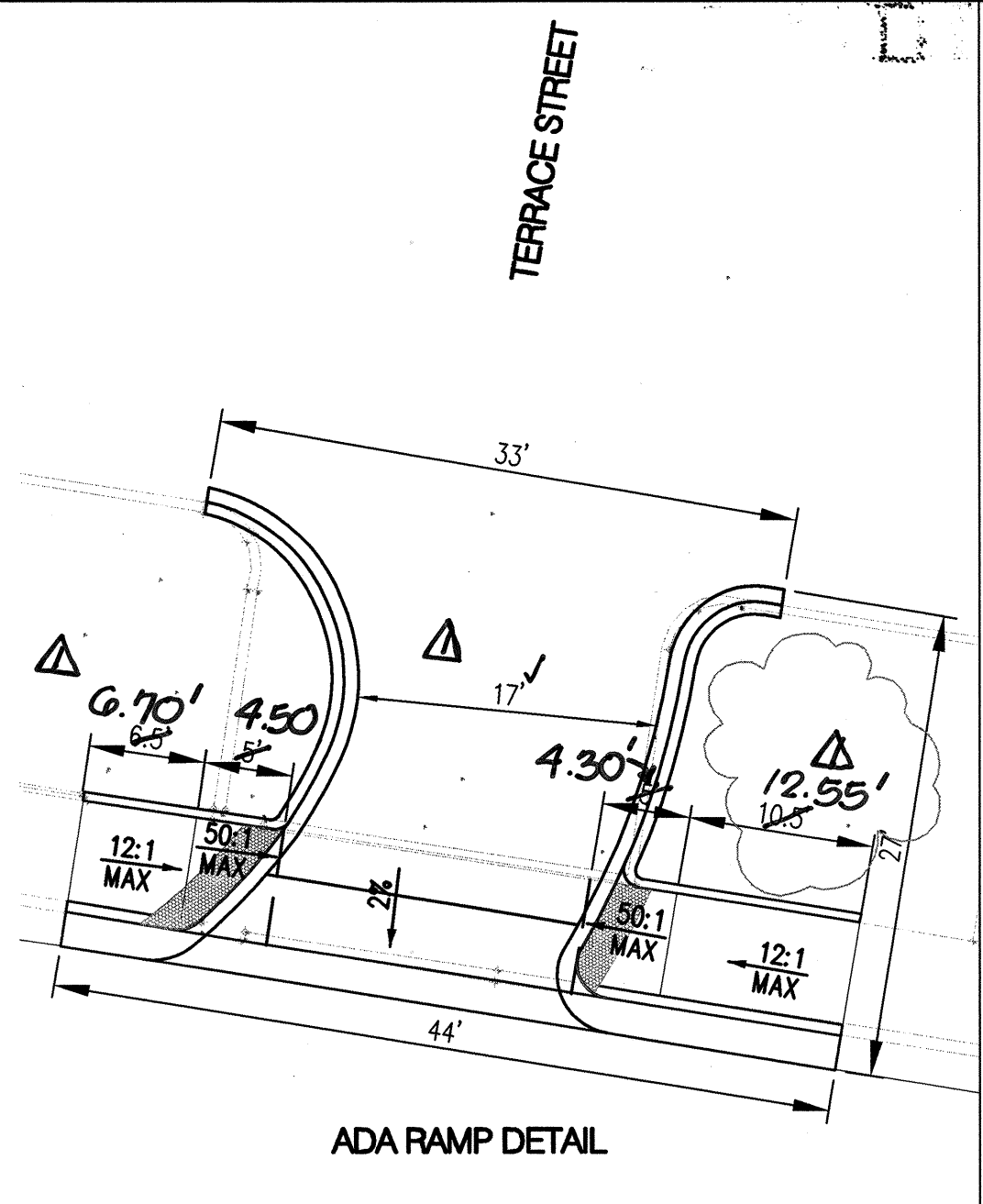

Point Table			
NORTHING	EASTING	ELEVATION	DESCRIPTION
1	1485502.1	388292.9	5154.33 ✓ PC, ME
2	1485488.2	388299.7	5153.18 ✓ .38 PCC
3	1485478.5	388292.4	5152.40 ✓ .52 PCC
4	1485478.6	388291.4	5152.38 ✓ PT
5	1485496.4	388325.6	5154.74 ✓ .82 ME
6	1485497.4	388324.6	5154.72 ✓ .81 PC
7	1485493.3	388319.9	5154.38 ✓ .28 PCC
8	1485476.9	388314.1	5153.30 ✓ .11 PRC
9	1485473.9	388315.5	5153.28 ✓ .08 PT
10	1485478.3	388329.9	5154.36 ✓ TOP SW, ME
11	1485471.7	388328.8	5153.48 ✓ .84 ME
12	1485478.9	388284.9	5152.08 ✓ .20 ME
13	1485485.4	388285.9	5153.06 ✓ TOP SW, ME
14	1485451.8	388247.0	5151.84 ✓ .85 ME
15	1485447.5	388273.9	5152.58 ✓ .02 PC
16	1485434.3	388294.4	5153.18 ✓ .23 PCC
17	1485428.0	388290.5	5153.18 ✓ .04 PT
18	1485440.8	388214.4	5150.18 ✓ .73 ME
19	1485484.5	388292.3	5152.58 ✓ .02 POT
20	1485484.2	388294.2	5152.52 ✓ .72 POT
21	1485474.0	388318.6	5153.38 ✓ .10 POT
22	1485474.4	388316.6	5153.28 ✓ .00 POT
23	1485480.3	388317.5	5153.48 ✓ .33 POT
24	1485480.0	388319.5	5153.48 ✓ .38 POT
25	1485424.4	388360.1	5155.51 MAN HOLE
26	1485442.5	390378.3	5171.39 SPK BENCH MARK

Curve Table			
ID	DELTA	RADIUS	TANGENT
C1	102°26'35"	10.00'	12.41'
C2	23°19'00"	30.00'	6.19'
C3	51°08'35"	2.00'	0.96'
C4	85°52'57"	4.00'	4.05'
C5	33°54'53"	48.00'	8.87'
C6	110°34'20"	2.00'	2.89'
C7	47°52'14"	30.00'	13.32'
C8	132°35'23"	4.00'	9.11'

- KEYED NOTES**
- PLACE ASPHALT CONCRETE SECTION, PER COA STD DRWG 2405B (4" TYPE B AC, 12" SUBGRADE PREPARATION) R250
 - REMOVE BOLLARDS (3)
 - ADJUST WATER VALVE TO GRADE OF NEW ASPHALT ELEVATIONS
 - EXISTING STRUCTURE TO REMAIN
 - BUILD MEDIAN CURB PER COA STD DRWG 2415B
 - INSTALL DETECTABLE WARNING SURFACE
 - SAWCUT LINE, 1' OFFSET FROM CURB & GUTTER (TYP)
 - BUILD STANDARD CURB & GUTTER PER COA STD DRWG 2415A.
 - BUILD HEADER CURB PER COA STD DRWG 2415B
 - SANTA FE BROWN AGGREGATE 3" DEPTH ON SUBGRADE
 - BUILD MEDIAN PAVEMENT PER COA STD DRWG 2408, MATCH EXISTING COLOR
 - INSTALL ADA RAMP PER COA STD DRWG 2426
 - TRANSITION TO MATCH EXISTING CURB
 - EXISTING CURB TO REMAIN
 - PROTECT FIRE HYDRANT DURING CONSTRUCTION
 - REMOVE EXISTING CURB
 - REMOVE SIDEWALK CULVERT
 - REMOVE EXISTING PAVEMENT
 - INSTALL 6" VALLEY GUTTER WITH 1" INVERT
 - PLACE ASPHALT CONCRETE SECTION PER COA STD DRWG 2405-ARTERIAL (ASPH 2 1/2" 100)
 - EXISTING SURVEY MONUMENT MUST BE RELOCATED PRIOR TO CONSTRUCTION. COORDINATE WITH THE CITY SURVEYOR, 768-3609

NOTES

- POINT TABLE INFORMATION AND CURVE TABLE IS TO FLOWLINE OF CURB.
- MATCH EXISTING ELEVATIONS AT BACK OF CURB FOR BUS ACCESS AND AT ALL SAWCUT LOCATIONS.
- PAINT MEDIAN NOSE YELLOW.

SURVEYOR'S CERTIFICATION

I, Joseph M. Solomon, Jr., a duly qualified Licensed Professional Surveyor under the laws of the State of New Mexico, do hereby certify; that the "as-built" information shown on these drawings was obtained from field construction and "as-built" surveys performed by me or under my supervision; that the "as-built" information shown on these drawings was added by me or under my supervision; and that this "as-built" information is true and correct to the best of my knowledge and belief. I am not responsible for any of the design concepts, calculations, engineering, or intent of the record drawings.

Joseph M. Solomon, Jr. 7/21/2009
Joseph M. Solomon, Jr., NMPS 15075 Date

BHI JOB NO. 080264

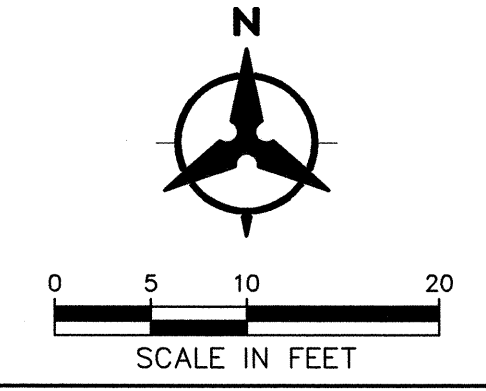

Bohannon & Huston
Courtney I 7500 Jefferson St. NE Albuquerque, NM 87109-4335
ENGINEERING & SPATIAL DATA & ADVANCED TECHNOLOGIES

CITY OF ALBUQUERQUE DEPARTMENT OF MUNICIPAL DEVELOPMENT	
TERRACE STREET BUS ACCESS PLAN SHEET	
DESIGN REVIEW COMMITTEE APPROVE MAR 10 2009	CITY ENGINEER APPROVAL APPROVE MAY 19 2009
DESIGN REVIEW COMMITTEE	CITY ENGINEER
CITY PROJECT NO. 786681	ZONE MAP NO. K-15
SHEET 2	OF 2