

CITY OF ALBUQUERQUE
DEPARTMENT OF MUNICIPAL DEVELOPMENT
CONSTRUCTION PLANS FOR
GABALDON ROAD/LEOPOLDO ROAD
INTERSECTION IMPROVEMENTS

COA PROJECT NO. 789092



INDEX OF SHEETS

1	TITLE SHEET
2	GENERAL NOTES
3	SUMMARY OF QUANTITIES
4	OVERALL LAYOUT
5	REMOVALS
6	PROPOSED LAYOUT/GRADING PLAN
7	SIGNING & STRIPING
8	COA STRIPING SHEET
9	DETAIL SHEET
10	DETAIL SHEET

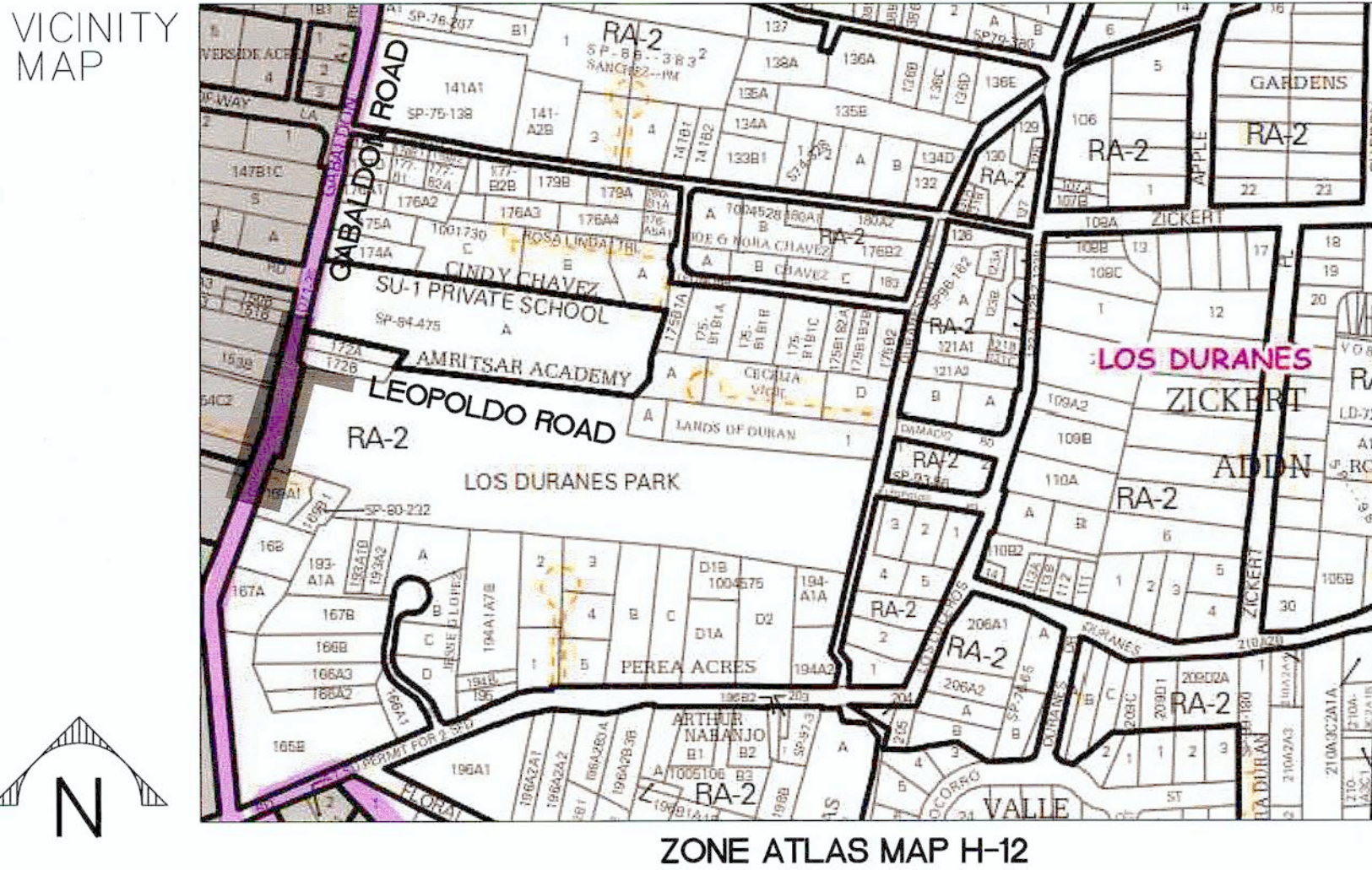

PURPOSE OF PROJECT:
THE PURPOSE OF THE PROJECT IS TO MODIFY THE EXISTING MEDIAN ON GABALDON ROAD TO ADD A SIDEWALK, ADD CURB RAMPS, AND NARROW GABALDON ROAD. THE EXISTING LOS DURANES PARK PARKING LOT WILL BE RESTRIPTED.

Parametrix
ENGINEERING · PLANNING · ENVIRONMENTAL SCIENCES

8801 Jefferson NE, Building B
Albuquerque, NM 87113
P. 505.821.4700 F. 505.821.7131
www.parametrix.com

REV.	SHEETS	CITY ENGINEER	DATE	USER DEPARTMENT	DATE	USER DEPARTMENT	DATE
ENGINEER'S STAMP & SIGNATURE		APPROVED	ENGINEER	DATE	APPROVED FOR CONSTRUCTION		
		DRC Chairman	<i>[Signature]</i>	9/27/16			
		Transportation	<i>[Signature]</i>	9/26/16			
		ABCWJA	<i>[Signature]</i>	9/26/16			
		Hydrology	<i>[Signature]</i>	9/26/16			
		C I P					
AMAFCA					CITY ENGINEER		
Constr. Coord.					DATE		
PROJECT NUMBER		ZONE ATLAS NO.					
789092		H-12		DRAWING NO. 1 OF 10			

GENERAL NOTES

1.

THE CONTRACTOR SHALL ABIDE BY ALL LOCAL, STATE, AND FEDERAL LAWS, RULES AND REGULATIONS THAT APPLY TO THE CONSTRUCTION OF THESE IMPROVEMENTS.
2.

ALL ELECTRICAL, TELEPHONE, CABLE TV, GAS AND OTHER UTILITY LINES, CABLES AND APPURTENANCES ENCOUNTERED DURING CONSTRUCTION THAT REQUIRE RELOCATION SHALL BE COORDINATED WITH THAT UTILITY. THE CONTRACTOR SHALL BE RESPONSIBLE FOR COORDINATION OF ALL NECESSARY UTILITY ADJUSTMENTS. NO ADDITIONAL COMPENSATION WILL BE ALLOWED FOR DELAYS OR INCONVENIENCES CAUSED BY UTILITY COMPANY WORK CREWS. THE CONTRACTOR MAY BE REQUIRED TO RESCHEDULE THEIR ACTIVITIES TO ALLOW UTILITY CREWS TO PERFORM THEIR REQUIRED WORK.
3.

DISPOSAL SITE FOR ALL EXCESS EXCAVATION MATERIAL AND UNSUITABLE MATERIAL SHALL BE OBTAINED BY THE CONTRACTOR IN COMPLIANCE WITH APPLICABLE ENVIRONMENTAL REGULATIONS AND APPROVED BY THE CONSTRUCTION ENGINEER. ALL COSTS INCURRED IN OBTAINING A DISPOSAL SITE AND HAUL THERETO SHALL BE CONSIDERED INCIDENTAL TO THE PROJECT AND NO SEPARATE MEASUREMENT OR PAYMENT WILL BE MADE.
4.

THE CONTRACTOR IS RESPONSIBLE FOR PROTECTING THE EXISTING UTILITY LINES WITHIN THE CONSTRUCTION AREA. ANY DAMAGE TO EXISTING FACILITIES CAUSED BY CONSTRUCTION ACTIVITY SHALL BE REPAIRED OR REPLACED AT THE CONTRACTOR'S EXPENSE AND APPROVED BY THE CONSTRUCTION ENGINEER.
5.

CONSTRUCTION ACTIVITY SHALL BE LIMITED TO THE PUBLIC RIGHT-OF-WAY AND/OR PROJECT LIMITS. ANY DAMAGE TO ADJACENT PROPERTIES RESULTING FROM THE CONSTRUCTION PROCESS IS THE RESPONSIBILITY OF THE CONTRACTOR. ANY COSTS INCURRED FOR REPAIRS SHALL BE THE COST OF THE CONTRACTOR.
6.

TWO WEEKS PRIOR TO CONSTRUCTION, THE CONTRACTOR SHALL NOTIFY THE TRANSIT DEPARTMENT OF ANY IMPACT THE PROPOSED PROJECT WILL HAVE ON THE TRANSIT SYSTEM SUCH AS CAUSING A DETOUR, OR CAUSING THE CLOSURE OR RELOCATION OF A BUS STOP. THE CONTACT PERSON IS SHABIH RIZVI, OFFICE PHONE 505-724-3134, CELL PHONE 505-331-0253, AND EMAIL SRIZVI@CABQ.GOV AND/OR DOUGLAS GOFF, OFFICE PHONE 505-724-3137, CELL PHONE 505-206-0151, AND EMAIL DGOFF@CABQ.GOV.
7.

OVERNIGHT PARKING OF CONSTRUCTION EQUIPMENT SHALL NOT OBSTRUCT DRIVEWAYS OR DESIGNATED TRAFFIC LANES. THE CONTRACTOR SHALL NOT STORE ANY EQUIPMENT OR MATERIAL WITHIN THE PUBLIC RIGHT-OF-WAY.
8.

THE CONTRACTOR SHALL OBTAIN ALL THE NECESSARY PERMITS FOR THE PROJECT PRIOR TO COMMENCING CONSTRUCTION (E.G., BARRICADING, SURFACE DISTURBANCE).
9.

ALL PERMANENT PAVEMENT MARKING AND TRAFFIC SIGNING SHALL BE FURNISHED BY THE CONTRACTOR PER PLAN.
10.

THE CONTRACTOR SHALL COORDINATE WITH THE CITY OF ALBUQUERQUE, TRAFFIC ENGINEERING DEPARTMENT, PRIOR TO BEGINNING ANY CONSTRUCTION WORK ON OR ADJACENT TO EXISTING STREETS.
11.

ALL BARRICADES AND CONSTRUCTION SIGNING SHALL CONFORM TO APPLICABLE SECTIONS OF THE "MANUAL ON UNIFORM TRAFFIC CONTROL DEVICES" (MUTCD), U.S. DEPARTMENT OF TRANSPORTATION, LATEST EDITION.
12.

THE CONTRACTOR SHALL MAINTAIN ALL CONSTRUCTION BARRICADES AND SIGNING AT ALL TIMES. THE CONTRACTOR SHALL VERIFY THE PROPER LOCATION OF ALL BARRICADING AT THE END AND BEGINNING OF EACH DAY.

13.

ALL SAWCUT PAVEMENT SHALL HAVE A UNIFORM EDGE AND BE SPRAYED WITH TACK.
14.

WHEN ABUTTING NEW CURB AND GUTTER TO EXISTING PAVEMENT, A 1' WIDE SECTION OF EXISTING PAVEMENT ADJACENT TO THE CURB AND GUTTER SHALL BE SAWCUT, REMOVED, AND REPLACED AS PER THE STANDARD SPECIFICATIONS.
15.

THE CONTRACTOR SHALL ASSUME RESPONSIBILITY FOR ANY DAMAGE TO EXISTING PAVEMENTS, PAVEMENT MARKINGS, CURB & GUTTER, DRIVE PADS, CURB RAMPS, SIGNAGE, AND SIDEWALK DURING CONSTRUCTION, APART FROM THOSE SECTIONS INDICATED FOR REMOVAL ON THE PLANS, AND SHALL REPAIR OR REPLACE PER COA STANDARDS, AT HIS OWN EXPENSE.
16.

ALL EXCAVATION, TRENCHING, AND SHORING ACTIVITIES SHALL BE CARRIED OUT IN ACCORDANCE WITH OSHA 29 CFR 1926.652.
17.

THE CONTRACTOR SHALL PROVIDE AND MAINTAIN ALL CONSTRUCTION SIGNAGE UNTIL THE PROJECT HAS BEEN ACCEPTED BY THE CITY OF ALBUQUERQUE.
18.

ALL SWPPP EROSION CONTROL MEASURES SHALL BE REMOVED FROM THE RIGHT-OF-WAY PRIOR TO FINAL ACCEPTANCE.
19.

AN EXCAVATION/CONSTRUCTION PERMIT SHALL BE REQUIRED BEFORE BEGINNING ANY WORK WITHIN THE CITY RIGHT-OF-WAY.
20.

ALL WORK DETAILED ON THESE PLANS TO BE PERFORMED UNDER CONTRACT SHALL, EXCEPT AS OTHERWISE STATED OR PROVIDED FOR HEREON, BE CONSTRUCTED IN ACCORDANCE WITH THE CITY OF ALBUQUERQUE STANDARD SPECIFICATIONS FOR PUBLIC WORKS CONSTRUCTION, 1986 EDITION AS REVISED THROUGH UPDATE 9.
21.

FIBER OPTIC CABLE IS INSTALLED ALONG THE CORRIDOR. IF THIS CABLE, OR ANY OTHER EXISTING CITY TRAFFIC INFRASTRUCTURE, IS DAMAGED AS PART OF THIS PROJECT WORK, THE CONTRACTOR SHALL REPAIR OR REPLACE IT PER CITY OF ALBUQUERQUE TRAFFIC REQUIREMENTS. DAMAGED FIBER OPTIC CABLE SHALL BE REPLACED FROM EXISTING FULL SPLICE TO EXISTING FULL SPLICE; NO INTERMEDIATE SPLICE WILL BE ALLOWED. THIS WORK SHALL BE DONE AT THE EXPENSE OF THE CONTRACTOR AND NO ADDITIONAL PAYMENT WILL BE MADE.
22.

TWO WORKING DAYS PRIOR TO ANY EXCAVATION, THE CONTRACTOR SHALL CONTACT THE NEW MEXICO ONE CALL SYSTEM (260-1990) FOR LOCATION OF EXISTING UTILITIES.
23.

PRIOR TO CONSTRUCTION, THE CONTRACTOR SHALL EXCAVATE AND VERIFY THE HORIZONTAL AND VERTICAL LOCATIONS OF ALL OBSTRUCTIONS. SHOULD A CONFLICT EXIST, THE CONTRACTOR SHALL NOTIFY THE ENGINEER OR SURVEYOR IMMEDIATELY SO THAT THE CONFLICT CAN BE RESOLVED WITH A MINIMUM AMOUNT OF DELAY.
24.

SEVEN (7) WORKING DAYS PRIOR TO BEGINNING CONSTRUCTION, THE CONTRACTOR SHALL SUBMIT TO THE CONSTRUCTION SERVICES DIVISION A DETAILED CONSTRUCTION SCHEDULE. TWO (2) WORKING DAYS PRIOR TO CONSTRUCTION, THE CONTRACTOR SHALL OBTAIN A BARRICADING PERMIT FROM THE CONSTRUCTION SERVICES DIVISION. CONTRACTOR SHALL NOTIFY THE CONSTRUCTION COORDINATION ENGINEER (768-2551) PRIOR TO OCCUPYING AN INTERSECTION. REFER TO SECTION 19 OF THE GENERAL CONDITIONS OF THE STANDARD SPECIFICATIONS.
25.

ALL WORK AFFECTING ARTERIAL ROADWAYS MAY REQUIRE TWENTY-FOUR HOUR CONSTRUCTION.
26.

ALL STREET STRIPING ALTERED OR DESTROYED SHALL BE REPLACED W/ PLASTIC REFLECTORIZED PAVEMENT MARKING BY THE CONTRACTOR AT THE SAME LOCATION AS EXISTING, OR AS INDICATED BY THIS PLAN SET.

27.

CONTRACTOR SHALL NOTIFY THE ENGINEER NOT LESS THAN SEVEN (7) DAYS PRIOR TO STARTING WORK IN ORDER THAT THE CITY SURVEYOR MAY TAKE NECESSARY MEASURES TO ENSURE THE PRESERVATION OF SURVEY MONUMENTS. CONTRACTOR SHALL NOT DISTURB PERMANENT SURVEY MONUMENTS WITHOUT THE CONSENT OF THE CITY SURVEYOR AND SHALL NOTIFY THE CITY SURVEYOR AND BEAR THE EXPENSE OF REPLACING ANY THAT MAY BE DISTURBED WITHOUT PERMISSION. REPLACEMENT SHALL BE DONE ONLY BY THE CITY SURVEYOR. WHEN A CHANGE IS MADE IN THE FINISHED ELEVATIONS OF THE PAVEMENT OF ANY ROADWAY IN WHICH A PERMANENT SURVEY MONUMENT IS LOCATED, THE CONTRACTOR SHALL, AT HIS OWN EXPENSE, ADJUST THE MONUMENT COVER TO THE NEW GRADE UNLESS OTHERWISE SPECIFIED. REFER TO SECTION 4.4 OF THE GENERAL CONDITIONS OF THE STANDARD SPECIFICATIONS.
28.

THE CONTRACTOR SHALL RECORD DATA ON ALL UTILITY LINES AND ACCESSORIES AS REQUIRED BY THE CITY OF ALBUQUERQUE FOR THE PREPARATION OF "AS CONSTRUCTED" DRAWINGS. THE CONTRACTOR SHALL NOT COVER UTILITY LINES AND ACCESSORIES UNTIL ALL DATA HAS BEEN RECORDED.
29.

THE CONTRACTOR SHALL MAINTAIN A GRAFFITI-FREE WORK SITE, AND SHALL PROMPTLY REMOVE ANY GRAFFITI FROM ALL EQUIPMENT, WHETHER PERMANENT OR TEMPORARY.
30.

THE CONTRACTOR SHALL COORDINATE WITH THE WATER AUTHORITY SEVEN (7) DAYS IN ADVANCE OF PERFORMING WORK THAT WILL AFFECT THE PUBLIC WATER OR SANITARY SEWER INFRASTRUCTURE. WORK REQUIRING SHUTOFF OF FACILITIES DESIGNATED AS MASTER PLAN FACILITIES MUST BE COORDINATED WITH THE WATER AUTHORITY 14 DAYS IN ADVANCE OF PERFORMING SUCH WORK. ONLY WATER AUTHORITY CREWS ARE AUTHORIZED TO OPERATE PUBLIC VALVES. SHUTOFF REQUESTS MUST BE MADE ONLINE AT [HTTP://WWW.ABCWUA.ORG/WATER SHUT OFF AND TURN ON PROCEDURE.ASPX](http://www.abcwua.org/water-shut-off-and-turn-on-procedure.aspx)
31.

"R" VALUE. THE DESIGN "R" VALUE FOR THIS PROJECT IS 50. MATERIAL WITH AN "R" VALUE LESS THAN THE DESIGN "R" VALUE SHALL NOT BE PLACED IN OR AROUND THE TOP TWO (2) FEET OF THE FINISHED SUBGRADE.
32.

BUSINESS ACCESS: THE CONTRACTOR SHALL PROVIDE INGRESS AND EGRESS TO LOCAL BUSINESSES AND RESIDENCES FOR THE DURATION OF THE PROJECT. THE CONTRACTOR SHALL ADVISE OF AND SCHEDULE ACCESS CLOSURES, AT LEAST 24 HOURS IN ADVANCE, WITH PROPERTY OWNERS AND THE CITY ENGINEER.
33.

INTERSECTION WORK: CRITICAL INTERSECTION WORK SHALL NOT START UNTIL THE CONTRACTOR HAS ALL MATERIAL, EQUIPMENT, AND NECESSARY PERSONNEL ON-SITE. TRAFFIC CONTROL DEVICES SHALL NOT BE PLACED PREMATURELY.
34.

THE CONTRACTOR SHALL SUBMIT A PROPOSED WORK PLAN FOR PEDESTRIAN IMPROVEMENTS TO THE PROJECT ENGINEER FOR REVIEW AND APPROVAL PRIOR TO INITIATING THIS WORK. THIS PLAN SHALL INCLUDE THE METHOD PROPOSED TO MAINTAIN PEDESTRIAN ACCESS TO BUSINESSES, SCHOOLS, HOSPITALS, BUILDINGS, ETC. THROUGHOUT THE PEDESTRIAN IMPROVEMENTS CONSTRUCTION IN PARTICULAR. THE CONTRACTOR, AT MINIMUM, SHALL MAINTAIN A 36" CLEAR PATH FOR PEDESTRIANS SO AS TO MEET ADA ACCESSIBILITY REQUIREMENTS.
35.

AS-BUILTS: THE CONTRACTOR SHALL MAINTAIN AN UP TO DATE SET OF AS-BUILT PLANS FOR THE PROJECT. THESE PLANS SHALL BE KEPT CURRENT, WITHIN TWO WEEKS, AT ALL TIMES AND SHALL BE SUBJECT TO REVIEW BY THE PROJECT MANAGER THROUGHOUT THE PROJECT AND WILL BE REVIEWED BY THE PROJECT MANAGER FOR ACCURACY AND COMPLETENESS AT LEAST ONCE EVERY 30 DAYS. THE FINAL AS-BUILT PLANS SHALL BE SUBMITTED AND ACCEPTED BY THE PROJECT ENGINEER PRIOR TO FINAL PAYMENT.
36.

NON-VIBRATORY ROLLER: THE CONTRACT SHALL BE RESTRICTED TO THE USE OF A 35 TON MAXIMUM NON-VIBRATORY ROLLER TO OBTAIN THE REQUIRED COMPACTION IN PAVEMENT STRUCTURE, ROADWAY BACKFILL, EMBANKMENT, AND SUBGRADES IN URBAN AREAS WHERE THE USE OF HEAVIER EQUIPMENT COULD DAMAGE UNDERGROUND UTILITIES OR OTHER PERMANENT STRUCTURES.
37.

EXISTING TIE-IN: ALL NEW STREET PAVING, CURB AND GUTTER, SIDEWALKS OR DRIVEPADS SHALL MATCH THE ELEVATIONS OF ABUTTING EXISTING AREAS AS SHOWN IN THE PLANS OR AS DIRECTED BY THE PROJECT ENGINEER.
38.

ALL REMOVAL OF EXISTING PAVEMENT MARKINGS SHALL BE ACCOMPLISHED IN ACCORDANCE WITH SECTION 443 OF THE CITY OF ALBUQUERQUE STANDARD SPECIFICATIONS FOR PUBLIC WORKS CONSTRUCTION, CURRENT EDITION. PAINTING OVER EXISTING DOES NOT CONSTITUTE APPROVED REMOVAL OR OBLITERATION.

UTILITY COMPANY CONTACTS

PNM—ELECTRIC

CHRIS BUDD
Project Manager
4201 Edith Blvd., NE
Albuquerque, New Mexico 87107
(505) 241–3698

LEVEL 3

JOHN HUFNAGEL
3830 Singer Blvd., NE Suite 2000
Albuquerque, New Mexico 87109
(505) 938–7326

NEW MEXICO GAS CO.

ROBERT SMITH
4625 Edith Blvd., NE
Albuquerque, New Mexico 87107
(505) 697–3169

COMCAST CABLE

MIKE MORTUS
8440 Washington St., NE
Albuquerque, New Mexico 87103
(505) 269–4006

ZAYO

JIM LARKIN
3150 Carlisle Blvd., NE Suite 112
Albuquerque, New Mexico 87110
(505) 835–7987

ABCWUA



(WATER & SEWER)

DAVID LAUGHLIN
SENIOR ENGINEER
P.O. Box 568
Albuquerque, New Mexico 87103
(505) 289–3035

CENTURY LINK

JAMES ARAGON
Area Engineer
201 3rd Street NW Room 700
Albuquerque, New Mexico 87102
(505) 245–6374





				CITY OF ALBUQUERQUE DEPARTMENT OF MUNICIPAL DEVELOPMENT ENGINEERING DIVISION			
TITLE: GABALDON/LEOPOLDO INTERSECTION IMPROVEMENTS							
GENERAL NOTES							
Design Review Committee		City Engineer Approval		Last Design Update		No. / Day / Yr.	
							
City Project No.		Zone Map No.		Sheet		Of	
789092		H-12		2		10	

SUMMARY OF QUANTITIES

ITEM NO.	DESCRIPTION	UNIT	ESTIMATE
301.02	SUBGRADE PREP, 12" AT 95% COMPACTION , CIP.	S.Y.	150
336.01	PRIME COAT, EMULSFIED ASPHALT, CIP.	S.Y.	150
336.08	ASPHALT CONC., PLACEMENT, 3" THICK, ARTERIAL FRADATION SP III	S.Y.	150
336.12	TACK COAT, CATIONIC EMULSIFIED ASPHALT, CIP.	S.Y.	150
340.01	SIDEWALK, 4" THICK, PORTLAND CEMENT CONCRETE, INCL. SUBGRADE COMPACTION , CIP.	S.Y.	90
340.023	WHEELCHAIR ACCESS RAMP, 4" PCC, STD. CURB., CIP.	S.Y.	25
340.0231A	DETECTABLE WARNING SURFACE ON NEW OR EXISTING HC RAMPS	S.F.	30
340.03	VALLEY GUTTER & CURB, PCC, CIP. SD 2420	S.Y.	100
340.05	CURB & GUTTER, STANDARD, PORTLAND CEMENT CONCRETE, INCL. SUBGRADE PREPARATION, CIP.	L.F.	450
340.11	HEADER CURB, PORTLAND CEMENT CONCRETE, INCL. SUBGRADE, CIP.	L.F.	30
343.02	EXISTING PAVEMENT, ASPHALT CONCRETE, UP TO 4" THICK, SAWCUT, REMOVE & DISPOSE, COMPL.	S.Y.	300
343.08	EXISTING CURB & GUTTER, PC CONCRETE, REMOVE & DISPOSE , COMPL.	L.F.	350
440.035	NON-REFELCTORIZED PAINTED MARKING, ANY COLOR OR SHAPE, CIP.	S.F.	30
441.001	REFLECTORIZED PLASTIC MARKINGS, 4" WIDTH, CIP.	L.F.	765
441.005	REFLECTORIZED PLASTIC MARKINGS, 24" WIDTH, CIP.	L.F.	160
441.034	REFLECTORIZED PLASTIC MARKING, WORD & SYMBOL, CIP.	S.F.	16
443.101	REMOVAL OF PAVEMENT STRIPE, ANY WIDTH, PAINTED OR PLASTIC, COMPL.	L.F.	400
450.001	ALUMINUM PANEL SIGN, CIP.	S.F.	20
450.01	SQUARE TUBE STEEL POST AND BASE FOR ALUMINUM PANEL SIGN, CIP.	L.F.	50
701.1	TRENCHING, BACKFILLING, & COMPACTION, FOR 18" TO 36" SD PIPE, UP TO 8' N DEPTH	L.F.	7
910.103	DRAINLINE REMOVAL, 10" - 18" EXCL. TRENCHING	L.F.	7
915.03	CATCH BASIN, TYPE "C", SINGLE GRATE, CIP.	EACH	1
915.07	CATCH BASIN, EXISTING, REMOVE & DISPOSE, ANY TYPE, INCL. CLEANUP,COMPL.	EACH	1
	SUBTOTAL		

ENGINEERS SEAL		SURVEY INFORMATION		BENCH MARKS		AS-BUILT INFORMATION	
NO.	DATE	REMARKS	FIELD NOTES		CONTRACTOR	INSPECTOR'S NAME	DATE
			BY	DATE			
					COA STATION 3 1/4" ALUMINUM DISK STAMPED		
					"7-813 1985" SET FLUSH WITH TOP OF THE CURB		
					LOCATED AT THE INTERSECTION OF RIO GRANDE		
					BOULEVARD AND SAN FRANCISCO ROAD, ON THE		
					SOUTHWEST CORNER 34.7 FT FROM RIO GRANDE		
					BOULEVARD CENTERLINE.		
DESIGNED BY: SL					MICRO-FILM INFORMATION		
DRAWN BY: ZT					RECORDED BY		
CHECKED BY					NO.		
					N=1495058.464 E=1514348.572; ELEV.=4963.168		

	CITY OF ALBUQUERQUE DEPARTMENT OF MUNICIPAL DEVELOPMENT ENGINEERING DIVISION			
TITLE: GABALDON/LEOPOLDO INTERSECTION IMPROVEMENTS SUMMARY OF QUANTITIES				
Design Review Committee 	City Engineer Approval 	& Last Design Update	Mo. / Day / Yr. 	Mo. / Day / Yr.
City Project No. 789092	Zone Map No. H-12	Sheet 3	Of 10	

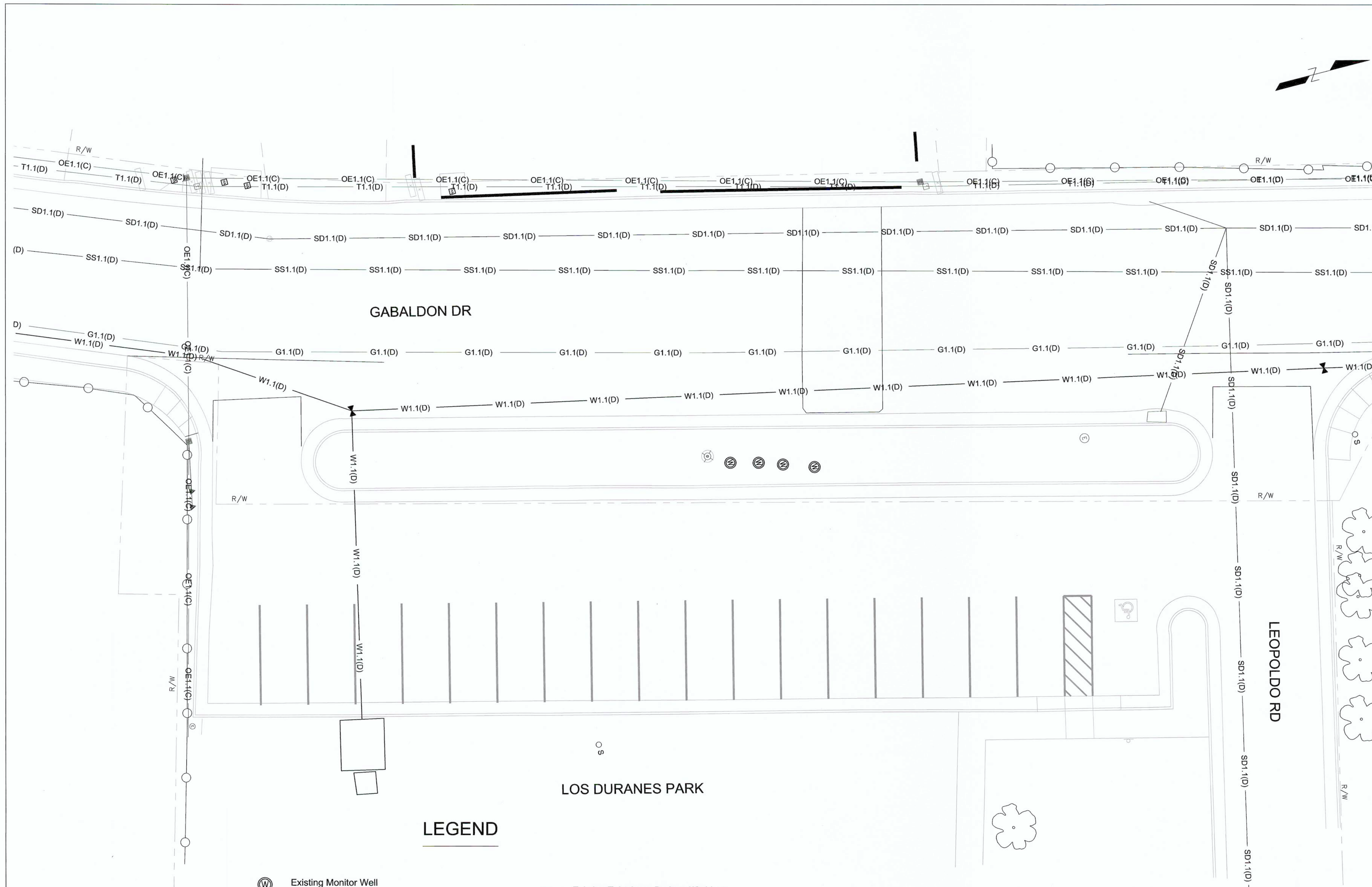

LEGAL DESCRIPTION:
SUMMARY PLAT
LOS DURANES PARK
ZONING = SU-2 FOR LD RA-2
EX. PARKING SPACES = 20
EX. HANDICAP PARKING
SPACES = 1
SIZE: 7.37 ACRES

LEGEND

- | | | | |
|--|--------------------------|--|-------------------------------------|
| | Existing Monitor Well | | Existing Telephone Pedestal/Cabinet |
| | Existing Fire Hydrant | | Existing Storm Drain Manhole |
| | Existing Water Valve | | Existing SAS Manhole |
| | Existing Water Meter | | Existing Guy Anchor |
| | Existing Chainlink Fence | | Existing Power Pole |
| | Existing Metal Fence | | Existing Light Pole |
| | Existing Mailbox | | Existing Electric Box/Panel |
| | Existing Tree | | Existing Single Post Sign |

SUE LEGEND

- | | | | |
|--|----------|-------------------|-------------------------|
| | T1.1(D) | Quality Level C/D | Utility: |
| | OE1.1(C) | | TELEPHONE - CENTURYLINK |
| | W1.1(D) | | OH ELECTRIC - PNM |
| | SS1.1(D) | | WATER - ABCWUA |
| | SD1.1(D) | | SANITARY SEWER - ABCWUA |
| | G1.1(D) | | STORM SEWER - ABCWUA |
| | | | GAS - NM GAS CO. |

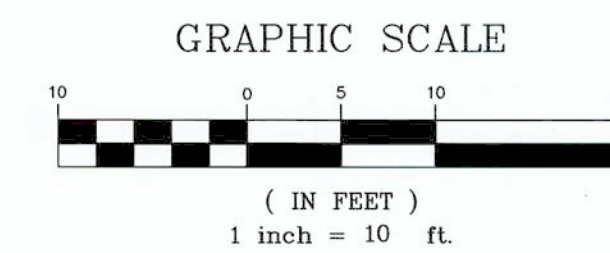

(BASED ON 24"x36" SHEET)

AS BUILT INFORMATION		BENCH MARKS		SURVEY INFORMATION		ENGINEERS SEAL	
CONTRACTOR		A COA STATION 3 1/4" ALUMINUM DISK STAMPED		FIELD NOTES			
DATE		"7-813 1985" SET FLUSH WITH TOP OF THE CURB		NO.			
DATE		LOCATED AT THE INTERSECTION OF RIO GRANDE		BY			
DATE		BOULEVARD AND SAN FRANCISCO ROAD ON THE					
DATE		SOUTHWEST CORNER 34.7 FT FROM RIO GRANDE					
DATE		BOULEVARD CENTERLINE.					
DATE		DATUM NAD 83 N.M. STATE PLANE CENTRAL					
DATE		N=1495058.484 E=1514348.572 ELEV=4963.168					

CITY OF ALBUQUERQUE DEPARTMENT OF MUNICIPAL DEVELOPMENT ENGINEERING DIVISION	
TITLE: GABALDON/LEOPOLDO INTERSECTION IMPROVEMENTS EXISTING LAYOUT	
Design Review Committee 	City Engineer Approval
City Project No. 789092	Zone Map No. H-12
Sheet 4	Of 10

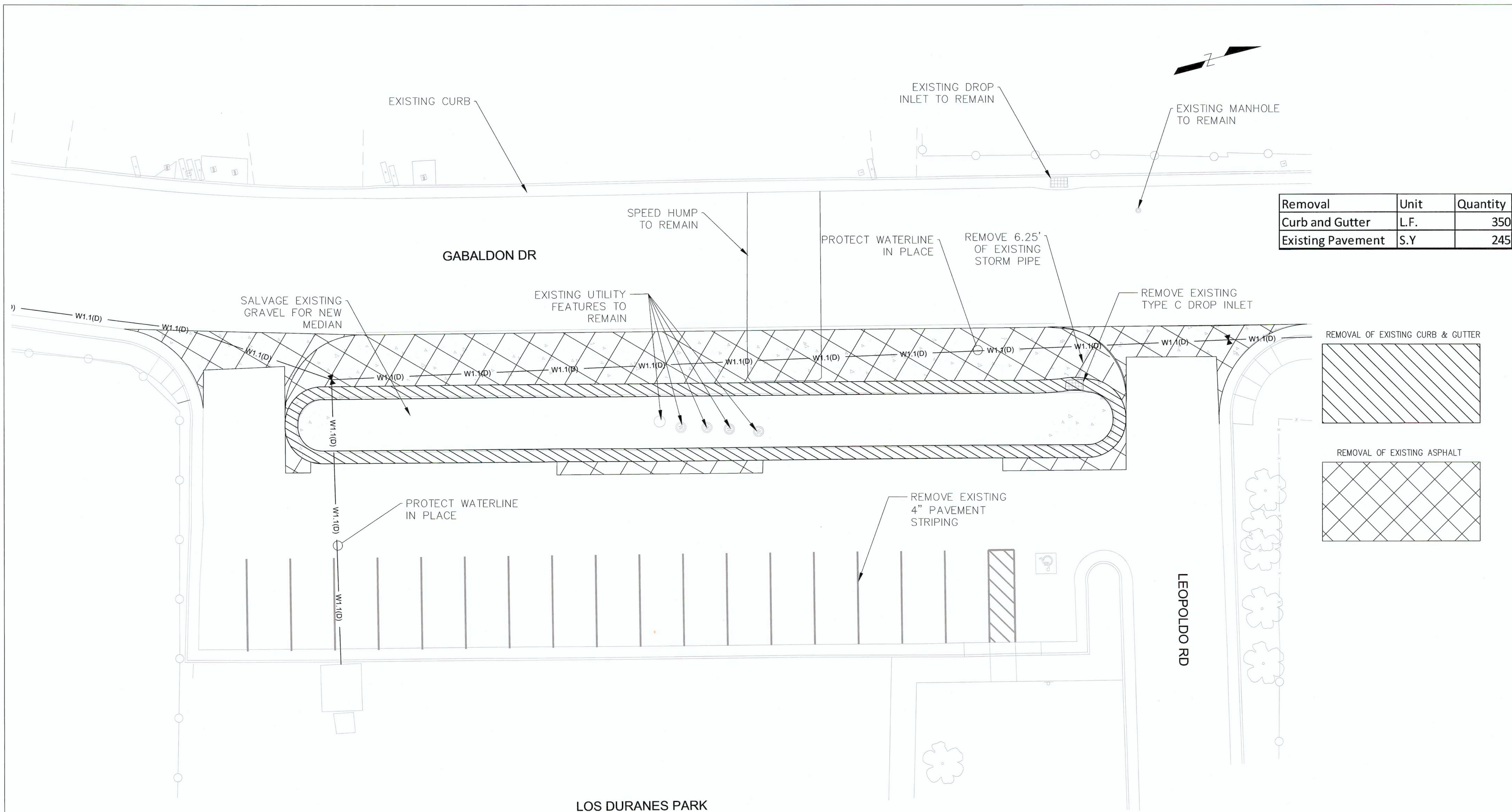

Removal	Unit	Quantity
Curb and Gutter	L.F.	350
Existing Pavement	S.Y	245

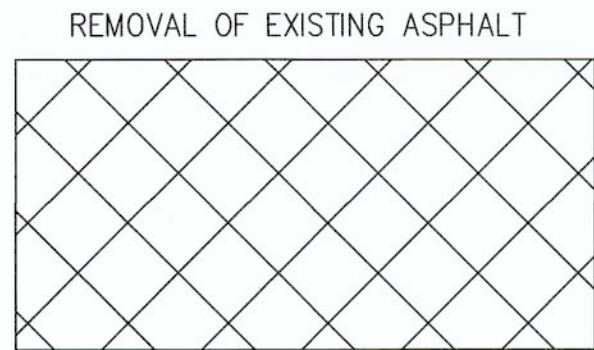
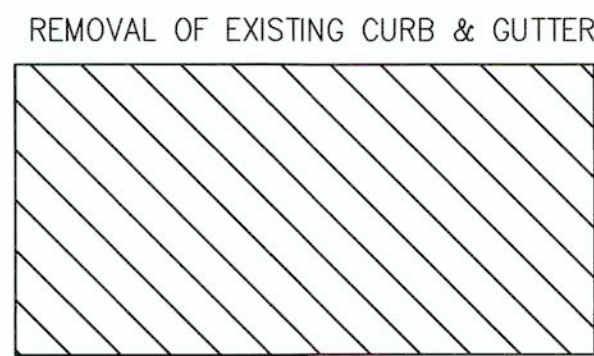

AS BUILT INFORMATION		BENCH MARKS		SURVEY INFORMATION		ENGINEERS SEAL	
CONTRACTOR	WORKED BY	A COA STATION 3 1/4" ALUMINUM DISK STAMPED	DATE	NO.	BY	NO.	BY
INSPECTOR'S	DATE	"7-813 1985" SET FLUSH WITH TOP OF THE CURB	DATE				
ACCEPTANCE BY	DATE	LOCATED AT THE INTERSECTION OF RIO GRANDE	DATE				
VERIFICATION BY	DATE	BOULEVARD AND SAN FRANCISCO ROAD ON THE	DATE				
COMPILED BY	DATE	SOUTHWEST CORNER 34.7 FT FROM RIO GRANDE	DATE				
RECORDED BY	DATE	BOULEVARD CENTERLINE.	DATE				
NO.		DATUM NAD 83 N.M. STATE PLANE CENTRAL					
		N=1495058.484 E=1514348.572, ELEV.=4963.168					

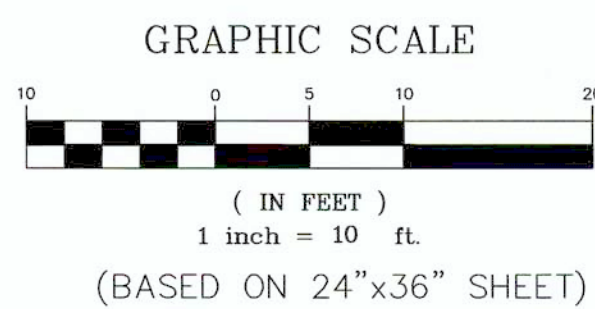

CITY OF ALBUQUERQUE
DEPARTMENT OF MUNICIPAL DEVELOPMENT
ENGINEERING DIVISION

TITLE: GABALDON/LEOPOLDO INTERSECTION IMPROVEMENTS
REMOVALS

DESIGN REVIEW COMMITTEE

CITY ENGINEER

City Project No.	789092	Zone Map No.	H-12	Sheet	5	Of	10
------------------	--------	--------------	------	-------	---	----	----

C2 Point Table	
QUARTER POINTS	Elevation
25	4962.34
43	4962.35
26	4962.36

C1 Point Table	
QUARTER POINTS	Elevation
20	4961.40
42	4961.65
21	4961.78

Point Table				
Point #	Elevation	Northing	Easting	Description
1*	4962.17	1496204.84	1511117.05	PC
2*	4962.16	1496207.81	1511119.25	PT
3	4962.15	1496206.78	1511117.53	INT
4	4962.49	1496225.97	1511105.99	INT
5	4962.25	1496278.04	1511118.93	INT
6*	4961.94	1496256.77	1511129.39	PC
8	4961.99	1496257.81	1511131.11	INT
7*	4961.92	1496257.32	1511133.05	PT
9*	4961.75	1496291.20	1511141.47	PC
10*	4961.73	1496292.72	1511141.24	PT
11	4961.74	1496291.68	1511139.52	INT
12	4961.94	1496311.83	1511127.40	INT
13	4961.77	1496352.59	1511137.49	PC
14	4961.74	1496353.37	1511145.57	PT
15*	4961.49	1496340.39	1511151.05	PC
16*	4961.48	1496340.80	1511153.79	PT
17	4961.48	1496342.46	1511152.14	INT
18	4961.31	1496356.76	1511155.70	PC
19	4961.34	1496362.81	1511152.10	PT
20	4961.40	1496364.27	1511146.46	PC
21	4961.78	1496354.80	1511130.57	PT
22	4961.92	1496321.88	1511122.46	POINT
23	4962.06	1496289.84	1511114.57	POINT
24	4962.20	1496257.80	1511106.67	POINT
25	4962.34	1496224.88	1511098.56	PC
26	4962.36	1496209.16	1511108.03	PT
27	4962.44	1496180.29	1511085.78	EX ELEV
28	4962.50	1496185.96	1511117.56	EX ELEV
29*	4961.03	1496358.80	1511180.86	EX ELEV
30	4961.64	1496379.78	1511177.17	EX ELEV
31	4961.78	1496403.82	1511142.50	EX ELEV
32	4962.14	1496200.60	1511127.40	EX ELEV
33	4961.89	1496270.04	1511144.61	EX ELEV
34	4961.40	1496346.60	1511163.18	EX ELEV
35	4961.23	1496365.90	1511191.50	EX ELEV
36*	4161.96	1496209.65	1511155.58	EX ELEV
37*	4161.69	1496265.95	1511169.75	EX ELEV
38*	4161.46	1496345.10	1511189.24	EX ELEV
39*	4161.20	1496347.61	1511178.83	EX ELEV
40*	4161.17	1496353.14	1511173.17	EX ELEV
41	4961.24	1496361.43	1511162.20	EX ELEV

*ELEVATION TAKEN FROM LIP OF GUTTER

Curve Table				
Curve #	Length	Radius	Delta	POINT LOCATION
C1	20.58	13.00	90.69	FACE OF CURB
C2	20.38	13.00	89.82	FACE OF CURB
C3	4.71	2.00	135.07	LIP OF GUTTER
C4	4.71	2.00	135.00	LIP OF GUTTER
C5	1.57	2.00	45.00	LIP OF GUTTER
C6	10.61	4.50	135.08	FACE OF CURB
C7	3.53	1.50	135.00	LIP OF GUTTER
C8	7.80	5.00	89.42	FACE OF CURB

- NOTES:
- 1.) ALL ELEVATIONS ARE TO FLOWLINE UNLESS OTHERWISE NOTED
 - 2.) SEE SHEET 9 FOR CURB RAMP DETAILS
 - 3.) SEE SHEET 10 FOR MODIFIED GRATE DETAIL (TO BE USED FOR NEW INLET)
 - 4.) SALVAGE EXISTING GRAVEL FOR NEW MEDIAN
 - 5.) PROPOSED PARKING SPACES = 18
PROPOSED HANDICAP SPACES = 1
PROPOSED MOTORCYCLE SPACES = 2
 - 6.) IF NEEDED CONTRACTOR SHALL ADJUST CURB AROUND WATER VALVE PER COA STD DWG # 2460

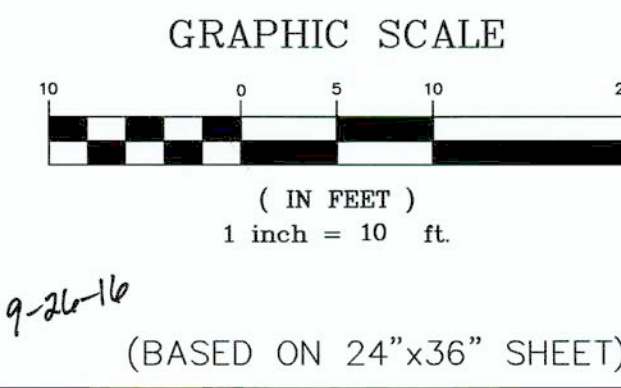

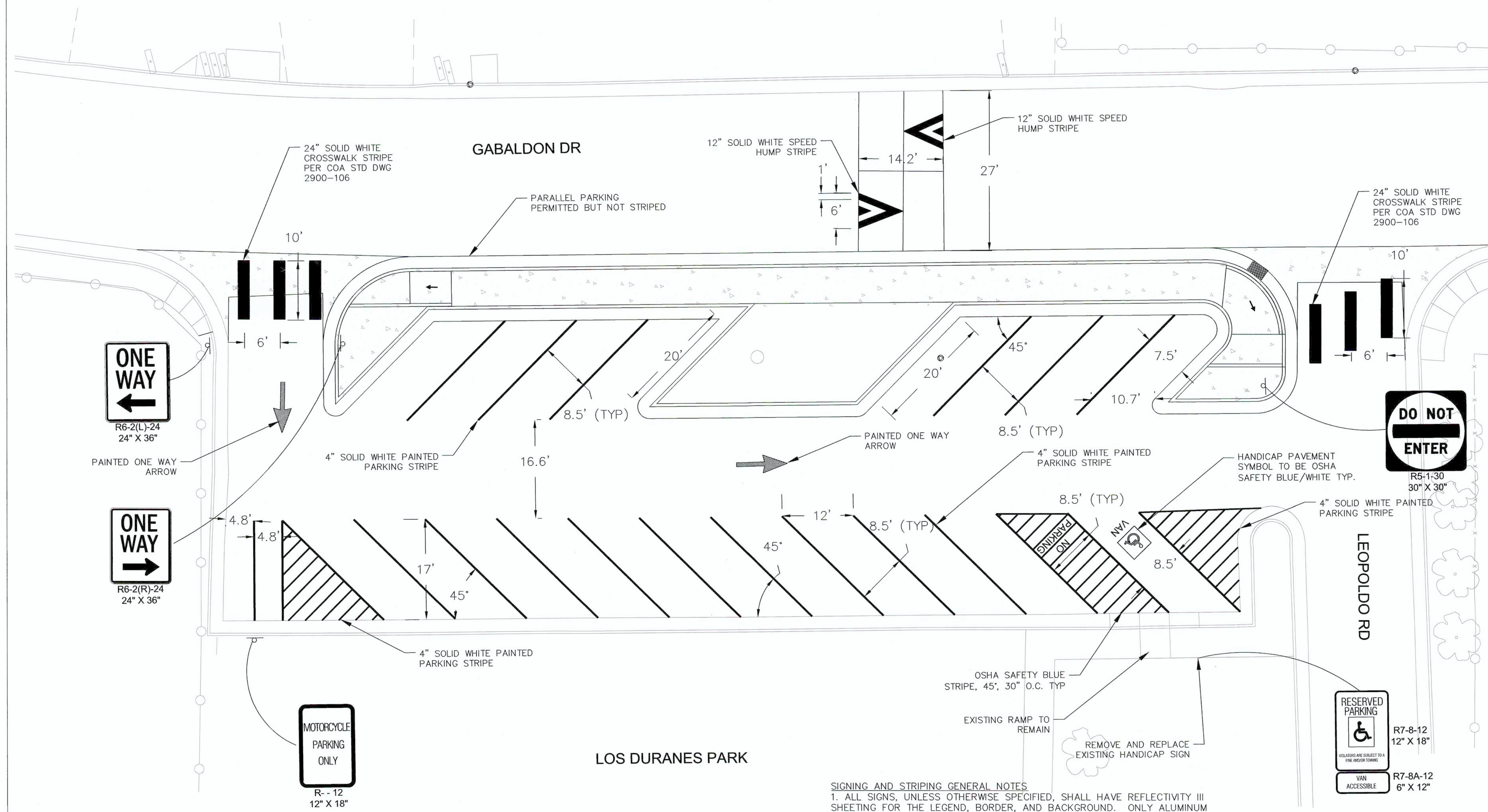

		CITY OF ALBUQUERQUE DEPARTMENT OF MUNICIPAL DEVELOPMENT ENGINEERING DIVISION	
TITLE: GABALDON/LEOPOLDO INTERSECTION IMPROVEMENTS OVERALL LAYOUT/GRADING PLAN			
Design Review Committee 	City Engineer Approval 	No. / Day / Yr. _____	No. / Day / Yr. _____
City Project No. 789092	Zone Map No. H-12	Sheet 6	Of 10

AS BUILT INFORMATION		BENCH MARKS		SURVEY INFORMATION		ENGINEER'S SEAL	
CONTRACTOR	WORK STARTED BY	A COA STATION 3 1/4" ALUMINUM DISK STAMPED	DATE	FIELD NOTES	DATE	NO.	BY
ACCEPTANCE BY	DATE	77-813 1985" SET FLUSH WITH TOP OF THE CURB LOCATED AT THE INTERSECTION OF RIO GRANDE BOULEVARD AND SAN FRANCISCO ROAD ON THE SOUTHWEST CORNER 34.7 FT FROM RIO GRANDE BOULEVARD CENTERLINE.	DATE				
DESIGNED BY	DATE	DATUM NAD 83 N.M. STATE PLANE CENTRAL	DATE				
DRAWN BY	DATE	N=1495058.484 E=1514348.572 ELEV=4963.168	DATE				
CHECKED BY	DATE		DATE				

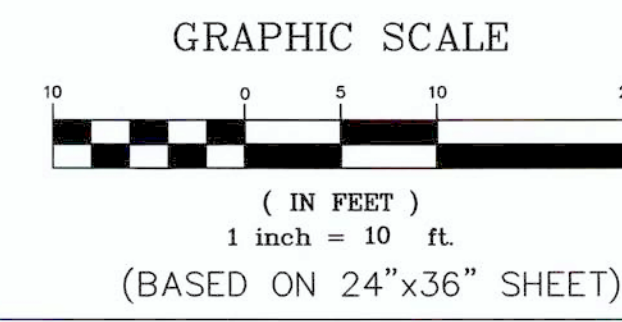

- SIGNING AND STRIPING GENERAL NOTES**
1. ALL SIGNS, UNLESS OTHERWISE SPECIFIED, SHALL HAVE REFLECTIVITY III SHEETING FOR THE LEGEND, BORDER, AND BACKGROUND. ONLY ALUMINUM PANEL SIGNS ARE PERMITTED.
 2. QUANTITIES MAY VARY AS FIELD CONDITIONS DICTATE. THE CONTRACTOR WILL BE PAID FOR ACTUAL QUANTITIES USED.
 3. EACH SIGN FACE SHOWN ON PLANS SHALL MEET THE SPECIFICATIONS IN THE STANDARD HIGHWAY SIGNS MANUAL (CURRENT EDITION) FOR PROPER ARRANGEMENT, SPACING OF LETTERS, LETTER HEIGHT, LETTER SERIES, SYMBOLS, AND BORDERS FOR THE SPECIFIED SIZE AND MESSAGE AS SHOWN ON PLANS.
 4. POST LENGTHS AREA BASED ON A MINIMUM OF 7 FT TO BOTTOM OF SIGN. SEE DETAIL SHEET C-010.
 5. THE LATERAL CLEARANCE OF SIGNS SHALL BE NO CLOSER THAN 2 FT. FROM FACE OF CURB.
 6. ALL SIGNING HARDWARE, INCLUDING BRACKETS, IS CONSIDERED INCIDENTAL TO SIGN INSTALLATION. NO PAYMENT WILL BE MADE THEREFOR.
 7. ALL STRIPING SHALL BE HOT THERMOPLASTIC.





CITY OF ALBUQUERQUE
DEPARTMENT OF MUNICIPAL DEVELOPMENT
ENGINEERING DIVISION

TITLE: GABALDON/LEOPOLDO INTERSECTION IMPROVEMENTS
SIGNING AND STRIPING PLAN

Design Review Committee

APPROVED

SEP 27 2016

DESIGN REVIEW COMMITTEE

City Engineer Approval

APPROVED

OCT 26 2016

CITY ENGINEER

City Project No. 789092

Zone Map No. H-12

Sheet 7 of 10

REVISIONS	
NO.	DATE

DESIGNED BY: SL
DRAWN BY: ZT
CHECKED BY:

DATE:
DATE:
DATE:

SURVEY INFORMATION				ENGINEERS SEAL			
FIELD NOTES		DATE	BY	REMARKS		DATE	BY
NO.							

BENCH MARKS				AS BUILT INFORMATION			
A COA STATION 3 1/4" ALUMINUM DISK STAMPED 77-813 1985" SET FLUSH WITH TOP OF THE CURB LOCATED AT THE INTERSECTION OF RIO GRANDE BOULEVARD AND SAN FRANCISCO ROAD ON THE SOUTHWEST CORNER 34.7 FT FROM RIO GRANDE BOULEVARD CENTERLINE. DATUM NAD 83 N.M. STATE PLANE CENTRAL N=1495058.484 E=1514348.572 ELEV=4963.168				CONTRACTOR	WORK STARTED BY	DATE	
					ACCEPTED BY	DATE	
					FIELD INSPECTION BY	DATE	
					DRAWINGS CORRECTED BY	DATE	
					MICRO-FILM INFORMATION		
					RECORDED BY	DATE	
					NO.		

M:\TRN\11-100-216-00\CADD\SHEETS\Striping.dwg 8/9/2012 9:14:07 AM, PDF995

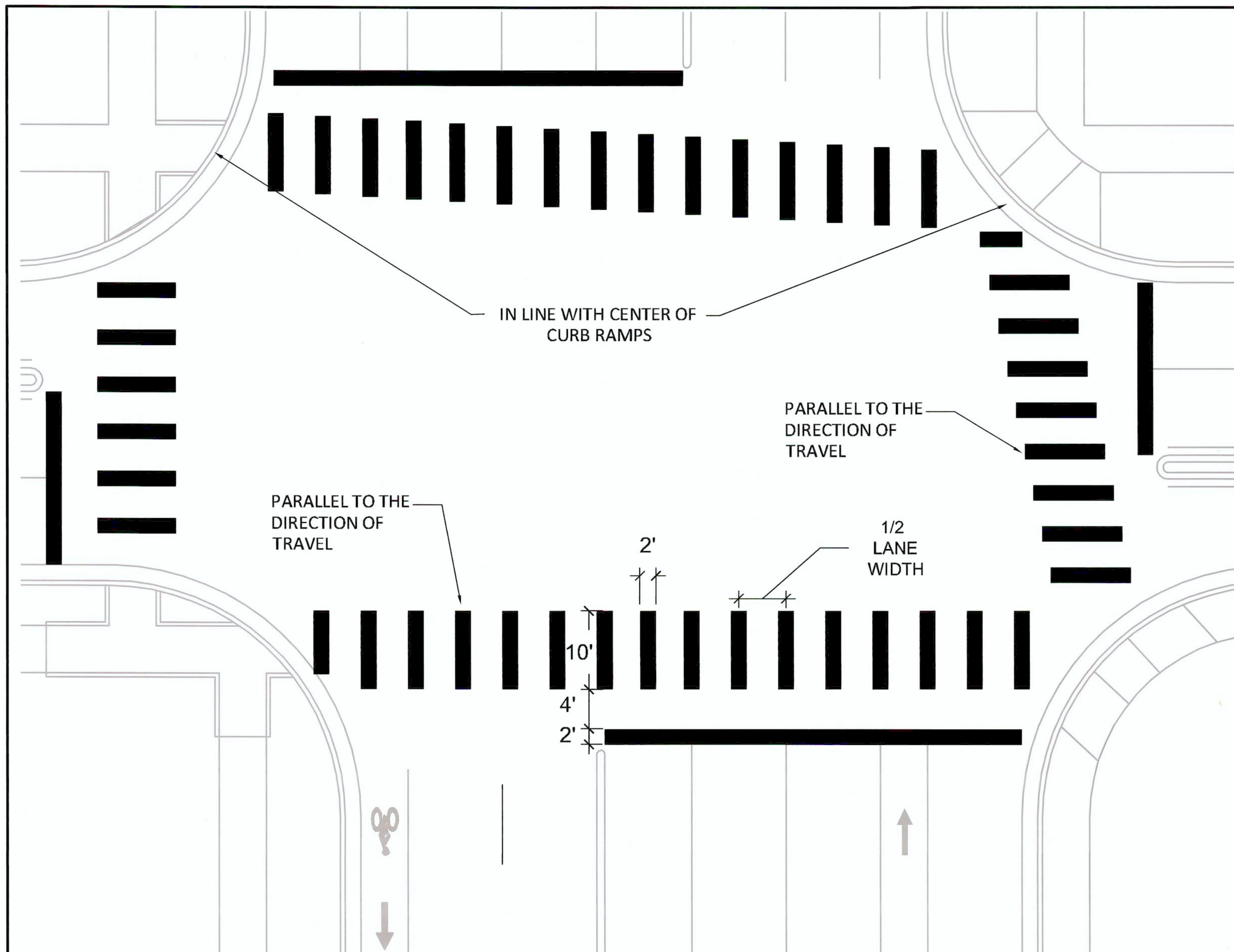

CROSSWALK MARKING NOTES:

1. WHEN CROSSWALK LINES ARE APPLIED THE "CONTINENTAL" TYPE SHALL BE USED, CONSISTING OF SOLID WHITE LONGITUDINAL LINES 10 FEET IN LENGTH AND 2 FEET WIDE.
2. THE DESIGN OF THE LINES SHALL BE INSTALLED AT THE CENTER OF EACH DRIVING LANE, RIGHT TURN LANE, AND LEFT TURN LANE; CENTERED BETWEEN EACH LANE PARALLEL TO THE DIRECTION OF TRAVEL AS SHOWN.
3. CROSSWALK LINES SHOULD EXTEND ACROSS THE FULL WIDTH OF THE ROADWAY PAVEMENT OR TO THE EDGE OF THE INTERSECTING CROSSWALK TO DISCOURAGE DIAGONAL WALKING BETWEEN CROSSWALKS.
4. CROSSWALK MARKING SHOULD BE LOCATED SO THAT THE CURB RAMPS ARE WITHIN THE EXTENSION OF THE CROSSWALK MARKINGS.

NOTE: MID-BLOCK CROSSINGS SHALL NOT BE PERMITTED WITHIN ALBUQUERQUE CITY LIMITS, UNLESS APPROVED BY CITY OF ALBUQUERQUE TRAFFIC ENGINEERING.

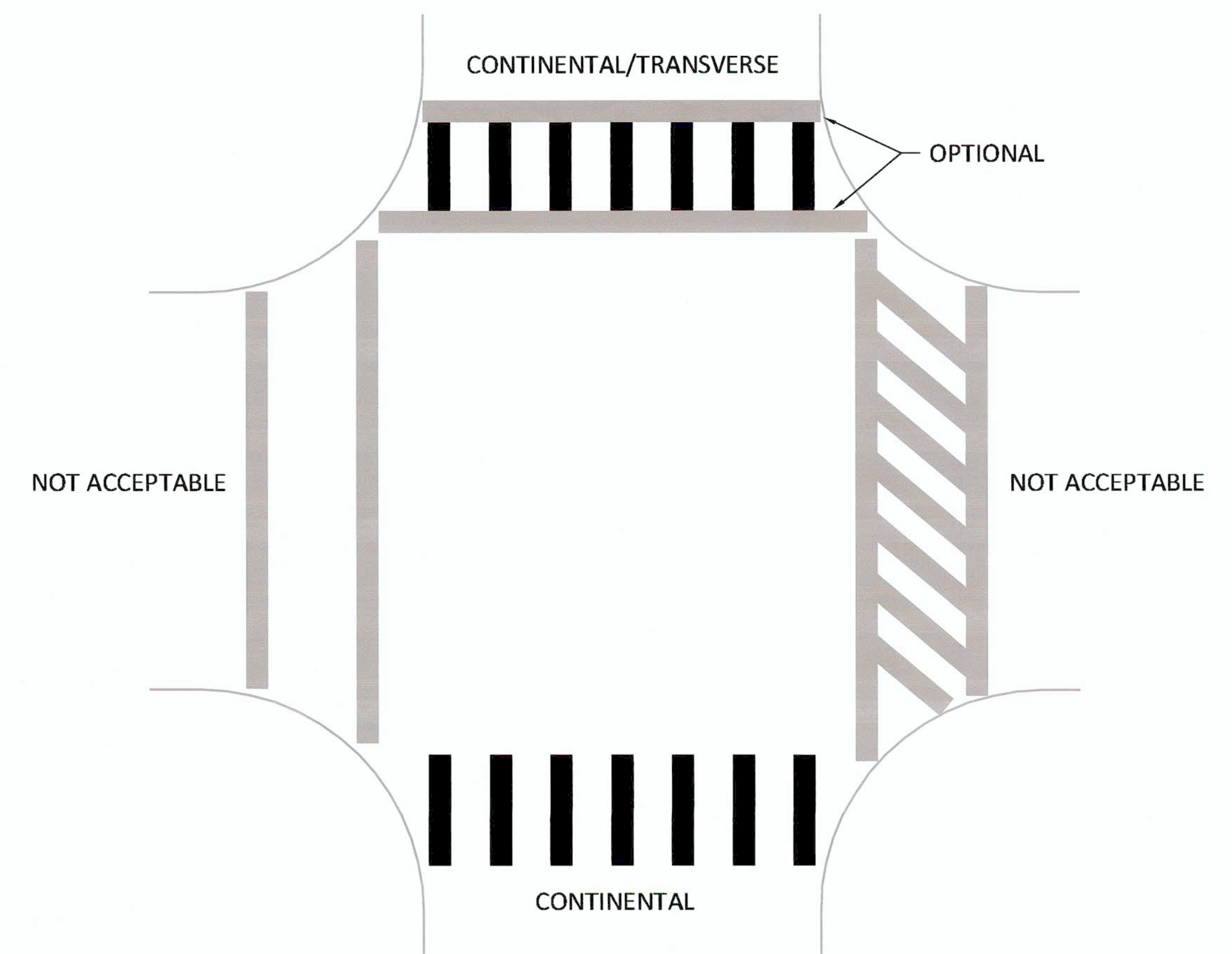

REVISIONS	CITY OF ALBUQUERQUE
	ROADWAY STRIPING
	CROSSWALK MARKING DETAILS
	DWG. 2900-106 JULY 2012

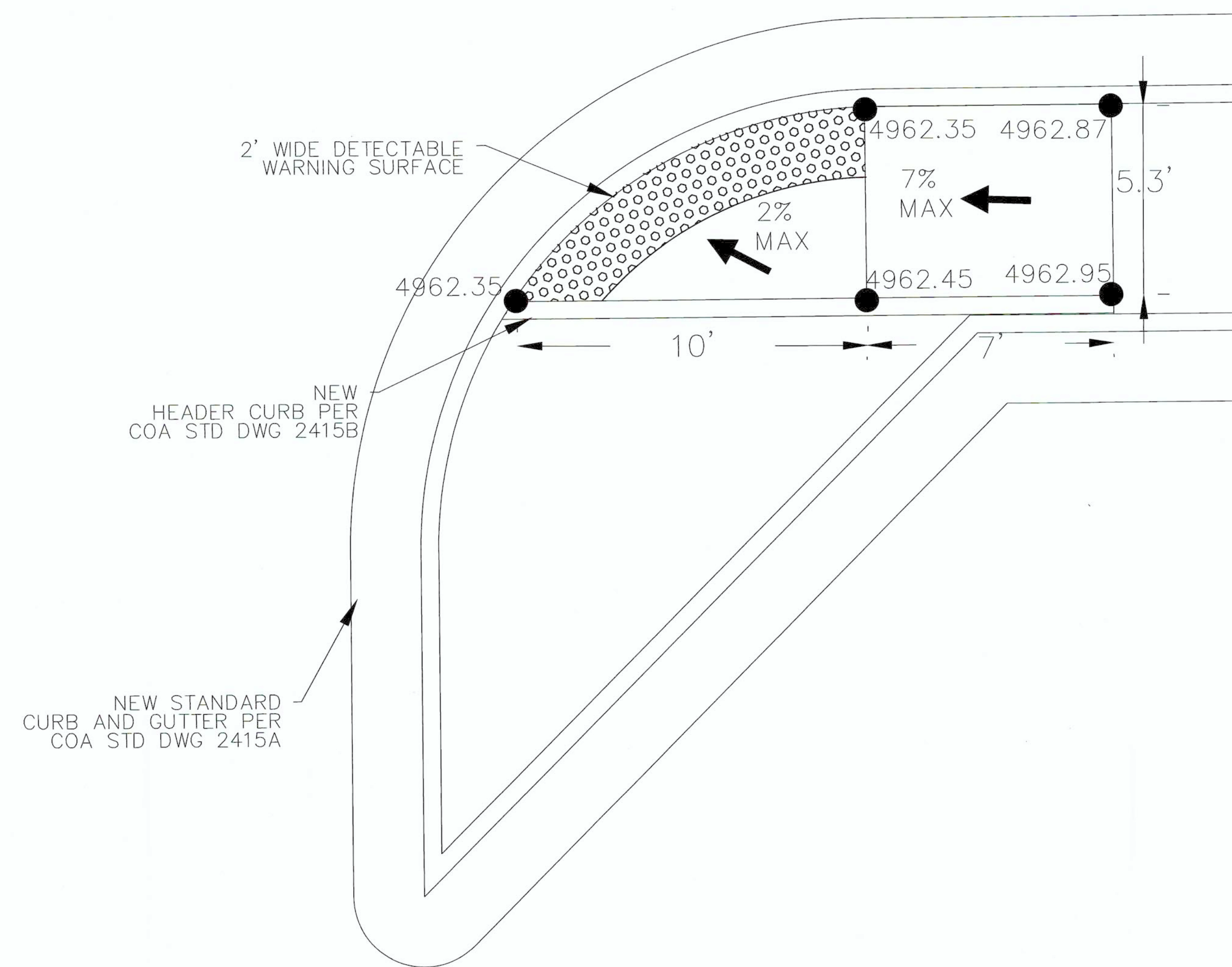

CURB RAMP DETAIL, NE CORNER OF
GABALDON RD AND DRIVEWAY

NTS

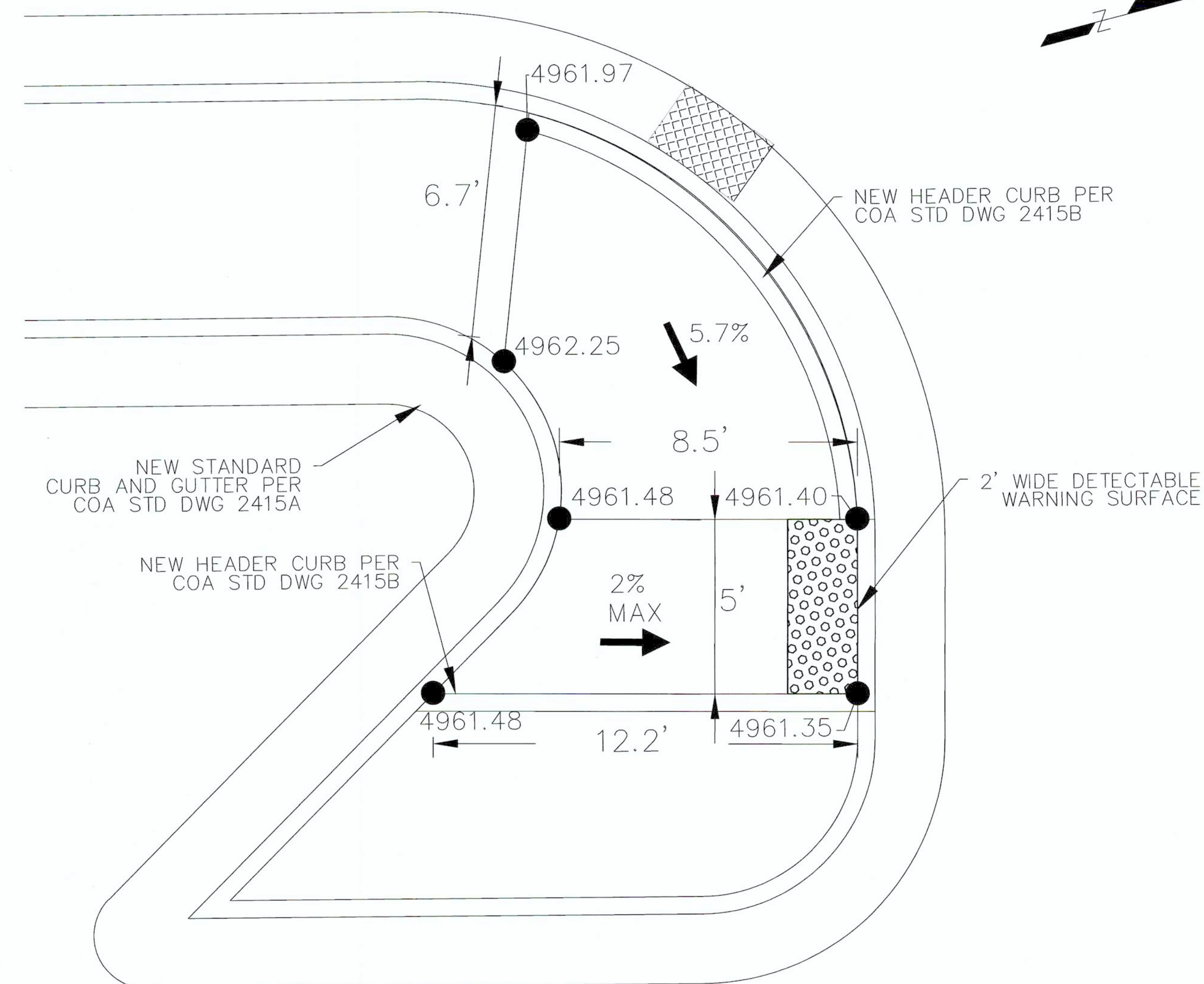

CURB RAMP DETAIL, SE CORNER OF
GABALDON RD AND LEOPOLDO RD

NTS

NOTES:

1. THE RUNNING SLOPE OF THE CURB RAMPS SHALL BE 7% MAXIMUM
2. THE CROSS SLOPE OF THE CURB RAMPS SHALL BE 1.5% MAXIMUM
3. USE CAST-IN-PLACE REPLACEABLE DETECTABLE WARNING SURFACE

AS BUILT INFORMATION		BENCH MARKS		SURVEY INFORMATION		ENGINEER'S SEAL	
CONTRACTOR	DATE	A COA STATION 3 1/4" ALUMINUM DISK STAMPED	DATE	NO.	BY		REMARKS REVISIONS DESIGN
WORKS BY	DATE	"7-81.3 1985" SET FLUSH WITH TOP OF THE CURB	DATE				
INSPECTOR'S	DATE	LOCATED AT THE INTERSECTION OF RIO GRANDE	DATE				
ACCEPTANCE BY	DATE	BOULEVARD AND SAN FRANCISCO ROAD ON THE	DATE				
VERIFICATION BY	DATE	SOUTHWEST CORNER 34.7 FT FROM RIO GRANDE	DATE			DESIGNED BY: SL	DATE
DRAWN BY	DATE	BOULEVARD CENTERLINE.	DATE			DRAWN BY: ZT	DATE
MICRO-FILM INFORMATION		DATUM NAD 83 N.M. STATE PLANE CENTRAL				CHECKED BY	
		N=1495058.484 E=1514348.572, ELEV=4963.168					

CITY OF ALBUQUERQUE DEPARTMENT OF MUNICIPAL DEVELOPMENT ENGINEERING DIVISION	
TITLE: GABALDON/LEOPOLDO INTERSECTION IMPROVEMENTS CURB RAMP DETAIL SHEET	
Design Review Committee 	City Engineer Approval
City Project No. 789092	Zone Map No. H-12
Sheet 9	Of 10

(BASED ON 24"x36" SHEET)

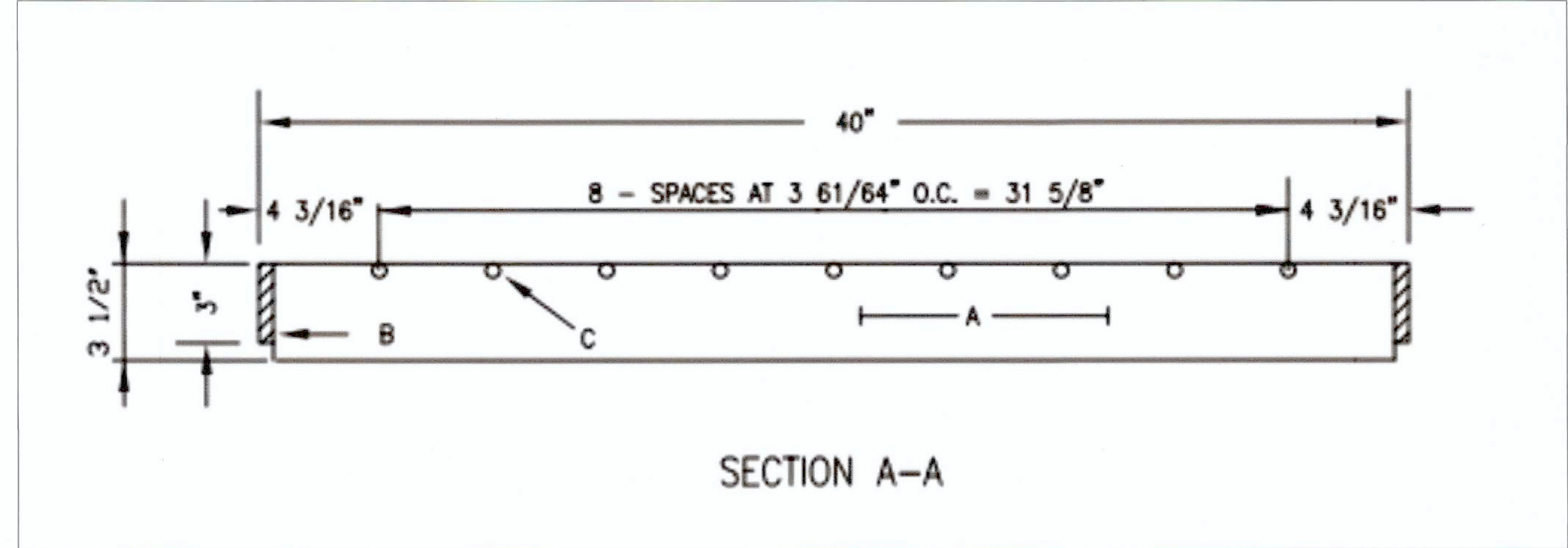
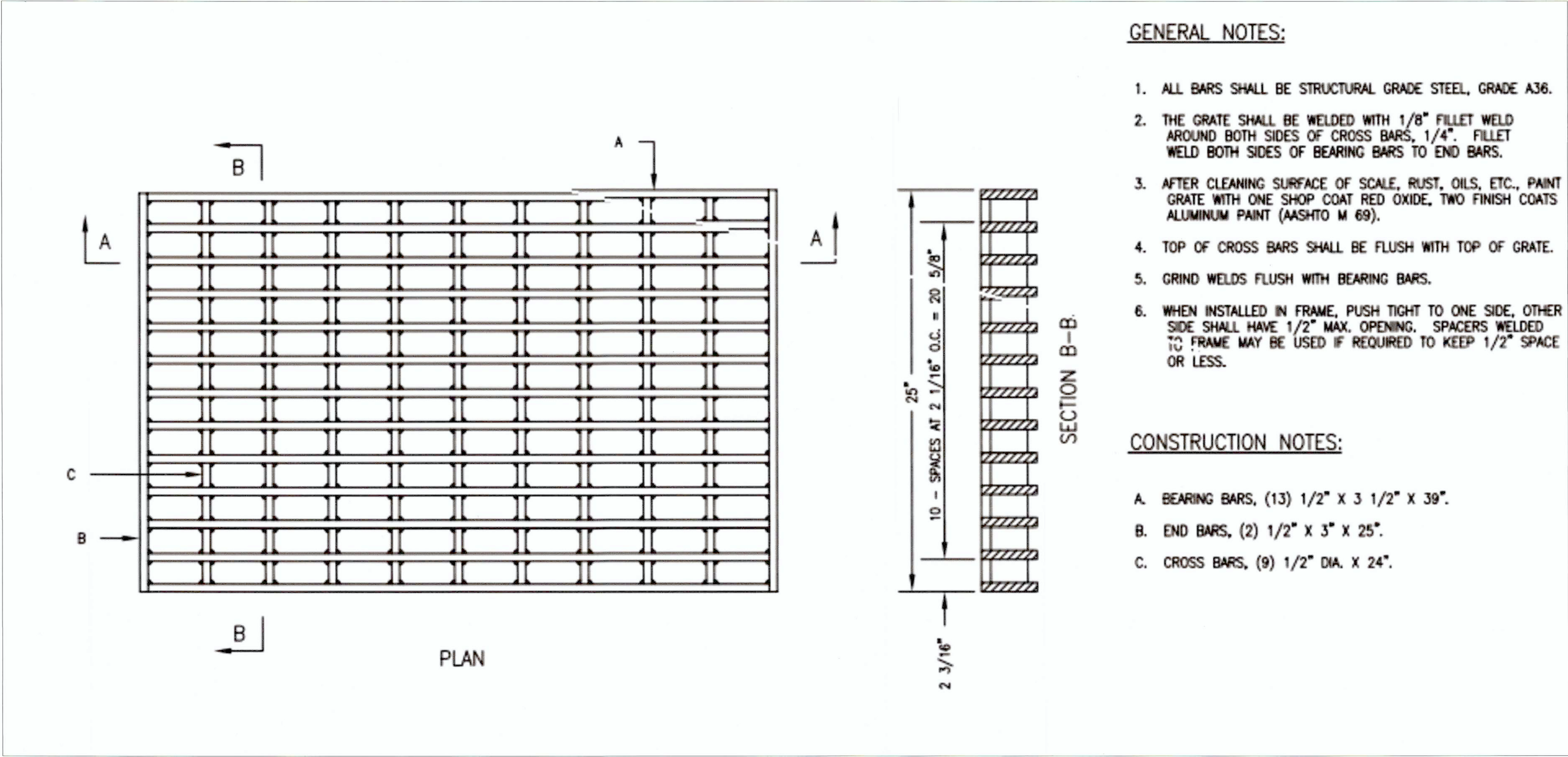

MODIFIED GRATE DETAIL



NTS

GENERAL NOTES:

1. ALL BARS SHALL BE STRUCTURAL GRADE STEEL, GRADE A36.
2. THE GRATE SHALL BE WELDED WITH 1/8" FILLET WELD AROUND BOTH SIDES OF CROSS BARS, 1/4". FILLET WELD BOTH SIDES OF BEARING BARS TO END BARS.
3. AFTER CLEANING SURFACE OF SCALE, RUST, OILS, ETC., PAINT GRATE WITH ONE SHOP COAT RED OXIDE, TWO FINISH COATS ALUMINUM PAINT (AASHTO M 69).
4. TOP OF CROSS BARS SHALL BE FLUSH WITH TOP OF GRATE.
5. GRIND WELDS FLUSH WITH BEARING BARS.
6. WHEN INSTALLED IN FRAME, PUSH TIGHT TO ONE SIDE, OTHER SIDE SHALL HAVE 1/2" MAX. OPENING. SPACERS WELDED TO FRAME MAY BE USED IF REQUIRED TO KEEP 1/2" SPACE OR LESS.

CONSTRUCTION NOTES:

- A. BEARING BARS, (13) 1/2" X 3 1/2" X 39".
- B. END BARS, (2) 1/2" X 3" X 25".
- C. CROSS BARS, (9) 1/2" DIA. X 24".

		CITY OF ALBUQUERQUE DEPARTMENT OF MUNICIPAL DEVELOPMENT ENGINEERING DIVISION	
TITLE: GABALDON/LEOPOLDO INTERSECTION IMPROVEMENTS DETAIL SHEET			
Design Review Committee  SEP 27 2016 DESIGN REVIEW COMMITTEE		City Engineer Approval  OCT 26 2016 CITY ENGINEER	
City Project No.	Zone Map No.	Sheet	Of
789092	H-12	10	10

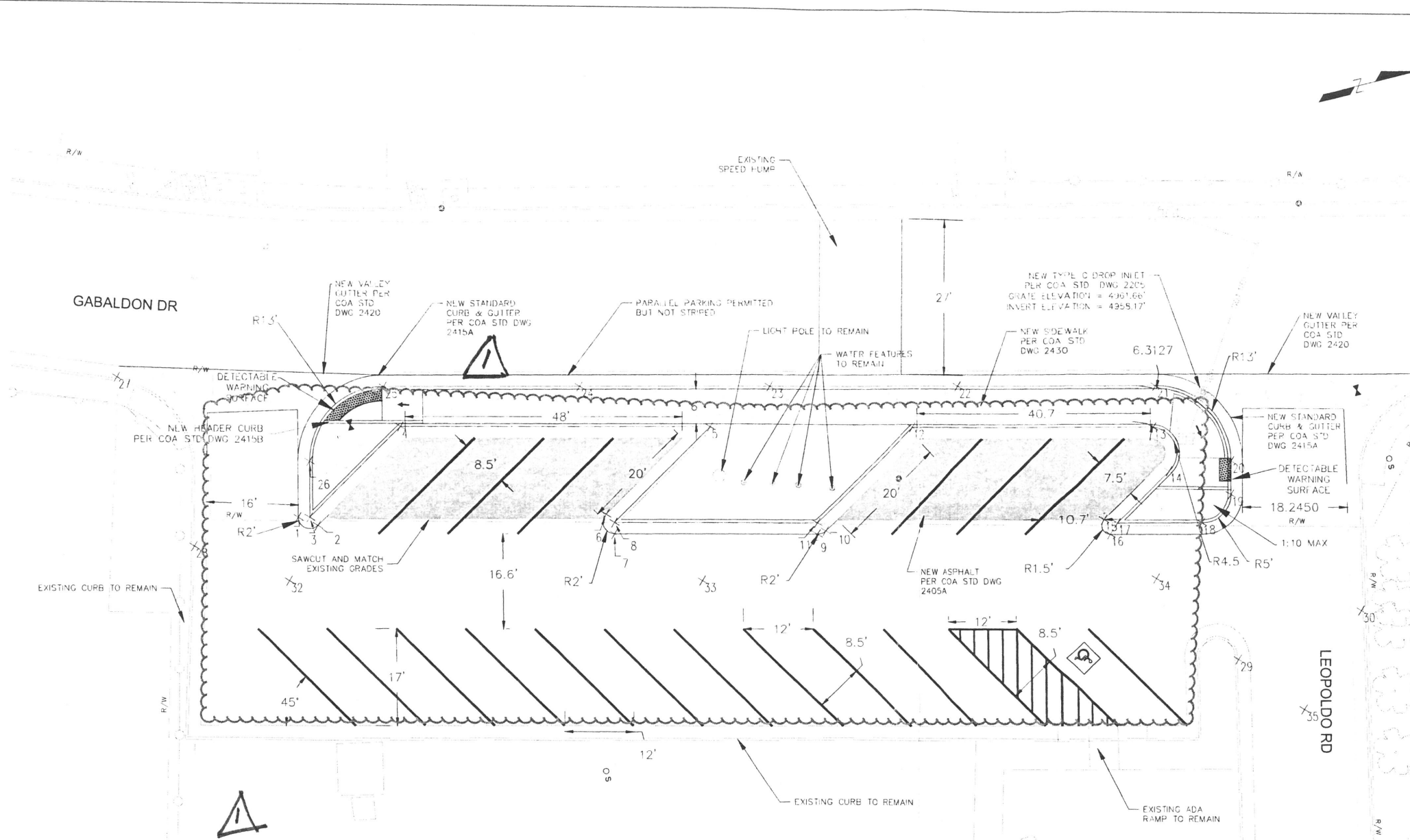

ACTIVE AMENDMENT
100AA-10088 PROJECT #1009077
RECONFIGURATION OF PARKING
LOT W/ ADDED SW ALONG
GABALDON DR.
10.24.2016
APPROVED BY [Signature] DATE

Point Table				
Point #	Elevation	Northings	Eastings	Description
1*	4962.17	1496204.84	1511117.05	PC
2*	4962.16	1496207.81	1511119.25	PT
3	4962.15	1496206.78	1511117.53	INT
4	4962.49	1496225.97	1511105.99	INT
5	4962.25	1496278.04	1511118.93	INT
6*	4961.94	1496256.77	1511129.39	PC
8	4961.99	1496257.81	1511131.11	INT
7*	4961.92	1496257.32	1511133.05	PT
9†	4961.75	1496291.20	1511141.47	PC
10*	4961.73	1496292.72	1511141.24	PT
11	4961.74	1496291.68	1511139.52	INT
12	4961.94	1496311.83	1511127.40	INT
13	4961.77	1496352.59	1511137.49	PC
14	4961.74	1496353.37	1511145.57	PT
15*	4961.49	1496340.39	1511151.05	PC
16*	4961.48	1496340.80	1511153.79	PT
17	4961.48	1496342.46	1511152.14	INT
18	4961.36	1496356.76	1511155.70	PC
19	4961.28	1496362.81	1511152.10	PT
20	4961.35	1496364.27	1511146.46	PC
21	4961.78	1496354.80	1511130.57	PT
22	4961.92	1496321.88	1511122.46	POINT
23	4962.06	1496289.84	1511114.57	POINT
24	4962.20	1496257.80	1511106.67	POINT
25	4962.34	1496224.88	1511098.56	PC
26	4962.36	1496209.16	1511108.03	PT
27	4962.44	1496180.29	1511085.78	EX ELEV
28	4962.50	1496185.96	1511117.56	EX ELEV
29	4961.03	1496356.93	1511180.32	EX ELEV
30	4961.64	1496379.78	1511177.17	EX ELEV
31	4961.78	1496403.82	1511142.50	EX ELEV
32	4962.14	1496200.60	1511127.40	EX ELEV
33	4961.89	1496270.04	1511144.61	EX ELEV
34	4961.40	1496346.60	1511163.18	EX ELEV
35	4961.23	1496365.90	1511191.50	EX ELEV

*ELEVATION TAKEN FROM
EDGE OF GUTTER

NOTES:

1.) ALL ELEVATIONS ARE TO
FLOWLINE UNLESS OTHERWISE
NOTED

2.) SEE SHEET 9 FOR CURB
RAMP DETAILS

3.) SEE SHEET 10 FOR MODIFIED
GRATE DETAIL

4.) SALVAGE EXISTING GRAVEL FOR
NEW MEDIAN

5.) PROPOSED PAVING SPACES = 18
PROPOSED HANDICAP SPACES = 1

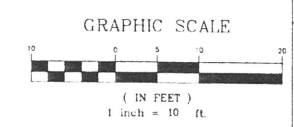

(BASED ON 24"x36" SHEET)

CITY OF ALBUQUERQUE DEPARTMENT OF MUNICIPAL DEVELOPMENT ENGINEERING DIVISION	
TITLE: GABALDON/LEOPOLDO INTERSECTION IMPROVEMENTS OVERALL LAYOUT/GRADING PLAN	
Design Review Committee	City Engineer Approval
City Project No. 789092	Zone Map No. H-12
Sheet 6	Of 10

PROPOSED

Gabaldon Road/Leopoldo Road Intersection Improvement

Engineer's Estimate

Date: 9-28-2016

ITEM NO.	DESCRIPTION	UNIT	ESTIMATE	COST	
				Unit Cost	Cost
301.02	SUBGRADE PREP, 12" AT 95% COMPACTION , CIP.	S.Y.	150	\$2.00	\$ 300.00
336.01	PRIME COAT, EMULSFIED ASPHALT, CIP.	S.Y.	150	\$0.50	\$ 75.00
336.08	ASPHALT CONC., PLACEMENT, 3" THICK, ARTERIAL FRADATION SP III	S.Y.	150	\$10.50	\$ 1,575.00
336.12	TACK COAT, CATIONIC EMULSIFIED ASPHALT, CIP.	S.Y.	150	\$0.50	\$ 75.00
340.01	SIDEWALK, 4" THICK, PORTLAND CEMENT CONCRETE, INCL. SUBGRADE COMPACTION , CIP.	S.Y.	102	\$41.00	\$ 4,182.00
340.023	WHEELCHAIR ACCESS RAMP, 4" PCC, STD. CURB., CIP.	S.Y.	25	\$50.00	\$ 1,250.00
340.0231A	DETECTABLE WARNING SURFACE ON NEW OR EXISTING HC RAMPS	S.F.	30	\$35.00	\$ 1,050.00
340.03	VALLEY GUTTER & CURB, PCC, CIP. SD 2420	S.Y.	50	\$60.00	\$ 3,000.00
340.05	CURB & GUTTER, STANDARD, PORTLAND CEMENT CONCRETE, INCL. SUBGRADE PREPARATION, CIP.	L.F.	450	\$21.00	\$ 9,450.00
340.11	HEADER CURB, PORTLAND CEMENT CONCRETE, INCL. SUBGRADE, CIP.	L.F.	30	\$20.00	\$ 600.00
343.02	EXISTING PAVEMENT, ASPHALT CONCRETE, UP TO 4" THICK, SAWCUT, REMOVE & DISPOSE, COMPL.	S.Y.	245	\$6.50	\$ 1,592.50
343.08	EXISTING CURB & GUTTER, PC CONCRETE, REMOVE & DISPOSE , COMPL.	L.F.	350	\$6.50	\$ 2,275.00
440.035	NON-REFELCTORIZED PAINTED MARKING, ANY COLOR OR SHAPE, CIP.	S.F.	48	\$1.50	\$ 72.00
441.001	REFLECTORIZED PLASTIC MARKINGS, 4" WIDTH, CIP.	L.F.	875	\$0.50	\$ 437.50
441.005	REFLECTORIZED PLASTIC MARKINGS, 24" WIDTH, CIP.	L.F.	60	\$2.75	\$ 165.00
441.034	REFLECTORIZED PLASTIC MARKING, WORD & SYMBOL, CIP.	S.F.	100	\$8.50	\$ 850.00
443.101	REMOVAL OF PAVEMENT STRIPE, ANY WIDTH, PAINTED OR PLASTIC, COMPL.	L.F.	426	\$1.00	\$ 426.00
450.001	ALUMINUM PANEL SIGN, CIP.	S.F.	22	\$19.00	\$ 418.00
450.01	SQUARE TUBE STEEL POST AND BASE FOR ALUMINUM PANEL SIGN, CIP.	L.F.	50	\$11.00	\$ 550.00
701.1	TRENCHING, BACKFILLING, & COMPACTION, FOR 18" TO 36" SD PIPE, UP TO 8' N DEPTH	L.F.	7	\$24.00	\$ 168.00
910.103	DRAINLINE REMOVAL, 10" - 18" EXCL. TRENCHING	L.F.	7	\$6.00	\$ 42.00
915.03	CATCH BASIN, TYPE "C", SINGLE GRATE, CIP.	EACH	1	\$3,900.00	\$ 3,900.00
915.07	CATCH BASIN, EXISTING, REMOVE & DISPOSE, ANY TYPE, INCL. CLEANUP, COMPL.	EACH	1	\$1,105.00	\$ 1,105.00
	SUBTOTAL				\$ 33,558.00

Subtotal	\$33,558
Contingency, 10%	\$3,356
Subtotal	\$36,914
NMGRT, 7.3125%	\$2,699
Total	\$39,613
Use	\$40,000