

IRRIGATION LEGEND

- RAINBIRD #1401 - 25 GPM FULL CIRCLE TRICKLE PATTERN BUBBLER (SEE COA STANDARD DETAIL DRAWINGS: 2710, 2711, 2711-A & 2712)
- ELECTRIC VALVE: RAINBIRD #100-PEB, 1" PLASTIC ELECTRIC VALVE WITH FLOW CONTROL (SEE COA STANDARD DETAIL DRAWING: 2703)
- ELECTRIC VALVE: RAINBIRD #150-PEB, 1 1/2" PLASTIC ELECTRIC VALVE WITH FLOW CONTROL (SEE COA STANDARD DETAIL DRAWING: 2703)
- MOTOROLA IRRINET ACE (AC) CONTROLLER WITH INTERSPEC ENCLOSURE, KEYPAD AND DOMED ANTENNA. UNIT SHALL COMMUNICATE ON COA RADIO FREQUENCY. (SEE DETAIL DRAWING: B/4 & D/4) (16 STATION OUTPUT)
- MOTOROLA IRRINET M (AC) CONTROLLER WITH INTERSPEC ENCLOSURE, KEYPAD AND DOMED ANTENNA. UNIT SHALL COMMUNICATE ON COA RADIO FREQUENCY. (SEE DETAIL DRAWING: B/4 & D/4) (12 STATION OUTPUT)
- ISOLATION VALVE ASSEMBLY (LINE SIZE) - SEE COA STANDARD DETAIL #2707
- FEBCO #825YA REDUCED PRESSURE BACKFLOW PREVENTER WITH MASTER VALVE ASSEMBLY INSTALLED IN "CLAY" COLORED HOTBOX "HOT ROK" HEATED AND INSULATED BACKFLOW DEVICE ENCLOSURE - SEE PLAN FOR BACKFLOW SIZE (SEE DETAIL DRAWING: C/4)
- MASTER METER 1 1/2" INTERMEDIATE MULTIJET SERIES OR 1" CLASSIC SERIES FLOW METER WITH ELECTRICAL OUTPUT REGISTER - 1 PULSE = 1 GALLON - SEE PLAN FOR FLOW METER SIZE (SEE DETAIL DRAWING: C/4)
- CITY WATER METER - SENSUS SR SERIES (SEE COA STANDARD DETAIL DRAWING: 2362 OR 2363) SEE PLAN FOR WATER METER SIZE
- CRISPEN #UL10.1 1" UNIVERSAL AIR RELEASE VALVE ASSEMBLY
- MAINLINE PIPING - SCH.40 PVC SOLVENT WELD (SEE PLAN FOR SIZE)
- LATERAL PIPING - SCH.40 PVC SOLVENT WELD (SIZE INDICATED ON PLAN - UNSIZED PIPE IS 3/4")
- SLEEVE PIPING - CLASS 200 PVC (TWO SIZES LARGER THAN PIPE TO BE SLEEVED)
- 120 VOLT ELECTRICAL POWER WIRE ROUTE
- VALVE ID NUMBER
- FLOW IN GALLONS PER MINUTE

IRRIGATION NOTES

- WATER PRESSURE:**
THE WATER PRESSURE AT THIS SITE HAS BEEN REPORTED AND NOTED ON DRAWING BY THE LANDSCAPE ARCHITECT. THE CONTRACTOR SHALL VERIFY WATER PRESSURE AT THE NEAREST AVAILABLE FIRE HYDRANT PRIOR TO BEGINNING INSTALLATION OF IRRIGATION SYSTEM.
- SPECIFICATIONS AND DETAIL DRAWINGS:**
THE CONTRACTOR SHALL REFER TO THE CITY OF ALBUQUERQUE'S STANDARD SPECIFICATIONS AND DETAIL DRAWINGS FOR IRRIGATION CONSTRUCTION. IN THE EVENT OF A CONFLICT BETWEEN SPECIFICATIONS AND IRRIGATION DESIGN, THE CONTRACTOR SHALL NOTIFY THE PROJECT MANAGER IN WRITING. THE CONTRACTOR SHALL NOT PROCEED WITH INSTALLATION OF CONFLICTING IRRIGATION COMPONENTS UNTIL HE RECEIVES CLARIFICATION IN WRITING FROM THE PROJECT MANAGER.
- PROXIMITY OF PIPING TO SHRUBS AND TREES:**
THE PIPE ROUTING SHOWN ON THESE PLANS IS SCHEMATIC AND MAY REQUIRE FIELD ADJUSTMENTS BY THE CONTRACTOR. WHEN POSSIBLE THE CONTRACTOR SHALL INSTALL PIPING OUTSIDE OF ROOTZONE OF SHRUBS AND TREES.
- IRRIGATION SATELLITE:**
FOR SCORPIO SATELLITES, THE CONTRACTOR SHALL HAVE A RADIO SIGNAL STRENGTH SURVEY PERFORMED TO VERIFY PROPER RADIO COMMUNICATION FROM IRRINET CONTROLLER LOCATION TO PROPOSED SCORPIO CONTROLLER LOCATION. PRIOR TO THE INSTALLATION OF THE SCORPIO CONTROLLER, THE CONTRACTOR SHALL CONTACT WATER RESOURCES, INC. (MARK MATHES) (505) 986-1388 FOR THIS SERVICE. THE CONTRACTOR SHALL BE RESPONSIBLE FOR ALL COSTS ASSOCIATED WITH THE RADIO SIGNAL STRENGTH SURVEY.
- ROAD CROSSINGS:**
THE CONTRACTOR SHALL BORE ALL SLEEVE PIPE WHEN CROSSING PAVED SURFACES.
- PROXIMITY OF PIPING AND WIRING TO LANDSCAPE PODS:**
THE CONTRACTOR SHALL INSTALL ALL PIPING (LATERAL AND MAINLINE) AND WIRING AS CLOSE TO THE LANDSCAPE POD AS POSSIBLE IN ORDER TO PROVIDE ROOM FOR FUTURE ROADWAY EXPANSION.

REDRAWN FOR RECORD PURPOSES

RECORD DRAWINGS

THIS RECORD DRAWING HAS BEEN PREPARED, BASED UPON INFORMATION FURNISHED BY THE CONTRACTOR. THE DESIGN PROFESSIONAL HAS NOT INDEPENDENTLY REVIEWED THE ACCURACY OF THE INFORMATION PROVIDED. THESE RECORD DRAWINGS ACCURATELY DEPICT THE FIELD CHANGES WHICH WERE REPORTED BY THE CONTRACTOR.

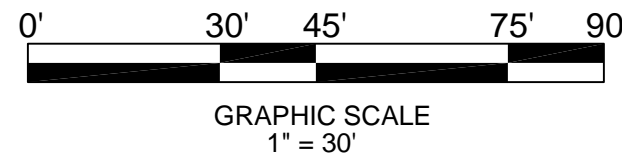

MORROW REARDON WILKINSON, LTD., LANDSCAPE ARCHITECTS
210 La Veta NE, Albuquerque, NM 87108
505.268.2266 FAX 505.265.9637
mrw@mrwnm.com

Irrigation Services

44 GOOD DRIVE BELEN, NM 87002
PHONE: (505) 861-1536
FAX: (505) 865-5212
EMAIL: irrservices@aol.com



CITY OF ALBUQUERQUE CAPITAL IMPLEMENTATION PROGRAM DEPARTMENT OF MUNICIPAL DEVELOPEMENT			
TITLE: PROTOTYPE MEDIAN & INTERSTATE LANDSCAPES FY08-C LOMAS MEDIAN: University to Girard AS-BUILT IRRIGATION SYSTEM			
Design Review Committee	City Engineer Approval	MO./DAY/YR. 05/18/09	MO./DAY/YR. 05/18/09
City Project No. 795903	Zone Map No. J15, J16	Sheet 1	Of 3

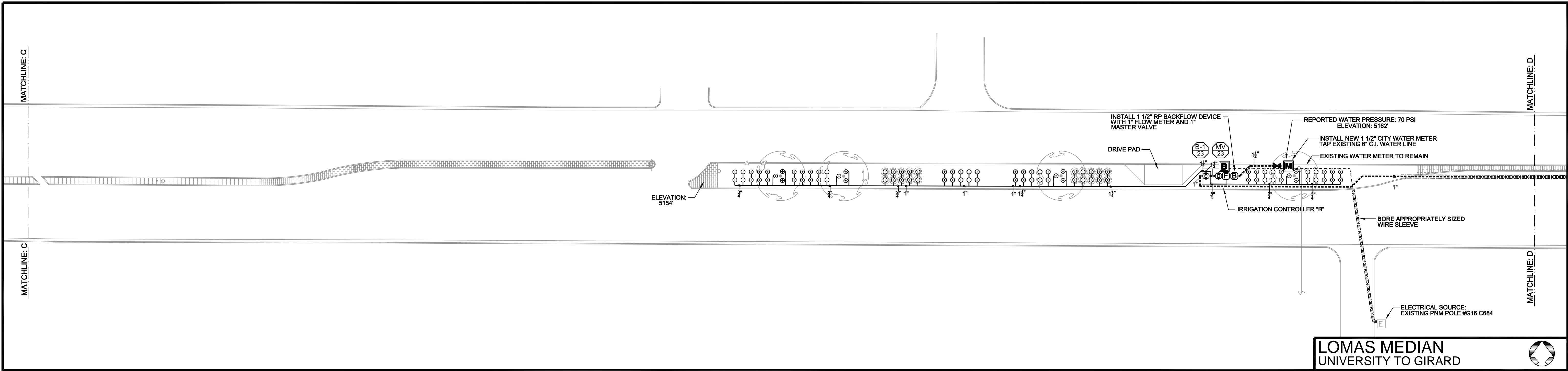
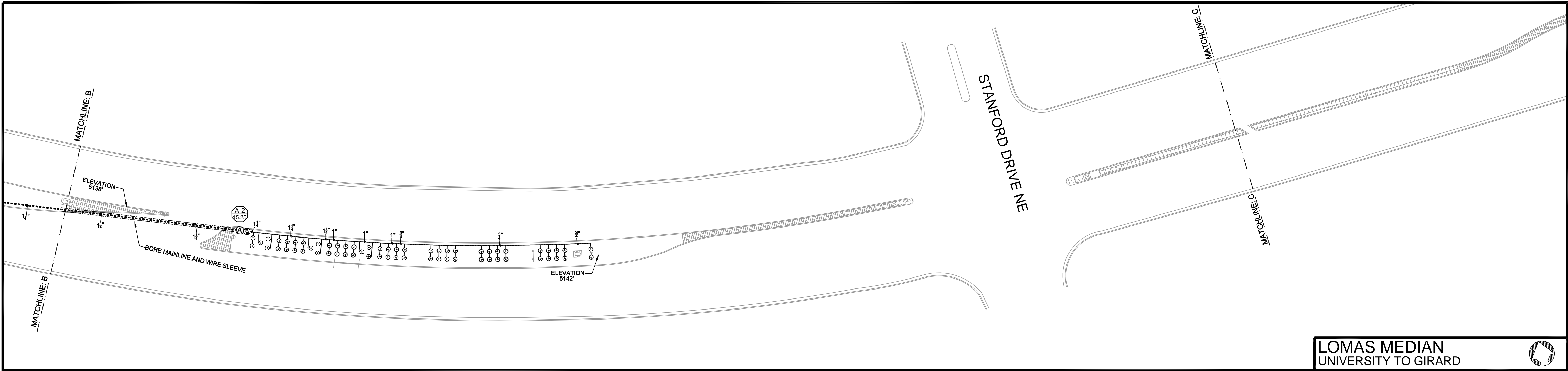

IRRIGATION LEGEND

- RAINBIRD #1401 .25 GPM FULL CIRCLE TRICKLE PATTERN BUBBLER (SEE COA STANDARD DETAIL DRAWINGS: 2710, 2711, 2711-A & 2712)
- ELECTRIC VALVE: RAINBIRD #100-PEB, 1" PLASTIC ELECTRIC VALVE WITH FLOW CONTROL (SEE COA STANDARD DETAIL DRAWING: 2703)
- ELECTRIC VALVE: RAINBIRD #150-PEB, 1 1/2" PLASTIC ELECTRIC VALVE WITH FLOW CONTROL (SEE COA STANDARD DETAIL DRAWING: 2703)
- MOTOROLA IRRINET ACE (AC) CONTROLLER WITH INTERSPEC ENCLOSURE, KEYPAD AND DOMED ANTENNA. UNIT SHALL COMMUNICATE ON COA RADIO FREQUENCY. (SEE DETAIL DRAWING: B/4 & D/4) (16 STATION OUTPUT)
- MOTOROLA IRRINET M (AC) CONTROLLER WITH INTERSPEC ENCLOSURE, KEYPAD AND DOMED ANTENNA. UNIT SHALL COMMUNICATE ON COA RADIO FREQUENCY. (SEE DETAIL DRAWING: B/4 & D/4) (12 STATION OUTPUT)
- ISOLATION VALVE ASSEMBLY (LINE SIZE) - SEE COA STANDARD DETAIL #2707
- FEBCO #825YA REDUCED PRESSURE BACKFLOW PREVENTER WITH MASTER VALVE ASSEMBLY INSTALLED IN "CLAY" COLORED HOTBOX "HOT ROK" HEATED AND INSULATED BACKFLOW DEVICE ENCLOSURE - SEE PLAN FOR BACKFLOW SIZE (SEE DETAIL DRAWING: C/4)
- MASTER METER 1 1/2" INTERMEDIATE MULTIJET SERIES OR 1" CLASSIC SERIES FLOW METER WITH ELECTRICAL OUTPUT REGISTER - 1 PULSE = 1 GALLON - SEE PLAN FOR FLOW METER SIZE (SEE DETAIL DRAWING: C/4)
- CITY WATER METER - SENSUS SR SERIES (SEE COA STANDARD DETAIL DRAWING: 2362 OR 2363) SEE PLAN FOR WATER METER SIZE
- CRISPEN AUL10.1 1" UNIVERSAL AIR RELEASE VALVE ASSEMBLY
- MAINLINE PIPING - SCH.40 PVC SOLVENT WELD (SEE PLAN FOR SIZE)
- LATERAL PIPING - SCH.40 PVC SOLVENT WELD (SIZE INDICATED ON PLAN - UNSIZED PIPE IS 3/4")
- SLEEVE PIPING - CLASS 200 PVC (TWO SIZES LARGER THAN PIPE TO BE SLEEVED)
- 120 VOLT ELECTRICAL POWER WIRE ROUTE
- VALVE ID NUMBER
- FLOW IN GALLONS PER MINUTE

IRRIGATION NOTES

- WATER PRESSURE:**
THE WATER PRESSURE AT THIS SITE HAS BEEN REPORTED AND NOTED ON DRAWING BY THE LANDSCAPE ARCHITECT. THE CONTRACTOR SHALL VERIFY WATER PRESSURE AT THE NEAREST AVAILABLE FIRE HYDRANT PRIOR TO BEGINNING INSTALLATION OF IRRIGATION SYSTEM.
- SPECIFICATIONS AND DETAIL DRAWINGS:**
THE CONTRACTOR SHALL REFER TO THE CITY OF ALBUQUERQUE'S STANDARD SPECIFICATIONS AND DETAIL DRAWINGS FOR IRRIGATION CONSTRUCTION. IN THE EVENT OF A CONFLICT BETWEEN SPECIFICATIONS AND IRRIGATION DESIGN, THE CONTRACTOR SHALL NOTIFY THE PROJECT MANAGER IN WRITING. THE CONTRACTOR SHALL NOT PROCEED WITH INSTALLATION OF CONFLICTING IRRIGATION COMPONENTS UNTIL HE RECEIVES CLARIFICATION IN WRITING FROM THE PROJECT MANAGER.
- PROXIMITY OF PIPING TO SHRUBS AND TREES:**
THE PIPE ROUTING SHOWN ON THESE PLANS IS SCHEMATIC AND MAY REQUIRE FIELD ADJUSTMENTS BY THE CONTRACTOR. WHEN POSSIBLE THE CONTRACTOR SHALL INSTALL PIPING OUTSIDE OF ROOTZONE OF SHRUBS AND TREES.
- IRRIGATION SATELLITE:**
FOR SCORPIO SATELLITES, THE CONTRACTOR SHALL HAVE A RADIO SIGNAL STRENGTH SURVEY PERFORMED TO VERIFY PROPER RADIO COMMUNICATION FROM IRRINET CONTROLLER LOCATION TO PROPOSED SCORPIO CONTROLLER LOCATION. PRIOR TO THE INSTALLATION OF THE SCORPIO CONTROLLER, THE CONTRACTOR SHALL CONTACT WATER RESOURCES, INC. (MARK MATHES) (505) 986-1388 FOR THIS SERVICE. THE CONTRACTOR SHALL BE RESPONSIBLE FOR ALL COSTS ASSOCIATED WITH THE RADIO SIGNAL STRENGTH SURVEY.
- ROAD CROSSINGS:**
THE CONTRACTOR SHALL BORE ALL SLEEVE PIPE WHEN CROSSING PAVED SURFACES.
- PROXIMITY OF PIPING AND WIRING TO LANDSCAPE PODS:**
THE CONTRACTOR SHALL INSTALL ALL PIPING (LATERAL AND MAINLINE) AND WIRING AS CLOSE TO THE LANDSCAPE POD AS POSSIBLE IN ORDER TO PROVIDE ROOM FOR FUTURE ROADWAY EXPANSION.

REDRAWN FOR RECORD PURPOSES

RECORD DRAWINGS

THIS RECORD DRAWING HAS BEEN PREPARED, BASED UPON INFORMATION FURNISHED BY THE CONTRACTOR. THE DESIGN PROFESSIONAL HAS NOT INDEPENDENTLY REVIEWED THE ACCURACY OF THE INFORMATION PROVIDED. THESE RECORD DRAWINGS ACCURATELY DEPICT THE FIELD CHANGES WHICH WERE REPORTED BY THE CONTRACTOR.

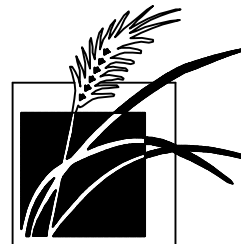
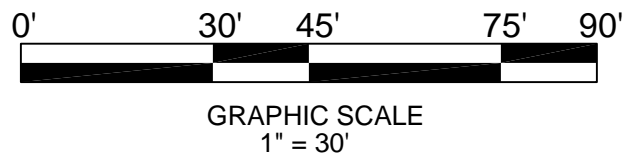

210 La Veta NE, Albuquerque, NM 87108
505.268.2266 FAX 505.265.9637
mrw@mrwnm.com

Irrigation Services

IRRIGATION DESIGNS & CONSULTANTS
44 GOOD DRIVE BELEN, NM 87002
PHONE: (505) 861-1536
FAX: (505) 866-5212
EMAIL: irrservices@aol.com

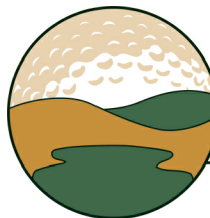

Mountain West GolfScapes, Inc.

CITY OF ALBUQUERQUE CAPITAL IMPLEMENTATION PROGRAM DEPARTMENT OF MUNICIPAL DEVELOPEMENT			
TITLE: PROTOTYPE MEDIAN & INTERSTATE LANDSCAPES FY08-C LOMAS MEDIAN: University to Girard			
AS-BUILT IRRIGATION SYSTEM			
Design Review Committee	City Engineer Approval	MO./DAY/YR. 05/18/09	MO./DAY/YR. 05/18/09
City Project No. 795903	Zone Map No. J15, J16	Sheet 2	Of 3

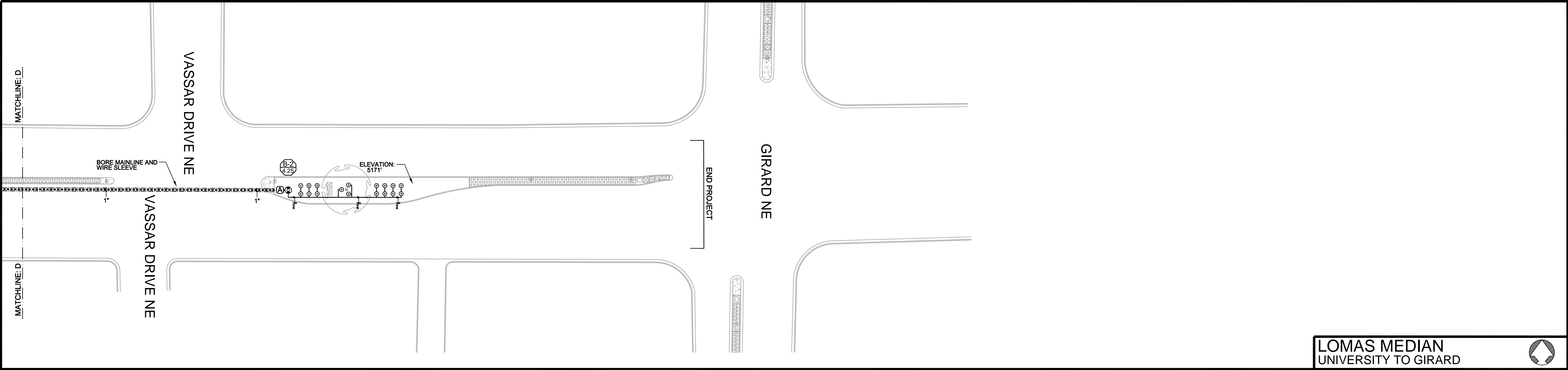

IRRIGATION LEGEND

- RAINBIRD #1401 . 25 GPM FULL CIRCLE TRICKLE PATTERN BUBBLER (SEE COA STANDARD DETAIL DRAWINGS: 2710, 2711, 2711-A & 2712)
- ELECTRIC VALVE: RAINBIRD #100-PEB, 1" PLASTIC ELECTRIC VALVE WITH FLOW CONTROL (SEE COA STANDARD DETAIL DRAWING: 2703)
- ELECTRIC VALVE: RAINBIRD #150-PEB, 1 1/2" PLASTIC ELECTRIC VALVE WITH FLOW CONTROL (SEE COA STANDARD DETAIL DRAWING: 2703)
- MOTOROLA IRRINET ACE (AC) CONTROLLER WITH INTERSPEC ENCLOSURE, KEYPAD AND DOMED ANTENNA. UNIT SHALL COMMUNICATE ON COA RADIO FREQUENCY. (SEE DETAIL DRAWING: B/4 & D/4) (16 STATION OUTPUT)
- MOTOROLA IRRINET M (AC) CONTROLLER WITH INTERSPEC ENCLOSURE, KEYPAD AND DOMED ANTENNA. UNIT SHALL COMMUNICATE ON COA RADIO FREQUENCY. (SEE DETAIL DRAWING: B/4 & D/4) (12 STATION OUTPUT)
- ISOLATION VALVE ASSEMBLY (LINE SIZE) - SEE COA STANDARD DETAIL #2707)
- FEBCO #825YA REDUCED PRESSURE BACKFLOW PREVENTER WITH MASTER VALVE ASSEMBLY INSTALLED IN "CLAY" COLORED HOTBOX "HOT ROK" HEATED AND INSULATED BACKFLOW DEVICE ENCLOSURE - SEE PLAN FOR BACKFLOW SIZE (SEE DETAIL DRAWING: C/4)
- MASTER METER 1 1/2" INTERMEDIATE MULTIJET SERIES OR 1" CLASSIC SERIES FLOW METER WITH ELECTRICAL OUTPUT REGISTER - 1 PULSE = 1 GALLON - SEE PLAN FOR FLOW METER SIZE (SEE DETAIL DRAWING: C/4)
- CITY WATER METER - SENSUS SR SERIES (SEE COA STANDARD DETAIL DRAWING: 2362 OR 2363) SEE PLAN FOR WATER METER SIZE
- CRISPEN #UL10.1 1" UNIVERSAL AIR RELEASE VALVE ASSEMBLY
- MAINLINE PIPING - SCH.40 PVC SOLVENT WELD (SEE PLAN FOR SIZE)
- LATERAL PIPING - SCH.40 PVC SOLVENT WELD (SIZE INDICATED ON PLAN - UNSIZED PIPE IS 3/4")
- SLEEVE PIPING - CLASS 200 PVC (TWO SIZES LARGER THAN PIPE TO BE SLEEVED)
- 120 VOLT ELECTRICAL POWER WIRE ROUTE
- VALVE ID NUMBER
- FLOW IN GALLONS PER MINUTE

IRRIGATION NOTES

WATER PRESSURE:
THE WATER PRESSURE AT THIS SITE HAS BEEN REPORTED AND NOTED ON DRAWING BY THE LANDSCAPE ARCHITECT. THE CONTRACTOR SHALL VERIFY WATER PRESSURE AT THE NEAREST AVAILABLE FIRE HYDRANT PRIOR TO BEGINNING INSTALLATION OF IRRIGATION SYSTEM.

SPECIFICATIONS AND DETAIL DRAWINGS:
THE CONTRACTOR SHALL REFER TO THE CITY OF ALBUQUERQUE'S STANDARD SPECIFICATIONS AND DETAIL DRAWINGS FOR IRRIGATION CONSTRUCTION. IN THE EVENT OF A CONFLICT BETWEEN SPECIFICATIONS AND IRRIGATION DESIGN, THE CONTRACTOR SHALL NOTIFY THE PROJECT MANAGER IN WRITING. THE CONTRACTOR SHALL NOT PROCEED WITH INSTALLATION OF CONFLICTING IRRIGATION COMPONENTS UNTIL HE RECEIVES CLARIFICATION IN WRITING FROM THE PROJECT MANAGER.

PROXIMITY OF PIPING TO SHRUBS AND TREES:
THE PIPE ROUTING SHOWN ON THESE PLANS IS SCHEMATIC AND MAY REQUIRE FIELD ADJUSTMENTS BY THE CONTRACTOR. WHEN POSSIBLE THE CONTRACTOR SHALL INSTALL PIPING OUTSIDE OF ROOTZONE OF SHRUBS AND TREES.

IRRIGATION SATELLITE:
FOR SCORPIO SATELLITES, THE CONTRACTOR SHALL HAVE A RADIO SIGNAL STRENGTH SURVEY PERFORMED TO VERIFY PROPER RADIO COMMUNICATION FROM IRRINET CONTROLLER LOCATION TO PROPOSED SCORPIO CONTROLLER LOCATION. PRIOR TO THE INSTALLATION OF THE SCORPIO CONTROLLER, THE CONTRACTOR SHALL CONTACT: WATER RESOURCES, INC. (MARK MATHES) (505) 988-1388 FOR THIS SERVICE. THE CONTRACTOR SHALL BE RESPONSIBLE FOR ALL COSTS ASSOCIATED WITH THE RADIO SIGNAL STRENGTH SURVEY.

ROAD CROSSINGS:
THE CONTRACTOR SHALL BORE ALL SLEEVE PIPE WHEN CROSSING PAVED SURFACES.

PROXIMITY OF PIPING AND WIRING TO LANDSCAPE PODS:
THE CONTRACTOR SHALL INSTALL ALL PIPING (LATERAL AND MAINLINE) AND WIRING AS CLOSE TO THE LANDSCAPE POD AS POSSIBLE IN ORDER TO PROVIDE ROOM FOR FUTURE ROADWAY EXPANSION.

REDRAWN FOR
RECORD PURPOSES
RECORD DRAWINGS

THIS RECORD DRAWING HAS BEEN PREPARED, BASED UPON INFORMATION FURNISHED BY THE CONTRACTOR. THE DESIGN PROFESSIONAL HAS NOT INDEPENDENTLY REVIEWED THE ACCURACY OF THE INFORMATION PROVIDED. THESE RECORD DRAWINGS ACCURATELY DEPICT THE FIELD CHANGES WHICH WERE REPORTED BY THE CONTRACTOR.

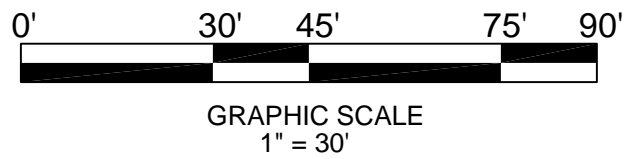

MORROW
REARDON
WILKINSON, LTD.,
LANDSCAPE ARCHITECTS
210 La Veta NE, Albuquerque, NM 87108
505.268.2286 FAX 505.265.9637
mrw@mrwnm.com

Irrigation
Services
44 GOOD DRIVE BELEN, NM 87002
PHONE: (505) 861-1536
FAX: (505) 865-5212
EMAIL: irrservices@aol.com



CITY OF ALBUQUERQUE				
CAPITAL IMPLEMENTATION PROGRAM				
DEPARTMENT OF MUNICIPAL DEVELOPEMENT				
TITLE: PROTOTYPE MEDIAN & INTERSTATE LANDSCAPES FY08-C				
LOMAS MEDIAN: University to Girard				
AS-BUILT IRRIGATION SYSTEM				
05/18/09				
Design Review Committee		City Engineer Approval		Last Design Update
				MO./DAY/YR.
				05/18/09
City Project No.		Zone Map No.		Sheet
795903		J15, J16		Of 3

SURVEY INFORMATION		BENCHMARK		AS BUILT INFORMATION	
NO.	FIELD NOTES	NO.	DATE	CONTRACTOR: Mountain West GolfScapes	
	BY		DATE	WORK STAKED BY: MWGS	
				INSPECTOR'S APPROVAL: JC	
				FIELD VERIFICATION BY: FR	
				DRAWING CORRECTED BY: FR / IS, LLC	
				MICRO-FILM INFORMATION	
				RECORDED BY	
				DATE:	
				NO.	