

CONSTRUCTION PLANS FOR

ALLEY RECONSTRUCTION
WEST OF 4TH STREET AND SOUTH OF CENTRAL AVE

DOWNTOWN ALBUQUERQUE, NEW MEXICO NOVEMBER 2014

INDEX OF DRAWINGS

- 01 TITLE SHEET
- 02 DEMOLITION PLAN
- 03 ALLEY IMPROVEMENTS
- 04 STANDARD DETAILS

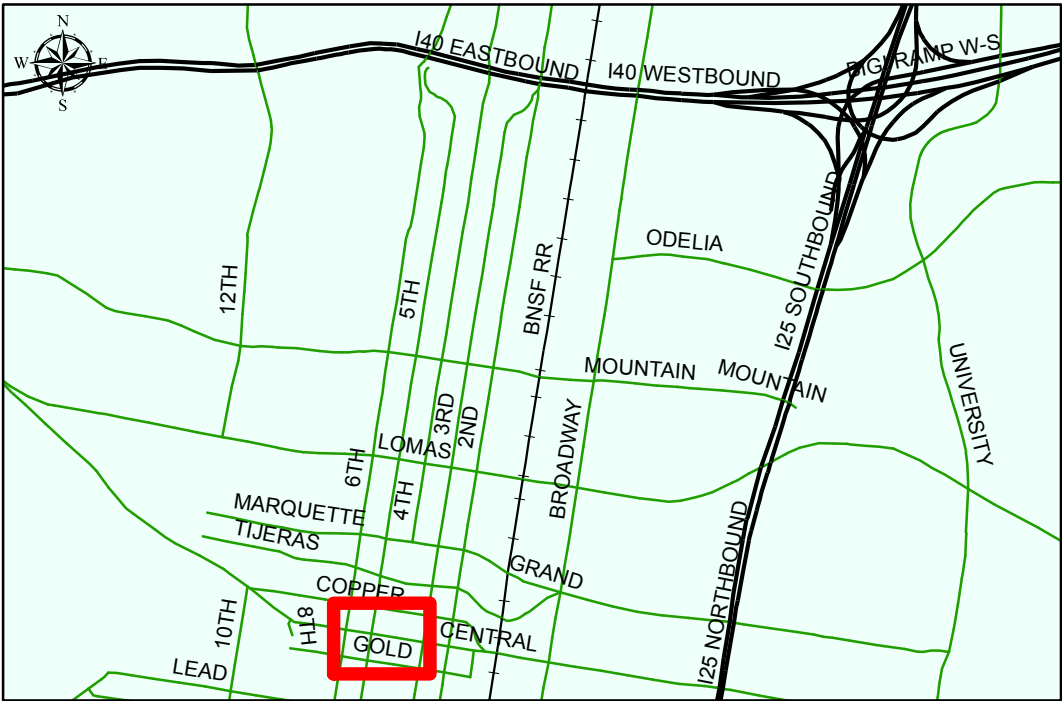

LOCATION MAP

CITY OF ALBUQUERQUE
DEPARTMENT OF MUNICIPAL DEVELOPMENT
Construction Services Division

NOTICE TO CONTRACTORS

1.ALL WORK DETAILED ON THESE PLANS TO BE PERFORMED UNDER CONTRACT SHALL, EXCEPT AS OTHERWISE STATED OR PROVIDED FOR HEREON, BE CONSTRUCTED IN ACCORDANCE WITH THE CITY OF ALBUQUERQUE STANDARD SPECIFICATIONS FOR PUBLIC WORKS CONSTRUCTION, 1986 UPDATE # 8.

2.TWO WORKING DAYS PRIOR TO ANY EXCAVATION, THE CONTRACTOR MUST CONTACT NEW MEXICO ONE CALL SYSTEM (811) FOR LOCATION OF EXISTIN UTILITIES.

3.ANY WORK AFFECTING AN ARTERIAL ROADWAY REQUIRES 24-HOUR CONSTRUCTION.

4.PRIOR TO CONSTRUCTION, THE CONTRACTOR SHALL EXCAVATE AND VERIFY THE HORIZONTAL AND VERTICAL LOCATIONS OF ALL OBSTRUCTIONS. SHOULD A CONFLICT EXIST, THE CONTRACTOR SHALL NOTIFY THE ENGINEER OR SURVEYER IMMEDIATELY SO THE CONFLICT CAN BE RESOLVED WITH A MINIMUM AMOUNT OF DELAY.

5.SEVEN (7) WORKING DAYS PRIOR TO BEGINNING OF CONSTRUCTION, THE CONTRACTOR SHALL SUBMIT TO CONSTRUCTION COORDINATION DIVISION A DETAILED CONSTRUCTION SCHEDULE. TWO (2) WORKING DAYS PRIOR TO CONSTRUCTION, THE CONTRACTOR SHALL OBTAIN A BARRICADING PERMIT FROM THE CONST. COORDINATION DIVISION. CONTRACTOR SHALL NOTIFY BARRICADE ENGINEER PRIOR TO OCCUPYING AN INTERSECTION. REFER TO STANDARD SPECIFICATIONS.

6.ALL STREET STRIPGIN ALTERED OR DETROYED SHALL BE REPLACED WITH PLASTIC REFLECTORIZED PAVEMENT MARKINGS BY THE CONTRACTOR TO LOCATION AS EXISTING OR AS INDICATED BY THIS PLAN SET.

7.CONTRACOT SHALL NOTIFY THE ENGINEER NOT LESS THAN SEVEN (7) DAYS PRIOR TO STARTING WORK IN ORDER THAT THE ENGINEER MAY TAKE NECESSARY MEASURES TO INSURE THE PRESERVATION OF SURVEY MONUMENTS. CONTRACTOR SHALL NOT DISTURB PERMANENT SURVEY MONUMENTS WITHOUT THE CONSENT OF THE ENGINEER AND SHALL NOTIFY THE ENGINEER AND BEAR THE EXPENSE OF REPLACING ANY THAT MAY BE DISTRUBED WITHOUT PERMISSION. REPLACEMENT SHALL BE ONDE ONLY BY THE CITY SURVEYER. WHEN A CHANCE IS MADE IN THE FINISHED ELEVATIONS OF THE PAVEMENT OF ANY ROADWAY IN WHICH A PERMANENT SURVEY MONUMENT IS LOCATED, CONTRACTOR SHALL, AT HIS OWN EXPENSE, ADJUST THE MONUMENT COVER TO THE NEW GRADE UNLESS OTHERWISE SPECIFIED. ANY PERMANENT SURVEY MONUMENT LOCATE WITHIN 50 FT. OF THIS PROJECT THAT IS NOT SHOWN ON THE PLAN AND IS DESTROYED DURING CONSTRUCTION WILL BE REPLACED AT THE CITY'S EXPENSE.

8.CONTRACTOR SHALL MAINTAIN A GRAFFITI-FREE WORK SITE. CONTRACTOR SHALL PROMPTLY REMOVE ANY AND ALL GRAFFITI FROM EQUIPMENT, WHETHER PERMANENT OR TEMPORARY.

9.ALL UTILITY WORK SHALL BE CONSTRUCTED IN ACCORDNACE WITH NEW MEXICO UTILITIES INC. SPECIFICATIONS FOR WATER AND WASTEWATER FACILITIES (MOST RECENT REVISIONS).

10.THE CONTRACTOR SHALL COORDINATE WITH THE WATER AUTHORITY SEVEN (7) DAYS IN ADVANCE OF PERFORMING WORK THAT WILL AFFECT THE PUBLIC WATER OR SANITARY SEWER INFRASTRUCTURE. WORK REQUIRING SHUTOFF OF FACILITIES DESIGNATED AS METER PLAN FACILITIES MUST BE COORDINATED WITH THE WATER AUTHORITY 14 DAYS IN ADVANCE OF PERFORMING SUCH WORK. ONLY WATER AUTHORITY CREWS ARE AUTHORIZED TO OPERATE PUBLIC VALVES. SHUTOFF REQUESTS MUST BE MADE ONLINE AT <http://abcwua.org/content/view/463/729>

11.ALL EXCAVATION, TRENCHING, AND SHORING ACTIVITIES MUST BE CARRIED OUT IN ACCORDANCE WITH OSHA 29 CFR 1926.650 SUBPART P.

12.ELECTRONIC MARKER DEVICES (EMS) WILL BE PLACED ACCORDING TO SECTION 170 OF THE COA STANDARD SPECIFICATIONS.

13.CONTRACTOR WILL BE RESPONSIBLE FOR PROVIDING AND MAINTAINING ALL CONSTRUCTION SIGNING UNTIL PROJECT HAS BEEN ACCEPTED BY THE COA.

4TH AND CENTRAL ALLEY TITLE SHEET

Sheet No.

1 of 4

Contact: M. Carrasco 505-924-3672

Date: 11/6/2014

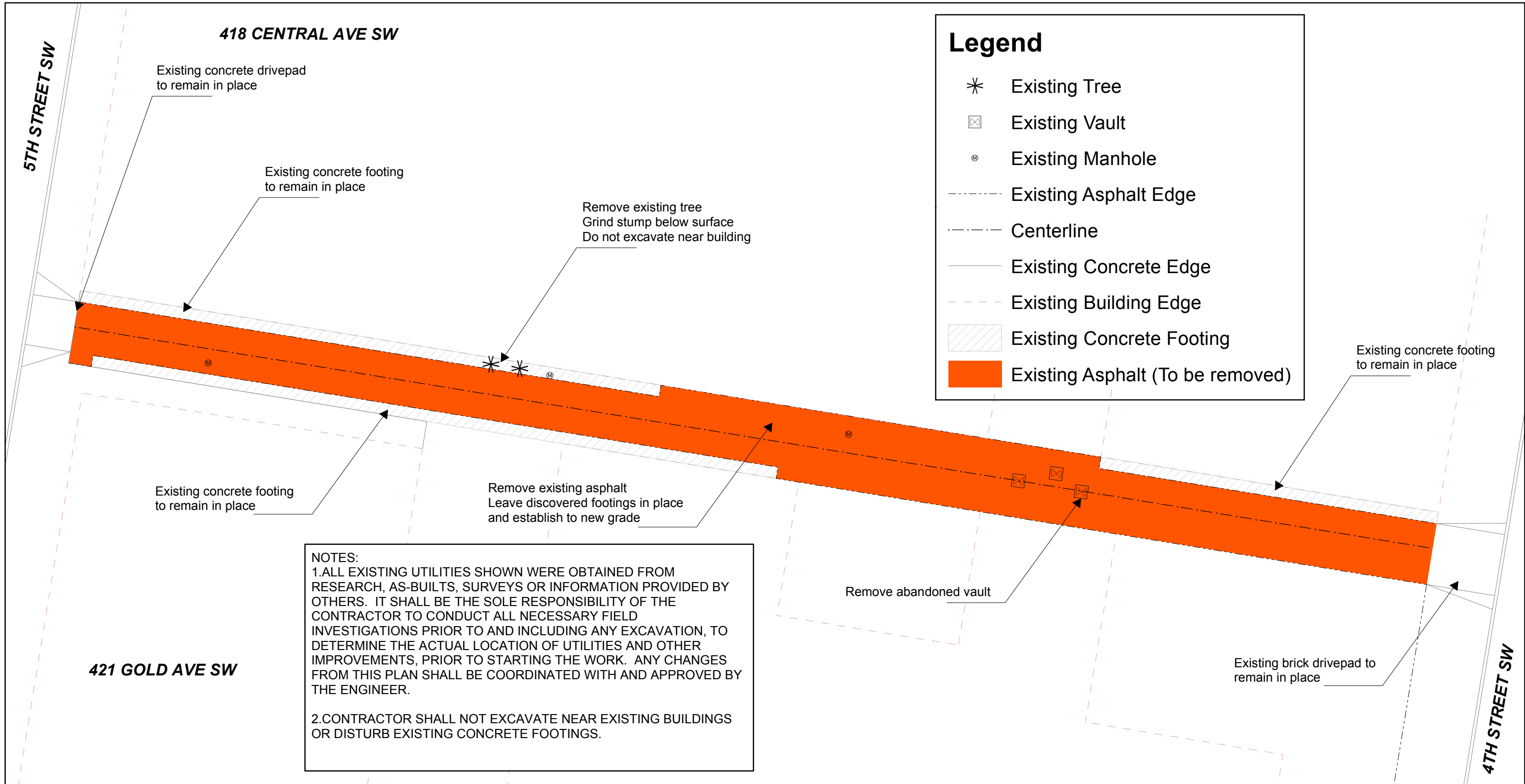

CITY OF ALBUQUERQUE
DEPARTMENT OF MUNICIPAL DEVELOPMENT
Construction Services Division



1 inch = 20 feet

4TH AND CENTRAL ALLEY
DEMO SHEET

Sheet No.
1 of 4

Contact: M. Carrasco 505-924-3672

Date: 11/6/2014

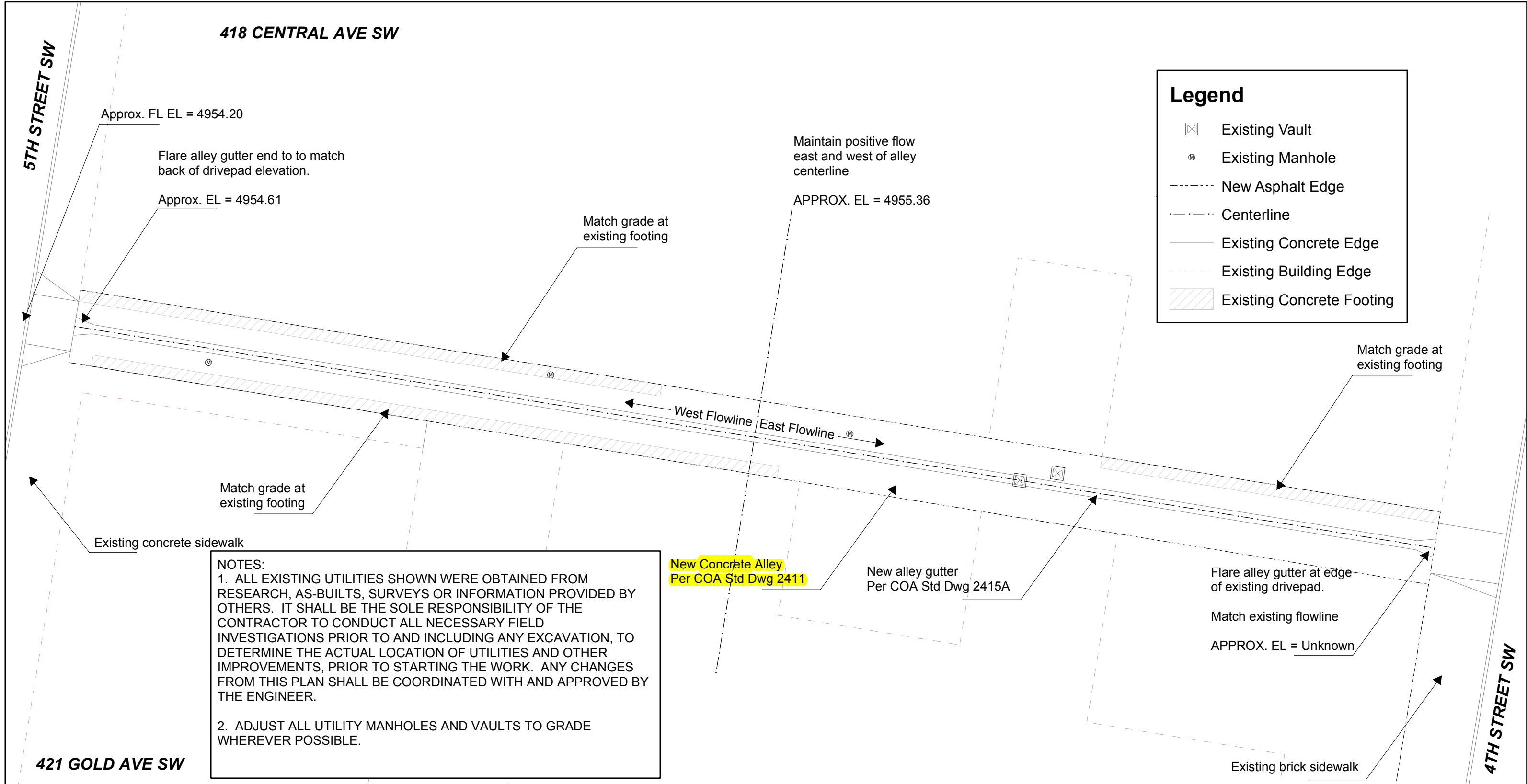

CITY OF ALBUQUERQUE DEPARTMENT OF MUNICIPAL DEVELOPMENT Construction Services Division	<div>  1 inch = 20 feet </div>	Sheet No. 3 of 4	4TH AND CENTRAL ALLEY ALLEY IMPROVEMENTS
			Contact: M. Carrasco 505-924-3672
			Date: 11/6/2014

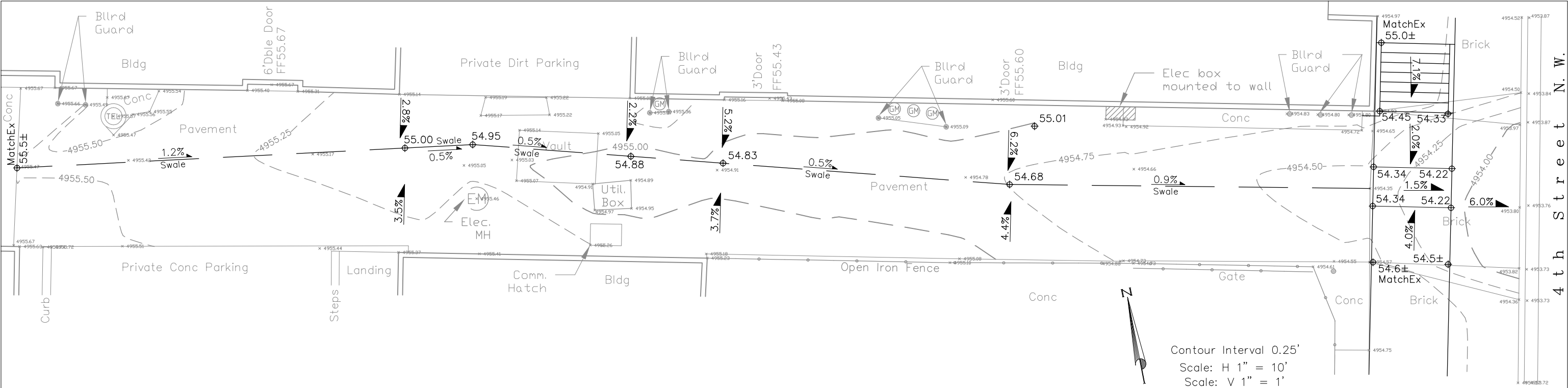

ALLEY NORTH OF AMY BIEHL CHARTER HIGH SCHOOL

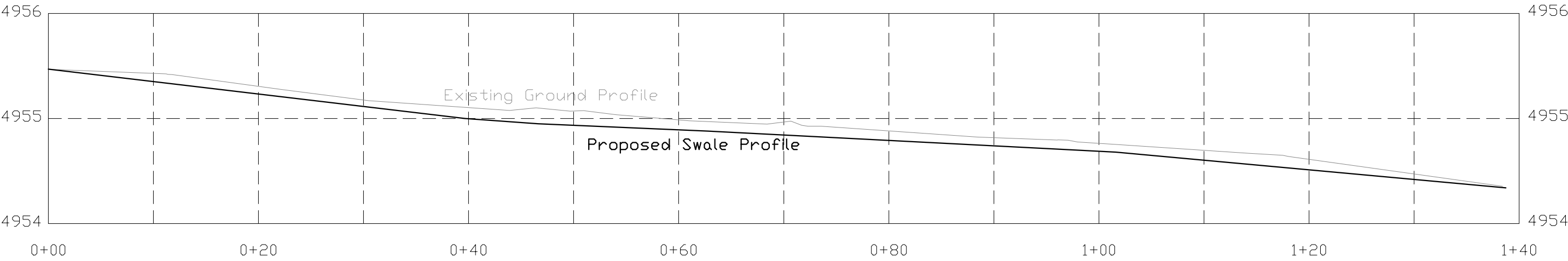

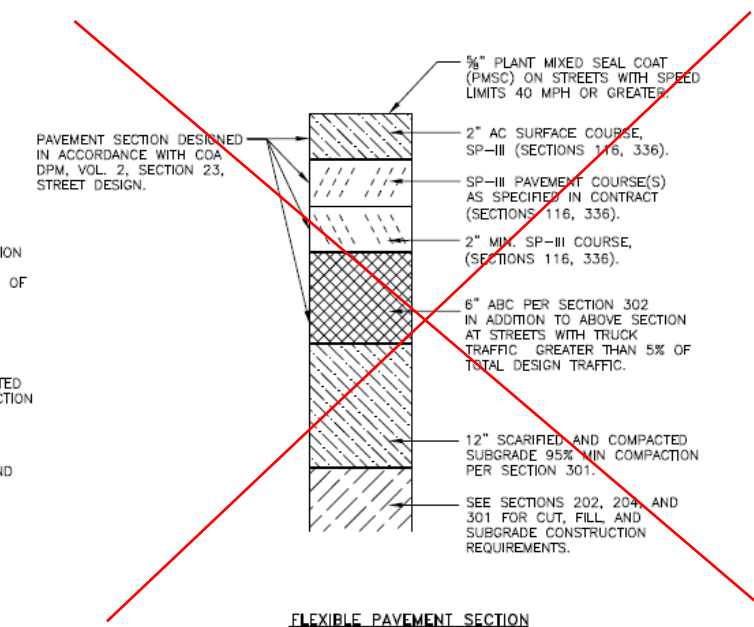
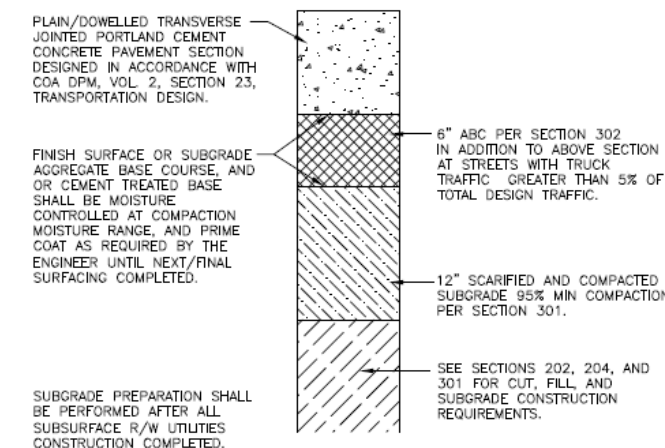
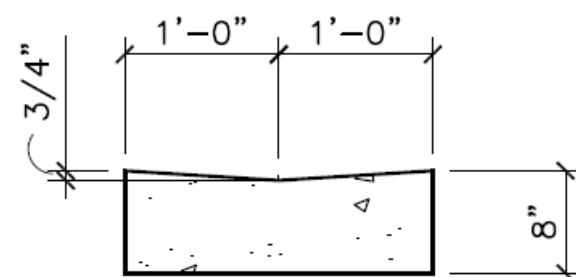
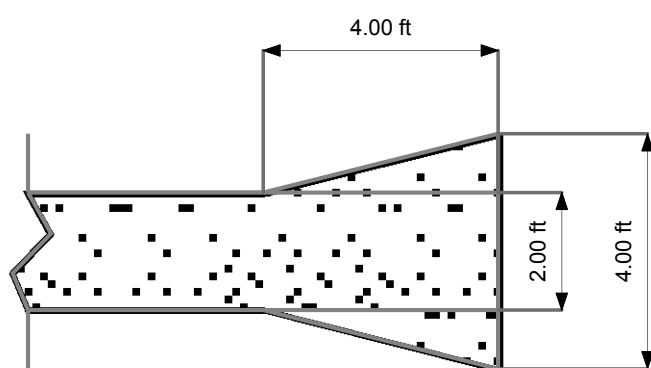
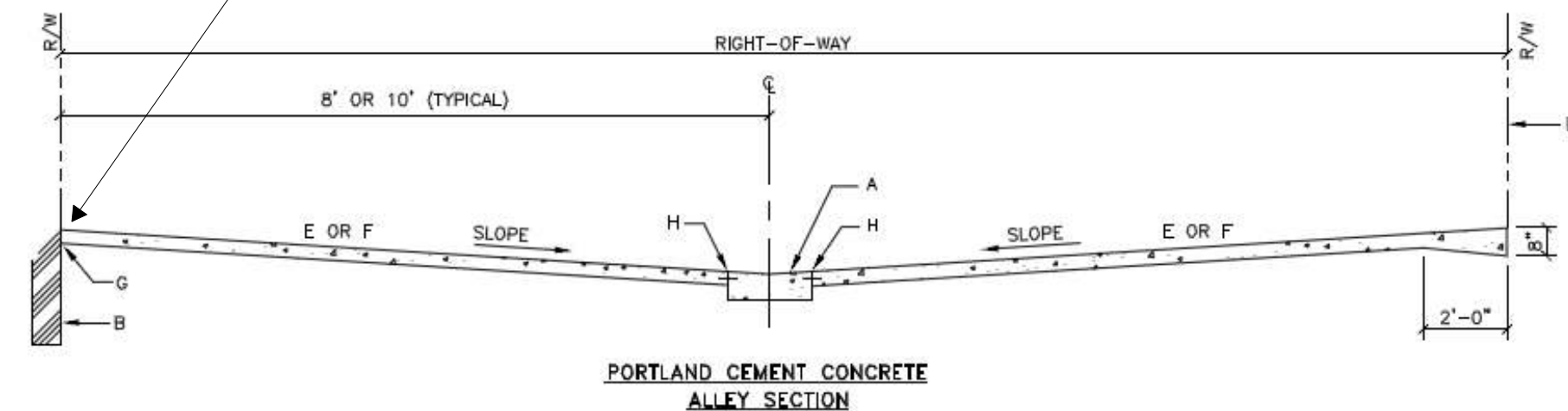
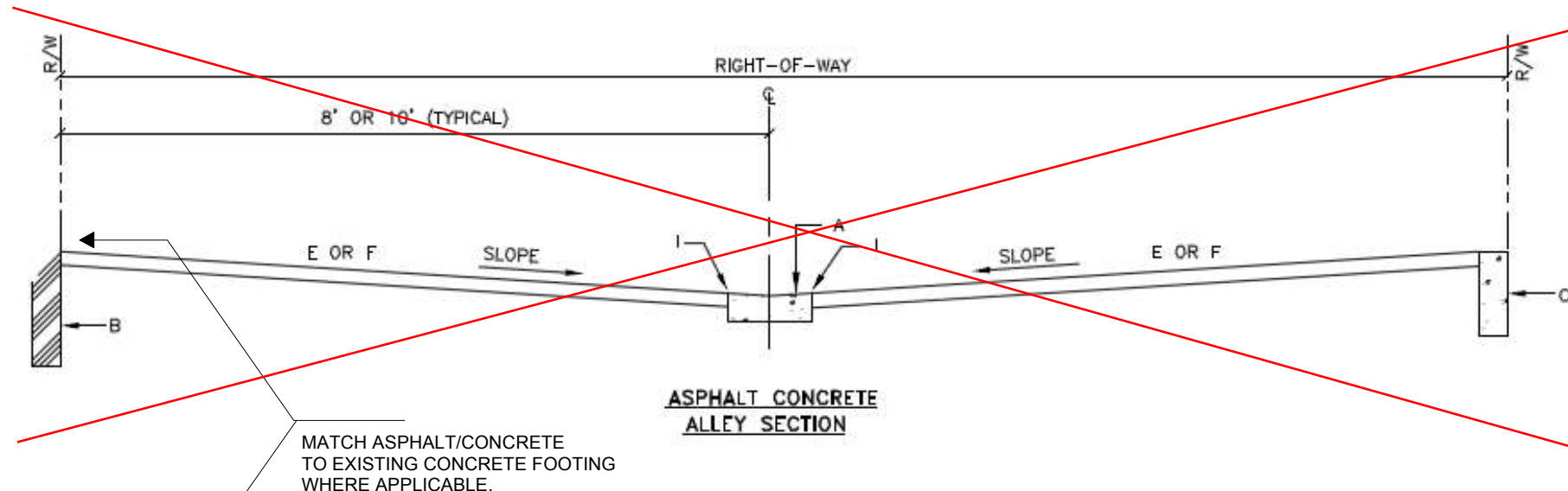

GENERAL NOTES:

1. REQUIREMENT FOR COMMERCIAL OR RESIDENTIAL PAVEMENT SECTION SHALL BE DETERMINED BY THE ENGINEER.
2. TRANSVERSE SLOPE OF ALLEY PAVEMENT SURFACE SHALL BE 2% MIN.
3. TYPE AND LOCATION OF JOINTS SHALL BE DEFINED ON THE PROJECT CONSTRUCTION PLANS, SEE SECTION 337.

CONSTRUCTION NOTES:

- A. ALLEY GUTTER, SEE DWG. 2415.
- B. WALL OR BUILDING FOUNDATION AT PROPERTY LINE.
- C. USE 6" x 18" PORTLAND CEMENT CONCRETE (PCC) CUT-OFF-WALL.
- D. RIGHT-OF-WAY ADJACENT TO OPEN AREA.
- E. USE RESIDENTIAL SECTION FOR RESIDENTIAL ALLEY USE, SEE DWG. 2405.
- F. USE ARTERIAL SECTION FOR COMMERCIAL ALLEY USE, SEE DWG. 2407.
- G. USE 1/2" EXPANSION JOINT WHERE PCC PAVEMENT ABUTS WALLS, RIGID PAVEMENT, POLES, TRANSFORMERS, ETC.
- H. TYPE 4 TIED JOINT, SEE DWG. 2450.
- I. SAWCUT AND SEAL JOINT, SEE DWG. 2450.

CITY OF ALBUQUERQUE
DEPARTMENT OF MUNICIPAL DEVELOPMENT
Construction Services Division

Construct Portland Cement Concrete Pavement per details on this sheet.

Sheet No.
4 of 4

4TH AND CENTRAL ALLEY
STANDARD DETAILS

Contact: M. Carrasco 505-924-3672

Date: 11/6/2014