

5/15/2016 5:49:51 PM Phoenix Half Scale.ctb
Brondice Long
P:\CoA On-call\Task 3, 4, & 5 Girard Blvd\CADD\DLV\Girard Task 4\ 001 Cover.dwg

CITY OF ALBUQUERQUE NEW MEXICO

DEPARTMENT OF MUNICIPAL DEVELOPMENT CONSTRUCTION PLANS

FOR

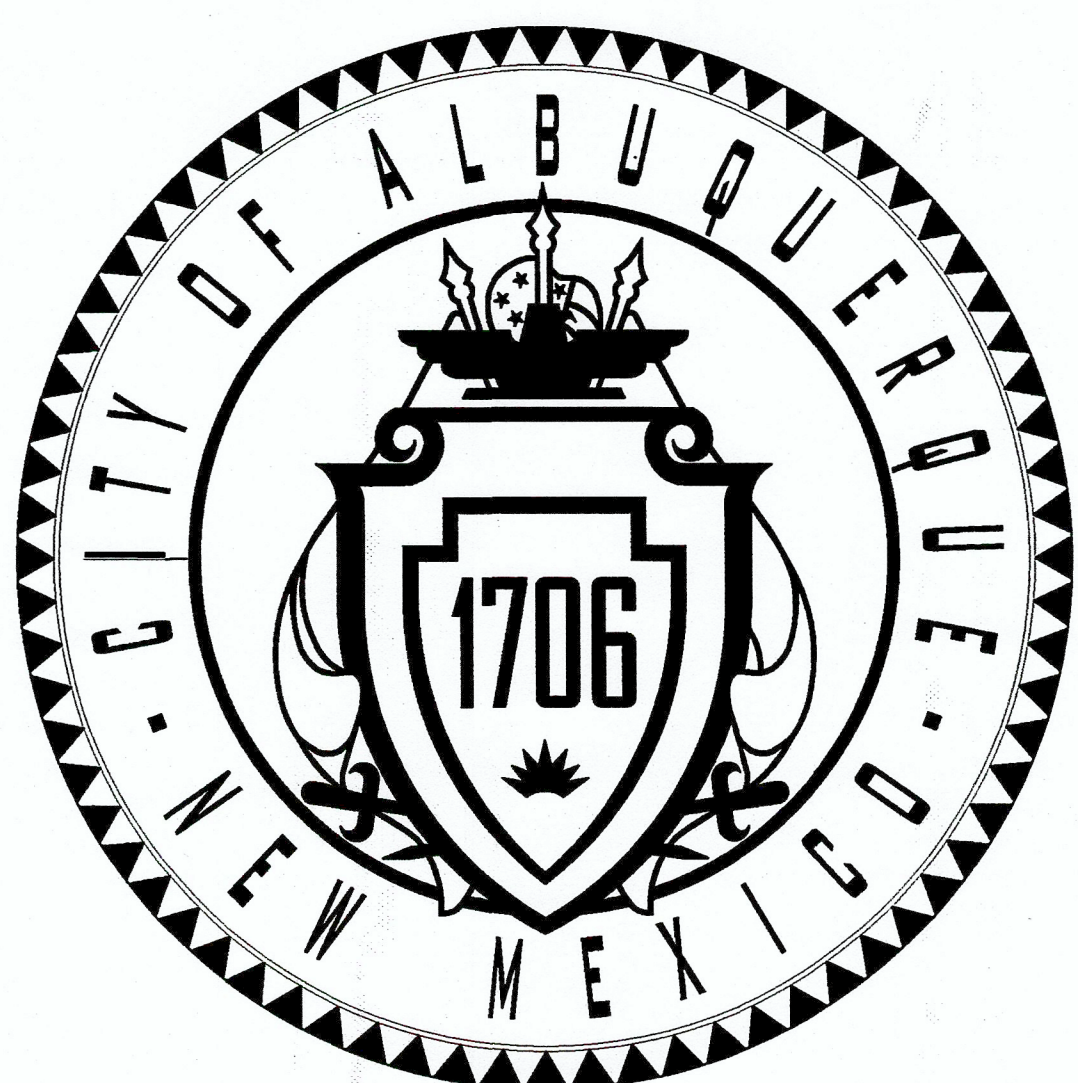

RECORD DRAWING INFO
CITY INSPECTOR: PERRY HAMPEL
CITY PROJECT MANAGER: ERIC MICHALSKI
CONTRACTOR: GANDYDANCER, LLC.
SURVEYOR: N/A
CONSTRUCTION PROJECT SUPERVISOR: DONALD MORALES
ACCEPTANCE DATE: 10/27/2017

APPROVED AS RECORD DRAWINGS
DMD/CSD
CITY CONSTRUCTION SUPERVISOR
Donald Morales
DATE: 12/7/2017

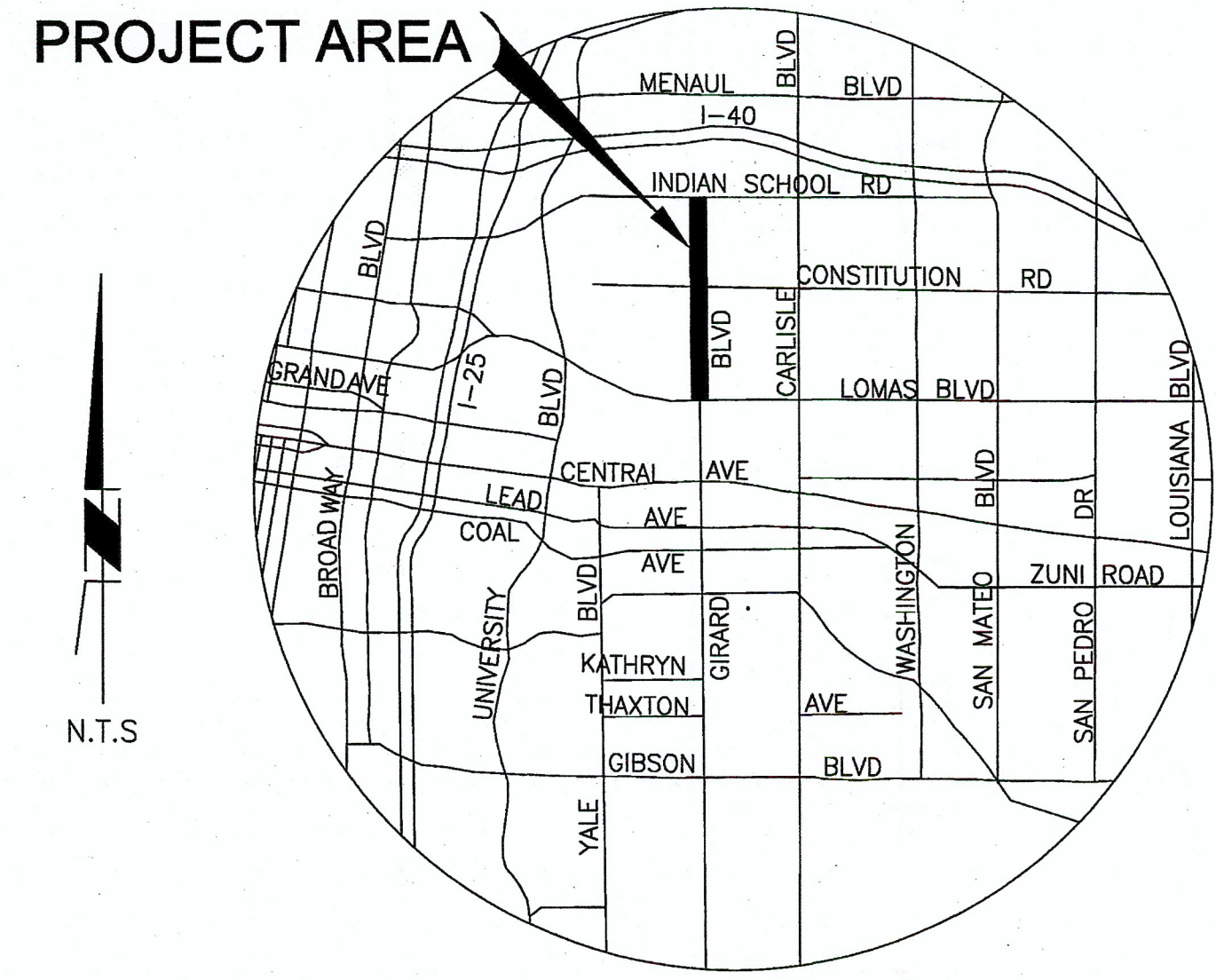

GIRARD BLVD COMPLETE STREET PLAN

PHASE III - LOMAS BLVD TO INDIAN SCHOOL RD

COA PROJECT NO. 9042.04

VICINITY MAP
N.T.S.
ZONE ATLAS - J16, H16

I, THE UNDERSIGNED, A REGISTERED PROFESSIONAL ENGINEER IN THE STATE OF NEW MEXICO, DO HEREBY CERTIFY THAT THE INDICATED RECORD DRAWINGS ARE BASED UPON INFORMATION PROVIDED BY THE CITY OF ALBUQUERQUE INSPECTOR IN THE FORM OF RED-LINED CONSTRUCTION DRAWING MARKUPS TO THE ORIGINAL DESIGN DRAWINGS. THE TRANSFER OF INFORMATION HEREIN IS TRUE AND CORRECT TO THE BEST OF MY KNOWLEDGE AND BELIEF. HOWEVER, I HAVE NOT VERIFIED THE ACCURACY AND/OR COMPLETENESS OF THE INFORMATION PROVIDED BY THE CITY OF ALBUQUERQUE INSPECTOR AND SHALL NOT BE RESPONSIBLE FOR ERRORS OR OMISSIONS THAT MAY BE INCORPORATED AS A RESULT OF ERRONEOUS INFORMATION PROVIDED BY OTHERS. ALL INFORMATION INCLUDING VERTICAL AND HORIZONTAL DIMENSIONS SHOULD BE FIELD VERIFIED PRIOR TO USE ON FUTURE PROJECTS.

NAME: ERIC J. FROBERG DATE: 12/7/17

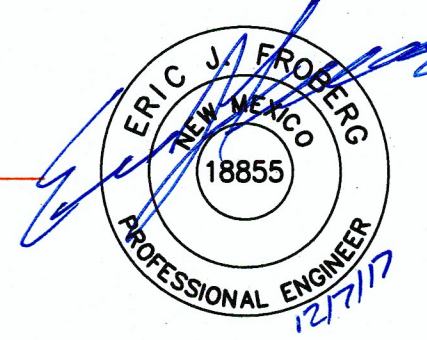

Two working days before you dig
CALL NEW MEXICO ONE CALL SYSTEM
260-1990

- SHEET INDEX:**
- 1 COVER SHEET & KEY MAP
 - 2 GENERAL NOTES & QUANTITIES
 - 3 TYPICAL SECTIONS
 - 4-8 SIGNING & STRIPING PLANS
 - 9 DETAILS

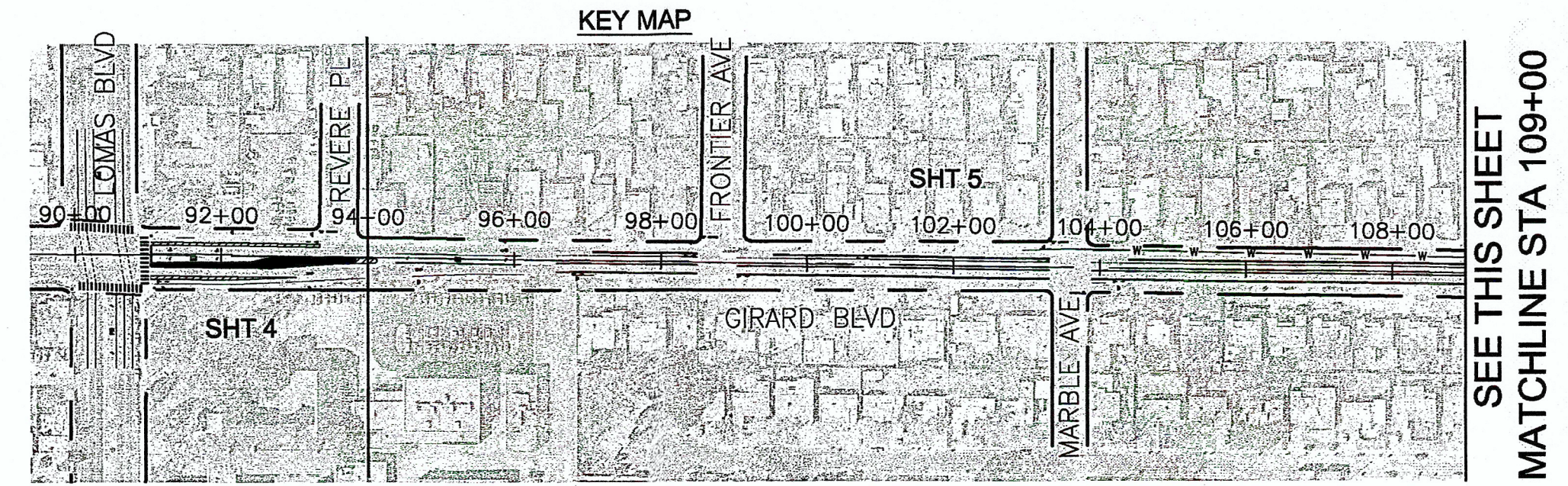

SEE THIS SHEET
MATCHLINE STA 109+00

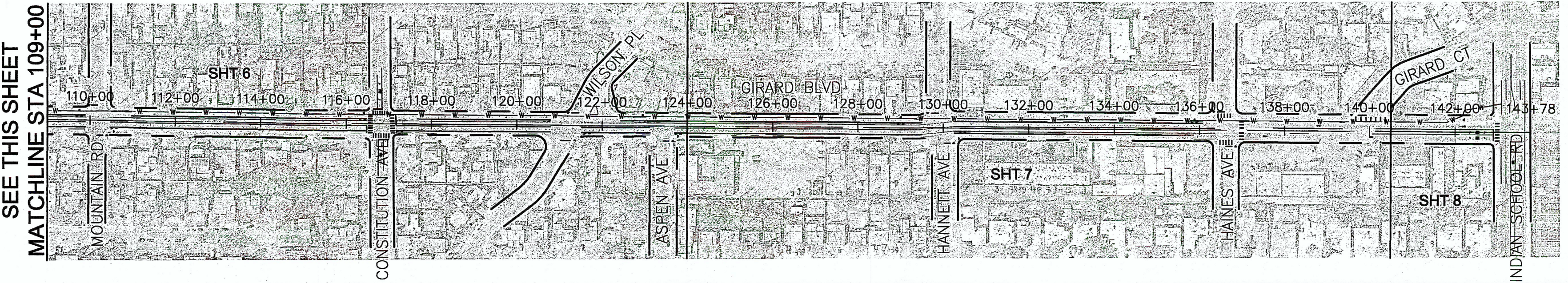

SEE THIS SHEET
MATCHLINE STA 109+00

KEY MAP
SCALE: 1"=200'

REV.	DATE	CITY ENGINEER	DATE	USER DEPARTMENT	DATE
ENGINEERS STAMP & SIGNATURE		APPROVALS		ENGINEER	DATE
 05/18/2016		DCR Chairman	<i>[Signature]</i>	6/19/16	APPROVED FOR CONSTRUCTION <i>[Signature]</i> 6/14/16 City Engineer Date
		Transportation	<i>[Signature]</i>	6/13/16	
		Water/Wastewater	<i>[Signature]</i>	6/13/16	
		Hydrology	<i>[Signature]</i>	6/13/16	
		Parks	<i>[Signature]</i>	6/13/16	
Constr. Mngmt.					
Constr. Coord.					
City Project No.		9042.04		Sheet 1	Of 9

RECORD DRAWING

RECORD DRAWING

P:\CoA On-call\Task 3, 4, & 5 Girard Blvd\CADD\DLV\Girard Task 3\SS-GEN Notes.dwg

GENERAL NOTES:

1. THE CONTRACTOR SHALL ABIDE BY ALL LOCAL, STATE, AND FEDERAL LAWS, RULES AND REGULATIONS WHICH APPLY TO THE CONSTRUCTION OF THESE IMPROVEMENTS.
2. ALL WORK DETAILED ON THESE PLANS TO BE PERFORMED, EXCEPT AS OTHERWISE STATED OR PROVIDED HEREON, SHALL BE CONSTRUCTED IN ACCORDANCE WITH CITY OF ALBUQUERQUE STANDARD SPECIFICATIONS FOR PUBLIC WORKS CONSTRUCTION, 1986 EDITION, THROUGH UPDATE #9, AND WILL BE REFERRED TO HEREIN AS "STANDARD SPECIFICATIONS".
3. ALL CONSTRUCTION WITHIN CITY RIGHT-OF-WAY OR EASEMENTS MUST BE DONE FROM APPROVED WORK ORDER DOCUMENTS FROM THE CITY.
4. THE CONTRACTOR AGREES THAT HE SHALL ASSUME THE SOLE AND compl..ETE RESPONSIBILITY FOR THE JOB SITE CONDITIONS DURING THE COURSE OF CONSTRUCTION OF THIS PROJECT, INCLUDING SAFETY OF ALL PERSONS AND PROPERTY. THIS REQUIREMENT SHALL APPLY CONTINUOUSLY AND NOT BE LIMITED TO NORMAL WORKING HOURS. THE CONTRACTOR SHALL DEFEND, INDEMNIFY, AND HOLD HARMLESS THE OWNER AND ENGINEER FROM ANY AND ALL LIABILITY, REAL OR ALLEGED, IN CONNECTION WITH THE PERFORMANCE OF WORK ON THIS PROJECT, EXCEPT LIABILITY ARISING FROM THE SOLE NEGLIGENCE OF THE OWNER OR ENGINEER
5. THE CONTRACTOR SHALL OBTAIN ALL NECESSARY PERMITS PRIOR TO CONSTRUCTION.
6. THE CONTRACTOR SHALL NOTIFY THE CITY SURVEYOR NOT LESS THAN SEVEN (7) DAYS PRIOR TO STARTING WORK IN ORDER THAT THE CITY SURVEYOR MAY TAKE NECESSARY MEASURES TO ENSURE THE PRESERVATION OF SURVEY MONUMENTS. THE CONTRACTOR SHALL NOT DISTURB PERMANENT SURVEY MONUMENTS WITHOUT THE CONSENT OF THE CITY SURVEYOR AND SHALL NOTIFY THE CITY SURVEYOR AND BEAR THE EXPENSE OF REPLACING ANY THAT MAY BE DISTURBED WITHOUT PERMISSION. ONLY THE CITY SURVEYOR SHALL REPLACE SURVEY MONUMENTS. WHEN A CHANGE IS MADE IN THE FINISHED ELEVATIONS OF THE PAVEMENT OF ANY ROADWAY IN WHICH A PERMANENT SURVEY MONUMENT IS LOCATED, THE CONTRACTOR SHALL, AT HIS OWN EXPENSE, ADJUST THE MONUMENT COVER TO THE NEW GRADE UNLESS OTHERWISE SPECIFIED.
7. ALL STREET STRIPING, ALTERED OR DESTROYED, SHALL BE REPLACED WITH THERMOPLASTIC REFLECTORIZED PAVEMENT MARKINGS BY THE CONTRACTOR TO SAME LOCATION AS EXISTING, OR AS INDICATED BY THIS PLAN SET.
8. SEVEN (7) WORKING DAYS PRIOR TO BEGINNING CONSTRUCTION, THE CONTRACTOR SHALL SUBMIT TO DMD, CONSTRUCTION SERVICES DIVISION, A DETAILED CONSTRUCTION SCHEDULE. THE CONTRACTOR SHALL OBTAIN EXCAVATION AND BARRICADE PERMIT TWO (2) DAYS PRIOR TO CONSTRUCTION. CONTRACTOR SHALL ALSO PROVIDE THE DETAILED CONSTRUCTION SCHEDULE TO THE CITY. THIS SHALL BE INCIDENTAL TO THE PROJECT.
9. THE ENGINEER HAS UNDERTAKEN NO FIELD VERIFICATION OF THE LOCATION, DEPTH, SIZE, OR TYPE OF EXISTING UNDERGROUND UTILITY LINES, MAKES NO REPRESENTATION PERTAINING THERETO, AND ASSUMES NO RESPONSIBILITY OR LIABILITY THEREFOR. THE CONTRACTOR SHALL INFORM ITSELF OF THE LOCATION OF ANY UTILITY LINE IN OR NEAR THE AREA OF THE WORK IN ADVANCE OF AND DURING EXCAVATION WORK. THIS WORK SHALL BE CONSIDERED INCIDENTAL TO THE PROJECT. THE CONTRACTOR IS FULLY RESPONSIBLE FOR ANY AND ALL DAMAGE CAUSED BY ITS FAILURE TO LOCATE, IDENTIFY, AND PRESERVE ANY AND ALL EXISTING UTILITIES.
10. THE CONTRACTOR SHALL PROMPTLY CLEAN UP ANY MATERIAL EXCAVATED WITHIN THE PUBLIC RIGHT-OF-WAY OR PRIVATE ROADWAY EASEMENTS SO THAT THE EXCAVATED MATERIAL IS NOT SUSCEPTIBLE TO BEING WASHED DOWN THE STREET OR INTO ANY PUBLIC DRAINAGE FACILITY.
11. CONTRACTOR SHALL BE RESPONSIBLE TO PROVIDE AND MAINTAIN ALL CONSTRUCTION SIGNING UNTIL THE PROJECT HAS BEEN ACCEPTED BY THE CITY OF ALBUQUERQUE.
12. A FOG SEAL COAT SHALL BE APPLIED TO ALL NEW AND EXISTING PAVEMENTS PRIOR TO FINAL STRIPING OF THE PROJECT. LIMITS OF THE COAT SHALL BE THROUGHOUT THE ENTIRE PROJECT AND PER BID ITEM 18.
13. CONSTRUCTION ACTIVITY SHALL BE LIMITED TO THE CITY RIGHT-OF-WAY AND/OR PROJECT LIMITS. ANY DAMAGE TO ADJACENT PROPERTIES RESULTING FROM THE CONSTRUCTION PROCESS IS THE RESPONSIBILITY OF THE CONTRACTOR. ANY COSTS INCURRED FOR REPAIRS SHALL BE THE COST OF THE CONTRACTOR.
14. OVERNIGHT PARKING OF CONSTRUCTION EQUIPMENT SHALL NOT OBSTRUCT DRIVEWAYS OR DESIGNATED TRAFFIC LANES. THE CONTRACTOR SHALL NOT STORE ANY EQUIPMENT OR MATERIAL WITHIN THE PUBLIC RIGHT-OF-WAY.
15. THE CONTRACTOR SHALL BE RESPONSIBLE TO REPLACE AT HIS EXPENSE ANY AND ALL PROPERTY CORNERS DESTROYED DURING CONSTRUCTION. ALL PROPERTY CORNERS MUST BE RESET BY A REGISTERED LAND SURVEYOR.
16. ALL BARRICADES AND CONSTRUCTION SIGNING SHALL CONFORM TO APPLICABLE SECTIONS OF THE M.U.T.C.D., U.S. DEPARTMENT OF TRANSPORTATION, LATEST EDITION 2009, REV 2.
17. THE CONTRACTOR SHALL MAINTAIN ALL CONSTRUCTION BARRICADES AND SIGNING AT ALL TIMES. THE CONTRACTOR SHALL VERIFY THE PROPER LOCATION OF ALL BARRICADING AT THE END AND BEGINNING OF EACH DAY.
18. THE CONTRACTOR SHALL ASSUME RESPONSIBILITY FOR ANY DAMAGE TO EXISTING PAVEMENTS, PAVEMENT MARKINGS, SIGNAGE, CURB & GUTTER, DRIVEPADS, CURB RAMPS, CHANNELS, LANDSCAPING INCLUDING IRRIGATION, AND SIDEWALK DURING CONSTRUCTION, APART FROM THOSE SECTIONS INDICATED FOR REMOVAL ON THE PLANS AND SHALL REPAIR OR REPLACE PER COA/AMAFCA STANDARDS, AT HIS OWN EXPENSE.
19. CONTRACTOR SHALL TRANSPORT ALL REMOVED AND SALVAGED SIGNS TO PINO YARDS OR LOCATION DIRECTED BY THE CITY'S PROJECT MANAGER AT NO ADDITIONAL COST.
20. CONTRACTOR SHALL MAINTAIN A GRAFFITI FREE WORKZONE UNTIL FINAL COMPLETION. CONTRACTOR SHALL MAKE EVERY EFFORT TO REMOVE GRAFFITI FROM ANY EXISTING OR PROPOSED SURFACE WITHIN THE PROJECT CORRIDOR. GRAFFITI REMOVAL SHALL BE INCIDENTAL TO THE COMPLETION OF THE PROJECT.

21. TYPICAL DIMENSIONS SHOWN ON PLANS ARE TO FACE OF CURB.
22. TWO WEEKS PRIOR TO CONSTRUCTION, THE CONTRACTOR SHOULD NOTIFY THE TRANSIT DEPARTMENT OF ANY IMPACT THE PROPOSED PROJECT WILL HAVE ON THE TRANSIT SYSTEM SUCH AS CAUSING A DETOUR, OR CAUSE THE CLOSING OR RELOCATION OF A BUS STOP. THE CONTACT PERSON IS SHABIH RIZVI, OFFICE PHONE 505-724-3134, CELL PHONE 505-331-0253, AND E-MAIL srizvi@cabq.gov AND/OR DOUGLAS GOFF, OFFICE PHONE 505-724-3137, CELL PHONE 505-206-0151, AND E-MAIL dgoff@cabq.gov
23. CONTRACTOR SHALL HAND DIG ALL SIGN POST LOCATIONS DUE TO POSSIBLE CONFLICT WITH EXISTING 14" WATERLINE ALONG THE EAST SIDEWALK AND 6" PVC ALONG THE WEST SIDEWALK. THE 14" WATERLINE IS A MINIMUM 36" DEPTH BURY, WHICH COINCIDES WITH THE MINIMUM 36" DEPTH BASE POST BURY. THIS SHALL BE INCIDENTAL TO THE PROJECT AND NO ADDITIONAL PAYMENT WILL BE MADE THEREFORE.
24. CONTRACTOR SHALL ENSURE THAT NEW CROSSWALK STRIPING LINES UP WITH EXISTING CURB RAMPS.

BID ITEM	ITEM ID No.	ITEM DESCRIPTION	UNIT	TOTAL	4	5	6	7	8
1	440.003	Reflectorized Painted Markings, Yellow or Red Curb, 8" Width, cip.	LF	715	22	187	192	179	135
2	441.001	Reflectorized Plastic Pavement Markings 4" Yellow Solid Double Stripe, cip.	LF	6,397	1,069	2,229	1,424	1,473	202
3	441.001	Reflectorized Plastic Pavement Markings 4" White Broken Stripe (10' Stripe, 30' Skip), cip.	LF	273	100		83	90	
4	441.002	Reflectorized Plastic Pavement Markings 6" White Solid Stripe, cip.	LF	11,060	2,653	2,533	3,053	2,621	200
5	441.002	Reflectorized Plastic Pavement Markings 6" White Dotted Stripe (2' Stripe, 2' Skip), cip.	LF	262		141	86	35	
6	441.004	Reflectorized Plastic Pavement Markings 12" White width, cip.	LF	469	81	167	104	27	90
7	441.005	Reflectorized Plastic Pavement Markings 24" White width, cip.	LF	673		70	260	253	90
8	441.031	Reflectorized Plastic Pavement Markings, Bike w/Arrow, cip.	EA	4			1	1	2
9	441.03x	Reflectorized Plastic Pavement Markings "Super" Sharrow, cip.	EA	51	13	13	13	12	
10	441.040	Reflectorized Plastic Pavement Markings Arrow, Left, cip	EA	2					2
11	441.040	Reflectorized Plastic Pavement Markings Arrow, Thru & Right, cip.	EA	2					2
12	441.040	Reflectorized Plastic Pavement Markings Word, Only, cip.	EA	1					1
13	443.101	Removal of Pavement Stripe, Any Width, Painted or Plastic, compl.	LF	8,346	1,331	2,312	2,071	2,105	527
14	444.102	Removal of Pavement Markings: Arrow, Symbol, or Word, Painted or Plastic, Compl.	EA	7			1	1	5
15	450.001	Aluminum Panel Sign, cip.	SF	302	71	72	68	73	18
16	450.01	Square Tube Steel Posts & Base Posts For Aluminum Panel Sign, cip.	LF	587	139	148	124	145	31
17	450.101	Sign, Post, & Base Post, Remove & Salvage, compl.	EA	15		1	1	13	
18	336.x	Fog Seal	SY	26,015					

SIGNALIZED INTERSECTIONS WITHIN THE PROJECT LIMITS:	
1	GIRARD BOULEVARD & COAL AVENUE
2	GIRARD BOULEVARD & LEAD AVENUE
3	GIRARD BOULEVARD & CENTRAL AVENUE

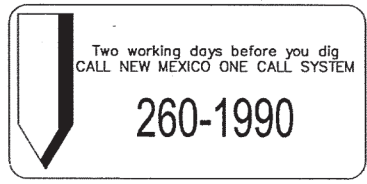

TY LIN INTERNATIONAL
engineers | planners | scientists
500 4th Street NW Suite 403
Bank of America Centre
Albuquerque, NM 87102

CITY OF ALBUQUERQUE
MUNICIPAL DEVELOPMENT DEPARTMENT
ENGINEERING DIVISION

TITLE: **GIRARD COMPLETE STREET PLAN
GENERAL NOTES & QUANTITIES**

Design Review Committee

City Engineer Approval

City Project No. 9042.03

Zone Map No. L16, K16

Sheet 2 of 9

RECORD DRAWING

RECORD DRAWING

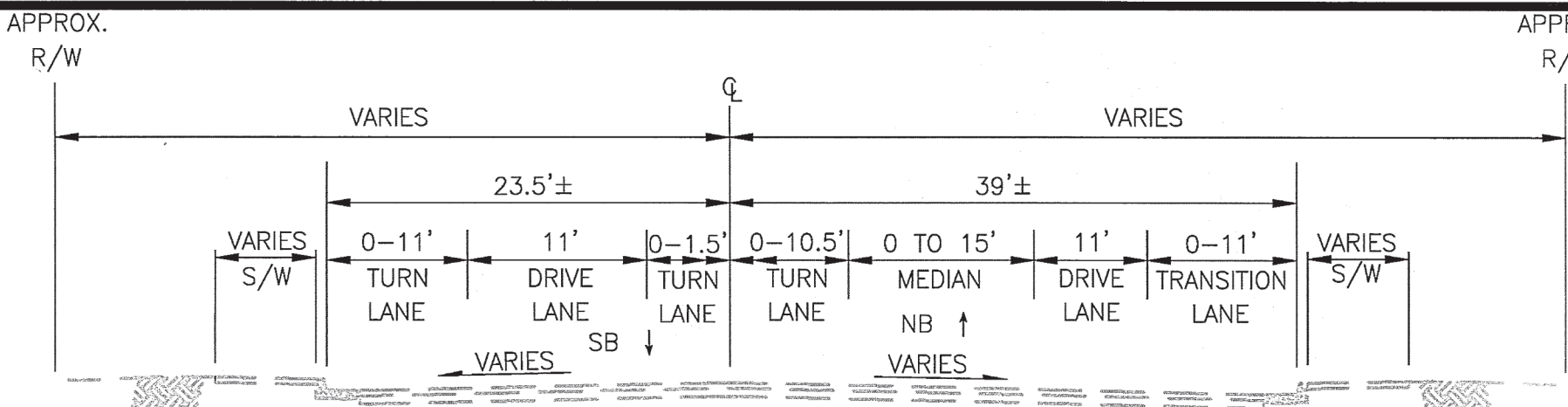

GIRARD BLVD
LOOKING NORTH
STA 91+04.00 TO 94+38.54
(EXISTING)

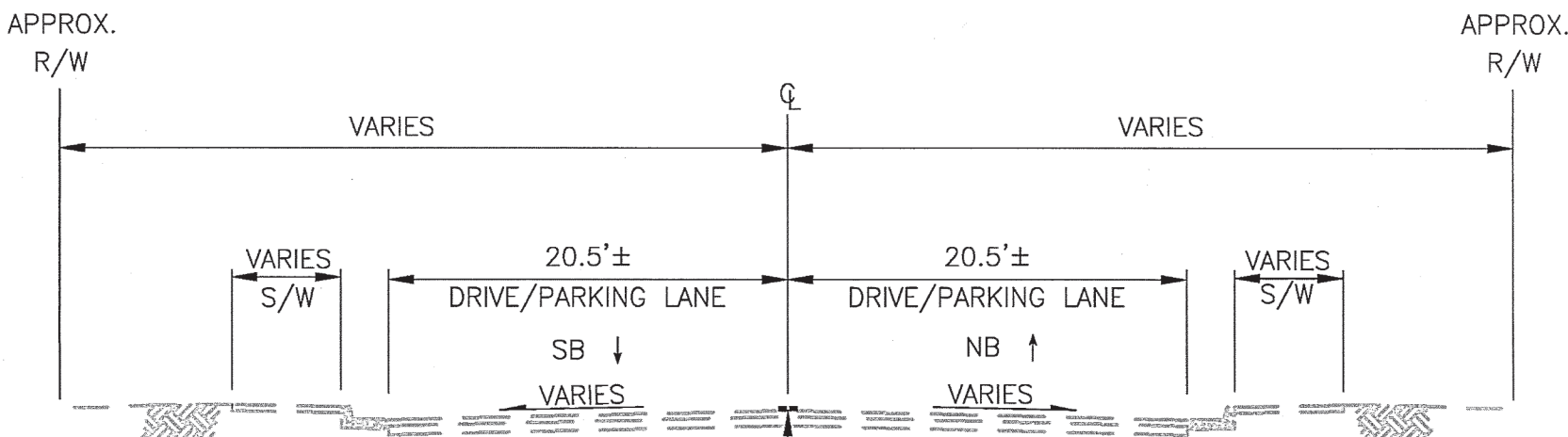

GIRARD BLVD
LOOKING NORTH
STA 95+40.94 TO 98+49.86
STA 99+04.07 TO 103+31.56
STA 103+89.08 TO 109+89.32
STA 110+46.69 TO 116+48.57
STA 117+16.41 TO 120+79.71
STA 121+51.84 TO 123+13.62
STA 123+70.30 TO 129+77.46
(EXISTING)

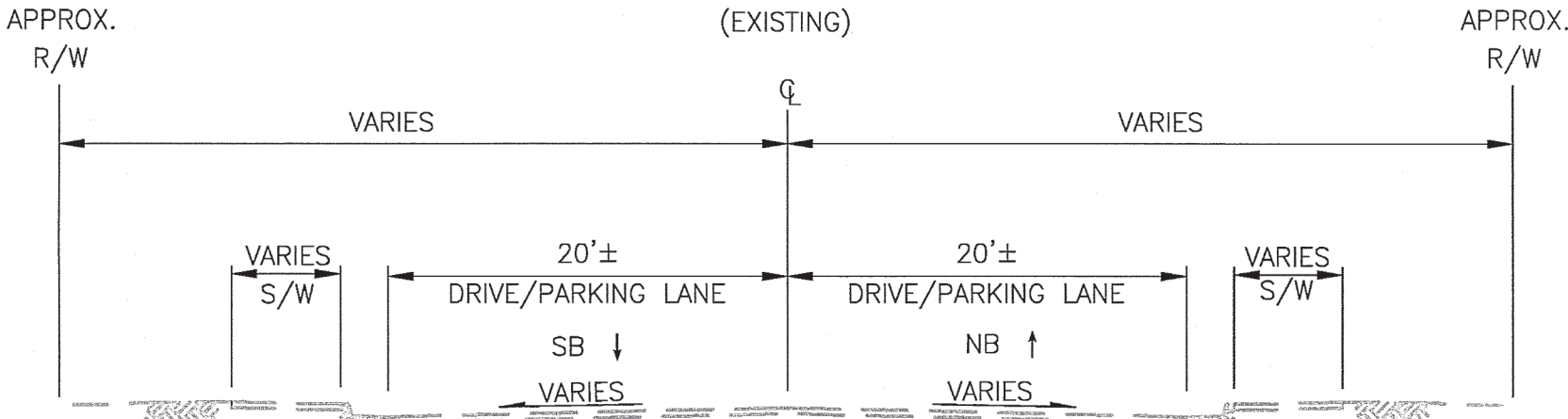

GIRARD BLVD
LOOKING NORTH
STA 137+72.98 TO 139+36.71
STA 140+14.41 TO 142+14.69
(EXISTING)

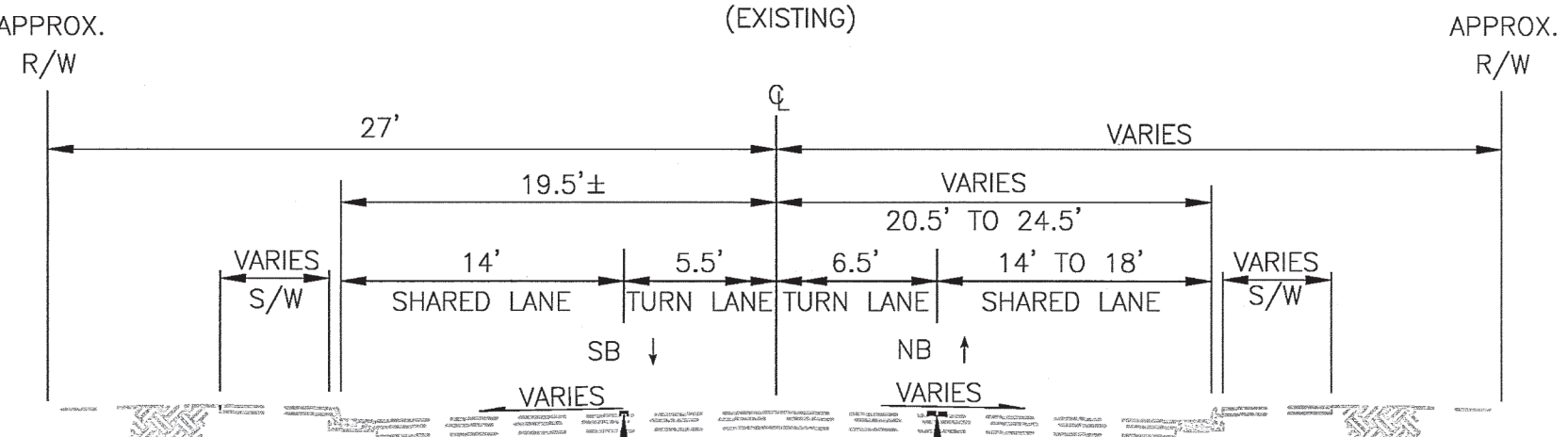

GIRARD BLVD
LOOKING NORTH
STA 94+38.54 TO 96+08.95
(PROPOSED)

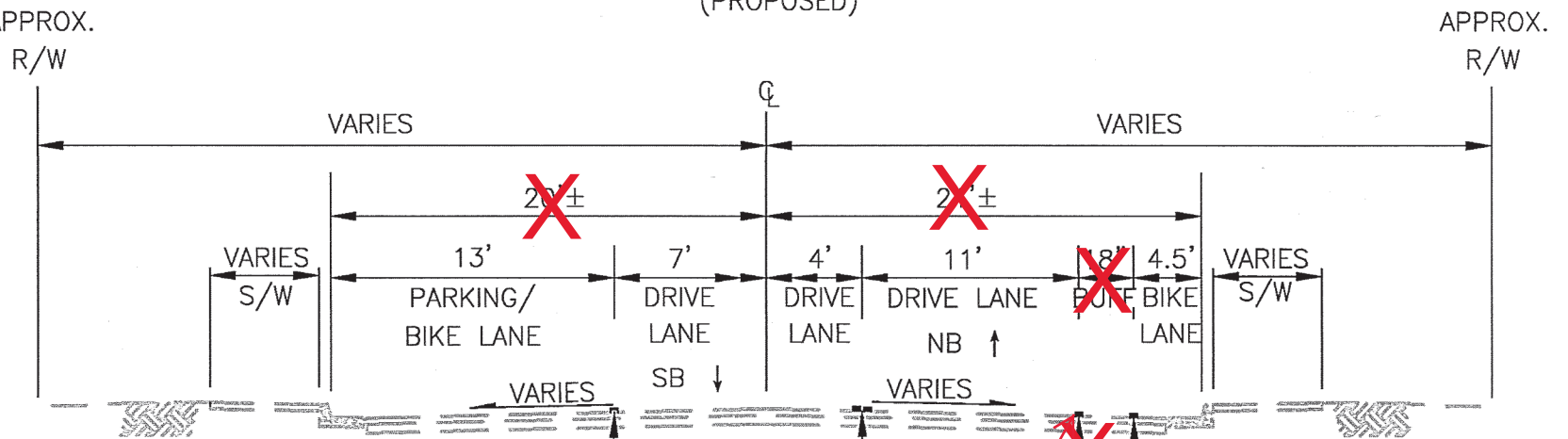

GIRARD BLVD
LOOKING NORTH
STA 96+57.52 TO 97+07.52
STA 99+04.07 TO 99+54.07
STA 103+89.08 TO 104+39.08
STA 110+46.69 TO 110+96.69
STA 117+16.41 TO 117+66.61
STA 121+51.84 TO 122+43.49
(PROPOSED)

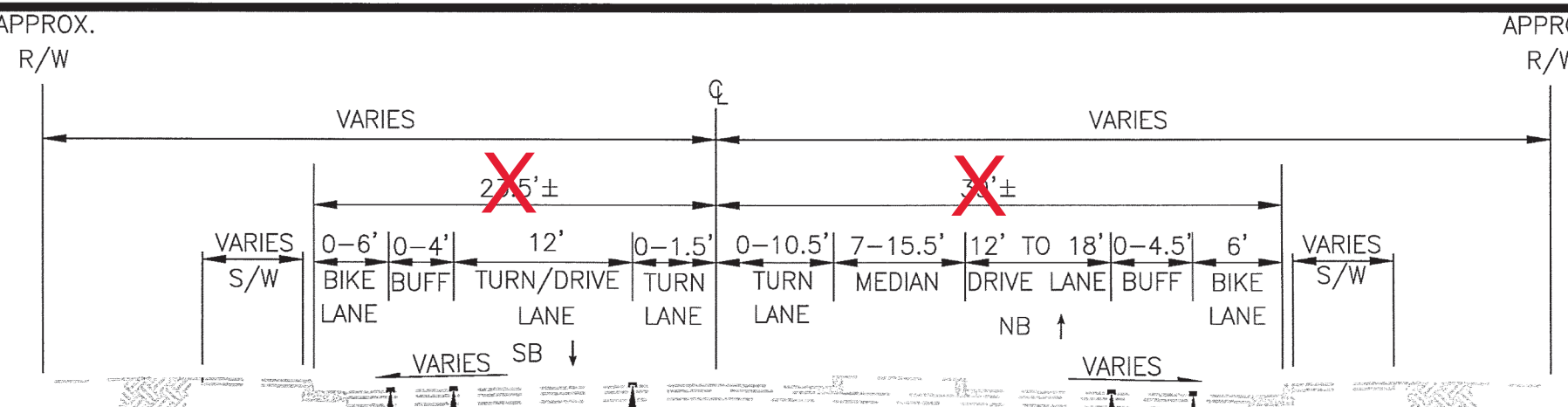

GIRARD BLVD
LOOKING NORTH
STA 91+04.00 TO 94+12.86
(PROPOSED)

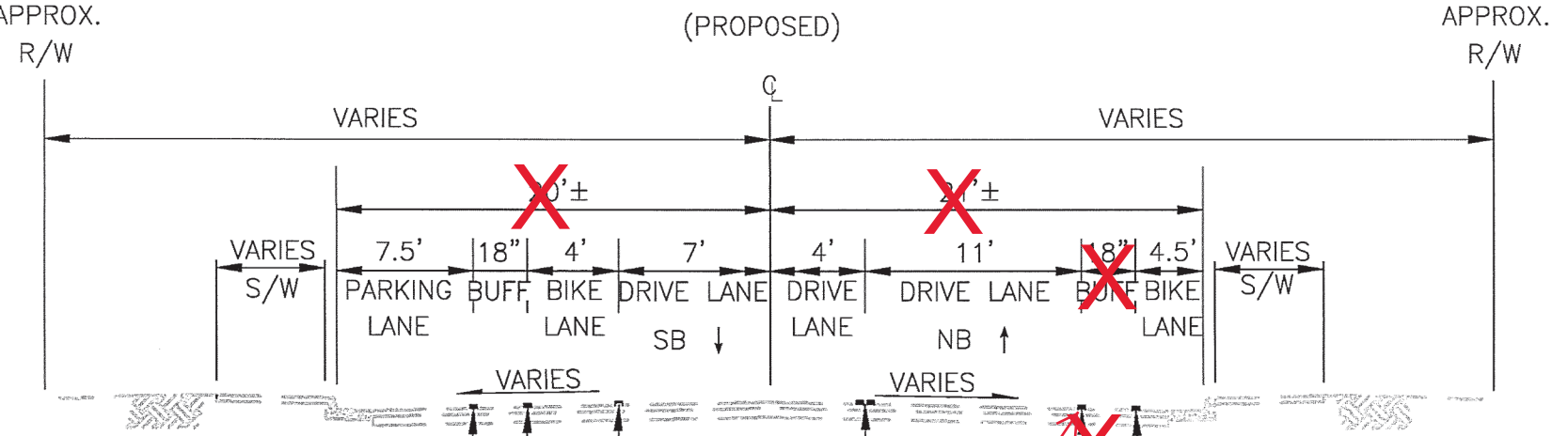

GIRARD BLVD
LOOKING NORTH
STA 97+07.52 TO 98+49.86
STA 99+54.07 TO 103+31.56
STA 104+39.08 TO 109+89.32
STA 110+96.69 TO 116+48.57
STA 117+66.61 TO 120+79.71
STA 122+43.49 TO 123+12.62
STA 123+70.30 TO 129+50.00
(PROPOSED)

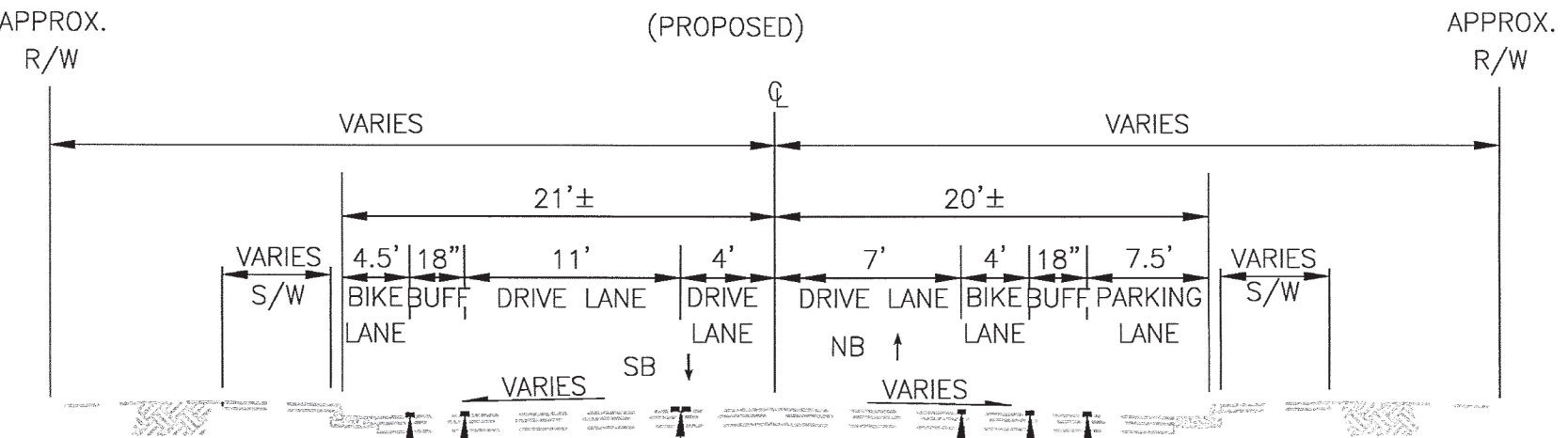

GIRARD BLVD
LOOKING NORTH
STA 130+25.80 TO 135+86.41
(PROPOSED)

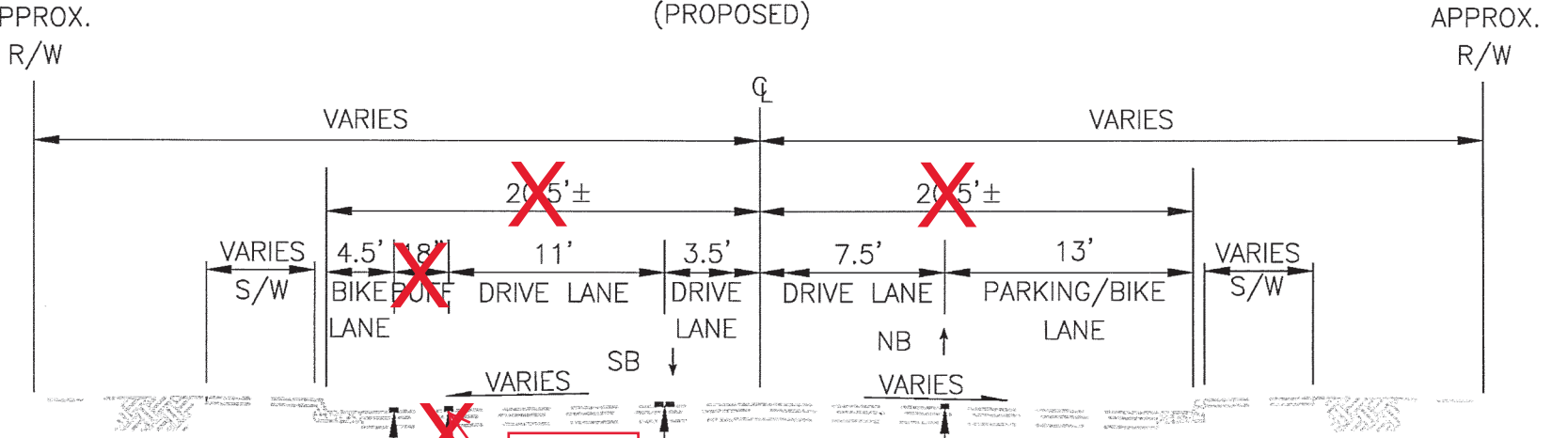

GIRARD BLVD
LOOKING NORTH
STA 135+86.41 TO 136+36.41
(PROPOSED)

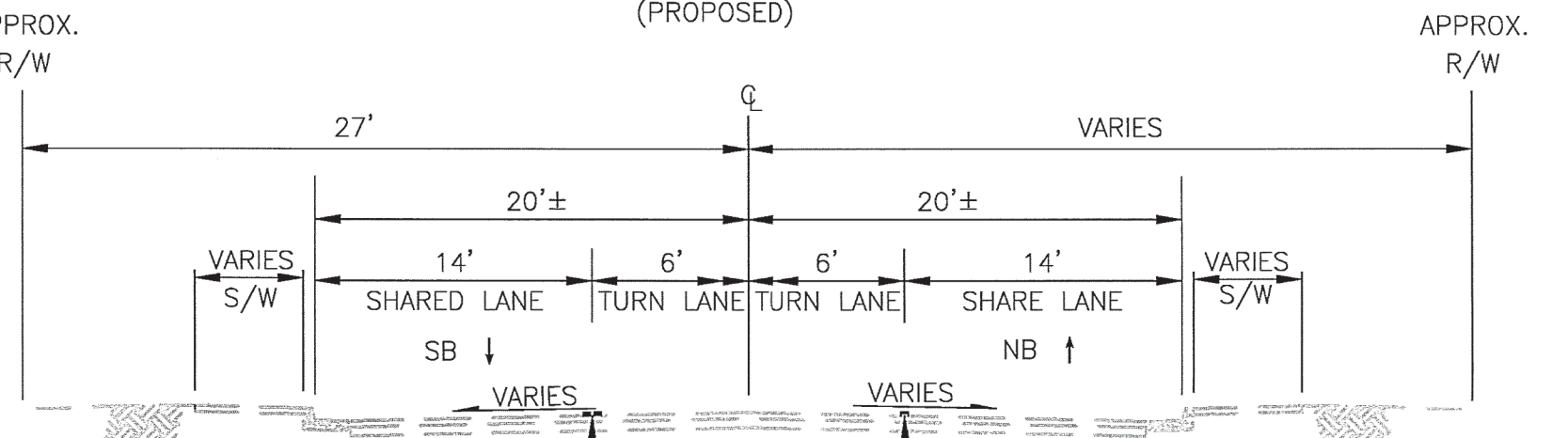

GIRARD BLVD
LOOKING NORTH
STA 137+72.98 TO 139+36.71
STA 140+14.41 TO 142+14.69
(PROPOSED)

ROAD WIDTH APPROXIMATELY
2' LESS THAN SHOWN

18" BUFFER - OPPOSITE OF
PARKING LANE ELIMINATED AS
PER SITE MEETING

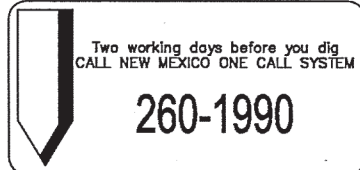
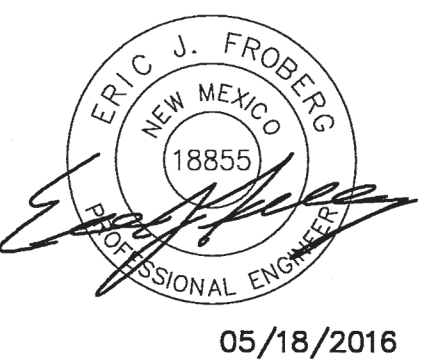

TY LIN INTERNATIONAL
engineers | planners | scientists
500 4th Street NW Suite 403
Bank of America Centre
Albuquerque, NM 87102



CITY OF ALBUQUERQUE
MUNICIPAL DEVELOPMENT DEPARTMENT
ENGINEERING DIVISION

TITLE: **GIRARD COMPLETE STREET PLAN
TYPICAL SECTIONS**

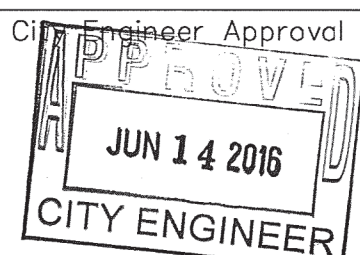
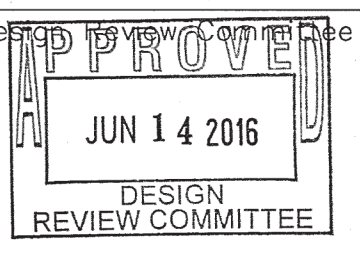

City Project No. 9042.04 Zone Map No. J16, H16 Sheet 3 Of 9

RECORD DRAWING

RECORD DRAWING





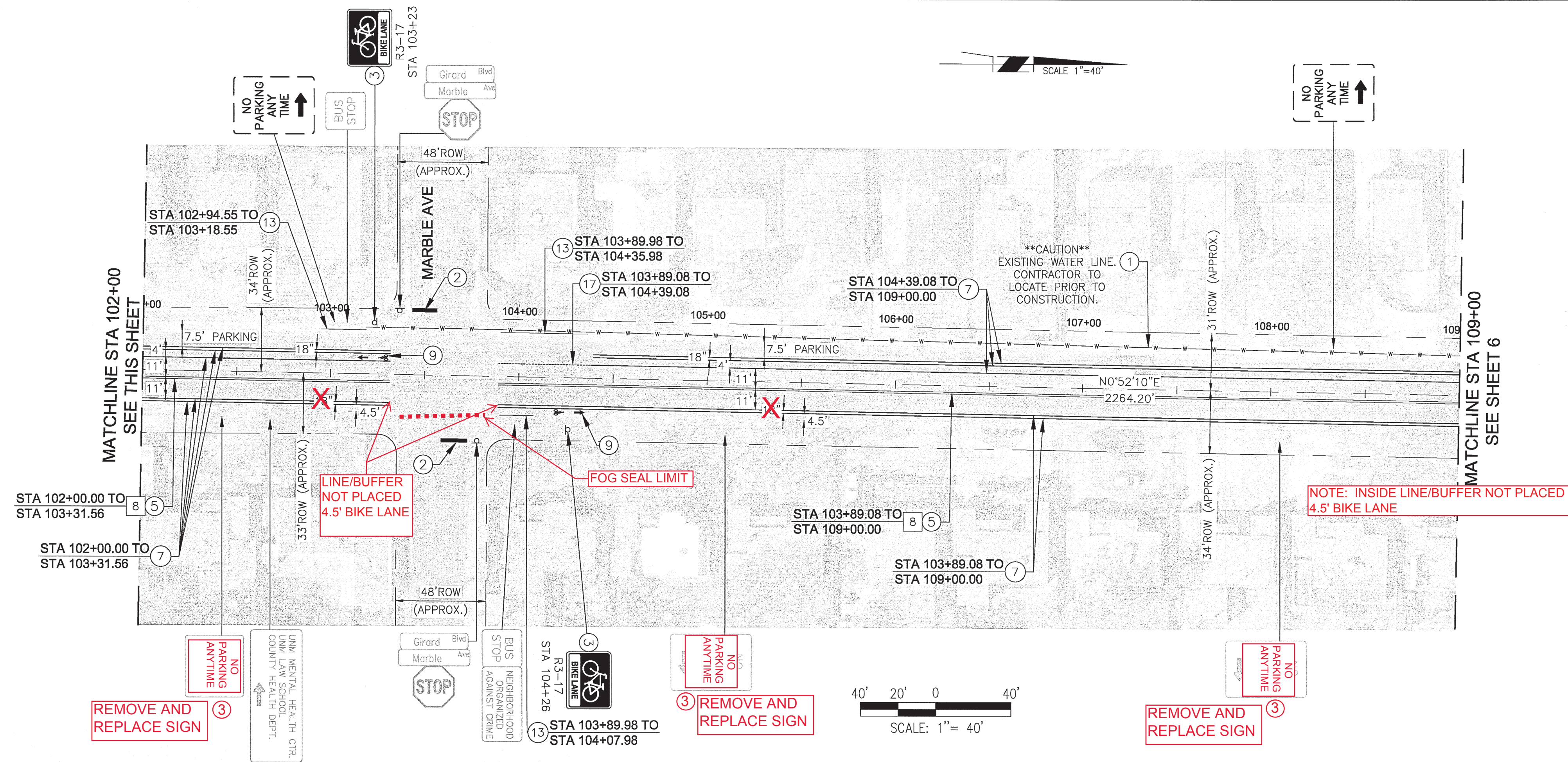

Two working days before you dig
CALL NEW MEXICO ONE CALL SYSTEM
260-1990

RECORD DRAWING

RECORD DRAWING

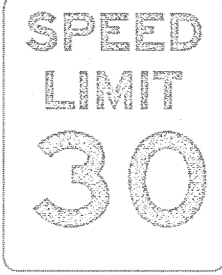
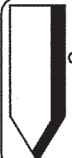

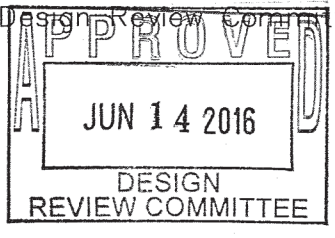
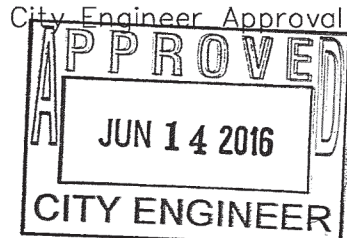
REMOVALS				
1	REMOVE EXISTING 4" SOLID WHITE STRIPE	80 LF		
3	REMOVE EXISTING SYMBOL	1 EA		
8	REMOVE EXISTING DOUBLE YELLOW SOLID STRIPE	1,317 LF		
GENERAL CONSTRUCTION NOTES				
1	PROTECT IN PLACE			
2	INSTALL 24" STOP BAR	40 LF		
3	INSTALL NEW SIGN W/ NEW SIGN POST PER DETAIL ON SHEET 9			
4	INSTALL A NEW "SUPER" SHARROW MARKING PER DETAIL ON SHEET 9	2 EA		
5	INSTALL 4" DOUBLE YELLOW SOLID STRIPE	1,301 LF		
7	INSTALL 6" SOLID WHITE STRIPE	5,384 LF		
9	INSTALL BIKE SYMBOL (WITH ARROW) PER DETAIL ON SHEET 9	6 EA		
10	INSTALL PLASTIC LEFT TURN SYMBOL	2 EA		
12	INSTALL PLASTIC WORD "ONLY"	1 EA		
13	REFRESH YELLOW CURB PAINT	118 LF		
14	INSTALL 8" SOLID WHITE STRIPE	29 LF		
17	INSTALL 6" DOTTED WHITE STRIPE (2' STRIPE, 2' SKIP)	150 LF		
18	PAINT CURB RED	151 LF		
GENERAL NOTES 1. ALL RIGHT OF WAY DIMENSIONS ARE APPROXIMATE.				
SIGNING LEGEND:				
		NEW/REMOVE & RELOCATED SIGN	8 EA	
		REMOVE & SALVAGE	4 EA	
		PROTECT IN PLACE		
TOTAL NEW SIGN:			24 SF	
TOTAL NEW SIGN POST:			66 LF	
 Two working days before you die CALL NEW MEXICO ONE CALL SYSTEM 260-1990				
TY. LIN INTERNATIONAL engineers planners scientists 500 4th Street NW Suite 403 Bank of America Centre Albuquerque, NM 87102				
 CITY OF ALBUQUERQUE MUNICIPAL DEVELOPMENT DEPARTMENT ENGINEERING DIVISION				
TITLE: GIRARD COMPLETE STREET PLAN				
SIGNING & STRIPING PLAN STA 94+00 TO 109+00				
				
DESIGN REVIEW COMMITTEE		CITY ENGINEER		
City Project No. 9042.04		Zone Map No. J16. H16		Sheet 5 Of 9

RECORD DRAWING

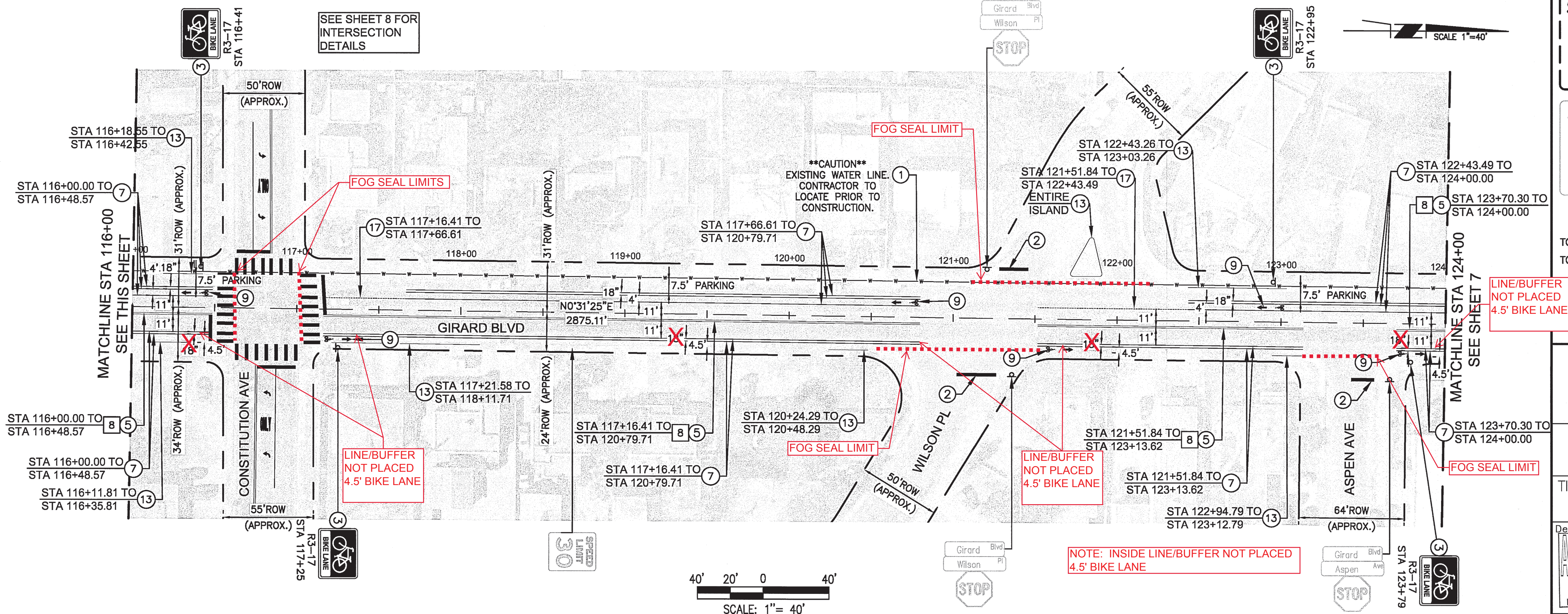
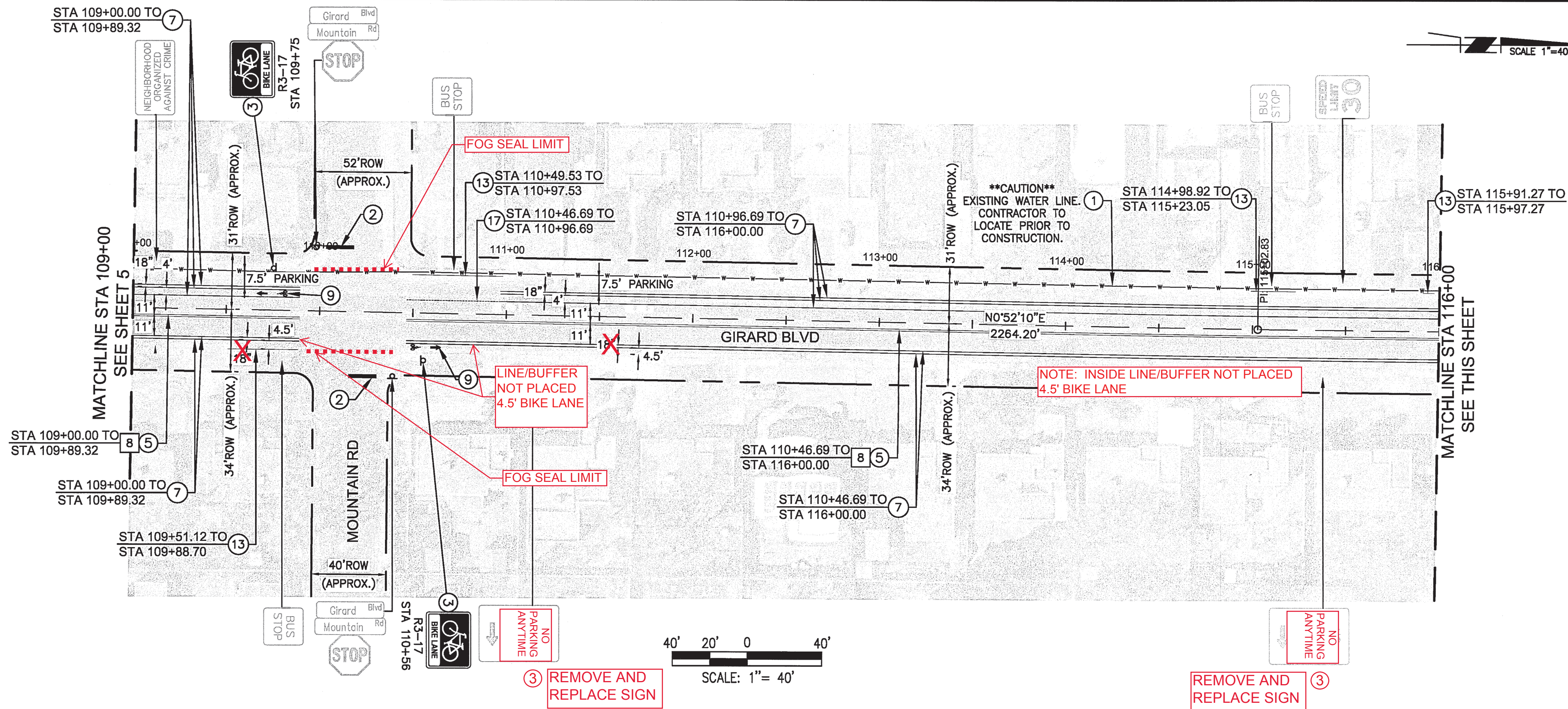

REMOVALS				
REMOVE	EXISTING	DOUBLE	YELLOW	1,246 LF
8	SOLID STRIPE			

GENERAL CONSTRUCTION NOTES			
1	PROTECT IN PLACE		
2	INSTALL 24" STOP BAR	86 LF	
3	INSTALL A NEW SIGN W/ NEW SIGN POST PER DETAIL ON SHEET 9		
5	INSTALL 4" DOUBLE YELLOW SOLID STRIPE	1,246 LF	
7	INSTALL 6" SOLID WHITE STRIPE	5,822 LF	
9	INSTALL BIKE SYMBOL (WITH ARROW) PER DETAIL ON SHEET 9	8 EA	
13	REFRESH YELLOW CURB PAINT	416 LF	
17	INSTALL 6" DOTTED WHITE STRIPE (2' STRIPE, 2' SKIP)	192 LF	

GENERAL NOTES
1. ALL RIGHT OF WAY DIMENSIONS ARE APPROXIMATE.

SIGNING LEGEND:

SPEED LIMIT	NEW/REMOVE & RELOCATED SIGN	6 EA
30		
30	REMOVE & SALVAGE	
30	PROTECT IN PLACE	

TOTAL NEW SIGN: 18 SF
TOTAL NEW SIGN POST: 62 LF

260-1990

TY LIN INTERNATIONAL
engineers | planners | scientists
500 4th Street NW Suite 403
Bank of America Centre
Albuquerque, NM 87102

CITY OF ALBUQUERQUE
MUNICIPAL DEVELOPMENT DEPARTMENT
ENGINEERING DIVISION

TITLE: **GIRARD COMPLETE STREET PLAN**
SIGNING & STRIPING PLAN
STA 109+00 TO 124+00

Design Review Committee	City Engineer Approval	Mo./Day/Yr.	Mo./Day/Yr.
APPROVED JUN 14 2016 DESIGN REVIEW COMMITTEE	APPROVED JUN 14 2016 CITY ENGINEER		

City Project No.	Zone Map No.	Sheet	Of
9042.04	J16, H16	6	9

RECORD DRAWING

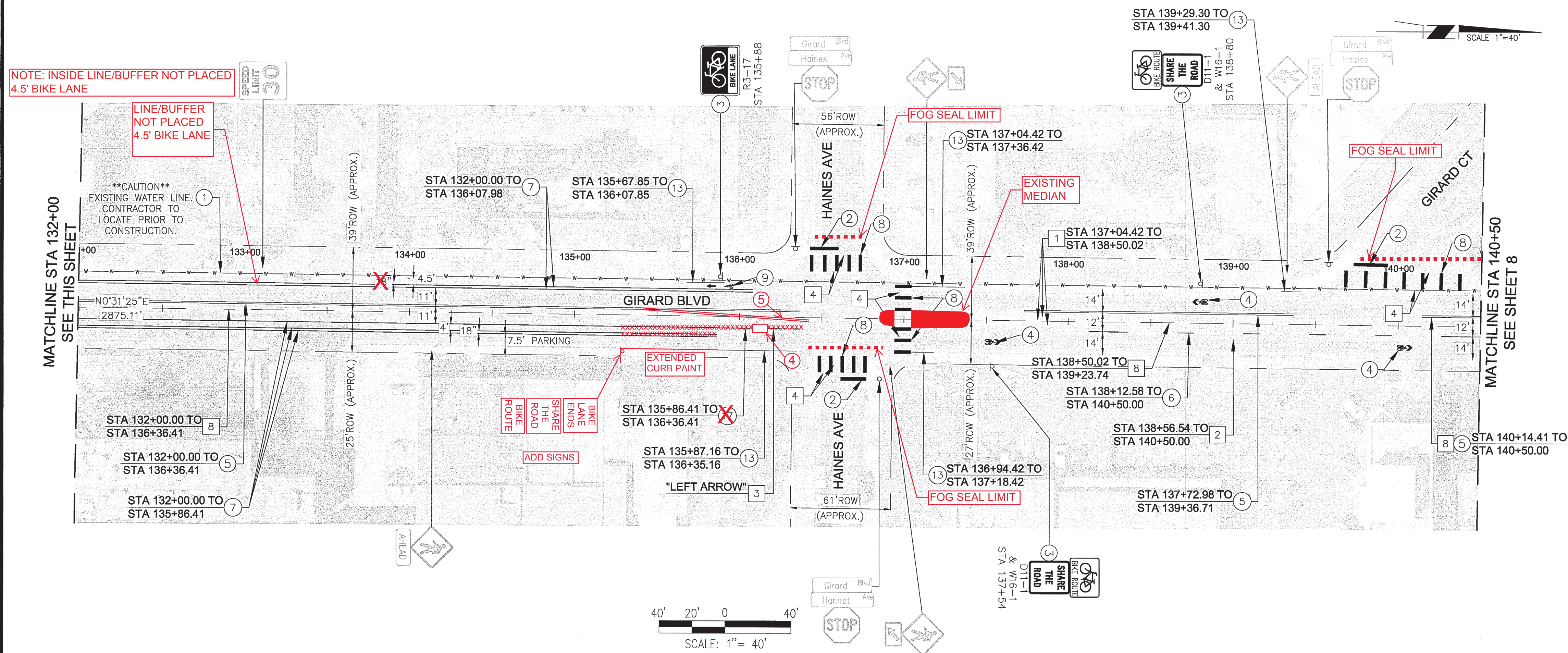
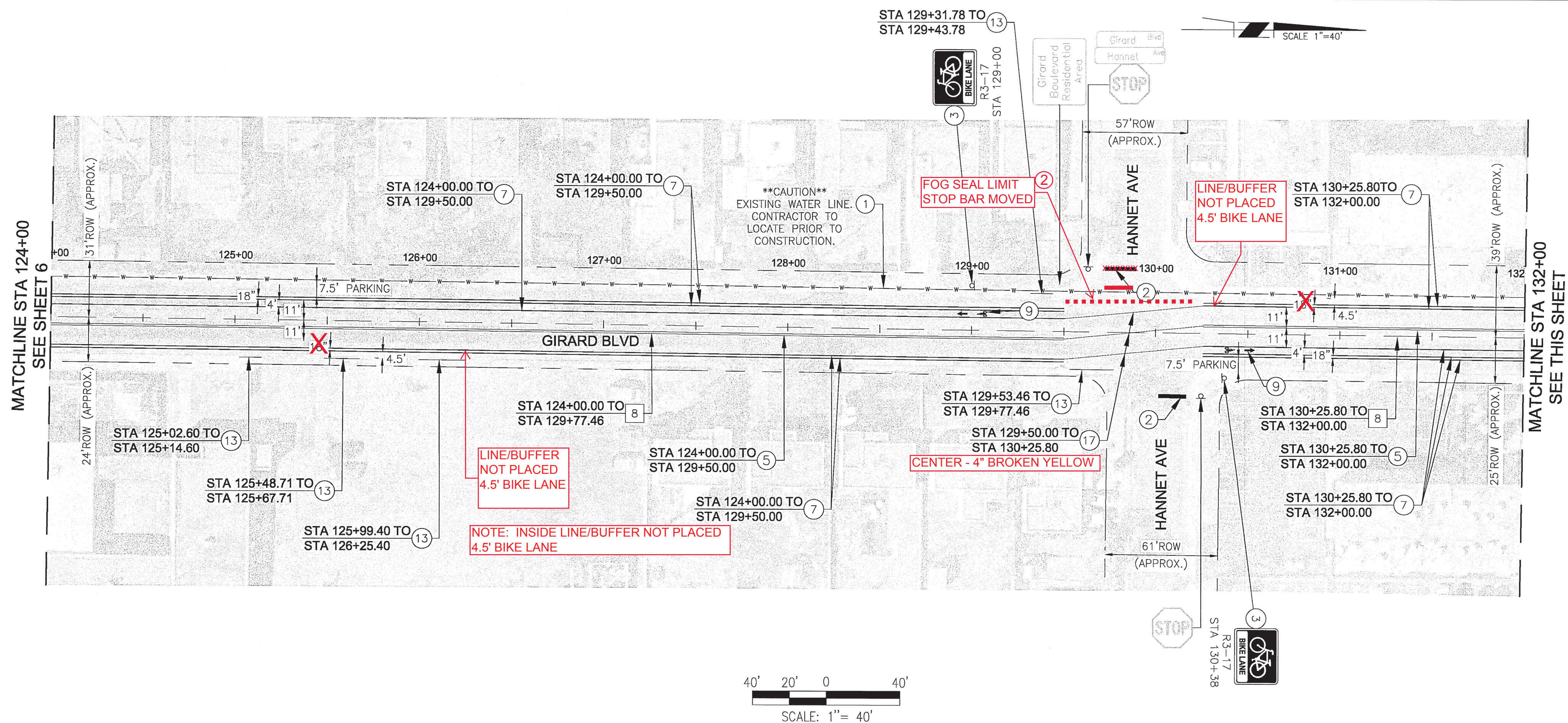

	REMOVALS						
1	REMOVE STRIPE	EXISTING	4"	SOLID	WHITE	288 LF	
2	REMOVE EXISTING BROKEN WHITE STRIPE					193 LF	
3	REMOVE EXISTING SYMBOL OR WORD					1 EA	
4	REMOVE EXISTING STRIPE	24"	SOLID	WHITE		432 LF	
8	REMOVE EXISTING SOLID STRIPE	DOUBLE	YELLOW			1,388 LF	

GENERAL CONSTRUCTION NOTES

1	PROTECT IN PLACE	
2	INSTALL 24" STOP BAR	86 LF
3	INSTALL NEW SIGN W/ NEW SIGN POST PER DETAIL ON SHEET 9	
4	INSTALL A NEW "SUPER" SHARROW MARKING PER DETAIL ON SHEET 9	3 EA
5	INSTALL 4" DOUBLE YELLOW SOLID STRIPE	1,361 LF
6	INSTALL 4" BROKEN WHITE STRIPE (10' STRIPE, 30' SKIP)	384 LF
7	INSTALL 6" SOLID WHITE STRIPE	5,597 LF
8	INSTALL 24" WHITE SOLID MARKINGS (CROSSWALK) PER DETAIL ON SHEET 9	230 LF
9	INSTALL BIKE SYMBOL (WITH ARROW) PER DETAIL ON SHEET 9	3 EA
13	REFRESH YELLOW CURB PAINT	249 LF
17	INSTALL 6" DOTTED WHITE STRIPE (2' STRIPE, 2' SKIP)	279 LF

GENERAL NOTES
1. ALL RIGHT OF WAY DIMENSIONS ARE APPROXIMATE.

SIGNING LEGEND:

SPEED LIMIT 30
NEW/REMOVE & RELOCATED SIGN 7 EA

SPEED LIMIT 30
REMOVE & SALVAGE

SPEED LIMIT 30
PROTECT IN PLACE

TOTAL NEW SIGN: 21 SF
TOTAL NEW SIGN POST: 56 LF

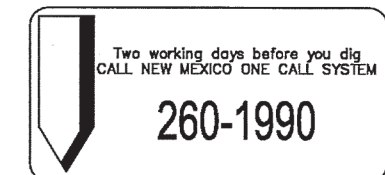

TY LIN INTERNATIONAL
engineers | planners | scientists

500 4th Street NW Suite 403
Bank of America Centre
Albuquerque, NM 87102

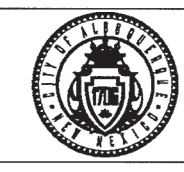

CITY OF ALBUQUERQUE
MUNICIPAL DEVELOPMENT DEPARTMENT
ENGINEERING DIVISION

TITLE: **GIRARD COMPLETE STREET PLAN**
SIGNING & STRIPING PLAN
STA 124+00 TO 140+50

Design Review Committee
APPROVED
JUN 14 2016
DESIGN REVIEW COMMITTEE

City Engineer Approval
APPROVED
JUN 14 2016
CITY ENGINEER

City Project No. 9042.04 Zone Map No. J16, H16 Sheet 7 Of 9

RECORD DRAWING

RECORD DRAWING



RECORD DRAWING

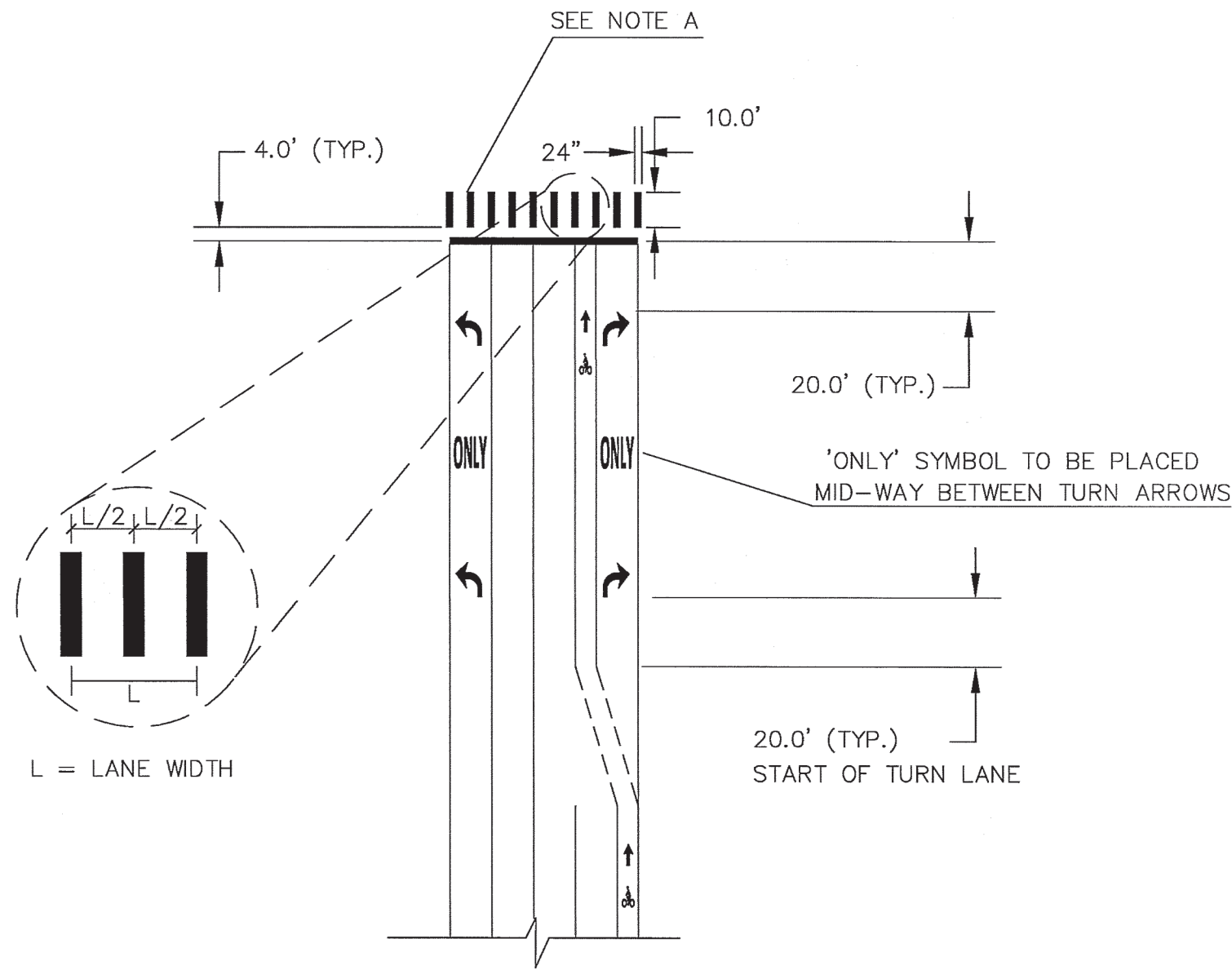

PAVEMENT MARKING DETAILS - CROSSWALK AND APPROACH

NOTE A. 24" X 10' LONGITUDINAL CROSSWALK MARKINGS SHALL BE INSTALLED CENTERED AT EACH DRIVING LANE AS SHOWN ABOVE TO AVOID THE WHEEL PATHS. LAYOUT AT EACH INTERSECTION SHALL REQUIRE APPROVAL BY THE CITY PROJECT MANAGER PRIOR TO INSTALLATION.

SIGNING AND PAVEMENT MARKING NOTES:

1. ALL SIGNS AND PAVEMENT MARKINGS SHALL BE IN COMPLIANCE WITH THE LATEST VERSION OF THE MANUAL ON UNIFORM TRAFFIC CONTROL DEVICES (MUTCD), CITY OF ALBUQUERQUE STANDARD SPECIFICATIONS, AND THESE PLANS.
2. ALL SIGNS SHALL BE PER COA STD SPEC 450 AND MADE OF TYPE IV PRISMATIC SHEETING WITH SHEETING TYPE ASTM D4956-04 AS PER THE MANUAL ON UNIFORM TRAFFIC CONTROL DEVICES (MUTCD), LATEST EDITION.
3. AT ALL INTERSECTIONS, SIGNALIZED AND NON-SIGNALIZED, STRIPING SHALL BE REFRESHED 100' BEYOND THE PROPOSED GIRARD BOULEVARD INTERSECTION STRIPING. ON STREETS WHERE THE EXISTING STRIPING IS LESS THAN 100', THE STRIPING SHALL BE REFRESHED TO THE EXISTING LENGTH.
4. CONTRACTOR SHALL MAKE EVERY EFFORT TO REMOVE GRAFFITI FROM ANY EXISTING OR RELOCATED SIGNS WITHIN THE PROJECT CORRIDOR. GRAFFITI REMOVAL SHALL BE INCIDENTAL TO THE COMPLETION OF THE PROJECT.
5. ALL PAVEMENT MARKING INSTALLATION SHALL BE THERMOPLASTIC UNLESS OTHERWISE NOTED WITHIN THE PLAN SET. ALL PAVEMENT MARKINGS SHALL BE PER COA STD SPEC 440, 441, AND 442.
6. PAVEMENT MARKING REMOVAL SHALL BE PERFORMED PER COA STD SPEC 443. METHOD SHALL BE AT THE DISCRETION OF THE CONTRACTOR BUT REQUIRE CITY APPROVAL PRIOR TO COMMENCING WORK.
7. ALL SIGN POST INSTALLATION PER NMDOT STANDARD DRAWING 701-02-1/3, SEE DETAIL THIS SHEET.
8. RELOCATIONS OF EXISTING SIGNS SHALL BE INCIDENTAL TO THE PROJECT AND NO ADDITIONAL PAYMENT SHALL BE MADE.

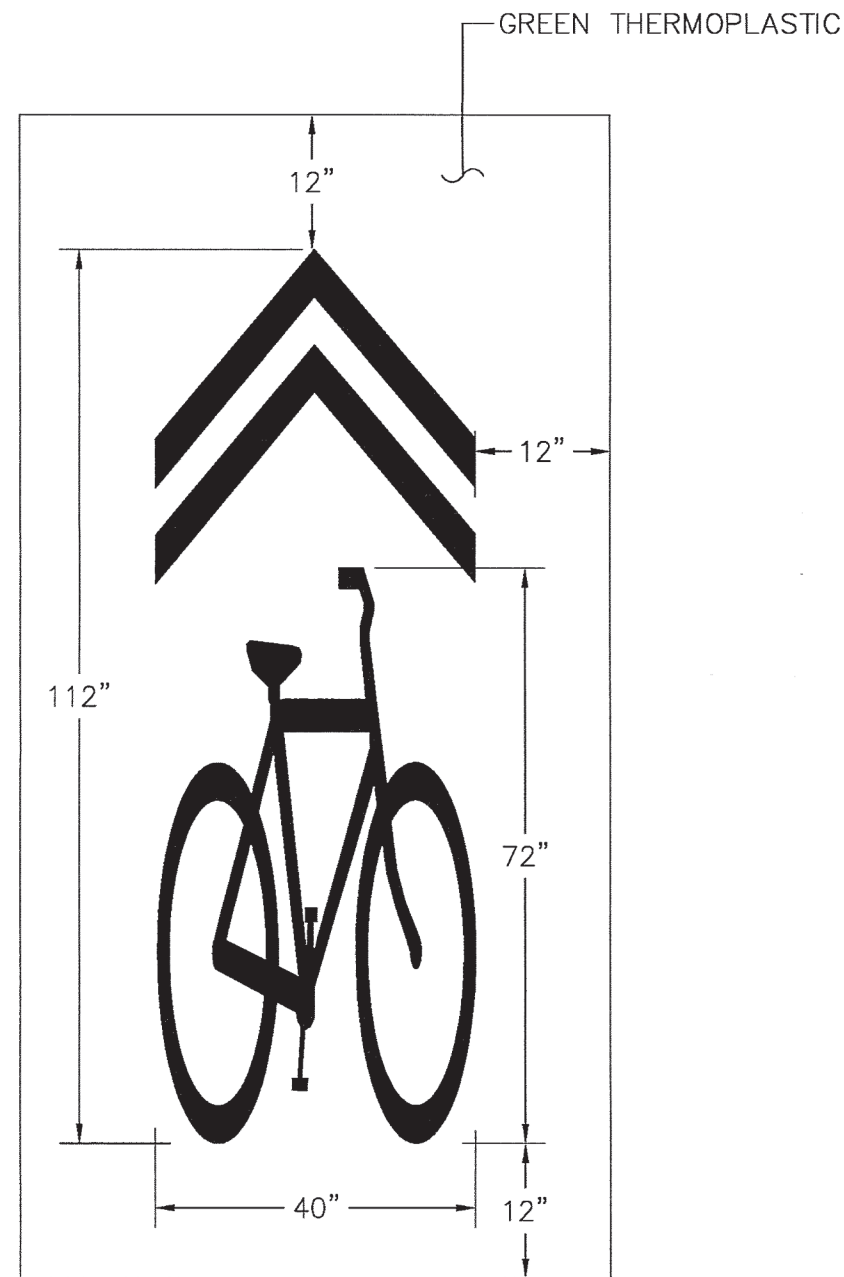

"SUPER" SHARROW MARKING DETAIL

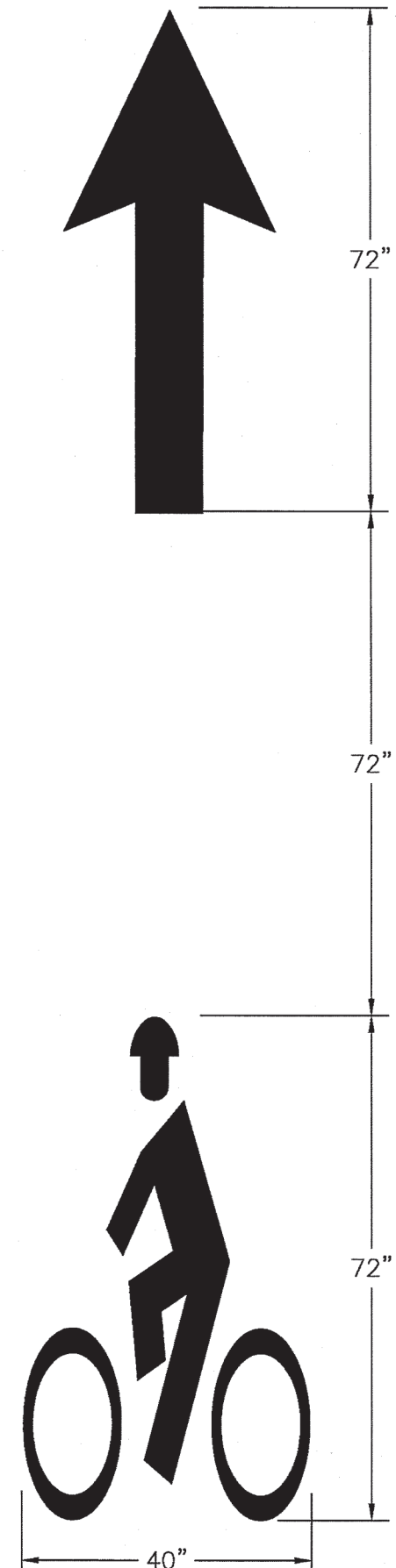

BIKE W/ ARROW MARKING DETAIL

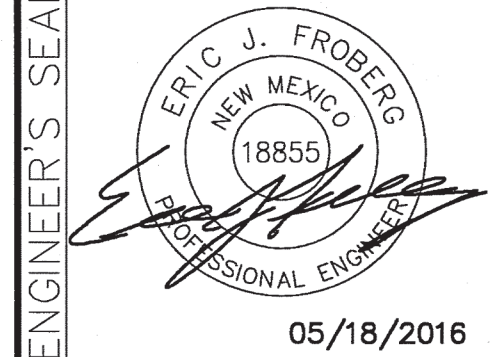
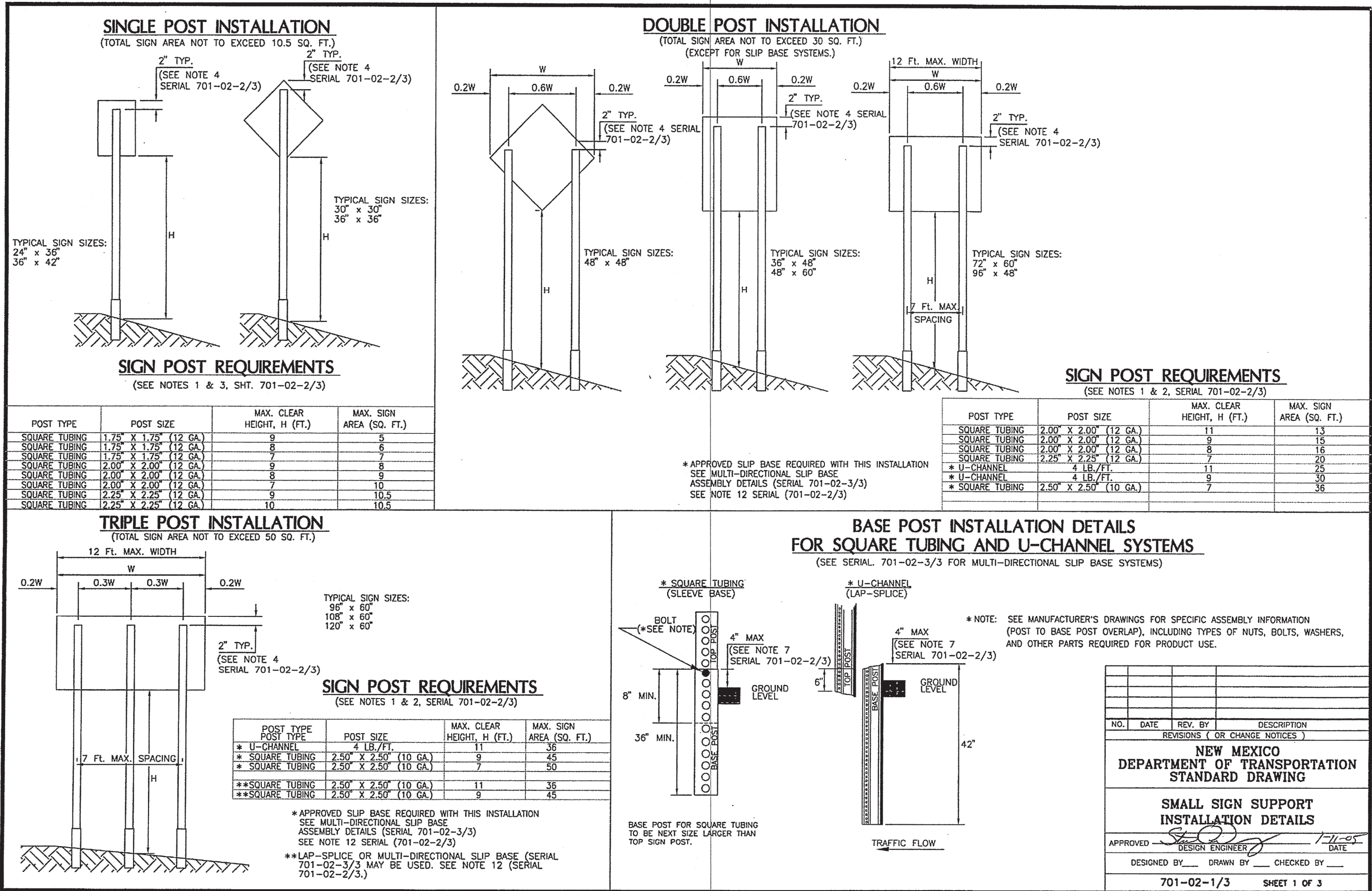

05/18/2016

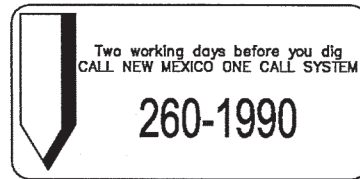

TY LIN INTERNATIONAL

engineers | planners | scientists

500 4th Street NW Suite 403
Bank of America Centre
Albuquerque, NM 87102



CITY OF ALBUQUERQUE
MUNICIPAL DEVELOPMENT DEPARTMENT
ENGINEERING DIVISION

TITLE: **GIRARD COMPLETE STREET PLAN**
SIGNING & STRIPING
DETAILS

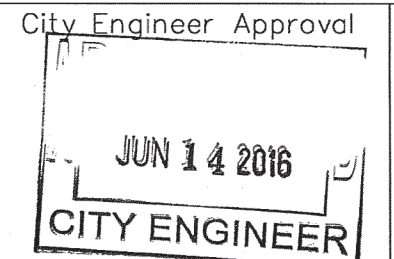
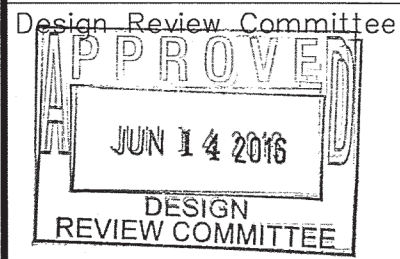

City Project No. 9042.04

Zone Map No. J16, H16

Sheet 9

Of 9

RECORD DRAWING

RECORD DRAWING