

5/15/2016 5:49:51 PM Phoenix Half Scale.ctb Brandice Long P:\CoA On-call\Task 3, 4, & 5 Girard Blvd\CADD\DLV\Girard Task 4\ C01 Cover.dwg

CITY OF ALBUQUERQUE NEW MEXICO
DEPARTMENT OF MUNICIPAL DEVELOPMENT CONSTRUCTION PLANS
FOR

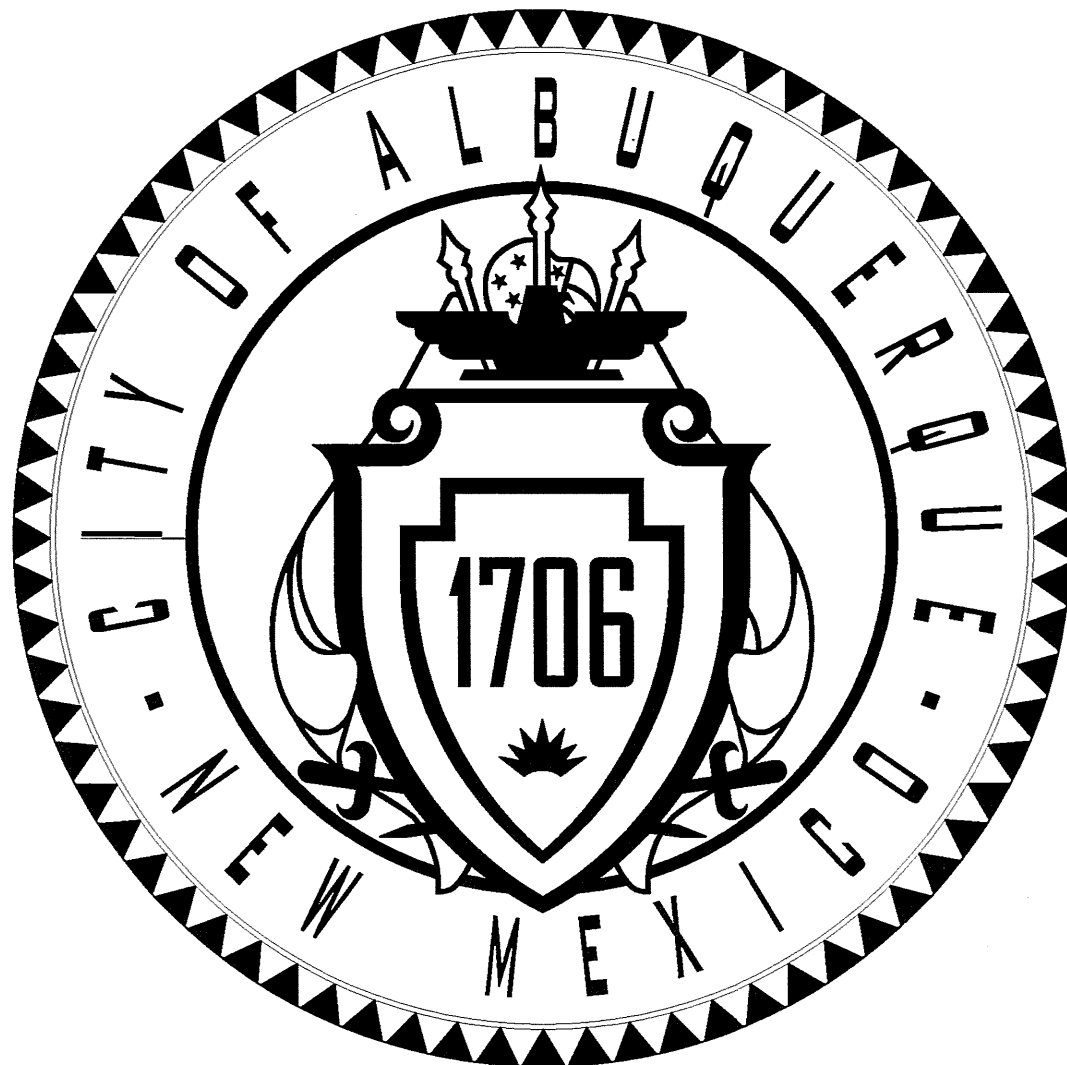

GIRARD BLVD COMPLETE STREET PLAN
PHASE III - LOMAS BLVD TO INDIAN SCHOOL RD
COA PROJECT NO. 9042.04

PROJECT AREA

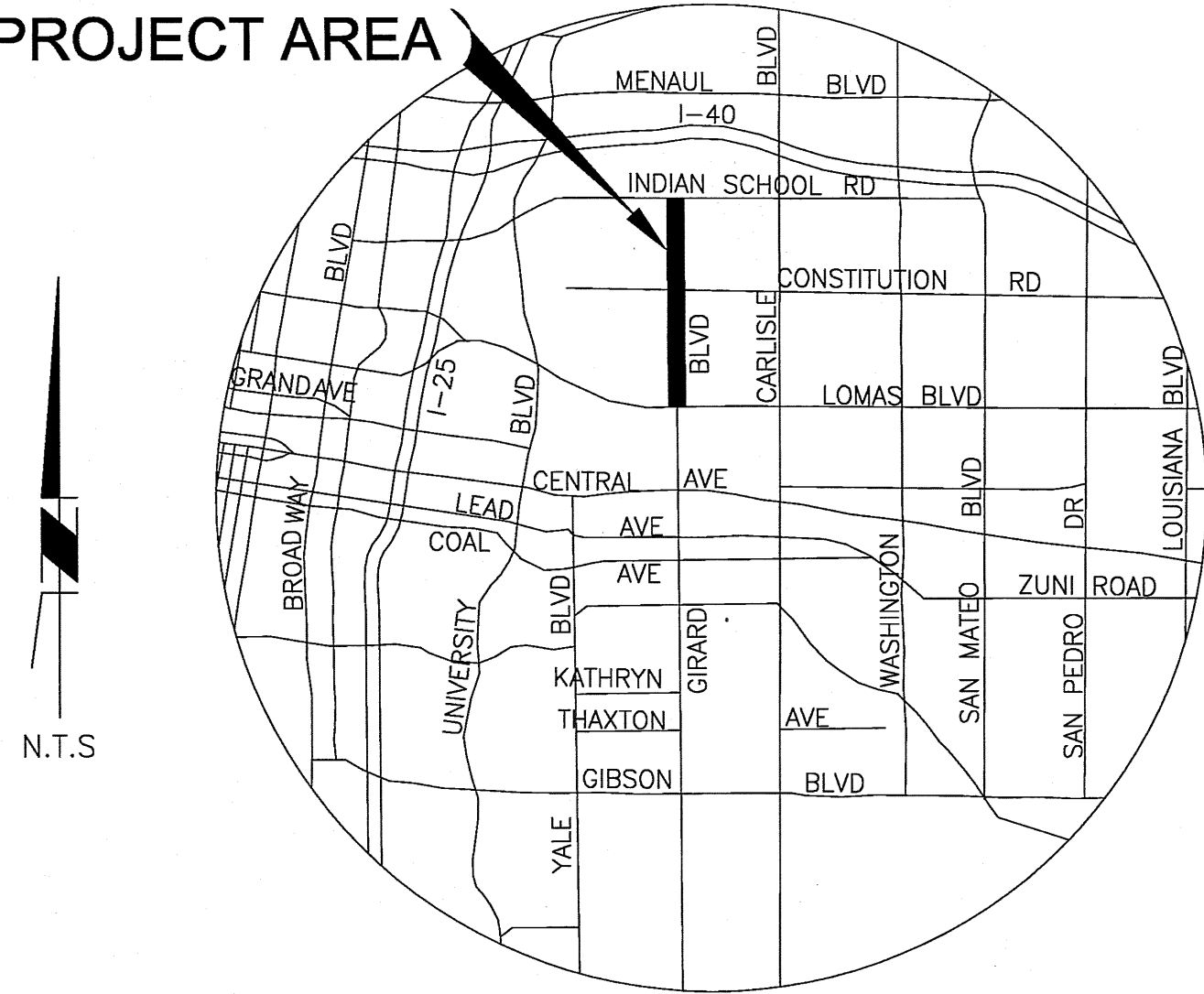

VICINITY MAP
N.T.S.
ZONE ATLAS - J16, H16

Two working days before you dig
CALL NEW MEXICO ONE CALL SYSTEM
260-1990

TY LIN INTERNATIONAL
engineers | planners | scientists
500 4th Street NW Suite 403
Bank of America Centre
Albuquerque, NM 87102

- SHEET INDEX:
- 1 COVER SHEET & KEY MAP
 - 2 GENERAL NOTES & QUANTITIES
 - 3 TYPICAL SECTIONS
 - 4-8 SIGNING & STRIPING PLANS
 - 9 DETAILS

KEY MAP
SCALE: 1"=200'

REV.	DATE	CITY ENGINEER	DATE	USER DEPARTMENT	DATE
ENGINEERS STAMP & SIGNATURE		APPROVALS	ENGINEER	DATE	*****
		DCR Chairman	<i>Eric J. Froberg</i>	6/19/16	APPROVED FOR CONSTRUCTION
		Transportation	<i>Eric J. Froberg</i>	6/13/16	
		Water/Wastewater	<i>Eric J. Froberg</i>	6/13/16	
		Hydrology	<i>Eric J. Froberg</i>	6/13/16	
		Parks	<i>Eric J. Froberg</i>	6/13/16	
City Project No.		9042.04	Sheet 1 of 9		6/14/16

GENERAL NOTES:

1. THE CONTRACTOR SHALL ABIDE BY ALL LOCAL, STATE, AND FEDERAL LAWS, RULES AND REGULATIONS WHICH APPLY TO THE CONSTRUCTION OF THESE IMPROVEMENTS.
2. ALL WORK DETAILED ON THESE PLANS TO BE PERFORMED, EXCEPT AS OTHERWISE STATED OR PROVIDED HEREON, SHALL BE CONSTRUCTED IN ACCORDANCE WITH CITY OF ALBUQUERQUE STANDARD SPECIFICATIONS FOR PUBLIC WORKS CONSTRUCTION, 1986 EDITION, THROUGH UPDATE #9, AND WILL BE REFERRED TO HEREIN AS "STANDARD SPECIFICATIONS".
3. ALL CONSTRUCTION WITHIN CITY RIGHT-OF-WAY OR EASEMENTS MUST BE DONE FROM APPROVED WORK ORDER DOCUMENTS FROM THE CITY.
4. THE CONTRACTOR AGREES THAT HE SHALL ASSUME THE SOLE AND compl.ETE RESPONSIBILITY FOR THE JOB SITE CONDITIONS DURING THE COURSE OF CONSTRUCTION OF THIS PROJECT, INCLUDING SAFETY OF ALL PERSONS AND PROPERTY. THIS REQUIREMENT SHALL APPLY CONTINUOUSLY AND NOT BE LIMITED TO NORMAL WORKING HOURS. THE CONTRACTOR SHALL DEFEND, INDEMNIFY, AND HOLD HARMLESS THE OWNER AND ENGINEER FROM ANY AND ALL LIABILITY, REAL OR ALLEGED, IN CONNECTION WITH THE PERFORMANCE OF WORK ON THIS PROJECT, EXCEPT LIABILITY ARISING FROM THE SOLE NEGLIGENCE OF THE OWNER OR ENGINEER
5. THE CONTRACTOR SHALL OBTAIN ALL NECESSARY PERMITS PRIOR TO CONSTRUCTION.
6. THE CONTRACTOR SHALL NOTIFY THE CITY SURVEYOR NOT LESS THAN SEVEN (7) DAYS PRIOR TO STARTING WORK IN ORDER THAT THE CITY SURVEYOR MAY TAKE NECESSARY MEASURES TO ENSURE THE PRESERVATION OF SURVEY MONUMENTS. THE CONTRACTOR SHALL NOT DISTURB PERMANENT SURVEY MONUMENTS WITHOUT THE CONSENT OF THE CITY SURVEYOR AND SHALL NOTIFY THE CITY SURVEYOR AND BEAR THE EXPENSE OF REPLACING ANY THAT MAY BE DISTURBED WITHOUT PERMISSION. ONLY THE CITY SURVEYOR SHALL REPLACE SURVEY MONUMENTS. WHEN A CHANGE IS MADE IN THE FINISHED ELEVATIONS OF THE PAVEMENT OF ANY ROADWAY IN WHICH A PERMANENT SURVEY MONUMENT IS LOCATED, THE CONTRACTOR SHALL, AT HIS OWN EXPENSE, ADJUST THE MONUMENT COVER TO THE NEW GRADE UNLESS OTHERWISE SPECIFIED.
7. ALL STREET STRIPING, ALTERED OR DESTROYED, SHALL BE REPLACED WITH THERMOPLASTIC REFLECTORIZED PAVEMENT MARKINGS BY THE CONTRACTOR TO SAME LOCATION AS EXISTING, OR AS INDICATED BY THIS PLAN SET.
8. SEVEN (7) WORKING DAYS PRIOR TO BEGINNING CONSTRUCTION, THE CONTRACTOR SHALL SUBMIT TO DMD, CONSTRUCTION SERVICES DIVISION, A DETAILED CONSTRUCTION SCHEDULE. THE CONTRACTOR SHALL OBTAIN EXCAVATION AND BARRICADE PERMIT TWO (2) DAYS PRIOR TO CONSTRUCTION. CONTRACTOR SHALL ALSO PROVIDE THE DETAILED CONSTRUCTION SCHEDULE TO THE CITY. THIS SHALL BE INCIDENTAL TO THE PROJECT.
9. THE ENGINEER HAS UNDERTAKEN NO FIELD VERIFICATION OF THE LOCATION, DEPTH, SIZE, OR TYPE OF EXISTING UNDERGROUND UTILITY LINES, MAKES NO REPRESENTATION PERTAINING THERETO, AND ASSUMES NO RESPONSIBILITY OR LIABILITY THEREFOR. THE CONTRACTOR SHALL INFORM ITSELF OF THE LOCATION OF ANY UTILITY LINE IN OR NEAR THE AREA OF THE WORK IN ADVANCE OF AND DURING EXCAVATION WORK. THIS WORK SHALL BE CONSIDERED INCIDENTAL TO THE PROJECT. THE CONTRACTOR IS FULLY RESPONSIBLE FOR ANY AND ALL DAMAGE CAUSED BY ITS FAILURE TO LOCATE, IDENTIFY, AND PRESERVE ANY AND ALL EXISTING UTILITIES.
10. THE CONTRACTOR SHALL PROMPTLY CLEAN UP ANY MATERIAL EXCAVATED WITHIN THE PUBLIC RIGHT-OF-WAY OR PRIVATE ROADWAY EASEMENTS SO THAT THE EXCAVATED MATERIAL IS NOT SUSCEPTIBLE TO BEING WASHED DOWN THE STREET OR INTO ANY PUBLIC DRAINAGE FACILITY.
11. CONTRACTOR SHALL BE RESPONSIBLE TO PROVIDE AND MAINTAIN ALL CONSTRUCTION SIGNING UNTIL THE PROJECT HAS BEEN ACCEPTED BY THE CITY OF ALBUQUERQUE.
12. A FOG SEAL COAT SHALL BE APPLIED TO ALL NEW AND EXISTING PAVEMENTS PRIOR TO FINAL STRIPING OF THE PROJECT. LIMITS OF THE COAT SHALL BE THROUGHOUT THE ENTIRE PROJECT AND PER BID ITEM 18.
13. CONSTRUCTION ACTIVITY SHALL BE LIMITED TO THE CITY RIGHT-OF-WAY AND/OR PROJECT LIMITS. ANY DAMAGE TO ADJACENT PROPERTIES RESULTING FROM THE CONSTRUCTION PROCESS IS THE RESPONSIBILITY OF THE CONTRACTOR. ANY COSTS INCURRED FOR REPAIRS SHALL BE THE COST OF THE CONTRACTOR.
14. OVERNIGHT PARKING OF CONSTRUCTION EQUIPMENT SHALL NOT OBSTRUCT DRIVEWAYS OR DESIGNATED TRAFFIC LANES. THE CONTRACTOR SHALL NOT STORE ANY EQUIPMENT OR MATERIAL WITHIN THE PUBLIC RIGHT-OF-WAY.
15. THE CONTRACTOR SHALL BE RESPONSIBLE TO REPLACE AT HIS EXPENSE ANY AND ALL PROPERTY CORNERS DESTROYED DURING CONSTRUCTION. ALL PROPERTY CORNERS MUST BE RESET BY A REGISTERED LAND SURVEYOR.
16. ALL BARRICADES AND CONSTRUCTION SIGNING SHALL CONFORM TO APPLICABLE SECTIONS OF THE M.U.T.C.D., U.S. DEPARTMENT OF TRANSPORTATION, LATEST EDITION 2009, REV 2.
17. THE CONTRACTOR SHALL MAINTAIN ALL CONSTRUCTION BARRICADES AND SIGNING AT ALL TIMES. THE CONTRACTOR SHALL VERIFY THE PROPER LOCATION OF ALL BARRICADING AT THE END AND BEGINNING OF EACH DAY.
18. THE CONTRACTOR SHALL ASSUME RESPONSIBILITY FOR ANY DAMAGE TO EXISTING PAVEMENTS, PAVEMENT MARKINGS, SIGNAGE, CURB & GUTTER, DRIVEPADS, CURB RAMPS, CHANNELS, LANDSCAPING INCLUDING IRRIGATION, AND SIDEWALK DURING CONSTRUCTION, APART FROM THOSE SECTIONS INDICATED FOR REMOVAL ON THE PLANS AND SHALL REPAIR OR REPLACE PER COA/AMAFCA STANDARDS, AT HIS OWN EXPENSE.
19. CONTRACTOR SHALL TRANSPORT ALL REMOVED AND SALVAGED SIGNS TO PINO YARDS OR LOCATION DIRECTED BY THE CITY'S PROJECT MANAGER AT NO ADDITIONAL COST.
20. CONTRACTOR SHALL MAINTAIN A GRAFFITI FREE WORKZONE UNTIL FINAL COMPLETION. CONTRACTOR SHALL MAKE EVERY EFFORT TO REMOVE GRAFFITI FROM ANY EXISTING OR PROPOSED SURFACE WITHIN THE PROJECT CORRIDOR. GRAFFITI REMOVAL SHALL BE INCIDENTAL TO THE COMPLETION OF THE PROJECT.

21. TYPICAL DIMENSIONS SHOWN ON PLANS ARE TO FACE OF CURB.
22. TWO WEEKS PRIOR TO CONSTRUCTION, THE CONTRACTOR SHOULD NOTIFY THE TRANSIT DEPARTMENT OF ANY IMPACT THE PROPOSED PROJECT WILL HAVE ON THE TRANSIT SYSTEM SUCH AS CAUSING A DETOUR, OR CAUSE THE CLOSING OR RELOCATION OF A BUS STOP. THE CONTACT PERSON IS SHABIH RIZVI, OFFICE PHONE 505-724-3134, CELL PHONE 505-331-0253, AND E-MAIL srizvi@cabq.gov AND/OR DOUGLAS GOFF, OFFICE PHONE 505-724-3137, CELL PHONE 505-206-0151, AND E-MAIL dgoff@cabq.gov
23. CONTRACTOR SHALL HAND DIG ALL SIGN POST LOCATIONS DUE TO POSSIBLE CONFLICT WITH EXISTING 14" WATERLINE ALONG THE EAST SIDEWALK AND 6" PVC ALONG THE WEST SIDEWALK. THE 14" WATERLINE IS A MINIMUM 36" DEPTH BURY, WHICH COINCIDES WITH THE MINIMUM 36" DEPTH BASE POST BURY. THIS SHALL BE INCIDENTAL TO THE PROJECT AND NO ADDITIONAL PAYMENT WILL BE MADE THEREFORE.
24. CONTRACTOR SHALL ENSURE THAT NEW CROSSWALK STRIPING LINES UP WITH EXISTING CURB RAMPS.

BID ITEM	ITEM ID No.	ITEM DESCRIPTION	UNIT	TOTAL	4	5	6	7	8
1	440.003	ReflectORIZED Painted Markings, Yellow or Red Curb, 8" Width, cip.	LF	715	22	187	192	179	135
2	441.001	ReflectORIZED Plastic Pavement Markings 4" Yellow Solid Double Stripe, cip.	LF	6,397	1,069	2,229	1,424	1,473	202
3	441.001	ReflectORIZED Plastic Pavement Markings 4" White Broken Stripe (10' Stripe, 30' Skip), cip.	LF	273	100		83	90	
4	441.002	ReflectORIZED Plastic Pavement Markings 6" White Solid Stripe, cip.	LF	11,060	2,653	2,533	3,053	2,621	200
5	441.002	ReflectORIZED Plastic Pavement Markings 6" White Dotted Stripe (2' Stripe, 2' Skip), cip.	LF	262		141	86	35	
6	441.004	ReflectORIZED Plastic Pavement Markings 12" White width, cip.	LF	469	81	167	104	27	90
7	441.005	ReflectORIZED Plastic Pavement Markings 24" White width, cip.	LF	673		70	260	253	90
8	441.031	ReflectORIZED Plastic Pavement Markings, Bike w/Arrow, cip.	EA	4			1	1	2
9	441.03x	ReflectORIZED Plastic Pavement Markings "Super" Sharrow, cip.	EA	51	13	13	13	12	
10	441.040	ReflectORIZED Plastic Pavement Markings Arrow, Left, cip	EA	2					2
11	441.040	ReflectORIZED Plastic Pavement Markings Arrow, Thru & Right, cip.	EA	2					2
12	441.040	ReflectORIZED Plastic Pavement Markings Word, Only, cip.	EA	1					1
13	443.101	Removal of Pavement Stripe, Any Width, Painted or Plastic, compl.	LF	8,346	1,331	2,312	2,071	2,105	527
14	444.102	Removal of Pavement Markings: Arrow, Symbol, or Word, Painted or Plastic, Compl.	EA	7			1	1	5
15	450.001	Aluminum Panel Sign, cip.	SF	302	71	72	68	73	18
16	450.01	Square Tube Steel Posts & Base Posts For Aluminum Panel Sign, cip.	LF	587	139	148	124	145	31
17	450.101	Sign, Post, & Base Post, Remove & Salvage, compl.	EA	15		1	1	13	
18	336.x	Fog Seal	SY	26,015					

SIGNALIZED INTERSECTIONS WITHIN THE PROJECT LIMITS:	
1	GIRARD BOULEVARD & COAL AVENUE
2	GIRARD BOULEVARD & LEAD AVENUE
3	GIRARD BOULEVARD & CENTRAL AVENUE

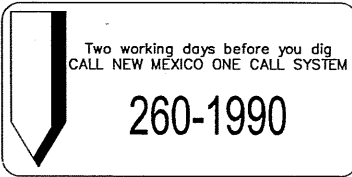

TY. LIN INTERNATIONAL
engineers | planners | scientists

500 4th Street NW Suite 403
Bank of America Centre
Albuquerque, NM 87102



CITY OF ALBUQUERQUE
MUNICIPAL DEVELOPMENT DEPARTMENT
ENGINEERING DIVISION

TITLE: **GIRARD COMPLETE STREET PLAN**
GENERAL NOTES & QUANTITIES

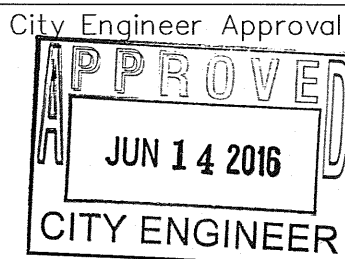

Last Design Update

Mo./Day/Yr.	Mo./Day/Yr.

City Project No.

9042.03

Zone Map No.

L16, K16

Sheet

Of 9

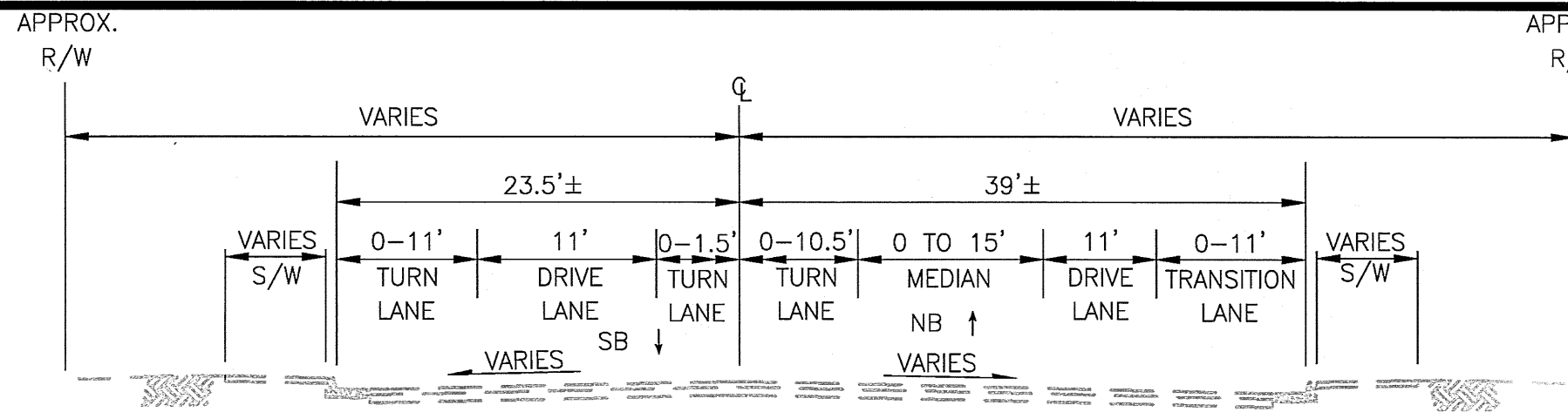

GIRARD BLVD
LOOKING NORTH
STA 91+04.00 TO 94+38.54
(EXISTING)

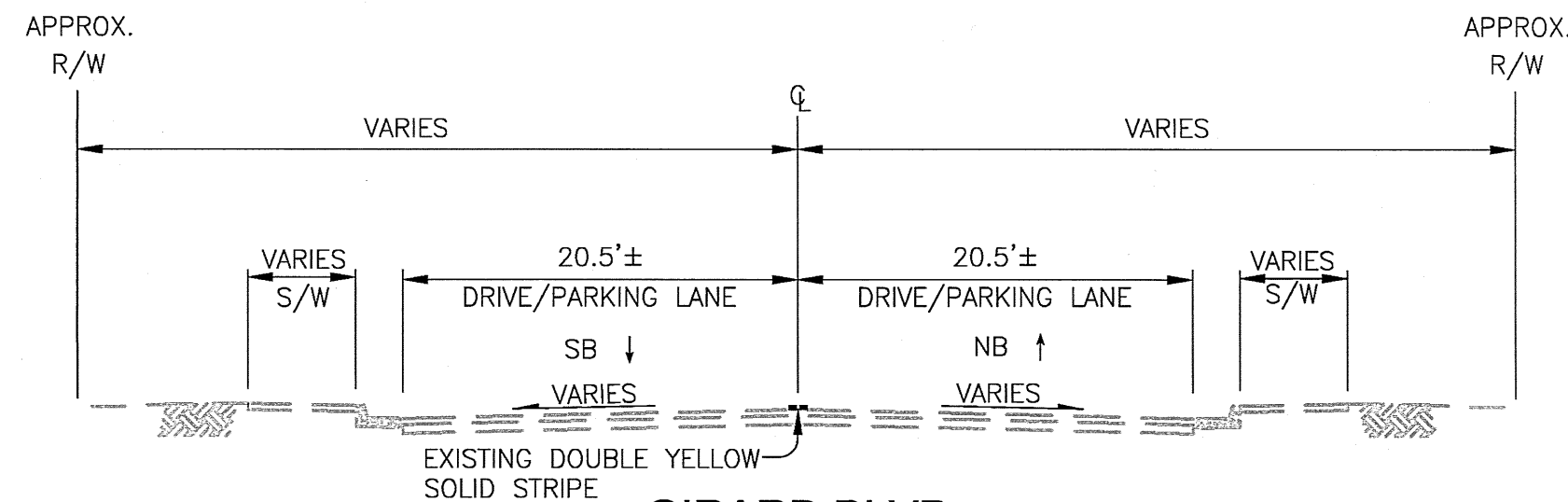

GIRARD BLVD
LOOKING NORTH
STA 95+40.94 TO 98+49.86
STA 99+04.07 TO 103+31.56
STA 103+89.08 TO 109+89.32
STA 110+46.69 TO 116+48.57
STA 117+16.41 TO 120+79.71
STA 121+51.84 TO 123+13.62
STA 123+70.30 TO 129+77.46
(EXISTING)

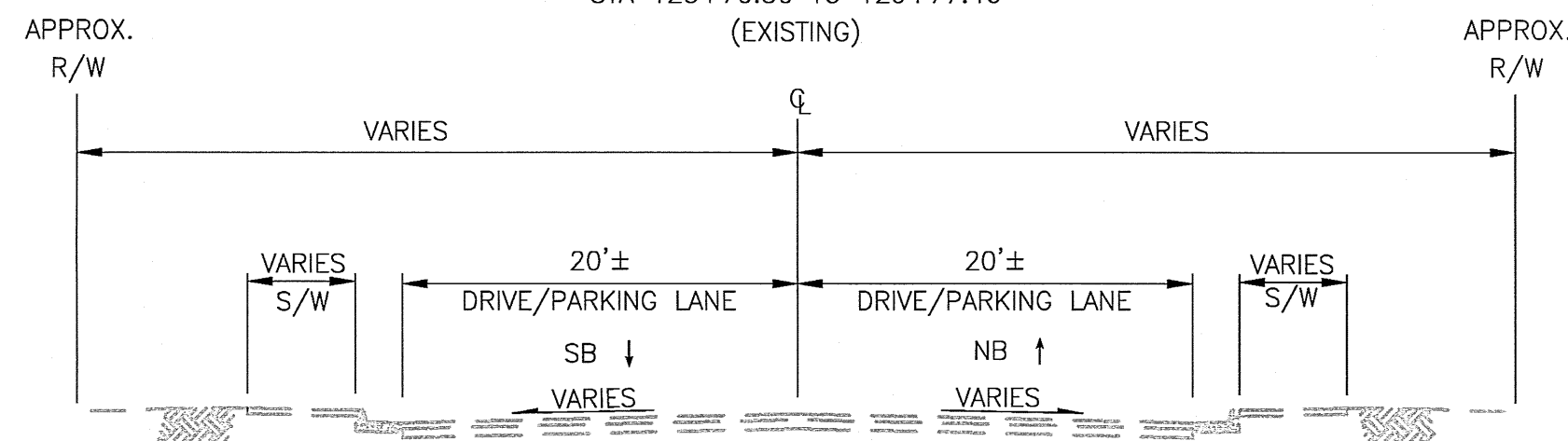

GIRARD BLVD
LOOKING NORTH
STA 137+72.98 TO 139+36.71
STA 140+14.41 TO 142+14.69
(EXISTING)

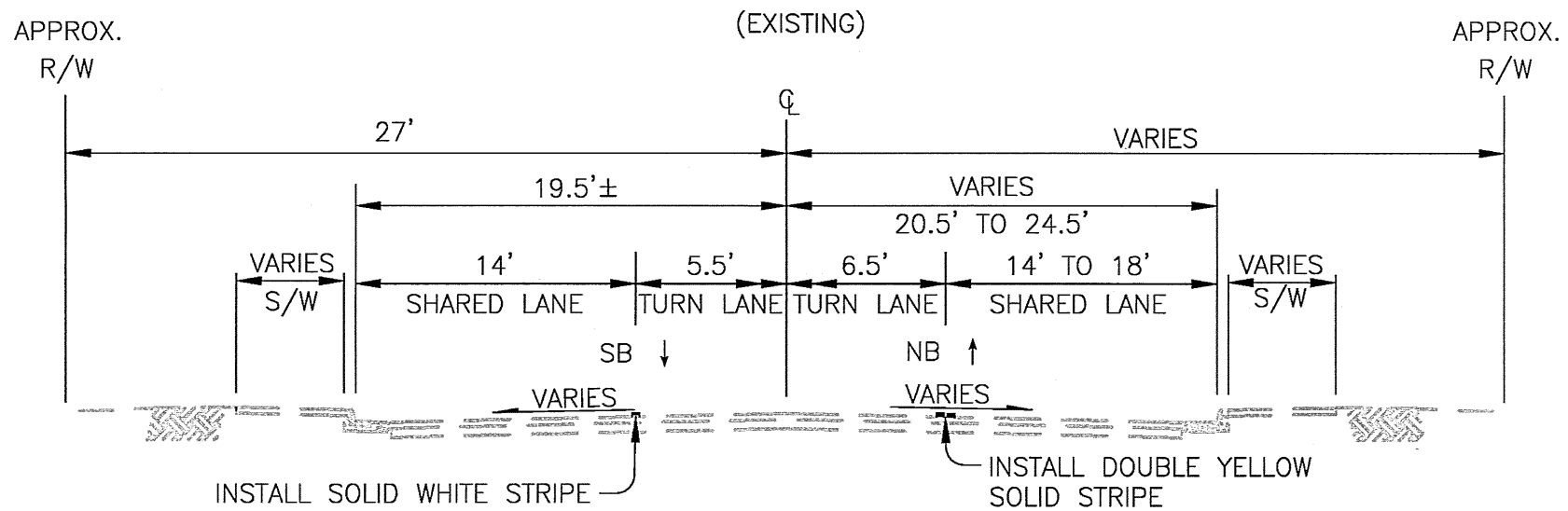

GIRARD BLVD
LOOKING NORTH
STA 94+38.54 TO 96+08.95
(PROPOSED)

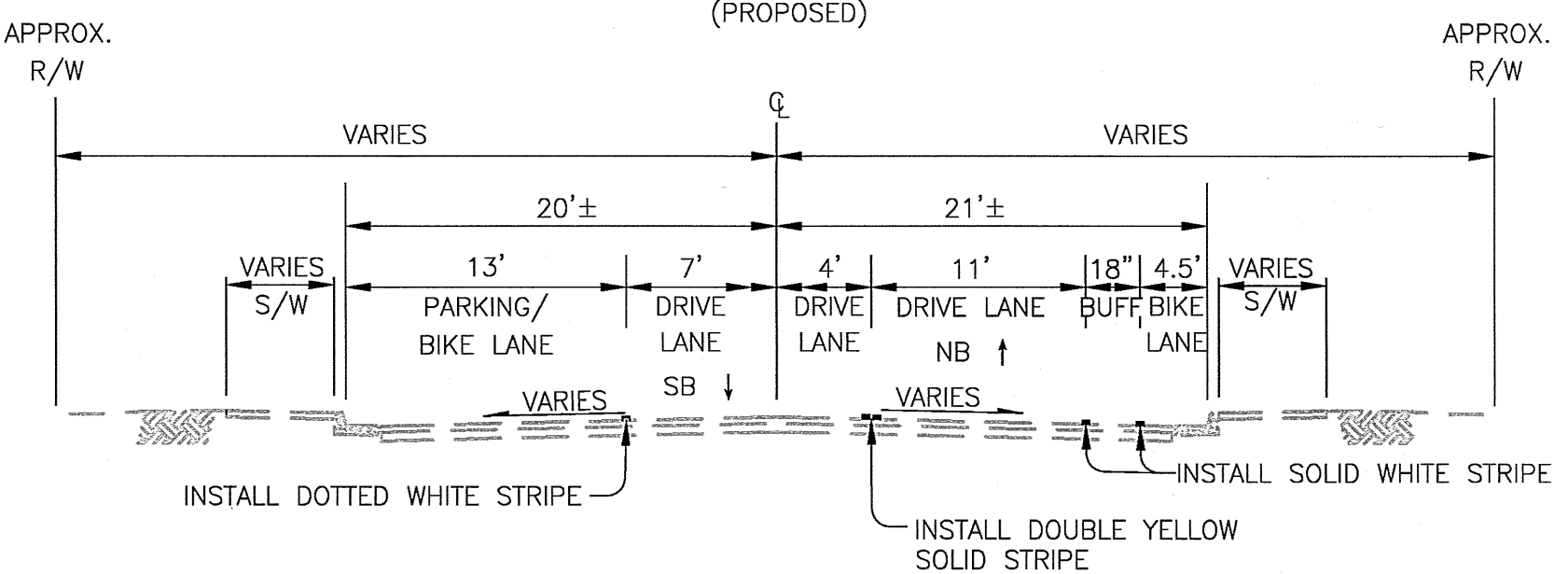

GIRARD BLVD
LOOKING NORTH
STA 96+57.52 TO 97+07.52
STA 99+04.07 TO 99+54.07
STA 103+89.08 TO 104+39.08
STA 110+46.69 TO 110+96.69
STA 117+16.41 TO 117+66.61
STA 121+51.84 TO 122+43.49
(PROPOSED)

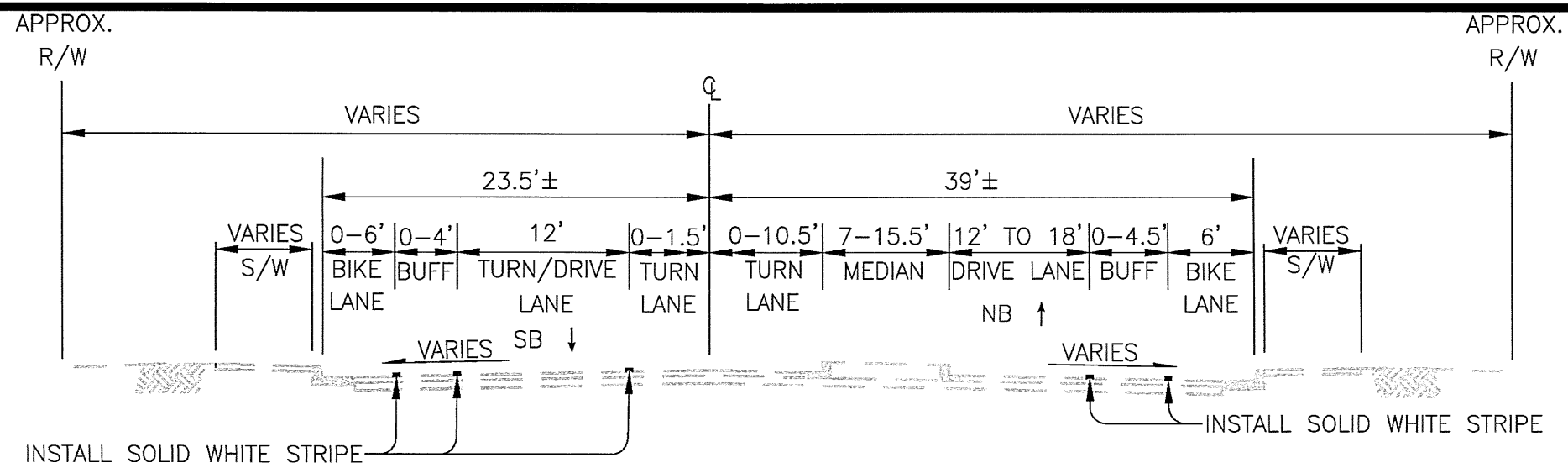

GIRARD BLVD
LOOKING NORTH
STA 91+04.00 TO 94+12.86
(PROPOSED)

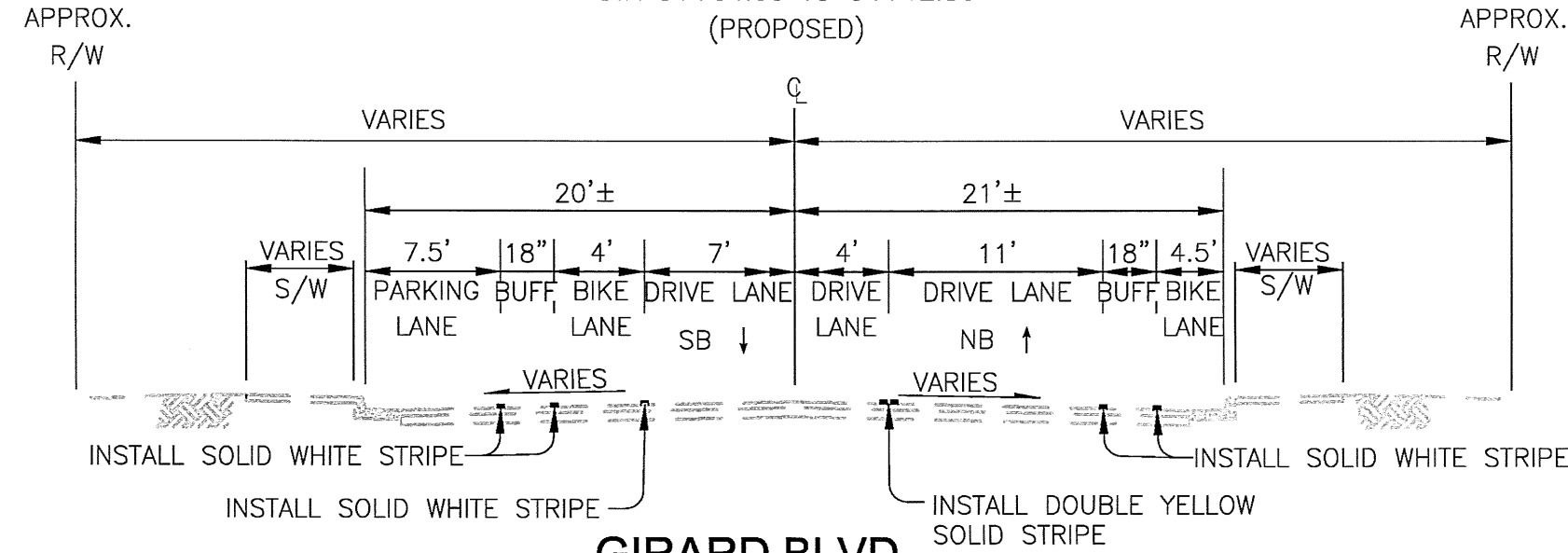

GIRARD BLVD
LOOKING NORTH
STA 97+07.52 TO 98+49.86
STA 99+54.07 TO 103+31.56
STA 104+39.08 TO 109+89.32
STA 110+96.69 TO 116+48.57
STA 117+66.61 TO 120+79.71
STA 122+43.49 TO 123+12.62
STA 123+70.30 TO 129+50.00
(PROPOSED)

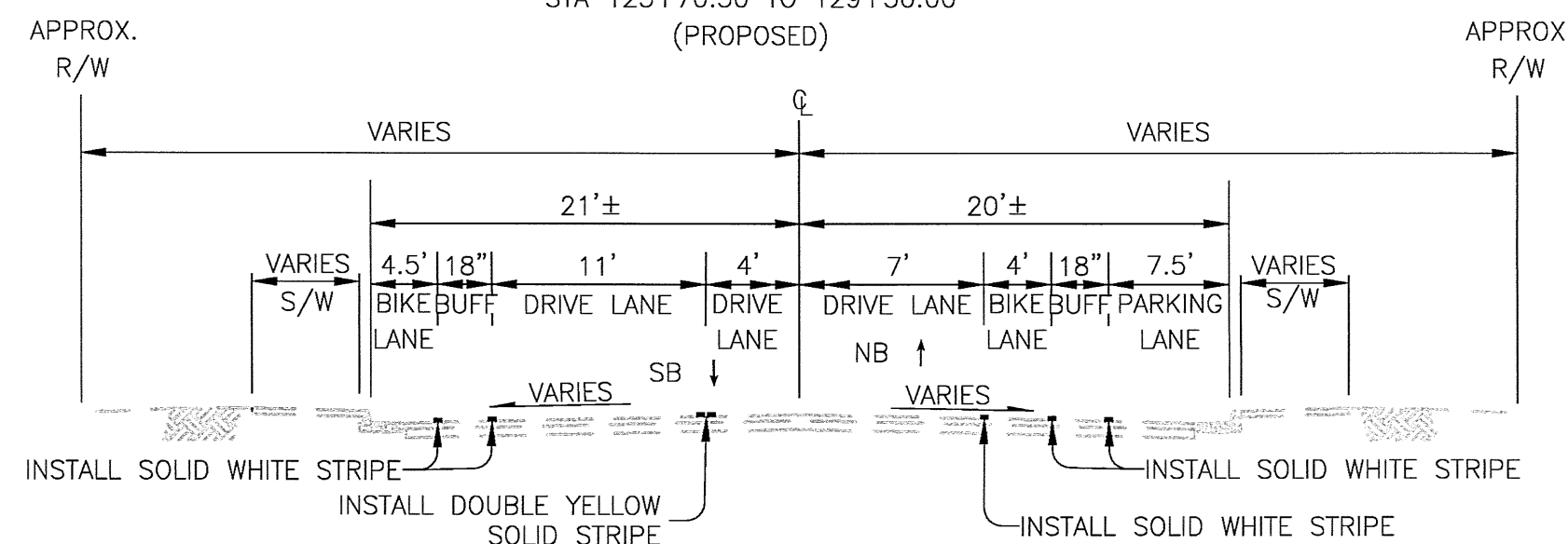

GIRARD BLVD
LOOKING NORTH
STA 130+25.80 TO 135+86.41
(PROPOSED)

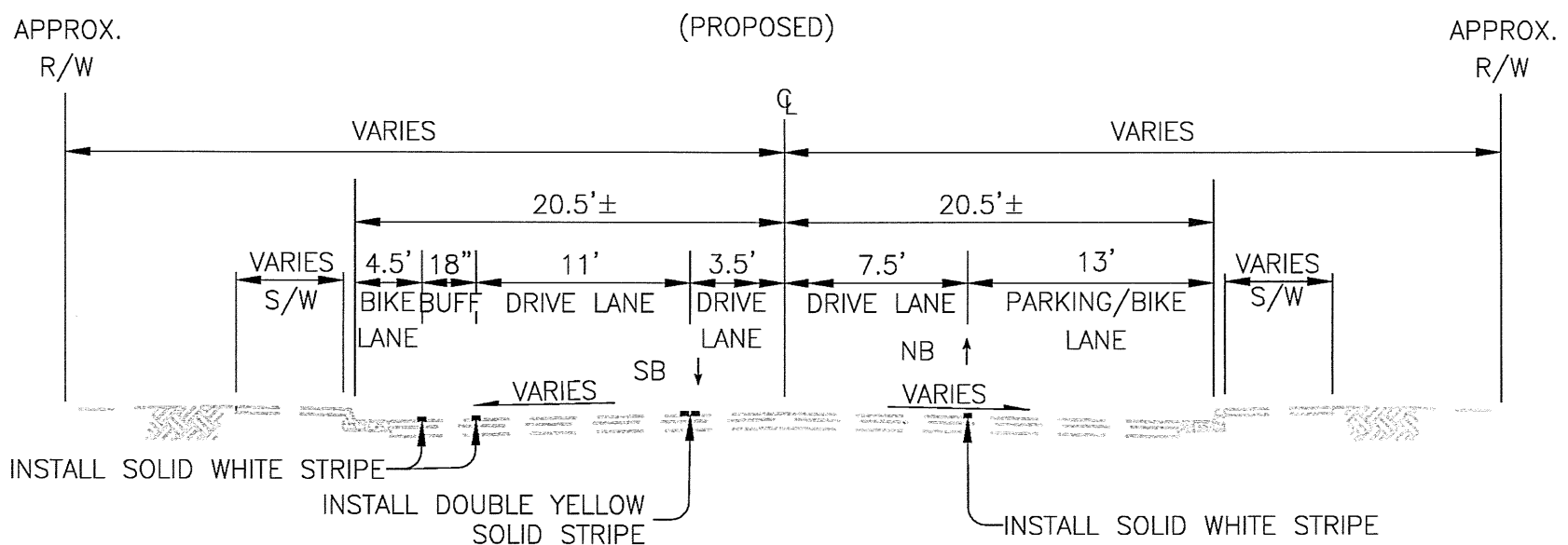

GIRARD BLVD
LOOKING NORTH
STA 135+86.41 TO 136+36.41
(PROPOSED)

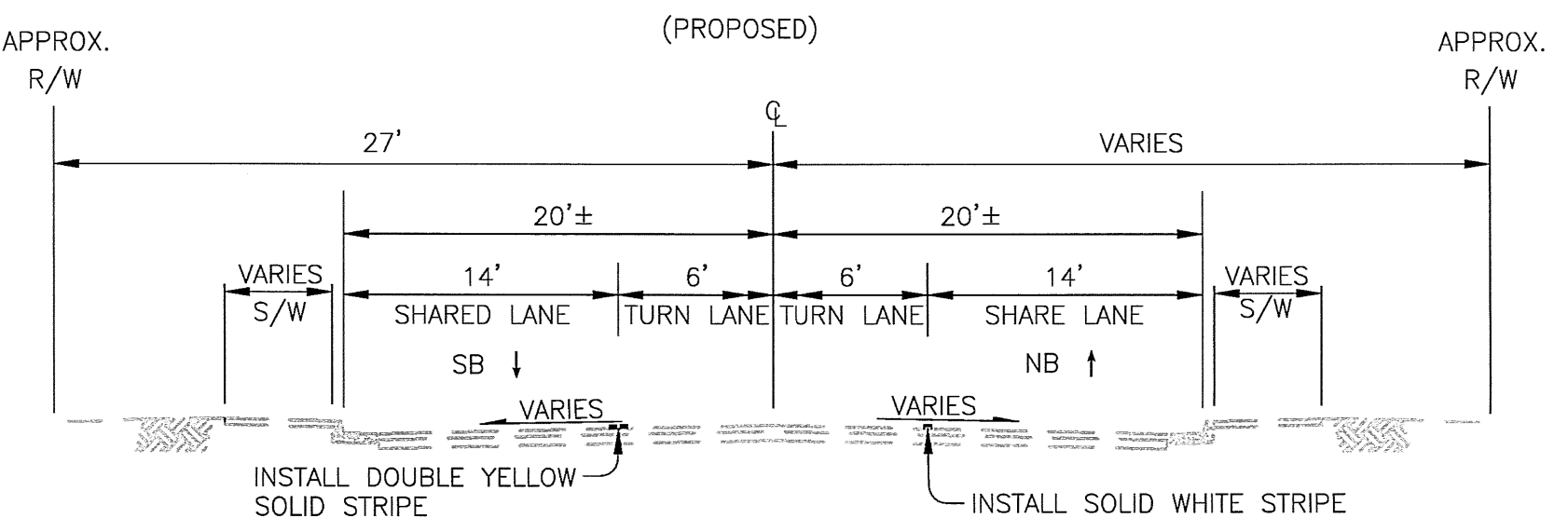

GIRARD BLVD
LOOKING NORTH
STA 137+72.98 TO 139+36.71
STA 140+14.41 TO 142+14.69
(PROPOSED)

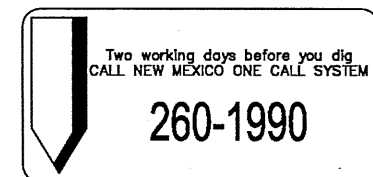

TY LIN INTERNATIONAL
engineers | planners | scientists

500 4th Street NW Suite 403
Bank of America Centre
Albuquerque, NM 87102



CITY OF ALBUQUERQUE
MUNICIPAL DEVELOPMENT DEPARTMENT
ENGINEERING DIVISION

TITLE: **GIRARD COMPLETE STREET PLAN
TYPICAL SECTIONS**

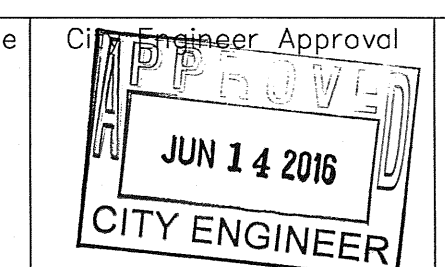
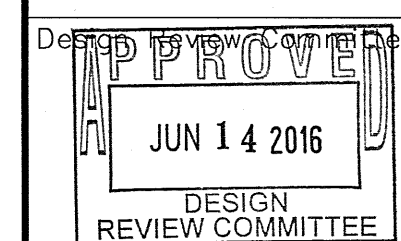

Last Design Update

Mo./Day/Yr.	Mo./Day/Yr.

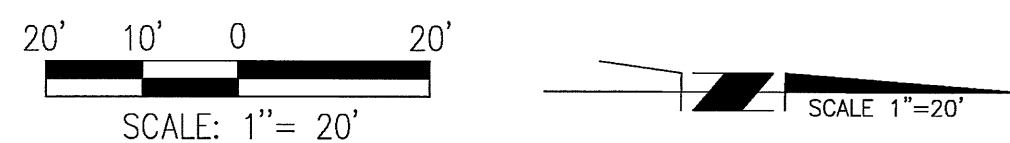
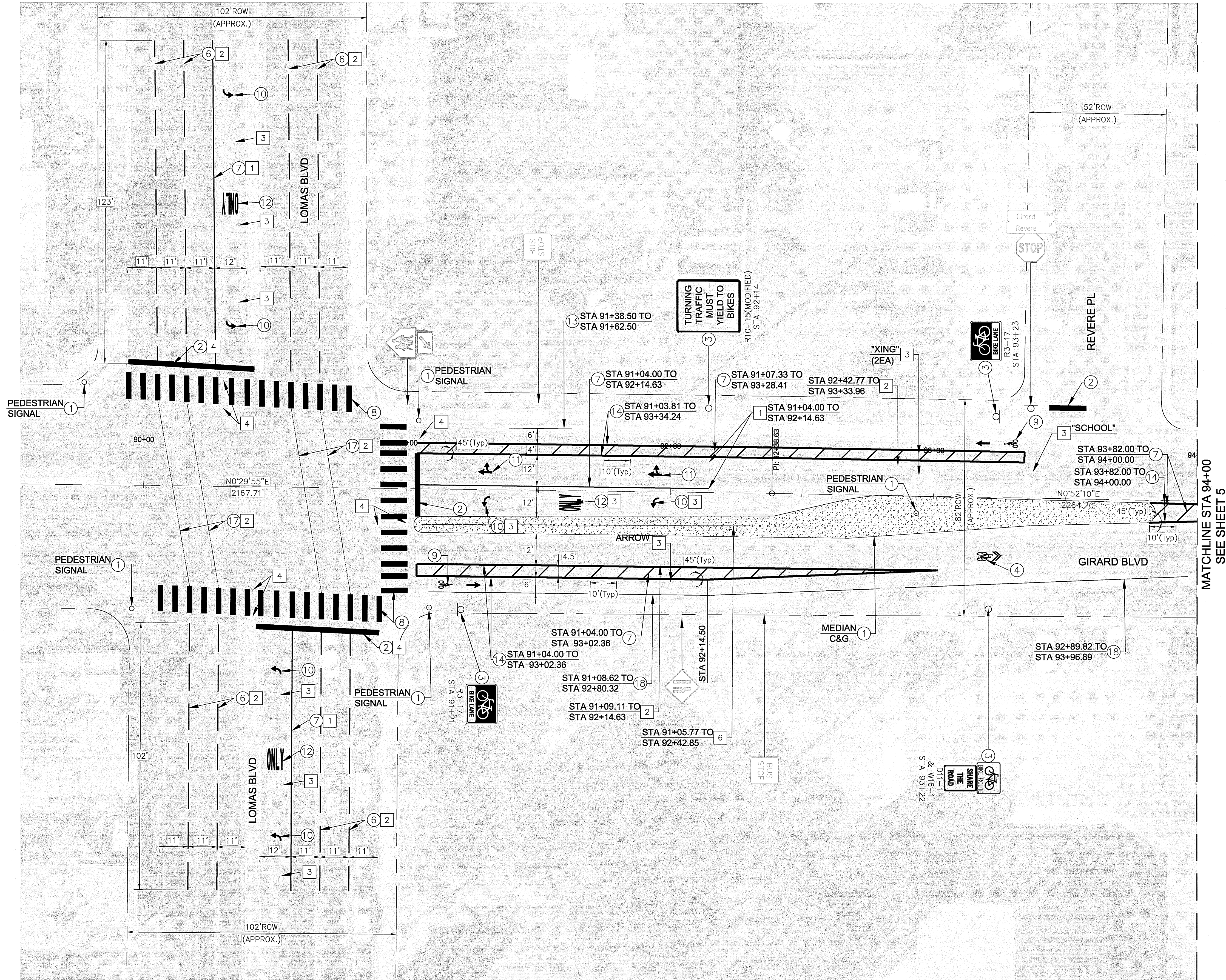

GENERAL NOTES
1. ALL RIGHT OF WAY DIMENSIONS ARE APPROXIMATE.

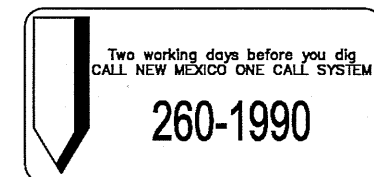

REMOVALS				AS BUILT INFORMATION	
NO.	DESCRIPTION	QUANTITY	DATE	CONTRACTOR	DATE
1	REMOVE EXISTING 4" SOLID WHITE STRIPE	440 LF			
2	REMOVE EXISTING BROKEN WHITE STRIPE	1,186 LF			
3	REMOVE EXISTING SYMBOL OR WORD	13 EA			
4	REMOVE EXISTING 24" SOLID WHITE STRIPE	622 LF			
6	REMOVE EXISTING PEDESTRIAN FENCING	822 SY			

GENERAL CONSTRUCTION NOTES				BENCH MARKS	
NO.	DESCRIPTION	QUANTITY	DATE	CONTRACTOR	DATE
1	PROTECT IN PLACE				
2	INSTALL 24" STOP BAR	133 LF			
3	INSTALL NEW SIGN W/ NEW SIGN POST PER DETAIL ON SHEET 9				
4	INSTALL A NEW "SUPER" SHARROW MARKING PER DETAIL ON SHEET 9	1 EA			
6	INSTALL 4" BROKEN WHITE STRIPE (10' STRIPE, 30' SKIP)	901 LF			
7	INSTALL 6" SOLID WHITE STRIPE	531 LF			
8	INSTALL 24" WHITE SOLID MARKINGS (CROSSWALK) PER DETAIL ON SHEET 9	440 LF			
9	INSTALL BIKE SYMBOL (WITH ARROW) PER DETAIL ON SHEET 9	2 EA			
10	INSTALL PLASTIC LEFT TURN SYMBOL	6 EA			
11	INSTALL PLASTIC RIGHT/STRAIGHT TURN SYMBOL	2 EA			
12	INSTALL PLASTIC WORD "ONLY"	3 EA			
13	REFRESH YELLOW CURB PAINT	24 LF			
14	INSTALL 8" SOLID WHITE STRIPE	885 LF			
17	INSTALL 6" DOTTED WHITE STRIPE (2' STRIPE, 2' SKIP)	285 LF			
18	PAINT CURB RED	279 LF			

SIGNING LEGEND:			
	SPEED LIMIT 30	NEW/REMOVE & RELOCATED SIGN	7 EA
	SPEED LIMIT 30	REMOVE & SALVAGE	
	SPEED LIMIT 30	PROTECT IN PLACE	

TY LIN INTERNATIONAL			
engineers planners scientists			
500 4th Street NW Suite 403 Bank of America Centre Albuquerque, NM 87102			
 CITY OF ALBUQUERQUE MUNICIPAL DEVELOPMENT DEPARTMENT ENGINEERING DIVISION		TITLE: GIRARD COMPLETE STREET PLAN SIGNING & STRIPING PLAN STA 90+00 TO 94+00	
DESIGNED BY: BLONG	DATE: 05/2016	REMARKS	BY
DRAWN BY: BLONG	DATE: 05/2016	REVISIONS	
CHECKED BY: E.FROBERG	DATE: 05/2016	DESIGN	

City Project No.		Zone Map No.		Sheet	
9042.04		J16, H16		4 of 9	

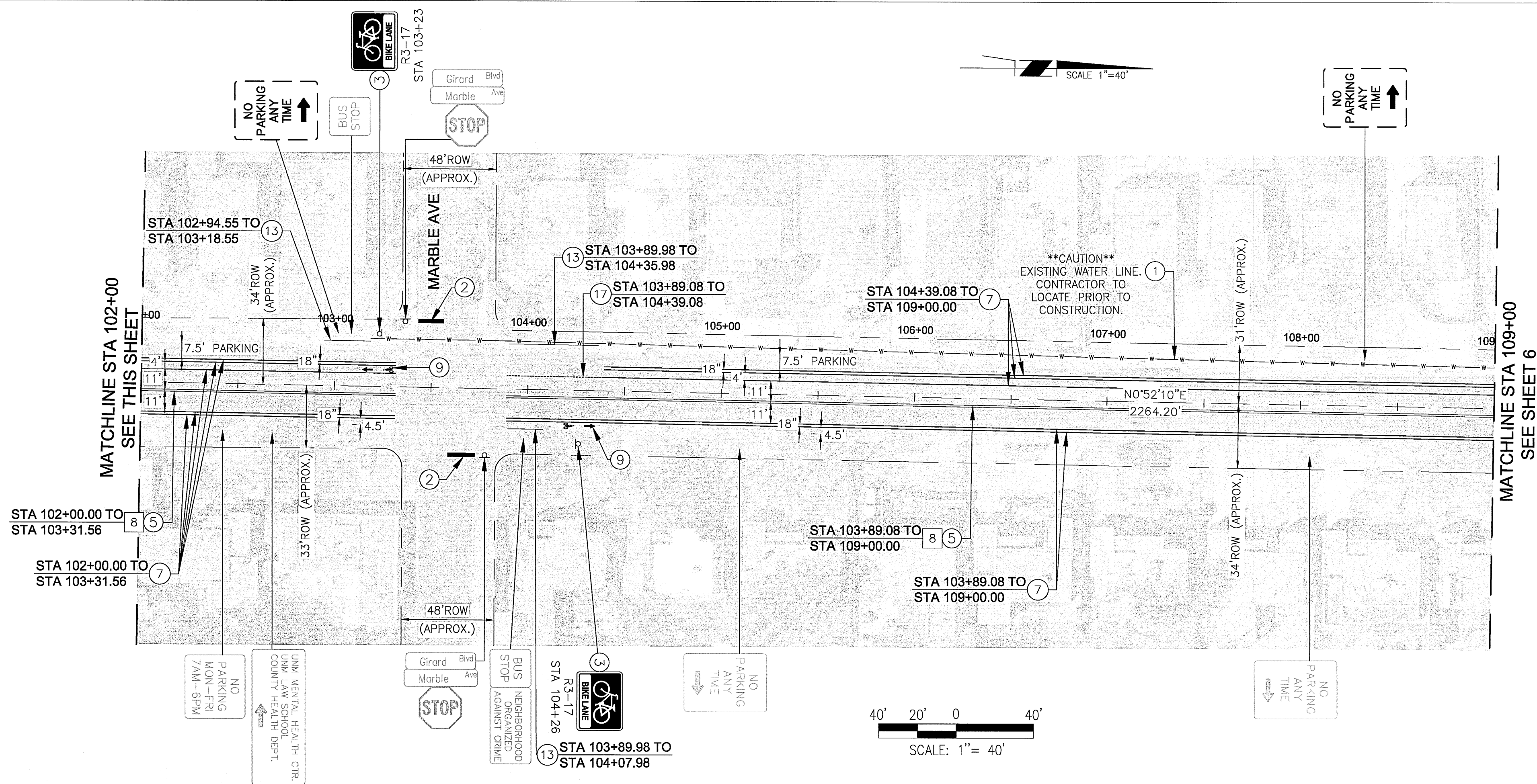
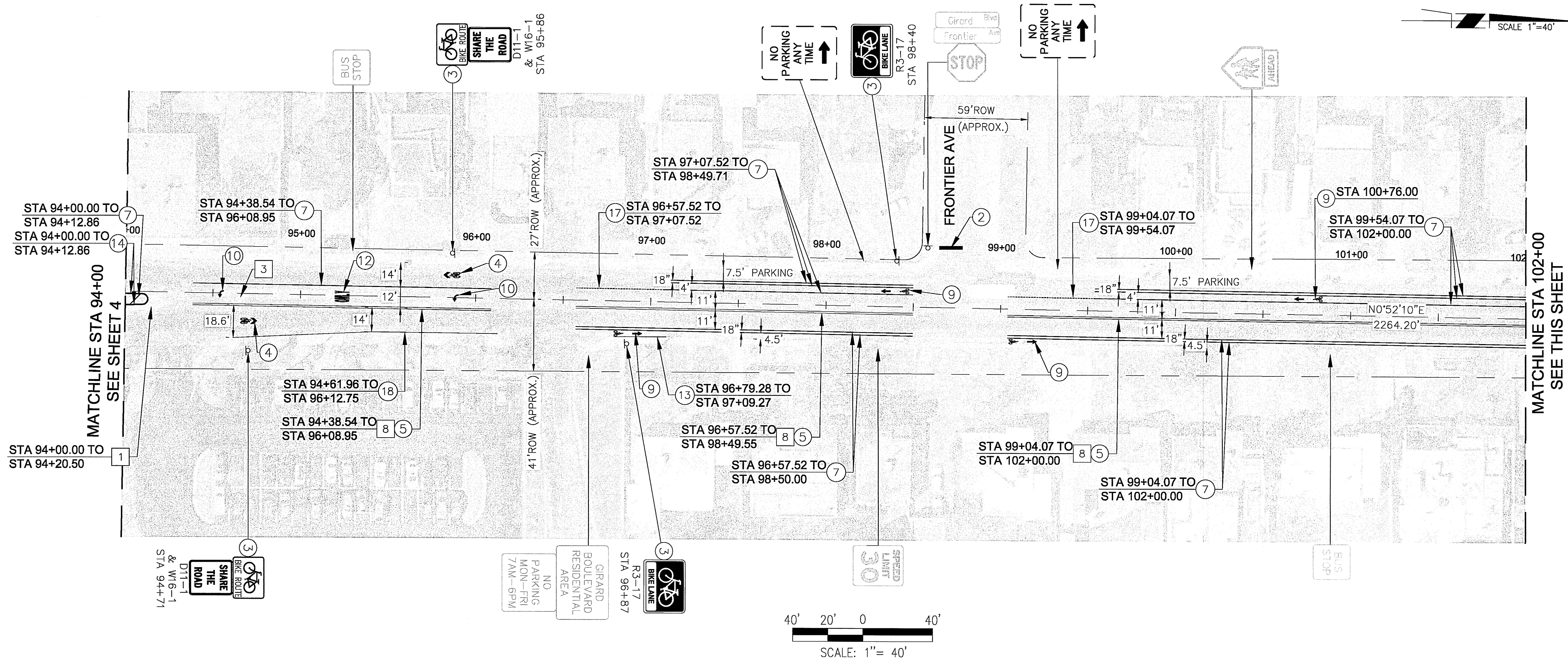

REMOVALS				AS BUILT INFORMATION	
1	REMOVE EXISTING 4" SOLID WHITE STRIPE	80 LF	DATE	DATE	DATE
3	REMOVE EXISTING SYMBOL	1 EA	DATE	DATE	DATE
8	REMOVE EXISTING DOUBLE YELLOW SOLID STRIPE	1,317 LF	DATE	DATE	DATE
GENERAL CONSTRUCTION NOTES				BENCH MARKS	
1	PROTECT IN PLACE		CONTRACTOR	DATE	
2	INSTALL 24" STOP BAR	40 LF	INSPECTOR	DATE	
3	INSTALL NEW SIGN W/ NEW SIGN POST PER DETAIL ON SHEET 9		ACCEPTANCE BY	DATE	
4	INSTALL A NEW "SUPER" SHARROW MARKING PER DETAIL ON SHEET 9	2 EA	VERIFICATION BY	DATE	
5	INSTALL 4" DOUBLE YELLOW SOLID STRIPE	1,301 LF	DRAWINGS CORRECTED BY	DATE	
7	INSTALL 6" SOLID WHITE STRIPE	5,384 LF	RECORDED BY	DATE	
9	INSTALL BIKE SYMBOL (WITH ARROW) PER DETAIL ON SHEET 9	6 EA	NO.		
10	INSTALL PLASTIC LEFT TURN SYMBOL	2 EA			
12	INSTALL PLASTIC WORD "ONLY"	1 EA			
13	REFRESH YELLOW CURB PAINT	118 LF			
14	INSTALL 8" SOLID WHITE STRIPE	29 LF			
17	INSTALL 6" DOTTED WHITE STRIPE (2' STRIPE, 2' SKIP)	150 LF			
18	PAINT CURB RED	151 LF			
GENERAL NOTES 1. ALL RIGHT OF WAY DIMENSIONS ARE APPROXIMATE.					
SIGNING LEGEND:					
NEW/REMOVE & RELOCATED SIGN		8 EA			
REMOVE & SALVAGE		4 EA			
PROTECT IN PLACE					
TOTAL NEW SIGN: 24 SF					
TOTAL NEW SIGN POST: 66 LF					
TY LIN INTERNATIONAL engineers planners scientists 500 4th Street NW Suite 403 Bank of America Centre Albuquerque, NM 87102				NO. DATE REMARKS REVISIONS DESIGN	
CITY OF ALBUQUERQUE MUNICIPAL DEVELOPMENT DEPARTMENT ENGINEERING DIVISION				DESIGNED BY: BLONG DATE: 05/2016 DRAWN BY: BLONG DATE: 05/2016 CHECKED BY: E.FROBERG DATE: 05/2016	
TITLE: GIRARD COMPLETE STREET PLAN SIGNING & STRIPING PLAN STA 94+00 TO 109+00					
				Mo./Day/Yr.	
City Project No. 9042.04		Zone Map No. J16, H16		Sheet 5 of 9	

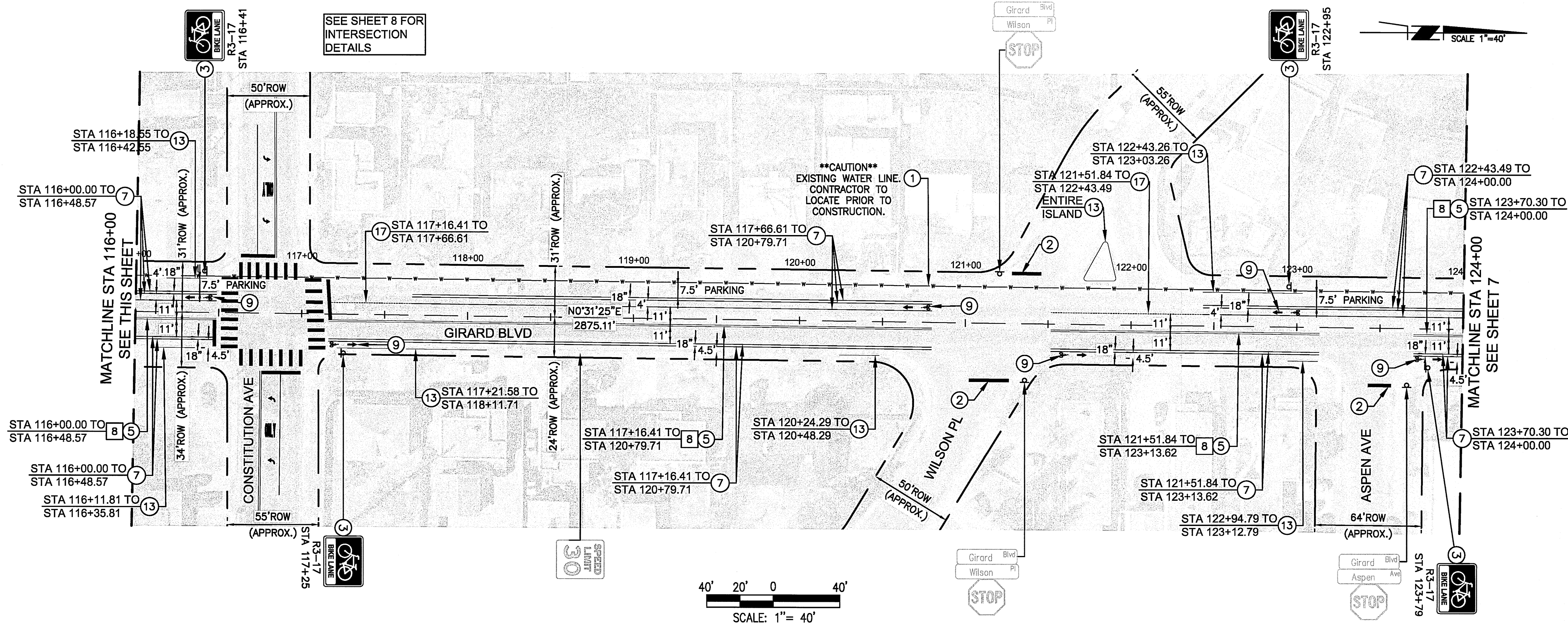
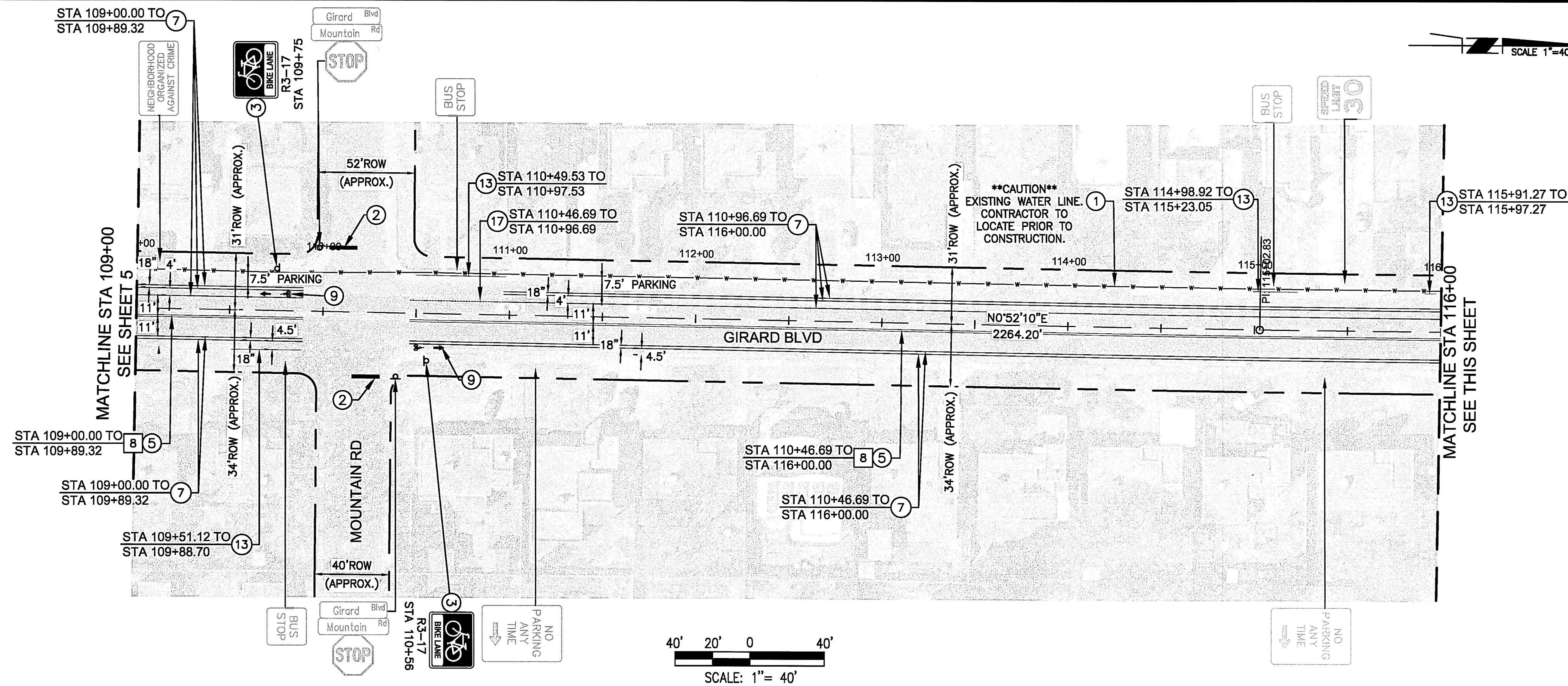

REMOVALS			
NO.	DESCRIPTION	QUANTITY	DATE
8	REMOVE EXISTING DOUBLE YELLOW SOLID STRIPE	1,246 LF	

GENERAL CONSTRUCTION NOTES			
NO.	DESCRIPTION	QUANTITY	DATE
1	PROTECT IN PLACE		
2	INSTALL 24" STOP BAR	86 LF	
3	INSTALL A NEW SIGN W/ NEW SIGN POST PER DETAIL ON SHEET 9		
5	INSTALL 4" DOUBLE YELLOW SOLID STRIPE	1,246 LF	
7	INSTALL 6" SOLID WHITE STRIPE	5,822 LF	
9	INSTALL BIKE SYMBOL (WITH ARROW) PER DETAIL ON SHEET 9	8 EA	
13	REFRESH YELLOW CURB PAINT	416 LF	
17	INSTALL 6" DOTTED WHITE STRIPE (2' STRIPE, 2' SKIP)	192 LF	

GENERAL NOTES
1. ALL RIGHT OF WAY DIMENSIONS ARE APPROXIMATE.

SIGNING LEGEND:

DESCRIPTION	QUANTITY
NEW/REMOVE & RELOCATED SIGN	6 EA
REMOVE & SALVAGE	
PROTECT IN PLACE	

TOTAL NEW SIGN: 18 SF
TOTAL NEW SIGN POST: 62 LF

260-1990

TY LIN INTERNATIONAL
engineers | planners | scientists
500 4th Street NW Suite 403
Bank of America Centre
Albuquerque, NM 87102

CITY OF ALBUQUERQUE
MUNICIPAL DEVELOPMENT DEPARTMENT
ENGINEERING DIVISION

TITLE: **GIRARD COMPLETE STREET PLAN**
SIGNING & STRIPING PLAN
STA 109+00 TO 124+00

Design Review Committee: APPROVED JUN 14 2016
City Engineer: APPROVED JUN 14 2016

City Project No. 9042.04
Zone Map No. J16, H16
Sheet 6 of 9

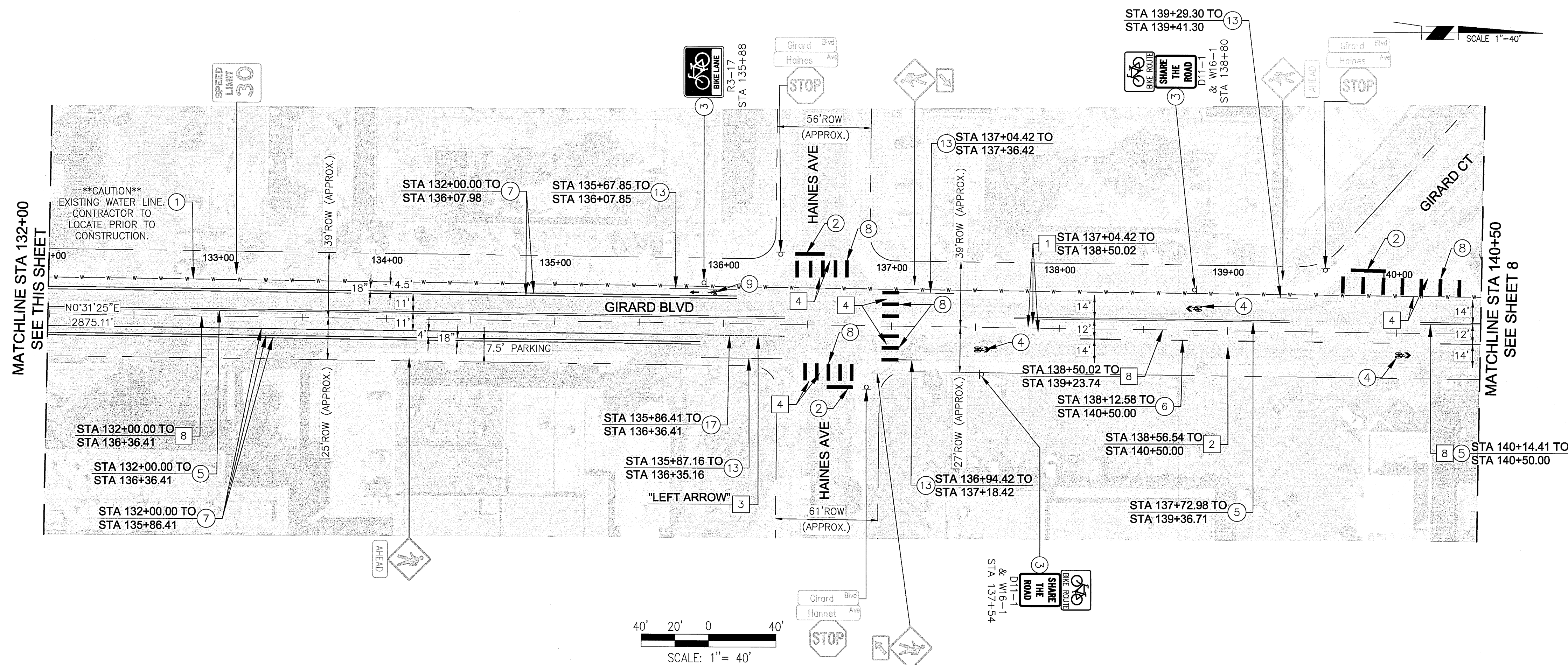

REMOVALS				AS BUILT INFORMATION			
1	REMOVE EXISTING STRIPE	4" SOLID WHITE	288 LF	DATE	DATE	DATE	DATE
2	REMOVE EXISTING STRIPE	BROKEN WHITE	193 LF	DATE	DATE	DATE	DATE
3	REMOVE EXISTING	SYMBOL OR WORD	1 EA	DATE	DATE	DATE	DATE
4	REMOVE EXISTING STRIPE	24" SOLID WHITE	432 LF	DATE	DATE	DATE	DATE
8	REMOVE EXISTING SOLID STRIPE	DOUBLE YELLOW	1,388 LF	DATE	DATE	DATE	DATE
○ GENERAL CONSTRUCTION NOTES ○				MICRO-FILM INFORMATION			
1	PROTECT IN PLACE			CONTRACTOR	WORK ORDER NO.	INSPECTED BY	ACCEPTANCE BY
2	INSTALL 24" STOP BAR		86 LF	DATE	DATE	DATE	DATE
3	INSTALL NEW SIGN W/ NEW SIGN POST PER DETAIL ON SHEET 9			FIELD VERIFICATION BY	DATE	DRAWINGS CORRECTED BY	RECORDED BY
4	INSTALL A NEW "SUPER" SHARROW MARKING PER DETAIL ON SHEET 9		3 EA	NO.	BY		
5	INSTALL 4" DOUBLE YELLOW SOLID STRIPE		1,361 LF				
6	INSTALL 4" BROKEN WHITE STRIPE (10' STRIPE, 30' SKIP)		384 LF				
7	INSTALL 6" SOLID WHITE STRIPE		5,597 LF				
8	INSTALL 24" WHITE SOLID MARKINGS (CROSSWALK) PER DETAIL ON SHEET 9		230 LF				
9	INSTALL BIKE SYMBOL (WITH ARROW) PER DETAIL ON SHEET 9		3 EA				
13	REFRESH YELLOW CURB PAINT		249 LF				
17	INSTALL 6" DOTTED WHITE STRIPE (2' STRIPE, 2' SKIP)		279 LF				
GENERAL NOTES 1. ALL RIGHT OF WAY DIMENSIONS ARE APPROXIMATE.							
SIGNING LEGEND:							
<div><div><div>SPEED LIMIT</div><div>30</div></div><div>NEW/REMOVE & RELOCATED SIGN</div><div>7 EA</div></div>				<div><div>ENGINEER'S SEAL</div><div><div>ERIC J. FROBERG</div><div>NEW MEXICO</div><div>18855</div><div>PROFESSIONAL ENGINEER</div></div><div>05/18/2016</div></div>			
<div><div><div>SPEED LIMIT</div><div>30</div></div><div>REMOVE & SALVAGE</div></div>				<div><div>REVISIONS</div><div>DESIGN</div><div>DATE: 05/2016</div><div>DATE: 05/2016</div><div>DATE: 05/2016</div></div>			
<div><div><div>SPEED LIMIT</div><div>30</div></div><div>PROTECT IN PLACE</div></div>				<div><div>NO. DATE</div><div>REMARKS</div><div>BY</div></div>			
TOTAL NEW SIGN: 21 SF							
TOTAL NEW SIGN POST: 56 LF							
<div><div><div>Two working days before you dig.</div><div>CALL NEW MEXICO ONE CALL SYSTEM</div><div>260-1990</div></div></div>							
TY. LIN INTERNATIONAL engineers planners scientists 500 4th Street NW Suite 403 Bank of America Centre Albuquerque, NM 87102							
CITY OF ALBUQUERQUE MUNICIPAL DEVELOPMENT DEPARTMENT ENGINEERING DIVISION							
TITLE: GIRARD COMPLETE STREET PLAN SIGNING & STRIPING PLAN STA 124+00 TO 140+50							
Design Review Committee APPROVED JUN 14 2016 DESIGN REVIEW COMMITTEE		City Engineer Approval JUN 14 2016 CITY ENGINEER		Last Design Update		Mo./Day/Yr. Mo./Day/Yr.	
City Project No.		Zone Map No.		Sheet		Of	
9042.04		J16, H16		7		9	

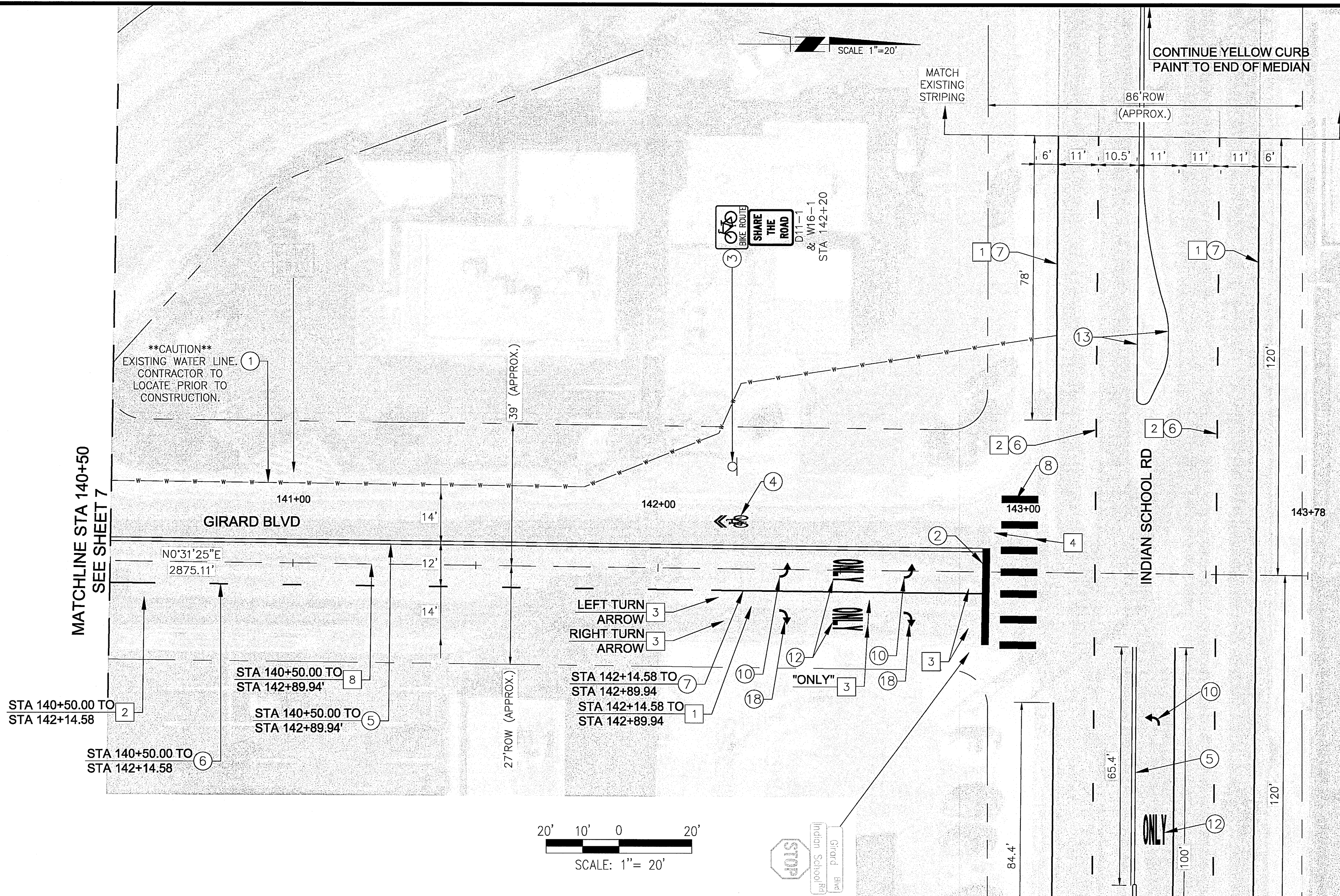
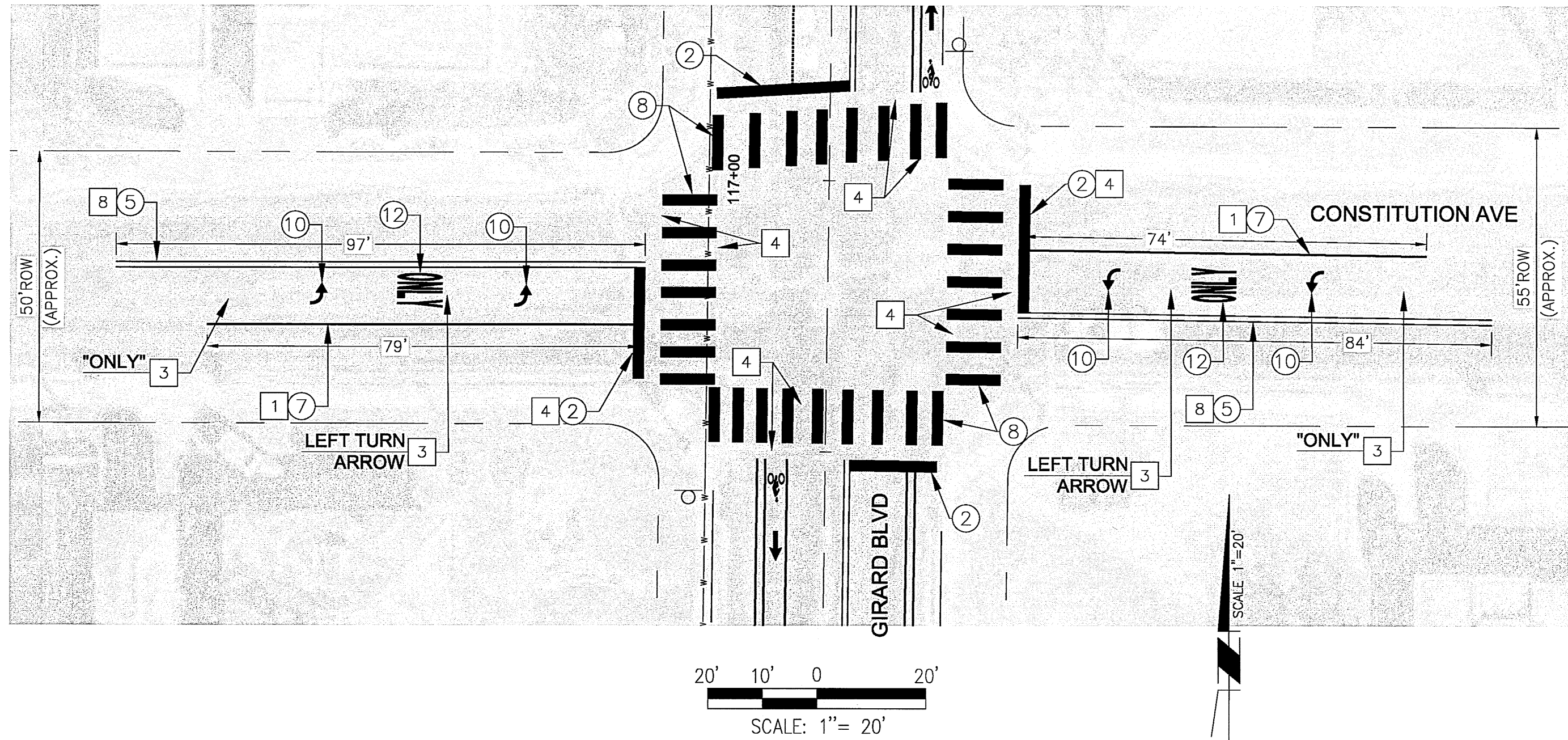

REMOVALS		AS BUILT INFORMATION	
NO.	DESCRIPTION	DATE	NO.
1	REMOVE EXISTING 4" SOLID WHITE STRIPE	763 LF	
2	REMOVE EXISTING BROKEN WHITE STRIPE	780 LF	
3	REMOVE EXISTING SYMBOL AND WORD	10 EA	
4	REMOVE EXISTING 24" SOLID WHITE STRIPE	448 LF	
8	REMOVE EXISTING DOUBLE YELLOW SOLID STRIPE	723 LF	

GENERAL CONSTRUCTION NOTES		BENCH MARKS	
NO.	DESCRIPTION	DATE	NO.
1	PROTECT IN PLACE		
2	INSTALL 24" STOP BAR	111 LF	
3	INSTALL NEW SIGN W/ NEW SIGN POST PER DETAIL ON SHEET 9		
4	INSTALL A NEW "SUPER" SHARROW MARKING PER DETAIL ON SHEET 9	1 EA	
5	INSTALL 4" DOUBLE YELLOW SOLID STRIPE	488 LF	
6	INSTALL 4" BROKEN WHITE STRIPE (10' STRIPE, 30' SKIP)	480 LF	
7	INSTALL 6" SOLID WHITE STRIPE	656 LF	
8	INSTALL 24" WHITE SOLID MARKINGS (CROSSWALK) PER DETAIL ON SHEET 9	370 LF	
10	INSTALL PLASTIC LEFT TURN SYMBOL	8 EA	
12	INSTALL PLASTIC WORD "ONLY"	5 EA	
13	INSTALL NEW YELLOW CURB PAINT	683 LF	
18	INSTALL PLASTIC RIGHT TURN SYMBOL	2 EA	

GENERAL NOTES
1. ALL RIGHT OF WAY DIMENSIONS ARE APPROXIMATE.

SIGNING LEGEND:

	NEW/REMOVE & RELOCATED SIGN	2 EA
	REMOVE & SALVAGE	
	PROTECT IN PLACE	

TOTAL NEW SIGN: 6 SF
TOTAL NEW SIGN POST: 13 LF

Two working days before you dig, CALL NEW MEXICO ONE CALL SYSTEM 260-1990

TY LIN INTERNATIONAL
engineers | planners | scientists
500 4th Street NW Suite 403
Bank of America Centre
Albuquerque, NM 87102

CITY OF ALBUQUERQUE
MUNICIPAL DEVELOPMENT DEPARTMENT
ENGINEERING DIVISION

TITLE: **GIRARD COMPLETE STREET PLAN**
SIGNING & STRIPING PLAN
STA 140+50 TO 143+78

DESIGN REVIEW COMMITTEE	CITY ENGINEER	DATE	NO.
		JUN 14 2016	

DESIGNED BY: BLONG	DRAWN BY: BLONG	CHECKED BY: E.FROBERG
DATE: 05/2016	DATE: 05/2016	DATE: 05/2016

REMARKS	REVISIONS	DESIGN

NO.	DATE	BY

City Project No. 9042.04 Zone Map No. J16, H16 Sheet 8 of 9

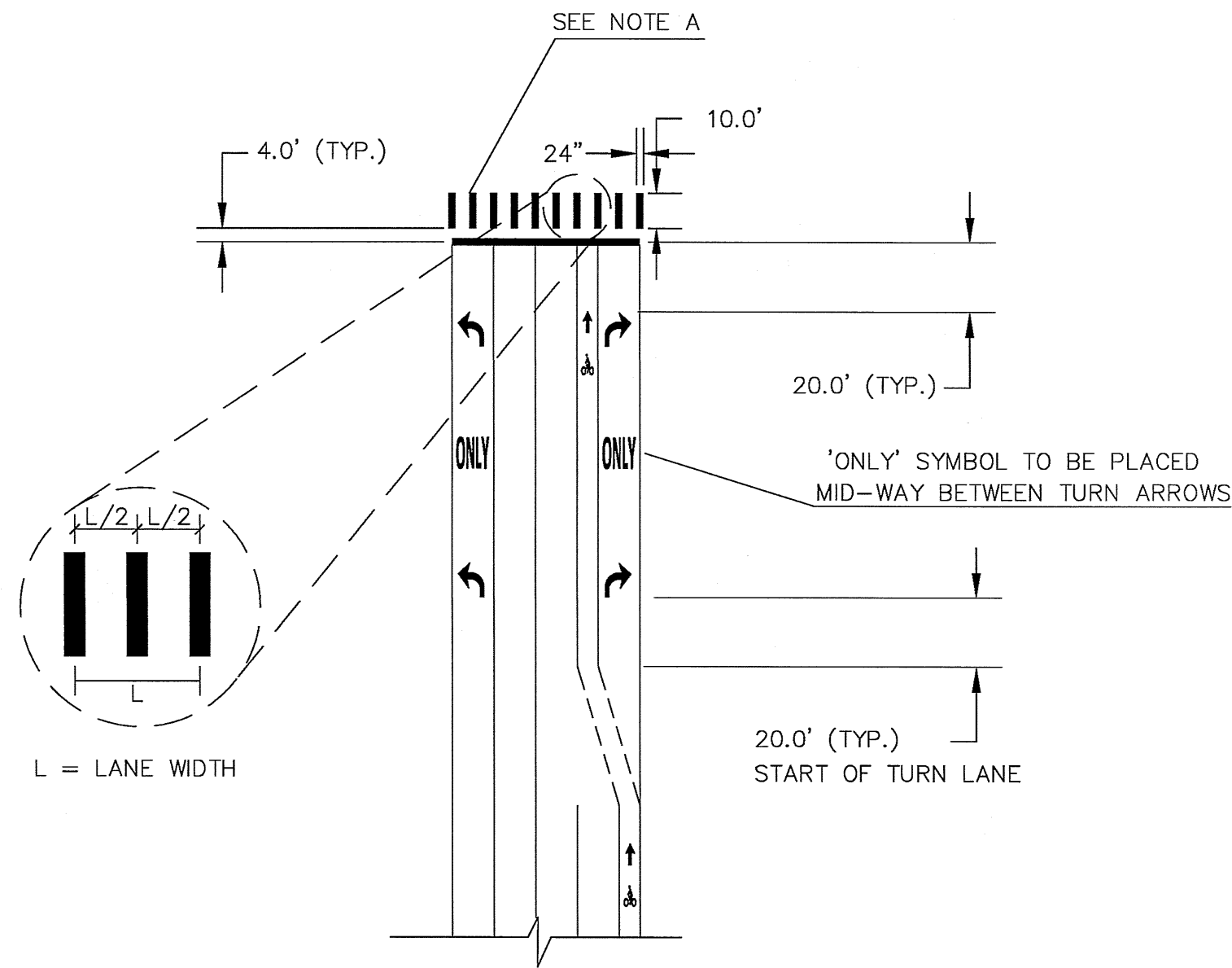

PAVEMENT MARKING DETAILS - CROSSWALK AND APPROACH

NOTE A. 24" X 10' LONGITUDINAL CROSSWALK MARKINGS SHALL BE INSTALLED CENTERED AT EACH DRIVING LANE AS SHOWN ABOVE TO AVOID THE WHEEL PATHS. LAYOUT AT EACH INTERSECTION SHALL REQUIRE APPROVAL BY THE CITY PROJECT MANAGER PRIOR TO INSTALLATION.

SIGNING AND PAVEMENT MARKING NOTES:

1. ALL SIGNS AND PAVEMENT MARKINGS SHALL BE IN COMPLIANCE WITH THE LATEST VERSION OF THE MANUAL ON UNIFORM TRAFFIC CONTROL DEVICES (MUTCD), CITY OF ALBUQUERQUE STANDARD SPECIFICATIONS, AND THESE PLANS.
2. ALL SIGNS SHALL BE PER COA STD SPEC 450 AND MADE OF TYPE IV PRISMATIC SHEETING WITH SHEETING TYPE ASTM D4956-04 AS PER THE MANUAL ON UNIFORM TRAFFIC CONTROL DEVICES (MUTCD), LATEST EDITION.
3. AT ALL INTERSECTIONS, SIGNALIZED AND NON-SIGNALIZED, STRIPING SHALL BE REFRESHED 100' BEYOND THE PROPOSED GIRARD BOULEVARD INTERSECTION STRIPING. ON STREETS WHERE THE EXISTING STRIPING IS LESS THAN 100', THE STRIPING SHALL BE REFRESHED TO THE EXISTING LENGTH.
4. CONTRACTOR SHALL MAKE EVERY EFFORT TO REMOVE GRAFFITI FROM ANY EXISTING OR RELOCATED SIGNS WITHIN THE PROJECT CORRIDOR. GRAFFITI REMOVAL SHALL BE INCIDENTAL TO THE COMPLETION OF THE PROJECT.
5. ALL PAVEMENT MARKING INSTALLATION SHALL BE THERMOPLASTIC UNLESS OTHERWISE NOTED WITHIN THE PLAN SET. ALL PAVEMENT MARKINGS SHALL BE PER COA STD SPEC 440, 441, AND 442.
6. PAVEMENT MARKING REMOVAL SHALL BE PERFORMED PER COA STD SPEC 443. METHOD SHALL BE AT THE DISCRETION OF THE CONTRACTOR BUT REQUIRE CITY APPROVAL PRIOR TO COMMENCING WORK.
7. ALL SIGN POST INSTALLATION PER NMDOT STANDARD DRAWING 701-02-1/3, SEE DETAIL THIS SHEET.
8. RELOCATIONS OF EXISTING SIGNS SHALL BE INCIDENTAL TO THE PROJECT AND NO ADDITIONAL PAYMENT SHALL BE MADE.

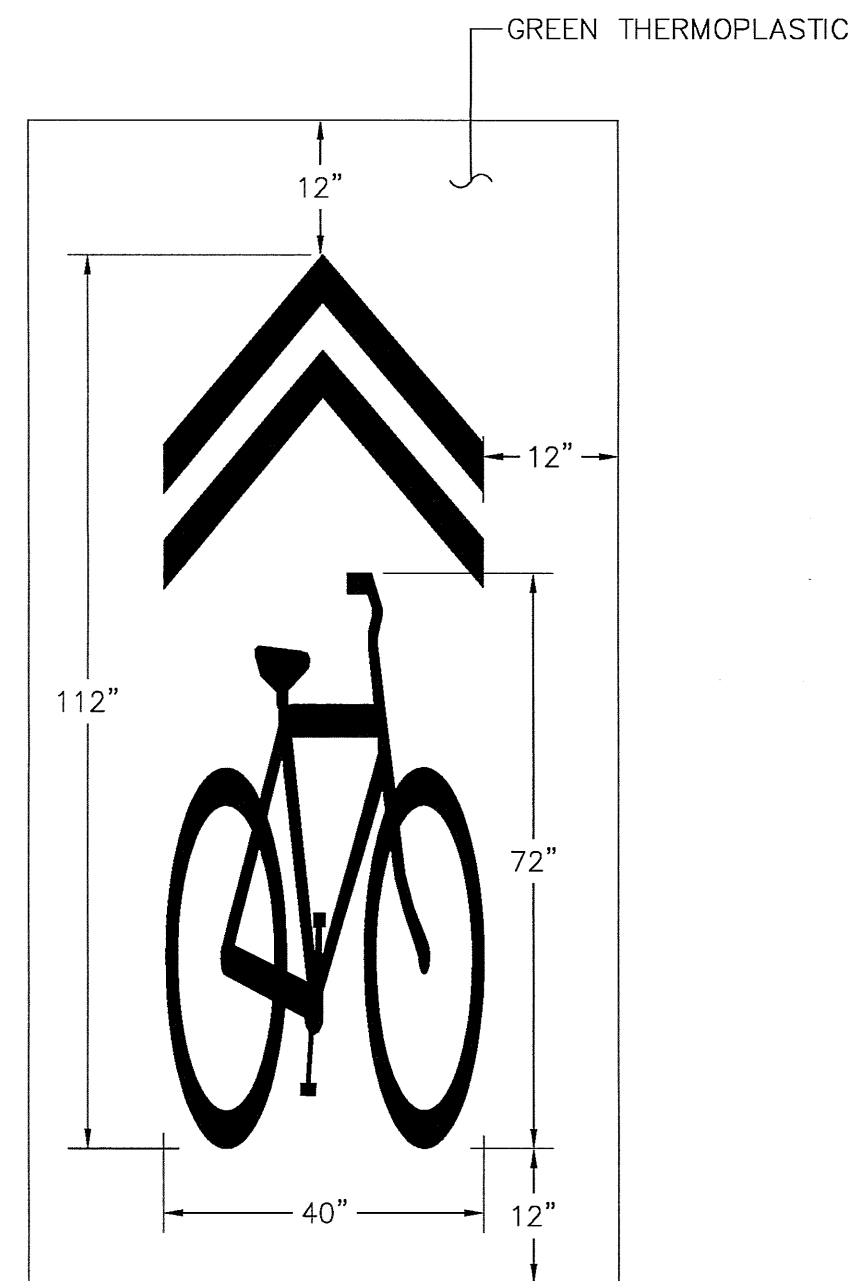

"SUPER" SHARROW MARKING DETAIL

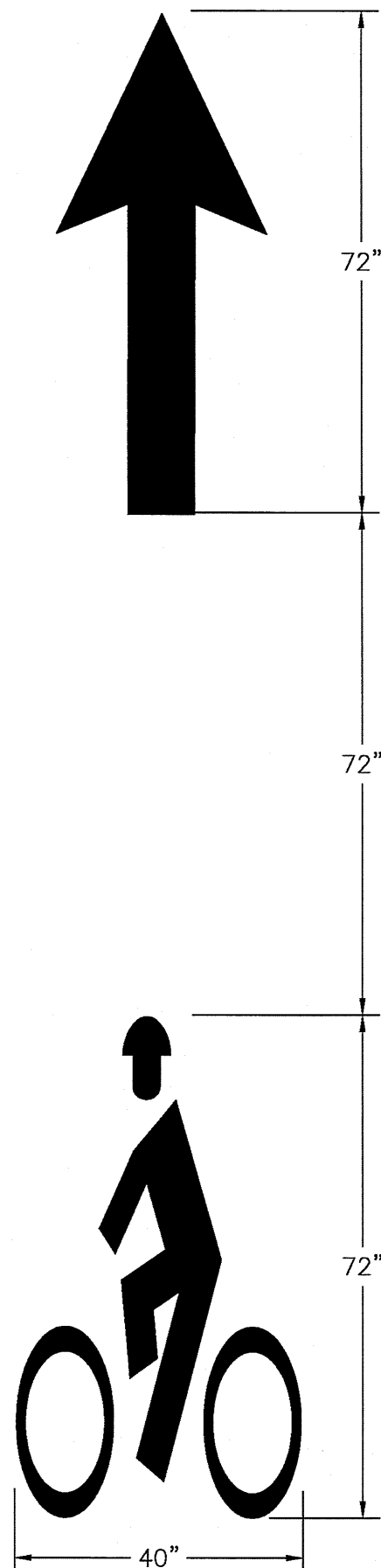

BIKE W/ ARROW MARKING DETAIL

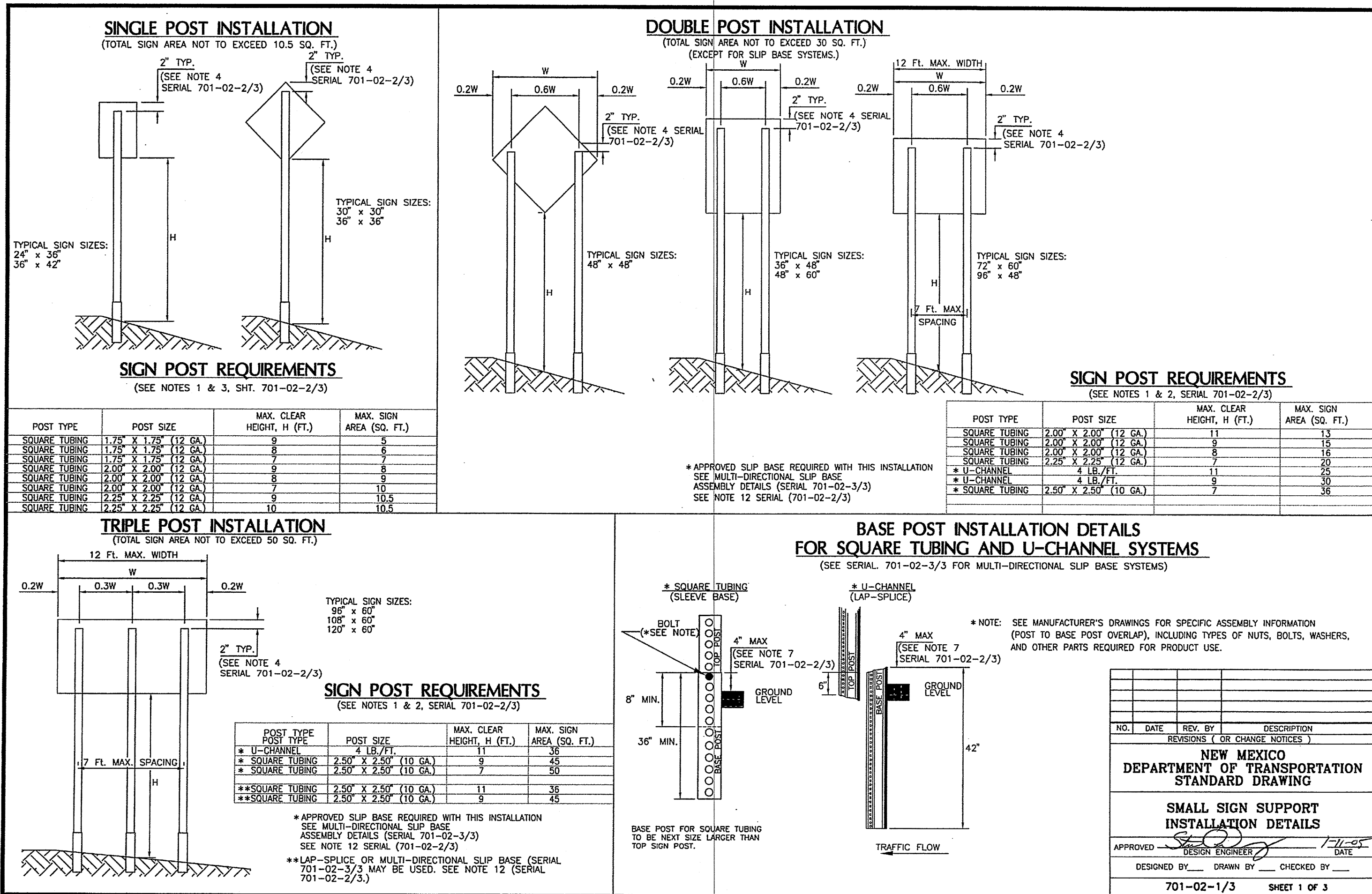

SURVEY INFORMATION		BENCH MARKS		AS BUILT INFORMATION	
NO.	FIELD NOTES		CONTRACTOR	DATE	DATE
	BY	DATE			
			WORK BY	DATE	
			SKETCHES BY	DATE	
			ACCEPTANCE BY	DATE	
			FIELD LOCATION BY	DATE	
			DRAWINGS	DATE	
			CORRECTED BY	DATE	
			MICRO—FILM INFORMATION		
			RECORDED BY	DATE	
			NO.		

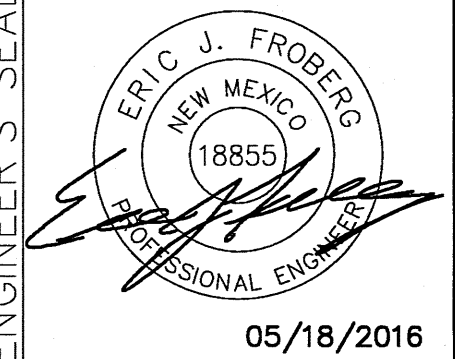

05/18/2016

--	--	--	--	--	--	--	--	--	--	--	--	--	--	--	--	--	--	--	--	--	--	--	--	--	--	--	--	--	--	--	--	--	--	--	--	--	--	--	--	--	--	--	--	--	--	--	--	--	--	--	--	--	--	--	--	--	--	--	--	--	--	--	--	--	--	--	--	--	--	--	--	--	--	--	--	--	--	--	--	--	--	--	--	--	--	--	--	--	--	--	--	--	--	--	--	--	--	--	--	--	--	--	--	--	--	--	--	--	--	--	--	--	--	--	--	--	--	--	--	--	--	--	--	--	--	--	--	--	--	--	--	--	--	--	--	--	--	--	--	--	--	--	--	--	--	--	--	--	--	--	--	--	--	--	--	--	--	--	--	--	--	--	--	--	--	--	--	--	--	--	--	--	--	--	--	--	--	--	--	--	--	--	--	--	--	--	--	--	--	--	--	--	--	--	--	--	--	--	--	--	--	--	--	--	--	--	--	--	--	--	--	--	--	--	--	--	--	--	--	--	--	--	--	--	--	--	--	--	--	--	--	--	--	--	--	--	--	--	--	--	--	--	--	--	--	--	--	--	--	--	--	--	--	--	--	--	--	--	--	--	--	--	--	--	--	--	--	--	--	--	--	--	--	--	--	--	--	--	--	--	--	--	--	--	--	--	--	--	--	--	--	--	--	--	--	--	--	--	--	--	--	--	--	--	--	--	--	--	--	--	--	--	--	--	--	--	--	--	--	--	--	--	--	--	--	--	--	--	--	--	--	--	--	--	--	--	--	--	--	--	--	--	--	--	--	--	--	--	--	--	--	--	--	--	--	--	--	--	--	--	--	--	--	--	--	--	--	--	--	--	--	--	--	--	--	--	--	--	--	--	--	--	--	--	--	--	--	--	--	--	--	--	--	--	--	--	--	--	--	--	--	--	--	--	--	--	--	--	--	--	--	--	--	--	--	--	--	--	--	--	--	--	--	--	--	--	--	--	--	--	--	--	--	--	--	--	--	--	--	--	--	--	--	--	--	--	--	--	--	--	--	--	--	--	--	--	--	--	--	--	--	--	--	--	--	--	--	--	--	--	--	--	--	--	--	--	--	--	--	--	--	--	--	--	--	--	--	--	--	--	--	--	--	--	--	--	--	--	--	--	--	--	--	--	--	--	--	--	--	--	--	--	--	--	--	--	--	--	--	--	--	--	--	--	--	--	--	--	--	--	--	--	--	--	--	--	--	--	--	--	--	--	--	--	--	--	--	--	--	--	--	--	--	--	--	--	--	--	--	--	--	--	--	--	--	--	--	--	--	--	--	--	--	--	--	--	--	--	--	--	--	--	--	--	--	--	--	--	--	--	--	--	--	--	--	--	--	--	--	--	--	--	--	--	--	--	--	--	--	--	--	--	--	--	--	--	--	--	--	--	--	--	--	--	--	--	--	--	--	--	--	--	--	--	--	--	--	--	--	--	--	--	--	--	--	--	--	--	--	--	--	--	--	--	--	--	--	--	--	--	--	--	--	--	--	--	--	--	--	--	--	--	--	--	--	--	--	--	--	--	--	--	--	--	--	--	--	--	--	--	--	--	--	--	--	--	--	--	--	--	--	--	--	--	--	--	--	--	--	--	--	--	--	--	--	--	--	--	--	--	--	--	--	--	--	--	--	--	--	--	--	--	--	--	--	--	--	--	--	--	--	--	--	--	--	--	--	--	--	--	--	--	--	--	--	--	--	--	--	--	--	--	--	--	--	--	--	--	--	--	--	--	--	--	--	--	--	--	--	--	--	--	--	--	--	--	--	--	--	--	--	--	--	--	--	--	--	--	--	--	--	--	--	--	--	--	--	--	--	--	--	--	--	--	--	--	--	--	--	--	--	--	--	--	--	--	--	--	--	--	--	--	--	--	--	--	--	--	--	--	--	--	--	--	--	--	--	--	--	--	--	--	--	--	--	--	--	--	--	--	--	--	--	--	--	--	--	--	--	--	--	--	--	--	--	--	--	--	--	--	--	--	--	--	--	--	--	--	--	--	--	--	--	--	--	--	--	--	--	--	--	--	--	--	--	--	--	--	--	--	--	--	--	--	--	--	--	--	--	--	--	--	--	--	--	--	--	--	--	--	--	--	--	--	--	--	--	--	--	--	--	--	--	--	--	--	--	--	--	--	--	--	--	--	--	--	--	--	--	--	--	--	--	--	--	--	--	--	--	--	--	--	--	--	--	--	--	--	--	--	--	--	--	--	--	--	--	--	--	--	--	--	--	--	--	--	--	--	--	--	--	--	--	--	--	--	--	--	--	--	--	--	--	--	--	--	--	--	--	--	--	--	--	--	--	--	--	--	--	--	--	--	--	--	--	--	--	--	--	--	--	--	--	--	--	--	--	--	--	--	--	--	--	--	--	--	--	--	--	--	--	--	--	--	--	--	--	--	--	--	--	--	--	--	--	--	--	--	--	--	--	--	--	--	--	--	--	--	--	--	--	--	--	--	--	--	--	--	--	--	--	--	--	--	--	--	--	--	--	--	--	--	--	--	--	--	--	--	--	--	--	--	--	--	--	--	--	--	--	--	--	--	--	--	--	--	--	--	--	--	--	--	--	--	--	--	--	--	--	--	--	--	--	--	--	--	--	--	--	--	--	--	--	--	--	--	--	--	--	--	--	--	--	--	--	--	--	--	--	--	--	--	--	--	--	--	--	--	--	--	--	--	--	--	--	--	--	--	--	--	--	--	--	--	--	--	--	--	--	--	--	--	--	--	--	--	--	--	--	--	--	--	--	--	--	--	--	--	--	--	--	--	--	--	--	--	--	--	--	--	--	--	--	--	--	--	--	--	--	--	--	--	--	--	--	--	--	--	--	--	--	--	--	--	--	--	--	--	--	--	--	--	--	--	--	--	--	--	--	--	--	--	--	--	--	--	--	--	--	--	--	--	--	--	--	--	--	--	--	--	--	--	--	--	--	--	--	--	--	--	--	--	--	--	--	--	--	--	--	--	--	--	--	--	--	--	--	--	--	--	--	--	--	--	--	--	--	--	--	--	--	--	--	--	--	--	--	--	--	--	--	--	--	--	--	--	--	--	--	--	--	--	--	--	--	--	--	--	--	--	--	--	--	--	--	--	--	--	--	--	--	--	--	--	--	--	--	--	--	--	--	--	--	--	--	--	--	--	--	--	--	--	--	--	--	--	--	--	--	--	--	--	--	--	--	--	--	--	--	--	--	--	--	--	--	--	--	--	--	--	--	--	--	--	--	--	--	--	--	--	--	--	--	--	--	--	--	--	--	--	--	--	--	--	--	--	--	--	--	--	--	--	--	--	--	--	--	--	--	--	--	--	--	--	--	--	--	--	--	--	--	--	--	--	--	--	--	--	--	--	--	--	--	--	--	--	--	--	--	--	--	--	--	--	--	--	--	--	--	--	--	--	--	--	--	--	--	--	--	--	--	--	--	--	--	--	--	--

TY LIN INTERNATIONAL
engineers | planners | scientists
500 4th Street NW Suite 403
Bank of America Centre
Albuquerque, NM 87102

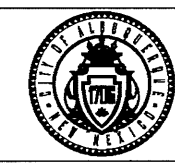

CITY OF ALBUQUERQUE
MUNICIPAL DEVELOPMENT DEPARTMENT
ENGINEERING DIVISION

TITLE: **GIRARD COMPLETE STREET PLAN
SIGNING & STRIPING
DETAILS**

Design Review Committee

City Engineer Approval

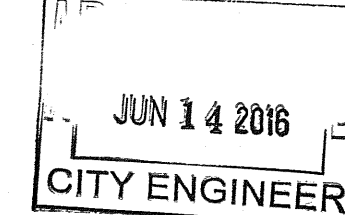
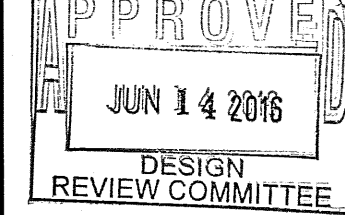

City Project No.

9042.04

Zone Map No.

J16, H16

Sheet

Of

9

9