

LADERA POND 16B

HYDROLOGY

EXISTING CONDITIONS

THE EXISTING SITE IS NOT WITHIN A DESIGNATED FLOOD ZONE. THE ENTIRE SITE DRAINS TO THE NORTH TOWARD COORS BLVD AND QUAKER HEIGHTS PLACE. SOME ONSITE PONDING DOES OCCUR PRIOR TO DRAINAGE REACHING THE POINTS OF DISCHARGE.

PROPOSED CONDITIONS

THE PROPOSED SITE DRAINAGE IMPROVEMENTS WILL INCLUDE SURFACE FLOW AND STORM DRAIN CONVEYANCE TO PERIMETER "FIRST FLUSH" WATER QUALITY PONDS.

THE STORM WATER RUNOFF WILL BE DIRECTED TO A DETENTION POND LOCATED IN LOT 9. SAID POND WILL DISCHARGE TO A STORM DRAIN THAT WILL CONVEY THE FLOW TO THE LADERA POND 16B FACILITY. SEE SEPARATE ANALYSIS OF LADERA POND FACILITY. THE DISCHARGE FROM POND WILL BE SUCH THAT EXISTING STORM DRAIN IN QUAKER HEIGHTS WILL NOT BE ADVERSELY IMPACTED BUT POND WILL DRAIN IN 24 HRS. APPROXIMATELY 3 CFS FOR 24 HOURS = 6 AC. FT.

REQUIRED FIRST FLUSH VOLUME

LOT DRAINAGE AS DEPICTED ON THIS PLAN SHALL BE MAINTAINED.

LOT DEPICTED HEREON SHALL BE RESPONSIBLE FOR MAINTAINING FIRST FLUSH RUNOFF RETENTION ON THE LOT IMMEDIATELY PRIOR TO DISCHARGE. THE VOLUME SHALL BE EQUAL TO: IMPERVIOUS AREA * (0.44-0.10)/12 IN CUBIC FEET.

IMPERVIOUS AREA = 831,900 SQ.FT.

REQUIRED VOLUME = 831,900 * (0.44-0.10)/12 = 23,571 CU.FT.
VOLUME PROVIDED = 27,670 CU.FT.

HYDROLOGIC DATA - PROPOSED

BASINS	AREA (acres)	LAND TREATMENT PERCENTAGES BY TYPE				YIELD (cfs/acre)	Q ¹⁰⁰ (cfs)	V ¹⁰⁰⁻²⁴ (acft)
		A	B	C	D			
D-1	13.36	0	10	0	90	4.13	55.23	2.04
D-2	1.26	0	10	0	90	4.14	5.20	0.19
D-3	1.39	0	10	0	90	4.14	5.76	0.21
D-4	0.82	0	10	0	90	4.15	3.40	0.12
D-5	0.99	0	10	0	90	4.15	4.09	0.15
D-6	0.93	0	10	0	90	4.23	3.93	0.14
D-7	1.51	0	10	0	90	4.14	6.23	0.23
D-8	0.94	0	10	0	90	4.15	3.88	0.14

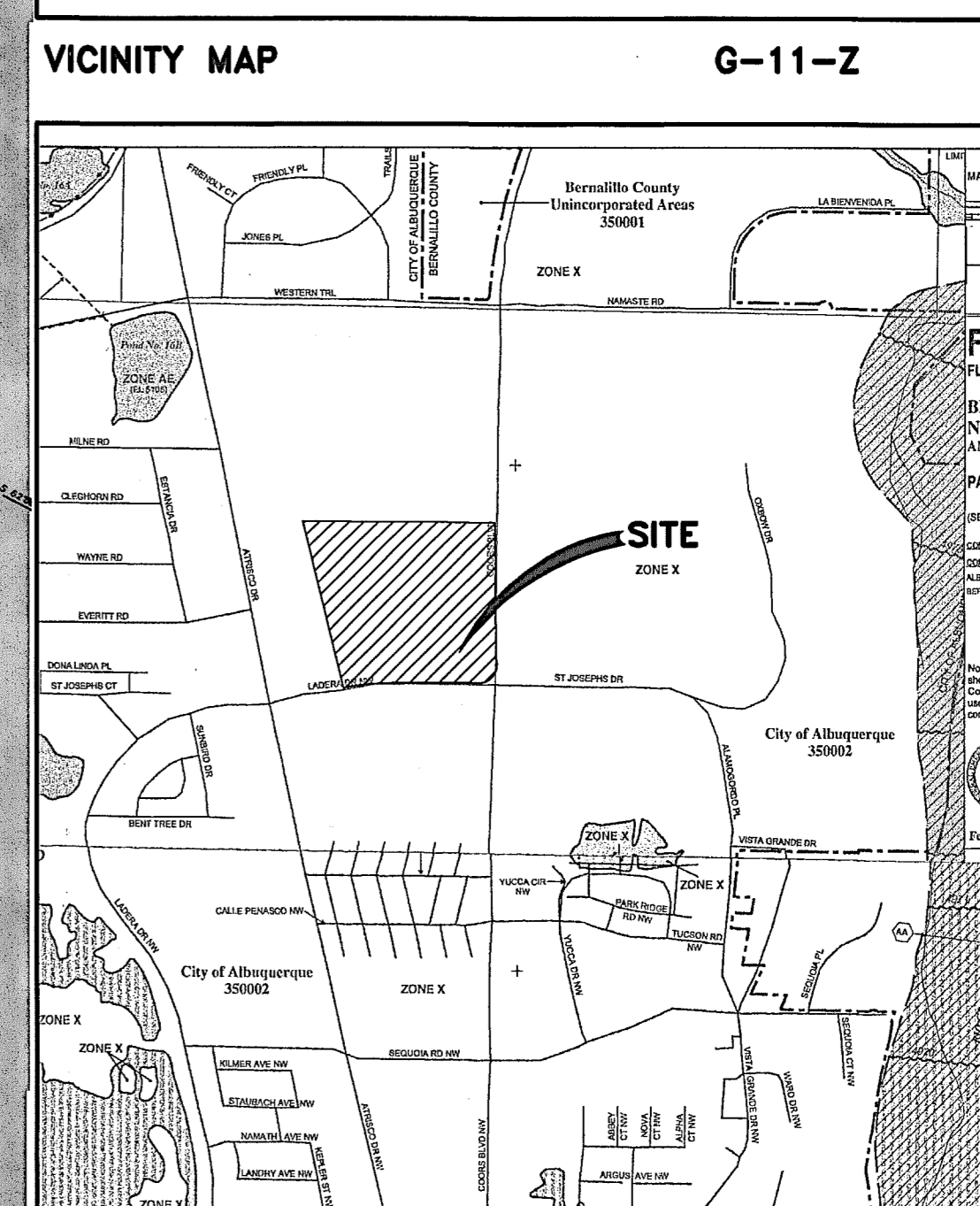
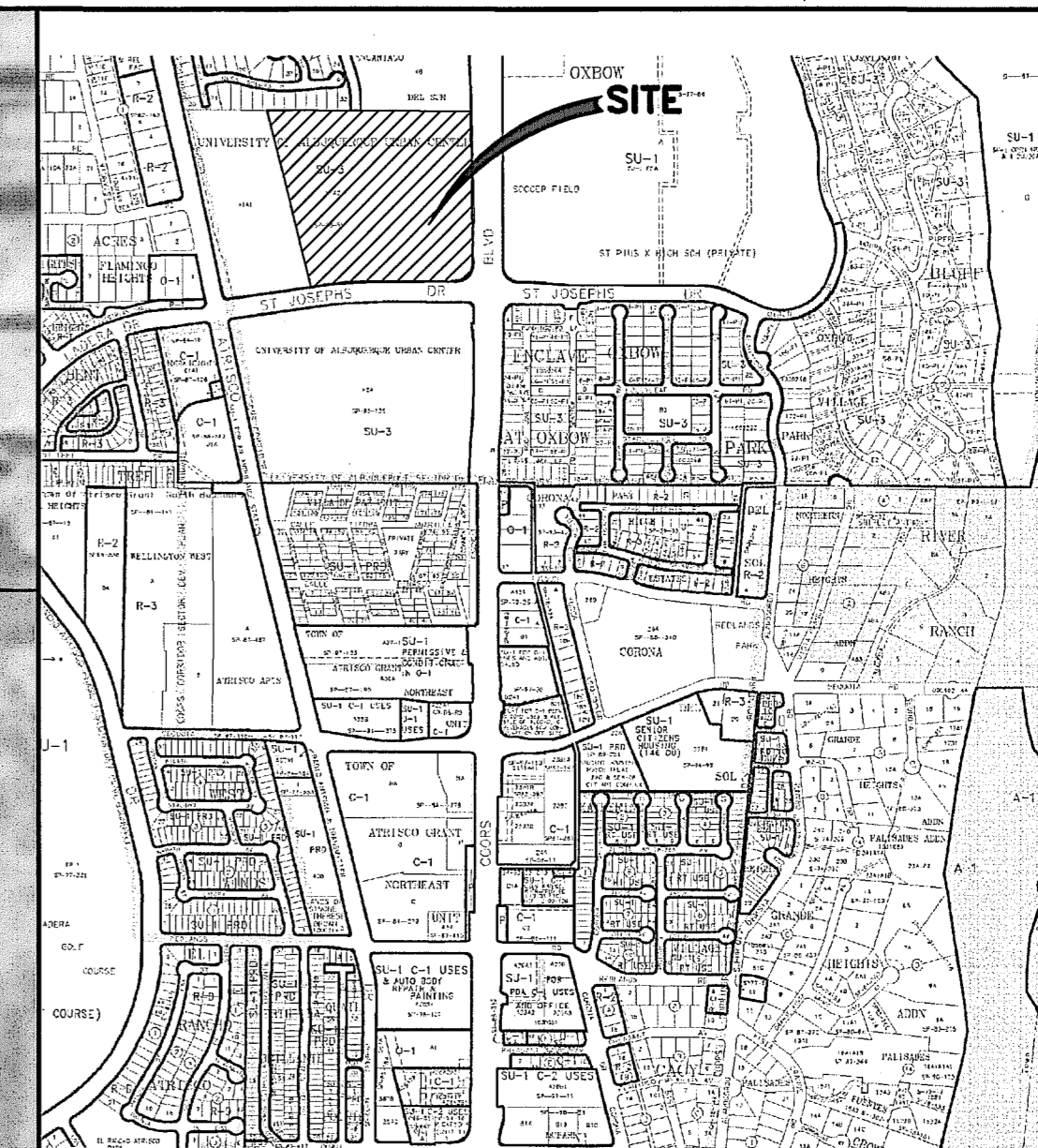

LEGAL DESCRIPTION Tracts X-1-A2 University of Albuquerque Urban Center Projected Sec. 2, T10N, R2E

LEGEND

- PROPOSED FLOW DIRECTION
- EXISTING FLOW DIRECTION
- PROPOSED BASIN

GND, LLC
CONSULTING ENGINEERS
11032 Dreamy Way Dr. NW
Albuquerque, NM 87114
Phone: (505) 264-4472
Email: agross@gndwep.com

CITY OF ALBUQUERQUE
MUNICIPAL DEVELOPMENT DEPARTMENT
ENGINEERING DIVISION
COORS PAVILION

CONCEPTUAL GRADING AND DRAINAGE PLAN

MONTH/DAY/YEAR USER DEPARTMENT

CITY PROJECT No. ZONE MAP No. SHEET 1 OF 1

AS BUILT INFORMATION	
CONTRACTOR	DATE
INSPECTOR'S	DATE
PERFORMANCE BY	DATE
VERIFICATION BY	DATE
CORRECTED BY	DATE
MICRO-FILM INFORMATION	
RECORDED BY	DATE
No.	

BENCH MARKS	
NGS/Albuquerque Control Survey Monument	
"JOSEPH 1969"	
NM State Plane Coordinates (Central Zone -NAD27)	
X=365,686.82 Y=1,502,246.75	
Delta Alpha=0015'24"	
Ground to Grid Factor=0.99967551	
Elevation=5116.61 (NAVD88)	

SURVEY INFORMATION	
FIELD NOTES	DATE
BY	
NO.	

ENGINEER'S SEAL	
NO. DATE	REMARKS
	DESIGN
DESIGNED BY: SEG	DATE: DEC 2016
DRAWN BY: SEG	DATE: DEC 2016
CHECKED BY: SEG	DATE: DEC 2016