



LADERA POND 16B

HYDROLOGY
EXISTING CONDITIONS
 THE EXISTING SITE IS NOT WITHIN A DESIGNATED FLOOD ZONE. THE ENTIRE SITE DRAINS TO THE NORTH TOWARD COORS BLVD AND OLAKEER HEIGHTS PLACE. SOME ONSITE PONDING DOES OCCUR PRIOR TO DRAINAGE REACHING THE POINTS OF DISCHARGE.

PROPOSED CONDITIONS
 THE PROPOSED SITE DRAINAGE IMPROVEMENTS WILL INCLUDE SURFACE FLOW AND STORM DRAIN CONVEYANCE TO PERIMETER FIRST FLUSH WATER QUALITY PONDS.
 THE STORM WATER RUNOFF WILL BE DIRECTED TO A STORM DRAIN TO BE LOCATED AT THE NORTHWEST CORNER THAT WILL CONVEY THE FLOW TO THE LADERA POND 16B FACILITY. SEE SEPARATE ANALYSIS OF LADERA POND FACILITY.

REQUIRED FIRST FLUSH VOLUME

LOT DRAINAGE AS DEPICTED ON THIS PLAN SHALL BE MAINTAINED.
 LOT DEPICTED HEREON SHALL BE RESPONSIBLE FOR MAINTAINING FIRST FLUSH RUNOFF RETENTION ON THE LOT IMMEDIATELY PRIOR TO DISCHARGE. THE VOLUME SHALL BE EQUAL TO: IMPERVIOUS AREA * (0.44-0.10)/12 IN CUBIC FEET.
 IMPERVIOUS AREA = 831,900 SQ.FT.
 REQUIRED VOLUME = 831,900 * (0.44-0.10)/12 = 23,571 CU.FT.
 VOLUME PROVIDED = 27,670 CU.FT.

HYDROLOGIC DATA - PROPOSED

BASINS	LAND TREATMENT PERCENTAGES BY TYPE				YIELD (cu/ft)	Q ₁₀₀ (cfs)	VOLUME (cuft)
	A	B	C	D			
D-1	13.56	0	10	0	413	55.23	2.04
D-2	1.26	0	10	0	414	5.20	0.19
D-3	1.39	0	10	0	414	5.76	0.21
D-4	0.82	0	10	0	415	3.40	0.12
D-5	0.99	0	10	0	415	4.09	0.15
D-6	0.93	0	10	0	423	3.93	0.14
D-7	1.51	0	10	0	414	6.23	0.23
D-8	0.94	0	10	0	415	3.88	0.14

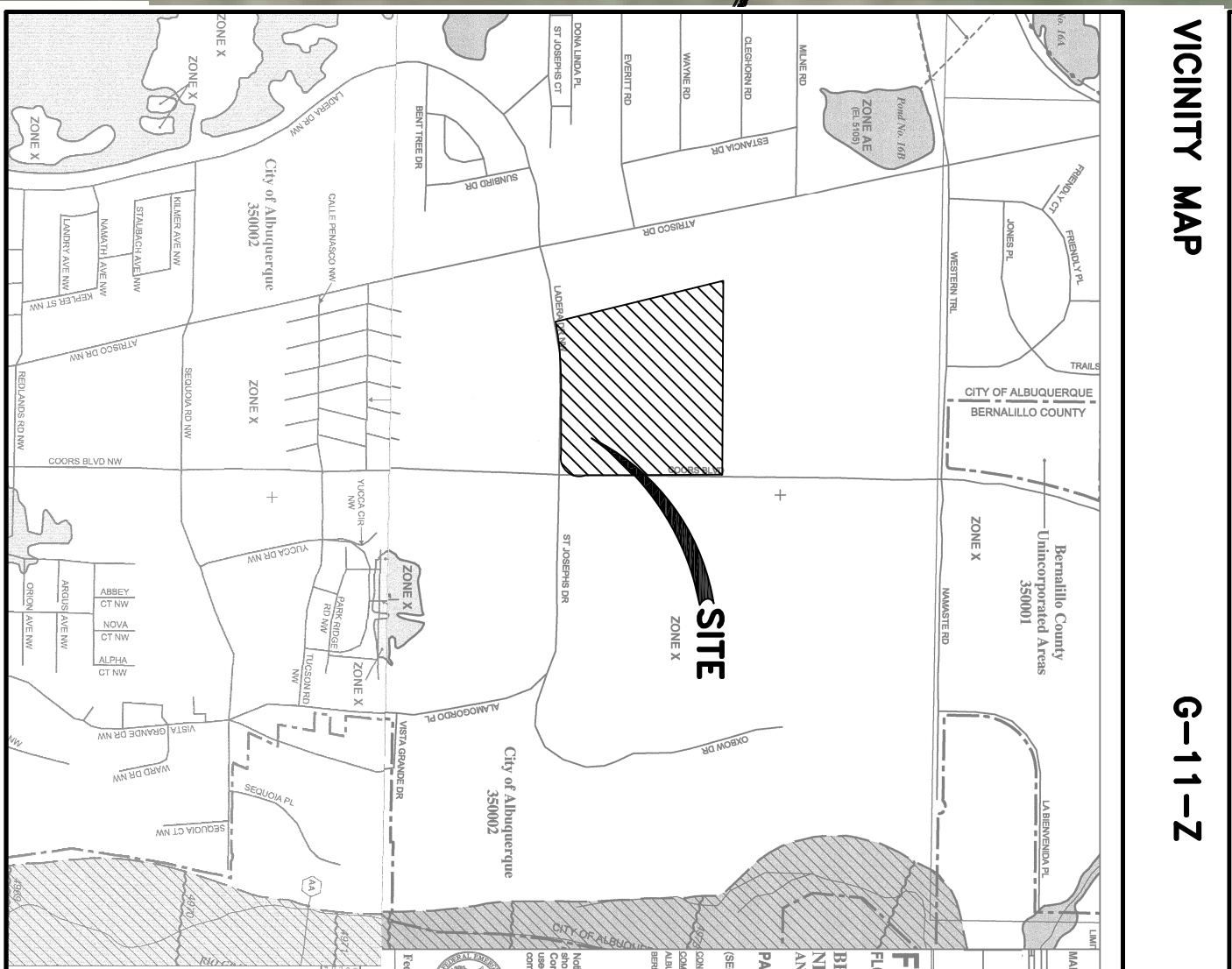

LEGAL DESCRIPTION
 Tracts X-1-1-A2
 University of Albuquerque Urban Center
 Projected Sec. 2, T10N, R2E

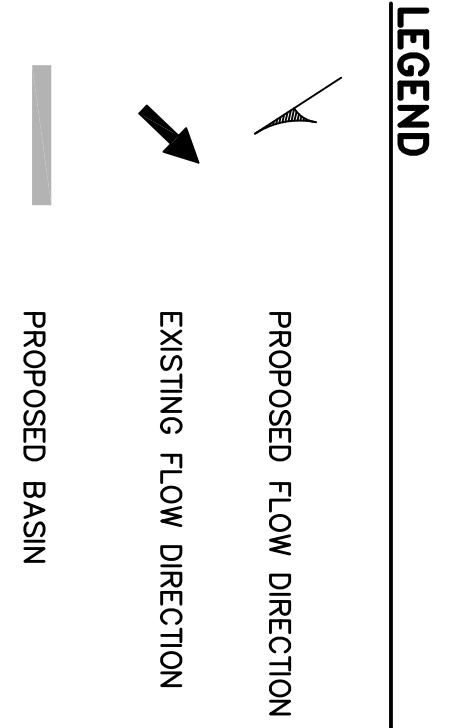

GND, LLC
 CONSULTING ENGINEERS

CITY OF ALBUQUERQUE
 MUNICIPAL DEVELOPMENT DEPARTMENT
 ENGINEERING DIVISION

CONCEPTUAL GRADING AND DRAINAGE PLAN

MONTH/DA/YEAR	USER DEPARTMENT	
CITY PROJECT No.	ZONE MAP No.	SHEET
	G-11	1 OF 1

AS BUILT INFORMATION	
CONTRACTOR	DATE
WORK STAKED BY	DATE
INSPECTOR'S ACCEPTANCE BY	DATE
FIELD VERIFICATION BY	DATE
DRAWINGS CORRECTED BY	DATE
MICRO-FILM INFORMATION	
RECORDED BY	DATE
No.	

BENCH MARKS	
NGS/Albuquerque Control Survey Monument	
"JOSEPH 1969"	
NM State Plane Coordinates (Central Zone -NAD27)	
X=366,686.82 Y=1,502,246.75	
Delta Alpha=-00'15"24"	
Ground to Grid Factor=0.99967551	
Elevation=5116.61 (NAVD88)	

SURVEY INFORMATION		
FIELD NOTES		
NO.	BY	DATE

ENGINEER'S SEAL

NO.	DATE	REMARKS	BY

DESIGNED BY: SEG DATE: NOV 2016
 DRAWN BY: SEG DATE: NOV 2016
 CHECKED BY: SEG DATE: NOV 2016