



LADERA POND 16B

PROPOSED 60 SD

PROPOSED 54' SD

FIRST FLUSH WATER QUALITY POND 4280 CU. FT.

FIRST FLUSH WATER QUALITY POND 5340 CU. FT.

FIRST FLUSH WATER QUALITY POND 1000 CU. FT.

FIRST FLUSH WATER QUALITY POND 7550 CU. FT.

FIRST FLUSH WATER QUALITY POND 1500 CU. FT.

FIRST FLUSH WATER QUALITY POND 1500 CU. FT.

HYDROLOGIC DATA - PROPOSED

BASINS	AREA (Acres)	LAND TREATMENT PERCENTAGES BY TYPE				YIELD (CUB/AC)	Q ₁₀₀ (CFS)	VOLUME (CUFT)
		A	B	C	D			
D-1	13.56	0	10	0	90	413	55,23	2,04
D-2	1.26	0	10	0	90	414	5,20	0.19
D-3	1.39	0	10	0	90	414	5,76	0.21
D-4	0.82	0	10	0	90	415	3,40	0.12
D-5	0.93	0	10	0	90	415	4,09	0.15
D-6	0.93	0	10	0	90	423	3,93	0.14
D-7	1.51	0	10	0	90	414	6,23	0.23
D-8	0.94	0	10	0	90	415	3,88	0.14

HYDROLOGY
EXISTING CONDITIONS
 THE EXISTING SITE IS NOT WITHIN A DESIGNATED FLOOD ZONE. THE ENTIRE SITE DRAINS TO THE NORTH TOWARD COORS BLVD AND QUAKER HEIGHTS PLACE. SOME ONSITE PONDING DOES OCCUR PRIOR TO DRAINAGE REACHING THE POINTS OF DISCHARGE.

PROPOSED CONDITIONS
 THE PROPOSED SITE DRAINAGE IMPROVEMENTS WILL INCLUDE SURFACE FLOW AND STORM DRAIN CONVEYANCE TO PERIMETER FIRST FLUSH WATER QUALITY PONDS.
 THE STORM WATER RUNOFF WILL BE DIRECTED TO A STORM DRAIN TO BE LOCATED AT THE NORTHWEST CORNER AND CONVEY THE FLOW TO THE LADERA POND 16B FACILITY. SEE SEPARATE ANALYSIS OF LADERA POND FACILITY.

REQUIRED FIRST FLUSH VOLUME

LOT DRAINAGE AS DEPICTED ON THIS PLAN SHALL BE MAINTAINED.
 LOT DEPICTED HEREON SHALL BE RESPONSIBLE FOR MAINTAINING FIRST FLUSH RUNOFF RETENTION ON THE LOT IMMEDIATELY PRIOR TO DISCHARGE. THE VOLUME SHALL BE EQUAL TO: IMPERVIOUS AREA * (0.44-0.10)/12 IN CUBIC FEET.
 IMPERVIOUS AREA = 831,900 SQ.FT.
 REQUIRED VOLUME = 831,900 * (0.44-0.10)/12 = 23,571 CU.FT.
 VOLUME PROVIDED = 27,670 CU.FT.

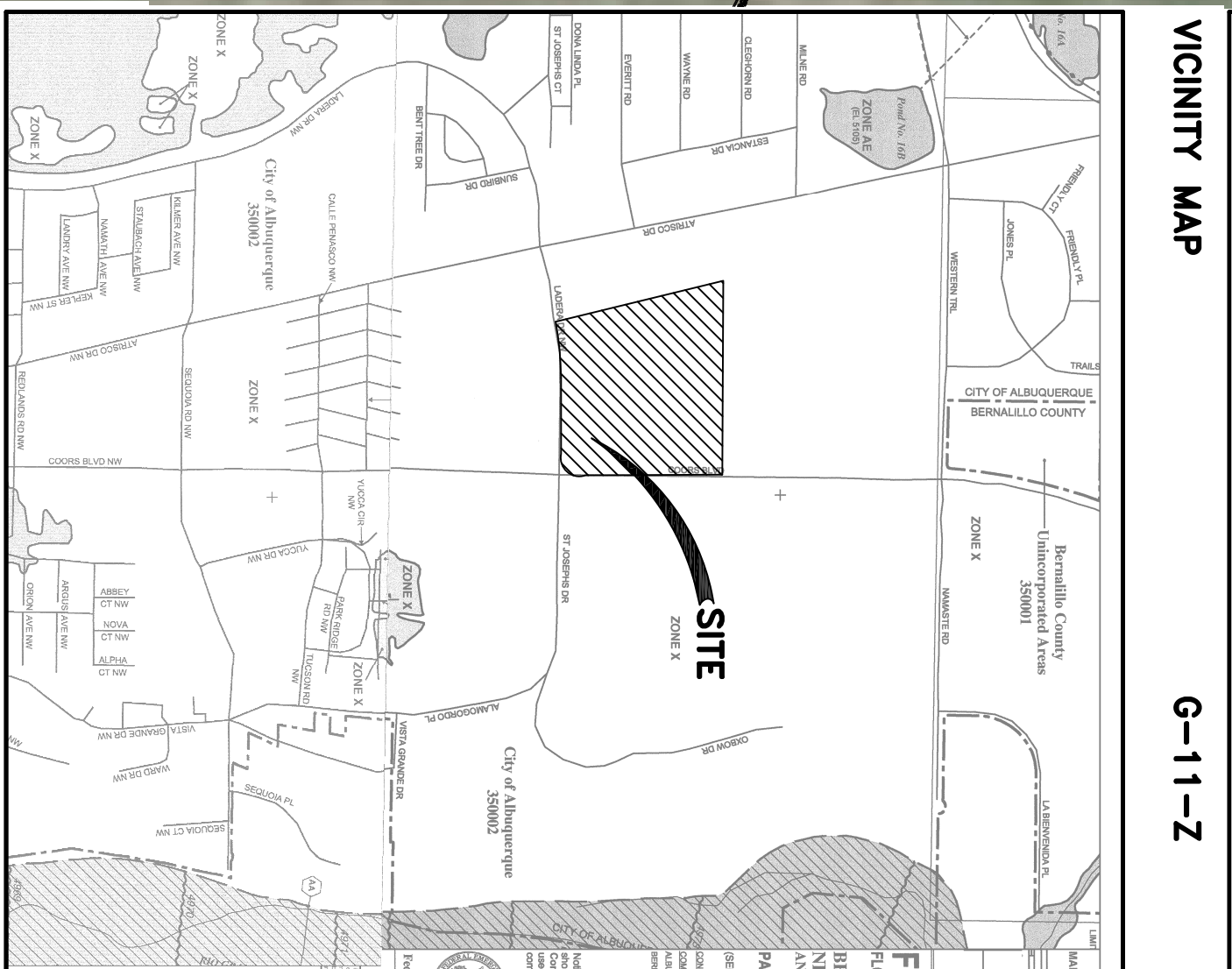

AS BUILT INFORMATION

CONTRACTOR	DATE
WORK STAKED BY	DATE
INSPECTOR'S ACCEPTANCE BY	DATE
FIELD VERIFICATION BY	DATE
DRAWINGS CORRECTED BY	DATE
MICRO-FILM INFORMATION	
RECORDED BY	DATE
No.	

BENCH MARKS

NGS/Albuquerque Control Survey Monument
"JOSEPH 1969"
NM State Plane Coordinates (Central Zone -NAD27)
X=366,686.82 Y=1,502,246.75
Delta Alpha=-00'15"24"
Ground to Grid Factor=0.99967551
Elevation=5116.61 (NAVD88)

SURVEY INFORMATION

FIELD NOTES		
NO.	BY	DATE

ENGINEER'S SEAL

3500100114E
3500100327E

LEGAL DESCRIPTION
 Tracts X-1-1-A2
 University of Albuquerque Urban Center
 Projected Sec. 2, T10N, R2E

LEGEND

- PROPOSED FLOW DIRECTION
- EXISTING FLOW DIRECTION
- PROPOSED BASIN

GND, LLC
 CONSULTING ENGINEERS
 11000 Broadway, Suite 300, NW
 Albuquerque, NM 87114
 Phone: (505) 253-4422
 Fax: (505) 253-4422

CITY OF ALBUQUERQUE
 MUNICIPAL DEVELOPMENT DEPARTMENT
 ENGINEERING DIVISION
 COORS PAVILION

CONCEPTUAL GRADING AND DRAINAGE PLAN

MONTH/DA/Y/EAR

USER DEPARTMENT

NO.	DATE	REMARKS	BY

DESIGNED BY: SEG DATE: OCT 2016
 DRAWN BY: SEG DATE: OCT 2016
 CHECKED BY: SEG DATE: OCT 2016

LATEST DESIGN UPDATE

MONTH/DA/Y/EAR	USER DEPARTMENT

CITY PROJECT No. G-11 ZONE MAP No. G-11 SHEET 1 OF 1