

**ORIGINAL**

**EXHIBIT A (REVISED 5/10/99)**  
TO SUBDIVISION IMPROVEMENT AGREEMENT  
DEVELOPMENT REVIEW BOARD  
REQUIRED INFRASTRUCTURE LIST  
(LEGAL DESCRIPTION OF SUBDIVISION)

Casa Pacifica Condominiums  
(NAME and UNIT OF SUBDIVISION)

Application No.: 1000534  
D.R.C. Project No.: \_\_\_\_\_  
Prelim. Plat Approved: 10/11/00  
Prelim. Plat Expires: 10/11/01  
Site Plan Approved: 10/11/01

Date Submitted: 9-15-00

Following is a summary of PUBLIC/PRIVATE Infrastructure required to be constructed or financially guaranteed for the above development. This listing is not necessarily a complete listing. During the SIA process and/or in the review of the construction drawings, if the DRC Chair determines that appurtenant items and/or unforeseen items have not been included in the infrastructure listing, the DRC Chair may include those items in the listing and related financial guarantee. Likewise, if the DRC Chair determines that appurtenant or non essential items can be deleted from the listing, those items may be deleted as well as the related portions of the financial guarantees. All such revisions require approval by the DRC Chair, the User Department and agent/owner. If such approvals are obtained, these revisions to the listing will be incorporated administratively. In addition, any unforeseen items which arise during construction which are necessary to complete the project and which normally are the Subdivider's responsibility will be required as a condition of the project acceptance and close out by the City.

<u>Size</u>	<u>Type Improvement</u>	<u>Location</u>	<u>From</u>	<u>To</u>
<b>WATER</b>				
6"	Waterline	A Street	Exist WL Spain Rd	B Street
6"	Waterline	B Street	A Street	C Street
6"	Waterline	C Street	B Street	Exist WL Spain Rd.
6"	Waterline	D Street	C Street	E Street
6"	Waterline	E Street	C Street	D Street
<b>SANITARY SEWER</b>				
8"	Sanitary Sewer	A Street	Exist SAS Spain Rd	20' SAS Easem.
8"	Sanitary Sewer	20' Easem	A Street	Ex SAS MH@ SW Prop Line
8"	Sanitary Sewer	B Street	A Street	C Street
8"	Sanitary Sewer	C Street	B Street	End
8"	Sanitary Sewer	D Street	C Street	End

**ORIGINAL**

**EXHIBIT A (REVISED 5/10/99)**  
**TO SUBDIVISION IMPROVEMENT AGREEMENT**  
**DEVELOPMENT REVIEW BOARD**  
**REQUIRED INFRASTRUCTURE LIST**  
**(LEGAL DESCRIPTION OF SUBDIVISION)**

Casa Pacifica Condominiums  
 (NAME and UNIT OF SUBDIVISION)

Application No.: 1000534  
 D.R.C. Project No.: \_\_\_\_\_  
 Prelim. Plat Approved: \_\_\_\_\_  
 Prelim. Plat Expires: \_\_\_\_\_  
 Site Plan Approved: \_\_\_\_\_

Date Submitted: 9-15-00

<u>Size</u>	<u>Type Improvement</u>	<u>Location</u>	<u>From</u>	<u>To</u>
<b>STORM DRAIN</b>				
Per Design	<del>Drainage Channel</del>	20' Easem.	<del>End C Street</del>	Spain Rd <i>AM</i>
Per Design	<del>Drainage Channel</del>	20' Easem.	<del>End D Street</del>	Spain Rd <i>AM</i>
Per Design	Sidwalk Culvert	Public R/W	Open Space	Spain Rd
Per Design	<del>Drainage Channel</del>	<del>West Prop Line</del>	<del>South Pt</del>	Spain Rd <i>AM</i>

Grading and Drainage Certification per DPM including Perimeter Walls as shown on the Grading Plan for Release of SIA and Financial Guarantees. ~~Financial Guarantee is not required for this item.~~ *AM*

Water infrastructure to include valves, fittings, valveboxes and fire hydrants.

Sanitary sewer to include manholes and service connections.

Street lights per DPM.

Signature: *Diane Hoelzer*  
 Agent/Owner Print Name: Diane Hoelzer, PE  
 Firm: Mark Goodwin & Associates, PA

**DEVELOPMENT REVIEW BOARD MEMBER APPROVALS**

<u><i>[Signature]</i></u> Transportation Dev.	<u>10-11-00</u> Date	<u><i>Roger Sheen</i></u> Utility Dev.	<u>10/11/00</u> Date	<u><i>Alisonne E. Cordiano</i></u> Parks & Recreation	<u>10/11/00</u> Date
_____	Date	<u><i>Paul Mering</i></u> Engineer/AMAFCA	<u>10/11/00</u> Date	<u><i>[Signature]</i></u> DRB Chairman	<u>10/11/00</u> Date

**ORIGINAL**

**EXHIBIT A (REVISED 5/10/99)**  
TO SUBDIVISION IMPROVEMENT AGREEMENT  
DEVELOPMENT REVIEW BOARD  
REQUIRED INFRASTRUCTURE LIST  
(LEGAL DESCRIPTION OF SUBDIVISION)

Casa Pacifica Condominiums  
(NAME and UNIT OF SUBDIVISION)

Application No.: 1000534  
D.R.C. Project No.: \_\_\_\_\_  
Prelim. Plat Approved: \_\_\_\_\_  
Prelim. Plat Expires: \_\_\_\_\_  
Site Plan Approved: \_\_\_\_\_

Date Submitted: 9-15-00

**DRC REVISIONS**

REVISIONS	DATE	DRC CHAIR	USER DEPT	AGENT/OWNER
①				
②				

OSO GRANDE SUBDIVISION  
(12-23-81, C19-53)

TRACT B-1

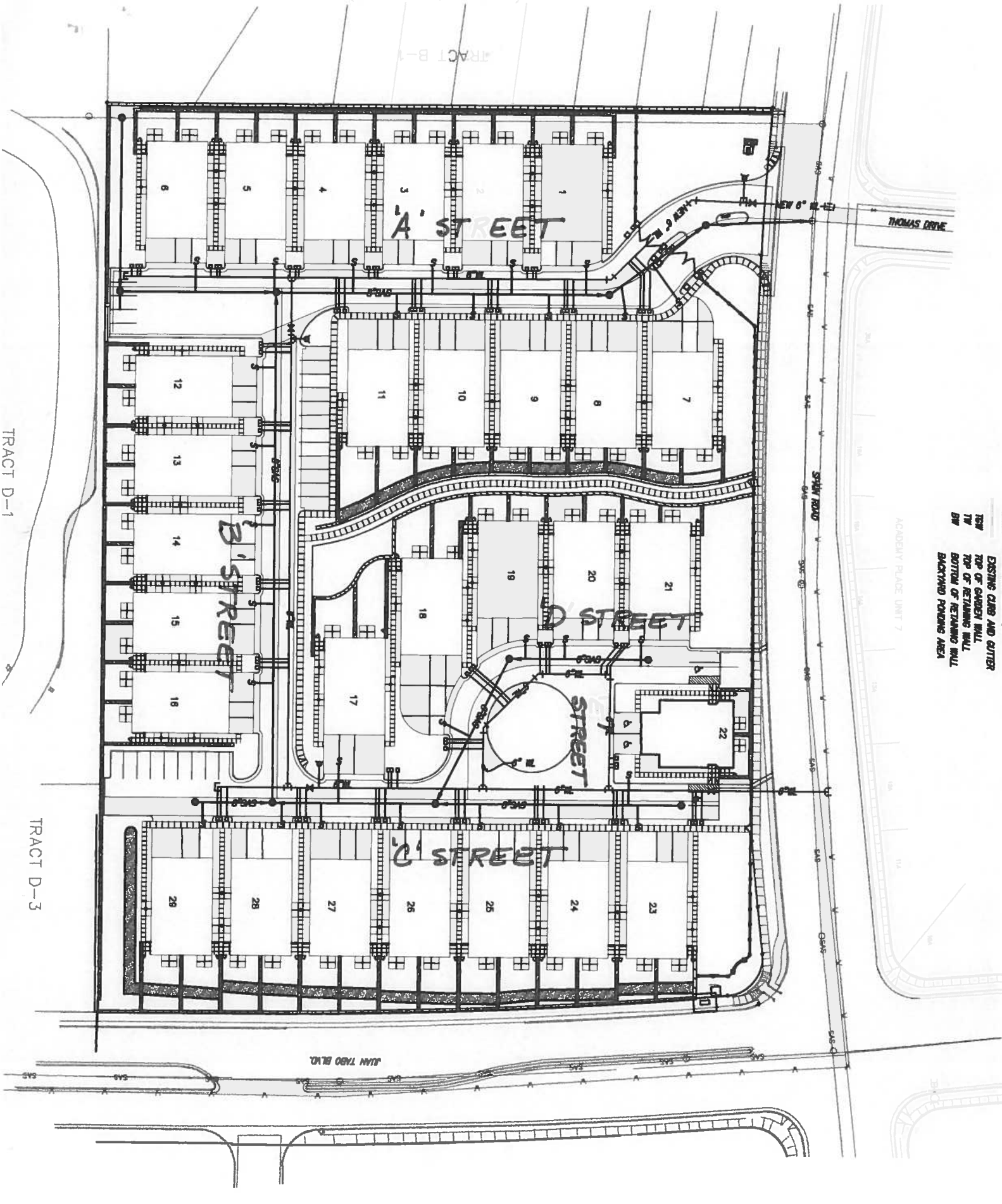

- EXISTING CURB AND GUTTER
- TOP OF GARDEN WALL
- TOP OF RETAINING WALL
- BOTTOM OF RETAINING WALL
- BACKWARD FLOWING AREA

TRACT D-1

TRACT D-3

JUAN TABO BLVD.

THOMAS DRIVE

SULLY ROAD

ACADEMY PLACE UNIT 7

D STREET

C' STREET

A' STREET

B' STREET