

EXISTING INDIAN PUEBLO CULTURAL CENTER

EXISTING RETAIL

LEGEND

- FUTURE BUILDING PAD
- TEMPORARY CRUSHER FINE BY OWNER. C.O.A. WILL DO FULL SIDEWALK IMPROVEMENTS
- NEW CONCRETE WALKWAY
- NEW SCORED SLAB AT PATIO WITH INTEGRATED COLOR
- NEW LANDSCAPING
- EXISTING CONCRETE WALKWAY
- EXISTING CARRIAGE LANDSCAPE STRIP VERIFY TREE REQUIREMENTS.
- NEW CARRIAGE STRIP AND LANDSCAPING 6'-0" WIDE PER CITY OF ALBUQUERQUE PROJECT # 7186.92
- CONCRETE SIDEWALK 10'-0" WIDE PER CITY OF ALBUQUERQUE PROJECT # 7186.92
- DEPRESSED "FIRST FLUSH" PONDING AND LANDSCAPING AT MEDIANS. REFER TO CIVIL DWGS

A1 SITE PLAN
SCALE 1" = 30'

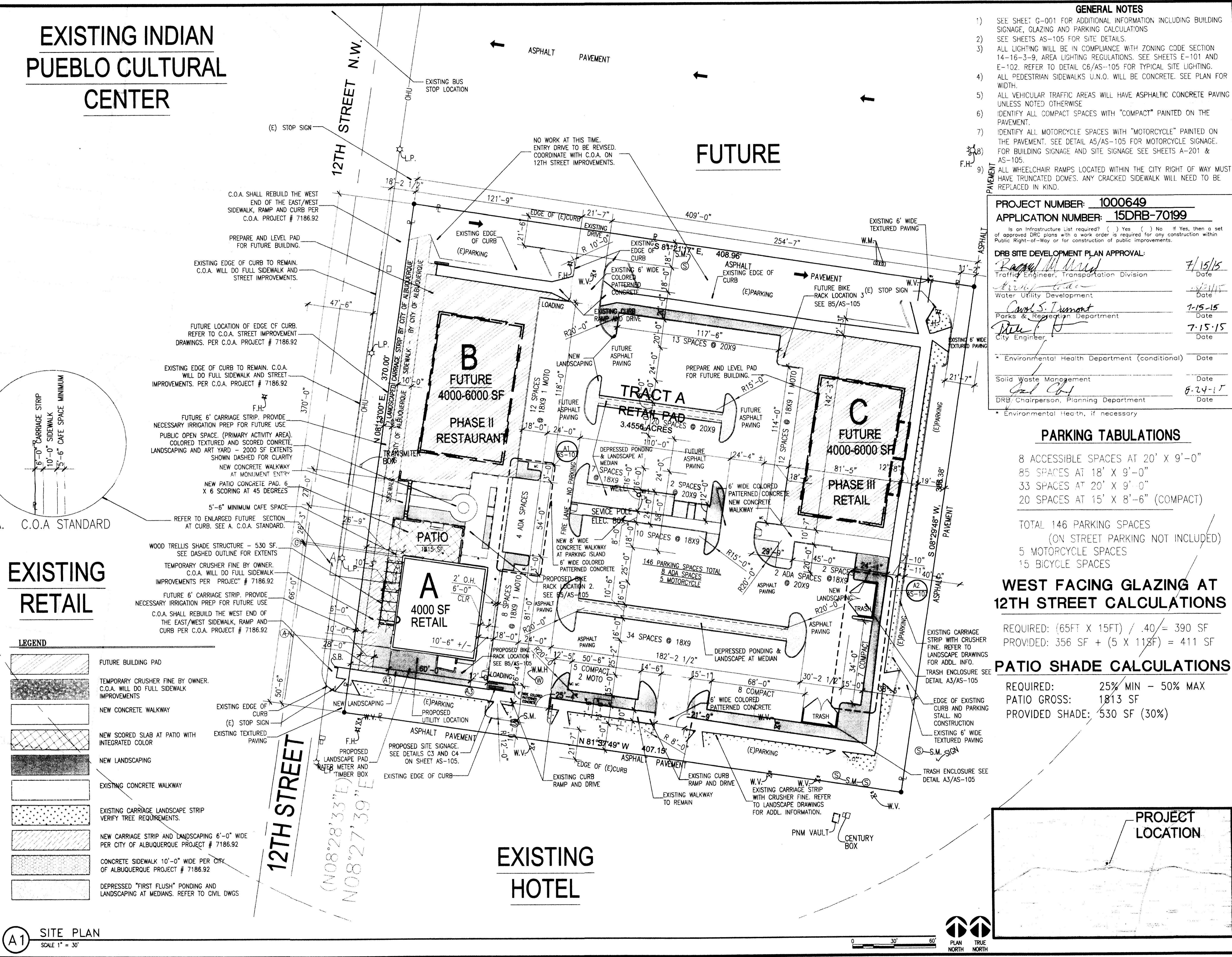

FUTURE

EXISTING HOTEL

- GENERAL NOTES**
- SEE SHEET G-001 FOR ADDITIONAL INFORMATION INCLUDING BUILDING SIGNAGE, GLAZING AND PARKING CALCULATIONS
 - SEE SHEETS AS-105 FOR SITE DETAILS.
 - ALL LIGHTING WILL BE IN COMPLIANCE WITH ZONING CODE SECTION 14-16-3-9, AREA LIGHTING REGULATIONS. SEE SHEETS E-101 AND E-102. REFER TO DETAIL C6/AS-105 FOR TYPICAL SITE LIGHTING.
 - ALL PEDESTRIAN SIDEWALKS U.N.O. WILL BE CONCRETE. SEE PLAN FOR WIDTH.
 - ALL VEHICULAR TRAFFIC AREAS WILL HAVE ASPHALTIC CONCRETE PAVING UNLESS NOTED OTHERWISE
 - IDENTIFY ALL COMPACT SPACES WITH "COMPACT" PAINTED ON THE PAVEMENT.
 - IDENTIFY ALL MOTORCYCLE SPACES WITH "MOTORCYCLE" PAINTED ON THE PAVEMENT. SEE DETAIL A5/AS-105 FOR MOTORCYCLE SIGNAGE. FOR BUILDING SIGNAGE AND SITE SIGNAGE SEE SHEETS A-201 & AS-105.
 - ALL WHEELCHAIR RAMPS LOCATED WITHIN THE CITY RIGHT OF WAY MUST HAVE TRUNCATED DOMES. ANY CRACKED SIDEWALK WILL NEED TO BE REPLACED IN KIND.

PROJECT NUMBER: 1000649
APPLICATION NUMBER: 15DRB-70199

Is an Infrastructure List required? () Yes () No If Yes, then a set of approved DRC plans with a work order is required for any construction within Public Right-of-Way or for construction of public improvements.

DRB SITE DEVELOPMENT PLAN APPROVAL:

<i>Raguel M. Uribe</i>	7/15/15
Traffic Engineer, Transportation Division	Date
<i>W. J. ...</i>	7/15/15
Water Utility Development	Date
<i>Carol S. Trueman</i>	7-15-15
Parks & Recreation Department	Date
<i>Robert P. ...</i>	7-15-15
City Engineer	Date
Environmental Health Department (conditional)	Date
Solid Waste Management	Date
<i>Paul ...</i>	8-24-15
DRB Chairperson, Planning Department	Date
Environmental Health, if necessary	Date

PARKING TABULATIONS

8 ACCESSIBLE SPACES AT 20' X 9'-0"
85 SPACES AT 18' X 9'-0"
33 SPACES AT 20' X 9' 0"
20 SPACES AT 15' X 8'-6" (COMPACT)

TOTAL 146 PARKING SPACES
(ON STREET PARKING NOT INCLUDED)
5 MOTORCYCLE SPACES
15 BICYCLE SPACES

WEST FACING GLAZING AT 12TH STREET CALCULATIONS

REQUIRED: (65FT X 15FT) / .40 = 390 SF
PROVIDED: 356 SF + (5 X 113F) = 411 SF

PATIO SHADE CALCULATIONS

REQUIRED: 25% MIN - 50% MAX
PATIO GROSS: 1813 SF
PROVIDED SHADE: 530 SF (30%)

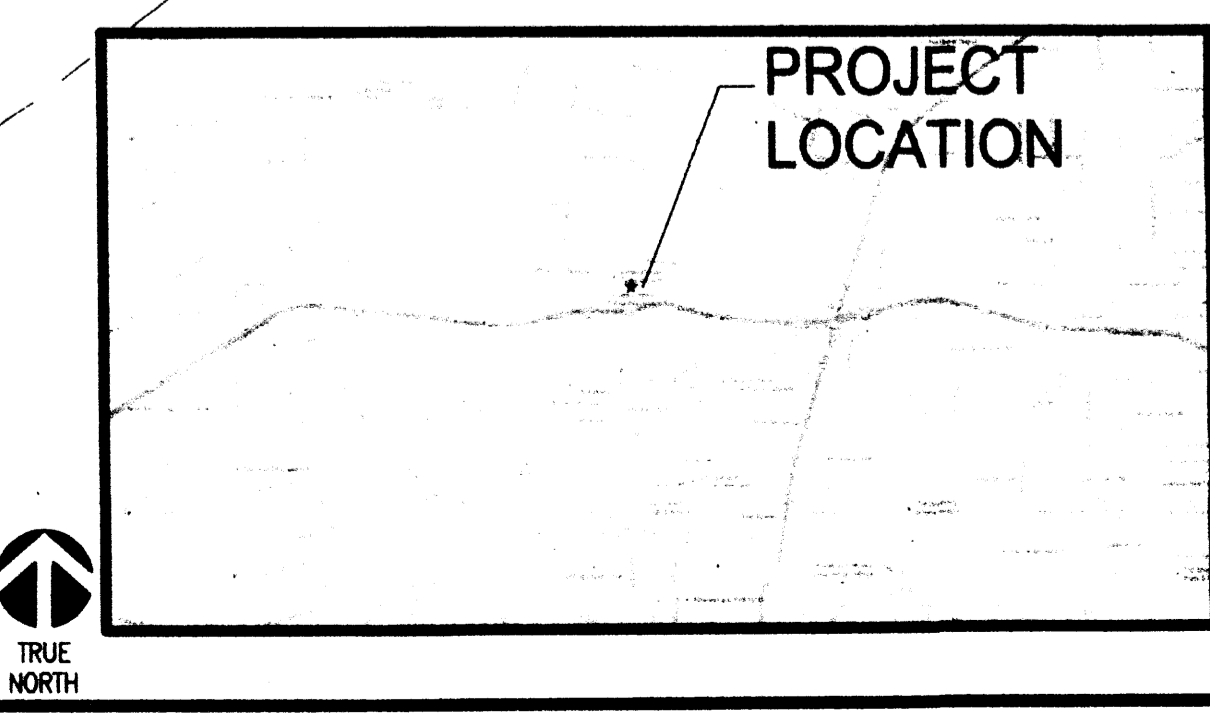

STUDIO SW ARCHITECTS

STUDIO SOUTHWEST ARCHITECTS, INC.
2101 Mountain Rd. NW, Albuquerque, NM 87104
505.843.9639 fax 505.843.9683
Web Site: www.studioswarch.com
E-Mail: mail@studioswarch.com

© 2015, Studio Southwest Architects, Inc. Duplication or reproduction by any means without the express written consent of Studio Southwest Architects, Inc. is a violation of Federal and International law. The information contained on this document is the intellectual property of Studio Southwest, Inc. and all rights thereto are Reserved. For exceptions, refer to the Owner-Architect Agreement.

CONSULTANTS

Architect	Engineer
DRB SUBMITTAL	

AIS MASTER PLAN PHASE 1

2400 12TH STREET
ALBUQUERQUE NM 87104

MARK	DATE	DESCRIPTION
1	6/17/15	DRB REVISIONS
ISSUE:		DRB
PROJECT NO:		1513
CAD DWG FILE:		1513 AS-101.RVT
DRAWN BY:		DSJ
CHECKED BY:		RH
DATE:		04/20/2015

SHEET TITLE
PAD1 SITE PLAN FOR BUILDING PERMIT

AS-101

1000649

