

SIGNATURES

D.R.B. CASE #: 01500-1658  
E.P.C. CASE #: 01110 00767  
01128 00768

I certify that this area is zoned SU-1 for C-1 and O-1 permissive uses and restaurant with full service liquor, B. & B., and Meeting and Conference Facility with Full Service Liquor and that this plan is consistent with the specific site development plan approved by the Environmental Planning Commission (EPC) on August 15, 2001, and that the findings in the Official Notice have been complied with.

SITE DEVELOPMENT PLAN

*Richard D. Daulton* 11/21/01  
Traffic Engineer, Public Works

*Wendy E. Carls* 11/21/01  
Parks and Recreation Dept.

N/A  
ANAFCA

*Barry D. Brighan* 11/21/01  
City Engineer, Public Works  
Engineering Division / ANAFCA

APPROVAL AND CONDITIONAL ACCEPTANCE: as specified by the Development Process Manual.

*Paul J. ...* 12/9/01  
City Planner  
Buenos Aires Planning Dept.

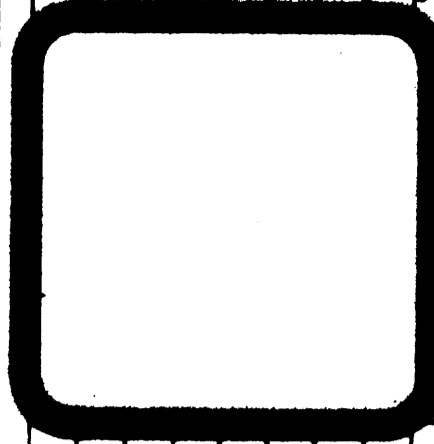

**ERIC MILLER ARCHITECT** AIA  
2427 ZEARING AVE. N.E.  
ALBUQUERQUE, NEW MEXICO 87104  
PHONE: (505) 764-0882  
FAX: (505) 764-0887

**RIO GRANDE PLAZA**  
PROFESSIONAL OFFICES AND SPECIALTY SHOPS  
ALBUQUERQUE NEW MEXICO

**DRAWN BY:** CJ  
**DATE:** 10/22/01  
**REVISIONS:**  
01-15-01 ADMIN. AMEND.  
11-09-01 EPC REZONING

**ARCHITECTURAL**  
**DRB**  
**SHT. 1**  
**OF 11**

PROJECT DATA

Table with project statistics including Site Area (4.20 acres), Floor Area Ratio (31), Building Area, and Parking/Bicycle Spaces.

**SIGNATURES**  
ERIC MILLER ARCHITECT  
APPROVED AND CONDITIONAL ACCEPTANCE: as specified by the Development Process Manual.

PROJECT DATA table with columns for BLDG. A through H, detailing floor area, building area, and parking requirements.

SITE PLAN SCALE: 1" = 20'

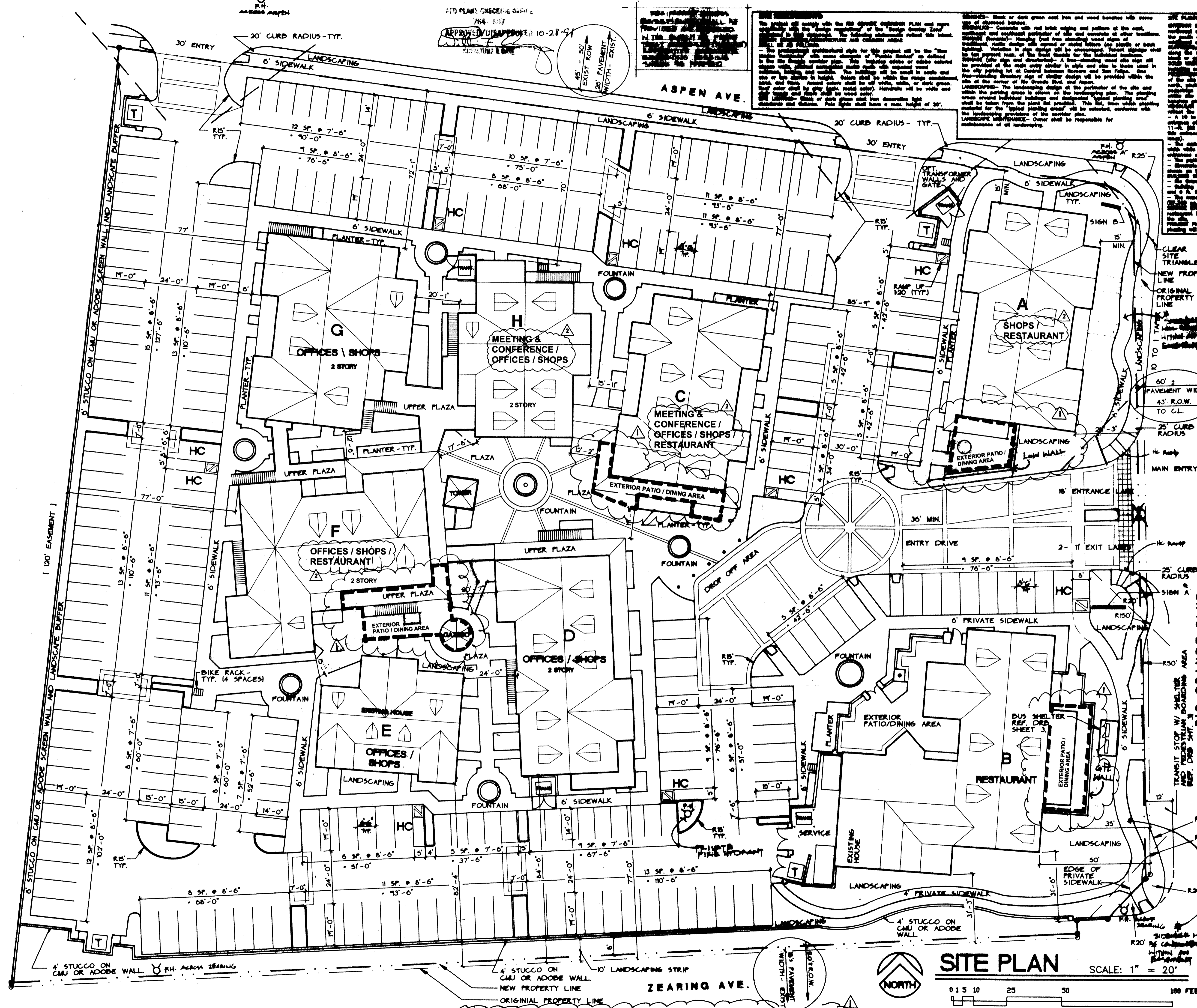
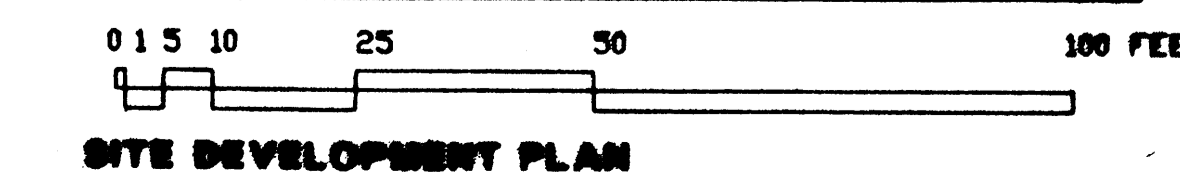

NOTE: NO AMPLIFIED MUSIC IS PERMITTED ON THE SITE AT ANY TIME