

Current DRC
Project Number:

ORIGINAL

FIGURE 12

INFRASTRUCTURE LIST

**EXHIBIT "A"
TO SUBDIVISION IMPROVEMENTS AGREEMENT
DEVELOPMENT REVIEW BOARD (D.R.B.) REQUIRED INFRASTRUCTURE LIST**

Date Submitted: 2/17/03
Date Site Plan Approved: N/A
Date Preliminary Plat Approved: 3/12/03
Date Preliminary Plat Expires: 3/12/04
DRB Project No.: 1001267
DRB Application No.: 3DRB-00021

Desert Pine Unit 4

PROPOSED NAME OF PLAT AND/OR SITE DEVELOPMENT PLAN

Tract 46, 47, and 48, Town of Atrisco Grant, Unit 2

EXISTING LEGAL DESCRIPTION PRIOR TO PLATTING ACTION

Following is a summary of PUBLIC/PRIVATE infrastructure required to be constructed or financially guaranteed for the above development. This Listing is not necessarily a complete listing. During the SIA process and/or in the review of the construction drawings, if the DRC Chair determines that appurtenant items and/or unforeseen items have not been included in the infrastructure listing, the DRC Chair may include those items in the listing and related financial guarantee. Likewise, if the DRC Chair determines that appurtenant or non-essential items can be deleted from the listing, those items may be deleted as well as the related portions of the financial guarantees. All such revisions require approval by the DRC Chair, the User Department and agent/owner. If such approvals are obtained, these revisions to the listing will be incorporated administratively. In addition, any unforeseen items which arise during construction which are necessary to complete the project and which normally are the Subdivider's responsibility will be required as a condition of project acceptance and close out by the City.

SIA Sequence #	COA DRC Project #	Size	Type of Improvement	Location	From	To	Private Inspector	City Inspector	City Cnst Engineer
		28' FF 4' * 4' **	PAVING Perm Pvmt Sidewalk (west side) Sidewalk (east) C & G (both sides)	Risa Springs Drive	Dakota Ridge Rd.	Round Rock Rd.	/	/	/
		28' FF 4' * 4' **	Perm Pvmt Sidewalk (east side) Sidewalk (west side) C & G (both sides)	Fern Spring Dr.	Dakota Ridge Rd.	Round Rock Rd.	/	/	/
		28' FF 4' *	Perm Pvmt Sidewalk (both sides) C & G (both sides)	Cole Springs Dr.	Dakota Ridge Rd.	Round Rock Rd.	/	/	/
		28' FF 4' *	Perm Pvmt Sidewalk (both sides) C & G (both sides)	Desert Maize Dr.	Dakota Ridge Rd.	Round Rock Rd.	/	/	/
		24' FF 4' *	Perm Pvmt Sidewalk (east side) C & G (both sides)	Desert Maize Dr.	Dakota Ridge Rd.	End of Stub St.	/	/	/
		24' FF 4' *	Perm Pvmt Sidewalk (east side) C & G (both sides)	Desert Maize Dr.	End of Stub St.	Round Rock Rd.	/	/	/

ORIGINAL

NAME OF PLAT AND/OR SITE PLAN Desert Pine, Unit 4

SIA Sequence #	COA DRC Project #	Size	Type of Improvement	Location	From	To	Private Inspector	City Inspector	City Cnst Engineer
		30' FF 4' *	PAVING CONT. Perm Pvmnt Sidewalk (both sides) C & G (both sides)	Pincher Creek Rd.	Eucariz Ave.	Round Rock Rd.	/	/	/
		18' FE 4' *	Perm Pvmnt Sidewalk (east side) C & G (east side) Temp Pavement	90th St.	Eucariz Ave.	North Prop. Line of City park on west	/	/	/
		28' FF 4' * 4' **	Perm Pvmnt Sidewalk (south side) Sidewalk (north side) C & G (both sides)	Round Rock Rd.	Risa Springs Dr.	Desert Maize Dr.	/	/	/
		24' FF 4' "	Perm Pvmnt Sidewalk (south side) C & G (both sides)	Round Rock Rd.	Risa Springs Dr.	End of Stub St.	/	/	/
		28' FF 4' * 4' **	Perm Pvmnt Sidewalk (north side) Sidewalk (south side) C & G (both sides)	Dakota Ridge Rd.	Risa Springs Dr.	End of Stub St. Desert Maize Dr.	/	/	/
		38' FF 4' *	Perm Pvmnt Sidewalk (both sides) C & G (both sides)	Sedge Creek Rd.	88th St.	Desert Maize Dr.	/	/	/
		24' FF 4' *	Perm Pvmnt Sidewalk (north side) C & G (both sides)	Dakota Ridge Rd.	Risa Springs Dr.	End of Stub St.	/	/	/
		24' FE 4' *	Perm Pvmnt Sidewalk (north side) C & G (north side)	Eucariz Ave.	88th St.	90th St.	/	/	/

ORIGINAL

NAME OF PLAT AND/OR SITE PLAN Desert Pine, Unit 4

SIA Sequence #	COA DRC Project #	Size	Type of Improvement	Location	From	To	Private Inspector	City Inspector	City Cnst Engineer
		24' FE 4'	Perm Pvmnt Sidewalk (east side) C & G (east side)	90th St.	N. Prop Line of City Park on west	N. Prop Line this project			
		N/A	Street lights per DPM				/	/	/
			WATER						
		8"	Waterline	90th St.	Exist Line Near Valve # 481	Dakota Ridge Rd.	/	/	/
		8"	Waterline	Dakota Ridge Rd.	90th St.	Risa Springs Dr.	/	/	/
		6"	Waterline	Dakota Ridge Rd.	Desert Maize Dr.	Risa Springs Dr.	/	/	/
		6"	Waterline	Round Rock Rd.	Desert Maize Dr.	Pincher Creek Dr.	/	/	/
		8"	Waterline	Round Rock Rd.	Pincher Creek Rd.	Risa Springs Dr.	/	/	/
		4"	Waterline	Round Rock Rd.	End of Stub St.	Risa Spring Dr.	/	/	/
		12"	Waterline	Euchariz Ave.	90th St.	86th St.	/	/	/
		12"	Waterline	90th St.	Euchariz Ave.	10" Stub In 90th	/	/	/
		N/A	Contents of PRV Vault	NW Corner 90th and Eucariz Ave.	N/A	N/A	/	/	/
		8"	Waterline	Risa Springs Dr.	Dakota Ridge Rd.	Round Rock Rd.	/	/	/
		6"	Waterline	Fern Spring Dr.	Dakota Ridge Rd.	Round Rock Rd.	/	/	/
		6"	Waterline	Cole Springs Dr.	Dakota Ridge Rd.	Round Rock Rd.	/	/	/
		6" / 4"	Waterline	Desert Maize Dr.	End of N. Stub St.	End of S. Stub St.	/	/	/
		8"	Waterline	Pincher Creek Dr.	Euchariz Ave.	Round Rock Rd.	/	/	/

ORIGINAL

SIA Sequence #	COA DRC Project #	Size	Type of Improvement	Location	From	To	Private Inspector	City Inspector	City Cnst Engineer
		4"	SANITARY SEWER Sanitary Sewer service	90th	Manhole	Lot 43D			
		8"	Sanitary Sewer	Round Rock Rd.	End of Stub St. ^{90th St. MH}	Desert Maize Dr.	/	/	/
		8"	Sanitary Sewer	Dakota Ridge Rd.	Stub out of Lot 43D	Desert Maize Dr.	/	/	/
		8"	Sanitary Sewer	Risa Springs Dr.	Dakota Ridge Rd.	Round Rock Rd.	/	/	/
		8"	Sanitary Sewer	Fern Spring Dr.	Dakota Ridge Rd.	Round Rock Rd.	/	/	/
		8"	Sanitary Sewer	Cole Springs Dr.	Dakota Ridge Rd.	Round Rock Rd.	/	/	/
		8"	Sanitary Sewer	Desert Maize Dr.	End of N. Stub St.	End of S. Stub St.	/	/	/
		6"	Sanitary Sewer	Sedge Creek Rd.	Desert Maize Dr.	88th St.	/	/	/
			STORM SEWER		<u>ROUND ROCK</u>				
		18" + 24" ^{+30"}	Storm Sewer & Appurtenances	Desert Maize Dr.	Inlets in Desert Maize	Euchariz Ave.	/	/	/
		24"	Storm Sewer & Appurtenances	Euchariz Ave.	90th St.	90th St. <u>DESERT MAIZE</u>	/	/	/
		18"	Storm Sewer, Inlets	88th St.	N. of existing inlets	Existing inlets	/	/	/
		18" + 30"	Storm Sewer + Appurtenances	Euchariz Ave.	Inlets	Manhole	/	/	/
		Notes	.	Sidewalks Deferred					
			**	Sidewalks Partially Deferred Per Exhibit					

NOTES

1 Grading and Dralange Certification per DPM including Retaining Walls as shown on the Grading Plan for release of SIA and Financial Guarantees.

2 Water infrastructure to include valves fittings, valve boxes, and fire hydrants. Sanitary Sewer to include manholes and service connections.

AGENT / OWNER	DEVELOPMENT REVIEW BOARD MEMBER APPROVALS	
AMY L. DRISCOLL, PE NAME (print)	<i>Sharon Matern</i> 3/12/03 DRB CHAIR - date	<i>Christina Sandoral</i> 3/12/03 PARKS & GENERAL SERVICES - date
MARK GOODWIN & ASSOCIATES FIRM	<i>[Signature]</i> 3-12-03 TRANSPORTATION DEVELOPMENT - date	AMAFCA - date
<i>[Signature]</i> 2/17/03 SIGNATURE - date	<i>Robert Sheen</i> 3/12/03 UTILITY DEVELOPMENT - date	- date
MAXIMUM TIME ALLOWED TO CONSTRUCT THE IMPROVEMENTS WITHOUT A DRB EXTENSION: 3-12-05	<i>Brad D. Biles</i> 3/12/03 CITY ENGINEER - date	- date

DESIGN REVIEW COMMITTEE REVISIONS

REVISION	DATE	DRC CHAIR	USER DEPARTMENT	AGENT / OWNER
1	5/28/03	<i>[Signature]</i>	Engineering	<i>[Signature]</i>

ORIGINAL

VALHALLA DELATES
(94-20-00, 100-00)
BLOCK 3

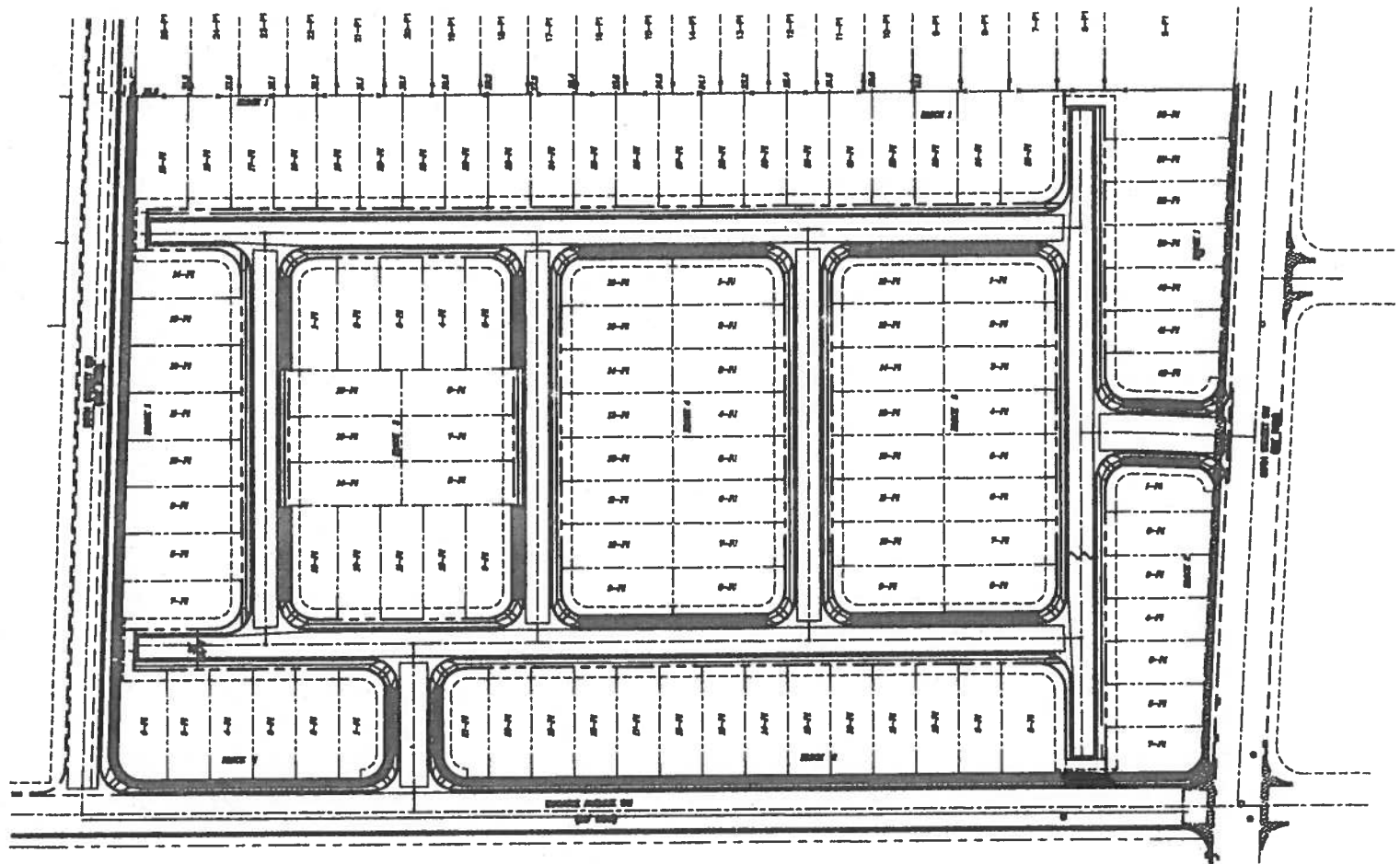

 MARK GOODWIN & ASSOCIATES, P.A.
 CONSULTING ENGINEERS
 P.O. BOX 90808
 ALBUQUERQUE, NEW MEXICO 87199
 (505) 828-2200, FAX (505) 797-9539

LEGEND

 SIDEWALK NOT DEFERRED

**DESERT PINE - UNIT 4
 SIDEWALK DEFERRAL EXHIBIT**

A02108\SDWK8X11\12-20-02\ MJR NHE