

Current DRC
Project Number: _____

FIGURE 12

ORIGINAL

TIDD INFRASTRUCTURE LIST- GARAGE 1

EXHIBIT "B"

Section 2 Parking Structure Winrock Town Center, 2100 Louisiana Blvd NE
PROPOSED NAME OF PLAT AND/OR SITE DEVELOPMENT PLAN

Winrock Center Addition
EXISTING LEGAL DESCRIPTION PRIOR TO PLATTING ACTION

Date Submitted: 2/5/2015
Date Site Plan Approved: _____
Date Preliminary Plat Approved: NA
Date Preliminary Plat Expires: _____
DRB Project No.: 1002202
DRB Application No.: XXDRB-XXXX

Following is a summary of PUBLIC/PRIVATE Infrastructure required to be constructed or financially guaranteed for the above development. This listing is not necessarily a complete listing. During the SIA process and/or in the review of the construction drawings, if the DRC Chair determines that applicant items and/or unforeseen items have not been included in the infrastructure listing, the DRC Chair may include those items in the listing and related financial guarantee. Likewise, if the DRC Chair determines that applicant or non-essential items can be deleted from the listing, those items may be deleted as well as the related portions of the financial guarantees. All such revisions require approval by the DRC Chair, the User Department and agent/owner. If such approvals are obtained, these revisions to the listing will be incorporated administratively. In addition, any unforeseen items which arise during construction which are necessary to complete the project and which normally are the Subdivider's responsibility will be required as a condition of project acceptance and close out by the City.

Sequence #	COA BLDG PERMIT #	Size	Type of Improvement	Location	From	To	Private Inspector	City Inspector	City Cast Engineer
		72,000 SF	EXISTING BUILDING DEMO AREA	A PORTION OF EXISTING BUILDING AREA AT SOUTHWESTERN CORNER OF MALL			/	/	/
			Section 2 Parking Structure						
		RAMP-1	CAST IN PLACE GARAGE RAMP ACCESS POINT -1	CAST IN PLACE GARAGE RAMP AND TUNNEL ACCESS POINT ALONG WESTERN GARAGE LOWER LEVEL-1 -AS INDICATED WITHIN FINAL AS-BUILT RECORD DRAWINGS	LOCATED ON THE WESTERN FACE OF GARAGE STRUCTURE		/	/	/
		RAMP-2	CAST IN PLACE GARAGE RAMP ACCESS POINT-2	CAST IN PLACE GARAGE RAMP ACCESS POINT-LOWER LEVEL-1 AS INDICATED WITHIN FINAL AS-BUILT RECORD DRAWINGS	LOCATED ON THE SOUTHWESTERN CORNER OF GARAGE STRUCTURE		/	/	/
		RAMP-3	CAST IN PLACE GARAGE RAMP ACCESS POINT-3	A PORTION OF NEW GARAGE RAMP ACCESS POINT AS INDICATED WITHIN FINAL AS-BUILT RECORD DRAWINGS	LOCATED ON THE NORTHEASTERN CORNER OF GARAGE STRUCTURE		/	/	/
		GARAGE	PRECAST CONCRETE	930 SPACE PRECAST CONCRETE PARKING GARAGE LOWER LEVEL-1 AND 2 AS INDICATED WITHIN FINAL AS-BUILT RECORD DRAWINGS			/	/	/
		GARAGE-1	GARAGE PEDESTRIAN VERTICAL CIRCULATION	GARAGE PEDESTRIAN STAIR AND ELEVATOR CIRCULATION AS INDICATED WITHIN FINAL AS-BUILT RECORD DRAWINGS	LOCATED AT 6 POINTS AROUND GARAGE PERIMETER		/	/	/

1 OPERATIONS & MAINTENANCE AGREEMENT INCLUDING INDEMNIFICATION AS APPROVED BY CMD

NOTES

2

3

AGENT/OWNER

DEPARTMENT OF MUNICIPAL DEVELOPMENT APPROVAL

SCOTT FRINKS

NAME (print)

[Signature]

2-13-15

DEPARTMENT OF MUNICIPAL DEVELOPMENT - date

[Signature] 4/22/15

TOWNSHIP

HUITT-ZOLLERS

FIRM

[Signature] 4/22/15

SIGNATURE State

[Signature] 4/22/15

ABERDEEN

4-22-15

[Signature]

City Engineer

4-22-15

[Signature] 4-22-15

Park & Recreation

DESIGN REVIEW COMMITTEE REVISIONS

REVISION	DATE	DRG CHAIR	USER DEPARTMENT	AGENT/OWNER

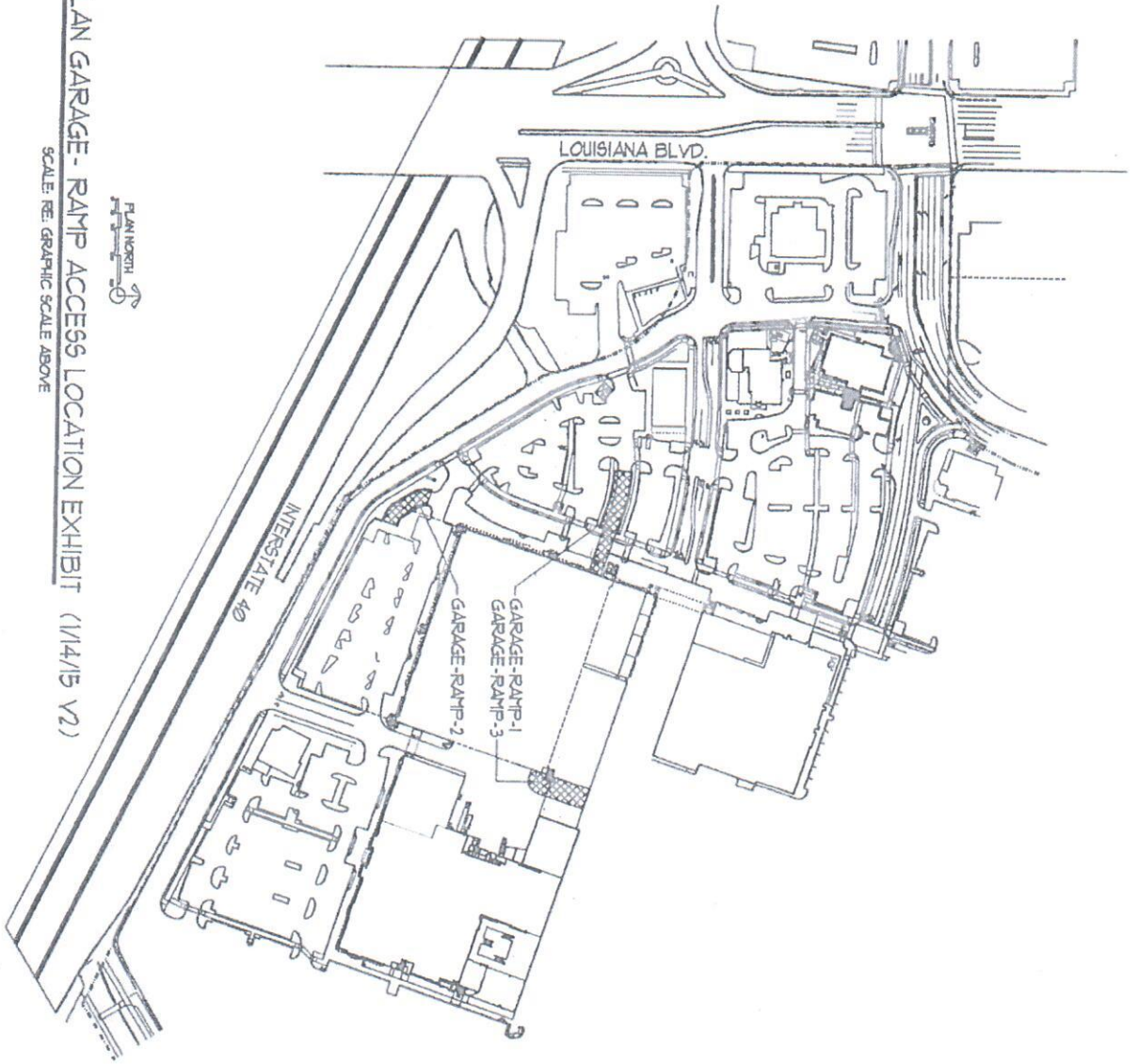

OVERALL SITEPLAN GARAGE - RAMP ACCESS LOCATION EXHIBIT (1/14/15 V2)

SCALE: RE: GRAPHIC SCALE ABOVE



#1

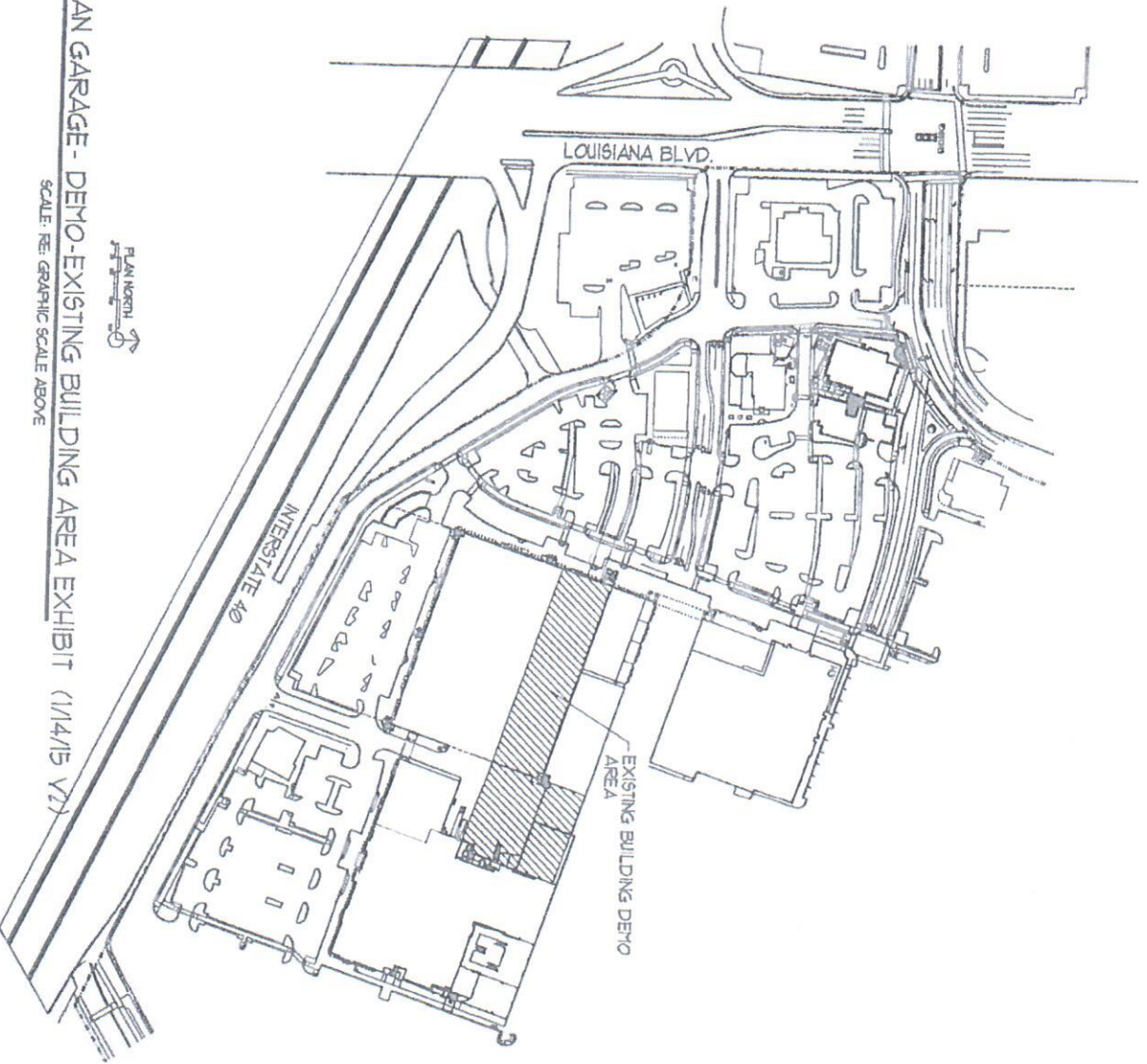

OVERALL SITEPLAN GARAGE - DEMO-EXISTING BUILDING AREA EXHIBIT (1/14/15 V1)

SCALE: RE: GRAPHIC SCALE ABOVE



#2

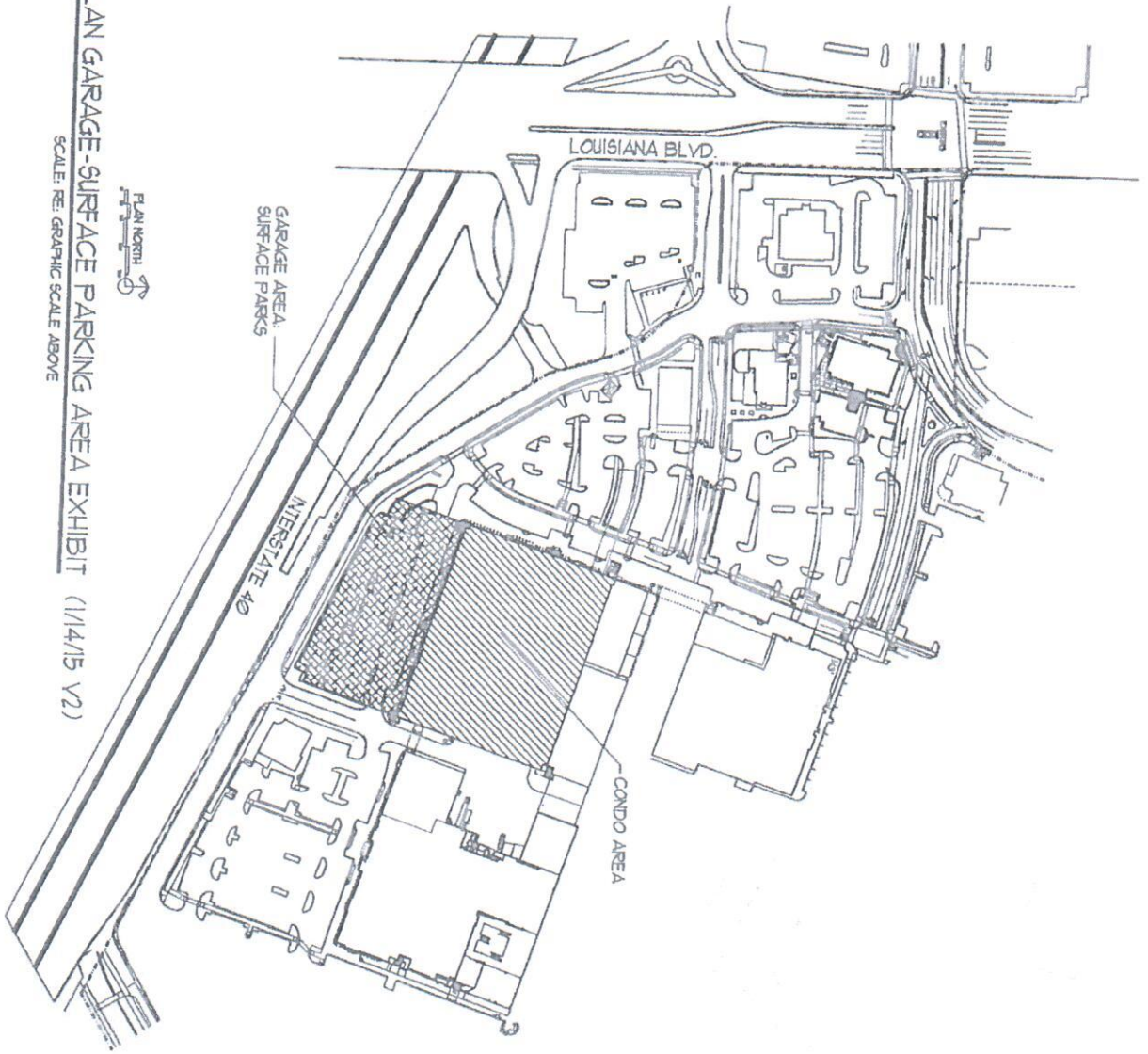

OVERALL SITEPLAN GARAGE-SURFACE PARKING AREA EXHIBIT (1/14/15 V2)
SCALE: RE: GRAPHIC SCALE ABOVE

#3

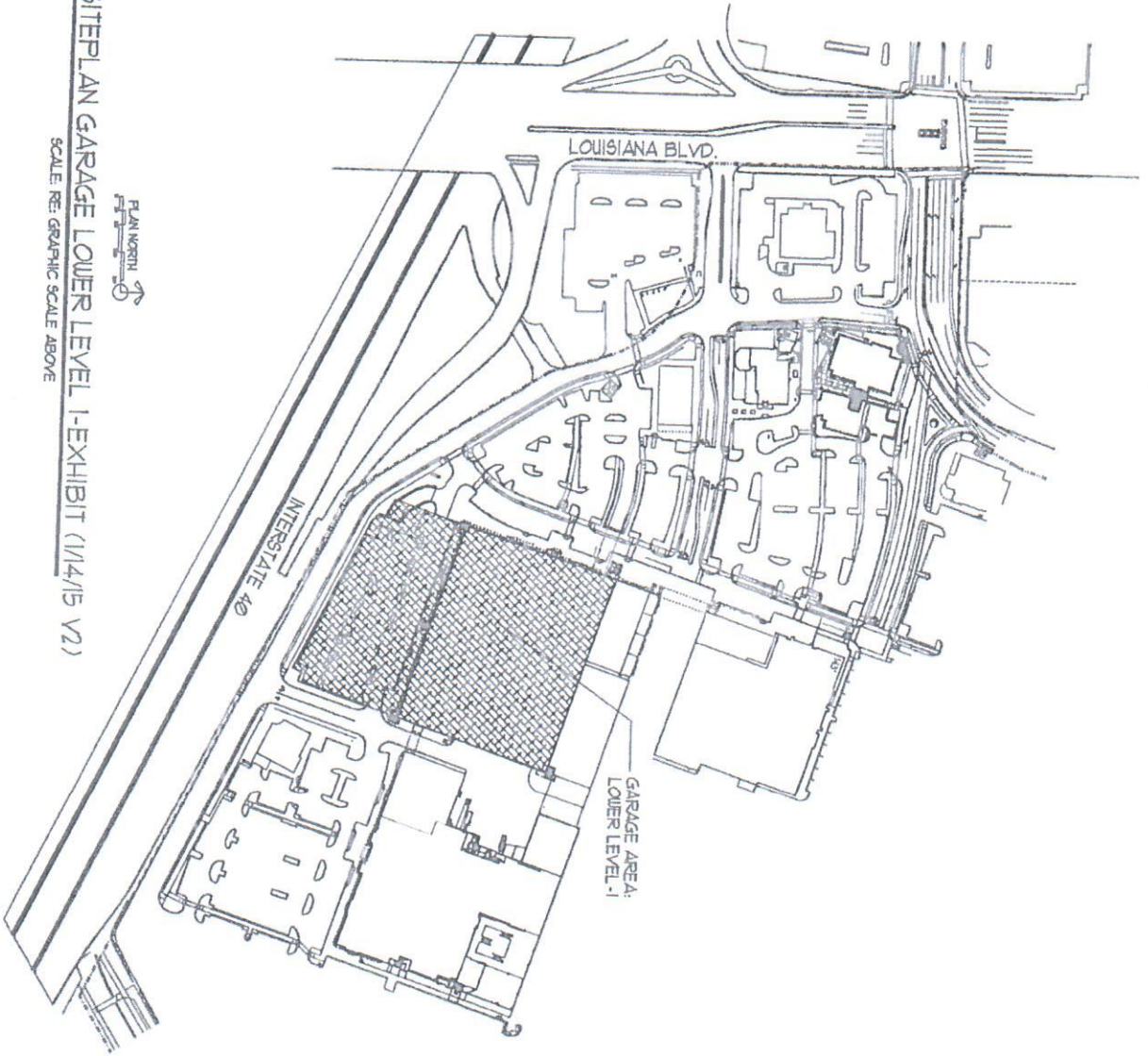

OVERALL SITE PLAN GARAGE LOWER LEVEL 1-EXHIBIT (1/14/15 V2)

PLAN NORTH
SCALE REF: GRAPHIC SCALE ABOVE

#4

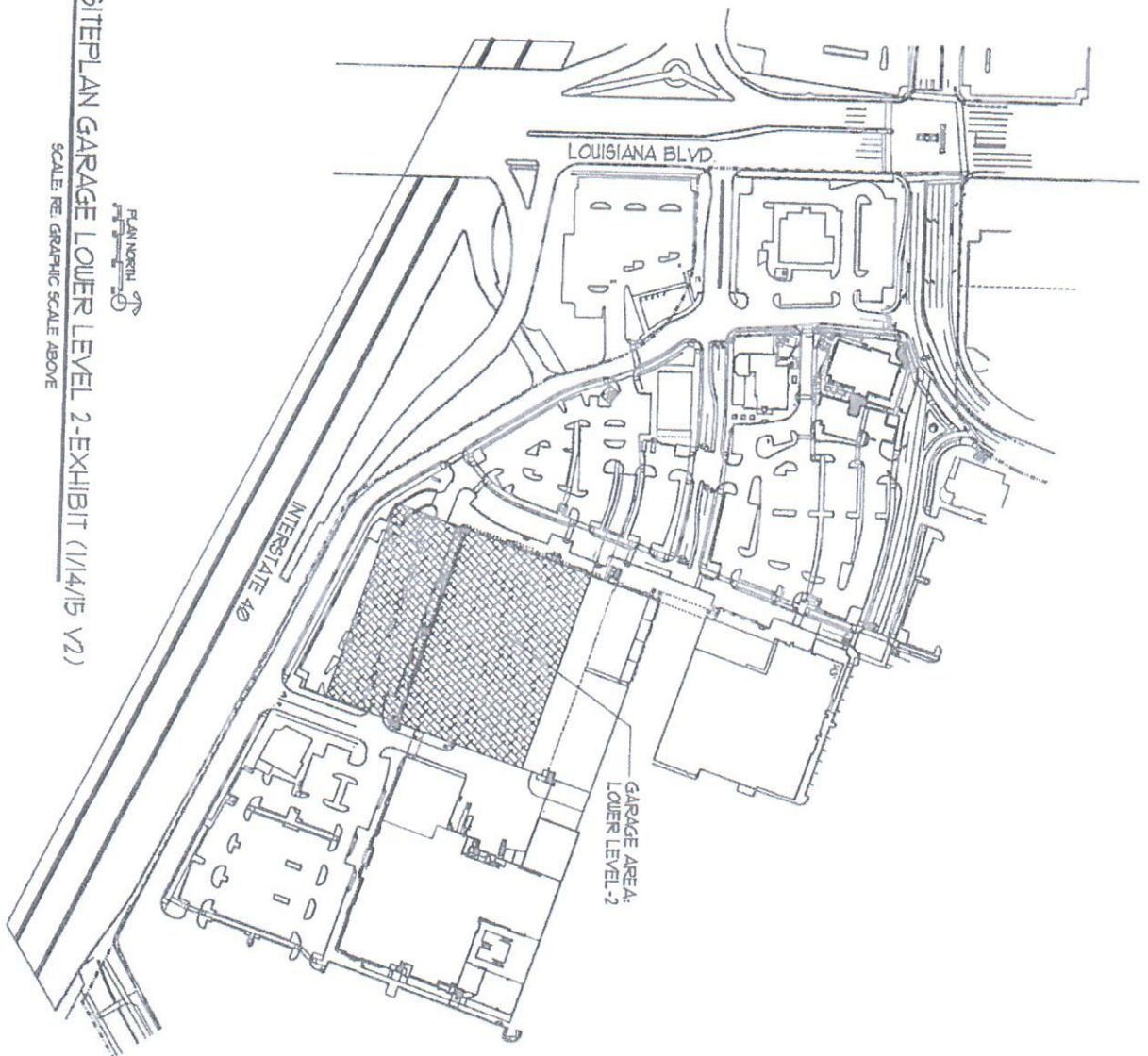

OVERALL SITEPLAN GARAGE LOWER LEVEL 2-EXHIBIT (1/14/15 V2)

PLAN NORTH
SCALE: RE: GRAPHIC SCALE ABOVE

#5