

done 10.14.02 05

PROJECT NO. 1002274	APPLICATION NO. DRB-01556 ⁰²
PROJECT NAME THOMAS ADDITION	
EPC APPLICATION NO.	
APPLICANT / AGENT Precision Surveys	PHONE NO. 856-5700
ZONE ATLAS PAGE G-20	
(4-9 lots) rec'd 10/10/02 PJA	
ONE STOP COMMENT FORM LOG	

TRANSPORTATION DEV (505) 924-3990		
PLANS DISAPPROVED	DATE	DATE
PLANS APPROVED NJP	DATE 10/14/02	DATE
COMMENTS:		
Completed		

UTILITY DEV (505) 924-3989		
PLANS DISAPPROVED	DATE	DATE
PLANS APPROVED BJJ	DATE 10/14/02	DATE
COMMENTS:		

HYDROLOGY DEV (505) 924-3986		
PLANS DISAPPROVED	DATE	DATE
PLANS APPROVED BUB	DATE 10/16/02	DATE
COMMENTS:		

PARKS AND REC (505) 768-5328		
PLANS DISAPPROVED CS	DATE 10/17/02	DATE
PLANS APPROVED	DATE	DATE
COMMENTS:		
Need verification of CIL payment for park ded. fees.		
Chad, Mel Otley, Pat		

PLANNING (505) 924-3858		
PLANS DISAPPROVED	DATE	DATE
PLANS APPROVED	DATE	DATE
COMMENTS:		

(Return form with plat / site plan)

2 30.11.04 2004

Claire - 8/25/04
Larry
Says Plat...
WAS NEVER RECORDED

I informed him that if it was not.. IT will have to be refiled because it has gone over 1 year since approval. He does remember seeing it lately if my lan had all signatures but that owner had decided not to record... for whatever reason... IF Plat has been recorded he will get back to us ASAP w/ recording info so we can close out file...
R.J.

2004



SUBDIVISION Supplemental form **S**

Major Subdivision action

Minor Subdivision action

Vacation

Variance (Non-Zoning)

ZONING Supplemental form **Z**

Annexation & Zone Establishment

Sector Plan

Zone Change

Text Amendment

SITE DEVELOPMENT PLAN Supplemental form **P**

...for Subdivision Purposes

...for Building Permit

IP Master Development Plan

Cert. of Appropriateness (LUCC) L

APPEAL / PROTEST of... Supplemental form **A**

Decision by: DRB, EPC, LUCC, Planning Director or Staff, ZHE, Zoning Board of Appeals

PRINT OR TYPE IN BLACK INK ONLY. The applicant or agent must submit the completed application in person to the Planning Department Development Services Center, 600 2nd Street NW, Albuquerque, NM 87102. Fees must be paid at the time of application. Refer to supplemental forms for submittal requirements.

APPLICANT INFORMATION:

NAME: ROBERTA ~~FREID~~ FREID PHONE: _____

ADDRESS: 1100 FLORIDA NE FAX: _____

CITY: ALBUQUERQUE STATE NM ZIP 87110 E-MAIL: _____

Proprietary interest in site: OWNER

AGENT (if any): PRECISION SURVEYS PHONE: 856 5700

ADDRESS: 8414-D JEFFERSON NE FAX: 856 7900

CITY: ALBUQUERQUE STATE NM ZIP 87113 E-MAIL: presurv@presurv.com

DESCRIPTION OF REQUEST: TO REPLAT EXISTING FOUR LOTS INTO NINE NEW LOTS

Is the applicant seeking incentives pursuant to the Family Housing Development Program? Yes. No.

SITE INFORMATION: ACCURACY OF THE LEGAL DESCRIPTION IS CRUCIAL! ATTACH A SEPARATE SHEET IF NECESSARY.

Lot or Tract No. LOTS 12-15 Block: 23 Unit: _____

Subdiv. / Addn. THOMAS ADDITION

Current Zoning: R-LT Proposed zoning: SAME

Zone Atlas page(s): G20 No. of existing lots: 4 No. of proposed lots: 9

Total area of site (acres): 0.7908 Density if applicable: dwellings per gross acre: _____ dwellings per net acre: _____

Within city limits? Yes. No , but site is within 5 miles of the city limits (DRB jurisdiction.) Within 1000FT of a landfill? No

UPC No. 102006037349612707 MRGCD Map No. _____

LOCATION OF PROPERTY BY STREETS: On or Near: HENDRIX NE

Between: MONTGOMERY NE and HILTON NE

CASE HISTORY:

List any current or prior case number that may be relevant to your application (Proj., App., DRB, AX, Z, V, S, etc.): NONE

8/25/04 LARRY'S DEVELOPER DECIDED NOT TO RECORD

Check-off if project was previously reviewed by Sketch Plan/Plan , or Pre-application Review Team . Date of review: 10/9/02

SIGNATURE Lenore Armijo DATE 10/9/02

(Print) LENORE ARMILJO _____

_____ Applicant Agent

FOR OFFICIAL USE ONLY

- INTERNAL ROUTING
- All checklists are complete
- All fees have been collected
- All case #s are assigned
- AGIS copy has been sent
- Case history #s are listed
- Site is within 1000ft of a landfill
- F.H.D.P. density bonus
- F.H.D.P. fee rebate

Application case numbers	Action	S.F.	Fees
<u>02 DRP - 01556</u>	<u>P&FP</u>	<u>5(3)</u>	<u>\$775⁰⁰</u>
_____	_____	_____	\$ _____
_____	_____	_____	\$ _____
_____	_____	_____	\$ _____
_____	_____	_____	\$ _____
Hearing date <u>int. Routing</u>			Total <u>\$775⁰⁰</u>

B. Bernt 10/9/02
Planner signature / date

Project # 1002274

FORM S(3): SUBDIVISION D.R.B. MEETING (UNADVERTISED) OR INTERNAL ROUTING

SKETCH PLAT REVIEW AND COMMENT

- Scale drawing of the proposed subdivision plat (folded to fit into an 8.5" by 14" pocket) 6 copies for unadvertised meetings. Sketches are not reviewed through internal routing.
 - Site sketch with measurements showing structures, parking, Bldg. setbacks, adjacent rights-of-way and street improvements, etcetera, if there is any existing land use (folded to fit into an 8.5" by 14" pocket) 6 copies.
 - Zone Atlas map with the entire property(ies) precisely and clearly outlined and crosshatched (to be photocopied)
 - Letter briefly describing, explaining, and justifying the request
 - Any original and/or related file numbers are listed on the cover application
- DRB meetings are approximately 8 DAYS after the Tuesday noon filing deadline. **Your attendance is required.**

MAJOR SUBDIVISION EXTENSION OF PRELIMINARY PLAT

- Preliminary Plat reduced to 8.5" x 11"
- Zone Atlas map with the entire property(ies) precisely and clearly outlined and crosshatched (to be photocopied)
- Letter briefly describing, explaining, and justifying the request
- Copy of previous D.R.B. approved infrastructure list
- Copy of the Official D.R.B. Notice of approval
- Any original and/or related file numbers are listed on the cover application

Extensions are not reviewed through internal routing.

Extension of preliminary plat approval expires after one year.

DRB meetings are approximately 8 DAYS after the Tuesday noon filing deadline. **Your attendance is required.**

MAJOR SUBDIVISION FINAL PLAT APPROVAL

- Proposed Final Plat (folded to fit into an 8.5" by 14" pocket) 6 copies for unadvertised meetings, 4 copies for internal routing.
- Zone Atlas map with the entire property(ies) precisely and clearly outlined and crosshatched (to be photocopied)
- Original Mylar drawing of the proposed plat for internal routing only. Otherwise, bring Mylar to meeting.
- Property owner's and City Surveyor's signatures on the Mylar drawing
- SIA financial guaranty verification
- Landfill disclosure and EHD signature line on the Mylar drawing if property is within a landfill buffer
- Any original and/or related file numbers are listed on the cover application

DRB meetings are approximately 8 DAYS after the Tuesday noon filing deadline. **Your attendance is required.**

MINOR SUBDIVISION PRELIMINARY / FINAL PLAT APPROVAL

- Proposed Preliminary / Final Plat (folded to fit into an 8.5" by 14" pocket) 6 copies for unadvertised meetings, 4 copies for internal routing.

VACANT

- Site sketch with measurements showing structures, parking, Bldg. setbacks, adjacent rights-of-way and street improvements, etcetera, if there is any existing land use (folded to fit into an 8.5" by 14" pocket) 6 copies.
- Zone Atlas map with the entire property(ies) precisely and clearly outlined and crosshatched (to be photocopied)
- Letter briefly describing, explaining, and justifying the request
- Original Mylar drawing of the proposed plat for internal routing only. Otherwise, bring Mylar to meeting.
- Property owner's and City Surveyor's signatures on the Mylar drawing
- Landfill disclosure and EHD signature line on the Mylar drawing if property is within a landfill buffer
- Fee (see schedule) 175.00 pd
- Any original and/or related file numbers are listed on the cover application

DRB meetings are approximately 8 DAYS after the Tuesday noon filing deadline. **Your attendance is required.**

AMENDMENT TO PRELIMINARY PLAT (with minor changes)

AMENDMENT TO INFRASTRUCTURE LIST (with minor changes)

AMENDMENT TO GRADING PLAN (with minor changes)

PLEASE NOTE: There are no clear distinctions between significant and minor changes with regard to subdivision amendments. Significant changes are those deemed by the DRB to require public notice and public hearing.

- Proposed Amended Preliminary Plat, Infrastructure List, and/or Grading Plan (folded to fit into an 8.5" by 14" pocket) 6 copies for unadvertised meetings, 4 copies for internal routing.
- Original Preliminary Plat, Infrastructure List, and/or Grading Plan (folded to fit into an 8.5" by 14" pocket) 6 copies for unadvertised meetings, 4 copies for internal routing.
- Zone Atlas map with the entire property(ies) precisely and clearly outlined and crosshatched (to be photocopied)
- Letter briefly describing, explaining, and justifying the request
- Original Mylar drawing of the proposed amended plat for internal routing only. Otherwise, bring Mylar to meeting.
- Property owner's and City Surveyor's signatures on the Mylar drawing, if the plat is being amended
- Any original and/or related file numbers are listed on the cover application

Amended preliminary plat approval expires after one year.

DRB meetings are approximately 8 DAYS after the Tuesday noon filing deadline. **Your attendance is required.**

I, the applicant, acknowledge that any information required but not submitted with this application will likely result in deferral of actions.

Lenore Armiño 10/9/02

 LENORE ARMINO 10/9/02

 Applicant signature / date



Form revised September 2001

- Checklists complete
- Fees collected
- Case #s assigned
- Related #s listed

Application case numbers	
02DRB-	-01556
-	-
-	-

P. P. P. 10/9/02

 Planner signature / date
Project # 1002274

SITE

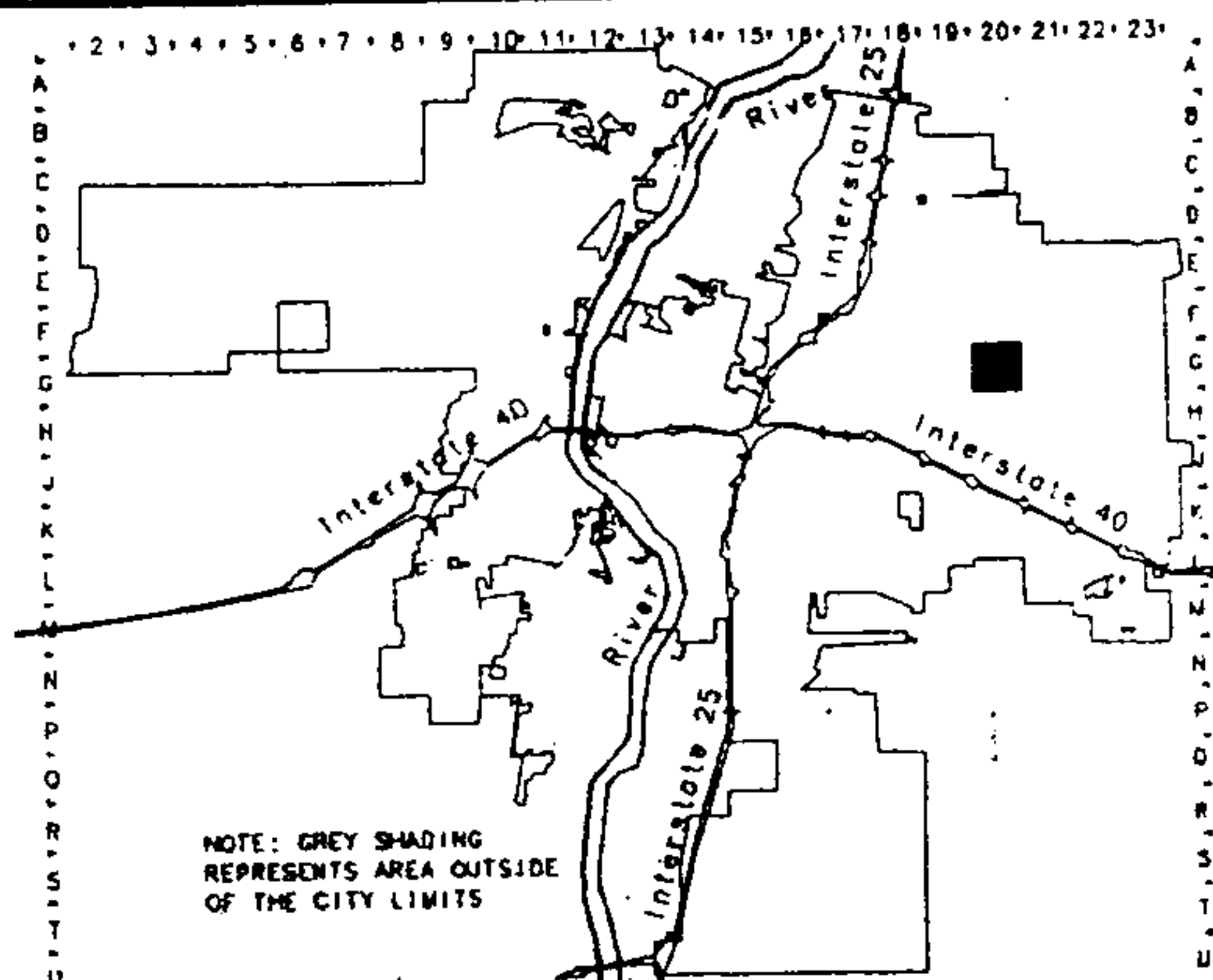
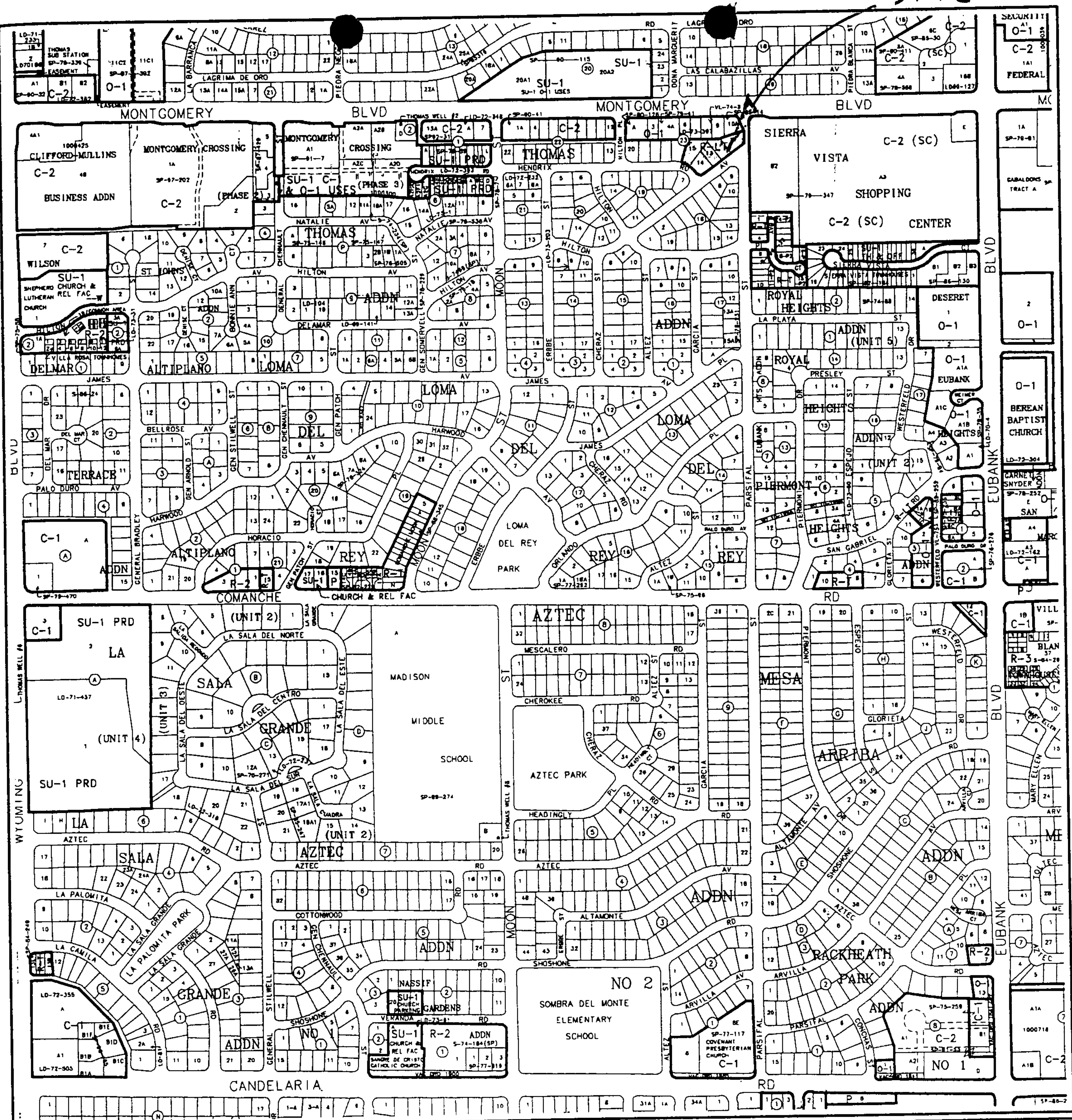

CITY OF Albuquerque
 Albuquerque Geographic Information System
 PLANNING DEPARTMENT

© Copyright 2000

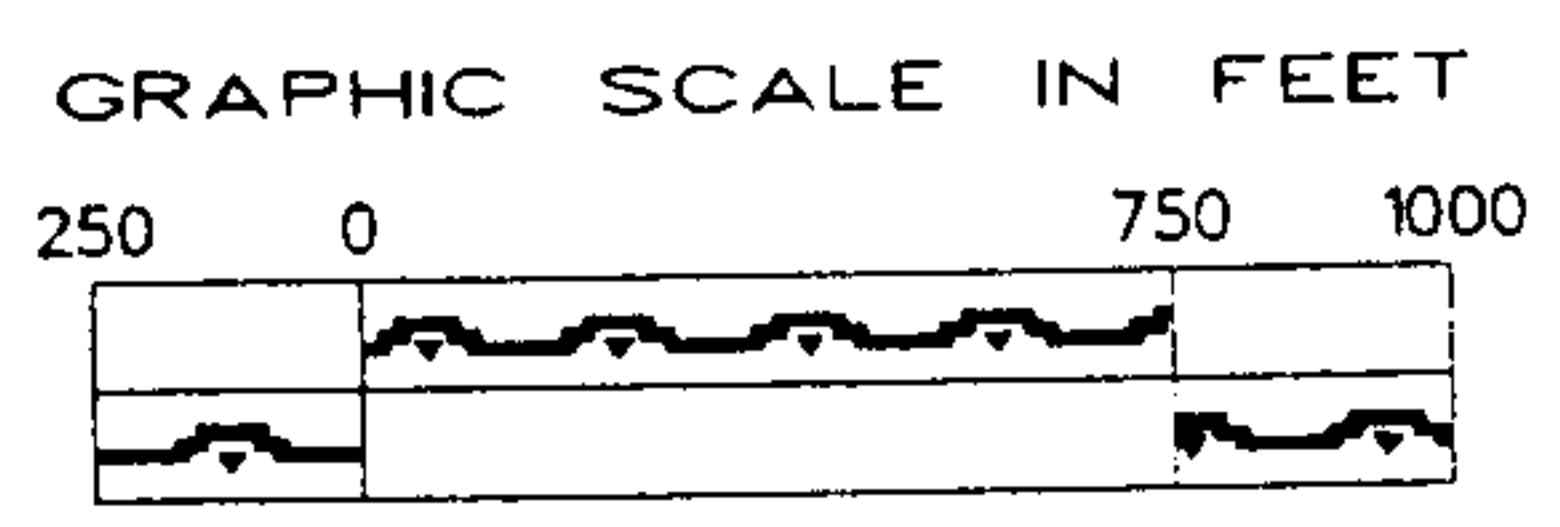

Zone Atlas Page

G-20-Z

Map Amended through December 07, 2000



PRECISION SURVEYS, INC.

October 8, 2002

Ms. Janet L. C-Stephens
Chair, Development Review Board
Planning/Development Services Division
600 2nd Street, N.W.
Albuquerque, NM 7102

**RE: REQUEST FOR PRELIMINARY/FINAL PLAT SUBMITTAL
LOTS 12 THRU 15, BLOCK 23 OF THOMAS ADDITION
ZONE ATLAS G-20-Z**

Dear Ms. Stephens;

On behalf of our client, Roberta Freid, we are submitting an application for final plat approval. We are requesting to replat the four (4) existing lots into nine (9) new lots.

If you have any questions or need additional information, please do not hesitate to contact our office at 856-5700.

Sincerely,

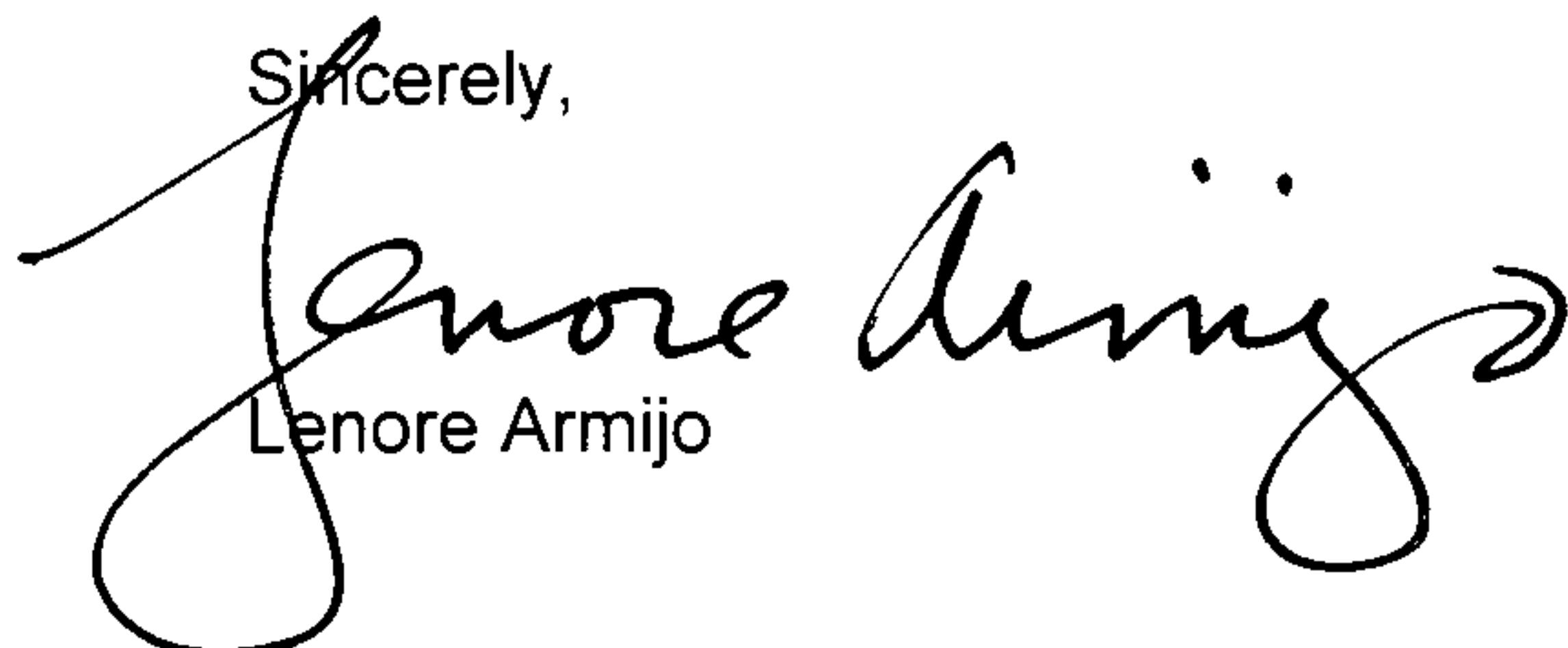
Lenore Armijo

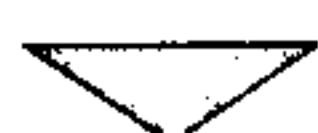
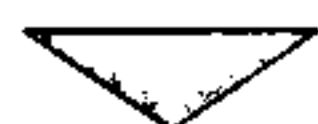

8414 - D JEFFERSON ST NE

ALBUQUERQUE, NEW MEXICO 87113

email presurv@presurv.com

PHONE 505 856 5700

FAX 505 856 7900

www.presurv.com

ONE STOP SHOP ••• FRONT COUNTER
City of Albuquerque • Planning Department

DEVELOPMENT & BUILDING SERVICES (D&B Svcs)
LAND DEVELOPMENT COORDINATION DIVISION (LDC)
Plaza Del Sol -2nd Floor West - 600 2nd St NW
Land Development / Planning - Main Fax (505) 924-3685
Development Services / Public Works - Main Fax (505) 924-3864

PAID RECEIPT

APPLICANT NAME ROBERTA FREID

AGENT PRECISION SURVEYS

ADDRESS 8414-D JEFFERSON ST. NE

PROJECT NO. 1002274

APPLICATION NO. 02DRB-01556

\$ 775⁰⁰ 441006 / 4983000 (DRB Cases)
\$ _____ 441006 / 4971000 (EPC & AA / LUCC / Appeals)
\$ _____ 441018 / 4971000 (Notification)

€ 775⁰⁰ **Total amount due**



PRECISION SURVEYS, INC.

PHONE 505-856-5700 FAX 505-856-7900
8414-D JEFFERSON ST. N.E.
ALBUQUERQUE, N.M. 87113

FIRST STATE BANK
Taos, Santa Fe, Albuquerque
and Surrounding Communities
Ph. 505-241-7500
95-145/1070

00604

PAY TO THE ORDER OF CITY OF ALBUQUERQUE 10/9/02

SEVEN HUNDRED SEVENTY-FIVE and no cents \$ 775⁰⁰ DOLLARS

#024147

MEMO

[Signature]
City of Albuquerque
Treasury Division
AUTHORIZED SIGNATURE

10/09/2002 2:47PM LOC: ANEX
00022727 WSH 007 TRANS# 0038
Account 441006 Fund 0110
Activity 4983000 TRSCCS
Trans Amt \$775.00
J24 Misc \$775.00
CK \$775.00
CHANGE 7/1/02 \$0.00