

ORIGINAL

Current DRC Project Number: \_\_\_\_\_

**FIGURE 12**

**INFRASTRUCTURE LIST**

**EXHIBIT "A"**

**TO SUBDIVISION IMPROVEMENTS AGREEMENT  
DEVELOPMENT REVIEW BOARD (D.R.B.) REQUIRED INFRASTRUCTURE LIST  
Anderson Heights Unit 4**

**PROPOSED NAME OF PLAT  
Parcels 4 and 6, Anderson Heights Unit 9  
EXISTING LEGAL DESCRIPTION PRIOR TO PLATTING ACTION**

Date Submitted: March 14, 2017  
Date Site Plan Approved: \_\_\_\_\_  
Date Preliminary Plat Approved: April 27, 2016  
Date Preliminary Plat Expires: April 27, 2017  
DRB Project No.: 1002739  
DRB Application No.: \_\_\_\_\_

**\*Extended 4-19-17  
to 4-19-18**

Following is a summary of PUBLIC/PRIVATE Infrastructure required to be constructed or financially guaranteed for the above development. This Listing is not necessarily a complete listing. During the SIA process and/or in the review of the construction drawings, if the DRC Chair determines that appurtenant items and/or unforeseen items have not been included in the infrastructure listing, the DRC Chair may include those items in the listing and related financial guarantee. Likewise, if the DRC Chair determines that appurtenant or non-essential items can be deleted from the listing, those items may be deleted as well as the related portions of the financial guarantees. All such revisions require approval by the DRC Chair, the User Department and agent/owner. If such approvals are obtained, these revisions to the listing will be incorporated administratively. In addition, any unforeseen items which arise during construction which are necessary to complete the project and which normally are the Subdivider's responsibility will be required as a condition of project acceptance and close out by the City.

SIA Sequence #	COA DRC Project #	Size	Type of Improvement	Location	From	To	Private Inspector	City Inspector	City Cnst Engineer
		26' FF	Perm Pymt (Access)	Cirque Peak Way (2)	Eagle Peak Trail	Bord Peak Trail	/	/	/
		4'	C&G (both sides)				/	/	/
		4'	Sidewalk (both sides) (1)				/	/	/
		26' FF	Perm Pymt (Access)	Eagle Peak Trail (2)	Costilla Peak Way	Cirque Peak Way	/	/	/
		4'	C&G (both sides)				/	/	/
		4'	Sidewalk (west side) (1)				/	/	/
		4'	Sidewalk (east side)				/	/	/
		26' FF	Perm Pymt (Access)	Costilla Peak Way (2)	Eagle Peak Trail	Bord Peak Trail	/	/	/
		4'	C&G (both sides)				/	/	/
		4'	Sidewalk (both sides) (1)				/	/	/
		26' FF	Perm Pymt (Access)	Bord Peak Trail	Cirque Peak Way	Costilla Peak Way	/	/	/
		4'	C&G (both sides)				/	/	/
		4'	Sidewalk (east side) (1)				/	/	/
		4'	Sidewalk (west side)	Tract G			/	/	/
		26' FF	Perm Pymt (Normal Local)	Bord Peak Trail	Costilla Peak Way	Hawkins Peak Way	/	/	/
		4'	C&G both sides				/	/	/
		4'	Sidewalks (both sides)	Tract D, Tract H, Tract VV, Tract C			/	/	/
		26' FF	Perm Pymt (Access)	Bord Peak Trail	Hawkins Peak Way	Banner Peak Way	/	/	/
		4'	C&G both sides				/	/	/
		4'	Sidewalks (both sides) (1)	Tract R, Tract S			/	/	/

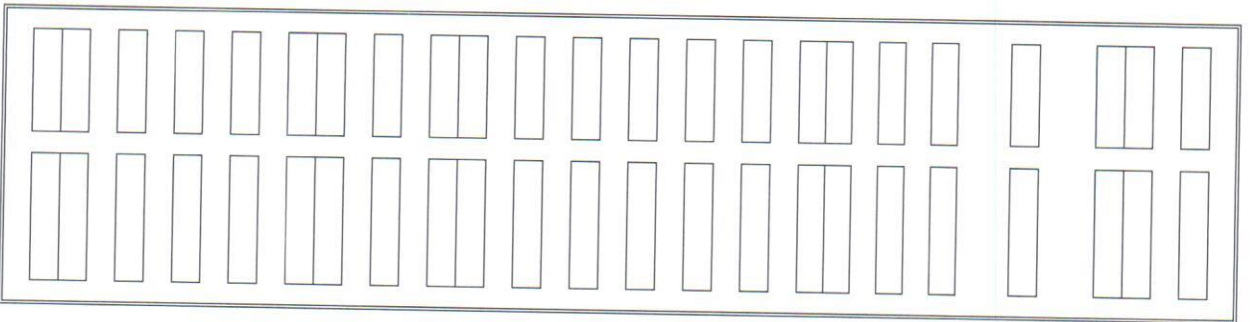

26' FF	Perm Pymt (Access) C&G (both sides)	Diamond Peak Way	Bord Peak Trail	Deer Horn Peak Trail
4'	Sidewalk (north side) (1)			
4'	Sidewalk (south side)			
56' FF	Perm Pymt (Normal Local) (9)	Barrow Way	118th Street	Bord Peak Trail
12'	Median (Vanes) & Turnaround			
	C&G (both sides)			
6'	Sidewalk (both sides)			
28' FF	Perm Pymt (Access) C&G (both sides)	Hawkins Peak Way	Bord Peak Trail	Deer Horn Peak Trail
4'	Sidewalk (north side)			
4'	Sidewalk (south side) (1)			
26' FF	Perm Pymt (Access) C&G (both sides)	Hawkins Peak Way (2)	Adams Peak Trail	Bord Peak Trail
4'	Sidewalk (both sides)	Tract C, Tract R		
26' FF	Perm Pymt (Access) C&G (both sides)	Adams Peak Trail (2)	Hawkins Peak Way	Banner Peak Way
4'	Sidewalks (both sides) (1)			
26' FF	Perm Pymt (Access) C&G (both sides)	Banner Peak Way (2)	Adams Peak Trail	Bord Peak Trail
4'	Sidewalk (south side) (1)			
4'	Sidewalk (north side)	Tract S		
26'	Perm Pymt (Normal Local) C&G (both sides)	Crag Peak Way (2)	Deer Horn Peak Trail	Emerald Peak Trail
4'	Sidewalk (Northside) (1)			
4'	Sidewalk (both sides)	Tract M, Tract L		
28'	Perm Pymt (Access) C & G (both sides)	Crag Peak Way	Emerald Peak Trail	Tyler Peak Trail
4'	Sidewalk (both sides)	Tract Z, Tract Y		
26'	Perm Pymt (Access) C&G (both sides)	Deer Horn Peak Trail (2)	Crag Peak Way	Basin Peak Way
4'	Sidewalks (west side)	Tract VV, Tract I		
4'	Sidewalks (both sides) (1)			

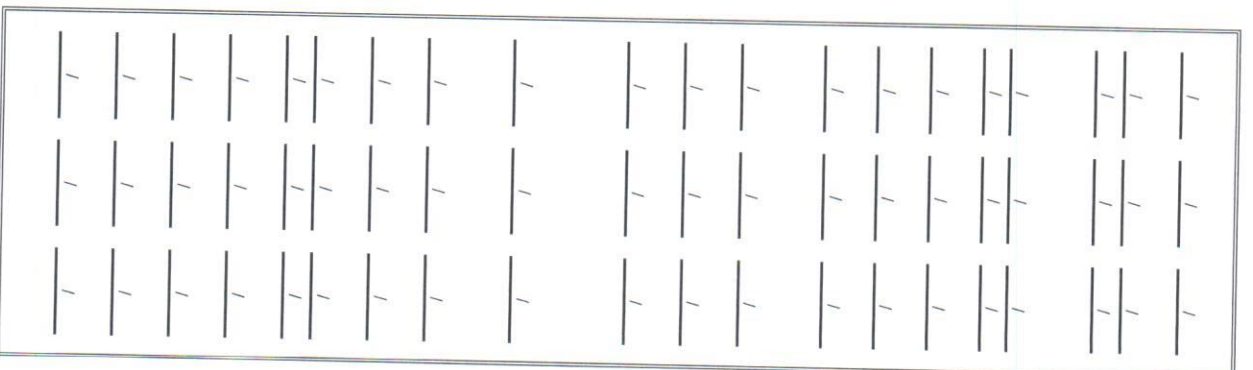

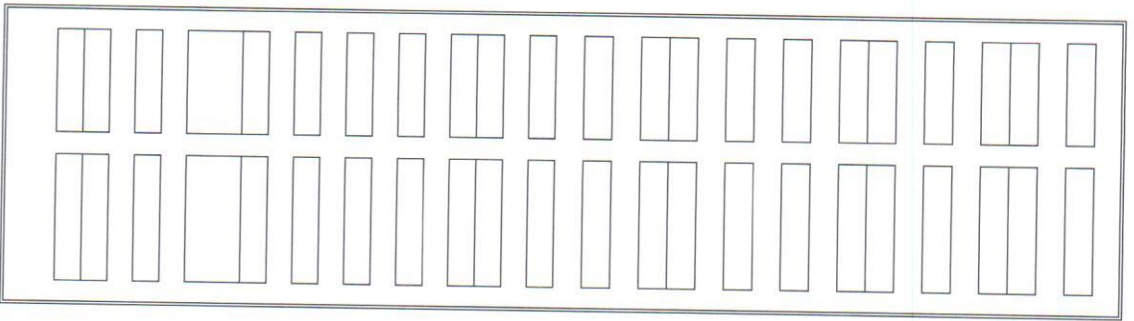

26' FF	Perm Pymt (Access) C&G (both sides)	Basin Peak Way (2)	Deer Horn Peak Trail	Alta Peak Trail
4'	Sidewalks (south sides) (1)	Tract Q, Tract U		
4'	Sidewalks (both sides)			
28' FF	Perm Pymt (Access/Normal Local) C&G (both sides)	Emerald Peak Trail	Crag Peak Way	Hawkins Peak Way
4'	Sidewalks (both sides) (1)	Lot 1-P1, Lot 24-P1, Block 8		
4'	Sidewalks (east side)			
28' FF	Perm Pymt (Access) C&G (both sides)	Hawkins Peak Way	Deer Horn Peak Trail	Emerald Peak Trail
4'	Sidewalks (both sides)	Tract N, Tract P		
42' - 54' 10'	Perm Pymt (Major Local) Median & Turnaround C&G (both sides)	Emerald Peak Trail	Amole Mesa Ave.	Crag Peak Way
6'	Sidewalks (both sides)			
26' FF	Perm Pymt (Access) C&G (both sides)	Pine Town Way (2)	Tyler Peak Trail	Potshard Trail
4'	Sidewalks (both sides) (1)	Tract BB		
4'	Sidewalk (south side)			
26' FF	Perm Pymt (Access) C&G (both sides)	Tyler Peak Trail	Pine Town Way	Lions Head Way
4'	Sidewalks (both sides) (1)			
26' FF	Perm Pymt (Access) C&G (both sides)	Alta Peak Trail (2)	Basin Peak Way	Pine Town Way
4'	Sidewalk (both sides) (1)	Lot 12, 13 Block 8, Lot 12, 13, Block 7, Lot 1 Block 13, Lot 1, 19, Block 12		
4'	Sidewalk			
28' FF	Lions Head Way (Access) C&G (both sides)	Lions Head Way	Emerald Peak Trail	Dundee Trail
4'	Sidewalk (both sides) (1)	Tract X, W, V, LL, Lot 1, 8 Block 9		
4'	Sidewalk (both sides)			

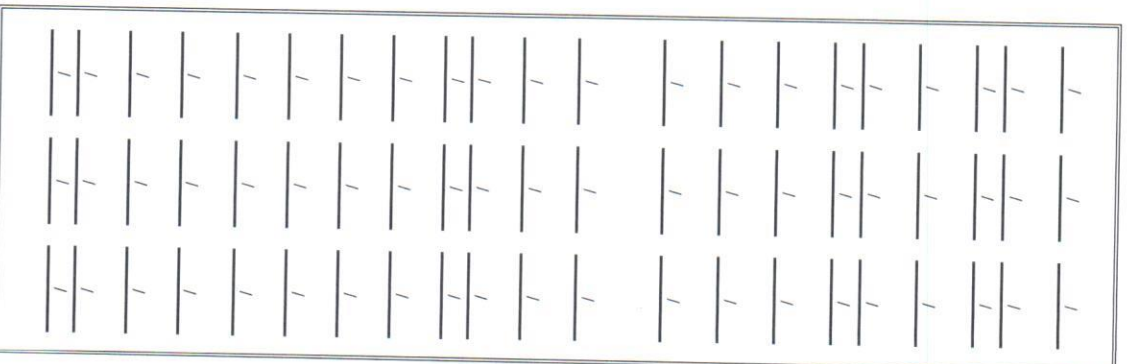







8"	Waterline	Basin Peak Way	Deer Horn Peak Trail	Alta Peak Trail	/	/	/	/
8"	Waterline	Emerald Peak Trail	Existing 12" WL	Basin Peak Way	/	/	/	/
8"	Waterline	Pine Town Way	Tyler Peak Trail	Dundee Trail	/	/	/	/
8"	Waterline	Tyler Peak Trail	Pine Town Way	Lions Head Way	/	/	/	/
8"	Waterline	Alta Peak Trail	Lions Head Way	Pine Town Way	/	/	/	/
8"	Waterline	Lions Head Way	Emerald Peak Trail	Dundee Trail	/	/	/	/
8"	Waterline	Hawkins Peak Way	Emerald Peak Trail	Alta Peak Trail	/	/	/	/
8"	Waterline	Alta Peak Trail	Basin Peak Way	Lions Head Way	/	/	/	/
8"	Waterline	Tract U	10" WL	Basin Peak Way	/	/	/	/
8"	Waterline	Brighton Bay Trail	Existing 12" WL	Pine Town Way	/	/	/	/
8"	Waterline	Potshard Trail	Lions Head Way	Pine Town Way	/	/	/	/
8"	Waterline	Blackburn Way	Alta Peak Trail	Dundee Trail	/	/	/	/
8"	Waterline	Dundee Trail	Pine Town Way	Lions Head Way	/	/	/	/
8"	Waterline	Cobblehill Way	Ironwood Hill Trail	Jacobs Bay Trail	/	/	/	/
8"	Waterline	Ironwood Hill Trail	Orange Grove Way	Lions Head Way	/	/	/	/
8"	Waterline	Orange Grove Way	Ironwood Hill Trail	Jacobs Bay Trail	/	/	/	/
8"	Waterline	Elands Bay Trail	Lions Head Way	Cobblehill Way	/	/	/	/
10"	Waterline	Jacobs Bay Trail	Cobble Hill Way	End Cuddezac	/	/	/	/
10"	Waterline	Tract RR	Jacobs Bay Trail	Existing 10" WL	/	/	/	/
<b>SANITARY SEWER</b>								
8"	Sanitary Sewer	Cirque Peak Way	Eagle Peak Trail	Bord Peak Trail	/	/	/	/
8"	Sanitary Sewer	Eagle Peak Trail	Costilla Peak Way	Cirque Peak Way	/	/	/	/
8"	Sanitary Sewer	Costilla Peak Way	Eagle Peak Trail	Bord Peak Trail	/	/	/	/
8"	Sanitary Sewer	Bord Peak Trail	Cirque Peak Way	Banner Peak Way	/	/	/	/
8"	Sanitary Sewer	Diamond Peak Way	Bord Peak Trail	Deer Horn Peak Trail	/	/	/	/
8"	Sanitary Sewer	Hawkins Peak Way	Bord Peak Trail	Deer Horn Peak Trail	/	/	/	/
8"	Sanitary Sewer	Adams Peak Trail	Hawkins Peak Way	Banner Peak Way	/	/	/	/
8"	Sanitary Sewer	Banner Peak Way	Adams Peak Trail	Bord Peak Trail	/	/	/	/



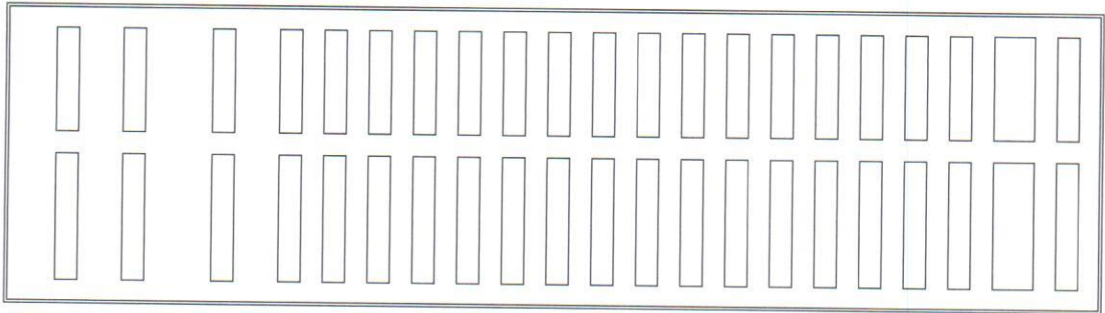

Storm Drain Size	Storm Drain Type	Location	Adjacent Property	Notes
18" - 24"	Storm Drain	Banner Peak Way	Tract T	Bord Peak Trail
24"	Storm Drain	Tract T	Banner Peak Way	Existing Storm Drain Colobel Ave
18"	Storm Drain	Diamond Peak Way	Lot 40, Blk-3	Deer Horn Peak Trail
24"	Storm Drain	Colobel Avenue (*)	Tract T	Exist MH 1C
24"	Storm Drain	Deer Horn Peak Trail	Diamond Peak Way	Crag Peak Way
18"-24"	Storm Drain	Crag Peak Way	Deer Horn Peak Trail	Tyler Peak Trail
18" - 30"	Storm Drain	Tyler Peak Trail	Crag Peak Way	Pine Town Way
18" - 42"	Storm Drain	Pine Town Way	Tyler Peak Trail	Dundee Trail
18" - 30"	Storm Drain	Basin Peak Way	Lot 20 Block 7	Tract U
18" - 30"	Storm Drain	Alta Peak Trail	Lot 34 Block-1	Tract U
36"	Storm Drain	Tract U	Basin Peak Way	Colobel Avenue
36"	Storm Drain	Colobel Avenue (*)	Tract U (MHS-1)	(MH 54)
42"	Storm Drain	Colobel Avenue (*)	Entrance (MH 55)	Existing 72" SD MH 57
42" - 54"	Storm Drain	Dundee Trail	Pine Town Way	Lions Head Way
54"	Storm Drain	Tract LL	Lions Head Way	Cobblehill Way
18"	Storm Drain	Orange Grove Way	Lot 4, Block 18	Jacobs Bay Trail
54" - 72"	Storm Drain	Jacobs Bay Trail	Tract LL	End Jacobs Bay Trail
72"	Storm Drain	Easement/Tract RR	End Jacobs Bay Trail	MH 57
<b>MISCELLANEOUS</b>				
Retaining Wall				
East Boundary				
1470 LF				
8 FT Max				
4" Sidewalk (Private Access)		Tract T	Banner Peak Way	Colobel Avenue
4" Sidewalk (Private Access)		Tract U	Basin Peak Way	Colobel Avenue

Colobel (\*) To include remove and replace asphalt; remove unused existing storm pipe and stubs

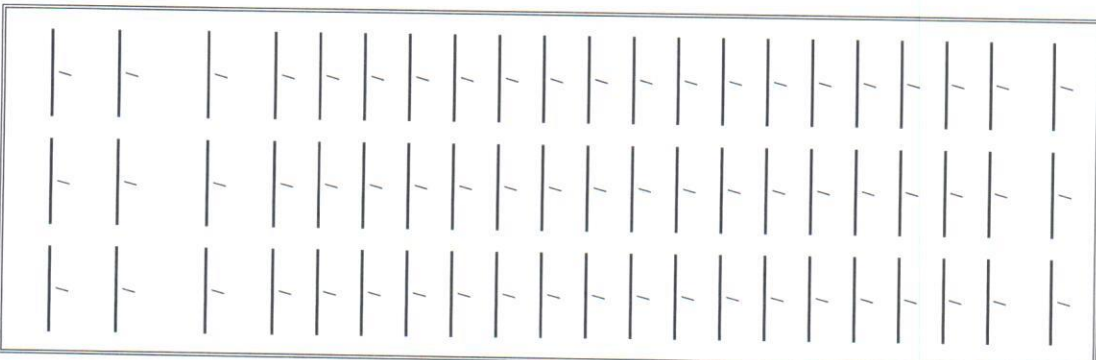



The items listed below are on the CCIP and approved for Impact Fee credits. Signatures from the Impact Fee Administrator and the City User Department is required prior to DRB

Financially Guaranteed DRC #	Constructed Under DRC #	Size	Type of Improvement	Location	From	To	Construction Certification	
							Private Inspector P.E.	City Cnst Engineer
							/	/
							/	/
							/	/
							/	/

1 Sidewalks to be Deferred per Exhibit

2 Includes Knuckles

3 Street Lights Per DPM

4 Water Infrastructure includes Valves, Fittings, Valve Boxes, Fire Hydrants, and Appurtenances.

5 Sanitary Sewer includes manholes and service connection to property line

6 Storm Drain includes manholes & inlets

7 Grading & Drainage certification per DPM to include Structural Stability Analysis of existing East Retaining Wall or Approved Replacement for release of SIA & Financial Guaranty's. Financial

**AGENT / OWNER** **DEVELOPMENT REVIEW BOARD APPROVALS**

Diane Hoelzer, P.E.

MARK GOODWIN & ASSOCIATES

PRM

*Mark Goodwin* 4/19/17  
SIGNATURE - date

DRB-CHAIR - date

*Diane Hoelzer* 4-18-17  
TRANSFORMATION DEVELOPMENT - date

PARKS & GENERAL SERVICES - date

AMAFCA - date

UTILITY DEVELOPMENT - date

CITY ENGINEER - date

MAXIMUM TIME ALLOWED TO CONSTRUCT THE IMPROVEMENTS WITHOUT A DRB EXTENSION: N/A

**DESIGN REVIEW COMMITTEE REVISIONS**

REVISION	DATE	DRC CHAIR	USER DEPARTMENT	AGENT / OWNER