

ORIGINAL

Current DRC Project Number: _____

FIGURE 12

INFRASTRUCTURE LIST

EXHIBIT "A"

**TO SUBDIVISION IMPROVEMENTS AGREEMENT
DEVELOPMENT REVIEW BOARD (D.R.B.) REQUIRED INFRASTRUCTURE LIST
Anderson Heights Unit 4**

**PROPOSED NAME OF PLAT
Parcels 4 and 6, Anderson Heights Unit 9
EXISTING LEGAL DESCRIPTION PRIOR TO PLATTING ACTION**

Date Submitted: March 14, 2017
Date Site Plan Approved: _____
Date Preliminary Plat Approved: April 27, 2016
Date Preliminary Plat Expires: April 27, 2017
DRB Project No.: 1002739
DRB Application No.: _____

***Extended 4-19-17
to 4-19-18**

Following is a summary of PUBLIC/PRIVATE Infrastructure required to be constructed or financially guaranteed for the above development. This Listing is not necessarily a complete listing. During the SIA process and/or in the review of the construction drawings, if the DRC Chair determines that appurtenant items and/or unforeseen items have not been included in the infrastructure listing, the DRC Chair may include those items in the listing and related financial guarantee. Likewise, if the DRC Chair determines that appurtenant or non-essential items can be deleted from the listing, those items may be deleted as well as the related portions of the financial guarantees. All such revisions require approval by the DRC Chair, the User Department and agent/owner. If such approvals are obtained, these revisions to the listing will be incorporated administratively. In addition, any unforeseen items which arise during construction which are necessary to complete the project and which normally are the Subdivider's responsibility will be required as a condition of project acceptance and close out by the City.

SIA Sequence #	COA DRC Project #	Size	Type of Improvement	Location	From	To	Private Inspector	City Inspector	City Cnst Engineer
		26' FF	Perm Pymt (Access)	Cirque Peak Way (2)	Eagle Peak Trail	Bord Peak Trail	/	/	/
		4'	C&G (both sides)				/	/	/
		4'	Sidewalk (both sides) (1)				/	/	/
		26' FF	Perm Pymt (Access)	Eagle Peak Trail (2)	Costilla Peak Way	Cirque Peak Way	/	/	/
		4'	C&G (both sides)				/	/	/
		4'	Sidewalk (west side) (1)				/	/	/
		4'	Sidewalk (east side)				/	/	/
		26' FF	Perm Pymt (Access)	Costilla Peak Way (2)	Eagle Peak Trail	Bord Peak Trail	/	/	/
		4'	C&G (both sides)				/	/	/
		4'	Sidewalk (both sides) (1)				/	/	/
		26' FF	Perm Pymt (Access)	Bord Peak Trail	Cirque Peak Way	Costilla Peak Way	/	/	/
		4'	C&G (both sides)				/	/	/
		4'	Sidewalk (east side) (1)				/	/	/
		4'	Sidewalk (west side)	Tract G			/	/	/
		26' FF	Perm Pymt (Normal Local)	Bord Peak Trail	Costilla Peak Way	Hawkins Peak Way	/	/	/
		4'	C&G both sides				/	/	/
		4'	Sidewalks (both sides)	Tract D, Tract H, Tract VV, Tract C			/	/	/
		26' FF	Perm Pymt (Access)	Bord Peak Trail	Hawkins Peak Way	Banner Peak Way	/	/	/
		4'	C&G both sides				/	/	/
		4'	Sidewalks (both sides) (1)	Tract R, Tract S			/	/	/

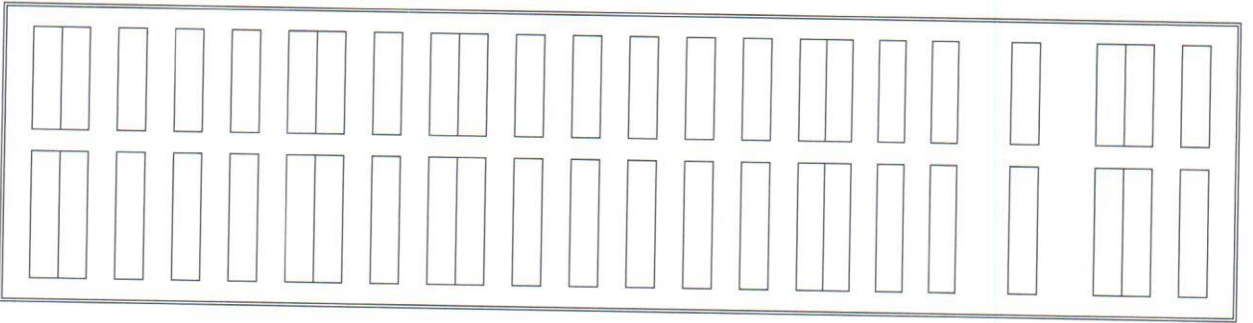

26' FF	Perm Pymt (Access) C&G (both sides)	Diamond Peak Way	Bord Peak Trail	Deer Horn Peak Trail
4'	Sidewalk (north side) (1)			
4'	Sidewalk (south side)			
56' FF	Perm Pymt (Normal Local) (9)	Barrow Way	118th Street	Bord Peak Trail
12'	Median (Vanes) & Turnaround			
	C&G (both sides)			
6'	Sidewalk (both sides)			
28' FF	Perm Pymt (Access) C&G (both sides)	Hawkins Peak Way	Bord Peak Trail	Deer Horn Peak Trail
4'	Sidewalk (north side)			
4'	Sidewalk (south side) (1)			
26' FF	Perm Pymt (Access) C&G (both sides)	Hawkins Peak Way (2)	Adams Peak Trail	Bord Peak Trail
4'	Sidewalk (both sides)	Tract C, Tract R		
26' FF	Perm Pymt (Access) C&G (both sides)	Adams Peak Trail (2)	Hawkins Peak Way	Banner Peak Way
4'	Sidewalks (both sides) (1)			
26' FF	Perm Pymt (Access) C&G (both sides)	Banner Peak Way (2)	Adams Peak Trail	Bord Peak Trail
4'	Sidewalk (south side) (1)			
4'	Sidewalk (north side)	Tract S		
26'	Perm Pymt (Normal Local) C&G (both sides)	Crag Peak Way (2)	Deer Horn Peak Trail	Emerald Peak Trail
4'	Sidewalk (Northside) (1)			
4'	Sidewalk (both sides)	Tract M, Tract L		
28'	Perm Pymt (Access) C & G (both sides)	Crag Peak Way	Emerald Peak Trail	Tyler Peak Trail
4'	Sidewalk (both sides)	Tract Z, Tract Y		
26'	Perm Pymt (Access) C&G (both sides)	Deer Horn Peak Trail (2)	Crag Peak Way	Basin Peak Way
4'	Sidewalks (west side)	Tract VV, Tract I		
4'	Sidewalks (both sides) (1)			

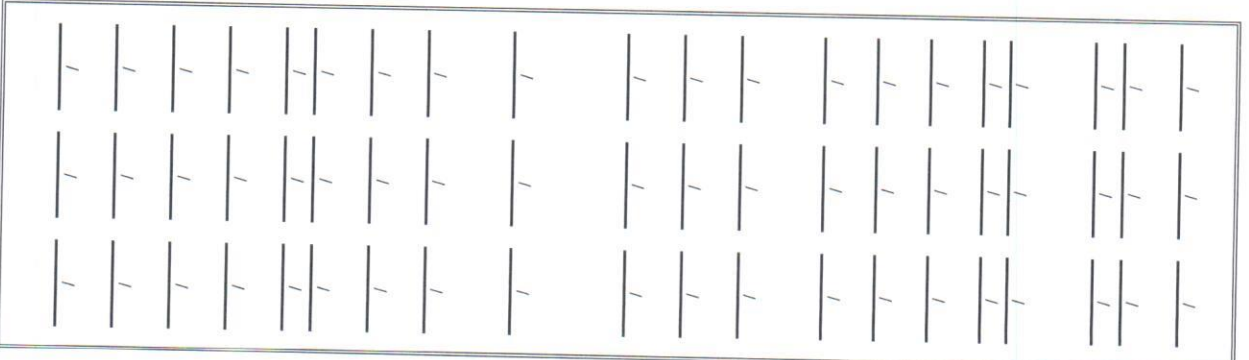

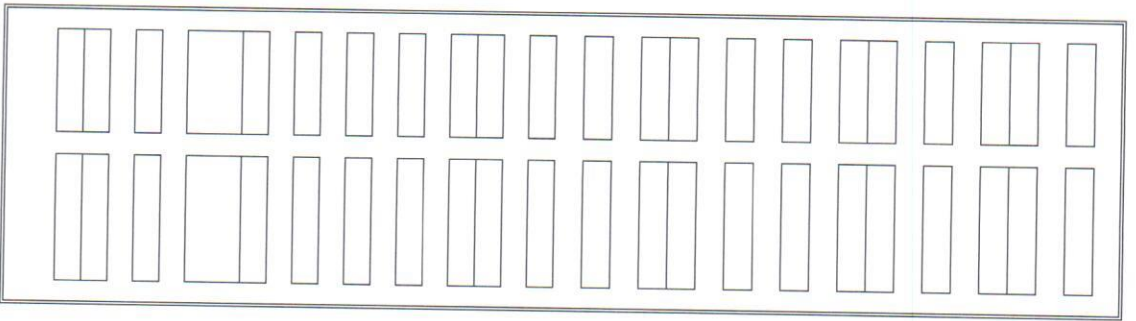

26' FF	Perm Pymt (Access) C&G (both sides)	Basin Peak Way (2)	Deer Horn Peak Trail	Alta Peak Trail
4'	Sidewalks (south sides) (1)	Tract Q, Tract U		
4'	Sidewalks (both sides)			
28' FF	Perm Pymt (Access/Normal Local) C&G (both sides)	Emerald Peak Trail	Crag Peak Way	Hawkins Peak Way
4'	Sidewalks (both sides) (1)	Lot 1-P1, Lot 24-P1, Block 8		
4'	Sidewalks (east side)			
28' FF	Perm Pymt (Access) C&G (both sides)	Hawkins Peak Way	Deer Horn Peak Trail	Emerald Peak Trail
4'	Sidewalks (both sides)	Tract N, Tract P		
42' - 54' 10'	Perm Pymt (Major Local) Median & Turnaround C&G (both sides)	Emerald Peak Trail	Amole Mesa Ave.	Crag Peak Way
6'	Sidewalks (both sides)	Pine Town Way (2)	Tyler Peak Trail	Potsford Trail
26' FF	Perm Pymt (Access) C&G (both sides)			
4'	Sidewalks (both sides) (1)	Tract BB		
4'	Sidewalk (south side)			
26' FF	Perm Pymt (Access) C&G (both sides)	Tyler Peak Trail	Pine Town Way	Lions Head Way
4'	Sidewalks (both sides) (1)	Alta Peak Trail (2)	Basin Peak Way	Pine Town Way
26' FF	Perm Pymt (Access) C&G (both sides)			
4'	Sidewalk (both sides) (1)	Lot 12, 13 Block 8, Lot 12, 13, Block 7, Lot 1 Block 13, Lot 1, 19, Block 12		
28' FF	Lions Head Way (Access) C&G (both sides)	Lions Head Way	Emerald Peak Trail	Dundee Trail
4'	Sidewalk (both sides) (1)	Tract X, W, V, LL Lot 1, 8 Block 9		
4'	Sidewalk (both sides)			

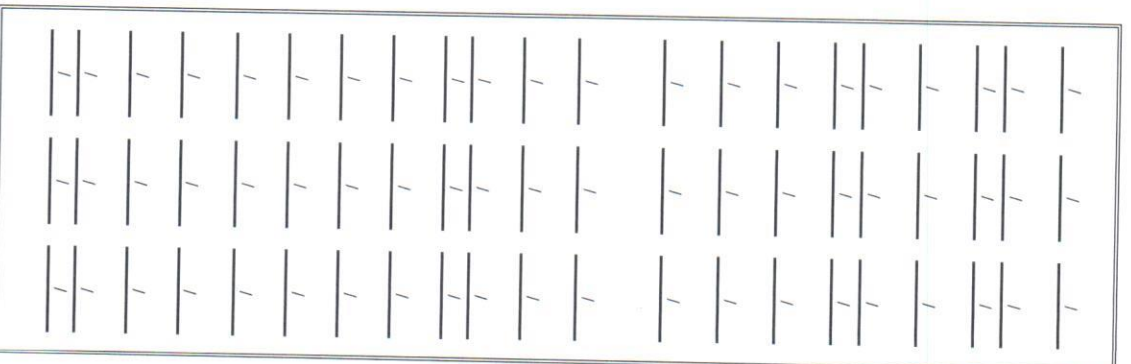

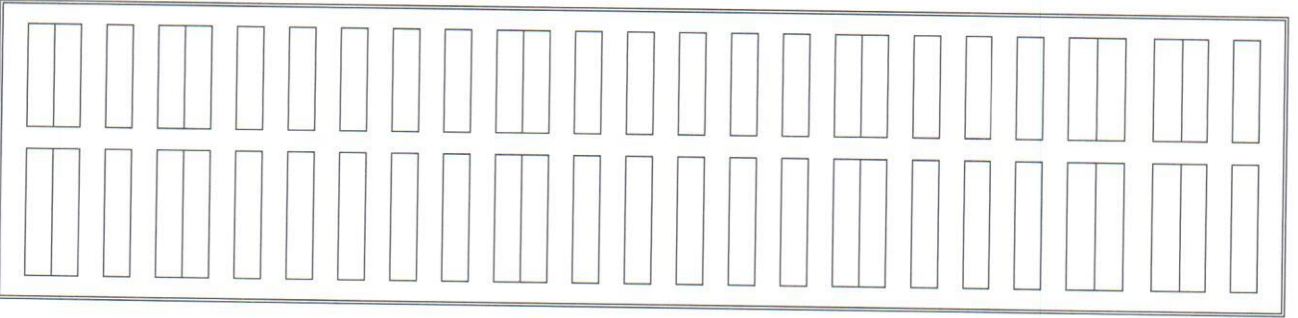

26' FF	Perm Pymt (Access) C&G (both sides)	Hawkins Peak Way	Emerald Peak Trail	Alta Peak Trail
4'	Sidewalks (both sides) (1)			
26' FF	Perm Pymt (Access) C&G both sides	Emerald Peak Trail	Hawkins Peak Way	Basin Peak Way
4'	Sidewalks (west side) (1)			
4'	Sidewalks (east side)			
28' FF	Perm Pymt (Normal Local) C&G (both sides)	Pine Town Way (2)	Poshard Trail	Dundee Trail
4'	Sidewalk (both sides) (1)			
54'	Perm Pymt (Major Local) C&G (both sides)	Brighton Bay Trail	Arnole Mesa Ave.	Pine Town Way
10'	Median			
6'	Sidewalks (both sides)			
28' FF	Perm Pymt (Access/Normal Local) C&G (both sides)	Poshard Trail	Lions Head Way	Pine Town Way
4'	Sidewalks (both sides)			
26'	Perm Pymt (Access) C&G (both sides)	Blackburn Way	Alta Peak Trail	Dundee Trail
4'	Sidewalks (both sides) (1)			
31' FF	Perm Pymt (Access) C&G (both sides)	Dundee Trail	Pine Town Way	Lions Head Way
4'	Sidewalks (east side) (1)			
4'	Sidewalks	Tract EE, Tract HH		
28' FF	Perm Pymt (Access/Normal Local) C&G (both sides)	Cobblehill Way	Ironwood Hill Trail	Elands Bay Trail
4'	Sidewalk (both sides)(1)			
26' FF	Perm Pymt (Access) C&G (both sides)	Cobblehill Way	Elands Bay Trail	Jacobs Bay Trail
4'	Sidewalk (both sides) (1)			
26' FF	Perm Pymt (Access) C&G (both sides)	Ironwood Hill Trail (2)	Orange Grove Way	Lions Head Way
4'	Sidewalk (west side) (1)			
4'	Sidewalk (east side)	Tract MM, Tract UU		
26' FF	Perm Pymt (Access) C&G (both sides)	Orange Grove Way (2)	Ironwood Hill Trail	Jacobs Bay Trail
4'	Sidewalk (both sides) (1)			
4'	Sidewalk (east side)	Tract OO		

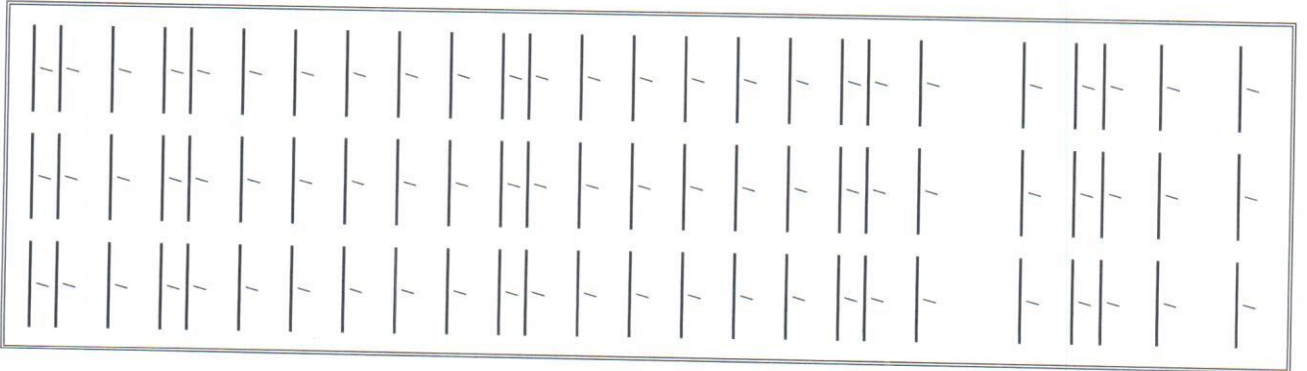

8"	Waterline	Basin Peak Way	Deer Horn Peak Trail	Alta Peak Trail	/	/	/	/
8"	Waterline	Emerald Peak Trail	Existing 12" WL	Basin Peak Way	/	/	/	/
8"	Waterline	Pine Town Way	Tyler Peak Trail	Dundee Trail	/	/	/	/
8"	Waterline	Tyler Peak Trail	Pine Town Way	Lions Head Way	/	/	/	/
8"	Waterline	Alta Peak Trail	Lions Head Way	Pine Town Way	/	/	/	/
8"	Waterline	Lions Head Way	Emerald Peak Trail	Dundee Trail	/	/	/	/
8"	Waterline	Hawkins Peak Way	Emerald Peak Trail	Alta Peak Trail	/	/	/	/
8"	Waterline	Alta Peak Trail	Basin Peak Way	Lions Head Way	/	/	/	/
8"	Waterline	Tract U	10" WL	Basin Peak Way	/	/	/	/
8"	Waterline	Brighton Bay Trail	Existing 12" WL	Pine Town Way	/	/	/	/
8"	Waterline	Potshard Trail	Lions Head Way	Pine Town Way	/	/	/	/
8"	Waterline	Blackburn Way	Alta Peak Trail	Dundee Trail	/	/	/	/
8"	Waterline	Dundee Trail	Pine Town Way	Lions Head Way	/	/	/	/
8"	Waterline	Cobblehill Way	Ironwood Hill Trail	Jacobs Bay Trail	/	/	/	/
8"	Waterline	Ironwood Hill Trail	Orange Grove Way	Lions Head Way	/	/	/	/
8"	Waterline	Orange Grove Way	Ironwood Hill Trail	Jacobs Bay Trail	/	/	/	/
8"	Waterline	Elands Bay Trail	Lions Head Way	Cobblehill Way	/	/	/	/
10"	Waterline	Jacobs Bay Trail	Cobble Hill Way	End Cuddezac	/	/	/	/
10"	Waterline	Tract RR	Jacobs Bay Trail	Existing 10" WL	/	/	/	/
SANITARY SEWER								
8"	Sanitary Sewer	Cirque Peak Way	Eagle Peak Trail	Bord Peak Trail	/	/	/	/
8"	Sanitary Sewer	Eagle Peak Trail	Costilla Peak Way	Cirque Peak Way	/	/	/	/
8"	Sanitary Sewer	Costilla Peak Way	Eagle Peak Trail	Bord Peak Trail	/	/	/	/
8"	Sanitary Sewer	Bord Peak Trail	Cirque Peak Way	Banner Peak Way	/	/	/	/
8"	Sanitary Sewer	Diamond Peak Way	Bord Peak Trail	Deer Horn Peak Trail	/	/	/	/
8"	Sanitary Sewer	Hawkins Peak Way	Bord Peak Trail	Deer Horn Peak Trail	/	/	/	/
8"	Sanitary Sewer	Adams Peak Trail	Hawkins Peak Way	Banner Peak Way	/	/	/	/
8"	Sanitary Sewer	Banner Peak Way	Adams Peak Trail	Bord Peak Trail	/	/	/	/

<input type="checkbox"/>	8"	Sanitary Sewer	Tract T	Banner Peak Way	Ave	/	/	/	/
<input type="checkbox"/>	8"	Sanitary Sewer	Deer Horn Peak Trail	Crag Peak Way	Basin Peak Way	/	/	/	/
<input type="checkbox"/>	8"	Sanitary Sewer	Basin Peak Way	Deer Horn Peak Trail	Alta Peak Trail	/	/	/	/
<input type="checkbox"/>	8"	Sanitary Sewer	Tract U	Basin Peak Way	Ave	/	/	/	/
<input type="checkbox"/>	8"	Sanitary Sewer	Crag Peak Way	Deer Horn Peak Trail	Tyler Peak Trail	/	/	/	/
<input type="checkbox"/>	8"	Sanitary Sewer	Emerald Peak Trail	Crag Peak Way	Lot 22, Block 5	/	/	/	/
<input type="checkbox"/>	8"	Sanitary Sewer	Emerald Peak Trail	Lot 6, Block 6	Basin Peak Way	/	/	/	/
<input type="checkbox"/>	8"	Sanitary Sewer	Hawkins Peak Way	Lot 24, Block 7	Alta Peak Trail	/	/	/	/
<input type="checkbox"/>	8"	Sanitary Sewer	Tyler Peak Trail	Lot 8, Block 9	Pine Town Way	/	/	/	/
<input type="checkbox"/>	8"	Sanitary Sewer	Pine Town Way	Tyler Peak Trail	Dundee Trail	/	/	/	/
<input type="checkbox"/>	8"	Sanitary Sewer	Dundee Trail	Pine Town Way	Lions Head Way	/	/	/	/
<input type="checkbox"/>	8"	Sanitary Sewer	Lions Head Way	Dundee Trail	Lot 14, Block 13	/	/	/	/
<input type="checkbox"/>	8"	Sanitary Sewer	Elands Bay Trail	Lions Head Way	Cobblehill Way	/	/	/	/
<input type="checkbox"/>	8"	Sanitary Sewer	Cobblehill Way	Lot 22, Block 16	Jacobs Bay Trail	/	/	/	/
<input type="checkbox"/>	8"	Sanitary Sewer	Jacobs Bay Trail	Cobblehill Way	Easement/Tract RR	/	/	/	/
<input type="checkbox"/>	8"	Sanitary Sewer	Easement/Tract RR	Jacobs Bay	Existing 8" SAS	/	/	/	/
<input type="checkbox"/>	8"	Sanitary Sewer	Alta Peak Trail	Lot 18 Block 10	Pine Town Way	/	/	/	/
<input type="checkbox"/>	8"	Sanitary Sewer	Lions Head Way	Lot 1 Block 8	Alta Peak Trail	/	/	/	/
<input type="checkbox"/>	8"	Sanitary Sewer	Alta Peak Trail	Basin Peak Way	Lions Head Road	/	/	/	/
<input type="checkbox"/>	8"	Sanitary Sewer	Blackburn Way	Lot 19, Block 12	Dundee Trail	/	/	/	/
<input type="checkbox"/>	8"	Sanitary Sewer	Ironwood Hill Trail	Orange Grove Way	Lions Head Way	/	/	/	/
<input type="checkbox"/>	8"	Sanitary Sewer	Orange Grove Way	Ironwood Hill Trail	Lot 4, Block 18	/	/	/	/
<input type="checkbox"/>	8"	Sanitary Sewer	Elands Bay Trail	Existing 8" SAS	Orange Grove Way	/	/	/	/
<input type="checkbox"/>	8"	Remove & Dispose SAS lateral (8)	Colobel Avenue			/	/	/	/

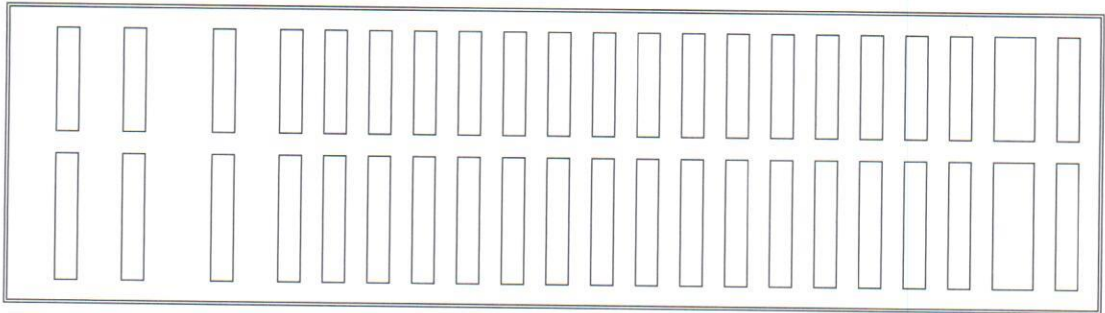

Storm Drain	Location	Tract	Notes
18" - 24"	Storm Drain	Banner Peak Way	Tract T
24"	Storm Drain	Tract T	Bord Peak Trail
18"	Storm Drain	Diamond Peak Way	Existing Storm Drain Colobel Ave
24"	Storm Drain	Colobel Avenue (*)	Deer Horn Peak Trail
24"	Storm Drain	Deer Horn Peak Trail	Exist MH 1C
18" - 24"	Storm Drain	Crag Peak Way	Diamond Peak Way
18" - 30"	Storm Drain	Tyler Peak Trail	Deer Horn Peak Trail
18" - 42"	Storm Drain	Pine Town Way	Tyler Peak Trail
18" - 30"	Storm Drain	Basin Peak Way	Pine Town Way
18" - 30"	Storm Drain	Alta Peak Trail	Tyler Peak Trail
36"	Storm Drain	Tract U	Dundee Trail
36"	Storm Drain	Colobel Avenue (*)	Tract U
42"	Storm Drain	Colobel Avenue (*)	Basin Peak Way
42" - 54"	Storm Drain	Dundee Trail	Lot 34 Block 1
54"	Storm Drain	Tract LL	Entrance (MH 55)
18"	Storm Drain	Orange Grove Way	Tract U (MHS1)
54" - 72"	Storm Drain	Jacobs Bay Trail	(MH 54)
72"	Storm Drain	Easement/Tract RR	Existing 72" SD MH 57
MISCELLANEOUS			
Retaining Wall			
East Boundary			
1470 LF			
8 FT Max			
4" Sidewalk (Private Access)			
Tract T			
Banner Peak Way			
4" Sidewalk (Private Access)			
Tract U			
Basin Peak Way			
Colobel Avenue			

Colobel (*) To include remove and replace asphalt; remove unused existing storm pipe and stubs

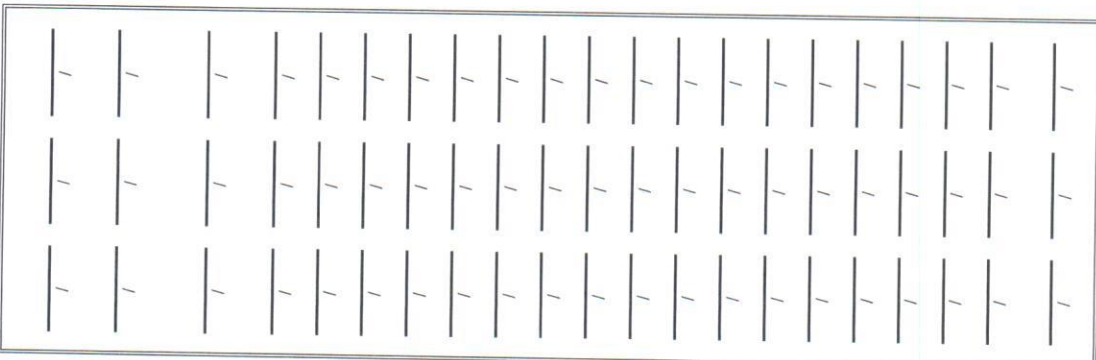

The items listed below are on the CCIP and approved for Impact Fee credits. Signatures from the Impact Fee Administrator and the City User Department is required prior to DRB

Financially Guaranteed DRC #	Constructed Under DRC #	Size	Type of Improvement	Location	From	To	Construction Certification	
							Private Inspector P.E.	City Cnst Engineer
							/	/
							/	/
							/	/

- 1 Sidewalks to be Deferred per Exhibit
- 2 Includes Knuckles
- 3 Street Lights Per DPM
- 4 Water Infrastructure includes Valves, Fittings, Valve Boxes, Fire Hydrants, and Appurtenances.
- 5 Sanitary Sewer includes manholes and service connection to property line
- 6 Storm Drain includes manholes & inlets
- 7 Grading & Drainage certification per DPM to include Structural Stability Analysis of existing East Retaining Wall or Approved Replacement for release of SJA & Financial Guaranty's Financial

Approval of Creditable Items: _____

Impact Fee Administrator Signature _____ Date _____

Approval of Creditable Items: _____

City User Dept. Signature _____ Date _____

AGENT / OWNER

Diane Hoelzer, P.E.

NAME (print) _____

MARK GOODWIN & ASSOCIATES

PRM _____

SIGNATURE - date _____

MAXIMUM TIME ALLOWED TO CONSTRUCT THE IMPROVEMENTS WITHOUT A DRB EXTENSION: N/A

DEVELOPMENT REVIEW BOARD APPROVALS

DPB-CHAIR - date _____

TRANSFORMATION DEVELOPMENT - date _____

UTILITY DEVELOPMENT - date _____

CITY ENGINEER - date _____

PARKS & GENERAL SERVICES - date _____

AMAFCA - date _____

DESIGN REVIEW COMMITTEE REVISIONS

REVISION	DATE	DRC CHAIR	USER DEPARTMENT	AGENT / OWNER