

FIGURE 12

INFRASTRUCTURE LIST

EXHIBIT "A"

TO SUBDIVISION IMPROVEMENTS AGREEMENT  
 DEVELOPMENT REVIEW BOARD (D.R.B.) REQUIRED INFRASTRUCTURE LIST  
 Heritage Trails Subdivision Unit 1-3  
 PROPOSED NAME OF PLAT  
 Tract A-1-A, Tract B-1, Anderson Heights Unit 4  
 EXISTING LEGAL DESCRIPTION PRIOR TO PLATTING ACTION

Date Submitted: 4/13/2018  
 Date Site Plan Approved: \_\_\_\_\_  
 Date Preliminary Plat Approved: 4-26-18  
 Date Preliminary Plat Expires: 5-9-19  
 DRB Project No.: 1002739  
 DRB Application No.: 18DRB-7003  
 \*Extended 4-19-17 to 4-19-18

ORIGINAL

Following is a summary of PUBLIC/PRIVATE Infrastructure required to be constructed or financially guaranteed for the above development. This listing is not necessarily a complete listing. During the SIA process and/or in the review of the construction drawings, if the DRG Chair determines that appurtenant items and/or unforeseen items have not been included in the infrastructure listing, the DRG Chair may include those items in the listing and related financial guarantee. Likewise, if the DRG Chair determines that appurtenant or non-essential items can be deleted from the listing, those items may be deleted as well as the related portions of the financial guarantees. All such revisions require approval by the DRG Chair, the User Department and agent/owner. If such approvals are obtained, these revisions to the listing will be incorporated administratively. In addition, any unforeseen items which arise during construction which are necessary to complete the project and which normally are the Subdivider's responsibility will be required as a condition of project acceptance and close out by the City.

SIA Sequence #	COA DRC Project #	Size	Type of Improvement	Location	From	To	Private Inspector	City Inspector	City Cnst Engineer
<b>OFF-SITE PAVING - UNIT 1</b>									
		36' FF	Perm Pmnt (Collector)	Anole Mesa Ave.	118th Street	Lot 12 Block 12	/	/	/
		8"	C&G (south side only)				/	/	/
		6'	Sidewalk (south side)	Anole Mesa Ave.	118th Street	East Property Line	/	/	/
<b>PAVING - UNIT 1</b>									
		48' FF	Perm Pmnt (Collector)	Colobel Avenue	Duerson Trail	Exist Pmnt at Morrissey	/	/	/
		8"	C&G (both sides)				/	/	/
		6'	Sidewalk (north side)				/	/	/
<b>PAVING - UNIT 1</b>									
		46' FF	Perm Pmnt	Crest Trail Drive	Three Rivers Road	Unit 1/2 Boundary	/	/	/
		6'	Sidewalk (both sides)				/	/	/
		6'	Median				/	/	/
		8"	C&G (both sides)				/	/	/
		26' FF	Perm Pmnt	Crest Trail Drive (2)	Three Rivers Road	Grass Mountain Road	/	/	/
		4'	C&G (both sides) (9)				/	/	/
		4'	Sidewalk (both sides) (1)				/	/	/
		4'	Sidewalk	Tract DD, EE, II, HH			/	/	/



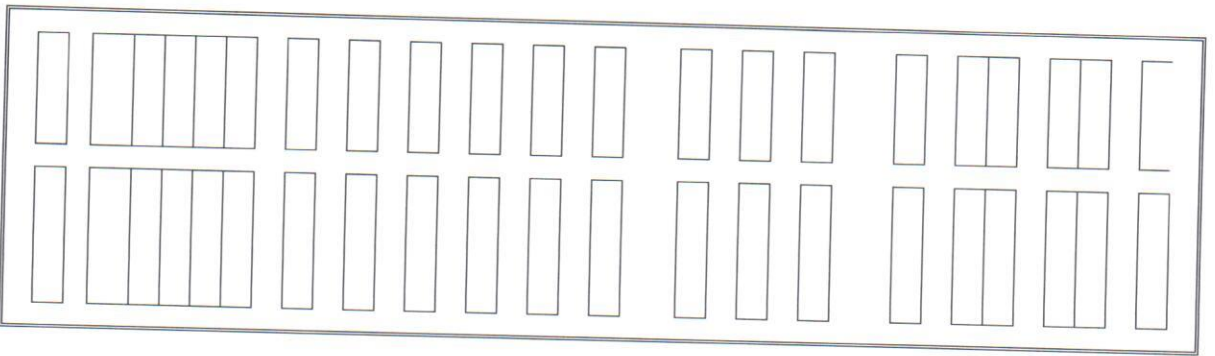

26' FF	Perm Pymt	Winsor Street (2)	South Peak Road	Horseshoe Lake Road
8"	C&G (both sides)			
4'	Sidewalk (1) (north, east, south)			
4'	Sidewalk (west side)	Lot 2, 3, Block 16		
32' FF	Perm Pymt	Rider Ridge Drive	Amole Mesa Ave.	Crest Trail Drive Drive
4'	Median			
8"	C&G (both sides)			
6'	Sidewalk (both sides)			
6'	Sidewalk	Tract II	Crest Trail Dr.	Gold Hill Rd.
32' FF	Perm Pymt	Quail Canyon Road	West Fork Road	Colobel Ave.
8"	C&G (both sides)			
6'	Sidewalk (both sides)			
<b>WATER - UNIT 1</b>				
8"	Waterline	Grass Mountain Rd.	Colobel Ave. Exst 10" WL Crest Trail Dr.	
8"	Waterline	Rider Ridge Drive	Amole Mesa Exst 12" WL South Peak Rd.	
8"	Waterline	Rider Ridge Drive	Horseshoe Lake Rd.	Crest Trail Dr.
6"	Waterline	Three Rivers Rd.	South Peak Rd.	West Fork Rd.
4"	Waterline	West Fork Dr.	Cuidasac (7 Lots)	
8"	Waterline	Winsor St.	South Peak Road	Horseshoe Lake Rd.
6"	Waterline	South Peak Rd.	Three Rivers Rd.	Rider Ridge Drive
6"	Waterline	South Peak Rd.	Rider Ridge Drive	Winsor St.
8"	Waterline	Horseshoe Lake Rd.	Three Rivers Rd.	Rider Ridge Drive
8"	Waterline	Horseshoe Lake Rd.	Rider Ridge Drive	Winsor St.
6"	Waterline	Crest Trail Dr.	Grass Mountain Rd.	Unit 1/2 Bndry (L28 B11/L1 B12)
6"	Waterline	Gold Hill Rd.	Grass Mountain Rd.	Three Rivers Rd.

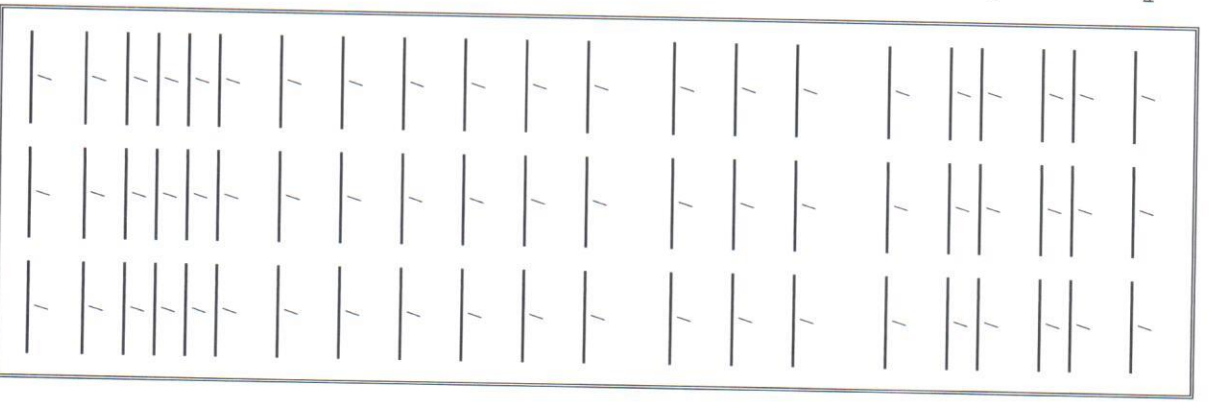

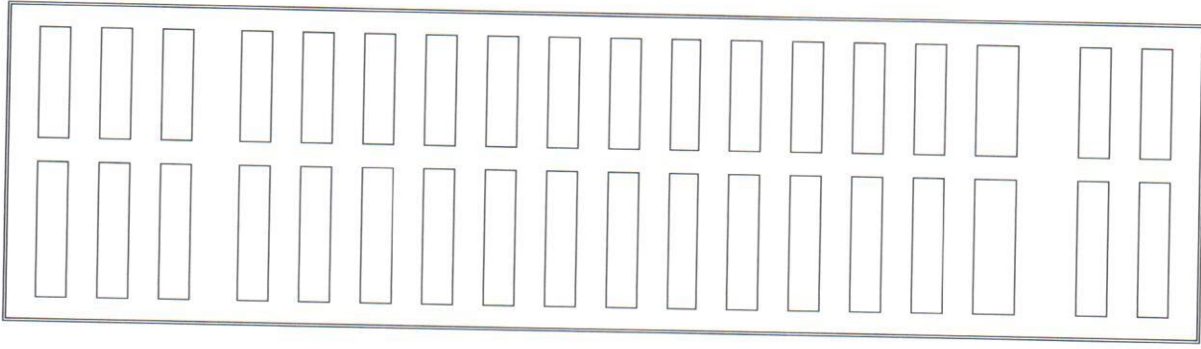

6"	Waterline	West Fork Rd.	Grass Mountain Rd.	Three Rivers Rd.	/	/	/	/	
8"	Waterline Stub (3 Each)	Colobel Ave. (*)	Fern & Dispose Cap at Main		/	/	/	/	
<b>SANITARY SEWER - UNIT 1</b>									
8"	Sanitary Sewer	Quail Canyon Rd.	West Fork Rd.	Exst 8" SAS Colobel Ave.	/	/	/	/	
8"	Sanitary Sewer	West Fork Rd.	Lot 14, Block 19	Three Rivers Road	/	/	/	/	
8"	Sanitary Sewer	West Fork Rd. Cuddezac	7 Lots		/	/	/	/	
8"	Sanitary Sewer	Three Rivers Rd.	West Fork Rd.	Lot 1, Block 13	/	/	/	/	
8"	Sanitary Sewer	Grass Mountain Rd.	Existing SAS Colobel Ave. Crest Trail Dr.		/	/	/	/	
8"	Sanitary Sewer	Gold Hill Rd.	Grass Mountain Rd.	Lot 24 Blk 18/Lot 1 Blk 19	/	/	/	/	
8"	Sanitary Sewer	Crest Trail Dr.	Grass Mountain Rd.	Three Rivers Rd.	/	/	/	/	
8"	Sanitary Sewer	Three Rivers Rd.	Crest Trail Dr.	South Peak Rd.	/	/	/	/	
8"	Sanitary Sewer	Rider Ridge Dr.	Crest Trail Dr.	Horseshoe Lake Rd.	/	/	/	/	
8"	Sanitary Sewer	Horseshoe Lake Rd.	Winsor St.	L18 B15, L1 B17	/	/	/	/	
8"	Sanitary Sewer	Winsor St.	Horseshoe Lake Rd.	South Peak Rd.	/	/	/	/	
8"	Sanitary Sewer	South Peak Lake Rd.	Three Rivers Rd.	Winsor St.	/	/	/	/	
8"	Sanitary Sewer	Colobel Ave.	Exst SAS	Row Line @ Tract AA	/	/	/	/	
<b>STORM DRAIN - UNIT 1</b>									
18"	Storm Drain	West Fork Rd.	Lot 14, Blk 19		/	/	/	/	
18"-24"	Storm Drain	Crest Trail Dr.	Grass Mountain Rd.	Rider Ridge Dr.	/	/	/	/	
18"-24"	Storm Drain	Winsor St.	Horseshoe Lake Rd.	South Peak Rd.	/	/	/	/	



**PAVING - UNIT 2 (INTERNAL PRIVATE ROADS)**

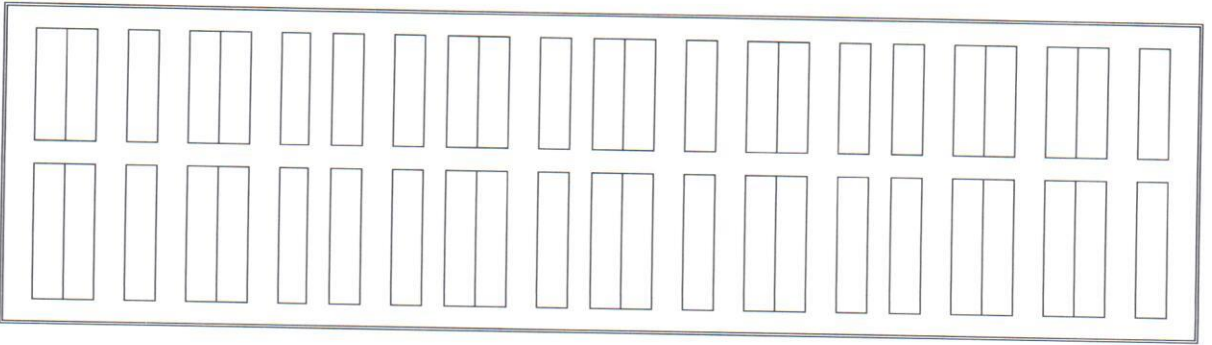

Width	Description	Location	Adjacent Road	Notes
28' FF	Perm Pymt (Access/Normal Local)	Emerald Peak Trail	Crag Peak Way	Basin Peak Way
	C&G (both sides) (9)			/
4'	Sidewalks (both sides) (1)	Tract H-1, J, G-1, L, O-1, N, P-1, S		/
4'	Sidewalk (both sides)			/
42' - 54'	Perm Pymt (Major Local)	Emerald Peak Trail	Annie Mesa Ave.	Crag Peak Way
10'	Median & Turnaround			/
8'	C&G (both sides)			/
6'	Sidewalks (both sides)			/
26' FF	Perm Pymt (Access)	Pine Town Way (2)	Tyler Peak Trail	Alta Peak Trail
	C&G (both sides) (9)			/
4'	Sidewalks (north side) (1)	Tract T		/
4'	Sidewalk (south side)			/
26' FF	Perm Pymt (Access)	Tyler Peak Trail	Pine Town Way	Crest Trail Drive
	C&G (both sides) (9)			/
4'	Sidewalks (both sides) (1)	Tract M		/
4'	Sidewalk (east side)			/
26' FF	Perm Pymt	Tyler Peak Trail	Crest Trail Drive	Basin Peak Way
	C&G (both sides) (9)			/
4'	Sidewalk (both sides) (1)	Tract L, L, J, K		/
4'	Sidewalk (both side)			/
28' FF	Perm Pymt	Crest Trail Drive	Unit 2/3 Boundary	Alta Peak Trail
	C&G (both sides)			/
6'	Sidewalk	Tract O-1, G-1		/
46' FF	Perm Pymt	Crest Trail Drive	Alta Peak Trail	Unit 1/2 Boundary
	C&G (both sides)			/
6'	Median			/
6'	Sidewalk (both sides)			/
26' FF	Perm Pymt (Access)	Alta Peak Trail (2)	Basin Peak Way	Pine Town Way
	C&G (both sides) (9)			/
4'	Sidewalk (both sides) (1)	Tract M, L, BB, R-1		/
4'	Sidewalk			/







**PAVING - UNIT 3 (INTERNAL PAVING PRIVATE)**

26' FF	Perm Pymt (Access) C&G (both sides) (9) Sidewalk (both sides) (1)	Cirque Peak Way (2)	Eagle Peak Trail	Bord Peak Trail	/	/	/
26' FF	Perm Pymt (Access) C&G (both sides) (9) Sidewalk (west side) (1) Sidewalk (east side)	Eagle Peak Trail (2)	Cosillia Peak Way	Cirque Peak Way	/	/	/
26' FF	Perm Pymt (Access) C&G (both sides) (9) Sidewalk (both sides) (1)	Cosillia Peak Way (2)	Eagle Peak Trail	Bord Peak Trail	/	/	/
26' FF	Perm Pymt (Access) C&G (both sides) (9) Sidewalk (east side) (1) Sidewalk (west side) (1)	Bord Peak Trail	Cirque Peak Way	Cosillia Peak Way	/	/	/
28' FF	Perm Pymt (Normal Local) C&G both sides Sidewalks (both sides)	Bord Peak Trail	Cosillia Peak Way	Crest Trail Drive	/	/	/
26' FF	Perm Pymt (Access) C&G both sides (9) Sidewalks (both sides) (1) Sidewalks	Bord Peak Trail	Crest Trail Drive	Banner Peak Way	/	/	/
26' FF	Perm Pymt (Access) C&G (both sides) (9) Sidewalk (north side) (1) Sidewalk (south side)	Diamond Peak Way	Bord Peak Trail	Deer Horn Peak Trail	/	/	/
56' FF	Perm Pymt (Normal Local) (9)	Barrow Way	118th Street	Bord Peak Trail	/	/	/
28'	Westbound Lane				/	/	/
16'	Eastbound Lane				/	/	/
12'	Median (Varres) & Turnaround				/	/	/
8'	C&G (both sides)				/	/	/
6'	Sidewalk (both sides)				/	/	/

28' FF	Perm Pymt (Access)	Crest Trail Drive	Bord Peak Trail	Unit 2/3 Boundary	/	/	/	/	/
	C&G (both sides) (9)				/	/	/	/	/
4'	Sidewalk (north side)	Tract W, O			/	/	/	/	/
4'	Sidewalk (south side) (1)				/	/	/	/	/
4'	Sidewalk (south side)	Tract G			/	/	/	/	/
26' FF	Perm Pymt (Access)	Crest Trail Drive (2)	Adams Peak Trail	Bord Peak Trail	/	/	/	/	/
	C&G (both sides) (9)				/	/	/	/	/
4'	Sidewalk (both sides)	Tract C, Tract E			/	/	/	/	/
26' FF	Perm Pymt (Access)	Adams Peak Trail (2)	Crest Trail Drive	Banner Peak Way	/	/	/	/	/
	C&G (both sides) (9)				/	/	/	/	/
4'	Sidewalks (both sides) (1)				/	/	/	/	/
26' FF	Perm Pymt (Access)	Banner Peak Way (2)	Adams Peak Trail	Bord Peak Trail	/	/	/	/	/
	C&G (both sides) (9)				/	/	/	/	/
4'	Sidewalk (south side) (1)				/	/	/	/	/
4'	Sidewalk (north side)	Tract F			/	/	/	/	/
4'	Sidewalk (south side)	Tract B			/	/	/	/	/
26' FF	Perm Pymt (Normal Local)	Crag Peak Way (2)	Deer Horn Peak Trail	Unit 2/3 Boundary	/	/	/	/	/
	C&G (both sides) (9)				/	/	/	/	/
4'	Sidewalk (Northside) (1)				/	/	/	/	/
4'	Sidewalk (south side)	Tract P			/	/	/	/	/
26' FF	Perm Pymt (Access)	Deer Horn Peak Trail (2)	Crag Peak Way	Basin Peak Way	/	/	/	/	/
	C&G (both sides) (9)				/	/	/	/	/
4'	Sidewalks (west side)	Tract W, U, Lot 25, Blk 1			/	/	/	/	/
4'	Sidewalks (both sides) (1)				/	/	/	/	/
26' FF	Perm Pymt (Access)	Basin Peak Way (2)	Deer Horn Peak Trail	Unit 2/3 Boundary	/	/	/	/	/
	C&G (both sides) (9)				/	/	/	/	/
4'	Sidewalks (south sides) (1)				/	/	/	/	/
4'	Sidewalks (north side)	Tract H-2			/	/	/	/	/
6'	Sidewalk (Private Access)	Tract B	Banner Peak Way	Colobel Avenue	/	/	/	/	/

**WATER - UNIT 3**

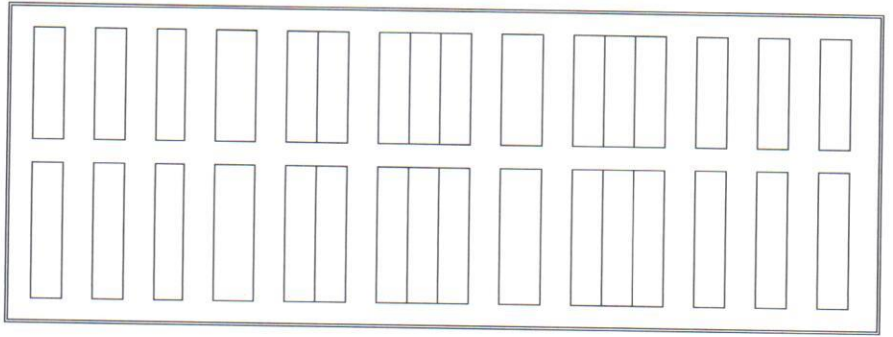

6"	Waterline	Cirque Peak Way	Eagle Peak Trail	Bord Peak Trail	/	/	/	/
6"	Waterline	Eagle Peak Trail	Cosillia Peak Way	Cirque Peak Way	/	/	/	/
6"	Waterline	Cosillia Peak Way	Eagle Peak Trail	Bord Peak Trail	/	/	/	/
6"	Waterline	Bord Peak Trail	Cirque Peak Way	Cosillia Peak Way	/	/	/	/
8"	Waterline	Bord Peak Trail	Cosillia Peak Way	Banner Peak Way	/	/	/	/
6"	Waterline	Diamond Peak Way	Bord Peak Trail	Deer Horn Peak Trail	/	/	/	/
10"	Waterline	Barrow Way	118th Street Existing 18" WL	Bord Peak Trail	/	/	/	/
6"	Waterline	Crest Trail Drive	Adams Peak Trail	Bord Peak Trail	/	/	/	/
8"	Waterline	Crest Trail Drive	Bord Peak Trail	Deer Horn Peak Trail	/	/	/	/
6"	Waterline	Adams Peak Trail	Crest Trail Drive	Banner Peak Way	/	/	/	/
6"	Waterline	Banner Peak Way	Adams Peak Trail	Tract B	/	/	/	/
8"	Waterline	Banner Peak Way	Tract B	Bord Peak Trail	/	/	/	/
8"	Waterline	Tract B	Banner Peak Way	Existing 10" WL Colobel Slub	/	/	/	/
8"	Waterline	Crag Peak Way	Deer Horn Peak Trail	Unit 2/3 Bndry Lot 49/50	/	/	/	/
8"	Waterline	Deer Horn Peak Trail	Crag Peak Way	Basin Peak Way	/	/	/	/
8"	Waterline	Basin Peak Way	Deer Horn Peak Trail	Unit 2/3 Bndry Lot 35/36	/	/	/	/

**SANITARY SEWER - UNIT 3**

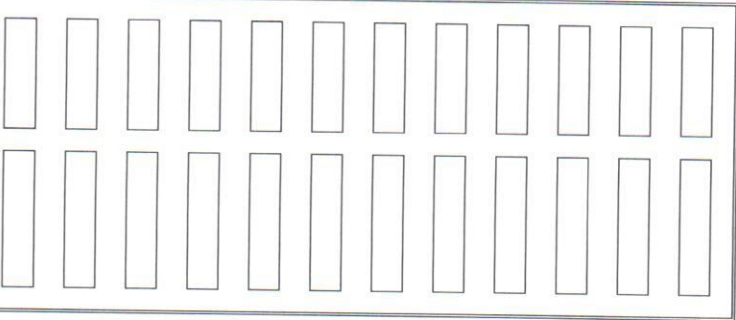

8"	Sanitary Sewer	Cirque Peak Way	Eagle Peak Trail	Bord Peak Trail
8"	Sanitary Sewer	Eagle Peak Trail	Costilla Peak Way	Cirque Peak Way
8"	Sanitary Sewer	Costilla Peak Way	Eagle Peak Trail	Bord Peak Trail
8"	Sanitary Sewer	Bord Peak Trail	Cirque Peak Way	Banner Peak Way
8"	Sanitary Sewer	Diamond Peak Way	Lot 35 B3	Deer Horn Peak Trail
8"	Sanitary Sewer	Crest Trail Drive	Lot 21 B1	Deer Horn Peak Trail
8"	Sanitary Sewer	Adams Peak Trail	Lot 1 Crest Trail Drive	Banner Peak Way
8"	Sanitary Sewer	Banner Peak Way	Adams Peak Trail	Bord Peak Trail
8"	Sanitary Sewer	Tract B	Banner Peak Way	Colobel Ave. Exst SAS
8"	Sanitary Sewer	Crag Peak Way	Lot 49/50 B 3	Deer Horn Peak Rd.
8"	Sanitary Sewer	Deer Horn Peak Rd.	Crag Peak Way	Basin Peak Way
8"	Sanitary Sewer	Basin Peak Way	Deer Horn Peak Rd.	Unit 2/3 Bndry Lot 35/36

**STORM DRAIN - UNIT 3 (INTERNAL STORM DRAIN PRIVATE)**

24"	Storm Drain	Crag Peak St.	Unit 2/3 Boundary	Deer Horn Peak Tr.
24"	Storm Drain	Deer Horn Peak Tr.	Crag Peak St.	Diamond Peak Way
18"-24"	Storm Drain	Diamond Peak Way	Deer Horn Peak Tr.	Lot 39/40 Bk. 3
24"	Storm Drain	Colobel Ave (*)	Tract B	Existing MH 1A
24"	Storm Drain	Tract B	Existing SD Colobel Ave.	Banner Peak Way

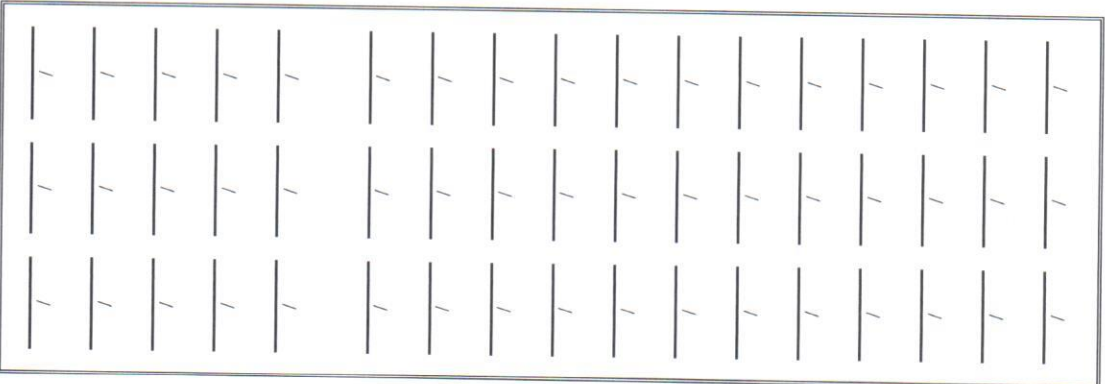

<input type="checkbox"/>	<input type="checkbox"/>
<input type="checkbox"/>	<input type="checkbox"/>
<input type="checkbox"/>	<input type="checkbox"/>
<input type="checkbox"/>	<input type="checkbox"/>
<input type="checkbox"/>	<input type="checkbox"/>
<input type="checkbox"/>	<input type="checkbox"/>
<input type="checkbox"/>	<input type="checkbox"/>
<input type="checkbox"/>	<input type="checkbox"/>
<input type="checkbox"/>	<input type="checkbox"/>
<input type="checkbox"/>	<input type="checkbox"/>
<input type="checkbox"/>	<input type="checkbox"/>
<input type="checkbox"/>	<input type="checkbox"/>
<input type="checkbox"/>	<input type="checkbox"/>
<input type="checkbox"/>	<input type="checkbox"/>
<input type="checkbox"/>	<input type="checkbox"/>

24"	Storm Drain	Banner Peak Way	Tract B	Tract F Pond
3,826 CF	First Flush Pond (11)	Tract F		
Concrete Rundown, including (3) Double D Inlets and 4' Perimeter Wall/Fence				
10 ft.	Swale	Tract A-2		
10 ft.	Swale	Tract C		
0.035 AF	Retention Pond	Tract D		
0.207 AF	Retention Pond	Tract Y		
10 ft.	Swale	Tract X		
10 ft.	Swale	Tract Z		

<input type="checkbox"/>	<input type="checkbox"/>	<input type="checkbox"/>	<input type="checkbox"/>
<input type="checkbox"/>	<input type="checkbox"/>	<input type="checkbox"/>	<input type="checkbox"/>
<input type="checkbox"/>	<input type="checkbox"/>	<input type="checkbox"/>	<input type="checkbox"/>
<input type="checkbox"/>	<input type="checkbox"/>	<input type="checkbox"/>	<input type="checkbox"/>
<input type="checkbox"/>	<input type="checkbox"/>	<input type="checkbox"/>	<input type="checkbox"/>
<input type="checkbox"/>	<input type="checkbox"/>	<input type="checkbox"/>	<input type="checkbox"/>
<input type="checkbox"/>	<input type="checkbox"/>	<input type="checkbox"/>	<input type="checkbox"/>
<input type="checkbox"/>	<input type="checkbox"/>	<input type="checkbox"/>	<input type="checkbox"/>
<input type="checkbox"/>	<input type="checkbox"/>	<input type="checkbox"/>	<input type="checkbox"/>
<input type="checkbox"/>	<input type="checkbox"/>	<input type="checkbox"/>	<input type="checkbox"/>
<input type="checkbox"/>	<input type="checkbox"/>	<input type="checkbox"/>	<input type="checkbox"/>
<input type="checkbox"/>	<input type="checkbox"/>	<input type="checkbox"/>	<input type="checkbox"/>
<input type="checkbox"/>	<input type="checkbox"/>	<input type="checkbox"/>	<input type="checkbox"/>
<input type="checkbox"/>	<input type="checkbox"/>	<input type="checkbox"/>	<input type="checkbox"/>

to DRB approval of this listing. The items listed below are subject to the standard SIA requirements.

Financially Guaranteed DRC #	Constructed Under DRC #	Size	Type of Improvement	Location	From	To	Construction Certification	
							Private Inspector P.E.	City Crst Engineer
							/	/
							/	/
							/	/
Approval of Creditable Items:							Approval of Creditable Items:	
Impact Fee Administrator Signature							City User Dept. Signature	
Date							Date	

- 1 Sidewalks to be Deferred per Exhibit
- 2 Includes Knuckles
- 3 Street Lights Per DPM
- 4 Water Infrastructure includes Valves, Fittings, Valve Boxes, Fire Hydrants, and Appurtenances.
- 5 Sanitary Sewer includes manholes and service connection to property line
- 6 Storm Drain includes manholes & inlets
- 7 Grading & Drainage certification per DPM for release of SIA & Financial Guaranty's. Financial Guaranty's are not required for grading.
- 8 Colobel (1) to include remove and replace asphalt's: remove unused existing storm pipe and stubs or water or sewer stubs
- 9 Refer to 8" Curb and Gutter Exhibit
- 10 These Storm Drain Items are associates with and for benefit of Unit 2
- 12 If Unit 2 & 3 are developed seperately, a revised phasing plan shall be submitted and included in the work order of the first unit developed
- 13 storm drain sizes may be subject to change at DRC, pending Hydrology approval of the finalized HGL calculations.
- 14 Prior to final plat or work order, whichever is first.

**AGENT / OWNER** **DEVELOPMENT REVIEW BOARD MEMBER APPROVALS**

**Diane Hoelzer, P.E.** **4/25/18**  
 NAME (print) DRB CHAIR - date

**MARK GOODWIN & ASSOCIATES** **4/25/18**  
 NAME (print) TRANSPORTATION DEVELOPMENT - date

*Mark Goodwin* **4/25/18**  
 SIGNATURE - date UTILITY DEVELOPMENT - date

**MARK GOODWIN** **4/25/18**  
 TRANSPORTATION DEVELOPMENT - date

**MARK GOODWIN** **4/25/18**  
 UTILITY DEVELOPMENT - date

**MARK GOODWIN** **4/25/18**  
 CITY ENGINEER - date

**MARK GOODWIN** **4/25/18**  
 CODE ENFORCEMENT - date

**MARK GOODWIN** **4/25/18**  
 AMAFCA - date

**MARK GOODWIN** **4/25/18**  
 PARKS & GENERAL SERVICES - date

**DESIGN REVIEW COMMITTEE REVISIONS**

REVISION	DATE	DRC CHAIR	USER DEPARTMENT	AGENT / OWNER