

- EROSION CONTROL NOTES:**
1. CONTRACTOR IS RESPONSIBLE FOR OBTAINING A TOPSOIL DISTURBANCE PERMIT PRIOR TO BEGINNING WORK.
  2. CONTRACTOR IS RESPONSIBLE FOR MAINTAINING RUN-OFF ON SITE DURING CONSTRUCTION.
  3. CONTRACTOR IS RESPONSIBLE FOR CLEANING ALL SEDIMENT THAT GETS INTO EXISTING RIGHT-OF-WAY.
  4. REPAIR OF DAMAGED FACILITIES AND CLEANUP OF SEDIMENT ACCUMULATIONS ON ADJACENT PROPERTIES AND IN PUBLIC FACILITIES IS THE RESPONSIBILITY OF THE CONTRACTOR.
  5. ALL EXPOSED EARTH SURFACES MUST BE PROTECTED FROM WIND AND WATER EROSION PRIOR TO FINAL ACCEPTANCE OF ANY PROJECT.

**DRAINAGE NARRATIVE**  
 THIS SITE IS LOCATED WITHIN THE NORTH ALBUQUERQUE ACRES MASTER DRAINAGE PLAN. THIS SITE WILL MATCH THE ALLOWED DISCHARGE RATES AND BASINS SHOWN FOR THIS SITE WITHIN THE DEVELOPED CONDITION ASSUMPTIONS. THE SITE WILL INCLUDE WATER QUALITY FEATURES TO CONFORM WITH THE CURRENT CITY REQUIREMENTS FOR WATER QUALITY DISCHARGE STANDARDS.

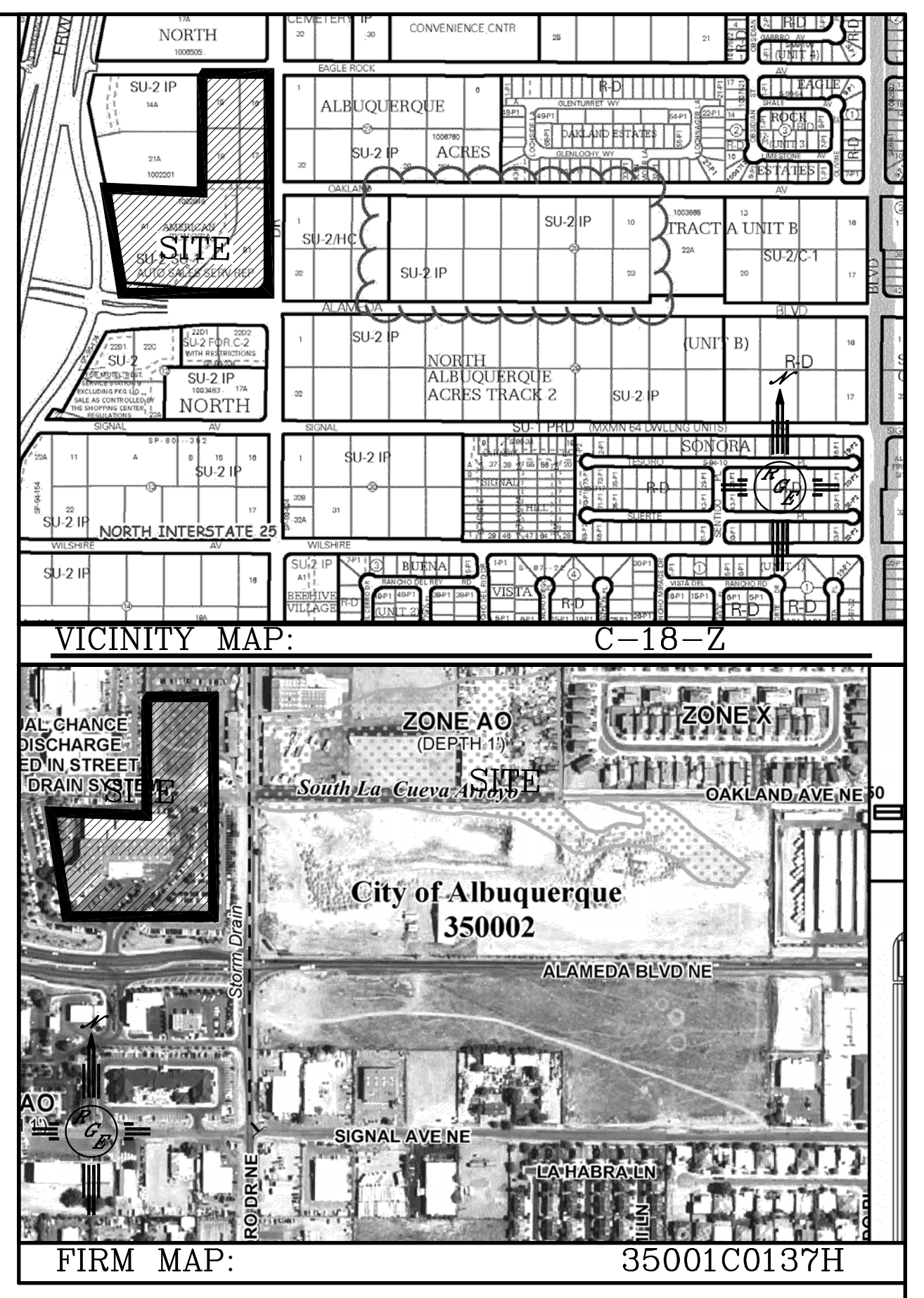

**LEGAL DESCRIPTION:**

- NOTES:**
1. ALL SPOT ELEVATIONS REPRESENT FLOWLINE ELEVATION UNLESS OTHERWISE NOTED.
  2. ALL CURB AND GUTTER TO 6" HEADER UNLESS OTHERWISE NOTED.
  3. ALL RETAINING WALL DESIGN SHALL BE BY OTHERS.

**LEGEND**

---	EXISTING CONTOUR
- - -	EXISTING INDEX CONTOUR
---	PROPOSED CONTOUR
- - -	PROPOSED INDEX CONTOUR
▲	SLOPE TIE
×	EXISTING SPOT ELEVATION
×	PROPOSED SPOT ELEVATION
---	BOUNDARY
---	CENTERLINE
---	RIGHT-OF-WAY
---	PROPOSED CURB AND GUTTER
---	EXISTING CURB AND GUTTER
---	PROPOSED SIDEWALK
---	PROPOSED SETBACK
---	PROPOSED LOT LINE
---	PROPOSED SCREEN WALL
---	PROPOSED RETAINING WALL

ROUGH GRADING APPROVAL \_\_\_\_\_ DATE \_\_\_\_\_

	<b>AMERICAN TOYOTA</b>	DRAWN BY WCWJ
	<b>GRADING AND DRAINAGE PLAN</b>	DATE 12-01-14
12/1/14		SHEET #
DAVID SOULE P.E. #14522	1806 CENTRAL AVENUE SE SUITE 201 ALBUQUERQUE, NM 87106 (505) 872-0999	JOB # 21403

**CAUTION:**  
 EXISTING UTILITIES ARE NOT SHOWN. IT SHALL BE THE SOLE RESPONSIBILITY OF THE CONTRACTOR TO CONDUCT ALL NECESSARY FIELD INVESTIGATIONS PRIOR TO ANY EXCAVATION TO DETERMINE THE ACTUAL LOCATION OF UTILITIES & OTHER IMPROVEMENTS.

