

18



Completed. 8-31-04
PA

DRB CASE ACTION LOG (PREL & FINAL)

REVISED 2/5/04

This sheet must accompany your plat or site plan to obtain delegated signatures. Return sheet with site plan/plat once comments are addressed.

DRB Application No.: **04DRB-01180 (P&F)**

Project # **1003537**

Project Name **PINON POINT SUBD. UNIT 5**

Agent: **Community Sciences Corp.**

Phone No.: **897-0000**

Your request for (SDP for SUB), (SDP for BP), **(FINAL PLATS)**, (MASTER DEVELOP. PLAN), was approved on 8.11.04 by the DRB with delegation of signature(s) to the following departments.

OUTSTANDING SIGNATURES COMMENTS TO BE ADDRESSED

TRANSPORTATION: _____

- _____
- _____
- _____

UTILITIES: _____

- _____
- _____

CITY ENGINEER / AMAFCA: _____

- _____
- _____

PARKS / CIP: _____

- _____
- _____

PLANNING (Last to sign): _____

- _____
- _____

Planning must record this plat. Please submit the following items:

- The original plat and a mylar copy for the County Clerk.
- Tax certificate from the County Treasurer.
- Recording fee (checks payable to the County Clerk). RECORDED DATE: _____
- Tax printout from the County Assessor.

Include 3 copies of the approved site plan along with the originals.

County Treasurer's signature must be obtained prior to the recording of the plat with the County Clerk.

Property Management's signature must be obtained prior to Planning Department's signature.

AGIS DXF File approval required. OK

Copy of recorded plat for Planning.

Project Number

1003537



DRB CASE ACTION LOG (PREL & FINAL)

REVISED 2/5/04

This sheet must accompany your plat or site plan to obtain delegated signatures. Return sheet with site plan/plat once comments are addressed.

DRB Application No.: <u>04DRB-01180 (P&F)</u>	Project # <u>1003537</u>
Project Name <u>PINON POINT SUBD. UNIT 5</u>	
Agent: <u>Community Sciences Corp.</u>	Phone No.: <u>897-0000</u>

Your request for (SDP for SUB), (SDP for BP), **FINAL PLATS**, (MASTER DEVELOP. PLAN), was approved on 8.11.04 by the DRB with delegation of signature(s) to the following departments.
OUTSTANDING SIGNATURES COMMENTS TO BE ADDRESSED

- TRANSPORTATION: _____
- _____
- _____
- _____
- _____
- UTILITIES: _____
- _____
- _____
- _____
- CITY ENGINEER / AMAFCA: _____
- _____
- _____
- _____
- PARKS / CIP: _____
- _____
- _____
- _____
- PLANNING (Last to sign): _____
- _____
- _____
- _____

- Planning must record this plat. Please submit the following items:**
 - The original plat and a mylar copy for the County Clerk.
 - Tax certificate from the County Treasurer.
 - Recording fee (checks payable to the County Clerk). RECORDED DATE: _____
 - Tax printout from the County Assessor.
 - Include 3 copies of the approved site plan along with the originals.**
 - County Treasurer's signature must be obtained prior to the recording of the plat with the County Clerk.**
 - Property Management's signature must be obtained prior to Planning Department's signature.**
 - AGIS DXF File approval required.** *OK*
 - Copy of recorded plat for Planning.**

Project Number 1003537

AGIS ELECTRONIC APPROVAL FORM

DRB Project Case #: 1003537

Subdivision Name: Pinon Pointe Unit 5 - Lots 104A, 105A, & 106A

Surveyor: Thomas Patrick

Company/Agent: Community Sciences Corporation

Contact Person: _____ E-mail: _____

Phone: _____ Fax: _____

DXF Received Date: 8/2/2004

Hard-Copy Date: 8/2/2004

Coordinate system: NMSP Grid (NAD 83) NMSP Grid (NAD 27) Ground rotated to NMSP Grid Other

Thomas Patrick
Approved

8/2/04
Date

*The dxf file cannot be accepted at this time for the following reason(s):

AGIS Use Only

Copied cov3537 to agiscov on 8/2/2004 . Contact person notified on 8/2/2004

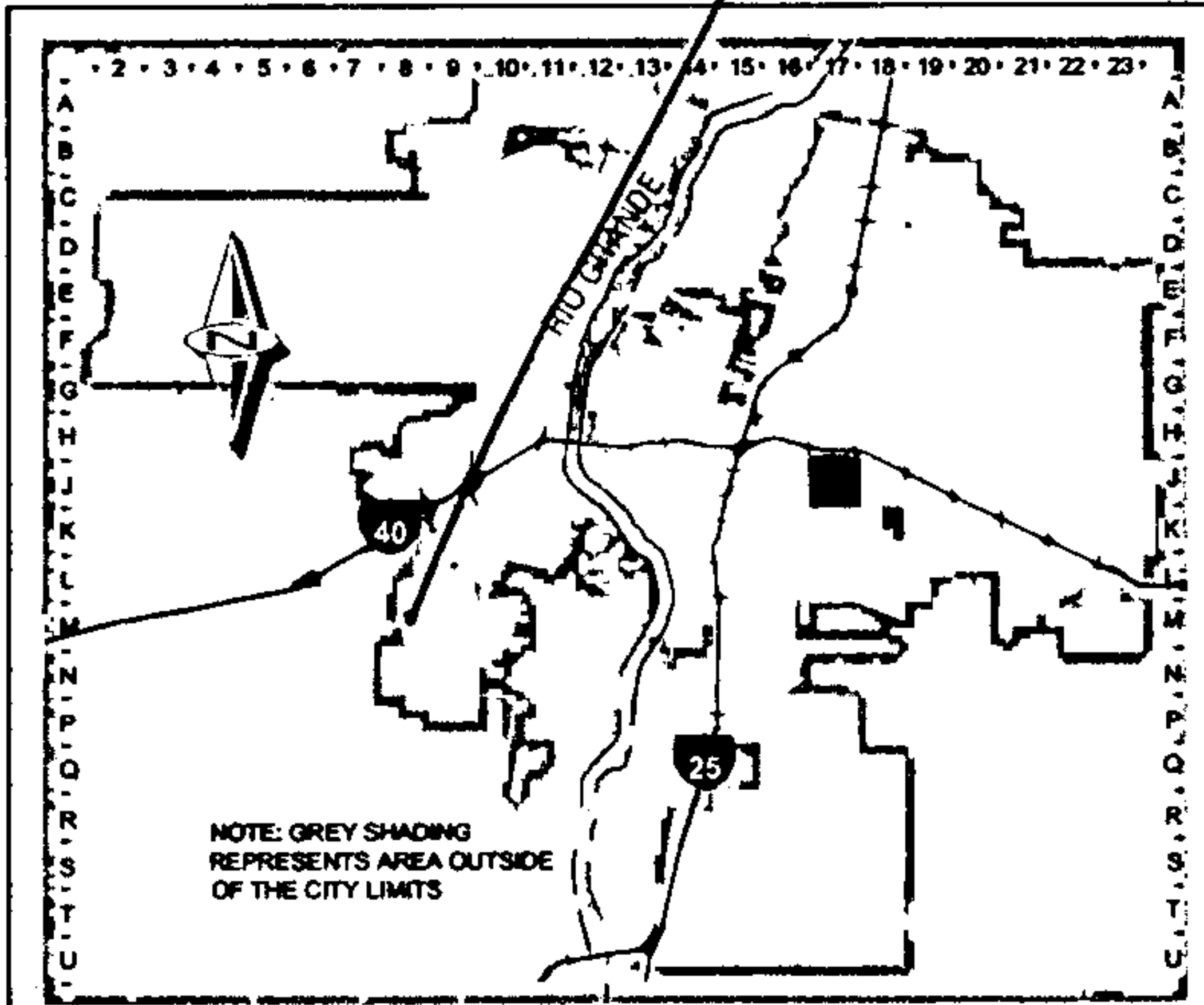
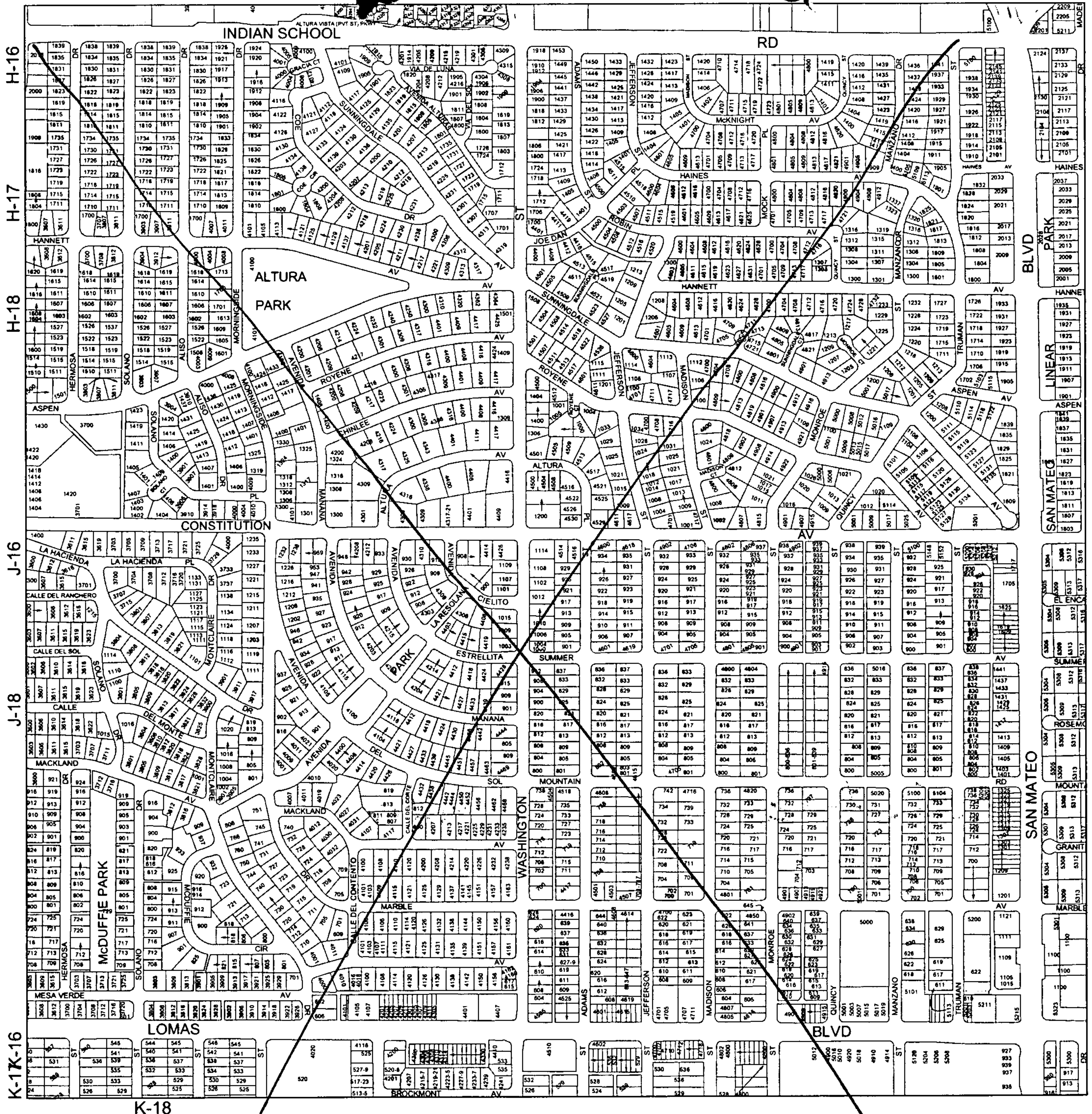

Address Map Page:

J-17

Symbol Legend

- | Unincorporated Areas
- Parcel Boundaries
- Easement Lines
- Freeway Lanes

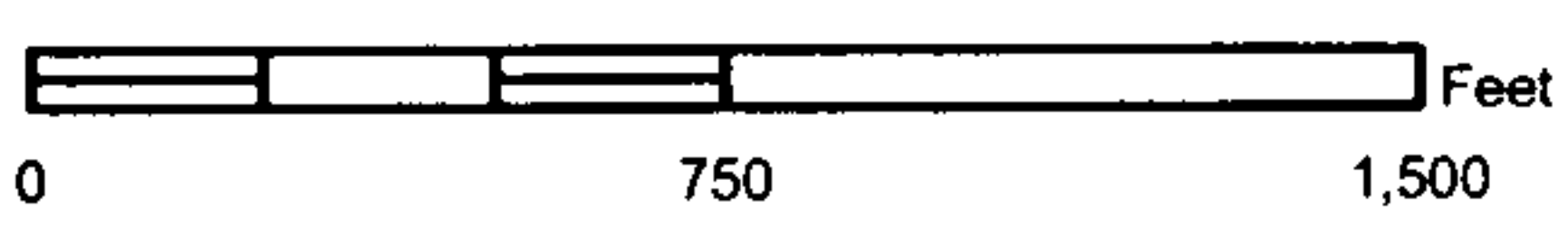

These addresses are for information purposes only and are not intended for address verification.



THREE HUNDRED YEARS
1706 • 2006
ALBUQUERQUE

Hacienda Historia

A G I S
Albuquerque Geographic Information System
PLANNING DEPARTMENT

© Copyright 2004

Map amended through: Jul 23, 2004



**DEVELOPMENT REVIEW BOARD
ACTION SHEET**

Plaza del Sol Hearing Room, Basement, Plaza del Sol Building

August 11, 2004

9:00 a.m.

MEMBERS:

Sheran Matson, AICP, DRB Chair
Claire Senova, Administrative Assistant

Wilfred Gallegos, Transportation Development
Brad Bingham, Alternate City Engineer

Roger Green, Utility Development
Christina Sandoval, Parks & Recreation

NOTE: UNLESS ANNOUNCED DURING THE MEETING, THE DEVELOPMENT REVIEW BOARD WILL NOT TAKE A LUNCH BREAK.

NOTE: INDIVIDUALS WITH DISABILITIES WHO NEED SPECIAL ASSISTANCE TO PARTICIPATE AT THIS MEETING SHOULD CONTACT CLAIRE SENOVA, PLANNING DEPARTMENT, AT 924-3946. HEARING IMPAIRED USERS MAY CONTACT HER VIA THE NEW MEXICO RELAY NETWORK BY CALLING TOLL-FREE:1-800-659-8331.

NOTE: REQUESTS FOR DEFERRAL OF CASES WILL BE DISCUSSED BY THE BOARD AND THE APPLICANT AND/OR AGENT AT THE BEGINNING OF THE AGENDA. BOTH PARTIES MUST AGREE UPON THE DATE OF DEFERRAL. IF THE APPLICANT/AGENT IS NOT PRESENT, THE ADMINISTRATIVE ASSISTANT MUST RECEIVE A LETTER, PRIOR TO THE HEARING DATE, REQUESTING A SPECIFIC DEFERRAL DATE. THE BOARD WILL DISCUSS AND MAKE A DECISION AT THE HEARING. THE APPLICANT/AGENT WILL THEN BE INFORMED OF THE DEFERRAL DATE AND REASON.

- A. Call to Order: 9:00 A.M.
- B. Changes and/or Additions to the Agenda
- C. New or Old Business

Adjourned: 11:25 A.M.

CASES WHICH REQUIRE PUBLIC NOTIFICATION

MAJOR SUBDIVISIONS, VACATIONS, SIA EXTENSIONS AND SITE DEVELOPMENT PLANS

- 1. **Project # 1001562**
04DRB-01103 Major-Two Year SIA
04DRB-01105 Major-Two Year SIA

MARK GOODWIN & ASSOCIATES, PA agent(s) for PULTE HOMES OF NEW MEXICO request(s) the above action(s) for all or a portion of Tract(s) A, Block(s) 28, FOUR HILLS VILLAGE, 5TH INSTALLMENT (to be known as **RESERVE @ FOUR HILLS**, zoned R-1 residential zone, located on WAGON TRAIL DR SE, between RATON AVE SE and RIO ARRIBA AVE SE containing approximately 17 acre(s). [REF: 02DRB-01096, 02DRB-01097, 02DRB-01098, 02DRB-01263] (M-22) **A TWO YEAR EXTENSION OF THE SIA WAS APPROVED. A TWO YEAR EXTENSION OF THE SIA WAS APPROVED.**

2. **Project # 1000296**
04DRB-01109 Major-Vacation of
Public Easements

BOHANNAN HUSTON, INC agent(s) for SCOTT PATRICK HOMES request(s) the above action(s) for all or a portion of Lot(s) 16P1 & 17P1, **OXBOW VILLAGE**, zoned SU-3 special center zone, located on OXBOW VILLAGE LN NW, between ALAMAGORDO DR NW and MORNING DOVE NW containing approximately 1 acre(s). [REF: 01400-DRB-01808] (G-11) **THE VACATION WAS APPROVED AS SHOWN ON EXHIBIT B IN THE PLANNING FILE.**

04DRB-01186 Minor-Prelim&Final Plat
Approval

BOHANNAN HUSTON, INC agent(s) for GARY & JUNE MARTIN-SCOTT PATRICK HOMES request(s) the above action(s) for all or a portion of Lot(s) 16-A, P1, **OXBOW VILLAGE**, zoned SU-3 special center zone, located on OXBOW VILLAGE LN NW, between ST JOSEPH'S DR NW and ALAMAGORDO DR NW containing approximately 1 acre(s). [REF: 04DRB00109] (G-11) **THE PRELIMINARY PLAT WAS APPROVED WITH FINAL SIGN OFF DELEGATED TO PLANNING FOR THE AGIS DXF FILE.**

3. **Project # 1002511**
04DRB-01118 Major-Preliminary Plat
Approval
04DRB-01119 Minor-Temp Defer SDWK
04DRB-01120 Minor-Sidewalk Waiver

ISAACSON & ARFMAN PA agent(s) for KB HOME OF NEW MEXICO INC request(s) the above action(s) for all or a portion of Tract(s) A UNIT 1, **SUNDANCE SUBDIVISION UNIT 2**, zoned R-LT residential zone, located on BLUEWATER RD NW, between UNSER BLVD NW and UNSER DIVERSION CHANNEL containing approximately 15 acre(s). [REF: 03DRB-00858, 01578, 01805, 04DRB-00358, 00359] (K-9) **WITH THE SIGNING OF THE INFRASTRUCTURE LIST REDATED 8/11/04 AND APPROVAL OF THE GRADING PLAN ENGINEER STAMP DATED 6/24/03 THE PRELIMINARY PLAT WAS APPROVED. TEMPORARY DEFERRAL OF CONSTRUCTION OF SIDEWALKS ON THE INTERIOR STREETS WAS APPROVED AS SHOWN ON EXHIBIT C IN THE PLANNING FILE. A SIDEWALK VARIANCE FOR WAIVER OF SIDEWALKS WAS APPROVED AS SHOWN ON EXHIBIT C IN THE PLANNING FILE.**

4. **Project # 1003542**
04DRB-01081 Major-Vacation of Pub
Right-of-Way

GEORGE & LULU SAGE-ALLISON request(s) the above action(s) for all or a portion of Lot(s) 23 & 24, Block(s) 31, PEREA ADDITION, zoned SU-2 special neighborhood zone, TH, located on 15TH ST NW, between ORCHARD PL NW and MARBLE AVE NW containing approximately 1 acre(s). [REF:V-80-17](J-13) **VACATION WAS APPROVED AS SHOWN ON EXHIBIT B IN THE PLANNING FILE.**

5. **Project # 1003554**
04DRB-01099 Major-Vacation of Pub
Right-of-Way
04DRB-01100 Major-Vacation of Public
Easements

TIERRA WEST LLC agent(s) for AMC DEVELOPMENT INC request(s) the above action(s) for all or a portion of Lot(s) 1-10, Block(s) 7 Lot(s) 1-10 Block(s) 8 and Lot(s) 1-8 Block(s) 9, SKYLINE HEIGHTS, zoned C-2 community commercial zone, located on CENTRAL AVE SE, between EUBANK BLVD SE and CONCHAS ST SE containing approximately 7 acre(s). [REF: ZA-88-406] (L-20) **THE VACATIONS WERE APPROVED AS SHOWN ON EXHIBIT B IN THE PLANNING FILE WITH THE FOLLOWING CONDITION OF FINAL PLAT: THE EXISTING SANITARY SEWER LINE WILL BE RELOCATED AND/OR ABANDONED AS REQUIRED BY THE CITY.**

6. **Project # 1003369**
04DRB-00514 Major-Drainage Plan to
Determine the Cost Allocation for Storm
Drainage Improvements

BOB KEERAN agent(s) for LLAVE CONSTRUCTION INC request(s) these action(s) for all or a portion of Unit(s) 3, Lot(s) 6 & 7, Tract(s) 3, Block(s) 16, NORTH ALBUQUERQUE ACRES, VINTNER COURT SUBDIVISION, zoned DETENTION POND, located on VINTNER NE, between VENTURA NE and CORONA NE containing approximately 2 acre(s). [Deferred from 5/12/04, 5/26/04, 6/9/04, 6/23/04, 7/14/04, 7/21/04 & 8/11/04] (C-20) **DEFERRED AT THE AGENT'S REQUEST TO 8/25/04.**

**SITE DEVELOPMENT PLANS (EPC FINAL SIGN-OFF) AMENDED PLANS AND MASTER DEVELOPMENT PLANS
(CITY COUNCIL FINAL SIGN-OFF)**

NOTE: IF THE APPLICANT/AGENT IS NOT PRESENT WHEN THEIR REQUEST IS CALLED, THEN THE REQUEST MAY BE INDEFINITELY DEFERRED ON A NO SHOW.

7. **Project # 1000399**
04DRB-01191 Minor-SiteDev Plan
Subd/EPC
04DRB-01192 Minor-SiteDev Plan
BldPermit/EPC
- GREGORY HICKS & ASSOCIATES P.C. agent(s) for UROLOGY NETWORK OF NEW MEXICO request(s) the above action(s) for all or a portion of Tract(s) A-1-B & A-1-C, **LOMAS CENTER**, zoned SM, SU-1, SM; R-G, located on the southeast corner of BROADWAY NE between LOMAS BLVD NE and ROMA NE containing approximately 1 acre(s). [REF: 04DRB-00957, 00952, 00953, SP-93-192] [**Carmen Marrone, EPC Case Planner**] (J-14) **THE SITE PLAN FOR SUBDIVISION WAS APPROVED WITH FINAL SIGN OFF DELEGATED TO TRANSPORTATION DEVELOPMENT FOR STALL DIMENSIONS. THE SITE PLAN FOR BUILDING PERMIT WAS APPROVED WITH FINAL SIGN OFF DELEGATED TO TRANSPORTATION DEVELOPMENT FOR STALL DIMENSIONS AND PARKING CALCULATIONS.**
8. **Project # 1003371**
04DRB-01184 Minor-SiteDev Plan
BldPermit
- STEPHEN C DAY, ARCHITECT agent(s) for DRIVETIME AUTOMOTIVE, DAN PACKOWSKI request(s) the above action(s) for all or a portion of Lot(s) 31 & 32, Block(s) 11, NORTH ALBUQUERQUE ACRES, TRACT A, UNIT B, (to be known as **DRIVE TIME @ ALAMEDA**) zoned SU-2 FOR M-1, located on ALAMEDA BLVD NE, between SAN MATEO NE and I-25 containing approximately 2 acre(s). [REF: 04DRB00531] [*Deferred from 8/11/04*] (C-18) **DEFERRED AT THE AGENT'S REQUEST TO 8/25/04.**

MINOR PLATS, FINAL (MAJOR) PLATS, AMENDED PLATS AND PLANS

9. **Project # 1003416**
04DRB-01183 Minor-Prelim&Final Plat
Approval
- SURVEYS SOUTHWEST LTD agent(s) for MICHAEL GOMEZ request(s) the above action(s) for all or a portion of Tract(s) 317-A, **TOWN OF ATRISCO GRANT, UNIT 3**, zoned R-1 residential zone, located on BRIDGE ST SW, between EUCARIZ AVE SW and YERBA RD SW containing approximately 3 acre(s). [REF: 04DRB-00670] (L-11) **INDEFINITELY DEFERRED AT THE AGENT'S REQUEST.**
10. **Project # 1003549**
04DRB-01091 Minor- Prelim&Final Plat
Approval
- SURVEYS SOUTHWEST, LTD agent(s) for DANIEL PUCETTI request(s) the above action(s) for all or a portion of Lot(s) 1, Block(s) 1, **ROSEMONT PARK ADDITION**, zoned S-MRN (SAWMILL R-C), located on MOUNTAIN RD NW, between 12TH ST NW and 11TH ST NW containing approximately 1 acre(s). [REF: ZA-81-350, ZA-84-445, V-76-42] (Was indefinitely deferred on 7/21/04) (J-13) **PRELIMINARY AND FINAL PLAT WERE APPROVED AND SIGNED OFF BY THE BOARD.**
11. **Project # 1002711**
04DRB-01189 Minor-Subd Design
(DPM) Variance
- MARK GOODWIN & ASSOCIATES, PA agent(s) for STV INVESTMENTS, LLC request(s) the above action(s) for all or a portion of Lot(s) 7-12, 21-26, Block(s) 27, Tract(s) A, **NORTH ALBUQUERQUE ACRES, UNIT B**, (to be known as **OAKLAND ESTATES**) zoned R-D residential and related uses zone, developing area, located on EAGLE ROCK AVE NE, between SAN PEDRO NE and LOUISIANA BLVD NE containing approximately 11 acre(s). [REF: 03110-01915, 03138-1914] [Was listed under Project #1003099 in error] (C-18) **A SIDEWALK VARIANCE FROM DESIGN STANDARDS WAS APPROVED A SHOWN ON EXHIBIT C IN THE PLANNING FILE.**

12. **Project # 1002050**
04DRB-01193 Minor-Prelim&Final Plat
Approval

MARK GOODWIN & ASSOCIATES, PA agent(s) for MEL FRAMIE, LLC request(s) the above action(s) for all or a portion of Lot(s) 23A-P1 THRU 30A-P1, **TRAILS @ LAS MARCADAS SUBDIVISION**, zoned R-LT residential zone, located on GOLF COURSE RD NW, between MARNA LYNN AVE NW and JILL PATRICIA ST NW containing approximately 2 acre(s). [REF: V-89-95, 03EPC00146, 03DRB00573] (C-12) **THE PRELIMINARY PLAT WAS APPROVED WITH FINAL SIGN OFF DELEGATED TO TRANSPORTATION DEVELOPMENT FOR ENCROACHMENT AGREEMENT AND PUE WITHIN RIGHT-OF-WAY AND UTILITIES SIGNATURES ON THE PLAT.**

13. **Project # 1002397**
04DRB-01196 Major-Final Plat Approval

TIERRA WEST LLC agent(s) for SHULL REALTY & WATERS EDGE LLC request(s) the above action(s) for all or a portion of Lot(s) 1-9, **LANDS OF TAYLOR-MARTIN L**, zoned C-1 neighborhood commercial zone, located on LA ORILLA RD NW, between COORS BLVD NW and CORRALES DRAIN containing approximately 12 acre(s). [REF:Z-87-56, DRB-87-200, 02DRB01925, 04DRB-00762, 00797, 00798 (E-12) **FINAL PLAT WAS APPROVED WITH FINAL SIGN OFF DELEGATED TO CITY ENGINEER FOR A & C, PRIVATE EASEMENTS ON LOTS 1, 2 & 3 AND DECLARATION OF COVENANTS.**

14. **Project # 1002851**
04DRB-01194 Major-Final Plat Approval

ABQ ENGINEERING INC agent(s) for LOS CANDELARIAS PARTNERS request(s) the above action(s) for all or a portion of Tract(s) 4, **LA PLAZA ACEQUIA 1, ALVARADO GARDENS**, zoned R-2 residential zone, located on CANDELARIA NW, between RIO GRANDE NW and DURANES LATERAL containing approximately 2 acre(s). [REF: 03DRB-01639, 03DRB-01278] (G-12) **FINAL PLAT WAS APPROVED AND SIGNED OFF BY THE BOARD.**

15. **Project # 1003026**
04DRB-01195 Minor-Final Plat Approval

ABQ ENGINEERING INC agent(s) for LOS CANDELARIAS PARTNERS request(s) the above action(s) for all or a portion of Lot(s) 3, **LA PLAZA ACEQUIA 2**, ALVARADO GARDENS, zoned R-LT residential zone, located on CANDELARIA NW, between CANDELARIA NW and DURANES LATERAL containing approximately 1 acre(s). [REF: 03DRB-01712] (G-12) **FINAL PLAT WAS APPROVED AND SIGNED OFF BY THE BOARD.**

16. **Project # 1003175**
04DRB-01190 Minor-Final Plat Approval

BOHANNAN HUSTON agent(s) for D. R. HORTON request(s) the above action(s) for all or a portion of Tract(s) 33C-1-A, **SUN GATE SUBDIVISION**, zoned R-LT residential zone, located on GIBSON BLVD SW, between BLAKE RD SW and MESA ARENOSA DR SW containing approximately 25 acre(s). [REF: 04DRB-00010, 00011& 00012] (N-9) **FINAL PLAT WAS APPROVED AND SIGNED OFF BY THE BOARD.**

17. **Project # 1003588**
04DRB-01173 Minor-Prelim&Final Plat Approval

RHOMBUS PA, INC. agent(s) for UNM FOUNDATION, INC. request(s) the above action(s) for all or a portion of Lot(s) 21-A & B-1, Block(s) 10, **PEREA ADDITION**, zoned SU-2 special neighborhood zone, TH, located on MARQUETTE AVE NW, between 12TH ST NW and 13TH ST NW containing approximately 1 acre(s). [REF: LUC-92-8, 1002925/03LUC-01423] (J-13) **PRELIMINARY AND FINAL PLAT WERE APPROVED AND SIGNED OFF BY THE BOARD.**

18. **Project # 1003537**
04DRB-01180 Minor-Prelim&Final Plat
Approval

COMMUNITY SCIENCES CORP agent(s) for PULTE HOMES request(s) the above action(s) for all or a portion of Lot(s) 104-106, **PINON POINTE SUBDIVISION, UNIT 5**, zoned R-LT residential zone, located on WEYMOUTH ST NW, between IRVING BLVD NW and LAS VENTANAS RD NW containing approximately 1 acre(s). [REF: 04DRB01067] (B-9) **PRELIMINARY AND FINAL PLAT WERE APPROVED AND SIGNED OFF BY THE BOARD.**

19. **Project # 1003112**
04DRB-01005 Major-Final Plat
Approval

COMMUNITY SCIENCES CORP agent(s) for COLLATZ INC, JACK CLIFFORD request(s) the above action(s) for all or a portion of Tract(s) A, LANDS OF COLLATZ INC, **RINCONADA TRAILS**, zoned SU-1 special use zone, located on UNSER BLVD NW, between UNSER BLVD NW and WESTERN TRAILS NW containing approximately 9 acre(s). [REF: 03DRB-01994, 04DRB-00166, 04DRB-00167, 04DRB-00168] [*Deferred from 7/14/04, 7/21/04, 8/4/04 & 8/11/04*] (F-11/F-12) **DEFERRED AT THE AGENT'S REQUEST TO 8/18/04.**

20. **Project # 1001087**
04DRB-00004 Minor- Final Plat
Approval

HALE & SUN CONSTRUCTION INC request(s) the above action(s) for all or a portion of Lot(s) 3-4, **MAJOR ACRES SUBDIVISION**, zoned SU-2,R-T, located on 12th ST NW, between CANDELARIA RD NW and MATTHEW AVE NW containing approximately 1 acre(s). [REF: 1002231, 02ZHE-01435, 01DRB-002688, 01DRB-01891] [Final Plat was indefinitely deferred on 3/31/04] (G-14) **FINAL PLAT WAS APPROVED WITH FINAL SIGN OFF DELEGATED TO CITY ENGINEER FOR SIA.**

NO ACTION IS TAKEN ON THESE CASES:
APPLICANT - AGENT IS REQUIRED TO BE AT THE MEETING

21. **Project # 1003591**
04DRB-01185 Minor-Sketch Plat or Plan
- BOHANNAN HUSTON agent(s) for CURB, INC. request(s) the above action(s) for all or a portion of Tract(s) 31A-1-A, **SUN GATE ESTATES**, zoned R-LT residential zone, located on GIBSON BLVD SW, between BLAKE RD SW and 98TH ST SW containing approximately 45 acre(s). [REF: 03DRB-01679 & 80, 1003014] (N-9) **THE ABOVE REQUEST WAS REVIEWED AND COMMENTS WERE GIVEN.**
22. **Project # 1003593**
04DRB-01198 Minor-Sketch Plat or Plan
- BOHANNAN HUSTON agent(s) for D. R. HORTON request(s) the above action(s) for all or a portion of Tract(s) 6, **VENTANA RANCH WEST**, zoned R-LT residential zone, located on IRVING BLVD NW and VENTANA RIDGE RD NW, containing approximately 24 acre(s). (B-8) **THE ABOVE REQUEST WAS REVIEWED AND COMMENTS WERE GIVEN.**
23. **Project # 1003594**
04DRB-01199 Minor-Sketch Plat or Plan
- BOHANNAN HUSTON agent(s) for D. R. HORTON request(s) the above action(s) for all or a portion of Tract(s) 1A, 1B & 3, **VENTANA RANCH WEST**, zoned R-LT residential zone, located on PASEO DEL NORTE NW and IRVING BLVD NW, containing approximately 32 acre(s). (B-8) **THE ABOVE REQUEST WAS REVIEWED AND COMMENTS WERE GIVEN.**

24. **Project # 1001568**
04DRB-01170 Minor-Sketch Plat or Plan

LINDA CARROLL agent(s) for INTERNATIONAL FOOD SERVICE HOLDINGS, LLC request(s) the above action(s) for all or a portion of Tract(s) 90, **MRGCD, MAP 35**, zoned R-1 residential zone, RA-2, located on RIO GRANDE BLVD NW, between INDIAN SCHOOL RD NW and LOS ANAYAS RD NW containing approximately 2 acre(s).[REF:01EPC-01563] (H-13) **THE ABOVE REQUEST WAS REVIEWED AND COMMENTS WERE GIVEN.**

25. **Project # 1003589**
04DRB-01181 Minor-Sketch Plat or Plan

SAMUEL DICKEY request(s) the above action(s) for all or a portion of Tract(s) 4A & 4B, **RAY PENA SUBDIVISION**, zoned R-D residential and related uses zone, developing area, located on WESTWARD LN NW, between ATRISCO DR NW and NORTHERN TRAIL NW containing approximately 1 acre(s). (F-11) **THE ABOVE REQUEST WAS REVIEWED AND COMMENTS WERE GIVEN.**

26. **Project # 1003592**
04DRB-01200 Minor-Sketch Plat or Plan

RHODES & SALMON PC agent(s) for GOLDEN SLUMBERS INC request(s) the above action(s) for all or a portion of Lot(s) 1, **SUNDT INDUSTRIAL AREA SCHMIDER PARCEL**, zoned M-2 heavy manufacturing zone, located on CANDELARIA NE, between EDITH NE and I-25 containing approximately 3 acre(s). (G-15) **THE ABOVE REQUEST WAS REVIEWED AND COMMENTS WERE GIVEN.**

27. Approval of the Development Review Board Minutes for July 28, 2004. **THE DEVELOPMENT REVIEW BOARD MINUTES FOR JULY 28, 2004 WERE APPROVED.**

ADJOURNED: 11:25 A.M.

**CITY OF ALBUQUERQUE
PLANNING DEPARTMENT
August 11, 2004
DRB Comments**

Item # 18

Project # 1003537 Application # 04-01180

RE: Lots 104-106/Pinon Pointe, Unit 5/prelim & final

Planning has no objection to this lot line adjustment.

AGIS dxf is approved.

Applicant may record the plat provided one hard copy of the recorded plat is returned to planning to close the file.

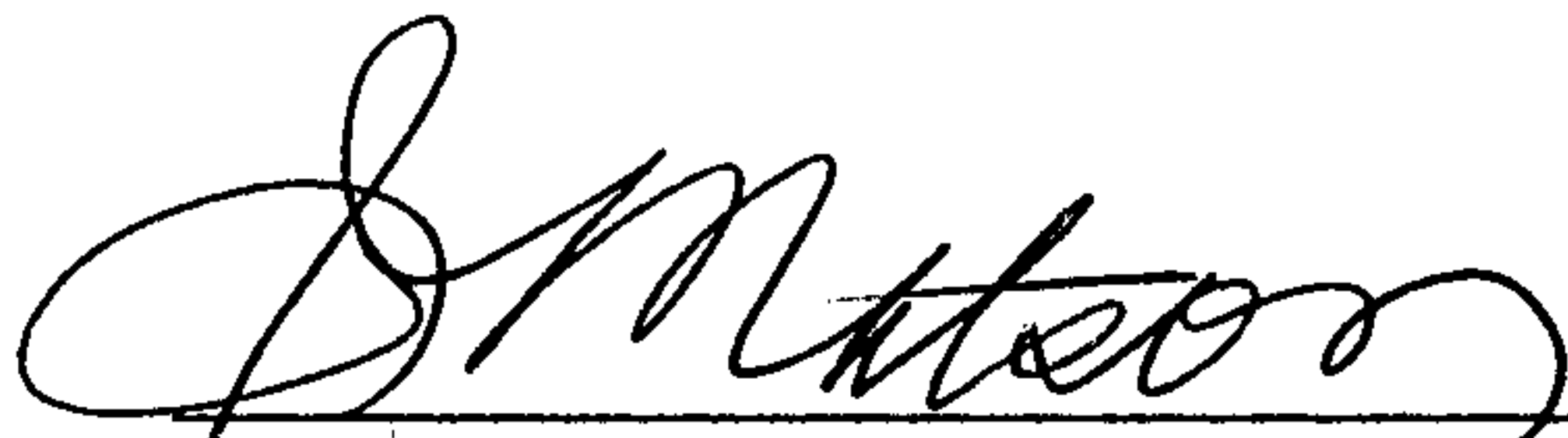

Sheran Matson, AICP DRB Chair
924-3880 fax 924-3864 smatson@cabq.gov

CITY OF ALBUQUERQUE

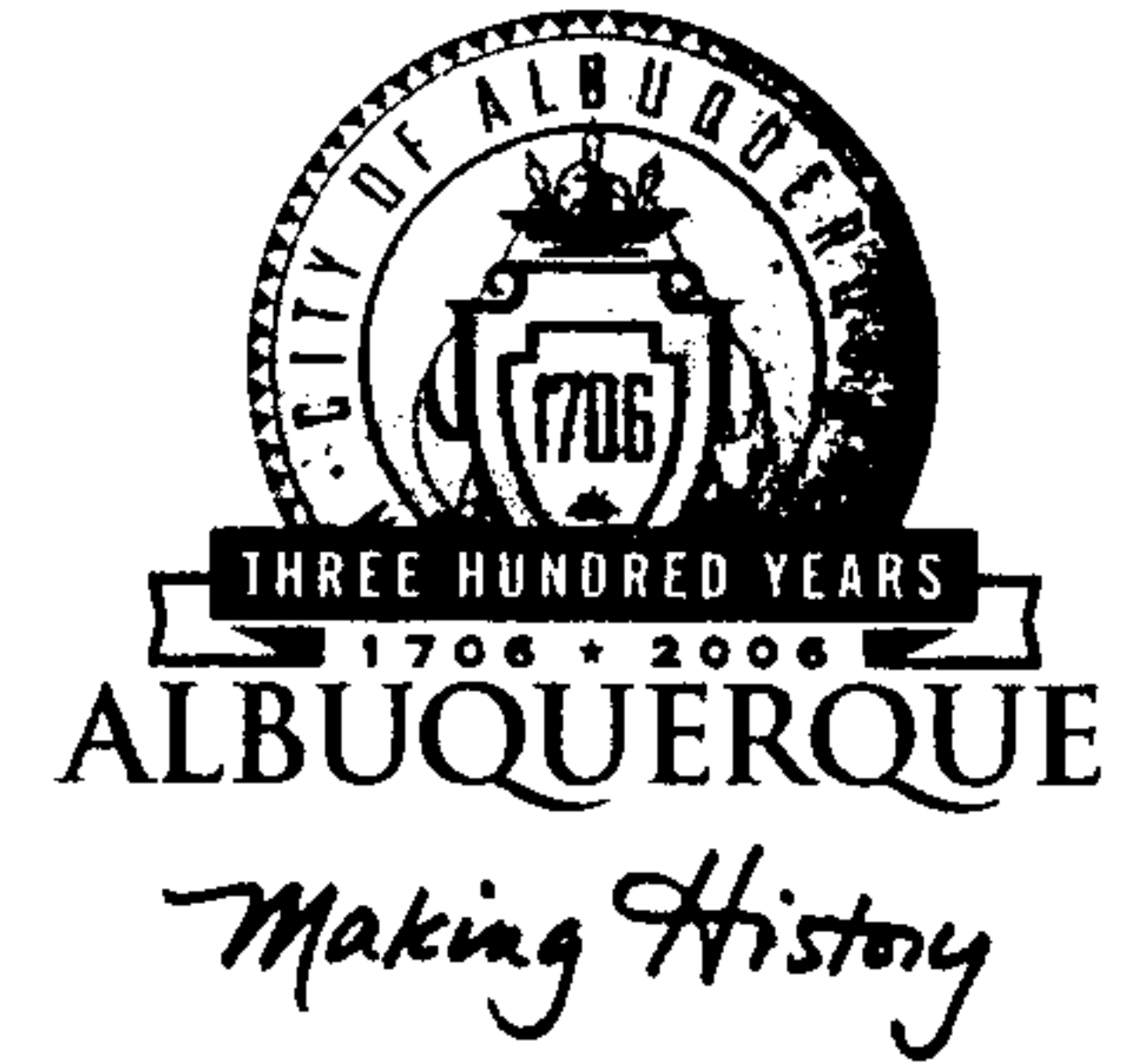

**PLANNING DEPARTMENT
DEVELOPMENT AND BUILDING SERVICES
HYDROLOGY DEVELOPMENT SECTION**

DEVELOPMENT REVIEW BOARD--SPEED MEMO

DRB CASE NO/PROJECT NO: 1003537

AGENDA ITEM NO: 18

SUBJECT:

- | | | |
|-------------------------|--------------------------|---------------------------|
| (01) Sketch Plat/Plan | (05) Site Plan for Subd | (10) Sector Dev Plan |
| (02) Bulk Land Variance | (06) Site Plan for BP | (11) Grading Plan |
| (03) Sidewalk Variance | (07) Vacation | (12) SIA Extension |
| (03a) Sidewalk Deferral | (08) Final Plat | (13) Master Dev. Plan |
| (04) Preliminary Plat | (09) Infrastructure List | (14) Cost Allocation Plan |

ACTION REQUESTED:

P.O. Box 1293

REV/CMT:() APP:(x) SIGN-OFF:() EXTN:() AMEND:()

Albuquerque

ENGINEERING COMMENTS:

No adverse comments.

New Mexico 87103

RESOLUTION:

www.cabq.gov

APPROVED ____; DENIED ____; DEFERRED ____; COMMENTS PROVIDED ____; WITHDRAWN

SIGNED-OFF: (SEC-PLN) (SP-SUB) (SP-BP) **(FP)** BY: (UD) (CE) (TRANS) (PKS) (PLNG)

DELEGATED: (SEC-PLN) (SP-SUB) (SP-BP) (FP) TO: (UD) (CE) (TRANS) (PKS) (PLNG)

FOR:

SIGNED: Bradley L. Bingham
City Engineer/AMAFCA Designee

DATE: August 11, 2004

PLANNING TRACKING LOG

Date	Project Name & #	Action Request	Action Taken
9/14/04	1003537	sketch	comments

CITY OF ALBUQUERQUE
PLANNING DEPARTMENT
Development Review Board
July 14, 2004 Comments

ITEM # 33

PROJECT # ~~100~~1003537

APPLICATION #04-01067

Re: Pinon Pointe, Lots 104-106/Sketch

No objection.



Sheran Matson, AICP DRB Chair
924-3880 Fax 924-3864 smatson@cabq.gov



City of Albuquerque

P.O. BOX 1293 ALBUQUERQUE, NEW MEXICO 87103

PLANNING DEPARTMENT DEVELOPMENT AND BUILDING SERVICES HYDROLOGY DEVELOPMENT SECTION

DEVELOPMENT REVIEW BOARD--SPEED MEMO

DRB CASE NO/PROJECT NO: 1003537

AGENDA ITEM NO: 33

SUBJECT:

- | | | |
|-------------------------|--------------------------|------------------------------|
| (01) Sketch Plat/Plan | (05) Site Plan for Subd | (10) Sector Dev Plan |
| (02) Bulk Land Variance | (06) Site Plan for BP | (11) Grading Plan |
| (03) Sidewalk Variance | (07) Vacation | (12) SIA Extension |
| (03a) Sidewalk Deferral | (08) Final Plat | (13) Master Development Plan |
| (04) Preliminary Plat | (09) Infrastructure List | (14) Other |

ACTION REQUESTED:

REV/CMT:(x) APP:() SIGN-OFF:() EXTN:() AMEND:()

ENGINEERING COMMENTS:

No adverse comments.

RESOLUTION:

APPROVED ____; DENIED ____; DEFERRED ____; COMMENTS PROVIDED *discussed* X; WITHDRAWN

SIGNED-OFF: (SEC-PLN) (SP-SUB) (SP-BP) (FP) BY: (UD) (CE) (TRANS) (PKS) (PLNG)

DELEGATED: (SEC-PLN) (SP-SUB) (SP-BP) (FP) TO: (UD) (CE) (TRANS) (PKS) (PLNG)

FOR:

SIGNED: Bradley L. Bingham
City Engineer/AMAFCA Designee

DATE: July 14, 2004



SUBDIVISION

- Major Subdivision action
- Minor Subdivision action
- Vacation
- Variance (Non-Zoning)

SITE DEVELOPMENT PLAN

- ...for Subdivision Purposes
- ...for Building Permit
- IP Master Development Plan
- Cert. of Appropriateness (LUCC)

Supplemental form

S

V

P

L

Supplemental form

ZONING

- Annexation & Zone Establishment
- Sector Plan (Phase I, II, III)
- Amendment to Sector, Area, Facility or Comprehensive Plan
- Zone Change
- Text Amendment

APPEAL / PROTEST of...

- Decision by: DRB, EPC, LUCC, Planning Director or Staff, ZHE, Zoning Board of Appeal

Z

A

PRINT OR TYPE IN BLACK INK ONLY. The applicant or agent must submit the completed application in person to the Planning Department Development Services Center, 600 2nd Street NW, Albuquerque, NM 87102. Fees must be paid at the time of application. Refer to supplemental forms for submittal requirements.

APPLICANT INFORMATION:

NAME: Pulte Homes
 ADDRESS: 7445 Pan American Freeway
 CITY: Albuquerque
 Proprietary interest in site: Pulte Homes
 AGENT (if any): Community Sciences Corporation
 ADDRESS: P.O. Box 1328 / 4481 Corrales Road
 CITY: Corrales

STATE NM ZIP 87109

STATE NM ZIP 87048

PHONE: 505-341-6800
 FAX: 505-341-6888
 E-MAIL: _____

PHONE: 505/897-0000
 FAX: 505/898-5195
 E-MAIL: sciencenm@aol.com

DESCRIPTION OF REQUEST: Final Plat Approval

Is the applicant seeking incentives pursuant to the Family Housing Development Program? Yes. No.

SITE INFORMATION: ACCURACY OF THE LEGAL DESCRIPTION IS CRUCIAL! ATTACH A SEPARATE SHEET IF NECESSARY.

Lot or Tract No. Lots 104, 105, 106 Block: N/A Unit: 5
 Subdiv. / Addn. Pinon Pointe Subdivision
 Current Zoning: R-LT Proposed zoning: N/A
 Zone Atlas page(s): B-9-Z No. of existing lots: 3 No. of proposed lots: 3
 Total area of site (acres): 0.4037 Density if applicable: dwellings per gross acre: N/A dwellings per net acre: N/A
 Within city limits? Yes. No , but site is within 5 miles of the city limits (DRB jurisdiction.) Within 1000FT of a landfill? N/A
 UPC No. 100906513247320105 MRGCD Map No. N/A
 LOCATION OF PROPERTY BY STREETS: On or Near: Weymouth Street NW
 Between: Irving Blvd. NW and Las Ventanas Road NW

CASE HISTORY:

List any current or prior case number that may be relevant to your application (Proj., App., DRB-, AX, Z, V, S, etc.): Project # 1003537
04DRB-01067 Sketch Plat Project # 100141 03DRB-01160, 04DRB-00354 Final Plat

Check-off if project was previously reviewed by Sketch Plat/Plan , or Pre-application Review Team . Date of review: 07/14/04

SIGNATURE

Glen Russell

DATE 8/02/04

(Print) Glen Russell

Applicant Agent

FOR OFFICIAL USE ONLY

Form revised 9/01, 3/03

INTERNAL ROUTING

- All checklists are complete
- All fees have been collected
- All case #s are assigned
- AGIS copy has been sent
- Case history #s are listed
- Site is within 1000ft of a landfill
- F.H.D.P. density bonus
- F.H.D.P. fee rebate

Application case numbers

04DRB - -01180

Action

P&F
CMF

S.F.

SC3

Fees

\$ 355.00

\$ 20.00

\$

\$

\$

\$

Total \$ 375.00

Hearing date 8-11-04

Glen Russell 8-2-04
 Planner signature / date

Project # 1003537

FORM S(3): SUBDIVISION - D.R.B. MEETING (UNADVERTISED) OR INTERNAL ROUTING

YOUR ATTENDANCE IS REQUIRED.

SKETCH PLAT REVIEW AND COMMENT

- Scale drawing of the proposed subdivision plat (folded to fit into an 8.5" by 14" pocket) 6 copies for unadvertised meetings. Sketches are not reviewed through internal routing.
- Site sketch with measurements showing structures, parking, Bldg. setbacks, adjacent rights-of-way and street improvements, etcetera, if there is any existing land use (folded to fit into an 8.5" by 14" pocket) 6 copies.
- Zone Atlas map with the entire property(ies) precisely and clearly outlined and crosshatched (to be photocopied)
- Letter briefly describing, explaining, and justifying the request
- Any original and/or related file numbers are listed on the cover application

MAJOR SUBDIVISION EXTENSION OF PRELIMINARY PLAT

Your attendance is required.

- Preliminary Plat reduced to 8.5" x 11"
- Zone Atlas map with the entire property(ies) precisely and clearly outlined and crosshatched (to be photocopied)
- Letter briefly describing, explaining, and justifying the request
- Copy of previous D.R.B. approved infrastructure list
- Copy of the LATEST Official D.R.B. Notice of approval for Preliminary Plat Extension request
- Any original and/or related file numbers are listed on the cover application

Extensions are not reviewed through internal routing.
 Extension of preliminary plat approval expires after one year.

MAJOR SUBDIVISION FINAL PLAT APPROVAL

Your attendance is required.

- Proposed Final Plat (folded to fit into an 8.5" by 14" pocket) 6 copies for unadvertised meetings, 4 copies for internal routing.
- Design elevations & cross sections of perimeter walls
- Zone Atlas map with the entire property(ies) precisely and clearly outlined and crosshatched (to be photocopied)
- Original Mylar drawing of the proposed plat for internal routing only. Otherwise, bring Mylar to meeting.
- Property owner's and City Surveyor's signatures on the Mylar drawing
- SIA financial guaranty verification
- Landfill disclosure and EHD signature line on the Mylar drawing if property is within a landfill buffer
- Any original and/or related file numbers are listed on the cover application

DXF FILE AND HARD COPY OF FINAL PLAT DATA FOR AGIS IS REQUIRED.

MINOR SUBDIVISION PRELIMINARY / FINAL PLAT APPROVAL

Your attendance is required.

- Proposed Preliminary / Final Plat (folded to fit into an 8.5" by 14" pocket) 6 copies for unadvertised meetings, 4 copies for internal routing.
- Site sketch with measurements showing structures, parking, Bldg. setbacks, adjacent rights-of-way and street improvements, etcetera, if there is any existing land use (folded to fit into an 8.5" by 14" pocket) 6 copies.
- Zone Atlas map with the entire property(ies) precisely and clearly outlined and crosshatched (to be photocopied)
- Letter briefly describing, explaining, and justifying the request
- Original Mylar drawing of the proposed plat for internal routing only. Otherwise, bring Mylar to meeting.
- Property owner's and City Surveyor's signatures on the Mylar drawing
- Landfill disclosure and EHD signature line on the Mylar drawing if property is within a landfill buffer
- Fee (see schedule)
- Any original and/or related file numbers are listed on the cover application
- Infrastructure list if required (verify with DRB Engineer)

NO INTERNAL ROUTING

DXF FILE AND HARD COPY OF FINAL PLAT DATA FOR AGIS IS REQUIRED.

AMENDMENT TO PRELIMINARY PLAT (with minor changes)

Your attendance is required.

AMENDMENT TO INFRASTRUCTURE LIST (with minor changes)

AMENDMENT TO GRADING PLAN (with minor changes)

PLEASE NOTE: There are no clear distinctions between significant and minor changes with regard to subdivision amendments. Significant changes are those deemed by the DRB to require public notice and public hearing.

- Proposed Amended Preliminary Plat, Infrastructure List, and/or Grading Plan (folded to fit into an 8.5" by 14" pocket) 6 copies for unadvertised meetings.
 - Original Preliminary Plat, Infrastructure List, and/or Grading Plan (folded to fit into an 8.5" by 14" pocket) 6 copies for unadvertised meetings
 - Zone Atlas map with the entire property(ies) precisely and clearly outlined and crosshatched (to be photocopied)
 - Letter briefly describing, explaining, and justifying the request
 - Original Mylar drawing of the proposed amended plat for internal routing only. Otherwise, bring Mylar to meeting.
 - Property owner's and City Surveyor's signatures on the Mylar drawing, if the plat is being amended
 - Any original and/or related file numbers are listed on the cover application
- Amended preliminary plat approval expires after one year.

I, the applicant, acknowledge that any information required but not submitted with this application will likely result in deferral of actions.

GLEN RUSSELL
Glen Russell

Applicant name (print)

8-02-04

Applicant signature / date



Form revised 3/03, 8/03 and 11/03

- Checklists complete
- Fees collected
- Case #s assigned
- Related #s listed

Application case numbers
 04DRB - - 01180
 - - - - -
 - - - - -

[Signature] 8-2-04
 Planner signature / date

Project # 1003537

P. O. Box 1328
Corrales, NM 87048

August 2, 2004

City of Albuquerque
Development Review Board
Attn: Sheran Matson
PO Box 1293
Albuquerque, New Mexico 87103

RE: Minor Preliminary/Final Plat Submittal for Lots 104, 105 and 105, Pinion Pointe, Unit 5

Dear Ms. Matson:

Please find attached CSC application and submittal for a minor subdivision preliminary/final plat. At sketch plat review (7-14-04), Board Members issued no concerns for the acceptance of this Plat.

Thank you for your consideration,

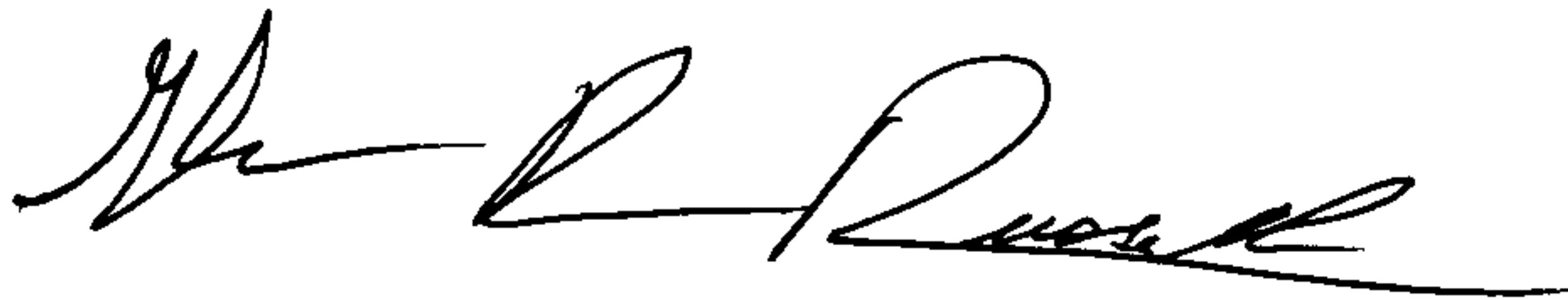

Glen R. Russell

GRR/eam

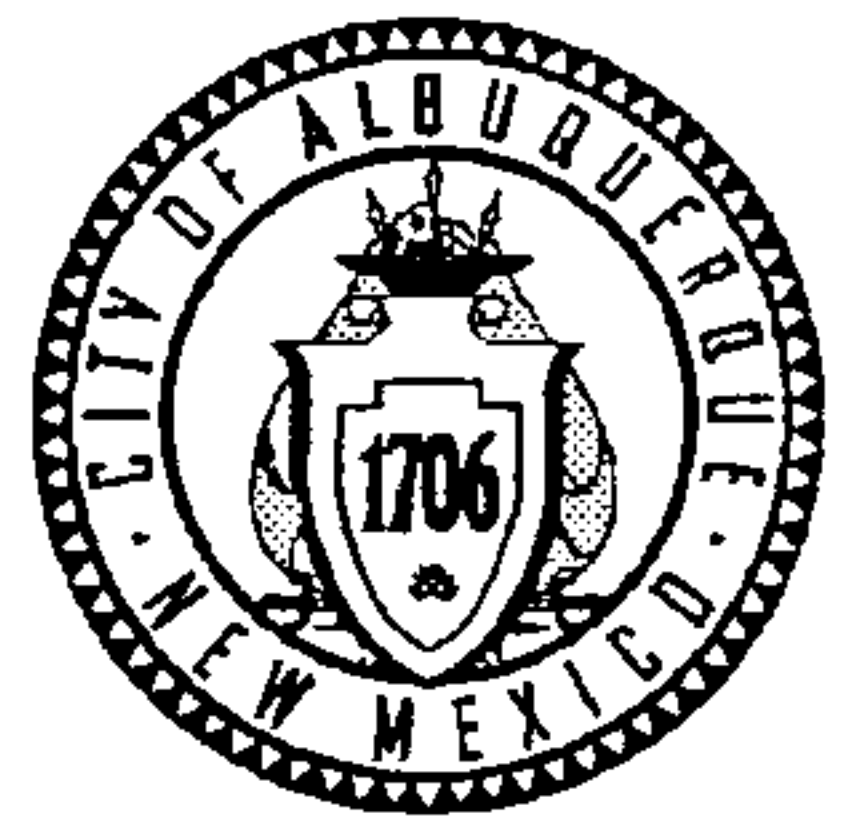
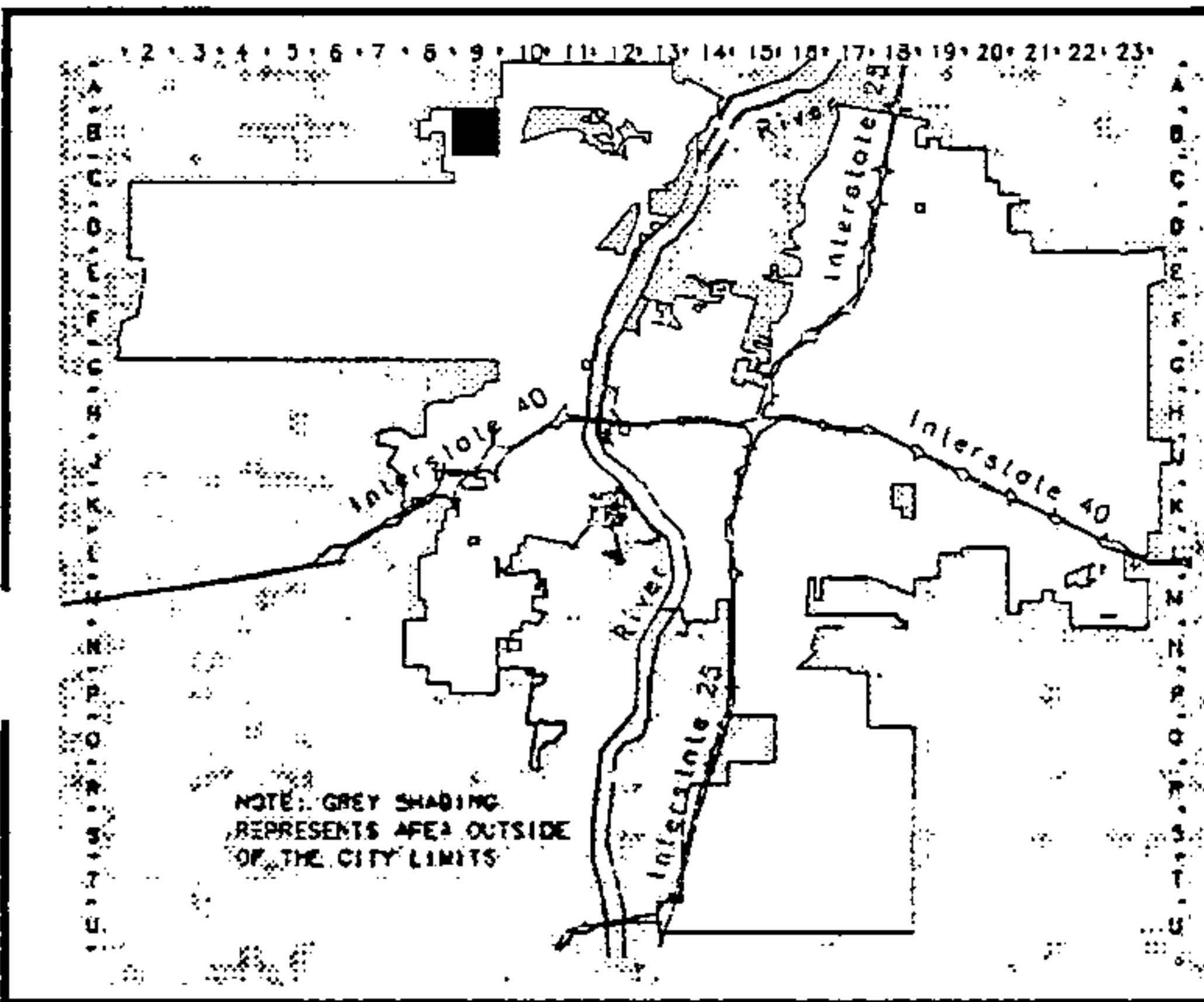
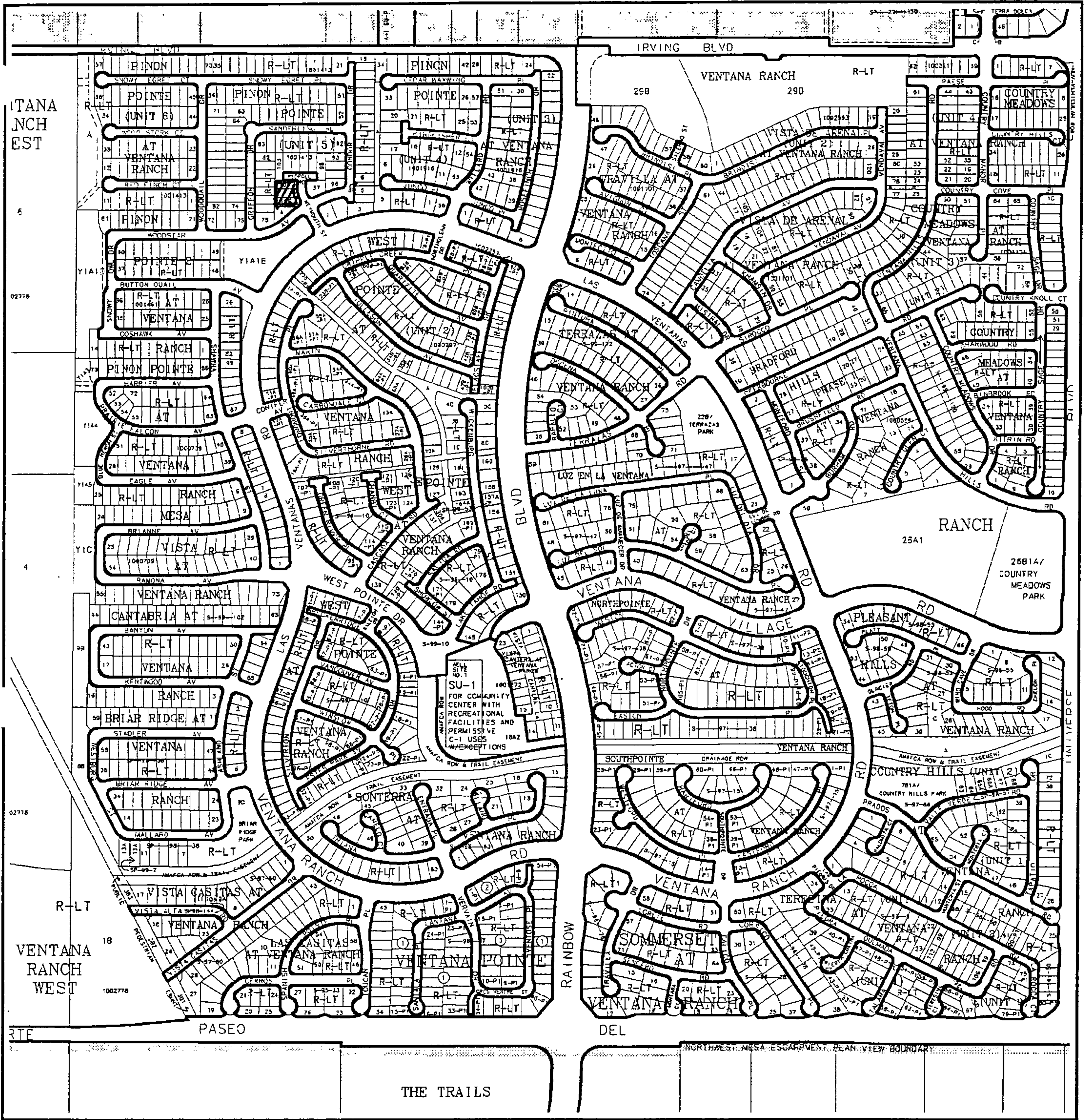

Abuquerque **G**eographic **I**nformation **S**ystem
PLANNING DEPARTMENT

© Copyright 2004

Zone Atlas Page

B-9-Z

Map Amended through July 06, 2004

**ONE STOP SHOP
CITY OF ALBUQUERQUE PLANNING DEPARTMENT
Development & Building Services**

PAID RECEIPT

APPLICANT NAME Pulte Homes
 AGENT Community Sciences
 ADDRESS PO Box 1328, Corrales
 PROJECT & APP # 1003537/04DRB01180
 PROJECT NAME Pinon Pointe Subd.

\$ 20.00 441032/3424000 Conflict Management Fee
 \$ 355.00 441006/4983000 DRB Actions
 \$ _____ 441006/4971000 EPC/AA/LUCC Actions & All Appeals
 \$ _____ 441018/4971000 Public Notification
 \$ _____ 441006/4983000 DRAINAGE PLAN REVIEW OR TRAFFIC IMPACT STUDY***
 () Major/Minor Subdivision () Site Development Plan () Bldg Permit
 () Letter of Map Revision () Conditional Letter of Map Revision
 () Traffic Impact Study
 \$ 375.00 TOTAL AMOUNT DUE

*****NOTE: If a subsequent submittal is required, bring a copy of this paid receipt with you to avoid an additional charge.**

VERIFY THE AUTHENTICITY OF THIS MULTI-TONE SECURITY DOCUMENT. CHECK BACKGROUND AREA CHANGES COLOR GRADUALLY FROM TOP TO BOTTOM.

Pulte Homes
 Pulte Homes of New Mexico, Inc.
 7445 Pan American Fwy NE
 Albuquerque, NM 87109

Check Number 0000002184
 Check Date 07/30/04

*****375.00

Pay exactly
 THREE HUNDRED SEVENTY-FIVE AND 00/100 DOLLARS

Pay to the order of
 City of Albuquerque
 PO Box 1313
 Albuquerque, NM 87103

Bank of America
 Customer Connection
 Atlanta, Dekalb County, GA

City of Albuquerque
 Treat Void After 180 Days

8/2/2004
 RECEIPT# 000270
 Account 441032
 Activity 4983000
 Trans Amt J24 Misc \$355.00
 CK \$375.00
 CHARGE \$0.00

000000 2184 06 111 2788 3 299 294 570

THE ORIGINAL DOCUMENT HAS A WHITE REFLECTIVE WATERMARK ON THE BACK. HOLD AT AN ANGLE TO SEE THE MARK WHEN CHECKING THE ENDORSEMENTS.



SUBDIVISION	Supplemental form S	ZONING	Supplemental form Z
<input type="checkbox"/> Major Subdivision action		<input type="checkbox"/> Annexation & Zone Establishment	
<input checked="" type="checkbox"/> Minor Subdivision action		<input type="checkbox"/> Sector Plan (Phase I, II, III)	
<input type="checkbox"/> Vacation	V	<input type="checkbox"/> Amendment to Sector, Area, Facility or Comprehensive Plan	
<input type="checkbox"/> Variance (Non-Zoning)		<input type="checkbox"/> Zone Change	
SITE DEVELOPMENT PLAN	P	<input type="checkbox"/> Text Amendment	
<input type="checkbox"/> ...for Subdivision Purposes		APPEAL / PROTEST of...	A
<input type="checkbox"/> ...for Building Permit		<input type="checkbox"/> Decision by: DRB, EPC, LUCC, Planning Director or Staff, ZHE, Zoning Board of Appeal	
<input type="checkbox"/> IP Master Development Plan			
<input type="checkbox"/> Cert. of Appropriateness (LUCC)	L		

PRINT OR TYPE IN BLACK INK ONLY. The applicant or agent must submit the completed application in person to the Planning Department Development Services Center, 600 2nd Street NW, Albuquerque, NM 87102. Fees must be paid at the time of application. Refer to supplemental forms for submittal requirements.

APPLICANT INFORMATION:

NAME: <u>Pulte Homes</u>	PHONE: <u>505-341-6800</u>
ADDRESS: <u>7445 Pan American Freeway</u>	FAX: <u>505-341-6888</u>
CITY: <u>Albuquerque</u> STATE <u>NM</u> ZIP <u>87109</u>	E-MAIL: _____
Proprietary interest in site: <u>Pulte Homes</u>	
AGENT (if any): <u>Community Sciences Corporation</u>	PHONE: <u>505/897-0000</u>
ADDRESS: <u>P.O. Box 1328 / 4481 Corrales Road</u>	FAX: <u>505/898-5195</u>
CITY: <u>Corrales</u> STATE <u>NM</u> ZIP <u>87048</u>	E-MAIL: <u>sciencenm@aol.com</u>

DESCRIPTION OF REQUEST: Sketch Plat

Is the applicant seeking incentives pursuant to the Family Housing Development Program? Yes. No.

SITE INFORMATION: ACCURACY OF THE LEGAL DESCRIPTION IS CRUCIAL! ATTACH A SEPARATE SHEET IF NECESSARY.

Lot or Tract No. Lots 104, 105, 106 Block: N/A Unit: 5

Subdiv. / Addn. Pinon Pointe Subdivision

Current Zoning: R-LT Proposed zoning: N/A

Zone Atlas page(s): B-9-Z No. of existing lots: 3 No. of proposed lots: 3

Total area of site (acres): 0.4037 Density if applicable: dwellings per gross acre: N/A dwellings per net acre: N/A

Within city limits? Yes. No , but site is within 5 miles of the city limits (DRB jurisdiction.) Within 1000FT of a landfill? N/A

UPC No. 100906513247320105 MRGCD Map No. N/A

LOCATION OF PROPERTY BY STREETS: On or Near: Weymouth Street
Between: Irving Blvd. and Las Ventanas Road

CASE HISTORY:

List any current or prior case number that may be relevant to your application (Proj., App., DRB-, AX_Z_, V_, S_, etc.): Project # 1001413 -----
03DRB-01160, 04ORB-00354 Final Plat

Check-off if project was previously reviewed by Sketch Plat/Plan , or Pre-application Review Team . Date of review: _____

SIGNATURE Glen Russell DATE 7/05/04
(Print) Glen Russell Applicant Agent

FOR OFFICIAL USE ONLY

Form revised 9/01, 3/03

<input checked="" type="checkbox"/> INTERNAL ROUTING	Application case numbers	Action	S.F.	Fees
<input checked="" type="checkbox"/> All checklists are complete	<u>04DRB - 01067</u>	<u>SKETCH</u>	<u>9(3)</u>	<u>\$ 0</u>
<input checked="" type="checkbox"/> All fees have been collected	_____	_____	_____	\$ _____
<input checked="" type="checkbox"/> All case #s are assigned	_____	_____	_____	\$ _____
<input checked="" type="checkbox"/> AGIS copy has been sent	_____	_____	_____	\$ _____
<input checked="" type="checkbox"/> Case history #s are listed	_____	_____	_____	\$ _____
<input checked="" type="checkbox"/> Site is within 1000ft of a landfill	_____	_____	_____	\$ _____
<input type="checkbox"/> F.H.D.P. density bonus				Total
<input type="checkbox"/> F.H.D.P. fee rebate				\$ <u>0</u>
Hearing date <u>7/14/04</u>		Project # <u>1003537</u>		
Planner signature / date <u>Glen Russell 07-6-04</u>				

FORM S(3): SUBDIVISION - D.R.B. MEETING (UNADVERTISED) OR INTERNAL ROUTING

SKETCH PLAT REVIEW AND COMMENT

YOUR ATTENDANCE IS REQUIRED.

- Scale drawing of the proposed subdivision plat (folded to fit into an 8.5" by 14" pocket) 6 copies for unadvertised meetings. Sketches are not reviewed through internal routing.
- Site sketch with measurements showing structures, parking, Bldg. setbacks, adjacent rights-of-way and street improvements, etcetera, if there is any existing land use (folded to fit into an 8.5" by 14" pocket) 6 copies.
- Zone Atlas map with the entire property(ies) precisely and clearly outlined and crosshatched (to be photocopied)
- Letter briefly describing, explaining, and justifying the request
- Any original and/or related file numbers are listed on the cover application

MAJOR SUBDIVISION EXTENSION OF PRELIMINARY PLAT

Your attendance is required.

- Preliminary Plat reduced to 8.5" x 11"
- Zone Atlas map with the entire property(ies) precisely and clearly outlined and crosshatched (to be photocopied)
- Letter briefly describing, explaining, and justifying the request
- Copy of previous D.R.B. approved infrastructure list
- Copy of the LATEST Official D.R.B. Notice of approval for Preliminary Plat Extension request
- Any original and/or related file numbers are listed on the cover application

Extensions are not reviewed through internal routing.
Extension of preliminary plat approval expires after one year.

MAJOR SUBDIVISION FINAL PLAT APPROVAL

Your attendance is required.

- Proposed Final Plat (folded to fit into an 8.5" by 14" pocket) 6 copies for unadvertised meetings, 4 copies for internal routing.
- Design elevations & cross sections of perimeter walls
- Zone Atlas map with the entire property(ies) precisely and clearly outlined and crosshatched (to be photocopied)
- Original Mylar drawing of the proposed plat for internal routing only. Otherwise, bring Mylar to meeting.
- Property owner's and City Surveyor's signatures on the Mylar drawing
- SIA financial guaranty verification
- Landfill disclosure and EHD signature line on the Mylar drawing if property is within a landfill buffer
- Any original and/or related file numbers are listed on the cover application

DXF FILE AND HARD COPY OF FINAL PLAT DATA FOR AGIS IS REQUIRED.

MINOR SUBDIVISION PRELIMINARY / FINAL PLAT APPROVAL

Your attendance is required.

- Proposed Preliminary / Final Plat (folded to fit into an 8.5" by 14" pocket) 6 copies for unadvertised meetings, 4 copies for internal routing.
- Site sketch with measurements showing structures, parking, Bldg. setbacks, adjacent rights-of-way and street improvements, etcetera, if there is any existing land use (folded to fit into an 8.5" by 14" pocket) 6 copies.
- Zone Atlas map with the entire property(ies) precisely and clearly outlined and crosshatched (to be photocopied)
- Letter briefly describing, explaining, and justifying the request
- Original Mylar drawing of the proposed plat for internal routing only. Otherwise, bring Mylar to meeting.
- Property owner's and City Surveyor's signatures on the Mylar drawing
- Landfill disclosure and EHD signature line on the Mylar drawing if property is within a landfill buffer
- Fee (see schedule)
- Any original and/or related file numbers are listed on the cover application
- Infrastructure list if required (verify with DRB Engineer) **NO INTERNAL ROUTING**

DXF FILE AND HARD COPY OF FINAL PLAT DATA FOR AGIS IS REQUIRED.

AMENDMENT TO PRELIMINARY PLAT (with minor changes)

Your attendance is required.

AMENDMENT TO INFRASTRUCTURE LIST (with minor changes)

AMENDMENT TO GRADING PLAN (with minor changes)

PLEASE NOTE: There are no clear distinctions between significant and minor changes with regard to subdivision amendments. Significant changes are those deemed by the DRB to require public notice and public hearing.

- Proposed Amended Preliminary Plat, Infrastructure List, and/or Grading Plan (folded to fit into an 8.5" by 14" pocket) 6 copies for unadvertised meetings.
- Original Preliminary Plat, Infrastructure List, and/or Grading Plan (folded to fit into an 8.5" by 14" pocket) 6 copies for unadvertised meetings
- Zone Atlas map with the entire property(ies) precisely and clearly outlined and crosshatched (to be photocopied)
- Letter briefly describing, explaining, and justifying the request
- Original Mylar drawing of the proposed amended plat for internal routing only. Otherwise, bring Mylar to meeting.
- Property owner's and City Surveyor's signatures on the Mylar drawing, if the plat is being amended
- Any original and/or related file numbers are listed on the cover application

Amended preliminary plat approval expires after one year.

I, the applicant, acknowledge that any information required but not submitted with this application will likely result in deferral of actions.

GLEN RUSSEYS
Applicant name (print)

[Signature]
Applicant signature / date



Form revised 3/02, 8/03 and 11/03

- Checklists complete
- Fees collected
- Case #s assigned
- Related #s listed

Application case numbers
04 DRB - 01067

[Signature] 07-6-04
Planner signature / date

Project # 1003537



P. O. Box 1328
Corrales, NM 87048

July 5, 2004

City of Albuquerque
Development Review Board
PO Box 1293
Albuquerque, New Mexico 87103

Attn: Sheran Matson

RE: Sketch Plat of Lots 104, 105, and 106, Pinon Pointe Subdivision, Unit 5, at Ventana Ranch

Dear Ms. Matson:

Please find attached CSC's application and submittal for Sketch Plat review for Lots 104, 105, and 106, Pinon Pointe Subdivision, Unit 5 at Ventana Ranch.

An oversight was made during the original platting of Pinon Pointe, Unit 5. The 10' P.U.E. was not taken into consideration for determining the lot width and development of Lot 104. We are proposing to shift the southerly lot line of Lot 104 to the south to create a width that will ensure developability. We are also proposing to shift the southerly lot line of Lot 105 to the south to maintain it's developability. Lot 106's developability will not be consequenced by this replat.

Respectfully Submitted,

A handwritten signature in black ink, appearing to read 'Glen R. Russell', written over a horizontal line.

Glen R. Russell

GRR/gmm

SITE

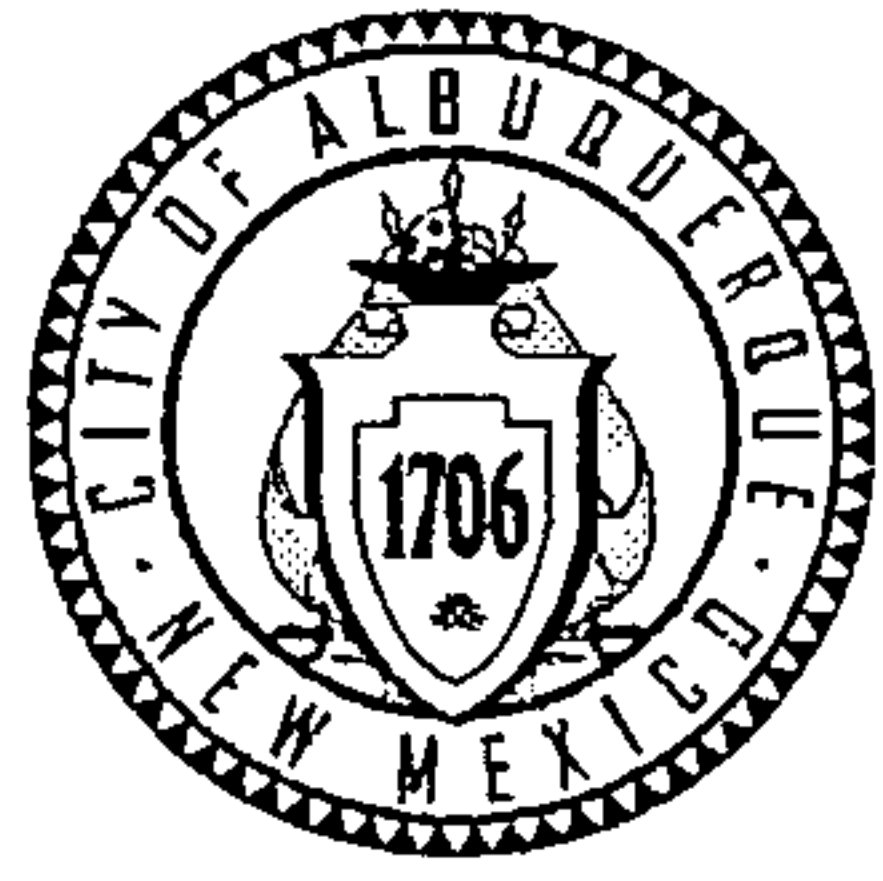
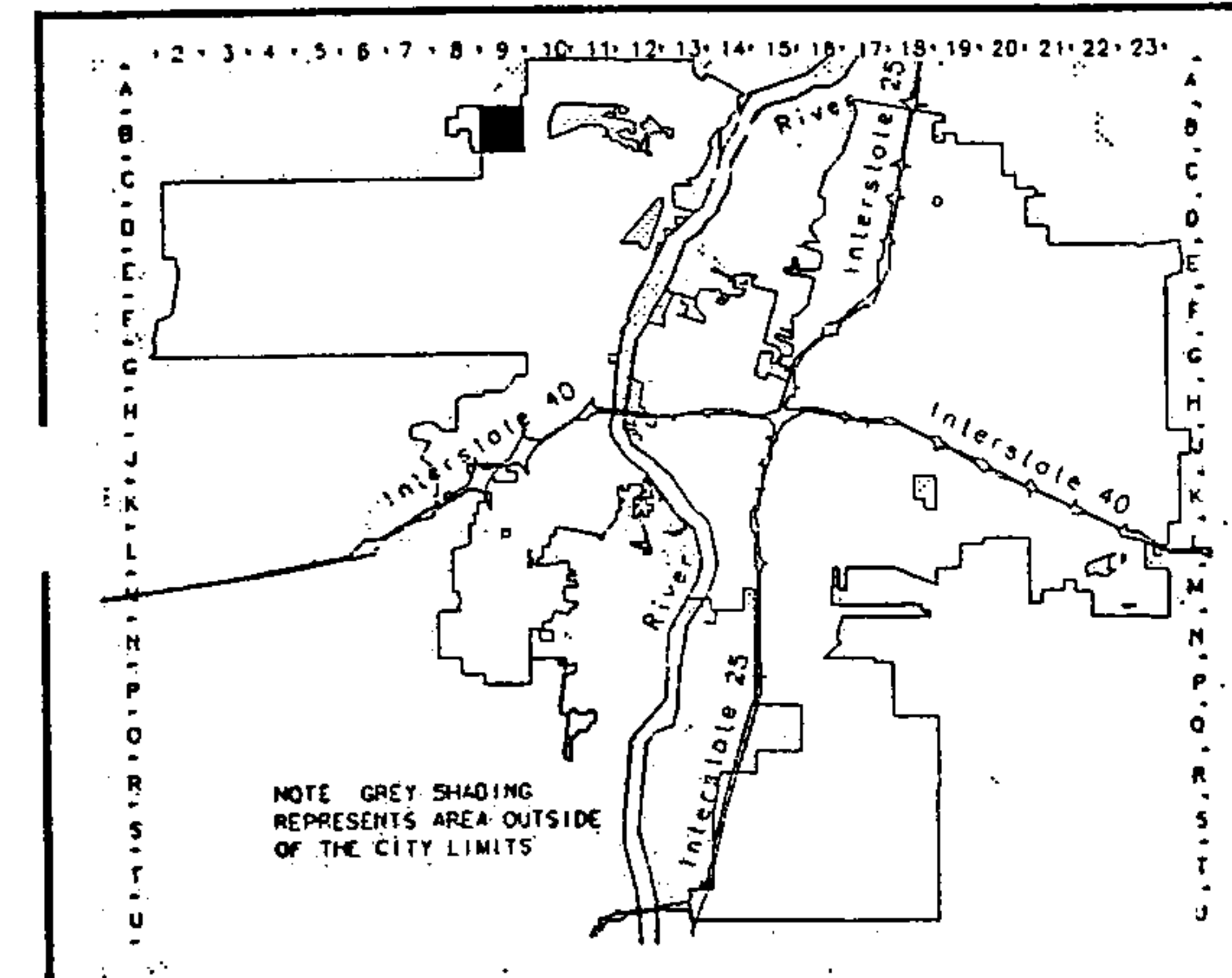
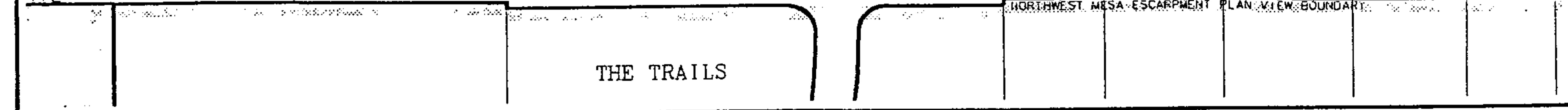
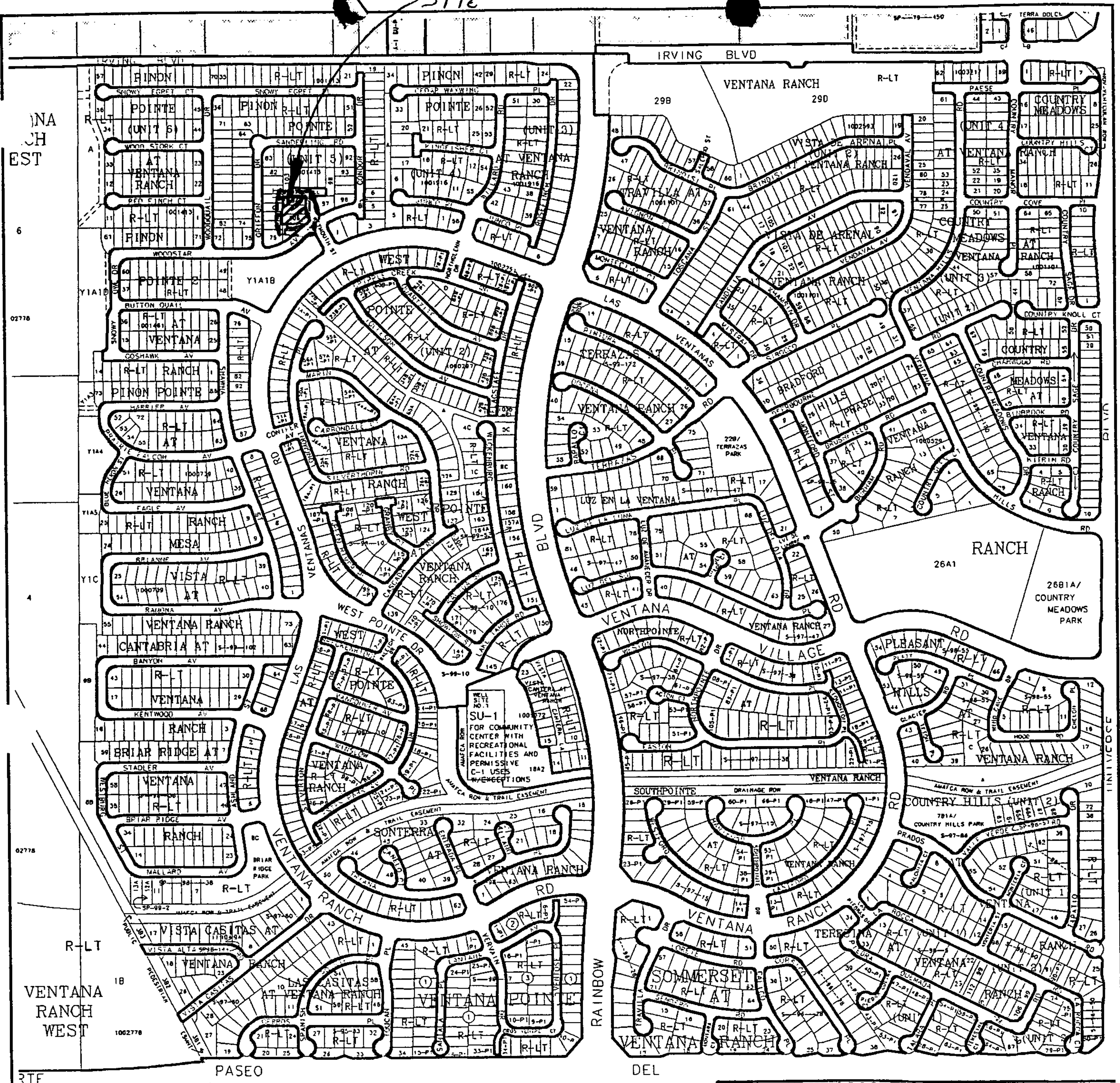

Albuquerque Geographic Information System
PLANNING DEPARTMENT

© Copyright 2004

Zone Atlas Page

B-9-Z

Map Amended through May 04, 2004