

#19



Completed 8/26/05  
OS

# DRB CASE ACTION LOG (PREL & FINAL PLAT)

REVISED 2/5/04

This sheet must accompany your plat or site plan to obtain delegated signatures. Return sheet with site plan/plat once comments are addressed.

DRB Application No.: **05DRB-01268 (P&F)**

Project # **1004058**

Project Name: **LANDS OF SANDIA FOUNDATION**

Agent: **Surveys Southwest**

Phone No.: **998-0303**

Your request for (SDP for SUB), (SDP for BP), **(FINAL PLATS)** (MASTER DEVELOP. PLAN), was approved on 8/17/05 by the DRB with delegation of signature(s) to the following departments.

### OUTSTANDING SIGNATURES COMMENTS TO BE ADDRESSED

- TRANSPORTATION: \_\_\_\_\_
- \_\_\_\_\_
- \_\_\_\_\_
- \_\_\_\_\_
- \_\_\_\_\_
- UTILITIES: \_\_\_\_\_
- \_\_\_\_\_
- \_\_\_\_\_
- \_\_\_\_\_
- CITY ENGINEER / AMAFCA: \_\_\_\_\_
- \_\_\_\_\_
- \_\_\_\_\_
- \_\_\_\_\_
- PARKS / CIP: \_\_\_\_\_
- \_\_\_\_\_
- \_\_\_\_\_
- \_\_\_\_\_
- PLANNING (Last to sign): \_\_\_\_\_
- \_\_\_\_\_
- \_\_\_\_\_
- \_\_\_\_\_

- Planning must record this plat. Please submit the following items:**
  - The original plat and a mylar copy for the County Clerk.
  - Tax certificate from the County Treasurer.
  - Recording fee (checks payable to the County Clerk). RECORDED DATE: \_\_\_\_\_
  - Tax printout from the County Assessor.
- Include 3 copies of the approved site plan along with the originals.**
- County Treasurer's signature must be obtained prior to the recording of the plat with the County Clerk.**
- Property Management's signature must be obtained prior to Planning Department's signature.**
- AGIS DXF File approval required.** —OK
- Copy of recorded plat for Planning.**

Project Number

1004058

#19



# DRB CASE ACTION LOG (PREL & FINAL PLAT)

REVISED 2/5/04

This sheet must accompany your plat or site plan to obtain delegated signatures. Return sheet with site plan/plat once comments are addressed.

DRB Application No.: 05DRB-01268 (P&F)

Project # 1004058

Project Name: LANDS OF SANDIA FOUNDATION

Agent: Surveys Southwest

Phone No.: 998-0303

Your request for (SDP for SUB), (SDP for BP), (FINAL PLATS) (MASTER DEVELOP. PLAN), was approved on 8/17/05 by the DRB with delegation of signature(s) to the following departments.

### OUTSTANDING SIGNATURES COMMENTS TO BE ADDRESSED

TRANSPORTATION: \_\_\_\_\_

- \_\_\_\_\_
- \_\_\_\_\_
- \_\_\_\_\_

UTILITIES: \_\_\_\_\_

- \_\_\_\_\_
- \_\_\_\_\_

CITY ENGINEER / AMAFCA: \_\_\_\_\_

- \_\_\_\_\_
- \_\_\_\_\_

PARKS / CIP: \_\_\_\_\_

- \_\_\_\_\_
- \_\_\_\_\_

PLANNING (Last to sign): \_\_\_\_\_

- \_\_\_\_\_
- \_\_\_\_\_

**Planning must record this plat. Please submit the following items:**

- The original plat and a mylar copy for the County Clerk.
- Tax certificate from the County Treasurer.
- Recording fee (checks payable to the County Clerk). RECORDED DATE: \_\_\_\_\_
- Tax printout from the County Assessor.

- Include 3 copies of the approved site plan along with the originals.**
- County Treasurer's signature must be obtained prior to the recording of the plat with the County Clerk.**
- Property Management's signature must be obtained prior to Planning Department's signature.**

~~AGIS DXF File approval required.~~ —OK

~~Copy of recorded plat for Planning.~~

Project Number

1004058

# CITY OF ALBUQUERQUE

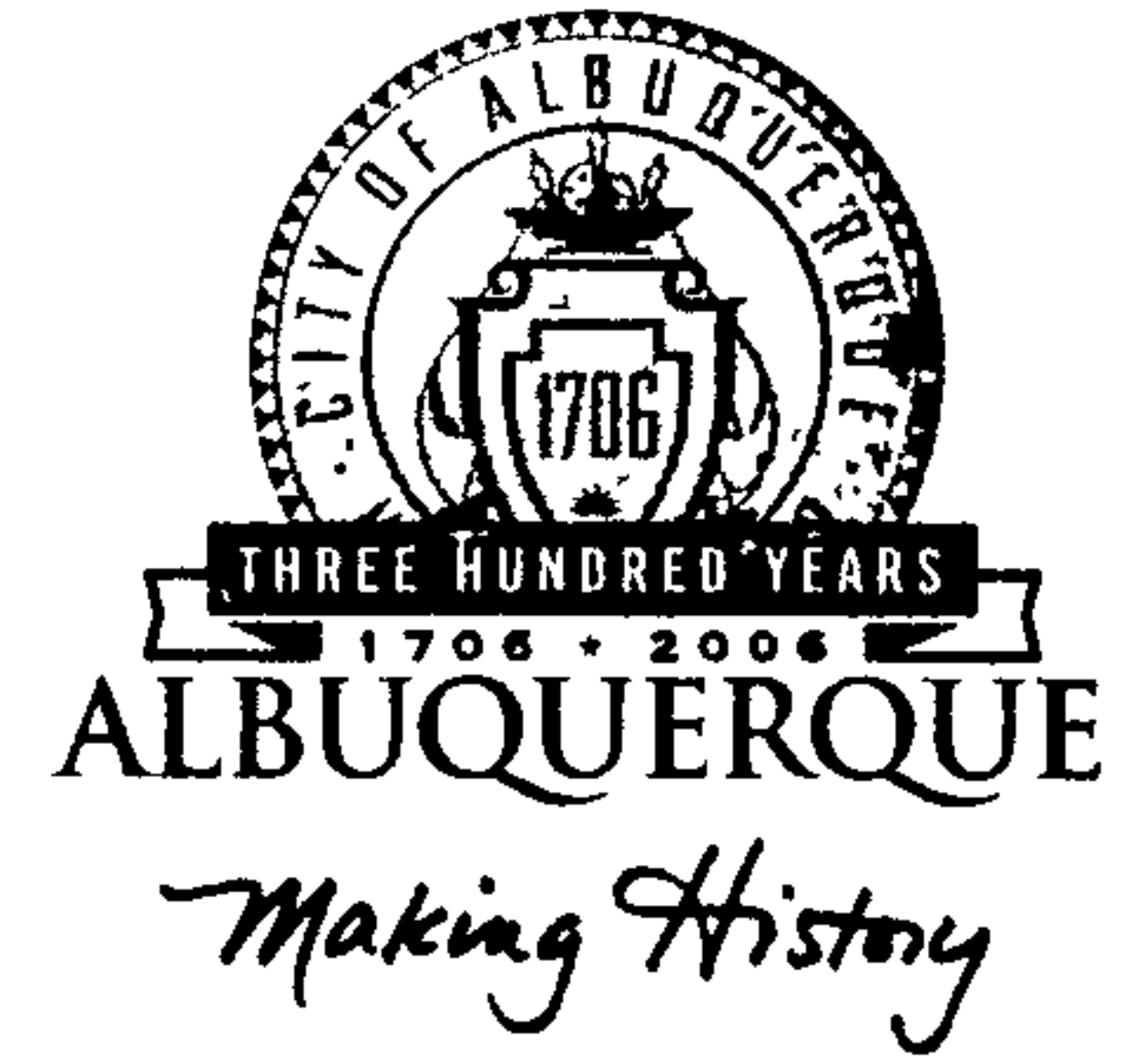

**PLANNING DEPARTMENT  
DEVELOPMENT AND BUILDING SERVICES  
HYDROLOGY DEVELOPMENT SECTION**

**DEVELOPMENT REVIEW BOARD – SPEED MEMO**

**DRB CASE NO/PROJECT NO: 1004058**

**AGENDA ITEM NO: 19**

**SUBJECT:**

**Final Plat  
Preliminary Plat**

**ACTION REQUESTED:**

**REV/CMT: ( )    APPROVAL: (X)    SIGN-OFF: ( )    EXTN: ( )    AMEND: ( )**

**ENGINEERING COMMENTS:**

No objection.

P.O. Box 1293

**RESOLUTION:**

Albuquerque

**APPROVED ; DENIED \_\_\_; DEFERRED \_\_\_; COMMENTS PROVIDED \_\_\_; WITHDRAWN \_\_\_**

New Mexico 87103

**SIGNED-OFF: (SEC-PLN) (SP-SUB) (SP-BP) (FP) BY: (UD) (CE) (TRANS) (PRKS) (PLNG)**

**DELEGATED: (SEC-PLN) (SP-SUB) (SP-BP) (FP) TO: (UD) (CE) (TRANS) (PRKS) (PLNG)**

**FOR:**

www.cabq.gov

**SIGNED: Bradley L. Bingham  
City Engineer / AMAFCA Designee**

**DATE: August 17, 2005**

**CITY OF ALBUQUERQUE  
Planning Department  
August 17, 2005  
DRB Comments**

**ITEM # 19**

**PROJECT #1004058**

**APPLICATION # 05-01268**

**Re: Lands of Sandia Foundation**

Planning has no objections to this request.

AGIS dxf is not on file. *8/12/05*

Agent may file the plat. Be sure Planning receives a recorded copy to close the file.



---

Sheran Matson, AICP DRB Chair  
924-3880 fax 924-3864 smatson@cabq.gov



**DEVELOPMENT REVIEW BOARD  
ACTION SHEET**

**Plaza del Sol Hearing Room, Basement, Plaza del Sol Building**

August 17, 2005

9:00 a.m.

**MEMBERS:**

Sheran Matson, AICP, DRB Chair  
Claire Senova, Administrative Assistant

Wilfred Gallegos, Transportation Development  
Brad Bingham, Alternate City Engineer

Roger Green, Utility Development  
Christina Sandoval, Parks & Recreation

\*\*\*\*\*

**NOTE:** UNLESS ANNOUNCED DURING THE MEETING, THE DEVELOPMENT REVIEW BOARD WILL NOT TAKE A LUNCH BREAK.

**NOTE:** INDIVIDUALS WITH DISABILITIES WHO NEED SPECIAL ASSISTANCE TO PARTICIPATE AT THIS MEETING SHOULD CONTACT CLAIRE SENOVA, PLANNING DEPARTMENT, AT 924-3946. HEARING IMPAIRED USERS MAY CONTACT HER VIA THE NEW MEXICO RELAY NETWORK BY CALLING TOLL-FREE:1-800-659-8331.

**NOTE:** REQUESTS FOR DEFERRAL OF CASES WILL BE DISCUSSED BY THE BOARD AND THE APPLICANT AND/OR AGENT AT THE BEGINNING OF THE AGENDA. BOTH PARTIES MUST AGREE UPON THE DATE OF DEFERRAL. IF THE APPLICANT/AGENT IS NOT PRESENT, THE ADMINISTRATIVE ASSISTANT MUST RECEIVE A LETTER, PRIOR TO THE HEARING DATE, REQUESTING A SPECIFIC DEFERRAL DATE. THE BOARD WILL DISCUSS AND MAKE A DECISION AT THE HEARING. THE APPLICANT/AGENT WILL THEN BE INFORMED OF THE DEFERRAL DATE AND REASON.

A. Call to Order: 9:00 A.M.

Adjourned: 12:15 P.M.

B. Changes and/or Additions to the Agenda

C. New or Old Business

**CASES WHICH REQUIRE PUBLIC NOTIFICATION**

**MAJOR SUBDIVISIONS, VACATIONS, SIA EXTENSIONS AND SITE DEVELOPMENT PLANS**

1. **Project # 1001986**  
05DRB-01194 Major-Two Year SIA

MARK GOODWIN & ASSOCIATES agent(s) for RIO OESTE DEVELOPMENT request(s) the above action(s) for all or a portion of Tract(s) D & E, **TAYLOR RANCH**, zoned R-1, located on COORS BLVD NW, between LA ORILLA NW and MONTANO PLAZA DR NW containing approximately 10 acre(s). [REF: 02DRB01927] (E-12) **A TWO-YEAR SUBDIVISION IMPROVEMENTS AGREEMENT WAS APPROVED.**

2. **Project # 1004162**  
05DRB-01193 Major-Preliminary Plat  
Approval  
05DRB-01195 Minor-Subd Design (DPM)  
Variance  
05DRB-01197 Minor-Sidewalk Waiver  
05DRB-01198 Minor-Temp Defer SDWK

JEFF MORTENSEN & ASSOCIATES agent(s) for HOECH REAL ESTATE CORPORATION request(s) the above action(s) for all or a portion of Lot(s) 1-P1 through 31-P1, Tract(s) L-2, VISTA DEL NORTE (to be known as **AGAVE SUBDIVISION**) zoned SU-1 PRD, located on VISTA DEL NORTE DR NE, between OSUNA RD NE and CALLE DEL CAMPO NE containing approximately 6 acre(s). [REF: 1000490, 05EPC00742, 05DRB01139, 05DRB01140] (E-16) **WITH THE SIGNING OF THE INFRASTRUCTURE LIST DATED 8/17/05 AND APPROVAL OF THE GRADING PLAN ENGINEER STAMP DATED 7/11/05 THE PRELIMINARY PLAT WAS APPROVED. A SUBDIVISION DESIGN VARIANCE FROM MINIMUM DESIGN STANDARDS WAS APPROVED AS SHOWN ON EXHIBIT C IN THE PLANNING FILE. A SIDEWALK VARIANCE FOR WAIVER OF SIDEWALKS WAS APPROVED AS SHOWN ON EXHIBIT C IN THE PLANNING FILE. THE TEMPORARY DEFERRAL OF CONSTRUCTION OF SIDEWALKS ON THE INTERIOR STREETS WAS APPROVED AS SHOWN ON EXHIBIT C IN THE PLANNING FILE.**

- 05DRB-01275 Minor-SiteDev Plan  
Subd/EPC

JEFF MORTENSEN & ASSOCIATES agent(s) for HOECH REAL ESTATE CORPORATION request(s) the above action(s) for all or a portion of Lot(s) 1-P1 through 31-P1, Tract(s) L-2, VISTA DEL NORTE (to be known as **AGAVE SUBDIVISION**) zoned SU-1 PRD, located on VISTA DEL NORTE DR NE, between OSUNA RD NE and CALLE DEL CAMPO NE containing approximately 6 acre(s). [REF: 1000490, 05EPC00742, 05DRB01139, 05DRB01140] **[Russell Brito for Elvira Lopez, EPC Case Planner] (E-16) THE SITE PLAN FOR SUBDIVISION WAS APPROVED WITH FINAL SIGN OFF DELEGATED TO PLANNING FOR CORRECTION OF NORTH ARROW.**

3. **Project # 1003585**  
05DRB-01191 Major-Vacation of Pub  
Right-of-Way  
05DRB-01190 Minor-Prelim&Final Plat  
Approval

SURVEYS SOUTHWEST, LTD. agent(s) for 3900 SILVER AVENUE LLC, request(s) the above action(s) for all or a portion of Lot(s) 1-20, **SILVER STREET TOWNHOMES**, zoned 0-R, located on SILVER AVE SE, between ALISO AVE SE and MORNINGSIDE AVE SE containing approximately 2 acre(s). [REF: 05DRB00737] *[Deferred from 8/17/05]* (K-17) **DEFERRED AT THE AGENT'S REQUEST TO 8/24/05.**

4. **Project # 1002861**  
05DRB-01202 Major-Preliminary Plat  
Approval

ABQ ENGINEERING INC agent(s) for INFILL SOLUTIONS DEVELOPMENT request(s) the above action(s) for all or a portion of Block(s) 46, Lots(s) 17 through 24, NEW MEXICO TOWN COMPANY TOWNSITE (to be known as **SOUTHERN UNION GAS LOFTS UNIT II**) zoned SU-3 special center zone, located on 9<sup>TH</sup> ST SW, between SILVER AVE SW and 8<sup>TH</sup> ST SW [REF: 03DRB01299, 04DRB00002, 04DRB01137, 05DRB00718] [Deferred from 8/17/05] (K-13) **DEFERRED AT THE AGENT'S REQUEST TO 8/24/05.**

5. **Project # 1004341**  
05DRB-01203 Major-Vacation of Pub  
Right-of-Way

RIO GRANDE ENGINEERING agent(s) for DAVID & JENNIFER SOULE request(s) the above action(s) for all or a portion of Tract(s) 180, AIRPORT UNIT, LANDS OF ATRISCO GRANT (to be known as **DEL RIO ESTATES**) zoned R-2 residential zone, located on 76<sup>TH</sup> STREET NW, between FORTUNA ROAD NW and GLEN RIO ROAD NW containing approximately 6 acre(s). (J-10) **WITHDRAWN AT THE AGENT'S REQUEST.**

6. **Project # 1003551**  
05DRB-01183 Major-Preliminary Plat  
Approval  
05DRB-01184 Minor-Temp Defer SDWK

BRASHER & LORENZ agent(s) for DON K. NAYLOR request(s) the above action(s) for all or a portion of Block(s) 11, Tract(s) 1, Lot(s) 12, 13, 19, 20 & 21, NORTH ALBUQUERQUE ACRES, UNIT 3, (to be known as **LA CUEVA ESTATES**) zoned R-D residential and related uses zone, developing area, located on GLENDALE AVE NE, between WYOMING BLVD NE and BARSTOW ST NE containing approximately 5 acre(s). [REF: 04DRB01095] (B-19) **WITH THE SIGNING OF THE INFRASTRUCTURE LIST DATED 8/17/05 AND APPROVAL OF THE GRADING PLAN ENGINEER STAMP DATED 7/19/05 THE PRELIMINARY PLAT WAS APPROVED WITH CONDITION: A PERIMETER WALL DESIGN SHALL BE APPROVED PRIOR TO FINAL PLAT. THE TEMPORARY DEFERRAL OF CONSTRUCTION OF SIDEWALKS ON THE INTERIOR STREETS WAS APPROVED AS SHOWN ON EXHIBIT C IN THE PLANNING FILE.**

7. **Project # 1004173**  
05DRB-01192 Major-Vacation of Public Easements  
05DRB-01196 Major-Preliminary Plat Approval  
05DRB-01199 Minor-Sidewalk Waiver  
05DRB-01200 Minor-Temp Defer SDWK

BOHANNAN HUSTON INC agent(s) for SANDIA PROPERTIES LTD., CO., request(s) the above action(s) for all or a portion of Tract(s) 4, 5 and D-2, (to be known as **VENTANA VISTA SUBDIVISION @ VENTANA RANCH WEST**) zoned R-LT residential zone, located on VENTANA PARKWAY NW, between VENTANA RIDGE RD NW and IRVING BLVD NW containing approximately 31 acre(s). (B-8) **THE VACATION WAS APPROVED AS SHOWN ON EXHIBIT B IN THE PLANNING FILE. WITH THE SIGNING OF THE INFRASTRUCTURE LIST DATED 8/17/05 AND APPROVAL OF THE GRADING PLAN ENGINEER STAMP DATED 8/10/05 THE PRELIMINARY PLAT WAS APPROVED. A SIDEWALK VARIANCE FOR WAIVER OF SIDEWALKS WAS APPROVED AS SHOWN ON EXHIBIT C IN THE PLANNING FILE. THE TEMPORARY DEFERRAL OF CONSTRUCTION OF SIDEWALKS ON THE INTERIOR STREETS WAS APPROVED AS SHOWN ON EXHIBIT C IN THE PLANNING FILE.**

- 05DRB-01281 Minor-Subd Design (DPM) Variance

BOHANNAN HUSTON INC agent(s) for SANDIA PROPERTIES LTD., CO., request(s) the above action(s) for all or a portion of Tract(s) 4, 5 and D-2, (to be known as **VENTANA VISTA SUBDIVISION @ VENTANA RANCH WEST**) zoned R-LT residential zone, located on VENTANA PARKWAY NW, between VENTANA RIDGE RD NW and IRVING BLVD NW containing approximately 31 acre(s). (B-8) **A SUBDIVISION DESIGN VARIANCE FROM MINIMUM DESIGN STANDARDS WAS APPROVED AS SHOWN ON EXHIBIT C IN THE PLANNING FILE.**

8. **Project # 1004353**  
05DRB-01119 Major-Preliminary Plat Approval  
05DRB-01120 Minor-Temp Defer SDWK

SURV-TEK, INC agent(s) for LONGFORD AT THE TRAILS, LLS request(s) the above action(s) for all or a portion of Tract(s) 6, **THE TRAILS, UNIT 2**, zoned R-LT residential zone, located on OAKRIDGE ST NW, between WOODMONT AVE NW and TREELINE AVE NW containing approximately 17 acre(s). [REF: 04DRB01322] *[Listed under Project #1002962 in error] [Deferred from 8/3/05]* (C-9) **WITH THE SIGNING OF THE INFRASTRUCTURE LIST DATED 8/17/05 AND APPROVAL OF THE GRADING PLAN ENGINEER STAMP DATED 7/7/05 THE PRELIMINARY PLAT WAS APPROVED WITH CONDITIONS: USE OF A**



**HAMMERHEAD REQUIRES FIRE AND SOLID WASTE APPROVAL. A PERIMETER WALL DESIGN SHALL BE APPROVED PRIOR TO FINAL PLAT. TEMPORARY DEFERRAL OF CONSTRUCTION OF SIDEWALKS ON THE INTERIOR STREETS WAS APPROVED AS SHOWN ON EXHIBIT C IN THE PLANNING FILE.**

9. **Project # 1003189**  
05DRB-01127 Major-Preliminary Plat  
Approval  
05DRB-01129 Minor-Temp Defer SDWK

RIO GRANDE ENGINEERING agent(s) for FULLER HOMES, INC request(s) the above action(s) for all or a portion of Tract(s) 355, 356 TRACTS A & B, LANDS OF HECTOR ROJO, TOWN OF ATRISCO GRANT (to be known as **AUTUMN VIEW SUBDIVISION**) zoned RD-R1, located on TOWER RD SW, between COORS BLVD SW and STINSON RD SW containing approximately 15 acre(s). *[Deferred from 8/3/05 & 8/17/05]* (L-10) **DEFERRED AT THE AGENT'S REQUEST TO 8/24/05.**

10. **Project # 1004300**  
05DRB-01080 Minor-SiteDev Plan  
BldPermit

JIM MEDLEY, Architect AIA agent(s) for ROBERT NAVARRETTE request(s) the above action(s) for all or a portion of Lot(s) 31, 32, Block(s) 9, Tract(s) A, **NORTH ALBUQUERQUE ACRES, UNIT B**, zoned SU-2, M-1, located on EAGLE ROCK AVE NE and SAN MATEO BLVD NE containing approximately 2 acre(s). *[Deferred from 7/27/05 and 8/10/05 & 8/17/05]* (C-18) **DEFERRED AT THE AGENT'S REQUEST TO 8/24/05.**

- 05DRB-01286 Minor-Prelim&Final Plat  
Approval

WAYJOHN SURVEYING INC agent(s) for ROBERT NAVARRETTE, ELITE DRI-WALL request(s) the above action(s) for all or a portion of Lot(s) 31, 32, Block(s) 9, Tract(s) A, **NORTH ALBUQUERQUE ACRES, UNIT B**, zoned SU-2, M-1, located on EAGLE ROCK AVE NE and SAN MATEO BLVD NE containing approximately 2 acre(s). *[REF: 05DRB01080] [Deferred from 8/17/05]* (C-18) **DEFERRED AT THE AGENT'S REQUEST TO 8/24/05.**

**SITE DEVELOPMENT PLANS (EPC FINAL SIGN-OFF) AMENDED PLANS AND MASTER DEVELOPMENT PLANS (CITY COUNCIL FINAL SIGN-OFF)**

**NOTE: IF THE APPLICANT/AGENT IS NOT PRESENT WHEN THEIR REQUEST IS CALLED, THEN THE REQUEST MAY BE INDEFINITELY DEFERRED ON A NO SHOW.**

**11. Project # 1000631**

05DRB-01287 Minor-SiteDev Plan  
Subd/EPC

05DRB-01288 Minor-SiteDev Plan  
BldPermit/EPC

GEORGE RAINHART ARCHITECT & ASSOCIATES, agent(s) for JEROME BETTMAN request(s) the above action(s) for all or a portion of Tract(s) A-2B and B-1, **JEANNEDALE, UNIT 5**, zoned SU-3 special center zone, located on UPTOWN BLVD NE, between SAN PEDRO DR NE and LOUISIANA BLVD NE containing approximately 5 acre(s). [REF: AA-96-118, Z-72-65, 03EPC02043, 03EPC02042, 1002442] [**Carmen Marrone, EPC Case Planner**] (H-18) **THE SITE PLAN FOR SUBDIVISION WAS APPROVED WITH FINAL SIGN OFF DELEGATED TO UTILITIES DEVELOPMENT TO SHOW WATERLINE EASEMENT AND TRANSPORTATION DEVELOPMENT FOR INTERNAL COMMENT SHEET MARKED UP AND ENTRANCE ON UPTOWN LOOP ROAD AND 3 COPIES OF THE SITE PLAN. THE SITE PLAN FOR BUILDING PERMIT WAS APPROVED WITH FINAL SIGN OFF DELEGATED TO UTILITIES DEVELOPMENT TO SHOW WATERLINE EASEMENT, TO SHOW NEW 2-INCH METERBOX WITHIN RIGHT-OF-WAY AND TO TRANSPORTATION DEVELOPMENT FOR INTERNAL COMMENT SHEET MARKED UP AND ENTRANCE ON UPTOWN LOOP ROAD AND 3 COPIES OF THE SITE PLAN.**

05DRB-01282 Minor-Prelim&Final Plat  
Approval

SURVEYS SOUTHWEST agent(s) for 6401 UPTOWN, LLC request(s) the above action(s) for all or a portion of Tract(s) A-2B and B-1, **DALE J BELLAMAH'S JEANNEDALE UNIT 5**, zoned SU-3 special center zone, located on AMERICAS PARKWAY NE, between UPTOWN BLVD NE and JEANNEDALE DR NE containing approximately 5 acre(s). [REF: AA-96-118 03EPC02043, 03EPC020] (H-18) **PRELIMINARY PLAT APPROVED WITH FINAL SIGN OFF DELEGATED TO UTILITIES DEVELOPMENT TO ADD 20-FOOT WATERLINE EASEMENT, CHANGE STREET NAME, MAY NEED PRIVATE WATER/SEWER SERVICE EASEMENTS FOR BUILDING TO THE WEST AND TO TRANSPORTATION DEVLEOPMNT FOR RADIUS DEDICATION @ INTERSECTIONS, ADA EASEMENTS AND CROSS-ACCESS (WEST)(NORTH).**

12. **Project # 1003991**  
05DRB-01293 Minor-SiteDev Plan  
Subd/EPC  
05DRB-01294 Minor-SiteDev Plan  
BldPermit/EPC
- TIERRA WEST LLC agent(s) for WAL MART STORES EAST LP request(s) the above action(s) for all or a portion of Tract(s) A-1, **TOWN OF ATRISCO GRANT, UNIT 7**, zoned SU-1 FOR C-1 WITH DRIVE UP PHARMACY & RLT, located on SNOW VISTA BLVD SW, between SAGE RD SW and BENAVIDES RD SW containing approximately 14 acre(s). [REF: 05EPC00365, 05EPC00366, 05EPC00367] [**Russell Brito for Elvira Lopez, EPC Case Planner**] [*Deferred from 8/17/05*] (M-9) **DEFERRED AT THE AGENT'S REQUEST TO 8/31/05.**
13. **Project # 1004353**  
05DRB-01285 Minor-SiteDev Plan  
Subd/EPC
- CONSENSUS PLANNING agent(s) for LONGFORD HOMES request(s) the above action(s) for all or a portion of Tract(s) 6, **SANTA FE @ THE TRAILS UNIT 2**, zoned R-D residential and related uses zone, developing area, located on WOODMONT NW, between RAINBOW BLVD NW and OAKRIDGE NW containing approximately 20 acre(s). [Listed under Project #1002962 in error] (C-9) **SITE PLAN FOR SUBDIVISION WS APPROVED AND SIGNED OFF BY THE BOARD.**
14. **Project # 1001946**  
05DRB-01047 Minor-SiteDev Plan  
BldPermit
- DEKKER PERICH SABATINI agent(s) for OFFICE DEPOT request(s) the above action(s) for all or a portion of Tract(s) A-1-D, **LOS ANGELES CENTER**, zoned M-1, located on PASEO DEL NORTE NE, between SAN PEDRO NE and INTERSTATE 25 containing approximately 3 acre(s). [REF: DRB-97-224, DRB-97-372; Z-1534] [*Deferred from 6/29/05 & 7/13/05 & 7/20/05 & 7/27/05 & 8/3/05 & indef deferred on a no show 8/17/05*] (D-18) **INDEFINITELY DEFERRED ON A NO SHOW.**

15. **Project # 1003358**  
04DRB-00478 Minor-SiteDev Plan  
BldPermit
- KEN HOVEY agent(s) for COMMERCIAL ENTERPRISES INC request(s) the above action(s) for all or a portion of Tract(s) 49, **CLIFFORD INDUSTRIAL PARK**, zoned SU-2 / M-1, located on WASHINGTON PL NE and ANAHEIM NE and containing approximately 3 acre(s). *[Was Indef Deferred on 4/7/04 on a no show] [Deferred from 8/10/05]* (C-17) **SITE PLAN FOR BUILDING PERMIT WAS APPROVED WITH FINAL SIGN OFF DELEGATED TO PLANNING TO DETERMINE IF ENVIRONMENTAL HEALTH HAS APPROVED THE ABATEMENT MEASURES FOR THE LANDFILL.**

**MINOR PLATS, FINAL (MAJOR) PLATS, AMENDED PLATS AND PLANS**

16. **Project # 1004177**  
05DRB-01280 Minor-Subd Design (DPM)  
Variance
- BOHANNAN HUSTON INC agent(s) for SANDIA PROPERTIES LTD CO request(s) the above action(s) for all or a portion of Tract(s) 10-13, **VENTANA RANCH WEST**, zoned R-LT residential zone, located on IRVING BLVD NW, between VENTANA RIDGE RD NW and containing approximately 74 acre(s). [REF: 05DRB01122, 01123, 01124, 00783] (B-8) **INDEFINITELY DEFERRED ON A NO SHOW.**
17. **Project # 1002960**  
05DRB-01284 Major-Final Plat Approval
- MARK GOODWIN & ASSOCIATES agent(s) for WESTLAND DEVELOPMENT CO INC request(s) the above action(s) for all or a portion of Tract(s) K, **SUNDORO SOUTH, UNIT 2**, zoned SU-2 FOR RLT, located on 98<sup>TH</sup> STREET NW, between LADERA BLVD NW and I-40 NW containing approximately 6 acre(s). [REF: 05DRB-00109] (J-8/9) **FINAL PLAT APPROVED WITH FINAL SIGN OFF DELEGATED TO TRANSPORTATION DEVELOPMENT FOR EXCHANGE WITH NMDOT AND TO RECORD PLAT AND TO PARKS FOR MAINTENANCE OF PCD EASEMENT.**

18. **Project # 1003982**  
05DRB-01283 Minor-Prelim&Final Plat  
Approval

WILKS CO. agent(s) for TAIHI & MARYANN JONES request(s) the above action(s) for Tract(s) A-15-M5-17 and A-15-M5-16, **LANDS OF TAIHI & MARYANN JONES**, zoned SU-2 NCR, located on WALTER NE, between MOUNTAIN RD NE and KINLEY AVE NE containing approximately 1 acre(s). [REF: 05DRB00338] (J-15) **PRELIMINARY AND FINAL PLAT WERE APPROVED AND SIGNED OFF BY THE BOARD.**

19. ~~**Project # 1004058**~~  
05DRB-01268 Minor-Prelim&Final Plat  
Approval

SURVEYS SOUTHWEST LTD agent(s) for SANDIA FOUNDATION, PATRICK GLENNON request(s) the above action(s) for all or a portion of Tract(s) A & B, LOMAS & BROADWAY and Tract(s) P-1, LANDS OF NEW MEXICO CREDIT CORP., UNIT 2 (to be known as **LANDS OF SANDIA FOUNDATION**) zoned SU-2 M-1, located on MARBLE AVE NE, between BROADWAY BLVD NE and LOMAS BLVD NE containing approximately 4 acre(s). [REF: ZA-87-241, DRB-93-164, DRB-90-186, 05DRB00486] (J-14) **PRELIMINARY AND FINAL PLAT WERE APPROVED AND SIGNED OFF BY THE BOARD.**

20. **Project # 1003672**  
05DRB-00704 Minor-Final Plat Approval

RIO GRANDE ENGINEERING agent(s) for ERIMY PROPERTIES LTD request(s) the above action(s) for all or a portion of Lot(s) 6 & 7, Block(s) 3, Tract(s) 3, NORTH ALBUQUERQUE ACRES, UNIT 3, (to be known as **ESTRADA COURT**) zoned R-D residential and related uses zone, developing area, located on OAKLAND AVE NE, between VENTURA BLVD NE and BARSTOW BLVD NE containing approximately 3 acre(s). [REF: 04DRB01423] (*Deferred from 5/4/05 & 5/18/05 & 5/25/05*) [*Final Plat Indef Deferred for SIA*] (C-20) **FINAL PLAT WAS APPROVED WITH FINAL SIGN OFF DELEGATED TO UTILITIES DEVELOPMENT FOR EASEMENT LANGUAGE ACROSS LOT 6-P1 AND TO PLANNING TO RECORD.**

**NO ACTION IS TAKEN ON THESE CASES:**  
**APPLICANT - AGENT IS REQUIRED TO BE AT THE MEETING**

21. **Project # 1004361**  
05DRB-01247 Minor-Sketch Plat or Plan
- G. DONALD DUDLEY ARCHITECT agent(s) for RIVER HORSE INVESTMENTS request(s) the above action(s) for all or a portion of Lot(s) 2, 3, 4 and 5, Block(s) 001, MONTGOMERY HEIGHTS (to be known as **TULANE TOWNHOUSES**) zoned R-3, located on TULANE NE, between CARLISLE NE and WELLESLY NE containing approximately 1 acre(s). (G-16) **THE ABOVE REQUEST WAS REVIEWED AND COMMENTS WERE GIVEN.**
22. **Project # 1004369**  
05DRB-01279 Minor-Sketch Plat or Plan
- RICHARD L GONZALES request(s) the above action(s) for all or a portion of Lot(s) 24-39, Block(s) 3, WEST PARK (to be known as **COUNTRY CLUB TOWNHOMES**) zoned C-2 community commercial zone, located on CENTRAL SW, between NEW YORK SW and GOLF COURSE containing approximately 2 acre(s). (J-12) **THE ABOVE REQUEST WAS REVIEWED AND COMMENTS WERE GIVEN.**
23. Approval of the Development Review Board Minutes for August 3, 2005. **THE DEVELOPMENT REVIEW BOARD MINUTES FOR AUGUST 3, 2005 WERE APPROVED BY THE BOARD.**

ADJOURNED: 12:15 P.M.

#19

**4058**

### DXF Electronic Approval Form

DRB Project Case #: 1004058

Subdivision Name: SANDIA FOUNDATION TRACTS 1 & 2

Surveyor: GARY E GRITSKO

Contact Person: SARAH AMATO

Contact Information:

DXF Received: 8/12/2005

Hard Copy Received: 8/12/2005

Coordinate System: NMSP Grid (NAD 27)

  
Approved

8-12-05  
Date

\* The DXF file cannot be accepted (at this time) for the following reason(s):

\_\_\_\_\_  
\_\_\_\_\_  
\_\_\_\_\_  
\_\_\_\_\_  
\_\_\_\_\_

**AGIS Use Only**

Copied fc **4058** to agiscov on **8/12/2005** Contact person notified on **8/12/2005**

PLANNING TRACKING LOG

Date	Project Name & #	Action Request	Action Taken
3/30/05	Lands of NM Credit Union Proj 1004058	Sketch	Comments Given
8/17/05	Lands of Sandia Foundation Proj 1004058	Pre & Final	Approved





# CITY OF ALBUQUERQUE

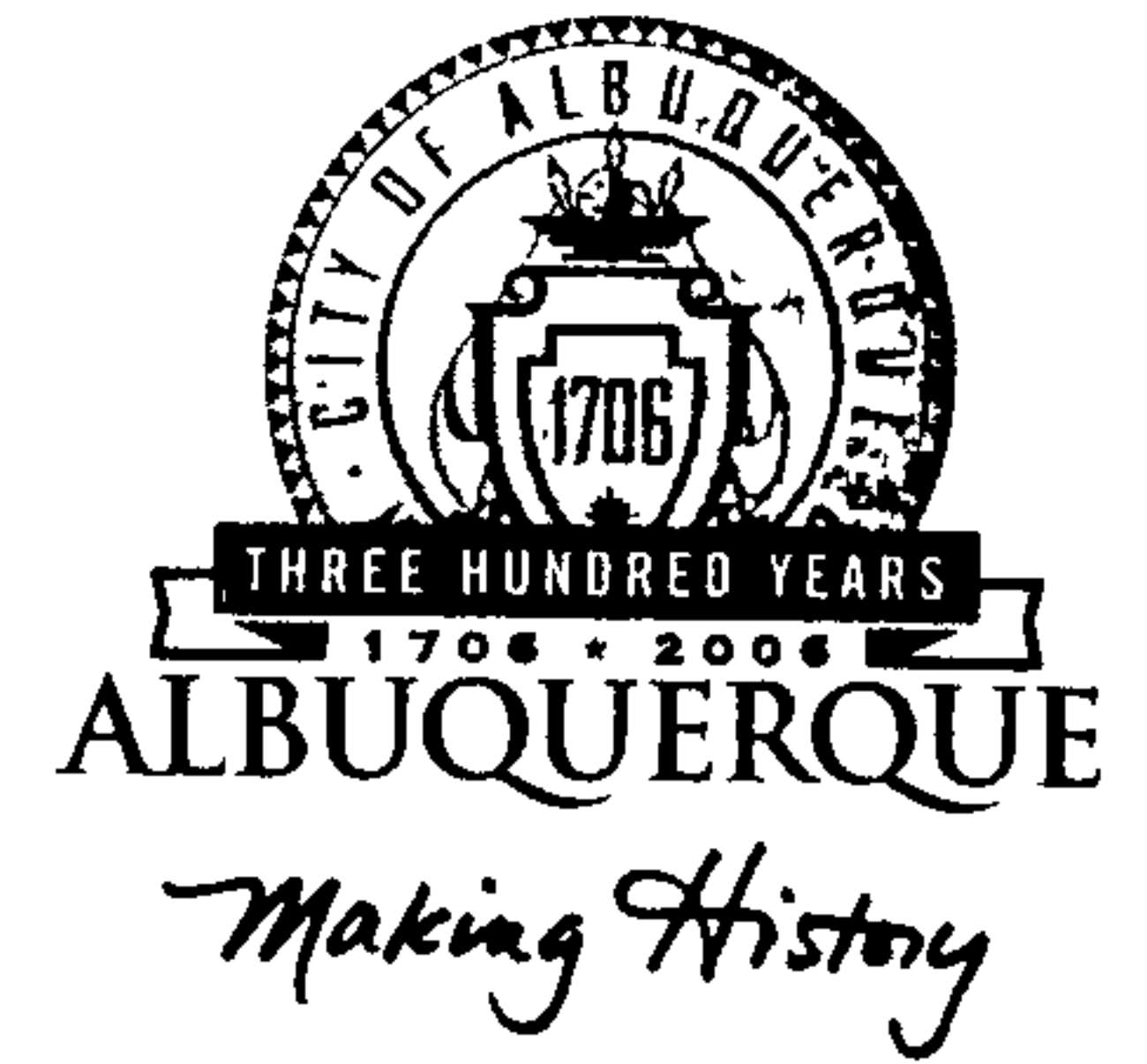

PLANNING DEPARTMENT  
DEVELOPMENT AND BUILDING SERVICES  
HYDROLOGY DEVELOPMENT SECTION

DEVELOPMENT REVIEW BOARD--SPEED MEMO

**DRB CASE NO/PROJECT NO: 1004058**

**AGENDA ITEM NO: 20**

**SUBJECT:**

Sketch Plat/Plan

**ACTION REQUESTED:**

REV/CMT:(x) APP:() SIGN-OFF:() EXTN:() AMEND:()

P.O. Box 1293

**ENGINEERING COMMENTS:**

No adverse comments.

Albuquerque

New Mexico 87103

**RESOLUTION:**

APPROVED \_\_\_\_; DENIED \_\_\_\_; DEFERRED \_\_\_\_; COMMENTS PROVIDED discuss x; WITHDRAWN

www.cabq.gov

SIGNED-OFF: (SEC-PLN) (SP-SUB) (SP-BP) (FP) BY: (UD) (CE) (TRANS) (PKS) (PLNG)

DELEGATED: (SEC-PLN) (SP-SUB) (SP-BP) (FP) TO: (UD) (CE) (TRANS) (PKS) (PLNG)

FOR:

**SIGNED:** Bradley L. Bingham  
City Engineer/AMAFCA Designee

**DATE:** March 30, 2005

**CITY OF ALBUQUERQUE  
PLANNING DEPARTMENT  
March 30, 2005  
DRB Comments**

**ITEM # 20**

**PROJECT # 1004058**

**APPLICATION # 05-00486**

**RE: Tracts A & B, Lomas & Broadway, Unit2 and Tract P-1,  
Lands of NM Credit Corporation/sketch**

The property lies within the Martineztown/Santa Barbara Sector Plan Boundaries. The plan states that SU2-M1 property must follow standard M1 zoning requirements for development.

Restaurant use is permitted in the M-1 zone because C2 permissive uses are allowed. Lot size is allowed in C2.

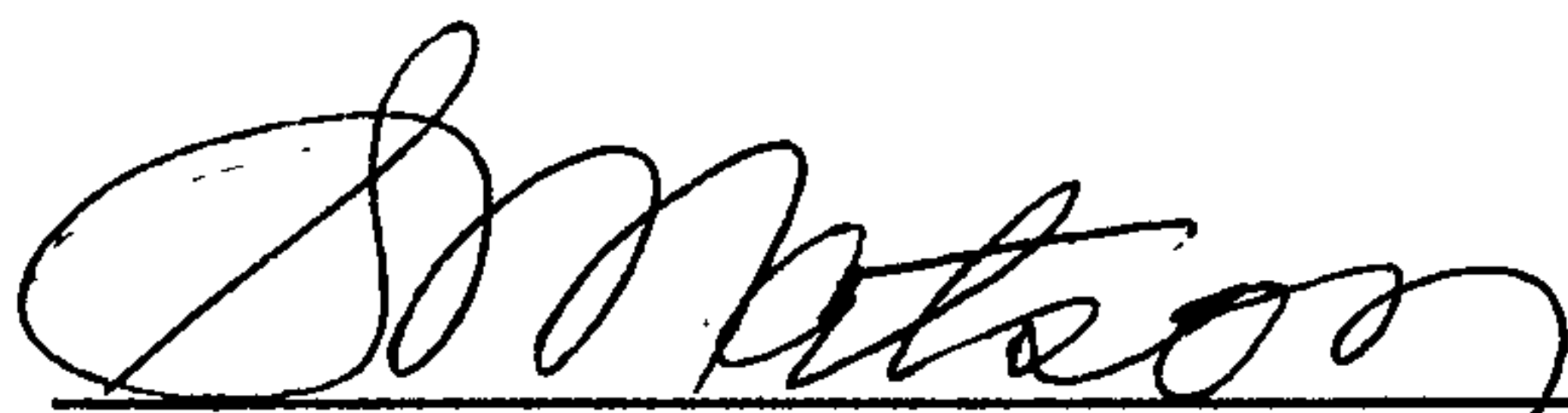

**Sheran Matson, AICP DRB Chair**  
924-3880 Fax 924-3864 [smatson@cabq.gov](mailto:smatson@cabq.gov)

# City of Albuquerque



## DEVELOPMENT/ PLAN REVIEW APPLICATION

Supplemental form

**SUBDIVISION** **S**

Major Subdivision action  
 Minor Subdivision action  
 Vacation  
 Variance (Non-Zoning)

**V**

**SITE DEVELOPMENT PLAN** **P**

...for Subdivision Purposes  
 ...for Building Permit  
 IP Master Development Plan  
 Cert. of Appropriateness (LUCC) **L**

Supplemental form

**ZONING & PLANNING** **Z**

Annexation  
 County Submittal  
 EPC Submittal  
 Zone Map Amendment (Establish or Change Zoning)  
 Sector Plan (Phase I, II, III)  
 Amendment to Sector, Area, Facility or Comprehensive Plan  
 Text Amendment (Zoning Code/Sub Regs)

**APPEAL / PROTEST of...** **A**

Decision by: DRB, EPC, LUCC, Planning Director or Staff, ZHE, Zoning Board of Appeals

PRINT OR TYPE IN BLACK INK ONLY. The applicant or agent must submit the completed application in person to the Planning Department Development Services Center, 600 2<sup>nd</sup> Street NW, Albuquerque, NM 87102. Fees must be paid at the time of application. Refer to supplemental forms for submittal requirements.

**APPLICANT INFORMATION:**

NAME: SANDIA FOUNDATION, PATRICK GLENNON PHONE: 242-2684  
 ADDRESS: 6211 SAN MATEO NE #100 FAX: \_\_\_\_\_  
 CITY: ALBU STATE: NM ZIP: 87109 E-MAIL: \_\_\_\_\_  
 Proprietary interest in site: OWNER List all owners: N/A  
 AGENT (if any): SURVELS SOUTHWEST, LTD PHONE: 998-0303  
 ADDRESS: 333 LOMAS BLVD NE FAX: 998-0306  
 CITY: ALBU STATE: NM ZIP: 87102 E-MAIL: \_\_\_\_\_

DESCRIPTION OF REQUEST: RECONFIGURE THREE EXISTING TRACTS INTO TWO NEW TRACTS & TO DEDICATE ADDITIONAL R-O-W (PRELIM/FINAL)

Is the applicant seeking incentives pursuant to the Family Housing Development Program? Yes  No

SITE INFORMATION: ACCURACY OF THE LEGAL DESCRIPTION IS CRUCIAL! ATTACH A SEPARATE SHEET IF NECESSARY.

Lot or Tract No. TRACTS A & B, LOMAS & BROADWAY Block: N/A Unit: 2  
 Subdiv. / Addn. TOGETHER W TRACT P-1, LANDS OF NEW MEXICO CREDIT CORP.  
 Current Zoning: SU-2 M-1 Proposed zoning: N/A  
 Zone Atlas page(s): J-14-Z No. of existing lots: 3 No. of proposed lots: 2  
 Total area of site (acres): 3.0135 Density if applicable: dwellings per gross acre: - dwellings per net acre: N/A  
 Within city limits?  Yes No  but site is within 5 miles of the city limits. Within 1000FT of a landfill?  Yes  No  
 UPC No. 1-014-058-440-145-42318, 1-014-058-438-129-42312 MRGCD Map No. NO  
 LOCATION OF PROPERTY BY STREETS On or Near: MARBLE AVE NE  
 Between: BROADWAY BLYD NE and LOMAS BLYD NE

**CASE HISTORY:**

List any current or prior case number that may be relevant to your application (Proj., App., DRB, AX, Z, V, S, etc.): V-95  
ZA-87-271, DEB 93-164, DEB 90-186, PROJ # 1004058, 05DEB-00486

Check-off if project was previously reviewed by Sketch Plat/Plan , or Pre-application Review Team . Date of review: 8.03.05

SIGNATURE Dan Graney DATE 8.03.05  
 (Print) Dan Graney Applicant  Agent

**FOR OFFICIAL USE ONLY**

Form revised 9/01, 3/03, 7/03, 10/03, 3/04

INTERNAL ROUTING	Application case numbers	Action	S.F.	Fees
<input checked="" type="checkbox"/> All checklists are complete	05DRB - 01268	P&F	503	\$ 285.00
<input checked="" type="checkbox"/> All fees have been collected		CMS		\$ 20.00
<input checked="" type="checkbox"/> All case #s are assigned				\$
<input checked="" type="checkbox"/> AGIS copy has been sent				\$
<input checked="" type="checkbox"/> Case history #s are listed				\$
<input checked="" type="checkbox"/> Site is within 1000ft of a landfill				\$
<input checked="" type="checkbox"/> F.H.D.P. density bonus				\$
<input checked="" type="checkbox"/> F.H.D.P. fee rebate				\$
	Hearing date <u>8/17/05</u>			Total <u>305.00</u>

Planner signature / date

Project # 1004058

1-014-058-421-110-42313

*TBK Landby Sandia Foundation*

*Vi Sins 8/5/05*

**FORM S(3): SUBDIVISION - D.R.B. MEETING (UNADVERTISED) OF INTERNAL ROUTING**

**SKETCH PLAT REVIEW AND COMMENT**

**YOUR ATTENDANCE IS REQUIRED.**

- \_\_\_ Scale drawing of the proposed subdivision plat (folded to fit into an 8.5" by 14" pocket) 6 copies for unadvertised meetings. Sketches are not reviewed through internal routing.
- \_\_\_ Site sketch with measurements showing structures, parking, Bldg. setbacks, adjacent rights-of-way and street improvements, etcetera, if there is any existing land use (folded to fit into an 8.5" by 14" pocket) 6 copies.
- \_\_\_ Zone Atlas map with the entire property(ies) precisely and clearly outlined and crosshatched (to be photocopied)
- \_\_\_ Letter briefly describing, explaining, and justifying the request
- \_\_\_ Any original and/or related file numbers are listed on the cover application

**MAJOR SUBDIVISION EXTENSION OF PRELIMINARY PLAT**

**Your attendance is required.**

- \_\_\_ Preliminary Plat reduced to 8.5" x 11"
- \_\_\_ Zone Atlas map with the entire property(ies) precisely and clearly outlined and crosshatched (to be photocopied)
- \_\_\_ Letter briefly describing, explaining, and justifying the request
- \_\_\_ Copy of previous D.R.B. approved infrastructure list
- \_\_\_ Copy of the LATEST Official D.R.B. Notice of approval for Preliminary Plat Extension request
- \_\_\_ Any original and/or related file numbers are listed on the cover application

**Extensions are not reviewed through internal routing.**  
Extension of preliminary plat approval expires after one year.

**MAJOR SUBDIVISION FINAL PLAT APPROVAL**

**Your attendance is required.**

- \_\_\_ Proposed Final Plat (folded to fit into an 8.5" by 14" pocket) 6 copies for unadvertised meetings, 4 copies for internal routing.
- \_\_\_ Design elevations & cross sections of perimeter walls
- \_\_\_ Zone Atlas map with the entire property(ies) precisely and clearly outlined and crosshatched (to be photocopied)
- \_\_\_ Original Mylar drawing of the proposed plat for internal routing only. Otherwise, bring Mylar to meeting.
- \_\_\_ Property owner's and City Surveyor's signatures on the Mylar drawing
- \_\_\_ SIA financial guaranty verification
- \_\_\_ Landfill disclosure and EHD signature line on the Mylar drawing if property is within a landfill buffer
- \_\_\_ Any original and/or related file numbers are listed on the cover application

**DXF FILE AND HARD COPY OF FINAL PLAT DATA FOR AGIS IS REQUIRED.**

**MINOR SUBDIVISION PRELIMINARY / FINAL PLAT APPROVAL**

**Your attendance is required.**

- ✓ Proposed Preliminary / Final Plat (folded to fit into an 8.5" by 14" pocket) 6 copies for unadvertised meetings, 4 copies for internal routing.
- ✓ Site sketch with measurements showing structures, parking, Bldg. setbacks, adjacent rights-of-way and street improvements, etcetera, if there is any existing land use (folded to fit into an 8.5" by 14" pocket) 6 copies.
- ✓ Zone Atlas map with the entire property(ies) precisely and clearly outlined and crosshatched (to be photocopied)
- ✓ Letter briefly describing, explaining, and justifying the request
- ✓ Original Mylar drawing of the proposed plat for internal routing only. Otherwise, bring Mylar to meeting.
- ✓ Property owner's and City Surveyor's signatures on the Mylar drawing
- ✓ Landfill disclosure and EHD signature line on the Mylar drawing if property is within a landfill buffer
- ✓ Fee (see schedule)
- ✓ Any original and/or related file numbers are listed on the cover application
- ✓ Infrastructure list if required (verify with DRB Engineer) **NO INTERNAL ROUTING**

**DXF FILE AND HARD COPY OF FINAL PLAT DATA FOR AGIS IS REQUIRED.**

**AMENDMENT TO PRELIMINARY PLAT (with minor changes)**

**Your attendance is required.**

**AMENDMENT TO INFRASTRUCTURE LIST (with minor changes)**

**AMENDMENT TO GRADING PLAN (with minor changes)**

PLEASE NOTE: There are no clear distinctions between significant and minor changes with regard to subdivision amendments. Significant changes are those deemed by the DRB to require public notice and public hearing.

- \_\_\_ Proposed Amended Preliminary Plat, Infrastructure List, and/or Grading Plan (folded to fit into an 8.5" by 14" pocket) 6 copies for unadvertised meetings.
- \_\_\_ Original Preliminary Plat, Infrastructure List, and/or Grading Plan (folded to fit into an 8.5" by 14" pocket) 6 copies for unadvertised meetings
- \_\_\_ Zone Atlas map with the entire property(ies) precisely and clearly outlined and crosshatched (to be photocopied)
- \_\_\_ Letter briefly describing, explaining, and justifying the request
- \_\_\_ Original Mylar drawing of the proposed amended plat for internal routing only. Otherwise, bring Mylar to meeting.
- \_\_\_ Property owner's and City Surveyor's signatures on the Mylar drawing, if the plat is being amended
- \_\_\_ Any original and/or related file numbers are listed on the cover application

Amended preliminary plat approval expires after one year.

I, the applicant, acknowledge that any information required but not submitted with this application will likely result in deferral of actions.

Dan Graney  
Applicant name (print)  
Dan Graney  
Applicant signature / date  
8.03.05



Form revised 3/03, 8/03 and 11/03

- Checklists complete
- Fees collected
- Case #s assigned
- Related #s listed

Application case numbers  
05DRB - 01268

Ki Sim 8/5/05  
Planner signature / date

**Project #** 1004058

# *Surveys Southwest, LTD*

---

333 Lomas Blvd., NE \* Albuquerque, New Mexico 87102 \* 998-0303 \* Fax 998-0306

August 4, 2005

DEVELOPMENT REVIEW BOARD MEMBERS  
PLAZA DEL SOL  
600 SECOND STREET NW  
ALBUQUERQUE, NM 87102

REF: TRACTS A-1 & P-1-A, LANDS OF SANDIA FOUNDATION

Dear Board Members:

The purpose of the above referenced plat is to reconfigure Three (3) existing lots into Two (2) new lots for development of Tract Two (2). Tract Two (2) is scheduled to be developed with a restaurant and coffee shop.

If you have any questions please feel free to contact me.

Sincerely,

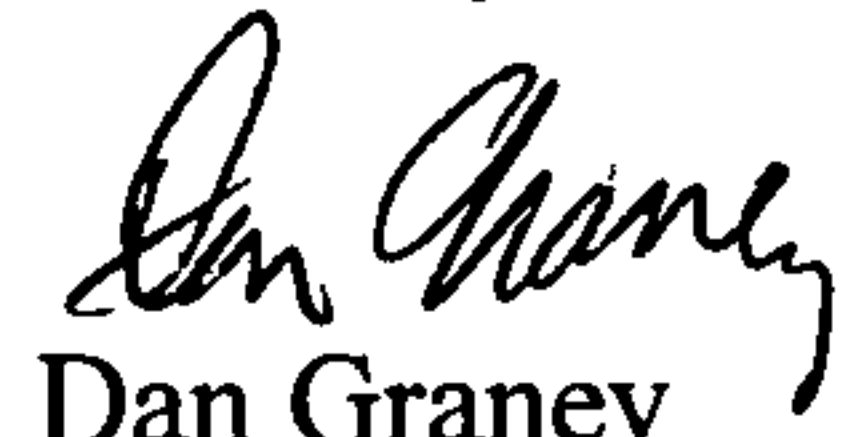

Dan Graney  
President

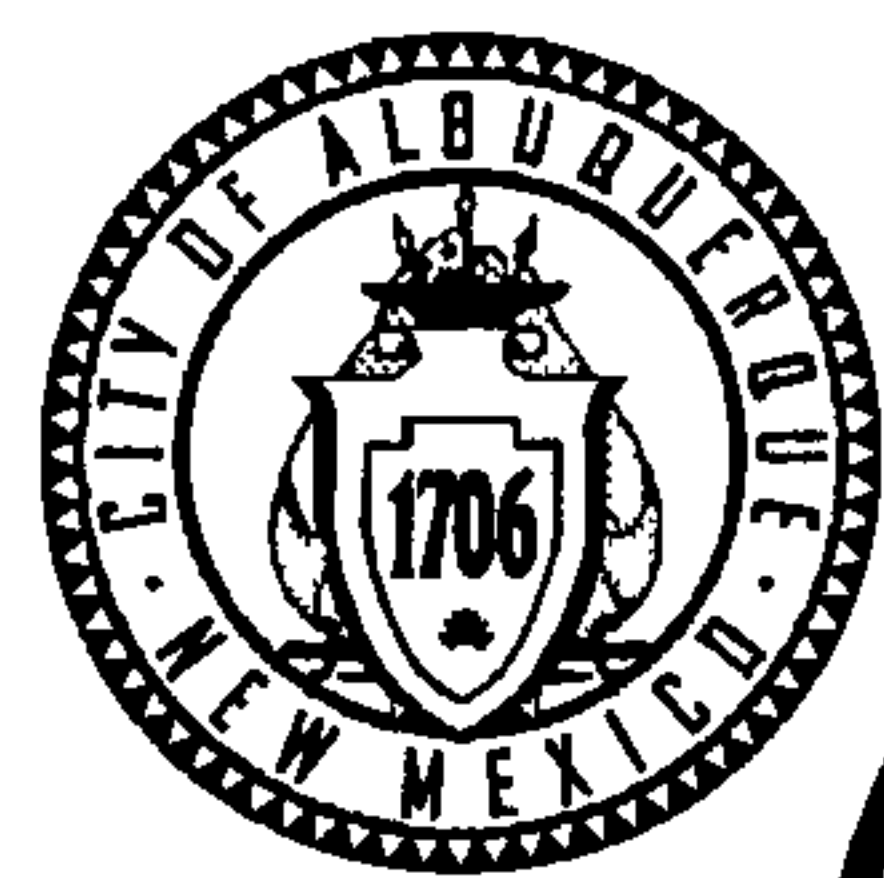
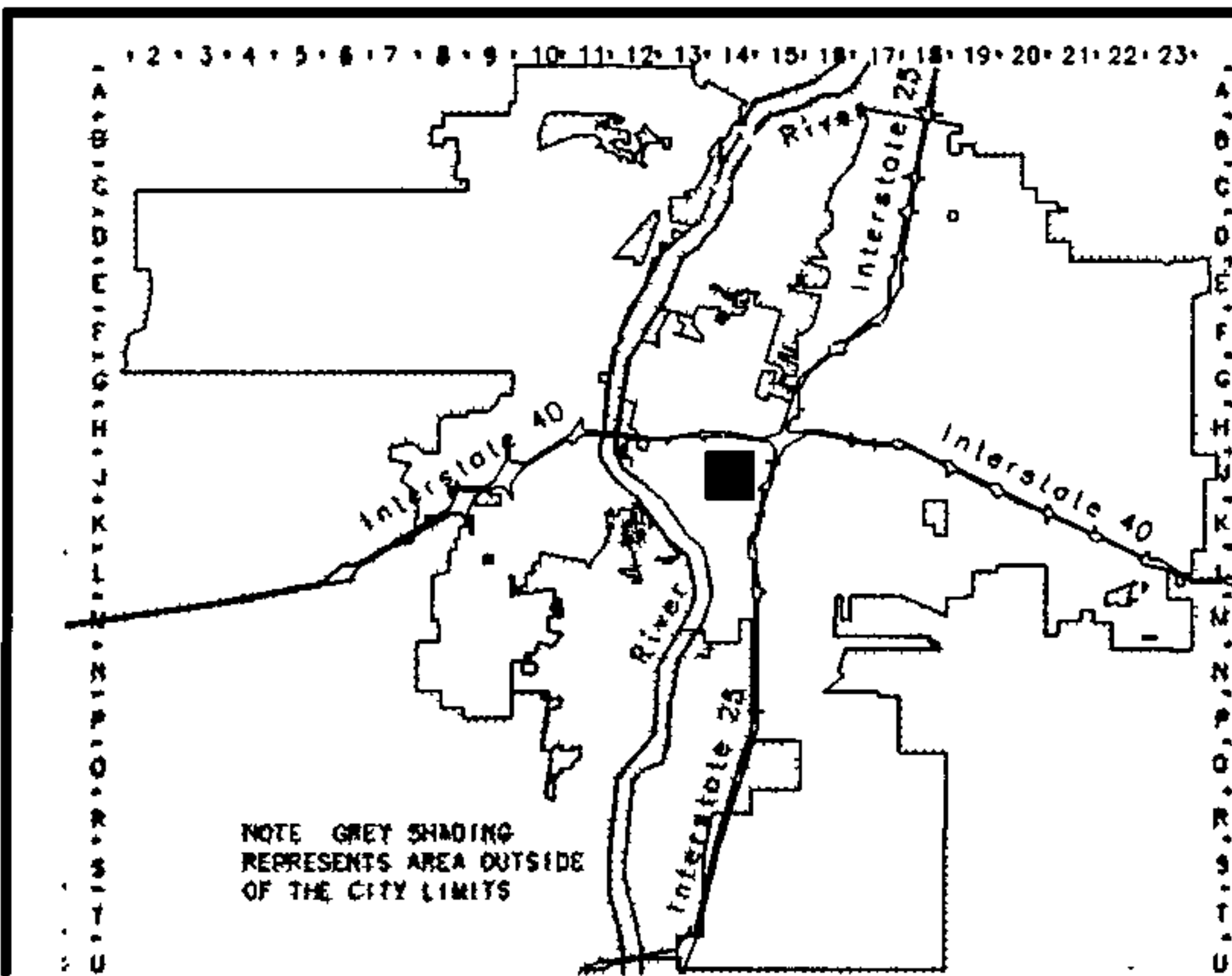
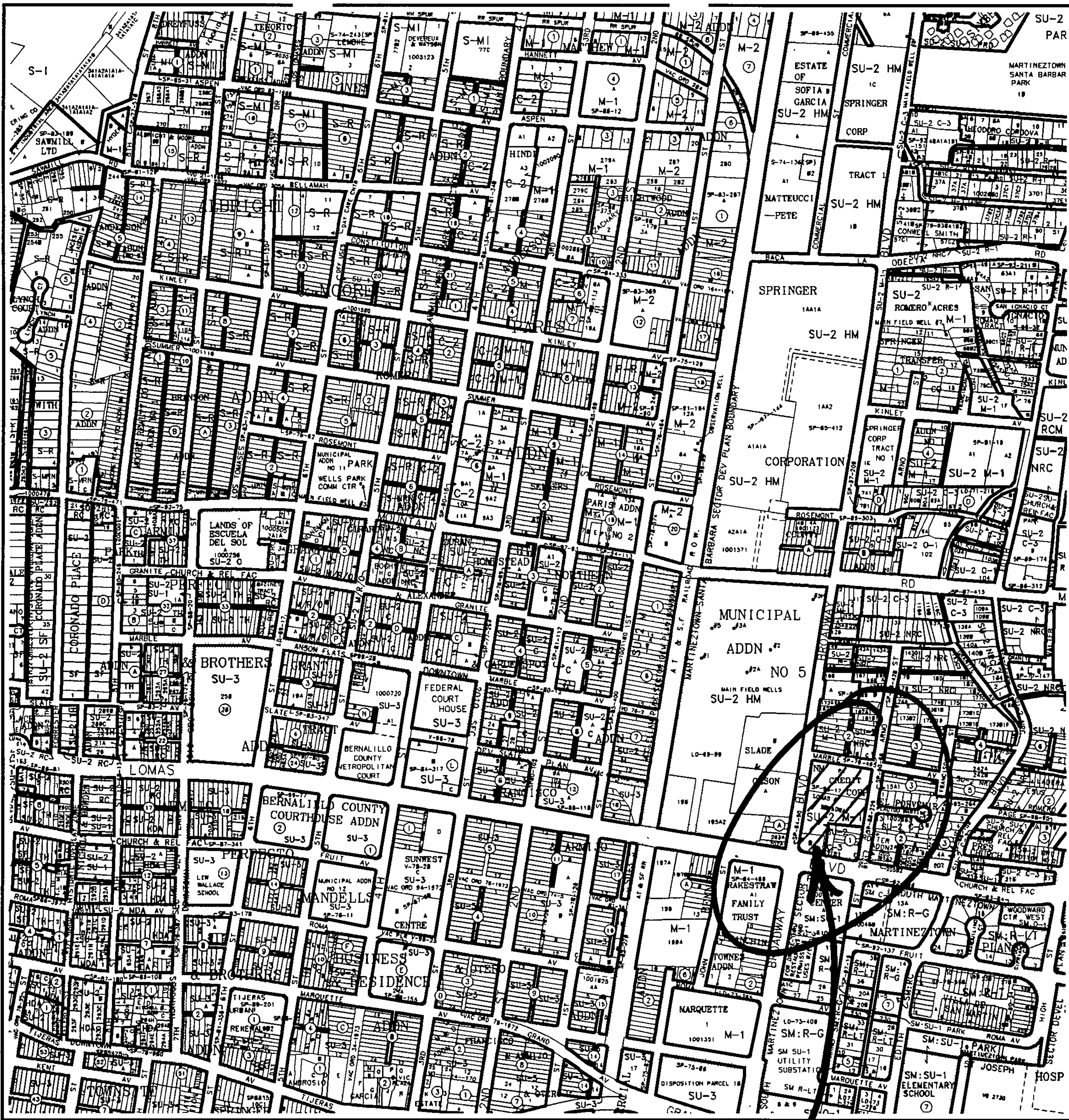

**AGIS**  
 Albuquerque Geographic Information Systems  
 PLANNING DEPARTMENT  
 © Copyright 2004

**SITE Zone Atlas Page**

**J-14-Z**

Map Amended through August 03, 2004

**ONE STOP SHOP  
CITY OF ALBUQUERQUE PLANNING DEPARTMENT  
Development & Building Services**

**PAID RECEIPT**

APPLICANT NAME SANDIA FOUNDATION Patrick Coleman  
 AGENT Survey Southwest  
 ADDRESS 333 Lomas Blvd.  
 PROJECT & APP # 1004058 / 05DRB-01268  
 PROJECT NAME LANDS OF New Mexico Credit Corp.

\$ 20.<sup>00</sup> 441032/3424000 Conflict Management Fee  
 \$ 285.<sup>00</sup> 441006/4983000 DRB Actions  
 \$ \_\_\_\_\_ 441006/4971000 EPC/AA/LUCC Actions & All Appeals  
 \$ \_\_\_\_\_ 441018/4971000 Public Notification  
 \$ \_\_\_\_\_ 441006/4983000 DRAINAGE PLAN REVIEW OR TRAFFIC IMPACT STUDY\*\*\*  
 ( ) Major/Minor Subdivision ( ) Site Development Plan ( ) Bldg Permit  
 ( ) Letter of Map Revision ( ) Conditional Letter of Map Revision  
 ( ) Traffic Impact Study  
 \$ 305.<sup>00</sup> TOTAL AMOUNT DUE

**\*\*\*NOTE: If a subsequent submittal is required, bring a copy of this paid receipt with you to avoid an additional charge.**

8/5/2005 RECEIPT# 00047283 Account 441032 Activity 3424000 Trans Amt J24 Misc	<b>SANDIA FOUNDATION</b> 6211 SAN MATEO BLVD NE SUITE 100 ALBUQUERQUE, NM 87109 (505) 242-2684	BANK OF ALBUQUERQUE, NA ALBUQUERQUE, NM 95-660/1070	9687
PAY TO THE ORDER OF <u>City of Albuquerque</u>		<u>8/2/2005</u>	\$ <b>**305.00</b>
Three Hundred and 00/100		<b>***DUPLICATE***</b>	
City of Albuquerque P.O. Box 1313 Albuquerque, NM 87103-1313		City of Albuquerque Treasury Division	
MEMO <u>replat Lomas &amp; Broadway</u>		8/5/2005 RECEIPT# 00047283 WSH 007 TRANS 0005 Account 441006 Fund 0110 Activity 4983000 Trans Amt \$305.00 J24 Misc	
@009687 @ 107006606 782722 746		\$285.00	\$305.00 \$0.00







Supplemental form **S**

**SUBDIVISION**  
 Major Subdivision action  
 Minor Subdivision action *SKETCH PLAT*  
 Vacation **V**  
 Variance (Non-Zoning)

**SITE DEVELOPMENT PLAN** **P**  
 ...for Subdivision Purposes  
 ...for Building Permit  
 IP Master Development Plan  
 Cert. of Appropriateness (LUCC) **L**

Supplemental form **Z**

**ZONING & PLANNING** **Z**  
 Annexation  
 County Submittal  
 EPC Submittal  
 Zone Map Amendment (Establish or Change Zoning)  
 Sector Plan (Phase I, II, III)  
 Amendment to Sector, Area, Facility or Comprehensive Plan  
 Text Amendment (Zoning Code/Sub Regs)

**APPEAL / PROTEST of...** **A**

Decision by: DRB, EPC, LUCC, Planning Director or Staff, ZHE, Zoning Board of Appeals

PRINT OR TYPE IN BLACK INK ONLY. The applicant or agent must submit the completed application in person to the Planning Department Development Services Center, 600 2<sup>nd</sup> Street NW, Albuquerque, NM 87102. Fees must be paid at the time of application. Refer to supplemental forms for submittal requirements.

**APPLICANT INFORMATION:**

NAME: *SANDIA FOUNDATION, PATRICK GLENNON* PHONE: *242-2684*  
 ADDRESS: *6211 SAN MATEO NE SUITE 100* FAX: \_\_\_\_\_  
 CITY: *ALBU* STATE *NM* ZIP *87109* E-MAIL: \_\_\_\_\_  
 Proprietary interest in site: *OWNER* List all owners: *FRANKLIN E. WILSON*  
 AGENT (if any): *SURVEYS SOUTHWEST, LTD* PHONE: *998-0303*  
 ADDRESS: *333 LOMAS BLVD NE* FAX: *998-0306*  
 CITY: *ALBU* STATE *NM* ZIP *87102* E-MAIL: \_\_\_\_\_

DESCRIPTION OF REQUEST: *RECONFIGURE THREE EXISTING TRACTS INTO TWO NEW TRACTS OF LAND.*

Is the applicant seeking incentives pursuant to the Family Housing Development Program?  Yes.  No.

**SITE INFORMATION: ACCURACY OF THE LEGAL DESCRIPTION IS CRUCIAL! ATTACH A SEPARATE SHEET IF NECESSARY.**

Lot or Tract No. *TRACTS A & B, LOMAS & BROADWAY, UNIT 2* Block: *1* Unit: *2*  
 Subdiv. / Addn. *TOGETHER W/ TRACT P-1, LANDS OF N. MEX. CREDIT CORPORATION*  
 Current Zoning: *SU-2 / M-1* Proposed zoning: *N/A*  
 Zone Atlas page(s): *J-14-Z* No. of existing lots: *3* No. of proposed lots: *2*  
 Total area of site (acres): *3.0134* Density if applicable: dwellings per gross acre: *1* dwellings per net acre: *1*  
 Within city limits?  Yes. No  but site is within 5 miles of the city limits.) Within 1000FT of a landfill? *NO*  
 UPC No. *1-014-058-440-145-42318, 1-014-058-438-129-42312* MRGCD Map No. *N/A*  
 LOCATION OF PROPERTY BY STREETS: On or Near: *MARBLE AVENUE NE*  
 Between: *BROADWAY BLVD NE* and *LOMAS BLVD NE*

**CASE HISTORY:**

List any current or prior case number that may be relevant to your application (Proj., App., DRB-, AX-, Z-, V-, S-, etc.): *V-95*  
*ZA-87-271, DRB93-164, DRB90-186*

Check-off if project was previously reviewed by Sketch Plat/Plan , or Pre-application Review Team . Date of review: *3-22-05*

SIGNATURE *[Signature]* DATE *3-22-05*  
 (Print) *Dan Orsney* \_\_\_\_\_ Applicant  Agent

FOR OFFICIAL USE ONLY Form revised 9/01, 3/03, 7/03, 10/03, 3/04

INTERNAL ROUTING	Application case numbers	Action	S.F.	Fees
<input checked="" type="checkbox"/> All checklists are complete	<i>05DRB - - 00486</i>	<i>SK</i>		\$ <i>0</i>
<input checked="" type="checkbox"/> All fees have been collected				\$
<input checked="" type="checkbox"/> All case #s are assigned				\$
<input type="checkbox"/> AGIS copy has been sent				\$
<input checked="" type="checkbox"/> Case history #s are listed				\$
<input type="checkbox"/> Site is within 1000ft of a landfill				\$
<input type="checkbox"/> F.H.D.P. density bonus				\$
<input type="checkbox"/> F.H.D.P. fee rebate				\$
	Hearing date <i>3-30-05</i>			Total \$ <i>0</i>

*[Signature]* *3-22-05*  
 Planner signature / date

**Project #** *1004058*

1-014-058-421-110-42313

**FORM S(3): SUBDIVISION - D.R.B. MEETING (UNADVERTISED) OR INTERNAL ROUTING**

- SKETCH PLAT REVIEW AND COMMENT** **YOUR ATTENDANCE IS REQUIRED.**
- Scale drawing of the proposed subdivision plat (folded to fit into an 8.5" by 14" pocket) 6 copies for unadvertised meetings. Sketches are not reviewed through internal routing.
  - Site sketch with measurements showing structures, parking, Bldg. setbacks, adjacent rights-of-way and street improvements, etcetera, if there is any existing land use (folded to fit into an 8.5" by 14" pocket) 6 copies.
  - Zone Atlas map with the entire property(ies) precisely and clearly outlined and crosshatched (to be photocopied)
  - Letter briefly describing, explaining, and justifying the request
  - Any original and/or related file numbers are listed on the cover application

- MAJOR SUBDIVISION EXTENSION OF PRELIMINARY PLAT** **Your attendance is required.**
- Preliminary Plat reduced to 8.5" x 11"
  - Zone Atlas map with the entire property(ies) precisely and clearly outlined and crosshatched (to be photocopied)
  - Letter briefly describing, explaining, and justifying the request
  - Copy of previous D.R.B. approved infrastructure list
  - Copy of the LATEST Official D.R.B. Notice of approval for Preliminary Plat Extension request
  - Any original and/or related file numbers are listed on the cover application
- Extensions are not reviewed through internal routing.**  
Extension of preliminary plat approval expires after one year.

- MAJOR SUBDIVISION FINAL PLAT APPROVAL** **Your attendance is required.**
- Proposed Final Plat (folded to fit into an 8.5" by 14" pocket) 6 copies for unadvertised meetings, 4 copies for internal routing.
  - Design elevations & cross sections of perimeter walls
  - Zone Atlas map with the entire property(ies) precisely and clearly outlined and crosshatched (to be photocopied)
  - Original Mylar drawing of the proposed plat for internal routing only. Otherwise, bring Mylar to meeting.
  - Property owner's and City Surveyor's signatures on the Mylar drawing
  - SIA financial guaranty verification
  - Landfill disclosure and EHD signature line on the Mylar drawing if property is within a landfill buffer
  - Any original and/or related file numbers are listed on the cover application
- DXF FILE AND HARD COPY OF FINAL PLAT DATA FOR AGIS IS REQUIRED.**

- MINOR SUBDIVISION PRELIMINARY / FINAL PLAT APPROVAL** **Your attendance is required.**
- Proposed Preliminary / Final Plat (folded to fit into an 8.5" by 14" pocket) 6 copies for unadvertised meetings, 4 copies for internal routing.
  - Site sketch with measurements showing structures, parking, Bldg. setbacks, adjacent rights-of-way and street improvements, etcetera, if there is any existing land use (folded to fit into an 8.5" by 14" pocket) 6 copies.
  - Zone Atlas map with the entire property(ies) precisely and clearly outlined and crosshatched (to be photocopied)
  - Letter briefly describing, explaining, and justifying the request
  - Original Mylar drawing of the proposed plat for internal routing only. Otherwise, bring Mylar to meeting.
  - Property owner's and City Surveyor's signatures on the Mylar drawing
  - Landfill disclosure and EHD signature line on the Mylar drawing if property is within a landfill buffer
  - Fee (see schedule)
  - Any original and/or related file numbers are listed on the cover application
  - Infrastructure list if required (verify with DRB Engineer) **NO INTERNAL ROUTING**
- DXF FILE AND HARD COPY OF FINAL PLAT DATA FOR AGIS IS REQUIRED.**

- AMENDMENT TO PRELIMINARY PLAT (with minor changes)** **Your attendance is required.**
- AMENDMENT TO INFRASTRUCTURE LIST (with minor changes)**
- AMENDMENT TO GRADING PLAN (with minor changes)**
- PLEASE NOTE: There are no clear distinctions between significant and minor changes with regard to subdivision amendments. Significant changes are those deemed by the DRB to require public notice and public hearing.
- Proposed Amended Preliminary Plat, Infrastructure List, and/or Grading Plan (folded to fit into an 8.5" by 14" pocket) 6 copies for unadvertised meetings.
  - Original Preliminary Plat, Infrastructure List, and/or Grading Plan (folded to fit into an 8.5" by 14" pocket) 6 copies for unadvertised meetings
  - Zone Atlas map with the entire property(ies) precisely and clearly outlined and crosshatched (to be photocopied)
  - Letter briefly describing, explaining, and justifying the request
  - Original Mylar drawing of the proposed amended plat for internal routing only. Otherwise, bring Mylar to meeting.
  - Property owner's and City Surveyor's signatures on the Mylar drawing, if the plat is being amended
  - Any original and/or related file numbers are listed on the cover application
- Amended preliminary plat approval expires after one year.

I, the applicant, acknowledge that any information required but not submitted with this application will likely result in deferral of actions.

Don Graney Applicant name (print)  
Don Graney Applicant signature / date  
 3.22.05



Form revised 3/03, 8/03 and 11/03

- Checklists complete
  - Fees collected
  - Case #s assigned
  - Related #s listed
- Application case numbers  
 05 0213 - 00486

Almis 3-22-05  
 Planner signature / date

**Project #** 1004058

# *Surveys Southwest, LTD*

---

*333 Lomas Blvd., NE \* Albuquerque, New Mexico 87102 \* 998-0303 \* Fax 998-0306*

March 22, 2005

DEVELOPMENT REVIEW BOARD MEMBERS  
PLAZA DEL SOL  
600 SECOND STREET NW  
ALBUQUERQUE, NM·87102

REF: TRACTS A-1 & P-1-A, LANDS OF SANDIA FOUNDATION

Dear Board Members:

The purpose of this sketch plat is to depict new lot lines for future development of Tract A-1 as a restaurant site. The existing buildings will be removed.

If you have any questions please feel free to contact me.

Sincerely,

Dan Graney  
President

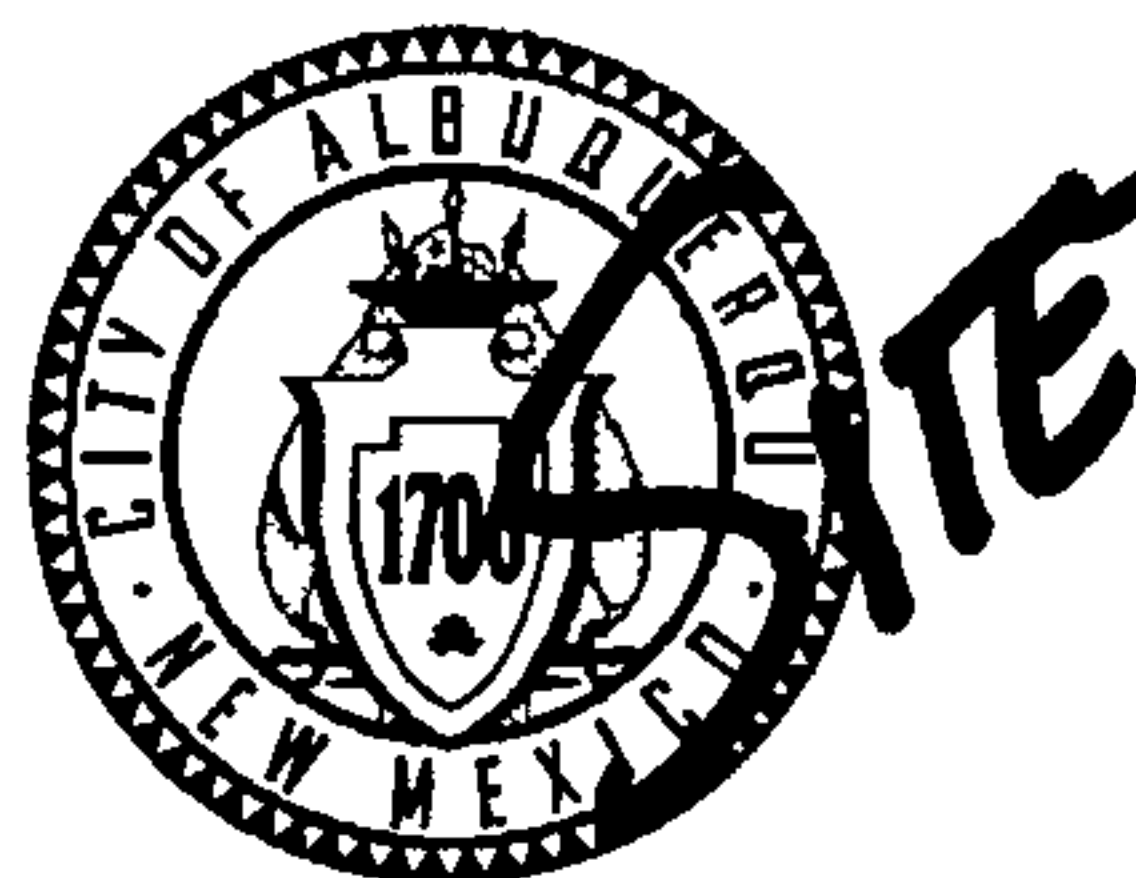
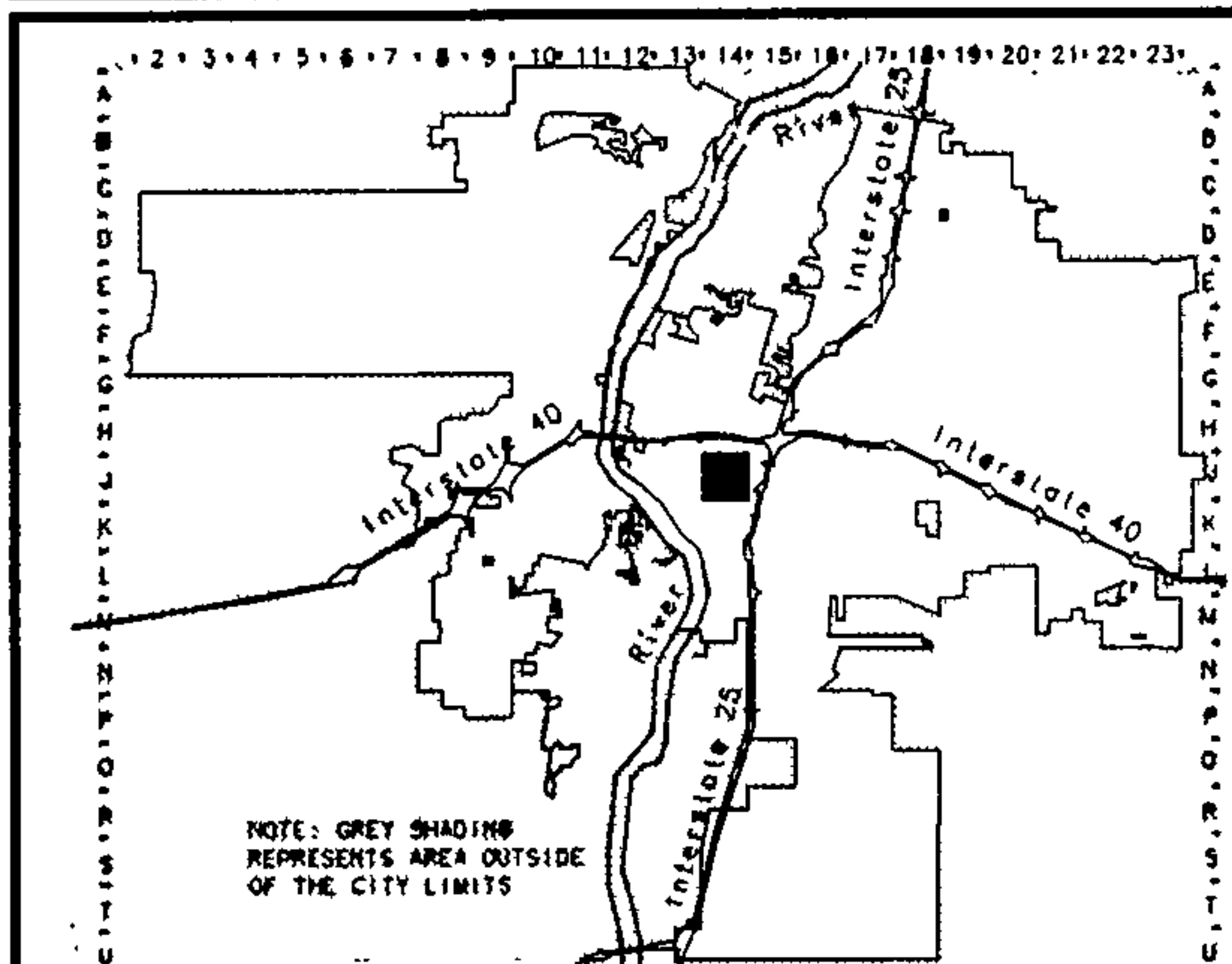
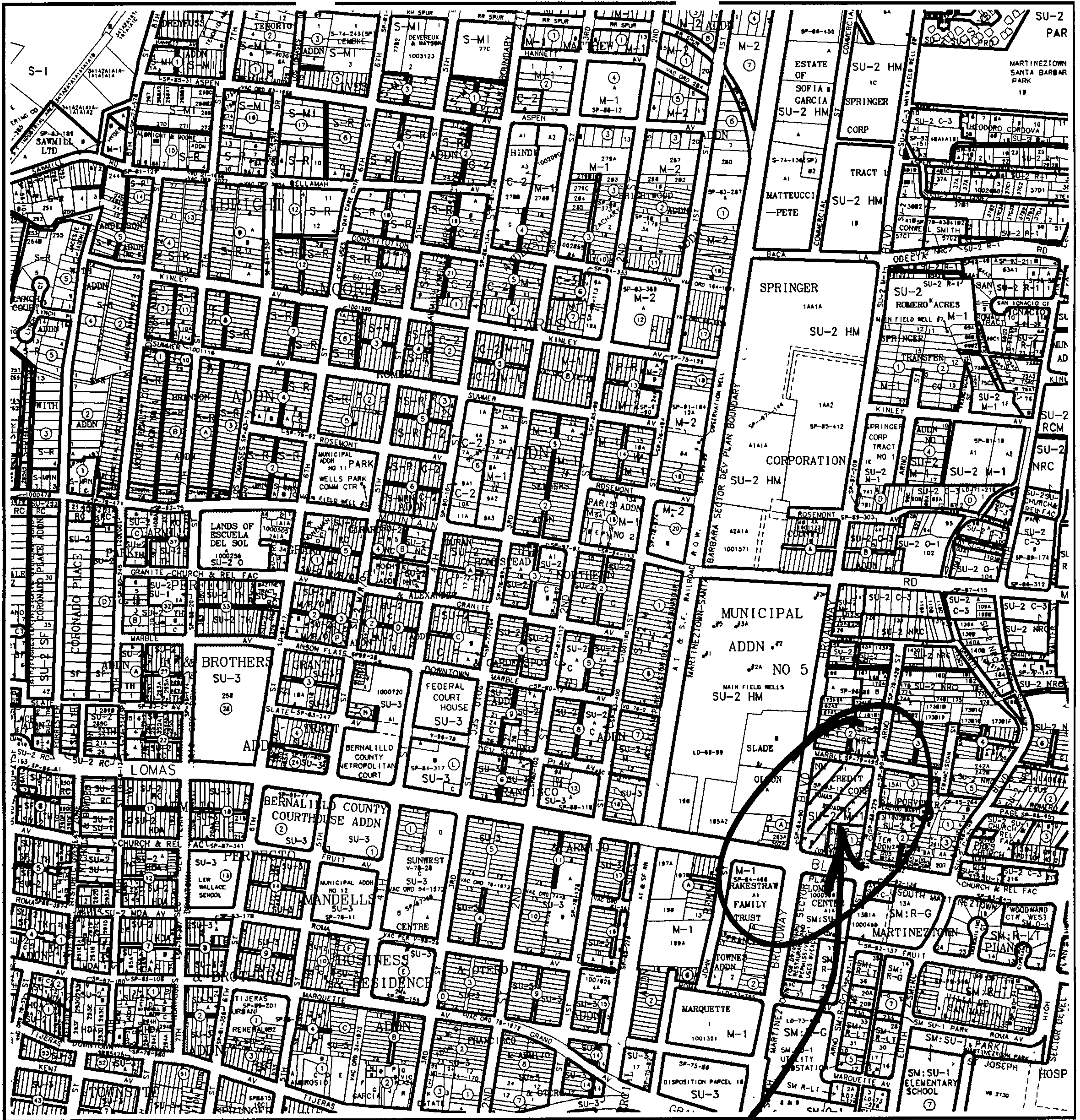

**Zone Atlas Page**

**J-14-Z**

Map Amended through August 03, 2004

**A G I S**  
 Albuquerque Geographic Information System  
 PLANNING DEPARTMENT  
 © Copyright 2004

BROADWAY BOULEVARD N.E.  
R.O.W. VARIES - 60'+

MA AVENUE N.E.  
30' R.O.W.

ARNO STREET N.E.  
60' R.O.W.

LOMAS BOULEVARD N.E.  
100' R.O.W.

TRACT P-1  
1.2342 ACS.

TRACT A  
1.5120ACS.

TRACT B  
LOMAS & BROADWAY UNIT 2  
FILED 5-17-1994 (94C, 158)

TRACT C  
LOMAS & BROADWAY UNIT 2  
FILED 5-17-1994 (94C, 158)

BLK. 1  
TROTTER ADDN.  
FILED 8-15-1931 (A1, 64)

$\Delta = 06^{\circ}16'46''$   
 $R = 1000.00'$   
 $L = 109.60'$   
CHORD = 109.54'  
 $N 05^{\circ}37'44'' E$

$\Delta = 06^{\circ}16'46''$   
 $R = 1000.00'$   
 $L = 109.60'$   
CHORD = 109.54'  
 $N 05^{\circ}37'44'' E$

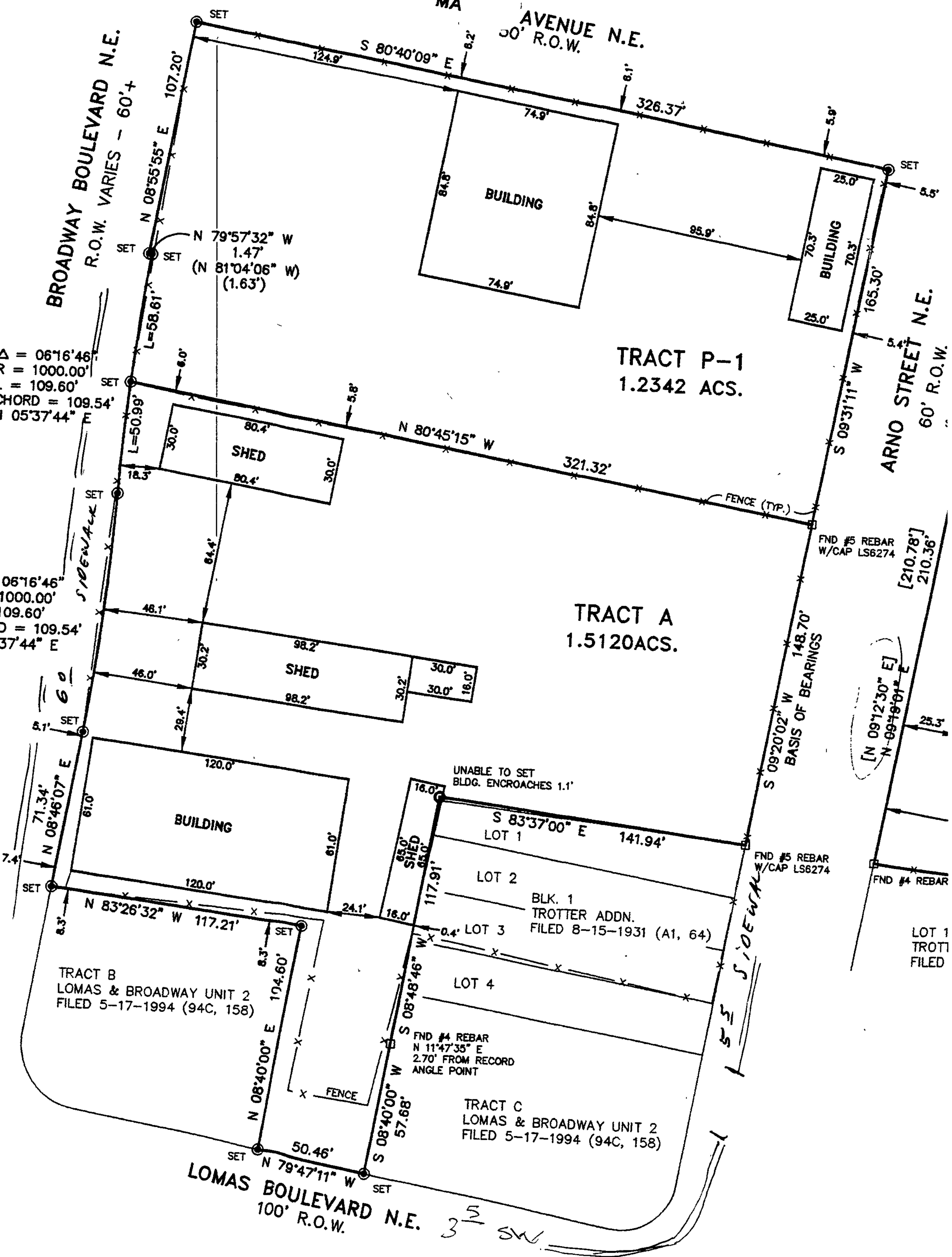

35 SW