

10



# DRB CASE ACTION LOG (SITE PLAN B.P.)

REVISED 2/5/04

This sheet must accompany your plat or site plan to obtain delegated signatures. Return sheet with site plan/plat once comments are addressed.

DRB Application No.: 05DRB-00603 (SBP)  
Project Name: MERIDIAN BUSINESS PARK  
Agent: ABQ Engineering

Project # 1004112  
Phone No.: 255-7802

Your request for (SDP for SUB), (SDP for BP), (FINAL PLATS), (MASTER DEVELOP. PLAN), was approved on 4/3/05 by the DRB with delegation of signature(s) to the following departments.  
**OUTSTANDING SIGNATURES COMMENTS TO BE ADDRESSED**

TRANSPORTATION: \_\_\_\_\_  
 \_\_\_\_\_  
 \_\_\_\_\_  
 \_\_\_\_\_  
 \_\_\_\_\_

UTILITIES: \_\_\_\_\_  
 \_\_\_\_\_  
 \_\_\_\_\_  
 \_\_\_\_\_

CITY ENGINEER / AMAFCA: \_\_\_\_\_  
 \_\_\_\_\_  
 \_\_\_\_\_  
 \_\_\_\_\_

PARKS / CIP: \_\_\_\_\_  
 \_\_\_\_\_  
 \_\_\_\_\_  
 \_\_\_\_\_

PLANNING (Last to sign): \_\_\_\_\_  
 \_\_\_\_\_  
 \_\_\_\_\_  
 \_\_\_\_\_

- Planning must record this plat. Please submit the following items:**
  - The original plat and a mylar copy for the County Clerk.
  - Tax certificate from the County Treasurer.
  - Recording fee (checks payable to the County Clerk). RECORDED DATE: \_\_\_\_\_
  - Tax printout from the County Assessor.
- Include 3 copies of the approved site plan ~~along with the originals~~**
- County Treasurer's signature must be obtained prior to the recording of the plat with the County Clerk.**
- Property Management's signature must be obtained prior to Planning Department's signature.**
- AGIS DXF File approval required.**
- Copy of recorded plat for Planning.**

Project Number 1004112



**DEVELOPMENT REVIEW BOARD  
ACTION SHEET**

**Plaza del Sol Hearing Room, Basement, Plaza del Sol Building**

April 27, 2005

9:00 a.m.

**MEMBERS:**

Sheran Matson, AICP, DRB Chair  
Claire Senova, Administrative Assistant

Wilfred Gallegos, Transportation Development  
Brad Bingham, Alternate City Engineer

Roger Green, Utility Development  
Christina Sandoval, Parks & Recreation

\*\*\*\*\*

**NOTE:** UNLESS ANNOUNCED DURING THE MEETING, THE DEVELOPMENT REVIEW BOARD WILL NOT TAKE A LUNCH BREAK.

**NOTE:** INDIVIDUALS WITH DISABILITIES WHO NEED SPECIAL ASSISTANCE TO PARTICIPATE AT THIS MEETING SHOULD CONTACT CLAIRE SENOVA, PLANNING DEPARTMENT, AT 924-3946. HEARING IMPAIRED USERS MAY CONTACT HER VIA THE NEW MEXICO RELAY NETWORK BY CALLING TOLL-FREE:1-800-659-8331.

**NOTE:** REQUESTS FOR DEFERRAL OF CASES WILL BE DISCUSSED BY THE BOARD AND THE APPLICANT AND/OR AGENT AT THE BEGINNING OF THE AGENDA. BOTH PARTIES MUST AGREE UPON THE DATE OF DEFERRAL. IF THE APPLICANT/AGENT IS NOT PRESENT, THE ADMINISTRATIVE ASSISTANT MUST RECEIVE A LETTER, PRIOR TO THE HEARING DATE, REQUESTING A SPECIFIC DEFERRAL DATE. THE BOARD WILL DISCUSS AND MAKE A DECISION AT THE HEARING. THE APPLICANT/AGENT WILL THEN BE INFORMED OF THE DEFERRAL DATE AND REASON.

- A. Call to Order: 9:00 A.M.
- B. Changes and/or Additions to the Agenda
- C. New or Old Business

Adjourned: 11:55 A.M.

**CASES WHICH REQUIRE PUBLIC NOTIFICATION**  
**MAJOR SUBDIVISIONS, VACATIONS, SIA EXTENSIONS AND SITE DEVELOPMENT PLANS**

1. **Project # 1000635**  
05DRB-00547 Major-Vacation of Public Easements  
TIERRA WEST LLC agent(s) for DE BARTOLO DEVELOPMENT request(s) the above action(s) for all or a portion of Tract(s) 38-1A1, 38-2A1, 38-2A2 and 38-3A1, **TAYLOR RANCH**, zoned SU-1 FOR C-1, located on MONTANO RD NW, between MONTANO PLAZA DR NW and COORS BLVD NW containing approximately 3 acre(s). [REF: 00DRB00878, 02DRB01040, 04DRB01698,04DRB01764] (E-12) **THE VACATION WAS APPROVED AS SHOWN ON EXHIBIT B IN THE PLANNING FILE.**

2. **Project # 1002948**  
05DRB-00538 Major-Vacation of  
Public Easements  
05DRB-00539 Minor-Prelim&Final Plat  
Approval

ISAACSON & ARFMAN PA agent(s) for BEALHEN CONSTRUCTION LLC, C/O MS DEV ONE LLC, request(s) the above action(s) for all or a portion of Lot(s) 7, **VISTA FAISAN SUBDIVISION**, zoned RA-2, located on VISTA FAISAN TRAIL NW, between EL POTRERO NW and GUADALUPE TRAIL NW containing approximately 1/4 acre(s). [REF: 03EPC01736, 03EPC01485, 03DRB01486, 03DRB01497, 04DRB01504, 04DRB01669] (F-14) **THE VACATION WAS APPROVED AS SHOWN ON EXHIBIT B IN THE PLANNING FILE. THE PRELIMINARY PLAT WAS APPROVED WITH FINAL SIGN OFF DELEGATED TO PLANNING FOR AGIS DXF AND 15-DAY APPEAL PERIOD.**

- 05DRB-00666 Minor-Prelim&Final Plat  
Approval  
05DRB-00665 Minor-Vacation of  
Private Easements

ISAACSON & ARFMAN PA agent(s) for MS DEV ONE LLC request(s) the above action(s) for all or a portion of Lot(s) 4 & 5, **VISTA FAISAN SUBDIVISION**, zoned RA-2, located on VISTA FAISAN TRAIL NW, between EL POTRERO NW and GUADALUPE TRAIL NW containing approximately 1 acre(s). [REF: 03EPC01736, 03DRB01485, 03DRB01486, 03DRB01497, 04DRB01504, 04DRB01669] (F-14) **PRELIMINARY PLAT WAS APPROVED WITH FINAL SIGN OFF DELEGATED TO PLANNING FOR AGIS DXF FILE. THE VACATION WAS APPROVED AS SHOWN ON EXHIBIT B IN THE PLANNING FILE.**

3. **Project # 1003902**  
05DRB-00542 Major-Vacation of Pub  
Right-of-Way  
05DRB-00543 Major-Vacation of  
Public Easements  
05DRB-00544 Minor-Prelim&Final Plat  
Approval

SURV-TEK INC agent(s) for PETERSON-FOX LLC request(s) the above action(s) for all or a portion of Lot(s) 1-8, Block(s) 41, **TIJERAS PLACE IMPROVEMENT COMPANY INC**, zoned C-2, located on CENTRAL AVE SE, between SAN PEDRO SE and VALENCIA DR SE containing approximately 1 acre(s). [REF: 05DRB00102] (K-18) **VACATIONS WERE APPROVED AS SHOWN ON EXHIBIT B IN THE PLANNING FILE. THE PRELIMINARY PLAT WAS APPROVED WITH FINAL SIGN OFF DELEGATED TO PLANNING OR AGIS DXF FILE AND 15-DAY APPEAL PERIOD.**



4. **Project # 1003757**  
04DRB-01688 Major-Vacation of Pub  
Right-of-Way

ISAACSON & ARFMAN PA agent(s) for DEAN FOODS, DBA CREAMLAND DAIRIES request(s) the above action(s) for **ALVARADO ADDITION**, located on HAINES NW, between 2<sup>ND</sup> ST NW and 3<sup>RD</sup> ST NW containing approximately 1 acre(s). [REF:V-89-87,DRB-89-490] [Deferred from 12/1/04, 12/15, 1/12/05 & 2/9/05 & 3/9/05] (H-14) **VACATION WAS APPROVED AS SHOWN ON EXHIBIT B IN THE PLANNING FILE.**

5. **Project # 1003470**  
04DRB-01523 Major-Preliminary Plat  
Approval  
04DRB-01524 Minor-Temp Defer  
SDWK

WILSON & COMPANY agent(s) for SPS LLC, SCOTT SCHIABOR request(s) the above action(s) for all or a portion of Tract(s) 1A, 2A, 1B & 2B, KASSUBA-MONTBEL LANDS, (to be known as **VISTA VIEJA SUBDIVISION**, zoned R-1 residential zone, located west of 81<sup>ST</sup> ST NW and southwest of ATRISCO NW between 81<sup>ST</sup> ST NW and ALBERICOQUE PL NW containing approximately 152 acre(s). [REF: 04DRB00825, 04DRB01460] [Deferred from 11/3/04, 11/10/04, 12/1/04, 1/12/05 & 2/16/05 & 3/16/05 & 3/30/05 & 4/6/05, 4/20/05] (D-9) **WITH THE SIGNING OF THE INFRASTRUCTURE LIST DATED 4/27/05 AND APPROVAL OF THE GRADING PLAN ENGINEER STAMP DATED 4/26/05 THE PRELIMINARY PLAT WAS APPROVED WITH A CONDITION. TEMPORARY DEFERRAL OF CONSTRUCTION OF SIDEWALKS ON THE INTERIOR STREETS WAS APPROVED AS SHOWN ON EXHIBIT C IN THE PLANNING FILE.**

**SITE DEVELOPMENT PLANS (EPC FINAL SIGN-OFF) AMENDED PLANS AND MASTER DEVELOPMENT PLANS  
(CITY COUNCIL FINAL SIGN-OFF)**

**NOTE: IF THE APPLICANT/AGENT IS NOT PRESENT WHEN THEIR REQUEST IS CALLED, THEN THE REQUEST MAY BE INDEFINITELY DEFERRED ON A NO SHOW.**

6. **Project # 1002457**  
05DRB-00649 Minor-SiteDev Plan  
Subd/EPC

CONSENSUS PLANNING agent(s) for KENNY HINKES, RE/MAX ELITE request(s) the above action(s) for all or a portion of Block(s) 2, Tract(s) X1A & X2A, **GLENWOOD HILLS, UNIT 1**, zoned C-1, located on TRAMWAY BLVD NW, between MONTGOMERY BLVD NW and COMANCHE RD NW containing approximately 3 acre(s). [REF: 03EPC00157, 03EPC00156, 03EPC00180, 05EPC00177, 05EPC00178] **[David Stallworth, EPC Case Planner]** *[Deferred from 4/27/05]* (G-23) **DEFERRED AT THE AGENT'S REQUEST TO 5/11/05.**
  
7. **Project # 1004138**  
05DRB-00667 Minor-SiteDev Plan  
BldPermit

DEKKER/PERICH/SABATINI agent(s) for JCC-ONE LLC request(s) the above action(s) for all or a portion of Tract(s) 5D-1 AND ALBUQUERQUE WELL SITE, **JOURNAL CENTER, TRACT 5**, zoned IP industrial park zone, located on JEFFERSON ST NE, between MASTHEAD NE and SUN NE containing approximately 6 acre(s). [REF:Z-79-80-2,S-80-26] *[Deferred from 4/27/05]* (D-17) **DEFERRED AT THE AGENT'S REQUEST TO 5/11/05.**
  
8. **Project # 1004141**  
05DRB-00670 Minor-SiteDev Plan  
BldPermit

JOHN KLEE agent(s) for CRAIG CORPORATION request(s) the above action(s) for all or a portion of Lot(s) 1, **JOURNAL CENTER, PHASE 2, UNIT 1**, zoned IP, located on WASHINGTON NE, between HAWKINS NE and RUTLEDGE NE containing approximately 1 acre(s). (D-17) **SITE PLAN FOR BUILDING PERMIT WAS APPROVED WITH FINAL SIGN OFF DELEGATED TO PLANNING FOR RESOLUTION OF MINOR COMMENTS.**

9. **Project # 1003865**  
05DRB-00304 Minor-SiteDev Plan  
BldPermit

DORMAN BREEN ARCHITECTS agent(s) for JAY PARKS request(s) the above action(s) for all or a portion of Lot(s) 22A, Block(s) 28, Tract(s) A, NORTH ALBUQUERQUE ACRES, UNIT B, (to be known as **OAKLAND SELF STORAGE**) zoned SU-2 IP, located on OAKLAND AVE NE, between SAN PEDRO NE and LOUISIANA NE containing approximately 4 acre(s). [REF: 05DRB00006] *[Was Indef Deferred 2/23/05 for Plat]* (C-18) **WITH THE SIGNING OF THE INFRASTRUCTURE LIST DATED 4/27/05 AND APPROVAL OF THE GRADING PLAN ENGINEER STAMP DATED 4/9/05 THE SITE PLAN FOR BUILDING PERMIT WAS APPROVED WITH FINAL SIGN OFF DELEGATED TO CITY ENGINEER FOR SIA AND TO PLANNING FOR REMOVAL OF JUNIPERS FROM LANDSCAPE PLAN.**

05DRB-00521 Minor-Prelim&Final Plat  
Approval

FORSTBAUER SURVEYING, LLC agent(s) for PARKS CUSTOM BUILDERS INC request(s) the above action(s) for all or a portion of Lot(s) 11, 12, 21 & 22, Block(s) 28, Tract(s) A, **NORTH ALBUQUERQUE ACRES, UNIT B**, zoned SU-2 IP, located on ALAMEDA BLVD NE, between SAN PEDRO NE and LOUISIANA NE containing approximately 4 acre(s). [REF: 05DRB00006, DRB-99-187, Z-87-42-1] *[Indef Deferred 4/6/05]* (C-18) **WITH THE SIGNING OF THE INFRASTRUCTURE LIST DATED 4/27/05 AND APPROVAL OF THE GRADING PLAN ENGINEER STAMP DATED 4/9/05 THE PRELIMINARY PLAT WAS APPROVED. FINAL PLAT WAS INDEFINITELY DEFERRED FOR THE SIA.**

**10. Project # 1004112**  
05DRB-00603 Minor-SiteDev Plan  
BldPermit

ABQ ENGINEERING agent(s) for BRUCE BESSER request(s) the above action(s) for all or a portion of Lot(s) 1, **MERIDIAN BUSINESS PARK**, zoned IP, located on LOS VOLCANOS RD NW, between SILVER CREEK RD NW and GALLATIN PL NW. [REF: DRB-97-59, Z-92-57] *[Deferred from 4/20/05]* (K-10) **SITE PLAN FOR BUILDING PERMIT WAS APPROVED WITH FINAL SIGN OFF DELEGATED TO PLANNING FOR 3 COPIES OF THE SITE PLAN.**

11. **Project # 1002371**  
05DRB-00560 Minor-SiteDev Plan  
BldPermit/EPC

TIERRA WEST LLC agent(s) for HOFFMANTOWN WEST CHURCH request(s) the above action(s) for all or a portion of Block(s) 15, Tract(s) 1A1, ALBAN HILLS, UNIT 1, (to be known as **HOFFMANTOWN WEST CHURCH**) zoned SU-1 FOR R-2 WITH CHURCH RELATED USES, located on LA ORILLA NW, between COORS BLVD NW and CORRALES DRAIN containing approximately 17 acre(s). [REF:02DRB01824, 03DRB02150] [Elvira Lopez, EPC Case Planner] [Deferred from 4/13/05 & 4/20/05] (D-12) **SITE PLAN FOR BUILDING PERMIT WAS APPROVED WITH FINAL SIGN OFF DELEGATED TO CITY ENGINEER FOR SIA AND PLANNING FOR CASE PLANNERS COMMENTS AND 3 COPIES OF THE SITE PLAN.**

**MINOR PLATS, FINAL (MAJOR) PLATS, AMENDED PLATS AND PLANS**

12. **Project # 1004120**  
05DRB-00622 Minor-Prelim&Final Plat  
Approval

ABQ ENGINEERING INC agent(s) for TRAVIS S THOM request(s) the above action(s) for all or a portion of Lot(s) 30B-2, **ALVARADO GARDENS, UNIT 3**, zoned R-2, located on CANDELARIA RD NW, between RIO GRANDE BLVD NW and GLENWOOD RD NW containing approximately 1 acre(s). (G-12) **PRELIMINARY AND FINAL PLAT WAS APPROVED AND SIGNED OFF BY THE BOARD.**

13. **Project # 1002636**  
05DRB-00372 Minor- Final Plat  
Approval

SURVEYS SOUTHWEST, LTD agent(s) for WAYNE LUJAN request(s) the above action(s) for LOTS 24-A, 24-B, 24-C & 24-D, **RICE'S DURANES ADDITION NO. 1**, zoned R-2, located on RICE AVE NW containing approximately 1 acre(s). [REF: 05DRB-00371] [Deferred from 3/30/05] (H-12) **FINAL PLAT WAS APPROVED WITH FINAL SIGN OFF DELEGATED TO PARKS FOR PARK DEDICATION FEE.**



**NO ACTION IS TAKEN ON THESE CASES:**  
**APPLICANT - AGENT IS REQUIRED TO BE AT THE MEETING**

14. **Project # 1004139**  
05DRB-00668 Minor-Sketch Plat or  
Plan

BRASHER & LORENZ agent(s) for STEVE SLICK request(s) the above action(s) for all or a portion of Lot(s) 27, 28 and 29, Block(s) 17, Tract(s) 1, NORTH ALBUQUERQUE ACRES, UNIT 3, (to be known as **MODESTO SEVEN**) zoned R-D residential and related uses zone, developing area, located on MODESTO AVE NE, between BARSTOW ST NE and VENTURA ST NE containing approximately 3 acre(s). **(B-20) THE ABOVE REQUEST WAS REVIEWED AND COMMENTS WERE GIVEN.**

15. Approval of the Development Review Board Minutes for April 13, 2005. **DRB MINUTES FOR APRIL 13, 2005 WERE APPROVED BY THE BOARD.**

ADJOURNED: 11:55 A.M.



# CITY OF ALBUQUERQUE

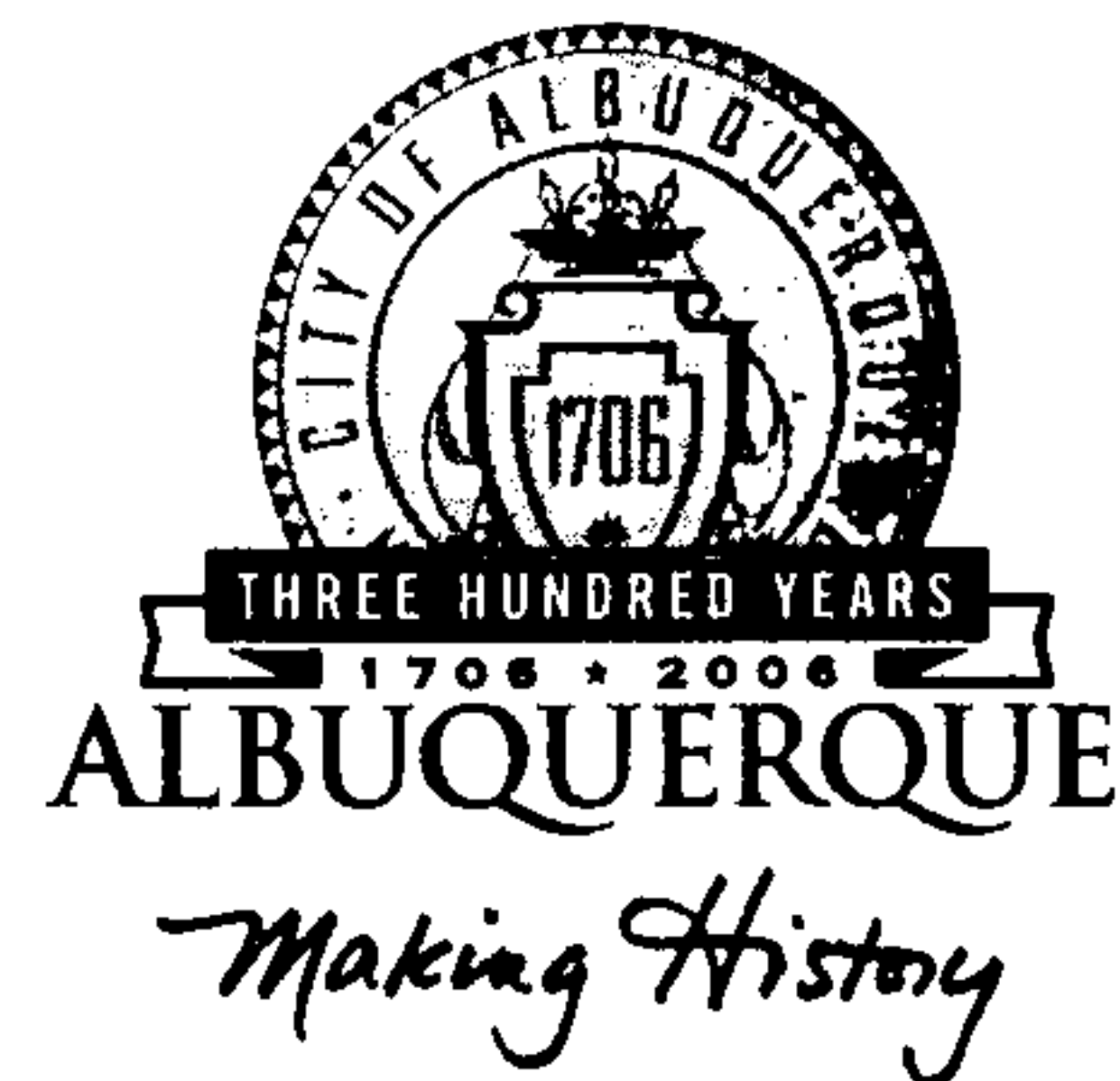

**PLANNING DEPARTMENT  
DEVELOPMENT AND BUILDING SERVICES  
HYDROLOGY DEVELOPMENT SECTION**

DEVELOPMENT REVIEW BOARD--SPEED MEMO

**DRB CASE NO/PROJECT NO: 1004112**

**AGENDA ITEM NO: 10**

**SUBJECT:**

Site Plan for BP

**ACTION REQUESTED:**

REV/CMT:() APP:(x) SIGN-OFF:() EXTN:() AMEND:()

**ENGINEERING COMMENTS:**

No adverse comments.

**RESOLUTION:**

APPROVED \_\_\_\_; DENIED \_\_\_\_; DEFERRED \_\_\_\_; COMMENTS PROVIDED \_\_\_\_; WITHDRAWN

SIGNED-OFF: (SEC-PLN) (SP-SUB) **(SP-BP)** (FP) BY: (UD) (CE) (TRANS) (PKS) (PLNG)

DELEGATED: (SEC-PLN) (SP-SUB) **(SP-BP)** (FP) TO: (UD) (CE) (TRANS) (PKS) **(PLNG)**

FOR:

**SIGNED:** Bradley L. Bingham  
City Engineer/AMAFCA Designee

**DATE:** April 27, 2005

P.O. Box 1293

Albuquerque

New Mexico 87103

www.cabq.gov



2. **Project # 1001674**  
05DRB-00519 Major-One Year SIA

MARK GOODWIN & ASSOCIATES agent(s) for SAPPHIRE DEVELOPMENT request(s) the above action(s) for Parcel H-12A, **RIVERVIEW SUBDIVISION**, zoned R-LT, located on ALL SAINTS NW, between COORS BLVD NW and EAGLE RANCH RD NW containing approximately 33 acre(s). (C-13) **A ONE-YEAR EXTENSION OF THE SIA WAS APPROVED.**

3. **Project # 1001871**  
05DRB-00505 Major-One Year SIA

MARK GOODWIN & ASSOCIATES, PA agent(s) for RANDALL HOMES, LLC request(s) the above action(s) for all or a portion of Lot(s) 28 & 29, Block(s) 12, Tract(s) 1, NORTH ALBUQUERQUE ACRES, UNIT 3, (to be known as **DESERT HIGHLANDS @ LA CUEVA**, zoned R-D 3DU/AC, located on MODESTO AVE NE, between WYOMING BLVD NE and BARSTOW STREET NE containing approximately 2 acre(s). (C-19) **A ONE-YEAR EXTENSION OF THE SIA WAS APPROVED.**

4. **Project # 1000029**  
05DRB-00509 Major-Vacation of  
Public Easements

BOHANNAN HUSTON INC. agent(s) for SAWMILL COMMUNITY LAND AND TRUST request(s) the above action(s) for Lot(s) C and B-1A-1, **DUKE CITY LUMBER ADDITION AND LOT D-1-A OF ARBOLERA DE VIDA PHASE 2**, zoned S-MI, S-DR, located on BELLAMAH ST NW, between 19<sup>TH</sup> ST NW and 18<sup>TH</sup> ST NW containing approximately 25 acre(s). [REF: 03DRB-01785, 03DRB-01786, 04DRB-01650, 04DRB-01651] (H-13) **VACATION WAS APPROVED AS SHOWN ON EXHIBIT B IN THE PLANNING FILE.**

5. **Project # 1004071**  
05DRB-00511 Major-Bulk Land  
Variance  
05DRB-00512 Major-Vacation of  
Public Easements  
05DRB-00513 Minor-Prelim&Final Plat  
Approval

JEFF MORTENSEN & ASSOCIATES agent(s) for ALBUQUERQUE PUBLIC SCHOOLS & NEW MEXICO STATE LAND OFFICE, request(s) the above action(s) for **GOVERNMENT LOTS 1-4, SECTION 16, 11N, R2E AND THE SOUTH 1/2 OF THE SOUTH 1/2 OF SECTION 16, 11N, R2E**, zoned RO-20, located on RAINBOW BLVD NW, between COMPASS DR NW and PETROGLYPH NATIONAL MONUMENT containing approximately 289 acre(s). *[Deferred from 4/20/05]* (C-9) **DEFERRED AT THE AGENT'S REQUEST TO 5/11/05.**

6. **Project # 1004073**  
05DRB-00514 Major-Preliminary Plat  
Approval  
05DRB-00515 Major-Vacation of  
Public Easements  
05DRB-00516 Minor-Subd Design  
(DPM) Variance  
05DRB-00517 Minor-Sidewalk Waiver  
05DRB-00518 Minor-Temp Defer  
SDWK

MARK GOODWIN & ASSOCIATES, PA agent(s) for JTH, LLC request(s) the above action(s) for all or a portion of Lot(s) 5, **JUAN TABO HILLS, UNIT 1**, zoned R-D, located on JUAN TABO BLVD NE, between EUBANK BLVD SE and FOUR HILLS RD SE containing approximately 102 acre(s). *[Deferred from 4/20/05]* (M-21/M-22) **DEFERRED AT THE AGENT'S REQUEST TO 5/18/05.**

7. **Project # 1003236**  
05DRB-00452 Major-Vacation of  
Public Easements  
05DRB-00454 Major-Preliminary Plat  
Approval  
05DRB-00453 Minor-Temp Defer  
SDWK

RIO GRANDE ENGINEERING agent(s) for CLEARBROOK INVESTMENTS INC request(s) the above action(s) for all or a portion of Tract(s) A, VILLA DE LA CHAMISA, UNIT 1, (to be known as **VILLA DE LA CHAMISA, UNIT 2**), zoned SU-1 FOR PRD, located on CALLE CHAMISA NW, between VIVALDI TRAIL NW and BIG SAGE NW containing approximately 6 acre(s). [REF: 04DRB00801, 04DRB00802, 04DRB00799, 04DRB00800, 04DRB00804, 04DRB01739] *[Deferred from 4/13/05]* (B-10) **VACATION WAS APPROVED AS SHOWN ON EXHIBIT C IN THE PLANNING FILE. WITH THE**



SIGNING OF THE INFRASTRUCTURE LIST DATED 4/20/05 AND APPROVAL OF THE GRADING PLAN ENGINEER STAMP DATED 5/7/04 THE PRELIMINARY PLAT WAS APPROVED WITH CONDITION OF FINAL PLAT: THE LOT NUMBERS NEED TO MATCH THE APPROVED SITE PLAN. THE TEMPORARY DEFERRAL OF CONSTRUCTION OF SIDEWALKS ON THE INTERIOR STREETS WAS APPROVED AS SHOWN ON EXHIBIT B IN THE PLANNING FILE.

8. **Project # 1000692**  
05DRB-00407 Major-SiteDev Plan  
BldPermit

BDA ARCHITECTS agent(s) for SIVAD ENTERPRISES request(s) the above action(s) for all or a portion of Tract(s) A1A, Block(s) 1, **BEAR CANYON VILLAGE, UNIT 2**, zoned SU-1 FOR C-1, located on Burlison NE & Wyoming NE between San Antonio NE and Academy NE containing approximately 5 acre(s). [Deferred from 4/6/05 & 4/20/05] (E-19) **DEFERRED AT THE AGENT'S REQUEST TO 5/11/05.**

9. **Project # 1003470**  
04DRB-01522 Major-Bulk Land  
Variance  
04DRB-01523 Major-Preliminary Plat  
Approval  
04DRB-01524 Minor-Temp Defer  
SDWK

WILSON & COMPANY agent(s) for SPS LLC, SCOTT SCHIABOR request(s) the above action(s) for all or a portion of Tract(s) 1A, 2A, 1B & 2B, **KASSUBA-MONTBEL LANDS**, (to be known as **VISTA VIEJA SUBDIVISION**), zoned R-1 residential zone, located west of 81<sup>ST</sup> ST NW and southwest of ATRISCO NW between 81<sup>ST</sup> ST NW and ALBERICOQUE PL NW containing approximately 152 acre(s). [REF: 04DRB00825, 04DRB01460] [Deferred from 11/3/04, 11/10/04, 12/1/04, 1/12/05 & 2/16/05 & 3/16/05 & 3/30/05 & 4/6/05] (D-9) **BULK LAND VARIANCE WAS APPROVED. PRELIMINARY PLAT WAS DEFERRED TO 4/27/05. TEMPORARY DEFERRAL OF SIDEWALKS WAS DEFERRED TO 4/27/05.**

05DRB-00609 Minor-Prelim&Final Plat  
Approval

WILSON & COMPANY agent(s) for SPS LLC, SCOTT SCHIABOR request(s) the above action(s) for all or a portion of Tract(s) 1A, 1B, 2A and 2B, KASSUBA-MONTBEL LANDS, (to be known as **VISTA VIEJA SUBDIVISION**, zoned R-1 residential zone, located on 81<sup>ST</sup> ST NW, between ALBERICOQUE PL NW and SCENIC RD NW containing approximately 159 acre(s). [REF: 04DRB01522, 04DRB01523, 04DRB01524] (D-9) **PRELIMINARY AND FINAL PLAT WERE APPROVED AND SIGNED OFF BY THE BOARD.**

**SITE DEVELOPMENT PLANS (EPC FINAL SIGN-OFF) AMENDED PLANS AND MASTER DEVELOPMENT PLANS (CITY COUNCIL FINAL SIGN-OFF)**

NOTE: IF THE APPLICANT/AGENT IS NOT PRESENT WHEN THEIR REQUEST IS CALLED, THEN THE REQUEST MAY BE INDEFINITELY DEFERRED ON A NO SHOW.

10. **Project # 1003872**  
05DRB-00604 Minor-SiteDev Plan  
BldPermit/EPC

SITES SOUTHWEST agent(s) for CITY OF ALBUQUERQUE WATER UTILITY request(s) the above action(s) for all or a portion of Tract(s) B, **SUNPORT MUNICIPAL ADDITION**, zoned SU-1 GOLF COURSE AND RELATED FACILITIES, located on SAN JOAQUIN SE, between GIRARD SE and WELLESLEY SE containing approximately 2 acre(s). [REF: 05EPC-00023, ZA-77-219] [Stephanie Shumsky, EPC Case Planner] (L-16) **SITE PLAN FOR BUILDING PERMIT WERE APPROVED WITH FINAL SIGN OFF DELEGATED TO PLANNING FOR EPC CASE PLANNER'S INITIALS.**

11. **Project # 1004112**  
#05DRB-00603 Minor-SiteDev Plan  
BldPermit

ABQ ENGINEERING agent(s) for BRUCE BESSER request(s) the above action(s) for all or a portion of Lot(s) 1, **MERIDIAN BUSINESS PARK**, zoned IP, located on LOS VOLCANOS RD NW, between SILVER CREEK RD NW and GALLATIN PL NW. [REF: DRB-97-59, Z-92-57] [Deferred from 4/20/05] (K-10) **DEFERRED AT THE AGENT'S REQUEST TO 4/27/05.**

12. **Project # 1004090**  
05DRB-00608 Minor-SiteDev Plan  
BldPermit

JLS ARCHITECTS agent(s) for JIM HAKEEM request(s) the above action(s) for all or a portion of Lot(s) 1, Block(s) 17, Tract(s) 2, **NORTH ALBUQUERQUE ACRES, UNIT 3**, zoned R-D residential and related uses zone, developing area, located on WYOMING NE and CORONA AVE NE containing approximately 2 acre(s). [REF: 05DRB00559] (C-19) **SITE PLAN FOR BUILDING PERMIT WAS APPROVED WITH FINAL SIGN OFF DELEGATED TO TRANSPORTATION DEVELOPMENT FOR MINOR CORRECTIONS.**

13. **Project # 1003360**  
05DRB-00623 Minor-SiteDev Plan  
BldPermit/EPC

CHERRY/SEE ARCHITECTS agent(s) for CITY OF ALBUQUERQUE, COMMUNITY & FAMILY SERVICES request(s) the above action(s) for all or a portion of Tract(s) A, **JOHN ADAMS MULTIPURPOSE CENTER**, zoned SU-1 FOR CENTER/PARK, located on GLENRIO RD NW, between 56<sup>TH</sup> ST NW and LOMA HERMOSA DR NW containing approximately 4 acre(s). [REF: 04EPC00487, 04EPC00486] [Russell Brito for Debbie Stover, EPC Case Planner] (J-11) **SITE PLAN FOR BUILDING PERMIT WAS APPROVED WITH FINAL SIGN OFF DELEGATED TO TRANSPORTATION DEVELOPMENT FOR MINOR COMMENTS AND TO PLANNING FOR EPC CASE PLANNER'S INITIALS.**

14. **Project # 1002371**  
05DRB-00560 Minor-SiteDev Plan  
BldPermit/EPC

TIERRA WEST LLC agent(s) for HOFFMANTOWN WEST CHURCH request(s) the above action(s) for all or a portion of Block(s) 15, Tract(s) 1A1, ALBAN HILLS, UNIT 1, (to be known as **HOFFMANTOWN WEST CHURCH**) zoned SU-1 FOR R-2 WITH CHURCH RELATED USES, located on LA ORILLA

NW, between COORS BLVD NW and CORRALES DRAIN containing approximately 17 acre(s). [REF:02DRB01824, 03DRB02150] [Elvira Lopez, EPC Case Planner] [Deferred from 4/13/05 & 4/20/05] (D-12) DEFERRED AT THE AGENT'S REQUEST TO 4/27/05.

15. **Project # 1000163**  
05DRB-00554 Minor-SiteDev Plan  
BldPermit/EPC

SANDERS & ASSOCIATES ARCHITECTS agent(s) for DR. AND MRS. ERNESTO GARZA request(s) the above action(s) for all or a portion of Tract(s) E, LA CUEVA VILLAGE, zoned C-2 (SC), located on CARMEL AVE NE, between WYOMING BLVD NE and BARSTOW NE containing approximately 1 acre(s). [REF: 04EPC-01828] [Elvira Lopez, EPC Case Planner] [Deferred from 4/13/05] (C-19) SITE PLAN FOR BUILDING PERMIT WAS APPROVED AND SIGNED OFF BY THE BOARD.

16. **Project # 1001932**  
05DRB-00523 Minor-SiteDev Plan  
BldPermit/EPC

CLAUDIO VIGIL ARCHITECTS agent(s) for PAUL HEDGES request(s) the above action(s) for all or a portion of Tract(s) C, WEST RIDGE, UNIT 1, (to be known as GUARDIAN SELF STORAGE) zoned SU-1 FOR C-1 AND IP USES, located at the southeast corner of OURAY RD NW and TWIN OAKS DR NW, containing approximately 4 acre(s). [REF: AX-80-18, Z-80-87, 04EPC01718] [David Stallworth, EPC Case Planner] [Deferred from 4/6/05] (G-10) SITE PLAN FOR BUILDING PERMIT WAS APPROVED AND SIGNED OFF BY THE BOARD.



17. **Project # 1003231**  
05DRB-00588 Major-Final Plat  
Approval

WILSON & COMPANY agent(s) for LONGFORD @ ARROWWOOD, LLC request(s) the above action(s) for all or a portion of Tract(s) 30A-1, **LANDS OF SALAZAR/QUATRO/JSJ/HANNETT**, zoned RLT, located on 98<sup>TH</sup> STREET SW, between RIO BRAVO SW and BLAKE SW containing approximately 30 acre(s). [REF: 04DRB00263, 05DRB00483, 05DRB00484, 5DRB00485, 05DRB00389, 05DRB00390] (N-9) **FINAL PLAT WAS APPROVED AND SIGNED OFF BY THE BOARD.**

18. **Project # 1003471**  
05DRB-00595 Minor-Final Plat  
Approval

SURV-TEK, INC agent(s) for CURB WEST, INC request(s) the above action(s) for all or a portion of Tract(s) B-2-A, **SEVILLE SUBDIVISION**, zoned R-1, located on SEGOVIA NW east of KAYENTA NW and containing approximately 24 acre(s). [REF: 04DRB00826, 008A27, 04DRB01224, 01225, 04DRB01948, 01949, 05DRB00083, 00084] (A-10) **FINAL PLAT WAS APPROVED WITH FINAL SIGN OFF DELEGATED TO CITY ENGINEER FOR AMAFCA'S SIGNATURE.**

19. **Project # 1002196**  
05DRB-00610 Major-Final Plat  
Approval

WAYJOHN SURVEYING INC agent(s) for DRAGONFLY DEVELOPMENT INC request(s) the above action(s) for all or a portion of Tract(s) 1-B, TOWN OF ATRISCO GRANT, (to be known as **LOS ANTEPASADOS, UNIT 6**) zoned SU-1 FOR MH PARK, located on SUNSET GARDENS RD SW, between CORRIGEDOR SW and FOOTHILL SW containing approximately 6 acre(s). [REF: DRB-91-385, 02EPC01356, 03EPC02048, 04CC00130, 04DRB00873, 04DRB00875, 04DRB00877] (K-11) **FINAL PLAT WAS APPROVED WITH FINAL SIGN OFF DELEGATED TO PARKS FOR CASH-IN-LIEU**

AND PLANNING FOR ENVIRONMENTAL HEALTH SIGNATURE, A NOTE ON THE PLAT: MAINTENANCE AND REPAIR EASEMENTS SHOWN ON FINAL PLAT FOR ZERO LOT LINES AND FOR QWEST SIGNATURES.

20. **Project # 1003762**  
05DRB-00611 Minor-Prelim&Final Plat  
Approval

JEFF MORTENSEN & ASSOCIATES agent(s) for ALBUQUERQUE PUBLIC SCHOOLS REAL ESTATE OFFICE request(s) the above action(s) for all or a portion of Block(s) 11, Tract(s) K, **PANORAMA HEIGHTS**, zoned R-1 residential zone, located on CONSTITUTION AVE NE, between CHELWOOD PARK BLVD NE and INDIAN SCHOOL RD NE containing approximately 18 acre(s). [REF: 04EPC01714, 05DRB00316] (J-22) **PRELIMINARY PLAT WAS APPROVED WITH FINAL SIGN OFF DELEGATED TO PLANNING FOR AGIS DXF FILE.**

21. **Project # 1004104**  
05DRB-00592 Minor-Prelim&Final Plat  
Approval

SURVEYS SOUTHWEST LTD agent(s) for KEN & PATRICIA MAESTAS request(s) the above action(s) for all or a portion of Lot(s) 2 & 3, **MAESTAS SUBDIVISION**, zoned R-1, located on LOS POBLANOS LN NW, between GUADALUPE TR NW and SANDIA RD NW containing approximately 1 acre(s). [REF: Z-86-23, AX-86-3, DRB-86-623] (F-14) **PRELIMINARY AND FINAL PLAT APPROVED AND SIGNED OFF BY THE BOARD.**

22. **Project # 1003694**  
05DRB-00613 Minor-Prelim&Final Plat  
Approval  
05DRB-00614 Minor-Subd Design  
(DPM) Variance

CHRISTOPHER CALOTT request(s) the above action(s) for all or a portion of Lot(s) BB, **ALVARADO GARDENS NO. 2**, zoned RA-2 W7, located on CAMPBELL RD NW, between GLENWOOD NW and TRELIS DR NW containing approximately 1 acre(s). [REF: 04DRB01485] (G-12) **PRELIMINARY PLAT WAS APPROVED WITH FINAL SIGN OFF DELEGATED TO PARKS FOR CASH-IN-LIEU AND PLANNING FOR AGIS DXF FILE. THE SUBDIVISION DESIGN VARIANCE WAS APPROVED AS SHOWN ON EXHIBIT D IN THE PLANNING FILE.**

23. **Project # 1002778**  
05DRB-00606 Minor-Prelim&Final Plat  
Approval

BOHANNAN HUSTON INC agent(s) for VENTANA WEST LLC request(s) the above action(s) for all or a portion of Tract(s) D-1 & D-2, **VENTANA RANCH WEST**, zoned R-LT residential zone, located on VENTANA WEST PARKWAY NW, between VENTANA RIDGE RD NW and PASEO DEL NORTE BLVD NW containing approximately 4 acre(s). [REF: 04DRB00126, 00127, 00128, 03EPC01057, 01058] (B-8/B-9) **PRELIMINARY PLAT APPROVED WITH FINAL SIGN OFF DELEGATED TO PLANNING FOR AGIS DXF FILE.**

24. **Project # 1002459**  
05DRB-00616 Minor-Prelim&Final Plat  
Approval  
05DRB-00615 Minor-Vacation of  
Private Easements

TIERRA WEST LLC agent(s) for QUAIL RIDGE LLC request(s) the above action(s) for all or a portion of Tract(s) 1, 3, 4, 5, **QUAIL RIDGE**, zoned C-2 (SC), located on COORS BLVD NW, between OURAY RD NW and QUAIL RD NW containing approximately 4 acre(s). [REF: 03EPC00159, 03EPC00160, 4AA00871] (H-11) **PRELIMINARY PLAT WAS APPROVED WITH FINAL SIGN OFF DELEGATED TO PLANNING FOR A COPY OF THE APPROVED AA SHOWING NEW LOT LINES. THE VACATION OF PRIVATE EASEMENTS WAS APPROVED AS SHOWN ON EXHIBIT B IN THE PLANNING FILE.**

25. **Project # 1004061**  
05DRB-00499 Minor-Prelim&Final Plat  
Approval

PRECISION SURVEYS INC agent(s) for CONNIE & ZACK LOVELADY, CZ ENTERPRISES request(s) the above action(s) for all or a portion of Lot(s) 25, **ALVARADO GARDENS, UNIT 1**, zoned RA-2, located on MATTHEW AVE NW and MEADOW VIEW DR NW and containing approximately 1 acre(s). *[Deferred from 3/30/05 & 4/13/05]* (G-13) **INDEFINITELY DEFERRED AT THE AGENT'S REQUEST.**

26. **Project # 1001409**  
05DRB-00531 Minor-Prelim&Final Plat  
Approval

ADVANCED ENGINEERING & CONSULTING agent(s) for SAIFI TALEBREZA request(s) the above action(s) for all or a portion of Lot(s) 20-A, Block(s) 1, **CANDELIGHT FOOTHILLS, UNIT 1**, zoned R-1, located on LOMAS BLVD NE, between MONTE LARGO DR NE and SUMMIT HILLS DR NE containing approximately 2 acre(s). [REF: 01DRB01160, 01DRB01819, 02DRB01863, 03DRB02032, 04DRB01425] *[Deferred from 4/6/05 & 4/13/05]* (J-23) **WITH THE SIGNING OF THE INFRASTRUCTURE LIST DATED 4/20/05 AND APPROVAL OF THE GRADING PLAN ENGINEER STAMP DATED 4/19/05 THE PRELIMINARY PLAT WAS APPROVED WITH THE CONDITION: NEED TO INCLUDE THE DESCRIPTION OF THE PUBLIC UTILITY EASEMENT (PUE). FINAL PLAT WAS INDEFINITELY DEFERRED FOR THE SIA.**

27. **Project # 1003554**  
05DRB-00530 Minor-Prelim&Final Plat  
Approval

TIERRA WEST LLC agent(s) for AMC DEVELOPMENT INC request(s) the above action(s) for all or a portion of Lot(s) 1-8, Block(s) 9 and Lot(s) 2-9, Block(s) 8, **SKYLINE HEIGHTS, (to be known as CENTRAL PARK PLACE, PHASE 1)** zoned C-2, located on CENTRAL AVE SE, between CONCHAS ST SE and EUBANK BLVD SE containing approximately 4 acre(s). [REF: ZA-88-406, 04DRB01099, 04DRB01100] *[Deferred from 4/6/05]* (L-20) **WITH THE SIGNING OF THE INFRASTRUCTURE LIST DATED 4/20/05 THE PRELIMINARY PLAT WAS APPROVED. FINAL PLAT WAS INDEFINITELY DEFERRED FOR THE SIA.**



28. **Project # 1002247**  
04DRB-00890 Minor-Final Plat  
Approval

BOHANNAN HUSTON, INC agent(s) for HUNT UPTOWN, LLC request(s) the above action(s) for all or a portion of Tract(s) A, **ALBUQUERQUE UPTOWN SITE, ST. PIUS X SUBDIVISION**, zoned SU-3 special center zone, located on INDIAN SCHOOL RD NE, between LOUISIANA BLVD NE and ESPANOLA ST NE containing approximately 18 acre(s). [REF: 1001164, 04DRB-00830] *(Deferred from 6/16/04)[Final Plat Indef Deferred 6/23/04 for SIA]* (H-19) **FINAL PLAT WAS APPROVED WITH FINAL SIGN OFF DELEGATED TO CITY ENGINEER FOR RECORDING OF PAPER EASEMENT AND TRANSPORTATION DEVELOPMENT FOR SIDEWALK EASEMENTS WITH EXHIBIT AND AGIS DXF FILE.**

**NO ACTION IS TAKEN ON THESE CASES:**  
**APPLICANT - AGENT IS REQUIRED TO BE AT THE MEETING**

29. **Project # 1004110**  
05DRB-00601 Minor-Sketch Plat or Plan

Alexander and Donette Garcia, request(s) the above action(s) for all or a portion of Tract(s) 108-D, **M.R.G.C.D. MAP 31**, zoned RA-2, located on RIO GRANDE BLVD NW, between ELFEGO RD NW and MANUEL TORRES LN NW containing approximately 1 acre(s). (F-13) **THE ABOVE REQUEST WAS REVIEWED AND COMMENTS WERE GIVEN.**

30. Approval of the Development Review Board Minutes for Month April 6, 2005. **DRB MINUTES FOR APRIL 6, 2005 WERE APPROVED BY THE BOARD.**

ADJOURNED: 11:55 A.M.

# CITY OF ALBUQUERQUE

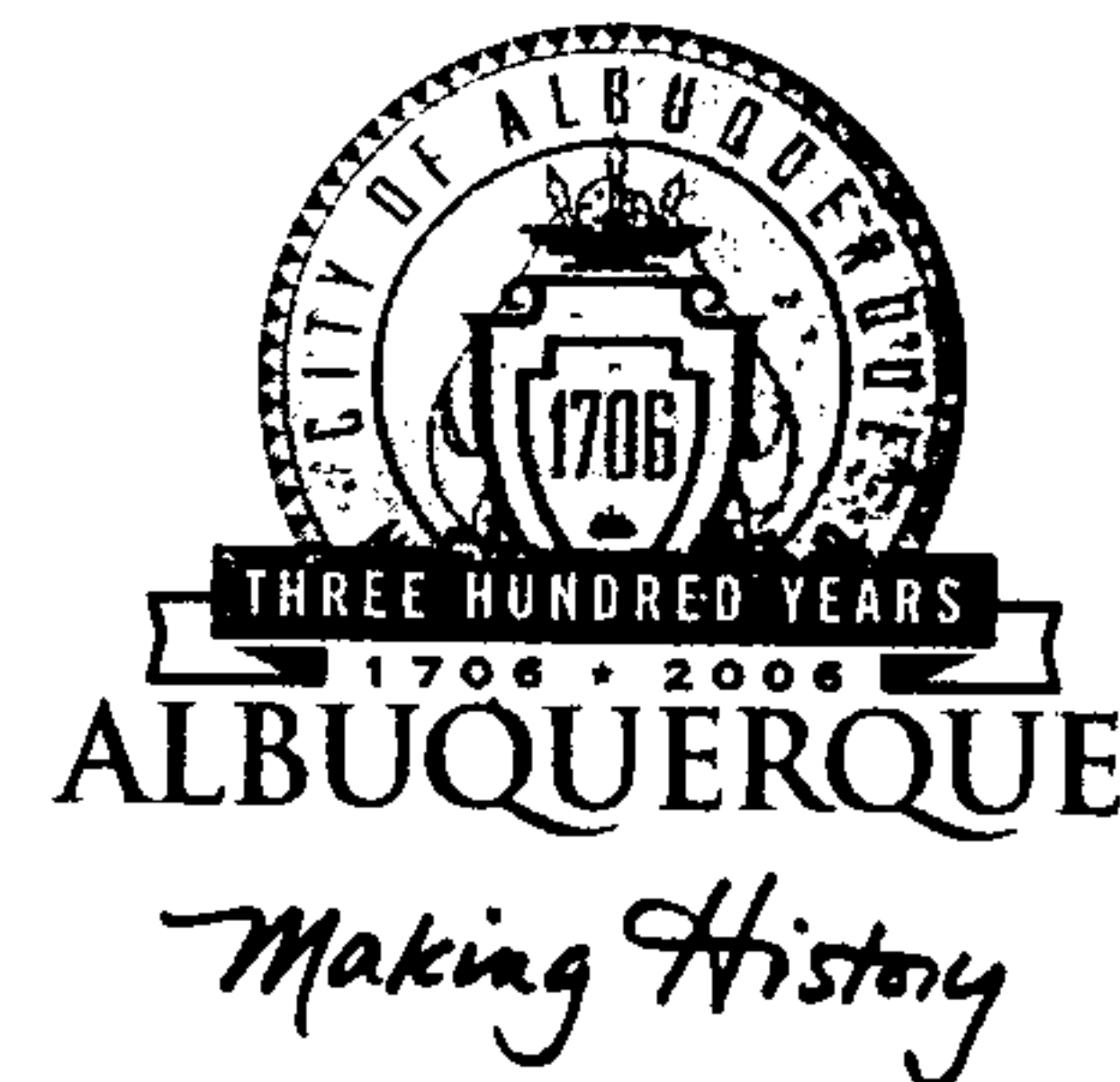

**PLANNING DEPARTMENT  
DEVELOPMENT AND BUILDING SERVICES  
HYDROLOGY DEVELOPMENT SECTION**

**DEVELOPMENT REVIEW BOARD--SPEED MEMO**

**DRB CASE NO/PROJECT NO: 1004112**

**AGENDA ITEM NO: 11**

**SUBJECT:**

Site Plan for BP

**ACTION REQUESTED:**

AMEND

**ENGINEERING COMMENTS:**

No adverse comments.

P.O. Box 1293

Albuquerque

New Mexico 87103

www.cabq.gov

**RESOLUTION:**

APPROVED \_\_\_\_; DENIED \_\_\_\_; DEFERRED X; COMMENTS PROVIDED \_\_\_\_; WITHDRAWN

SIGNED-OFF: (SEC-PLN) (SP-SUB) (SP-BP) (FP) BY: (UD) (CE) (TRANS) (PKS) (PLNG)

DELEGATED: (SEC-PLN) (SP-SUB) (SP-BP) (FP) TO: (UD) (CE) (TRANS) (PKS) (PLNG)

FOR:

**SIGNED:** Bradley L. Bingham  
City Engineer/AMAFCA Designee

**DATE:** April 20, 2005

4-27-05

**CITY OF ALBUQUERQUE  
PLANNING DEPARTMENT**

**April 20, 2005  
DRB Comments**

**ITEM # 11**

**PROJECT # 1004112**

**APPLICATION # 05-00603**

**RE: Meridian Business Park/ minor SDPBP**

No objections to this request.

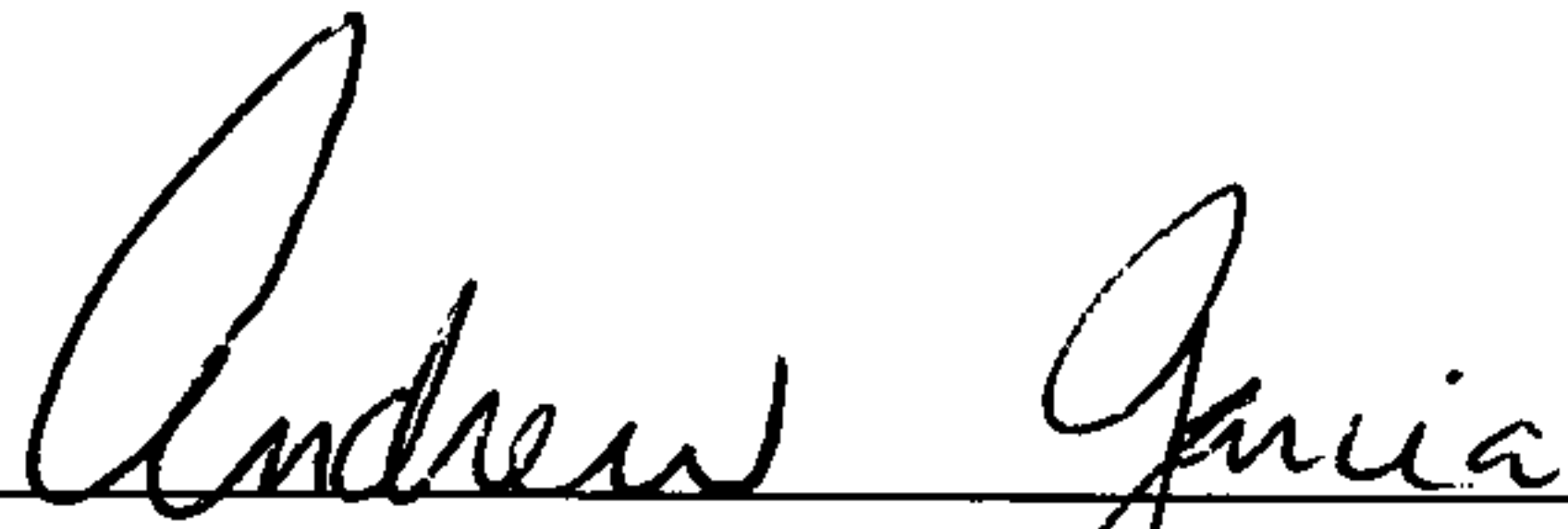

---

Andrew Garcia, Planning Alternate  
924-3895 Fax 924-3864 agarcia@cabq.gov



ONE STOP SHOP  
CITY OF ALBUQUERQUE PLANNING DEPARTMENT  
Development & Building Services

PAID RECEIPT

APPLICANT NAME \_\_\_\_\_  
AGENT ABQ  
ADDRESS \_\_\_\_\_  
PROJECT & APP # 1004121  
PROJECT NAME Merridian Business Park

\$ \_\_\_\_\_ 441032/3424000 Conflict Management Fee  
\$ \_\_\_\_\_ 441006/4983000 DRB Actions  
\$ 50.00 441006/4971000 EPC/AA/LUCC Actions & All Appeals *deferral fee*  
\$ \_\_\_\_\_ 441018/4971000 Public Notification  
\$ \_\_\_\_\_ 441006/4983000 DRAINAGE PLAN REVIEW OR TRAFFIC IMPACT STUDY\*\*\*  
( ) Major/Minor Subdivision ( ) Site Development Plan ( ) Bldg Permit  
( ) Letter of Map Revision ( ) Conditional Letter of Map Revision  
( ) Traffic Impact Study  
\$ 50.00 TOTAL AMOUNT DUE

\*\*\*NOTE: If a subsequent submittal is required, bring a copy of this paid receipt with you to avoid an additional charge.

ORIGINAL CHECK HAS A COLORED BACKGROUND PRINTED ON CHEMICAL REACTIVE PAPER - SEE BACK FOR DETAILS

ABQ ENGINEERING, INC.

6739 ACADEMY RD., NE SUITE 130

ALBUQUERQUE, NM 87109

(505) 255-7802

WELLS FARGO BANK NEW MEXICO, N.A.

ALBUQUERQUE, NM 87110

95-219

1070 130

005011

PAY TO THE ORDER OF

CITY OF ALBUQU

City of Albuquerque  
Treasury Division

50.00

*Fifty and 00/100*

4/25/2005 11:05AM LUC-ANNX DOLLARS

RECEIPT# 00041221 WS# 007 TRNSH# 0011

Account 441006 Fund 0110

Activity 4971000 TRSL JS

Trans Amt *New Bid* \$50.00

J24 Misc \$50.00

MEMO 25039 ONB DEF FEE

CK AUTHORIZED SIGNATURE \$0.00

CHANGE \$0.00

005011 1070021921060211246

Thank You



# City of Albuquerque



## DEVELOPMENT/ PLAN REVIEW APPLICATION

Supplemental form

**SUBDIVISION**

- Major Subdivision action
- Minor Subdivision action
- Vacation
- Variance (Non-Zoning)

**SITE DEVELOPMENT PLAN**

- for Subdivision Purposes
- for Building Permit
- IP Master Development Plan
- Cert. of Appropriateness (LUCC)

**STORM DRAINAGE**

- Storm Drainage Cost Allocation Plan

**S Z ZONING & PLANNING**

- Annexation
- County Submittal
- EPC Submittal
- Zone Map Amendment (Establish or Change Zoning)
- Sector Plan (Phase I, II, III)
- Amendment to Sector, Area, Facility or Comprehensive Plan
- Text Amendment (Zoning Code/Sub Regs)
- Street Name Change (Local & Collector)
- L A APPEAL / PROTEST of...**
- D** Decision by: DRB, EPC, LUCC, Planning Director or Staff, ZHE, Zoning Board of Appeals

PRINT OR TYPE IN BLACK INK ONLY. The applicant or agent must submit the completed application in person to the Planning Department Development Services Center, 600 2<sup>nd</sup> Street NW, Albuquerque, NM 87102. Fees must be paid at the time of application. Refer to supplemental forms for submittal requirements.

**APPLICANT INFORMATION:**

NAME: BRUCE BESSER PHONE: \_\_\_\_\_  
 ADDRESS: 550 SILVER CREEK RD NW FAX: \_\_\_\_\_  
 CITY: ALBUQUERQUE STATE NM ZIP 87 E-MAIL: \_\_\_\_\_  
 Proprietary interest in site: OWNER List all owners: BRUCE BESSER  
 AGENT (if any): ABQ ENGINEERING PHONE: 255-7802  
 ADDRESS: 6739 ACADEMY RD NE #130 FAX: 255-7902  
 CITY: ALBUQUERQUE STATE NM ZIP 87112 E-MAIL: mygarcia@abqeng.com

DESCRIPTION OF REQUEST: AMENDED SITE PLAN FOR BUILDING EXPANSION

Is the applicant seeking incentives pursuant to the Family Housing Development Program?  Yes.  No.

**SITE INFORMATION: ACCURACY OF THE LEGAL DESCRIPTION IS CRUCIAL! ATTACH A SEPARATE SHEET IF NECESSARY.**

Lot or Tract No. LOT 1 Block: \_\_\_\_\_ Unit: \_\_\_\_\_  
 Subdiv. / Addn. MERIDIAN BUSINESS PARK  
 Current Zoning: IP Proposed zoning: \_\_\_\_\_  
 Zone Atlas page(s): K-10 No. of existing lots: 1 No. of proposed lots: \_\_\_\_\_  
 Total area of site (acres): \_\_\_\_\_ Density if applicable: dwellings per gross acre: \_\_\_\_\_ dwellings per net acre: \_\_\_\_\_  
 Within city limits?  Yes. No , but site is within 5 miles of the city limits.) Within 1000FT of a landfill? NO  
 UPC No. 101005708350020505 MRGCD Map No. \_\_\_\_\_  
 LOCATION OF PROPERTY BY STREETS: On or Near: LOS VOLCANOS RD  
 Between: SILVER CREEK RD and GALLATIN PL

**CASE HISTORY:**

List any current or prior case number that may be relevant to your application (Proj., App., DRB-, AX, Z, V, S, etc.): \_\_\_\_\_

DRB-97-59 292-57

Check-off if project was previously reviewed by Sketch Plat/Plan , or Pre-application Review Team . Date of review: \_\_\_\_\_

SIGNATURE [Signature] DATE 7 APR 05  
 (Print) FRANCIS PHILLIPS \_\_\_\_\_ Applicant  Agent

**FOR OFFICIAL USE ONLY**

Form revised 4/04

- INTERNAL ROUTING
- All checklists are complete
- All fees have been collected
- All case #'s are assigned
- AGIS copy has been sent
- Case history #'s are listed
- Site is within 1000ft of a landfill
- F.H.D.P. density bonus
- F.H.D.P. fee rebate

Application case numbers	Action	S.F.	Fees
<u>05DRB -00603</u>	<u>ASBP</u>	<u>PL3</u>	<u>\$ 50.00</u>
_____	_____	_____	<u>\$ 20.00</u>
_____	_____	_____	\$ _____
_____	_____	_____	\$ _____
_____	_____	_____	\$ _____
Total			<u>\$ 70.00</u>

Hearing date 4-20-05

[Signature] 4-12-05  
 Planner signature / date

Project # 1004112



**FORM P(3): SITE PLAN REVIEW - D.R.B. MEETING (UNADVERTISED)**

**SKETCH PLAN REVIEW AND COMMENT**

- \_\_\_ Scaled site sketch and related drawings showing proposed land use including structures, parking, Bldg. setbacks, adjacent rights-of-way and street improvements, etc. (folded to fit into an 8.5" by 14" pocket) **6** copies.
  - \_\_\_ Zone Atlas map with the entire property(ies) precisely and clearly outlined and crosshatched (to be photocopied)
  - \_\_\_ Letter briefly describing, explaining, and justifying the request
  - \_\_\_ Any original and/or related file numbers are listed on the cover application
- Meetings are approximately 8 DAYS after the Tuesday noon filing deadline. **Your attendance is required.**

**SITE DEVELOPMENT PLAN FOR SUBDIVISION**

- \_\_\_ Scaled site plan and related drawings (folded to fit into an 8.5" by 14" pocket) **6** copies.
  - \_\_\_ Zone Atlas map with the entire property(ies) precisely and clearly outlined and crosshatched (to be photocopied)
  - \_\_\_ Letter briefly describing, explaining, and justifying the request
  - \_\_\_ Letter of authorization from the property owner if application is submitted by an agent
  - \_\_\_ Copy of the document delegating approval authority to the DRB
  - \_\_\_ Infrastructure List, if relevant to the site plan
  - \_\_\_ Fee (see schedule)
  - \_\_\_ Any original and/or related file numbers are listed on the cover application
- Meetings are approximately 8 DAYS after the Tuesday noon filing deadline. **Bring the original Mylar to the meeting for sign-off. Your attendance is required.**

**SITE DEVELOPMENT PLAN FOR BUILDING PERMIT**

- \_\_\_ Site plan and related drawings (folded to fit into an 8.5" by 14" pocket) **6** copies.
  - \_\_\_ Site Plan for Subdivision, if applicable, previously approved or simultaneously submitted. **6** copies.
  - \_\_\_ Solid Waste Management Department signature on Site Plan
  - \_\_\_ Zone Atlas map with the entire property(ies) precisely and clearly outlined and crosshatched (to be photocopied)
  - \_\_\_ Letter briefly describing, explaining, and justifying the request
  - \_\_\_ Letter of authorization from the property owner if application is submitted by an agent
  - \_\_\_ Copy of the document delegating approval authority to the DRB
  - \_\_\_ Infrastructure List, if relevant to the site plan
  - \_\_\_ Completed Site Plan for Building Permit Checklist
  - \_\_\_ Blue-line copy of Site Plan with Fire Marshal's stamp
  - \_\_\_ Fee (see schedule)
  - \_\_\_ Any original and/or related file numbers are listed on the cover application
- Meetings are approximately 8 DAYS after the Tuesday noon filing deadline. **Bring the original Mylar to the meeting for sign-off. Your attendance is required.**

**AMENDED SITE DEVELOPMENT PLAN FOR SUBDIVISION**

**AMENDED SITE DEVELOPMENT PLAN FOR BUILDING PERMIT**

- Proposed amended Site Plan (folded to fit into an 8.5" by 14" pocket) **6** copies.
  - DRB signed Site Plan being amended (folded to fit into an 8.5" by 14" pocket) Copies as needed above
  - Zone Atlas map with the entire property(ies) precisely and clearly outlined and crosshatched (to be photocopied)
  - Letter briefly describing, explaining, and justifying the request
  - Letter of authorization from the property owner if application is submitted by an agent
  - Infrastructure List, if relevant to the site plan
  - Completed Site Plan for Building Permit Checklist (not required for amendment of SDP for Subdivision)
  - Fee (see schedule)
  - \_\_\_ Any original and/or related file numbers are listed on the cover application
- Meetings are approximately 8 DAYS after the Tuesday noon filing deadline. **Bring the original Mylar to the meeting for sign-off. Your attendance is required.**

**D.R.B. FINAL SIGN-OFF FOR E.P.C. APPROVED S.D.P. for SUBDIVISION**

**D.R.B. FINAL SIGN-OFF FOR E.P.C. APPROVED S.D.P. for BUILDING PERMIT**

- \_\_\_ Site plan and related drawings (folded to fit into an 8.5" by 14" pocket) **6** copies.
  - \_\_\_ Approved Grading and Drainage Plan (folded to fit into an 8.5" by 14" pocket) **6** copies.
  - \_\_\_ Solid Waste Management Department signature on Site Plan (not required for SDP for Subdivision)
  - \_\_\_ Zone Atlas map with the entire property(ies) precisely and clearly outlined and crosshatched (to be photocopied)
  - \_\_\_ Letter carefully explaining how each EPC condition has been met and a copy of the EPC Notification of Decision
  - \_\_\_ Infrastructure List, if relevant to the site plan
  - \_\_\_ Blue-line copy of Site Plan with Fire Marshal's stamp (not required for SDP for Subdivision)
  - \_\_\_ Any original and/or related file numbers are listed on the cover application
- Meetings are approximately 8 DAYS after the Tuesday noon filing deadline. **Bring the original Mylar to the meeting for sign-off. Your attendance is required.**

I, the applicant, acknowledge that any information required but not submitted with this application will likely result in deferral of actions.

FRANCIS PHILIPS

Applicant name (print)

[Signature]

Applicant signature / date

7 APR 05



Form revised October 2004

- Checklists complete
- Fees collected
- Case #s assigned
- Related #s listed

Application case numbers  
05 DRP - 00603 - \_\_\_\_\_  
 \_\_\_\_\_ - \_\_\_\_\_  
 \_\_\_\_\_ - \_\_\_\_\_

[Signature] 4-12-05  
 Planner signature / date

**Project #** 100 4112

April 1, 2005

DRB Chair  
City of Albuquerque Development Services  
600 2<sup>nd</sup> Street NW  
Albuquerque, NM 87102

RE: Meridian Business Park – Brunacini Office/Warehouse Addition

Dear Chair:

ABQ Engineering, Inc. has been retained by Healthcare Laundry Services to amend an approved site plan (DRB -97-59). The amendment is to allow for construction of an additional 5,547 square foot warehouse at the southeast corner of the existing building. The site is located at the southeast corner of Los Volcanos Road, N.W., and Silver Creek Road, N.W.; Zone atlas page K-10.

The site is currently fully developed. No improvements to the site are proposed other than shown on the plan and described above. The addition will be served with utilities from the existing building. No additional landscaping is proposed.

The revised grading and drainage plan has been submitted and approved by the city.

Please schedule before the DRB as soon as possible.

Sincerely,



Francis K. Phillips  
ABQ Engineering, Inc.  
25039

April 5, 2005

ABQ Engineering  
6739 Academy Blvd NE  
Suite 130  
Albuquerque, NM 87109

To Whom It May Concern:

Please be advised that we are expecting you to represent the ownership of the building located at 7600 Los Volcanes, in Albuquerque. This memo is to serve as that notice you may have to present to any of the departments within the City of Albuquerque Building Department.

Sincerely,

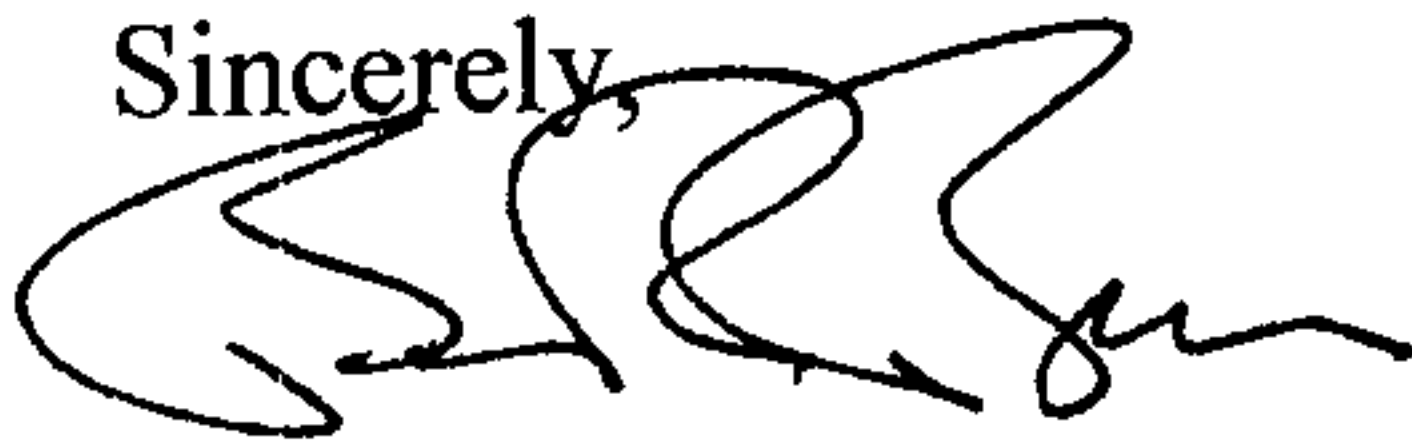

Bruce R. Besser , owner of 7600 Los Volcanes  
660 Canyon Road  
Santa Fe, NM 87501



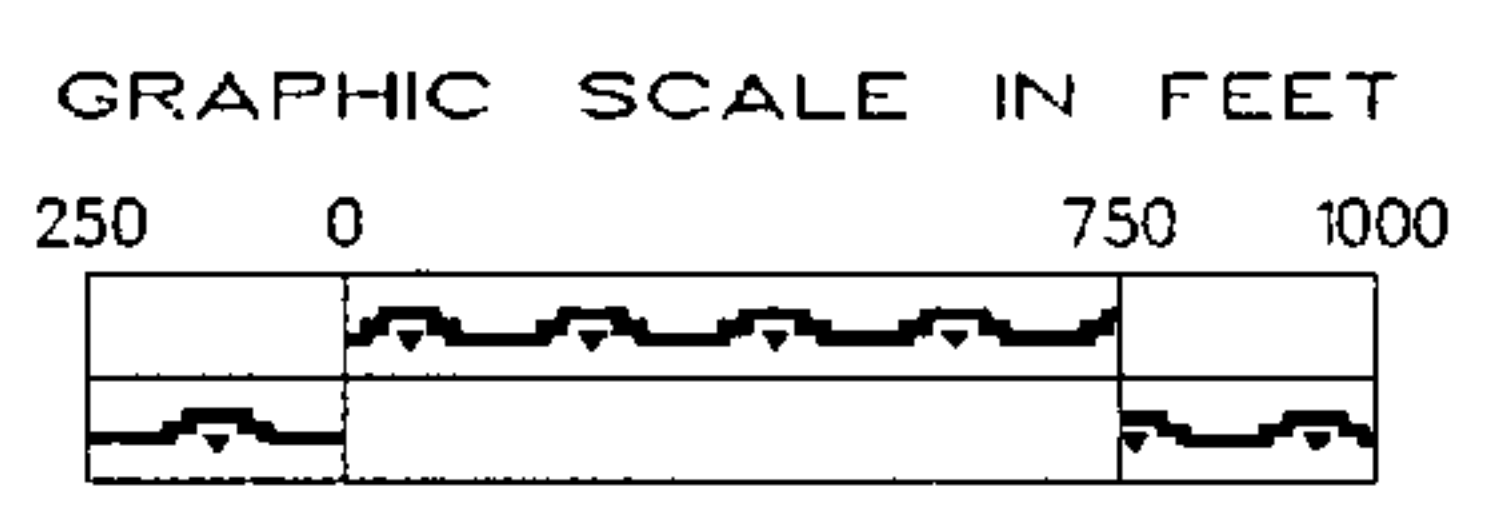
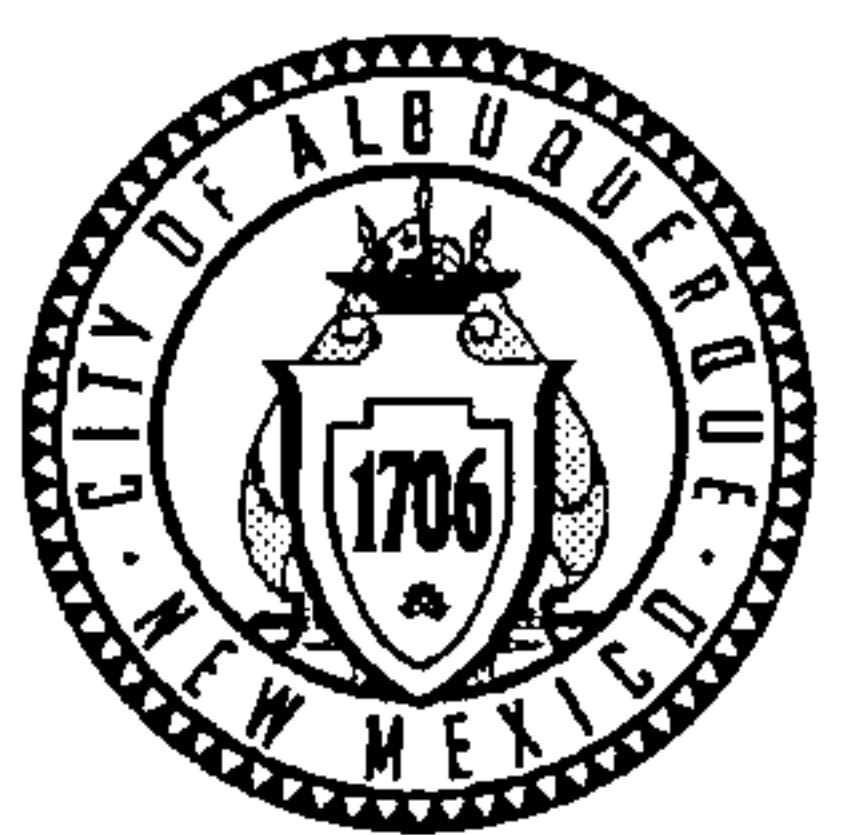
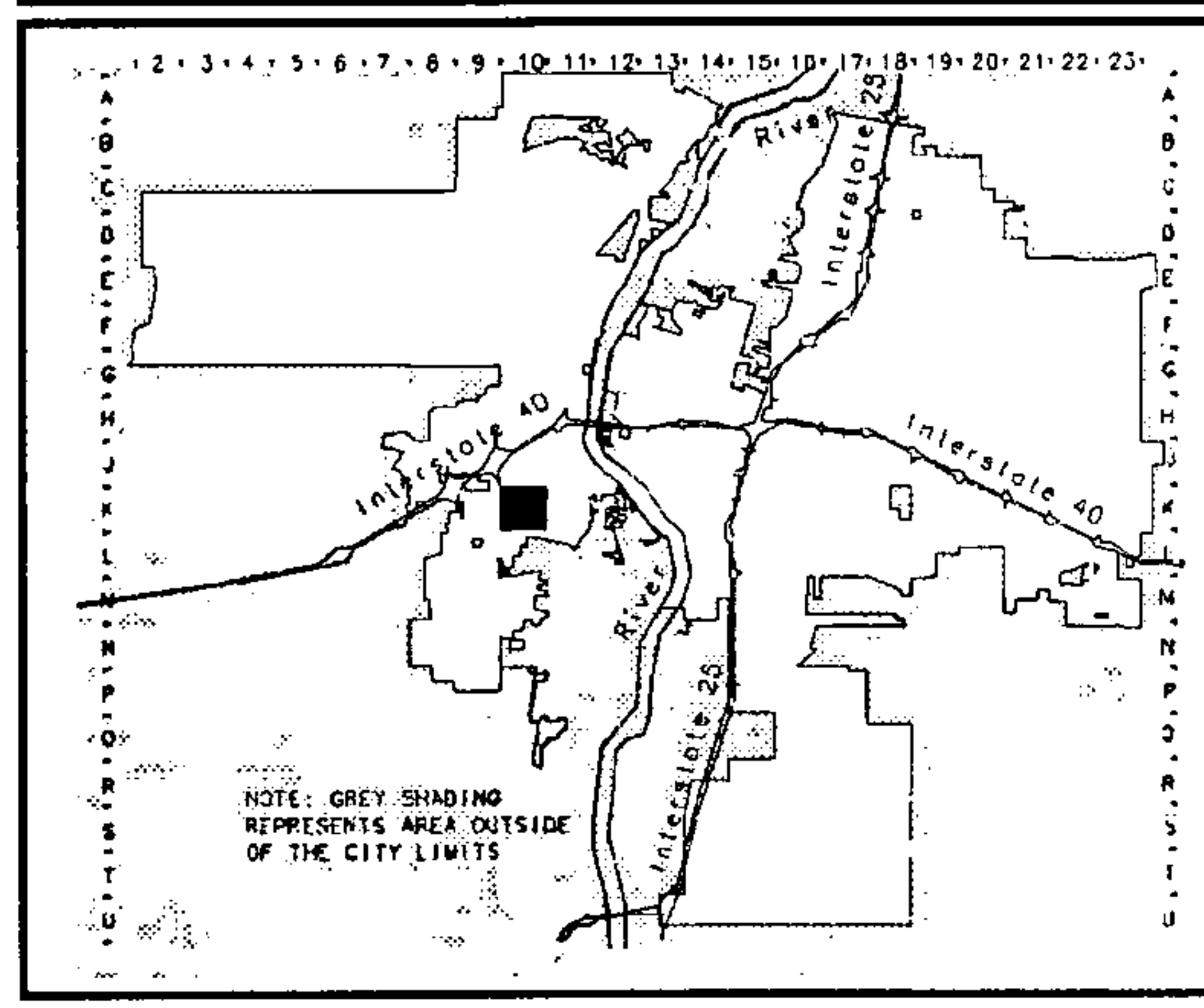
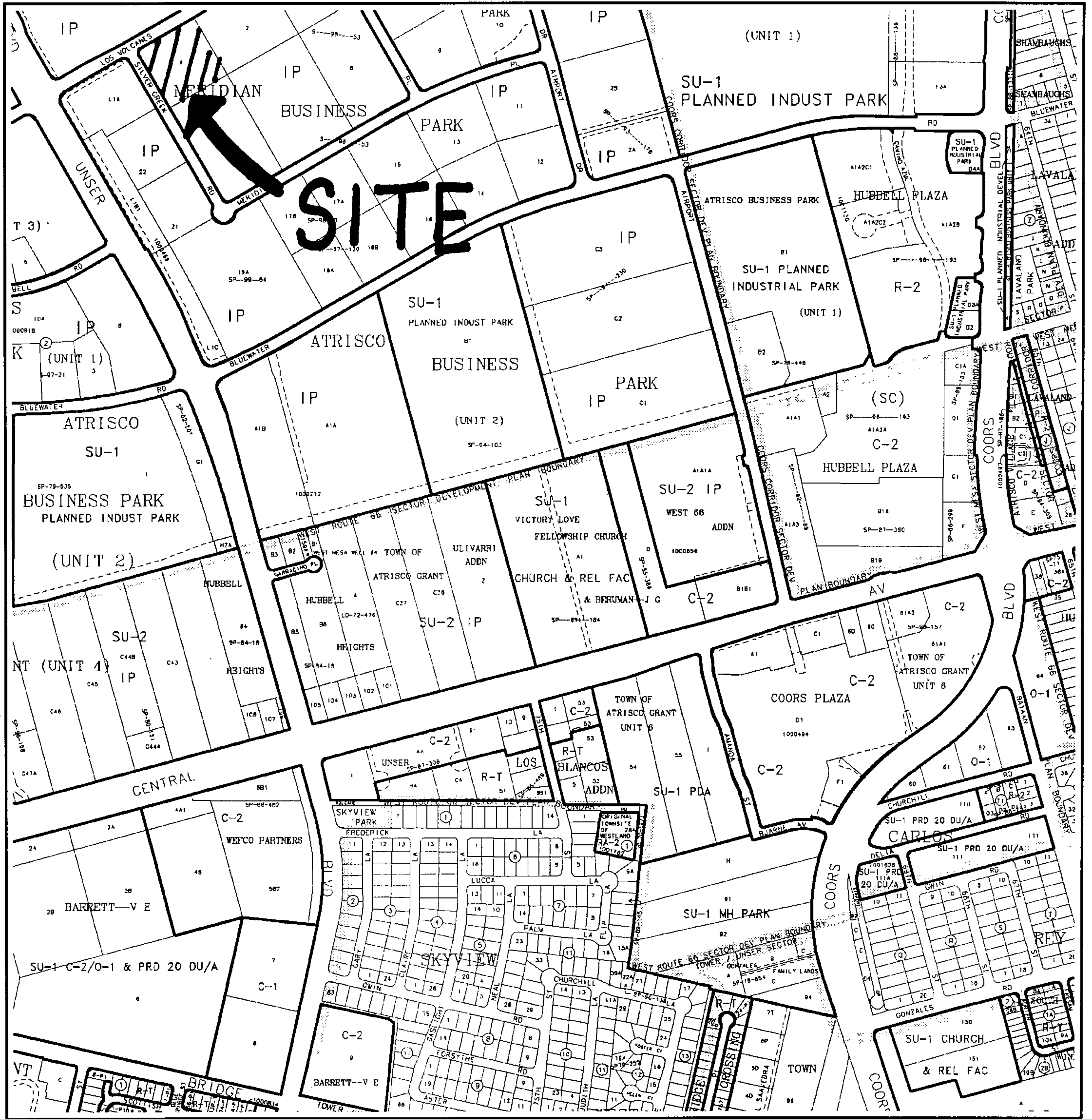

**A**lbuquerque **G**eographic **I**nformation **S**ystem  
**PLANNING DEPARTMENT**  
 © Copyright 2003

**Zone Atlas Page**  
**K-10-Z**

Map Amended through November 01, 2003





# SITE DEVELOPMENT PLAN FOR BUILDING PERMIT CHECKLIST

Revised: 1/10/2005

## B. Proposed Development

### 1. Structural

- A. Location of existing and proposed structures (distinguish between existing & proposed)
- B. Square footage of each structure
- C. Proposed use of each structure
- D. Temporary structures, signs and other improvements
- E. Walls, fences, and screening: indicate height, length, color and materials
- F. Dimensions of all principal site elements or typical dimensions thereof
- G. Loading facilities
- H. Site lighting (indicate height & fixture type)
- I. Indicate structures within 20 feet of site
- J. Elevation drawing of refuse container and enclosure, if applicable.

### 2. Parking and Internal Circulation

- A. Parking layout with spaces numbered per aisle and totaled.
  - 1. **Location and typical dimensions**, including handicapped spaces
  - 2. **Calculations:** spaces required: \_\_\_\_\_ provided: \_\_\_\_\_  
Handicapped spaces required: \_\_\_\_\_ provided: \_\_\_\_\_
- B. Bicycle parking & facilities
  - 1. Bicycle racks, spaces required: \_\_\_\_\_  
provided: \_\_\_\_\_
  - 2. Other bicycle facilities, if applicable
- C. Vehicular Circulation (Refer to Chapter 23 of DPM)
  - 1. Ingress and egress locations, including width and curve radii dimensions
  - 2. Drive aisle locations, including width and curve radii dimensions
  - 3. End aisle locations, including width and curve radii dimensions
  - 4. Location & orientation of refuse enclosure, with dimensions
  - 5. Curb cut locations and dimensions
- D. Pedestrian Circulation
  - 1. Location and dimensions of all sidewalks and pedestrian paths
  - 2. Location and dimension of drive aisle crossings, including paving treatment
  - 3. Location and description of amenities, including patios, benches, tables, etc.

### 3. Streets and Circulation

- A. Locate and identify adjacent public and private streets and alleys.
  - 1. Existing and proposed pavement widths, right-of-way widths and curve radii
  - 2. Identify existing and proposed turn lanes, deceleration lanes and similar features related to the functioning of the proposal, with dimensions
  - 3. Location of traffic signs and signals related to the functioning of the proposal
  - 4. Identify existing and proposed medians and median cuts
  - 5. Sidewalk widths and locations, existing and proposed
- B. Identify Alternate transportation facilities within site or adjacent to site
  - 1. Bikeways and bike-related facilities

# SITE DEVELOPMENT PLAN FOR BUILDING PERMIT CHECKLIST

Revised: 1/10/2005

- 2. Pedestrian trails and linkages
- 3. Bus facilities, including routes, bays and shelters existing or required

## 4. Utilities

- 1. Fire hydrant locations, existing and proposed.
- 2. Distribution lines
- 3. Right-of-Way and easements, existing and proposed, on the property and adjacent to the boundaries, with identification of types and dimensions.
- 4. Existing water, sewer, storm drainage facilities (public and/or private).
- 5. Proposed water, sewer, storm drainage facilities (public and/or private)

## 5. Phasing

- A. Proposed phasing of improvements and provision for interim facilities. Indicate phasing plan, including location and square footage of structures and associated improvements including circulation, parking and landscaping.

## SHEET #2 - LANDSCAPING PLAN

Landscaping may be shown on sheet #1 with written approval from Planning Department staff.

- 1. Scale - must be same as scale on sheet #1 - Site plan
- 2. Bar Scale
- 3. North Arrow
- 4. Property Lines
- 5. Existing and proposed easements
- 6. Identify nature of ground cover materials
  - A. Impervious areas (pavement, sidewalks, slope pavings, curb and gutters, etc.)
  - B. Pervious areas (planting beds, grass, ground cover vegetation, etc.)
  - C. Ponding areas either for drainage or landscaping/recreational use
- 7. Identify type, location and size of plantings (common and/or botanical names).
  - A. Existing, indicating whether it is to preserved or removed.
  - B. Proposed, to be established for general landscaping.
  - C. Proposed, to be established for screening/buffering.
- 8. Describe irrigation system
- 9. Planting Beds, indicating square footage of each bed
- 10. Turf Area - only 20% of landscaped area can be high water turf; provide square footage and percentage.
- 11. Responsibility for Maintenance (statement)
- 12. Statement of compliance with Water Conservation... Ordinance, see article 6-1-1-1.
- 13. Landscaped area requirement; square footage and percent (specify clearly on plan)
- 14. Landscaped area provided; square footage and percent (specify clearly on plan)

## SHEET #3 - PRELIMINARY GRADING PLAN -

The Preliminary Grading Plan provides the Planning Commission and staff with an understanding of site topography and how it relates to adjacent property. Planning staff may waive or allow adjustments to the Preliminary Grading Plan requirements for sites that are small, relatively flat and have no existing or proposed extraordinary drainage facilities. Waivers must be obtained in writing from the City Engineer prior to application submittal.

Grading information for sites that are under 1 acre can be included on Sheet #1.



# SITE DEVELOPMENT PLAN FOR BUILDING PERMIT CHECKLIST

Revised: 1/10/2005

## A. General Information

- 1. Scale - must be same as Sheet #1 - Site Plan
- 2. Bar Scale
- 3. North Arrow
- 4. Property Lines
- 5. Existing and proposed easements
- 6. Building footprints
- 7. Location of Retaining walls

## B. Grading Information

- 1. On the plan sheet, provide a narrative description of existing site topography, proposed grading improvements and topography within 100 feet of the site.
- 2. Indicate finished floor elevation and provide spot elevations for all corners of the site (existing and proposed) and points of maximum cut or fill exceeding 1 foot.
- 3. Identify ponding areas, erosion and sediment control facilities.
- 4. Cross Sections  
Provide cross section for all perimeter property lines where the grade change is greater than 4 feet at the point of the greatest grade change. Provide one additional cross section in each direction within no more than 100 feet of the reference point.

## SHEET #4 - BUILDING AND STRUCTURE ELEVATIONS

### A. General Information

- A. Scale (minimum of 1/8" or as approved by Planning Staff).
- B. Bar Scale
- C. Detailed Building Elevations for each facade
  - 1. Identify facade orientation
  - 2. Dimensions of facade elements, including overall height and width
  - 3. Location, material and colors of windows, doors and framing
  - 4. Materials and colors of all building elements and structures
- E. Site Development Plans for single family residential projects with multiple units may require submittal of specific information on building features in lieu of elevation drawings for each building. Applicants are advised to discussed submittal requirements with Planning Department staff.

### B. Signage

- 1. Site location(s)
- 2. Sign elevations to scale
- 3. Dimensions, including height and width
- 4. Sign face area - dimensions and square footage clearly indicated
- 5. Lighting
- 6. Materials and colors for sign face and structural elements.

*Applicants should make sure that the submitted site development plan drawings are accurate and complete, and that items specified in this checklist have been clearly indicated on the plan drawings as required.*

ONE STOP SHOP  
CITY OF ALBUQUERQUE PLANNING DEPARTMENT  
Development & Building Services

PAID RECEIPT

APPLICANT NAME Bruce Besser  
AGENT ABQ Engineering  
ADDRESS 6739 Academy Rd NE  
PROJECT & APP # 1004112 / 05 DRB 00603  
PROJECT NAME Meridian Bus PK, Lt 1

\$ 20.00 441032/3424000 Conflict Management Fee  
\$ 50.00 441006/4983000 DRB Actions  
\$ \_\_\_\_\_ 441006/4971000 EPC/AA/LUCC Actions & All Appeals  
\$ \_\_\_\_\_ 441018/4971000 Public Notification  
\$ \_\_\_\_\_ 441006/4983000 DRAINAGE PLAN REVIEW OR TRAFFIC IMPACT STUDY\*\*\*  
( ) Major/Minor Subdivision ( ) Site Development Plan ( ) Bldg Permit  
( ) Letter of Map Revision ( ) Conditional Letter of Map Revision  
( ) Traffic Impact Study  
\$ 70.00 TOTAL AMOUNT DUE

\*\*\*NOTE: If a subsequent submittal is required, bring a copy of this paid receipt with you to avoid an additional charge.

ORIGINAL CHECK HAS A COLORED BACKGROUND PRINTED ON CHEMICAL REACTIVE PAPER. SEE BACK FOR DETAILS.

ABQ ENGINEERING, INC.  
6739 ACADEMY RD, NE SUITE 130  
ALBUQUERQUE, NM 87110  
(505) 255-7802

WELLS FARGO BANK NEW MEXICO, N.A.  
ALBUQUERQUE, NM 87110  
95-219-130  
\*1070

004979

4/7/2005

City of Albuquerque \*70.00  
Treasury Division

4/12/2005 19:59AM LOC: ANN DOLLARS  
RECEIPT# 00040168 WSH 007 TRANS# 0016  
Account # 441032 Fund 0110  
Activity 3424000 TRSL45  
Trans Per Yut 20.00

MEMO Job# 25039

MP

004979 1070021921060211246