



Supplemental Form (SF)

**SUBDIVISION**

- Major subdivision action
- Minor subdivision action
- Vacation
- Variance (Non-Zoning)

**SITE DEVELOPMENT PLAN**

- for Subdivision
- for Building Permit
- Administrative Amendment/Approval (AA)
- IP Master Development Plan
- Cert. of Appropriateness (LUCC)

**STORM DRAINAGE (Form D)**

- Storm Drainage Cost Allocation Plan

**S Z ZONING & PLANNING**

- Annexation
- Zone Map Amendment (Establish or Change Zoning, includes Zoning within Sector Development Plans)
- Adoption of Rank 2 or 3 Plan or similar
- Text Amendment to Adopted Rank 1, 2 or 3 Plan(s), Zoning Code, or Subd. Regulations
- Street Name Change (Local & Collector)
- APPEAL / PROTEST of...**
- Decision by: DRB, EPC, LUCC, Planning Director, ZEO, ZHE, Board of Appeals, other

PRINT OR TYPE IN BLACK INK ONLY. The applicant or agent must submit the completed application in person to the Planning Department Development Services Center, 600 2<sup>nd</sup> Street NW, Albuquerque, NM 87102. Fees must be paid at the time of application. Refer to supplemental forms for submittal requirements.

**APPLICATION INFORMATION:**

Professional/Agent (if any): RIO GRANDE ENGINEERING PHONE: 505.321.9099  
 ADDRESS: PO BOX 93924 FAX: \_\_\_\_\_  
 CITY: ALB STATE NM ZIP 87199 E-MAIL: david@riograndeengineering.com

APPLICANT: ENCHANTMENT HOMES PHONE: \_\_\_\_\_  
 ADDRESS: 9171 GLENDALE NE FAX: \_\_\_\_\_  
 CITY: ALBUQUERQUE STATE NM ZIP 87122 E-MAIL: \_\_\_\_\_

Proprietary interest in site: \_\_\_\_\_ List all owners: \_\_\_\_\_

**DESCRIPTION OF REQUEST:** 2 YEAR EXTENSION TO TEMPORARY DEFFERAL OF SIDEWALKS

Is the applicant seeking incentives pursuant to the Family Housing Development Program?  Yes.  No.

**SITE INFORMATION: ACCURACY OF THE EXISTING LEGAL DESCRIPTION IS CRUCIAL! ATTACH A SEPARATE SHEET IF NECESSARY.**

Lot or Tract No. LOT 1-60 Block: \_\_\_\_\_ Unit: \_\_\_\_\_  
 Subdiv/Addn/TBKA: MESA DEL RIO  
 Existing Zoning: R2 Proposed zoning: R2 MRGCD Map No \_\_\_\_\_  
 Zone Atlas page(s): J10 UPC Code: 101005815025622301

**CASE HISTORY:**

List any current or prior case number that may be relevant to your application (Proj., App., DRB-, AX\_,Z\_, V\_, S\_, etc.): \_\_\_\_\_  
 1004341

**CASE INFORMATION:**

Within city limits?  Yes Within 1000FT of a landfill?  NO  
 No. of existing lots: 60 No. of proposed lots: 60 Total site area (acres): 5.2  
 LOCATION OF PROPERTY BY STREETS: On or Near: MESA DEL RIO  
 Between: FORTUNA ROAD NW and GLEN RIO NW

Check if project was previously reviewed by: Sketch Plat/Plan  or Pre-application Review Team(PRT) . Review Date: \_\_\_\_\_

**SIGNATURE** \_\_\_\_\_ **DATE** \_\_\_\_\_  
 (Print Name) DAVID SOULE Applicant:  Agent:

**FOR OFFICIAL USE ONLY**

Revised: 4/2012

<input type="checkbox"/> INTERNAL ROUTING	Application case numbers	Action	S.F.	Fees
<input type="checkbox"/> All checklists are complete	_____	_____	_____	\$ _____
<input type="checkbox"/> All fees have been collected	_____	_____	_____	\$ _____
<input type="checkbox"/> All case #s are assigned	_____	_____	_____	\$ _____
<input type="checkbox"/> AGIS copy has been sent	_____	_____	_____	\$ _____
<input type="checkbox"/> Case history #s are listed	_____	_____	_____	\$ _____
<input type="checkbox"/> Site is within 1000ft of a landfill	_____	_____	_____	\$ _____
<input type="checkbox"/> F.H.D.P. density bonus				Total
<input type="checkbox"/> F.H.D.P. fee rebate				\$ _____

Hearing date \_\_\_\_\_

Project # \_\_\_\_\_

Staff signature & Date \_\_\_\_\_

**FORM V: SUBDIVISION VARIANCES & VACATIONS**

- BULK LAND VARIANCE (DRB04)** **(PUBLIC HEARING CASE)**
    - Application for Minor Plat on FORM S-3, including those submittal requirements. **24 copies**
    - Letter briefly describing and explaining: the request, compliance with the Development Process Manual, and all improvements to be waived.
    - Notice on the proposed Plat that there are conditions to subsequent subdivision (refer to DPM)
    - Office of Community & Neighborhood Coordination inquiry response, notifying letter, certified mail receipts
    - Sign Posting Agreement
    - Fee (see schedule)
    - List any original and/or related file numbers on the cover application
- DRB Public hearings are approximately 30 DAYS after the filing deadline. Your attendance is required.**

- VACATION OF PUBLIC EASEMENT (DRB27)**
  - VACATION OF PUBLIC RIGHT-OF-WAY (DRB28)**
    - The complete document which created the public easement (folded to fit into an 8.5" by 14" pocket) **24 copies.**  
(Not required for City owned public right-of-way.)
    - Drawing showing the easement or right-of-way to be vacated, etc. (not to exceed 8.5" by 11") **24 copies**
    - Zone Atlas map with the entire property(ies) clearly outlined
    - Letter briefly describing, explaining, and justifying the request
    - Office of Community & Neighborhood Coordination inquiry response, notifying letter, certified mail receipts
    - Sign Posting Agreement
    - Fee (see schedule)
    - List any original and/or related file numbers on the cover application
- Unless the vacation is shown on a DRB approved plat recorded by the County Clerk within one year, it will expire.  
**DRB Public hearings are approximately 30 DAYS after the filing deadline. Your attendance is required.**

- SIDEWALK VARIANCE (DRB20)**
  - SIDEWALK WAIVER (DRB21)**
    - Scale drawing showing the proposed variance or waiver (not to exceed 8.5" by 14") **6 copies**
    - Zone Atlas map with the entire property(ies) clearly outlined
    - Letter briefly describing, explaining, and justifying the variance or waiver
    - List any original and/or related file numbers on the cover application
- DRB meetings are approximately 8 DAYS after the Tuesday noon filing deadline. Your attendance is required.**

- SUBDIVISION DESIGN VARIANCE FROM MINIMUM DPM STANDARDS (DRB25)**
    - Scale drawing showing the location of the proposed variance or waiver (not to exceed 8.5" by 14") **24 copies**
    - Zone Atlas map with the entire property(ies) clearly outlined
    - Letter briefly describing, explaining, and justifying the variance
    - Office of Community & Neighborhood Coordination inquiry response, notifying letter, certified mail receipts
    - Sign Posting Agreement
    - Fee (see schedule)
    - List any original and/or related file numbers on the cover application
- DRB meetings are approximately 30 DAYS after the filing deadline. Your attendance is required.**

- TEMPORARY DEFERRAL OF SIDEWALK CONSTRUCTION (DRB19)**
  - EXTENSION OF THE SIA FOR TEMPORARY DEFERRAL OF SIDEWALK CONSTRUCTION (DRB07)**
    - Drawing showing the sidewalks subject to the proposed deferral or extension (not to exceed 8.5" by 14") **6 copies**
    - Zone Atlas map with the entire property(ies) clearly outlined
    - Letter briefly describing, explaining, and justifying the deferral or extension
    - List any original and/or related file numbers on the cover application
- DRB meetings are approximately 8 DAYS after the Tuesday noon filing deadline. Your attendance is required.**

- VACATION OF PRIVATE EASEMENT (DRB26)**
  - VACATION OF RECORDED PLAT (DRB29)**
    - The complete document which created the private easement/recorded plat (not to exceed 8.5" by 14") **6 copies**
    - Scale drawing showing the easement to be vacated (8.5" by 11") **6 copies**
    - Zone Atlas map with the entire property(ies) clearly outlined
    - Letter/documents briefly describing, explaining, and justifying the vacation **6 copies**
    - Letter of authorization from the grantors and the beneficiaries (private easement only)
    - Fee (see schedule)
    - List any original and/or related file numbers on the cover application
- Unless the vacation is shown on a DRB approved plat recorded by the County Clerk within one year, it will expire.  
**DRB meetings are approximately 8 DAYS after the Tuesday noon filing deadline. Your attendance is required.**

I, the applicant, acknowledge that any information required but not submitted with this application will likely result in deferral of actions.

\_\_\_\_\_ Applicant name (print)

\_\_\_\_\_ Applicant signature / date



Form revised 4/07

- Checklists complete Application case numbers
- Fees collected \_\_\_\_\_ - \_\_\_\_\_
- Case #s assigned \_\_\_\_\_ - \_\_\_\_\_
- Related #s listed \_\_\_\_\_ - \_\_\_\_\_

\_\_\_\_\_ Planner signature / date

\_\_\_\_\_ Project #

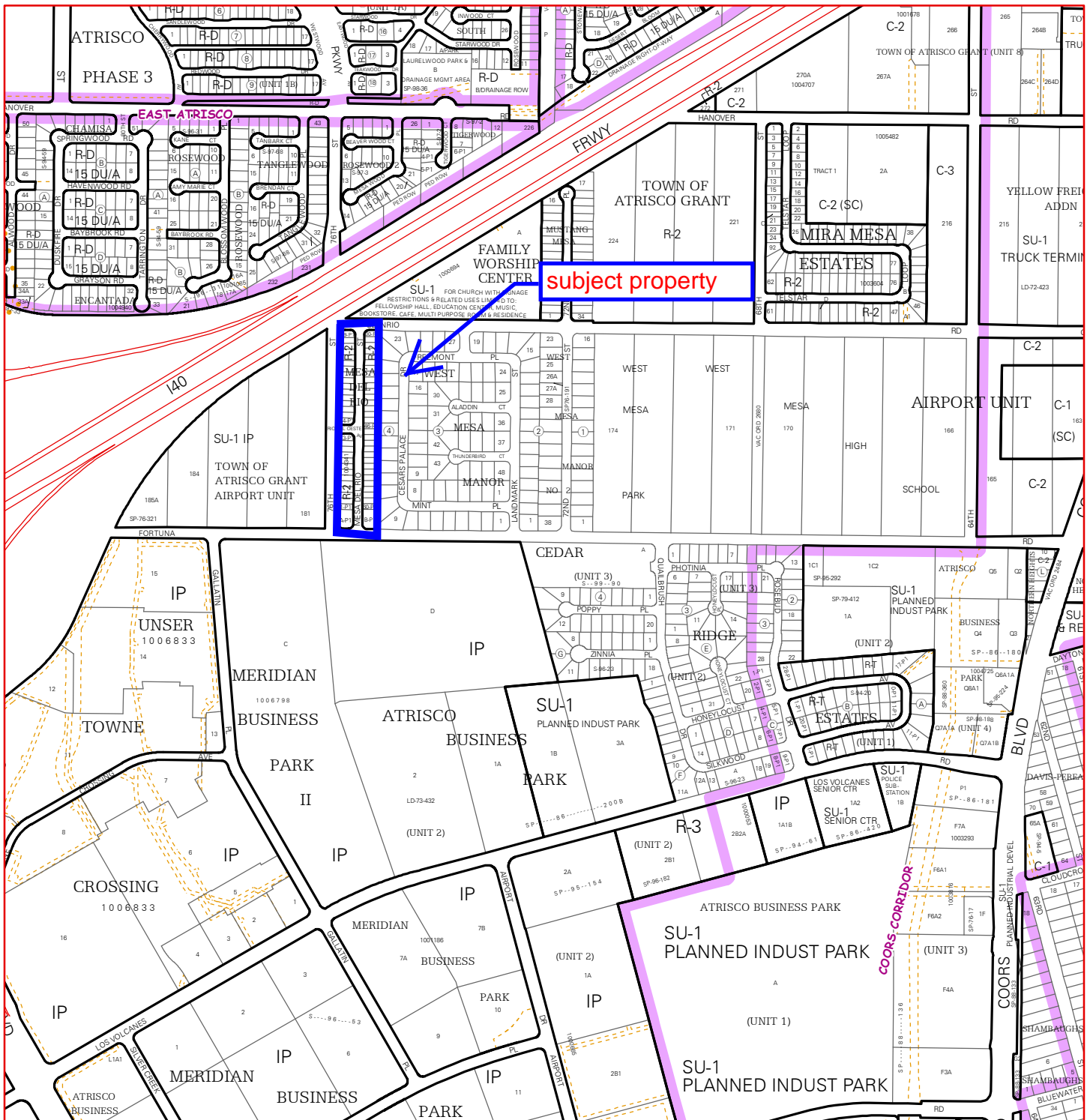

For more current information and more details visit: <http://www.cabq.gov/gis>

Map amended through: 2/4/2010

Note: Grey Shading Represents Area Outside of the City Limits

Zone Atlas Page:  
**J-10-Z**

Selected Symbols

	SECTOR PLANS		Escarpment
	Design Overlay Zones		2 Mile Airport Zone
	City Historic Zones		Airport Noise Contours
	H-1 Buffer Zone		Wall Overlay Zone
	Petroglyph Mon.		

0 750 1,500 Feet

