

NORTH DIVERSION CHANNEL (AMAFCA)

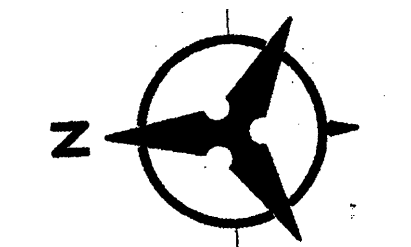

SCALE: 1"=50'

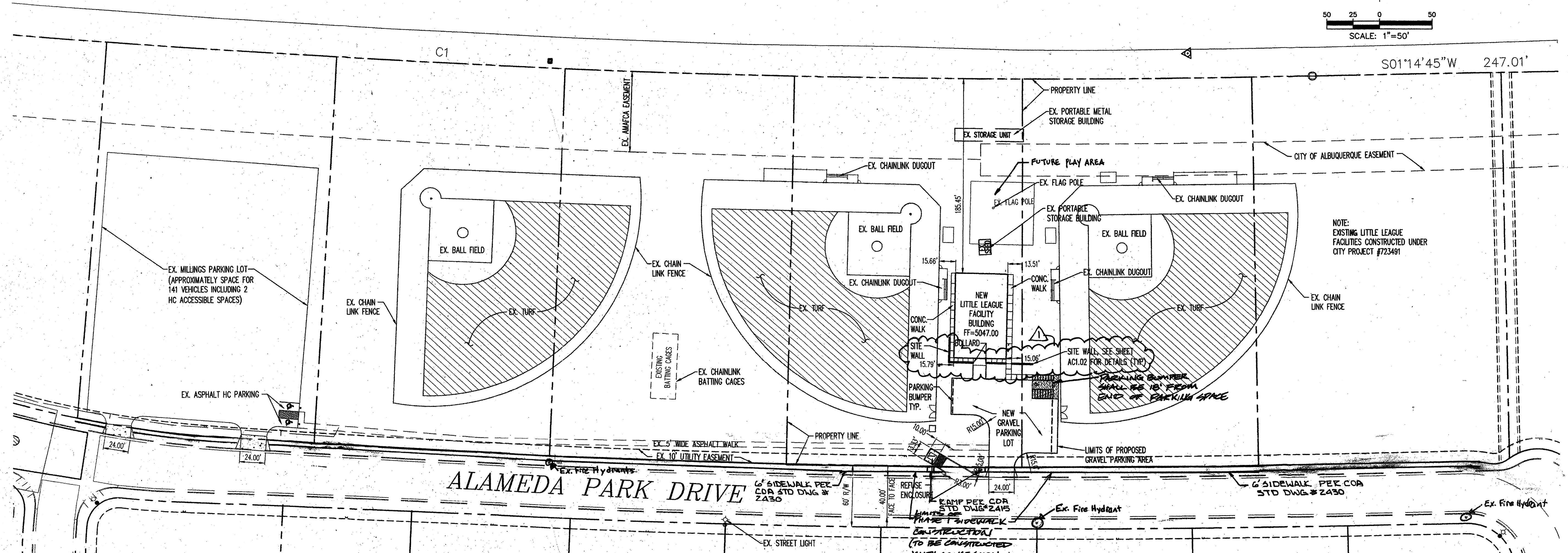

NOTE: EXISTING LITTLE LEAGUE FACILITIES CONSTRUCTED UNDER CITY PROJECT #723491

ALAMEDA PARK DRIVE

PARKING CALCULATIONS

Concession Area
 Parking Requirements, per IBC, 2003 and COA Zoning Code (latest edition) 14-16-3-1 are as follows:
 Storage: Use 17: 964 NSF = 1 parking space
 Kitchen: Use 27: 500 NSF = 3 parking spaces
 Office: Use 21: 990 NSF = 5 parking spaces

Spectator Viewing Area
 Parking Requirements, per COA Zoning Code (latest edition) 14-16-3-1 (23)
 Recreation, outdoor: One space per 200 square feet of site where customers circulate, participate in, or watch the recreation.
 Area = 20,254sf / 200 = 101.27 required

LEGAL DESCRIPTION

LOTS 22, 23, 24, 25, 26, & 27 OF ALAMEDA BUSINESS PARK

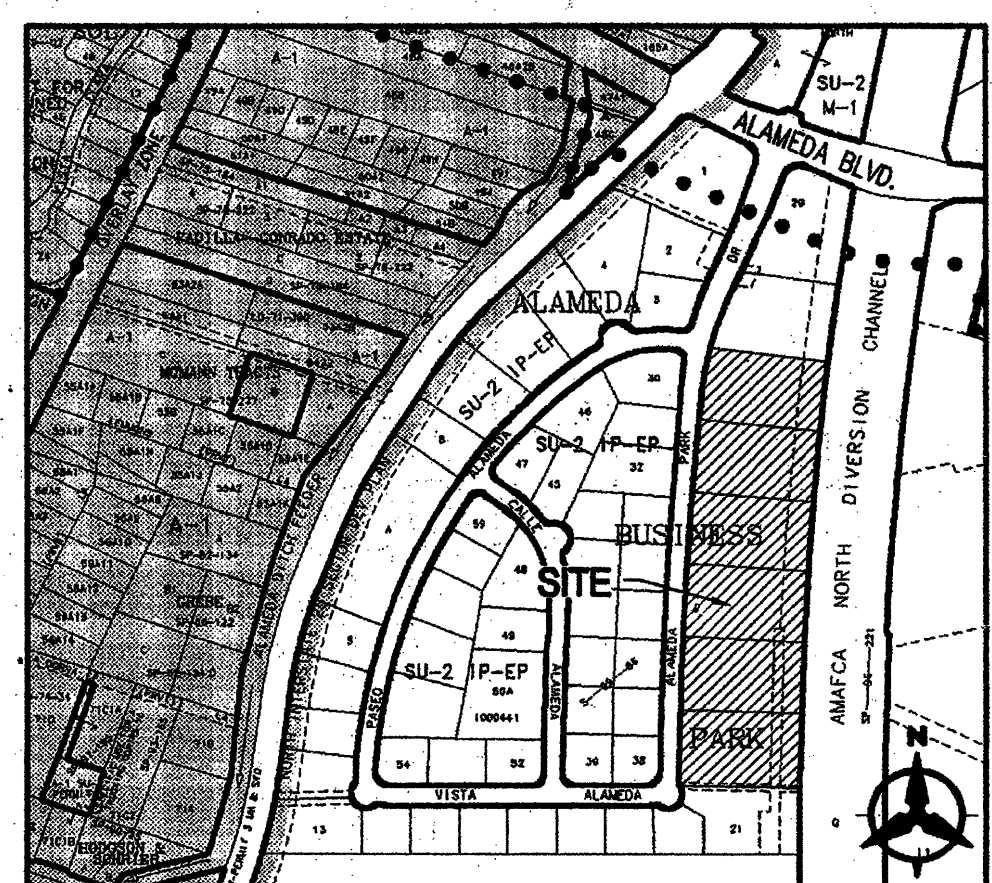

VICINITY MAP
 ZONE ATLAS PAGE C-16-Z
 SCALE: 1"=600'

DRB ADMINISTRATIVE SITE PLAN AMENDMENT
 PROJECT NO. 1004343
 PLAN NO. OCAA-01213
 Remove concrete wall to the west of the building
 Planning Director: [Signature]
 DATE: [Blank]

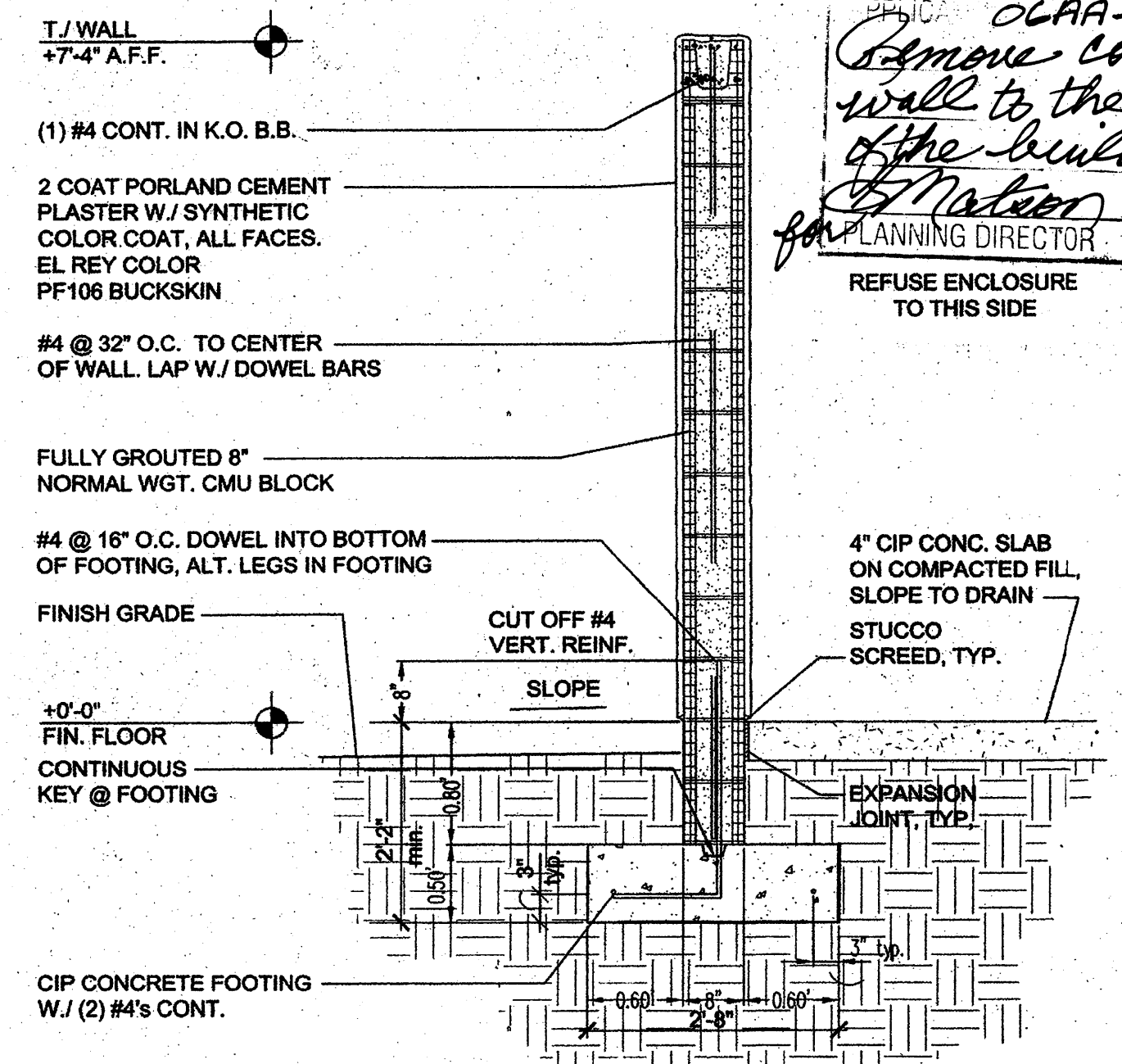

3 REFUSE ENCLOSURE DETAIL
 N.T.S.

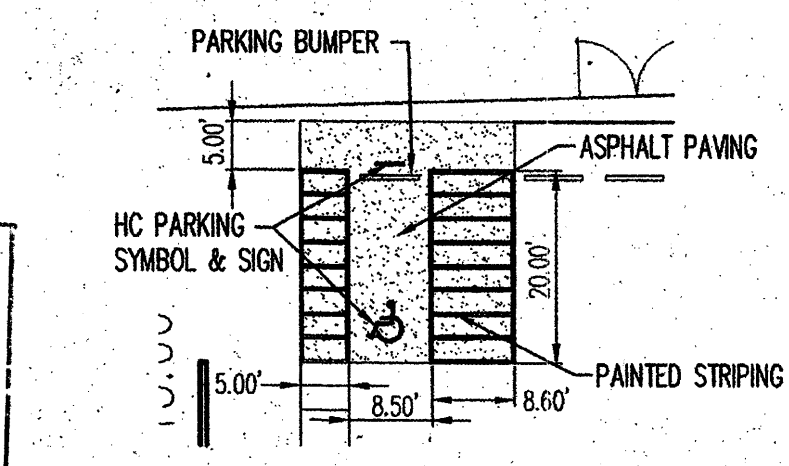

2 HANDICAP PARKING DETAIL
 N.T.S.

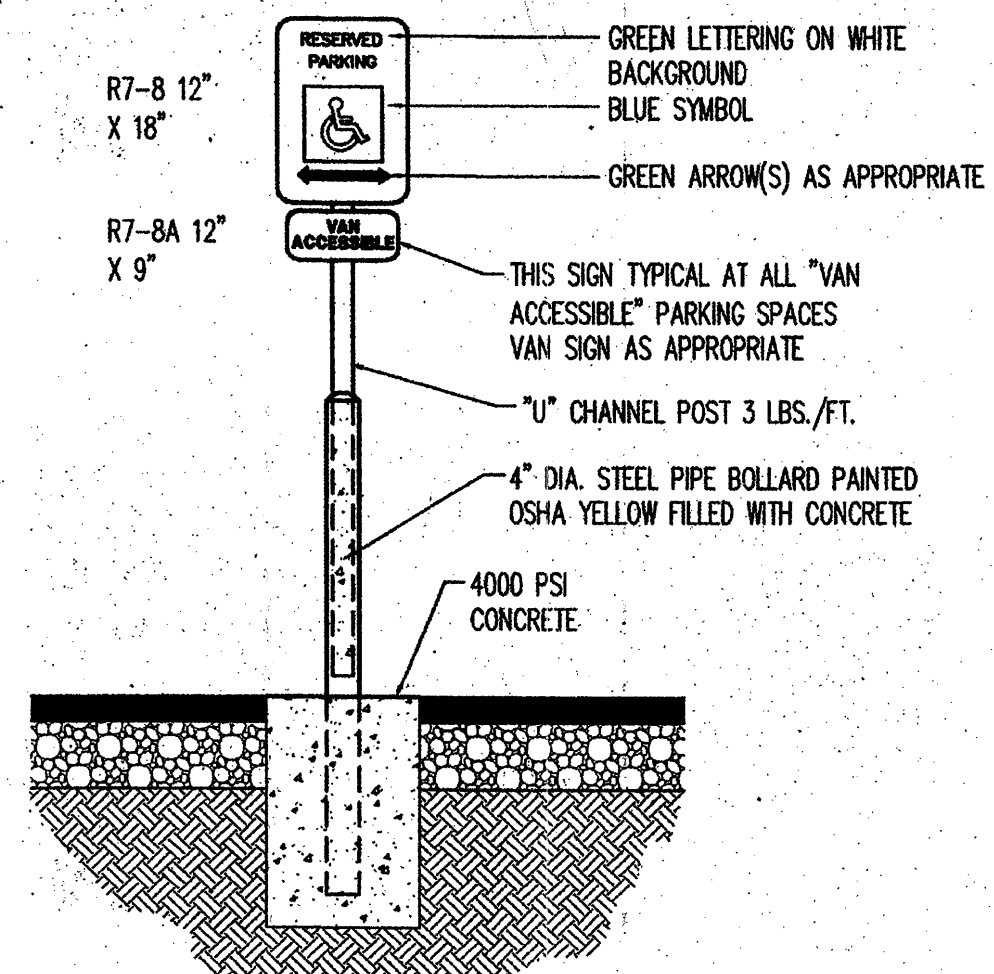

1 HANDICAP PARKING SIGN MOUNTING DETAIL
 N.T.S.

PLANS CHECKING
 924-3611
 APPROVED FOR CONSTRUCTION
 DATE: 11/11/05
 DELETE CMU GITE WALL

PROJECT NUMBER: 1004343
 Application Number: 05DRB-01213
 Is an Infrastructure List required? () Yes (X) No
 If yes, then a set of approved DRC plans with a work order is required for any construction within Public Right-of-Way or for construction of public improvements.

DRB SITE DEVELOPMENT PLAN APPROVAL:

[Signature]	1-31-06
Traffic Engineering, Transportation Division	Date
[Signature]	12/14/05
Water Utility Department	Date
[Signature]	12/14/05
Parks and Recreation Department	Date
[Signature]	12/14/05
City Engineer	Date
N/A	Date
Environmental Health Department (conditional)	Date
[Signature]	7/22/05
Solid Waste Management	Date
[Signature]	12/14/05
DRB Chairperson, Planning Department	Date

PROJECT DATA	
Zoning (Existing)	= SU-2 IP-EP
Zoning (Proposed)	= SU-2 IP-EP
Site Area	= --- (Lots 22,23,24,25,26,27)
Building Area	= 4,070 sf
Parking Required - Concession Area	= 9 spaces
Parking Provided - Concession Area	= 11 spaces including 1 HC space
Parking Required - Spectator Viewing Area	= 101 spaces
Parking Provided - Spectator Viewing Area	= 141 spaces including 2 HC spaces

BICYCLE PARKING: 2 REQUIRED, 2 PROVIDED

Bohannon & Huston
 Courtyard 1 7800 Jefferson St. NE Albuquerque, NM 87109-4335
 ENGINEERING • SPATIAL DATA • ADVANCED TECHNOLOGIES

**CITY OF ALBUQUERQUE
 PARKS AND RECREATION DEPARTMENT**

TITLE: ALAMEDA LITTLE LEAGUE FACILITY
 SITE DEVELOPMENT PLAN FOR BUILDING PERMIT - SITE PLAN
 JULY, 2005

Design Review Committee City Engineer Approval

City Project No. Zone Map No. Sheet Of
 C-16-Z 1 6

AS BUILT INFORMATION		BENCHMARK		SURVEY INFORMATION		ENGINEER'S SEAL		REVISIONS / REMARKS		BY	
CONTRACTOR	DATE:	AMAFCA Brass Tablet stamped "NDC - 7"	DATE:	FIELD NOTES	BY	NO.	DATE:	NO.	DATE:	NO.	DATE:
WORK STAKED BY	DATE:	N.M. State Plane Coordinates (Central Zone)	DATE:								
INSPECTOR'S APPROVAL	DATE:	X = 394,094.80 Y = 1,522,635.84	DATE:								
FIELD VERIFICATION BY	DATE:	Ground - To - Grid Factor = 0.99967075	DATE:								
DRAWING CORRECTED BY	DATE:	al = 001215'	DATE:								
MICRO-FILM INFORMATION	NO.	Elevation = 5062.6	NO.								
RECORDED BY	NO.		RECORDED BY	NO.							

PROJECT 1004343
 DRB ADM PLAN AMENDMENT