

NORTH DIVERSION CHANNEL (AMAFCA)

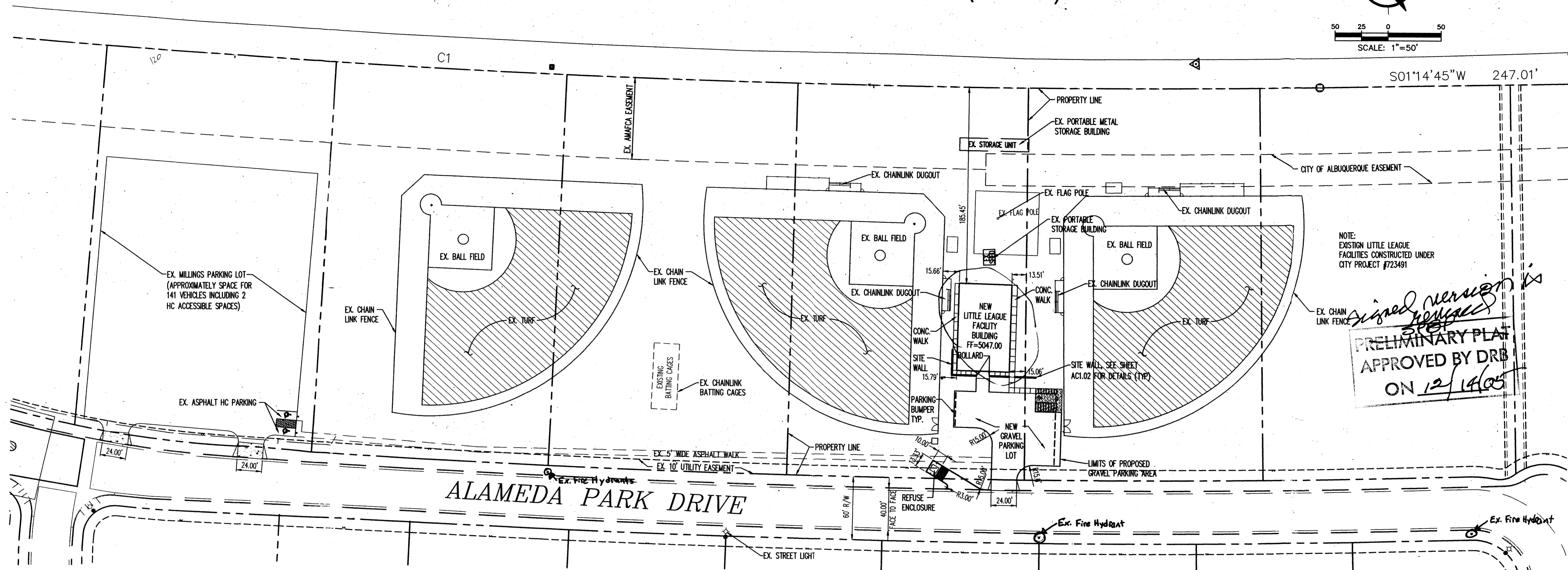
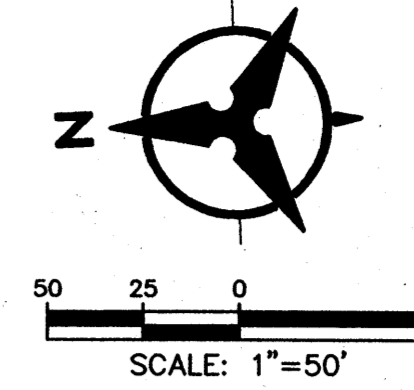

Signed version of PRELIMINARY PLAN APPROVED BY DRB ON 12/14/05

ALAMEDA PARK DRIVE

PARKING CALCULATIONS

Concession Area
 Parking Requirements, per IBC, 2003 and COA Zoning Code (latest edition) 14-16-3-1 are as follows:
 Storage: Use 17: 964 NSF = 1 parking space
 Kitchen: Use 27: 580 NSF = 3 parking spaces
 Office: Use 21: 990 NSF = 5 parking spaces

Spectator Viewing Area
 Parking Requirements, per COA Zoning Code (latest edition) 14-16-3-1 (23)
 Recreation, outdoor: One space per 200 square feet of site where customers circulate, participate in, or watch the recreation.
 Area = 20,254sf / 200 = 101.27 required

LEGAL DESCRIPTION

LOTS 22, 23, 24, 25, 26, & 27 OF ALAMEDA BUSINESS PARK

PROJECT NUMBER: _____
Application Number: _____

Is an Infrastructure List required? () Yes () No If yes, then a set of approved DRC plans with a work order is required for any construction within Public Right-of-Way or for construction of public improvements.

DRB SITE DEVELOPMENT PLAN APPROVAL:

Traffic Engineering, Transportation Division	Date
Water Utility Department	Date
Parks and Recreation Department	Date
City Engineer	Date
Environmental Health Department (conditional)	Date
<i>Michael Holton</i> Solid Waste Management	7/22/05 Date
DRB Chairperson, Planning Department	Date

*Environmental Health, if necessary.

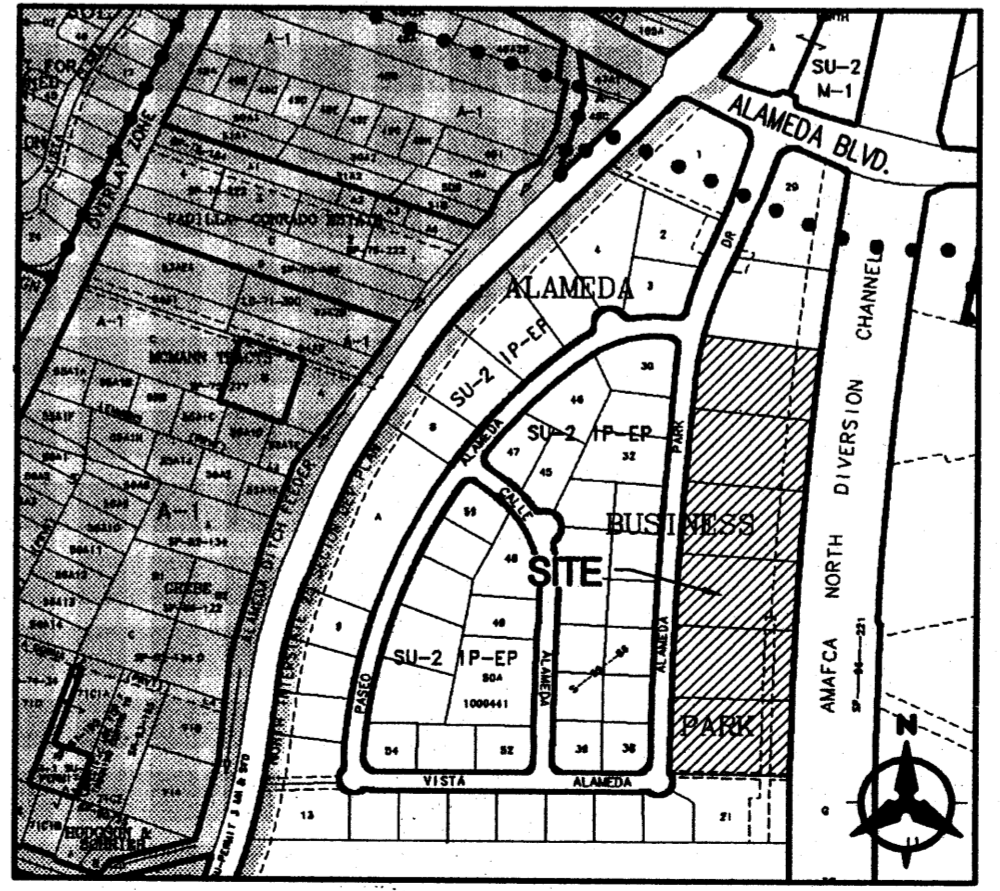

VICINITY MAP
 ZONE ATLAS PAGE C-16-Z
 SCALE: 1"=500±

PROJECT DATA	
Zoning (Existing)	= SU-2 IP-EP
Zoning (Proposed)	= SU-2 IP-EP
Site Area	= --- (Lots 22,23,24,25,26,27)
Building Area	= 4,070 sf
Parking Required - Concession Area	= 9 spaces
Parking Provided - Concession Area	= 11 spaces including 1 HC space
Parking Required - Spectator Viewing Area	= 101 spaces
Parking Provided - Spectator Viewing Area	= 141 spaces including 2 HC spaces

BICYCLE PARKING: 2 REQUIRED, 2 PROVIDED

Bohannon & Huston
 Courtyard I 7500 Jefferson St. NE Albuquerque, NM 87109-4335
 ENGINEERING • SPATIAL DATA • ADVANCED TECHNOLOGIES

**CITY OF ALBUQUERQUE
 PARKS AND RECREATION DEPARTMENT**

TITLE: **ALAMEDA LITTLE LEAGUE FACILITY** JULY, 2005
 SITE DEVELOPMENT PLAN FOR BUILDING PERMIT - SITE PLAN

Design Review Committee	City Engineer Approval	NO. ZIR/ZIR	NO. ZIR/ZIR
-------------------------	------------------------	-------------	-------------

City Project No. _____ Zone Map No. C-16-Z Sheet 1 Of 6

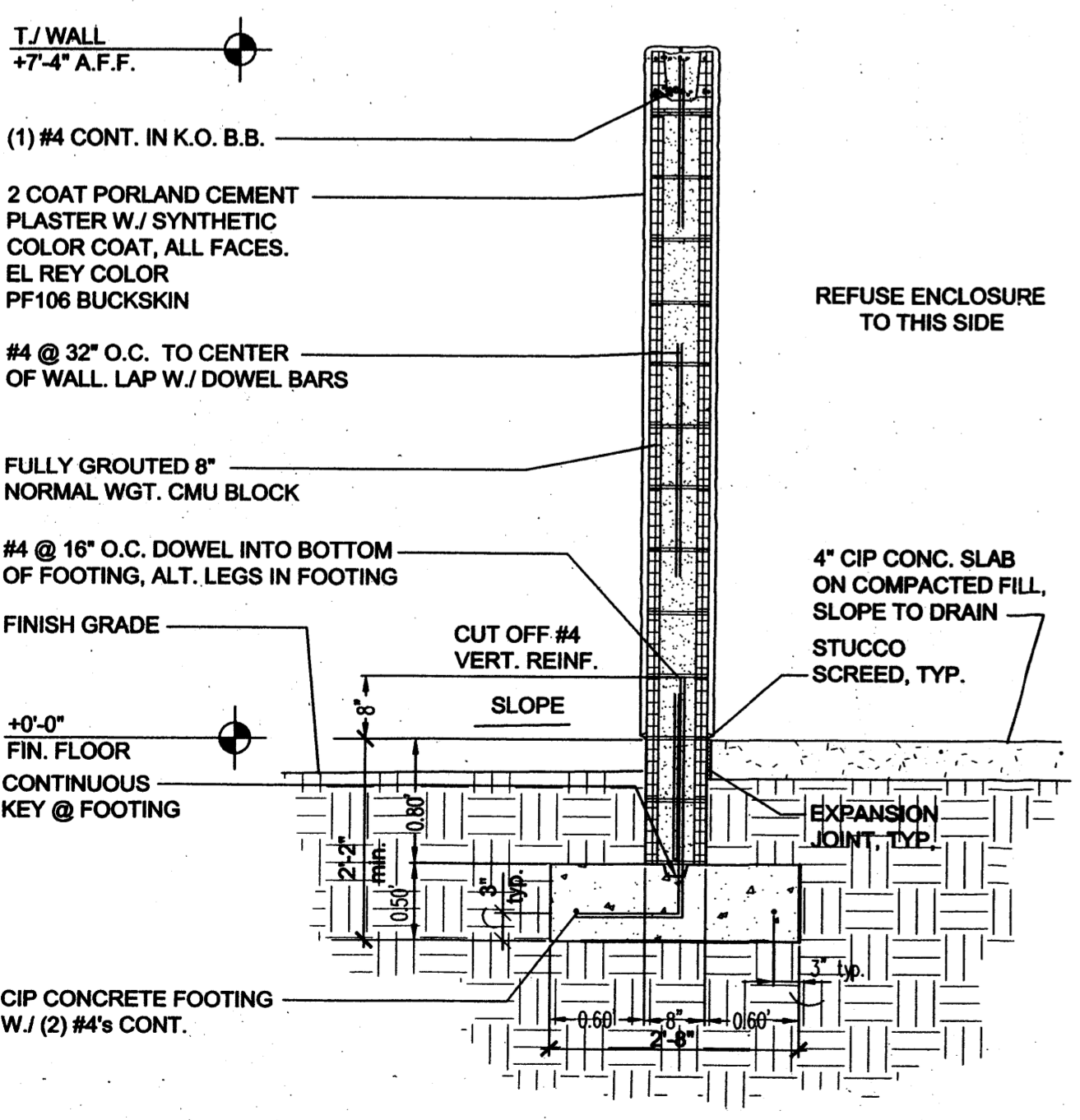

3 REFUSE ENCLOSURE DETAIL
 N.T.S.

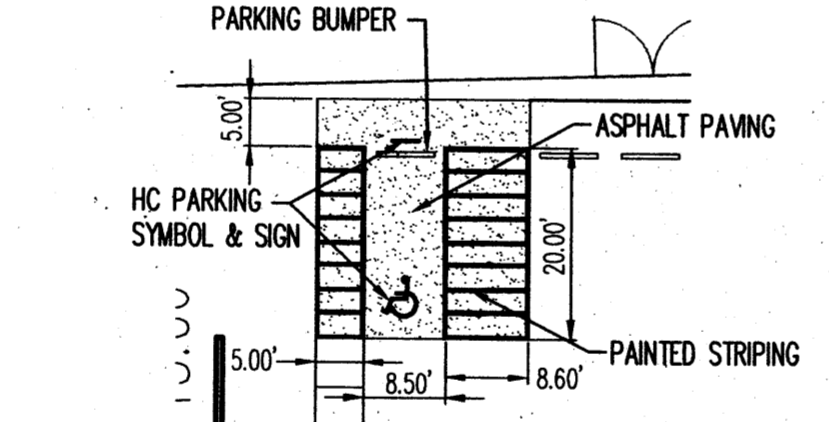

2 HANDICAP PARKING DETAIL
 N.T.S. FOR VAN ACCESSIBLE

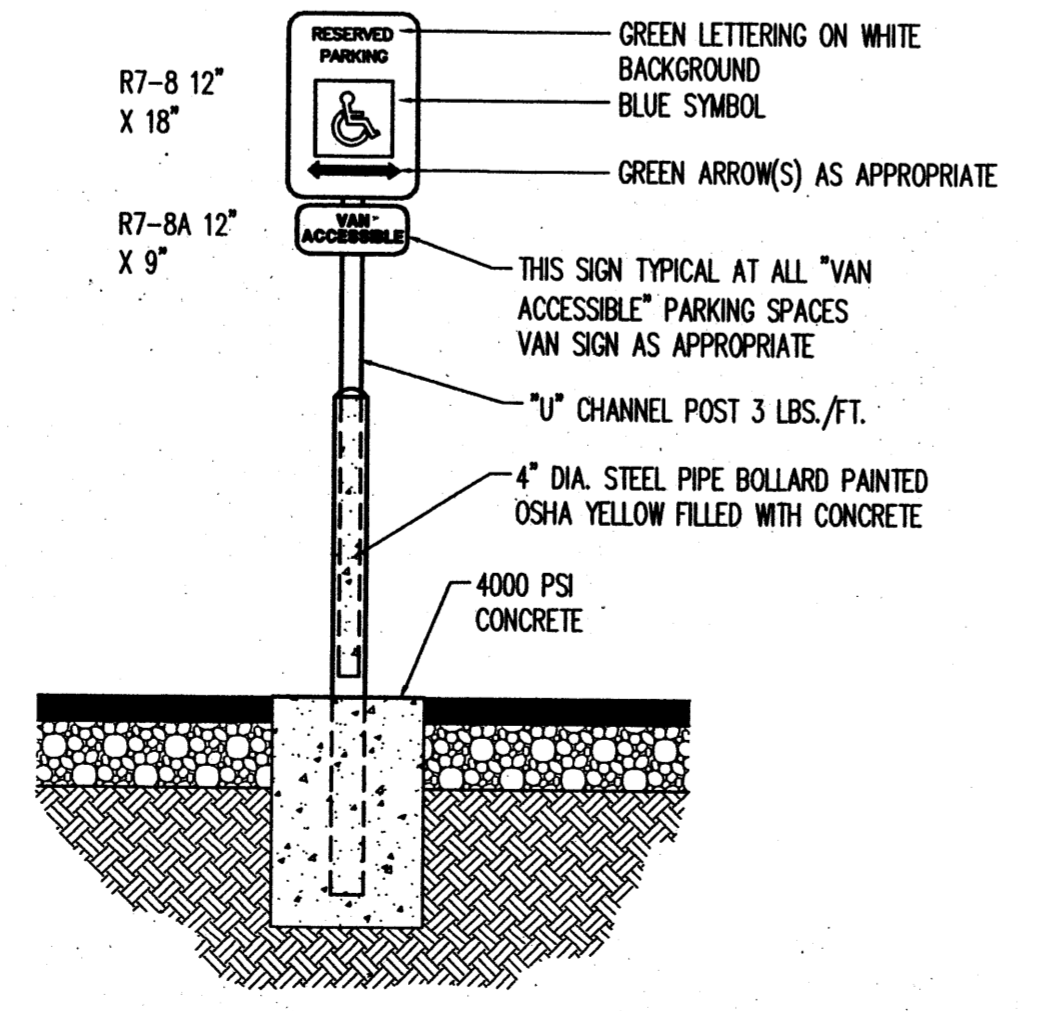

1 HANDICAP PARKING SIGN MOUNTING DETAIL
 N.T.S. ONE AT EACH HANDICAP SPACE.

NORTH DIVERSION CHANNEL (AMAFCA)

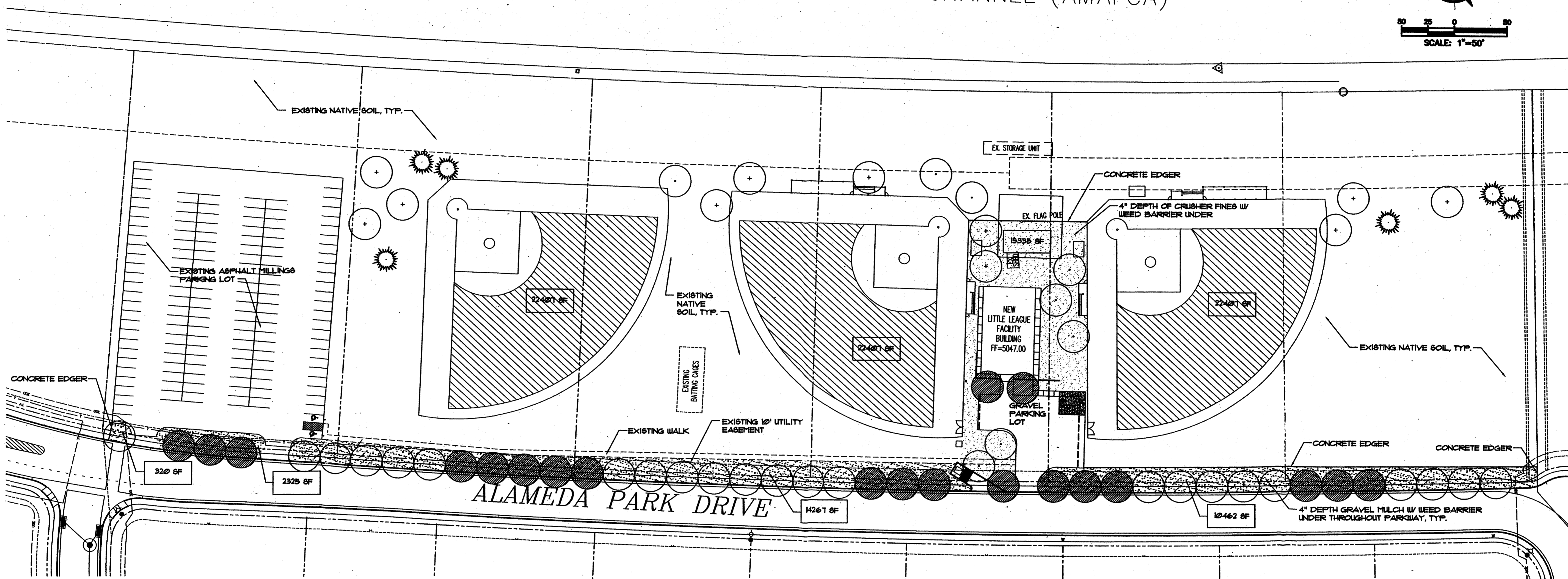
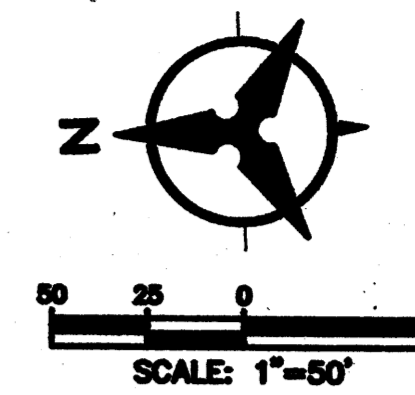

PLANT SCHEDULE		SIZE				
KEY	COMMON NAME	BOTANICAL NAME	QTY	INSTALLED	MATURE	COMMENTS
SHADE TREES						
	AUTUMN PURPLE ASH	FRAXINUS AMERICANA 'AUTUMN PURPLE'	20	2" CAL., 12'-14' HT.	25' HT. & 8FPD.	30" BOX
	SHADEMASTER HONEY LOCUST	GLEDITSIA TRIACANTHOS 'SHADEMASTER'	31	2" CAL., 12'-14' HT.	25' HT. & 8FPD.	30" BOX
	WESTERN HACKBERRY	CELTIS RETICULATA	11	2" CAL., 12'-14' HT.	30' HT. X 20' 8FPD.	30" BOX
EVERGREEN TREES						
	AUSTRIAN PINE	PINUS NIGRA	6	6'-8' ht.	20' ht. & 8pd.	24" BOX

NOTES:

1. THIS PLAN IS IN COMPLIANCE WITH THE CITY OF ALBUQUERQUE WATER CONSERVATION LANDSCAPING AND WATER WASTE ORDINANCE, ENACTMENT NO. 18-1938, SECTION 6-1-1-B (A) (1) FOR ATHLETIC FIELDS.
2. THIS PLAN IS IN COMPLIANCE WITH THE CITY OF ALBUQUERQUE STREET TREE ORDINANCE.
3. MAINTENANCE OF THE LANDSCAPE SHALL BE THE RESPONSIBILITY OF THE ALAMEDA LITTLE LEAGUE.
4. LANDSCAPE IRRIGATION WILL BE AN AUTOMATIC BUBBLER SYSTEM W/ A REDUCED PRESSURE PRINCIPLE BACKFLOW PREVENTER.

LANDSCAPE REQUIREMENTS
TOTAL LOT AREA: 510,215 SF
BUILDING AREA: 406,0 SF
NET LOT AREA: 506,215 SF (TOTAL - BUILDING + NET)
TOTAL LANDSCAPED AREA REQUIRED (15% OF NET): 75,932 SF
TOTAL LANDSCAPED AREA PROVIDED: 109,930 (22% OF NET)

**MORROW REARDON
WILKINSON MILLER, LTD.
LANDSCAPE ARCHITECTS**

210 La Veta NE, Albuquerque, NM 87106
505.263.2295 FAX 505.265.9637
mrw@mrwm.com

Bohannon & Huston

Consulting | 7800 Jefferson Dr. NE Albuquerque, NM 87109-4395
ENGINEERING • SPATIAL DATA • ADVANCED TECHNOLOGIES

**CITY OF ALBUQUERQUE
PARKS AND RECREATION DEPARTMENT**

TITLE: ALAMEDA LITTLE LEAGUE FACILITY - CONCEPTUAL LANDSCAPE PLAN JULY, 2005
SITE DEVELOPMENT PLAN FOR BUILDING PERMIT

Design Review Committee City Engineer Approval

City Project No. Zone Map No. Sheet Of
C-16-Z 2 6

AS BUILT INFORMATION		BENCHMARK		SURVEY INFORMATION		ENGINEER'S SEAL		REVISIONS / REMARKS	
CONTRACTOR	DATE	AMAFCA Brass Tablet stamped "NOC - 7"	N.M. State Plane Coordinates (Central Zone)	NO.	BY	NO.	DATE	NO.	DATE
WORK STAKED BY	DATE	X = 394,094.80	Y = 1,522,635.84						
INSPECTOR'S APPROVAL	DATE	Ground - Io - Grid Factor = 0.99987075	at = 001215"						
FIELD VERIFICATION BY	DATE	Elevation = 5062.6							
DRAWING CORRECTED BY	DATE								
MICRO-FILM INFORMATION	DATE								
RECORDED BY	DATE								
	NO.								

P:\050203\cdp\arch\MRWA07-22-05\Landscape Plan.dwg, Model
July 25, 2005 - 7:17am
P:\Year-2005\6505\6505-acad\6505-current\6505-base\6505-Site Dev Plan.dwg
Jul 22, 2005 - 1:42pm
P:\Year-2005\6505\6505-acad\6505-current\6505-base\6505-Site Dev Plan.dwg, 7/22/2005 1:42:30 PM, pccgbum, 1:1

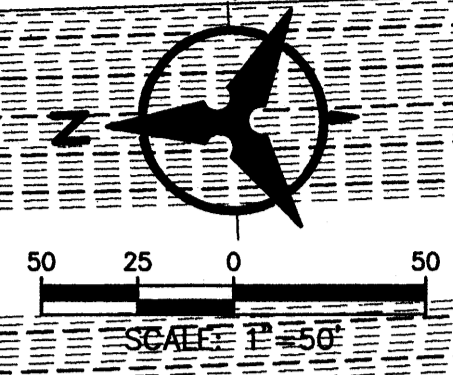
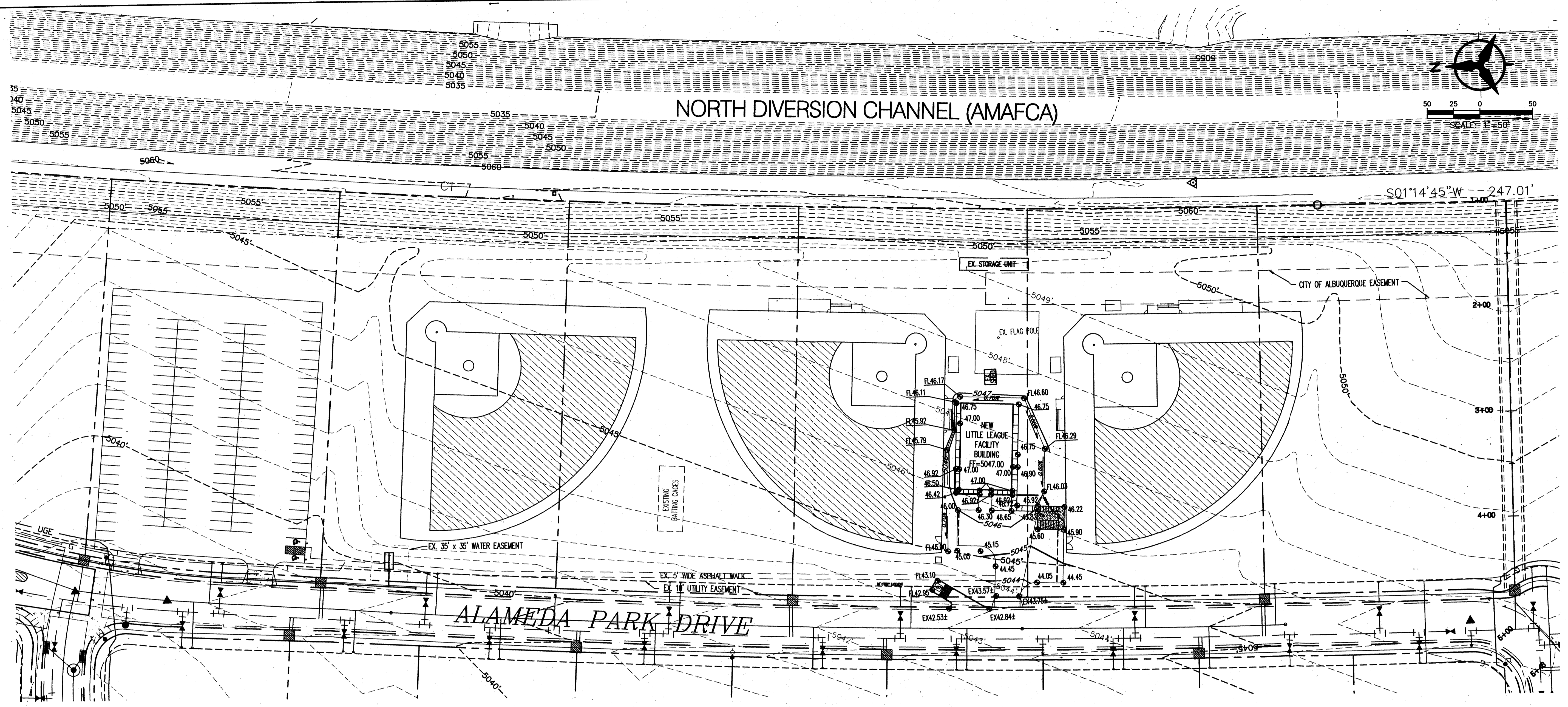

EXISTING GRADING OF THE LITTLE LEAGUE IS IN ACCORDANCE WITH CITY PROJECT # 723481. PROPOSED GRADING FOR THE CONCESSION STAND AREA IS PER THE APPROVED GRADING & DRAINAGE PLAN DATED 11/15/04, CITY HYDROLOGY FILE C16/D688

LEGEND

—	PROPERTY LINE
- - - 5040 - - -	EXISTING CONTOUR
- - - 35 - - -	PROPOSED INDEX CONTOUR
- - - 32 - - -	PROPOSED INTERMEDIATE CONTOUR
⊕ 32.40	EXISTING SPOT ELEVATION
⊙ 32.40	PROPOSED SPOT ELEVATION
FL = FLOWLINE	
TS = TOP OF SIDEWALK	
FGH = FINISHED GROUND HIGH SIDE	
FL = FINISHED GROUND LOW SIDE	
→	DIRECTION OF FLOW
↘	SLOPE SYMBOL

Bohannon & Huston
 Courtyard 1 7500 Jefferson St. NE Albuquerque, NM 87109-4335
 ENGINEERING • SPATIAL DATA • ADVANCED TECHNOLOGIES

CITY OF ALBUQUERQUE
PARKS AND RECREATION DEPARTMENT

TITLE: ALAMEDA LITTLE LEAGUE FACILITY JULY, 2005
SITE DEVELOPMENT PLAN FOR BUILDING PERMIT - GRADING PLAN

Design Review Committee	City Engineer Approval	NO. / DATE / YR.	NO. / DATE / YR.

City Project No. _____ Zone Map No. C-16-Z Sheet 3 Of 6

AS BUILT INFORMATION		BENCHMARK		SURVEY INFORMATION		ENGINEER'S SEAL		REVISIONS / REMARKS		BY	
CONTRACTOR	DATE:	AMAFCA Brass Tablet stamped "NDC - 7"	N.M. State Plane Coordinates (Central Zone)	NO.	BY	NO.	DATE	NO.	DATE	NO.	DATE
WORK STAGED BY	DATE:	X = 394,094.80	Y = 1,522,635.84								
INSPECTOR'S APPROVAL	DATE:	Ground - To - Grid Factor = 0.99967075									
FIELD VERIFICATION BY	DATE:										
DRAWING CORRECTED BY	DATE:										
MICRO-FILM INFORMATION	DATE:										
RECORDED BY	NO.	Elevation = 5062.6									

AMAFCA NORTH DIVERSION CHANNEL

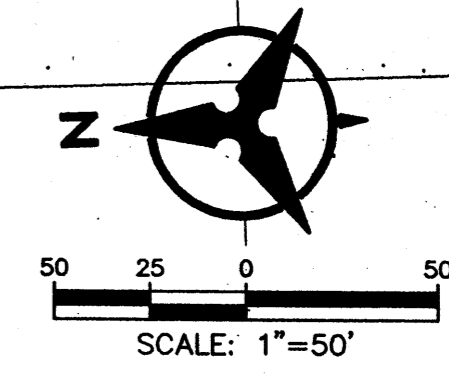

NORTH DIVERSION CHANNEL (AMAFCA)

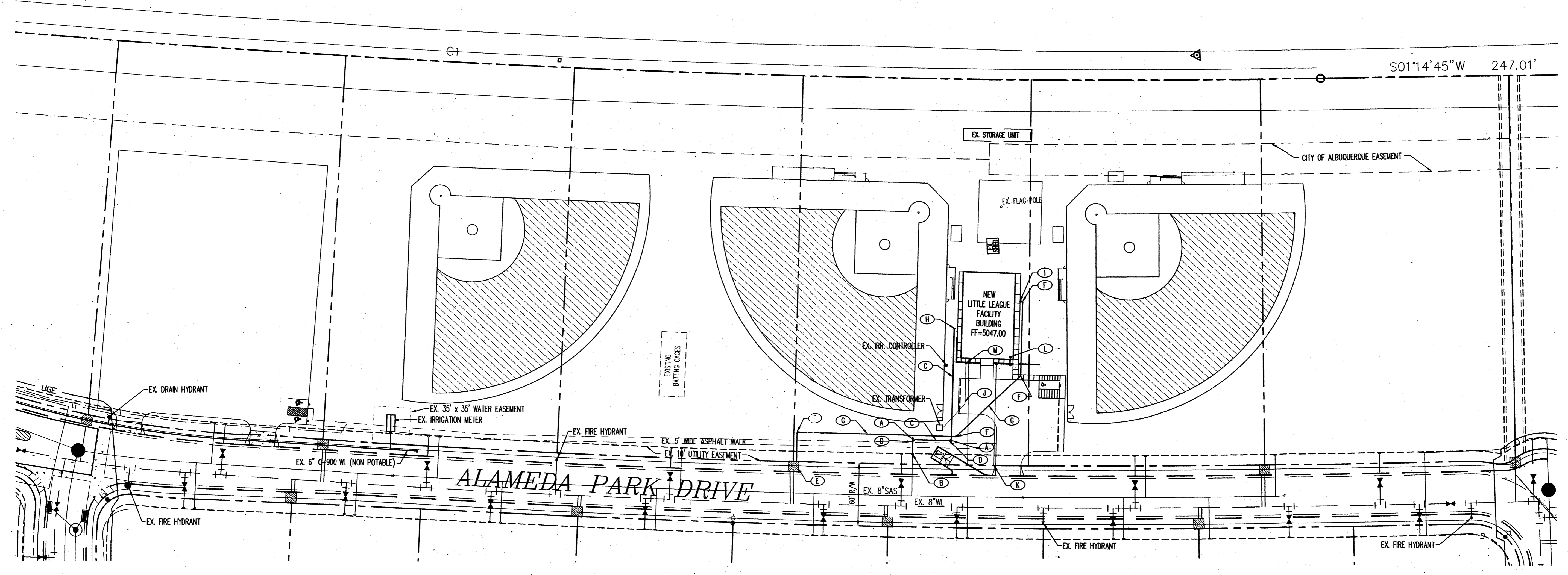

(A) UTILITY KEYED NOTES

- A. INSTALL 4" SANITARY SEWER CLEANOUT.
 - B. CONNECT TO EXISTING 6" SANITARY SEWER SERVICE AND INSTALL 6"x4" REDUCER.
 - C. INSTALL 4" SANITARY SEWER SERVICE.
 - D. INSTALL 4" 90° WYE.
 - E. CONNECT 1.5" WATER LINE SERVICE TO EXISTING 2" WATER METER.
 - F. INSTALL 1.5" 90° BEND.
 - G. INSTALL 1.5" WATER LINE SERVICE.
 - H. END 4" SANITARY SEWER SERVICE. CONNECT TO PROPOSED GREASE TRAP AND DOMESTIC SERVICE LINE.
 - I. END 1.5" WATER LINE SERVICE 5 FEET FROM BUILDING.
 - J. INSTALL 1-4" CONDUIT FOR PROPOSED ELECTRIC SERVICE.
 - K. INSTALL 1" GAS SERVICE. VERIFY EXISTING MAIN LOCATION WITH PNM.
 - L. INSTALL NEW FIRE DEPARTMENT CONNECTION AND SPRINKLER RISER.
 - M. NEW 2" CONDUIT TO STREET WITH PULL CORD FOR PHONE SERVICE.
- NOTE: CONTRACTOR TO VERIFY LOCATION OF ALL EXISTING SERVICE CONNECTIONS PRIOR TO CONSTRUCTION.

AS BUILT INFORMATION		BENCHMARK		SURVEY INFORMATION		ENGINEER'S SEAL		REVISIONS / REMARKS		BY	
CONTRACTOR	DATE	AMAFCA Brass Tablet stamped "NDC - 7"	N.M. State Plane Coordinates (Central Zone)	NO.	FIELD NOTES	NO.	DATE	NO.	DATE	NO.	DATE
WORK STAKED BY	DATE	X = 394,094.80	Y = 1,522,635.84								
INSPECTOR'S APPROVAL	DATE	Ground - To - Grid Factor = 0.99967075	Grid - To - Grid Factor = 0.99967075								
FIELD VERIFICATION BY	DATE	Grid - To - Grid Factor = 0.99967075	Grid - To - Grid Factor = 0.99967075								
DRAWING CORRECTED BY	DATE	Grid - To - Grid Factor = 0.99967075	Grid - To - Grid Factor = 0.99967075								
MICRO-FILM INFORMATION	DATE	Grid - To - Grid Factor = 0.99967075	Grid - To - Grid Factor = 0.99967075								
RECORDED BY	NO.	Elevation = 5062.6	Elevation = 5062.6								
DESIGNED BY:	DATE:										
DRAWN BY:	DATE:										
CHECKED BY:	DATE:										

Bohannon & Huston
Courtyard I 7500 Jefferson St. NE Albuquerque, NM 87109-4335
 ENGINEERING • SPATIAL DATA • ADVANCED TECHNOLOGIES

**CITY OF ALBUQUERQUE
 PARKS AND RECREATION DEPARTMENT**

TITLE: ALAMEDA LITTLE LEAGUE FACILITY JULY, 2005
 SITE DEVELOPMENT PLAN FOR BUILDING PERMIT - UTILITY PLAN

Design Review Committee	City Engineer Approval	NO. / DATE	NO. / DATE
UTILITY PLAN			

City Project No. Zone Map No. Sheet Of

C-16-Z 6 6

NORTH DIVERSION CHANNEL (AMAFCA)

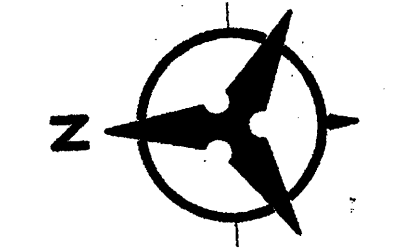

SCALE: 1"=50'

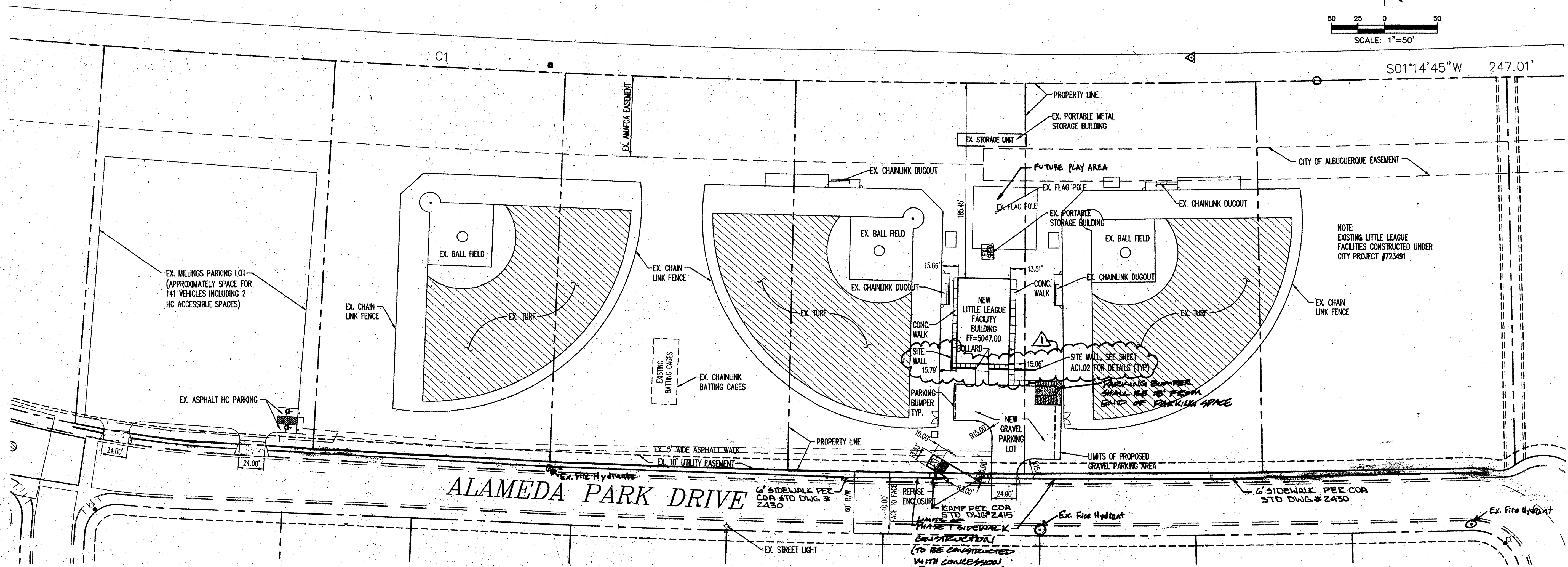

NOTE: EXISTING LITTLE LEAGUE FACILITIES CONSTRUCTED UNDER CITY PROJECT #723491

ALAMEDA PARK DRIVE

PARKING CALCULATIONS

Concession Area
 Parking Requirements, per IBC, 2003 and COA Zoning Code (latest edition) 14-16-3-1 are as follows:
 Storage: Use 17: 964 NSF = 1 parking space
 Kitchen: Use 27: 580 NSF = 3 parking spaces
 Office: Use 21: 990 NSF = 5 parking spaces

Spectator Viewing Area
 Parking Requirements, per COA Zoning Code (latest edition) 14-16-3-1 (23)
 Recreation, outdoor: One space per 200 square feet of site where customers circulate, participate in, or watch the recreation.
 Area = 20,254sf / 200 = 101.27 required

LEGAL DESCRIPTION

LOTS 22, 23, 24, 25, 26, & 27 OF ALAMEDA BUSINESS PARK

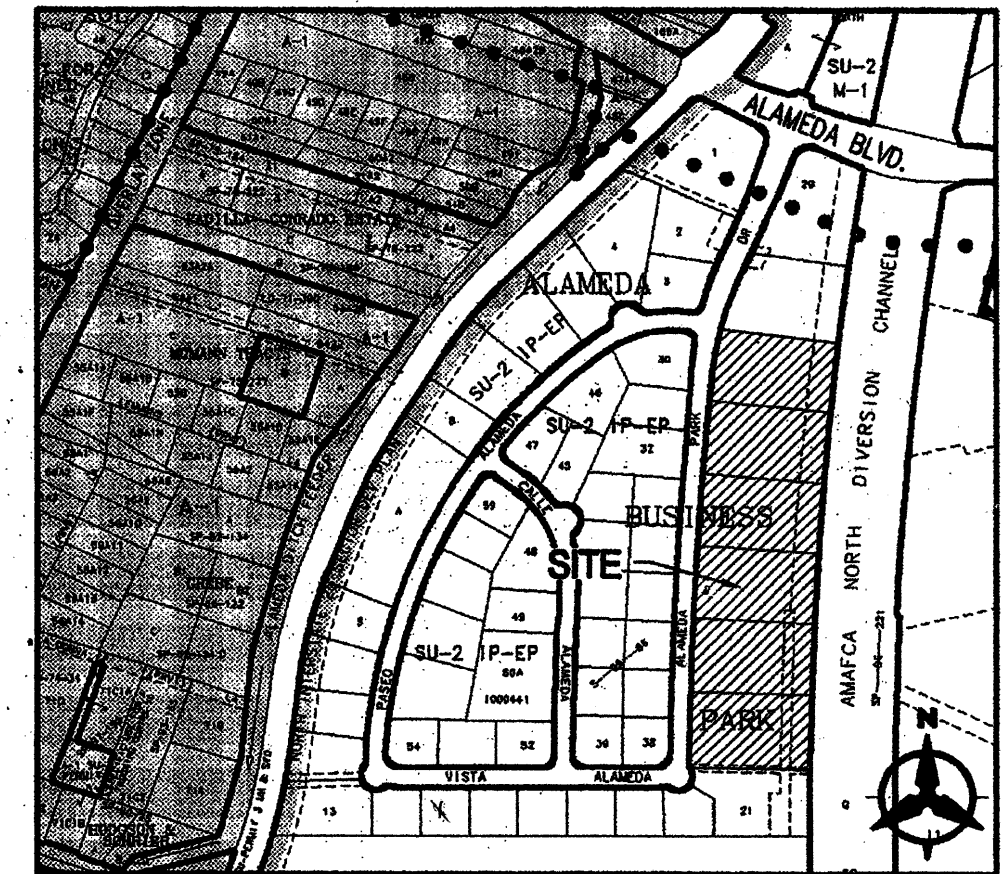

VICINITY MAP
 ZONE ATLAS PAGE C-16-Z
 SCALE: 1"=600±

PROJECT 1004343
 DRB ADM AMENDMENT

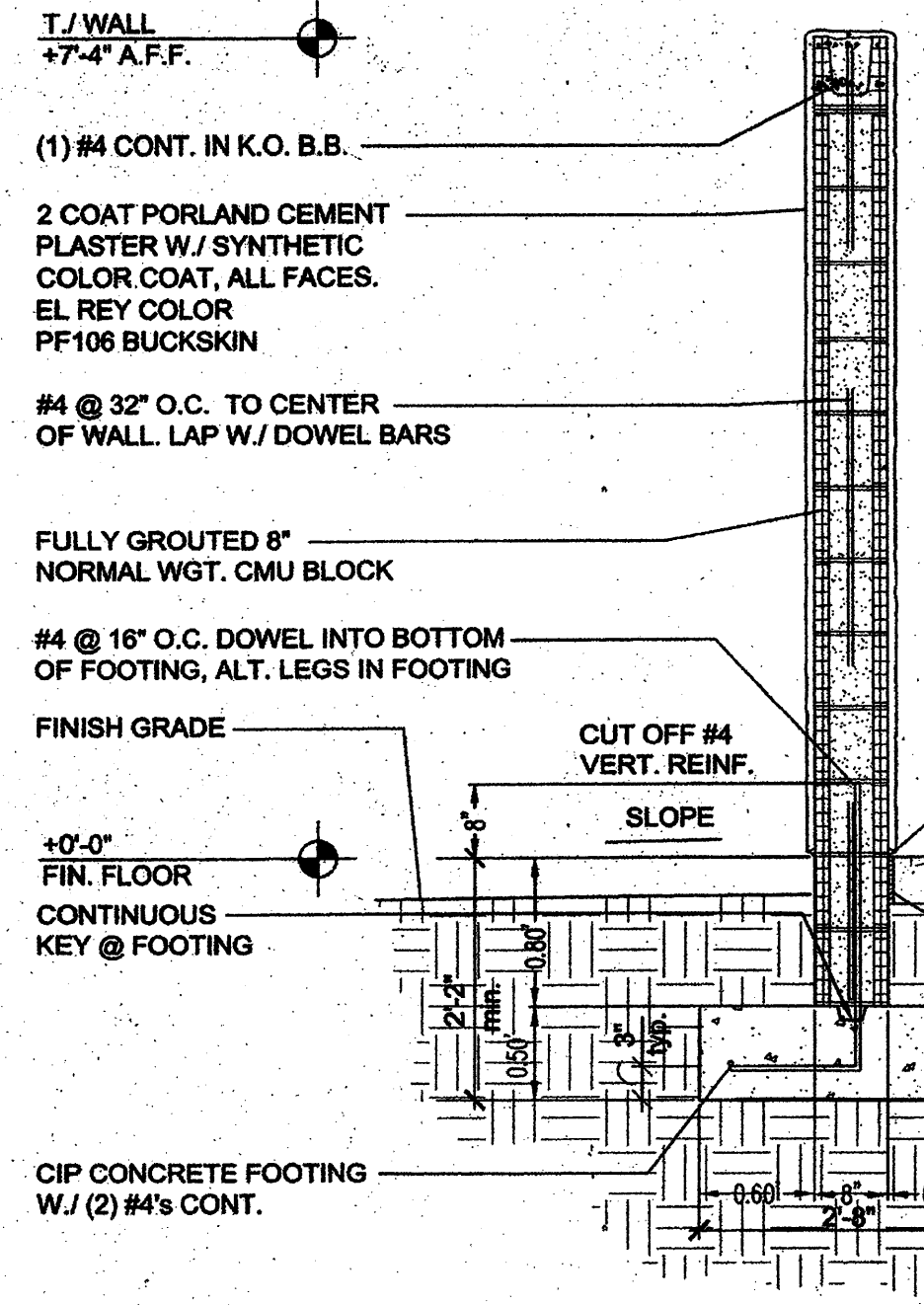

3 REFUSE ENCLOSURE DETAIL
 N.T.S.

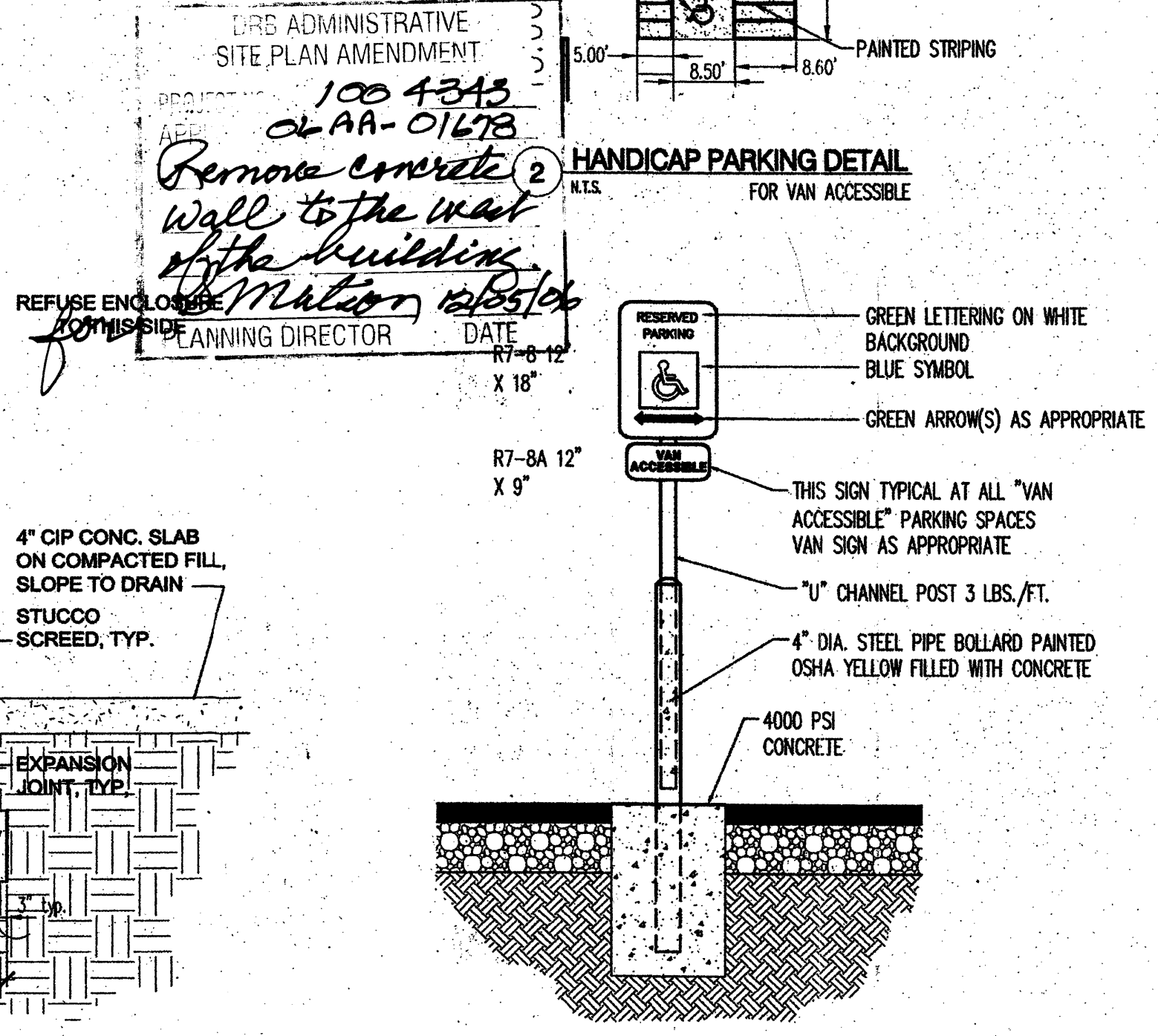

1 HANDICAP PARKING SIGN MOUNTING DETAIL
 N.T.S.
 ONE AT EACH HANDICAP SPACE.

DRB ADMINISTRATIVE
 SITE PLAN AMENDMENT
 1004343
 OR AA-0167B
 Remove concrete wall to the west of the building
 Matteson
 Planning Director
 DATE: 7/8/05
 X 18"

PLANS CHECKING OFF
 924-3031
 APPROVED APPROX
 10/11/05
 10/11/05

DELETE CMU SITE WALL R.J. 10/11/05

PROJECT NUMBER: 1004343

Application Number: 05DRB-01213

is an Infrastructure List required? () Yes (X) No. If yes, then a set of approved DRB plans with a work order is required for any construction within Public Right-of-Way or for construction of public improvements.

DRB SITE DEVELOPMENT PLAN APPROVAL:

Mike Sny	12/14/05
Traffic Engineering, Transportation Division	Date
William G. Baker	12/14/05
Water Utility Department	Date
Christine Dandora	12/14/05
Parks and Recreation Department	Date
Bradley K. Bingham	12/14/05
City Engineer	Date
N/A	
Environmental Health Department (conditional)	Date
Michael Holton	7/22/05
Solid Waste Management	Date
Matteson	12/14/05
DRB Chairperson, Planning Department	Date

PROJECT DATA	
Zoning (Existing)	= SU-2 IP-EP
Zoning (Proposed)	= SU-2 IP-EP
Site Area	= --- (Lots 22,23,24,25,26,27)
Building Area	= 4,070 sf
Parking Required - Concession Area	= 9 spaces
Parking Provided - Concession Area	= 11 spaces including 1 HC space
Parking Required - Spectator Viewing Area	= 101 spaces
Parking Provided - Spectator Viewing Area	= 141 spaces including 2 HC spaces

BICYCLE PARKING: 2 REQUIRED, 2 PROVIDED

Bohannon & Huston
 Courtyard 1 7500 Jefferson St. NE Albuquerque, NM 87109-4335
 ENGINEERING • SPATIAL DATA • ADVANCED TECHNOLOGIES

**CITY OF ALBUQUERQUE
 PARKS AND RECREATION DEPARTMENT**

TITLE: ALAMEDA LITTLE LEAGUE FACILITY JULY, 2005
 SITE DEVELOPMENT PLAN FOR BUILDING PERMIT - SITE PLAN

Design Review Committee	City Engineer Approval
-------------------------	------------------------

City Project No. _____ Zone Map No. C-16-Z Sheet 1 Of 6

AS BUILT INFORMATION	
CONTRACTOR	AMAFCA Brass Tablet stamped "NDC - 7"
DATE	
WORK STAKED BY	
INSPECTOR'S APPROVAL	
DATE	
FIELD VERIFICATION BY	
DATE	
DRAWING CORRECTED BY	
DATE	
MICRO-FILM INFORMATION	
RECORDED BY	
DATE	
NO.	

SURVEY INFORMATION	
FIELD NOTES	
BY	
NO.	

ENGINEER'S SEAL	
BY	
DATE	
DATE	
DATE	