

(A) = FOOTING TO REMAIN OUTSIDE PUBLIC ROW. (PERIMETER RETAINING WALL/GARDEN WALL)

- LANDSCAPE BUFFER NOTES:**
- Swale to be 6" deep when the distance between back of curb and the sidewalk is 5 feet.
 - Swale to be 1" deeper than the distance in feet between the back of curb and the sidewalk for landscape buffers different than 5 feet wide.
 - For wide landscape buffers, greater than 10 feet, the maximum depth is 10 inches.
 - Final grade of dirt to be 1 to 2 inches below top of curb and top of sidewalk grade.
 - Surface between back of curb and sidewalk to be covered with gravel mulch (minimum 3/4"), cobbles or rip-rap. Do not fill entire swale.
 - A check dam will be required for swales on steeper longitudinal slopes and longer sections. The engineer will determine the location.
 - Landscape fabric is recommended, but not required, between the dirt and the stone. If landscape fabric is to be used it is to be permeable.
 - Detail is to be built for all new construction. In the case where the sidewalk is existing and the landscape buffer is improved with landscaping and/or some form of erosion protection, this requirement does not apply.

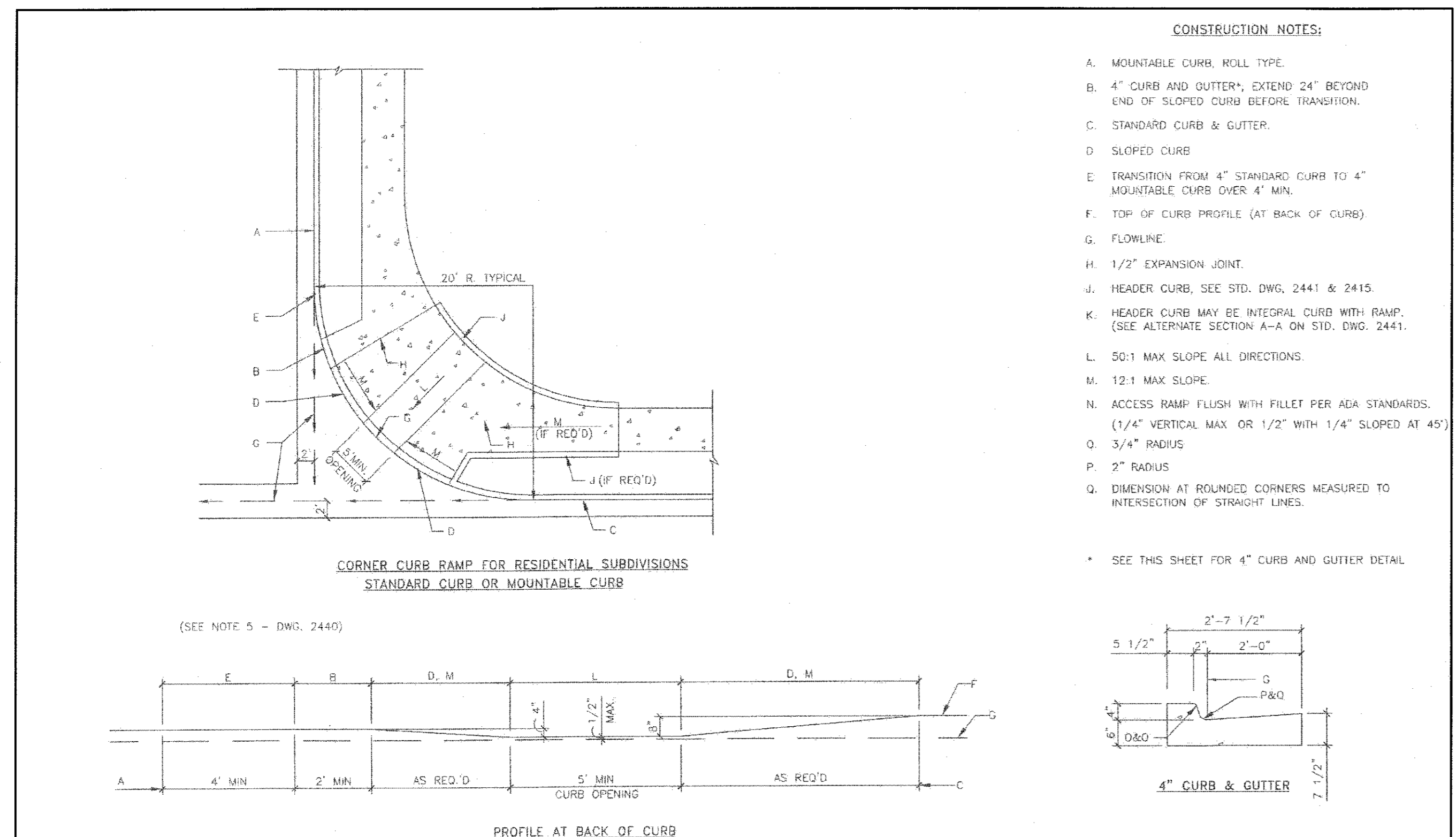

- CONSTRUCTION NOTES:**
- MOUNTABLE CURB, ROLL TYPE.
 - 4" CURB AND GUTTER*, EXTEND 24" BEYOND END OF SLOPED CURB BEFORE TRANSITION.
 - STANDARD CURB & GUTTER.
 - SLOPED CURB
 - TRANSITION FROM 4" STANDARD CURB TO 4" MOUNTABLE CURB OVER 4" MIN.
 - TOP OF CURB PROFILE (AT BACK OF CURB).
 - FLOWLINE.
 - 1/2" EXPANSION JOINT.
 - HEADER CURB, SEE STD. DWG. 2441 & 2415.
 - HEADER CURB MAY BE INTEGRAL CURB WITH RAMP. (SEE ALTERNATE SECTION A-A ON STD. DWG. 2441).
 - S0:1 MAX SLOPE ALL DIRECTIONS.
 - 12:1 MAX SLOPE.
 - ACCESS RAMP FLUSH WITH FILLET PER ADA STANDARDS. (1/4" VERTICAL MAX OR 1/2" WITH 1/4" SLOPED AT 45°)
 - 3/4" RADIUS
 - 2" RADIUS
 - DIMENSION AT ROUNDED CORNERS MEASURED TO INTERSECTION OF STRAIGHT LINES.
- * SEE THIS SHEET FOR 4" CURB AND GUTTER DETAIL

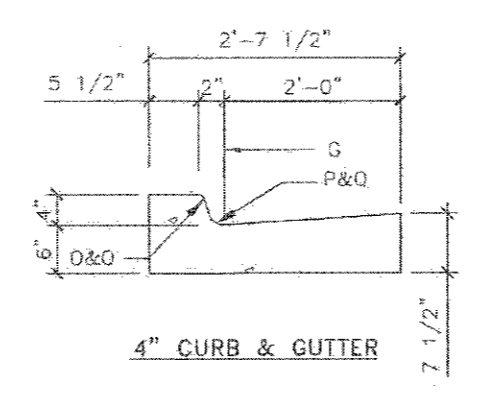

| AS BUILT INFORMATION | | CONTRACTOR | | DATE | |
|---------------------------|------|---------------------------|------|---------------------------|------|
| CONTRACTOR | DATE | CONTRACTOR | DATE | CONTRACTOR | DATE |
| WORK BY | DATE | WORK BY | DATE | WORK BY | DATE |
| INSPECTOR'S ACCEPTANCE BY | DATE | INSPECTOR'S ACCEPTANCE BY | DATE | INSPECTOR'S ACCEPTANCE BY | DATE |
| DESIGNATION BY | DATE | DESIGNATION BY | DATE | DESIGNATION BY | DATE |
| DRAWINGS CORRECTED BY | DATE | DRAWINGS CORRECTED BY | DATE | DRAWINGS CORRECTED BY | DATE |
| MICRO-FILM INFORMATION | DATE | MICRO-FILM INFORMATION | DATE | MICRO-FILM INFORMATION | DATE |
| RECORDED BY | DATE | RECORDED BY | DATE | RECORDED BY | DATE |
| NO. | | NO. | | NO. | |

| BENCH MARKS | | DATE | |
|-------------------------------------|------|-------------------------------------|------|
| CONTRACTOR | DATE | CONTRACTOR | DATE |
| AGRS Brass Cap stamped "10-C18" | | AGRS Brass Cap stamped "10-C18" | |
| Elevation in feet (NAVD83)=5322.090 | | Elevation in feet (NAVD83)=5322.090 | |

| SURVEY INFORMATION | | FIELD NOTES | |
|--------------------|------|-------------|------|
| NO. | DATE | NO. | DATE |
| | | | |
| | | | |

| ENGINEER'S SEAL | | REVISIONS | |
|-----------------|------|-----------|------|
| NO. | DATE | NO. | DATE |
| | | | |
| | | | |

| DESIGNED BY | | DATE | |
|-------------|-------|-------------|-------|
| DESIGNED BY | DATE | DESIGNED BY | DATE |
| DLH | 06/16 | DLH | 06/16 |
| CHECKED BY | DATE | CHECKED BY | DATE |
| DMG | 06/16 | DMG | 06/16 |

dmg MARK GOODWIN & ASSOCIATES, P.A.
CONSULTING ENGINEERS
P.O. BOX 90606
ALBUQUERQUE, NEW MEXICO 87199
OFFICE (505) 828-2200, FAX (505) 797-9539

CITY OF ALBUQUERQUE
PUBLIC WORKS DEPARTMENT

TITLE: **GLENDESTO SUBDIVISION MASTER PAVING PLAN**

| DESIGN REVIEW COMMITTEE | CITY ENGINEER APPROVAL | MO./DAY/YR. | MO./DAY/YR. |
|-------------------------|------------------------|-------------|-------------|
| | | | |
| | | | |

CITY PROJECT NO. _____ ZONE MAP NO. **B-18-Z** SHEET **2** OF **X**