

**GRADING PLAN**

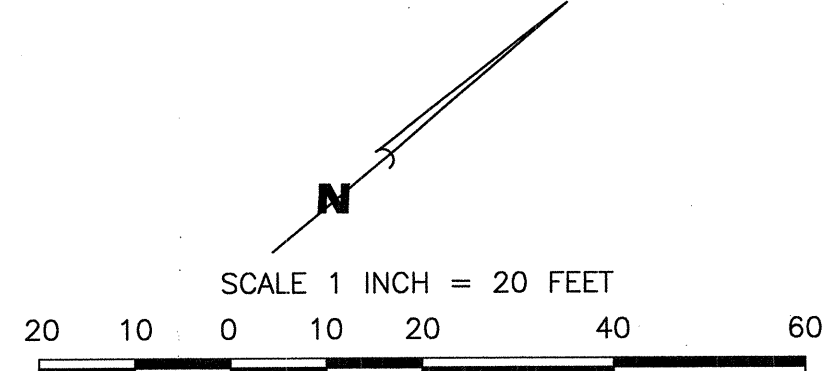

**VICINITY MAP NO. F-11**

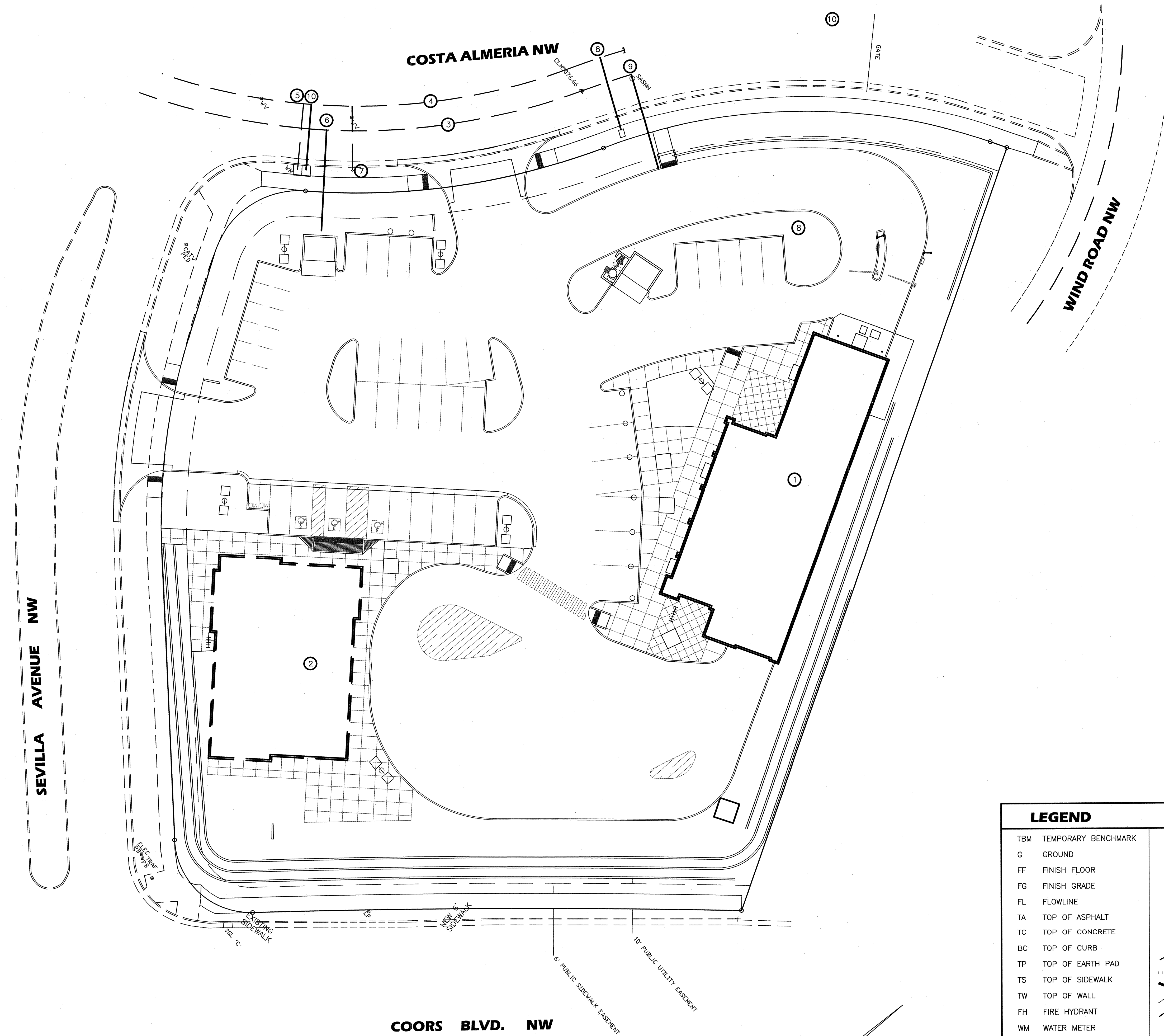
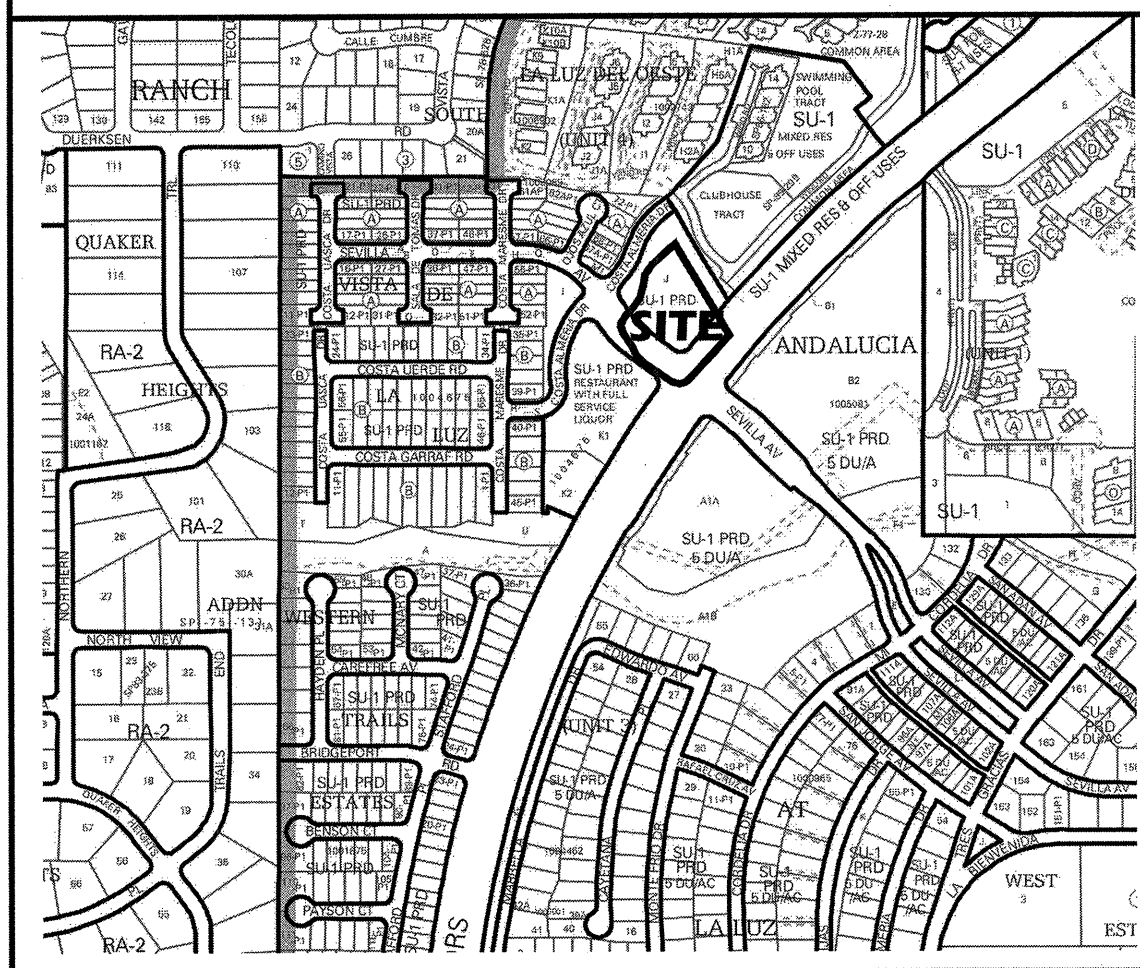

**KEYED NOTES**

1. PROPOSED CAR WASH.
2. PROPOSED BUILDING SHELL.
3. EXISTING 8" PVC SAS.
4. EXISTING 8" PVC WATER.
5. EXISTING 3/4" WATER SERVICE. USE FOR IRRIGATION SYSTEM.
6. EXISTING 4" SAS SERVICE.
7. EXISTING 6" WATER LINE WITH GATE VALVE. INSTALL FIRE HYDRANT.
8. PROPOSED 2" WATER SERVICE AND METER BOX.
9. PROPOSED 4" SAS SERVICE.
10. PROPOSED 1" WATER SERVICE.

**LEGAL DESCRIPTION**

TRACT 'J', VISTA DE LA LUZ

**PERMANENT BENCHMARK**

ACS STATION 11-F11, ELEVATION 5029.526 (NAVD 1988)

**LEGEND**

TBM	TEMPORARY BENCHMARK	GM	GAS METER
G	GROUND	GV	GAS VALVE
FF	FINISH FLOOR	LP	LIGHT POLE
FG	FINISH GRADE	PP	POWER POLE
FL	FLOWLINE	GW	GUY WIRE
TA	TOP OF ASPHALT	PED	ELEC. OR TEL. PEDESTAL
TC	TOP OF CONCRETE	RD	ROOF DRAINAGE POINT
BC	TOP OF CURB		
TP	TOP OF EARTH PAD	(dashed line)	FEMA FLOODPLAIN BOUNDARY
TS	TOP OF SIDEWALK	(dotted line)	DRAINAGE BASIN BOUNDARY
TW	TOP OF WALL	(solid line)	EROSION SETBACK LINE
FH	FIRE HYDRANT	(dashed line)	EXISTING CONTOUR
WM	WATER METER	(solid line)	PROPOSED CONTOUR
WV	WATER VALVE	(dotted line)	EXISTING SPOT ELEVATION
MH	MANHOLE	(dotted line with cross)	PROPOSED SPOT ELEVATION
CB	CATCH BASIN GRATE	(dotted line with cross)	RECORD SPOT ELEVATION

no.	date	remarks	by

REVISIONS

			project title <b>X</b> 5401 SEVILLA AVE. NW ALBUQUERQUE, NM
sheet title <b>WET UTILITY PLAN</b>			project no. 1518
drawn by meto	design by JJB	sheet	
09/01/16			

**BORDENAVE DESIGNS**  
P.O. BOX 91194, ALBUQUERQUE, NM 87199  
(505)823-1344 FAX (505)821-9105