

LOCATION MAP 1"=750' C-18-Z

PLAT OF
 LOT 9-P1
 BLOCK 2
 UNIT 4
 EAGLE ROCK ESTATES
 WITHIN THE
 ELENA GALLEGOS GRANT
 PROJECTED SECTION 13
 TOWNSHIP 11 NORTH, RANGE 3 EAST, NMPM
 CITY OF ALBUQUERQUE
 BERNALILLO COUNTY, NEW MEXICO
 SEPTEMBER, 2005

PROJECT NUMBER: 1004712
 Application Number: 06DRB-00233

PLAT APPROVAL

Utility Approvals:

<u>Leah D. Mark</u>	<u>5-10-06</u>
PNM Electric Services Division	Date
<u>Leah D. Mark</u>	<u>5-10-06</u>
PNM Gas Services Division	Date
<u>Don Crabtree</u>	<u>5-10-06</u>
Quest	Date
<u>Ann B. Baker</u>	<u>5-5-06</u>
Comcast	Date
City Approval: <u>M.B. Ford</u>	<u>10-31-05</u>
City Surveyor	Date
<u>N/A</u>	<u>3/29/07</u>
Real Property Division	Date
<u>N/A</u>	<u>3/29/07</u>
Environmental Health Department	Date
<u>Mike E. [Signature]</u>	<u>04-12-06</u>
Traffic-Engineering, Transportation Division	Date
<u>Roger A. [Signature]</u>	<u>4-12-06</u>
Utilities Development	Date
<u>Christina Santoral</u>	<u>4/12/06</u>
Parks and Recreation Department	Date
<u>Bradley L. Bingham</u>	<u>3/29/07</u>
AMAFCA	Date
<u>Bradley L. Bingham</u>	<u>3/29/07</u>
City Engineer	Date
<u>[Signature]</u>	<u>3/29/07</u>
DRB Chairperson, Planning Department	Date

DESCRIPTION

A tract of land situate within the Elena Gallegos Grant, projected Section 13, Township 11 North, Range 3 East, New Mexico Principal Meridian, City of Albuquerque, Bernalillo County, New Mexico being all of a Temporary Public Drainage Easement within BLOCK 2, UNIT 4, EAGLE ROCK ESTATES as the same is shown and designated on said plat filed for record in the office of the County Clerk of Bernalillo County, New Mexico on July 12, 1999, Book 99C, Page 180 and containing 0.1640 acres more or less.

PURPOSE OF PLAT

- To create Lot 9-P1 as shown hereon.
- To vacate a Temporary Public Drainage Easement

SUBDIVISION DATA

- Project No.:
Application No.:
- Zone Atlas Index No.: C-18-Z
- Total Number of Existing Lots: 0
- Total Number of Existing Tracts: 1
- Total Number of Lots created: 1
- Total Number of Tracts created: 0
- Gross Subdivision Acreage: 0.1640

NOTES

- Bearings are New Mexico State Plane Grid Bearings (Central Zone).
- Distances are ground distances.
- Bearings and distances are field and record.
- Basis of boundary is from the plats of record entitled:
Plat Of "NORTH ALBUQUERQUE ACRES, TRACT A, UNIT B"
(04-24-36, D-130)
Plat Of "EAGLE ROCK ESTATES, UNIT 4"
(07-12-99, 99C-180)
all being records of Bernalillo County, New Mexico.
- Field Survey: performed April, 1999.
- Title Report: None provided.
- Address of Property: None provided.
- City of Albuquerque, New Mexico Zone: R-D
- Utility Council Location System Log No.: 2002480773

2887851323
 6534276
 Page: 1 of 2
 04/05/2007 03:18P
 Bk-2887C Pg-83
 Maggie Toulouse Bern. Co. PLAT R 12.00

THIS IS TO CERTIFY THAT THESE ARE CURRENT AND
 PAID ON UPC # 10 13059 119 310 20419
 PROPERTY OWNER OF RECORD
 has Maran [Signature]
 BERNALILLO COUNTY TREASURER'S OFFICE
 [Signature] 4-5-07

FREE CONSENT AND DEDICATION

The subdivision hereon described is with the free consent and in accordance with the desires of the undersigned owner(s) and/or proprietor(s) thereof and said owner(s) and/or proprietor(s) do hereby consent to the creating of Lot 9-P1 as shown hereon. Said owner(s) and/or proprietor(s) do hereby consent to all of the foregoing and do hereby certify that this subdivision is their free act and deed. Said owner(s) Warrants that (he/she) holds complete and indefeasible title in fee simple to the land subdivided.

Owner(s): Shakeel Rizvi
Shakeel Rizvi Oct 31, 2005
 SHAKEEL RIZVI Date

STATE OF NEW MEXICO
 BERNALILLO COUNTY
 On this 28 day of September, 2005, this instrument was acknowledged
 before me by Shakeel Rizvi
[Signature] 07-30-06
 Notary Public My Commission Expires

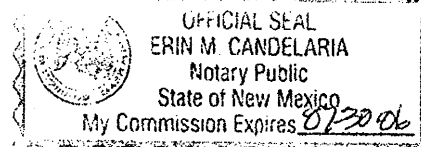

Owner(s): Adil Rizvi
Adil Rizvi Oct 31, 2005
 ADIL RIZVI Date

STATE OF NEW MEXICO)
 BERNALILLO COUNTY)
 On this 28 day of September, 2005, this instrument was acknowledged
 before me by Adil Rizvi
[Signature] 07-30-06
 Notary Public My Commission Expires

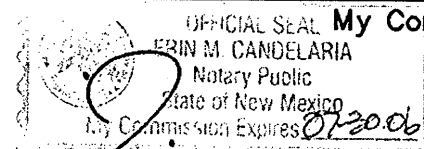

Owner(s): Esmail Haidari
Esmail Haidari Oct 13, 05
 ESMAIL HAIDARI Date

STATE OF NEW MEXICO)
 BERNALILLO COUNTY)
 On this 13 day of October, 2005, this instrument was acknowledged
 before me by Esmail Haidari
Ann M. Bauer March 29, 09
 Notary Public My Commission Expires

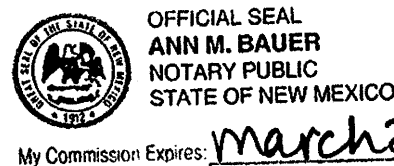

Drawn By:	ECM	Date:	09-30-05
Checked By:	TA	Drawing Name:	02089B2.DWG
Job No.:	02-089	Sheet:	1 of 2

SURVEYOR'S CERTIFICATION

"I, Timothy Aldrich, a duly qualified Registered Professional Land Surveyor under the laws of the State of New Mexico, do hereby certify that this plat and description were prepared by me or under my supervision, shows all easements as shown on the plat of record or made known to me by the owners and/or proprietors of the subdivision shown hereon, utility companies and other parties expressing an interest and meets the minimum requirements for monumentation and surveys of the Albuquerque Subdivision Ordinance, and further meets the Minimum Standards for Land Surveying in the State of New Mexico. This is true and correct to the best of my knowledge and belief.

[Signature] 09-30-05
 Timothy Aldrich, S. No. 17719 Date

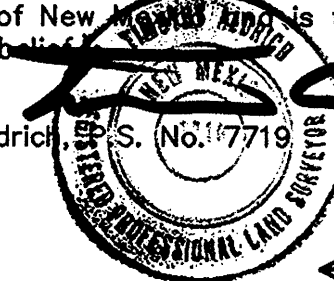

ALDRICH LAND SURVEYING

P.O. BOX 30701, ALBQ., N.M. 87190
 505-884-1990

PLAT OF
 LOT 9-P1
 BLOCK 2
 UNIT 4
 EAGLE ROCK ESTATES
 WITHIN THE
 ELENA GALLEGOS GRANT
 PROJECTED SECTION 13
 TOWNSHIP 11 NORTH, RANGE 3 EAST, NMPM
 CITY OF ALBUQUERQUE
 BERNALILLO COUNTY, NEW MEXICO
 SEPTEMBER, 2005

PROPERTY CORNERS

- FOUND 5/8" REBAR WITH CAP "ALS LS 7719"

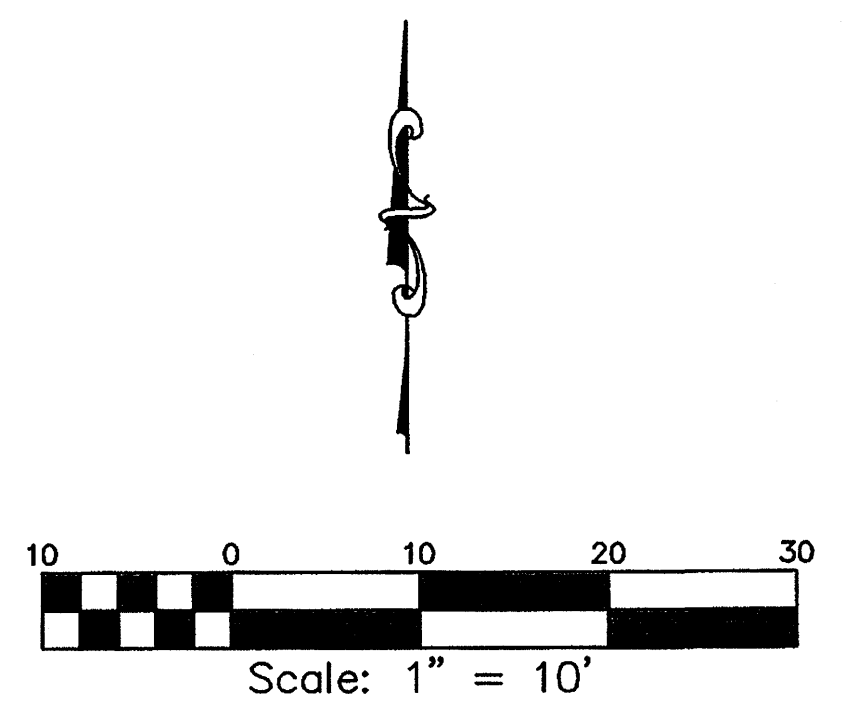

ACS MONUMENT
 "10-C18"
 Y=1524061.42
 X=402319.45
 G-G=0.9996613
 Δα=-00°11'18"
 CENTRAL ZONE
 (NAD 1927)
 ELEVATION=5219.41
 (NGVD 1929)

NORTH ALBUQUERQUE ACRES
 TRACT A, UNIT B, BLOCK 26
 (04-24-36, D-130)

LOT 12

N 00°12'38" E

MODESTO AVENUE NE
 (60' R/W)

S 89°41'47" E

55.18'

LOT 9-P1
 BLOCK 2
 0.1640 AC.

S 29°02'54" E

EAGLE ROCK ESTATES
 UNIT 4, BLOCK 2
 LOT 10-P1
 (07-12-99, 99C-180)

EXISTING 10' PRIVATE DRAINAGE EASEMENT
 (07-12-99, 99C-180) (Typ.)

N 65°15'48" W

EXISTING 10' P.U.E.
 (07-12-99, 99C-180)

LOT 8
 EAGLE ROCK ESTATES
 UNIT 4, BLOCK 2
 (07-12-99, 99C-180)

97.29'

SCHIST AVENUE NE
 (44' R/W)

OBISDIAN STREET NE
 (50' R/W)

2007051323
 6634279
 Page: 2 of 2
 04/05/2007 03:10P
 Bk-2007C Pg-83
 Maggie Toulouse Bern. Co. PLRT R 12.00

ALDRICH LAND SURVEYING
 09-30-05

NUMBER	ARC LENGTH	DELTA ANGLE	RADIUS	TANGENT	CHORD DIRECTION	CHORD LENGTH
C1	25.28'	36°12'55"	40.00'	13.08'	S 42°50'39" W	24.86'

Drawn By:	ECM	Date:	09-30-05
Checked By:	TA	Drawing Name:	02089B2.DWG
Job No.:	02-089	Sheet:	2 of 2

ALDRICH LAND SURVEYING
 P.O. BOX 30701, ALBQ., N.M. 87190
 505-884-1990

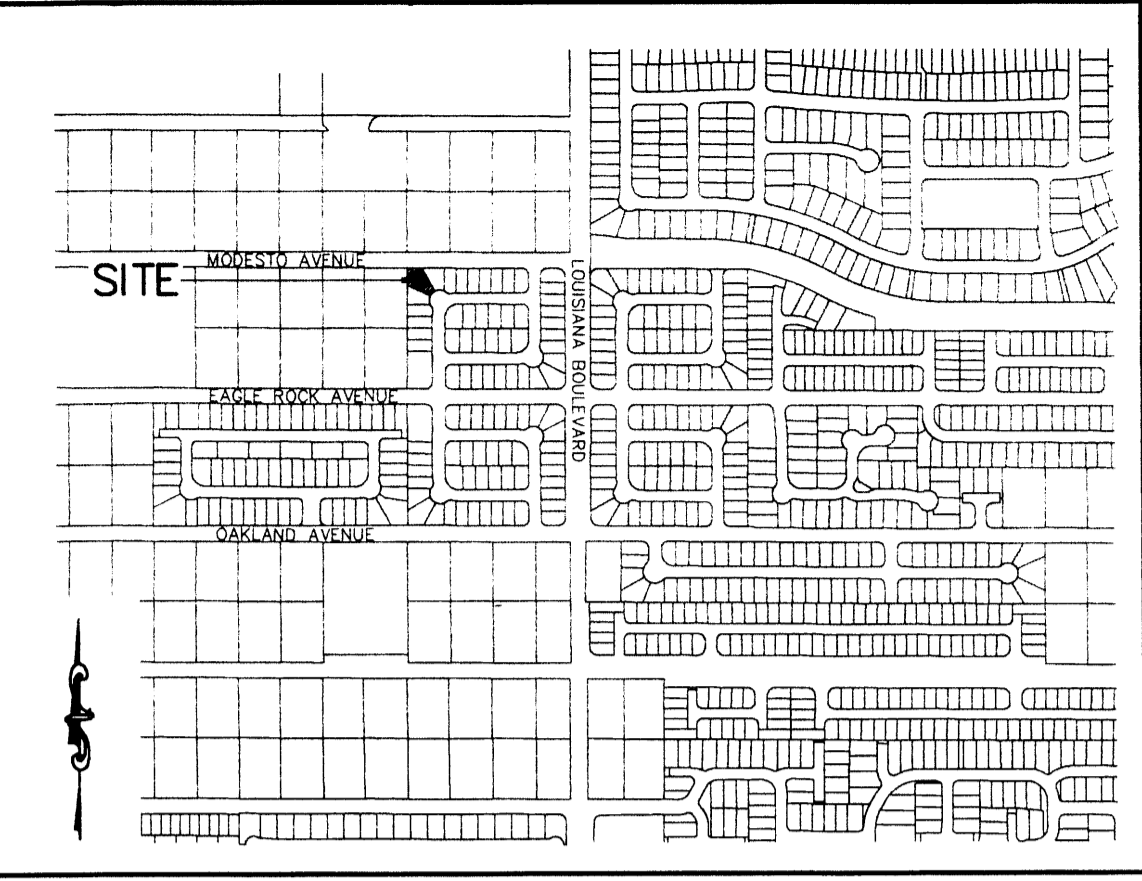

LOCATION MAP 1"=750' C-18-Z

PLAT OF
 LOT 9-P1
 BLOCK 2
 UNIT 4
 EAGLE ROCK ESTATES
 WITHIN THE
 ELENA GALLEGOS GRANT
 PROJECTED SECTION 13
 TOWNSHIP 11 NORTH, RANGE 3 EAST, NMPM
 CITY OF ALBUQUERQUE
 BERNALILLO COUNTY, NEW MEXICO
 SEPTEMBER, 2005

DESCRIPTION

A tract of land situate within the Elena Gallegos Grant, projected Section 13, Township 11 North, Range 3 East, New Mexico Principal Meridian, City of Albuquerque, Bernalillo County, New Mexico being all of a Temporary Public Drainage Easement within BLOCK 2, UNIT 4, EAGLE ROCK ESTATES as the same is shown and designated on said plat filed for record in the office of the County Clerk of Bernalillo County, New Mexico on July 12, 1999, Book 99C, Page 180 and containing 0.1640 acres more or less.

FREE CONSENT AND DEDICATION

The subdivision hereon described is with the free consent and in accordance with the desires of the undersigned owner(s) and/or proprietor(s) thereof and said owner(s) and/or proprietor(s) do hereby consent to the creating of Lot 9-P1 as shown hereon. Said owner(s) and/or proprietor(s) do hereby consent to all of the foregoing and do hereby certify that this subdivision is their free act and deed. Said owner(s) Warrants that (he/she) holds complete and indefeasible title in fee simple to the land subdivided.

Owner(s): Shakeel Rizvi
 SHAKEEL RIZVI *[Signature]* Oct 31, 2005
 Date

STATE OF NEW MEXICO)
 BERNALILLO COUNTY)
 On this 28 day of September, 2005, this instrument was acknowledged
 before me by Shakeel Rizvi
[Signature] 07-30-06
 Notary Public My Commission Expires

Owner(s): Adil Rizvi
 ADIL RIZVI *[Signature]* Oct 31, 2005
 Date

STATE OF NEW MEXICO)
 BERNALILLO COUNTY)
 On this 28 day of September, 2005, this instrument was acknowledged
 before me by Adil Rizvi
[Signature] 07-30-06
 Notary Public My Commission Expires

Owner(s): Esmail Haidari
 ESMAIL HAIDARI *[Signature]* Oct 13, 2005
 Date

STATE OF NEW MEXICO)
 BERNALILLO COUNTY)
 On this 13 day of October, 2005, this instrument was acknowledged
 before me by Esmail Haidari
[Signature] March 29, 09
 Notary Public My Commission Expires

OFFICIAL SEAL
 ANN M. BAUER
 NOTARY PUBLIC
 STATE OF NEW MEXICO
 My Commission Expires March 29, 09

PROJECT NUMBER:
 Application Number:
 PLAT APPROVAL
 Utility Approvals:

**PRELIMINARY PLAT
 APPROVED BY DRB
 ON**

- PNM Electric Services Division _____ Date
- PNM Gas Services Division _____ Date
- Qwest _____ Date
- Comcast _____ Date
- City Approver: *[Signature]* 10-31-05
 City Surveyor _____ Date
- Real Property Division _____ Date
- Environmental Health Department _____ Date
- Traffic Engineering, Transportation Division _____ Date
- Utilities Development _____ Date
- Parks and Recreation Department _____ Date
- AMAFA _____ Date
- City Engineer _____ Date
- DRB Chairperson, Planning Department _____ Date

PURPOSE OF PLAT

1. To create Lot 9-P1 as shown hereon.
2. To vacate a Temporary Public Drainage Easement

SUBDIVISION DATA

1. Project No.:
 Application No.:
2. Zone Atlas Index No.: C-18-Z
3. Total Number of Existing Lots: 0
4. Total Number of Existing Tracts: 1
5. Total Number of Lots created: 1
6. Total Number of Tracts created: 0
7. Gross Subdivision Acreage: 0.1640

NOTES

1. Bearings are New Mexico State Plane Grid Bearings (Central Zone).
2. Distances are ground distances.
3. Bearings and distances are field and record.
4. Basis of boundary is from the plats of record entitled:
 Plat Of "NORTH ALBUQUERQUE ACRES, TRACT A, UNIT B"
 (04-24-36, D-130)
 Plat Of "EAGLE ROCK ESTATES, UNIT 4"
 (07-12-99, 99C-180)
 all being records of Bernalillo County, New Mexico.
5. Field Survey: performed April, 1999.
6. Title Report: None provided.
7. Address of Property: None provided.
8. City of Albuquerque, New Mexico Zone: R-D
9. Utility Council Location System Log No.: 2002480773

SURVEYOR'S CERTIFICATION

"I, Timothy Aldrich, a duly qualified Registered Professional Land Surveyor under the laws of the State of New Mexico, do hereby certify that this plat and description were prepared by me or under my supervision, shows all easements as shown on the plat of record or made known to me by the owners and/or proprietors of the subdivision shown hereon, utility companies and other parties expressing an interest and meets the minimum requirements for monumentation and surveys of the Albuquerque Subdivision Ordinance, and further meets the Minimum Standards for Land Surveying in the State of New Mexico. This is true and correct to the best of my knowledge and belief."

Timothy Aldrich *[Signature]* 09-30-05
 S. No. 7719 Date

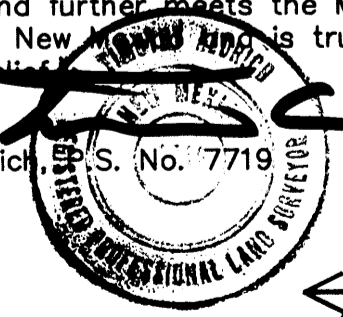

**ALDRICH LAND
 SURVEYING**

P.O. BOX 30701, ALBQ., N.M. 87190
 505-884-1990

Drawn By:	ECM	Date:	09-30-05
Checked By:	TA	Drawing Name:	02089B2.DWG
Job No.:	02-089	Sheet:	1 of 2

PLAT OF
 LOT 9-P1
 BLOCK 2
 UNIT 4
 EAGLE ROCK ESTATES
 WITHIN THE
 ELENA GALLEGOS GRANT
 PROJECTED SECTION 13
 TOWNSHIP 11 NORTH, RANGE 3 EAST, NMPM
 CITY OF ALBUQUERQUE
 BERNALILLO COUNTY, NEW MEXICO
 SEPTEMBER, 2005

MODESTO AVENUE NE
 (60' R/W)

ACS MONUMENT
 "10-C18"
 Y=1524061.42
 X=402319.45
 G-G=0.9996613
 Δα=-00'11"18"
 CENTRAL ZONE
 (NAD 1927)
 ELEVATION=5219.41
 (NGVD 1929)

NORTH ALBUQUERQUE ACRES
 TRACT A, UNIT B, BLOCK 26
 (04-24-36, D-130)

LOT 12

67.56'
 N 00'12'38" E

S 89'41'47" E

55.18'

LOT 9-P1
 BLOCK 2
 0.1640 AC.

EXISTING 10' PRIVATE DRAINAGE EASEMENT
 (07-12-99, 99C-180) (Typ.)

EXISTING 10' P.U.E.
 (07-12-99, 99C-180)

N 65'15'48" W

LOT 8

EAGLE ROCK ESTATES
 UNIT 4, BLOCK 2
 (07-12-99, 99C-180)

97.29'

C1

OBSIDIAN STREET NE
 (50' R/W)

SCHIST AVENUE NE
 (44' R/W)

EAGLE ROCK ESTATES
 UNIT 4, BLOCK 2
 (07-12-99, 99C-180)

LOT 10-P1

102.66'

PROPERTY CORNERS

- FOUND 5/8" REBAR WITH CAP "ALS LS 7719"

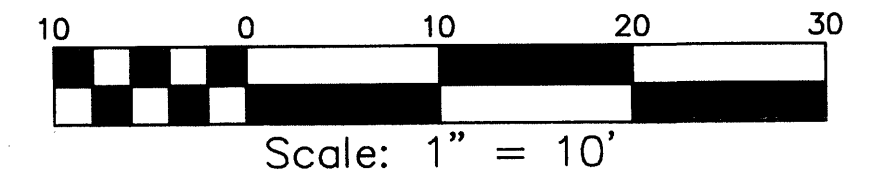

NUMBER	ARC LENGTH	DELTA ANGLE	RADIUS	TANGENT	CHORD DIRECTION	CHORD LENGTH
C1	25.28'	36°12'55"	40.00'	13.08'	S 42°50'39" W	24.86'

Drawn By:	ECM	Date:	09-30-05
Checked By:	TA	Drawing Name:	02089B2.DWG
Job No.:	02-089	Sheet:	2 of 2

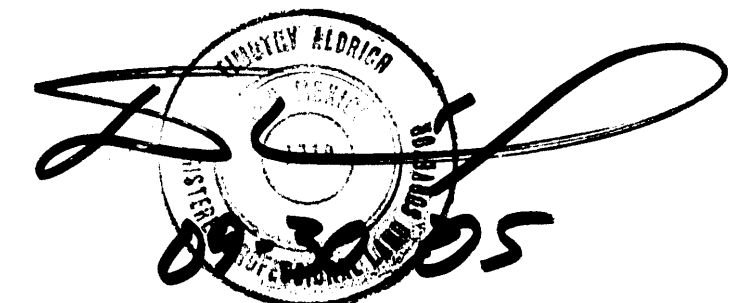

ALDRICH LAND SURVEYING

P.O. BOX 30701, ALBQ., N.M. 87190
 505-884-1990

