

4791

DXF Electronic Approval Form

DRB Project Case #: 1004791

Subdivision Name: GREVEY--TRACT C1A

Surveyor: DAVID R KRAEMER

Contact Person: DAVID SOULE

Contact Information: 872-0999

DXF Received: 5/19/2010

Hard Copy Received: 5/19/2010

Coordinate System: NMSP Grid (NAD 83)

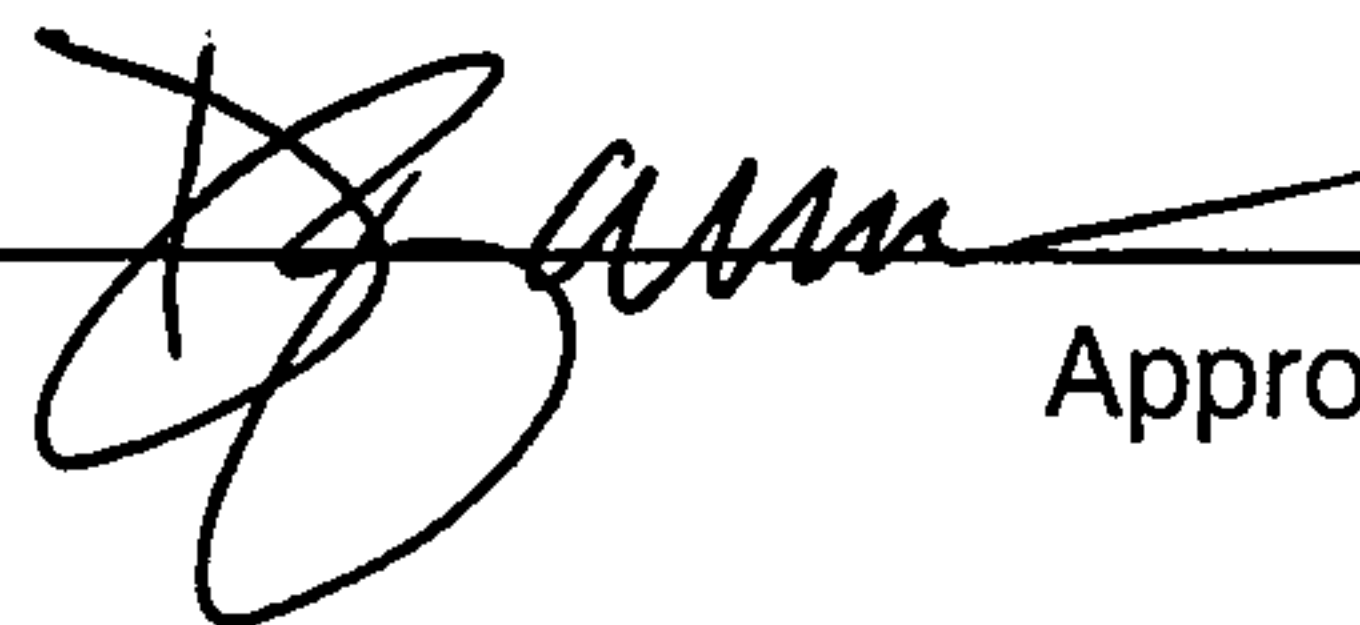
Approved

05-20-2010
Date

* The DXF file cannot be accepted (at this time) for the following reason(s):

AGIS Use Only

Copied fc4791 to agiscov on 5/20/2010 Contact person notified on 5/20/2010

3. **Project# 1004073**
10DRB-70033 MAJOR – 1 YEAR
EXTENSION OF SUBDIVISION
IMPROVEMENTS AGREEMENT
(2YR SIA)

MARK GOODWIN AND ASSOCIATES PA agent(s) for JTH, LLC request(s) the referenced/ above action(s) for all or a portion of **JUAN TABO HILLS Unit(s) 1**, zoned RD, located on JUAN TABO BLVD NE south of the TIJERAS ARROYO containing approximately 244.4124 acre(s). (M-21, M-22) **A ONE YEAR EXTENSION OF THE SUBDIVISION IMPROVEMENT AGREEMENT (SIA) WAS APPROVED.**

4. **Project# 1007886**
09DRB-70282 VACATION OF PUBLIC
RIGHT-OF-WAY

The NATIONAL PARK SERVICE request(s) the referenced/ above action(s) for all of ST. JOSEPH'S AVENUE NW, located on the west side of UNSER BLVD NW within the boundary of Petroglyph National Monument. (G-10) **THE VACATION WAS APPROVED AS SHOWN ON EXHIBIT B IN THE PLANNING FILE PER SECTION 14-14-7-2(A) (1) AND (B) (1)(3) OF THE SUBDIVISION ORDINANCE.**

**SITE DEVELOPMENT PLANS (EPC FINAL SIGN-OFF) AMENDED PLANS AND
MASTER DEVELOPMENT PLANS (CITY COUNCIL FINAL SIGN-OFF)**

5. **Project# 1008086**
10DRB-70054 EPC APPROVED SDP
FOR BUILD PERMIT
10DRB-70055 EPC APPROVED SDP
FOR SUBDIVISION

MCELHENEY ARCHITECTS agent(s) for GOODWILL INDUSTRIES OF NEW MEXICO request(s) the above action(s) for all or a portion of Lot(s) 6, 28 & 27, Block(s) 10, Tract(s) 2, **NORTH ALBUQUERQUE ACRES Unit(s) 3**, zoned SU-2 FOR MIXED USES, located on PASEO DEL NORTE NE AND HOLLY AVE NE BETWEEN WYOMING NE AND LOUISIANA NE containing approximately 1.84 acre(s). (C-19)**DEFERRED TO 3/17/10 AT THE AGENT'S REQUEST.**

6. **Project# 1002123**
09DRB-70378 MINOR - FINAL PLAT
APPROVAL

DEL'S HIDE-A-WAY request(s) the above action(s) for all or a portion of Lot(s) 1-35, Tract(s) A, B, C, D, E, F, & G, zoned SU-1 FOR RT, located on SAN CLEMENTE AVE NW BETWEEN NORTH FOURTH ST AND 2ND ST containing approximately 4.5 acre(s). (G-14)[*Deferred from 12/23/09, 2/17/10*] **INDEFINITELY DEFERRED ON A NO SHOW.**

7. ~~**Project# 1004791**~~
10DRB-70031 MINOR - PRELIMINARY/
FINAL PLAT APPROVAL

RIO GRANDE ENGINEERING agent(s) for LOMAS JACK LLC request(s) the above action(s) for all or a portion of Tract(s) C-1 & C-2, **LANDS OF GREVEY**, zoned C-1, located on LOMAS BLVD NE BETWEEN EASTERDAY NE AND EUBANK NE containing approximately 1.23 acre(s). (J-10) [*Deferred from 2/10/10*] **THE PRELIMINARY/FINAL PLAT WAS APPROVED WITH FINAL SIGN OFF DELEGATED TO PLANNING FOR AGIS DXF FILE.**

CITY OF ALBUQUERQUE

PLANNING DEPARTMENT

February 10, 2010

DRB Comments

ITEM # 6

PROJECT # 1004791

APPLICATION # 09-70031

RE: Tracts C-1 and C-2, Lands of Grevey

A Solar Note consistent with § 14-14-4-7 of the Subdivision Ordinance is required, specific to this type of request, i.e. use the words "THIS PLAT" (rather than the words "REQUESTED FINAL ACTION") at the beginning of the note, and do not use the words "OR SITE DEVELOPMENT PLAN FOR SUBDIVISION" at the end of the note.



Jack Cloud AICP, DRB Chairman
924-3880/ jcloud@cabq.gov

HEARINGS DATE 2-10-10 (P.F.)

#17



complete
6/4/07
[Signature]

DRB CASE ACTION LOG (PREL & FINAL)

REVISED 9/28/05

This sheet must accompany your plat or site plan to obtain delegated signatures. Return sheet with site plan/plat once comments are addressed.

DRB Application No.: <u>07DRB-70002 (P&F)</u>	Project # <u>1004791</u>
Project Name: <u>LANDS OF GREVEY</u>	
Agent: <u>WAYJOHN SURVEYING INC</u>	Phone No.: <u>255-2052</u>

Project Number 1004791

Your request for (SDP for SUB), (SDP for BP), (FINAL PLATS), (MASTER DEVELOP. PLAN), was approved on 5/30/07 by the DRB with delegation of signature(s) to the following departments.
OUTSTANDING SIGNATURES COMMENTS TO BE ADDRESSED

- TRANSPORTATION: _____
- _____
- _____
- _____
- _____
- UTILITIES: _____
- _____
- _____
- _____
- CITY ENGINEER / AMAFCA: _____
- _____
- _____
- _____
- PARKS / CIP: _____
- _____
- _____
- _____
- PLANNING (Last to sign): record
- _____
- _____
- _____

- Planning must record this plat. Please submit the following items:**
 - The original plat and a mylar copy for the County Clerk.
 - Tax certificate from the County Treasurer.
 - Recording fee (checks payable to the County Clerk). RECORDED DATE: _____
 - Tax printout from the County Assessor.
- 3 copies of the approved site plan. Include all pages.**
- County Treasurer's signature must be obtained prior to the recording of the plat with the County Clerk.**
- Property Management's signature must be obtained prior to Planning Department's signature.**
- AGIS DXF File approval required.**
- Copy of recorded plat for Planning.**

OK



DRB CASE ACTION LOG (PREL & FINAL)

REVISED 9/28/05

This sheet must accompany your plat or site plan to obtain delegated signatures. Return sheet with site plan/plat once comments are addressed.

DRB Application No.: 07DRB-70002 (P&F)
Project Name: LANDS OF GREVEY
Agent: WAYJOHN SURVEYING INC

Project # 1004791
Phone No.: 255-2052

Your request for (SDP for SUB), (SDP for BP), (FINAL PLATS), (MASTER DEVELOP. PLAN), was approved on 5/30/07 by the DRB with delegation of signature(s) to the following departments.

OUTSTANDING SIGNATURES COMMENTS TO BE ADDRESSED

TRANSPORTATION: _____

UTILITIES: _____

CITY ENGINEER / AMAFCA: _____

PARKS / CIP: _____

PLANNING (Last to sign): record

Planning must record this plat. Please submit the following items:

- The original plat and a mylar copy for the County Clerk.
- Tax certificate from the County Treasurer.
- Recording fee (checks payable to the County Clerk). RECORDED DATE: _____
- Tax printout from the County Assessor.

- 3 copies of the approved site plan. Include all pages.
- County Treasurer's signature must be obtained prior to the recording of the plat with the County Clerk.
- Property Management's signature must be obtained prior to Planning Department's signature.
- AGIS DXF File approval required.
- Copy of recorded plat for Planning.

OK

Project Number

1004791

#17

CITY OF ALBUQUERQUE



PLANNING DEPARTMENT
DEVELOPMENT AND BUILDING SERVICES
HYDROLOGY DEVELOPMENT SECTION

DEVELOPMENT REVIEW BOARD – SPEED MEMO

DRB CASE NO/PROJECT NO: 1004791

AGENDA ITEM NO: 17

SUBJECT:

Final Plat
Preliminary Plat

ACTION REQUESTED:

REV/CMT: () APPROVAL: (X) SIGN-OFF: () EXTN: () AMEND: ()

ENGINEERING COMMENTS:

No adverse comments.

P.O. Box 1293

Albuquerque

New Mexico 87103

www.cabq.gov

RESOLUTION:

APPROVED ; DENIED __; DEFERRED __; COMMENTS PROVIDED __; WITHDRAWN __

DELEGATED: (SEC-PLN) (SP-SUB) (SP-BP) (FP) TO: (UD) (CE) (TRANS) (PRKS) (PLNG)

SIGNED: Bradley L. Bingham
City Engineer / AMAFCA Designee

DATE: MAY 30, 2007

0



J20

#17
#1004791
05/30/2007

R-1

C-1

LOMAS

K20

SU-1



**DEVELOPMENT REVIEW BOARD
ACTION SHEET**

Plaza del Sol Hearing Room, Basement, Plaza del Sol Building

May 30, 2007

9:00 A.M.

MEMBERS:

Sheran Matson, AICP, DRB Chair
Claire Senova, Administrative Assistant

Wilfred Gallegos, Transportation Development
Brad Bingham, Alternate City Engineer

Roger Green, Utility Development
Christina Sandoval, Parks & Recreation

NOTE: UNLESS ANNOUNCED DURING THE MEETING, THE DEVELOPMENT REVIEW BOARD WILL NOT TAKE A LUNCH BREAK.

NOTE: INDIVIDUALS WITH DISABILITIES WHO NEED SPECIAL ASSISTANCE TO PARTICIPATE AT THIS MEETING SHOULD CONTACT CLAIRE SENOVA, PLANNING DEPARTMENT, AT 924-3946. HEARING IMPAIRED USERS MAY CONTACT HER VIA THE NEW MEXICO RELAY NETWORK BY CALLING TOLL-FREE:1-800-659-8331.

NOTE: REQUESTS FOR DEFERRAL OF CASES WILL BE DISCUSSED BY THE BOARD AND THE APPLICANT AND/OR AGENT AT THE BEGINNING OF THE AGENDA. BOTH PARTIES MUST AGREE UPON THE DATE OF DEFERRAL. IF THE APPLICANT/AGENT IS NOT PRESENT, THE ADMINISTRATIVE ASSISTANT MUST RECEIVE A LETTER, PRIOR TO THE HEARING DATE, REQUESTING A SPECIFIC DEFERRAL DATE. THE BOARD WILL DISCUSS AND MAKE A DECISION AT THE HEARING. THE APPLICANT/AGENT WILL THEN BE INFORMED OF THE DEFERRAL DATE AND REASON.

- A. Call to Order: 9:00 A.M. Adjourned: Noon
- B. Changes and/or Additions to the Agenda
- C. New or Old Business

CASES WHICH REQUIRE PUBLIC NOTIFICATION
MAJOR SUBDIVISIONS, VACATIONS, SIA EXTENSIONS AND SITE DEVELOPMENT PLANS

- 1. **Project # 1002371**
07DRB-00577 Major-Vacation of Public Easements
07DRB-00576 Minor-Prelim&Final Plat Approval

TIERRA WEST LLC agent(s) for HOFFMANTOWN WEST CHURCH request(s) the above action(s) for all or any portion of Tract(s) 1-A-1, Block(s) 15, ALBAN HILLS (to be known as **HOFFMANTOWN WEST CHURCH**) zoned SU-1 for R-2 with church related uses, located on LA ORILLA RD NW between COORS BLVD NW and the CORRALES DRAIN containing approximately 17 acre(s). [REF: 02DRB01824, 03DRB02150, 05DRB00560, 03DRB02085, 03DRB02086, 03EPC01285, 07DRB00286] [Deferred from 5/30/07] (D-12) **DEFERRED AT THE AGENT'S REQUEST TO 6/6/07.**

2. **Project # 1005539**
07DRB-00580 Major-Vacation of Pub
Right-of-Way

WILSON AND COMPANY agent(s) for MGMe DEVELOPMENT INC request(s) the above action(s) for all or any portion of Lot(s) 1, Block(s) 5, VOLCANO CLIFFS SUBDIVISION, UNIT 26 (to be known as **TIERRA BUENA ESTATES**) zoned SU-2 SRLL located on ROSA PARKS RD NW between UNSER BLVD NW and CALLE NORTENA NW containing approximately 4 acre(s). [REF: 07DRB00561] (C-11) **THE VACATION WAS APPROVED AS SHOWN ON EXHIBIT B IN THE PLANNING FILE WITH THE FOLLOWING CONDITION OF FINAL PLAT: PRIOR TO THE REPLAT A RE-EVALUATION OF THE LEFT HAND TURN BAYS WILL BE NEEDED.**

3. **Project # 1005540**
07DRB-00578 Major-Vacation of Public
Easements
07DRB-00579 Major-Vacation of Pub
Right-of-Way

WILSON AND COMPANY agent(s) for LEGACY SUSTAINABLE DEVELOPMENT INC request(s) the above action(s) for all or any portion of Tract(s) D, **LA CUENTISTA SUBDIVISION, UNIT 3**, zoned SU-2 SRLL, located on KIMMICK DR NW between ROSA PARKS RD NW and the PETROGLYPH NATIONAL MONUMENT containing approximately 20 acre(s). [REF: 07DRB00562] (C-11 & D-11) **THE VACATIONS WERE APPROVED AS SHOWN ON EXHIBIT B IN THE PLANNING FILE WITH THE FOLLOWING CONDITION OF FINAL PLAT: PRIOR TO THE REPLAT A RE-EVALUATION OF THE LEFT HAND TURN BAYS WILL BE NEEDED.**

4. **Project # 1004075**
06DRB-01537 Major-Vacation of Pub
Right-of-Way
06DRB-01539 Minor-Vacation of Private
Easements

BOHANNAN HUSTON INC agent(s) for MESA DEL SOL LLC request(s) the above action(s) for all or a portion of Tract(s) 4A, 4B, 4C and 1 through 15, **MESA DEL SOL**, zoned SU-2 PLANNED COMMUNITY, located on INTERSTATE 25 SW, between BROADWAY BLVD SW and LOS PICAROS RD SW containing approximately 2,294 acre(s). [REF: 06DRB-00744] [*Deferred from 11/15/06, 12/13/06, 1/3/07, 1/17/07, 2/7/07, 2/28/07, 3/21/07, 04/11/07 & 05/02/07 & 5/30/07*]. (R-16, Q-16, R-15, R-17, S-14, S-16, S-17, T-16) **DEFERRED AT THE AGENT'S REQUEST TO 6/20/07.**

SITE DEVELOPMENT PLANS (EPC FINAL SIGN-OFF) AMENDED PLANS AND MASTER DEVELOPMENT PLANS (CITY COUNCIL FINAL SIGN-OFF)

NOTE: IF THE APPLICANT/AGENT IS NOT PRESENT WHEN THEIR REQUEST IS CALLED, THEN THE REQUEST MAY BE INDEFINITELY DEFERRED ON A NO SHOW.

5. **Project# 1003364**
07DRB-70003 EPC APPROVED SDP
FOR BUILD PERMIT

TAFAZZUL HUSSAIN agent(s) for PHILLIP LINDBORG request(s) the above action(s) for all or a portion of Lot(s) 1-A-1-A1, Block(s) 10, Tract(s) 2, **NORTH ALBUQUERQUE ACRES, UNIT 3**, zoned SU-2 MIXED USE, located on HOLLY AVE NE BETWEEN LOUISIANA NE AND WYOMING NE containing approximately 1 acre(s). [Anna DiMambro, EPC Case Planner] [*Indef deferred from 5/30/07*] (C-19) **INDEFINITELY DEFERRED AT THE AGENT'S REQUEST.**

6. **Project# 1005239**
07DRB-70009 EPC APPROVED SDP
FOR BUILD PERMIT

CLAUDIO VIGIL ARCHITECTS agent(s) for MECH-CON INVESTMENT LLC request(s) the above action(s) for all or a portion of Tract(s) K-1, **GATEWAY INDUSTRIAL PARK**, zoned IP, located on BROADWAY NE BETWEEN MENAUL NE AND CLAREMONT NE containing approximately 1.75 acre(s). [REF: 06EPC 01583] [Catalina Lehner, EPC Case Planner] (H-15) **SITE PLAN FOR BUILDING PERMIT WAS APPROVED WITH FINAL SIGN OFF DELEGATED TO TRANSPORTATION DEVELOPMENT FOR CROSS-ACCESS WITH PLAT 30 FEET AND MINOR SITE COMMENTS AND PLANNING FOR CATALINA LEHNER'S INITIALS AND 3 COPIES OF THE SITE PLAN.**

7. **Project# 1005240**
07DRB-70007 EPC APPROVED SDP
FOR BUILD PERMIT

CLAUDIO VIGIL ARCHITECTS agent(s) for MECH-CON INVESTMENT LLC request(s) the above action(s) for all or a portion of Tract(s) H-1, **GATEWAY INDUSTRIAL PARK**, zoned IP, located on BROADWAY NE BETWEEN MENAUL NE AND CLAREMONT NE containing approximately 2.575 acre(s). [Catalina Lehner, EPC Case Planner](H-14) **SITE PLAN FOR BUILDING PERMIT WAS APPROVED WITH FINAL SIGN OFF DELEGATED TO PLANNING FOR CATALINA LEHNER'S INITIALS, REMOVAL OF SIGNATURE BLOCK FROM UTILITY PLAN AND 3 COPIES OF THE SITE PLAN.**

8. **Project# 1005280**
07DRB-70011 EPC APPROVED SDP
FOR BUILD PERMIT
07DRB-70012 EPC APPROVED SDP
FOR SUBDIVISION

GEORGE RAINHART ARCHITECTS agent(s) for SCM PROPERTY CO LLC request(s) the above action(s) for all or a portion of TRACT 16-A-1, PARADISE NORTH AND TRACT E-A-1, CRESTVIEW SUBDIVISION (to be known as **MCMAHON MARKETPLACE**) zoned SU-1 FOR C-1 PURPOSES, located on MCMAHON NW BETWEEN BANDELIER DR NW AND UNSER BLVD NW containing approximately 12.3 acre(s). [REF: 06EPC01706, 06EPC01705, 063PC01704] [**Catalina Lehner, EPC Case Planner**] [*Indef deferred from 5/30/07*] (A-11) **INDEFINITELY DEFERRED AT THE AGENT'S REQUEST.**

9. **Project# 1005498**
07DRB-70006 MINOR - SDP FOR
BUILDING PERMIT

CLAUDIO VIGIL ARCHITECTS agent(s) for MART-NAIR, LLC request(s) the above action(s) for all or a portion of Lot(s) 10-12 and portion of Lot 13, Block(s) 3, Tract(s) A, NORTH ALBUQUERQUE ACRES, UNIT B (to be known as **UNIVERSITY OF PHOENIX**) zoned IP, located on PASADENA NE BETWEEN I-25 FRONTAGE ROAD NE AND SAN MATEO BLVD NE containing approximately 3 acre(s). (B-18) **WITH THE SIGNING OF THE INFRASTRUCTURE LIST DATED 5/30/07 THE SITE PLAN FOR BUILDING PERMIT WAS APPROVED WITH FINAL SIGN OFF DELGATED TO CITY ENGINEER FOR SIA AND PLANNING TO CHANGE THE TITLE TO SITE PLAN FOR BUILDING PERMIT AND 3 COPIES OF THE PLAN.**

07DRB-70001 MINOR - PRELIMINARY/
FINAL PLAT APPROVAL

SURV-TEK INC agent(s) for MART-NAIR, LLC request(s) the above action(s) for all or a portion of Lot(s) 10-12, and portion of Lot 13, Block(s) 3, Tract(s) A, NORTH ALBUQUERQUE ACRES, UNIT B (to be known as **UNIVERSITY OF PHOENIX**) zoned IP, located on PASADENA NE BETWEEN I-25 FRONTAGE ROAD NE AND SAN MATEO BLVD NE containing approximately 3 acre(s). (B-18) **THE PRELIMINARY AND FINAL PLAT WAS APPROVED WITH FINAL SIGN OFF DELEGATED TO PLANNING TO RECORD.**

10. **Project # 1005545**
07DRB-00588 Minor-SiteDev Plan
BldPermit

MULLEN HELLER ARCHITECTURE agent(s) for FARM CREDIT OF NEW MEXICO request(s) the above action(s) for all or any portion of Tract(s) C-1-A, **NORTH GATEWAY SUBDIVISION**, zoned IP industrial park, located on BALLOON FIESTA PARKWAY NE between SAN MATEO NE and PAN AMERICAN FREEWAY containing approximately 2 acre(s). [REF:DRB-97-6] [*Deferred from 5/16/07*] (B-18) **THE SITE PLAN FOR BUILDING PERMIT WAS APPROVED WITH FINAL SIGN OFF DELEGATED TO UTILITIES DEVELOPMENT FOR UTILITY PLAN, FIRE MARSHAL STAMP, REVISED WORK ORDER SETS AND PLANNING FOR 3 COPIES OF THE PLAN.**

11. **Project # 1002455**
06DRB-01648 Minor-SiteDev Plan
Subd/EPC
06DRB-01649 Minor-SiteDev Plan
BldPermit/EPC

TAFAZZUL HUSSAIN agent(s) for DOUGLAS SIMMS request(s) the above action(s) for all or a portion of Lot(s) 2-7, **J J SUBDIVISION**, zoned SU-1 for C-1 USES, located on SAN ANTONIO DR NE, between I-25 and SAN PEDRO NE containing approximately 8 acre(s). [REF: 06DRB-00610, 06EPC-00458, 06EPC-01076] [**Carmen Marrone, EPC Case Planner**] [*Indef deferred from 11/29/06*] [*Indef deferred from 5/30/07*] (E-18) **INDEFINITELY DEFERRED AT THE AGENT'S REQUEST.**

07DRB-70004 VACATION OF
PRIVATE EASEMENT
07DRB-70005 MINOR - PRELIMINARY/
FINAL PLAT APPROVAL

RIO GRANDE SURVEYING CO. agent(s) for SAN ANTONIO PROPERTIES LLC request(s) the above action(s) for all or a portion of Lot(s) 3-7, **JJ SUBDIVISION**, zoned SU-1 for C-1 USES, located on SAN ANTONIO NE between INTERSTATE 25 NE and FOREST HILLS NE containing approximately 6.5044 acre(s). [*Indef deferred from 5/30/07*] (E-18) **INDEFINITELY DEFERRED AT THE AGENT'S REQUEST.**

12. **Project # 1000762**
07DRB-00597 Minor-SiteDev Plan
BldPermit/EPC

GOLDEN ASSOCIATES LLC agent(s) for FIRST BAPTIST CHURCH request(s) the above action(s) for all or any portion of Tract(s) B, RICHLAND HILLS, UNIT 1, **FIRST BAPTIST CHURCH**, zoned SU-1 FOR IP uses with exceptions, located on PASEO DEL NORTE NW between RICHLAND HILLS RD NW and EAGLE RANCH RD NW containing approximately 6 acre(s). [REF: 06EPC01711] [**Stephanie Shumsky, EPC Case Planner**] [*Deferred from 5/23/07*] (C-12) **WITH THE SIGNING OF THE INFRASTRUCTURE LIST DATED 5/30/07 THE SITE PLAN FOR BUILDING PERMIT WAS APPROVED WITH FINAL SIGN OFF DELEGATED TO CITY ENGINEER FOR SIA AND PLANNING FOR REPLAT, STEPHANIE SHUMSKY'S INITIALS AND 3 COPIES OF THE PLAN.**

13. **Project # 1005390**
07DRB-00648 Minor-SiteDev Plan
BldPermit

TIMOTHY OTT request(s) the above action(s) for all or any portion of Lot(s) 9, 10 & 12, **NZ COMMERCIAL, THE RANDOLPH BUILDING**, zoned IP, located on RANDOLPH RD SE between YALE BLVD SE and UNIVERSITY BLVD SE containing approximately 4 acre(s). [REF: 07DRB-00648] [*Deferred from 5/23/07*] (M-15) **THE SITE PLAN FOR BUILDING PERMIT WAS APPROVED WITH FINAL SIGN OFF DELEGATED TO PLANNING FOR 3 COPIES.**

07DRB-00206 Minor-Final Plat Approval

BORDENAVE DESIGNS agent(s) for TIMOTHY OTT request(s) the above action(s) for all or a portion of Lot(s) 9, 10 & 12, **NZ COMMERCIAL THE RANDOLPH BUILDING** zoned IP industrial park zone, located on RANDOLPH RD SE between YALE BLVD SE and UNIVERSITY BLVD SE containing approximately 4 acre(s). [*Deferred from 2/28/07 & Indef deferred 3/7/07*] [*Deferred from 5/23/07*] (M-15) **THE FINAL PLAT WAS APPROVED WITH FINAL SIGN OFF DELEGATED TO PLANNING FOR AGIS DXF FILE AND TO RECORD.**

MINOR PLATS, FINAL (MAJOR) PLATS, AMENDED PLATS AND PLANS

14. **Project# 1005182**
07DRB-70014 AMENDMENT TO
PRELIMINARY PLAT
- WILSON AND COMPANY INC agent(s) for LA CUENTISTA II LLC request(s) the above action(s) for all or a portion of Tract(s) C, **LA CUENTISTA SUBDIVISION, UNIT 2**, zoned SU-2 SRSL, located on ROSA PARKS RD NW between ALOE RD NW and KIMMICK DR NW containing approximately 35.4714 acre(s). [REF: 1000922] [Deferred from 5/30/07] (C-10 & C-11) **DEFERRED AT THE AGENT'S REQUEST TO 6/6/07.**
15. **Project# 1004272**
07DRB-70013 SUBDN DESIGN
VARIANCE FROM MIN DPM STDS
- ISAACSON AND ARFMAN PA agent(s) for CURB INC request(s) the above action(s) for all or a portion of Tract(s) 16-D-1, EL RANCHO GRANDE, UNIT 16 (to be known as **EL RANCHO GRANDE, UNIT 17**) zoned R-D, located on GIBSON BLVD SW between DELGADO DR SW and 118TH ST SW containing approximately 2.9585 acre(s). [REF: 07DRB-00547, 07DRB-00548, 07DRB-00549, 07DRB-00550] (N-8) **A SUBDIVISION DESIGN VARIANCE FROM MINIMUM DPM STANDARDS WAS APPROVED AS SHOWN ON EXHIBIT D IN THE PLANNING FILE.**
16. **Project# 1000572**
07DRB-70008 MAJOR - FINAL PLAT
APPROVAL
- ISAACSON AND ARFMAN PA agent(s) for CENTEX HOMES request(s) the above action(s) for all or a portion of Tract(s) E, H, R, S & T, **THE PRESIDIO, UNIT 2**, zoned SU-1 PRD, located on CHICO RD NE BETWEEN EUBANK BLVD NE AND MORRIS STREET NE containing approximately 4.3225 acre(s). [REF: 06DRB-01778, 06DRB-01779, 06DRB-01781] (K-21) **THE FINAL PLAT WAS APPROVED WITH FINAL SIGN OFF DELEGATED TO PLANNING FOR AGIS DXF FILE AND TO RECORD.**

17. ~~Project#-1004791~~
07DRB-70002 MINOR - PRELIMINARY/
FINAL PLAT APPROVAL

WAYJOHN SURVEYING INC agent(s) for LOMAS JACK LLC request(s) the above action(s) for all or a portion of Tract(s) C, **LANDS OF GREVEY**, zoned C-1, located on LOMAS BLVD NE between WALKER DR NE and EUBANK BLVD NE containing approximately 1.226 acre(s). [REF: 06EPC-00413] (J-20) **PRELIMINARY AND FINAL PLAT WAS APPROVED WITH FINAL SIGN OFF DELEGATED TO PLANNING TO RECORD.**

18. **Project # 1004565**
06DRB-00908 Minor-Final Plat Approval

WAYJOHN SURVEYING INC agent(s) for DOYLE & TRICARIO INVESTMENTS request(s) the above action(s) for all or a portion of Lot(s) 7, 8 & 9, Block(s) 16-A, SANTILLA PLACE (to be known as **CAGUA TOWNHOMES**) zoned SU-1 FOR PRD, located on CAGUA DR NE between COPPER AVE NE and GRAND AVE NE containing approximately 1 acre(s). [**Catalina Lehner, EPC Case Planner**] [*Deferred from 8/2/06 & 8/16/06 & 8/30/06 & 9/6/06 & 9/13/06*] (K-18) **FINAL PLAT WAS APPROVED WITH FINAL SIGN OFF DELEGATED TO PLANNING TO RECORD.**

NO ACTION IS TAKEN ON THESE CASES:
APPLICANT - AGENT IS REQUIRED TO BE AT THE MEETING

19. **Project# 1006500**
07DRB-70010 SKETCH PLAT REVIEW
AND COMMENT

MARK GOODWIN AND ASSOCIATES PA agent(s) for KB HOMES NEW MEXICO, INC request(s) the above action(s) for all or a portion of **ANDERSON HEIGHTS, UNITS 4 & 6**, zoned R-D, located on 118TH ST SW between AMOLE MESA AVE SW and COLOBEL AVE SW containing approximately 55.274 acre(s). (N-8) **THE ABOVE REQUEST WAS REVIEWED AND COMMENTS WERE GIVEN.**

20. Approval of the Development Review Board Minutes for May 23, 2007. **THE DEVELOPMENT REVIEW BOARD MINUTES FOR 5/23/07 WERE APPROVED BY THE BOARD.**

ADJOURNED: NOON

CITY OF ALBUQUERQUE
PLANNING DEPARTMENT
May 30, 2007
DRB Comments

ITEM # 17

PROJECT # 1004791 APPLICATION # 07-70002

RE: Tract C, Lands of Grevey/fp

AGIS dxf is ok.

Has anything changed from the preliminary plat?

Planning has no objection to this platting request, but will take delegation to record the plat.

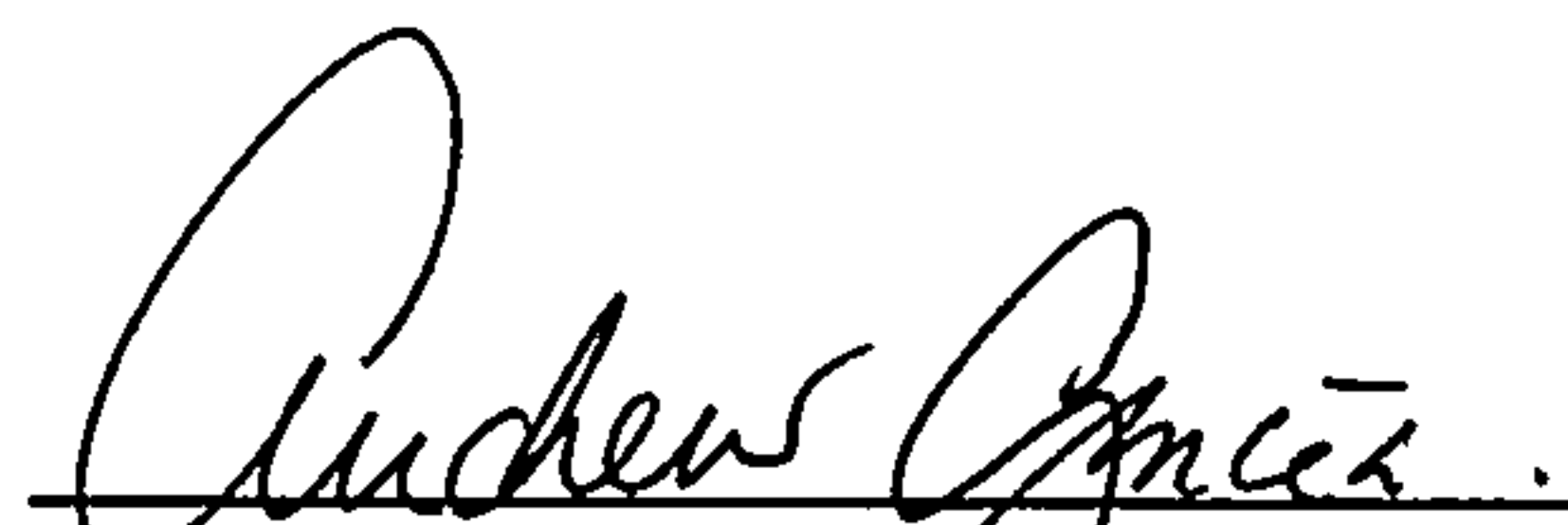

Andrew Garcia, Planning Alternate
924-3858 agarcia@cabq.gov

#17

4791

DXF Electronic Approval Form

DRB Project Case #: 1004791

Subdivision Name: GREVEY--TRACTS C1 & C2

Surveyor: THOMAS D JOHNSTON

Contact Person: THOMAS D JOHNSTON

Contact Information: 255-2052

DXF Received: 5/22/2007

Hard Copy Received: 5/21/2007

Coordinate System: Ground rotated to NMSP Grid

Approved

5.22.2007
Date

* The DXF file cannot be accepted (at this time) for the following reason(s):

AGIS Use Only

Copied fc 4791 to agiscov on 5/22/2007 Contact person notified on 5/22/2007

City of Albuquerque Planning Department
One Stop Shop – Development and Building Services

01/20/2010 Issued By: PLNSDH 88182

Permit Number: 2010 070 031 **Category Code 910**

Application Number: 10DRB-70031, Minor - Preliminary/ Final Plat Approval

Address:

Location Description: LOMAS BLVD NE BETWEEN EASTERDAY NE AND EUBANK NE

Project Number: 1004781

Applicant
Lomas Jack Llc

Po Box 87305
NM

Agent / Contact
Rio Grande Engineering
David Soule
1806 Central Ave Se Ste 201
Albuquerque NM 87108

david@riograndeengineering.com

Application Fees

441018/4971000	Public Notification	
441032/3424000	Conflict Mgmt Fee	\$20.00
441006/4983000	DRB Actions	\$215.00
TOTAL:		\$235.00

City Of Albuquerque
Treasury Division

1/20/2010 4:06PM LOC: ANNX
WS# 006 TRANS# 0065
RECEIPT# 00114930-00114930
PERMIT# 2010070031 TRSCXG
Trans Amt \$235.00
Conflict Manag. Fee \$20.00
DRB Actions \$215.00
CK \$235.00
CHANGE \$0.00

Thank You



DRB CASE ACTION LOG *(Preliminary/Final)*

This sheet **must** accompany your plat or site plan to obtain delegated signatures. Return sheet with site plan/plat once comments have been addressed.

DRB Application No.: 10DRB-70031

Project # 1004791

Project Name: Lands of Grevey

Agent: Rio Grande Engineering

Phone No.: _____

Your request was approved on 02-24-10 by the DRB with delegation of signature(s) to the following departments.

OUTSTANDING SIGNATURES COMMENTS TO BE ADDRESSED:

TRANSPORTATION: _____

ABCWUA: _____

CITY ENGINEER / AMAFCA: _____

PARKS / CIP: _____

PLANNING (Last to sign): .dxl file

Planning must record this plat. Please submit the following items:

- The original plat and a mylar copy for the County Clerk.
- Tax certificate from the County Treasurer.
- Recording fee (checks payable to the County Clerk). **RECORDED DATE:** _____
- Tax printout from the County Assessor.
 - 3 copies of the approved site plan. Include all pages.**
 - County Treasurer's signature must be obtained prior to the recording of the plat with the County Clerk.**
 - Property Management's signature must be obtained prior to Planning Department's signature.**
 - AGIS DXF File approved required.**
 - Copy of recorded plat for Planning.**



Supplemental form

SUBDIVISION

- Major Subdivision action
- Minor Subdivision action
- Vacation
- Variance (Non-Zoning)

SITE DEVELOPMENT PLAN

- for Subdivision
- for Building Permit
- Administrative Amendment (AA)
- IP Master Development Plan
- Cert. of Appropriateness (LUCC)

STORM DRAINAGE (Form D)

- Storm Drainage Cost Allocation Plan

S Z ZONING & PLANNING

- Annexation
- County Submittal
- EPC Submittal
- Zone Map Amendment (Establish or Change Zoning)
- Sector Plan (Phase I, II, III)
- Amendment to Sector, Area, Facility or Comprehensive Plan
- Text Amendment (Zoning Code/Sub Regs)
- Street Name Change (Local & Collector)
- D A APPEAL / PROTEST of...**
 - Decision by: DRB, EPC, LUCC, Planning Director or Staff, ZHE, Zoning Board of Appeals

PRINT OR TYPE IN BLACK INK ONLY. The applicant or agent must submit the completed application in person to the Planning Department Development Services Center, 600 2nd Street NW, Albuquerque, NM 87102. Fees must be paid at the time of application. Refer to supplemental forms for submittal requirements.

APPLICATION INFORMATION:

Professional/Agent (if any): Lomas Jack LLC Rio Grande Engineering PHONE: 321-9099
 ADDRESS: PO Box 67305 Alb FAX: 872-2205
 CITY: Alb STATE NM ZIP 87199 E-MAIL: dauid@riograndeengineering.com

APPLICANT: Lomas Jack LLC PHONE: ---
 ADDRESS: PO Box 67305 Alb FAX: ---
 CITY: Alb STATE NM ZIP 87199 E-MAIL: ---

Proprietary interest in site: _____ List all owners: _____

DESCRIPTION OF REQUEST: Redevelop / Vacation of interior property

Is the applicant seeking incentives pursuant to the Family Housing Development Program? Yes. No.

SITE INFORMATION: ACCURACY OF THE EXISTING LEGAL DESCRIPTION IS CRUCIAL! ATTACH A SEPARATE SHEET IF NECESSARY.

Lot or Tract No. Tracts C1 & C2 Block: - Unit: ---
 Subdiv/Addn/TBKA: lands of Grevey
 Existing Zoning: C-1 Proposed zoning: C-1 MRGCD Map No NA
 Zone Atlas page(s): 5-10 UPC Code: 102005845700840211, 102005847900840908

CASE HISTORY:

List any current or prior case number that may be relevant to your application (Proj., App., DRB-, AX_Z_, V_, S_, etc.): 1004791

CASE INFORMATION:

Within city limits? Yes Within 1000FT of a landfill? _____
 No. of existing lots: 2 No. of proposed lots: 1 Total area of site (acres): 1.23 AC
 LOCATION OF PROPERTY, BY STREETS: On or Near: Lomas Blvd NE
 Between: Eastday NE and Eubank NE

Check-off if project was previously reviewed by Sketch Plat/Plan , or Pre-application Review Team . Date of review: _____

SIGNATURE [Signature] DATE 1/19/10
 (Print) David Sode Applicant: Agent:

FOR OFFICIAL USE ONLY

Form revised 4/07

- INTERNAL ROUTING
- All checklists are complete
- All fees have been collected
- All case #s are assigned
- AGIS copy has been sent
- Case history #s are listed
- Site is within 1000ft of a landfill
- F.H.D.P. density bonus
- F.H.D.P. fee rebate

Application case numbers	Action	S.F.	Fees
<u>(0 DRB) 70031</u>	<u>P&E</u>	<u>2(3)</u>	<u>\$ 215.00</u>
_____	<u>CME</u>	_____	<u>\$ 20.00</u>
_____	_____	_____	\$ _____
_____	_____	_____	\$ _____
_____	_____	_____	\$ _____
_____	_____	_____	\$ _____
Hearing date <u>02/03/10</u>	_____	_____	Total <u>\$ 235.00</u>

Sandy Handley 01/20/10 Project # 1004791
 Planner signature / date

FORM S(3): SUBDIVISION - D.R.B. MEETING (UNADVERTISED) OR INTERNAL ROUTING

A Bulk Land Variance requires application on FORM-V in addition to application for subdivision on FORM-S.

SKETCH PLAT REVIEW AND COMMENT (DRB22) Your attendance is required.

- Scale drawing of the proposed subdivision plat (folded to fit into an 8.5" by 14" pocket) 6 copies
- Site sketch with measurements showing structures, parking, Bldg. setbacks, adjacent rights-of-way and street improvements, if there is any existing land use (folded to fit into an 8.5" by 14" pocket) 6 copies
- Zone Atlas map with the entire property(ies) clearly outlined
- Letter briefly describing, explaining, and justifying the request
- List any original and/or related file numbers on the cover application

EXTENSION OF MAJOR PRELIMINARY PLAT (DRB08) Your attendance is required.

- Preliminary Plat reduced to 8.5" x 11"
 - Zone Atlas map with the entire property(ies) clearly outlined
 - Letter briefly describing, explaining, and justifying the request
 - Copy of DRB approved infrastructure list
 - Copy of the LATEST Official DRB Notice of approval for Preliminary Plat Extension request
 - List any original and/or related file numbers on the cover application
- Extension of preliminary plat approval expires after one year.

MAJOR SUBDIVISION FINAL PLAT APPROVAL (DRB12) Your attendance is required.

- Proposed Final Plat (folded to fit into an 8.5" by 14" pocket) 6 copies
- Signed & recorded Final Pre-Development Facilities Fee Agreement for Residential development only
- Design elevations & cross sections of perimeter walls 3 copies
- Zone Atlas map with the entire property(ies) clearly outlined
- Bring original Mylar of plat to meeting, ensure property owner's and City Surveyor's signatures are on the plat
- Copy of recorded SIA
- Landfill disclosure and EHD signature line on the Mylar if property is within a landfill buffer
- List any original and/or related file numbers on the cover application
- DXF file and hard copy of final plat data for AGIS is required.

MINOR SUBDIVISION PRELIMINARY/FINAL PLAT APPROVAL (DRB16) Your attendance is required.

- 5 Acres or more: Certificate of No Effect or Approval
- Proposed Preliminary / Final Plat (folded to fit into an 8.5" by 14" pocket) 6 copies for unadvertised meetings ensure property owner's and City Surveyor's signatures are on the plat prior to submittal
- Signed & recorded Final Pre-Development Facilities Fee Agreement for Residential development only
- Design elevations and cross sections of perimeter walls (11" by 17" maximum) 3 copies
- Site sketch with measurements showing structures, parking, Bldg. setbacks, adjacent rights-of-way and street improvements, if there is any existing land use (folded to fit into an 8.5" by 14" pocket) 6 copies
- Zone Atlas map with the entire property(ies) clearly outlined
- Letter briefly describing, explaining, and justifying the request
- Bring original Mylar of plat to meeting, ensure property owner's and City Surveyor's signatures are on the plat
- Landfill disclosure and EHD signature line on the Mylar if property is within a landfill buffer
- Fee (see schedule)
- List any original and/or related file numbers on the cover application
- Infrastructure list if required (verify with DRB Engineer)
- DXF file and hard copy of final plat data for AGIS is required.

AMENDMENT TO PRELIMINARY PLAT (with minor changes) (DRB03) Your attendance is required.

- PLEASE NOTE: There are no clear distinctions between significant and minor changes with regard to subdivision amendments. Significant changes are those deemed by the DRB to require public notice and public hearing.
- Proposed Amended Preliminary Plat, Infrastructure List, and/or Grading Plan (folded to fit into an 8.5" by 14" pocket) 6 copies
 - Original Preliminary Plat, Infrastructure List, and/or Grading Plan (folded to fit into an 8.5" by 14" pocket) 6 copies
 - Zone Atlas map with the entire property(ies) clearly outlined
 - Letter briefly describing, explaining, and justifying the request
 - Bring original Mylar of plat to meeting, ensure property owner's and City Surveyor's signatures are on the plat
 - List any original and/or related file numbers on the cover application
- Amended preliminary plat approval expires after one year

I, the applicant, acknowledge that any information required but not submitted with this application will likely result in deferral of actions.

David Salk
Applicant name (print)
DSM 1/19/10
Applicant signature / date



Form revised October 2007

- Checklists complete
- Fees collected
- Case #s assigned
- Related #s listed

Application case numbers
10 DRB - 70031

Sandy Handley 01/20/10
Planner signature / date
Project # 1004791

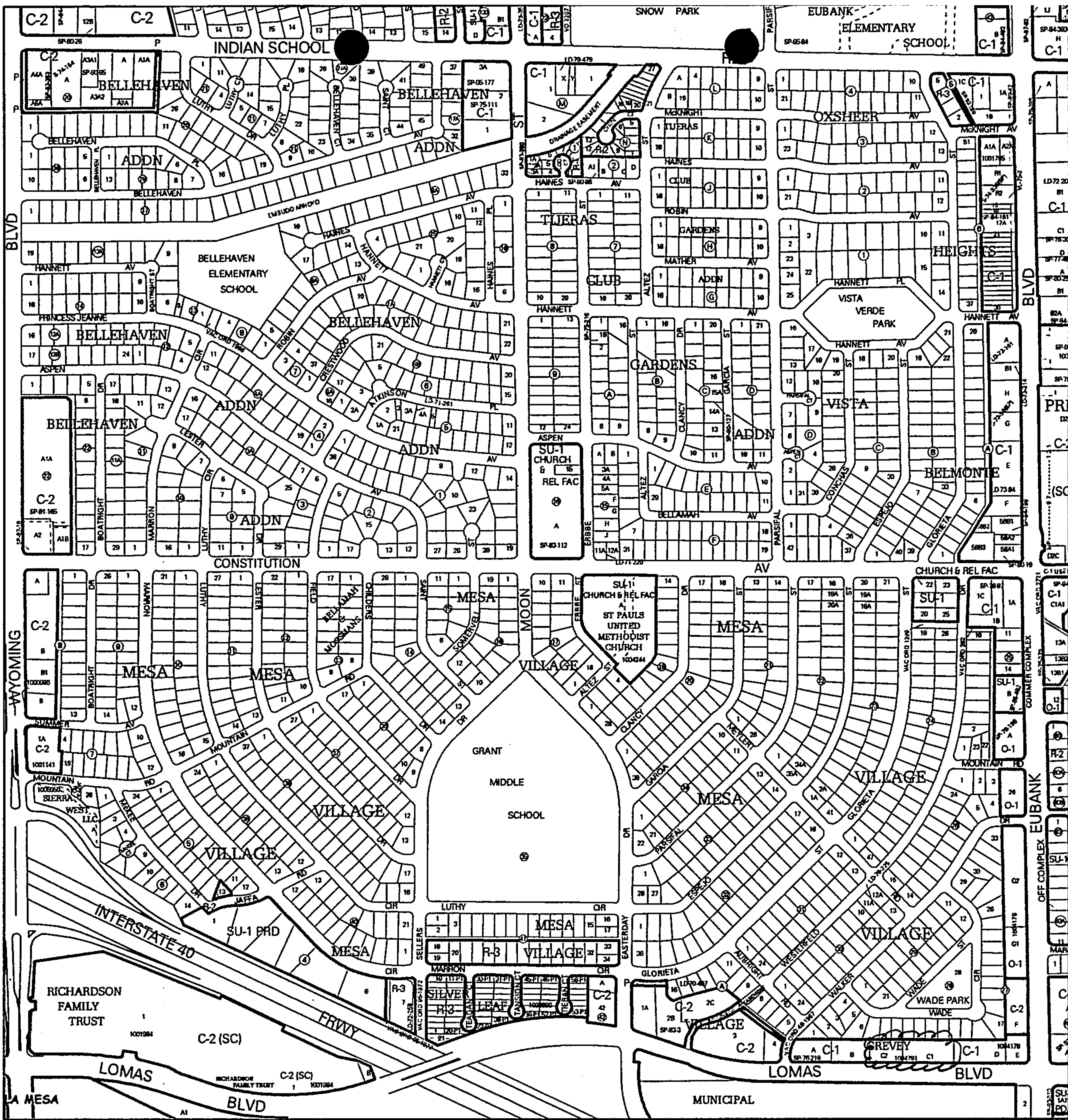

For more current information and more details visit: <http://www.cabq.gov/gis>

AGIS
Albuquerque Geographic Information System

Map amended through: 3/10/2009

Note: Grey Shading Represents Area Outside of the City Limits

Zone Atlas Page:
J-20-Z

Selected Symbols

SECTOR PLANS	Escarpment
Design Overlay Zones	2 Mile Airport Zone
City Historic Zones	Airport Noise Contours
H-1 Buffer Zone	Wall Overlay Zone
Petroglyph Mon.	

0 750 1,500 Feet

January 18, 2010

Mr. Jack Cloud
Chairman
Development Review Board

RE: Replat- Tract C-1-A
Lands of Grevey

Dear Mr. Cloud,

The purpose of this submittal is to obtain approval of the enclosed minor subdivision. The requested action is the approval of the combination of two lots into one. The combined lots will be immediately developed as a full service car wash.

Sincerely



David Soule
Rio Grande Engineering of NM llc
PO Box 67305
Albuquerque, New Mexico 87199



Supplemental form

SUBDIVISION

- Major Subdivision action
- Minor Subdivision action
- Vacation
- Variance (Non-Zoning)

SITE DEVELOPMENT PLAN

- for Subdivision
- for Building Permit
- Administrative Amendment (AA)
- IP Master Development Plan
- Cert. of Appropriateness (LUCC)

STORM DRAINAGE

- Storm Drainage Cost Allocation Plan

S Z ZONING & PLANNING

- Annexation
- County Submittal
- EPC Submittal
- Zone Map Amendment (Establish or Change Zoning)
- Sector Plan (Phase I, II, III)
- Amendment to Sector, Area, Facility or Comprehensive Plan
- Text Amendment (Zoning Code/Sub Regs)
- Street Name Change (Local & Collector)
- L A APPEAL / PROTEST of...**
- D** Decision by: DRB, EPC, LUCC, Planning Director or Staff, ZHE, Zoning Board of Appeals

PRINT OR TYPE IN BLACK INK ONLY. The applicant or agent must submit the completed application in person to the Planning Department Development Services Center, 600 2nd Street NW, Albuquerque, NM 87102. Fees must be paid at the time of application. Refer to supplemental forms for submittal requirements.

APPLICANT INFORMATION:

Professional/Agent (if any): WAYSON SURVEYING INC. PHONE: 255.2052
 ADDRESS: 330 LOUISIANA BLVD NE FAX: 255.2887
 CITY: ALBUQUERQUE STATE NM ZIP 87108 E-MAIL: WAYSONSURV@AOL.COM

APPLICANT: LOMAS JACK LLC (DANNY BRANDENBURG) PHONE: 883.4000
 ADDRESS: 2211 CANDELARIA ROAD NE FAX: 883.0700
 CITY: ALBUQUERQUE STATE NM ZIP 87107 E-MAIL: _____

Proprietary interest in site: OWNER List all owners: _____

DESCRIPTION OF REQUEST: MINOR PRELIMINARY / FINAL PWT TO CREATE 2 LOTS FROM 1 LOT.

Is the applicant seeking incentives pursuant to the Family Housing Development Program? Yes. No.

SITE INFORMATION: ACCURACY OF THE EXISTING LEGAL DESCRIPTION IS CRUCIAL! ATTACH A SEPARATE SHEET IF NECESSARY.

Lot or (Tract) No. C Block: _____ Unit: _____
 Subdiv/Addn/TBKA: LANDS OF GREVEY
 Existing Zoning: ~~C-1~~ Proposed zoning: SAME
 Zone Atlas page(s): J-20 MRGCD Map No. _____

CASE HISTORY:

List any current or prior case number that may be relevant to your application (Proj., App., DRB-, AX_Z_, V_, S_, etc.): SP 81.229
1004791 06EPC 00413

CASE INFORMATION:

Within city limits? Yes Within 1000FT of a landfill? NO
 No. of existing lots: 1 No. of proposed lots: 2 Total area of site (acres): 1.2260
 LOCATION OF PROPERTY BY STREETS: On or Near: LOMAS BOULEVARD NE
 Between: WALKER DRIVE NE and EUBANK BOULEVARD NE
 Check-off if project was previously reviewed by Sketch Plat/Plan , or Pre-application Review Team . Date of review: _____

SIGNATURE [Signature] DATE 5.21.07
 (Print) THOMAS D. JOHNSTON Applicant: Agent:

FOR OFFICIAL USE ONLY

Form revised 4/07

INTERNAL ROUTING	Application case numbers	Action	S.F.	Fees
<input checked="" type="checkbox"/> All checklists are complete	<u>DRB07-70002</u>	<u>P+F</u>	<u>53</u>	<u>\$ 285.00</u>
<input checked="" type="checkbox"/> All fees have been collected	_____	_____	_____	\$ _____
<input checked="" type="checkbox"/> All case #s are assigned	_____	<u>CMF</u>	_____	<u>\$ 20.00</u>
<input checked="" type="checkbox"/> AGIS copy has been sent	_____	_____	_____	\$ _____
<input checked="" type="checkbox"/> Case history #s are listed	_____	_____	_____	\$ _____
<input checked="" type="checkbox"/> Site is within 1000ft of a landfill	_____	_____	_____	\$ _____
<input checked="" type="checkbox"/> F.H.D.P. density bonus	_____	_____	_____	Total
<input checked="" type="checkbox"/> F.H.D.P. fee rebate	_____	_____	_____	<u>\$ 305.00</u>

Hearing date 5/30/07

Spec in force 5/21/07

Project # 1004791

FORM S(3): SUBDIVISION - D.R.B. MEETING (UNADVERTISED) OR INTERNAL ROUTING

A Bulk Land Variance requires application on FORM-V in addition to application for subdivision on FORM-S.

SKETCH PLAT REVIEW AND COMMENT (DRB22) Your attendance is required.

- Scale drawing of the proposed subdivision plat (folded to fit into an 8.5" by 14" pocket) 6 copies
- Site sketch with measurements showing structures, parking, Bldg. setbacks, adjacent rights-of-way and street improvements, if there is any existing land use (folded to fit into an 8.5" by 14" pocket) 6 copies
- Zone Atlas map with the entire property(ies) clearly outlined.
- Letter briefly describing, explaining, and justifying the request
- List any original and/or related file numbers on the cover application

EXTENSION OF MAJOR PRELIMINARY PLAT (DRB08) Your attendance is required.

- Preliminary Plat reduced to 8.5" x 11"
 - Zone Atlas map with the entire property(ies) clearly outlined
 - Letter briefly describing, explaining, and justifying the request
 - Copy of DRB approved infrastructure list
 - Copy of the LATEST Official DRB Notice of approval for Preliminary Plat Extension request
 - List any original and/or related file numbers on the cover application
- Extension of preliminary plat approval expires after one year.

MAJOR SUBDIVISION FINAL PLAT APPROVAL (DRB12) Your attendance is required.

- Proposed Final Plat (folded to fit into an 8.5" by 14" pocket) 6 copies
- Signed & recorded Final Pre-Development Facilities Fee Agreement for Residential development only
- Design elevations & cross sections of perimeter walls 3 copies
- Zone Atlas map with the entire property(ies) clearly outlined
- Bring original Mylar of plat to meeting, ensure property owner's and City Surveyor's signatures are on the plat
- Copy of recorded SIA
- Landfill disclosure and EHD signature line on the Mylar if property is within a landfill buffer
- List any original and/or related file numbers on the cover application
- DXF file and hard copy of final plat data for AGIS is required.

MINOR SUBDIVISION PRELIMINARY/FINAL PLAT APPROVAL (DRB16) Your attendance is required.

- Proposed Preliminary / Final Plat (folded to fit into an 8.5" by 14" pocket) 6 copies for unadvertised meetings
- ~~N/A~~ Signed & recorded Final Pre-Development Facilities Fee Agreement for Residential development only
- ~~N/A~~ Design elevations and cross sections of perimeter walls (11" by 17" maximum) 3 copies
- Site sketch with measurements showing structures, parking, Bldg. setbacks, adjacent rights-of-way and street improvements, if there is any existing land use (folded to fit into an 8.5" by 14" pocket) 6 copies
- Zone Atlas map with the entire property(ies) clearly outlined
- Letter briefly describing, explaining, and justifying the request
- ~~N/A~~ Bring original Mylar of plat to meeting, ensure property owner's and City Surveyor's signatures are on the plat
- ~~N/A~~ Landfill disclosure and EHD signature line on the Mylar if property is within a landfill buffer
- Fee (see schedule)
- List any original and/or related file numbers on the cover application
- ~~N/A~~ Infrastructure list if required (verify with DRB Engineer)
- DXF file and hard copy of final plat data for AGIS is required.

AMENDMENT TO PRELIMINARY PLAT (with minor changes) (DRB03) Your attendance is required.

- PLEASE NOTE: There are no clear distinctions between significant and minor changes with regard to subdivision amendments. Significant changes are those deemed by the DRB to require public notice and public hearing.
- Proposed Amended Preliminary Plat, Infrastructure List, and/or Grading Plan (folded to fit into an 8.5" by 14" pocket) 6 copies
 - Original Preliminary Plat, Infrastructure List, and/or Grading Plan (folded to fit into an 8.5" by 14" pocket) 6 copies
 - Zone Atlas map with the entire property(ies) clearly outlined
 - Letter briefly describing, explaining, and justifying the request
 - Bring original Mylar of plat to meeting, ensure property owner's and City Surveyor's signatures are on the plat
 - List any original and/or related file numbers on the cover application
- Amended preliminary plat approval expires after one year

I, the applicant, acknowledge that any information required but not submitted with this application will likely result in deferral of actions.

THOMAS D. JOHNSTON (AGENT)
 Applicant name (print)

 Applicant signature / date
 S. 21-07



Form revised 4/07

- Checklists complete
 - Fees collected
 - Case #s assigned
 - Related #s listed
- Application case numbers
DRB07 - _____ - 70002

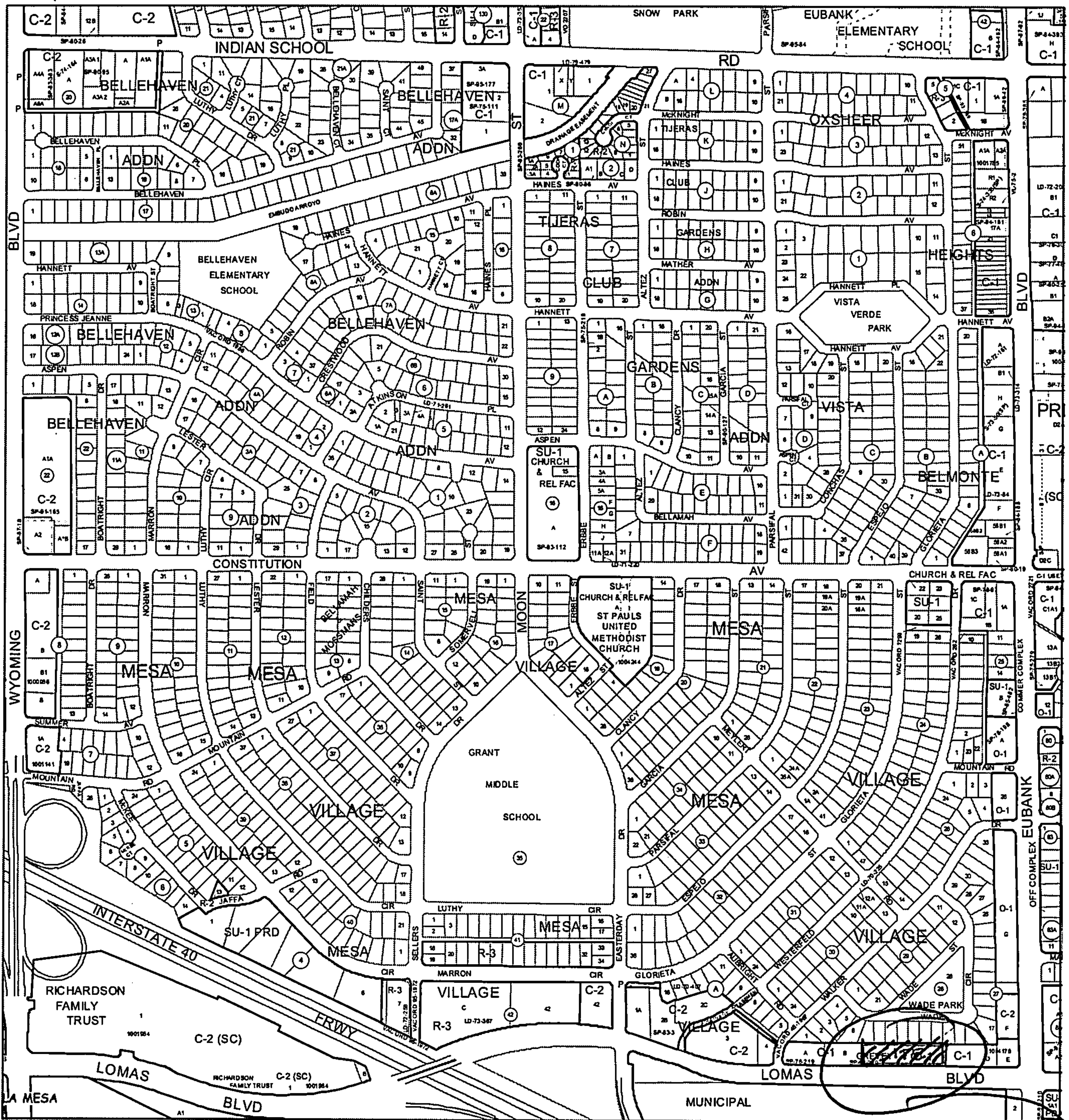
Joseph M. Rocco 5/21/07
 Planner signature / date
Project # 1004791



For more current information and more details visit: <http://www.cabq.gov/gis>

Albuquerque Geographic Information System

Note: Grey Shading Represents Area Outside of the City Limits

Zone Atlas Page:
J-20-Z

Selected Symbols

SECTOR PLANS	Escarpment
Design Overlay Zones	2 Mile Airport Zone
City Historic Zones	Airport Noise Contours
H-1 Buffer Zone	Wall Overlay Zone
Petroglyph Mon.	

0 750 1,500 Feet

Map amended through: 3/14/2006

site

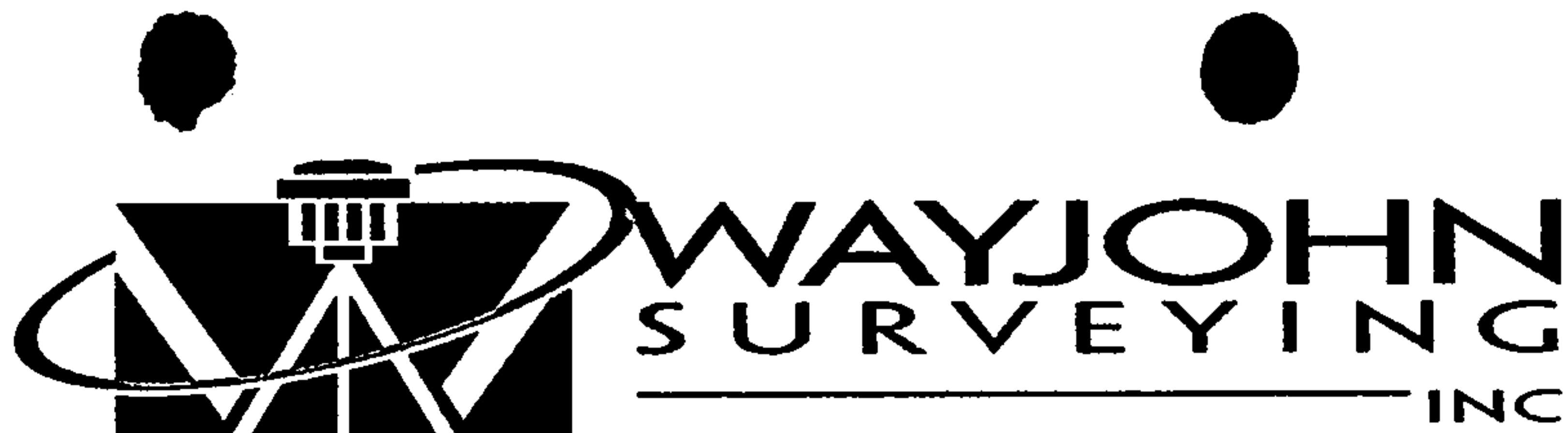

330 Louisiana Blvd., N.E. ♦ Albuquerque, NM 87108 ♦ Phone: (505) 255-2052 ♦ Fax: (505) 255-2887

May 21, 2007

Planning Department
City of Albuquerque
PO Box 1293
Albuquerque, NM 87103

RE: Minor Preliminary/Final Plat of Tracts C-1 and C-2, Lands of Grevey

To Whom It May Concern:

I am submitting a minor preliminary and final subdivision plat proposing to create two lots from one lot. The parcels to be created are currently vacant.

Thank you for your time in considering this matter. If you have any questions, please give me a call at the above number.

Regards,

A handwritten signature in black ink, appearing to read 'T. Johnston', is written over a horizontal line.

Thomas D. Johnston, PS, PE
President, Wayjohn Surveying Inc.

City of Albuquerque Planning Department

One Stop Shop – Development and Building Services

05/21/2007 Issued By: PLNABG

Permit Number: 2007 070 002

Project Number: 1004791

Project Description: TRACT C-BLOCK 27- MESA VILLAGE SUBDIVISI:ZONE MAP AMENDMENT

Application Number: 07DRB-70002, Minor - Preliminary/ Final Plat Approval

Address:

Location Description: LOMAS BLVD. NE WALKER DR. NE EUBANK BLVD. NE

Applicant
Lomas Jack Llc
Danny Brandenburg

Agent / Contact
Wayjohn Surveying Inc
Wayjohnsurv@aol.com

Application Fees

441018/4971000	Public Notification	
441032/3424000	Conflict Mgmt Fee	\$20.00
441006/4983000	DRB Actions	\$335.00
TOTAL:		\$355.00

5/21/2007 11:33AM LOC: ANNX
 RECEIPT# 00075792 WSH# 008 TRANS# 0021
 Account 441006 Fund 0110
 Activity 4983000 TRSLJS
 Trans Amt \$355.00
 J24 Misc \$335.00
 CK \$305.00
 CK \$50.00
 CHANGE \$0.00

City Of Albuquerque
Treasury Division

City Of Albuquerque
Treasury Division

5/21/2007 11:32AM LOC: ANNX
 RECEIPT# 00075791 WSH# 008 TRANS# 0021
 Account 441032 Fund 0110
 Activity 3424000 TRSLJS
 Trans Amt \$355.00
 J24 Misc \$20.00

Thank You

Thank You