

CERTIFIED MAIL
RETURN RECEIPT REQUESTED

May 4, 2017

Christopher Lopez
105555 Montgomery Boulevard NE
Building 1, Suite 100
Albuquerque, NM 87111

Re: Preliminary Plat Approval and Variance to Subdivision Design Standards, Wilderness Canon

Dear Mr. Lopez:

The City of Albuquerque's Office of Neighborhood Coordination has informed us that you are a representative of the HIGH DESERT RESIDENTIAL OWNERS ASSOCIATION.

This letter is to advise you that Bohannon Huston, Inc., agent for Mesa Verde Development, LLC, is seeking approval for a vacation of a floating public waterline easement on existing Tract A-1, Wilderness Canon at High Desert Subdivision. See the attached Zone Atlas Page for the project location.

A 20' floating water line easement was granted to the ABCWUA on Tract A-1 with the intent of confining and defining the location of the easement with future platting of Tract A-1. The easement will be defined on the final plat for the proposed 19 lot subdivision. The City Development Review Board (DRB) has requested that the floating easement be vacated.

Affected Neighborhood Associations and Homeowner Associations may request a Facilitated Meeting regarding this project by contacting the Office of Neighborhood Coordination (ONC) by email at ONC@cabq.gov or by phone at (505) 924-3914. A facilitated meeting request must be received by ONC by Monday **May 15, 2017**.

Please feel free to contact me if you have any questions regarding this matter or need information as to the date and time of the public hearing.

Sincerely,

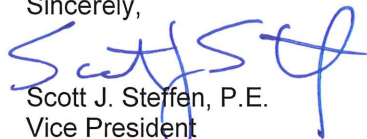

Scott J. Steffen, P.E.
Vice President
Community Development and Planning Group

Enclosure

CERTIFIED MAIL
RETURN RECEIPT REQUESTED

May 4, 2017

Tom Murdock
5601 Mariola Place NE
Albuquerque, NM 87111

Re: Vacation of Public Waterline Easement, Wilderness Canon

Dear Mr. Murdock:

The City of Albuquerque's Office of Neighborhood Coordination has informed us that you are a representative of the HIGH DESERT RESIDENTIAL OWNERS ASSOCIATION.

This letter is to advise you that Bohannon Huston, Inc., agent for Mesa Verde Development, LLC, is seeking approval for a vacation of a floating public waterline easement on existing Tract A-1, Wilderness Canon at High Desert Subdivision. See the attached Zone Atlas Page for the project location.

A 20' floating water line easement was granted to the ABCWUA on Tract A-1 with the intent of confining and defining the location of the easement with future platting of Tract A-1. The easement will be defined on the final plat for the proposed 19 lot subdivision. The City Development Review Board (DRB) has requested that the floating easement be vacated.

Affected Neighborhood Associations and Homeowner Associations may request a Facilitated Meeting regarding this project by contacting the Office of Neighborhood Coordination (ONC) by email at ONC@cabq.gov or by phone at (505) 924-3914. A facilitated meeting request must be received by ONC by Monday **May 15, 2017**.

Please feel free to contact me if you have any questions regarding this matter or need information as to the date and time of the public hearing.

Sincerely,



Scott J. Steffen, P.E.
Vice President
Community Development and Planning Group

Enclosure

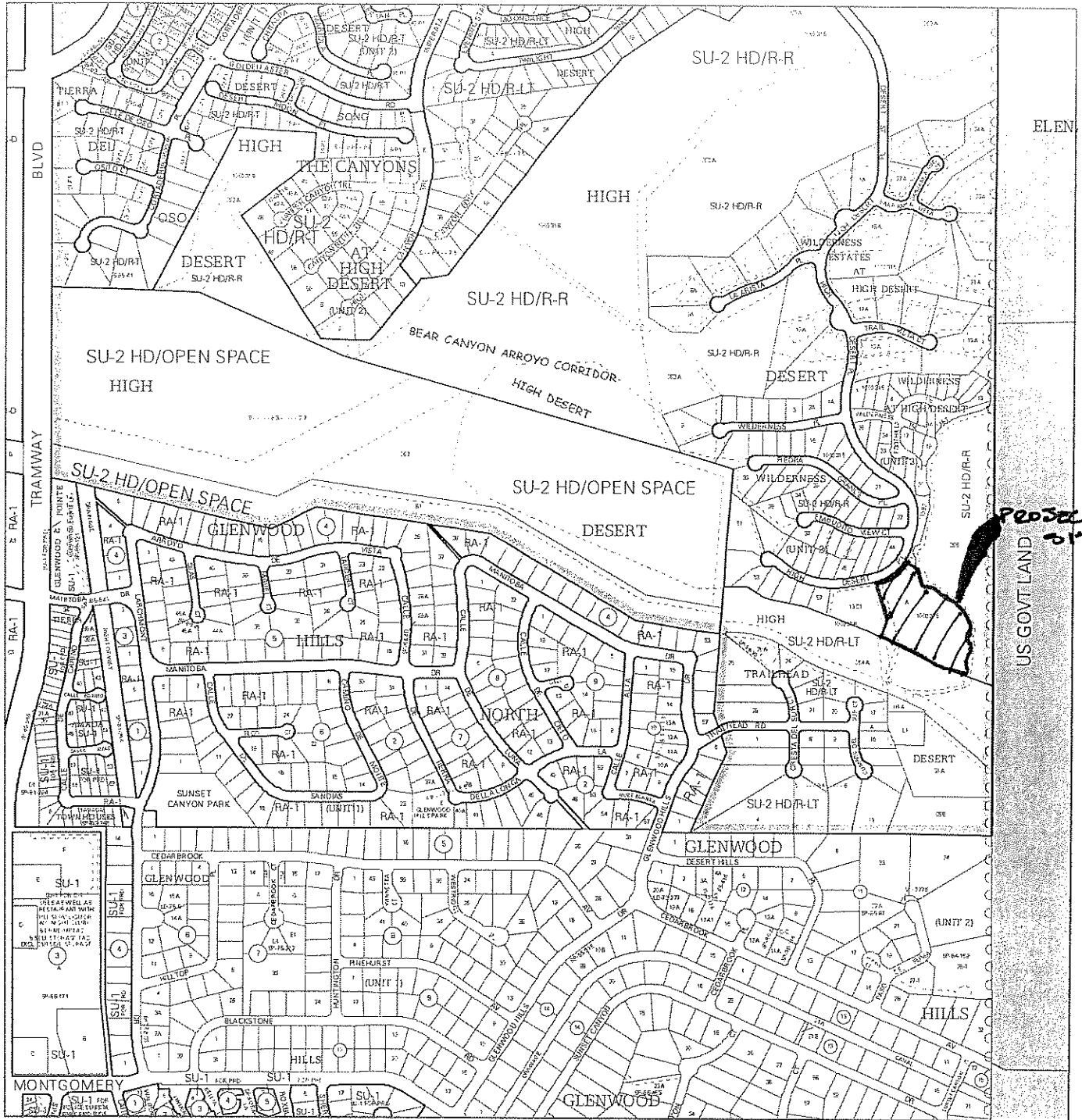

For more current information and more details visit: <http://www.cabq.gov/gis>

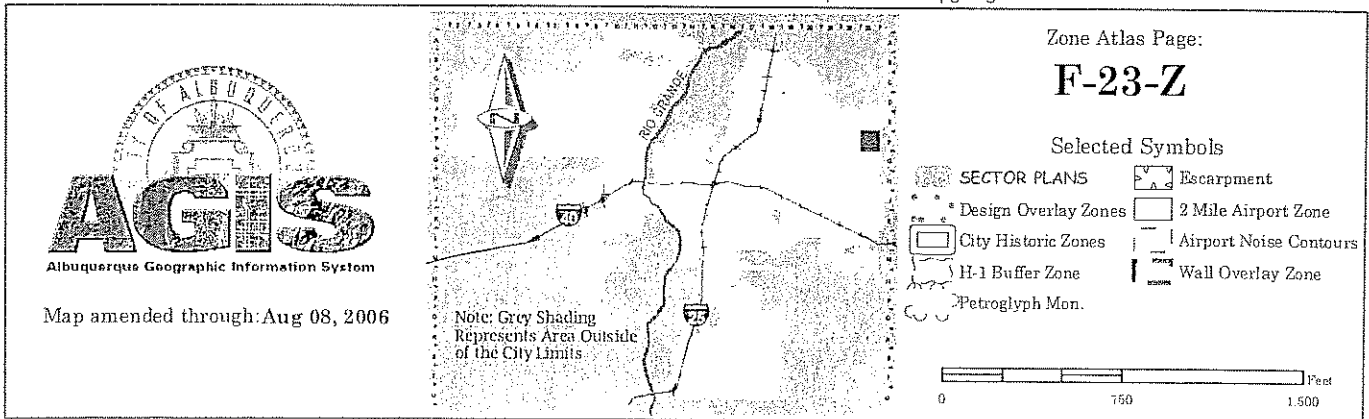

Courtyard 1
7500 Jefferson St. NE
Albuquerque, NM
87109-4335

Tom Murdock
5601 Mariola Place NE
Albuquerque, NM 87111

SENDER: COMPLETE THIS SECTION

- Complete items 1, 2, and 3.
- Print your name and address on the reverse so that we can return the card to you.
- Attach this card to the back of the mailpiece, or on the front if space permits.

1. Article Addressed to:
*Tom Murdock
5601 Mariola Place NE
Albuquerque, NM 87111*



9590 9402 2527 6306 6860 72

2. Article Number (Transfer from service label)
7015 1520 0000 6042 6311

PS Form 3811, July 2015 PSN 7530-02-000-9053

COMPLETE THIS SECTION ON DELIVERY

- A. Signature Agent
- Addressee
- B. Received by (Printed Name) Date of Delivery
- D. Is delivery address different from item 1? Yes
If YES, enter delivery address below: No

3. Service Type
- Adult Signature
 - Adult Signature Restricted Delivery
 - Certified Mail®
 - Certified Mail Restricted Delivery
 - Collect on Delivery
 - Collect on Delivery Restricted Delivery
 - Insured Mail
 - Insured Mail Restricted Delivery (over \$500)
 - Priority Mail Express®
 - Registered Mail™
 - Registered Mail Restricted Delivery
 - Return Receipt for Merchandise
 - Signature Confirmation™
 - Signature Confirmation Restricted Delivery

Domestic Return Receipt

U.S. Postal Service™
CERTIFIED MAIL® RECEIPT
Domestic Mail Only

For delivery information, visit our website at www.usps.com®.

OFFICIAL USE

Certified Mail Fee

- Extra Services & Fees (check box, add fee as appropriate)
- Return Receipt (hardcopy) \$ _____
 - Return Receipt (electronic) \$ _____
 - Certified Mail Restricted Delivery \$ _____
 - Adult Signature Required \$ _____
 - Adult Signature Restricted Delivery \$ _____

Postage

Total Postage and Fees

Postmark
Here

Sent To
Tom Murdock
Street and Apt. No., or PO Box No.
5601 MARIOLA PLACE NE
City, State, ZIP+4®
ALBUQUERQUE NM 87111

PS Form 3800, April 2015 PSN 7530-02-000-9047

See Reverse for Instructions

TEE9 2409 0000 025T 5T02
TEE9 2409 0000 025T 5T02

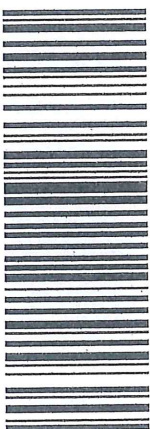

CERTIFIED MAIL®

DO NOT WRITE IN THESE SPACES. ADDRESSES AND RETURN ADDRESSES MUST BE PRINTED IN BLOCK CAPITAL LETTERS. DO NOT WRITE IN THESE SPACES.

Courtyard 1
7500 Jefferson St. NE
Albuquerque, NM
87109-4335

Christopher Lopez
10555 Montgomery Boulevard NE
Building 1, Suite 100
Albuquerque, NM 87111

SENDER: COMPLETE THIS SECTION

- Complete items 1, 2, and 3.
- Print your name and address on the reverse so that we can return the card to you.
- Attach this card to the back of the mailpiece, or on the front if space permits.

1. Article Addressed to:

CHRISTOPHER LOPEZ
10555 MONTGOMERY BLVD NE
BLDG 1, STE 100
ALBUQUERQUE, NM 87111



9590 9402 2527 6306 6860 41

2. Article Number (Transfer from service label)

7015 1520 0000 6042 6304

PS Form 3811, July 2015 PSN 7530-02-000-9053

COMPLETE THIS SECTION ON DELIVERY

- A. Signature Agent
- X** Addressee
- B. Received by (Printed Name) Addressee
- C. Date of Delivery
- D. Is delivery address different from item 1? Yes
If YES, enter delivery address below: No

3. Service Type

- Adult Signature
- Adult Signature Restricted Delivery
- Certified Mail®
- Certified Mail Restricted Delivery
- Collect on Delivery
- Collect on Delivery Restricted Delivery
- Insured Mail
- Insured Mail Restricted Delivery (over \$500)
- Priority Mail Express®
- Registered Mail™
- Registered Mail Restricted Delivery
- Return Receipt for Merchandise
- Signature Confirmation™
- Signature Confirmation Restricted Delivery

Domestic Return Receipt

U.S. Postal Service™
CERTIFIED MAIL® RECEIPT
Domestic Mail Only

For delivery information, visit our website at www.usps.com®.

OFFICIAL USE

Certified Mail Fee	\$
Extra Services & Fees (check box, add fee as appropriate)	
<input type="checkbox"/> Return Receipt (hardcopy)	\$
<input type="checkbox"/> Return Receipt (electronic)	\$
<input type="checkbox"/> Certified Mail Restricted Delivery	\$
<input type="checkbox"/> Adult Signature Required	\$
<input type="checkbox"/> Adult Signature Restricted Delivery	\$
Postage	\$
Total Postage and Fees	\$

Postmark
Here

Sent To
CHRISTOPHER LOPEZ, NE
Street and Apt. No. or PO Box No.
10555 MONTGOMERY BLVD. BLDG. 1, STE 100
City, State, ZIP+4®
ALBUQUERQUE, NM 87111

PS Form 3800, April 2015 PSN 7530-02-000-9047

See Reverse for Instructions

40E9 2409 0000 025T 5T0L
40E9 2409 0000 025T 5T0L

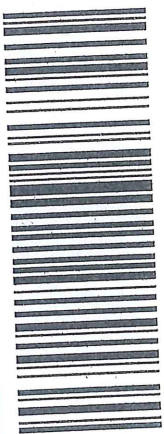

CERTIFIED MAIL
PLACE THE RETURN ADDRESS ON THE DOTTED LINE
OF THE ENVELOPE OR ADD IT TO THE BACK OF THE MAILPIECE