

PERSPECTIVE WALL RENDERING
SCALE: NTS

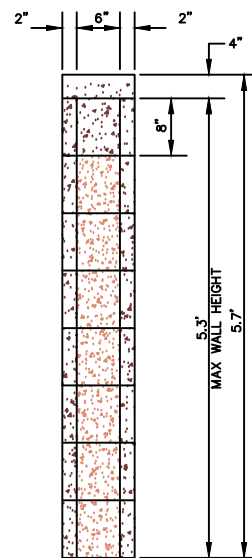

WALL CROSS SECTION
VIEW A-A
SCALE: NTS

NOTES:

THE OVERALL WALL PROGRAM AT LA CUENTISTA IS DESIGNED TO ENCOMPASS THE CHARACTER OF THE WEST MESA, ACHIEVED BY BREAKS OR OPENINGS IN THE WALL AT OPEN SPACE SECTIONS, ALLOWING FOR PEDESTRIAN ACCESS CONTINUITY, LOWERING THE WALL HEIGHT PER THE SECTOR DEVELOPMENT PLAN, PROVIDING A BASALT COLORED FEATURE DESIGNED TO ECHO PREDOMINANT PETROGLYPHS WHICH ARE SET IN A SPLIT-FACE WALL WITH CONTRASTING PILASTERS IN COLORS THAT MIMIC HUES FOUND ON THE MESA TOP. RETAINING WALLS HAVE BEEN MINIMIZED AND AN ADJACENT YARD WALL WILL BE SET BACK 4' WITH NATIVE LANDSCAPING IN FRONT.

REQUIREMENTS:

- LAYOUT:
- 1) DECORATIVE FEATURE (BASALT COLORED CMU 'DEER MAN' PATTERN) SET IN LIGHT COLORED WALL SECTION EVERY 40', FACING PUBLIC ROW. ENTIRE WALL SECTION WITH THIS PATTERN WILL BE SPLIT-FACE CMU.
 - 2) CONTRASTING DARKER SPLIT-FACE CMU PILASTERS EVERY 20', PROJECTING 2" ON THE PUBLIC SIDE OF THE WALL SURFACE. CONTRASTING CAP ALONG THE ENTIRE WALL.
 - 3) RETAINING WALL/YARD WALL - RETAINING WALL WILL BE NO GREATER THAN 4' IN HEIGHT AND YARD WALL WILL BE NO GREATER THAN 5' IN HEIGHT AND SET BACK 4' HORIZONTALLY.

- FACADE:
- 1) LANDSCAPING WILL BE PROVIDED IN FRONT OF THE YARD WALL WHERE RETAINING IS REQUIRED; MINIMUM 25% OF WALL SURFACE.
 - 2) LA CUENTISTA SUBDIVISION PERIMETER WALL DESIGN COMPLIES WITH THE CITY WALL REGULATIONS ON HEIGHT, LAYOUT, FACADE, AND MATERIALS.
 - 3) THE PRIMARY WALL SURFACE WILL BE SPLIT-FACE COLORED CMU.

- WALL HEIGHT:
- 1) RETAINING WALLS SHALL BE LIMITED TO 4' IN HEIGHT.
 - 2) PERIMETER YARD WALLS SHALL BE LIMITED TO 5.7' IN HEIGHT.

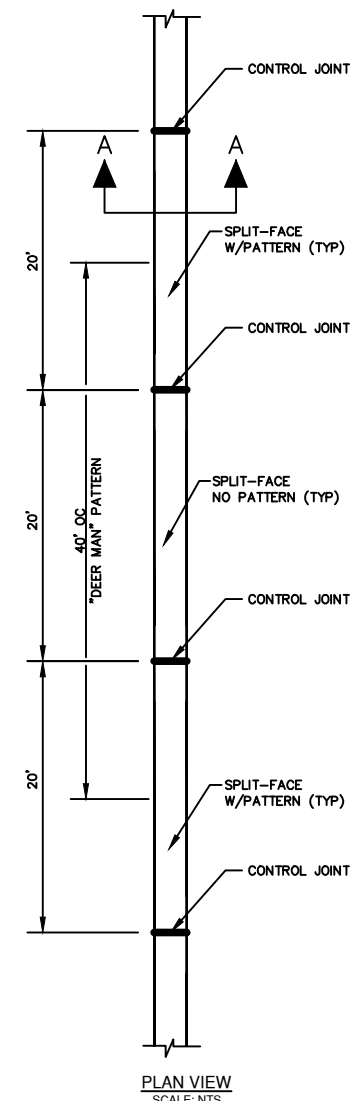

PLAN VIEW
SCALE: NTS

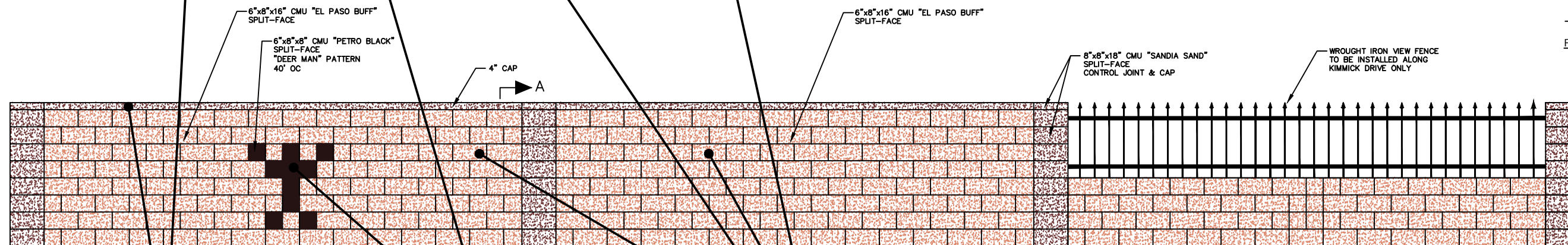

WALL ELEVATION
SCALE: NTS



SANDIA SAND
SPLIT-FACE



PETRO BLACK
SPLIT-FACE



EL PASO BUFF
SPLIT-FACE

DRB # 1005182

NEAREST INTERSECTION:
KIMMICK DR / ROSA PARKS RD

ZONE ATLAS:
C-10, C-11

WILSON & COMPANY

4900 LANG AVE NE
ALBUQUERQUE, NM
87109
(505) 348-4000

LA CUENTISTA SUBDIVISION - UNIT II

PERIMETER WALL DETAIL-
NO RETAINING

REVISIONS	NO.	DATE	REMARKS	BY	
DESIGN	DMD	WCEA NO.	1460008900	DATE	OCT 2017
DRAWN	ALL	PROJECT NO.	709786	SHEET NO.	
CHECK	DMD	709787	709788	1 OF 4	

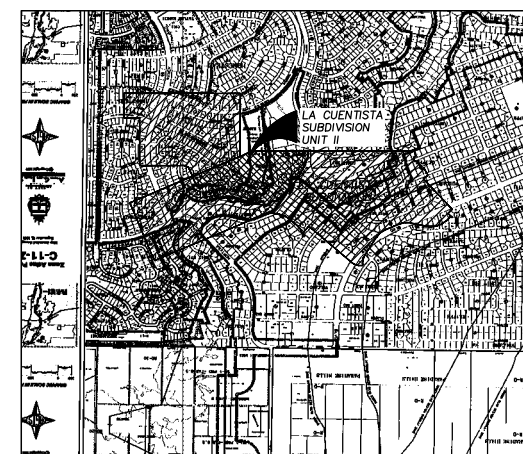
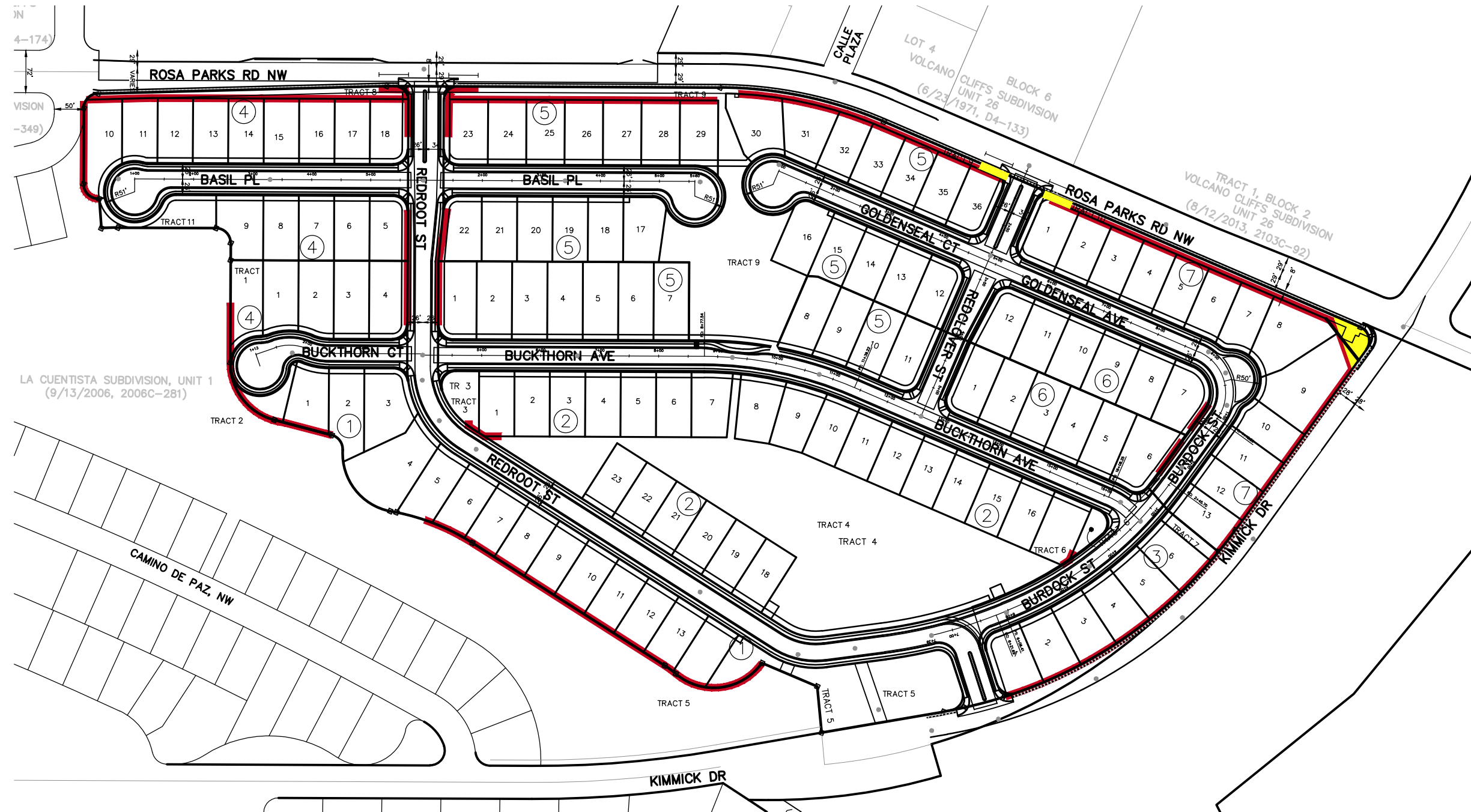

LOCATION MAP
ZONE ATLAS MAP NO. C-10, C-11

- LOCATION OF PERIMETER WALL
- LOCATION OF LANDSCAPING (EXCEPT AS NOTED IN FACADE NOTE 1 SHEETS 1&2 OF 4)

DRB # 1005182
NEAREST INTERSECTION:
KIMMICK DR / ROSA PARKS RD



 WILSON & COMPANY 4900 LANG AVE NE ALBUQUERQUE, NM 87109 (505) 348-4000	LA CUENTISTA SUBDIVISION - UNIT II			
	<h3 style="margin: 0;">PERIMETER WALL SITE PLAN EXHIBIT</h3>			
REVISIONS	NO.	DATE	REMARKS	BY
DESIGN	DMD	WCEA NO. 146008900	DATE	OCT 2017
DRAWN	ALL	PROJECT NO. 709786	SHEET NO.	
CHECK	DMD	709787 709788	3 OF 4	

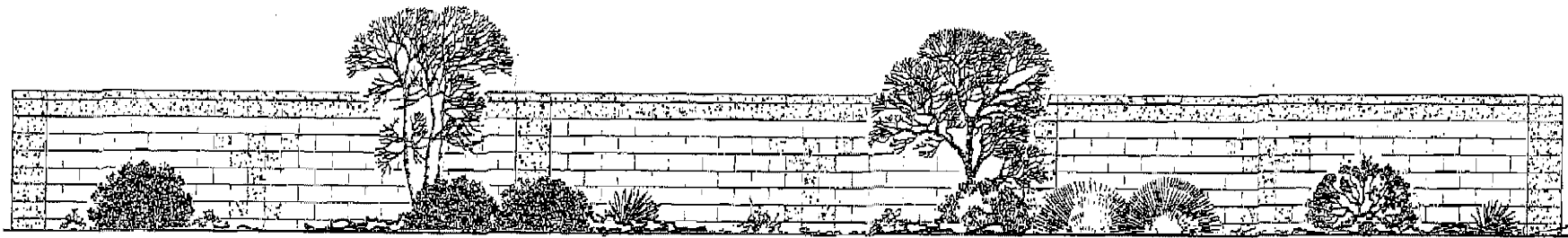

WALL ELEVATION
RLB

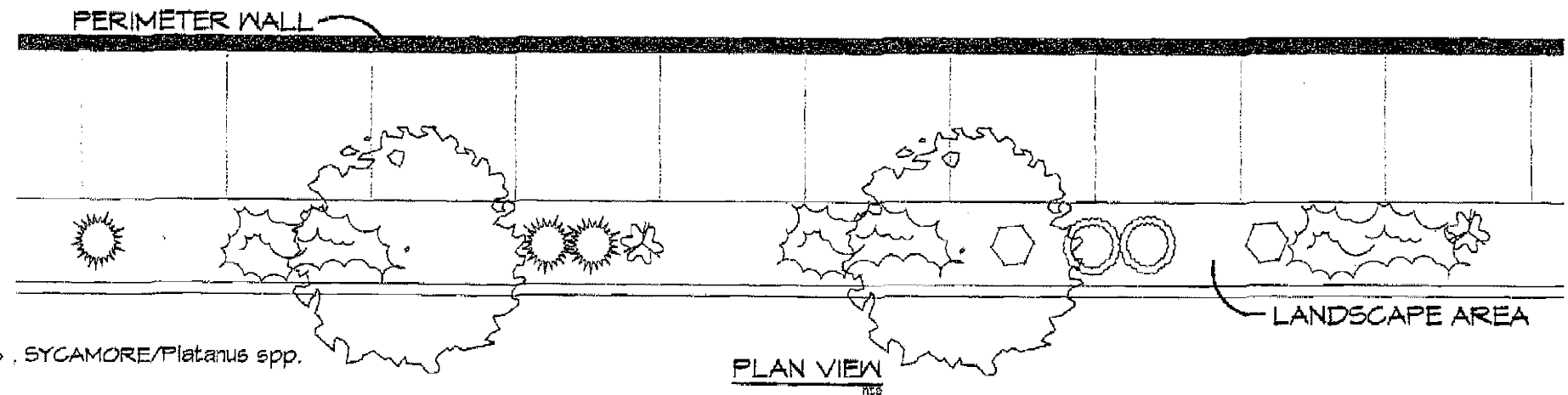

PLAN VIEW
RLB

PLANT PALETTE

- BOTANICAL/COMMON NAME**
- SHADE TREE 2" Cal.**
 ASH/*Fraxinus pennsylvanica* , HONEY LOCUST/*Gleditsia triacanthos* , SYCAMORE/*Platanus* spp.
- ORNAMENTAL TREE 2" Cal.**
 REDBUD/*Cercis* spp. , CHITALPA/*Chilopsis x catalpa* , FLOWERING PEAR/*Pyrus calleryana* , GOLDEN RAIN TREE/*Koelreuteria paniculata*
- EVERGREEN TREE 6-8'**
 AUSTRIAN PINE/*Pinus nigra*
- ORNAMENTAL TREE 15 Gal.**
 NEW MEXICO OLIVE/*Forestiera neomexicana* , WASHINGTON HAWTHORN/*Crataegus phaenopyrum* , DESERT WILLOW/*Chilopsis linearis*
- DESERT ACCENTS**
- PALM YUCCA , OCOTILLO , PRICKLY PEAR , AGAVE , BLUE SOTOL , RED YUCCA**
- SHRUBS/GROUNDCOVERS AND GRASSES 5 GALLON BUCKETS**
 SPANISH BROOM/*Genista hispanica* , REGAL MIST/*Muhlenbergia capillaris* , BLUE MIST SPIREA/*Caryopteris clandonensis* , BIRD OF PARADISE/*Caesalpinia gilliesii* , LANAS BROOM/*Cytisus scoparius* , BUTTERFLY BUSH/*Buddleia davidii* , RUSSIAN SAGE/*Perovskia atriplicifolia* , ARP ROSEMARY/*Rosmarinus officianalis* , MAIDENGRASS/*Miscanthus sinensis* , APACHE PLUME/*Fairugia paradoxa*
- SHRUBS/GROUNDCOVERS AND GRASSES 1 GALLON BUCKETS**
 POWIS CASTLE SAGE/*Artemisia x Powis Castle* , AUTUMN SAGE/*Salvia greggii* , LAVENDER/*Lavandula angustifolia* , THREADGRASS/*Stipa tenuissima*

IRRIGATION SYSTEM
 IRRIGATION SYSTEM SHALL CONSIST OF A FULLY AUTOMATED SPRINKLER/DRIP IRRIGATION SYSTEM TO IRRIGATE TREE, SHRUB, AND GROUNDCOVER PLANTING AREAS. A SEPERATE WATER METER IS INCLUDED IN THE INFRASTRUCTURE LIST FOR THE COMMON AREAS.

MAINTENANCE RESPONSIBILITY
 ALL PLANTING AREAS WILL BE MAINTAINED IN A LIVING, ATTRACTIVE, AND NEED FREE CONDITION. LANDSCAPE AREAS SHALL BE MAINTAINED BY THE LA CUENTISTA HOMEOWNERS ASSOCIATION.

La Cuentista

DRB # 1005182

NEAREST INTERSECTION:
 KIMMICK DR / ROSA PARKS RD

ZONE ATLAS:
 C-10, C-11

WILSON & COMPANY 4900 LANG AVE NE ALBUQUERQUE, NM 87109 (505) 348-4000		LA CUENTISTA SUBDIVISION - UNIT II			
		PERIMETER WALL LANDSCAPE PLAN			
REVISIONS	NO.	DATE	REMARKS	BY	
DESIGN	KIS	WCEA NO. 1460008900	DATE	OCT 2017	
DRAWN	OR	PROJECT NO. 709786	SHEET NO.		
CHECK	KIS	709787 709788	4 OF 4		

The Hilltop

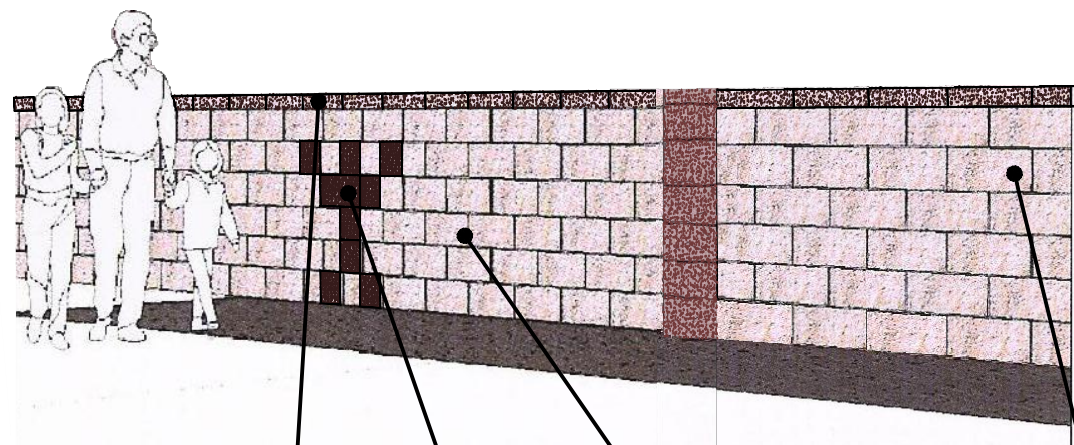

PERSPECTIVE WALL RENDERING
SCALE: NTS

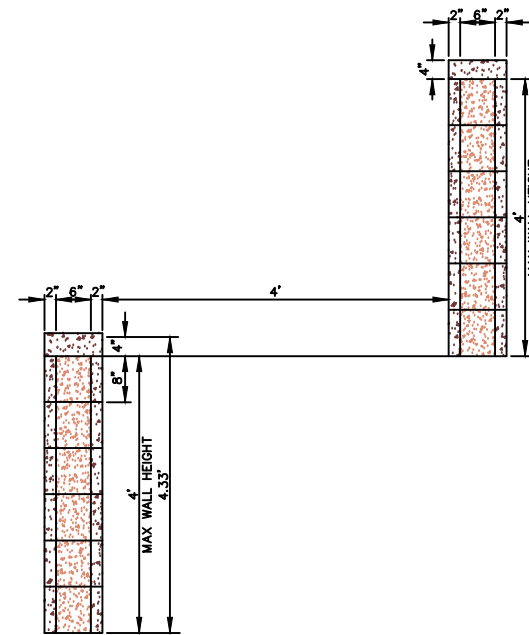

WALL CROSS SECTION
VIEW A-A
SCALE: NTS

NOTES:

THE OVERALL WALL PROGRAM AT LA CUENTISTA IS DESIGNED TO ENCOMPASS THE CHARACTER OF THE WEST MESA, ACHIEVED BY BREAKS OR OPENINGS IN THE WALL AT OPEN SPACE SECTIONS, ALLOWING FOR PEDESTRIAN ACCESS CONTINUITY, LOWERING THE WALL HEIGHT PER THE SECTOR DEVELOPMENT PLAN, PROVIDING A BASALT COLORED FEATURE DESIGNED TO ECHO PREDOMINANT PETROGLYPHS WHICH ARE SET IN A SPLIT-FACE WALL WITH CONTRASTING PILASTERS IN COLORS THAT MIMIC HUES FOUND ON THE MESA TOP. RETAINING WALLS HAVE BEEN MINIMIZED AND AN ADJACENT YARD WALL WILL BE SET BACK 4' WITH NATIVE LANDSCAPING IN FRONT.

REQUIREMENTS:

- LAYOUT: 1) DECORATIVE FEATURE (BASALT COLORED CMU 'DEER MAN' PATTERN) SET IN LIGHT COLORED WALL SECTION EVERY 40', FACING PUBLIC ROW. ENTIRE WALL SECTION WITH THIS PATTERN WILL BE SPLIT-FACE CMU.
2) CONTRASTING DARKER SPLIT-FACE CMU PILASTERS EVERY 20', PROJECTING 2" ON THE PUBLIC SIDE OF THE WALL SURFACE. CONTRASTING CAP ALONG THE ENTIRE WALL.
3) RETAINING WALL/YARD WALL - RETAINING WALL WILL BE NO GREATER THAN 4' IN HEIGHT AND YARD WALL WILL BE NO GREATER THAN 5' IN HEIGHT AND SET BACK 4' HORIZONTALLY.

- FACADE: 1) LANDSCAPING WILL BE PROVIDED IN FRONT OF THE YARD WALL WHERE RETAINING IS REQUIRED; MINIMUM 25% OF WALL SURFACE.
2) LA CUENTISTA SUBDIVISION PERIMETER WALL DESIGN COMPLIES WITH THE CITY WALL REGULATIONS ON HEIGHT, LAYOUT, FACADE, AND MATERIALS.
3) THE PRIMARY WALL SURFACE WILL BE SPLIT-FACE COLORED CMU.

- WALL HEIGHT: 1) RETAINING WALLS SHALL BE LIMITED TO 4' IN HEIGHT.
2) PERIMETER YARD WALLS SHALL BE LIMITED TO 5.7' IN HEIGHT.

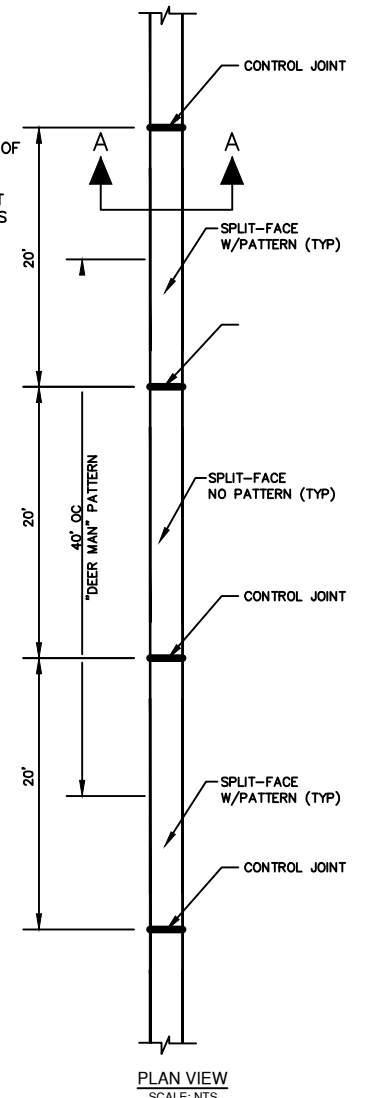

PLAN VIEW
SCALE: NTS

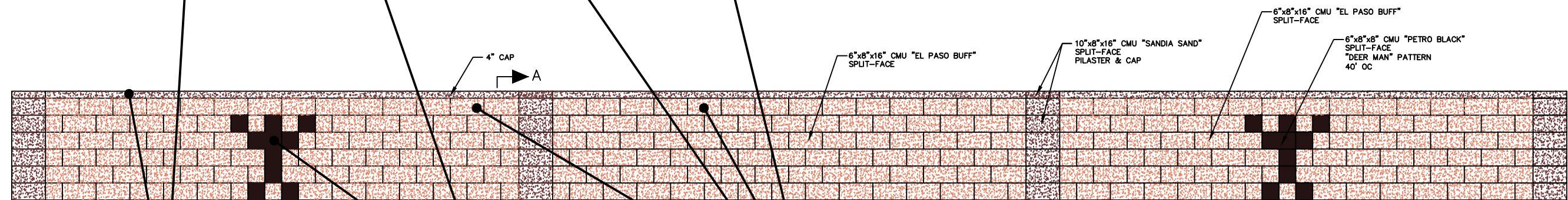

WALL ELEVATION
SCALE: NTS



SANDIA SAND
SPLIT-FACE



PETRO BLACK
SPLIT-FACE



EL PASO BUFF
SPLIT-FACE

DRB # 1005182

NEAREST INTERSECTION:
KIMMICK DR / ROSA PARKS RD

ZONE ATLAS:
C-10, C-11

WILSON & COMPANY

4900 LANG AVE NE
ALBUQUERQUE, NM
87109
(505) 348-4000

LA CUENTISTA SUBDIVISION - UNIT II

PERIMETER WALL DETAIL-
WITH RETAINING

REVISIONS	NO.	DATE	REMARKS	BY
DESIGN	DMD	WCEA NO. 1460008900	DATE OCT 2017	
DRAWN	ALL	PROJECT NO. 709786	SHEET NO.	
CHECK	DMD	709787 709788	2 OF 4	