



Supplemental Form (SF)

SUBDIVISION

- Major subdivision action
- Minor subdivision action
- Vacation
- Variance (Non-Zoning)

SITE DEVELOPMENT PLAN

- for Subdivision
- for Building Permit
- Administrative Amendment (AA)
- Administrative Approval (DRT, URT, etc.)
- IP Master Development Plan
- Cert. of Appropriateness (LUCC)

STORM DRAINAGE (Form D)

- Storm Drainage Cost Allocation Plan

S Z ZONING & PLANNING

- Annexation
- V** Zone Map Amendment (Establish or Change Zoning, includes Zoning within Sector Development Plans)
- P** Adoption of Rank 2 or 3 Plan or similar
- Text Amendment to Adopted Rank 1, 2 or 3 Plan(s), Zoning Code, or Subd. Regulations
- D** Street Name Change (Local & Collector)
- L A** **APPEAL / PROTEST of...**
 - Decision by: DRB, EPC, LUCC, Planning Director, ZEO, ZHE, Board of Appeals, other

PRINT OR TYPE IN BLACK INK ONLY. The applicant or agent must submit the completed application in person to the Planning Department Development Services Center, 600 2nd Street NW, Albuquerque, NM 87102.
Fees must be paid at the time of application. Refer to supplemental forms for submittal requirements.

APPLICATION INFORMATION:

Professional/Agent (if any): Mark Goodwin and Associates PA PHONE: 828-2200
 ADDRESS: PO Box 90606 FAX: _____
 CITY: Albuquerque STATE nm ZIP 87199 E-MAIL: douge.goodwin@engineers.com
 APPLICANT: LGI Homes PHONE: (415) 595-4293
 ADDRESS: 9150 E. Del Camino Suite 118 FAX: _____
 CITY: Scottsdale STATE AZ ZIP 85258 E-MAIL: ehillshome@lghomes.com
 Proprietary interest in site: Purchase Contract Accepted List all owners: Salazar Family Trust

DESCRIPTION OF REQUEST: Sketch Plat Request for 233 Residential Lots for Lands of Salazar

Is the applicant seeking incentives pursuant to the Family Housing Development Program? Yes. No.

SITE INFORMATION: ACCURACY OF THE EXISTING LEGAL DESCRIPTION IS CRUCIAL! ATTACH A SEPARATE SHEET IF NECESSARY.

Lot or Tract No. A-1-A & A-1-B Block: _____ Unit: _____
 Subdiv/Addn/TBKA: Bulk Land Plat for Lands of Salazar Family Trust
 Existing Zoning: R-LT Proposed zoning: R-LT MRGCD Map No. _____
 Zone Atlas page(s): N-09 UPC Code: 100905405008040201
100905410007040202

CASE HISTORY:

List any current or prior case number that may be relevant to your application (Proj., App., DRB-, AX, Z, V, S, etc.): _____

CASE INFORMATION:

Within city limits? Yes Within 1000FT of a landfill? no
 No. of existing lots: 2 No. of proposed lots: 233 Total site area (acres): 41.82
 LOCATION OF PROPERTY BY STREETS: On or Near: 98th Street SW
 Between: Dennis Chavez Blvd SW and Colobel Ave SW
 Check if project was previously reviewed by: Sketch Plat/Plan or Pre-application Review Team(PRT) Review Date: _____

SIGNATURE

James D Hughes
 (Print Name) James D Hughes

DATE 4-12-2016
 Applicant: Agent:

FOR OFFICIAL USE ONLY

Revised: 11/2014

<input type="checkbox"/> INTERNAL ROUTING	Application case numbers	Action	S.F.	Fees
<input type="checkbox"/> All checklists are complete	_____	_____	_____	\$ _____
<input type="checkbox"/> All fees have been collected	_____	_____	_____	\$ _____
<input type="checkbox"/> All case #s are assigned	_____	_____	_____	\$ _____
<input type="checkbox"/> AGIS copy has been sent	_____	_____	_____	\$ _____
<input type="checkbox"/> Case history #s are listed	_____	_____	_____	\$ _____
<input type="checkbox"/> Site is within 1000ft of a landfill	_____	_____	_____	\$ _____
<input type="checkbox"/> F.H.D.P. density bonus				Total
<input type="checkbox"/> F.H.D.P. fee rebate				\$ _____
	Hearing date _____			

Project # _____

Staff signature & Date _____

FORM S(3): SUBDIVISION - D.R.B. MEETING (UNADVERTISED) OR INTERNAL ROUTING

A Bulk Land Variance requires application on FORM-V in addition to application for subdivision on FORM-S.

SKETCH PLAT REVIEW AND COMMENT (DRB22) **Your attendance is required.**

- Scale drawing of the proposed subdivision plat (folded to fit into an 8.5" by 14" pocket) **6 copies**
- Site sketch with measurements showing structures, parking, Bldg. setbacks, adjacent rights-of-way and street improvements, if there is any existing land use (folded to fit into an 8.5" by 14" pocket) **6 copies**
- Zone Atlas map with the entire property(ies) clearly outlined
- Letter briefly describing, explaining, and justifying the request
- N/A** List any original and/or related file numbers on the cover application

EXTENSION OF MAJOR PRELIMINARY PLAT (DRB08) **Your attendance is required.**

- Preliminary Plat reduced to 8.5" x 11"
 - Zone Atlas map with the entire property(ies) clearly outlined
 - Letter briefly describing, explaining, and justifying the request
 - Copy of DRB approved infrastructure list
 - Copy of the LATEST Official DRB Notice of approval for Preliminary Plat Extension request
 - List any original and/or related file numbers on the cover application
- Extension of preliminary plat approval expires after one year.**

MAJOR SUBDIVISION FINAL PLAT APPROVAL (DRB12) **Your attendance is required.**

- Proposed Final Plat (folded to fit into an 8.5" by 14" pocket) **6 copies**
- Signed & recorded Final Pre-Development Facilities Fee Agreement for **Residential** development only
- Design elevations & cross sections of perimeter walls **3 copies**
- Zone Atlas map with the entire property(ies) clearly outlined
- Bring original Mylar of plat to meeting, ensure property owner's and City Surveyor's signatures are on the plat
- Copy of recorded SIA
- Landfill disclosure and EHD signature line on the Mylar if property is within a landfill buffer
- List any original and/or related file numbers on the cover application
- DXF file and hard copy of final plat data for AGIS is required.

MINOR SUBDIVISION PRELIMINARY/FINAL PLAT APPROVAL (DRB16) **Your attendance is required.**

- 5 Acres or more: Certificate of No Effect or Approval
- Proposed Preliminary / Final Plat (folded to fit into an 8.5" by 14" pocket) **6 copies** for unadvertised meetings ensure property owner's and City Surveyor's signatures are on the plat prior to submittal
- Signed & recorded Final Pre-Development Facilities Fee Agreement for **Residential** development only
- Design elevations and cross sections of perimeter walls (11" by 17" maximum) **3 copies**
- Site sketch with measurements showing structures, parking, Bldg. setbacks, adjacent rights-of-way and street improvements, if there is any existing land use (folded to fit into an 8.5" by 14" pocket) **6 copies**
- Zone Atlas map with the entire property(ies) clearly outlined
- Letter briefly describing, explaining, and justifying the request
- Bring original Mylar of plat to meeting, ensure property owner's and City Surveyor's signatures are on the plat
- Landfill disclosure and EHD signature line on the Mylar if property is within a landfill buffer
- Fee (see schedule)
- List any original and/or related file numbers on the cover application
- Infrastructure list if required (**verify with DRB Engineer**)
- DXF file and hard copy of final plat data for AGIS is required.

AMENDMENT TO PRELIMINARY PLAT (with minor changes) (DRB03) **Your attendance is required.**

- PLEASE NOTE: There are no clear distinctions between significant and minor changes with regard to subdivision amendments. Significant changes are those deemed by the DRB to require public notice and public hearing.
- Proposed Amended Preliminary Plat, Infrastructure List, and/or Grading Plan (folded to fit into an 8.5" by 14" pocket) **6 copies**
 - Original Preliminary Plat, Infrastructure List, and/or Grading Plan (folded to fit into an 8.5" by 14" pocket) **6 copies**
 - Zone Atlas map with the entire property(ies) clearly outlined
 - Letter briefly describing, explaining, and justifying the request
 - Bring original Mylar of plat to meeting, ensure property owner's and City Surveyor's signatures are on the plat
 - List any original and/or related file numbers on the cover application
- Amended preliminary plat approval expires after one year**

I, the applicant, acknowledge that any information required but not submitted with this application will likely result in deferral of actions.



 Applicant name (print)
James D. Hughes
 Applicant signature / date
8-12-2016



Form revised **October 2007**

- | | |
|--|--------------------------|
| <input type="checkbox"/> Checklists complete | Application case numbers |
| <input type="checkbox"/> Fees collected | _____ |
| <input type="checkbox"/> Case #s assigned | _____ |
| <input type="checkbox"/> Related #s listed | _____ |

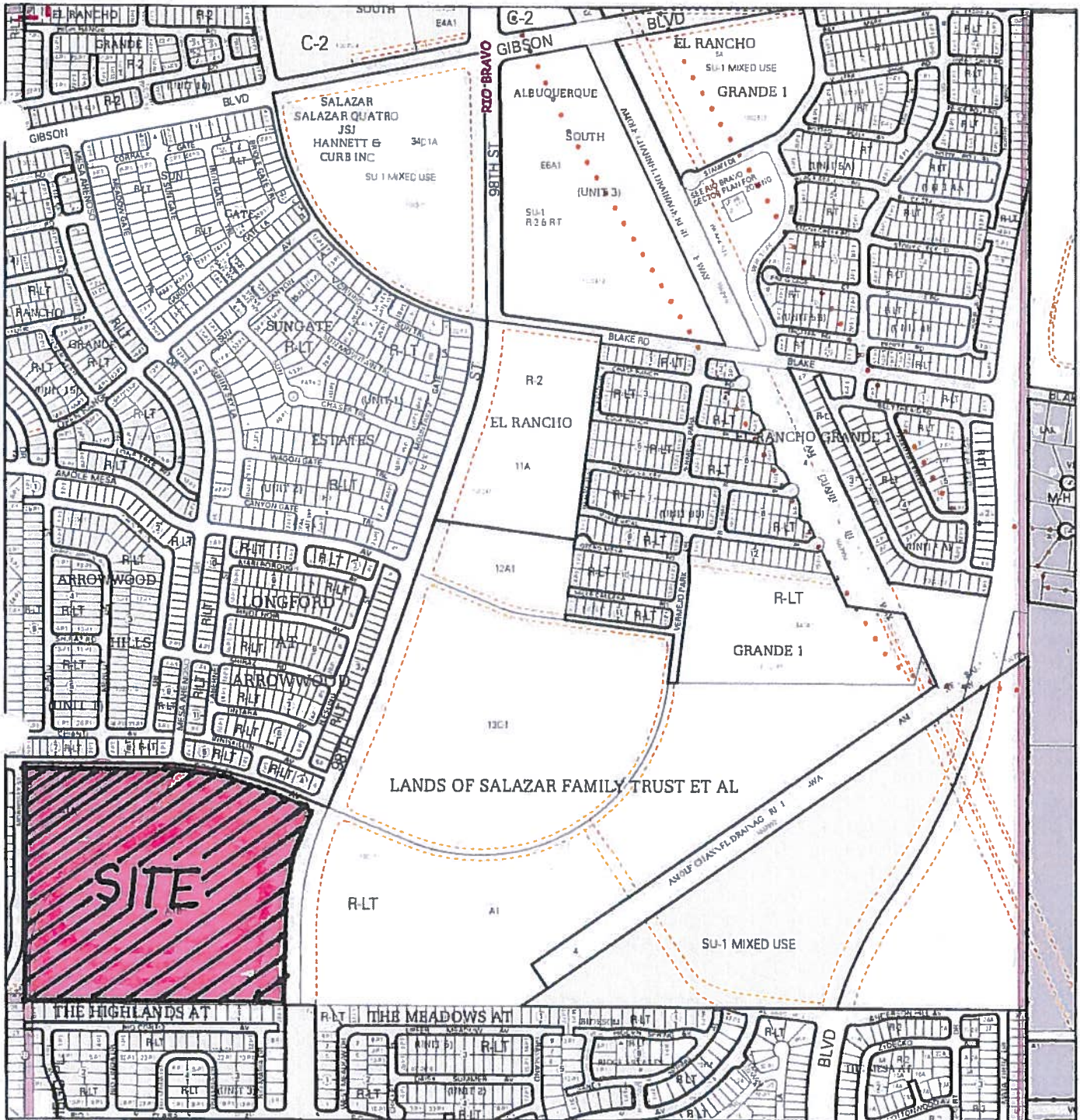
 Planner signature / date
 Project # _____



For more current information and details visit: <http://www.cabq.gov/gis>



Map amended through: 4/2/2012

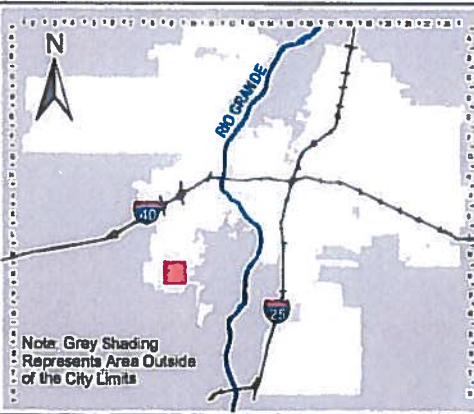

Note: Grey Shading Represents Area Outside of the City Limits

Zone Atlas Page:
N-09-Z

Selected Symbols

- SECTOR PLANS**
- Design Overlay Zones**
- City Historic Zones**
- H-1 Buffer Zone**
- Petroglyph Mon.**
- Escarpment**
- 2 Mile Airport Zone**
- Airport Noise Contours**
- Wall Overlay Zone**





D. Mark Goodwin & Associates, P.A.
Consulting Engineers

P.O. BOX 90606, ALBUQUERQUE, NM 87199
(505) 828-2200 FAX 797-9539

*~ 2012 ACEC/NM Award Winner for Engineering Excellence ~
~ 2008 ACEC/NM Award Winner for Engineering Excellence ~*

April 12, 2016

Mr. Jack Cloud
City of Albuquerque
P.O. Box 1293
Albuquerque, NM 87103

Re: Lands of Salazar

Dear Mr. Cloud:

Attached, please find the Sketch Plat for the referenced property. This layout meets the Zoning Code and the requirements for the DPM.

Please call with any questions or concerns.

Sincerely,
Mark Goodwin & Associates, PA

A handwritten signature in blue ink, reading 'James D. Hughes'. The signature is written in a cursive, flowing style.

James D. Hughes, PE
Senior Engineer

DMG/kb