

Current DRC  
Project Number: \_\_\_\_\_

ORIGINAL

FIGURE 12

INFRASTRUCTURE LIST

EXHIBIT "A"

TO SUBDIVISION IMPROVEMENTS AGREEMENT  
DEVELOPMENT REVIEW BOARD (D.R.B.) REQUIRED INFRASTRUCTURE LIST

**Desert Sands Subdivision Units 1 and 2**

~~PROPOSED NAME OF PLAT AND/OR SITE DEVELOPMENT PLAN~~

**Tracts A-1-A and A-1-B of the Lands of Salazar Family Trust**

**EXISTING LEGAL DESCRIPTION PRIOR TO PLATTING ACTION**

Date Submitted: August 23, 2016  
Date Site Plan Approved: 8-24-16  
Date Preliminary Plat Approved: \_\_\_\_\_  
Date Preliminary Plat Expires: 8-24-17  
DRB Project No.: 1005224  
DRB Application No.: \_\_\_\_\_

Following is a summary of PUBLIC/PRIVATE Infrastructure required to be constructed or financially guaranteed for the above development. This Listing is not necessarily a complete listing. During the SIA process and/or in the review of the construction drawings, if the DRC Chair determines that appurtenant items and/or unforeseen items have not been included in the Infrastructure listing, the DRC Chair may include those items in the listing and related financial guarantee. Likewise, if the DRC Chair determines that appurtenant or non-essential items can be deleted from the listing, those items may be deleted as well as the related portions of the financial guarantees. All such revisions require approval by the DRC Chair, the User Department and agent/owner. If such approvals are obtained, these revisions to the listing will be incorporated administratively. In addition, any unforeseen items which arise during construction which are necessary to complete the project and which normally are the Subdivider's responsibility will be required as a condition of project acceptance and close out by the City. Unit 1 must precede Unit 2.

SIA Sequence #	COA DRC Project #	Size	Type of Improvement	Location	From	To	Private Inspector	City Inspector	City Cnst Engineer
		14'	Collector Paving to complete 40' FF C&G (south side only)	Colobel Ave	98" St.	Pauza Dr.	/	/	/
		6'	Sidewalk (South side only)				/	/	/
		36' FF	Major Local Paving C&G (both sides)	Pauza Dr.	Colobel Ave	Artemisia Ave	/	/	/
		6'	Sidewalk (both sides)				/	/	/
		28' FF	Major Local Paving C&G (both sides)	Pauza Dr.	Artemisia Ave	Farinosa Ave.	/	/	/
		4'	Sidewalk (west side)				/	/	/
		4'	Sidewalk (east side) <sup>(1)</sup>				/	/	/
		28' FF	Local Residential Paving C&G (both sides)	Pauza Dr.	Farinosa Ave.	Sacate Blanco	/	/	/
		4'	Sidewalk (both sides)				/	/	/
		28' FF	Local Residential Paving C&G (both sides)	Bosque de Oro Dr.	Artemisia Ave	Farinosa Ave.	/	/	/
		4'	Sidewalk (both sides) <sup>(1)</sup>				/	/	/
		28' FF	Local Residential Paving C&G (both sides)	Terra Dorado Dr.	Artemisia Ave	Farinosa Ave.	/	/	/
		4'	Sidewalk (both sides) <sup>(1)</sup>				/	/	/

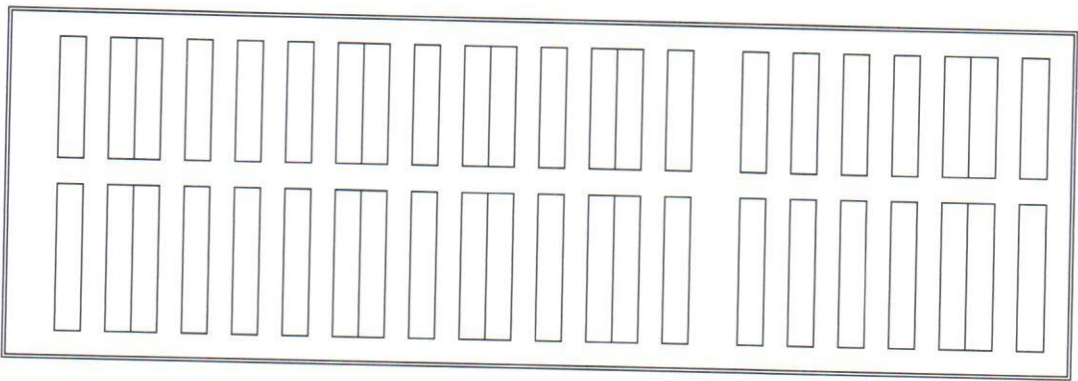

28' FF	Local Residential Paving C&G (both sides) Sidewalk (east side) <sup>(1)</sup> 4' Sidewalk (west side)	Tierra Dorado Dr.	Farinosa Ave.	Sacate Blanco
26' FF	Local Residential Paving C&G (both sides) Sidewalk (east side only) <sup>(1)</sup> 4'	Tierra Dorado Dr.	Artemisia Ave	North end of Stub
28' FF	Local Residential Paving C&G (both sides) Sidewalk (both sides)	Artemisia Ave	Lot 12 Block 7	Pauza Dr.
28' FF	Local Residential Paving C&G (both sides) Sidewalk (north side) <sup>(1)</sup> 4' Sidewalk (south side)	Artemisia Ave	Pauza Dr.	Tierra Dorado Dr.
26' FF	Local Residential Paving C&G (both sides) Sidewalk (north side) <sup>(1)</sup> 4' Sidewalk (south side)	Andrews Ave	Lot 16 Block 7	Pauza Dr.
26' FF	Local Residential Paving C&G (both sides) Sidewalk (north side) 4' Sidewalk (south side) <sup>(1)</sup>	Farinosa Ave.	Lot 16 Block 8	Tierra Dorado Dr.
26' FF	Local Residential Paving C&G (both sides) Sidewalk (both sides) <sup>(1)</sup> 4'	Sacate Blanco	Lot 47 Block 1	Tierra Dorado Dr.
28' FF	Major Local Paving C&G (both sides) Sidewalk (north side) 4' Sidewalk (south side) <sup>(1)</sup> 6' Sidewalk	Sacate Blanco	Tierra Dorado Dr.	98th St.
		12' Pedestrian Easement Tract C	Tierra Dorado Dr.	Colibal Ave

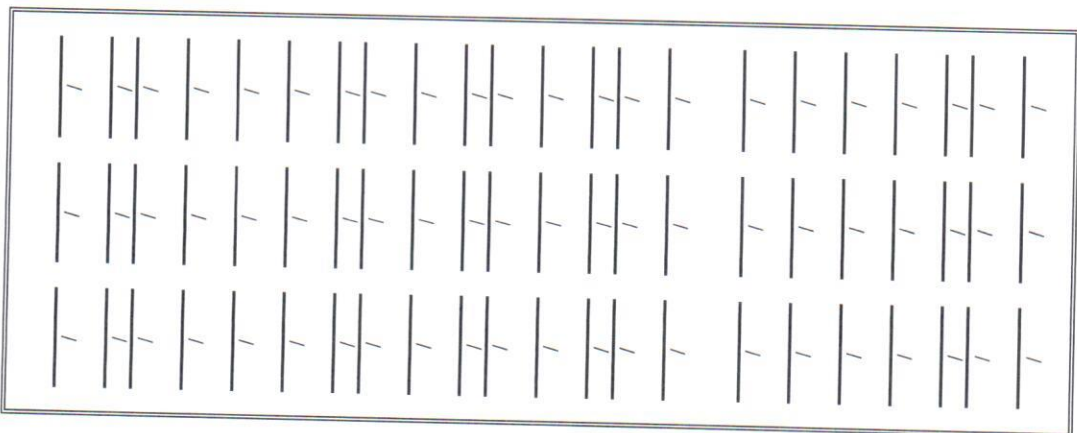

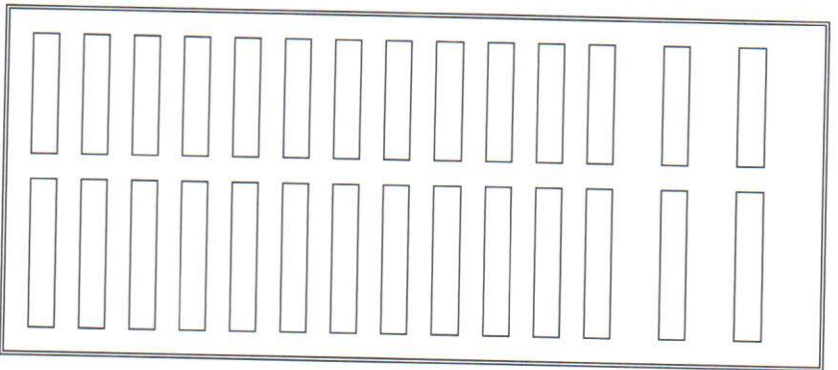

**WATER**

12" Waterline  
 12" Waterline  
 12" Waterline  
 12" Waterline  
 12" Waterline (7)  
 12" Waterline  
 8" Waterline  
 8" Waterline  
 8" Waterline  
 8" Waterline  
 8" Waterline  
 8" Waterline  
 8" Waterline  
 8" Waterline  
 8" Waterline  
 8" Waterline

Pauza Dr.  
 Sacate Blanco  
 98" St.  
 98" St.  
 98" St.  
 Colobel Ave  
 Tierra Dorado Dr.  
 Sacate Blanco  
 Bosque de Oro Dr.  
 Artemisia Ave  
 Andrews Ave  
 Farnosa Ave.  
 Sacate Blanco  
 Sacate Blanco

Existing 12" WL at Artemisia Ave  
 Pauza Dr.  
 Innskillin Ave  
 Colobel Ave  
 Sacate Blanco Ave  
 98" St.  
 Colobel Ave  
 Tierra Dorado Dr.  
 Artemisia Ave  
 Lot 12 Block 7  
 Lot 16 Block 7  
 Lot 16 Block 8  
 Pauza Dr.  
 Pauza Dr.

Sacate Blanco  
 Existing 12" WL at West end of Cui-de-sac  
 Colobel Ave  
 Sacate Blanco Ave  
 Rio Corto Ave.  
 Tierra Dorado Dr.  
 Sacate Blanco  
 98" St.  
 Farnosa Ave.  
 Tierra Dorado Dr.  
 Pauza Dr.  
 Tierra Dorado Dr.  
 Tierra Dorado Dr.

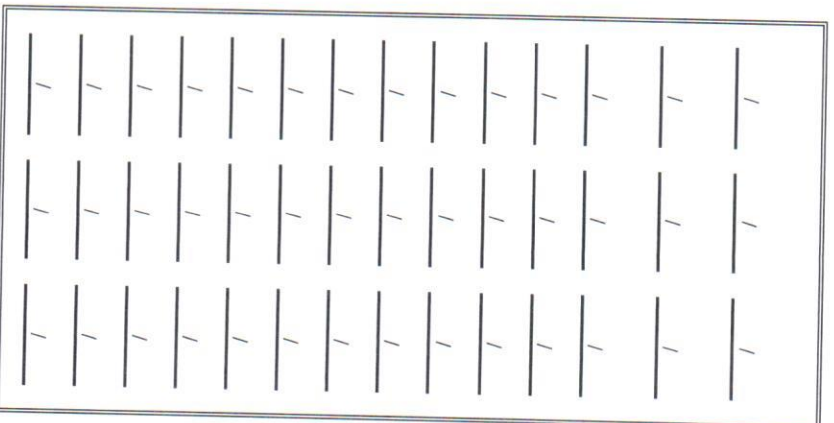

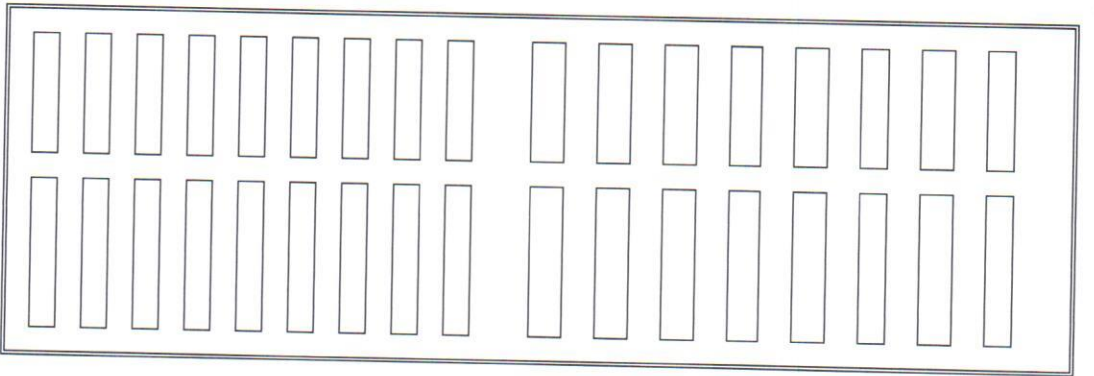

**SANITARY SEWER**

8"	Sanitary Sewer	Paenza Dr.	Artemisia Ave	Farmosa Ave.
8"	Sanitary Sewer	Bosque de Oro Dr.	Artemisia Ave	Farmosa Ave.
8"	Sanitary Sewer	Tierra Dorado Dr.	Lot 12 Block 2	Sacate Blanco
8"	Sanitary Sewer	Artemisia Ave	Lot 12 Block 7	Tierra Dorado Dr.
8"	Sanitary Sewer	Andrews Ave	Lot 16 Block 7	Paenza Dr.
8"	Sanitary Sewer	Farmosa Ave.	Lot 16 Block 8	Tierra Dorado Dr.
8"	Sanitary Sewer	Sacate Blanco	Lot 47 Block 1	98 <sup>th</sup> St.
8"	Sanitary Sewer	98 <sup>th</sup> St.	Sacate Blanco	Rio Corto Ave.
<b>Storm Drain</b>				
18"	Storm Drain	Colobel Ave & Tract C	Colobel Ave	Pond on Tract C
18" - 42"	Storm Drain	Farmosa Ave.	Lot 45 Block 1	Tierra Dorado Dr.
18" - 54"	Storm Drain	Tierra Dorado Dr.	Lot 16 Block 5	Sacate Blanco
18" - 36"	Storm Drain	Sacate Blanco	Lot 25 Block 3	Tierra Dorado Dr.
54"	Storm Drain	Esmit on Tract C	Tierra Dorado Dr.	98 <sup>th</sup> St.
.2 ac-ft	Retention Pond with Agreement and Covenant	New Public Drainage Easement on Tract C		
0.7 ac-ft	First Flush Pond with Agreement and Covenant	New Public Drainage Easement on Tract A-1-C Lands of Salazar east of 98th St.		
\$50,000	Letter of Map Revision (LOMR)	Unit 1		
Per Design	Revegetate disturbed areas per Sec 1012	Tracts B, C, D, & F		

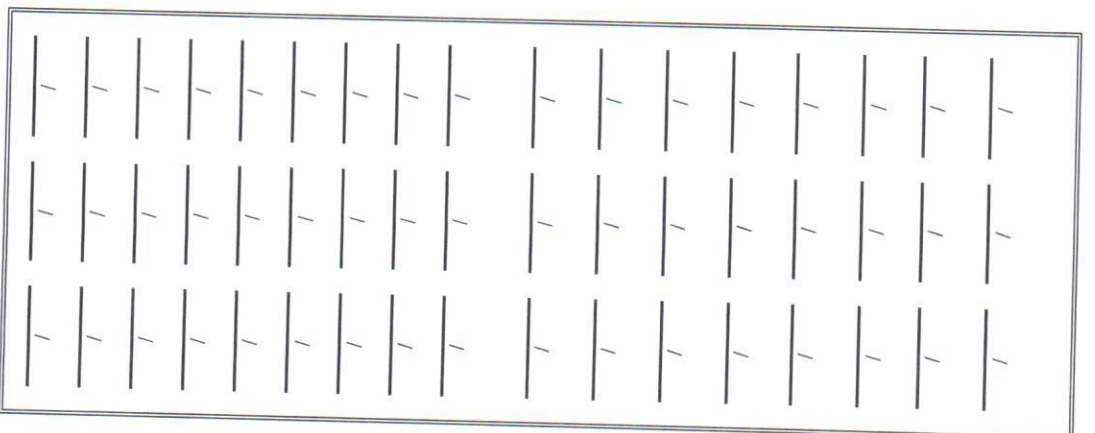

### Unit 2 Infrastructure

SIA Sequence #	COA DRC Project #	Size	Type of Improvement <b>PAVING</b>	Location	From	To	Private Inspector	City Inspector	City Cnst Engineer
		14'	Collector Paving to complete 40' FF C&G (south side only)	Colobel Ave	Morrissey St.	Paauz Dr.	/	/	/
		6'	Sidewalk (South side only)				/	/	/
		28' FF	Local Residential Paving	Artemisia Ave	West edge of Lot 12 Block 7	Rio Maule Dr.	/	/	/
		4'	C&G (both sides)				/	/	/
		4'	Sidewalk (north side) <sup>(1)</sup>				/	/	/
		4'	Sidewalk (south side)				/	/	/
		26' FF	Local Residential Paving	Rio Maule Dr.	Artemisia Ave	North end of Stub	/	/	/
		4'	C&G (both sides)				/	/	/
		4'	Sidewalk (west side only) <sup>(1)</sup>				/	/	/
		26' FF	Local Residential Paving	Andrews Ave	West edge of Lot 15 Block 7	Rio Maule Dr.	/	/	/
		4'	C&G (both sides)				/	/	/
		4'	Sidewalk (north side) <sup>(1)</sup>				/	/	/
		4'	Sidewalk (south side)				/	/	/
		26' FF	Local Residential Paving	Farinosa Ave.	Rio Maule Dr.	West edge of Lot 9 Block 8	/	/	/
		4'	C&G (both sides)				/	/	/
		4'	Sidewalk (north side)				/	/	/
		4'	Sidewalk (south side) <sup>(1)</sup>				/	/	/
		26' FF	Local Residential Paving	Farinosa Ave.	West edge of Lot 9 Block 8	West edge of Lot 16 Block 8	/	/	/
		4'	C&G (both sides)				/	/	/
		4'	Sidewalk (both sides) <sup>(1)</sup>				/	/	/
		26' FF	Local Residential Paving	Farinosa Ave.	Rio Maule Dr.	West end of Stub	/	/	/
		4'	C&G (both sides)				/	/	/
		4'	Sidewalk (south side) <sup>(1)</sup>				/	/	/
		26' FF	Local Residential Paving	Sacate Blanco	West edge of Lot 47 Block 1	West end of Sacate Blanco	/	/	/
		4'	C&G (both sides)				/	/	/
		4'	Sidewalk (both sides) <sup>(1)</sup>				/	/	/
		48' Radius	Local Residential Paving (Cul-de-sac) C&G (around Perimeter)	West end of Sacate Blanco			/	/	/
		4'	Sidewalk (north side only) <sup>(1)</sup>				/	/	/
		26' FF	Local Residential Paving	Rio Maule Dr.	Artemisia Ave	Andrews Ave	/	/	/
		4'	C&G (both sides)				/	/	/
		4'	Sidewalk (west side) <sup>(1)</sup>				/	/	/
		4'	Sidewalk (east side)				/	/	/

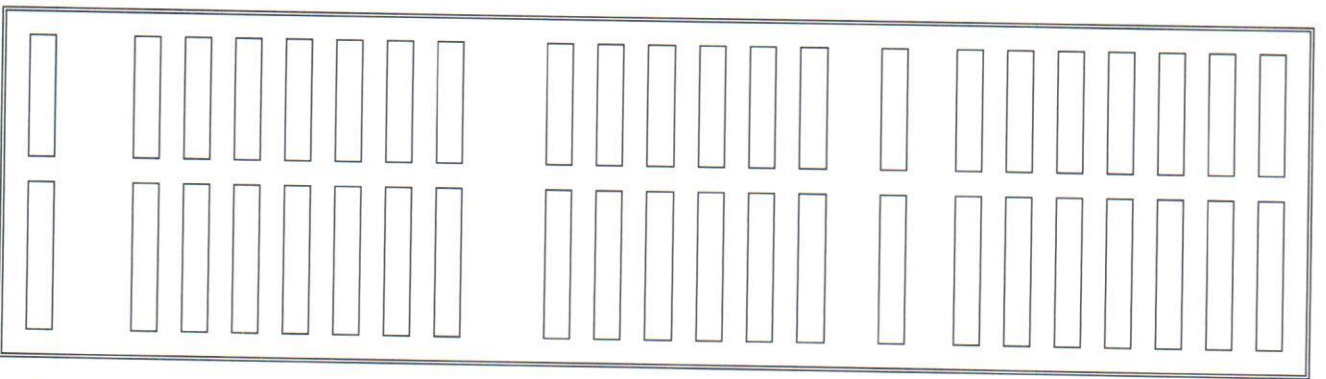

26' FF	Local Residential Paving C&G (both sides) Sidewalk (both sides) (1)	Rio Maule Dr.	Andrews Ave	Farrosa Ave.
4'	Local Residential Paving C&G (both sides) Sidewalk (both sides) (1)	Kraft Ct.	Andrews Ave	South end of Kraft Ct
26' FF	Local Residential Paving (Hammer Head) C&G (both sides) Sidewalk (south side only) (1)	South end of Kraft Ct		
4'				
6'	Sidewalk	12' Pedestrian Easement Tract A	Rio Maule Dr. Stub	Colobel Ave.
6'	Sidewalk	12' Pedestrian Easement Tract G	Farrosa Ave Stub	Morrissey St.
<b>WATER</b>				
8"	Waterline	Artemisia Ave	Unit 1 Boundary	Rio Maule Dr.
8"	Waterline	Andrews Ave	Unit 1 Boundary	Rio Maule Dr.
8"	Waterline	Farrosa Ave.	Unit 1 Boundary	Morrissey St.
8"	Waterline	Rio Maule Dr.	Lot 13 Block 1	Farrosa Ave.
4"	Waterline	Kraft Ct.	Andrews Ave	Kraft Ct (Hammer head)
4"	Waterline	Kraft Ct (Hammer head)	West end	East end
<b>SANITARY SEWER</b>				
8"	Sanitary Sewer	Artemisia Ave	Unit 1 Boundary	Rio Maule Dr.
8"	Sanitary Sewer	Andrews Ave	Unit 1 Boundary	Rio Maule Dr.
8"	Sanitary Sewer	Farrosa Ave.	Unit 1 Boundary	Lot 31 Block 1
8"	Sanitary Sewer	Sacate Blanco	Unit 1 Boundary	Lot 60 Block 1
8"	Sanitary Sewer	Rio Maule Dr.	Lot 13 Block 1	Farrosa Ave.
8"	Sanitary Sewer	Kraft Ct.	Andrews Ave	Kraft Ct (Hammer head)
8"	Sanitary Sewer	Kraft Ct (Hammer head)	West end	East end
<b>Storm Drain</b>				
Per Design	Revegetate disturbed areas per Sec 1012	Tracts A, E, & G.		

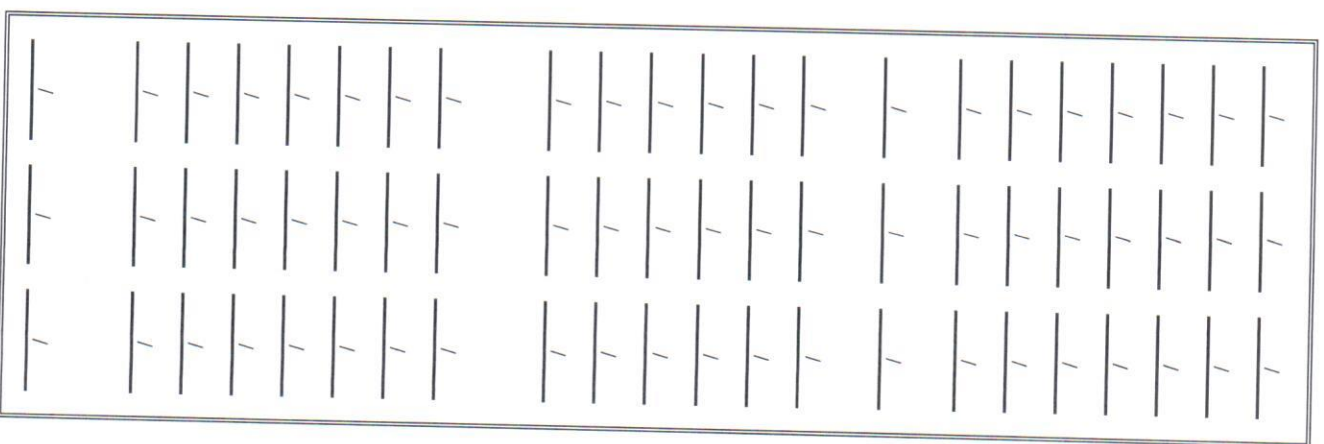

The items listed below are on the CCIP and approved for Impact Fee credits. Signatures from the Impact Fee Administrator and the City User Department is required prior to DRB approval of this listing. The items listed below are subject to the standard SIA requirements.

Financially Guaranteed DRC #	Constructed Under DRC #	Size	Type of Improvement	Location	From	To	Construction Certification	
							Private Inspector P.E.	City Crst Engineer
							/	/
							/	/
							/	/
							/	/

- Sidewalks to be Deferred per the approved sidewalk deferral exhibit.
- Street Lights Per DPM
- Water Infrastructure includes Valves, Fittings, Valve Boxes, Fire Hydrants, and Appurtenances.
- Sanitary Sewer includes manholes and service connection to property line
- Storm Drain includes manholes & inlets and Storm Drain sizes shall be per DRC final design and analysis.
- Engineer's Certification of Private Grading & Drainage per DPM for release of SIA & Financial Guaranty's. Earthwork and private retaining walls will not be financially guaranteed.
- Construction of the 12" waterline in 98th St. between Colobel Ave and Sacate Blanco is to be deferred to a later date and may be replaced by a looped waterline east of 98th St. at the time of the future development of the property east of 98th St. The line in 98th St. is to be financially guaranteed and not constructed with Unit 1.

**AGENT / OWNER** **DEVELOPMENT REVIEW BOARD MEMBER APPROVALS**

James D. Hughes *[Signature]* 8-24-16  
 NAME (print) DRB CHAIR - date

Mark Goodwin & Assoc. *[Signature]* 8/24/16  
 FIRM TRANSPORTATION DEVELOPMENT - date

*[Signature]* 8-23-2016 *[Signature]* 8-24-16  
 SIGNATURE - date UTILITY DEVELOPMENT - date

MAXIMUM TIME ALLOWED TO CONSTRUCT \_\_\_\_\_  
 THE IMPROVEMENTS WITHOUT A DRB \_\_\_\_\_  
 EXTENSION: N/A CITY ENGINEER - date

**DESIGN REVIEW COMMITTEE REVISIONS**

REVISION	DATE	DRC CHAIR	USER DEPARTMENT	AGENT / OWNER