

Current DRC
Project Number: _____

ORIGINAL

FIGURE 12

INFRASTRUCTURE LIST

EXHIBIT "A"

TO SUBDIVISION IMPROVEMENTS AGREEMENT
DEVELOPMENT REVIEW BOARD (D.R.B.) REQUIRED INFRASTRUCTURE LIST

Desert Sands Subdivision Units 1 and 2

~~PROPOSED NAME OF PLAT AND/OR SHEET DEVELOPMENT PLAN~~

Tracts A-1-A and A-1-B of the Lands of Salazar Family Trust
EXISTING LEGAL DESCRIPTION PRIOR TO PLATTING ACTION

Date Submitted: August 23, 2016
Date Site Plan Approved: 8-24-16
Date Preliminary Plat Approved: 8-24-17
Date Preliminary Plat Expires: 8-24-17
DRB Project No.: 1005224
DRB Application No.: _____

Following is a summary of PUBLIC/PRIVATE Infrastructure required to be constructed or financially guaranteed for the above development. This Listing is not necessarily a complete listing. During the SIA process and/or in the review of the construction drawings, if the DRC Chair determines that appurtenant items and/or unforeseen items have not been included in the Infrastructure listing, the DRC Chair may include those items in the listing and related financial guarantee. Likewise, if the DRC Chair determines that appurtenant or non-essential items can be deleted from the listing, those items may be deleted as well as the related portions of the financial guarantees. All such revisions require approval by the DRC Chair, the User Department and agent/owner. If such approvals are obtained, these revisions to the listing will be incorporated administratively. In addition, any unforeseen items which arise during construction which are necessary to complete the project and which normally are the Subdivider's responsibility will be required as a condition of project acceptance and close out by the City. Unit 1 must precede Unit 2.

| SIA Sequence # | COA DRC Project # | Size | Type of Improvement | Location | From | To | Private Inspector | City Inspector | City Cnst Engineer |
|----------------|-------------------|--------|---|-------------------|---------------|---------------|-------------------|----------------|--------------------|
| | | 14' | Collector Paving to complete 40' FF C&G (south side only) | Colobel Ave | 98" St. | Pauza Dr. | / | / | / |
| | | 6' | Sidewalk (South side only) | | | | / | / | / |
| | | 36' FF | Major Local Paving C&G (both sides) | Pauza Dr. | Colobel Ave | Artemisia Ave | / | / | / |
| | | 6' | Sidewalk (both sides) | | | | / | / | / |
| | | 28' FF | Major Local Paving C&G (both sides) | Pauza Dr. | Artemisia Ave | Farinosa Ave. | / | / | / |
| | | 4' | Sidewalk (west side) | | | | / | / | / |
| | | 4' | Sidewalk (east side) ⁽¹⁾ | | | | / | / | / |
| | | 28' FF | Local Residential Paving C&G (both sides) | Pauza Dr. | Farinosa Ave. | Sacate Blanco | / | / | / |
| | | 4' | Sidewalk (both sides) | | | | / | / | / |
| | | 28' FF | Local Residential Paving C&G (both sides) | Bosque de Oro Dr. | Artemisia Ave | Farinosa Ave. | / | / | / |
| | | 4' | Sidewalk (both sides) ⁽¹⁾ | | | | / | / | / |
| | | 28' FF | Local Residential Paving C&G (both sides) | Terra Dorado Dr. | Artemisia Ave | Farinosa Ave. | / | / | / |
| | | 4' | Sidewalk (both sides) ⁽¹⁾ | | | | / | / | / |

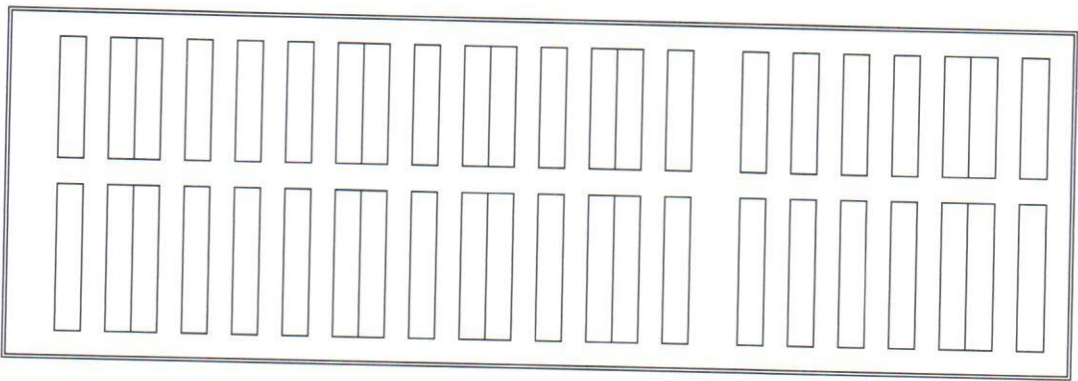

| | | | | |
|--------|--|------------------------------------|-------------------|-------------------|
| 28' FF | Local Residential Paving C&G (both sides) | Tierra Dorado Dr. | Farinosa Ave. | Sacate Blanco |
| 4' | Sidewalk (east side) ⁽¹⁾ | | | |
| 4' | Sidewalk (west side) | | | |
| 26' FF | Local Residential Paving C&G (both sides) | Tierra Dorado Dr. | Artemisia Ave | North end of Stub |
| 4' | Sidewalk (east side only) ⁽¹⁾ | | | |
| 28' FF | Local Residential Paving C&G (both sides) | Artemisia Ave | Lot 12 Block 7 | Pauza Dr. |
| 4' | Sidewalk (both sides) | | | |
| 28' FF | Local Residential Paving C&G (both sides) | Artemisia Ave | Pauza Dr. | Tierra Dorado Dr. |
| 4' | Sidewalk (north side) ⁽¹⁾ | | | |
| 4' | Sidewalk (south side) | | | |
| 26' FF | Local Residential Paving C&G (both sides) | Andrews Ave | Lot 16 Block 7 | Pauza Dr. |
| 4' | Sidewalk (north side) ⁽¹⁾ | | | |
| 4' | Sidewalk (south side) | | | |
| 26' FF | Local Residential Paving C&G (both sides) | Farinosa Ave. | Lot 16 Block 8 | Tierra Dorado Dr. |
| 4' | Sidewalk (north side) | | | |
| 4' | Sidewalk (south side) ⁽¹⁾ | | | |
| 26' FF | Local Residential Paving C&G (both sides) | Sacate Blanco | Lot 47 Block 1 | Tierra Dorado Dr. |
| 4' | Sidewalk (both sides) | | | |
| 4' | Sidewalk (both sides) ⁽¹⁾ | | | |
| 28' FF | Major Local Paving C&G (both sides) | Sacate Blanco | Tierra Dorado Dr. | 98th St. |
| 4' | Sidewalk (north side) | | | |
| 4' | Sidewalk (south side) ⁽¹⁾ | | | |
| 6' | Sidewalk | 12' Pedestrian Easement Tract C | Tierra Dorado Dr | Colibal Ave |

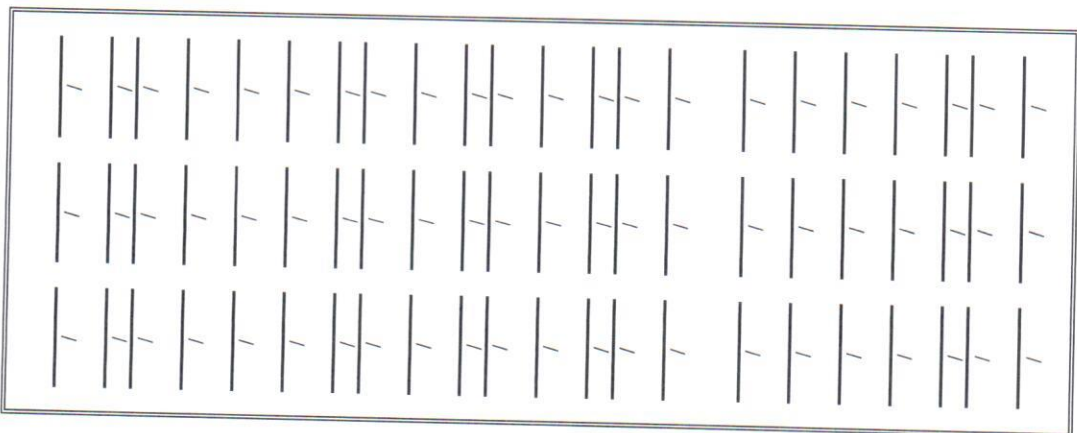

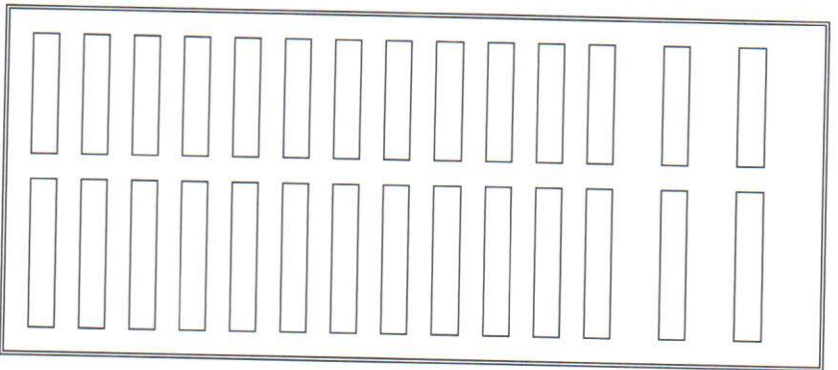

WATER

12" Waterline
 12" Waterline
 12" Waterline
 12" Waterline
 12" Waterline (7)
 12" Waterline
 8" Waterline
 8" Waterline
 8" Waterline
 8" Waterline
 8" Waterline
 8" Waterline
 8" Waterline
 8" Waterline
 8" Waterline
 8" Waterline

Pauza Dr.
 Sacate Blanco
 98" St.
 98" St.
 98" St.
 Colobel Ave
 Tierra Dorado Dr.
 Sacate Blanco
 Bosque de Oro Dr.
 Artemisia Ave
 Andrews Ave
 Farnosa Ave.
 Sacate Blanco
 Sacate Blanco

Existing 12" WL at Artemisia Ave
 Pauza Dr.
 Innskillin Ave
 Colobel Ave
 Sacate Blanco Ave
 98" St.
 Colobel Ave
 Tierra Dorado Dr.
 Artemisia Ave
 Lot 12 Block 7
 Lot 16 Block 7
 Lot 16 Block 8
 Pauza Dr.
 Pauza Dr.

Sacate Blanco
 Existing 12" WL at West end of CUI-de-sac
 Colobel Ave
 Sacate Blanco Ave
 Rio Corto Ave.
 Tierra Dorado Dr.
 Sacate Blanco
 98" St.
 Farnosa Ave.
 Tierra Dorado Dr.
 Pauza Dr.
 Tierra Dorado Dr.
 Tierra Dorado Dr.

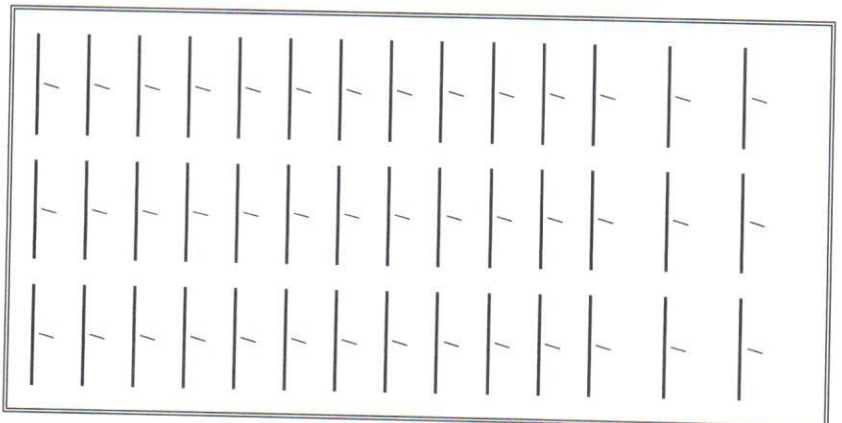

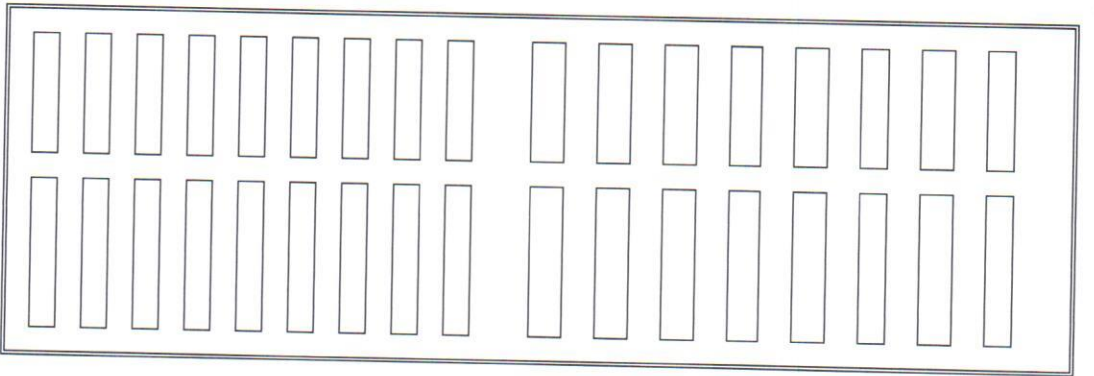

SANITARY SEWER

| | | | | |
|--------------------|--|---|-------------------|----------------------|
| 8" | Sanitary Sewer | Paenza Dr. | Artemisia Ave | Farmosa Ave. |
| 8" | Sanitary Sewer | Bosque de Oro Dr. | Artemisia Ave | Farmosa Ave. |
| 8" | Sanitary Sewer | Tierra Dorado Dr. | Lot 12 Block 2 | Sacate Blanco |
| 8" | Sanitary Sewer | Artemisia Ave | Lot 12 Block 7 | Tierra Dorado Dr. |
| 8" | Sanitary Sewer | Andrews Ave | Lot 16 Block 7 | Paenza Dr. |
| 8" | Sanitary Sewer | Farmosa Ave. | Lot 16 Block 8 | Tierra Dorado Dr. |
| 8" | Sanitary Sewer | Sacate Blanco | Lot 47 Block 1 | 98 th St. |
| 8" | Sanitary Sewer | 98 th St. | Sacate Blanco | Rio Corto Ave. |
| Storm Drain | | | | |
| 18" | Storm Drain | Colobel Ave & Tract C | Colobel Ave | Pond on Tract C |
| 18" - 42" | Storm Drain | Farmosa Ave. | Lot 45 Block 1 | Tierra Dorado Dr. |
| 18" - 54" | Storm Drain | Tierra Dorado Dr. | Lot 16 Block 5 | Sacate Blanco |
| 18" - 36" | Storm Drain | Sacate Blanco | Lot 25 Block 3 | Tierra Dorado Dr. |
| 54" | Storm Drain | Esmit on Tract C | Tierra Dorado Dr. | 98 th St. |
| 2 ac-ft | Retention Pond with Agreement and Covenant | New Public Drainage Easement on Tract C | | |
| 0.7 ac-ft | First Flush Pond with Agreement and Covenant | New Public Drainage Easement on Tract A-1-C Lands of Salazar east of 98th St. | | |
| \$50,000 | Letter of Map Revision (LOMR) | Unit 1 | | |
| Per Design | Revegetate disturbed areas per Sec 1012 | Tracts B, C, D, & F | | |

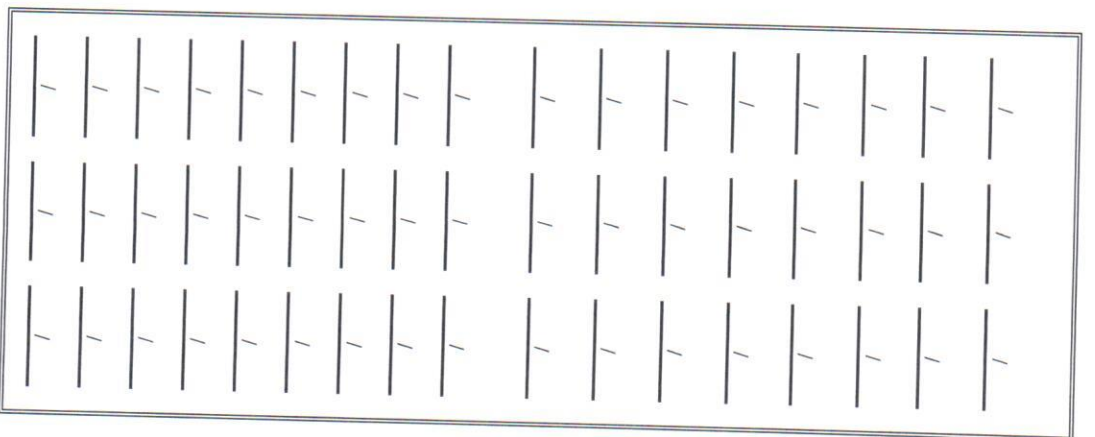

Unit 2 Infrastructure

| SIA Sequence # | COA DRC Project # | Size | Type of Improvement PAVING | Location | From | To | Private Inspector | City Inspector | City Cnst Engineer |
|----------------|-------------------|------------|---|---------------------------|--------------------------------|--------------------------------|-------------------|----------------|--------------------|
| | | 14' | Collector Paving to complete 40' FF C&G (south side only) | Colobel Ave | Morrissey St. | Paufa Dr. | / | / | / |
| | | 6' | Sidewalk (South side only) | | | | / | / | / |
| | | 28' FF | Local Residential Paving | Artemisia Ave | West edge of Lot 12 Block 7 | Rio Maule Dr. | / | / | / |
| | | 4' | C&G (both sides) | | | | / | / | / |
| | | 4' | Sidewalk (north side) ⁽¹⁾ | | | | / | / | / |
| | | 4' | Sidewalk (south side) | | | | / | / | / |
| | | 26' FF | Local Residential Paving | Rio Maule Dr. | Artemisia Ave | North end of Stub | / | / | / |
| | | 4' | C&G (both sides) | | | | / | / | / |
| | | 4' | Sidewalk (west side only) ⁽¹⁾ | | | | / | / | / |
| | | 26' FF | Local Residential Paving | Andrews Ave | West edge of Lot 15 Block 7 | Rio Maule Dr. | / | / | / |
| | | 4' | C&G (both sides) | | | | / | / | / |
| | | 4' | Sidewalk (north side) ⁽¹⁾ | | | | / | / | / |
| | | 4' | Sidewalk (south side) | | | | / | / | / |
| | | 26' FF | Local Residential Paving | Farinosa Ave. | Rio Maule Dr. | West edge of Lot 9 Block 8 | / | / | / |
| | | 4' | C&G (both sides) | | | | / | / | / |
| | | 4' | Sidewalk (north side) | | | | / | / | / |
| | | 4' | Sidewalk (south side) ⁽¹⁾ | | | | / | / | / |
| | | 26' FF | Local Residential Paving | Farinosa Ave. | West edge of Lot 9 Block 8 | West edge of Lot 16 Block 8 | / | / | / |
| | | 4' | C&G (both sides) | | | | / | / | / |
| | | 4' | Sidewalk (both sides) ⁽¹⁾ | | | | / | / | / |
| | | 26' FF | Local Residential Paving | Farinosa Ave. | Rio Maule Dr. | West end of Stub | / | / | / |
| | | 4' | C&G (both sides) | | | | / | / | / |
| | | 4' | Sidewalk (south side) ⁽¹⁾ | | | | / | / | / |
| | | 26' FF | Local Residential Paving | Sacate Blanco | West edge of Lot 47 Block 1 | West end of Sacate Blanco | / | / | / |
| | | 4' | C&G (both sides) | | | | / | / | / |
| | | 4' | Sidewalk (both sides) ⁽¹⁾ | | | | / | / | / |
| | | 48' Radius | Local Residential Paving (Cul-de-sac) C&G (around Perimeter) | West end of Sacate Blanco | | | / | / | / |
| | | 4' | Sidewalk (north side only) ⁽¹⁾ | | | | / | / | / |
| | | 26' FF | Local Residential Paving | Rio Maule Dr. | Artemisia Ave | Andrews Ave | / | / | / |
| | | 4' | C&G (both sides) | | | | / | / | / |
| | | 4' | Sidewalk (west side) ⁽¹⁾ | | | | / | / | / |
| | | 4' | Sidewalk (east side) | | | | / | / | / |

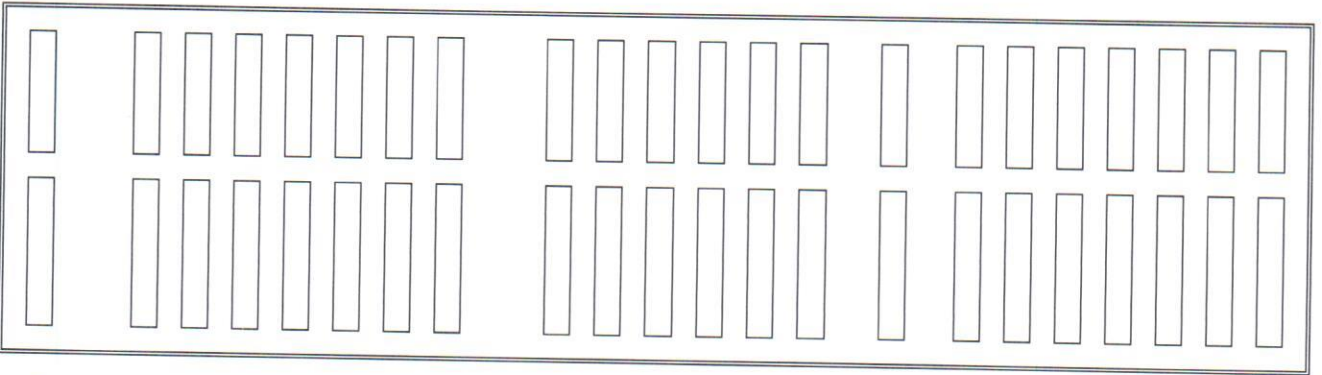

| | | | | |
|-----------------------|--|------------------------------------|--------------------|------------------------|
| 26' FF | Local Residential Paving C&G (both sides) | Rio Maule Dr. | Andrews Ave | Farrosa Ave. |
| 4' | Sidewalk (both sides) (1) | | | |
| 26' FF | Local Residential Paving C&G (both sides) | Kraft Ct. | Andrews Ave | South end of Kraft Ct |
| 4' | Sidewalk (both sides) (1) | | | |
| 26' FF | Local Residential Paving (Hammer Head) C&G (both sides) | South end of Kraft Ct | | |
| 4' | Sidewalk (south side only) (1) | | | |
| 6' | Sidewalk | 12' Pedestrian Easement Tract A | Rio Maule Dr. Stub | Colobel Ave. |
| 6' | Sidewalk | 12' Pedestrian Easement Tract G | Farrosa Ave Stub | Morrissey St. |
| WATER | | | | |
| 8" | Waterline | Artemisia Ave | Unit 1 Boundary | Rio Maule Dr. |
| 8" | Waterline | Andrews Ave | Unit 1 Boundary | Rio Maule Dr. |
| 8" | Waterline | Farrosa Ave. | Unit 1 Boundary | Morrissey St. |
| 8" | Waterline | Rio Maule Dr. | Lot 13 Block 1 | Farrosa Ave. |
| 4" | Waterline | Kraft Ct. | Andrews Ave | Kraft Ct (Hammer head) |
| 4" | Waterline | Kraft Ct (Hammer head) | West end | East end |
| SANITARY SEWER | | | | |
| 8" | Sanitary Sewer | Artemisia Ave | Unit 1 Boundary | Rio Maule Dr. |
| 8" | Sanitary Sewer | Andrews Ave | Unit 1 Boundary | Rio Maule Dr. |
| 8" | Sanitary Sewer | Farrosa Ave. | Unit 1 Boundary | Lot 31 Block 1 |
| 8" | Sanitary Sewer | Sacate Blanco | Unit 1 Boundary | Lot 60 Block 1 |
| 8" | Sanitary Sewer | Rio Maule Dr. | Lot 13 Block 1 | Farrosa Ave. |
| 8" | Sanitary Sewer | Kraft Ct. | Andrews Ave | Kraft Ct (Hammer head) |
| 8" | Sanitary Sewer | Kraft Ct (Hammer head) | West end | East end |
| Storm Drain | | | | |
| Per Design | Revegetate disturbed areas per Sec 1012 | Tracts A, E, & G. | | |

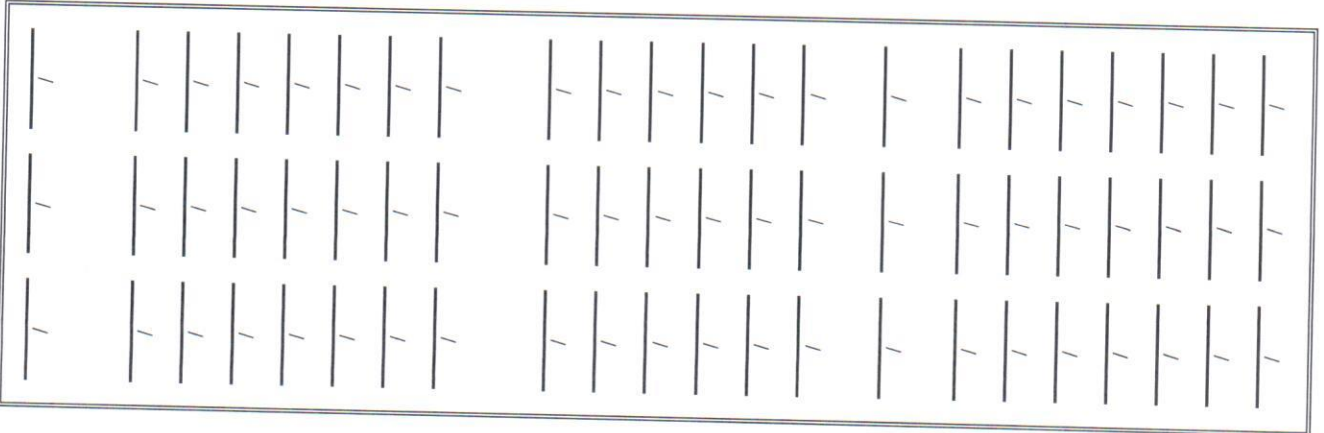

The items listed below are on the CCIP and approved for Impact Fee credits. Signatures from the Impact Fee Administrator and the City User Department is required prior to DRB approval of this listing. The items listed below are subject to the standard SIA requirements.

| Financially Guaranteed DRC # | Constructed Under DRC # | Size | Type of Improvement | Location | From | To | Construction Certification | | |
|------------------------------------|-------------------------|------|---------------------|----------|------|----|-------------------------------|---------------------------|--|
| | | | | | | | Private Inspector P.E. | City Crst Engineer | |
| | | | | | | | / | / | |
| | | | | | | | / | / | |
| | | | | | | | / | / | |
| | | | | | | | / | / | |
| | | | | | | | / | / | |
| | | | | | | | / | / | |
| Approval of Creditable Items: | | | | | | | Approval of Creditable Items: | | |
| Impact Fee Administrator Signature | | | | | | | Date | City User Dept. Signature | |
| | | | | | | | | | |

- Sidewalks to be Deferred per the approved sidewalk deferral exhibit.
- Street Lights Per DPM
- Water Infrastructure includes Valves, Fittings, Valve Boxes, Fire Hydrants, and Appurtenances.
- Sanitary Sewer includes manholes and service connection to property line
- Storm Drain includes manholes & inlets and Storm Drain sizes shall be per DRC final design and analysis.
- Engineer's Certification of Private Grading & Drainage per DPM for release of SIA & Financial Guaranty's. Earthwork and private retaining walls will not be financially guaranteed.
- Construction of the 12" waterline in 98th St. between Colobel Ave and Sacate Blanco is to be deferred to a later date and may be replaced by a looped waterline east of 98th St. at the time of the future development of the property east of 98th St. The line in 98th St. is to be financially guaranteed and not constructed with Unit 1.

AGENT / OWNER **DEVELOPMENT REVIEW BOARD MEMBER APPROVALS**

James D. Hughes 8-24-16
 NAME (print) Carol S. Dumont
 Mark Goodwin & Assoc. PARKS & RECREATION DEPARTMENT - date
 FIRM AMAFCA - date
 Signature: *James D. Hughes* 8-23-2016 Signature: *Carol S. Dumont* 8-24-16
 SIGNATURE - date TRANSPORTATION DEVELOPMENT - date
 MAXIMUM TIME ALLOWED TO CONSTRUCT Signature: *Frank* 8/24/16
 THE IMPROVEMENTS WITHOUT A DRB UTILITY DEVELOPMENT - date
 EXTENSION: N/A Signature: *Frank* 8-24-16
 CITY ENGINEER - date

DESIGN REVIEW COMMITTEE REVISIONS

| REVISION | DATE | DRC CHAIR | USER DEPARTMENT | AGENT / OWNER |
|----------|------|-----------|-----------------|---------------|
| | | | | |
| | | | | |
| | | | | |