

LEGEND

=====	CURB & GUTTER
-----	BOUNDARY LINE
-----	EASEMENT
=====	BUILDING
=====	RETAINING WALL
-----	EXISTING WL EASEMENT
-----	EXISTING CURB & GUTTER

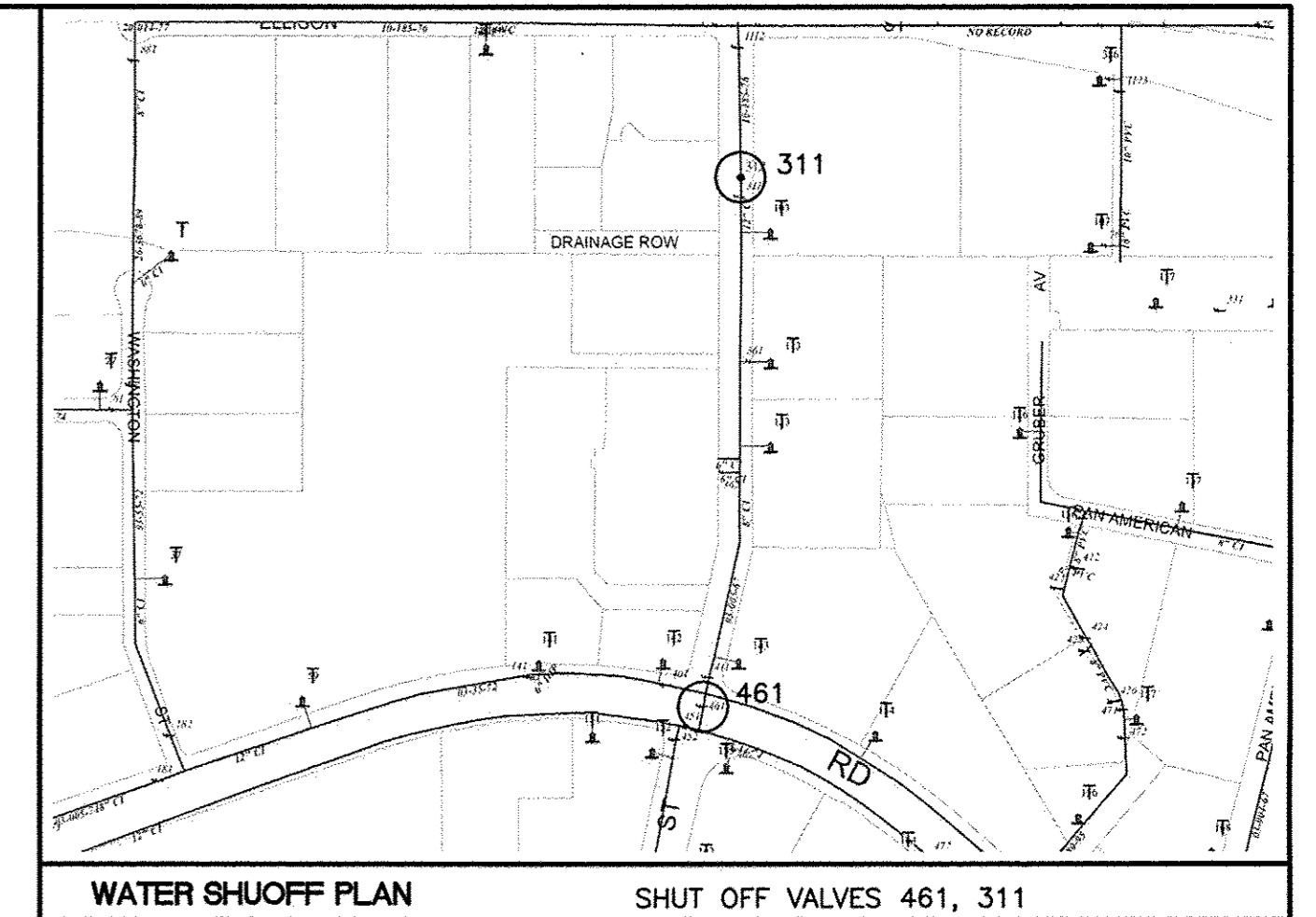

WATER SHUTOFF NOTES

THE CONTRACTOR SHALL COORDINATE WITH THE WATER AUTHORITY SEVEN (7) DAYS IN ADVANCE OF PERFORMING WORK THAT WILL AFFECT THE PUBLIC WATER OR SANITARY SEWER INFRASTRUCTURE. WORK REQUIRING SHUTOFF OF WELL COLLECTORS, TRANSMISSION LINES OR FACILITIES DESIGNATED AS MASTER PLAN FACILITIES MUST BE COORDINATED WITH THE WATER AUTHORITY 14 DAYS IN ADVANCE OF PERFORMING SUCH WORK. ONLY WATER AUTHORITY CREWS ARE AUTHORIZED TO OPERATE PUBLIC VALVES. SHUTOFF REQUESTS MUST BE MADE ONLINE AT [HTTP://WWW.ABCWUA.ORG/WATER_SHUT_OFF_AND_TURN_ON_PROCEDURES.ASPX](http://www.abcwua.org/water_shut_off_and_turn_on_procedures.aspx).

KEYED NOTES

- 1 EXISTING FIRE HYDRANT
- 2 EXISTING 6" SAS SERVICE
- 3 EXISTING 1-1/2" WATER SERVICE (DOMESTIC)
- 4 EXISTING 6" FIRELINE
- 5 NEW 6" FIRELINE
- 6 NEW 1-1/2" WATER SERVICE (DOMESTIC)
- 7 NEW 6" SAS SERVICE
- 8 EXISTING 1" WATER SERVICE (IRRIGATION)
- 9 GREASE INTERCEPTOR
INV (N)=5137.50
INV (OUT)=5136.30
- 10 NEW 4" SAS SERVICE
- 11 REMOVE EXISTING CAP CONNECT TO 6" FIRELINE
- 12 INSTALL NEW PRIVATE FIRE HYDRANT AND GATE VALVE
- 13 EXISTING 6" GATE VALVE

GENERAL UTILITY NOTES:

1. ALL WATER AND SEWER UTILITY WORK TO BE DONE IN ACCORDANCE WITH CITY OF ALBUQUERQUE SPECIFICATIONS FOR PUBLIC UTILITY CONSTRUCTION, 1986 EDITION (UPDATE NO 8) INCLUDING AMENDMENT NO 1.
2. 4' MINIMUM BURY REQUIRED FOR ALL UTILITIES UNLESS OTHERWISE NOTED.
3. REFERENCE ARCHITECTURAL PLANS FOR WATER LINE RISER LOCATIONS.
4. CLEAN OUTS ARE TO BE BUILT PER UNIFORM PLUMBING CODE STANDARDS.
5. ALL PLUMBING PIPE MATERIAL TO BE USED PER UPC.
6. IRRIGATION AND DOMESTIC WATERLINE MUST HAVE BACKFLOW PREVENTORS PER UPC. IF BACKFLOW PREVENTOR IS INSTALLED EXTERIOR OF BUILDING A HOT BOX SHALL BE INSTALLED AND USED.
7. ALL EXCAVATION, TRENCHING AND SHORING ACTIVITIES MUST BE CARRIED-OUT IN ACCORDANCE WITH OSHA 29 CFR 1926.650 SUBPART P.
8. ALL UTILITY DISTANCES SHOWN ARE FOR REFERENCE ONLY.
9. PNM HAS NUMEROUS ELECTRIC FACILITIES AT THIS SITE CURRENTLY SERVING EXISTING CUSTOMERS. THE APPLICANT SHALL COORDINATE WITH PNM REGARDING THESE EXISTING FACILITIES. ANY RELOCATION, CHANGES OR REALIGNMENT OF EXISTING ELECTRIC UTILITIES WILL BE THE DEVELOPER EXPENSE. IN SOME CASES, RELOCATION OR CHANGES TO EXISTING FACILITIES MAY NOT BE FEASIBLE DUE TO PHYSICAL, USE OR SAFETY CLEARANCE CONSTRAINTS.
10. PNM WILL REVIEW ALL TECHNICAL NEEDS, ISSUES AND SAFETY CLEARANCES FOR ITS ELECTRIC POWER SYSTEMS. ANY EXISTING AND PROPOSED PUBLIC UTILITY EASEMENTS SHALL BE INDICATED ON THE SITE PLAN UTILITY SHEET PRIOR TO DRB REVIEW. PNM'S STANDARD FOR PUBLIC UTILITY EASEMENTS IS 10 FEET IN WIDTH TO ENSURE ADEQUATE, SAFE CLEARANCES.
11. SCREENING SHALL BE DESIGNED TO ALLOW FOR ACCESS TO UTILITY FACILITIES. IT IS NECESSARY TO PROVIDE ADEQUATE CLEARANCE OF TEN FEET SURROUNDING ALL GROUND-MOUNTED UTILITIES FOR SAFE OPERATION, MAINTENANCE AND REPAIR PURPOSES.
12. ALL ONSITE FIRE HYDRANTS ARE PRIVATE AND PAINTED "SAFETY ORANGE"

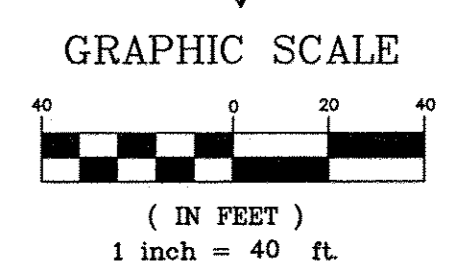
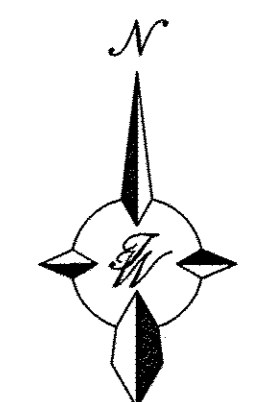

CAUTION

ALL EXISTING UTILITIES SHOWN WERE OBTAINED FROM RESEARCH, AS-BUILTS, SURVEYS OR INFORMATION PROVIDED BY OTHERS. IT SHALL BE THE SOLE RESPONSIBILITY OF THE CONTRACTOR TO CONDUCT ALL NECESSARY FIELD INVESTIGATIONS PRIOR TO AND INCLUDING ANY EXCAVATION, TO DETERMINE THE ACTUAL LOCATION OF UTILITIES AND OTHER IMPROVEMENTS, PRIOR TO STARTING THE WORK. ANY CHANGES FROM THIS PLAN SHALL BE COORDINATED WITH AND APPROVED BY THE ENGINEER.

	INDEPENDENCE SQUARE ALBUQUERQUE, NM	DRAWN BY pm
	LOT 1 AND LOT 2 MASTER UTILITY PLAN	DATE 2-20-18
TERRA WEST, LLC 5571 MIDWAY PARK PL NE ALBUQUERQUE, NEW MEXICO 87109 (505) 858-3100 www.tierawestllc.com	DRAWING 2017093-MUB	SHEET # 2
VINCENT P. CARRICA P.E. #16212	JOB # 2017093	