

HAWKING DR.

SCHOTT SOLAR
SIGN

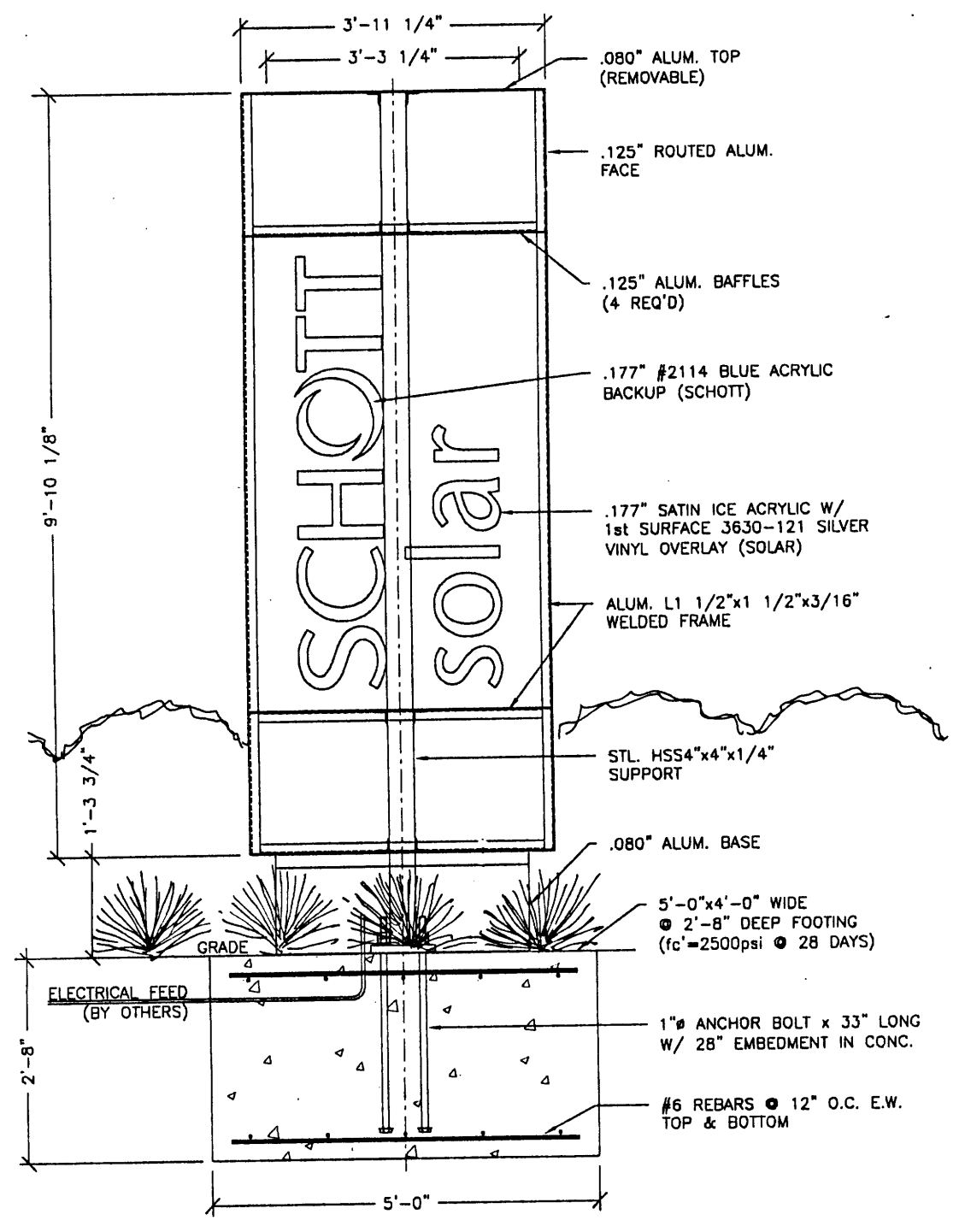
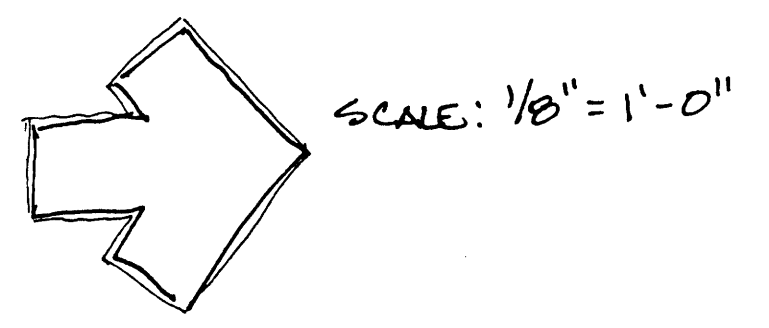

SIGN ELEVATION (N.T.S)

The Halltop

8/28/09 n

SCHOTT solar

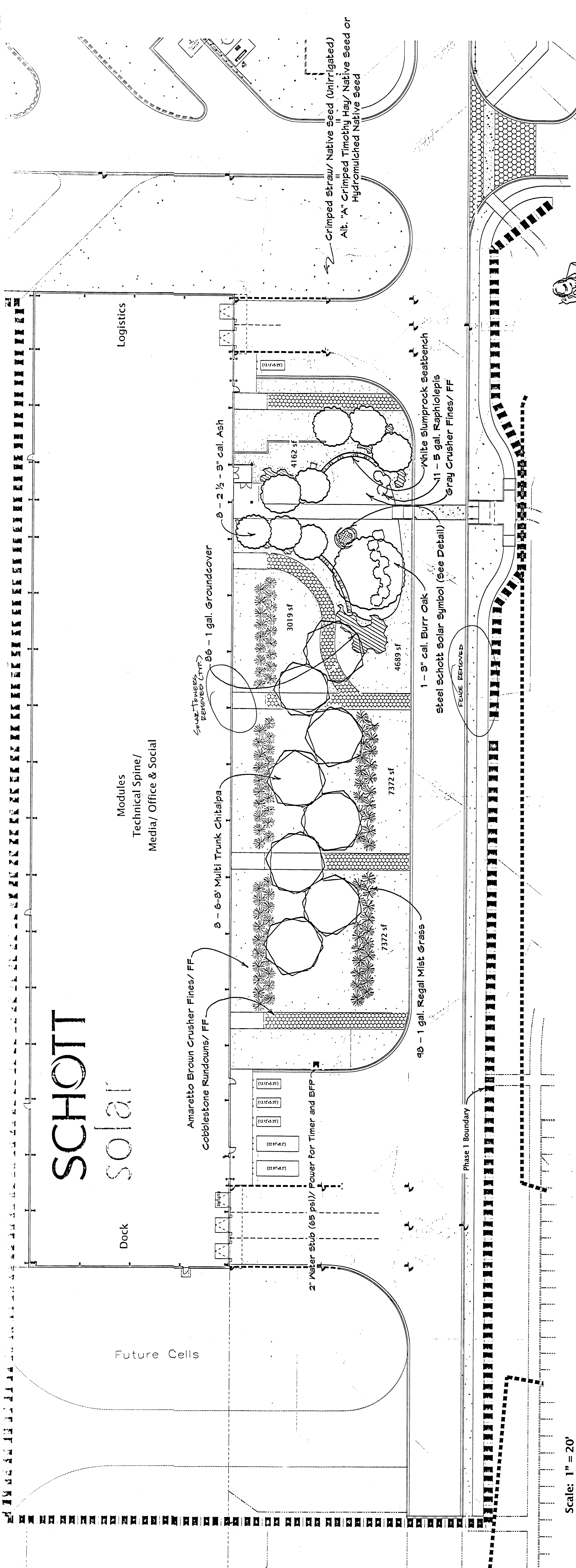

Scale: 1" = 20'

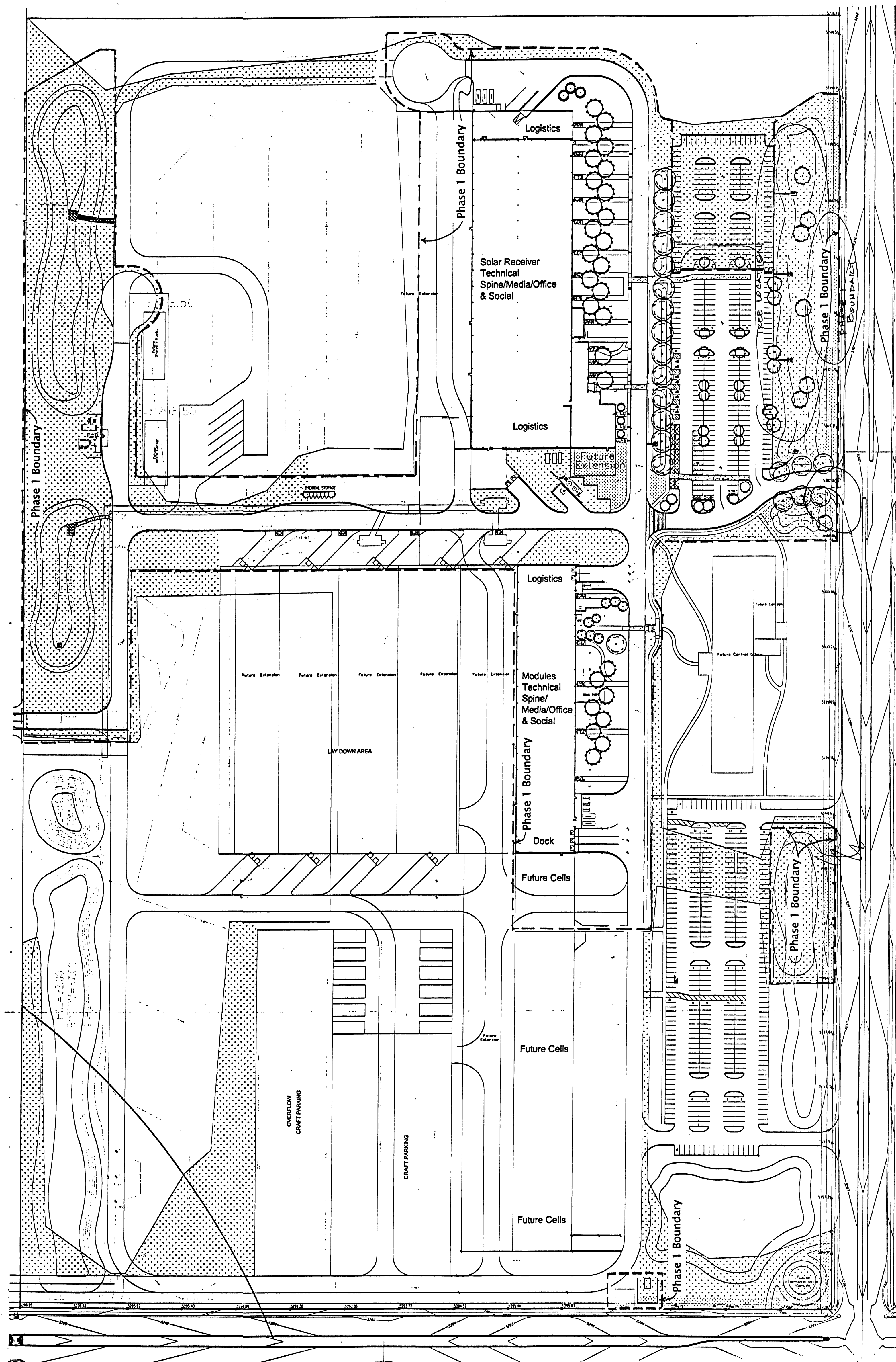

Scale: 1" = 100'

Site Plan

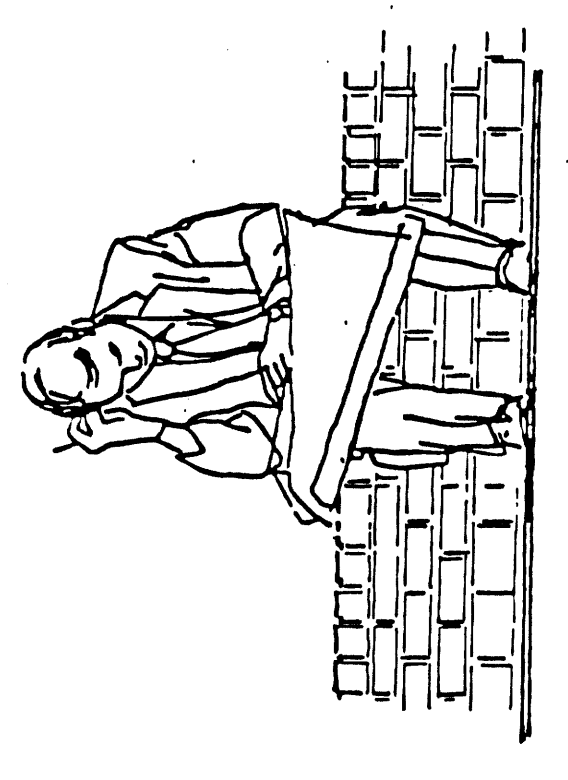

White Slumprock Masonry Seatbench (NTS)

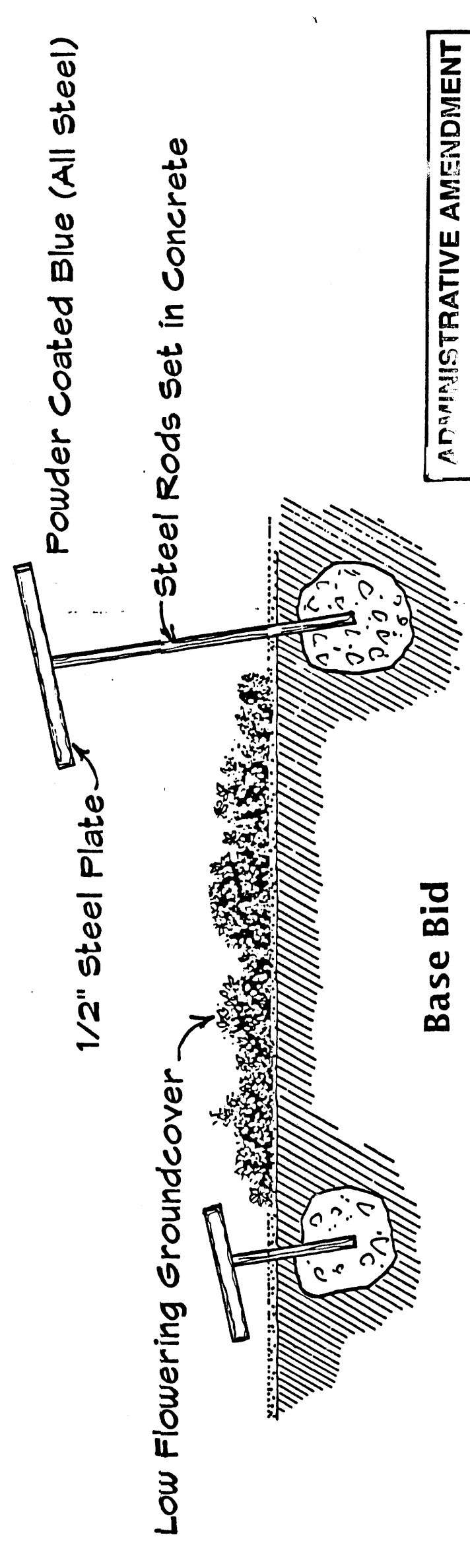
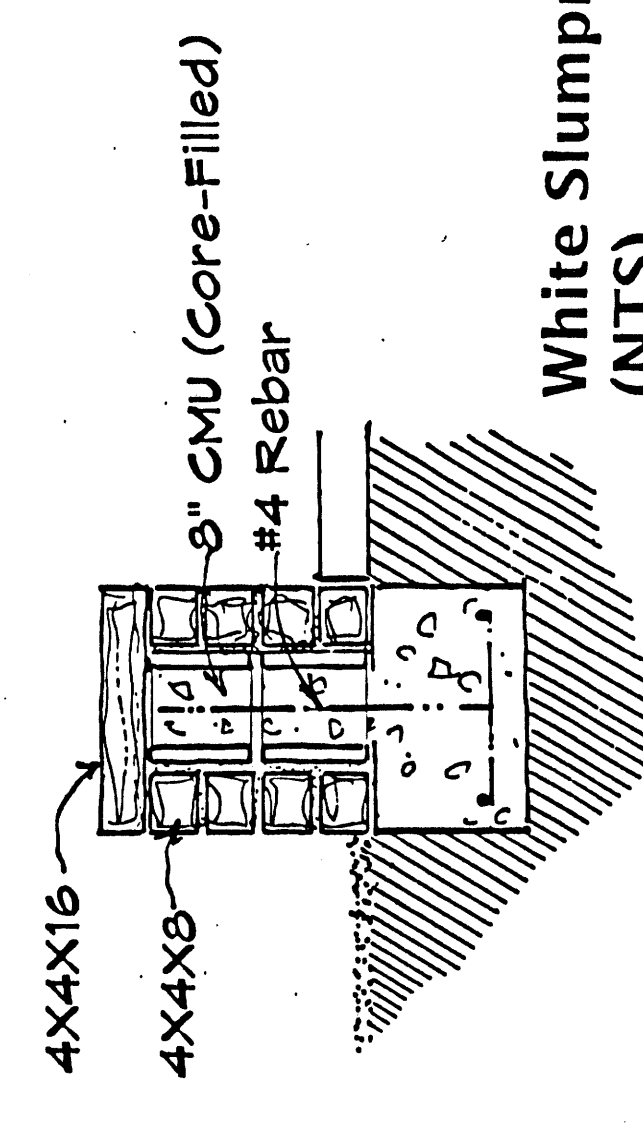

Base Bid

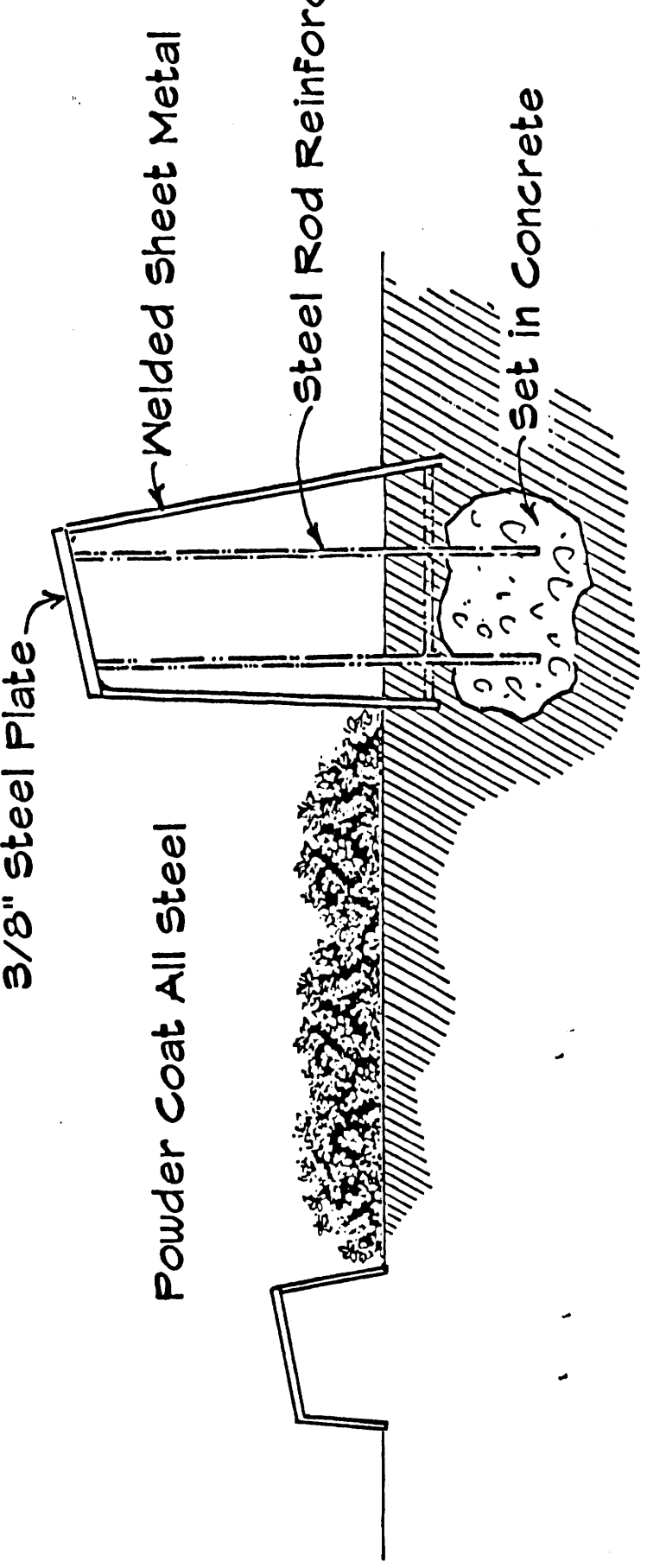

Alternate Upgrade

Section: Schott Solar Symbol (NTS)

ADMINISTRATIVE AMENDMENT
 F. 01/10/04 Project: Schott Solar
 Revised Landscaping and Solar Symbols
 Approved By: [Signature]
 Date: 1/10/04

Approved for compliance with PC Zoning Level "A" and Level "B" Plans and compliance with the Design Standards of the Mesa del Sol Employment Center. Comments, Conditions & Restrictions.
 Architectural Review Committee
 Mesa del Sol Employment Center
 By: [Signature]
 City Administrator

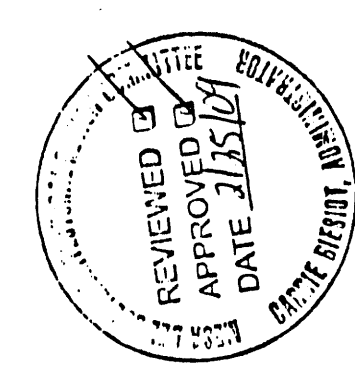

The Hilltop
 LANDSCAPE ARCHITECTS & CONTRACTORS
 7209 E. HIGHWAY 43
 ALBUQUERQUE, NM 87184
 PHONE: (505) 896-7930
 FAX: (505) 896-7930
 email: thehilltop@hilltop.com
 www.hilltoplandscaping.com

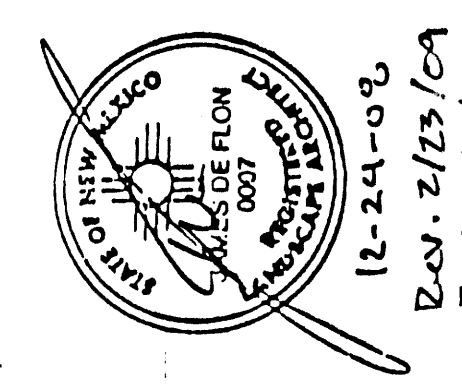

DRAWING 1 OF 2

SCHOTT solar

Logistics

Solar Receiver
Technical Spine/Media/Office & Social

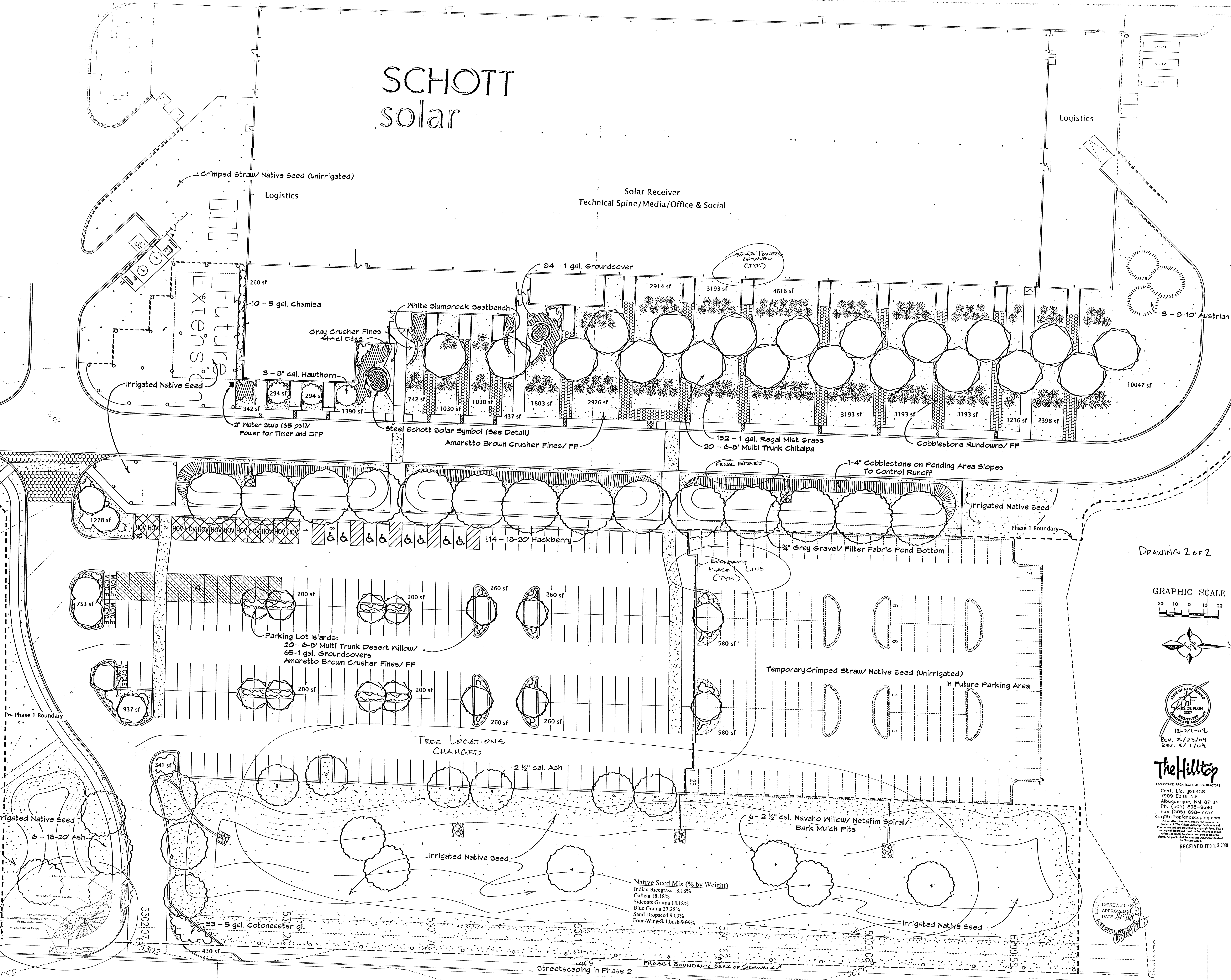

DRAWING 2 OF 2

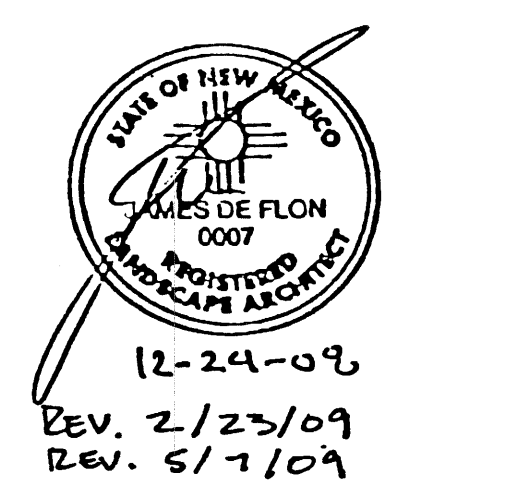
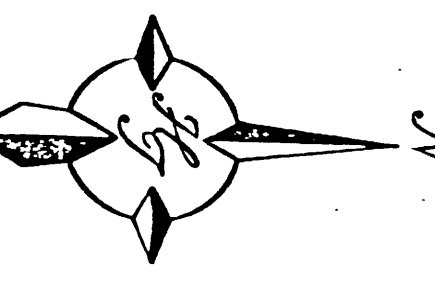
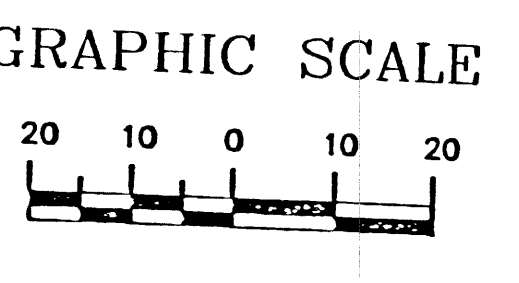

The Hilltop
LANDSCAPE ARCHITECTS & CONTRACTORS
Cont. Lic. #26458
7909 Edith N.E.
Albuquerque, NM 87184
Ph. (505) 898-9690
Fax (505) 898-7737
cm@hilltoplandscaping.com
RECEIVED FEB 23 2009

Native Seed Mix (% by Weight)
Indian Ricegrass 18.18%
Galletta 18.18%
Sideoats Grama 18.18%
Blue Grama 27.27%
Sand Dropseed 9.09%
Four-Wing-Saltbush 9.09%

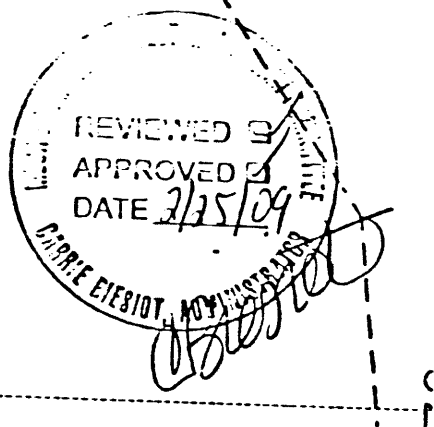

Streetscaping in Phase 2

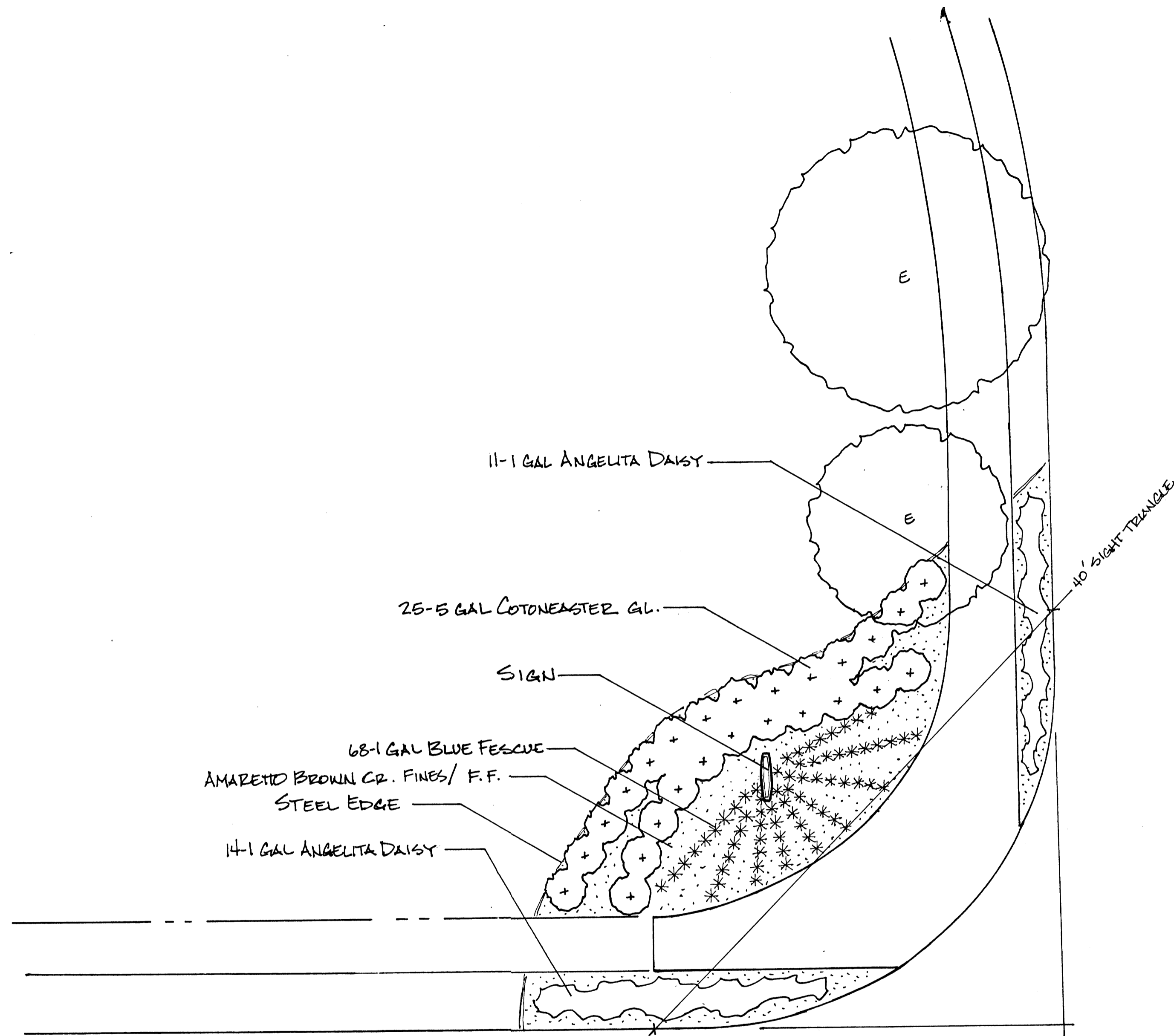

HAWKING DR.

SCHOTT SOLAR
SIGN

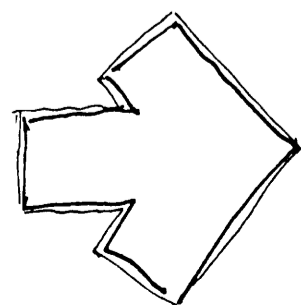

SCALE: 1/8" = 1'-0"

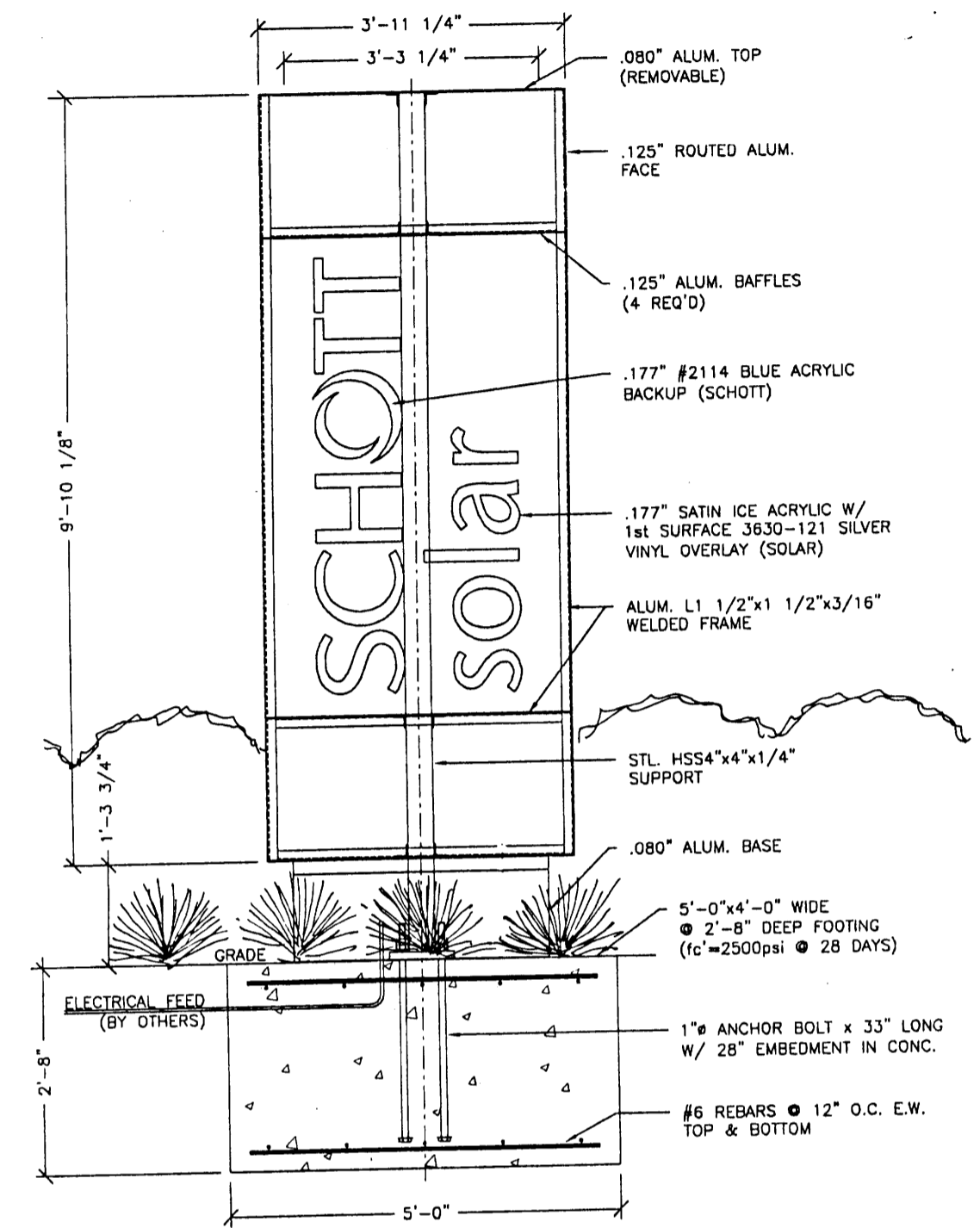

SIGN ELEVATION (N.T.S)

TheHaltop

8/28/09 n

SCHOTT solar

Future Cells

Dock

Modules
Technical Spine/
Media/ Office & Social

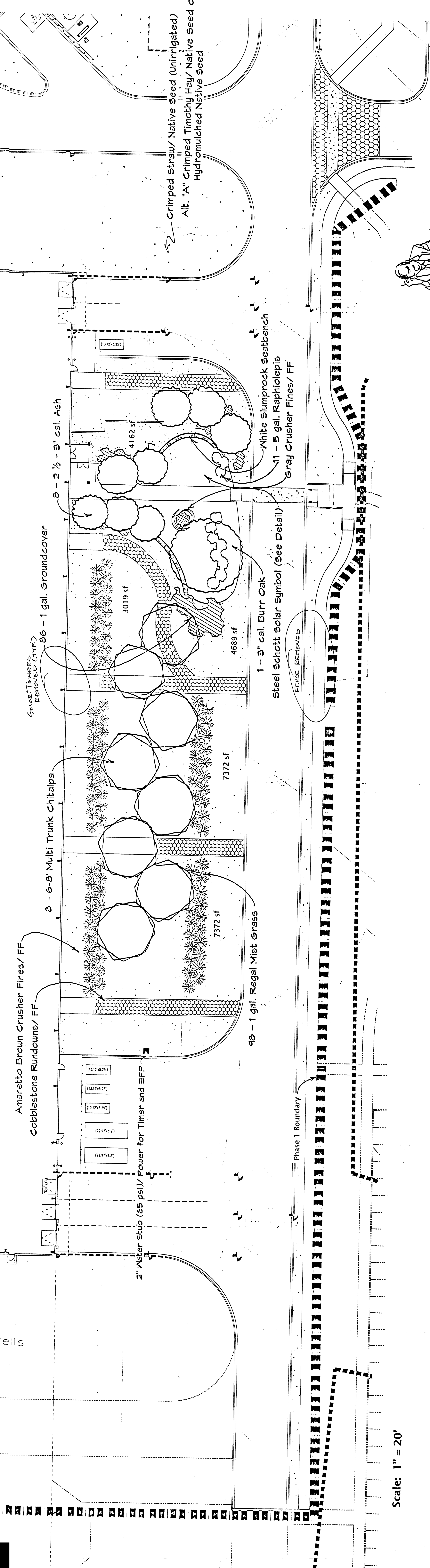

Scale: 1" = 20'

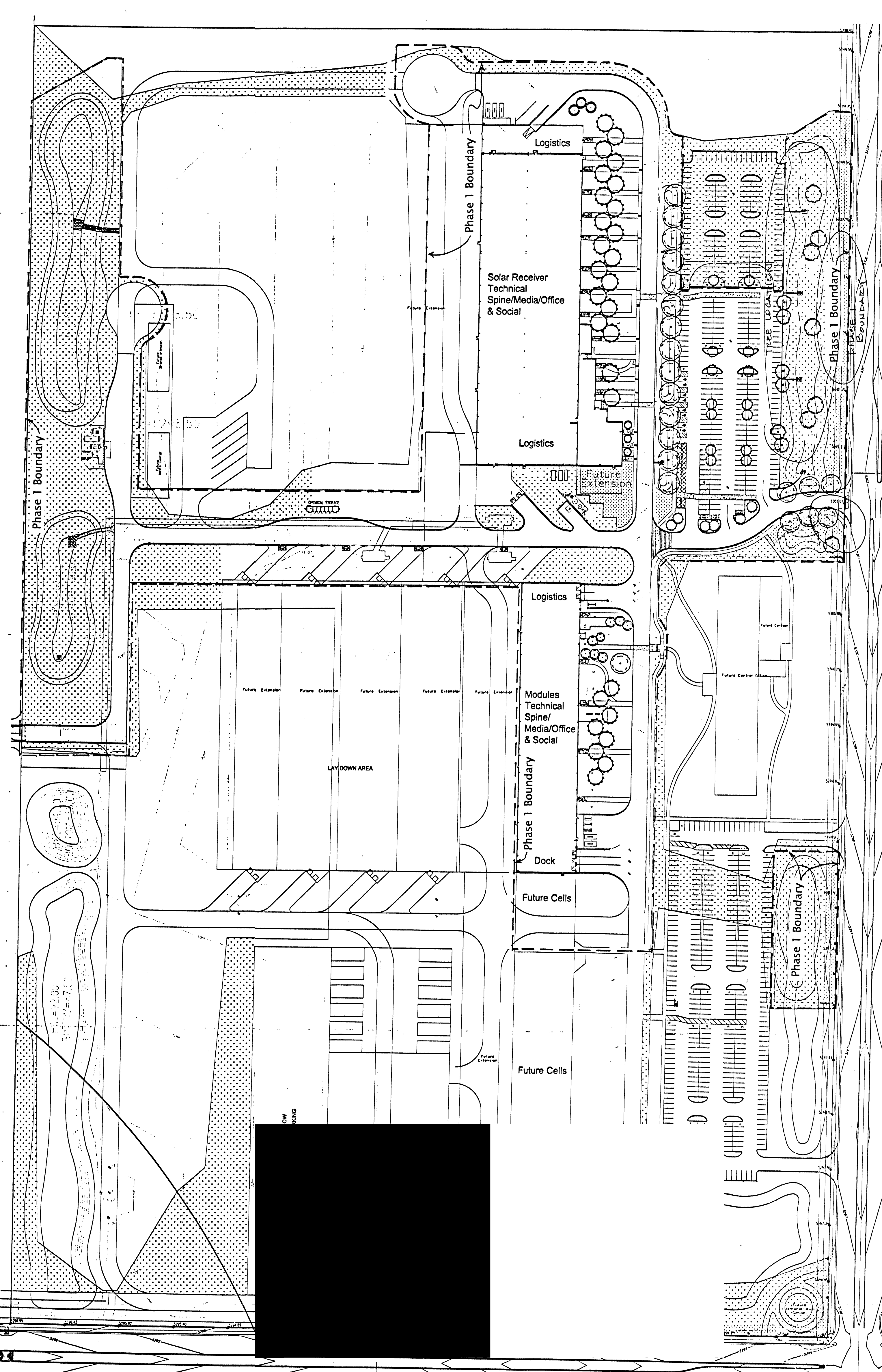

Scale: 1" = 100'

Site Plan

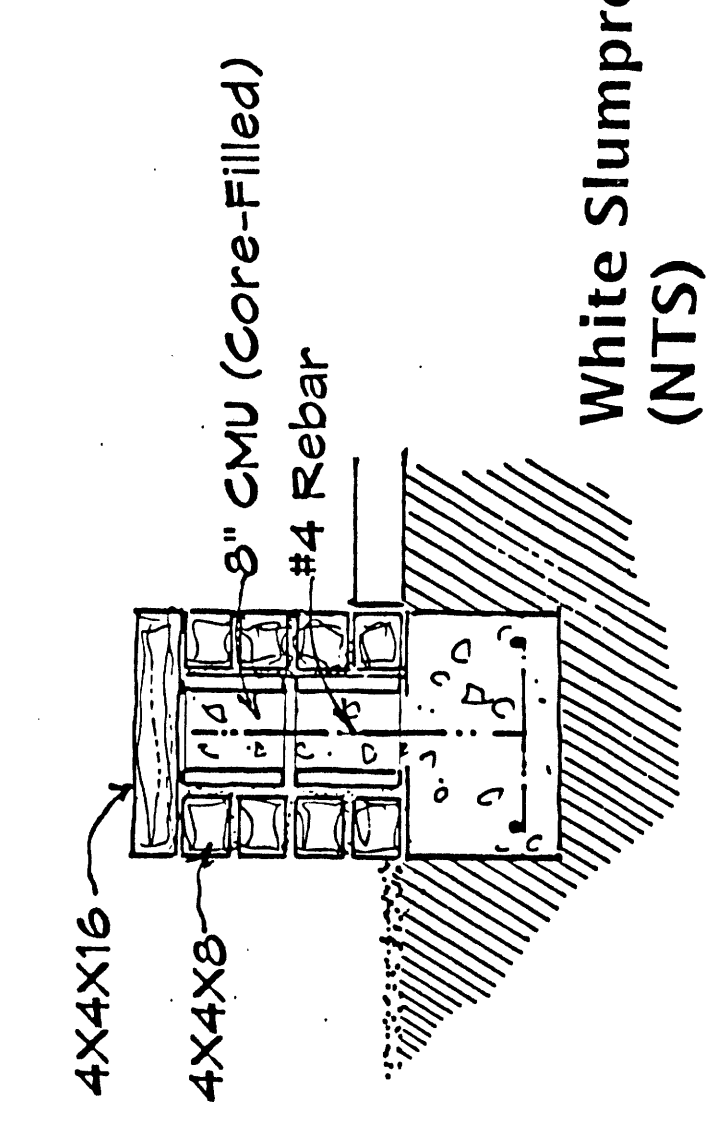
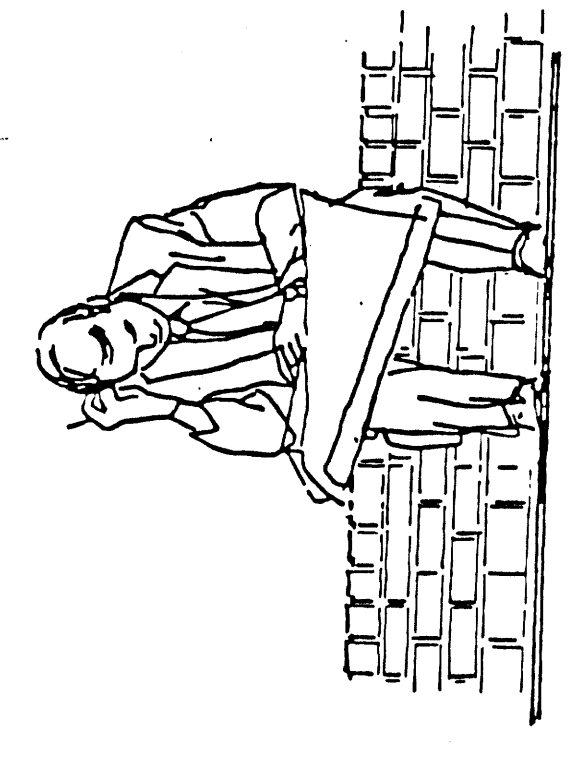

White Slumprock Masonry Seatbench (NTS)

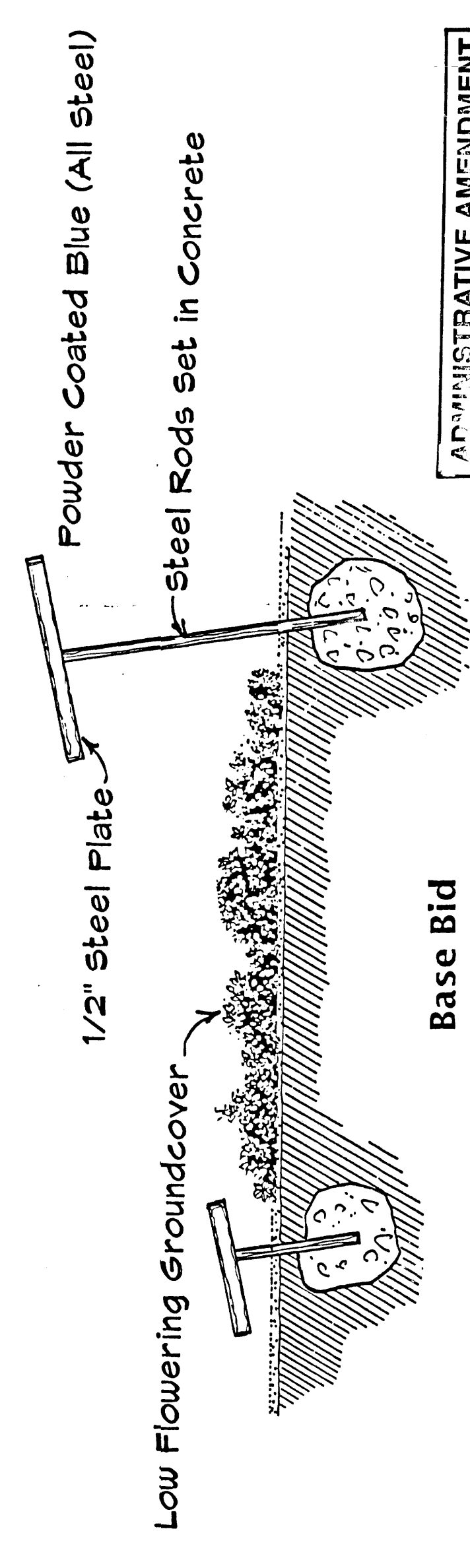

Powder Coated Blue (All Steel)

Base Bid

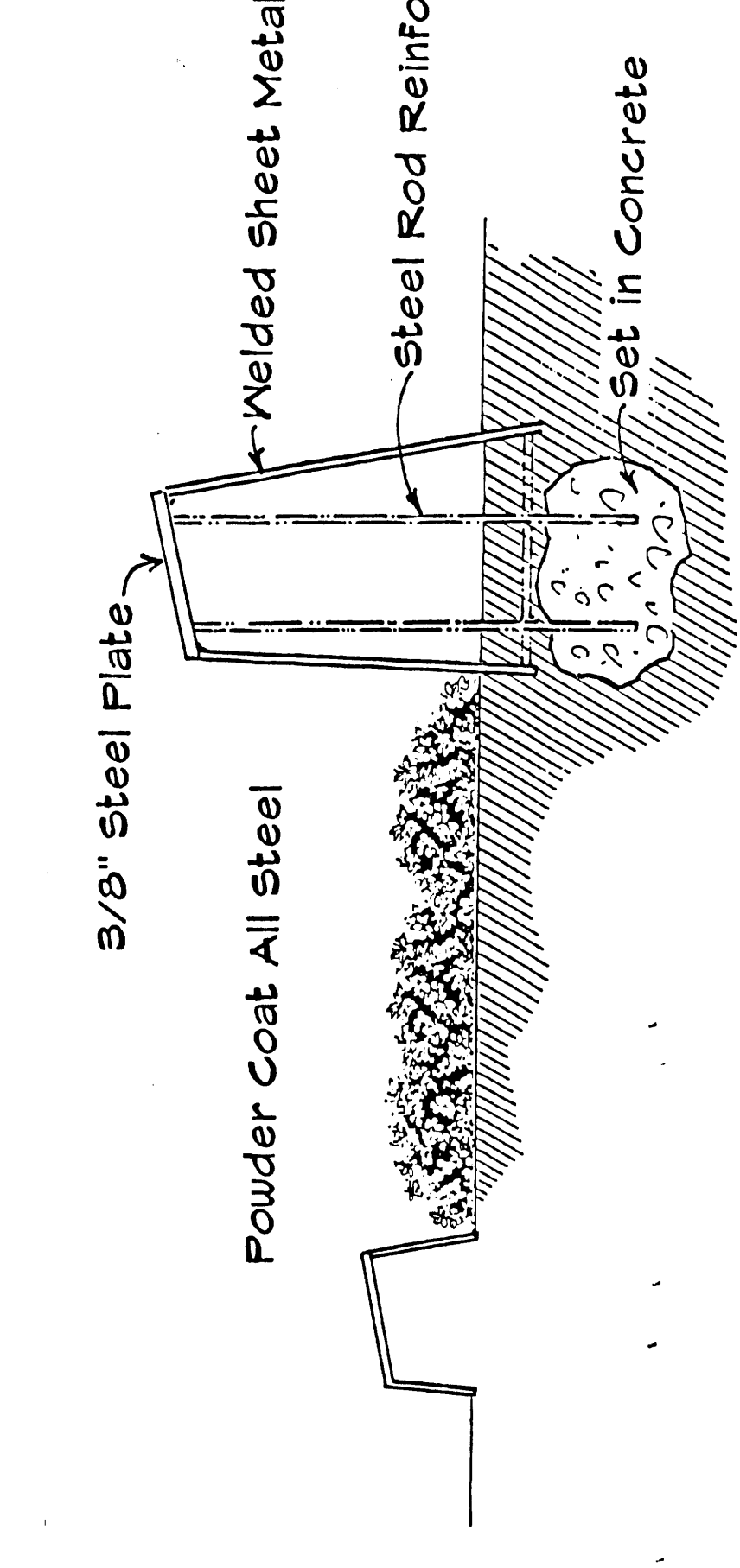

Alternate Upgrade

Section: Schott Solar Symbol (NTS)

ADMINISTRATIVE AMENDMENT
F. CHART/COMPLIMENT 100202
Revised Landscaping and Solar Structure to be installed
APPROVED BY: *[Signature]*

Approved for compliance with PG Zoning Level "A" and the PG Zoning Ordinance with the Design Standards of the Mesa del Sol Environment Center Conventions, Conditions & Restrictions.
Architectural Review Committee
Mesa del Sol Environment Center
By: *[Signature]*
Carrie Bleser, Administrator

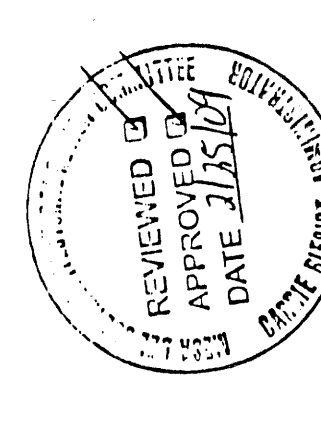

The Hilltop
LANDSCAPE ARCHITECTS & CONSULTANTS
Cont. Lic. #26459
4809 Edith NE, #2184
Phoenix, AZ 85018
Ph: (602) 838-9500
Fax: (602) 838-7737
www.hilltoplandscaping.com
Approved for PG Zoning Level "A" and the PG Zoning Ordinance with the Design Standards of the Mesa del Sol Environment Center Conventions, Conditions & Restrictions.
By: *[Signature]*
Date: 5/17/09

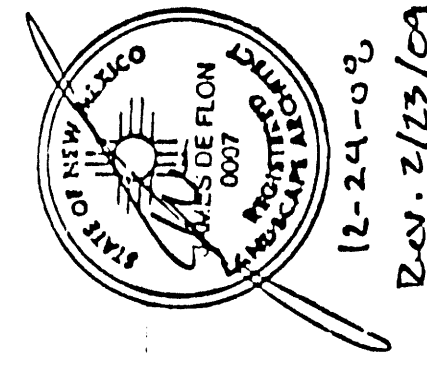

12-24-08
Rev. 5/17/09

DRAWING 1 OF 2

SCHOTT solar

Logis

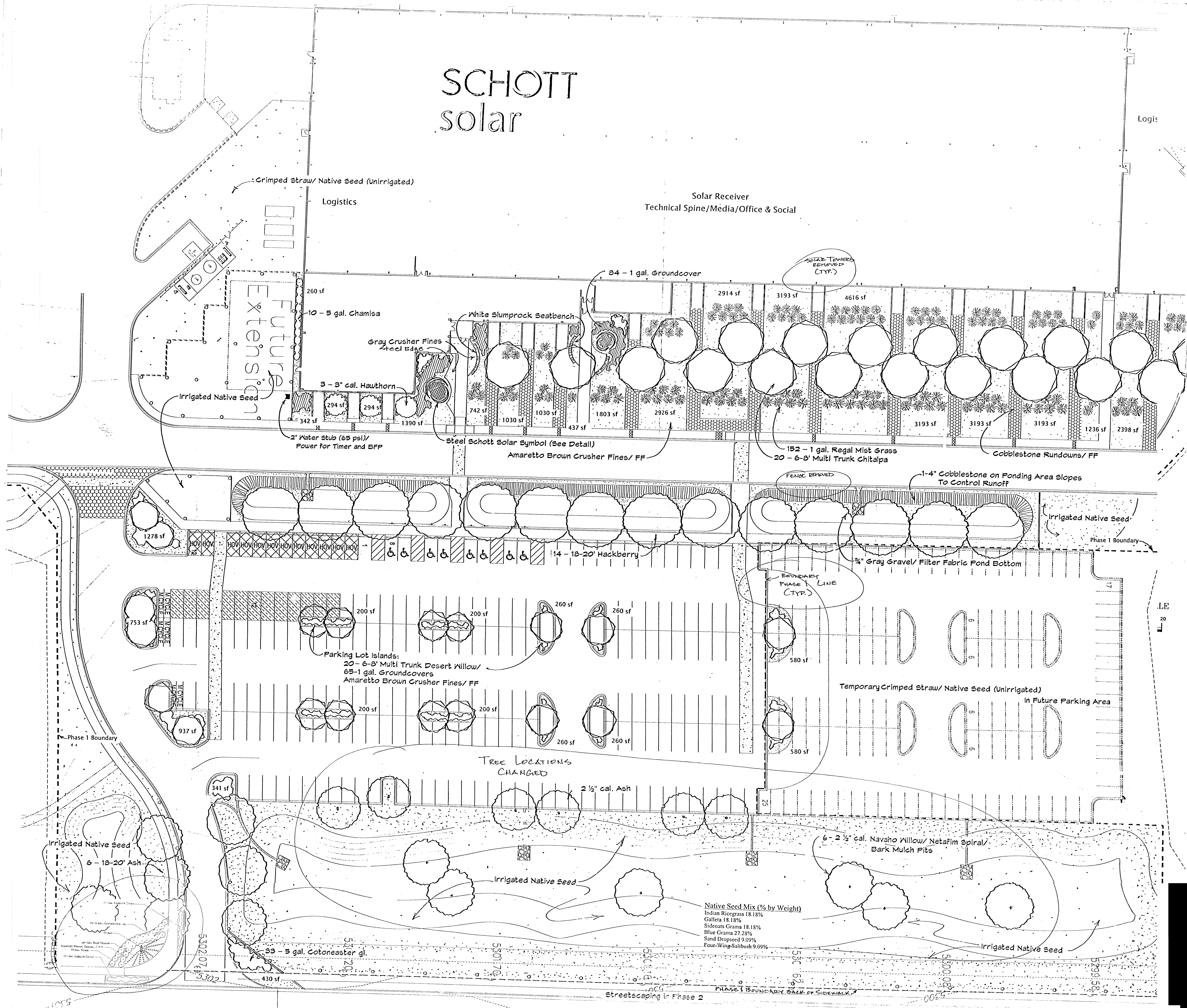

Logistics

Solar Receiver
Technical Spine/Media/Office & Social

Future
Extension

84 - 1 gal. Groundcover

2914 sf

3193 sf

4616 sf

10 - 5 gal. Chamisa

White Slumprock Seatbench

Gray Crusher Fines Steel Base

3 - 3" cal. Hawthorn

294 sf

294 sf

1390 sf

742 sf

1030 sf

1030 sf

437 sf

1803 sf

2926 sf

Steel Schott Solar Symbol (See Detail)

Amaretto Brown Crusher Fines/ FF

152 - 1 gal. Regal Mist Grass

20 - 6-8' Multi Trunk Chitalpa

Cobblestone Rundowns/ FF

1236 sf

2398 sf

3193 sf

3193 sf

3193 sf

2" Water Stub (65 psi)/ Power for Timer and BFP

Solar Towers removed (TYP.)

1278 sf

14 - 18-20' Hackberry

1-4" Cobblestone on Ponding Area Slopes To Control Runoff

Irrigated Native Seed

Phase 1 Boundary

3/4" Gray Gravel/ Filter Fabric Pond Bottom

753 sf

200 sf

200 sf

260 sf

260 sf

937 sf

200 sf

200 sf

260 sf

260 sf

580 sf

580 sf

Parking Lot Islands:
20 - 6-8' Multi Trunk Desert Willow/
65-1 gal. Groundcovers
Amaretto Brown Crusher Fines/ FF

BOUNDARY LINE (TYP.)

TEMPORARY CRIMPED STRAW/ NATIVE SEED (UNIRRIGATED)
In Future Parking Area

341 sf

2 1/2" cal. Ash

6 - 18-20' Ash

Irrigated Native Seed

6 - 2 1/2" cal. Navaho Willow/ Netafim Spiral/
Bark Mulch Pits

Irrigated Native Seed

33 - 5 gal. Cotoneaster gl.

Native Seed Mix (% by Weight)
Indian Ricegrass 18.18%
Galleta 18.18%
Sideoats Grama 18.18%
Blue Grama 27.28%
Sand Dropseed 9.09%
Four-Wing-Saltbush 9.09%

Streetscaping in Phase 2

PHASE 1 BOUNDARY BACK OF SIDEWALK