



#20

COMPLETED 09/12/07 SH
DRB CASE ACTION LOG (PREL & FINAL)

REVISED 9/28/05

This sheet must accompany your plat or site plan to obtain delegated signatures. Return sheet with site plan/plat once comments are addressed.

DRB Application No.: 07DRB-70220 (P&F)

Project # 1006785

Project Name: MESA COURT ADDITION

Agent WAYJOHN SURVEYING INC

Phone No.: 255-2052

Your request for (SDP for SUB), (SDP for BP), (FINAL PLATS), (MASTER DEVELOP. PLAN), was approved on 9/5/07 by the DRB with delegation of signature(s) to the following departments.
OUTSTANDING SIGNATURES COMMENTS TO BE ADDRESSED

TRANSPORTATION: _____

ABCWUA: _____

CITY ENGINEER / AMAFCA: _____

PARKS / CIP: _____

PLANNING (Last to sign): Approved
 Record

- Planning must record this plat. Please submit the following items:**
 - The original plat and a mylar copy for the County Clerk.
 - Tax certificate from the County Treasurer.
 - Recording fee (checks payable to the County Clerk). RECORDED DATE: _____
 - Tax printout from the County Assessor.
- 3 copies of the approved site plan. Include all pages.
- County Treasurer's signature must be obtained prior to the recording of the plat with the County Clerk.
- Property Management's signature must be obtained prior to Planning Department's signature.
- AGIS DXF File approval required. OK
- Copy of recorded plat for Planning.

Project Number 1006785



#20

DRB CASE ACTION LOG (PREL & FINAL)

REVISED 9/28/05

This sheet must accompany your plat or site plan to obtain delegated signatures. Return sheet with site plan/plat once comments are addressed.

DRB Application No.: 07DRB-70220 (P&F)	Project # 1006785
Project Name: MESA COURT ADDITION	
Agent WAYJOHN SURVEYING INC	Phone No.: 255-2052

Your request for (SDP for SUB), (SDP for BP), (FINAL PLATS), (MASTER DEVELOP. PLAN), was approved on 9/5/07 by the DRB with delegation of signature(s) to the following departments.
OUTSTANDING SIGNATURES COMMENTS TO BE ADDRESSED

TRANSPORTATION: _____

ABCWUA: _____

CITY ENGINEER / AMAFCA: _____

PARKS / CIP: _____

PLANNING (Last to sign): Analysis
 Record

- Planning must record this plat. Please submit the following items:**
- The original plat and a mylar copy for the County Clerk.
 - Tax certificate from the County Treasurer.
 - Recording fee (checks payable to the County Clerk). RECORDED DATE: _____
 - Tax printout from the County Assessor.
 - 3 copies of the approved site plan. Include all pages.
 - County Treasurer's signature must be obtained prior to the recording of the plat with the County Clerk.
 - Property Management's signature must be obtained prior to Planning Department's signature.
 - AGIS DXF File approval required. OK
 - Copy of recorded plat for Planning.

Project Number 1006785

Subj: **Project No. 1006785**
Date: 09/05/2007 7:52:45 A.M. Mountain Daylight Time
From: dmzamora@cabq.gov
To: Wayjonsurv@aol.com

The .dxf file for Project No. 1006785 (Mesa Court Addn) has been approved.

David M. Zamora
GIS Coordinator - AGIS
City of Albuquerque
Planning Department
924-3929 phone
924-3812 fax
www.cabq.gov/gis
dmzamora@cabq.gov

6785

DXF Electronic Approval Form

DRB Project Case #: 1006785

Subdivision Name: MESA COURT BLOCK 1 TRACTS B1A & B2A

Surveyor: THOMAS D JOHNSTON

Contact Person: THOMAS D JOHNSTON

Contact Information: 255-2052

DXF Received: 9/4/2007

Hard Copy Received: 9/4/2007

Coordinate System: NMSP Grid (NAD 27)

Approved

09-05-2007
Date

* The DXF file cannot be accepted (at this time) for the following reason(s):

AGIS Use Only

Copied fc **6785**

to agiscov on **9/5/2007**

Contact person notified on **9/5/2007**



**DEVELOPMENT REVIEW BOARD
ACTION SHEET**

Plaza del Sol Hearing Room, Basement, Plaza del Sol Building

September 5, 2007 9:00 A.M.

MEMBERS:

Sheran Matson, AICP, DRB Chair
Sandra Handley, Administrative Assistant

Wilfred Gallegos, Transportation Development
Brad Bingham, Alternate City Engineer

Roger Green, ABCWUA
Christina Sandoval, Parks & Recreation

NOTE: UNLESS ANNOUNCED DURING THE MEETING, THE DEVELOPMENT REVIEW BOARD WILL NOT TAKE A LUNCH BREAK.

NOTE: INDIVIDUALS WITH DISABILITIES WHO NEED SPECIAL ASSISTANCE TO PARTICIPATE AT THIS MEETING SHOULD CONTACT CLAIRE SENOVA, PLANNING DEPARTMENT, AT 924-3946. HEARING IMPAIRED USERS MAY CONTACT HER VIA THE NEW MEXICO RELAY NETWORK BY CALLING TOLL-FREE:1-800-659-8331.

NOTE: REQUESTS FOR DEFERRAL OF CASES WILL BE DISCUSSED BY THE BOARD AND THE APPLICANT AND/OR AGENT AT THE BEGINNING OF THE AGENDA. BOTH PARTIES MUST AGREE UPON THE DATE OF DEFERRAL. IF THE APPLICANT/AGENT IS NOT PRESENT, THE ADMINISTRATIVE ASSISTANT MUST RECEIVE A LETTER, PRIOR TO THE HEARING DATE, REQUESTING A SPECIFIC DEFERRAL DATE. THE BOARD WILL DISCUSS AND MAKE A DECISION AT THE HEARING. THE APPLICANT/AGENT WILL THEN BE INFORMED OF THE DEFERRAL DATE AND REASON.

- A. Call to Order 9:00 A.M. Adjourned: 12:10 P.M.
- B. Changes and/or Additions to the Agenda
- C. New or Old Business

NOTE: IF THE APPLICANT/AGENT IS NOT PRESENT WHEN THEIR REQUEST IS CALLED, THEN THE REQUEST MAY BE INDEFINITELY DEFERRED ON A NO SHOW.

CASES WHICH REQUIRE PUBLIC NOTIFICATION

MAJOR SUBDIVISIONS, VACATIONS, SIA EXTENSIONS AND SITE DEVELOPMENT PLANS

1. **Project# 1006739**
07DRB-70187 VACATION OF PUBLIC
RIGHT-OF-WAY

JACK'S HIGH COUNTRY INC. agent(s) for MANUEL AND MARTHA P. BARRARA request(s) the above action(s) for all or a portion of the AMOLE DEL NORTE DIVERSION FACILITY, located on SAGE RD SW BETWEEN RAELE ST SW AND AMOLE DEL NORTE DIVERSION CHANNEL containing approximately 0.32 acre(s). (L-10) **DEFERRED AT THE AGENT'S REQUEST TO 09/12/07.**

2. **Project# 1001178**
07DRB-70182 MAJOR - SDP FOR
BUILDING PERMIT

RON BURTON, DWL ARCHITECTS agent(s) for CHECK WITH ME LLC request(s) the above action(s) for all or a portion of Tract(s) A-1-B-3, **ACME ACRES**, zoned C-3(SC), located on CUTLER AVE NE BETWEEN CARLISLE BLVD NE AND MORNINGSIDE DR NE containing approximately 0.89 acre(s). (H-17) **THE SITE PLAN FOR BUILDING PERMIT WAS APPROVED WITH FINAL SIGN OFF DELEGATED TO ABCWUA FOR REMOVAL OF TREES FROM THE SANITARY SEWER EASEMENT, FIRE FLOW CALCULATION SHEET, TO LABEL WATER METER SIZE AND TO PLANNING FOR: ZONING COMMENTS ADDRESSED, PATIO AREA NOTE, PLANNING COMMENTS ADDRESSED, CITY STANDARD DRAWING NUMBERS IN PUBLIC RIGHT-OF-WAY, MOTORCYCLE PARKING STALL DESIGNATIONS AND 3 COPIES OF THE SITE DEVELOPMENT PLAN AFTER THE 15 DAY APPEAL PERIOD.**

3. **Project# 1004989**
07DRB-70183 MAJOR - AMENDMENT
TO PRELIMINARY PLAT

BOHANNAN HUSTON INC. agent(s) for MESA VERDE DEVELOPMENT CO request(s) the above action(s) for all or a portion of Tract(s) A, WILDERNESS AT HIGH DESERT, UNIT 2 (to be known as **WILDERNESS CANON AT HIGH DESERT**) zoned SU-2 HD/R-R, located on HIGH DESERT PL NE BETWEEN TRAILHEAD RD NE AND EMBUDITO VIEW CT NE containing approximately 3.9653 acre(s). (F-23) **THE AMENDED PRELIMINARY PLAT, THE AMENDED GRADING AND DRAINAGE PLAN DATED 7/17/07 AND AMENDED INFRASTRUCTURE LIST DATED 09/05/07 WERE APPROVED. THIS AMENDMENT DOES NOT EXTEND THE EXPIRATION DATE OF THE ALREADY APPROVED PRELIMINARY PLAT. THAT DATE IS EXTENDED, HOWEVER, THE LENGTH OF THE APPEAL PERIOD.**

4. **Project# 1002715**
07DRB-70184 VACATION OF PUBLIC
RIGHT-OF-WAY
07DRB-70185 BULK LAND VARIANCE
07DRB-70186 MINOR - PRELIMINARY/
FINAL PLAT APPROVAL

ISAACSON AND ARFMAN PA agent(s) for PARADISE AT UNSER LLC request(s) the above action(s) for all or a portion of Lot(s) 1,2,3 & 4, replat of Tract H, LANDS OF HORIZON CORPORATION (to be known as **PARADISE AT UNSER**), zoned SU-1 FOR C-1 USES/ SU-1 PRD-FAR 0.5, located on UNSER BLVD NW BETWEEN PARADISE BLVD NW AND LYONS BLVD NW containing approximately 29.8336 acre(s). (B-11) **DEFERRED AT THE AGENT'S REQUEST TO 09/12/07.**

5. **Project# 1005464**
07DRB-70082 VACATION OF PUBLIC
RIGHT-OF-WAY
- THOMPSON ENGINEERING CONSULTANTS INC
agent(s) for ESMAIL HAIDARI request(s) the above
action(s) for all or a portion of Lot(s) 32, Tract(s) A, **NORTH
ALBUQUERQUE ACRES**, zoned R-LT, located on
PALOMAR AVE NE between BARSTOW ST NE and
VENTURA ST NE containing approximately 0.73 acre(s).
*[Deferred at the Board's request from 07/18/07 & deferred
from 08/15/07](D-19) OFFICIALLY WITHDRAWN AT THE
AGENT'S REQUEST.*
6. **Project # 1005070**
06DRB-01154 Major-Preliminary Plat
Approval
06DRB-01156 Minor-Sidewalk Waiver
06DRB-01155 Minor-Temp Defer SDWK
- SURV-TEK INC & WILSON & COMPANY agent(s) for THE
TRAILS LLC request(s) the above action(s) for all or a
portion of Tract(s) 8, THE TRAILS, UNIT 2 (to be known as
TAOS @ THE TRAILS, UNIT 2) zoned SU-2-SRLL,
located on WOODMONT AVE NW, between UNIVERSE
BLVD NW and RAINBOW BLVD NW containing
approximately 9 acre(s). *[Deferred from 9/6/06, 9/13/06,
9/27/06, 10/11/06, 10/25/06, 11/29/06, 12/20/06, 1/24/07,
4/18/07, 6/20/07, 7/18/07 & 08/22/07] (C-9) DEFERRED
AT THE AGENT'S REQUEST TO 09/26/07.*
7. **Project # 1005546**
07DRB-00589 Major-Vacation of Pub
Right-of-Way
- SURV TEK INC agent(s) for BLACK FARMS LLC
request(s) the above action(s) for **BLACK FARMS
ESTATE, UNIT 2**, zoned RA-1 located on IRVING BLVD
NW between VALLEY VIEW DR NW and RIVERFRONTE
DR NW. *[Deferred from 06/06/07] (C-13) DEFERRED AT
THE AGENT'S REQUEST TO 11/07/07.*

**SITE DEVELOPMENT PLANS (EPC FINAL SIGN-OFF) AMENDED PLANS AND
MASTER DEVELOPMENT PLANS (CITY COUNCIL FINAL SIGN-OFF)**

8. **Project# 1004677**
07DRB-70221 EPC APPROVED SDP
FOR SUBDIVISION
- INFILL SOLUTIONS request(s) the above action(s) for all
or a portion of Parcel 1, Tract(s) 133A1, 133A2, 133B, 134
& 135A and Parcel 2 Tract(s) 129B1A, MRGCD Map 38,
Tract(s) A & B, LANDS OF HB AND CALVIN HORN &
LAGUNA SUBDIVISION, Tract(s) A1A, LAGUNA
SUBDIVISION (to be known as **COUNTRY CLUB PLAZA**)
zoned SU-2/CLD, located on CENTRAL AVE SW
BETWEEN LAGUNA BLVD SW AND SAN PASQUALE
AVE SW containing approximately 4.45 acre(s). **[Carmen
Morrone, EPC Planner] (J-13) DEFERRED AT THE
AGENT'S REQUEST TO 09/12/07.**

9. **Project# 1003359**
07DRB-70226 MINOR - PRELIMINARY/
FINAL PLAT APPROVAL
07DRB-70227 MINOR - SDP FOR
BUILDING PERMIT

RIO GRANDE SURVEYING agent(s) for KASSAM BUSINESS CENTER LLC request(s) the above action(s) for all or a portion of Lot(s) 8-10 & 23-25, Tract(s) A, Block(s) 26, **NORTH ALBUQUERQUE ACRES, UNIT B**, zoned SU-2/IP, located on EAGLE ROCK AVE NE BETWEEN SAN PEDRO NE AND LOUISIANA NE containing approximately 6.01 acre(s). (C-18) **THE AGENT MUST PROVIDE A WITHDRAWAL LETTER FOR THE MINOR - PRELIMINARY/ FINAL PLAT, 07DRB-700089. DEFERRED AT THE AGENT'S REQUEST TO 09/12/07.**

MINOR PLATS, FINAL (MAJOR) PLATS, AMENDED PLATS AND PLANS

10. **Project# 1006779**
07DRB-70214 MINOR - PRELIMINARY/
FINAL PLAT APPROVAL

SURVEYS SOUTHWEST LTD agent(s) for PATRICK APODACA request(s) the above action(s) for all or a portion of Lot(s) 23-26, Block(s) 2, **LA MESA ADDITION**, zoned R-T, located on DOMINGO RD NE BETWEEN ALCAZAR ST NE AND CHAMA ST NE containing approximately 0.6198 acre(s). (K-19) **INDEFINITELY DEFERRED AT THE AGENT'S REQUEST.**

11. **Project# 1006784**
07DRB-70219 MINOR - PRELIMINARY/
FINAL PLAT APPROVAL

SURVEYS SOUTHWEST LTD agent(s) for RICHARD & JOANNE MCGRATH request(s) the above action(s) for all or a portion of Lot(s) 6 & 7, Block(s) 25 together with VACATED RIDGECREST DR SE, **RIDGECREST ADDITION**, zoned R-1, located on RIDGECREST DR SE BETWEEN MONROE PL SE AND PAMPAS DR SE (L-17) **PRELIMINARY AND FINAL PLAT WAS APPROVED WITH FINAL SIGN OFF DELEGATED TO PLANNING FOR THE AGIS DXF FILE.**

12. **Project# 1005590**
07DRB-70211 MINOR - PRELIMINARY/
FINAL PLAT APPROVAL

HIGH MESA CONSULTING GROUP agent(s) for ALBUQUERQUE PUBLIC SCHOOLS FACILITIES DESIGN & CONSTRUCTION request(s) the above action(s) for all or a portion of Tract(s) A & B, **SUSIE RAYOS MARMON ELEMENTARY CSHOOL**, zoned R-D 15 DU/A, located on ILIFF RD NW BETWEEN 72th ST NW AND 68th ST NW containing approximately 14.981 acre(s). (H-10) **PRELIMINARY AND FINAL PLAT WAS APPROVED WITH FINAL SIGN OFF DELEGATED TO PLANNING FOR THE AGIS DXF FILE.**

13. **Project# 1002962**
07DRB-70224 MINOR - PRELIMINARY/
FINAL PLAT APPROVAL
- BOHANNAN HUSTON INC agent(s) for CANTATA AT THE TRAILS, INC. request(s) the above action(s) for all or a portion of Tract(s) A, B, & C, **CANTATA AT THE TRAILS, UNIT 2**, zoned SU-2, SU-1 FOR PARK & SU2 FOR UR, located on OAKRIDGE ST NW BETWEEN WOODMONT AVE NW AND PASEO DEL NORTE NW containing approximately 20.7395 acre(s). (C-9) **PRELIMINARY AND FINAL PLAT WAS APPROVED WITH FINAL SIGN OFF DELEGATED TO CITY ENGINEER FOR CROSS LOT DRAINAGE EASEMENT AND TO PLANNING FOR THE SOLAR COLLECTOR LANGUAGE ON THE PLAT, AGIS DXF FILE AND TO RECORD.**
14. **Project# 1006788**
07DRB-70223 MINOR - PRELIMINARY/
FINAL PLAT APPROVAL
- BOHANNAN HUSTON INC agent(s) for KKY PROPERTIES, LLC request(s) the above action(s) for all or a portion of Lot(s) 10-A, Tract(s) B-3-A-1 (to be known as **LOT 10-A-1 WASHINGTON BUSINESS PARK**) zoned SU-2/M-1, located on WASHINGTON ST NE BETWEEN WASHINGTON PL NE AND ALAMEDA BLVD NE containing approximately 5.9162 acre(s). (C-17) **PRELIMINARY AND FINAL PLAT WAS APPROVED WITH FINAL SIGN OFF DELEGATED TO PLANNING FOR THE SOLAR COLLECTOR LANGUAGE, ENVIRONMENTAL HEALTH'S SIGNATURE, TO BE SURE SIDEWALKS EXISTING, AGIS DXF FILE AND TO RECORD.**
15. **Project# 1000029**
07DRB-70225 SIDEWALK WAIVER
- BOHANNAN HUSTON INC agent(s) for SAWMILL COMMUNITY LAND TRUST request(s) the above action(s) for all or a portion of **ARBOLERA DE VIDA PHASE 2B**, zoned SU2-M1, S-1, located on 18TH ST NW BETWEEN AGUA FRESCA NW AND MIS ABUELITOS DR NW containing approximately 23.8439 acre(s). (H-13) **THE SIDEWALK WAIVER WAS APPROVED AS SHOWN ON EXHIBIT C IN THE PLANNING FILE.**
16. **Project# 1004355**
07DRB-70230 MINOR - PRELIMINARY/
FINAL PLAT APPROVAL
- WILSON AND COMPANY INC agent(s) for KB HOMES NEW MEXICO request(s) the above action(s) for all or a portion of Lot(s) 1-4, Block(s) 2, Lot(s) 1-4, Block(s) 3, **VISTA VIEJA SUBDIVISION, UNIT 2**, zoned R-D, located on VISTA TERRAZA DR NW BETWEEN BOUVARDIA RD NW AND MOCK HEATHER RD NW containing approximately 1.35 acre(s). (D-9) **PRELIMINARY AND FINAL PLAT WAS APPROVED WITH FINAL SIGN OFF DELEGATED TO PLANNING FOR THE SOLAR COLLECTOR LANGUAGE, REAL PROPERTY'S SIGNATURE ON THE PLAT, AGIS DXF FILE AND TO RECORD.**

17. **Project# 1004607**
07DRB-70229 MINOR - PRELIMINARY/
FINAL PLAT APPROVAL

WILSON & COMPANY INC agent(s) for SALLS BROTHERS CONSTRUCTION INC request(s) the above action(s) for all or a portion of Lot(s) 8-11, Block(s) 12 & Lot(s) 10-13, Block(s) 14 of Unit(s) 3 and Lot(s) 1-6, Block(s) 20 of Unit 4, **VISTA VIEJA SUBDIVISION**, zoned R-D, located on VISTA TERRAZA DR NW BETWEEN BOUVARDIA RD NW AND MOCK HEATHER RD NW containing approximately 2.57 acre(s). (D-9) **PRELIMINARY AND FINAL PLAT WAS APPROVED WITH FINAL SIGN OFF DELEGATED TO PLANNING FOR THE SOLAR COLLECTOR LANGUAGE, REAL PROPERTY'S SIGNATURE ON THE PLAT, AGIS DXF FILE AND TO RECORD.**

18. **Project# 1005185**
07DRB-70222 MAJOR - FINAL PLAT
APPROVAL

HARRIS SURVEYING INC agent(s) for "W" INVESTMENTS request(s) the above action(s) for all or a portion of Parcel 2-A-1, **'LAND OF EDMUND I RADY**, (to be known as **VILLA LOMA ESTATES**) zoned C-2, located on MONTGOMERY BLVD NE BETWEEN TRAMWAY BLVD NE AND BERMUDA RD NE containing approximately 2.6337 acre(s). (F-22) **FINAL PLAT WAS APPROVED WITH FINAL SIGN OFF DELEGATED TO PLANNING FOR THE SOLAR COLLECTOR LANGUAGE, HOMEOWNER ASSOCIATION PRESIDENT'S SIGNATURE ON THE PLAT, AGIS DXF FILE AND TO RECORD.**

19. **Project# 1005482**
07DRB-70228 MINOR - PRELIMINARY/
FINAL PLAT APPROVAL

DOUG SMITH SURVEYING agent(s) for ROBERT THOMAS request(s) the above action(s) for all or a portion of Lot(s) 2 & 3, **MIRA MESA ESTATES**, zoned C-2, located on HANOVER RD NW BETWEEN TELSTAR NW AND 64TH ST NW containing approximately 4.9993 acre(s). (J-10) **PRELIMINARY AND FINAL PLAT WAS APPROVED WITH FINAL SIGN OFF DELEGATED TO PLANNING FOR THE AGIS DXF FILE AND TO RECORD.**

~~20. **Project# 1006785**~~
07DRB-70220 MINOR - PRELIMINARY/
FINAL PLAT APPROVAL

WAYJOHN SURVEYING INC agent(s) for BARTON DARROW request(s) the above action(s) for all or a portion of Lot(s) B-1 & B-2, Block(s) 1, **MESA COURT ADDITION**, zoned R-3, located on HERMOSA DR SE BETWEEN CARLISLE PL SE AND SMITH AVE SE containing approximately 0.3344 acre(s). (L-16) **PRELIMINARY AND FINAL PLAT WAS APPROVED WITH FINAL SIGN OFF DELEGATED TO PLANNING TO RECORD.**

21. **Project# 1003674**
07DRB-70075 MINOR - PRELIMINARY/
FINAL PLAT APPROVAL

TERRAMETRICS OF NEW MEXICO agent(s) for LLAVE DEVELOPMENT INC request(s) the above action(s) for all or a portion of Tract(s) A, RICH COURT SUBDIVISION (to be known as Lot(s) 7, 8, & 9 and Tract(s) A-1, RICH COURT SUBDIVISION) zoned R-D 3DU/A, located on ALAMEDA AVE NE between BARSTOW ST NE and VENTURA ST NE containing approximately 1.0376 acre(s). [Deferred from 06/27/07] (C-20) **PRELIMINARY AND FINAL PLAT WAS APPROVED WITH FINAL SIGN OFF DELEGATED TO CITY ENGINEER FOR AMAFCA'S SIGNATURE, MAINTANENCE AND BENEFICIARIES OF ALL ACCESS EASEMENTS, ACCESS EASEMENTS TO LOT A-1, SANITARY SEWER EASEMENTS TO FUTURE CUL-DE-SAC AND STREET AND TO PLANNING FOR THE SOLAR COLLECTOR LANGUAGE ON THE PLAT AND TO RECORD.**

22. **Project # 1003800**
07DRB-70212 MINOR - FINAL PLAT
APPROVAL

LLAVE DEVELOPMENT INC. request(s) the above action(s) for all or any portion of Lot(s) 1-4, Block(s) 2, Tract(s) 3, NORTH ALBUQUERQUE ACRES, UNIT 3 (to be known as LA CUEVITA OESTE) zoned R-D residential and related uses zone, developing area located on EAGLE ROCK NE between BARSTOW NE and VENTURA NE containing approximately 4 acre(s). [REF: 05DRB01906, 05DRB01907, 05DRB01908] [Deferred from 08/29/07] (C-20) **FINAL PLAT WAS APPROVED WITH FINAL SIGN OFF DELEGATED TO PLANNING TO RECORD.**

NO ACTION IS TAKEN ON THESE CASES:

APPLICANT - AGENT IS REQUIRED TO BE AT THE MEETING

23. **Project# 1006783**
07DRB-70218 SKETCH PLAT REVIEW
AND COMMENT

RUDY RAEL request(s) the above action(s) for all or a portion of Lot(s) B-1, **ROZZI**, zoned R-1, located on MOUNTAIN RD NW BETWEEN RIO GRANDE BLVD NW AND MONTOYA RD NW containing approximately 0.21 acre(s). (J-12) **THE ABOVE REQUEST WAS REVIEWED AND COMMENTS WERE GIVEN.**

Other Matters: None.

ADJOURNED: 12:10 P.M.

CITY OF ALBUQUERQUE



**PLANNING DEPARTMENT
DEVELOPMENT AND BUILDING SERVICES
HYDROLOGY DEVELOPMENT SECTION**

DEVELOPMENT REVIEW BOARD – SPEED MEMO

DRB CASE NO/PROJECT NO: 1006785

AGENDA ITEM NO: 20

SUBJECT:

Final Plat
Preliminary Plat

ACTION REQUESTED:

REV/CMT: () APPROVAL: (X) SIGN-OFF: () EXTN: () AMEND: ()

ENGINEERING COMMENTS:

P.O. Box 1293

No adverse comments.

Albuquerque

New Mexico 87103

www.cabq.gov

RESOLUTION:

APPROVED ; DENIED ___; DEFERRED ___; COMMENTS PROVIDED ___; WITHDRAWN ___

DELEGATED: (SEC-PLN) (SP-SUB) (SP-BP) (FP) TO: (UD) (CE) (TRANS) (PRKS) (PLNG)

SIGNED: Bradley L. Bingham

City Engineer / AMAFCA Designee

DATE: SEPTEMBER 5, 2007

505-924-3986

0

**CITY OF ALBUQUERQUE
PLANNING DEPARTMENT
September 5, 2007
DRB Comments**

ITEM # 20

PROJECT # 1006785 APPLICATION # 07-70220

RE: Lots B-1 & B-2, Block 1, Mesa Court Addition/plat

Be advised that any plats approved by DRB must contain the following language from the City Subdivision Ordinance:

Section 14-14-4-7(B) "No property within the area of requested final action shall at any time be subject to a deed restriction, covenant, or building agreement prohibiting solar collectors from being installed on buildings or erected on the lots or parcels within the area of proposed plat. The foregoing requirement shall be a condition to approval of this plat or site development plan for subdivision."

Planning will take delegation for the addition of this language, AGIS dxf approval and to record the plat.

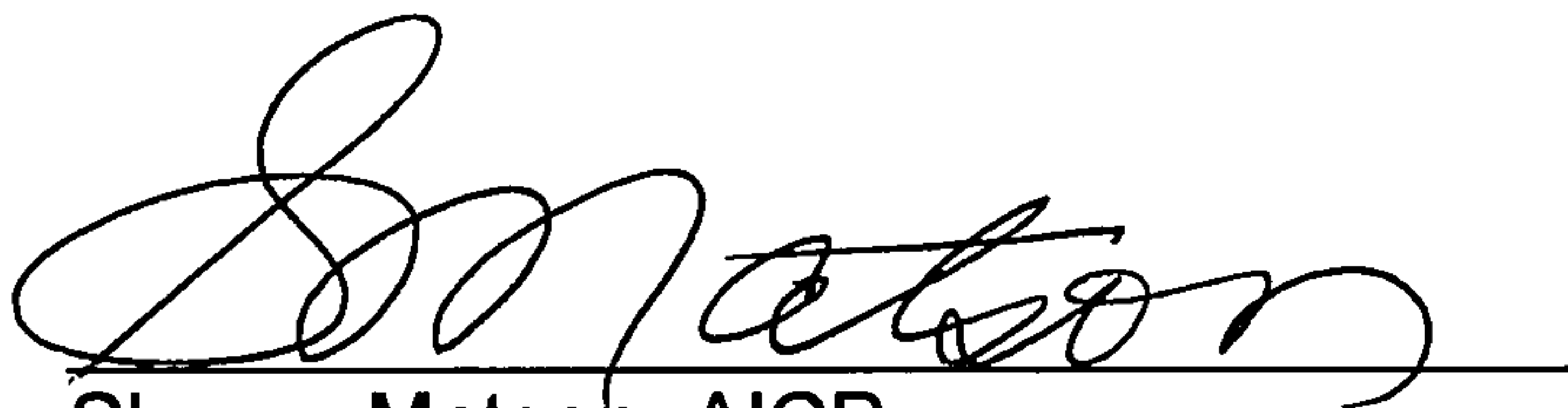

Sheran Matson, AICP

DRB Chair

924-3880 smatson@cabq.gov

City of Albuquerque Planning Department
One Stop Shop – Development and Building Services

08/27/2007 Issued By: PLNSDH

Permit Number: 2007 070 220 **Category Code 910**

Application Number: 07DRB-70220, Minor - Preliminary/ Final Plat Approval

Address:

Location Description: HERMOSA DR SE BETWEEN CARLISLE PL SE AND SMITH AVE SE

Project Number: 1006785

Applicant
Barton Darrow

Agent / Contact
Wayjohn Surveying Inc

913 Hermosa Dr Se
Albuquerque, NM 87108
255-4774

330 Louisiana Blvd Se
Albuquerque, NM 87108
255-2052

Application Fees

441018/4871000	Public Notification	
441032/3424000	Conflict Mgmt Fee	\$20.00
441006/4983000	DRB Actions	\$285.00
TOTAL:		\$305.00

City Of Albuquerque
Treasury Division

8/27/2007 10:37AM LOC: ANX
WS# 007 TRANS# 0007
RECEIPT# 00087128-00087128
PERMIT# 2007070220 TRSMSP
Trans Amt \$305.00
Conflict Manag. Fee \$20.00
DRB Actions \$285.00
CK \$305.00
CHANGE \$0.00

Thank You

**CITY OF ALBUQUERQUE
PLANNING DEPARTMENT
September 5, 2007
DRB Comments**

ITEM # 20

PROJECT # 1006785 APPLICATION # 07-70220

RE: Lots B-1 & B-2, Block 1, Mesa Court Addition/plat

Be advised that any plats approved by DRB must contain the following language from the City Subdivision Ordinance:

Section 14-14-4-7(B) "No property within the area of requested final action shall at any time be subject to a deed restriction, covenant, or building agreement prohibiting solar collectors from being installed on buildings or erected on the lots or parcels within the area of proposed plat. The foregoing requirement shall be a condition to approval of this plat or site development plan for subdivision."

Planning will take delegation for the addition of this language, AGIS dxf approval and to record the plat.

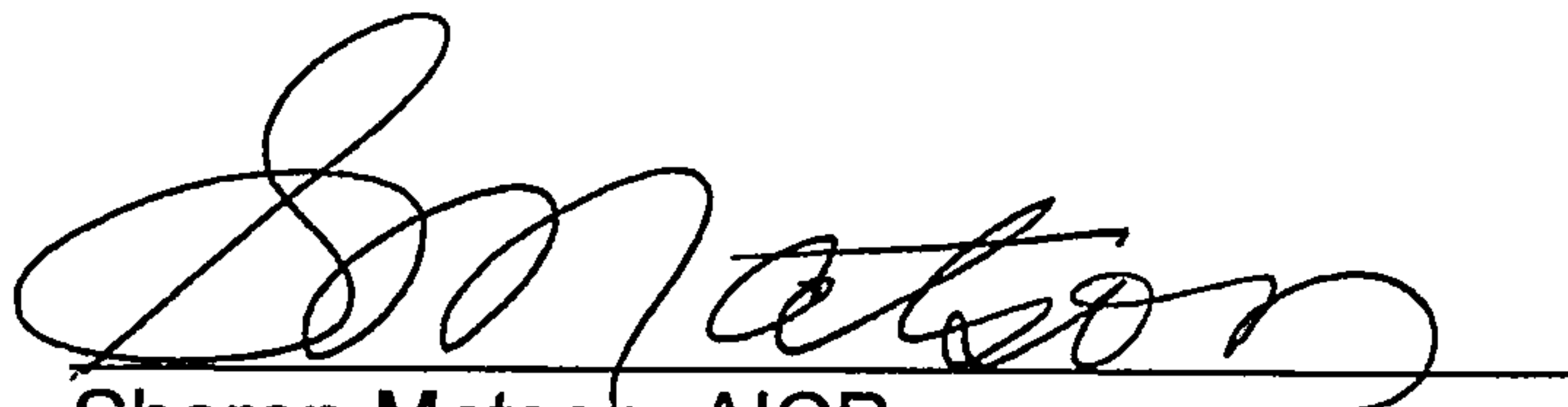

Sheran Matson, AICP

DRB Chair

924-3880 smatson@cabq.gov

City of Albuquerque



DEVELOPMENT/ PLAN REVIEW APPLICATION

Supplemental form

SUBDIVISION

- Major Subdivision action
- Minor Subdivision action
- Vacation
- Variance (Non-Zoning)

SITE DEVELOPMENT PLAN

- for Subdivision
- for Building Permit
- Administrative Amendment (AA)
- IP Master Development Plan
- Cert. of Appropriateness (LUCC)

STORM DRAINAGE

- Storm Drainage Cost Allocation Plan

S Z ZONING & PLANNING

- Annexation
- County Submittal
- EPC Submittal
- Zone Map Amendment (Establish or Change Zoning)
- Sector Plan (Phase I, II, III)
- Amendment to Sector, Area, Facility or Comprehensive Plan
- Text Amendment (Zoning Code/Sub Regs)
- Street Name Change (Local & Collector)
- L A APPEAL / PROTEST of...
- D Decision by: DRB, EPC, LUCC, Planning Director or Staff, ZHE, Zoning Board of Appeals

PRINT OR TYPE IN BLACK INK ONLY. The applicant or agent must submit the completed application in person to the Planning Department Development Services Center, 600 2nd Street NW, Albuquerque, NM 87102. Fees must be paid at the time of application. Refer to supplemental forms for submittal requirements.

APPLICANT INFORMATION:

Professional/Agent (if any): WAYJOHN SURVEYING INC. PHONE: 255-2052
 ADDRESS: 330 LOUISIANA BLVD NE FAX: 255-2887
 CITY: ALBUQUERQUE STATE NM ZIP 87108 E-MAIL: WAYJONSURV@AOL.COM

APPLICANT: BARTON DARROW PHONE: 255-4774
 ADDRESS: 913 HERMOSA DRIVE SE FAX: _____
 CITY: ALBUQUERQUE STATE NM ZIP 87108 E-MAIL: _____

Proprietary interest in site: OWNER List all owners: BARTON DARROW; CHRISTOPHER PIND

DESCRIPTION OF REQUEST: MINOR PRELIMINARY/FINAL PLAT TO ADJUST THE INTERIOR LOT LINE BETWEEN TWO LOTS

Is the applicant seeking incentives pursuant to the Family Housing Development Program? Yes. No.

SITE INFORMATION: ACCURACY OF THE EXISTING LEGAL DESCRIPTION IS CRUCIAL! ATTACH A SEPARATE SHEET IF NECESSARY.

Lot or (Tract) No. B-1 & B-2 Block: 1 Unit: _____

Subdiv/Addn/TBKA: MESA COURT ADDITION

Existing Zoning: R-3 Proposed zoning: SAME

Zone Atlas page(s): L-16 MRGCD Map No. _____

UPC# 101705609267312706

CASE HISTORY:

List any current or prior case number that may be relevant to your application (Proj., App., DRB-, AX, Z, V, S, etc.): SP-78-414

CASE INFORMATION:

Within city limits? Yes Within 1000FT of a landfill? NO

No. of existing lots: 2 No. of proposed lots: 2 Total area of site (acres): 0.3344

LOCATION OF PROPERTY BY STREETS: On or Near: HERMOSA DRIVE SE

Between: CARLISLE PLACE SE and SMITH AVENUE SE

Check-off if project was previously reviewed by Sketch Plat/Plan , or Pre-application Review Team . Date of review: _____

SIGNATURE [Signature] DATE 8.23.07

(Print) THOMAS D. JOHNSTON Applicant: Agent:

FOR OFFICIAL USE ONLY

Form revised 4/07

- INTERNAL ROUTING
- All checklists are complete
- All fees have been collected
- All case #s are assigned
- AGIS copy has been sent
- Case history #s are listed
- Site is within 1000ft of a landfill
- F.H.D.P. density bonus
- F.H.D.P. fee rebate

Application case numbers
01/28/07 70270

Action	S.F.	Fees
<u>P&F</u>	<u>513</u>	<u>\$ 285.00</u>
<u>CME</u>		<u>\$ 20.00</u>
		\$ _____
		\$ _____
		\$ _____
		\$ _____
		Total
		<u>\$ 305.00</u>

Hearing date 09/05/07

Sandy Handberg 08/27/07

Project # 1006785

FORM S(3): SUBDIVISION - D.R.B. MEETING (UNADVERTISED) OR INTERNAL ROUTING

A Bulk Land Variance requires application on FORM-V in addition to application for subdivision on FORM-S.

- SKETCH PLAT REVIEW AND COMMENT (DRB22)** Your attendance is required.
- Scale drawing of the proposed subdivision plat (folded to fit into an 8.5" by 14" pocket) **6 copies**
 - Site sketch with measurements showing structures, parking, Bldg. setbacks, adjacent rights-of-way and street improvements, if there is any existing land use (folded to fit into an 8.5" by 14" pocket) **6 copies**
 - Zone Atlas map with the entire property(ies) clearly outlined.
 - Letter briefly describing, explaining, and justifying the request
 - List any original and/or related file numbers on the cover application

- EXTENSION OF MAJOR PRELIMINARY PLAT (DRB08)** Your attendance is required.
- Preliminary Plat reduced to 8.5" x 11"
 - Zone Atlas map with the entire property(ies) clearly outlined
 - Letter briefly describing, explaining, and justifying the request
 - Copy of DRB approved infrastructure list
 - Copy of the LATEST Official DRB Notice of approval for Preliminary Plat Extension request
 - List any original and/or related file numbers on the cover application
- Extension of preliminary plat approval expires after one year.

- MAJOR SUBDIVISION FINAL PLAT APPROVAL (DRB12)** Your attendance is required.
- Proposed Final Plat (folded to fit into an 8.5" by 14" pocket) **6 copies**
 - Signed & recorded Final Pre-Development Facilities Fee Agreement for Residential development only
 - Design elevations & cross sections of perimeter walls **3 copies**
 - Zone Atlas map with the entire property(ies) clearly outlined
 - Bring original Mylar of plat to meeting, ensure property owner's and City Surveyor's signatures are on the plat
 - Copy of recorded SIA
 - Landfill disclosure and EHD signature line on the Mylar if property is within a landfill buffer
 - List any original and/or related file numbers on the cover application
 - DXF file and hard copy of final plat data for AGIS is required.

- MINOR SUBDIVISION PRELIMINARY/FINAL PLAT APPROVAL (DRB16)** Your attendance is required.
- Proposed Preliminary / Final Plat (folded to fit into an 8.5" by 14" pocket) **6 copies** for unadvertised meetings
 - Signed & recorded Final Pre-Development Facilities Fee Agreement for Residential development only
 - Design elevations and cross sections of perimeter walls (11" by 17" maximum) **3 copies**
 - Site sketch with measurements showing structures, parking, Bldg. setbacks, adjacent rights-of-way and street improvements, if there is any existing land use (folded to fit into an 8.5" by 14" pocket) **6 copies**
 - Zone Atlas map with the entire property(ies) clearly outlined
 - Letter briefly describing, explaining, and justifying the request
 - Bring original Mylar of plat to meeting, ensure property owner's and City Surveyor's signatures are on the plat
 - Landfill disclosure and EHD signature line on the Mylar if property is within a landfill buffer
 - Fee (see schedule)
 - List any original and/or related file numbers on the cover application
 - Infrastructure list if required (**verify with DRB Engineer**)
 - DXF file and hard copy of final plat data for AGIS is required.

- AMENDMENT TO PRELIMINARY PLAT (with minor changes) (DRB03)** Your attendance is required.
- PLEASE NOTE: There are no clear distinctions between significant and minor changes with regard to subdivision amendments. Significant changes are those deemed by the DRB to require public notice and public hearing.
- Proposed Amended Preliminary Plat, Infrastructure List, and/or Grading Plan (folded to fit into an 8.5" by 14" pocket) **6 copies**
 - Original Preliminary Plat, Infrastructure List, and/or Grading Plan (folded to fit into an 8.5" by 14" pocket) **6 copies**
 - Zone Atlas map with the entire property(ies) clearly outlined
 - Letter briefly describing, explaining, and justifying the request
 - Bring original Mylar of plat to meeting, ensure property owner's and City Surveyor's signatures are on the plat
 - List any original and/or related file numbers on the cover application
- Amended preliminary plat approval expires after one year

I, the applicant, acknowledge that any information required but not submitted with this application will likely result in deferral of actions.

THOMAS D. JOHNSON (AGENT)
Applicant name (print)

Applicant signature / date

8.23.07
Applicant signature / date



Form revised 4/07

- Checklists complete
 - Fees collected
 - Case #s assigned
 - Related #s listed
- Application case numbers
01 DRB - 70220

Sandy Hinder 08/27/07
Planner signature / date

Project # 1006785

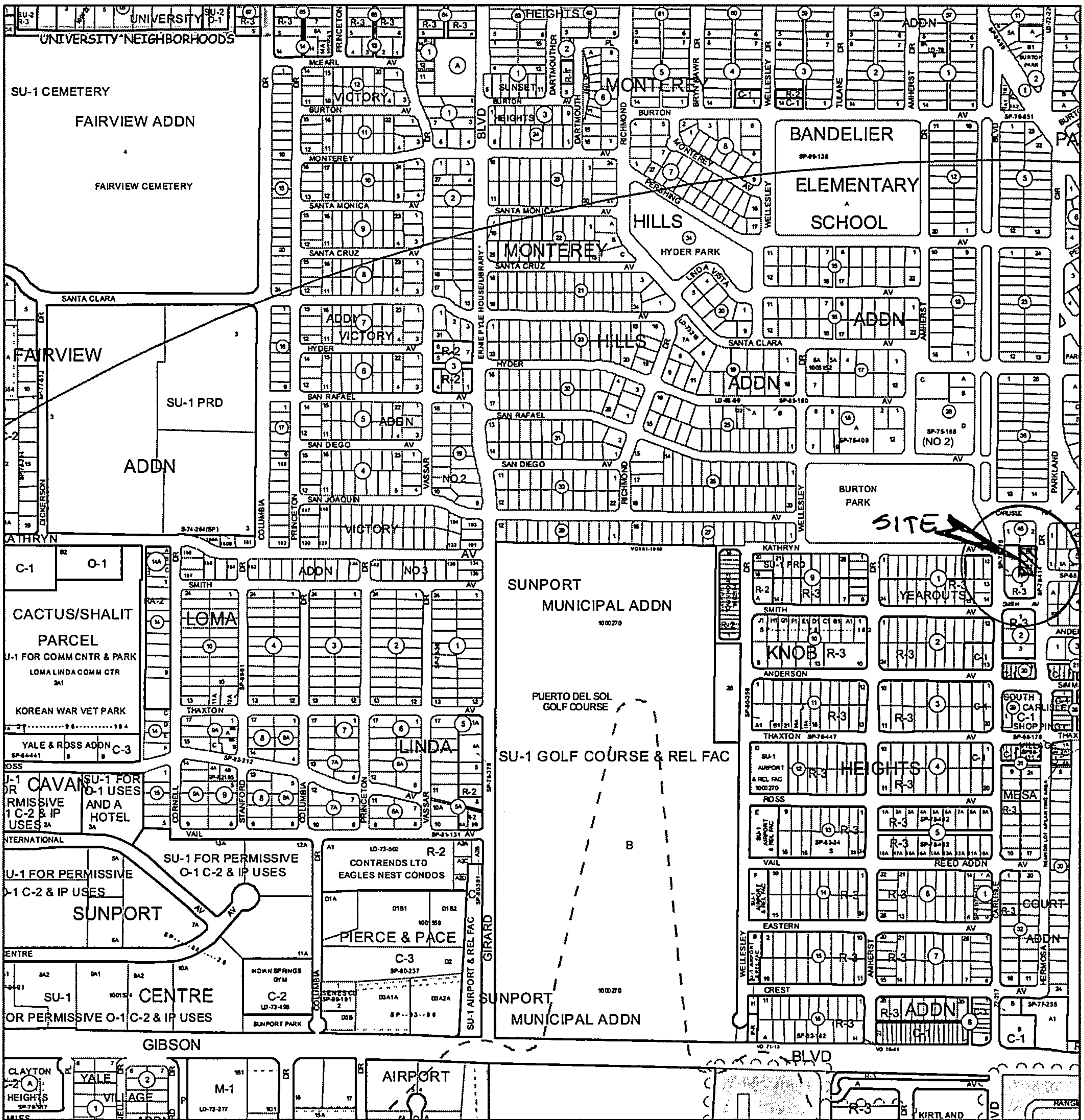

For more current information and more details visit: <http://www.cabq.gov/gis>

AGIS
Albuquerque Geographic Information System

Map amended through: 3/14/2006

Note: Grey Shading Represents Area Outside of the City Limits

Zone Atlas Page:
L-16-Z

Selected Symbols

- SECTOR PLANS
- Design Overlay Zones
- City Historic Zones
- H-1 Buffer Zone
- Petroglyph Mon.
- Escarpment
- 2 Mile Airport Zone
- Airport Noise Contours
- Wall Overlay Zone

0 750 1,500 Feet



330 Louisiana Blvd., N.E. • Albuquerque, NM 87108 • Phone: (505) 255-2052 • Fax: (505) 255-2887

August 23, 2007

Planning Department
City of Albuquerque
PO Box 1293
Albuquerque, NM 87103

RE: Minor Preliminary/Final Plat of Tracts B-1-A and B-2-A, Block 1, Mesa Court Addition

To Whom It May Concern:

I am submitting a request for minor preliminary and final plat to adjust the lot lines between two existing parcels. The parcels currently contain existing zero-lot line residences. We propose to adjust the interior lot line to conform to the existing structures.

Thank you for your time in considering this matter. If you have any questions, please give me a call at the above number.

Regards,

A handwritten signature in black ink, appearing to read 'Thomas D. Johnston', is written over a horizontal line.

Thomas D. Johnston, PS, PE
President, Wayjohn Surveying Inc.