

CERTIFIED MAIL
RETURN RECEIPT REQUESTED

voice: 505.823.1000
facsimile: 505.798.7988
toll free: 800.877.5332

September 9, 2016

Ted Trujillo
6601 Honeylocust Avenue NW
Albuquerque, NM 87121

Re: Request for Public and Private Easement Vacation, Bulk Land Variance, and Replat/Lot consolidation requests.

Dear Mr. Trujillo:

The City of Albuquerque's Office of Neighborhood Coordination has informed us that you are a representative of the LOS VOLCANES Neighborhood Association.

This letter is to advise you that Bohannon Huston, Inc., agent for Ben E. Keith Company, is seeking approval for Public and Private Easement Vacations, Bulk Land Variance, and Replat/Lot consolidation requests. See the attached Zone Atlas Page for the project location. These requests are being made to accommodate the potential development of the property by the Ben E. Keith Company.

You were also recently informed of a related public right-of-way vacation associated with Towne Crossing Avenue. The subject request will also incorporate all or a portion of the vacated right-of-way into the property.

Please feel free to contact me if you have any questions regarding this matter or need information as to the date and time of the public hearing.

Sincerely,



Paul M. Wymer, AIA, AICP
Senior Architect/Planner
Community Development and Planning

Enclosure

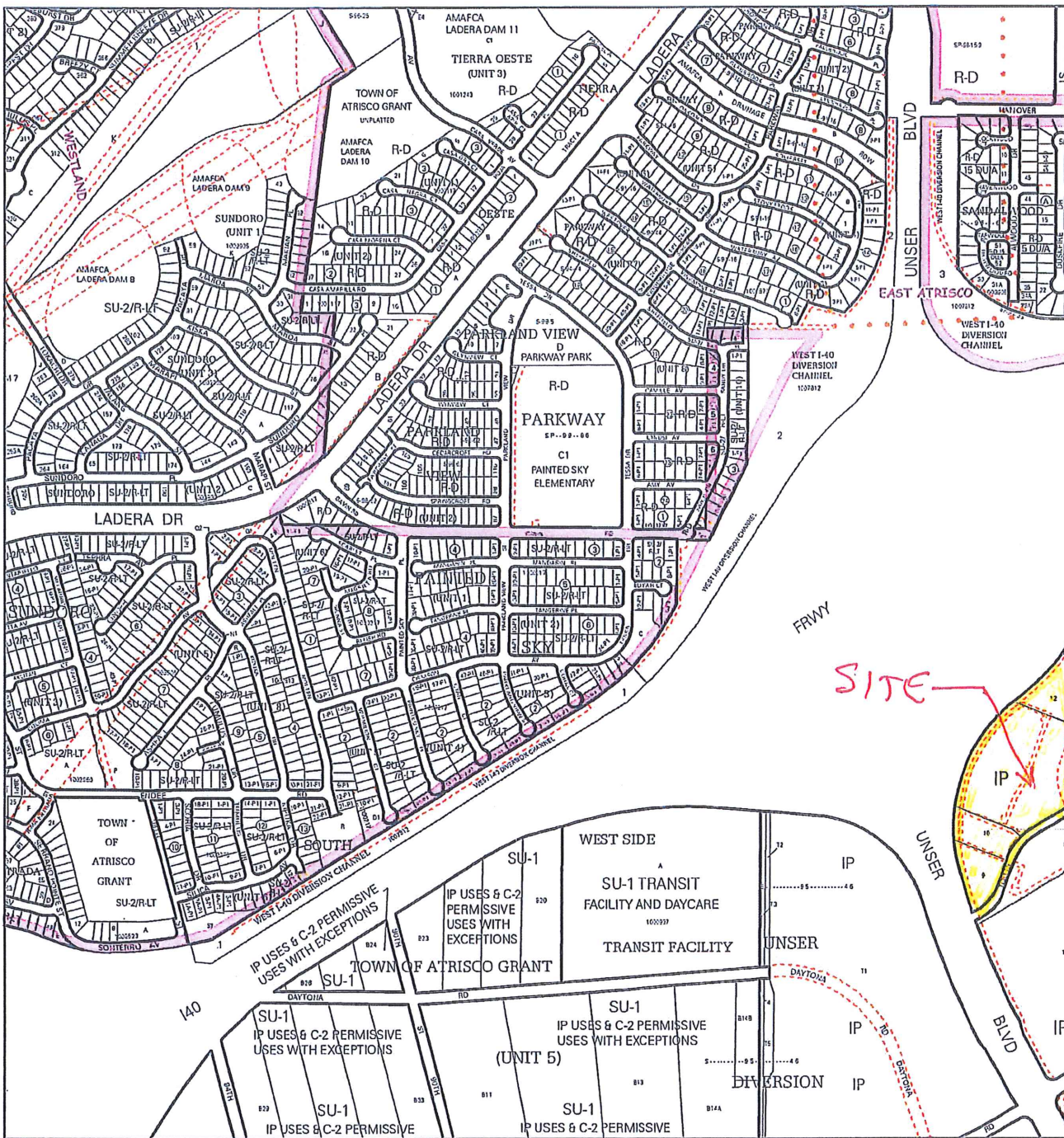

For more current information and details visit: <http://www.cabq.gov/gis>











Map amended through: 4/2/2012



Note: Grey Shading Represents Area Outside of the City Limits

Zone Atlas Page:
J-09-Z

Selected Symbols

	SECTOR PLANS		Escarpment
	Design Overlay Zones		2 Mile Airport Zone
	City Historic Zones		Airport Noise Contours
	H-1 Buffer Zone		Wall Overlay Zone
	Petroglyph Mon.		

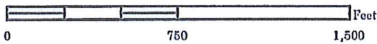

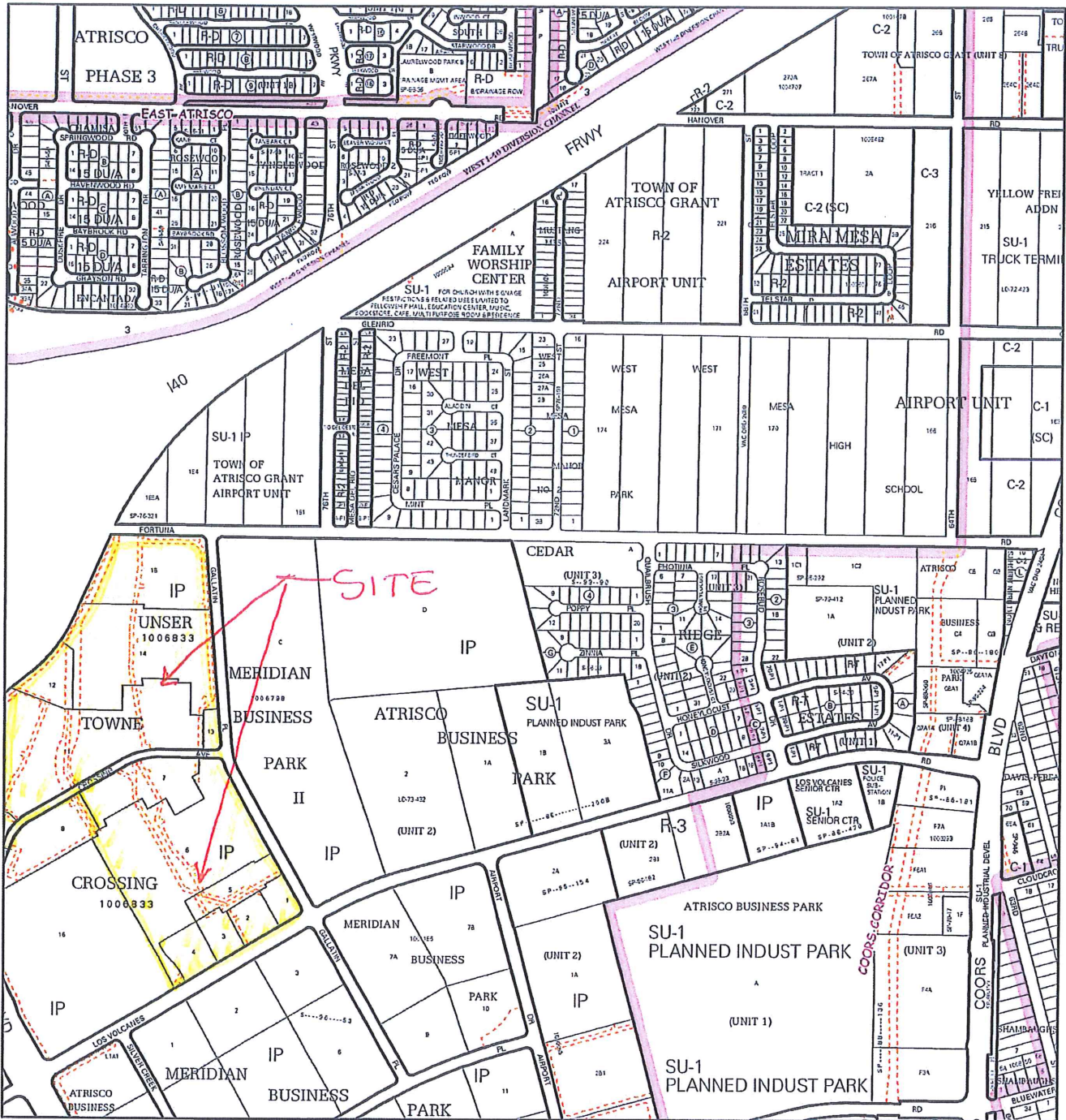

For more current information and details visit: <http://www.cabq.gov/gis>



Map amended through: 4/2/2012

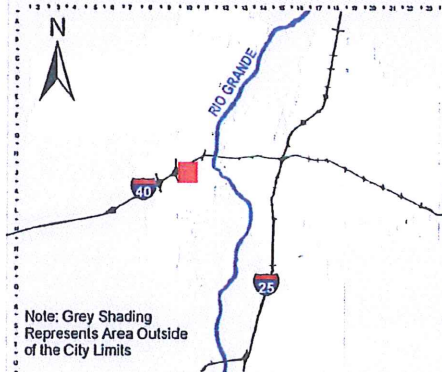

Note: Grey Shading Represents Area Outside of the City Limits

Zone Atlas Page:
J-10-Z

Selected Symbols

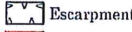
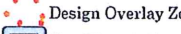
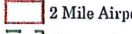
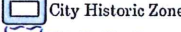
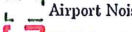
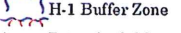
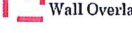
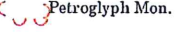
 SECTOR PLANS	 Escarpment
 Design Overlay Zones	 2 Mile Airport Zone
 City Historic Zones	 Airport Noise Contours
 H-1 Buffer Zone	 Wall Overlay Zone
 Petroglyph Mon.	



0 750 1,500 Feet

CERTIFIED MAIL
RETURN RECEIPT REQUESTED

voice: 505.823.1000
facsimile: 505.798.7988
toll free: 800.877.5332

September 9, 2016

Doug Cooper
6800 Silkwood NW
Albuquerque, NM 87121

Re: Request for Public and Private Easement Vacation, Bulk Land Variance, and Replat/Lot consolidation requests.

Dear Mr. Cooper:

The City of Albuquerque's Office of Neighborhood Coordination has informed us that you are a representative of the LOS VOLCANES Neighborhood Association.

This letter is to advise you that Bohannon Huston, Inc., agent for Ben E. Keith Company, is seeking approval for Public and Private Easement Vacations, Bulk Land Variance, and Replat/Lot consolidation requests. See the attached Zone Atlas Page for the project location. These requests are being made to accommodate the potential development of the property by the Ben E. Keith Company.

You were also recently informed of a related public right-of-way vacation associated with Towne Crossing Avenue. The subject request will also incorporate all or a portion of the vacated right-of-way into the property.

Please feel free to contact me if you have any questions regarding this matter or need information as to the date and time of the public hearing.

Sincerely,



Paul M. Wymer, AIA, AICP
Senior Architect/Planner
Community Development and Planning

Enclosure

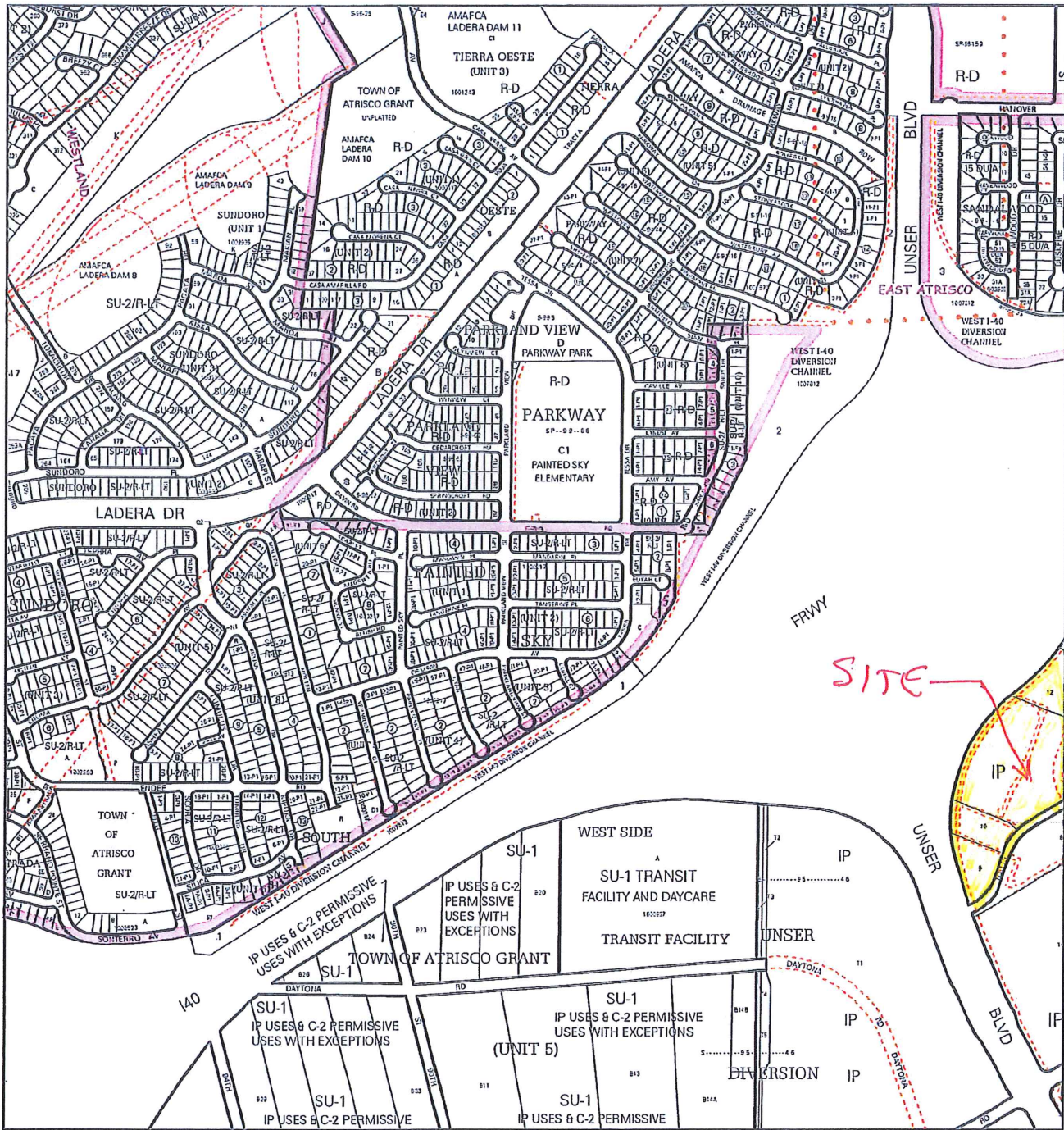

For more current information and details visit: <http://www.cabq.gov/gis>

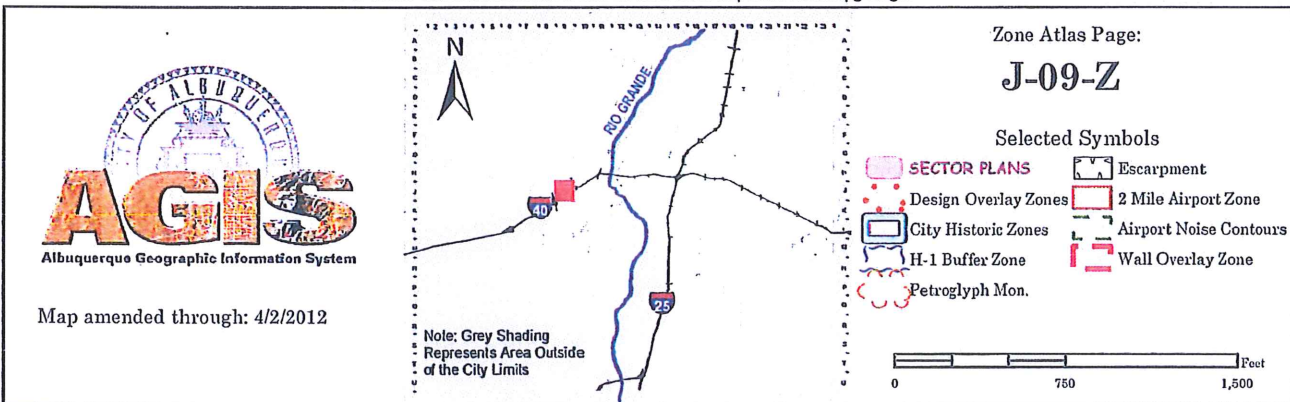

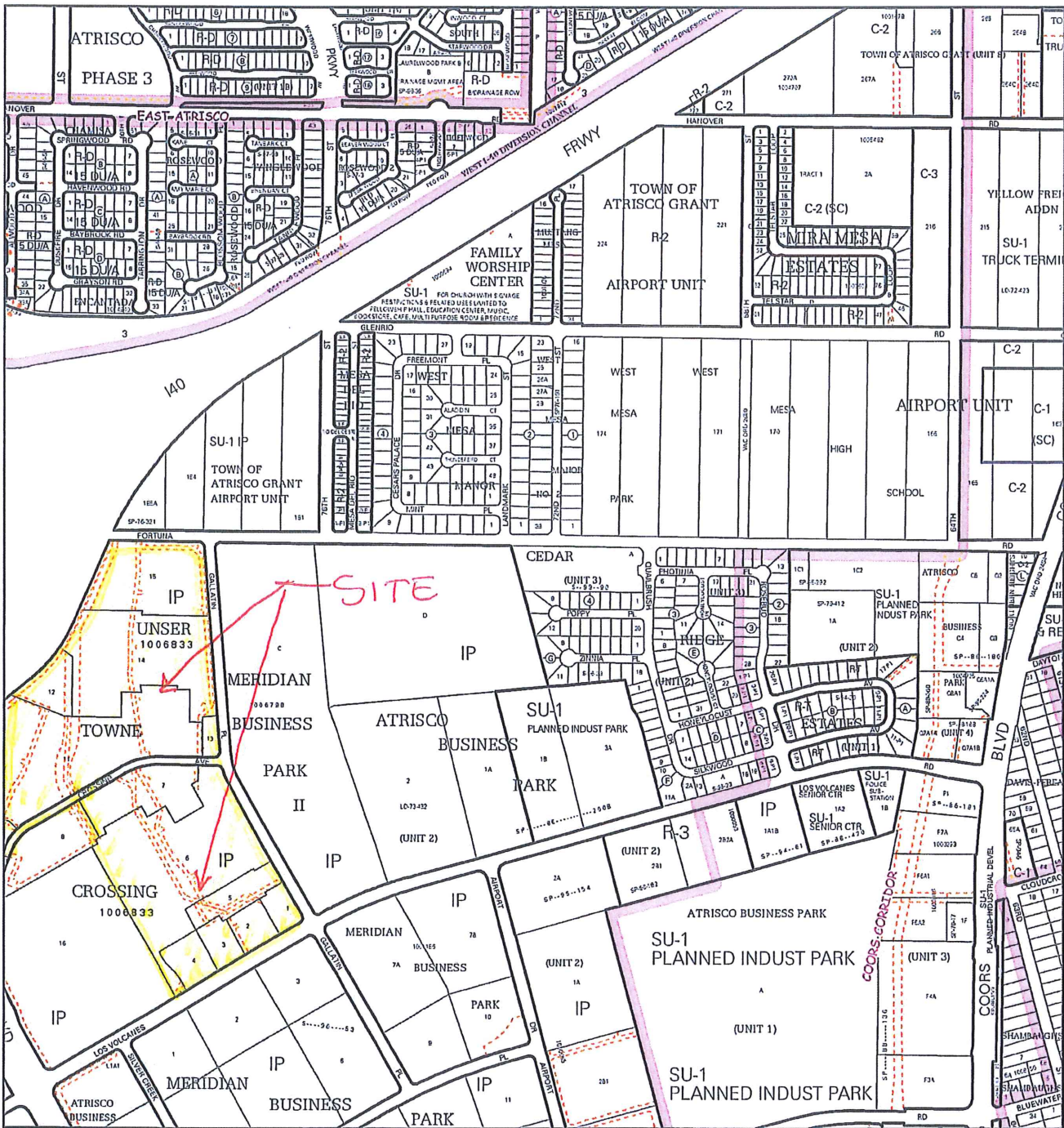

For more current information and details visit: <http://www.cabq.gov/gis>

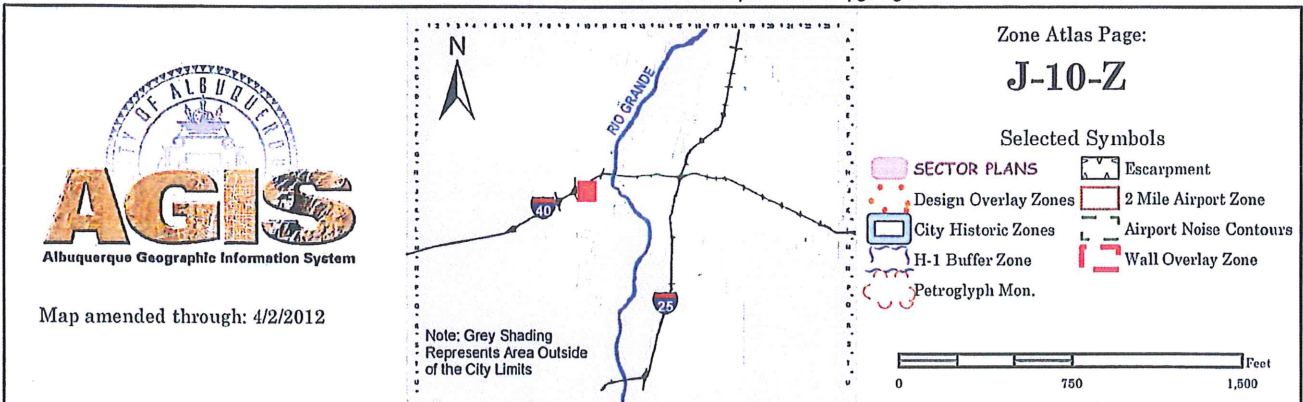

PLACE STICKER AT TOP OF ENVELOPE TO THE RIGHT OF THE RETURN ADDRESS, FOLD AT DOTTED LINE

CERTIFIED MAIL™

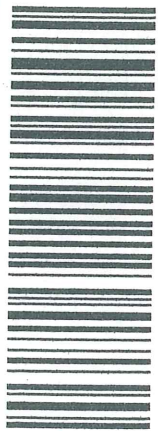

7010 1870 0000 2738 5412
7010 1870 0000 2738 5412

U.S. Postal Service™
CERTIFIED MAIL™ RECEIPT
(Domestic Mail Only; No Insurance Coverage Provided)

For delivery information visit our website at www.usps.com®

OFFICIAL USE

Postage	\$	Postmark Here
Certified Fee		
Return Receipt Fee (Endorsement Required)		
Restricted Delivery Fee (Endorsement Required)		
Total Postage & Fees	\$	

Sent To Ted Trujillo
 Street, Apt. No.,
 or PO Box No. 6601 Honeylocust Ave. NW
 City, State, ZIP+4 Albuq. NM 87121

PS Form 3800, August 2006 See Reverse for Instructions

SENDER: COMPLETE THIS SECTION

- Complete items 1, 2, and 3. Also complete item 4 if Restricted Delivery is desired.
- Print your name and address on the reverse so that we can return the card to you.
- Attach this card to the back of the mailpiece, or on the front if space permits.

1. Article Addressed to:
Ted Trujillo
6601 Honeylocust Ave. NW
Albuquerque, NM 87121

2. Article Number
(Transfer from service label)
7010 1870 0000 2738 5412

PS Form 3811, February 2004

Domestic Return Receipt

102596-02-M-1540

COMPLETE THIS SECTION ON DELIVERY

A. Signature Agent
 Addressee

B. Received by (Printed Name) Date of Delivery

D. Is delivery address different from item 1? Yes
 if YES, enter delivery address below: No

3. Service Type
 Certified Mail Express Mail
 Registered Return Receipt for Merchandise
 Insured Mail C.O.D.

4. Restricted Delivery? (Extra Fee) Yes

Ted Trujillo
 6601 Honeylocust Avenue NW
 Albuquerque, NM 87121

COMPLETE THIS SECTION ON DELIVERY

A. Signature Agent Addressee
 B. Received by (Printed Name) C. Date of Delivery
 D. Is delivery address different from item 1? Yes No
 If YES, enter delivery address below:

3. Service Type Express Mail
 Certified Mail Registered Return Receipt for Merchandise
 Insured Mail C.O.D.
 4. Restricted Delivery? (Extra Fee) Yes

SENDER: COMPLETE THIS SECTION

- Complete items 1, 2, and 3. Also complete item 4 if Restricted Delivery is desired.
- Print your name and address on the reverse so that we can return the card to you.
- Attach this card to the back of the mailpiece, or on the front if space permits.

1. Article Addressed to:

*Doug Cooper
6800 Silkwood NW
Albuquerque, NM 87121*

2. Article Number (Transfer from service label) **7010 0107 0000 2738 5429**

PS Form 3811, February 2004

Domestic Return Receipt

102595-02-M-1540

Doug Cooper
6800 Silkwood NW
Albuquerque, NM 87121

PLACE STICKER AT TOP OF ENVELOPE TO THE RIGHT OF THE RETURN ADDRESS, FOLD AT DOTTED LINE

CERTIFIED MAIL™

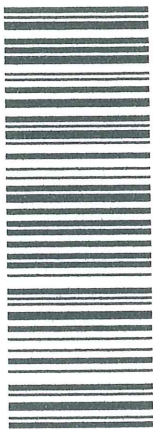

7010 0107 0000 2738 5429

U.S. Postal Service™
CERTIFIED MAIL™ RECEIPT
(Domestic Mail Only; No Insurance Coverage Provided)

For delivery information visit our website at www.usps.com®

OFFICIAL USE

Postage	\$
Certified Fee	
Return Receipt Fee (Endorsement Required)	
Restricted Delivery Fee (Endorsement Required)	
Total Postage & Fees	\$

Postmark Here

Sent To *Doug Cooper*
 Street, Apt. No., or PO Box No. *6800 Silkwood NW*
 City, State, ZIP+4 *Albuq. NM 87121*