

SURV TEK, INC.

Consulting Surveyors

9384 Valley View Drive, NW Albuquerque, New Mexico 87114
Phone: 505-897-3366 Fax: 505-897-3377 E-mail: russhugg@survtek.com

September 17, 2014

Albuquerque Development Review Board
PO Box 1293
Albuquerque, New Mexico 87103
Attention: Mr. Jack Cloud, Chair

RE: Preliminary/Final Plat of Proposed Tract A, Quatro (Being a replat of Lots 1 thru 12, Block 2, Paris Addition, City of Albuquerque, Bernalillo County, New Mexico. City Zone Atlas page A-14.

Dear Mr. Cloud

The owners of the above captioned property, The Greater Albuquerque Housing Partnership is hereby filing application with the City of Albuquerque Development Review Board for a Minor Preliminary/Final Plat approval of the property as described below:

The Preliminary/Final Plat will combine twelve (12) existing Lots into one (1) new Tract in conjunction with the Site Plan for subdivision to be submitted by Integrated Design Architects.

If you have any questions concerning this request, please feel free to contact me at your convenience.

Sincerely,

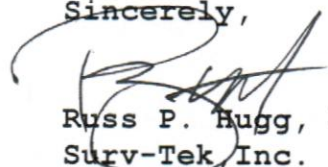

Russ P. Hugg, PS
Surv-Tek, Inc.

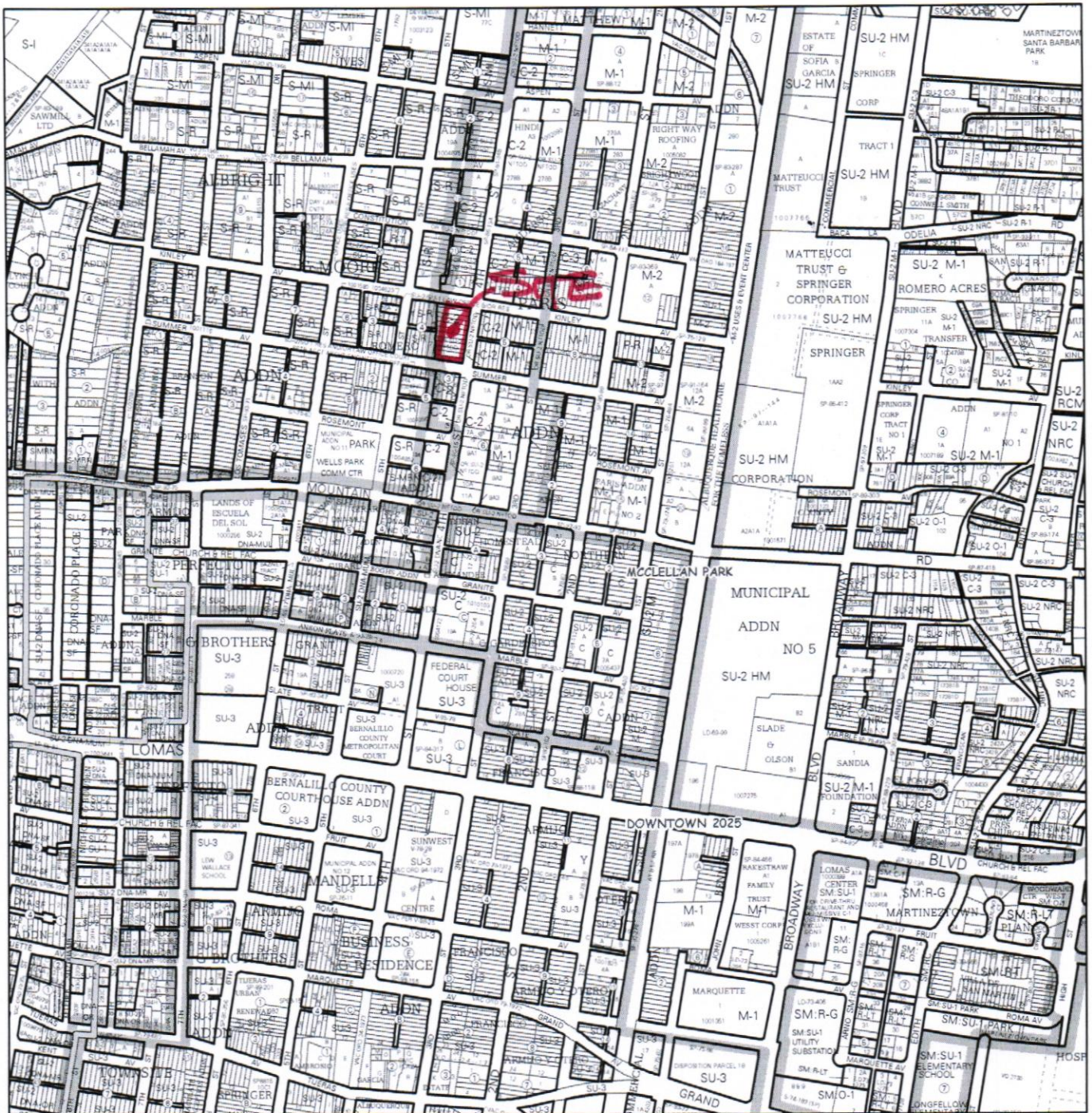

For more current information and details visit: <http://www.cabq.gov/gis>

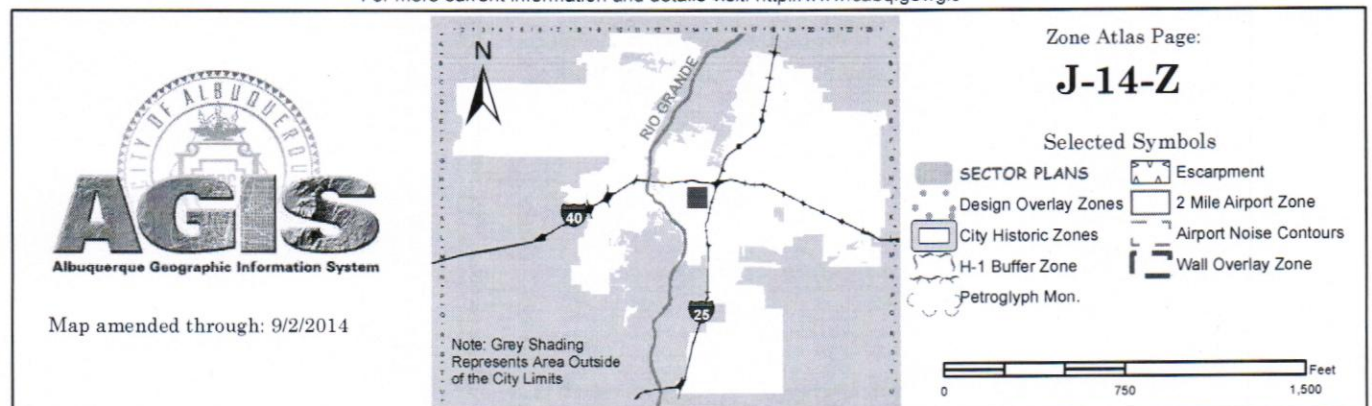

September 16, 2014

Mr. Russ Hugg
Surv-Tek, Inc.
5643 Paradise Blvd. N.W.
Albuquerque, New Mexico 87114

Dear Russ:

By this letter, I hereby authorize you to act as agent on behalf of
The Greater Albuquerque Housing Partnership for the purpose of
replatting Lots 1 thru 12, Block 2, Paris Addition, City of
Albuquerque, Bernalillo County, New Mexico.

Sincerely,

The Greater Albuquerque Housing Partnership

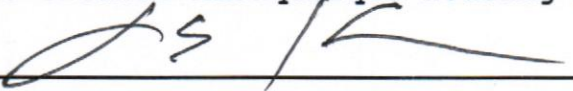
A handwritten signature in dark ink, appearing to be 'L. Kolker', is written over a horizontal line.

Louis Kolker, Executive Director