

LANDSCAPE TREE SCHEDULE

COMMON NAME	BOTANICAL NAME	MATURE SIZE	INSTALLED SIZE	DECIDUOUS/ EVERGREEN	LIGHT NEEDS	WATER NEEDS	LOCATIONS	REMARKS
TREES								
Bosque Elm	Ulmus parviflora 'UPMTF'	45'h x 30'w	2" caliper	deciduous	full sun	medium	Summer & Kinley	upright topyramidal to broadly oval; dark glossy green foliage; yellow-orange in fall; well shaped for planting on city streets and planting in restricted spaces, thanks to its upright growth habit and narrow crown
Crimson Spire Oak	Quercus robur x Q. alba 'Crimschmidt'	45'h x 15'w	2" caliper	deciduous	sun/shade	medium	4th Street	columnar, tightly fastigiate; dark green to bluish-green foliage, rusty red fall color; originated as a hybrid of Q. robur and Q. alba; white oak parentage provides dark green, mildew resistant foliage and reddish fall color; fastigiate growth habit is inherited from the English oak side
Purple Robe Locust	Robinia pseudoacacia 'Purple Robe'	40-50'h x 20-35'w	2" caliper	deciduous	full sun	medium	Entries	ascending, outward arching branches, open; foliage-purple tinted new growth ages to bronze green, yellowish in fall; dark purple flowers; seedless pods; tough, fast growing tree well adapted to hot, dry climates; best suited for areas where it provides welcome shade during hot dry summers
Chinese Pistache	Pistacia chinensis	30-35'h x 20-25'w	2" caliper	deciduous	full sun	medium	Alley	Deciduous shade tree with medium to fine textured foliage; remains an attractive, deep green color during growing season; spectacular fall color in shades of orange, red-orange and even crimson; offers superior drought, heat and wind tolerance once established
Persian Ironwood	Parrotia persica	20-40'h x 15-30'w	2" caliper	deciduous	part shade to full sun	medium	Comers at 4th	multi-trunk tree; new leaves begin as purple-red then turn dark green; orange, yellow and red fall color; deciduous with peeling bark; shade tree, street tree, or pruned as container tree; part shade to full sun; once established, it's drought tolerant
Mimosa	Albizia julibrissin rosea	to 30'h x 30'+w	1.5" caliper	deciduous	full sun	medium	Courtyard	Umbrella shaped deciduous silk tree w/striking fern-like foliage and pink fluffy flowers in summer; quick growing w/arching horizontal branching habit creating flat topped crown; ideal as a shade tree around patios, decks and close to houses; tolerant of wide range of soils, heat and dry conditions; hardy
Chaste Tree	Vitex agnus-castus	15-20'h x 15-20'w	1.5" caliper	deciduous	full sun	medium	Courtyard	vase-shaped deciduous shrub or trained as single trunk tree 20' tall; features aromatic, compound, palmate, grayish-green leaves w/5-7 lance-shaped leaflets and tiny, fragrant, lavender to pale violet flowers appearing in loose panicles in mid to late summer; flowers quite attractive to butterflies
Japanese Maple	Acer palmatum 'Bloodgood'	12-15'h x 15-25'w	1.5" caliper	deciduous	shade/ sun	medium+	Courtyard	Attractive foliage w/burgundy red coloring turns brilliant scarlet in fall; blackish red bark; slender, airy tree well-suited for use as a small lawn tree or for patios and entryways; partial to full sun; slow-growing; reach heights of 15' but can easily be maintained to any height with regular pruning; low maintenance and naturally disease and pest resistant
Streetkeeper Honey Locust	Gleditsia triacanthos 'Draves'	45'h x 20'w	2" caliper	deciduous	full sun	medium+		narrow, strongly upright, tightly pyramidal; dark green, fine textured foliage; fall color yellow; ideal tree for city streets, boasts tight narrow form that has long been lacking in urban tolerant honey locust; ascending branch structure gives it a canopy that is only half as wide as other cultivars, foliage also deeper green

LANDSCAPE SHRUBS SCHEDULE

SYMBOL	COMMON NAME	BOTANICAL NAME	MATURE SIZE	INSTALLED SIZE	DECIDUOUS/ EVERGREEN	LIGHT NEEDS	WATER NEEDS	LOCATIONS	REMARKS
SHRUBS									
MS	Maxmillian's Sunflower	Helianthus maximiliana	6-8'h x 48" w	15 gal.	deciduous	full sun	medium	parking wall	one of most spectacular late season bursts of color; use against walls or fences or make a hedge of it (can use a tomato cage)
RY	Red Yucca	Hesperaloe parviflora	5'h x 36" w	5 gal.	evergreen	sun/shade	medium	various	attracts hummingbirds, spring or summer planted
	Palmer's Penstemon	Penstemon palmeri	4-5'h x 2' w	5 gal.	evergreen	full sun	low		fragrant, blooms with gigantic spikes of large, light pink flowers early summer, gray foliage
PC	Purple Coneflower	Echinacea	3-4'h x 1-2' w	5 gal.	deciduous	full sun	medium		Full sun, attract songbirds, easy to care for, good for cut flowers, relatively drought tolerant, perennials
	Goldenrod	Solidago rugosa 'Fireworks'	3'h x 2' w	5 gal.	deciduous	sun/shade	medium		late summer/early fall bloomer, easy to grow native; more compact than most species and flowers more heavily; lacy dome of golden flowers looks like exploding fireworks providing nectar and pollen for bees and butterflies in early fall
HT	Horsetail (winter scouring rush)	Equisetum hyemale	2-4'h x 1-6" w	5 gal.	evergreen	full sun to part shade, tolerate heavy shade	medium to wet		At walls, green background, good near water (will grow in up to 4" standing water); can be invasive; in water gardens or tub gardens, plant in pots at water bottom to contain growth (both height and spread); evergreen stems are particularly noticeable in winter and can provide significant interest in the landscape; interesting plant for large patio containers; provides strong vertical accent to any planting
TBR	Trailing Blue Rosemary	Rosmarinus officinalis 'Irene'	2-3'h x 6-8" w	1 gal.	evergreen	full sun	xeric (waterwise)	roof deck?	full sun, foliage fragrant, some sources say winter to spring bloom, some say June/July, reputation for improving memory, used as a symbol for remembrance during weddings, war commemorations and funerals in Europe and Australia
COG	Compact Oregon Grape Holly	Mahonia aquifolium 'Compacta'	2-3'h x 3-4" w	5 gal.	evergreen	sun, part shade, shade	moderate		evergreen shrub with reddish new growth, turning to dark green; winter foliage is purplish-red; nice yellow flowers in spring; edible and can be added to raw salads or boiled to make lemonade substitute; berries can be eaten off bush, but best cooked and sweetened in a jam; medium growth rate
GF	Gayfeather	Liatris punctata	2'h x 30" w	1 gal.	deciduous	full sun	low		starts season looking like coarse green grass, leafy flower stems emerge from basal foliage midsummer, bloom time short, typically 3 weeks in September
AJS	Autumn Joy Sedum	Sedum telephium	24" h x 24" w	1 gal.	evergreen	sun/shade	low+		dependable choice for late summer and fall garden; green broccoli-like buds in mid-summer, gradually open into dusty-pink flower heads, finally deepening to rich bronzy-red; even dead flower heads have good winter effect
BMW	Bowles Mauve Wallflower	Erysimum infolium 'Bowles Mauve'	18-24" h x 18-24" w	5 gal.	evergreen	full sun	medium		classic perennial wallflower with profuse clusters of fragrant, mauve flowers over an exceptionally long season; nearly year round in mild climates; border or container plant, perfect for mixed borders, cottage and butterfly gardens; easy to grow, drought tolerant once established
BEL	Buena Vista English Lavender	Lavandula angustifolia 'Buena Vista'	1.5-2'h x 1.5-2' w	1 gal.	evergreen	sun/shade	medium		blooms twice per season, superb fragrance, bi-colored spikes; rock garden, herb garden or scented garden; can be particularly effective when massed; effective as an edger or low hedge in some areas
MY	Moonshine Yarrow	Achillea species	18-24" h x 18" w	1 gal.	evergreen	sun/shade	medium		Easy-to-grown beautiful perennial w/upright, canary-yellow flower clusters; attractive addition to the landscape in borders or massed plantings; flowers may be cut and dried for bouquets
MH	Mexican Hat	Ratibida columnifera 'Mexican Hat'	15-24" h x 18" w	1 gal.	deciduous	full sun	low+		drought tolerant, easy to establish, heavy bloomer; used in roadside plantings, parks, recreational areas and prairie restoration projects, sometimes grown as an ornamental

LANDSCAPE GRASSES & VINES SCHEDULE

SYMBOL	COMMON NAME	BOTANICAL NAME	MATURE SIZE	INSTALLED SIZE	DECIDUOUS/ EVERGREEN	LIGHT NEEDS	WATER NEEDS	LOCATIONS	REMARKS
GRASSES									
KF	Karl Foerster Feather Reed Grass	Calamagrostis	4-5'h x 2' w	5 gal.	deciduous	full sun	moderate		drought tolerant, upright growth habit, good behind perennials w/spreading or rounded shape, feathery plumes emerge early summer, ripen to handsome wheat-color seed head by fall, combine w/Powis Castle or Russian Sage, best in groups of 3 or 5
	Dwarf Maiden Grass	Miscanthus sinensis 'Adagio'	3-4'h x 3-4" w	5 gal.		full sun, part shade	medium		upright warm season, clump-forming ornamental grass which features extremely narrow, silver-gray blades which turn yellow in fall; tiny pink-tinged flowers appear in tassel-like inflorescences above the foliage in late summer, gradually turning into creamy white plumes by fall as the seed mature; foliage & flower plumes persist well into winter providing good winter interest
CS	Cheyenne Sky Prairie Switch Grass	Panicum virgatum 'Cheyenne Sky'	2-3'h x 18-24" w	1 gal.	evergreen	full sun to part shade	moderate		winter interest, showy, will grow in part shade but begins to lose its form in too much shade; noted for its tall, upright, blue-green foliage that turns deep wine red in early summer; fades to beige-brown by winter
ST	Threadgrass	Stipa tenuissima	1-2'h x 12" w	1 gal.	deciduous	part sun to sun	low+		spacing 20-24", works in containers; where colder than 20 degrees, treat as an annual, once turns brown can be removed immediately or in spring
	Siskiyou Blue Idaho Fescue Grass	Festuca idahoensis 'Siskiyou Blue'	18" h x 15" w	1 gal.	evergreen	full sun to light shade; avg to poor soil, dislikes moist fertile soil	xeric		year round interest in most climates; notable for its enticing spruce-blue foliage, the thin leaves are much longer than the more familiar festuca glauca, giving a softer, more graceful look, blooms late spring with tall straight tan flower spikes; partner w/Bouteloua gracilis, carex flacca, salixirorata, salix purpurea 'Nana', Sedum 'matrona', Eryngium bourgatti; recommended spacing 8-16" o.c.; can survive years with no maintenance
VINES									
TV	Trumpet Vine	Campsis radicans	25-40'h x 48" w	5 gal.	deciduous	full sun, part shade	medium		handling plant may cause allergic reaction; climbs by aerial roots, but need additional support; attracts hummingbirds; best flower production in full sun
SL	Silver Lacevine	Polygonum aubertii	climbing x 40'spread	5 gal.	deciduous	full sun	low+		showy, fast-growing vine gives two seasons of bloom; small, creamy white flowers in frothy clusters; light green heart-shaped foliage; perfect for arbor, trellis or fence
LB	Lady Banks' Rose	Rosa banksia normalis	7-20'h x 20" w	5 gal.	evergreen	full sun	medium		normalis best for fragrance, violet-scented
CH	Coral Honeysuckle	Lonicera heckrottii 'Goldflame'	10-12'h x 48" w	5 gal.	evergreen	sun/shade	medium		spacing 36-48", renowned for sweet scent, 'Goldflame' is a fragrant exception (most coral honeysuckles not fragrant); coral pink to orange flower clusters throughout growing season; contained enough to plant at base of Chinese Pistache to climb the tree and provide color under the canopy; plant it on porch or patio cover posts to attract hummingbirds

LANDSCAPE GROUND COVER SCHEDULE

SYMBOL	COMMON NAME	BOTANICAL NAME	MATURE SIZE	INSTALLED SIZE	DECIDUOUS/ EVERGREEN	LIGHT NEEDS	WATER NEEDS	LOCATIONS	REMARKS
GROUNDCOVERS									
HT	Creeping Hummingbird Trumpet	Zauschneria garrettii 'Orange Carpet'	4-6" h x 15-18" w	5 gal.	deciduous	full sun/partial shade	average to dry soil		spreads like a groundcover to form a mat of low growing, bright green foliage; mid to late summer blooms w/bright orange flowers, 'Orange Carpet' prefers some afternoon shade, especially at lower elevations
DP	Dwarf Plumbago	Ceratostigma plumbaginoides	12" h x 24" w	1 gal.	deciduous	shade/sun	medium		forms a dense ground cover with three seasons of interest; shiny apple-green leaves late spring, midsummer sheets of round cobalt-blue flowers, foliage turns red with shorter days of autumn, then drop leaving short wiry stems in winter; plant with something of equal tenacity or alone
VM	Vinca minor	Periwinkle	9" h x 24" w	1 gal.	evergreen	shade/sun	medium+		bloom late March-April, and May-June, fewer blooms when in deep shade; effective on slopes where its rooting stems will prevent erosion; can cascade over a terrace or retaining wall
KK	Kinnikinnick	Arctostaphylos uva-ursi	9" h x 24" w	1 gal.	evergreen	shade/sun	medium		blooms white w/tinge of pink April to May; extremely winter hardy, creeping, slow-growing, prostrate, woody evergreen shrub; moderate to large scale ground cover; with year round interest, helps control soil erosion on slopes and hillsides; effective when grown around shrubs, along sunny border margins, in naturalized areas and in native plant gardens, rock gardens, herb gardens or drape over a wall; fruit persists until early winter, sprigs of green leaves with red berries may be used as Christmas decorations
LT	Lily turf	Liriope muscari	9" h x 9" w	5 gal.	evergreen	shade/sun	medium+		grass-like perennial; charming, attractive violet-blue flowers give this plant its charm; useful in the landscape as a ground cover, edger or accent plant; flowers are followed by blue-black berrylike fruits in the fall, will grow well underneath trees or around shrubs but will not tolerate foot traffic (don't want spicata as it can even spread below concrete)
RR DG-1	Creeping Thyme	Thymus serpyllum	2" h x 18" w	1 gal.	evergreen	sun/shade	medium		Hairy, prostrate, creeping, woody-based perennial primarily grown as an ornamental ground cover
	River Rock			3-4"					
	Crusher Fines Gravel	Santa Fe Brown		3/4" minus					

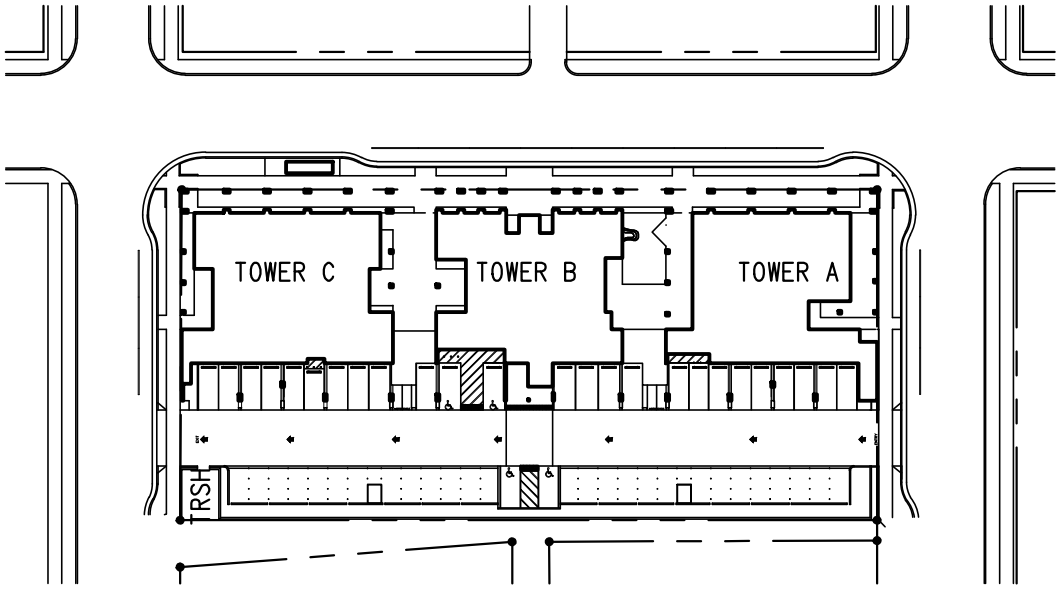

KEY PLAN

NORTH

NTS

integrated
design architecture

906 1/2 Park Avenue SW
Albuquerque, NM 87102
tel:505.243.3499
fax:505.243.3583
info@integrateddesignarch.com
www.integrateddesignarch.com

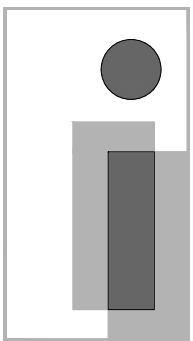

Greater Albuquerque Housing Partnership
CUATRO

Albuquerque, New Mexico

PROJECT ARCHITECT:
BOB HALL, AIA

Project #:
Date: IDA-14-13-P
SEPTEMBER 22, 2014

NEW LANDSCAPE SCHEDULES

By: KIS
File: DRB_NEW LAND PLN.DWG
Plot Date: 9/22/2014 1:20:50 PM

Sheet of

LAND200