

NORTH EXTERIOR ELEVATION - TOWER A

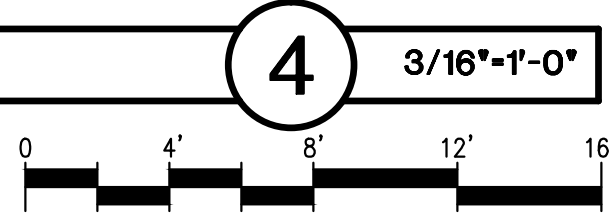

General Notes

- COORDINATE WORK WITH ALL DRAWINGS & NOTIFY ARCHITECT OF ANY DISCREPANCIES BETWEEN ALL DRAWINGS, SPECIFICATIONS, OR FIELD CONDITIONS BEFORE PROCEEDING WITH WORK.
- REFER TO DIMENSIONS, DO NOT SCALE OFF DRAWINGS.
- DIMENSIONS ARE GIVEN TO FACE OF FRAMING, FACE OF CMU, FACE OF CONCRETE, OR FACE OF SHEATHING AT EXTERIOR WALLS, UNLESS NOTED OTHERWISE.
- LARGER SCALE DETAILS ARE TO TAKE PRECEDENCE OVER SMALLER, TYPICAL.
- SEAL EXTERIOR JOINTS, SEAMS, AND PENETRATIONS IN BUILDING ENVELOPE FROM AIR LEAKAGE WITH DURABLE SEALANT OR CLOSED CELL FOAM MATERIALS CLOSED WITH GASKET SYSTEMS, TAPED OR COVERED WITH MOISTURE & VAPOR BARRIER. SEAL JOINTS BETWEEN DISSIMILAR MATERIALS TO ALLOW FOR DIFFERENTIAL EXPANSION & CONTRACTION. EXTERIOR OPENINGS IN BUILDING ENVELOPE MUST BE SEALED, GASKETED, WEATHERSTRIPPED, TIGHTLY PACKED WITH FIBERGLASS INSULATION, OR OTHERWISE SEALED WITH A FLEXIBLE MATERIAL TO LIMIT AIR LEAKAGE.
- SEE ARCH400-WINDOWS FOR DOOR, WINDOW, AND STUCCO COLOR SCHEDULES.

Keyed Notes

- 6" FIBER CEMENT BOARD COLOR 1.
- 8" FIBER CEMENT BOARD COLOR 2.
- 1/2" FIBER-REINFORCED TWO-COAT STUCCO SYSTEM WITH ACRYLIC COLOR COAT, OVER LATH, OVER (2) LAYERS OF 15# BUILDING PAPER.
- CMU BURNISHED WALL, 8x8x16.
- CMU BURNISHED COLUMNS, 8X8X16.
- CMU BURNISHED BOND BEAM, 8X8X16.
- STUCCO CONTROL JOINT, TYP.
- STUCCO EXPANSION JOINT AT FLOOR LINE TYP.
- FINISH GRADE, SEE CIVIL, TYP.
- LINE OF FINISH FLOOR BEHIND.
- JULIET BALCONY, STEEL.
- LINE OF WHITE TPO ROOF SYSTEM.
- VINYL WINDOW, TYP. SEE SHEET ARCH400 FOR SCHEDULE.
- ACRYLIC WINDOW. SEE SHEET ARCH400 FOR SCHEDULE.
- ALUMINUM STORE FRONT GLAZING. SEE SHEET ARCH400 FOR SCHEDULE.
- BALCONY.
- METAL SOLAR CONTROL AWNING, TYP.
- STEEL GUARDRAIL.
- SHOJI SUNSCREEN.
- DOOR, SEE SHEET ARCH400 WINDOW FOR SCHEDULE.
- PERFORATED METAL SIGN. SEE SHEET SITE600.
- DECK DRAIN.
- METAL CANOPY OVERHANG.
- VENTS, SEE MECHANICAL.
- METAL CAP FLASHING W/GALVALUME FINISH, TYP.
- PERFORATED STEEL SHADE STRUCTURE.
- STEEL COLUMN.
- PASSIVE COOLING TOWER.
- ORNAMENTAL METAL FENCE, SEE SHEET SITE400 & SITE 401.
- ORNAMENTAL METAL FENCE, NOT SHOWN FOR CLARITY, SEE SHEET SITE400 & SITE401.
- METAL GATE, NOT SHOWN FOR CLARITY, SEE SHEET SITE400 & SITE401.
- STUCCO WALL.
- BALCONY ROOF.
- CMU YARD WALL. SEE SHEET SITE400 & SITE401 FOR HEIGHTS, TYP.
- SITE SIGNAGE, SEE SHEET SITE600.
- PACKAGED TERMINAL AIR CONDITIONER VENT.
- ELECTRIC METERS, TYP.
- SHEET METAL.
- AUTOMOBILE ENTRANCE GATE, NOT SHOWN FOR CLARITY, SEE SITE FENCE & WALL DETAILS FOR HEIGHTS.

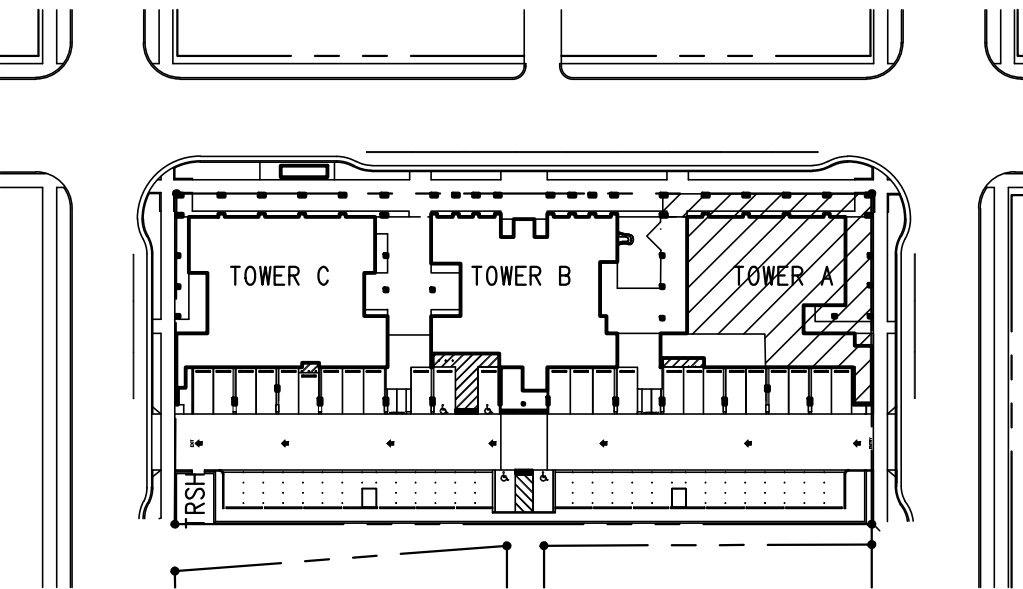

KEY PLAN

NORTH

NTS

integrated
design architecture

906 1/2 Park Avenue SW
Albuquerque, NM 87102
tel:505.243.3499
fax:505.243.3583
info@integrateddesignarch.com
www.integrateddesignarch.com

Greater Albuquerque Housing Partnership
CUATRO

Albuquerque, New Mexico

PROJECT ARCHITECT:

BOB HALL, AIA

Project #:

IDA-14-13-P

Date:

SEPTEMBER 22, 2014

NORTH EXTERIOR ELEVATION - TOWER A

By:

File: ARCH200 EXTR ELEVS.DWG

Plot Date:

9/22/2014 2:36:55 PM

Sheet of

ARCH203