

1007412

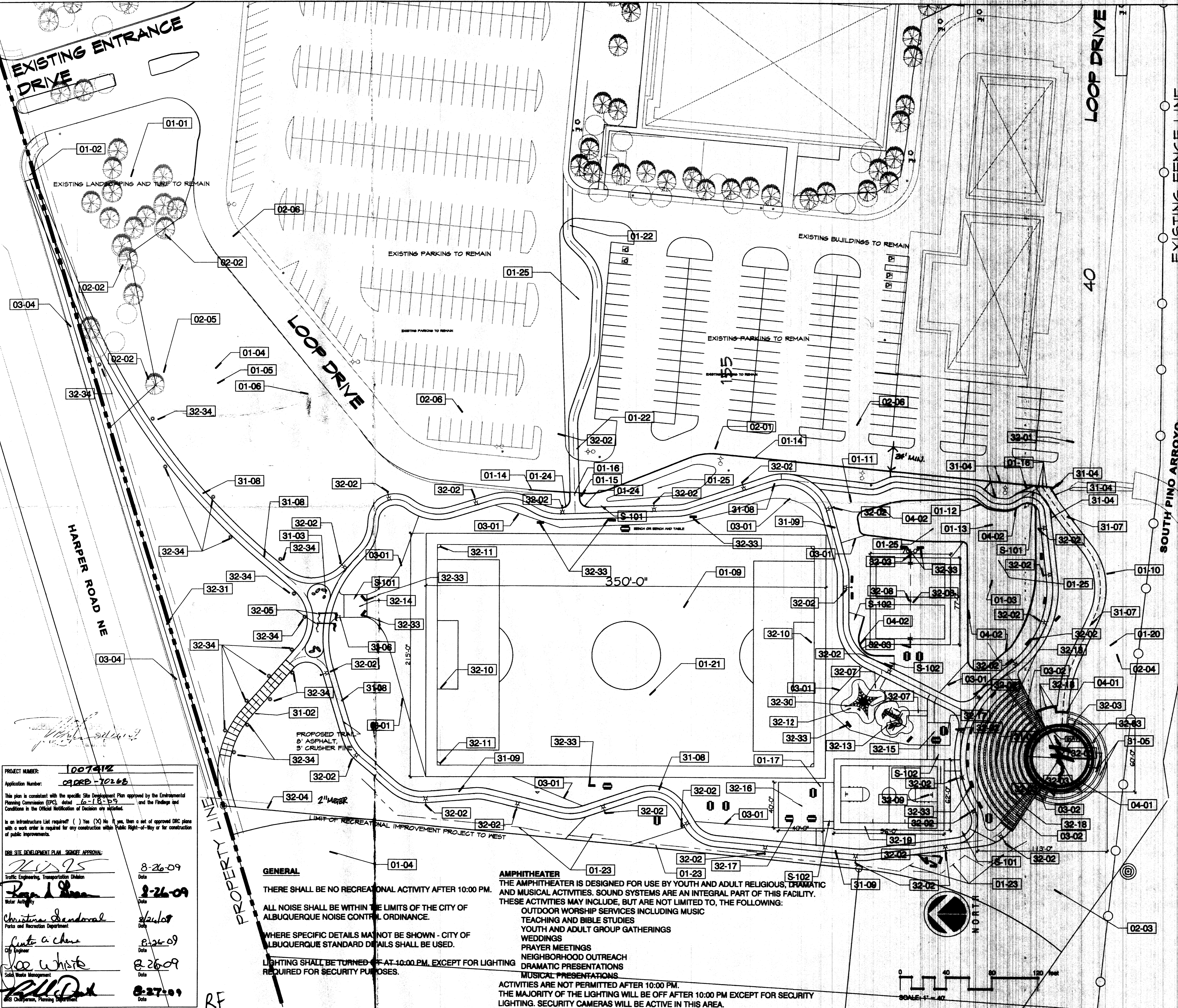

PROJECT NUMBER: 1007412
 Application Number: 092RB-10268

Christina Acuna
 City Engineer
 Date: 8-26-09

Joe White
 Solid Waste Management
 Date: 8-26-09

John D. Rupley
 Landscape Architect
 Date: 8-27-09

GENERAL
 THERE SHALL BE NO RECREATIONAL ACTIVITY AFTER 10:00 PM.
 ALL NOISE SHALL BE WITHIN THE LIMITS OF THE CITY OF ALBUQUERQUE NOISE CONTROL ORDINANCE.
 WHERE SPECIFIC DETAILS MAY NOT BE SHOWN - CITY OF ALBUQUERQUE STANDARD DETAILS SHALL BE USED.
 LIGHTING SHALL BE TURNED OFF AT 10:00 PM, EXCEPT FOR LIGHTING REQUIRED FOR SECURITY PURPOSES.

AMPHITHEATER
 THE AMPHITHEATER IS DESIGNED FOR USE BY YOUTH AND ADULT RELIGIOUS, DRAMATIC AND MUSICAL ACTIVITIES. SOUND SYSTEMS ARE AN INTEGRAL PART OF THIS FACILITY. THESE ACTIVITIES MAY INCLUDE, BUT ARE NOT LIMITED TO, THE FOLLOWING:
 OUTDOOR WORSHIP SERVICES INCLUDING MUSIC TEACHING AND BIBLE STUDIES
 YOUTH AND ADULT GROUP GATHERINGS
 WEDDINGS
 PRAYER MEETINGS
 NEIGHBORHOOD OUTREACH
 DRAMATIC PRESENTATIONS
 MUSICAL PRESENTATIONS
 ACTIVITIES ARE NOT PERMITTED AFTER 10:00 PM.
 THE MAJORITY OF THE LIGHTING WILL BE OFF AFTER 10:00 PM EXCEPT FOR SECURITY LIGHTING. SECURITY CAMERAS WILL BE ACTIVE IN THIS AREA.

- REFERENCE NOTES SCHEDULE**
- S-101: 90" W 30" LIGHT (VARIABLE LIGHTING, MONTEIRY SERIES, TYPE S, 1-1/2" HOOD) - SEE DETAIL 44P100
 - S-102: 25" W 30" LIGHT (VARIABLE LIGHTING, MONTEIRY SERIES, TYPE S, 3000 K) - SEE DETAIL 44P100
 - S-103: HOT BOX WITH INTEGRAL ELECTRICAL HEATER
 - S-104: FLAG POLE: THE FLAG COMPANY 30" POLE WITH INTERNAL LANTERN & SOUVENIR WITH FLAGPOLE BRACKET AND HOUSING IN PLACE
 - S-105: RECTANGULAR BENCH DRINKING FOUNTAIN TYPE 108
 - S-106: VENTILATED GLASS AND COLOR SYSTEM IS REQUIRED WITH PERMANENT WARE RECOMMENDATIONS - SEE COLOR BLEND PER LANDSCAPE ARCHITECT'S SELECTION
 - S-107: VOLLEYBALL STANDARDS AND NET WITH CRANE TYPE ADJUSTMENTS - SET FOR TWO NETS AND APPROX. AS SHOWN
 - S-108: BASKETBALL STANDARDS - 4" DIAMETER, GOOSENECK BASKETBALL STANDARDS WITH SQUARE 4x8x40 BACKBOARD AND BREAKAWAY RIM WITH CLAM NET
 - S-109: ACCORDION: "WORLD OF GOUL" 4-SPEAKER HEAVY WEIGHT PERMANENT MOUNTED PORTABLE COATED GOUL FRAME WITH NET AND BACK AND BOTTOM BARS, BOLTED TO CONCRETE SETTING POINTS PER MFG. REQUIREMENTS
 - S-110: PROVIDE REBAR WITH STEEL CAP AT EACH FIELD CORNER TO ESTABLISH LIMITS OF FIELD DETECTABLE ELECTRICALLY
 - S-111: LANDSCAPE STRUCTURES CLIMBING DEVICES FOR OLDER YOUTH - SET FOR TWO NETS AND APPROX. AS SHOWN
 - S-112: MARIJUA CLUBBER UNIT FOR OLDER YOUTH 12 PANEL UNIT 4'x8'x8'
 - S-113: SHADE STRUCTURE STYLE 8-A SHADE KITES 20'-20' - SEE DETAIL 44P102
 - S-114: SHADE STRUCTURE STYLE 8-B COLOR RECTANGLE 12'-11' 2" ENTRANCE - SEE DETAIL 44P102
 - S-115: SHADE STRUCTURE STYLE 8-C 4 UNITS ON 40x80 SLAB-3 COLORS - SEE DETAIL 44P102
 - S-116: ACCESSIBLE TABLE: KAY - MODEL 1115/1116A PORTABLE, WITH COATED CHAIR 12" LONG ANCHORED TO HO-BOLT IN CONCRETE CURB OR SLAB, COLOR TO BE SELECTED - SEE DETAIL 44P101
 - S-117: PORTING STANDARD STACK BLOCK, OUTDOOR WORKSHOP AREA - SEE DETAIL 44P102
 - S-118: SHADE SYSTEMS - SUPER SPAN 6 POST SHADE CLOTH STRUCTURE OVER BASKETBALL COURT W/ LIGHTING - 60x100' - SEE DETAIL 44P102
 - S-119: LANDSCAPE STRUCTURES-SPACE NET - MODEL 3030
 - S-120: 5' EXTENSION OF CRUSHER FINE RUNNING SURFACE
 - S-121: 6' RECYCLED WOOD BENCH WITH BACK - SEE DETAIL 44P101
 - S-122: LOW BOLLARD LIGHT - SECURITY
 - S-123: SITE FURNISHINGS
 - S-124: LANDSCAPE FORMS GREEN-SUPLY TRASH RECEPTACLE - 30 GAL. 42" X 30" - SEE DETAIL 44P101
 - S-125: LANDSCAPE FORMS OFF-80-LOC. SIDE OPENING TRASH RECEPTACLE - 30 GAL. 42" X 30" - SEE DETAIL 44P101
- LIGHTING SCHEDULE**
- | SYMBOL | DESCRIPTION | QTY |
|----------|-------------------------------------|-----|
| [Symbol] | LIGHTING LIGHT STD-01 W SECURITY SZ | 2 |
| [Symbol] | LIGHTING LIGHT STD-01 | 2 |
| [Symbol] | LIGHTING LIGHT STD-10 BOLLARD 1C | 1C |

PROJECT: HOFFMANTOWN CHURCH RECREATION AREA

SHEET TITLE: SITE DEVELOPMENT PLAN FOR BUILDING PERMIT

BACK TO THE DRAWING BOARD
 920 Girard Boulevard NE
 Albuquerque, NM 87106-2718
 Phone: (505) 265-2562

STATE OF NEW MEXICO
 JOHN D. RUPLEY #177
 REGISTERED LANDSCAPE ARCHITECT

NO.	REVISION	DATE	BY	APPROVED

PROJECT: 200802
 DESIGN: JDR
 DRAWING: HTRW, LC100.dwg
 CHECKED: JR
 DATE: 05/15/2009
 DRAWN: JDR
 SCALE: AS NOTED

SHEET NO. LC1.01

02 of 13